



Cement
Coller
Kleben
Pegar
Incollare
Colar
Kleven



DO NOT Cement
Ne pas Coller
Nicht Kleben
No Pegar
Non Incollare
Nao Colar
Niet Kleven



Cut away
Couper
Scheiden
Cortar
Tagliere
Cortar
Snijden



Optional parts
Choix
Auswahlmöglichkeit
Eleccion
Scelta
Opaco
Keuze



3

Repeat operation
Répéter l'opération
Vorgang wiederholen
Ripetir la operacion
Ripetere
Repitir a operacao
Herhalen

1 FUSELAGE ASSEMBLY

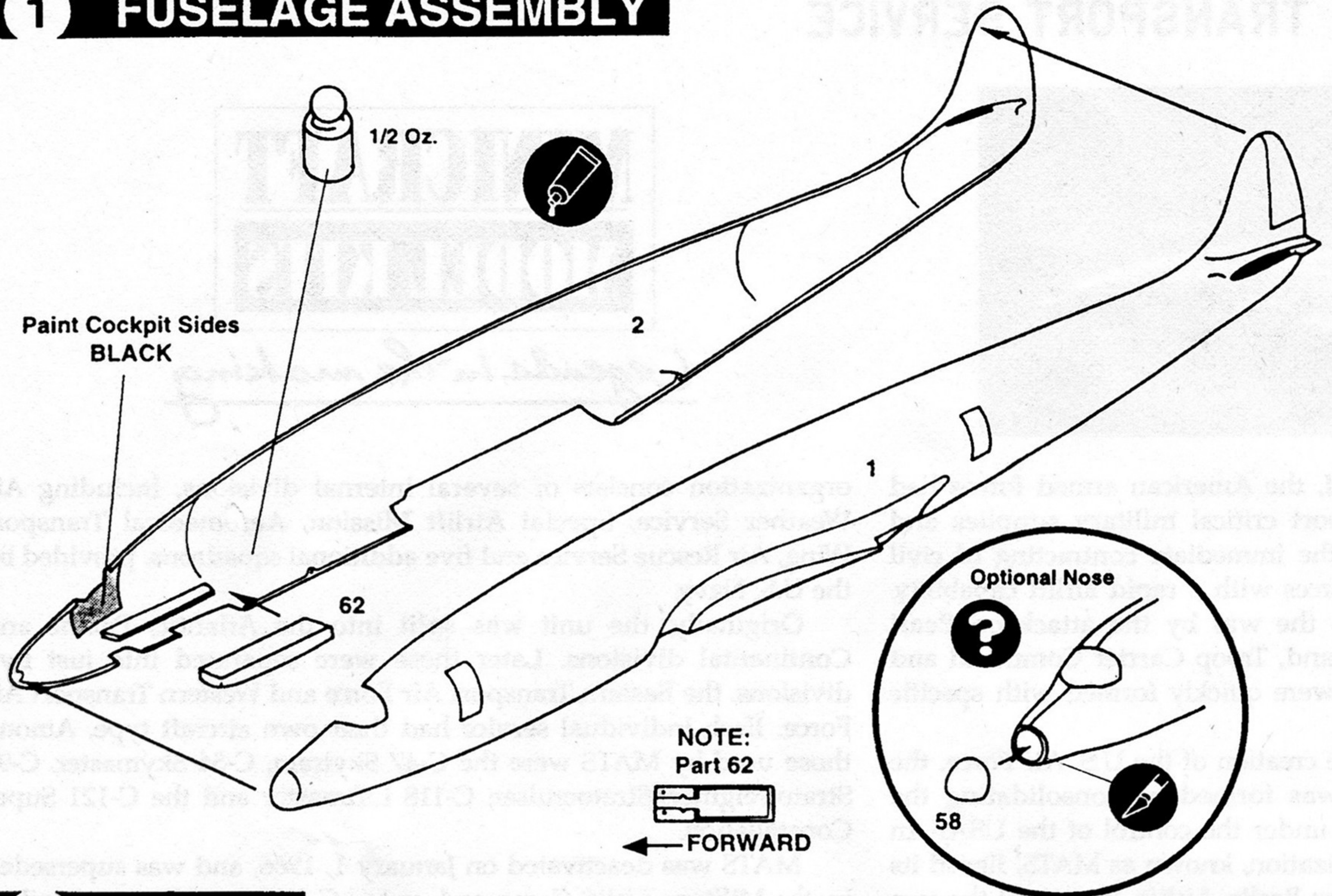

2 WINGS

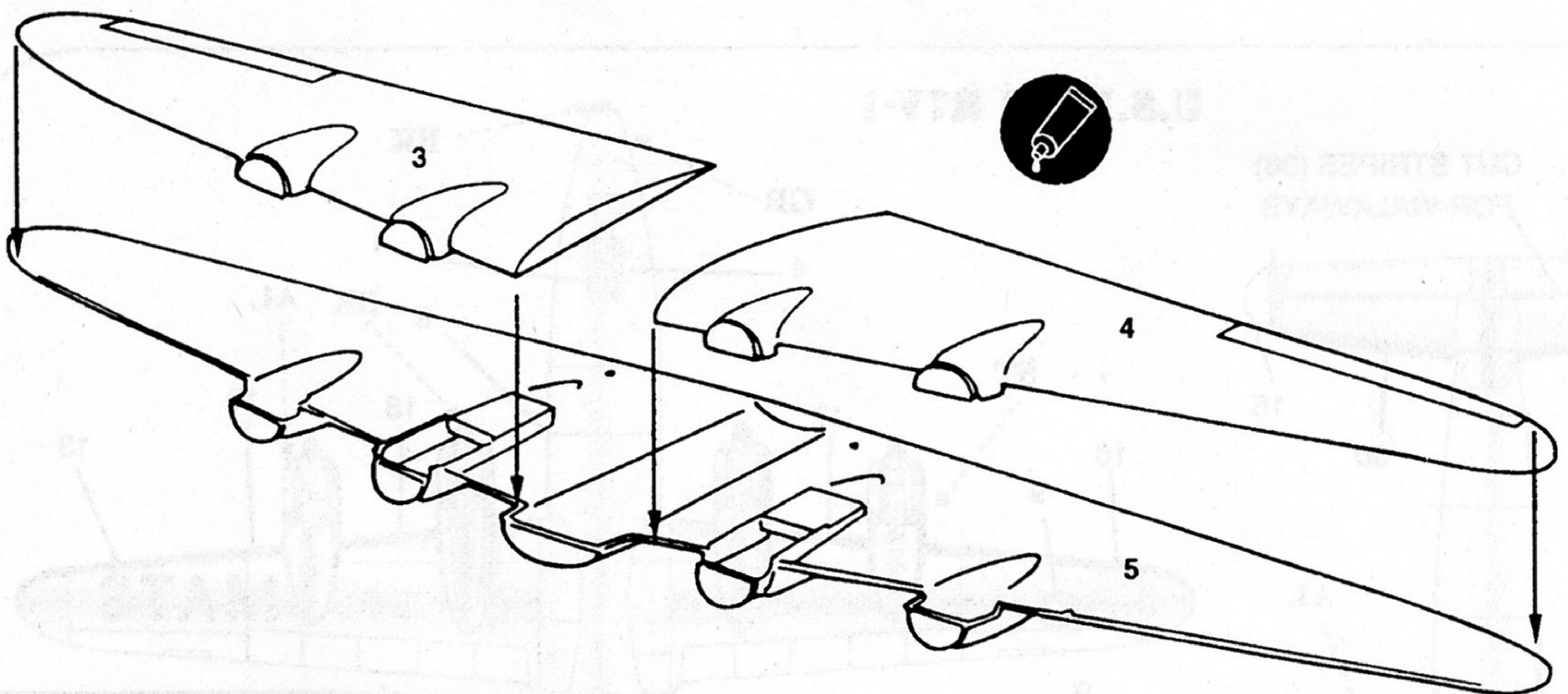

3 WING TIP TANKS

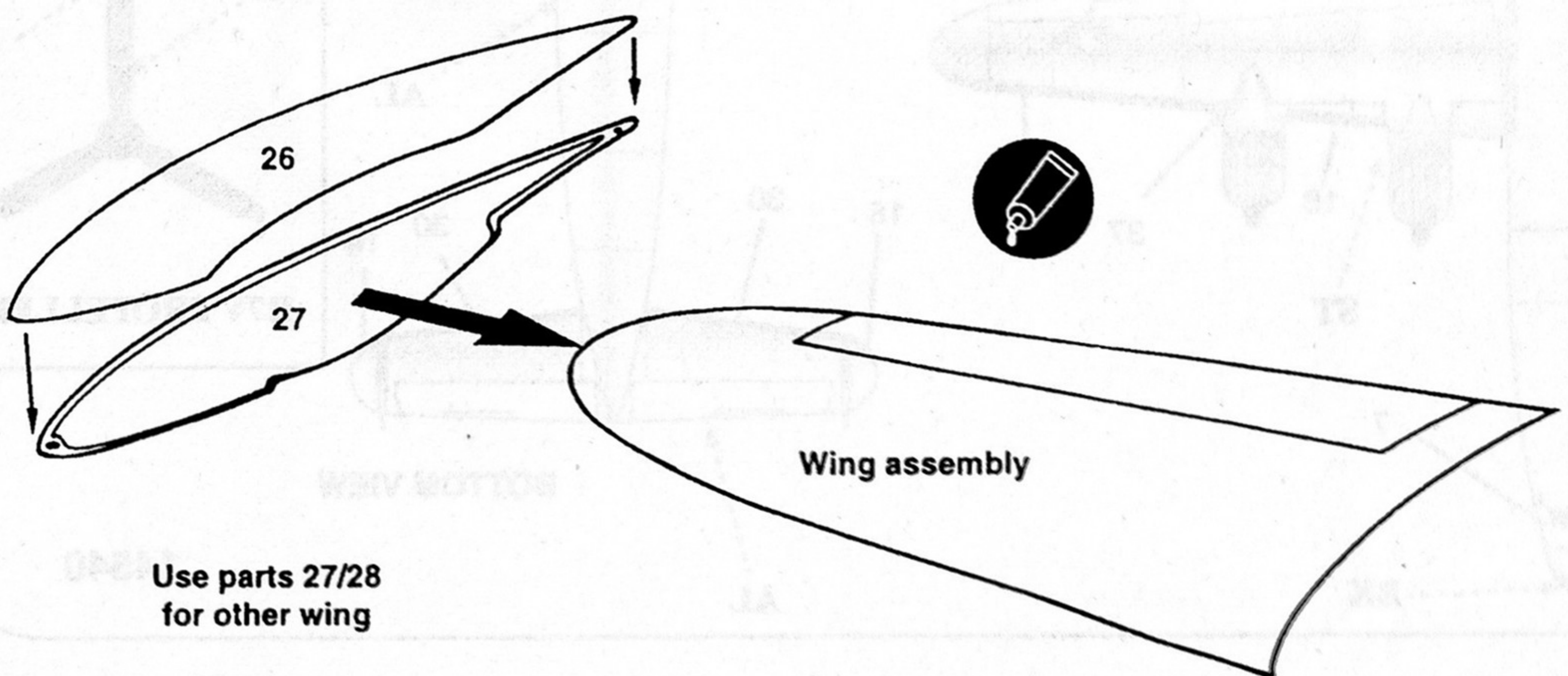

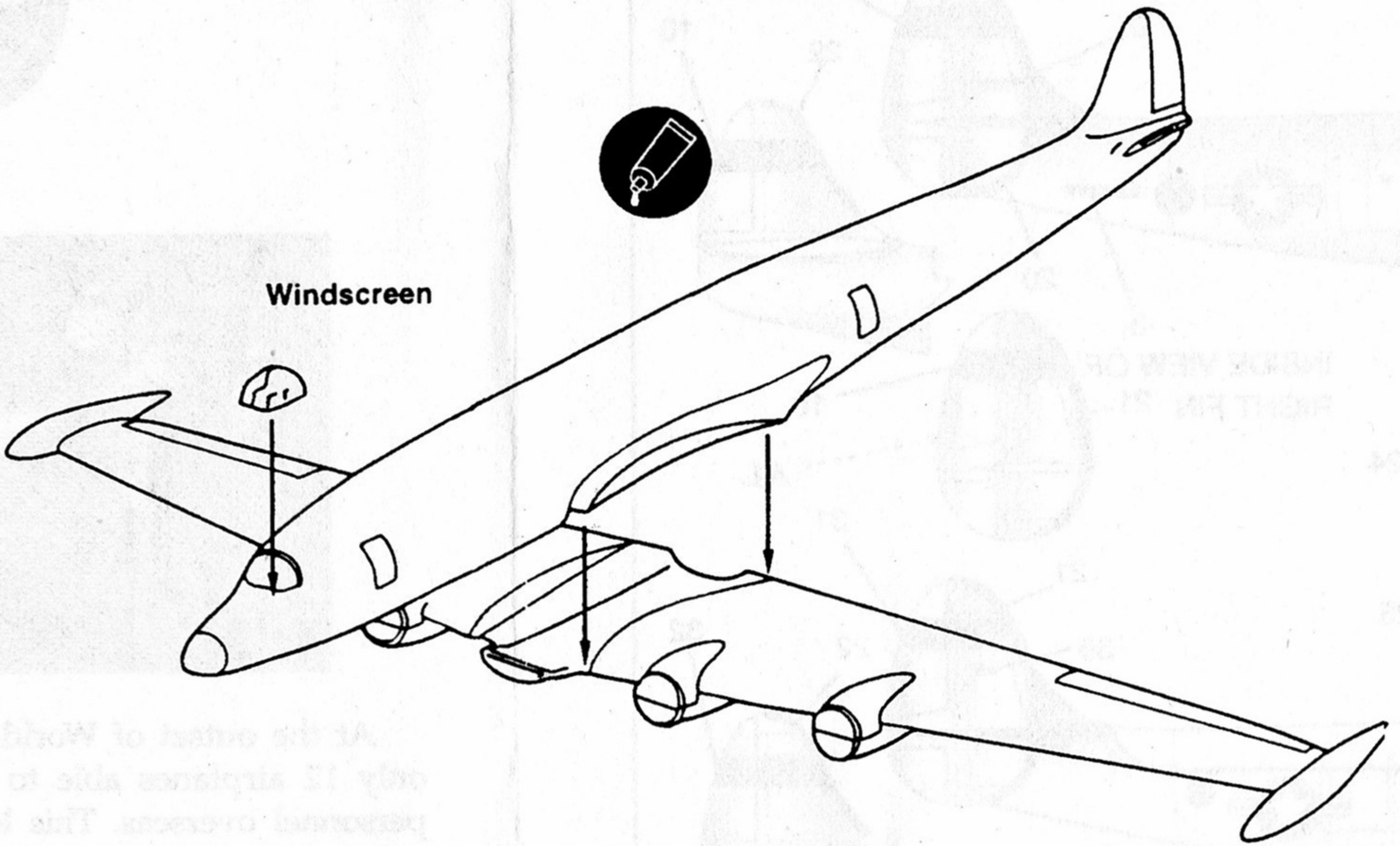
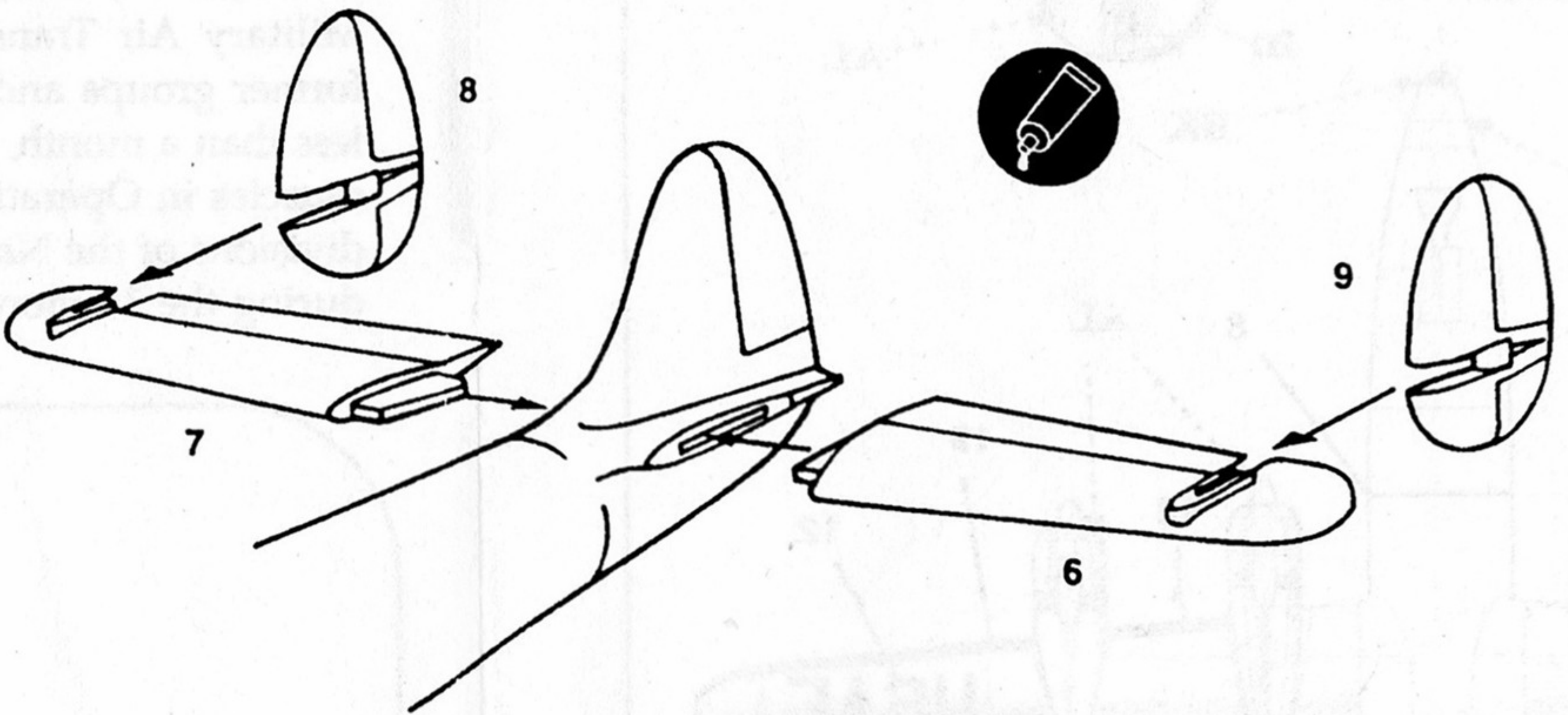
4**FUSELAGE / WINGS****5****TAIL ASSEMBLY****6****NOSE GEAR**

- Tires BLACK
- Hubs ALUMINUM
- Struts ALUMINUM
- Gear Door Interiors and Gear Wells ALUMINUM

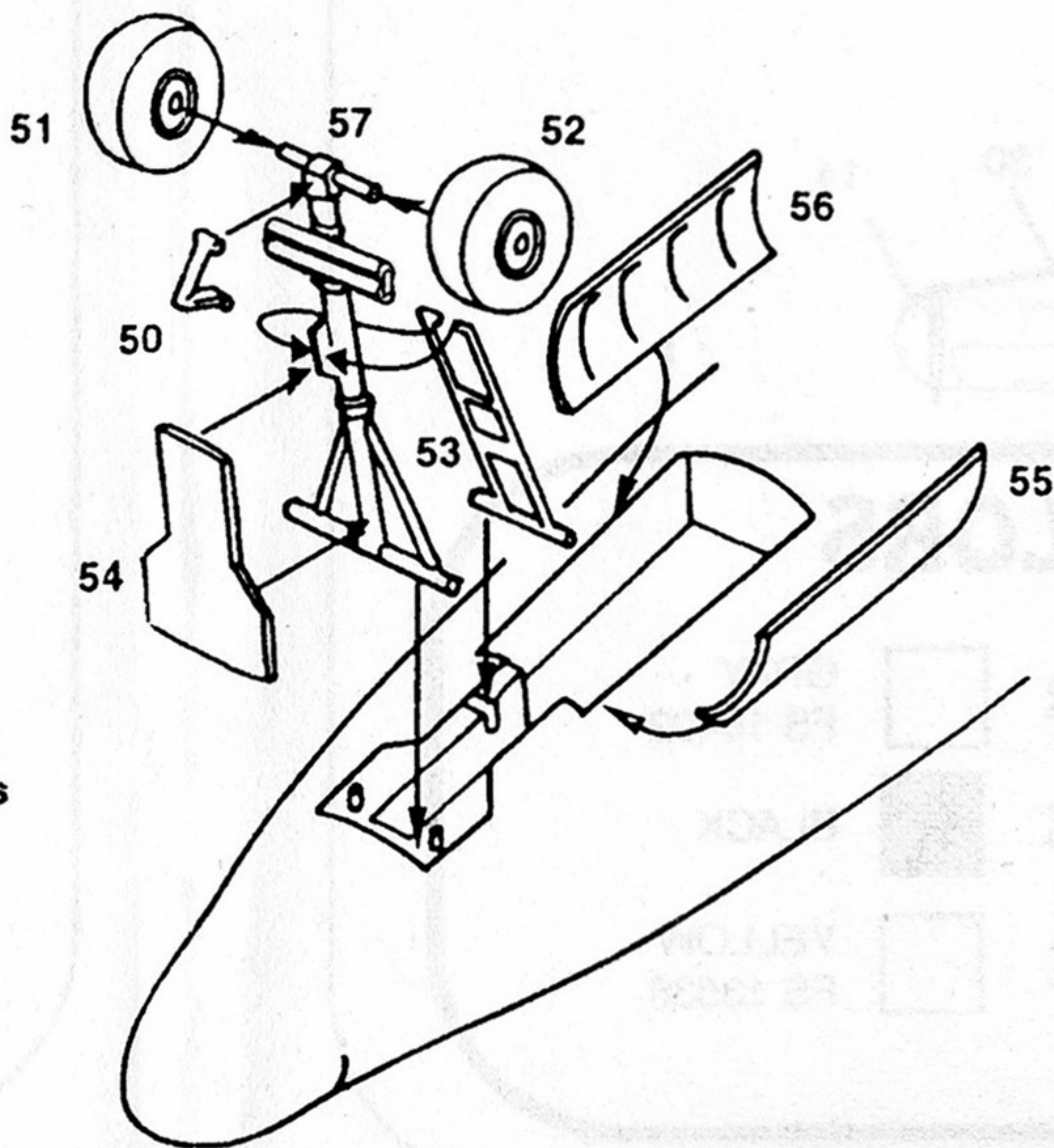

7

MAIN LANDING GEAR

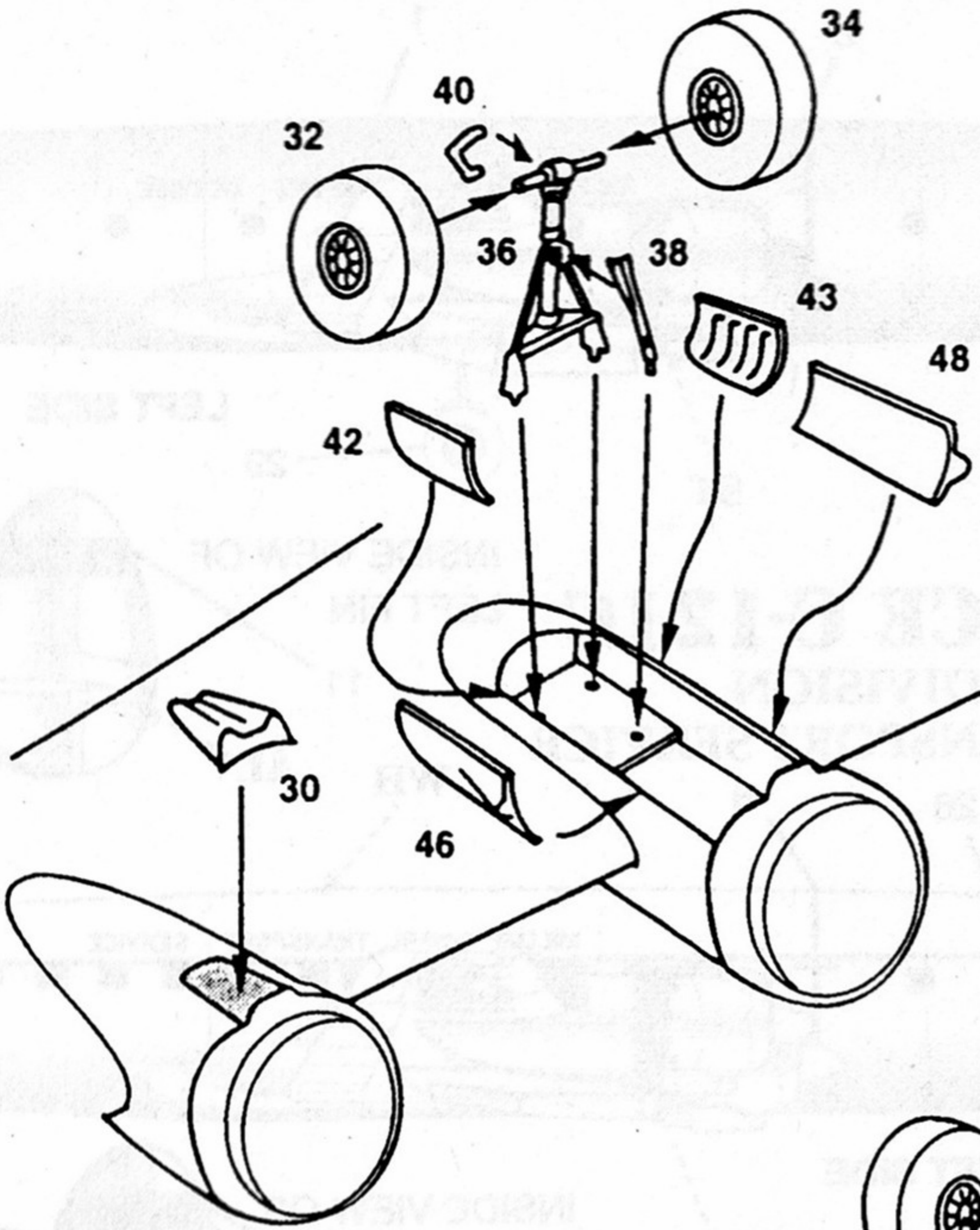

- Tires BLACK
- Hubs ALUMINUM
- Struts ALUMINUM
- Gear Door Interiors and Gear Wells ALUMINUM

Port (Left) Main Gear

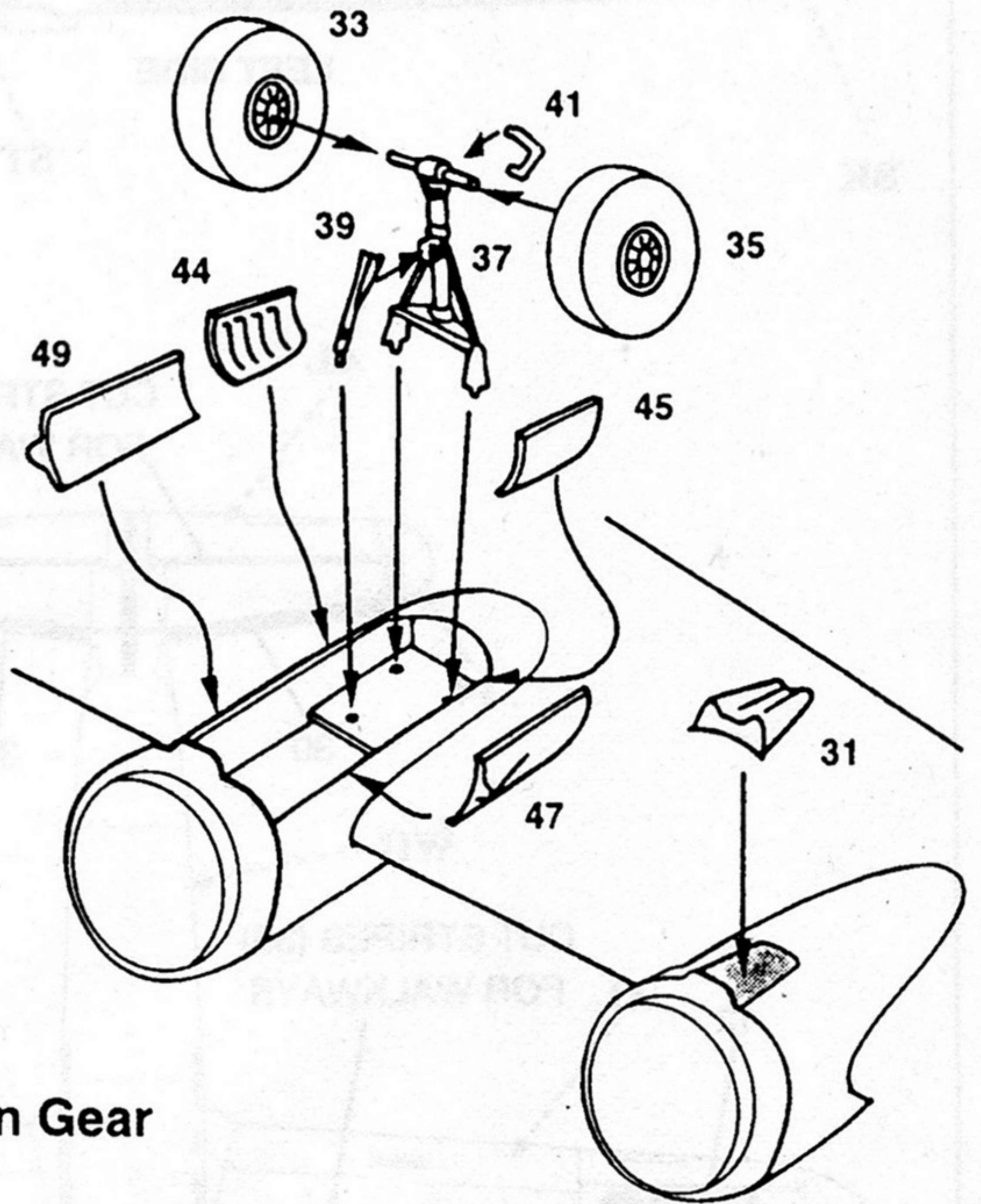

- Tires BLACK
- Hubs ALUMINUM
- Struts ALUMINUM
- Gear Door Interiors and Gear Wells ALUMINUM

Starboard (Right) Main Gear

8

POWERPLANTS

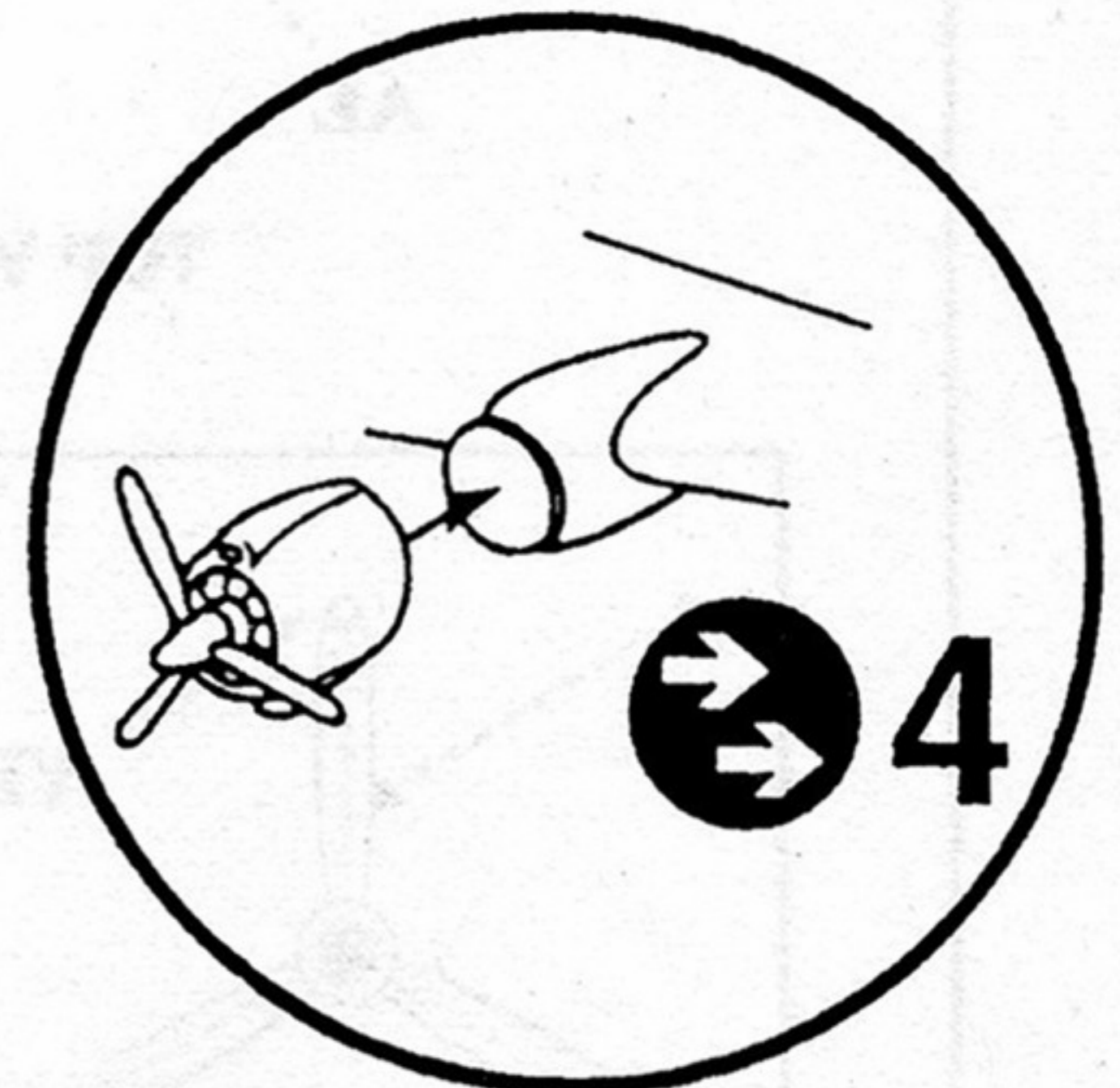
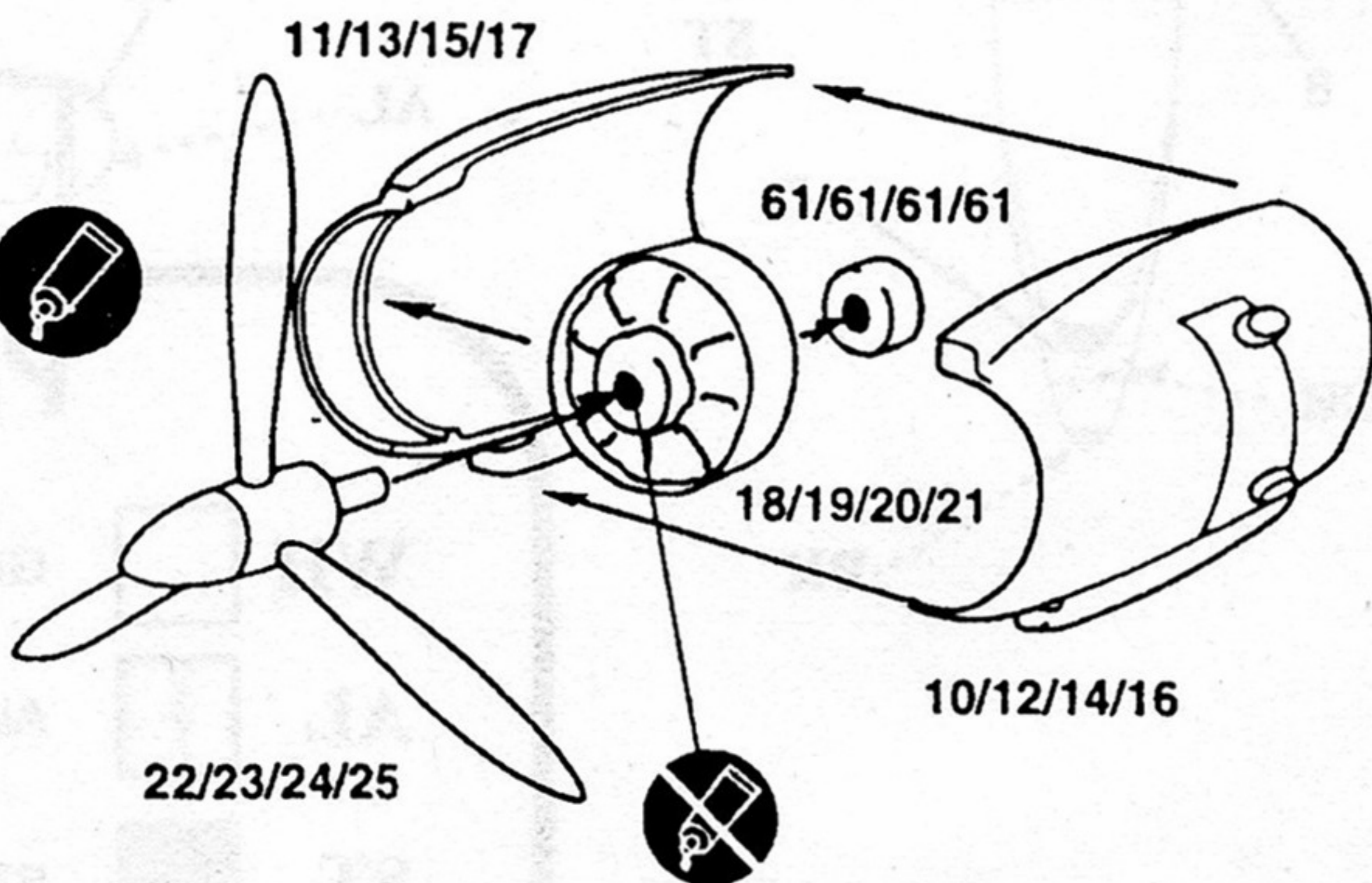

- Cylinders STEEL
- Gearbox GRAY
- Magnetos BLACK
- Cowling Interior ALUMINUM
- Propeller Hub ALUMINUM
- Propeller Blades FLAT BLACK

U.S. NAVY R7V-1
R7V-1, VR-8, PACIFIC DIVISION
MILITARY AIR TRANSPORT SERVICE

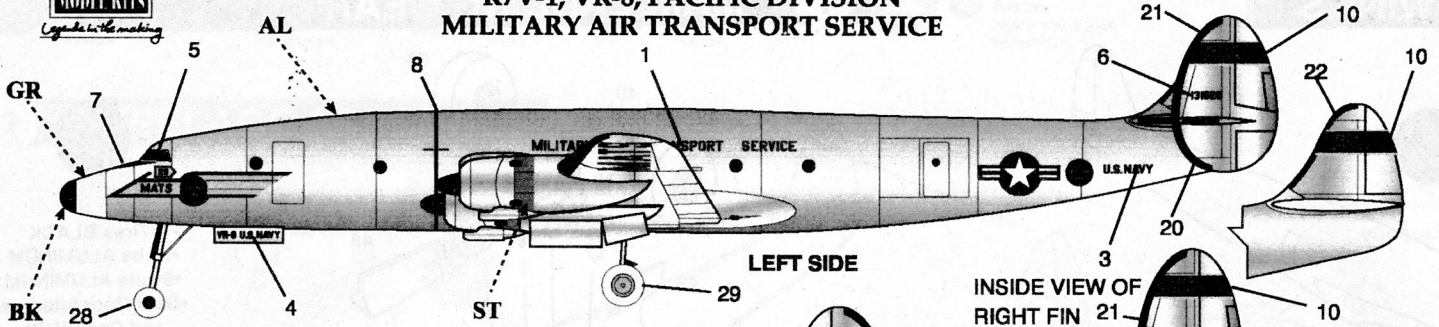

U.S. AIR FORCE C-121C
ATLANTIC DIVISION
MILITARY AIR TRANSPORT SERVICE

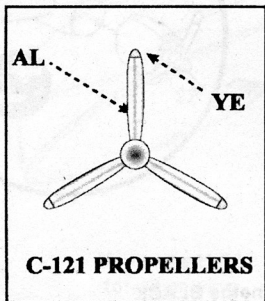
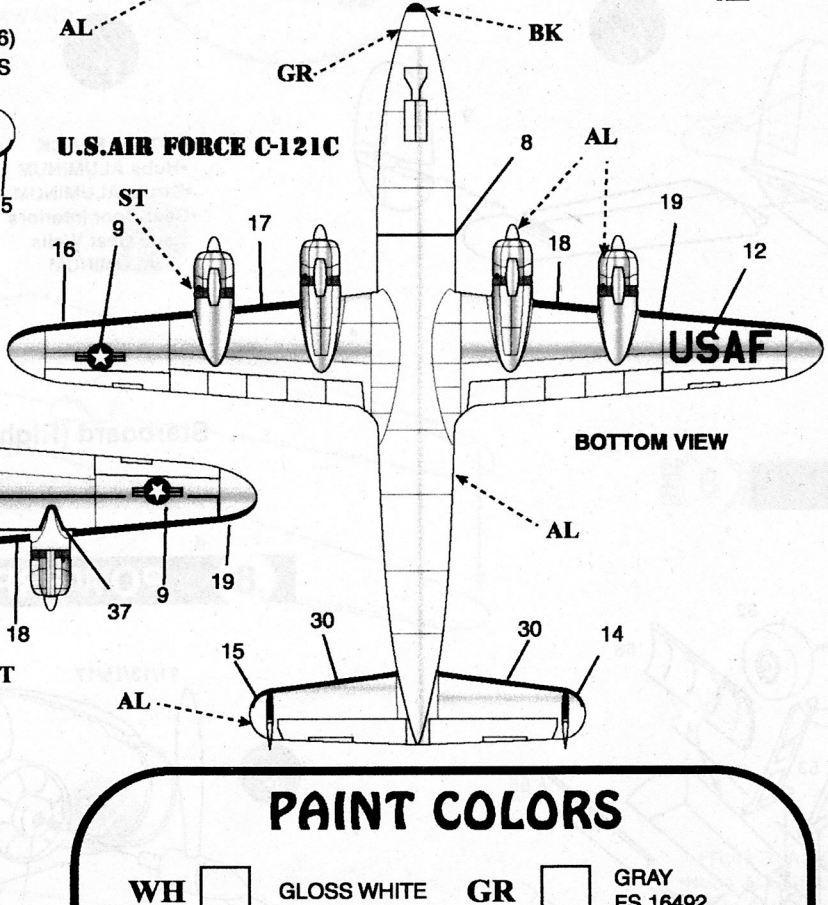
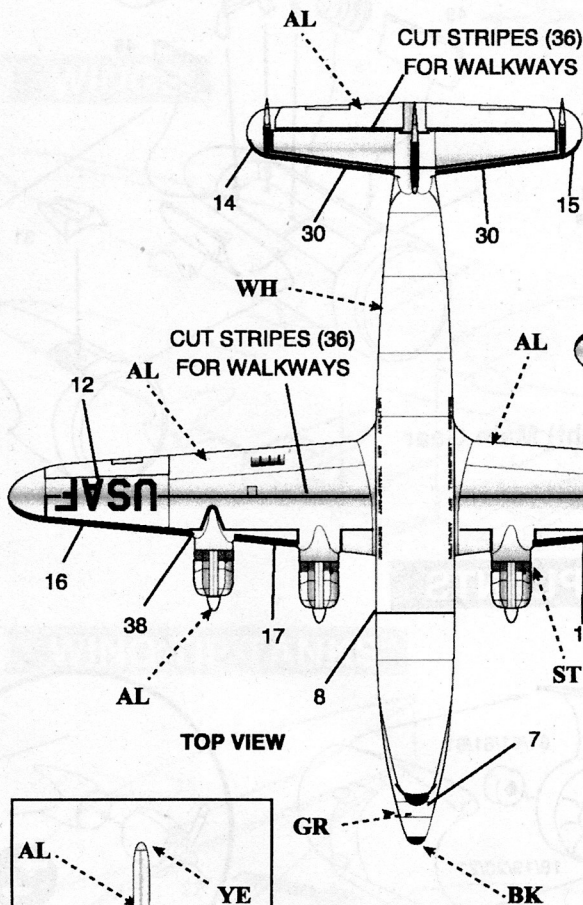
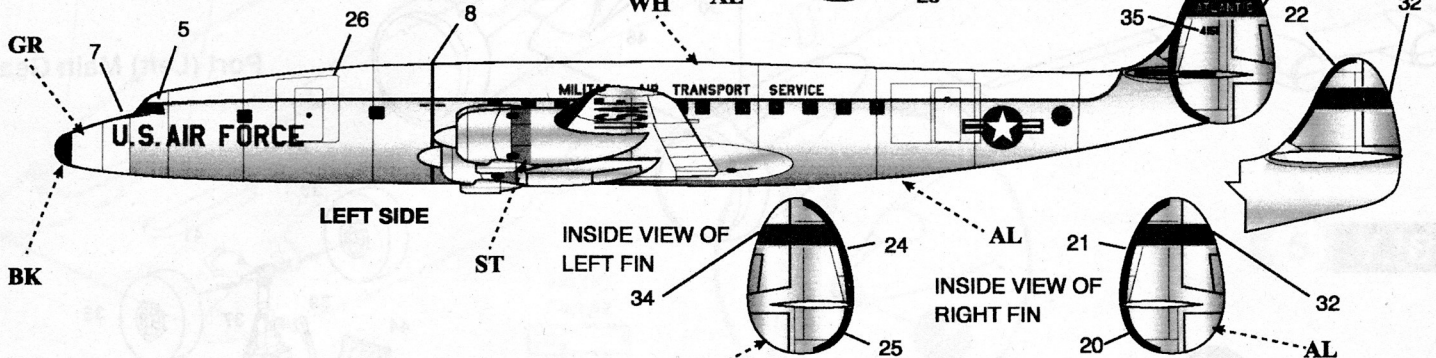

PAINT COLORS

WH		GLOSS WHITE	GR		GRAY FS 16492
AL		ALUMINUM	BK		BLACK
ST		STEEL	YE		YELLOW FS 13538