

# F4U-5 Corsair



The Corsair was developed in 1942 as an aircraft carrier based high performance fighter. The Corsair used the most advanced and powerful radial engine available to turn the largest propeller that could be fitted to the airframe. To accommodate the large propeller the wings were bent to give the large propeller clearance of the landing surface thus giving the airplane the nickname "bent wing bird". After significant challenges during the development and deployment of the Corsair were overcome, the F4U Corsair was recognized as one of the best fighters in world War Two. The Corsair served the US Navy as a first line operational fighter and fighter-bomber from World War Two to the Korean War from 1950 to 1953. After the Korean War new jets and even larger propeller driven aircraft started replacing the Corsair.

The new Minicraft 1/48 scale Corsair can be built to represent one of 2 US Navy aircraft Corsairs. The kit features recessed panel lines, detailed interior, under-wing armament including bombs and rockets and markings for the US Navy F4U-5 with 20mm cannons based on the USS Franklin D. Roosevelt and a Navy reserve aircraft based in Glenview IL.

Markings included in this kit are:

Navy Reserve AB Glenview, 1954

VF-14, CVG-1, USS Franklin D. Roosevelt, 1953

Minicraft Models (US) LLC, 1501 Commerce Drive, Elgin IL 60123 USA

[www.minicraftmodels.com](http://www.minicraftmodels.com)

Printed in China

# PARTS LOCATING DIAGRAM

11682

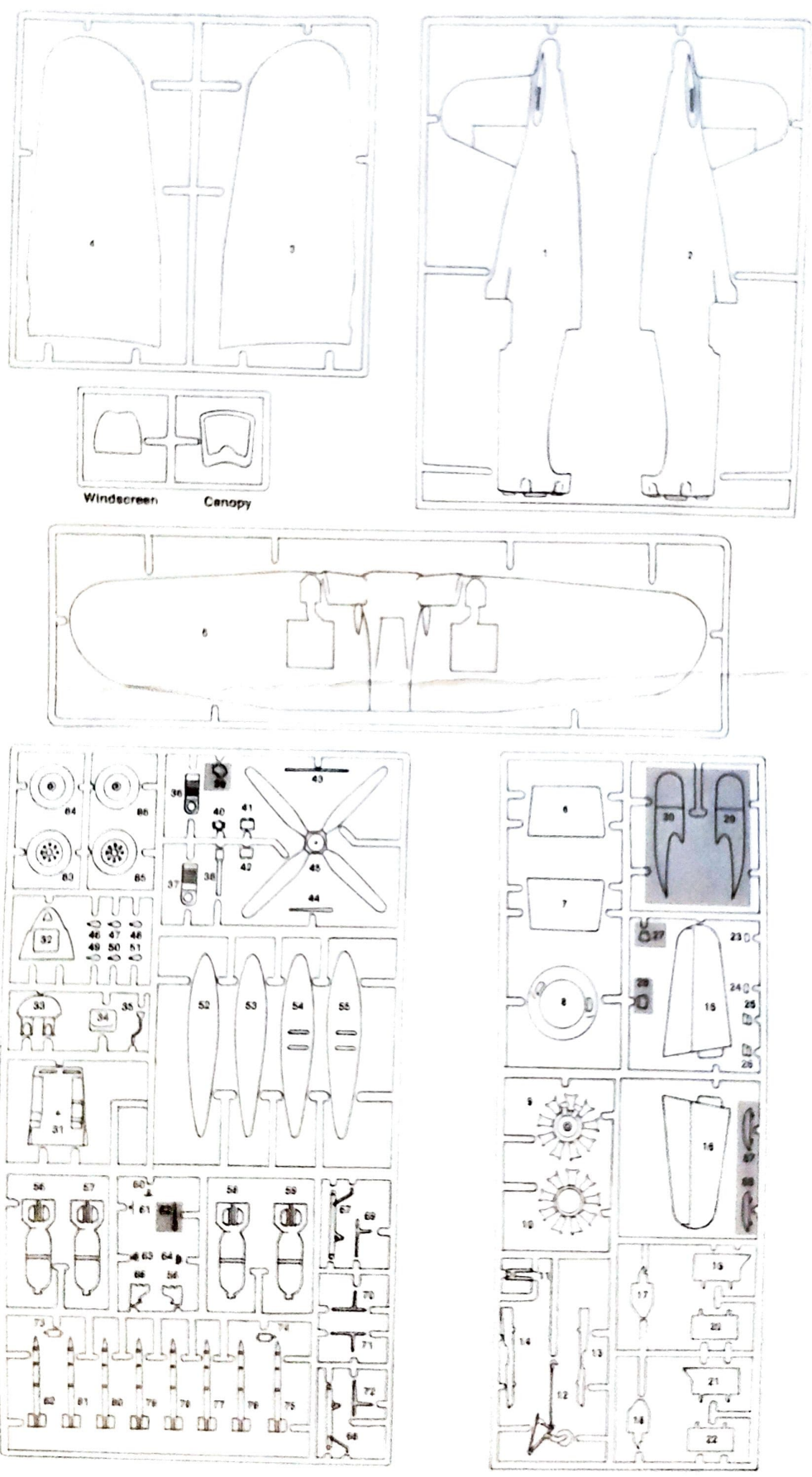

NOTE Parts shown in Gray are not for use.



- 

Cement  
Coller  
Kleben  
Pagar  
Incollare  
Colar  
Kleven
- 

DO NOT Cement  
Ne pas Coller  
Nicht Kleben  
No Pegar  
Non Incollare  
Nao Colar  
Niet Kleven
- 

Cut away  
Couper  
Schneiden  
Cortar  
Tagliare  
Cortar  
Snijden
- 

Optional parts  
Choix  
Auswahlmoglichkeit  
Eleccion  
Scektion  
Opaco  
Keuze
- 

3

Repeat operation  
R2peter f op2retion  
Vorgang wiederholen  
Repitrir la operacion  
Ripetere  
Repitrir a operacao  
Herhalen
- 

Symmetrical assembly

# 1 COCKPIT INTERIOR

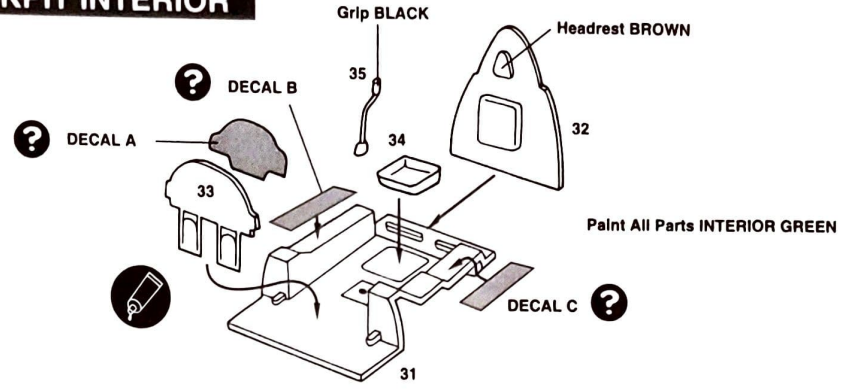

# 2 FUSELAGE ASSEMBLY

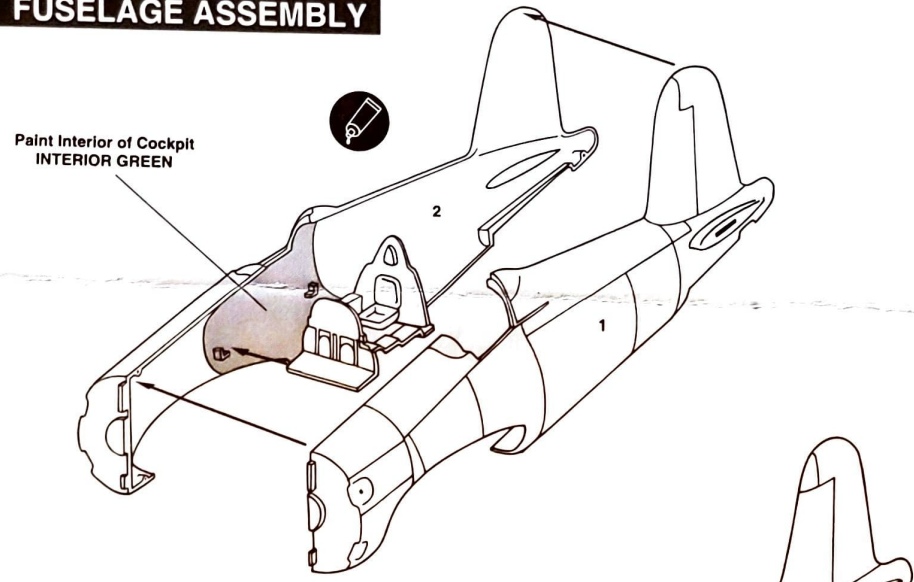

# 3 ENGINE & COWLING

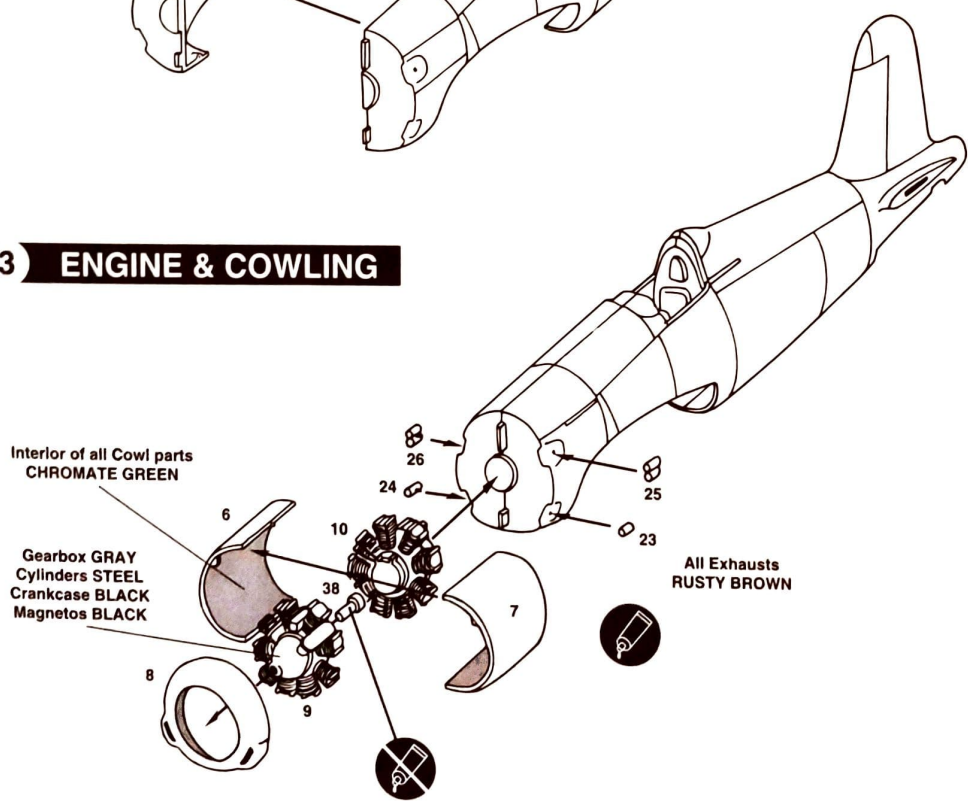

**4 WINGS**

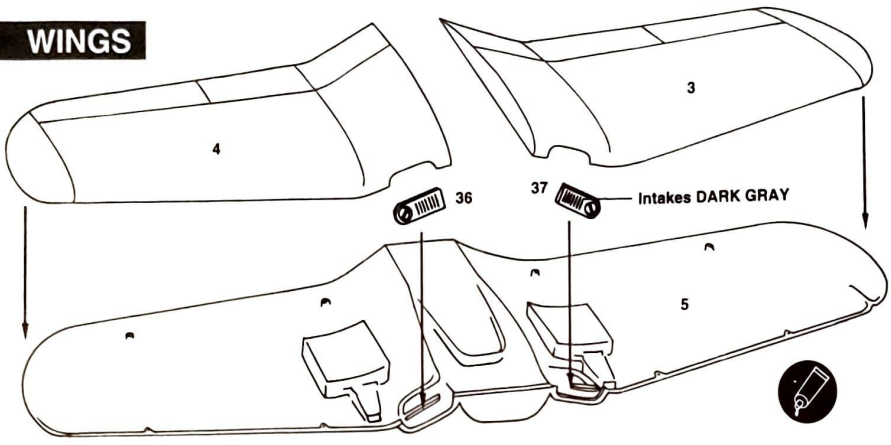

**5 WINGS/FUSELAGE/STABILIZERS**

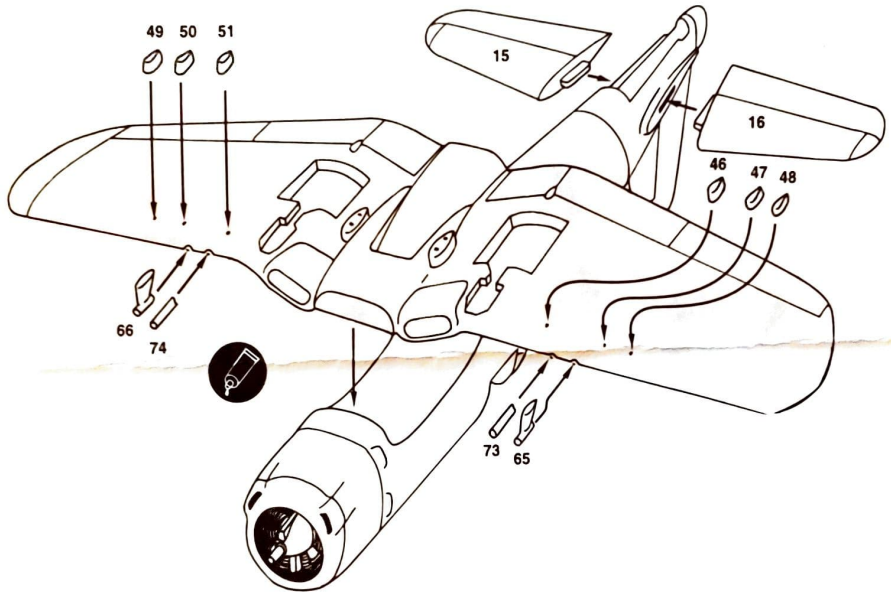

**6 MAIN UNDERCARRIAGE**

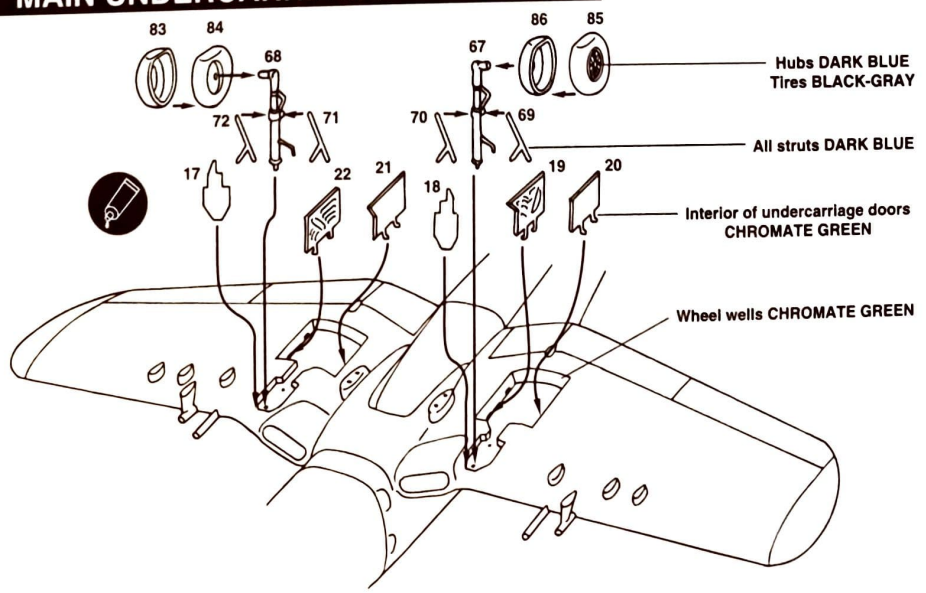

# 7 TAILWHEEL ASSEMBLY

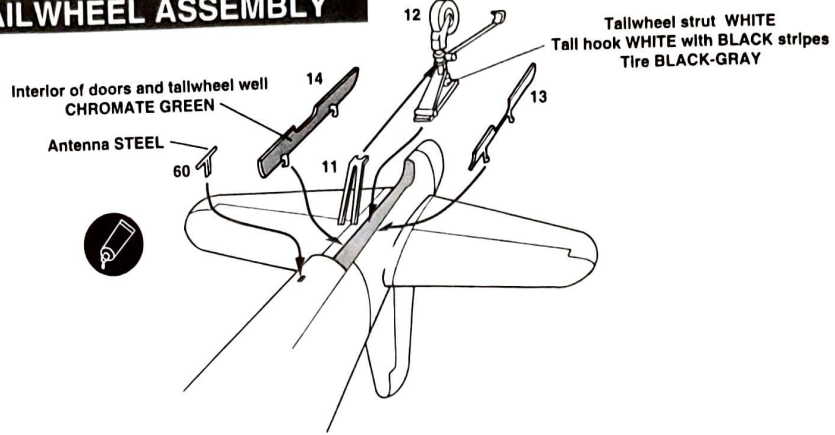

# 8 ARMAMENT

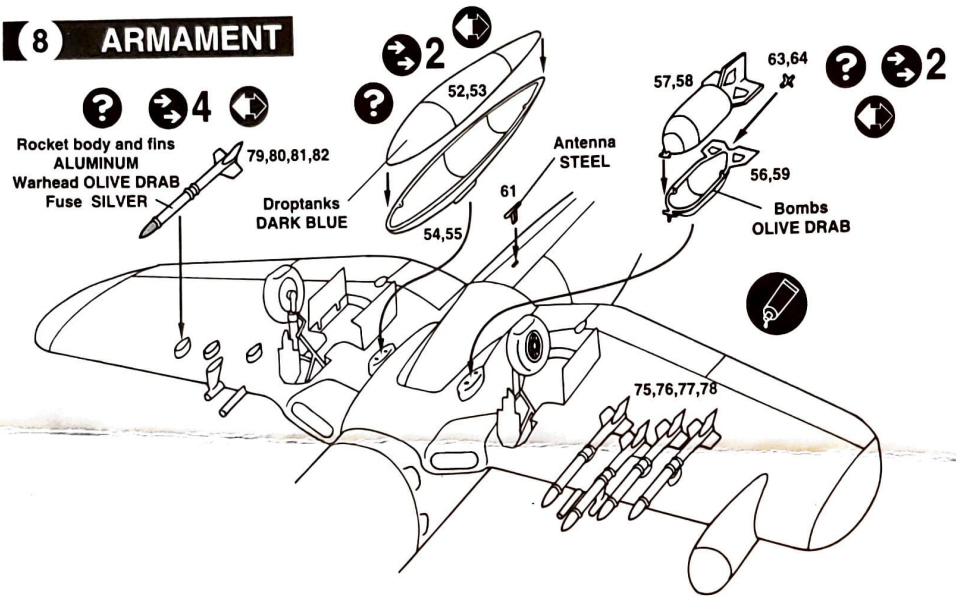

# 9 FINAL ASSEMBLY

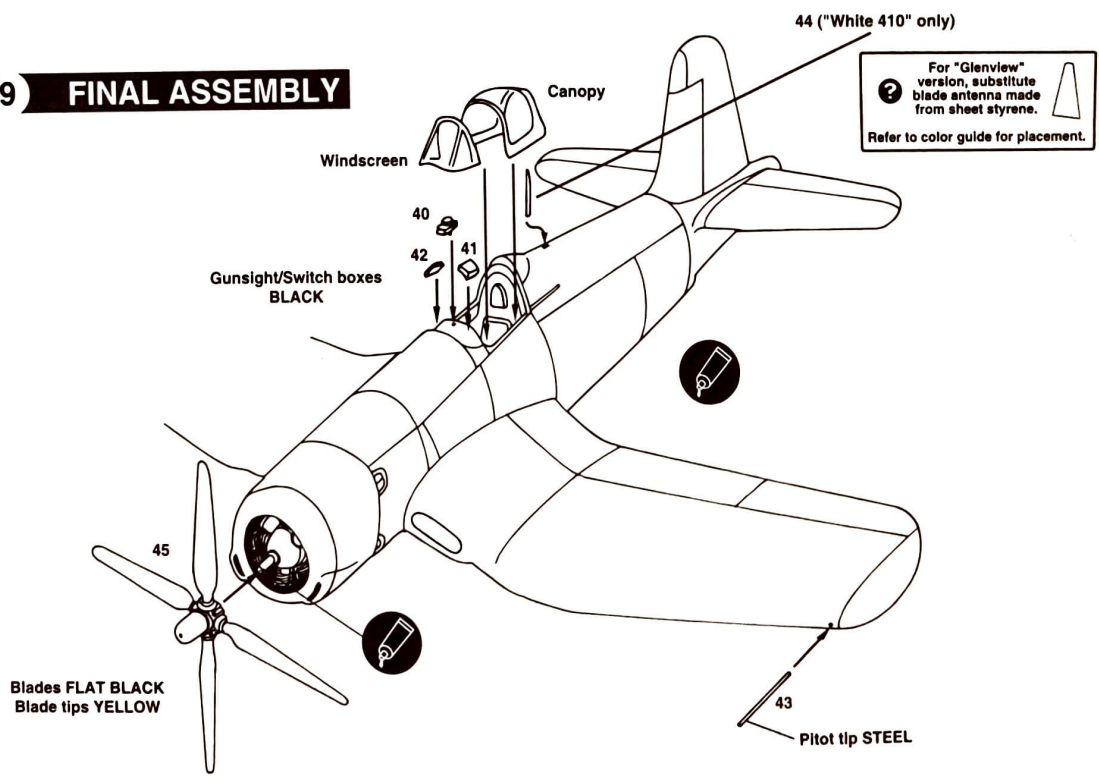



# PAINTING AND DECAL PLACEMENT

Navy Reserve AB Glenview, 1954.

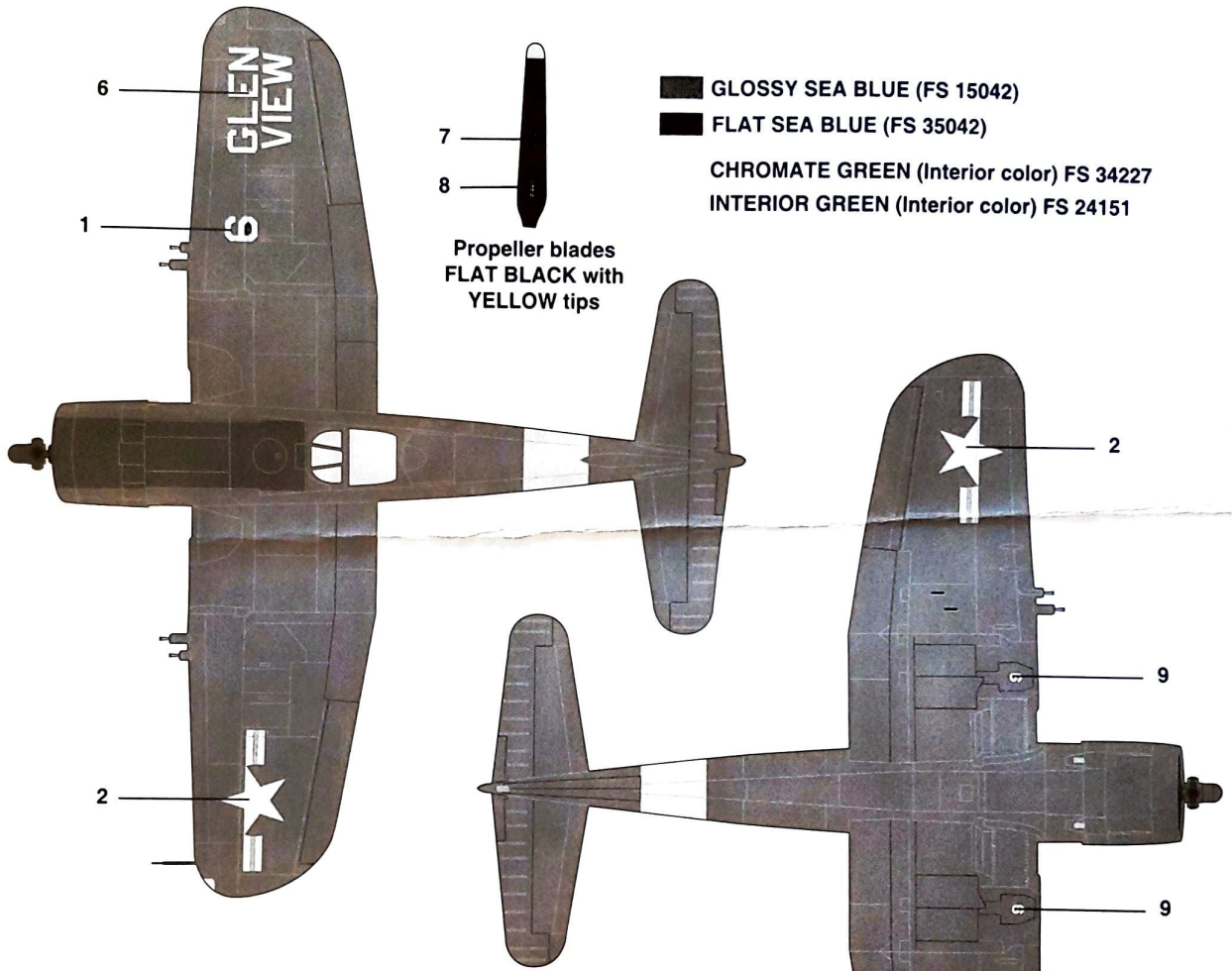
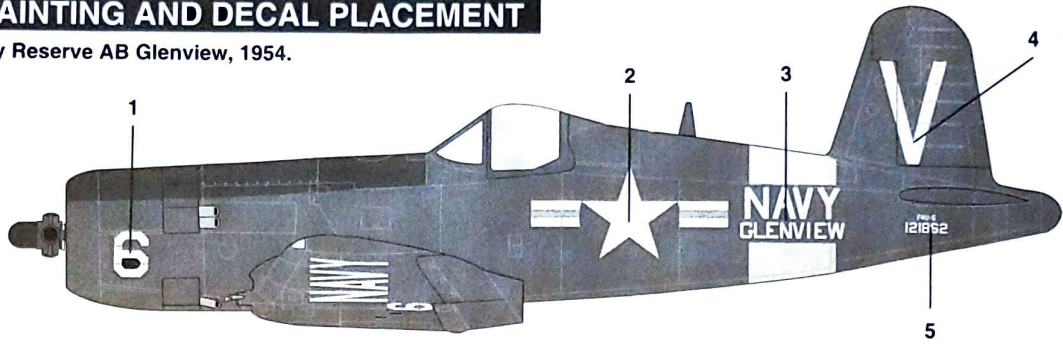

■ GLOSSY SEA BLUE (FS 15042)

■ FLAT SEA BLUE (FS 35042)

■ CHROMATE GREEN (Interior color) FS 34227

■ INTERIOR GREEN (Interior color) FS 24151

Propeller blades  
FLAT BLACK with  
YELLOW tips

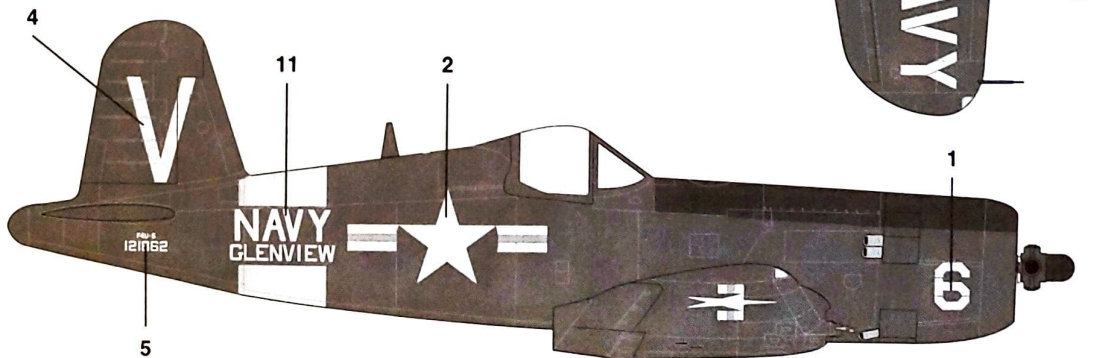

# PAINTING AND DECAL PLACEMENT

VF-14, CVG-1, USS Franklin D. Roosevelt, 1953.

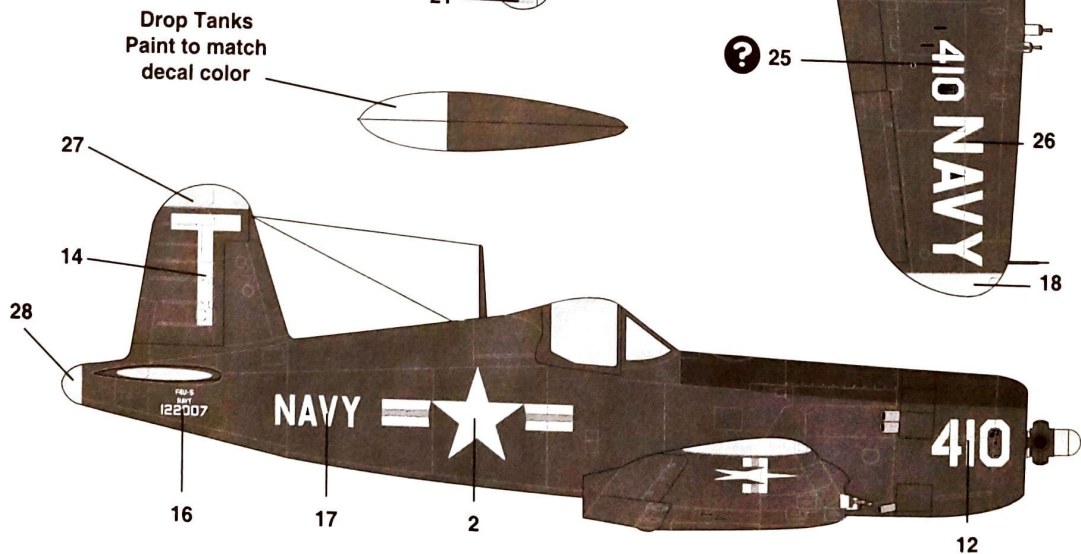
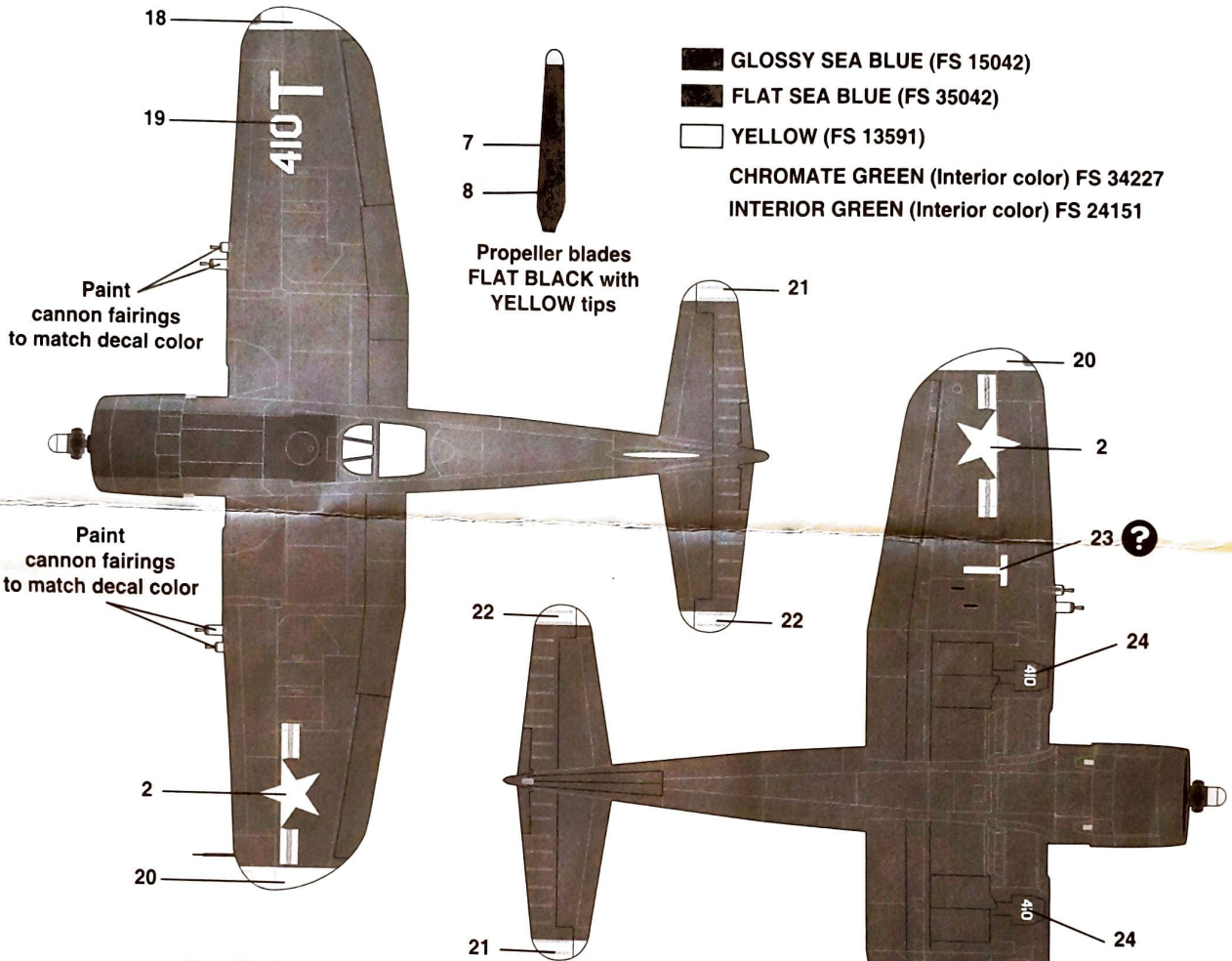
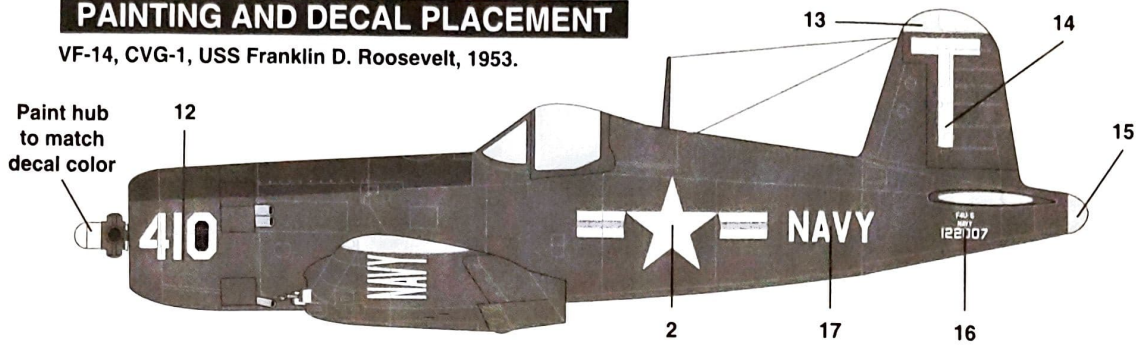



Your Minicraft model includes high-quality waterslide decals. These decals adhere best to a glossy surface; and it is recommended that you apply a clear gloss coat over your painted model.

Use a sharp scissors or knife to cut individual decals from the carrier sheet. Do not cut into the clear film surrounding the individual decals.

\* It is recommended that you apply one decal at a time.

\* Place the decal section in warm water, when first inserted in the water your decal will curl, after approximately ten seconds the decal will uncurl. Remove from water and lay on a paper towel. After approximately 10 - 20 seconds the decal will slide freely from the backing paper. Use a small brush to help slide the decal from the backing paper and into position on the model. Carefully blot excess water from the decal, using care not to move the decal or tear it.

\* If you choose to use a setting solution, apply a thin coat over the decal following the manufacturer's instruction.

\* Allow the decal to dry overnight. Wash any adhesive residue off the model with a small amount of clean water and dry thoroughly.

\* Apply clear gloss, matte or flat coat to seal decals following the instructions from the manufacturer.



*Legends in the making™*

Visit our Website-  
[www.minicraftmodels.com](http://www.minicraftmodels.com)

Minicraft Models (US) LLC  
1501 Commerce Drive  
Elgin, IL 60123

Phone: 847-429-9676

Printed in China