

Douglas Dauntless

Probably the most famous of all U.S. Naval Aircraft to serve in the Second World War, the Dauntless was already obsolete when the U.S.A. entered the war but continued in action until the final victory. The SBD Dauntless was powered by a 1,000 h.p. Wright Cyclone engine giving a maximum speed of 246 m.p.h. In the SBD-5 the 1,200 Cyclone gave a speed of 255 m.p.h. Range was 456 miles with full load and armament consisted of twin fixed 0.5

in. machine guns in the nose and either one of two 0.303 in. machine guns in the rear cockpit. Bomb load was one bomb of either 500 or 1,000 lbs. beneath the fuselage and one 100lb. bomb under each wing.

The decals in this kit are for the SBD flown by Ensign J.A. Leppla during the Battle of Coral Sea in May 1942, when he and his gunner downed seven Japanese aircraft in two days.

IMPORTANT! READ THIS FIRST

- Study assembly drawings carefully before starting.
- Each part is identified by a part number (14).
- Scrape paint from areas to be cemented.
- Before cement is used, check the fit of each part.
- Use only enough cement to join parts.
- Apply cement to small parts with a toothpick.
- Use cement made for styrene plastic only.
- Allow paint to dry thoroughly before handling.
- Your model may be painted to match the box photos.
- Cement all parts except where Do Not Cement symbol (⊗) is shown.
- Follow the step numbers (1) in each assembly drawing.
- ★ Refer to other assembly drawing for location.
- Refer to last page for decal and painting instructions.

- 5 — STEP NUMBERS
- 32 — PLASTIC PART NUMBERS
- (⊗) — OPTIONAL
- (⊗) — DO NOT CEMENT
- (⊗) — CEMENT HERE ONLY
- (2X) — REPEAT SEVERAL TIMES
- (⊗) — REMOVE
- ★ — REFER TO
- (⊗) — DECAL

© 1982 Fundimensions, Division of CPG Products Corp.

10

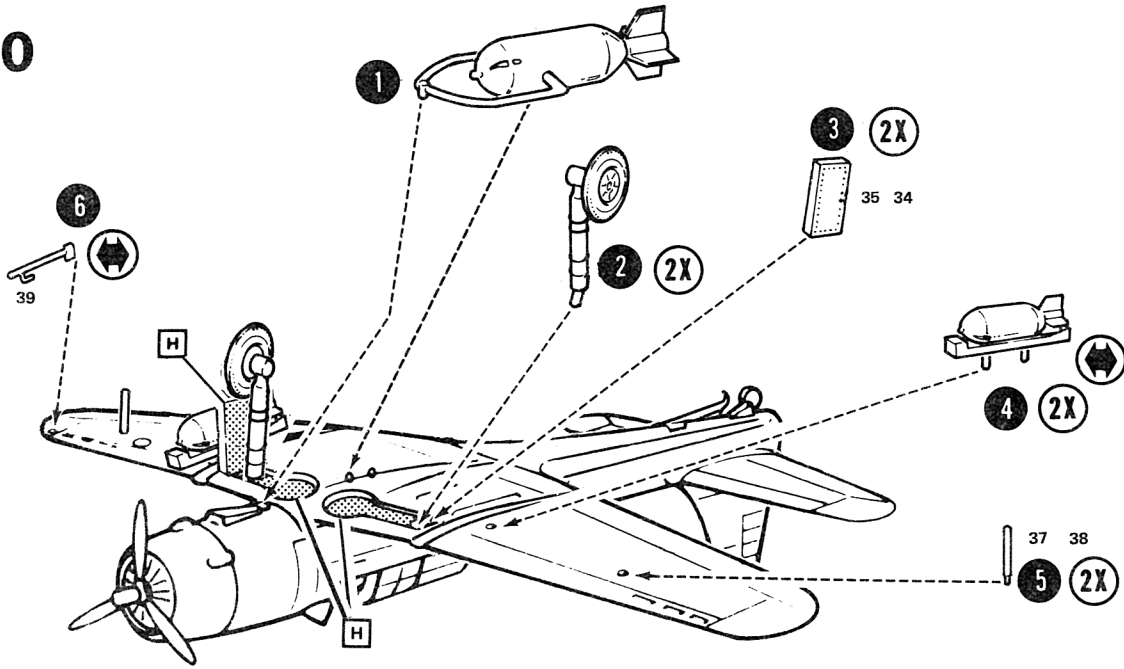

11

MARKINGS DEPICT DAUNTLESS SBD-3.

SEE BOX COVER FOR REFERENCE

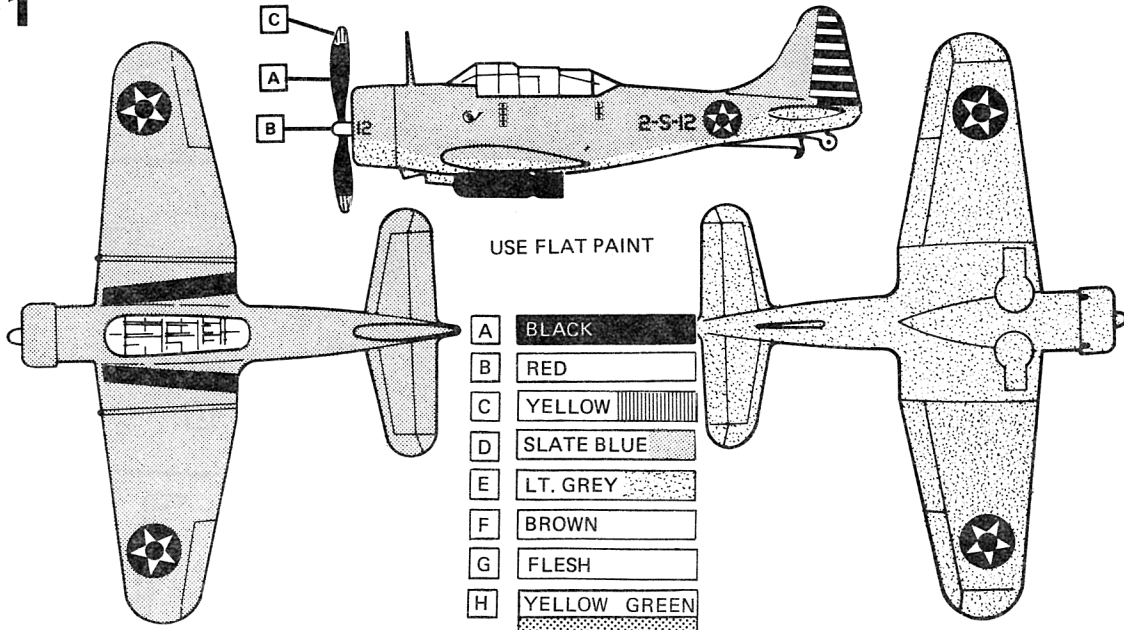

1

