

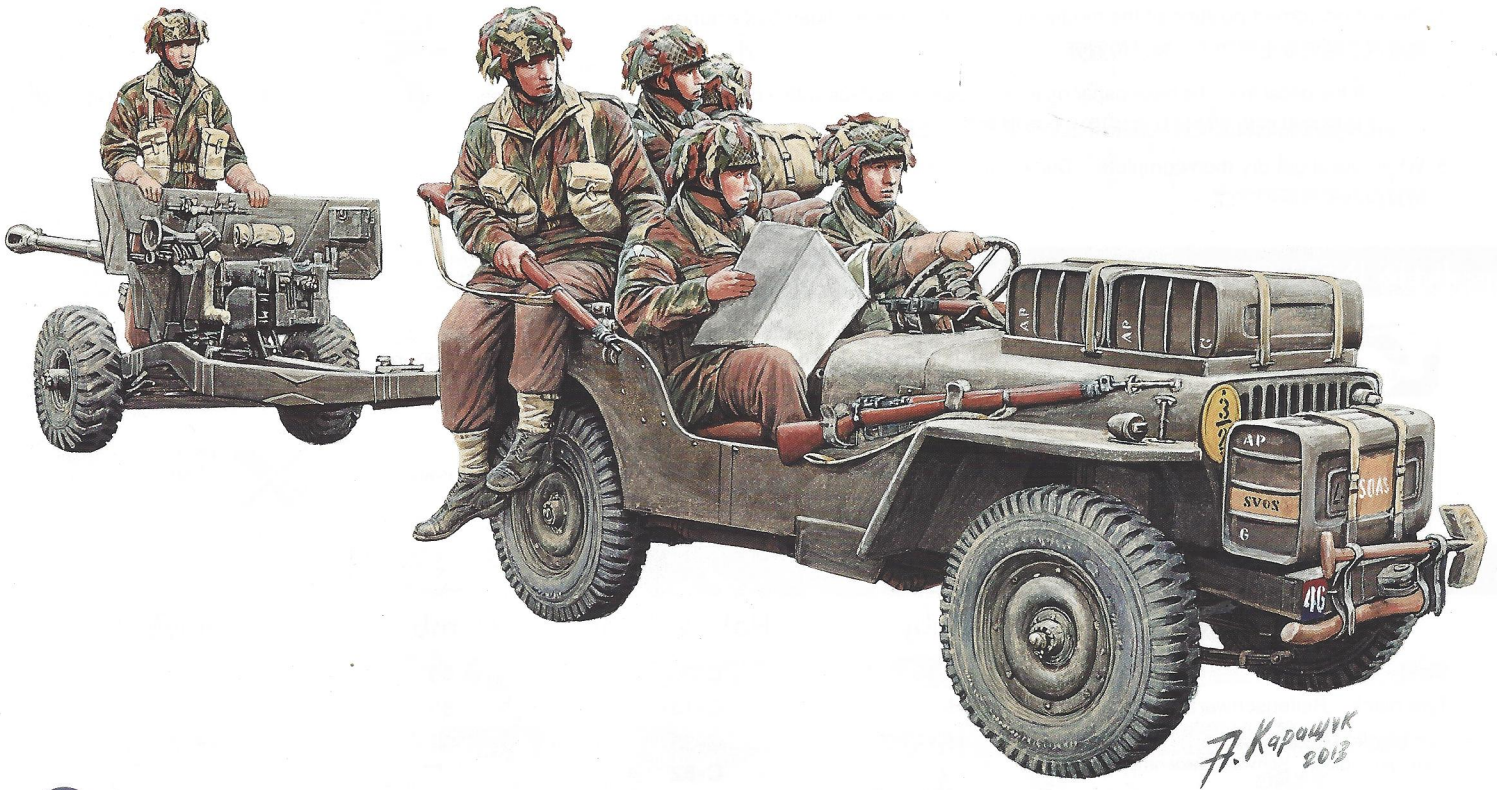

Kit No.CB-35170

British 6 Pdr Anti-Tank Gun (Airborne) With 1/4 Ton Truck & Crew

1/35 SCALE

英军6磅(空降型)反坦克炮与1/4吨多用途车辆及伞兵乘员



The 6 Pounder Anti-tank gun was chosen to equip the anti-tank batteries of the British Airlanding Brigades of the 1st and 6th Airborne Divisions. However the variant used,  OQF 6Pdr A/Tk Gun MkIV on Carriage MkIII (Airborne), had a modified carriage with 2-piece trail legs. It also featured shorter axles and modified gun shields. It was towed into battle by Jeep 1/4 ton trucks which were also used for ammunition and crew transport. The 6 Pdr fired an APCBC round that could penetrate 86mm of armour angled at 30 degrees at a distance of 1,000 meters. While the new APDS round introduced in 1944 could pierce 156mm of armour at a similar range. The 6 Pounder could destroy all but the heaviest German tanks at battle ranges, yet it was relatively light and easily handled by its crew. In action the 6 Pounder was transported by a Horsa glider, with the Jeeps carried in separate gliders. On landing the Jeeps would link up with the guns and tow them into the battle area. The guns were used in all three major Airborne battles 1944-45, D-Day, Arnhem and the Rhine Crossing.

Information & research by Phil Greenwood

Die Sechspfünder Panzerabwehrkanone war den Panzerabwehrbatterien der britischen Luftlandetruppen zugeteilt worden. Man verwendete dort das Modell OQF 6Pdr A/Tk  Gun Mk IV auf Lafette Mk III. Dieses hatte geänderte Ausleger, verkürzte Achsen und ein kleineres Schutzschild. Zum Transport gab es ¼ Tonne Jeeps, welche auch die Besatzung und Munition beförderten. Das Geschütz konnte mit einer APCBC Granate 86 mm Panzerung im 30 Grad Winkel auf 1000 Meter durchschlagen. Mit Einführung der neuen APDS Munition 1944 wurden 156 mm aus ähnlichen Entfernungen erreicht. Damit konnten außer den schweren Typen alle deutschen Panzer auf normale Gefechtsentfernung vernichtet werden. Dennoch war die Kanone relativ leicht und einfach zu bedienen. Zum Einsatz gelangten die Sechspfünder und der Jeep in getrennten Horsa Seglern. Nach der Landung wurde das Geschütz angehängt und zur Kampfzone gebracht. Man setzte es in den drei großen Luftlandeoperationen zwischen 1944-45 ein: Während der Landung in der Normandie, bei Arnhem sowie der Überquerung des Rheins.

© Translation Michael Knoblich ACADEMY EUROPE GmbH

6磅反坦克炮被挑选作为英军的第1和第6空降师反坦克旅的装备。但该炮的外形有稍作变更，是把原来的OQF 6磅反坦克炮身装在Mk.III(空降)型的载架上，它是  有两条改良过的两段式支撑腿车架。它还有改短了的轮轴及修改了炮盾的外观。它通常在战场上由1/4吨吉普车拖载，而吉普车也被用于弹药和乘员组的运输。6磅炮可发射APCBC穿甲弹能击穿1000米距离外约30度角及86毫米厚的装甲。在1944年一款新的弹药可以在上述相同距离射穿156毫米的装甲。6磅炮可以在正常战斗范围内摧毁一般的德国重型坦克，因为它较轻和容易被它的组员操作。在空降行动中6磅炮通常是与吉普车分开装在不同的‘霍莎’滑翔机。登陆后吉普车会与该炮接连起来并把它们拖往战斗区域。这款空降型的6磅炮被投送到1944年-45间发生的三场主要空降战役中，它们是法国诺曼底登陆日的‘霸王行动’、荷兰安恒地区的‘花园作战行动’及进入德国境内的‘渡过莱茵河行动’。

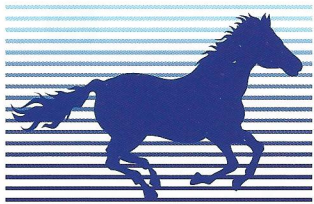

BRONCO

Bronco Models

Copyright © 2013

Made in China

中国制造

(M) × 2



(Dc) × 1

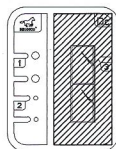

(Y) × 3

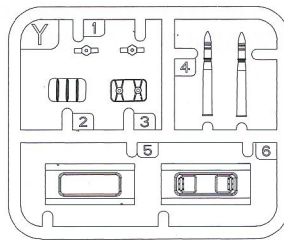

(Da) × 2

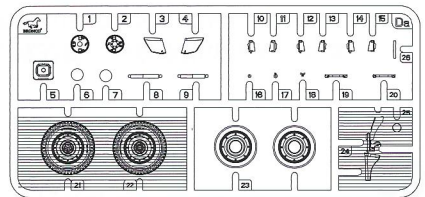

No use parts
不要部件

(Ba) × 1

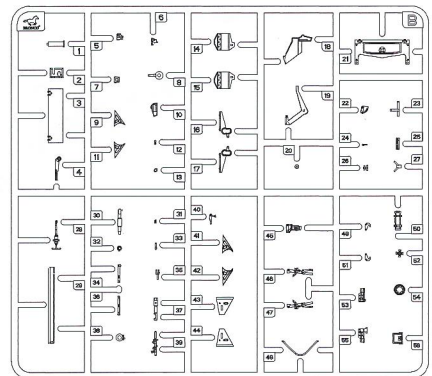

(Kc) × 3

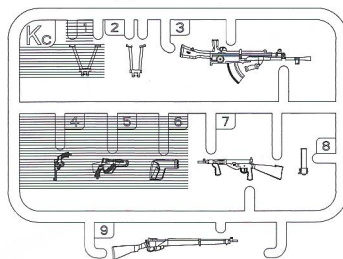

(A) × 1

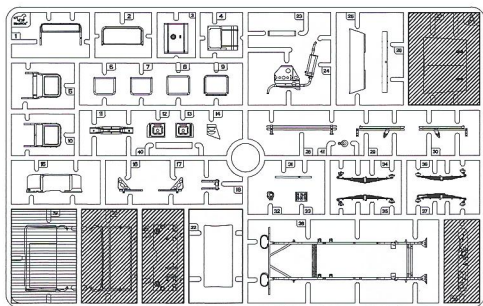

(A) × 1

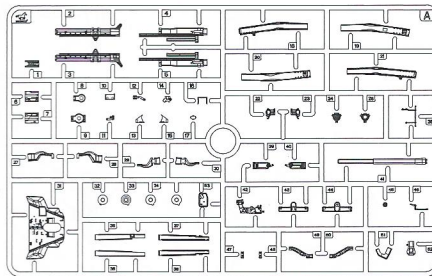

(Ca) × 1

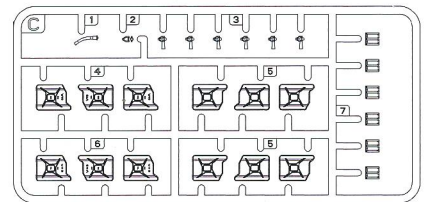

(B) × 1

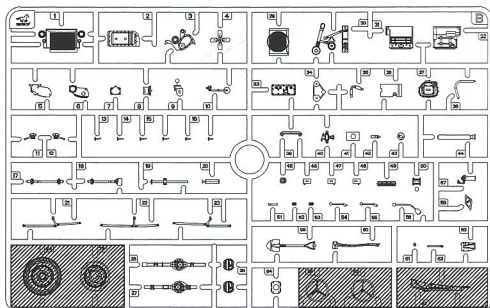

(A) × 1

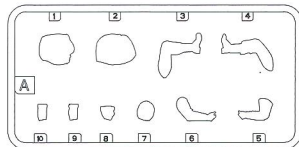

(D) × 1

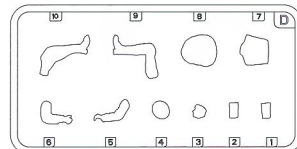

(F) × 1

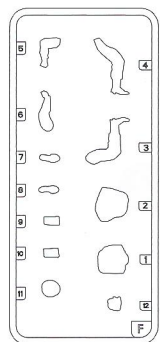

(C) × 2

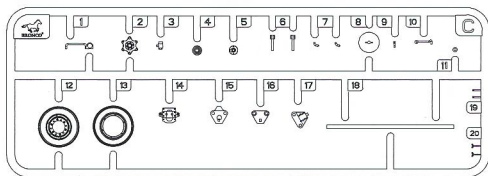

(B) × 1

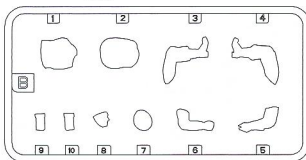

(E) × 1

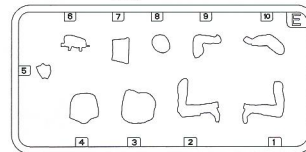

(Ja) × 1

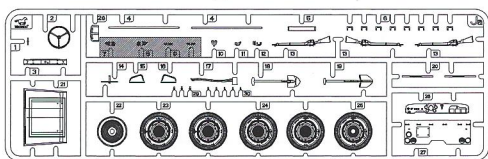

(P) × 1

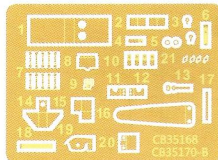

(PC) × 1



DECAL × 1

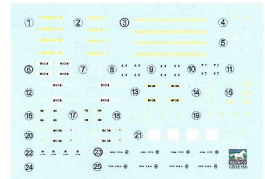

(G) × 1

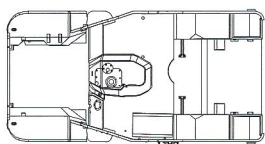

String
绳子



(C) × 1

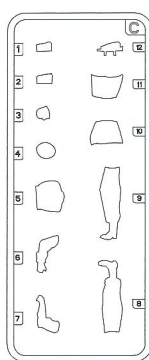

(PA) × 1

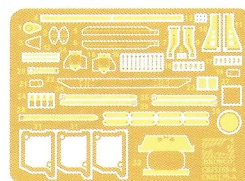

DECAL × 1



CB35170

ILLUSTRATION 图示说明:

Caution:

This kit contains a lot of small accurate parts, please carefully to read before to assembly.

此套件包含不少精细零件，请在制作前先翻阅说明书了解清楚。

1

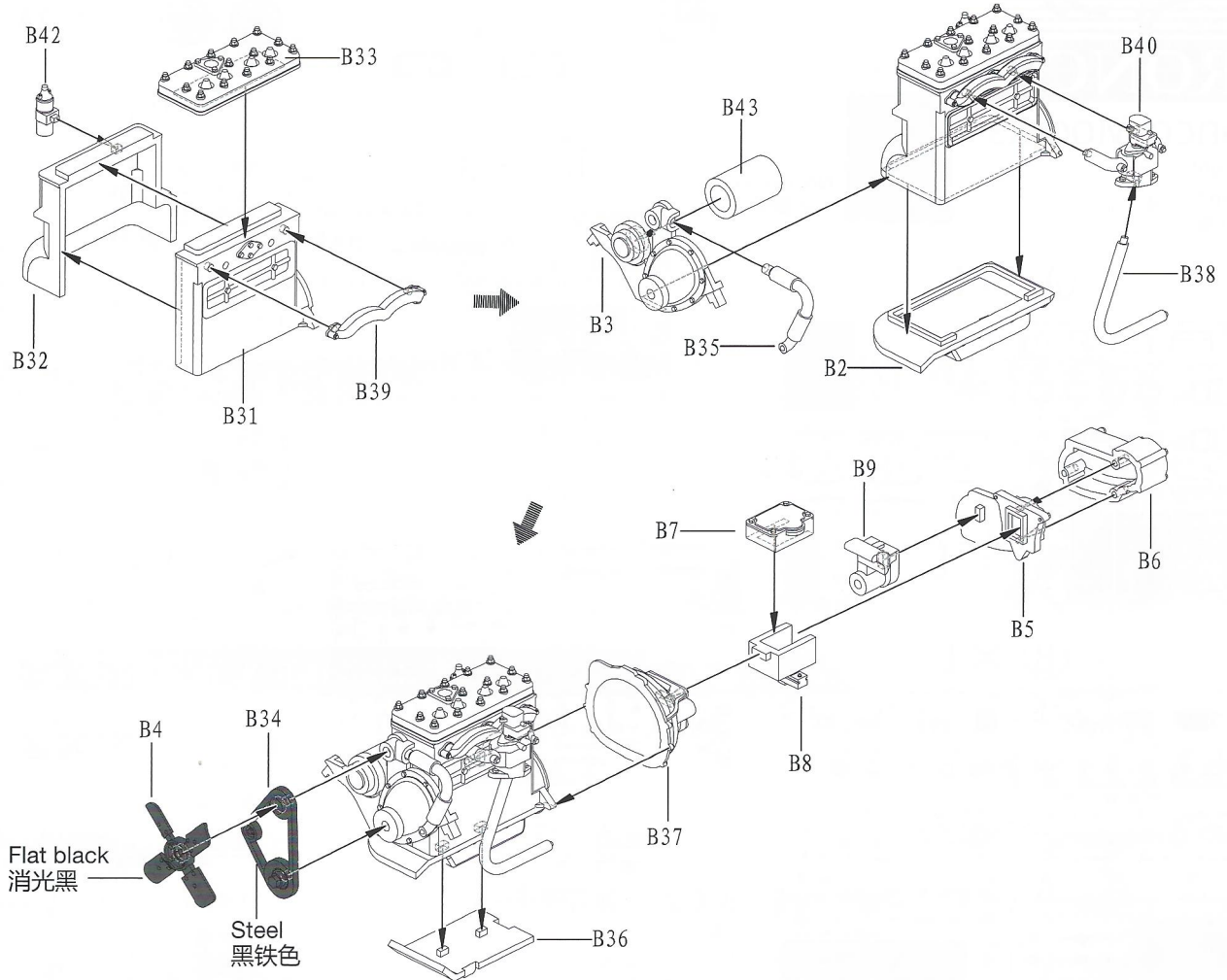

2

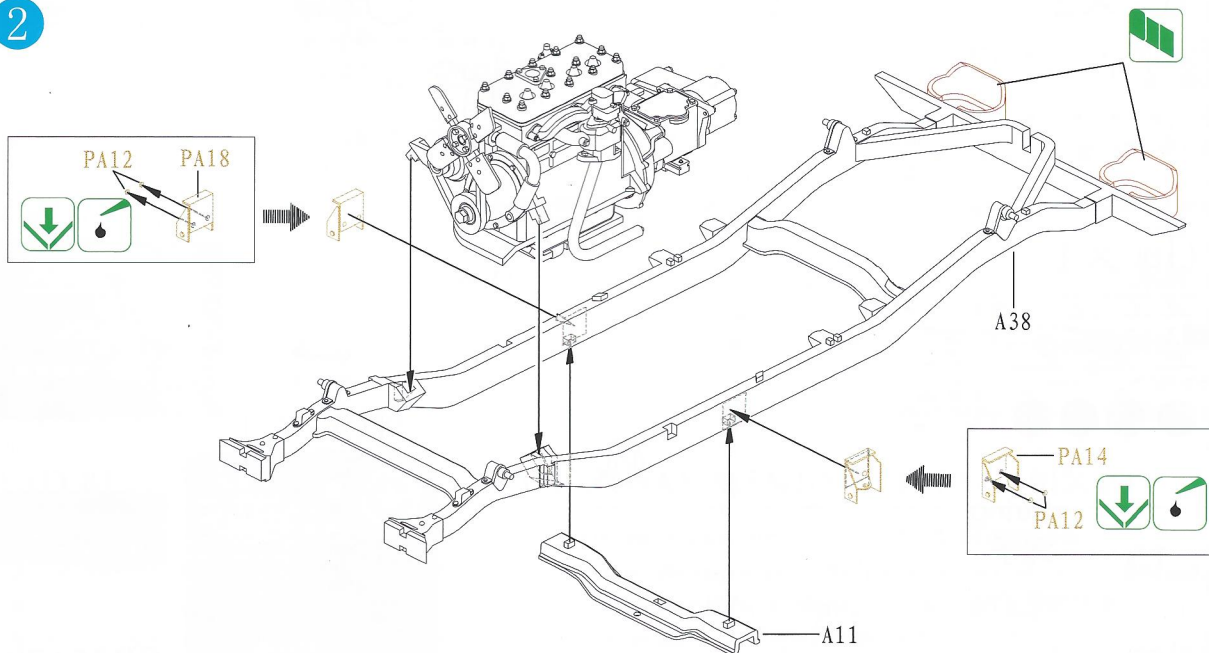

3

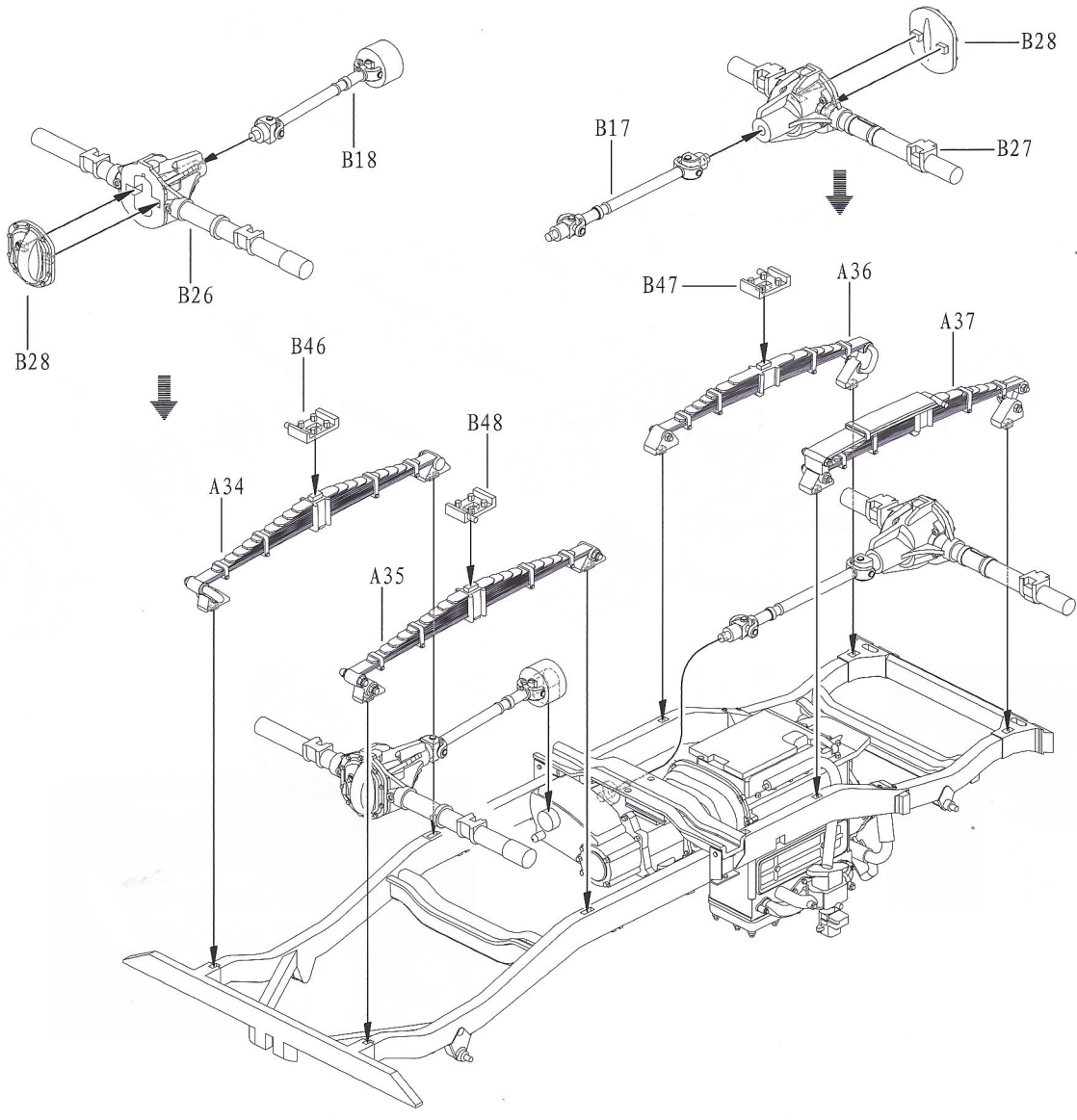

4

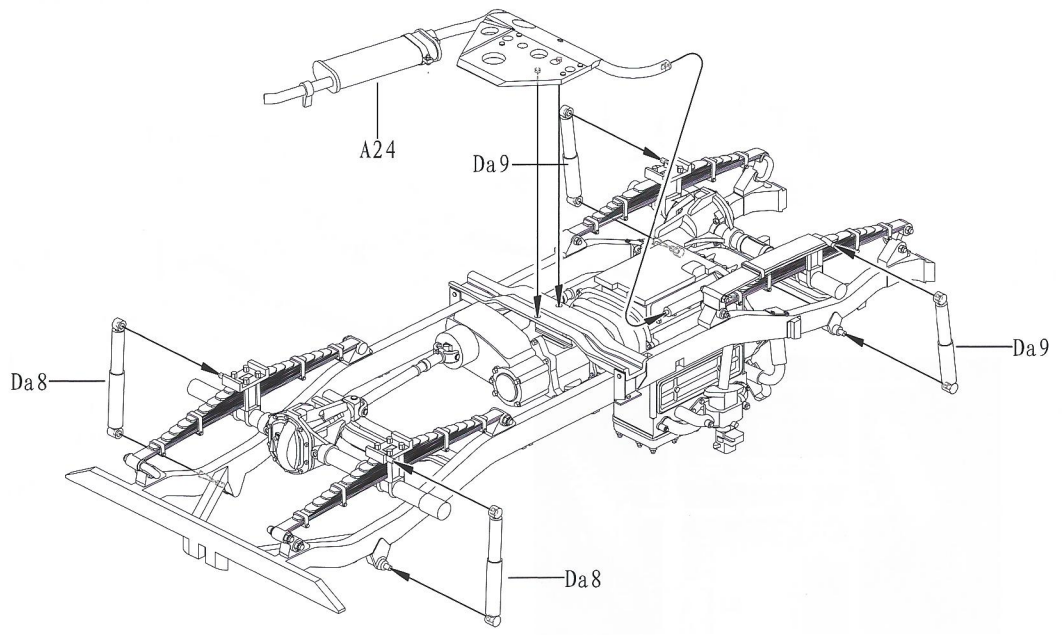
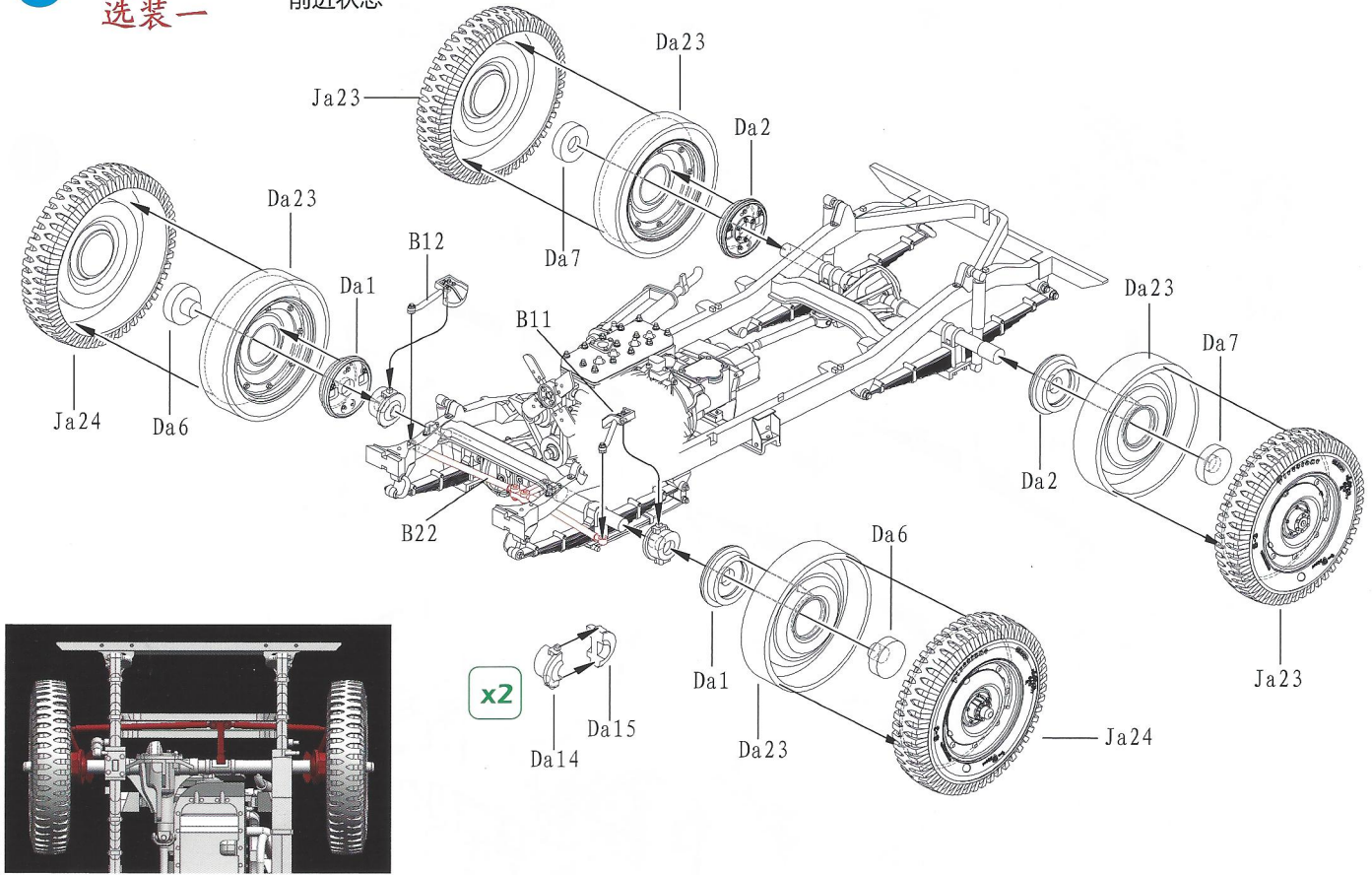
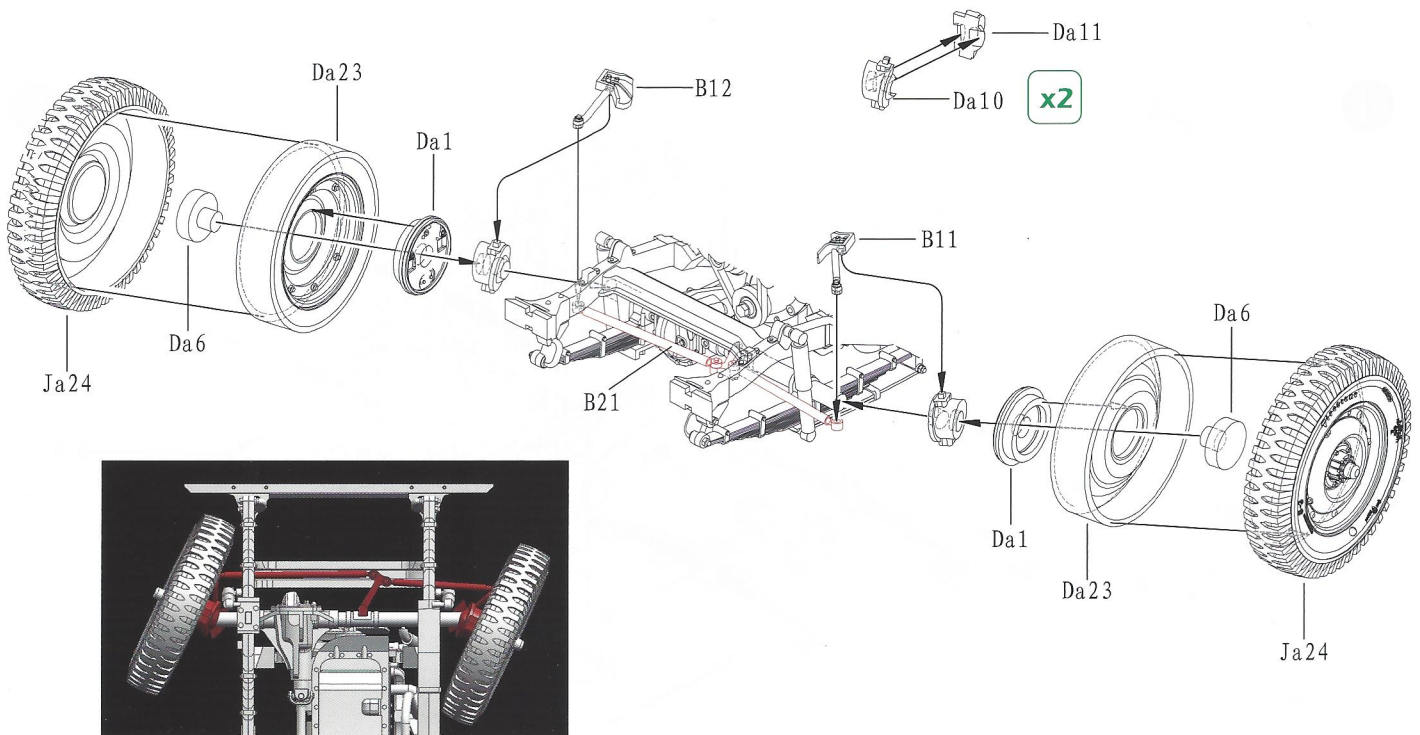

ILLUSTRATION 图示说明:

5 Option 1: Forward position 选装一 前进状态



6 Option 2: Left-turn position 选装二 左转状态



7 Option 3: Right-turn position
选装三 右转状态

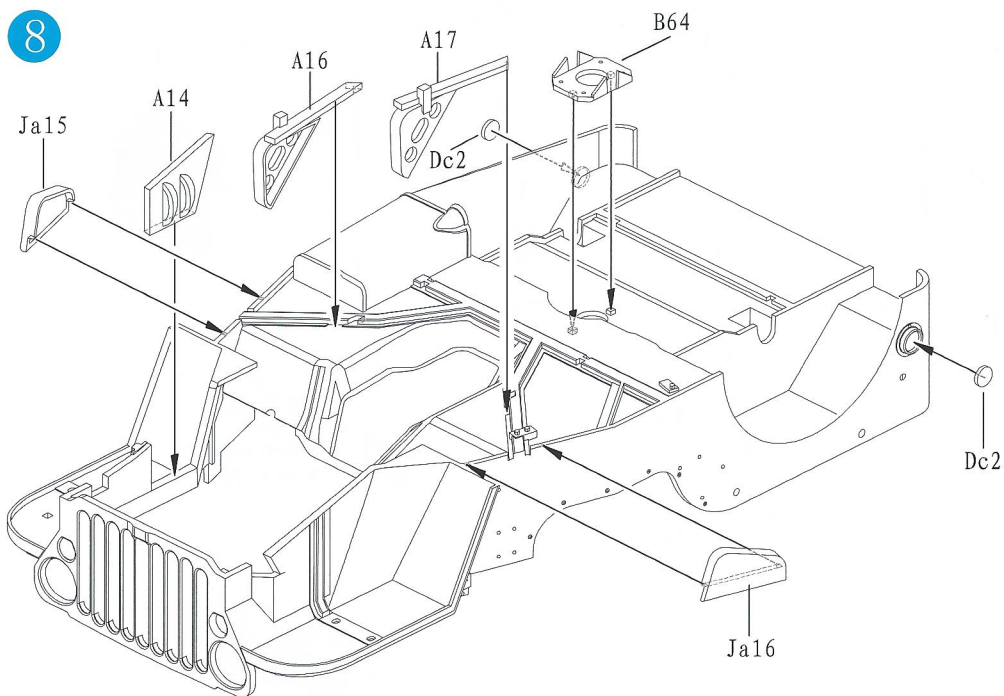
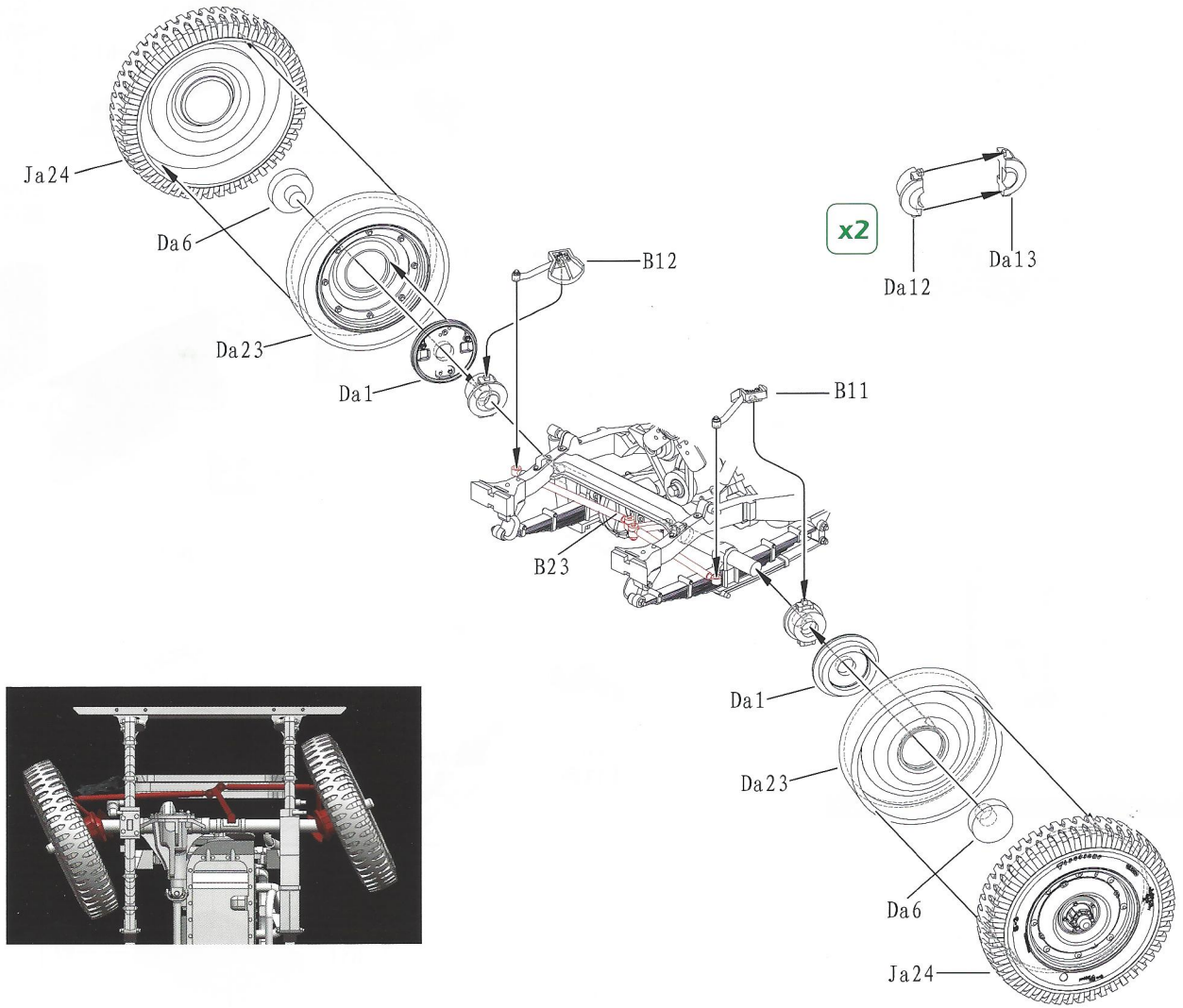
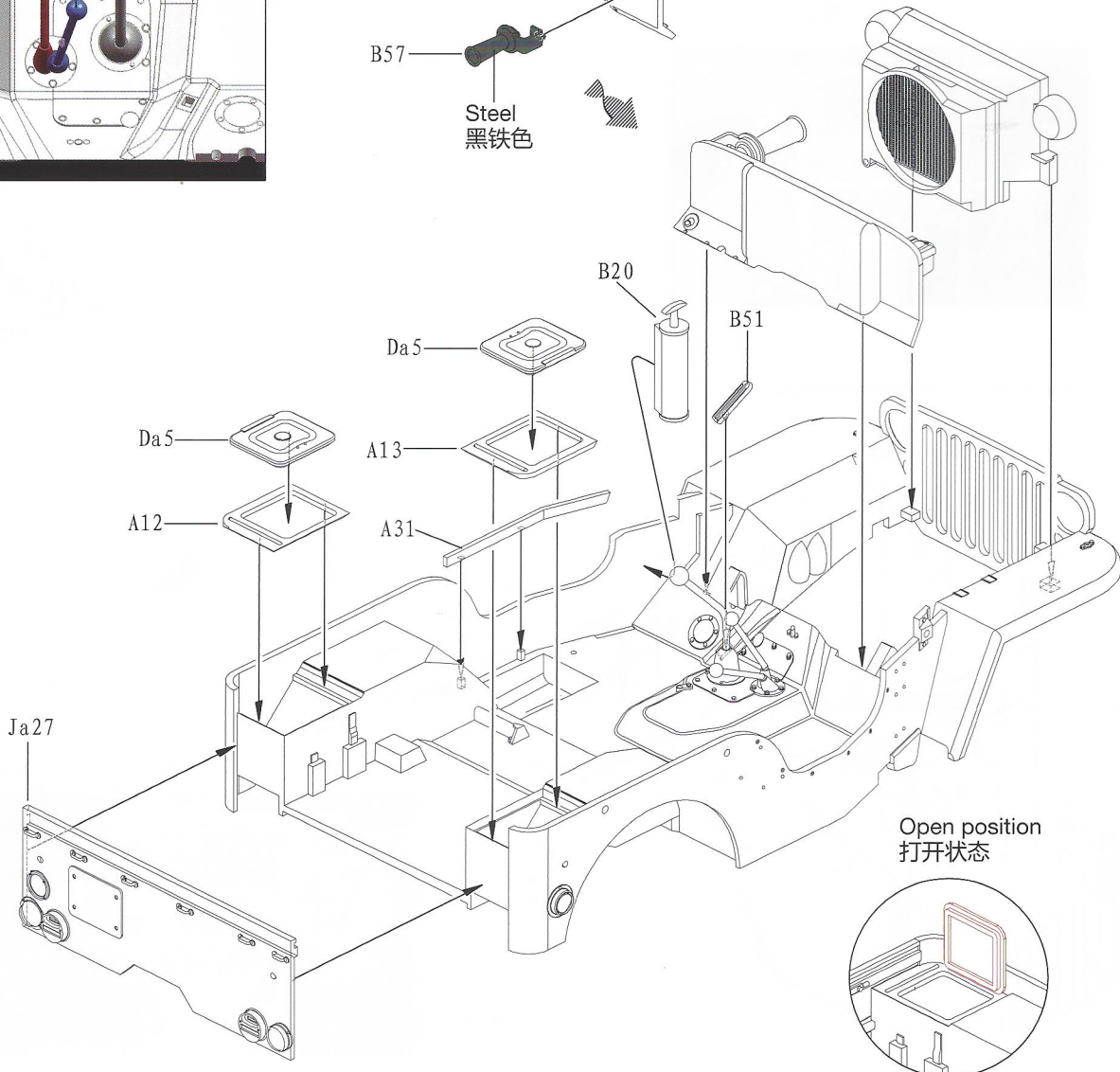
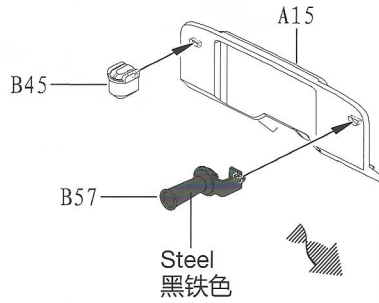
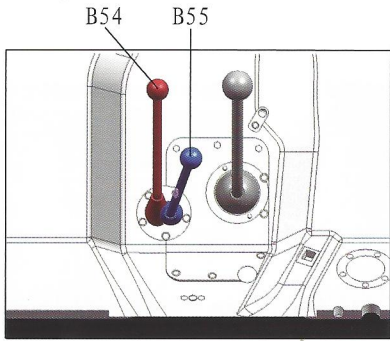
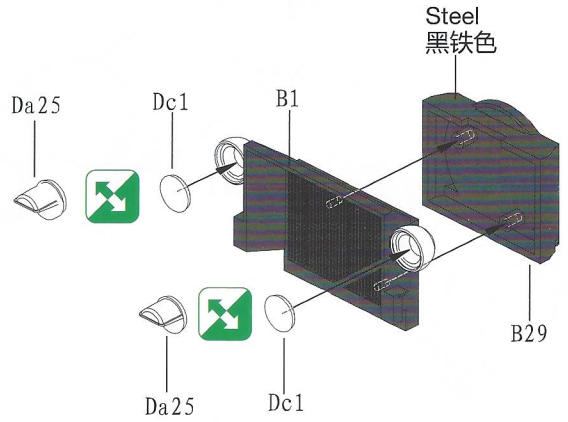
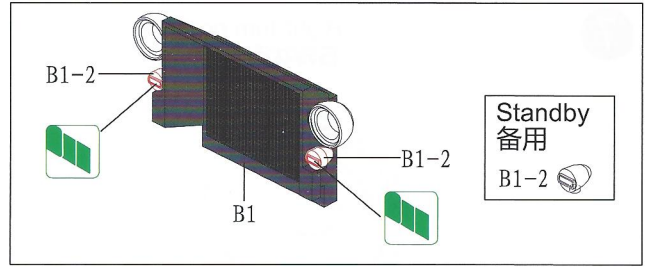
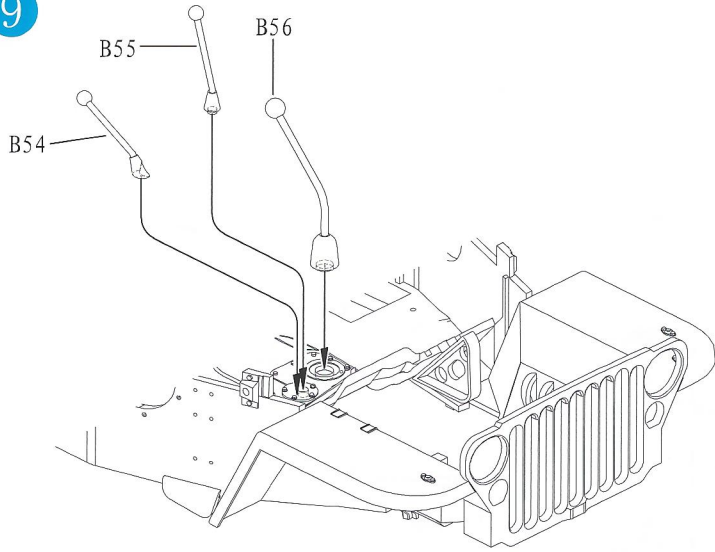
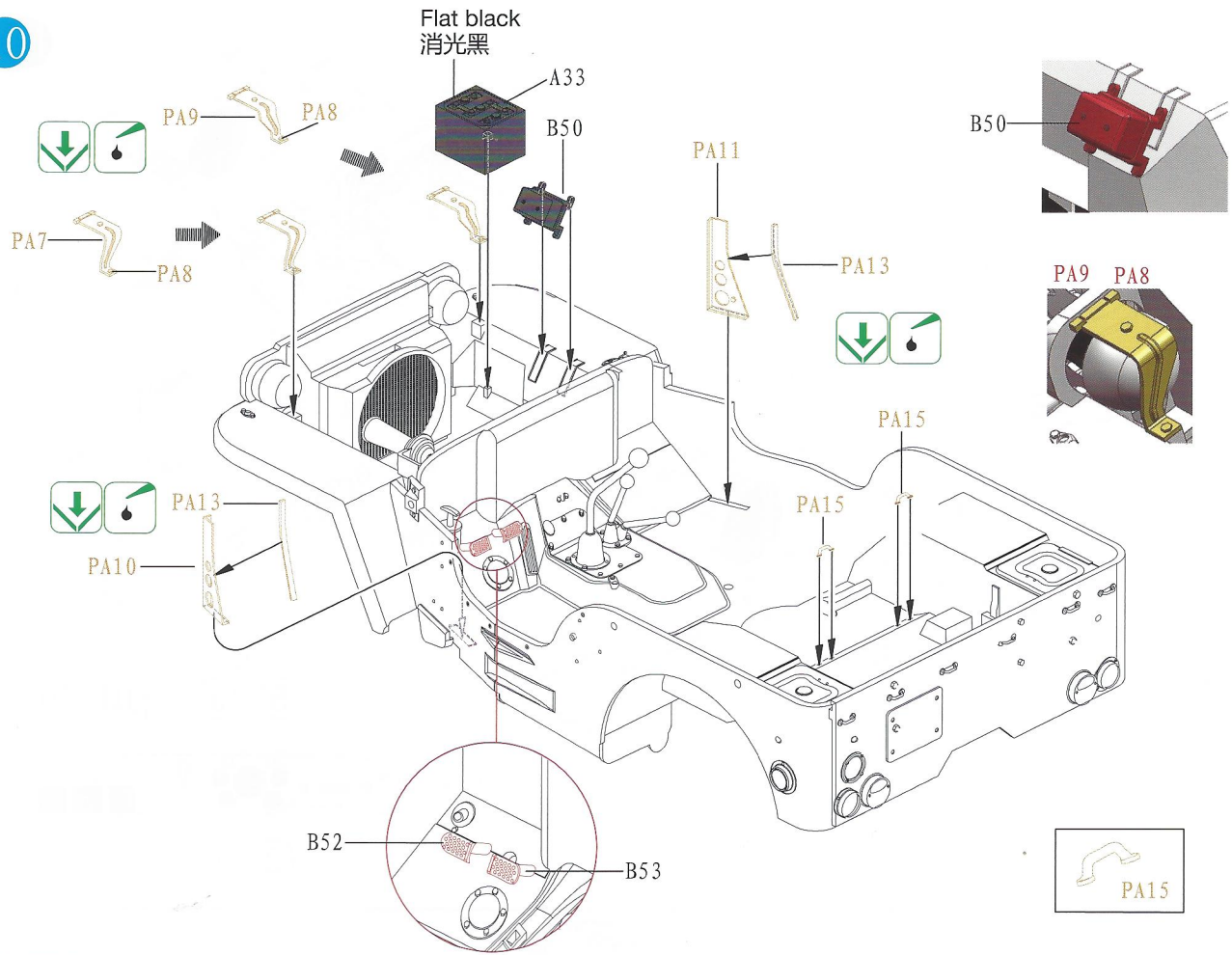

ILLUSTRATION 图示说明:

9



10



11

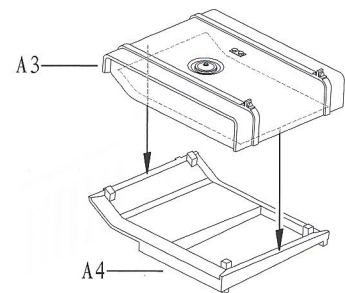
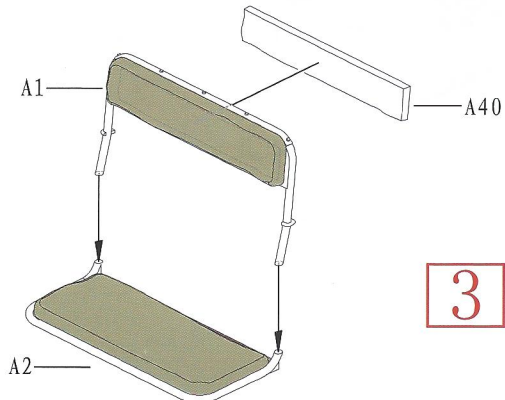
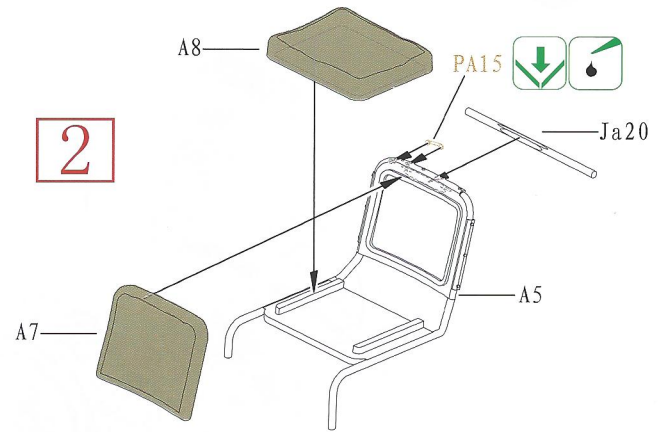
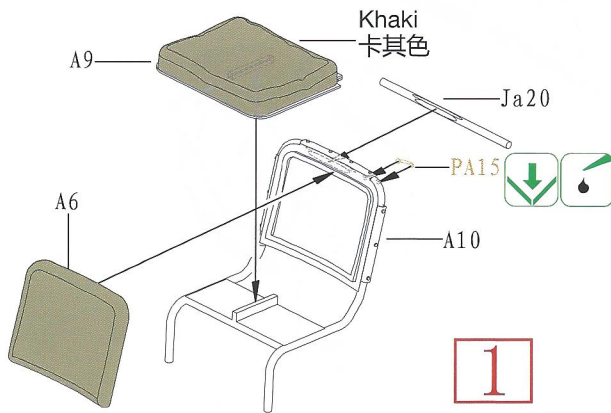

12

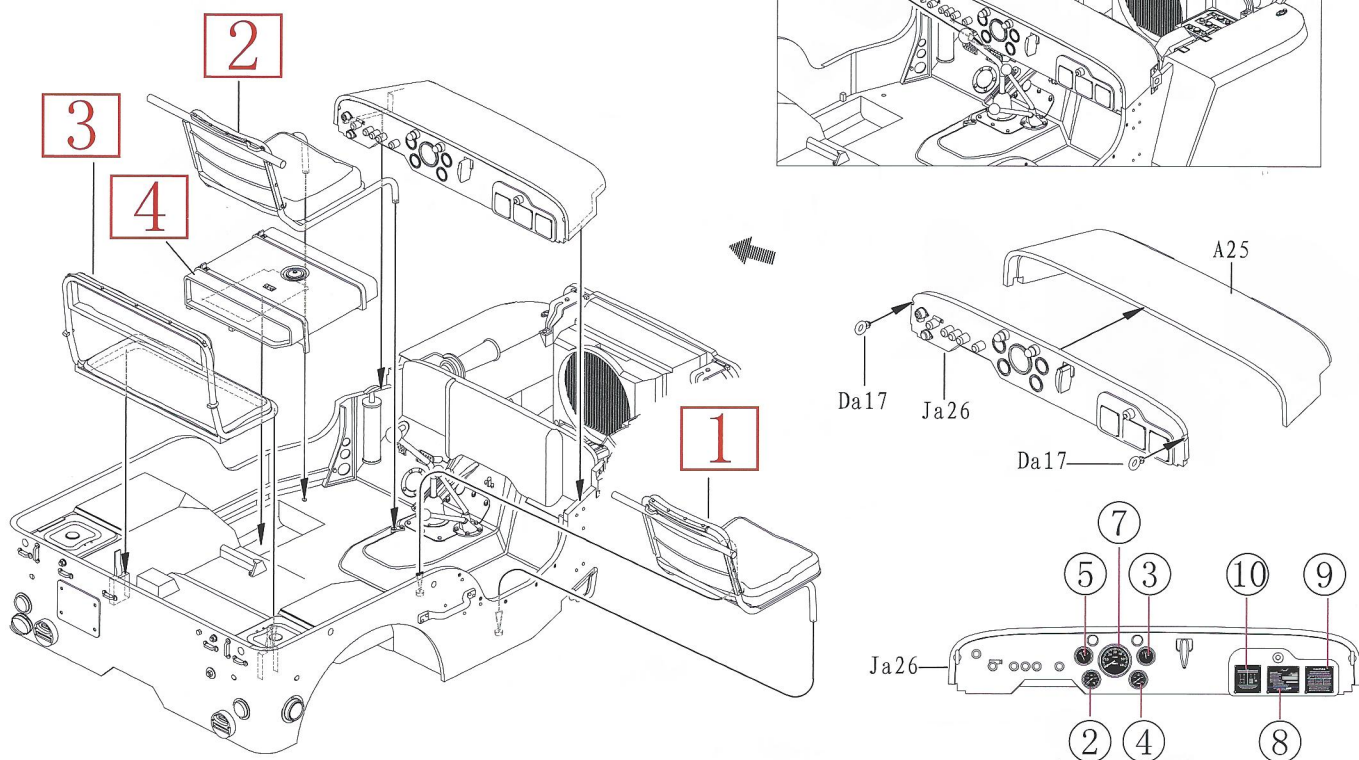

13

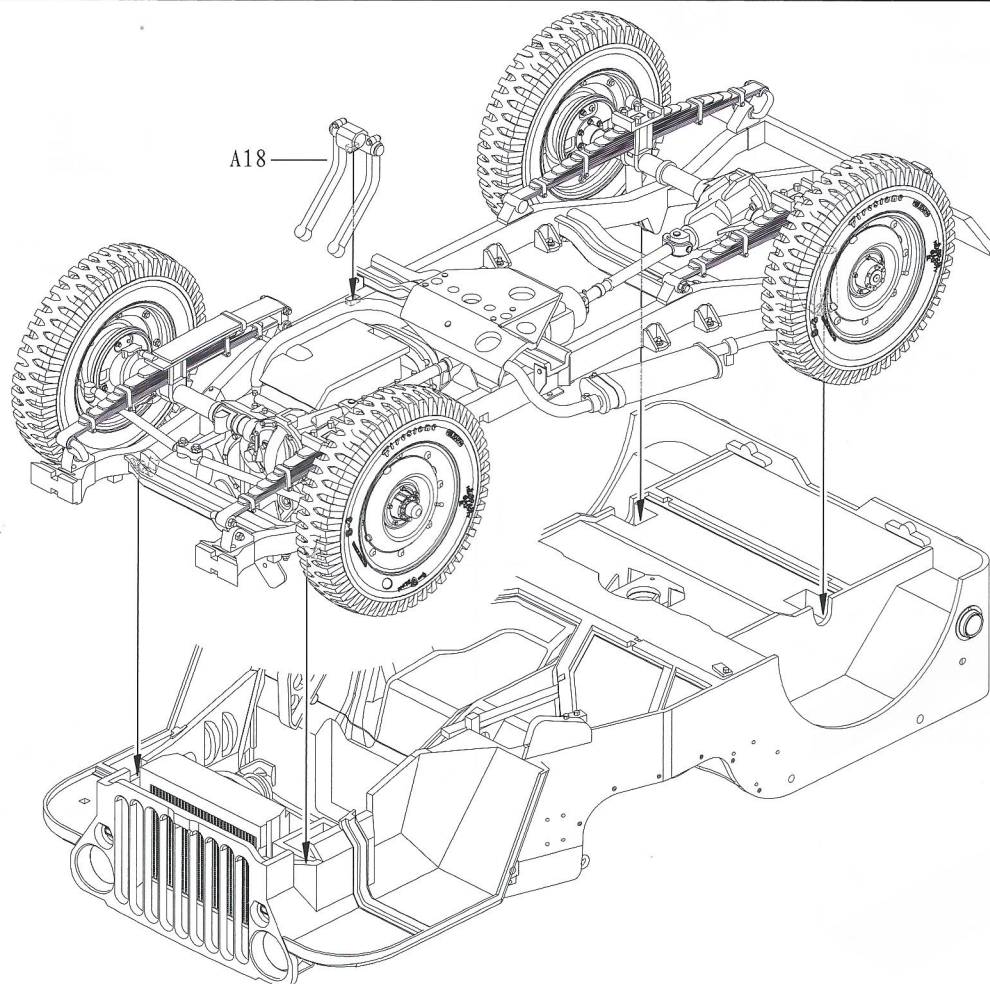

14

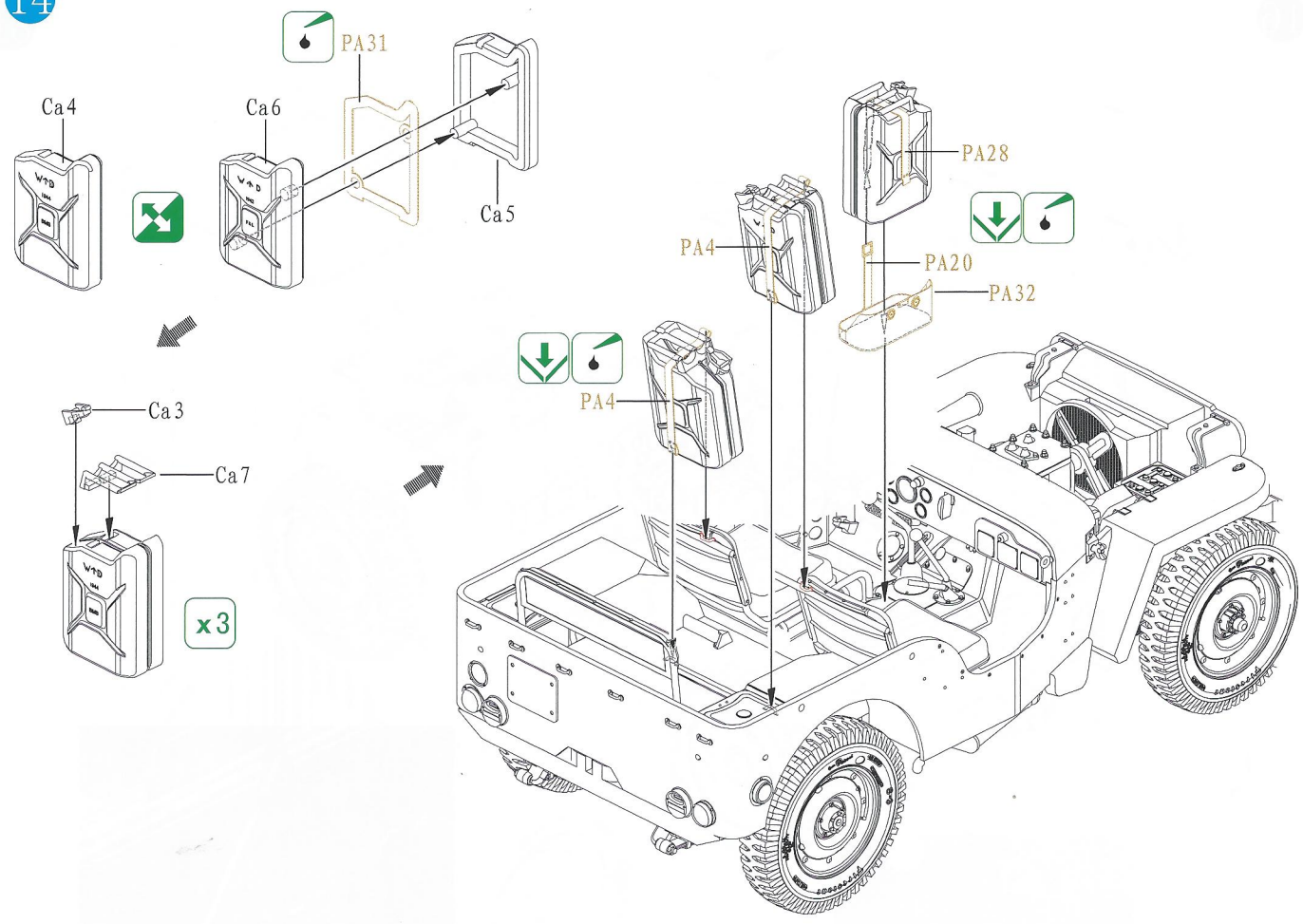

15

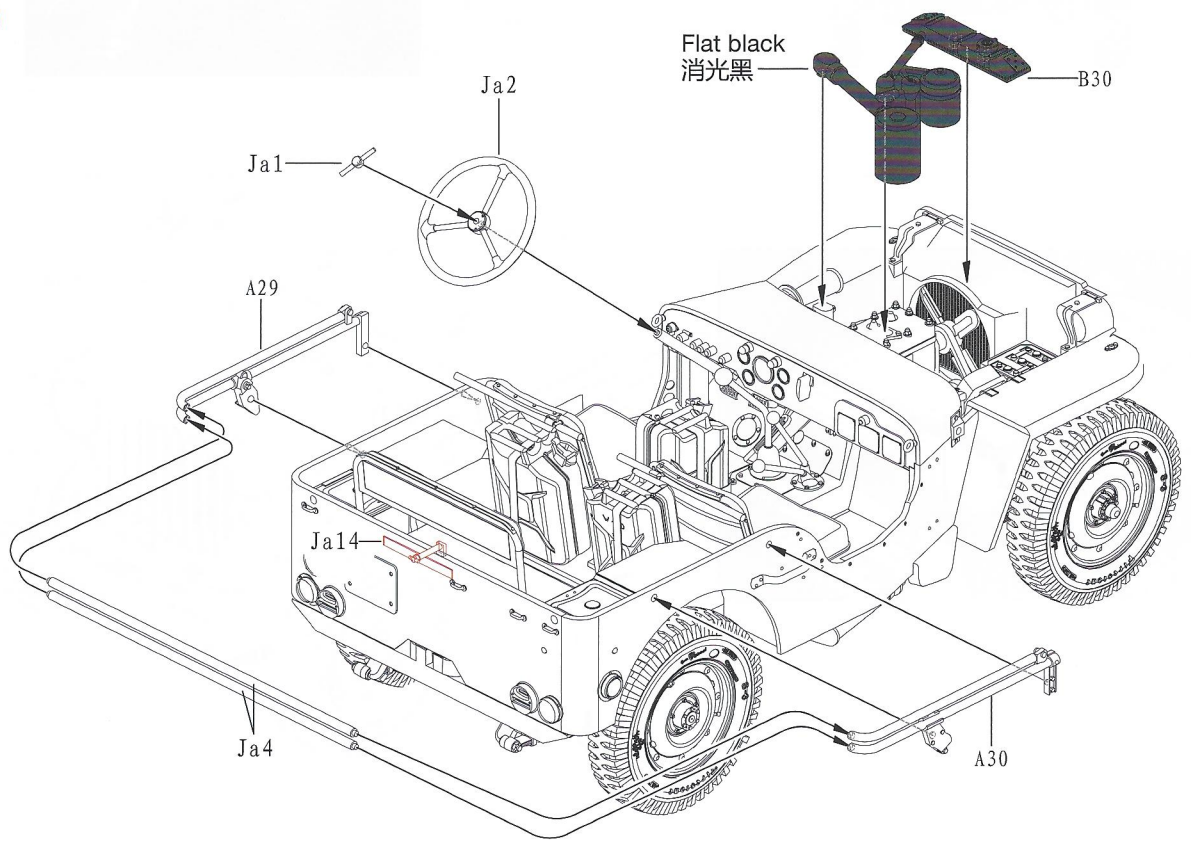

16

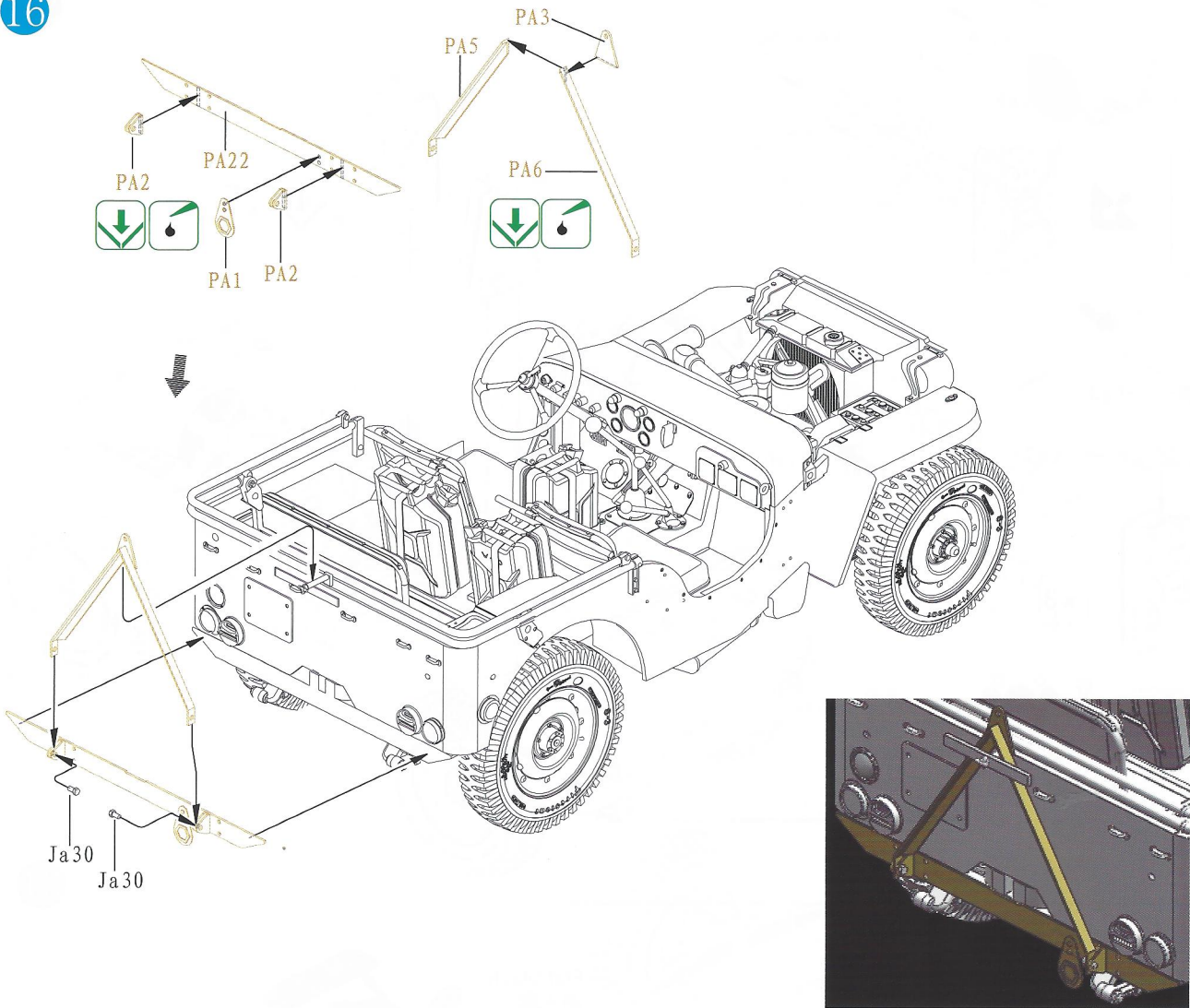

17

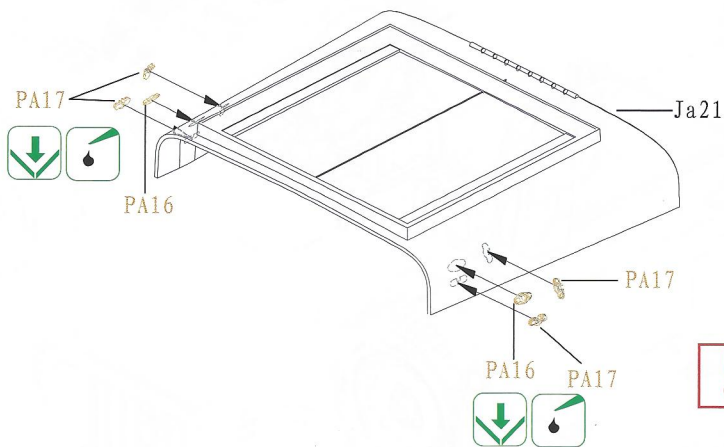

5

18

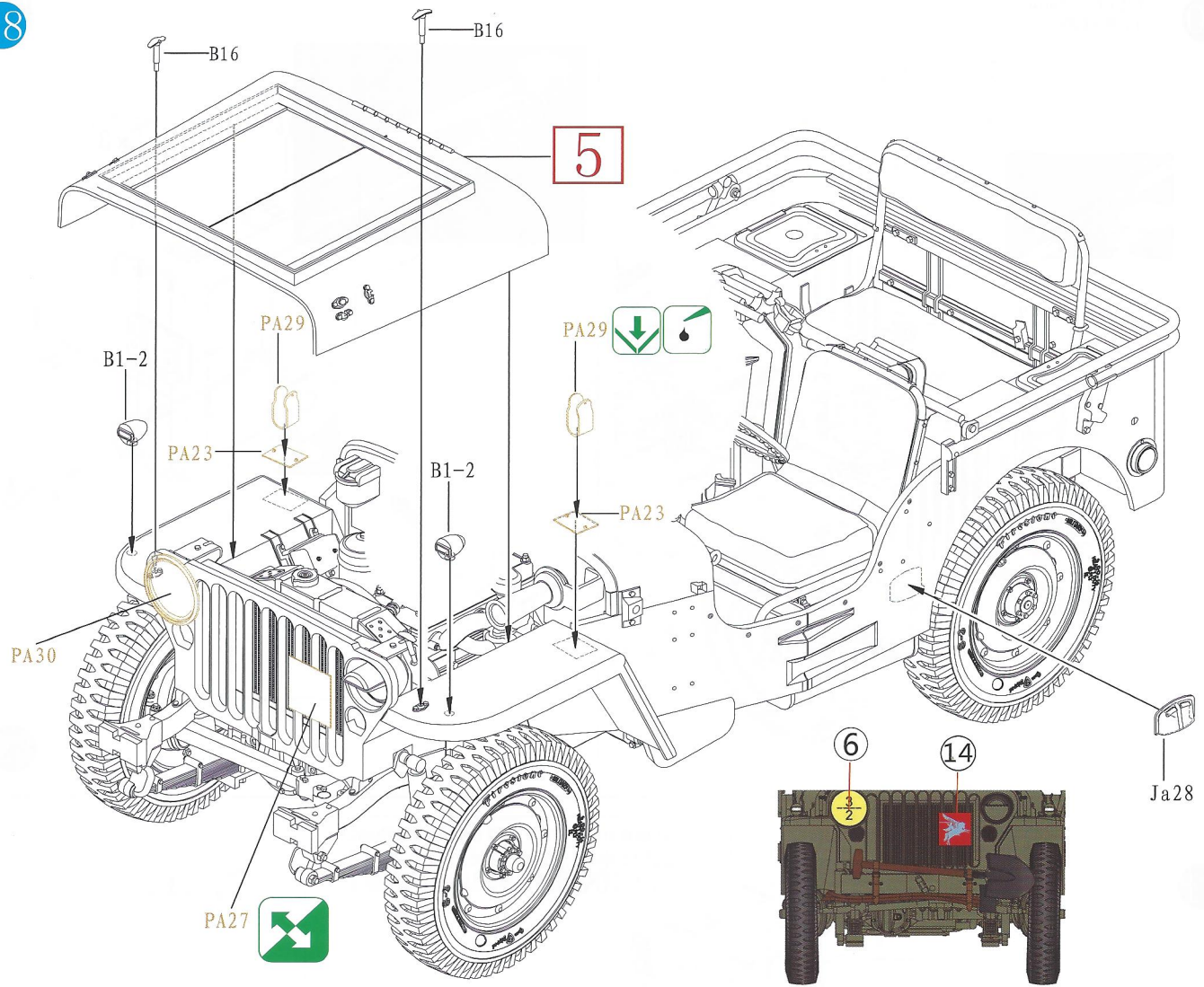

19

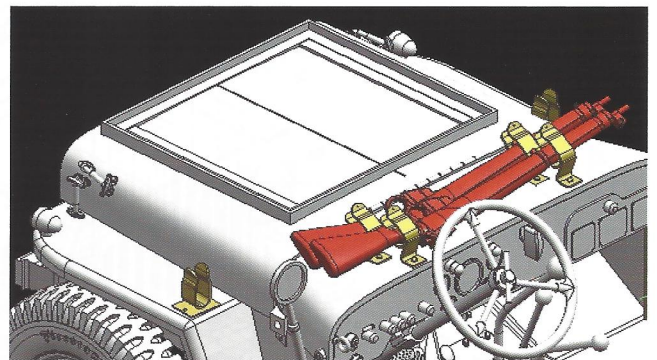
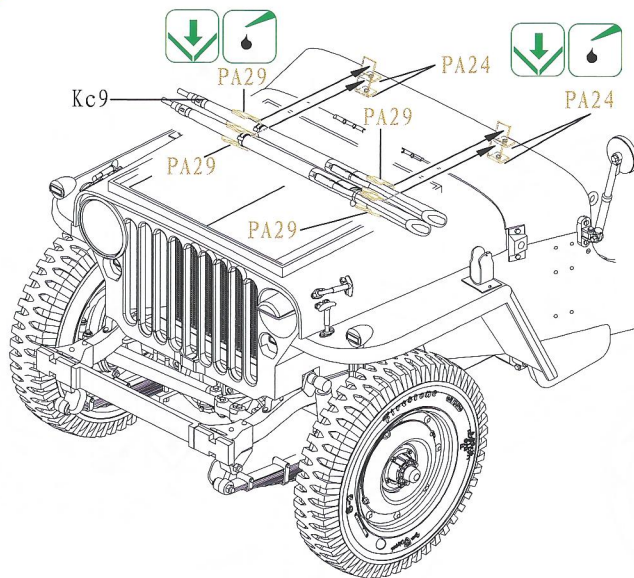
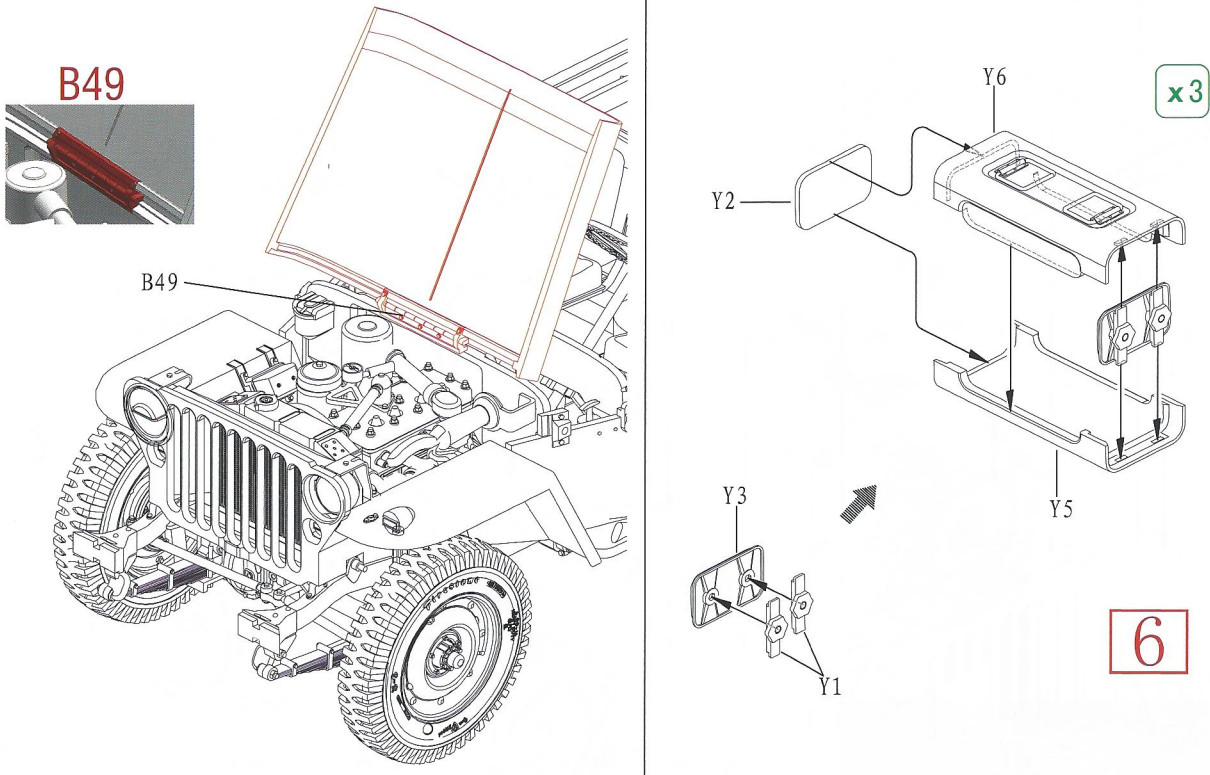

ILLUSTRATION 图示说明:

20

Open position
打开状态



21

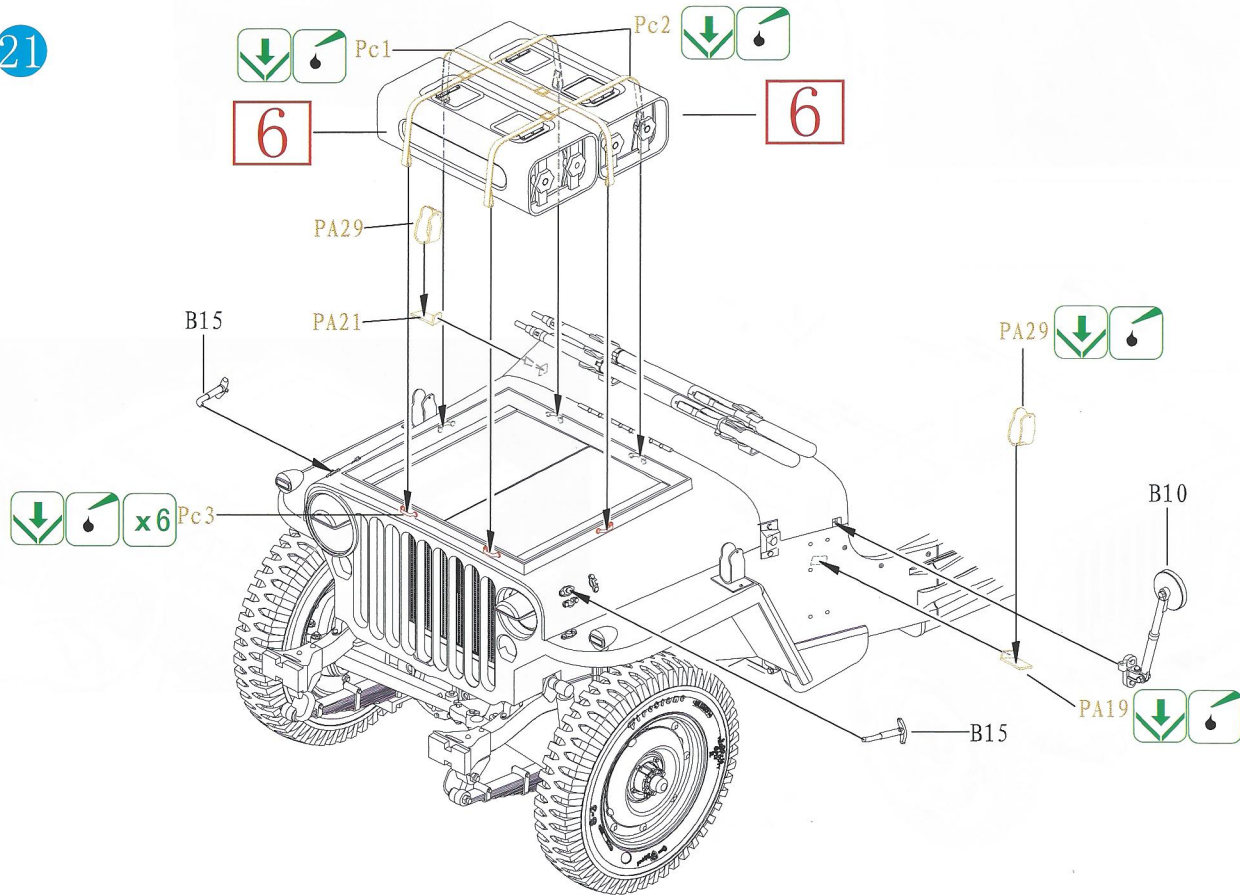

22

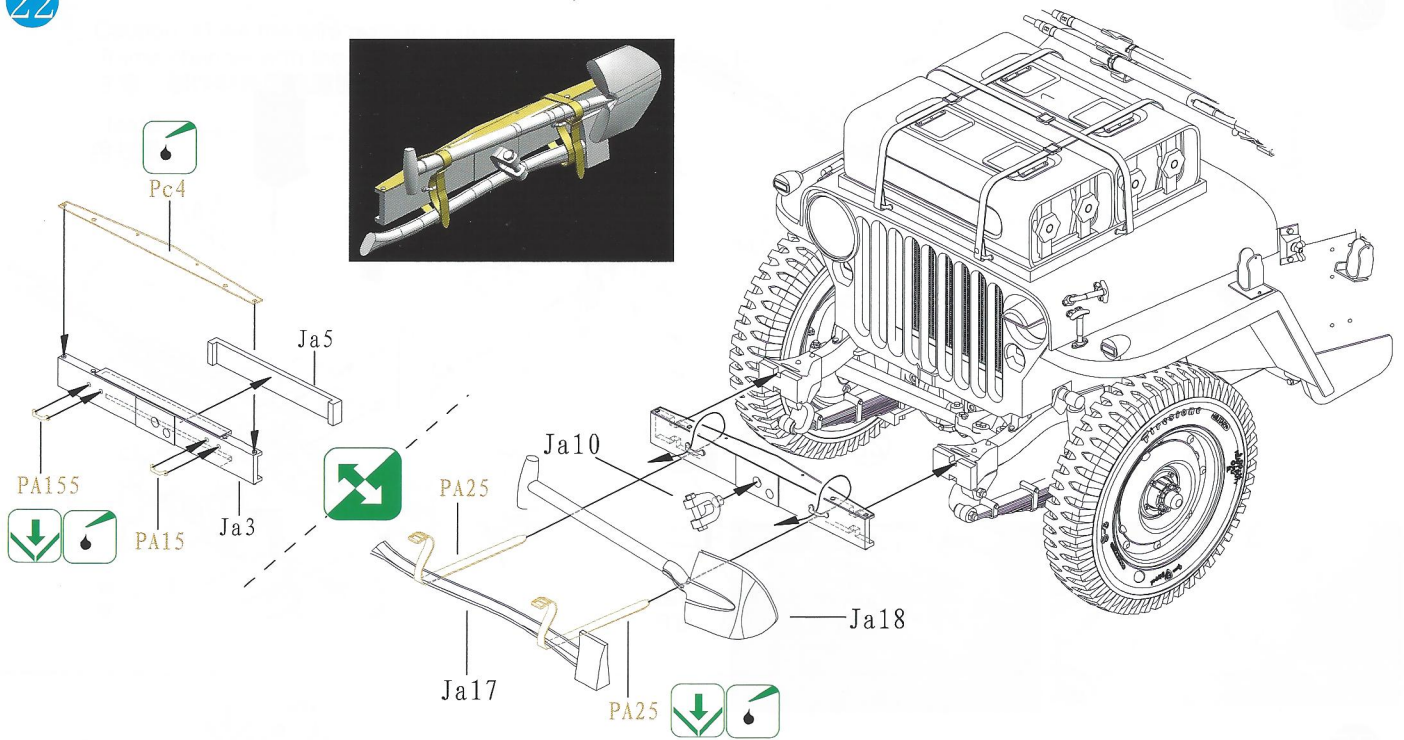

23

Option 1:
选装一

★ Caution: Make the wire from the plastic frame channel with the heat of fire.
注意：制作电线用流道加热拉丝。

Option 2:
选装二

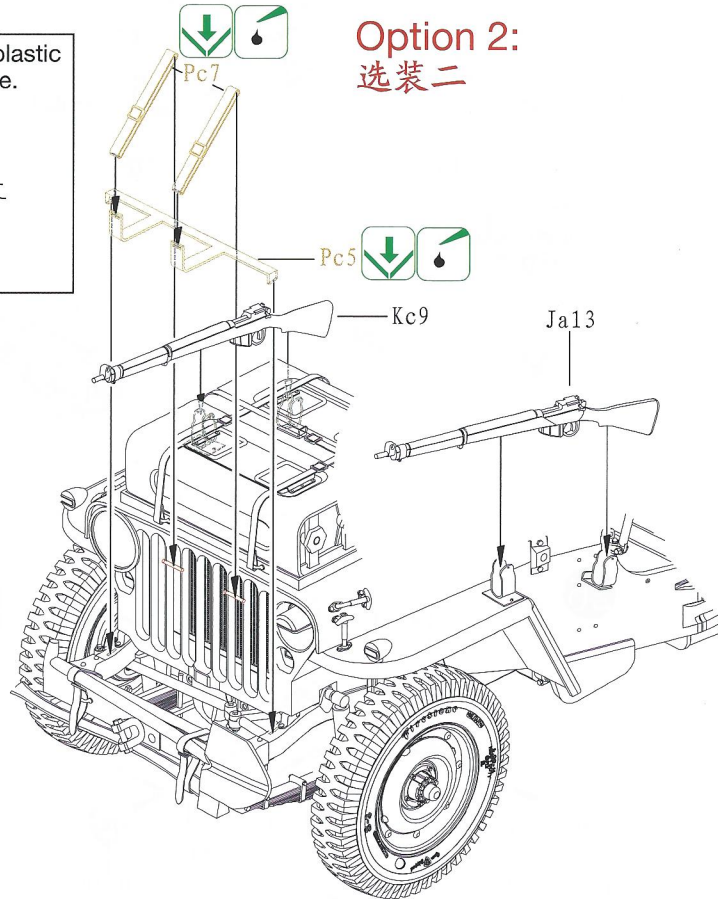
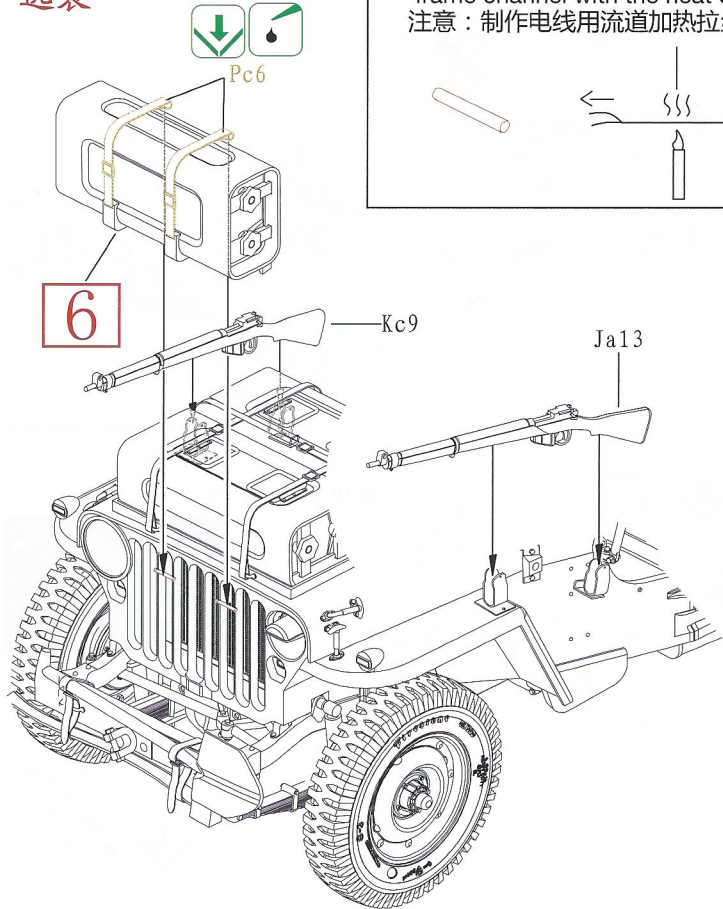
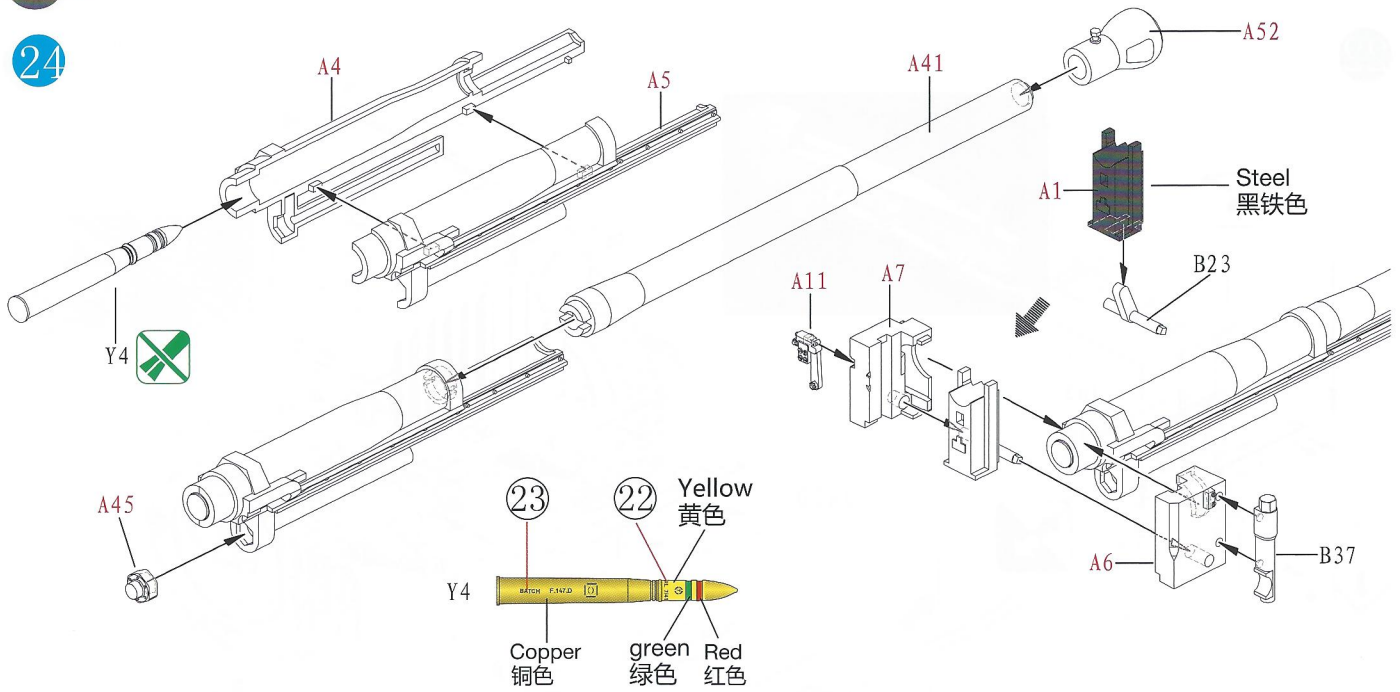
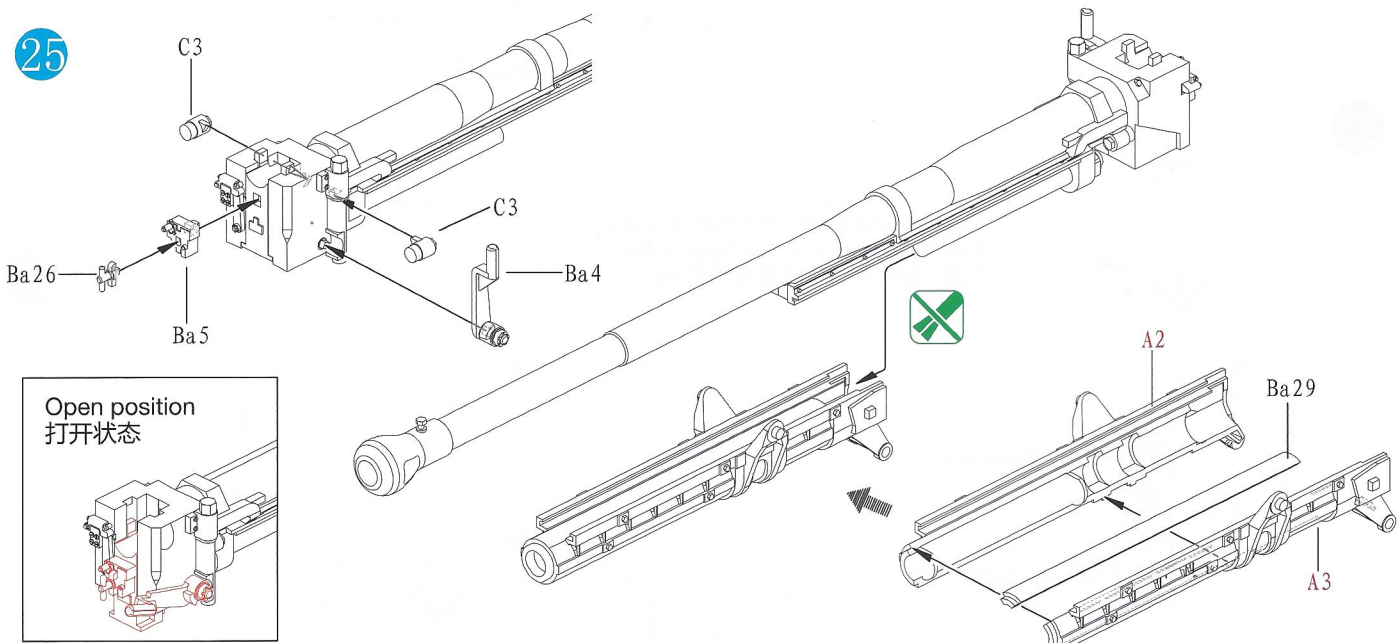

ILLUSTRATION 图示说明:

24



25



26

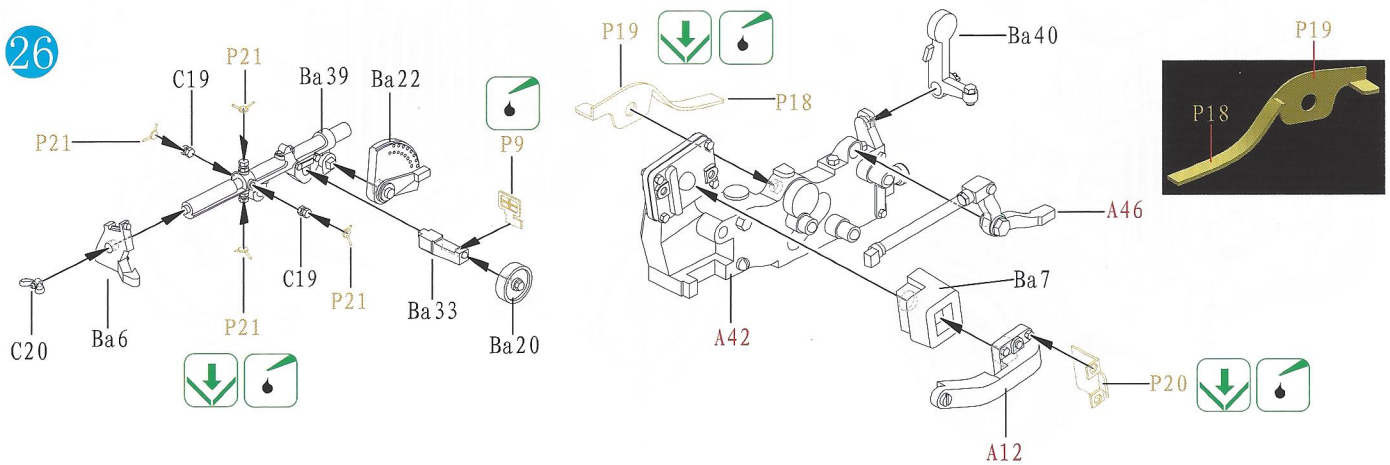

27

★ Caution: Make the wire from the plastic frame channel with the heat of the fire.
 注意：制作电线用流道加热拉丝。

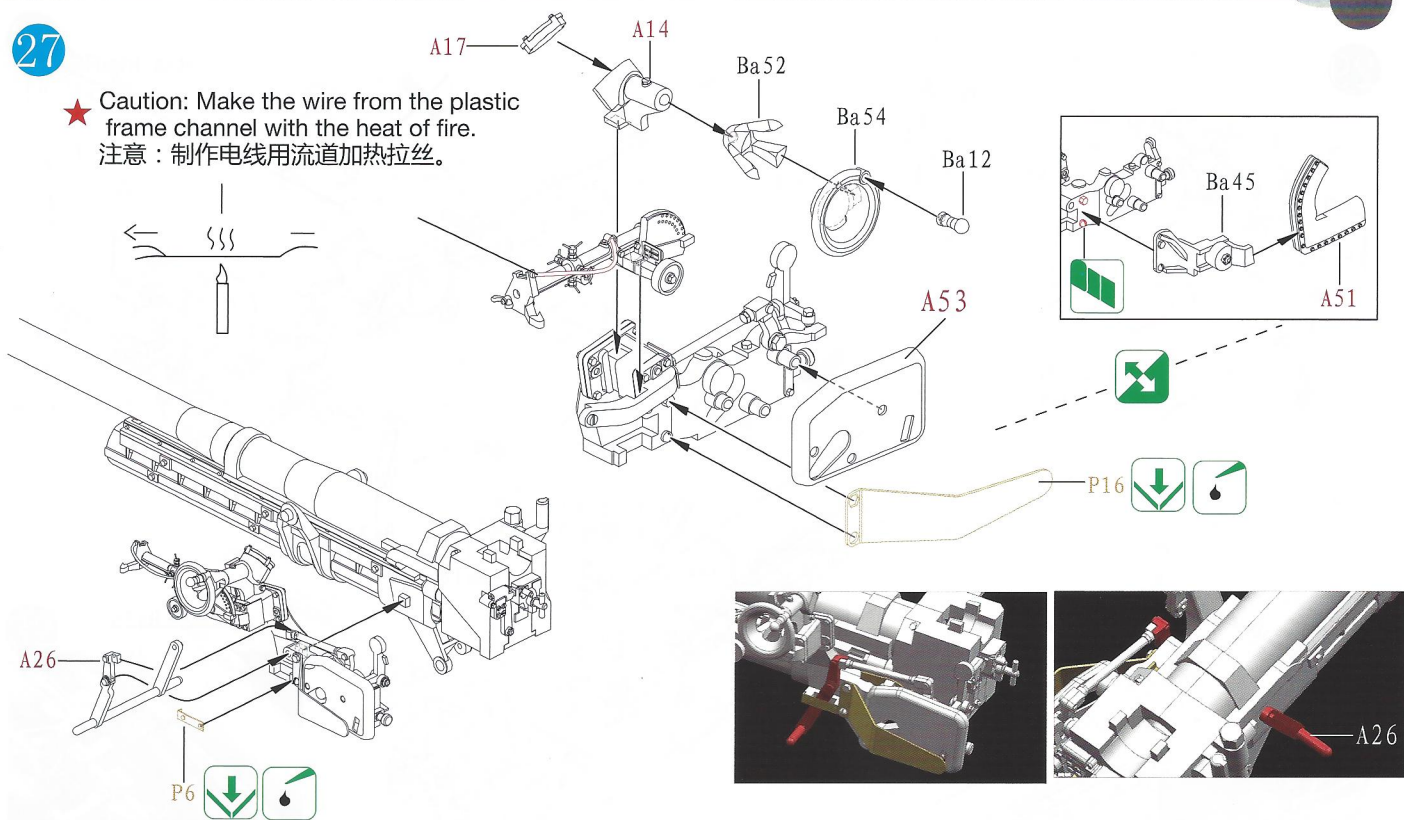

28

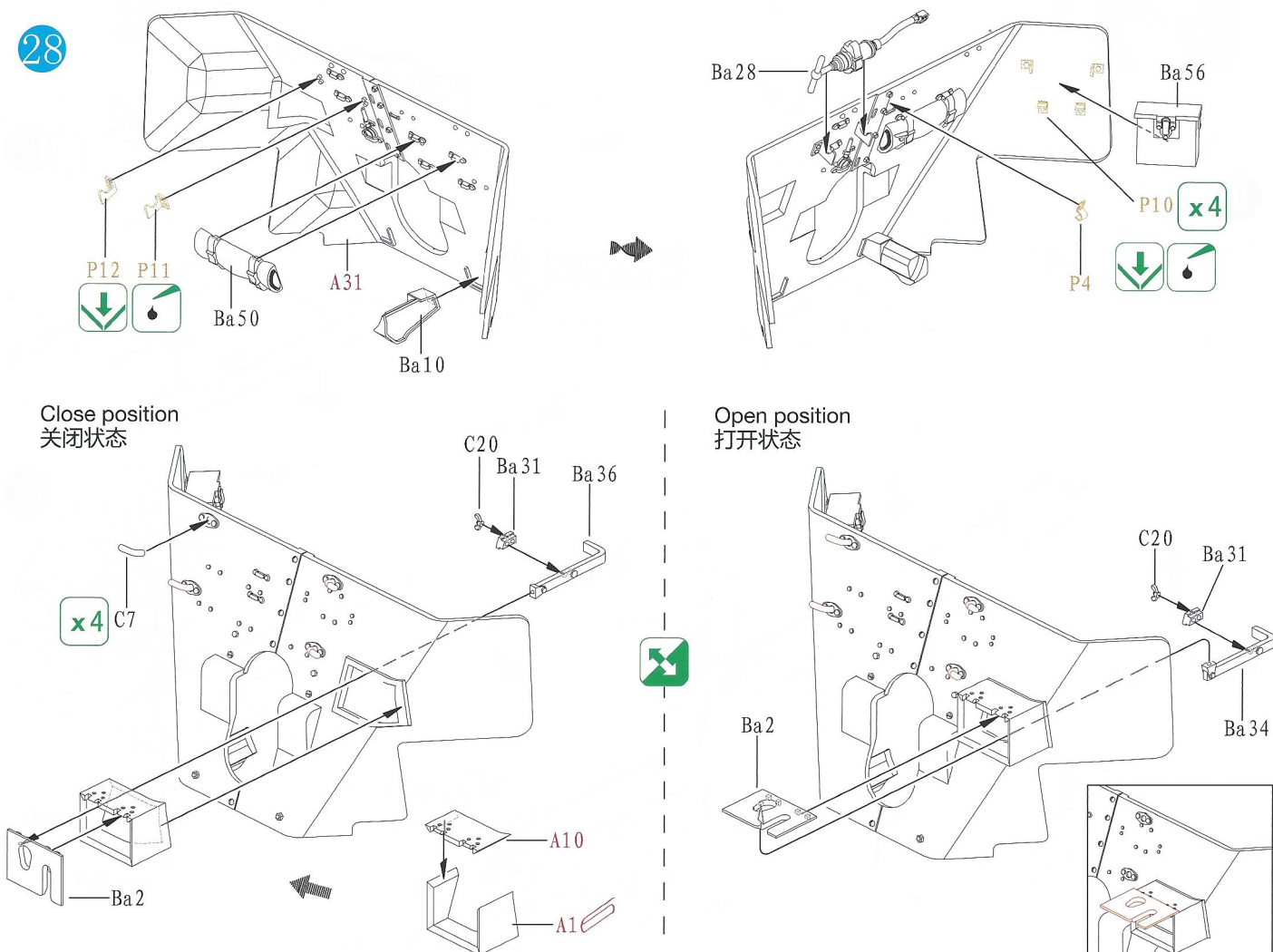
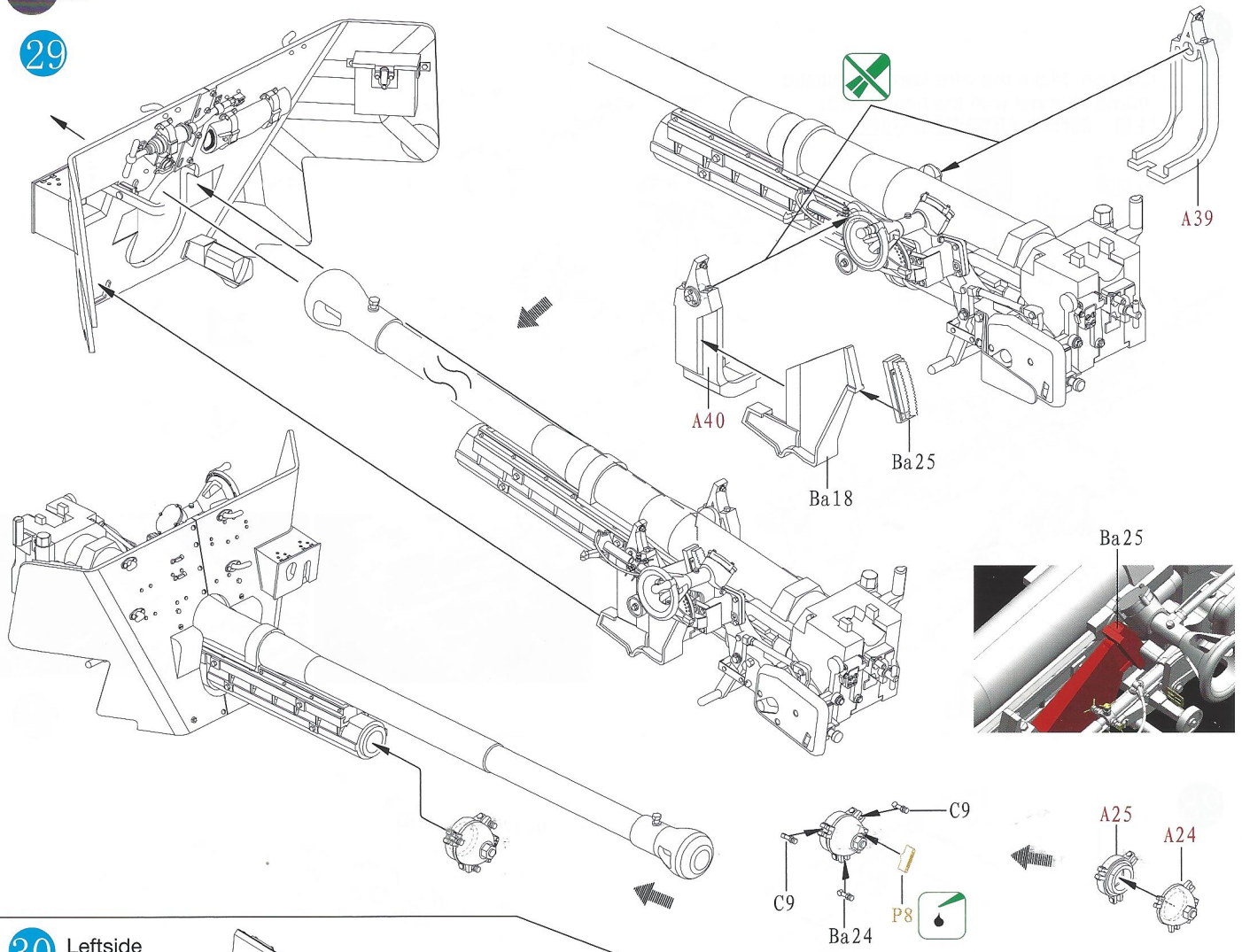
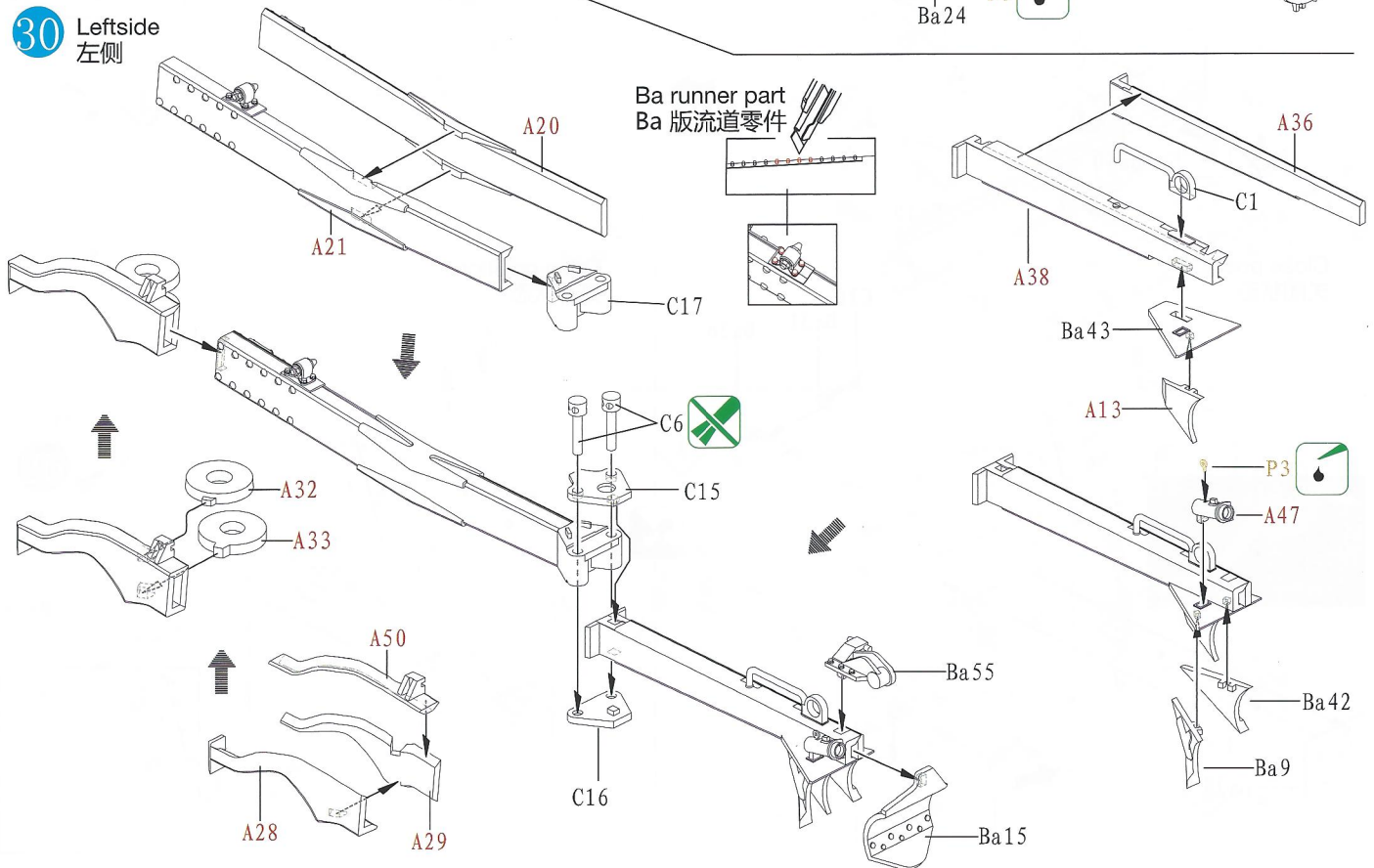

ILLUSTRATION 图示说明:

29



30 Leftside 左侧



31

Right side
右侧

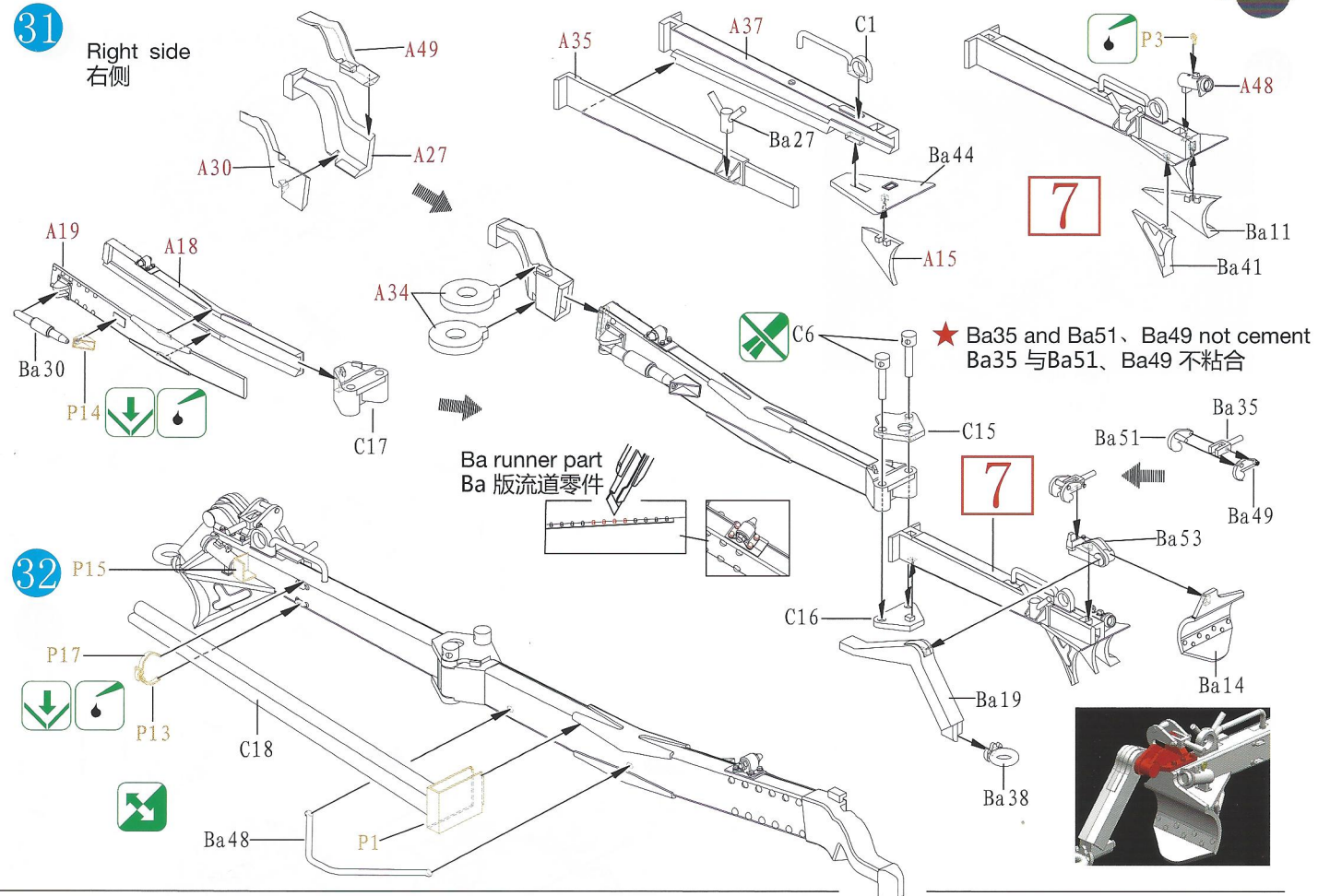

32

33

34

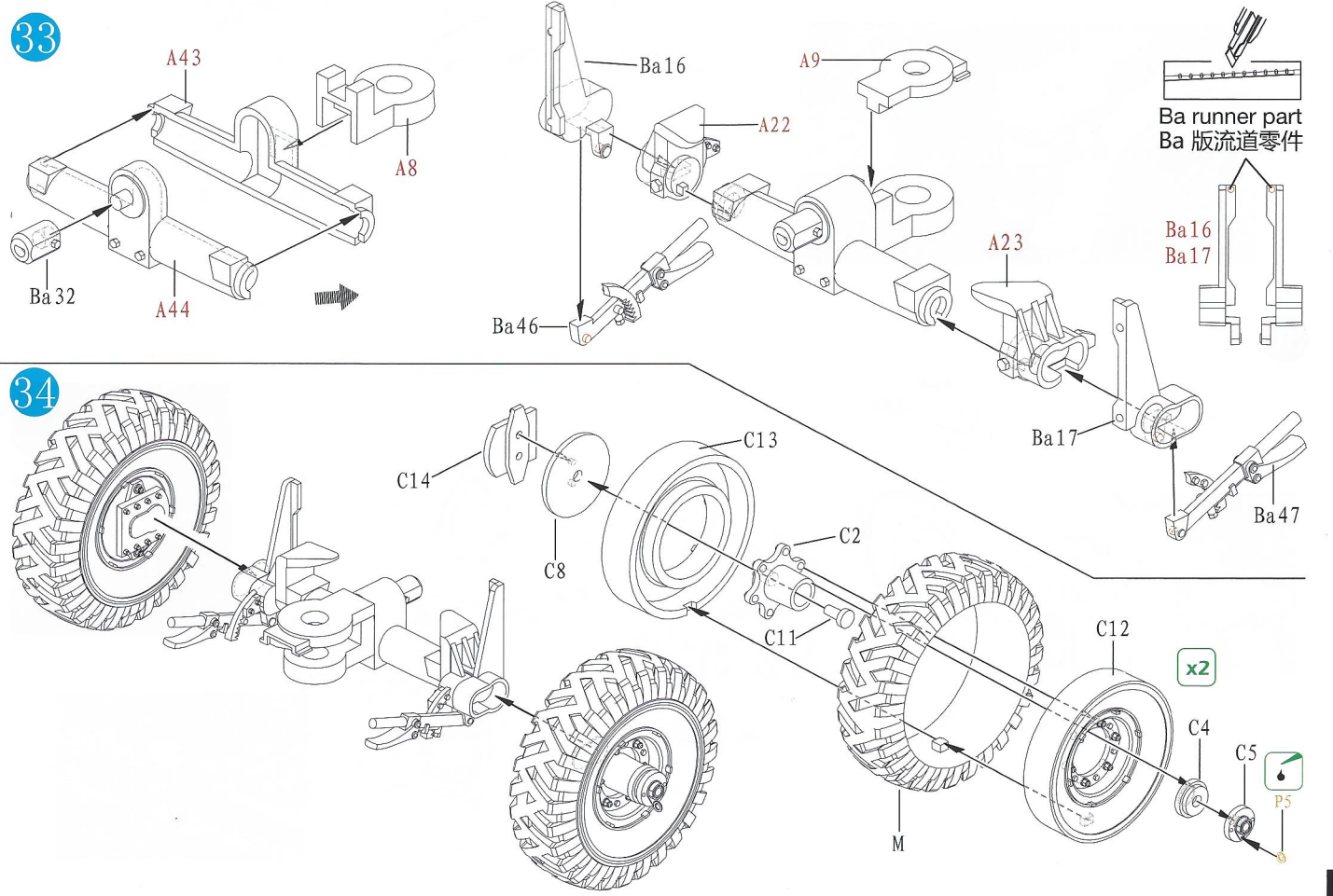
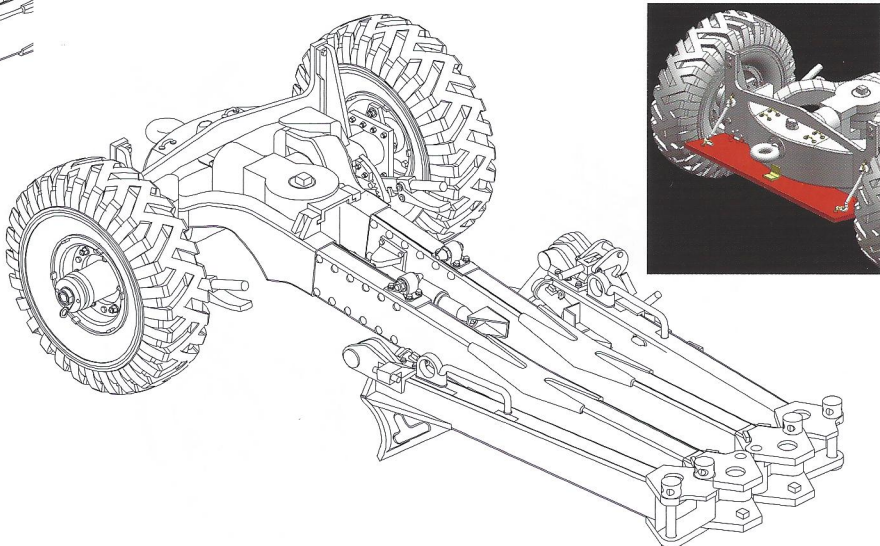
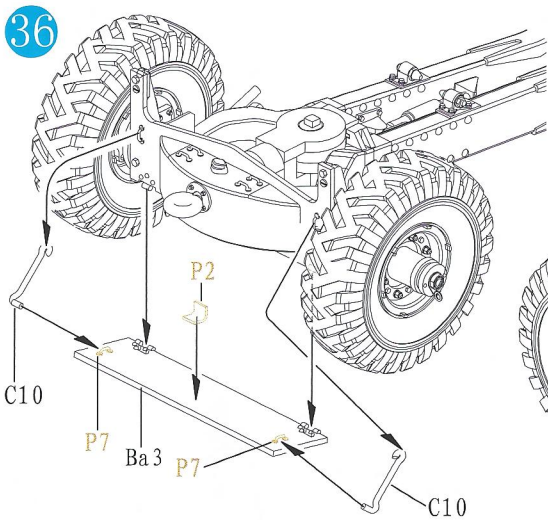
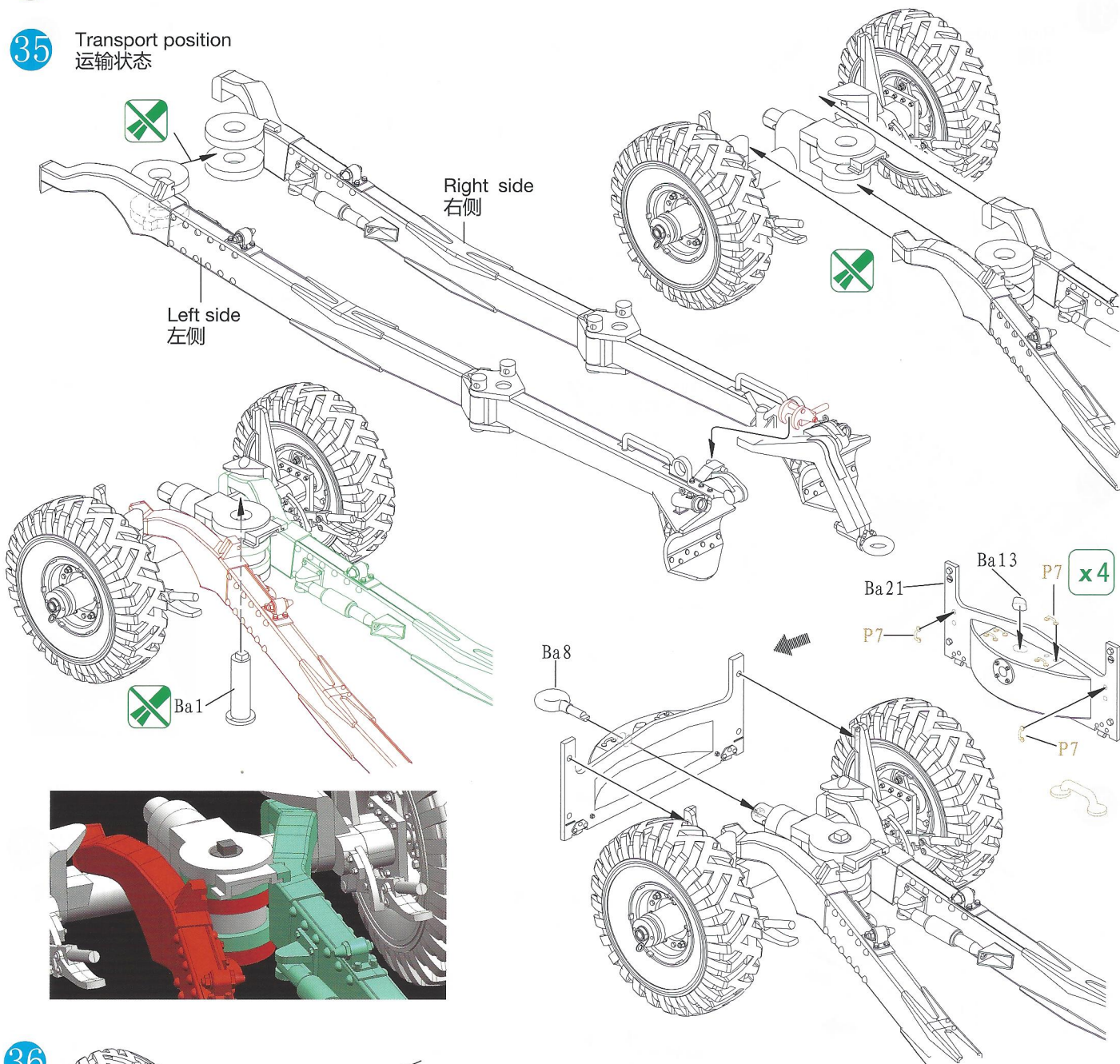
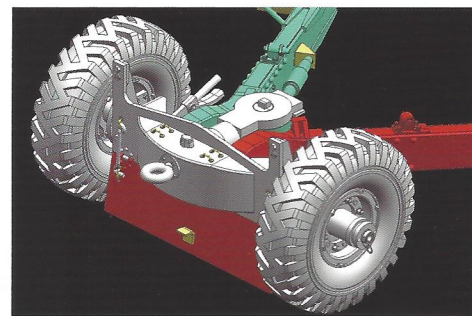
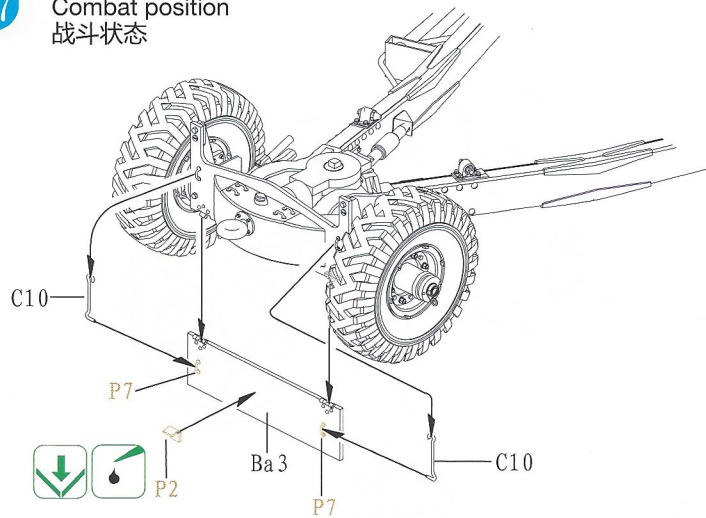

ILLUSTRATION 图示说明:

35 Transport position 运输状态



37 Combat position
战斗状态



38

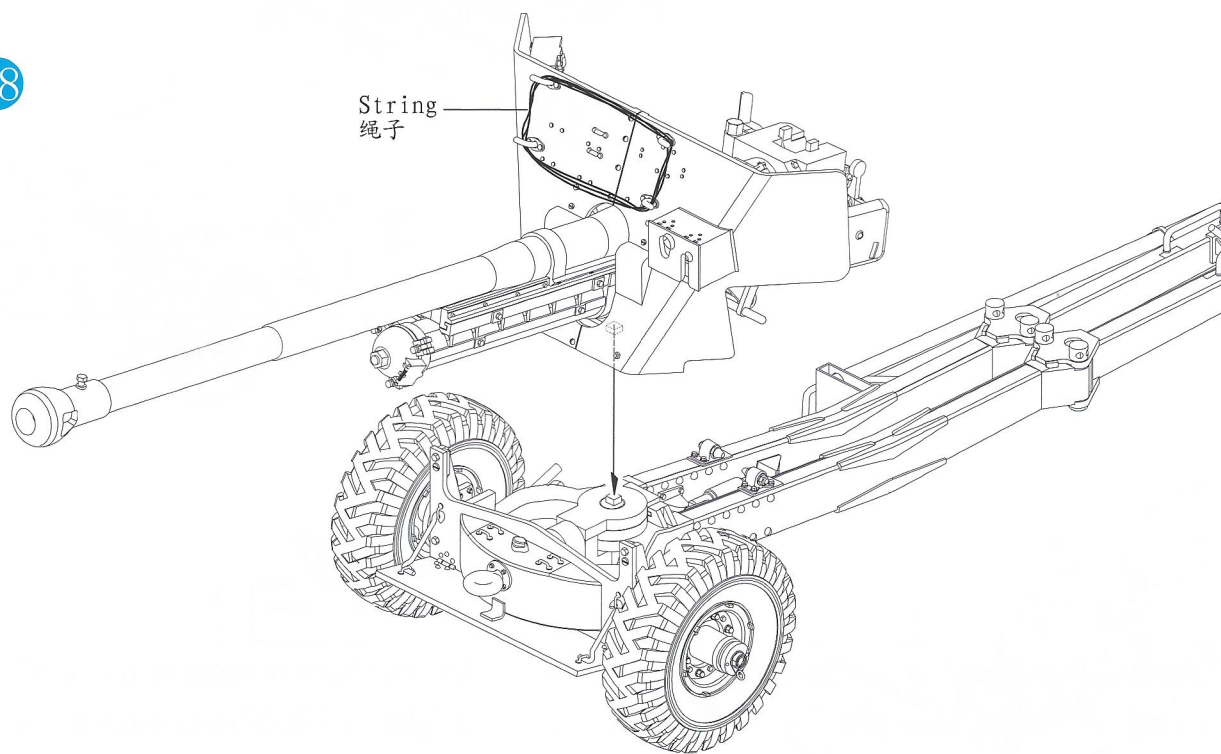

39 Transport position
运输状态

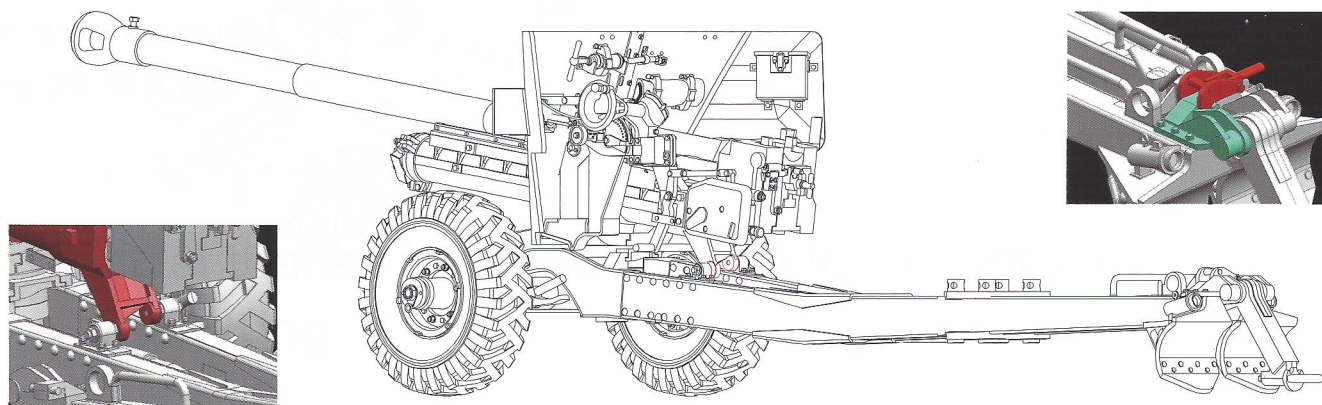
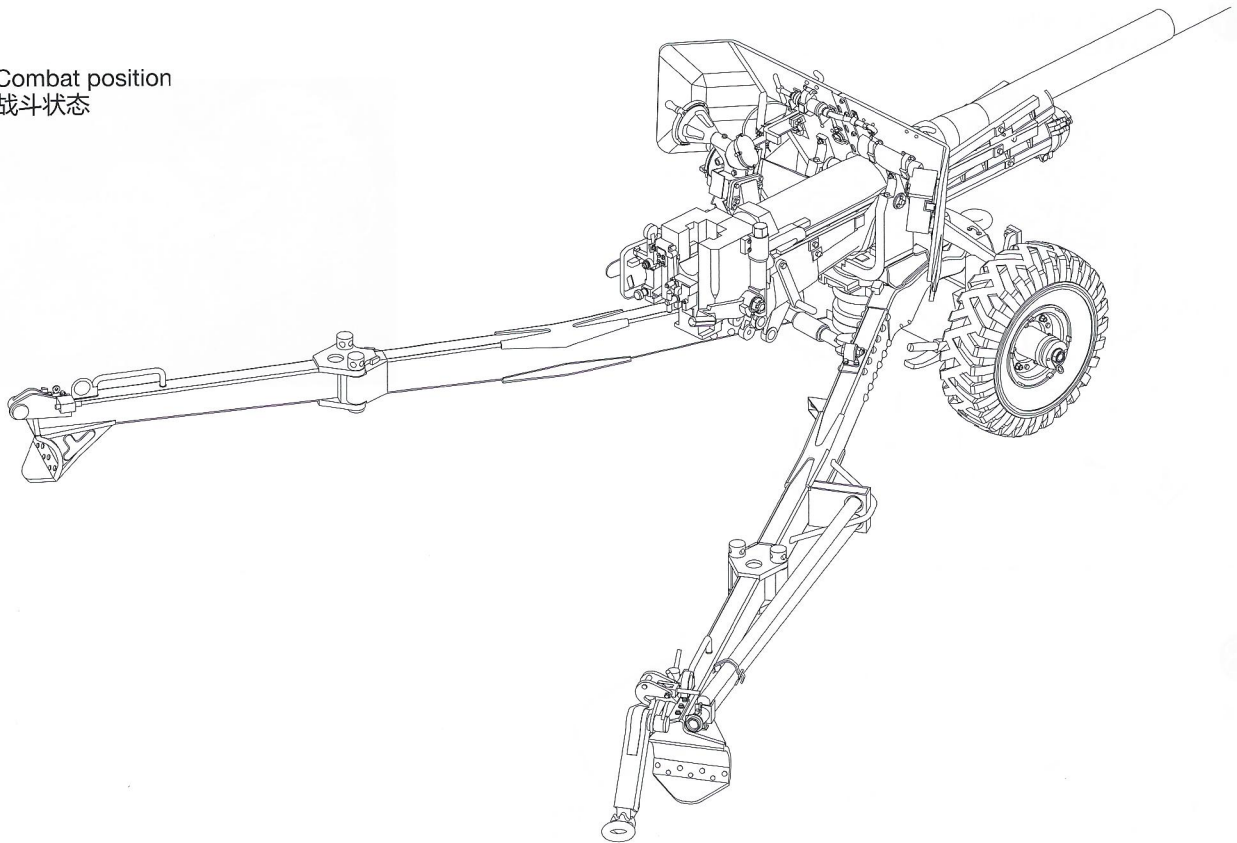

ILLUSTRATION 图示说明:

40

Combat position
战斗状态



41

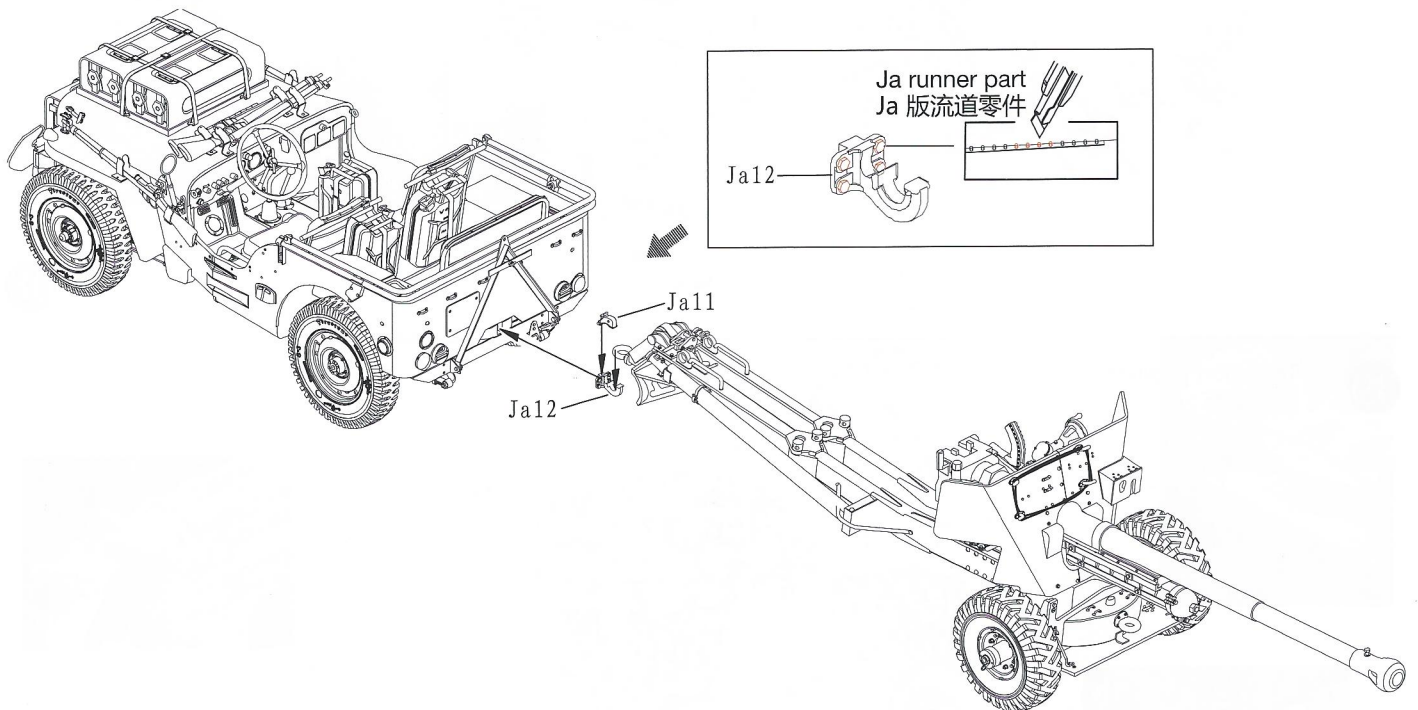

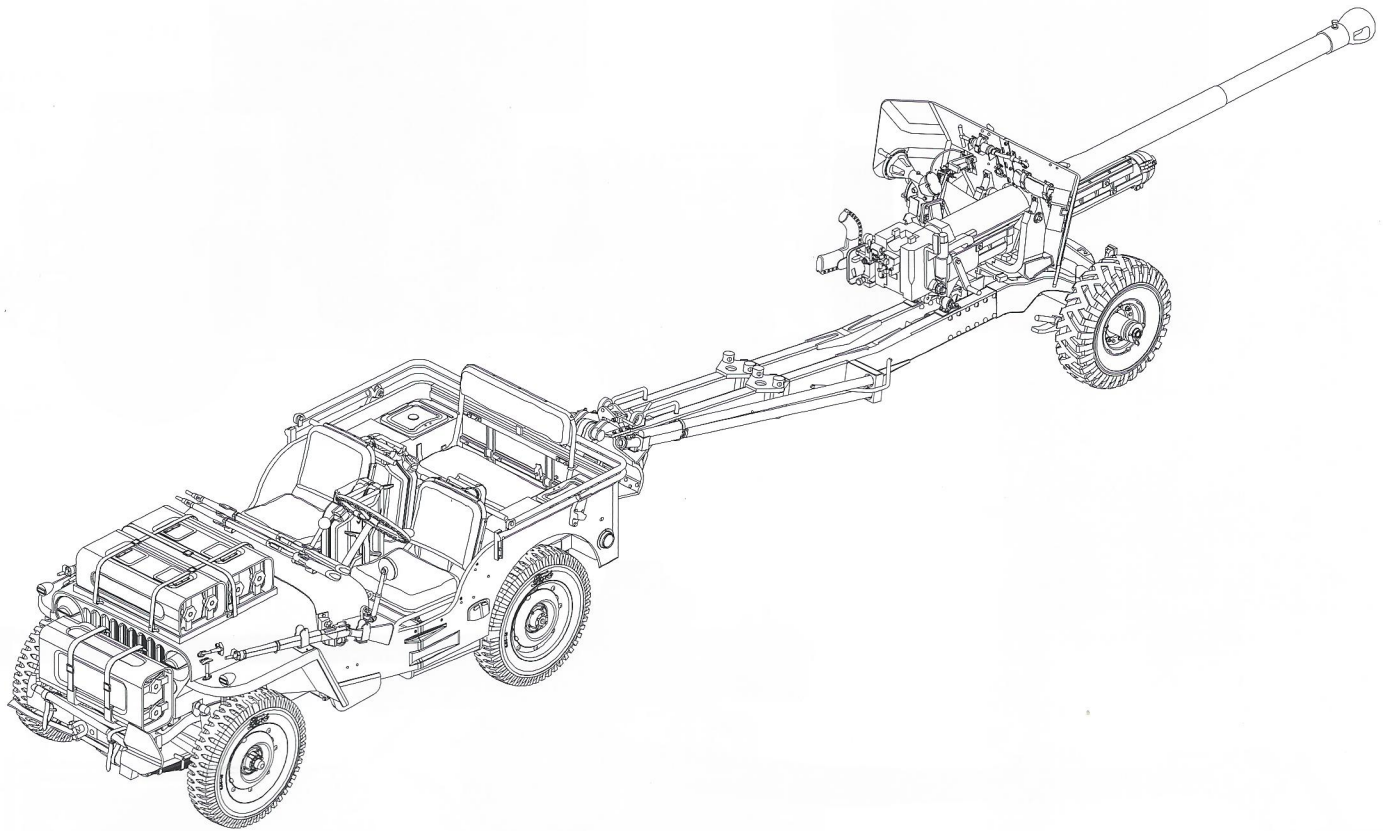

- ★ This is a precision molded plastic kit with exceptionally fine detail. It will require a little more care during assembly, but you feel the end result is well worth the effort.
本套件设计精密,零件繁多可能让你在制作过程中有所不便,但完成后会让你产生无穷之成功快感。

Happy modelling!
祝愿制作愉快!

- ★ Special thanks to below person for the info assistance
-Simon King

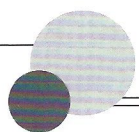

DECAL & COLOUR GUIDE 水贴及涂色指示:

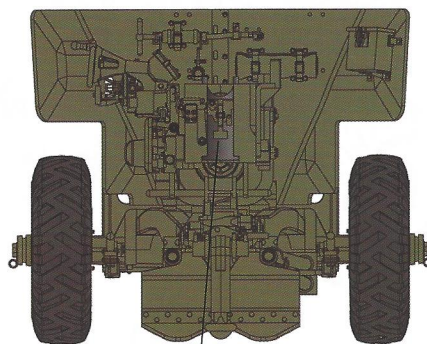
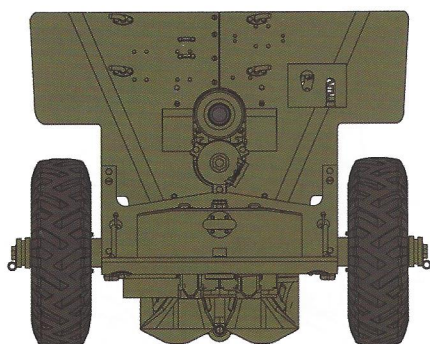

Steel
黑铁色

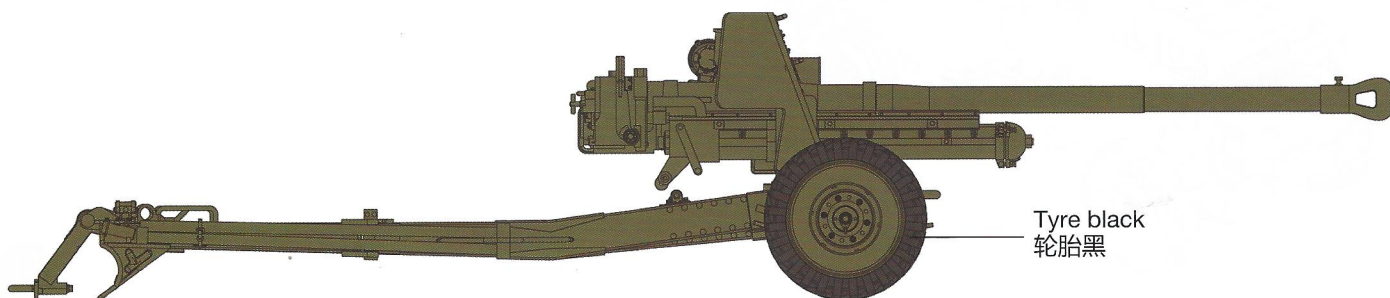

Tyre black
轮胎黑

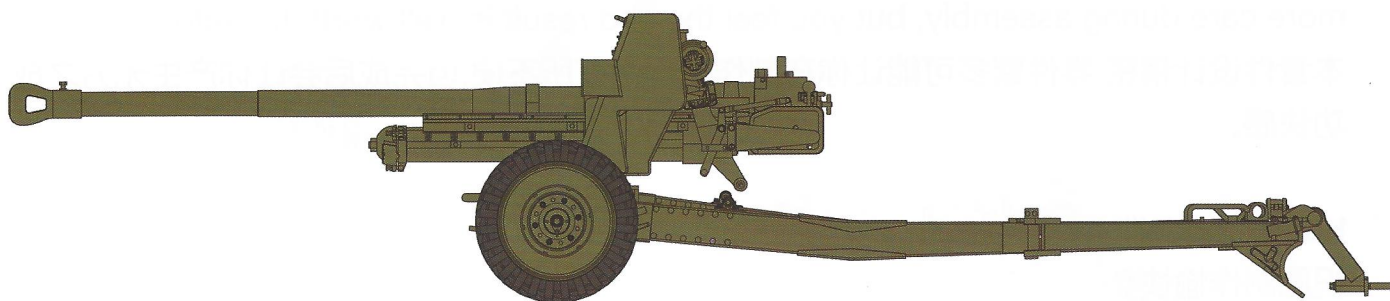





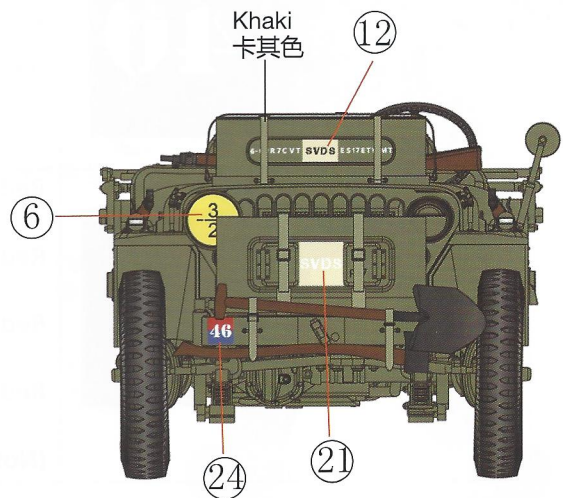
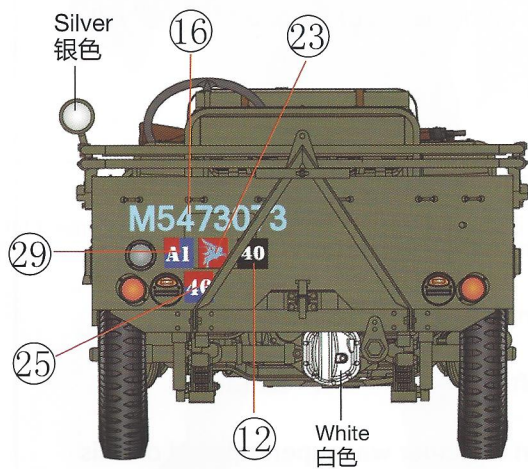
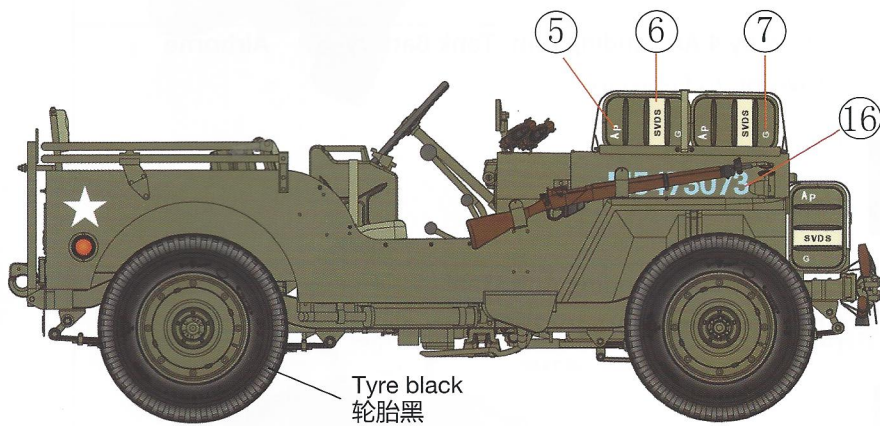
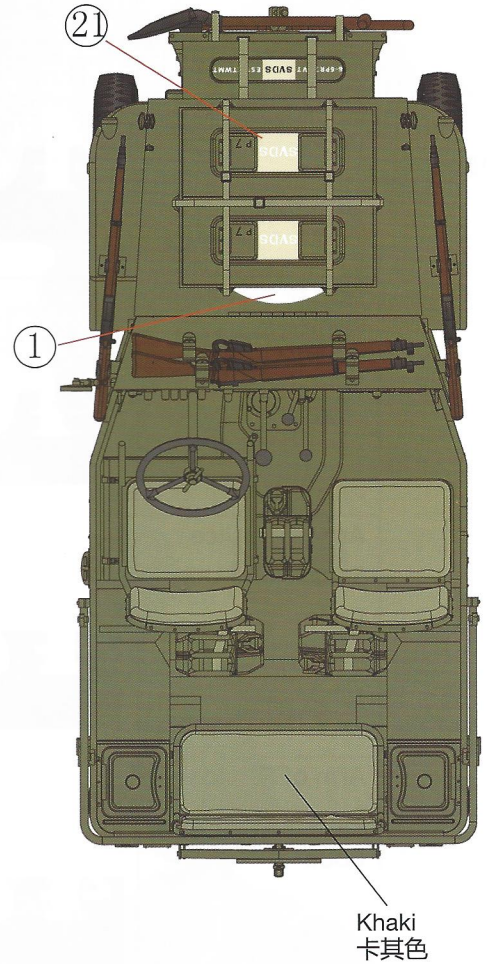
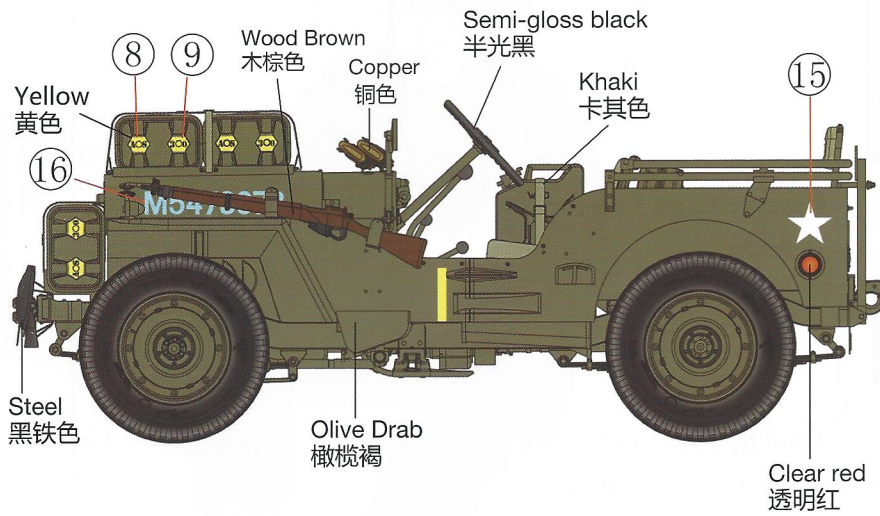

Camouflage Scheme: Overall Olive Drab
全车涂橄榄褐色

Option 1:

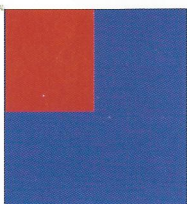

DECAL & COLOUR GUIDE 水貼及涂色指示:

Marking		Notes
Divisional Sign		Used by both the 1 st and 6 th Airborne Divisions
Arm of Service Square and Unit Code		Used by 1 and 2 Air Landing Anti -Tank Battery ,1 st Airborne Division
Arm of Service Square and Unit Code		Used by 3 Air Landing Anti -Tank Battery ,6 th Airborne Division to February 1945
Arm of Service Square and Unit Code		Used by 4 Air Landing Anti -Tank Battery ,6 th Airborne Division to February 1945
Arm of Service Square and Unit Code		Used by 2 Air Landing Anti -Tank regiment ,6 th Airborne Division from February 1945
Arm of Service Square and Unit Code		Divisional Headquarters sign sometimes also seen on anti-tank assets attached to Divisional Headquarters –might be seen for example on the jeeps of Z troop of the 1 st A/L battery – see below
Royal Artillery Tactical Marking		<p>Red quadrant top right = 1st Battery</p> <p>Red quadrant bottom right = 2nd Battery</p> <p>Red quadrant bottom left = 3rd Battery</p> <p>Red quadrant top left = 4th Battery</p> <p>(Note that troop/gun identifier was superimposed on this</p>

As always, consult your own references regarding the complex subject of markings as required

A

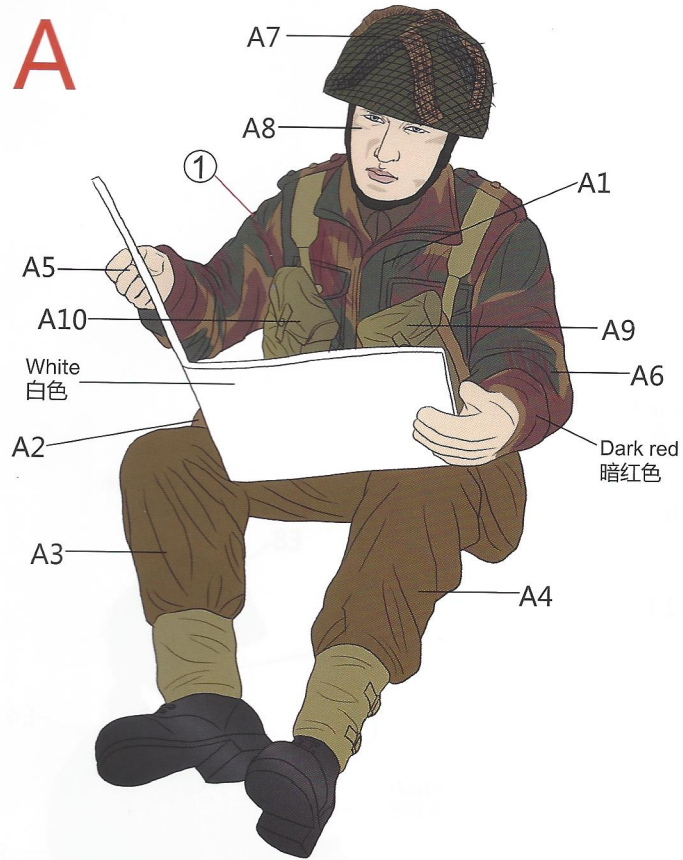

B

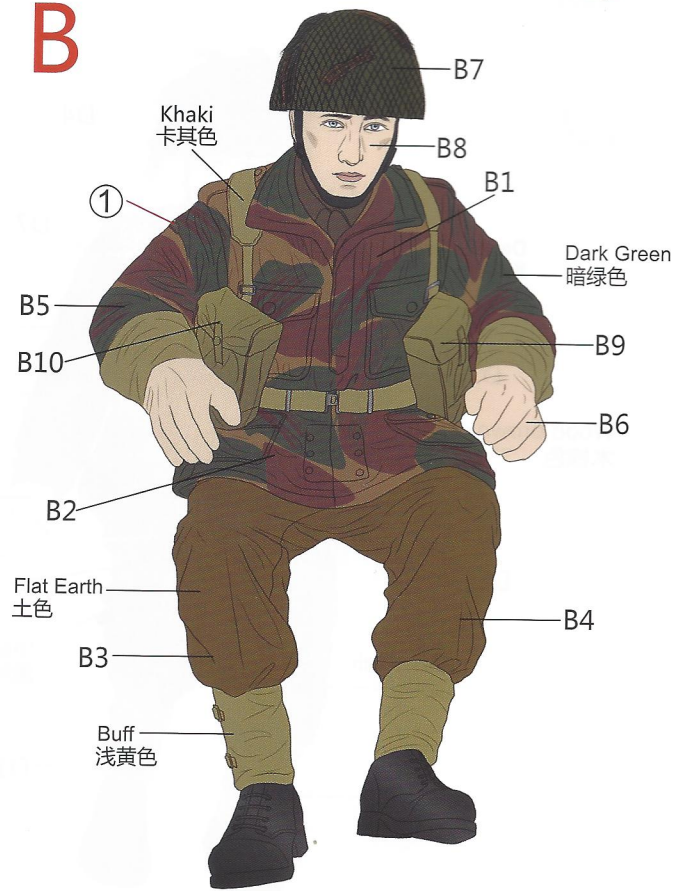

C

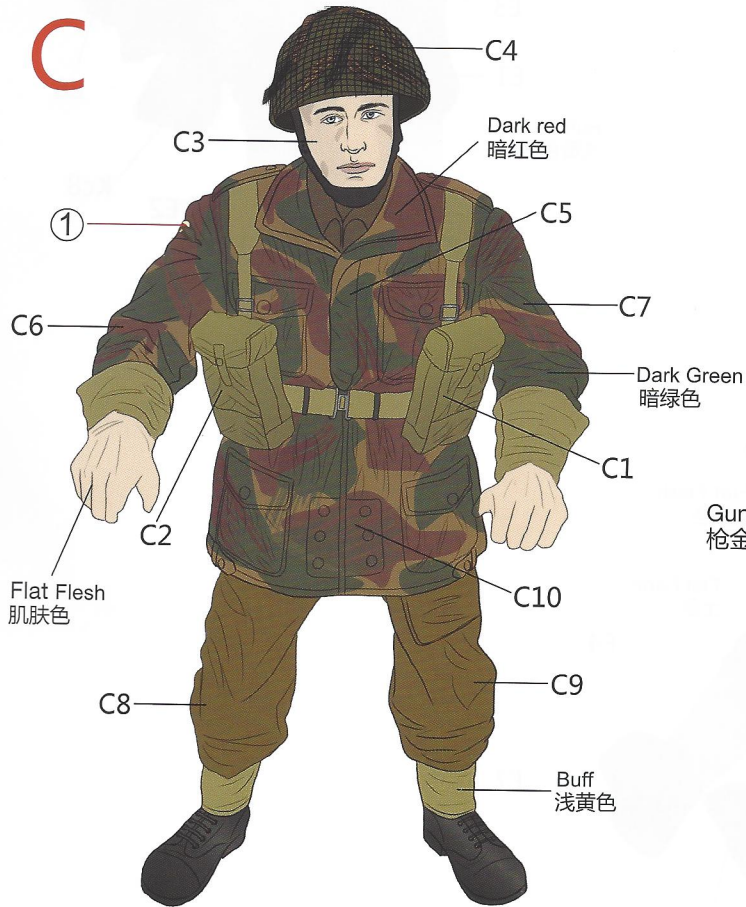

DECAL & COLOUR GUIDE 水贴及涂色指示:

D

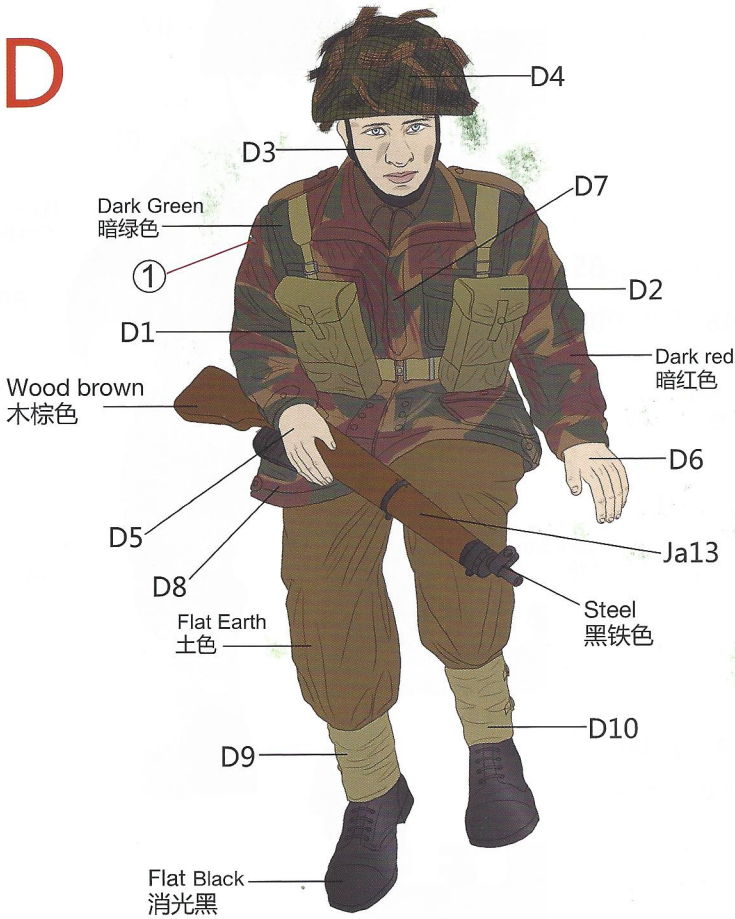

E



F

