

SuE SEM



Super Étendard / Super Étendard Modernisé

The Super Étendard (SuE) is a French carrier-borne strike fighter aircraft designed by Dassault-Breguet for service with the French Navy. The aircraft is an advanced development of the Étendard IVM. The Super Étendard first flew in October 1974 and entered French service in June 1978. French Super Étendards have served in several conflicts such as the Kosovo War, the War in Afghanistan and the military intervention in Libya.

The Super Étendard was also operated by Iraq and Argentina, who both deployed the aircraft during wartime. The SuE was used by Iraq to attack oil tankers and merchant shipping in the Persian Gulf during the Iraq-Iran War. Argentina's use of the Super Étendard and the Exocet missile during the 1982 Falklands / Malvinas War.

The SuE is a single-engined, mid-winged aircraft with an all-metal structure. Both the wings and tailplane are swept, with the folding wings having a sweepback of about 45 degrees. The main new weapon of the SuE was the French anti-shiping missile, the Aérospatiale AM 39 Exocet.

The Super Étendard Modernisé (SEM) flew strike missions in Operation Enduring Freedom. Mission Héraclès saw the deployment of the aircraft carrier Charles de Gaulle and its Super Étendards in Afghanistan.

シュペルエタンダールはフランス海軍の艦載機としてダッソーブレゲー社から開発されたもので、エタンダールIVの後継機である。対艦ミサイル・エグゾセと共に開発され、1974年初飛行し、1978年実戦配備以来のさまざまな戦争や紛争で重要な役割を果たし続けている。その中でも、フォークランド戦争の当時アルゼンチン海軍の同機からの攻撃によりイギリスの駆逐艦・シェフィールドを撃沈させた、いわゆる「シェフィールド・ショック」が有名である。その他にも、イラン・イラク戦争においてイラクに貸与していた機体によるタンカーへの攻撃や、フランス海軍のコソボ紛争、イラク・アフガニスタン・リビアなどに対する海外作戦展開などに参加し、対地攻撃やその支援、偵察、対空監視、給油など多様な任務に就いている。特に、1990年代から行われた近代化改修を受けたSuper Étendard Modernisé (SeM)はラファールなどの僚機がレーザー誘導爆弾で攻撃するターゲットを照射できるレーザーポッドを運営している。また、この機体は核爆弾やミサイルの運用能力を持ち、フランスの核戦力のひとつでもある。

CAUTION

- *Read carefully and fully understand the instructions before commencing assembly.
- *Keep out of reach of children. Children must not be allowed to put any parts in their mouths, or pull plastic bag over their heads.
- *When using adhesives and paints, please make sure not to use them in closed room or near the fire.
- *When assembling this kit, tools including knives are used. Extra care should be taken to avoid injury.

WARNING: CONTAIN SMALL PARTS NOT FOR CHILDREN UNDER 14 YEARS OF AGE.



Drill



Remove



2 Set



Bend



Optional



Decal



Super Glue



Fill Hole



No Cement



Be Careful

TOOLS RECOMMENDED

Cement



Side Cutter

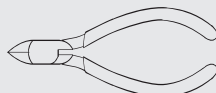

Modeling Knife



Tweezers



1/48 SCALE AIRCRAFT SERIES NO. K48140

AFTERMARKET SERVICES CARD

When requesting replacement parts, please take or send this form to your local dealer so that the parts required can be correctly identified. Please note that specifications and availability are subject to change without notice. Or visit <http://www.kineticmodel.com> for latest information. For more information, please contact services@kineticmodel.com

Part Code	K48140	Qty	Item
00-127-013	1/48 FRENCH WEAPONS (Z)	2	Z
00-157-001	1/48 SUPER ETENDARD FUESLAGE #1	1	A
00-157-002	1/48 SUPER ETENDARD FUESLAGE #2	1	B
00-157-003	1/48 SUPER ETENDARD PARTS	1	C
00-157-004	1/48 SUPER ETENDARD CLEAR PARTS	1	D
00-157-005	1/48 SUPER ETENDARD MODEN WEAPON	2	E
01-157-48061	1/48 SUPER ETENDARD	1	DECAL
01-157-48140	1/48 SUPER ETENDARD MODERN	1	DECAL
03-157-48140	1/48 SUPER ETENDARD	1	MANUAL
06-157-48061	1/48 SUPER ETENDARD	1	PE

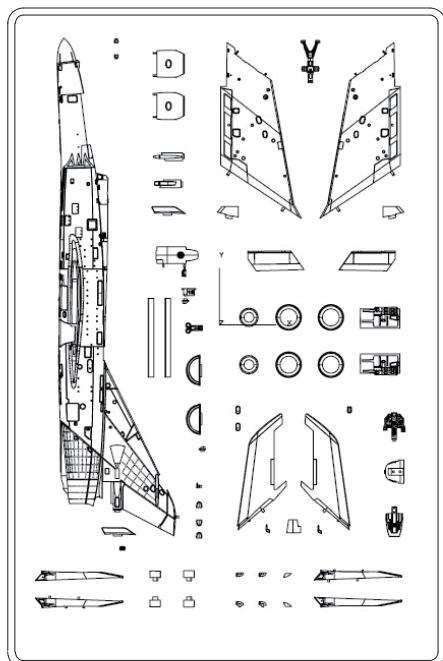
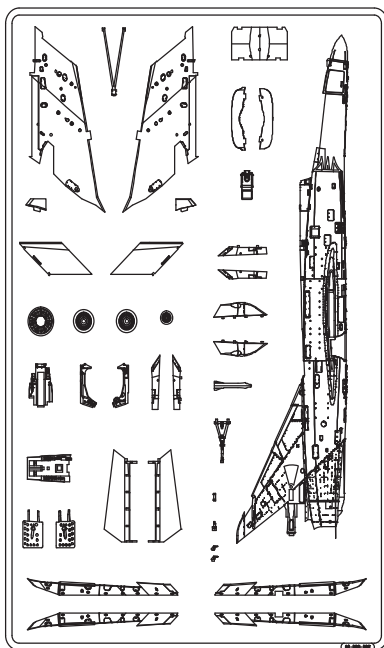
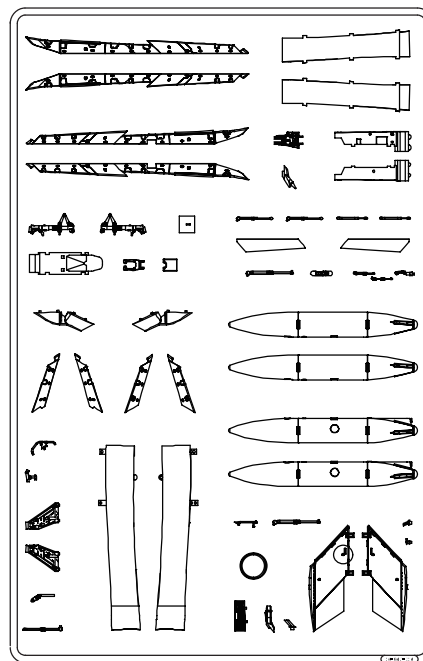
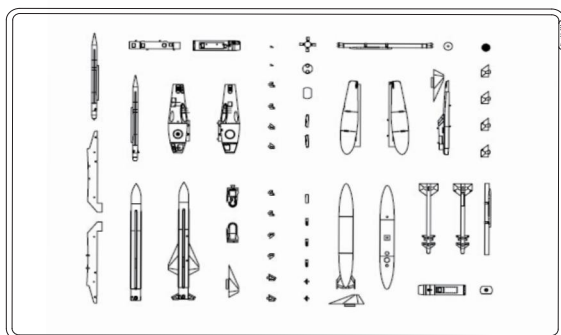
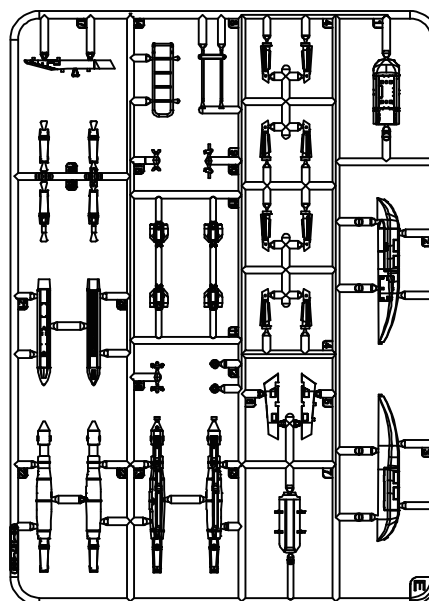
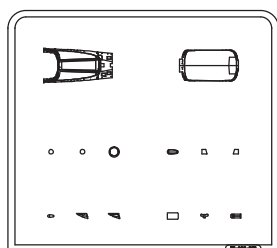
A

B

C

Zx2

Ex2

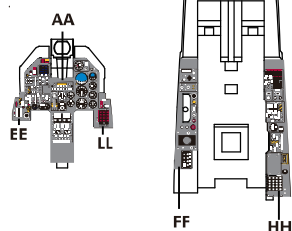
D

PE





COLOR	AMMO MIG	VALLEJO MODEL COLOR	GSI CREOS MR. COLOR	TAMIYA ENAMEL/ACRYLIC	HUMBROL ENAMEL
GUNMETAL	A.MIG-045	70.863	28	X-10	-
FLAT BLACK	A.MIG-046	70.950	33	XF-1	33
SATIN WHITE	A.MIG-047	71.001	1	X-2	22
RED	A.MIG-049	70.957	114	XF-7	153
FLAT WHITE	A.MIG-050	70.951	62	XF-2	34
CLEAR GREEN	A.MIG-092	70.936	138	X-25	-
CLEAR RED	A.MIG-093	90.934	47	X-27	-
SILVER	A.MIG-195	70.790	8	X-11	11
DARK SEA GREY	A.MIG-203	71.048	308	-	196
GUNSHIP GREY (FS 36118)	A.MIG-204	70.836	305	XF-77	-
DARK GHOST GREY (FS 36320)	A.MIG-208	71.120	307	-	-
GRAYISH BLUE (FS 35237)	A.MIG-210	70.905	337	-	-
OLIVE DRAB	A.MIG-926	70.889	304	-	-

For Color Profile, please go to www.kineticmodel.com for download
 (type the kit# and go for manual/painting guide)

SEM

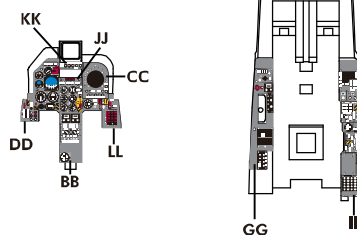

SUE



1

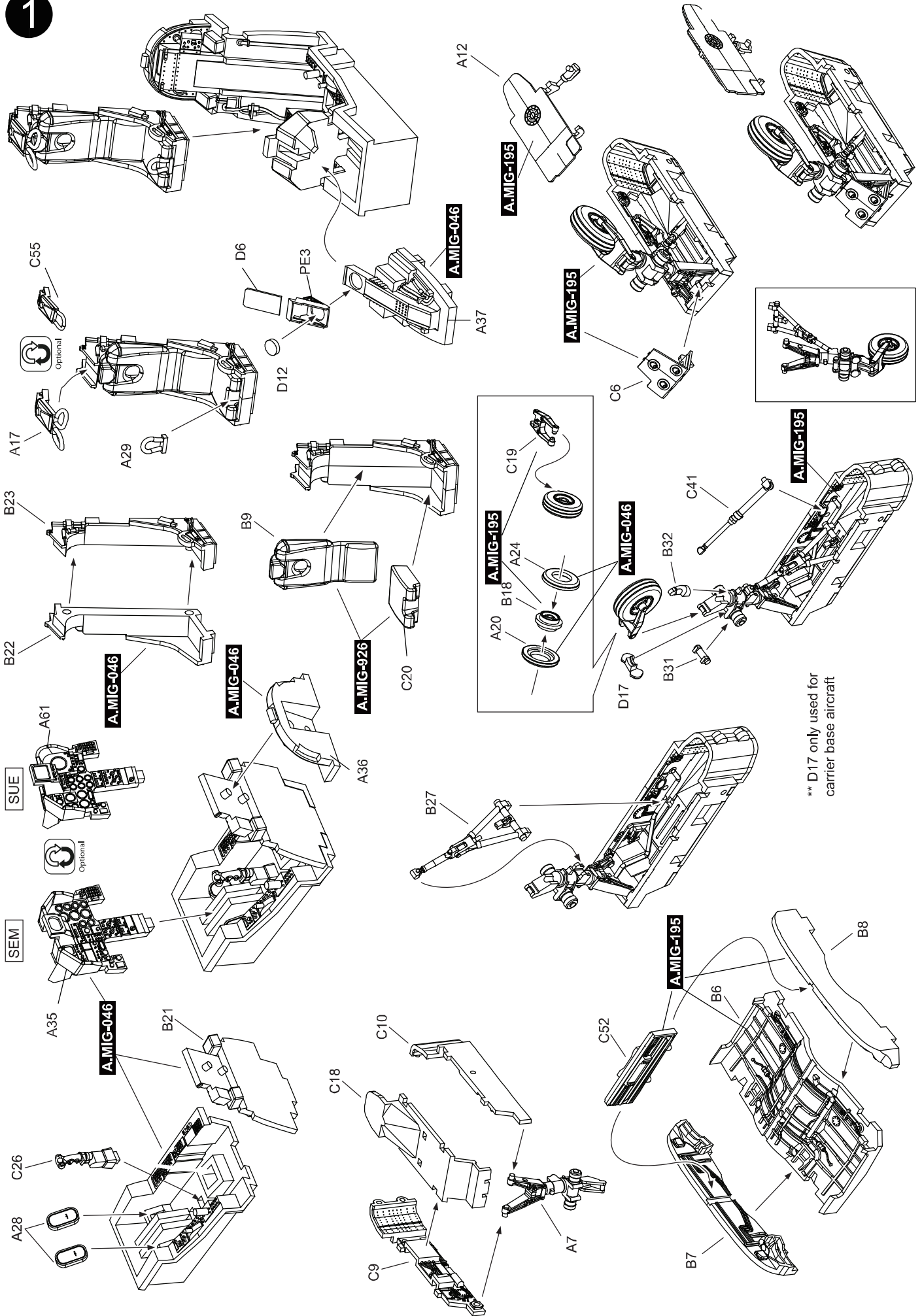

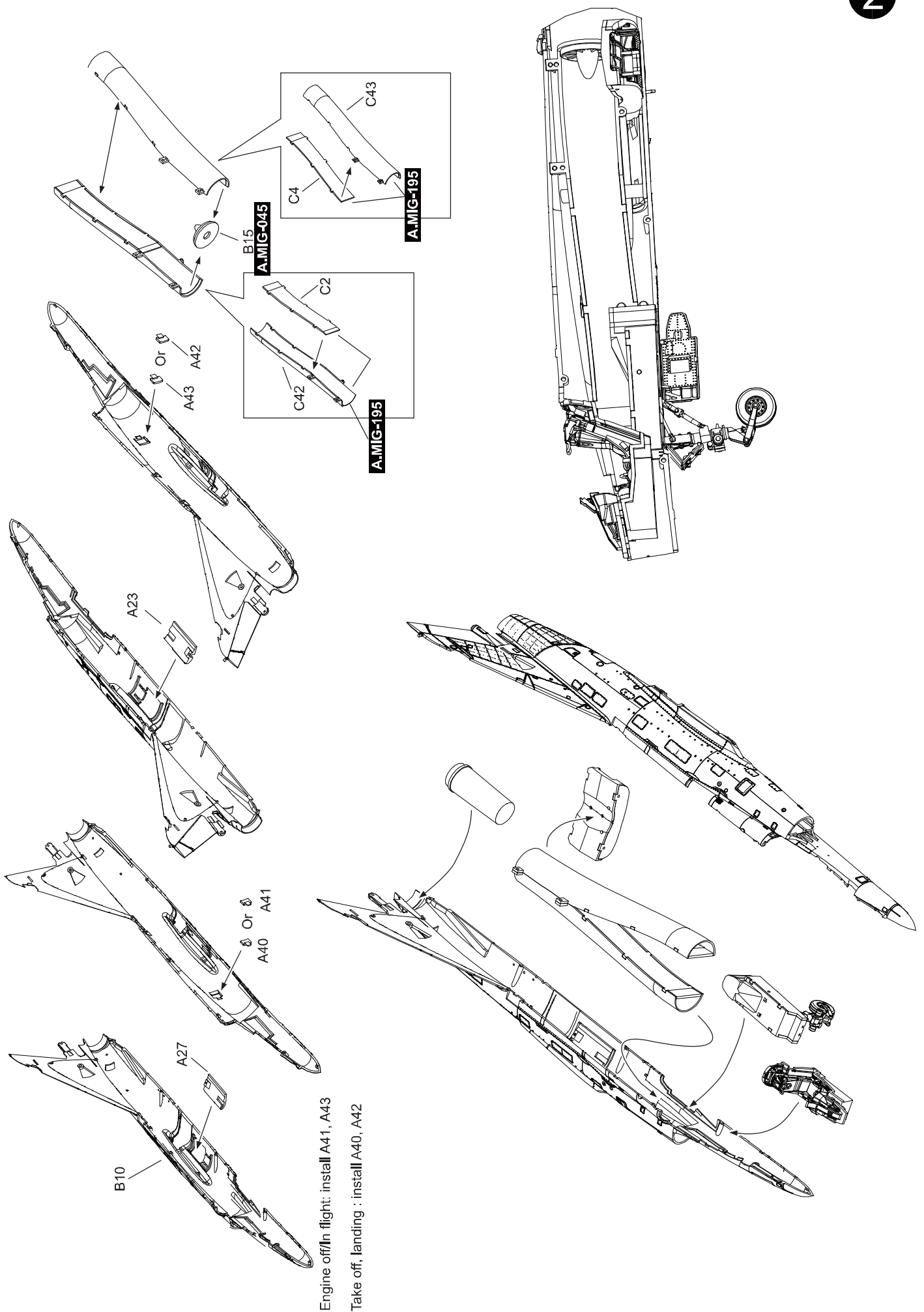

3

Airbarkes Closed

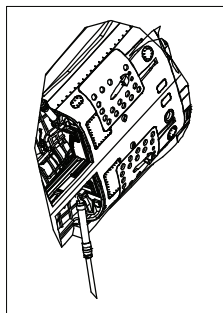

Airbarkes Opened

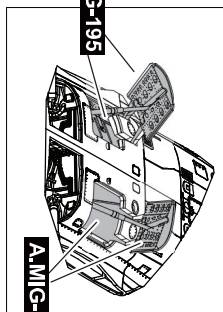

4

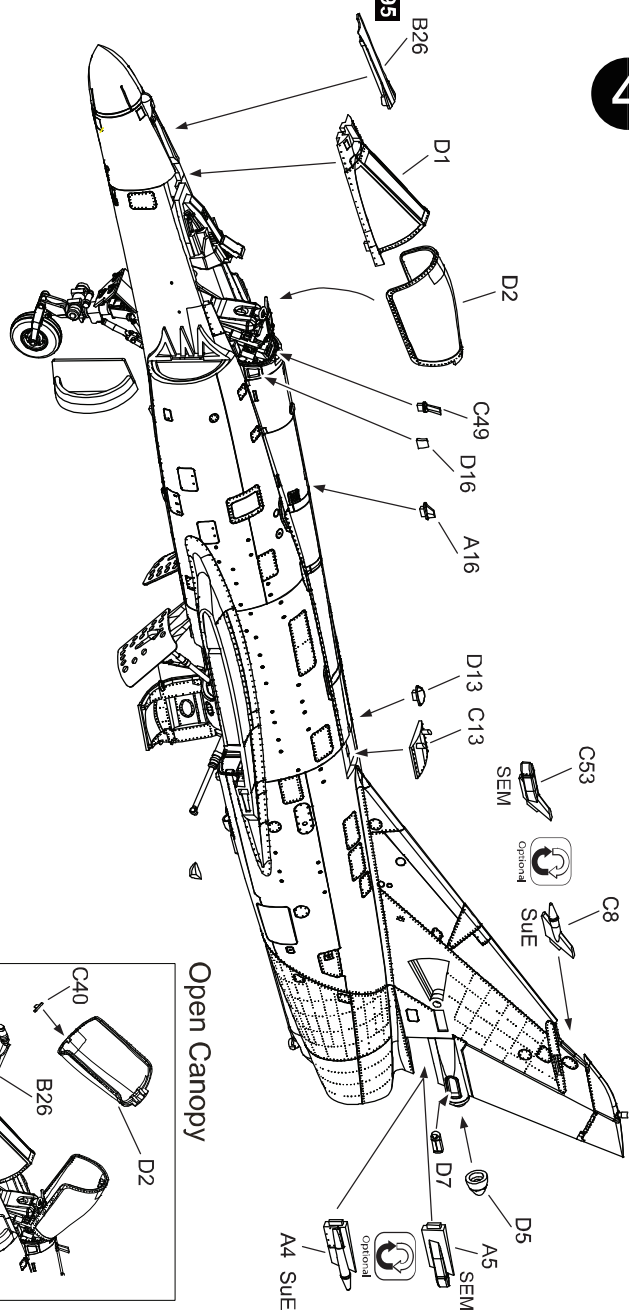

Open Canopy

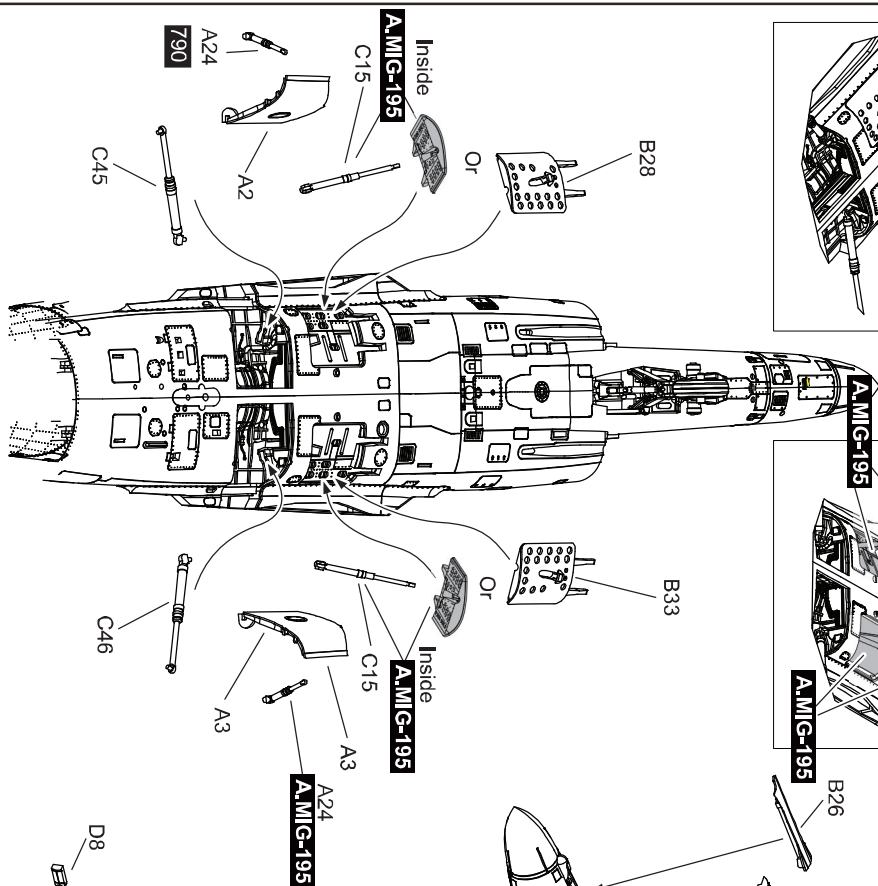

Wheel Bay

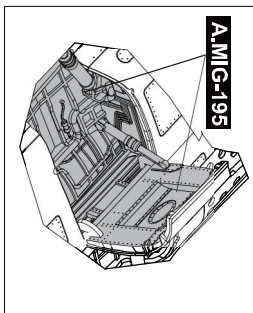

A.MIG-195

Wheel Bay

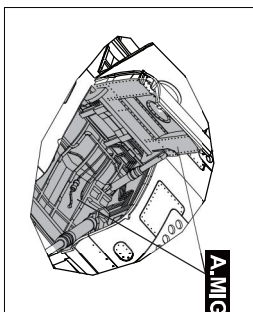

A.MIG-195

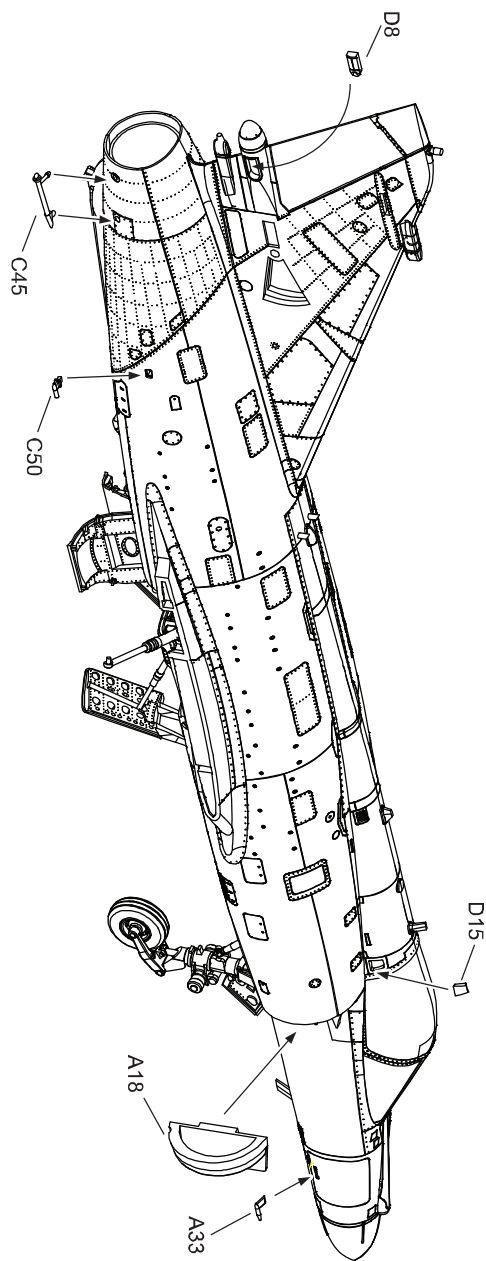

5

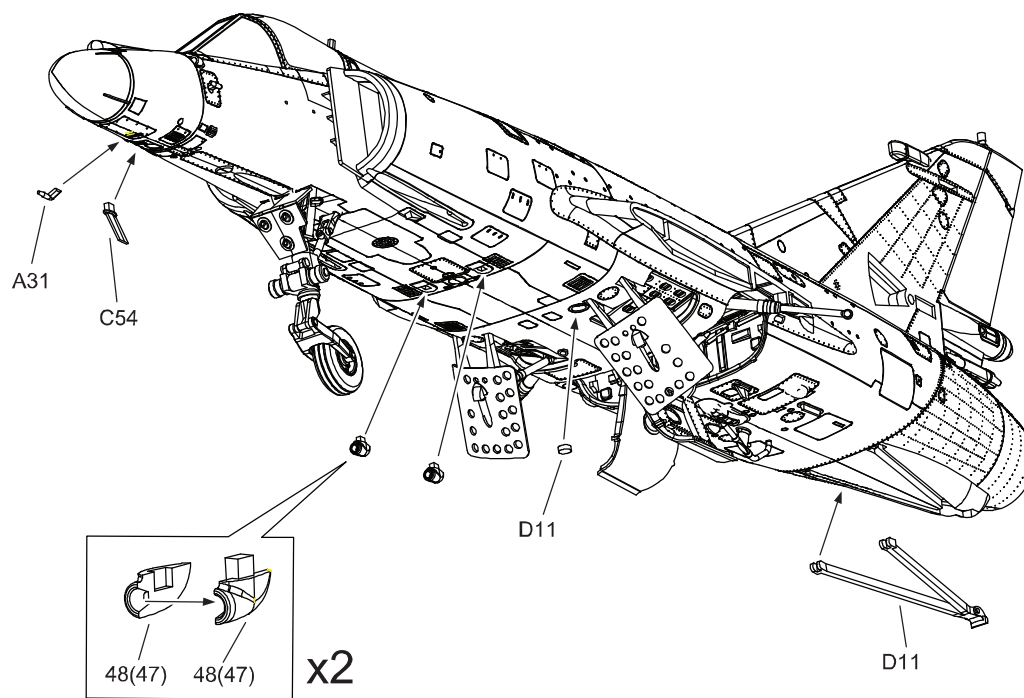

6

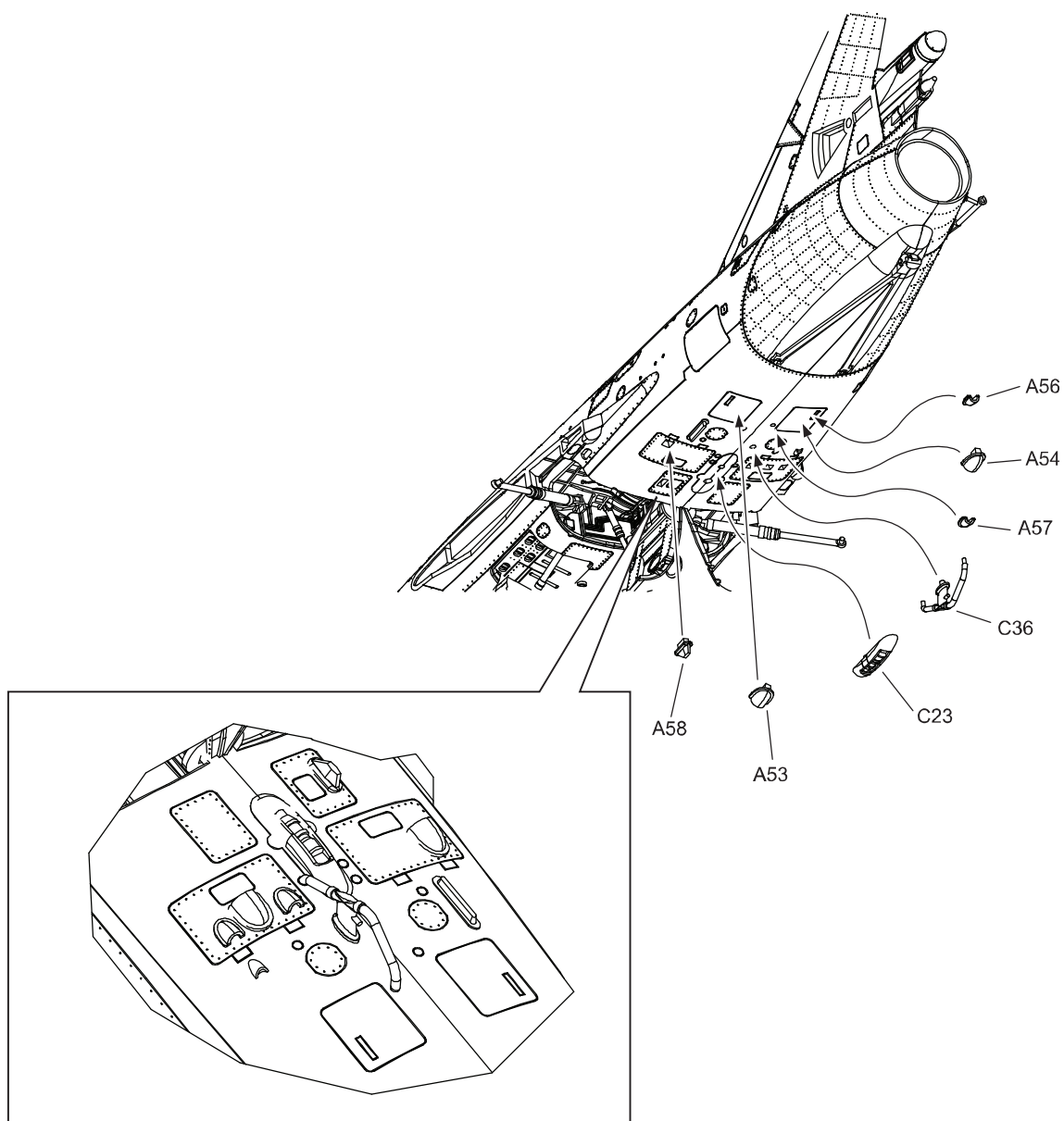

7

Flaps Up
(in flight or parked)

Flaps Down
(take-off or landing)

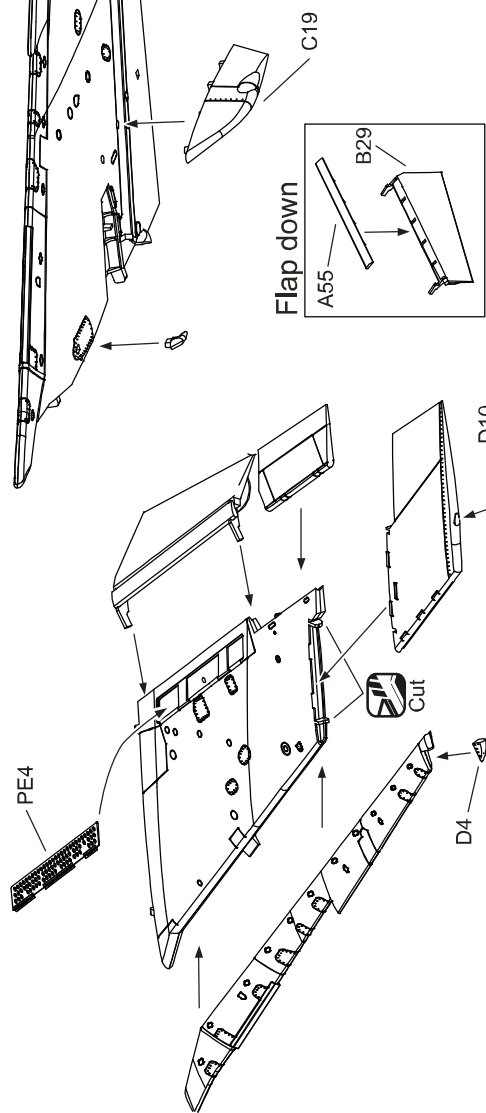

WING EXTENDED

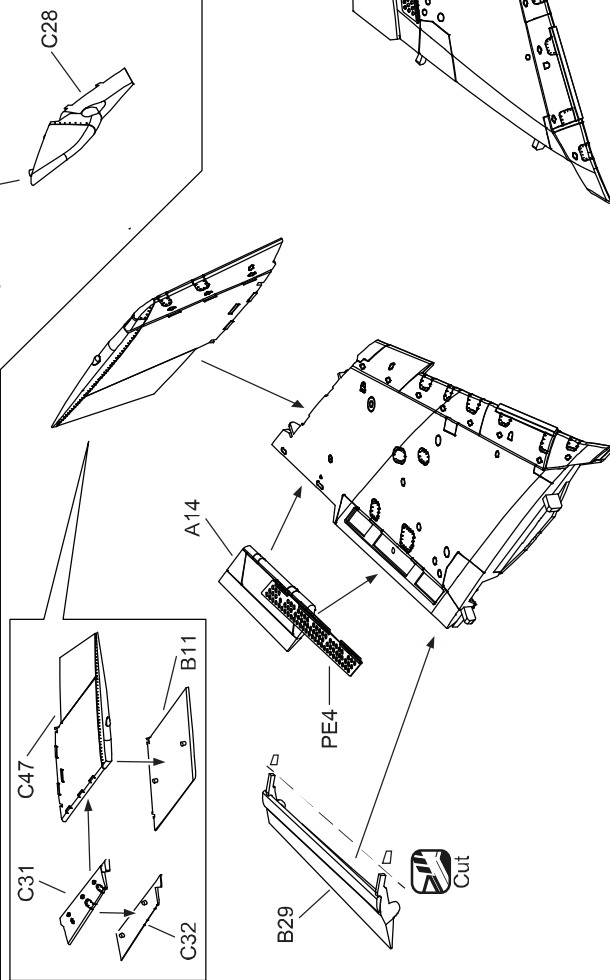

FOLDED WING

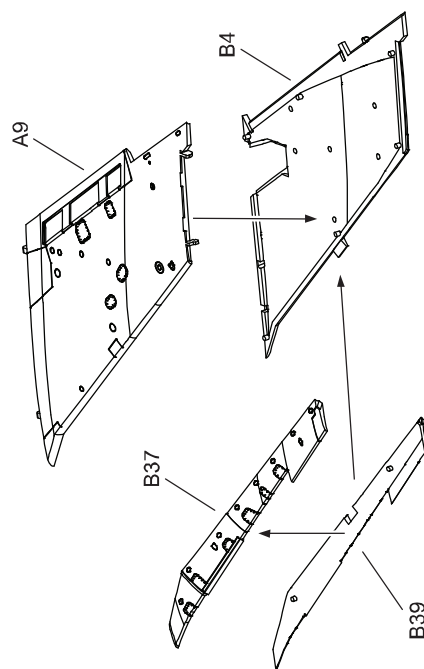

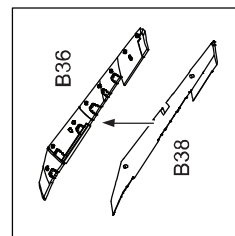
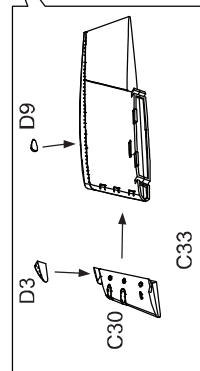
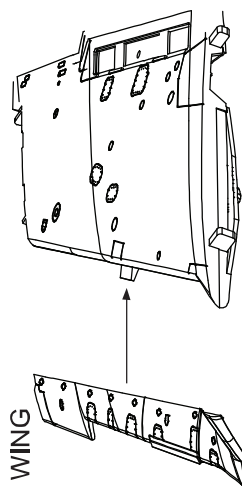
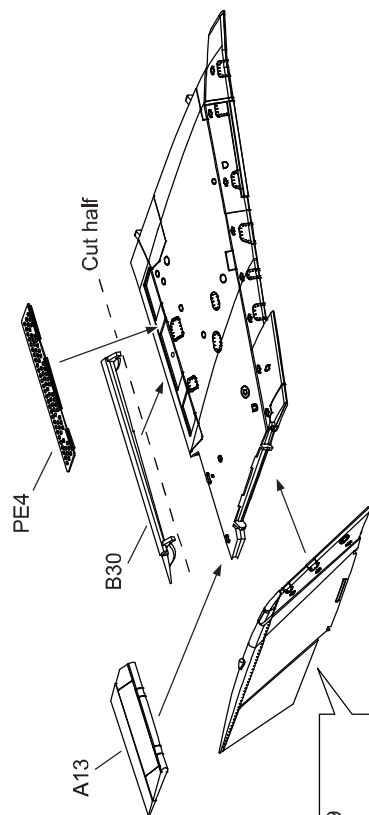
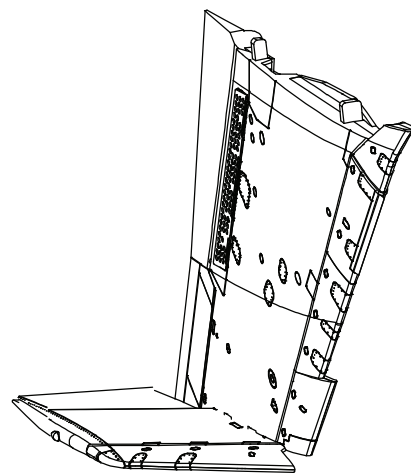
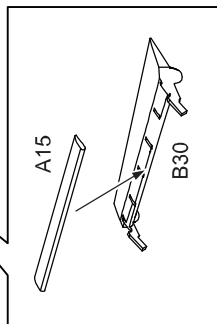
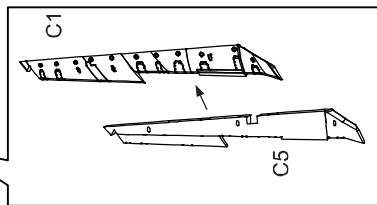
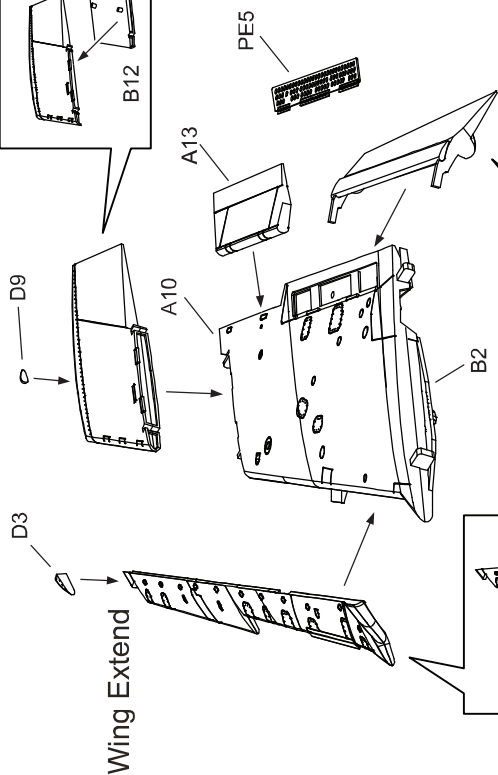
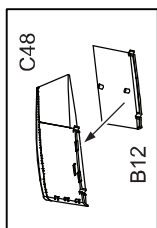
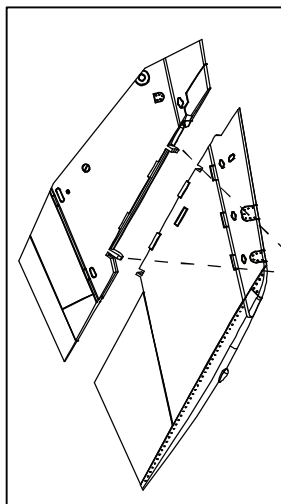
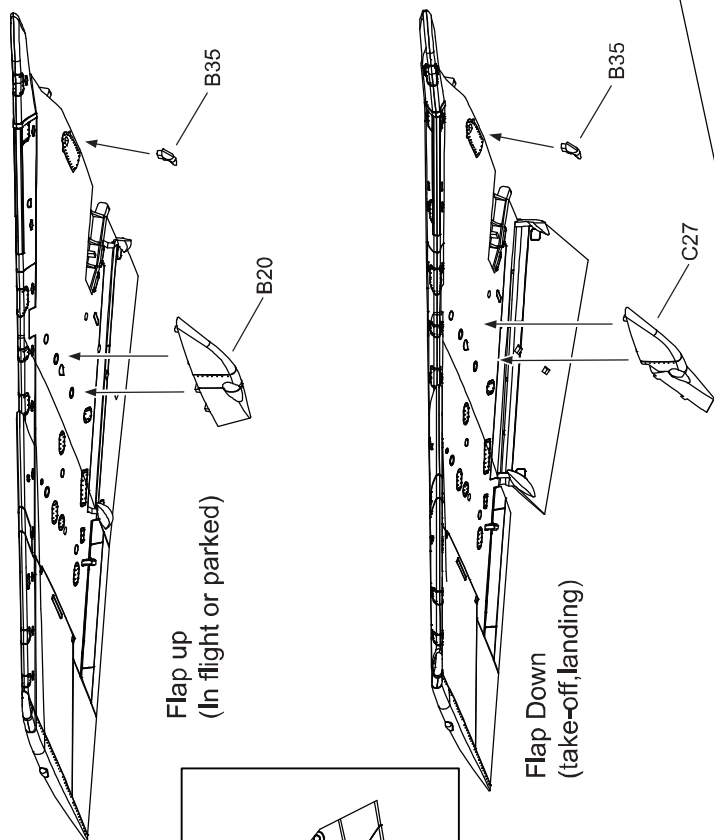

FOLDED WING

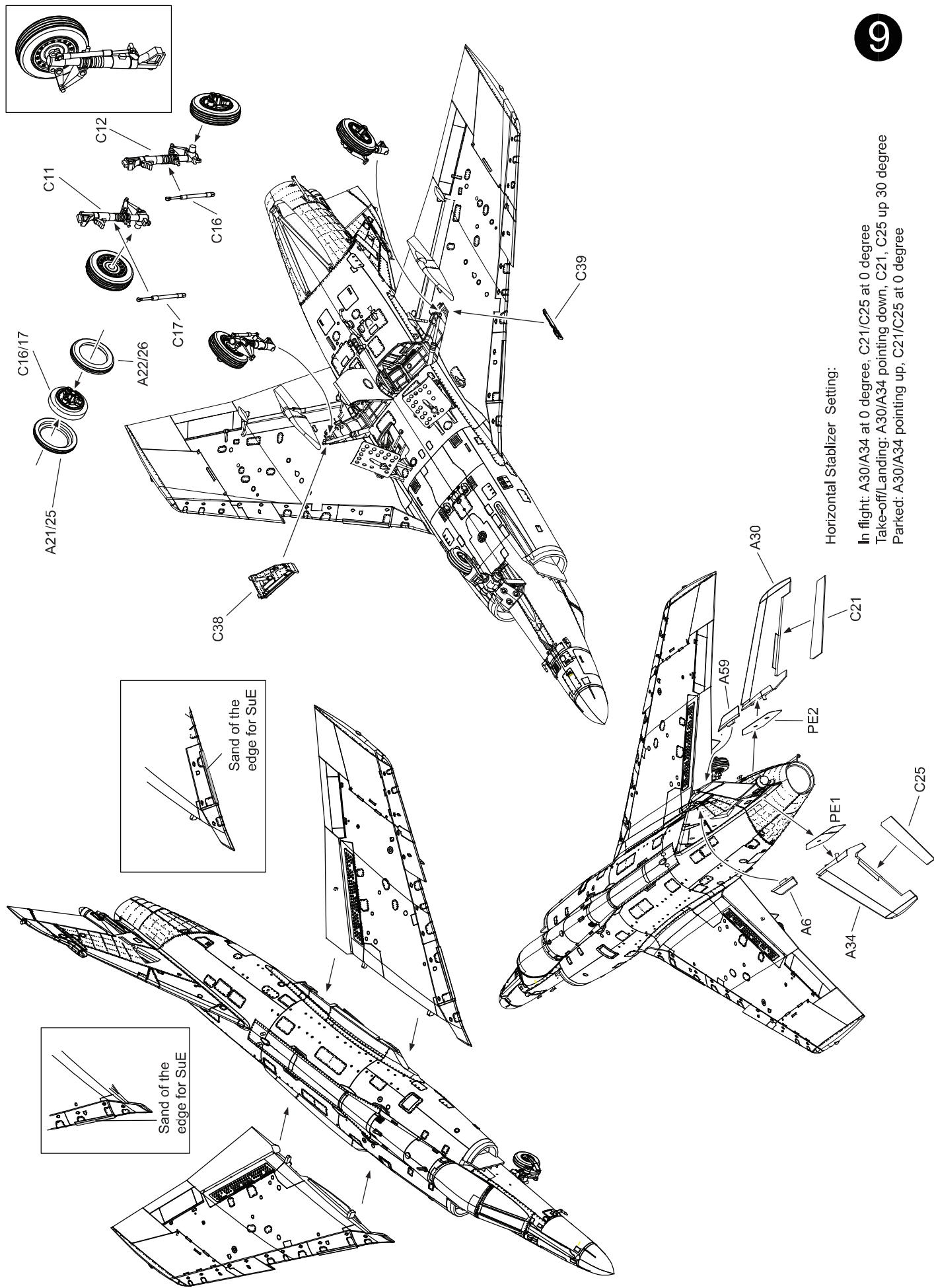

Horizontal Stabilizer Setting:

In flight: A30/A34 at 0 degree, C21/C25 at 0 degree
 Take-off/Landing: A30/A34 pointing down, C21, C25 up 30 degree
 Parked: A30/A34 pointing up, C21/C25 at 0 degree

11

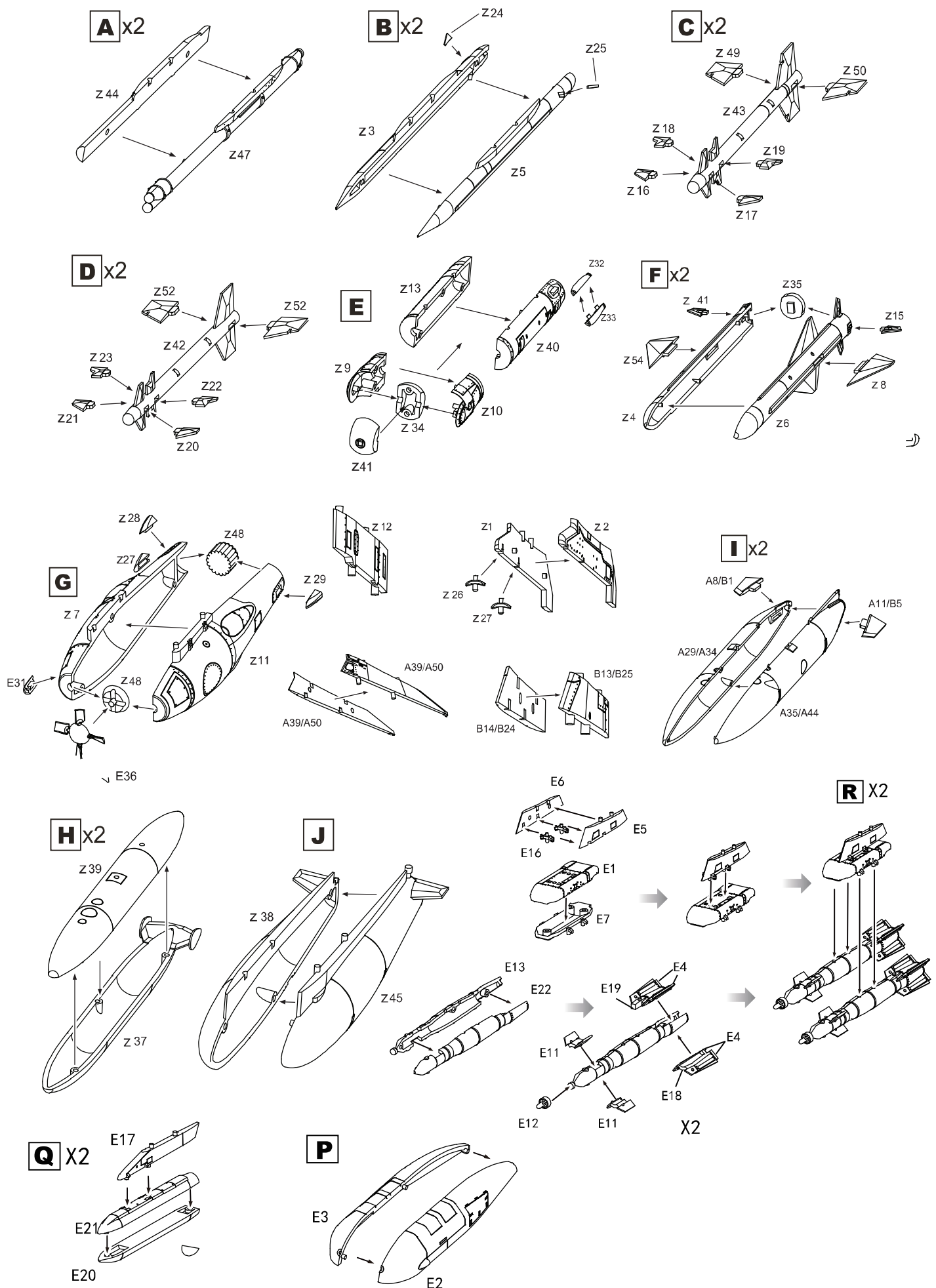

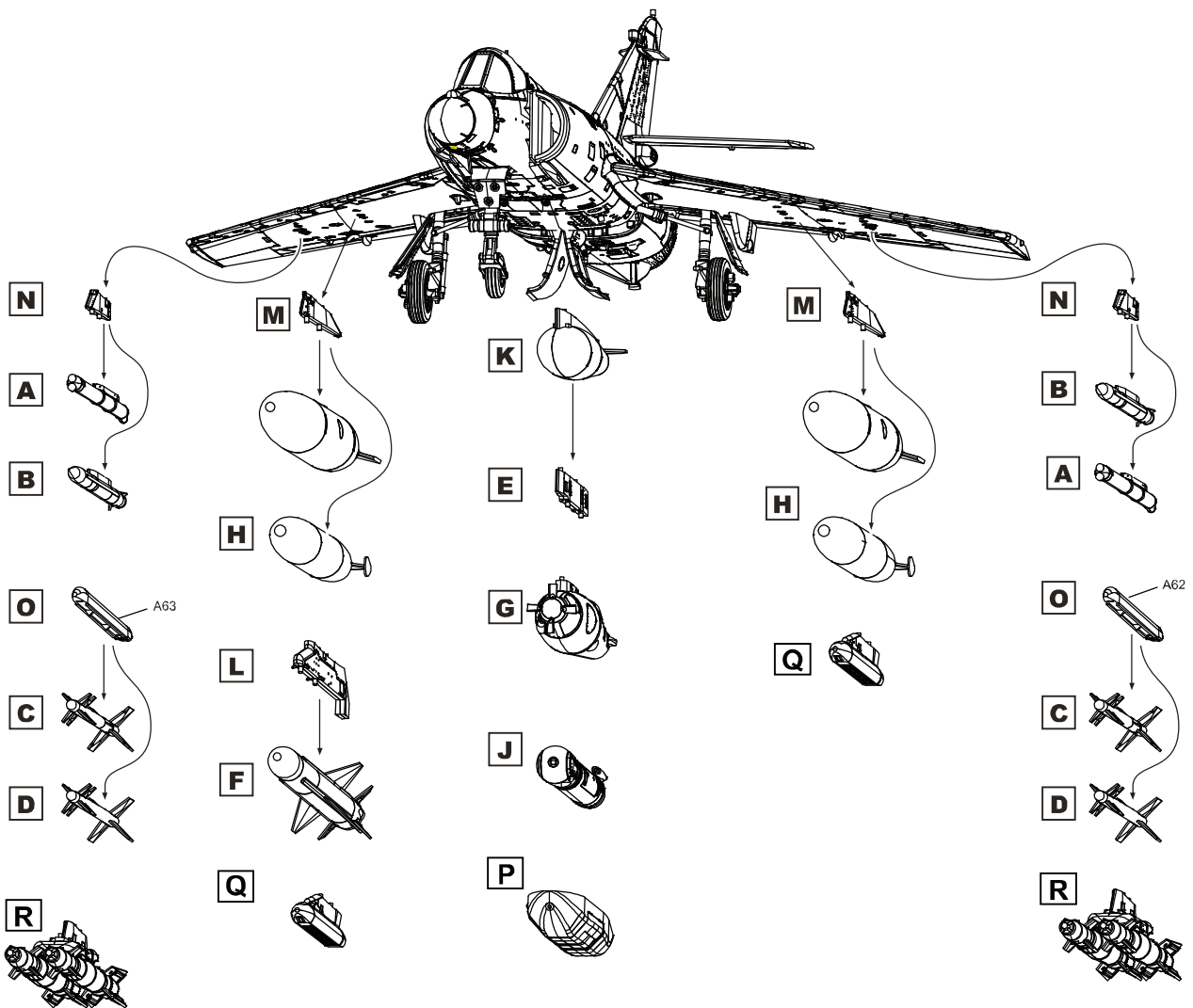
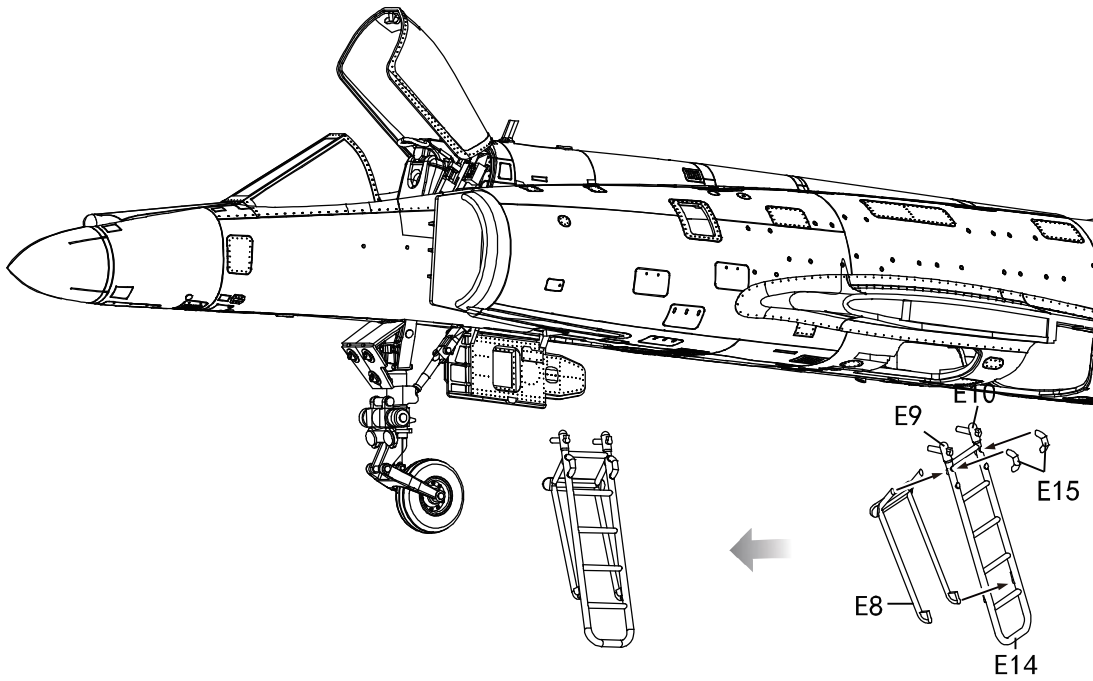

BASIC STENCIL MARKINGS LOCATION

DAMOCLES POD

99 to the front

86 92 90 91

85 93 89 93

85, 86, 92, 93 to both sides

625LITER TANK

108 to both sides

R550 MAGIC 2

103 102 104

103/104 to both sides

IN FLIGHT REFUELING POD

82 95 96 87 97 98 100 88 82 83 84

GBU-49

109 110 109 109

101 to canopy inside

71/72*

55*

71/72*

71/72*

75*

45*

44*

34 73/74 37 43 61 47 32 4 94 71/72 73/74 63 64 18 59 56 73/74 67/68 35 58 66 41 73/74 60 73/74 66 108 to both sides

AM39 EXOCET



105

106 both sides

* : Apply to both sides

1/48 SCALE AIRCRAFT SERIES NO. K48140

1. Super Étendard , Aéronavale (French Naval Aviation), 1980s.

- 11  : Flottille 11 (11 Squadron)
 12  : Flottille 14 (14 Squadron, disbanded in 1991)
 13  : Flottille 17 (17 Squadron)

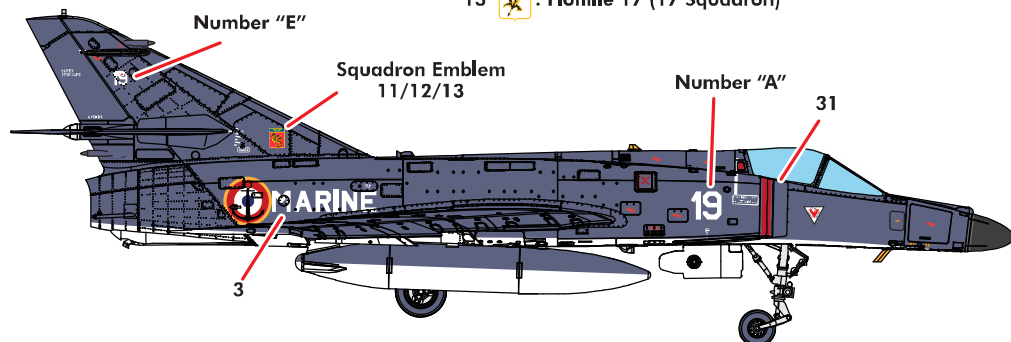

All markings are applied to both sides, except 1/3.

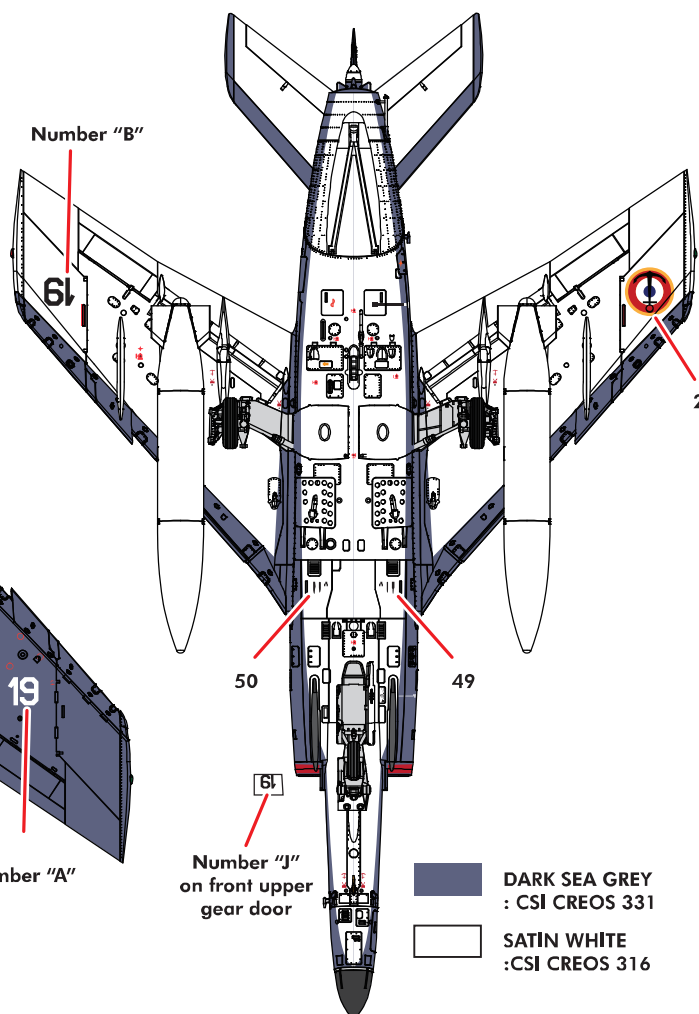
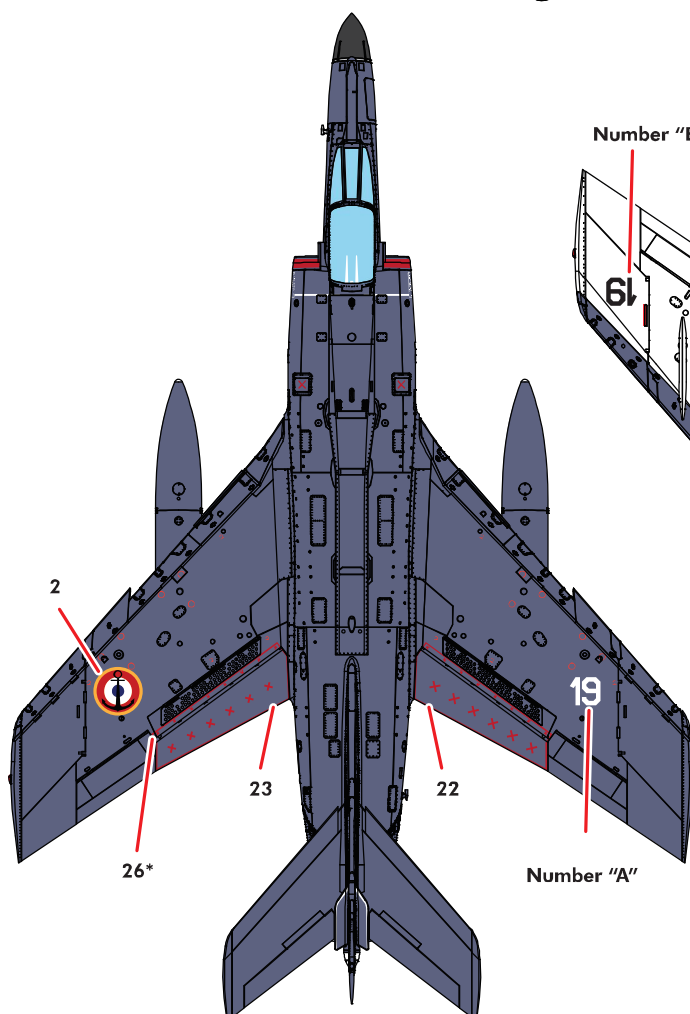
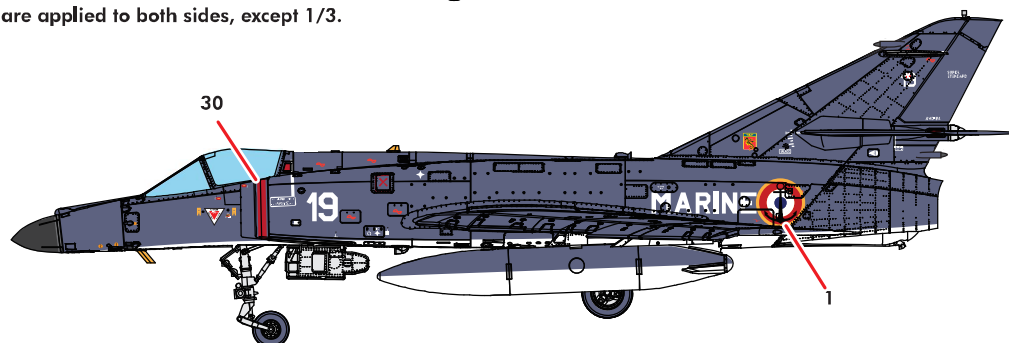

 DARK SEA GREY
 : CSI CREOS 331
 SATIN WHITE
 : CSI CREOS 316

1/48 SCALE AIRCRAFT SERIES NO. K48140

2. Super Étendard Modernisé , Aéronavale (French Naval Aviation), missions on Afghanistan, 2008.

15  : Flottille 11 (11 Squadron)

17  : Flottille 17 (17 Squadron)

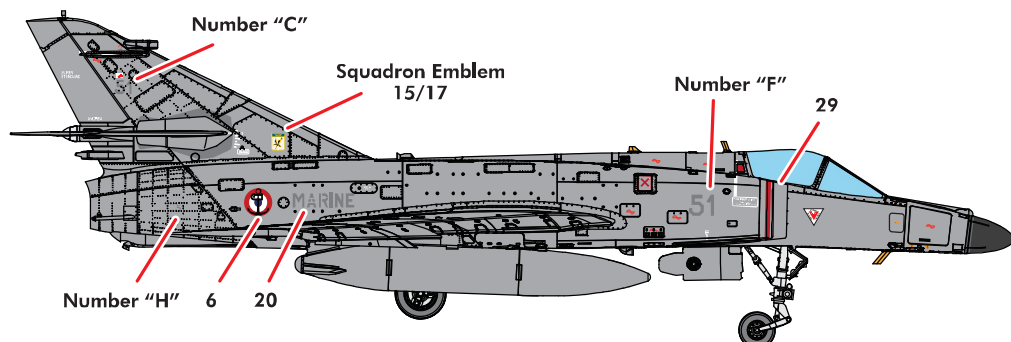

All markings are applied to both sides, except 28/29.

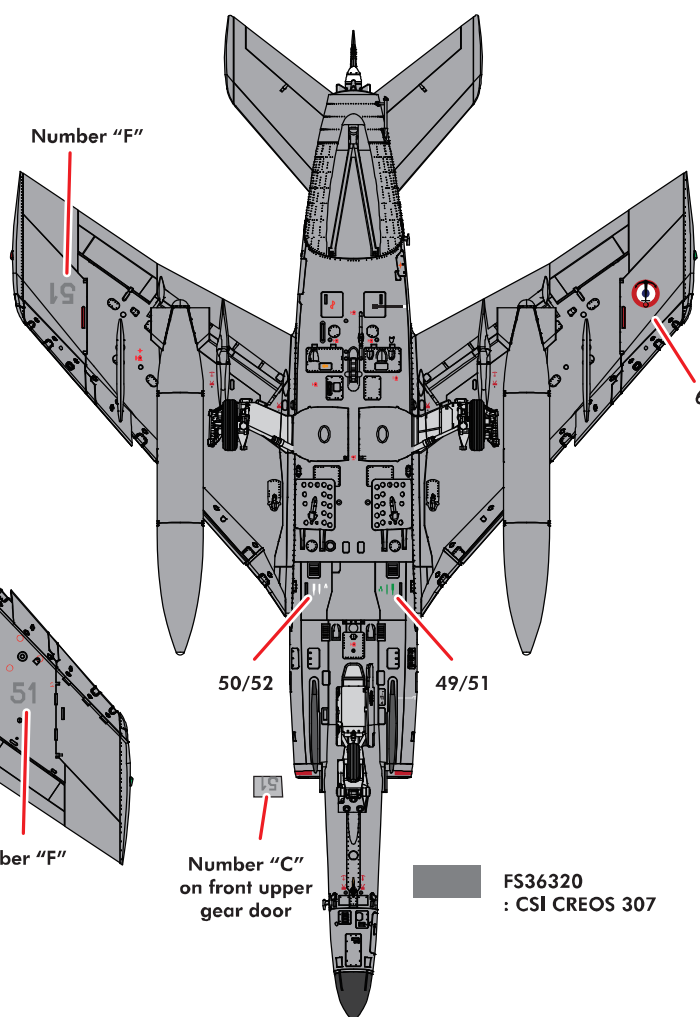
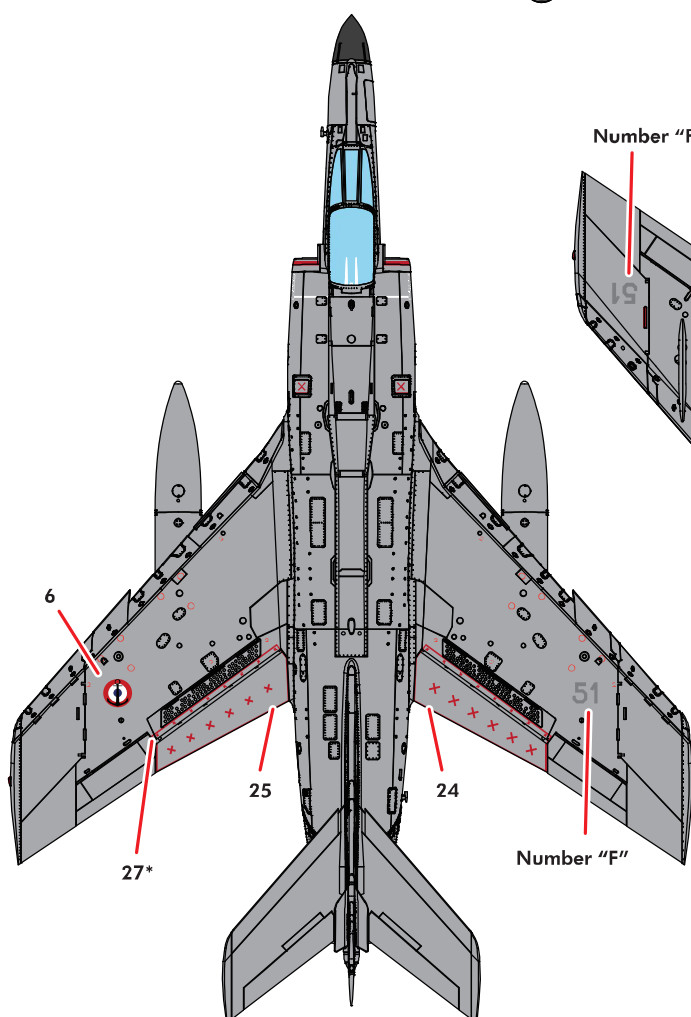
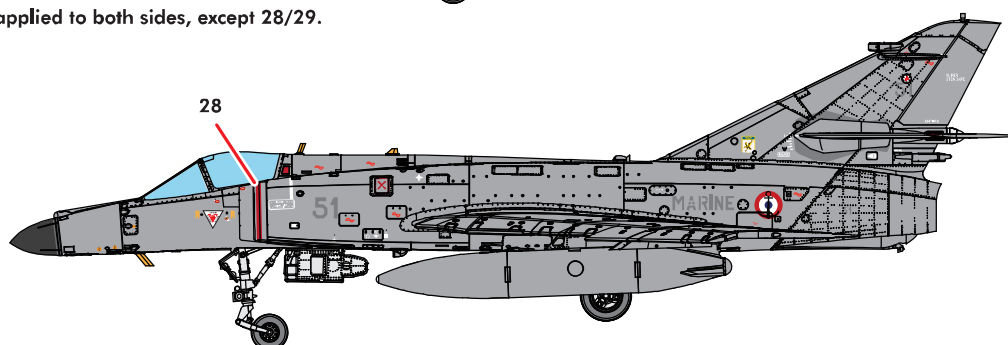

FS36320
: CSI CREOS 307

1/48 SCALE AIRCRAFT SERIES NO. K48140

3. Super Étendard Modernisé, Aéronavale (French Naval Aviation), missions on Libya, 2011.
 - SEM No. 10, 33, 37, 43, 44, 65 of 17F, aboard Charles de Gaulle, operated over Libya.

15  : Flottille 11 (11 Squadron)

17  : Flottille 17 (17 Squadron)

In 2011 nose emblems are applied to each aircraft, which was the coat of arms of French departments of the same INSEE code with aircraft's serial, as:
 No 10, Troyes, Aube - decal no. 7
 No 33, Bordeaux, Gironde - decal no. 8
 No 37, Tours, Indre-et-Loire - decal no. 9
 No 65, Tarbes, Hautes-Pyrénées - decal no. 10

