

Border



九七式艦上攻撃機

JASON 2023



NAKAJIMA B5N2 TYPE97 CARRIER ATTACK BOMBER(KATE) W/FULL INTERIOR

- FEATURES A REPLICATED FOLDABLE WING STRUCTURE.
- THE ENTIRE FUSELAGE IS DESIGNED WITH STRESSED SKIN AND ADDED RIVETS, PERFECTLY REPLICATING SURFACE DETAILS.
- INCLUDES VARIOUS OPTIONAL ACCESSORIES, SUCH AS ENGINE COVERS.
- FULL INTERIOR, INCLUDING THE ENGINE, COCKPIT, AND AMMUNITION STORAGE.
- COMPLETE SET OF DECALS, INCLUDING INTRICATE CHARACTERS AND DASHBOARD DECALS.
- INCLUDES HEAVY ARMOR-PIERCING BOMBS AND AVIATION TORPEDOES WITH WOODEN TAIL FINS.
- INCLUDES PE PARTS, SUCH AS PILOT SAFETY BELTS.

● READY TO ASSEMBLE PRECISION MODEL KIT ● MODELING SKILLS HELPFUL IF UNDER 14 YEARS OF AGE ● MODEL MAY VARY FROM IMAGE ON BOX ● CEMENT AND PAINT NOT INCLUDED

## History 历史介绍 | NAKAJIMA B5N2 TYPE97 CARRIER ATTACK BOMBER(KATE) W/FULL INTERIOR

九七舰攻前期型的实战皆在中国战场进行对地支援任务，改良后的三型首场实战即为1941年的偷袭珍珠港作战，此场战役中日军航空母舰共计派出了143架九七式三号舰攻（103架搭载炸弹，40架搭载鱼雷），并对当时停泊的美军舰队击中了36发鱼雷（美军资料23发），此战作战中损失了5台九七舰攻。

此后马来亚战役九七舰攻负担部分对地支援任务，珊瑚海海战时，日军三艘航舰（翔鹤、瑞鹤、祥凤）共搭载76架九七舰攻，扣除开战即被击沉的祥凤号搭载的12架，剩余的64架对美军舰队发动攻击，并成功的对列克星敦号航空母舰（CV-2）击中了2枚鱼雷迫使其重创自沉，但此场作战战斗损失了10架九七舰攻，而3艘航母皆受重创或击沉，其舰载机大多损失殆尽。

中途岛海战时，日军主力四艘航舰携带了93架九七舰攻，其中部分参与了空袭中途岛任务，飞龙号搭载的10架九七舰攻在日军航舰遭到击沉后对美军约克镇号航空母舰发动空袭，此场空袭中约克镇号遭到九七舰攻搭载的2枚鱼雷击中并重创倾斜，但所有的航舰搭载机皆在此战役中损失。瓜达尔卡纳尔岛战役时，除了双方制空权的争夺以外攻击机也负担了沉重的对地支援任务，此场战役中配备了70架以上的九七舰攻，但是到日军撤出时已经没有任何一架可以正常飞行。

在1944年后，九七舰攻的任务逐渐被天山舰载攻击机取代，但是因为天山的重量太重无法在小型航舰起降，因此九七舰攻仍然配发了18架在日军轻型航舰起降，因此九七舰攻仍然配发了18架在日军轻型航舰起降，除了特攻作战外九七舰攻另外装备了磁气探测器作为海上补给线护航用机。1937-38年，九七舰攻随第一航空战队（赤城号和加贺号航母）和第二航空战队（苍龙号和飞龙号航母）参与侵华战争。由于珍珠港水浅，九七舰攻进行雷击时，飞行高度下降到20米；水平轰炸也改为了5机编队，使用800公斤16英寸穿甲弹作为炸弹。1941年12月的珍珠港行动中，第一波攻击中89架九七舰攻，49架带炸弹进行水平轰炸，40架带鱼雷进行雷击，5架雷击机没有返航。第二波有54架水平轰炸机，全部返航。九七舰攻的浅水鱼雷和穿甲弹给太平洋舰队造成了毁灭性打击，亚历桑纳号的大爆炸就是由穿甲弹在舱内爆炸引起的。战地指挥官渊田美津雄的九七舰攻第一个进入珍珠港，最后一个飞离珍珠港。其后第一、二、五航空战队的99舰爆、九七舰攻在零战的配合下，在太平洋中统治了6个月的时间，袭击的目标有拉包尔港、达尔文港等。还包括1942年4月，在印度洋击沉英海军航母竞技神号，5月岛系列以及圣克鲁斯海空战使日本海军失去了大量的飞行员。而后随美国新型战斗机的出现，零式战斗机已不能为九七舰攻提供充足的护航，并且美军的防空能力日益提高，1943年中，能够突防投弹的九七舰攻已为数不多。无装甲的九七舰攻很容易被盟军击落，及至1944年末到1945年初，速度较低的九七舰攻已属过时，其后生产的九七舰攻也多被改装成神风飞机。

The early combat deployments of the Type 97 carrier attack bombers were all conducted on the Chinese battlefield for ground support missions. The improved Model 3 first saw combat during the 1941 attack on Pearl Harbor, where the Japanese aircraft carriers launched a total of 143 Type 97 Model 3s (103 with bombs, 40 with torpedoes), hitting the moored U.S. fleet with 36 torpedoes (23 according to U.S. records). The Japanese lost 5 Type 97s in this battle.

Thereafter, during the Malayan Campaign, the Type 97s took on some ground support tasks. In the Battle of the Coral Sea, the Japanese deployed 76 Type 97s on three carriers (Shokaku, Zuikaku, Shoho). Excluding the 12 lost when Shoho was sunk at the start of the conflict, the remaining 64 launched an attack on the U.S. fleet, successfully hitting the aircraft carrier USS Lexington (CV-2) with 2 torpedoes, forcing it to sink due to severe damage. However, this battle saw the loss of 10 Type 97s, and all three carriers were either heavily damaged or sunk, with most of their aircraft lost.

At the Battle of Midway, the Japanese main fleet carried 93 Type 97s, some of which participated in the air raid on Midway Island. After the Japanese carriers were sunk, the 10 Type 97s from the carrier Hiryu launched an air raid on the USS Yorktown, hitting it with 2 torpedoes and causing severe damage and a list. However, all carrier-based aircraft were lost in this campaign. During the Battle of Guadalcanal, aside from the fight for air supremacy, attack planes also undertook heavy ground support tasks. More than 70 Type 97s were equipped, but by the time the Japanese withdrew, not a single one was able to fly normally.

After 1944, the role of the Type 97s was gradually replaced by the Tenzan carrier attack planes, but since the Tenzan was too heavy to operate from smaller carriers, 18 Type 97s were still deployed on Japanese light carriers. Besides kamikaze missions, the Type 97s were additionally equipped with magnetic anomaly detectors for escorting sea supply lines. From 1937-38, the Type 97s, with the First Air Fleet (carriers Akagi and Kaga) and the Second Air Fleet (carriers Soryu and Hiryu), participated in the war against China. Due to the shallow waters of Pearl Harbor, the Type 97s lowered their attack altitude to 20 meters during torpedo runs; horizontal bombing was also conducted in groups of five using 800 kg (16-inch) armor-piercing shells as bombs. In the Pearl Harbor operation of December 1941, the first wave of 89 Type 97s, with 49 carrying bombs for horizontal bombing and 40 carrying torpedoes for torpedo attacks, resulted in 5 torpedo bombers not returning. The second wave consisted of 54 horizontal bombers, all of which returned. The Type 97's shallow-water torpedoes and armor-piercing bombs inflicted devastating damage on the Pacific Fleet, with the explosion on the USS Arizona caused by an armor-piercing shell detonating within. The commander of the battlefield, Mitsuo Fuchida's Type 97, was the first to enter Pearl Harbor and the last to leave. Subsequently, the First, Second, and Fifth Air Fleets' Type 99 bombers and Type 97 attack bombers, with the coordination of the Zero fighters, dominated the Pacific for six months, targeting places like Rabaul and Darwin. This included sinking the British aircraft carrier HMS Hermes in the Indian Ocean in April 1942 and the American aircraft carrier USS Lexington in May at the Coral Sea.

In the Battle of Midway in June 1942, Japanese commander Chuichi Nagumo wavered between equipping the Type 97s with bombs for attacking the airfield or torpedoes for striking ships, a hesitation that contributed to Japan's defeat at Midway. The subsequent battles at Guadalcanal, the Santa Cruz Islands, and others led to the loss of many Japanese pilots. With the emergence of new American fighters, the Zero could no longer provide sufficient escort for the Type 97s, and American air defense capabilities were improving. By mid-1943, only a few Type 97s were able to penetrate defenses and drop bombs. With no armor, the Type 97 was easily shot down by Allied forces, and by the end of 1944 to the beginning of 1945, the slower Type 97 had become obsolete. The Type 97s produced later were mostly modified into kamikaze aircraft.

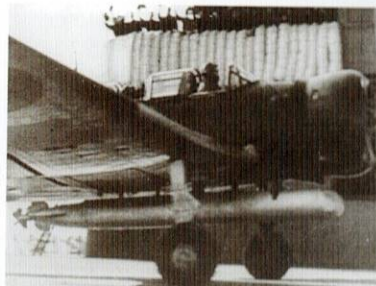
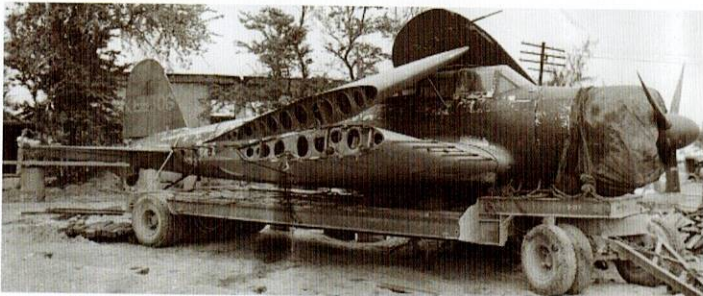

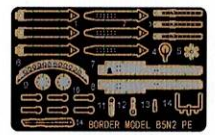
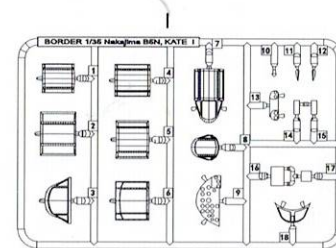
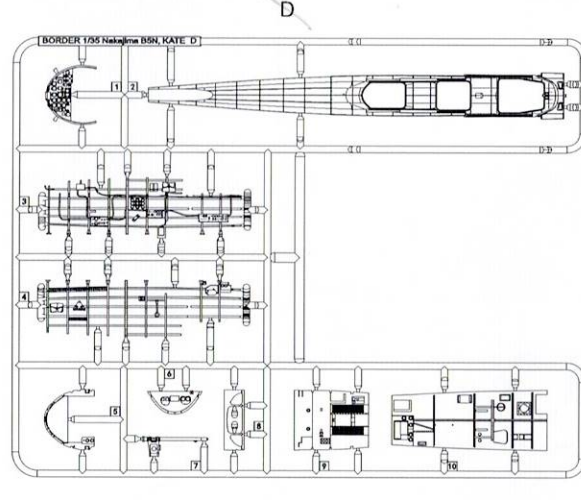
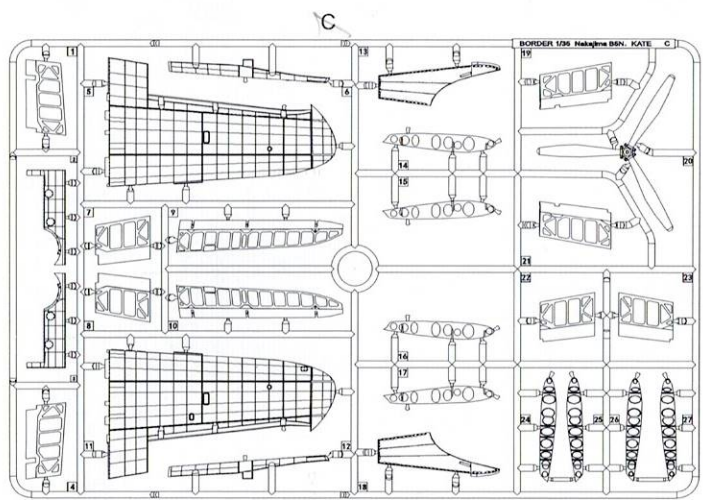
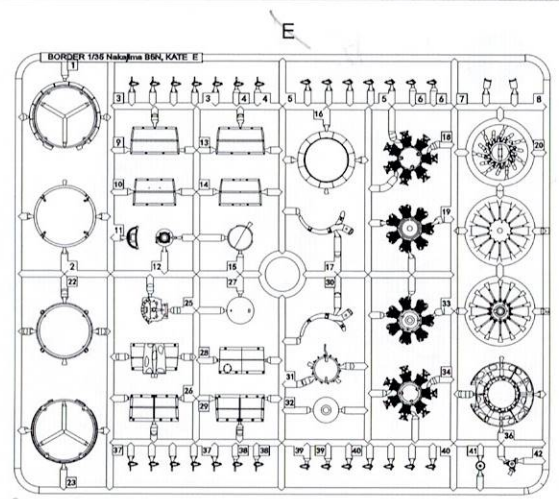
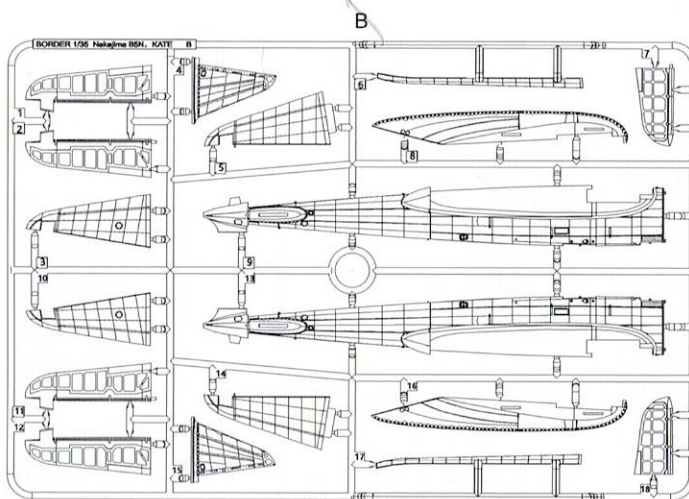
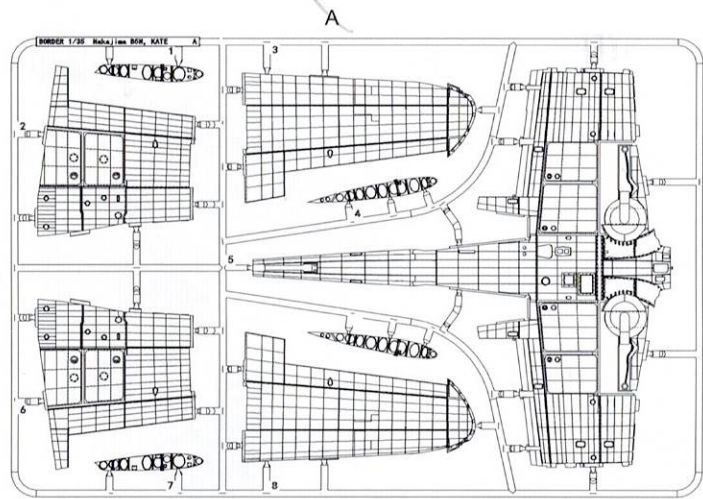

PE

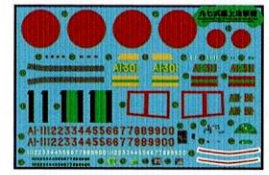
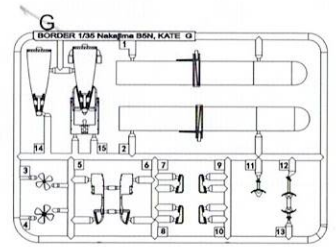

DECAL

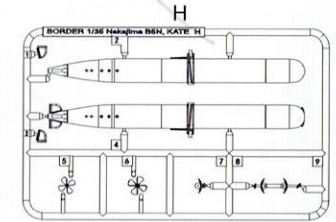
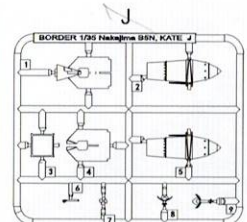
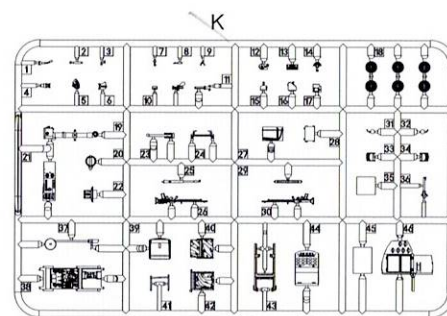
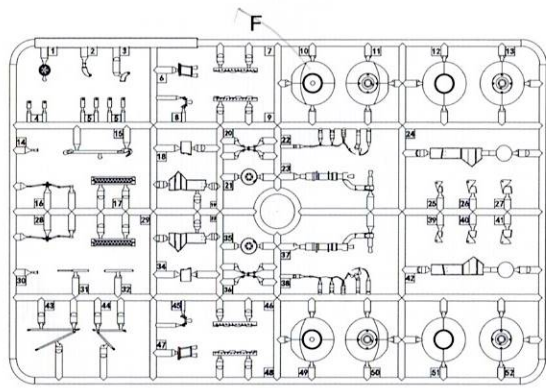

1

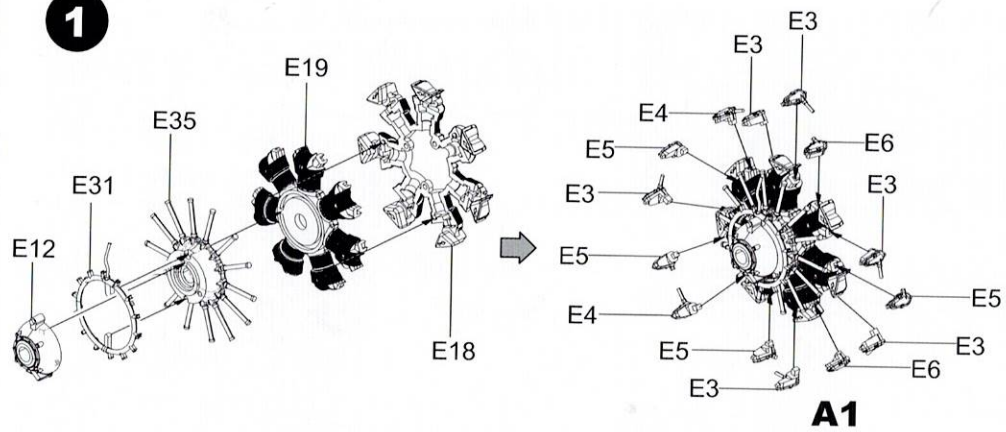

2

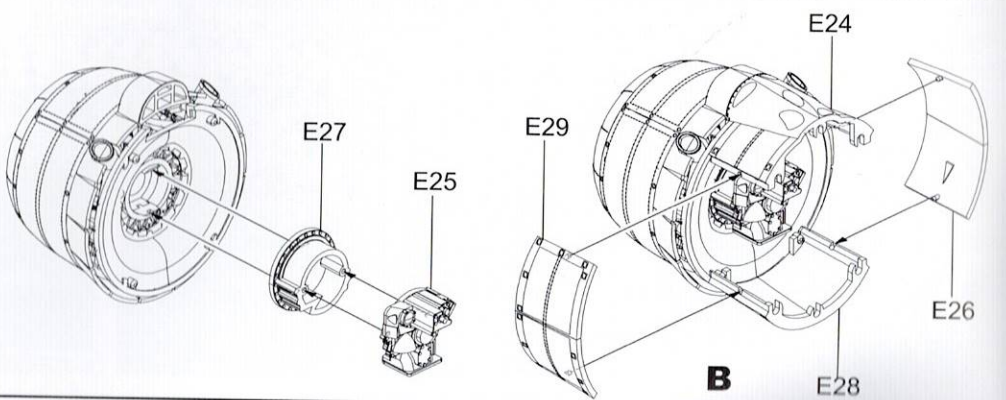
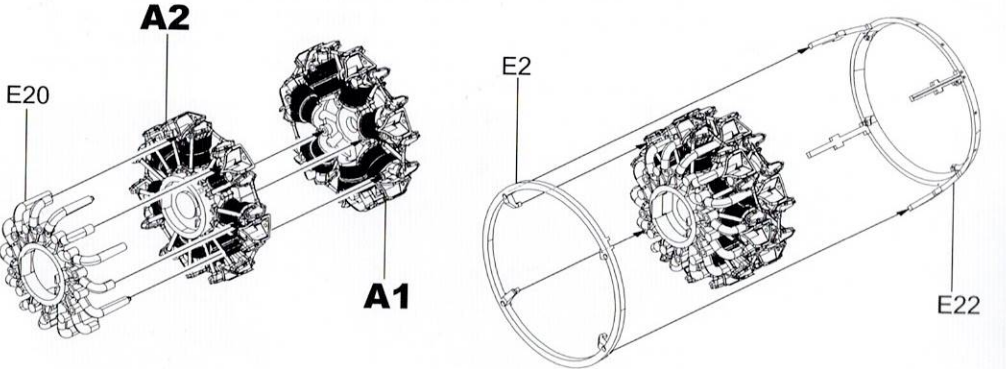
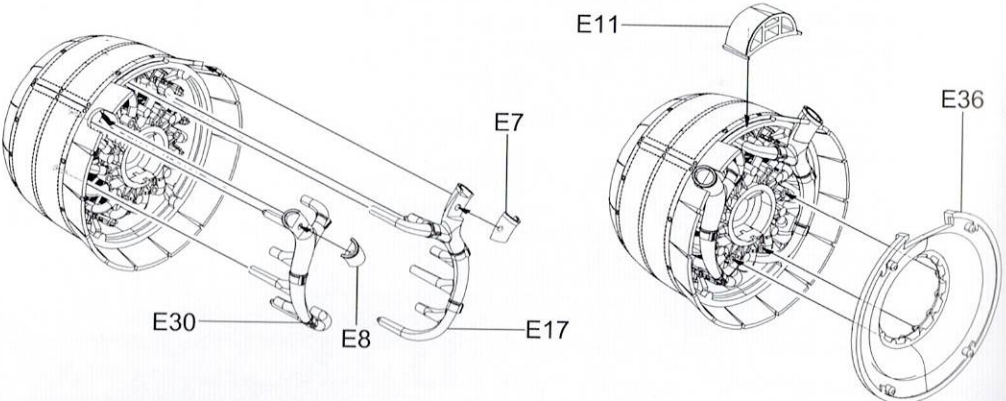
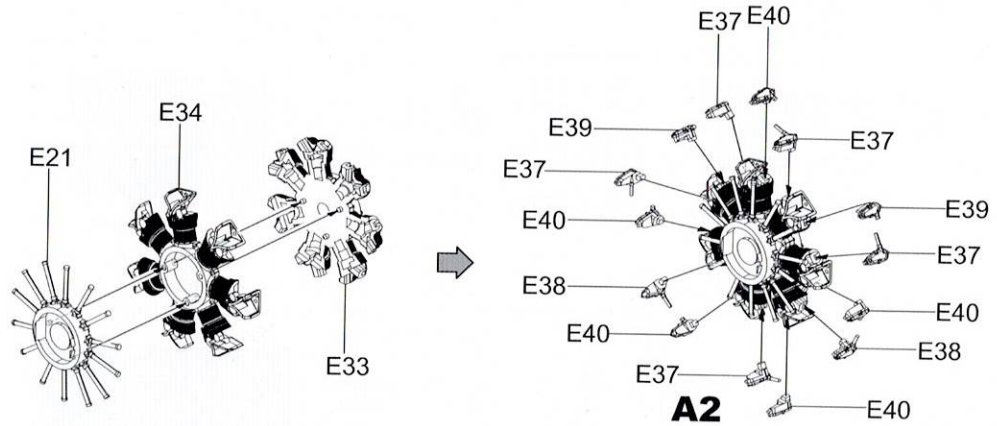
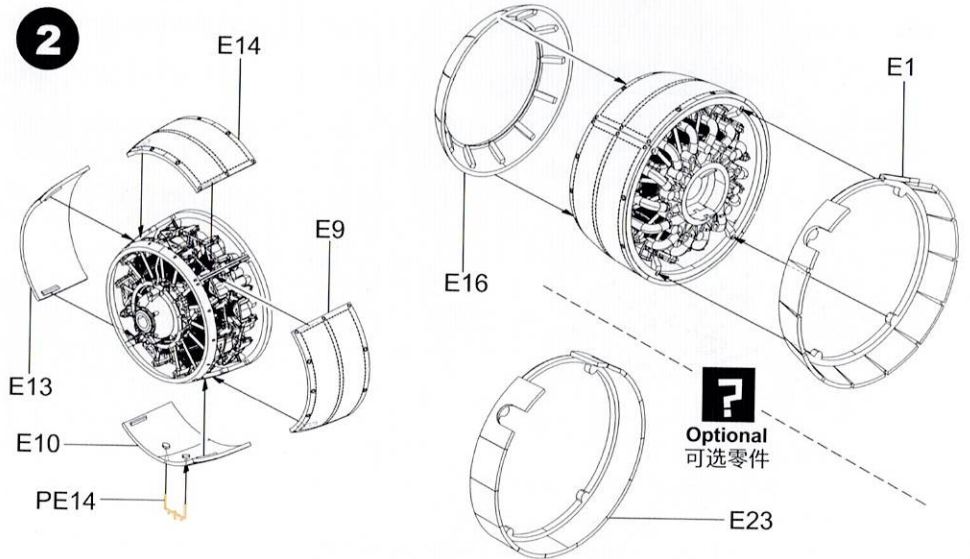

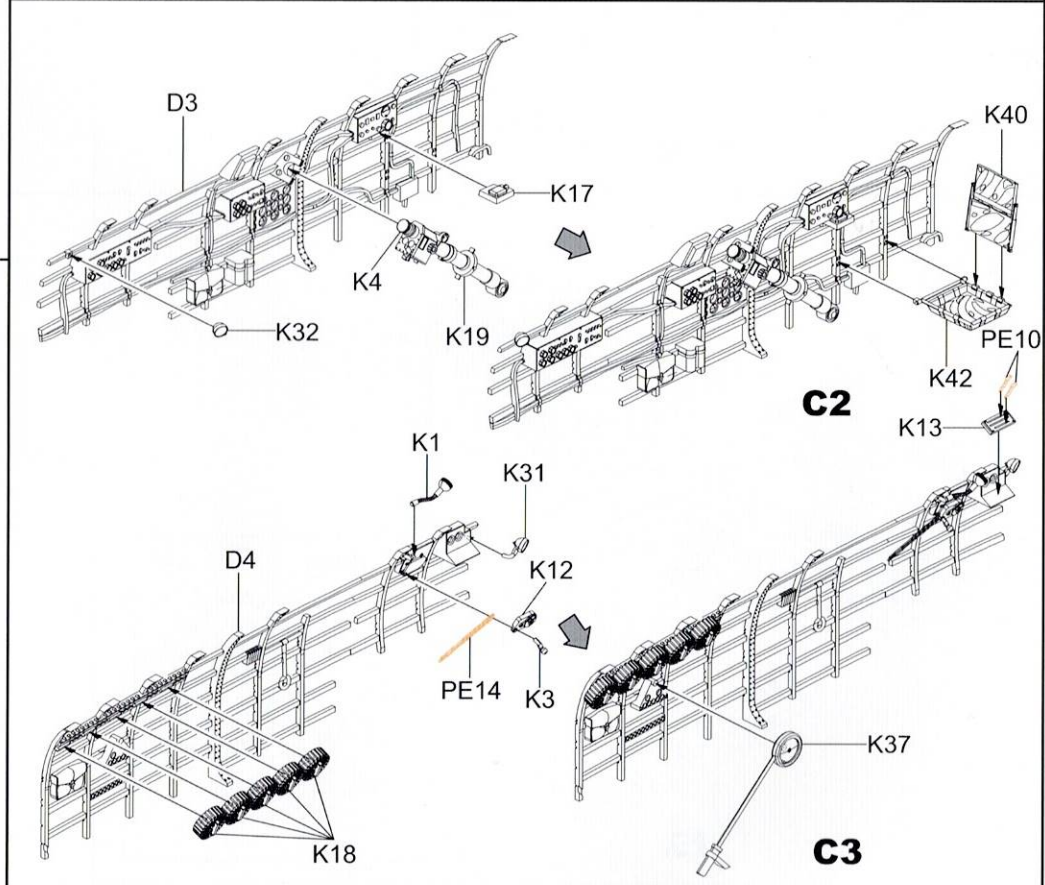
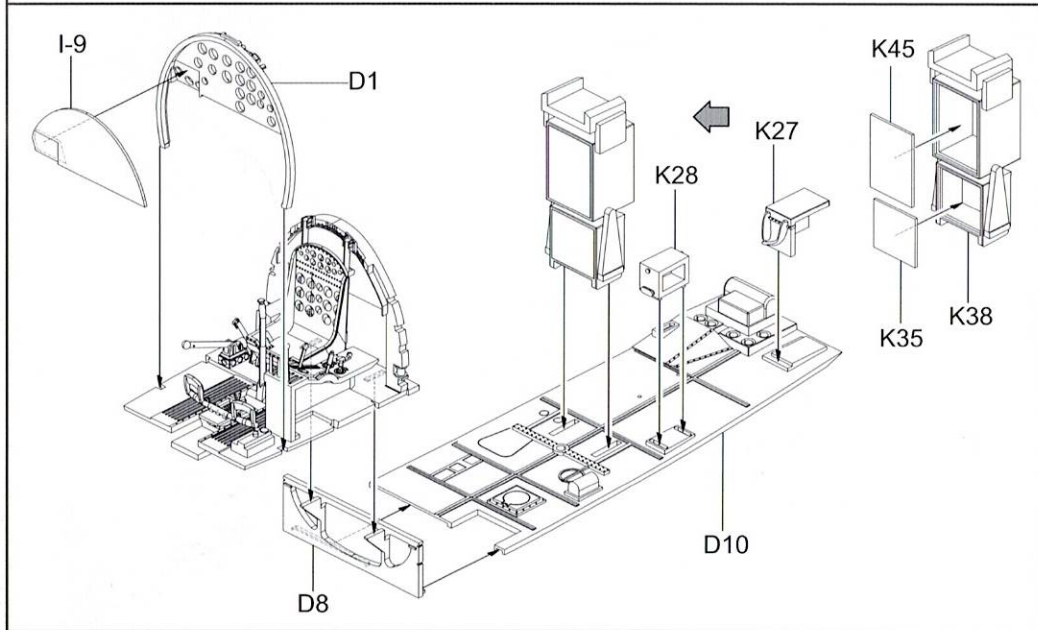
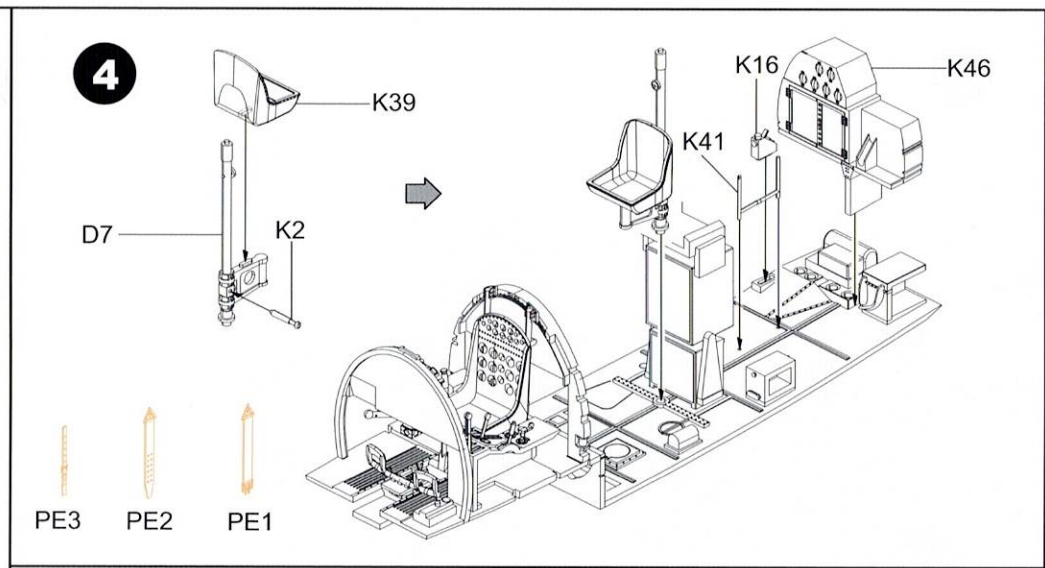
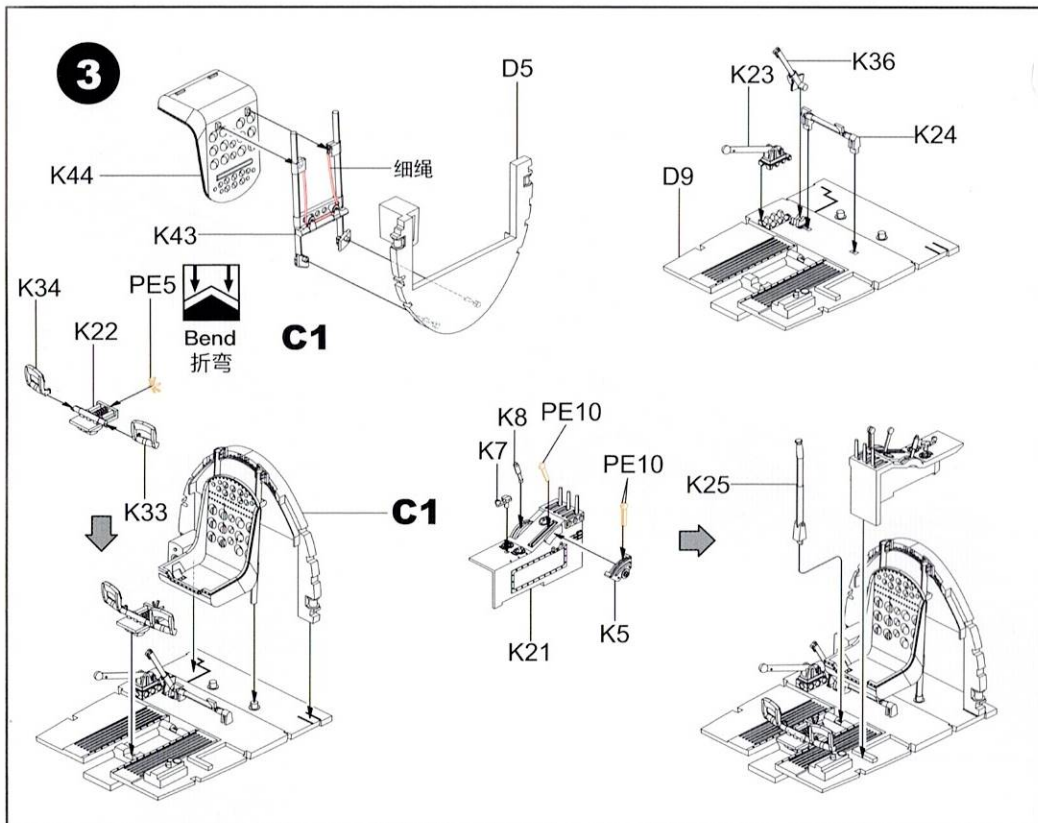

5

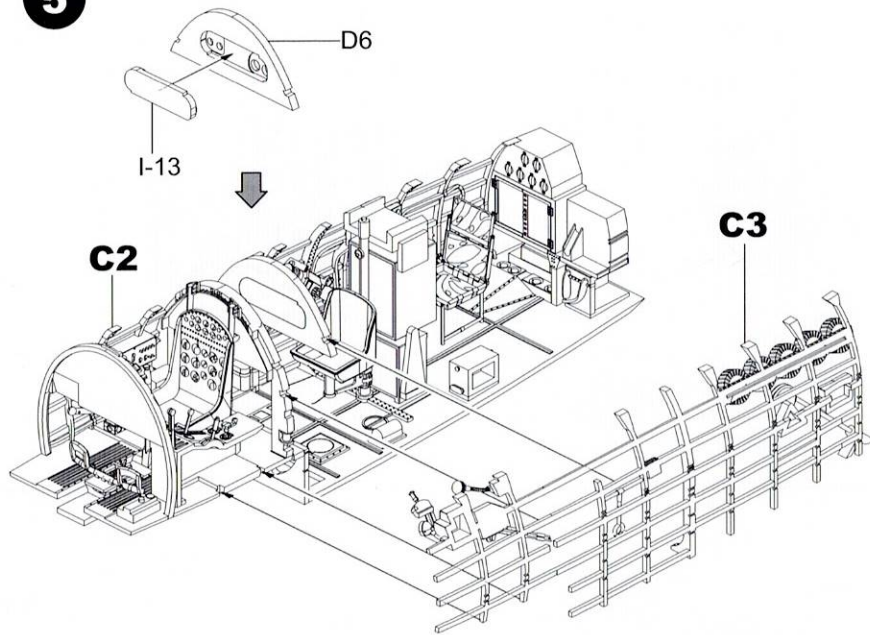

6

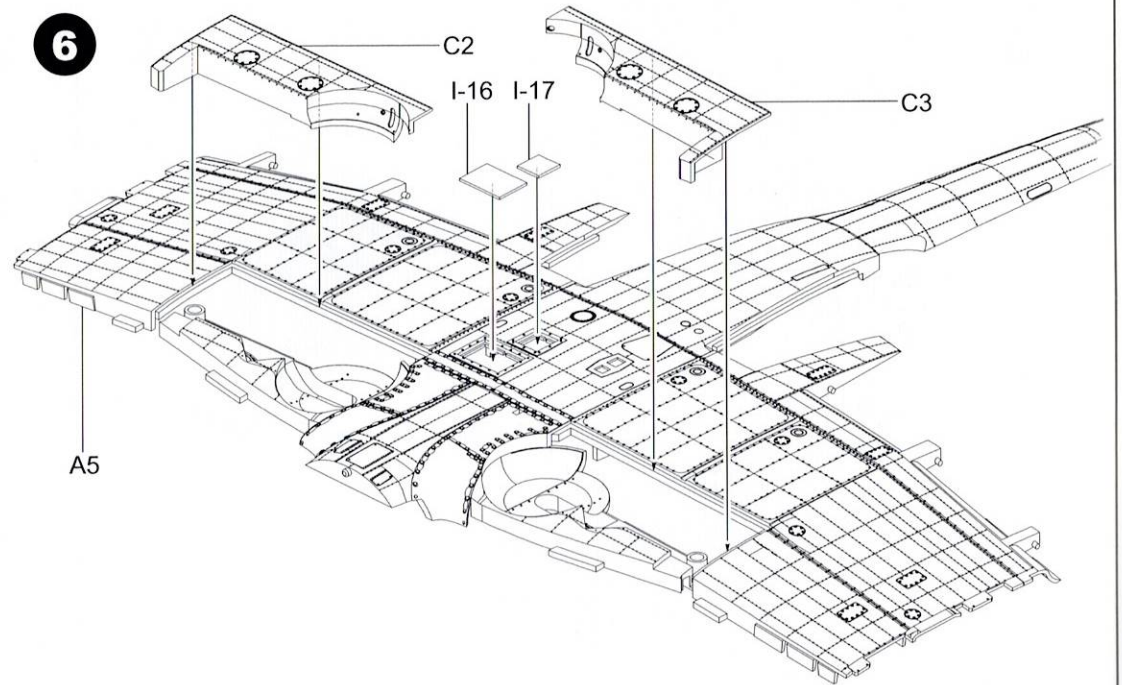

PE8

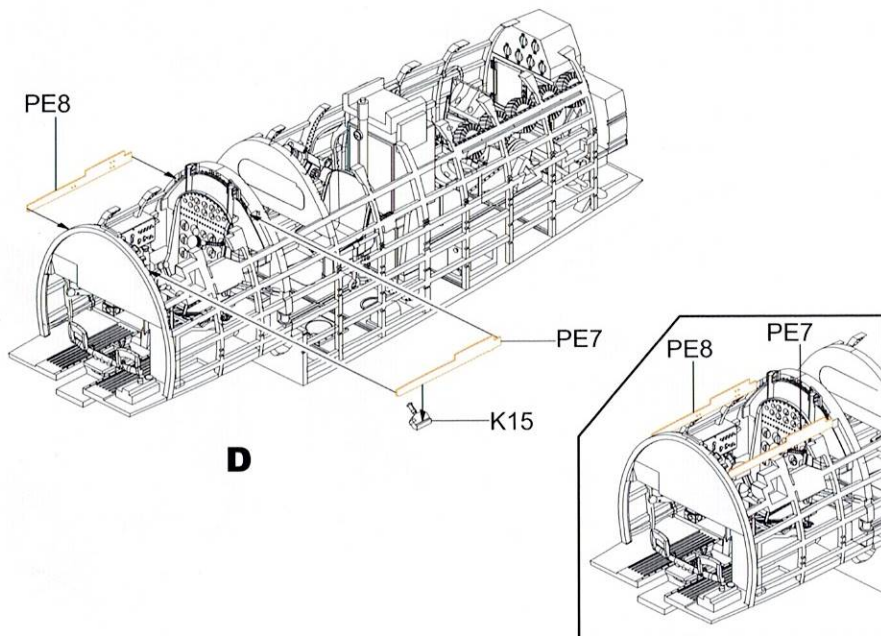

D

孔1

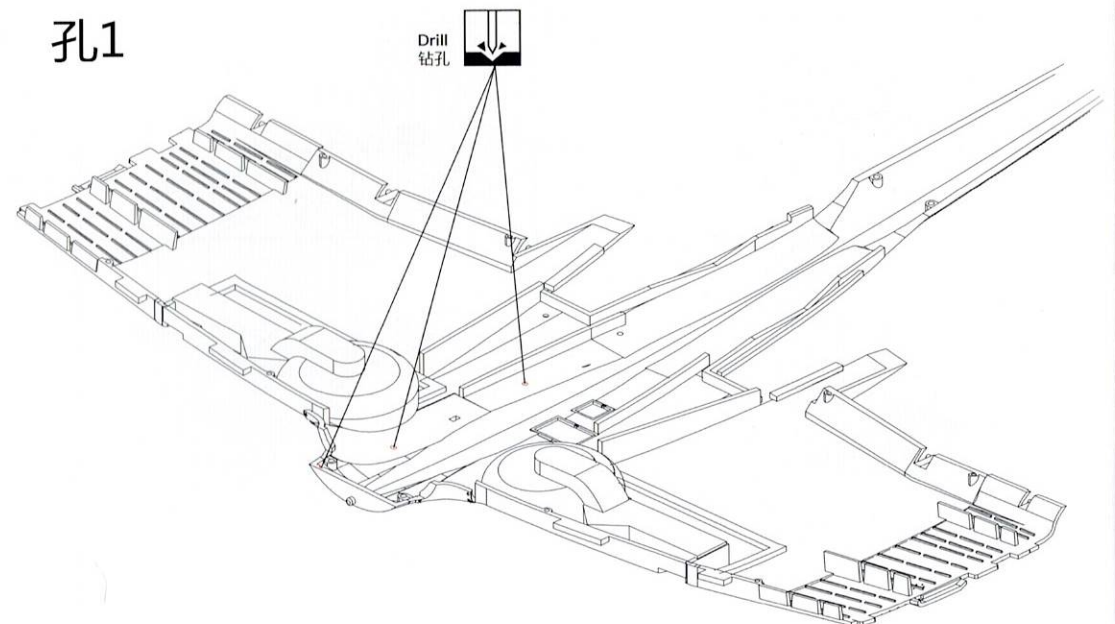

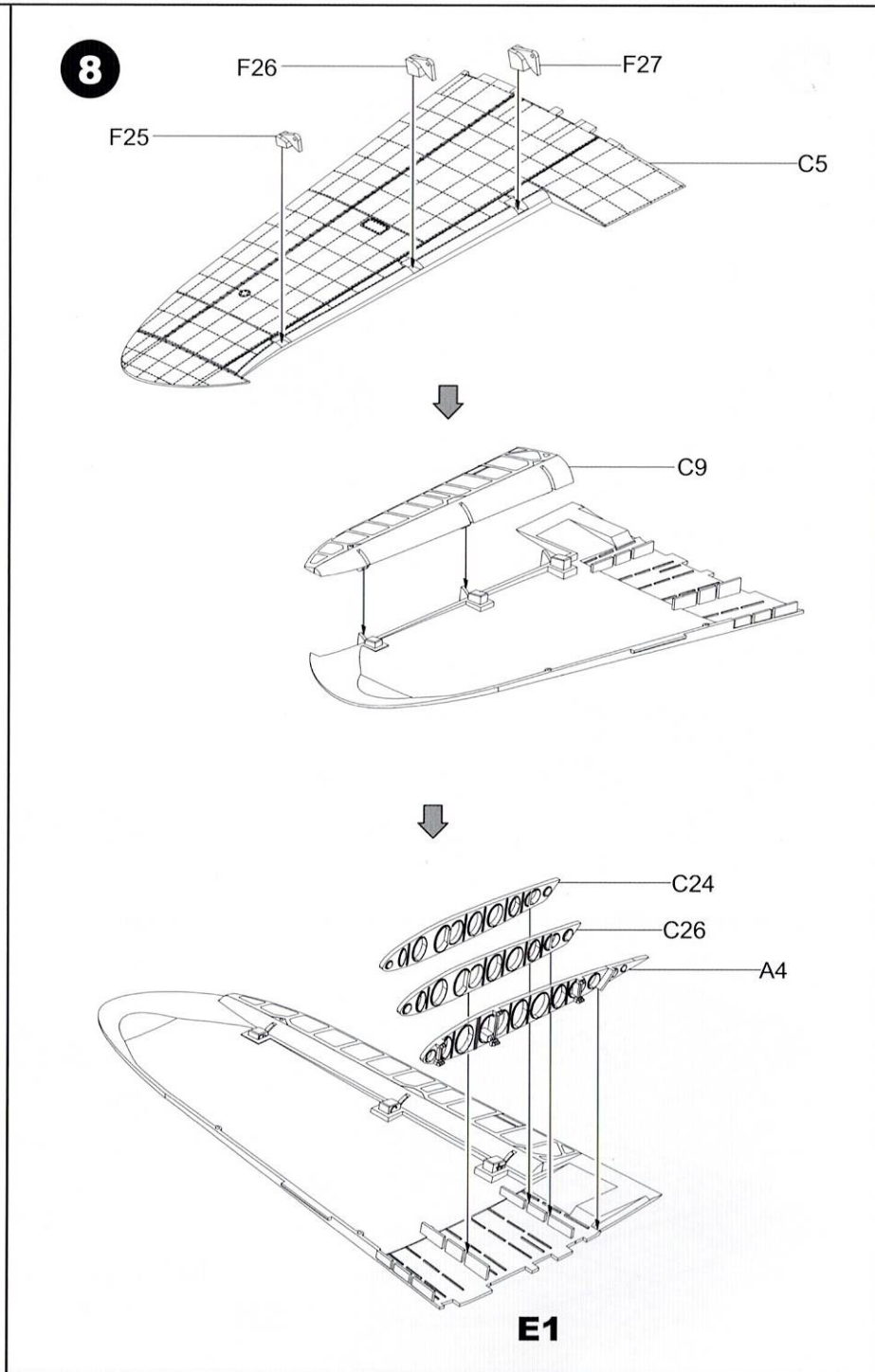
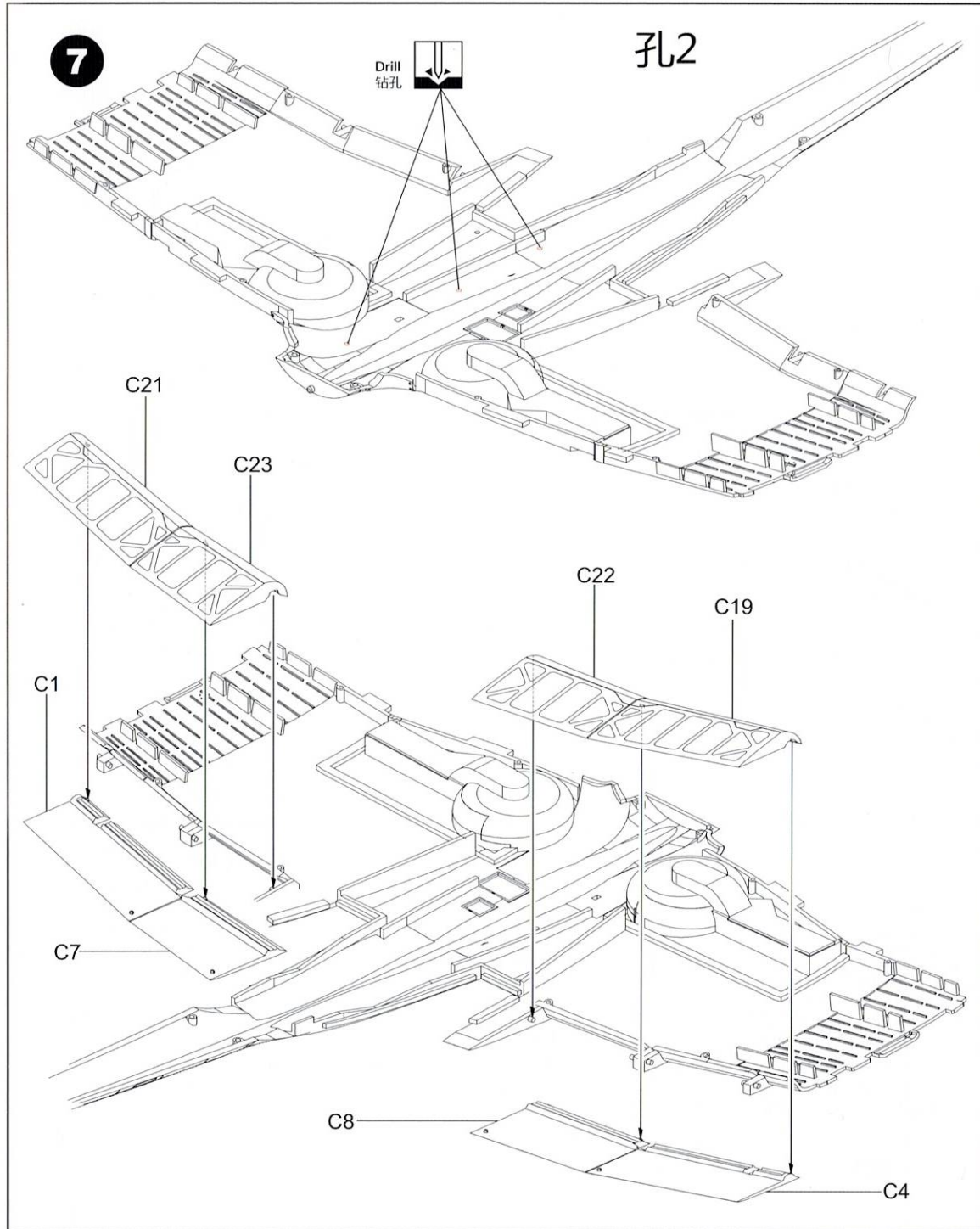

9

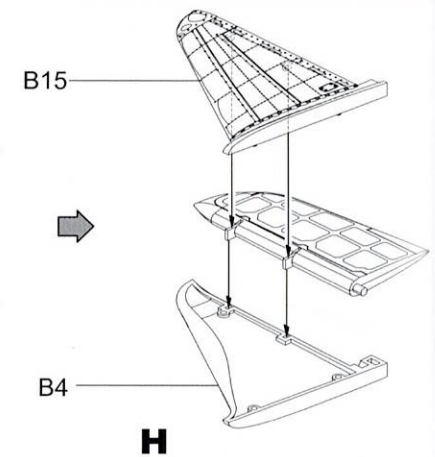
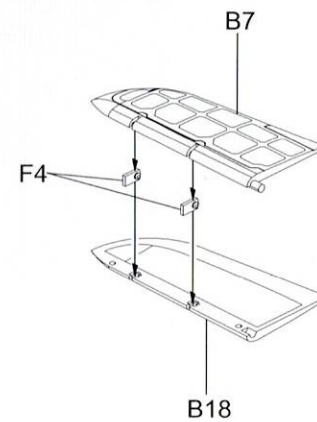
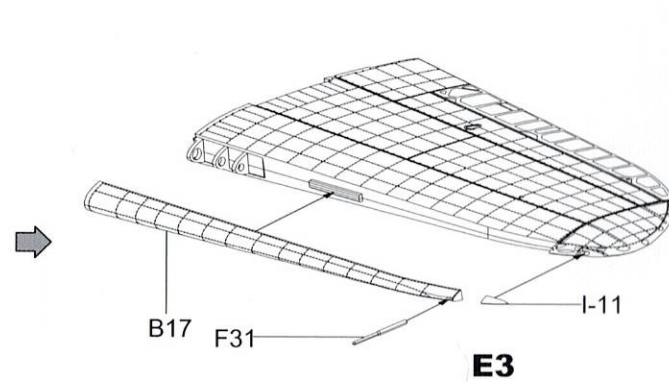
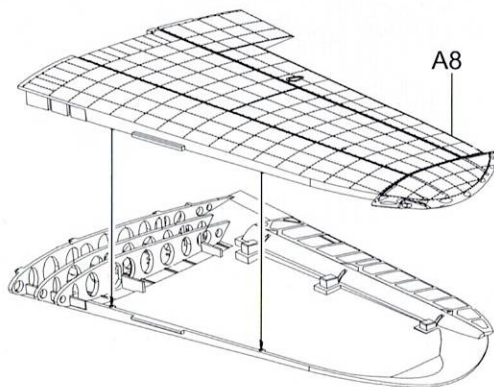
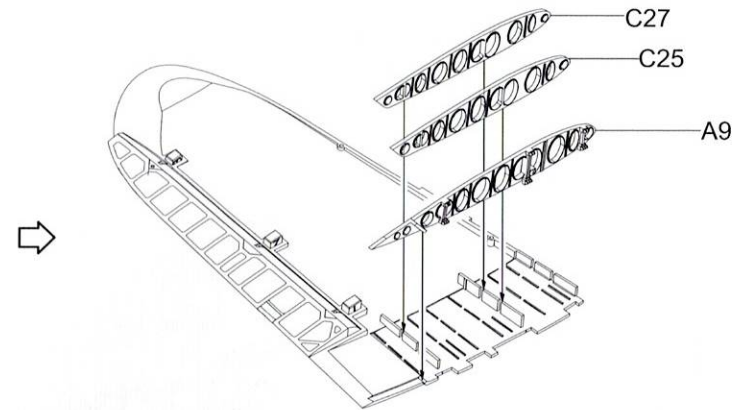
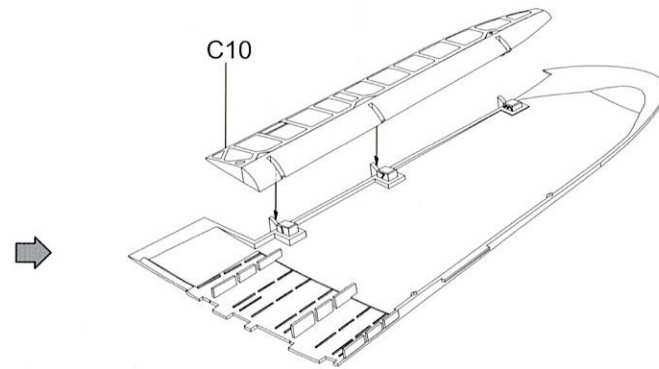
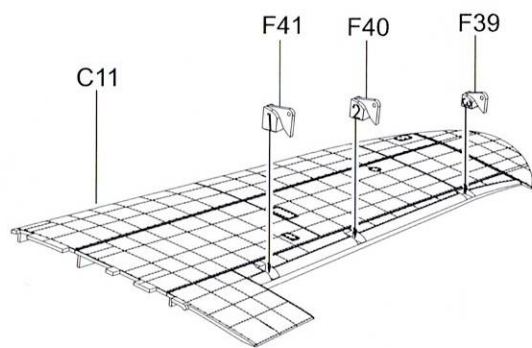
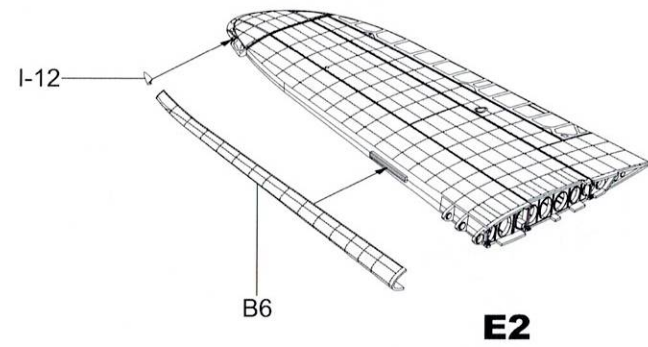
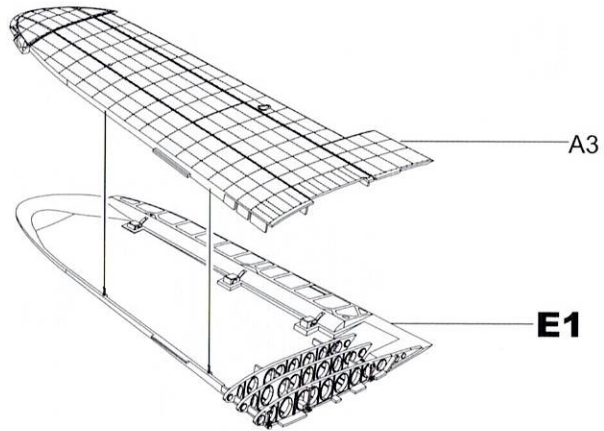

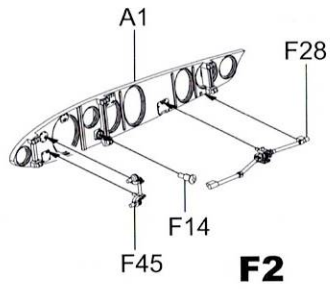
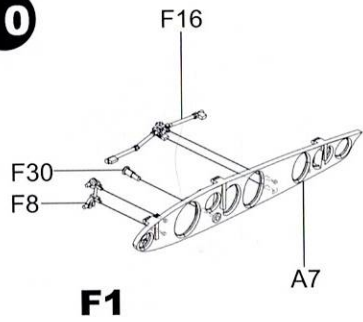
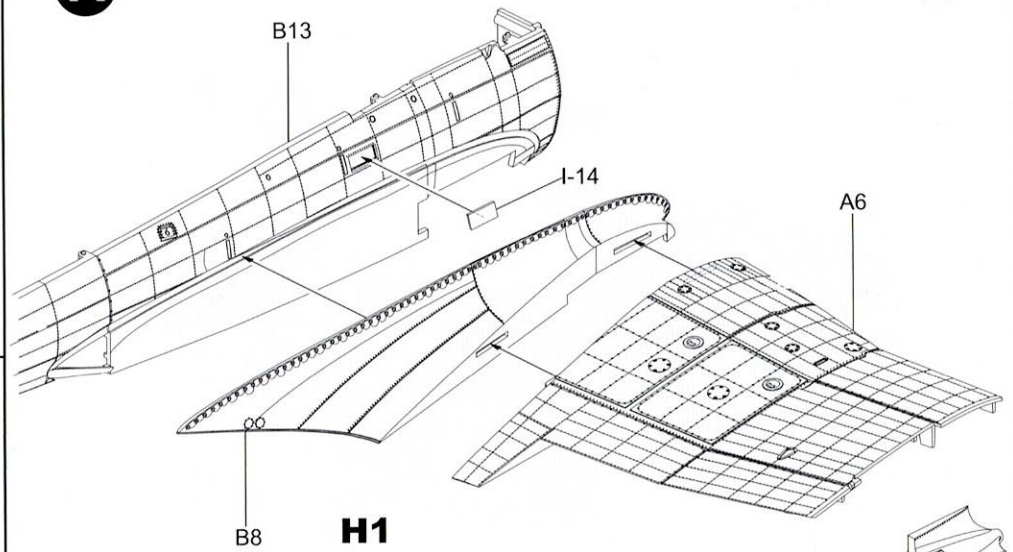
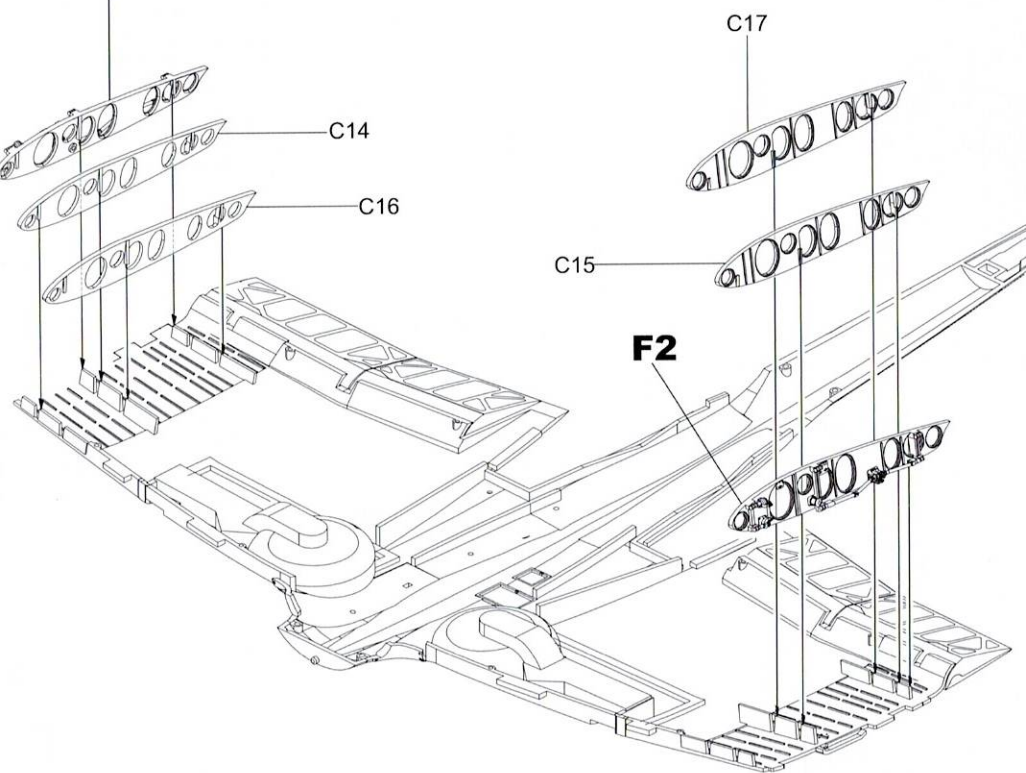
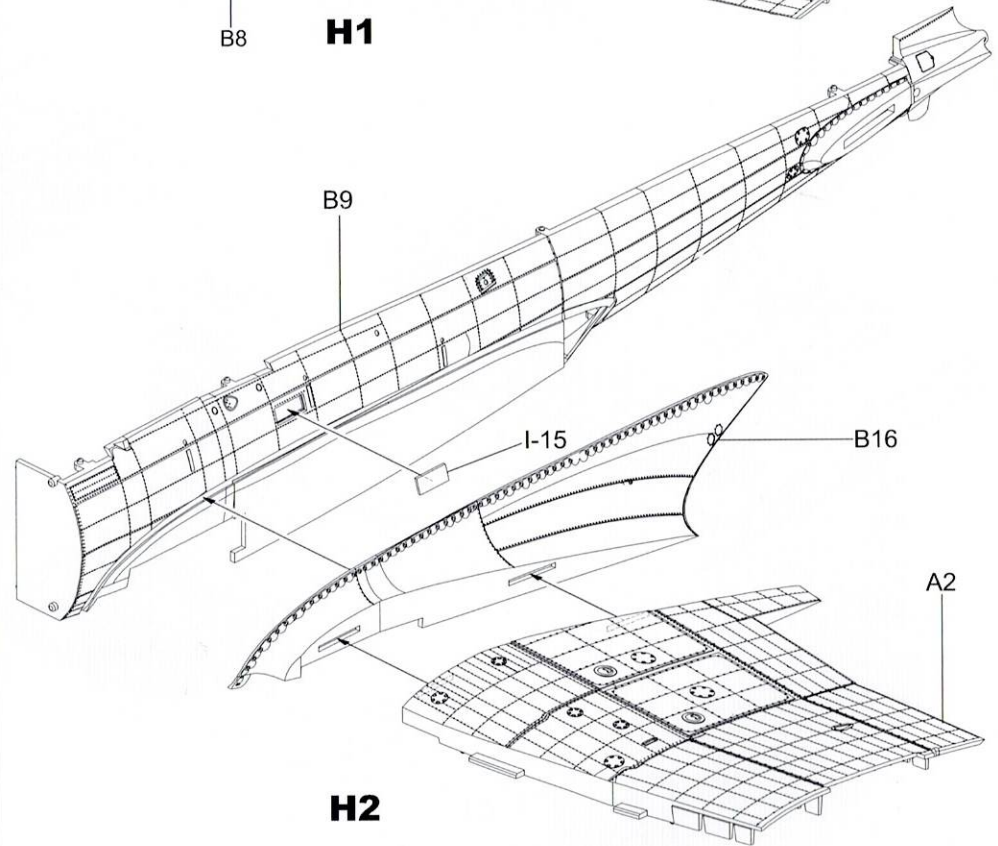

**10****11****F1****H1****H2**

12

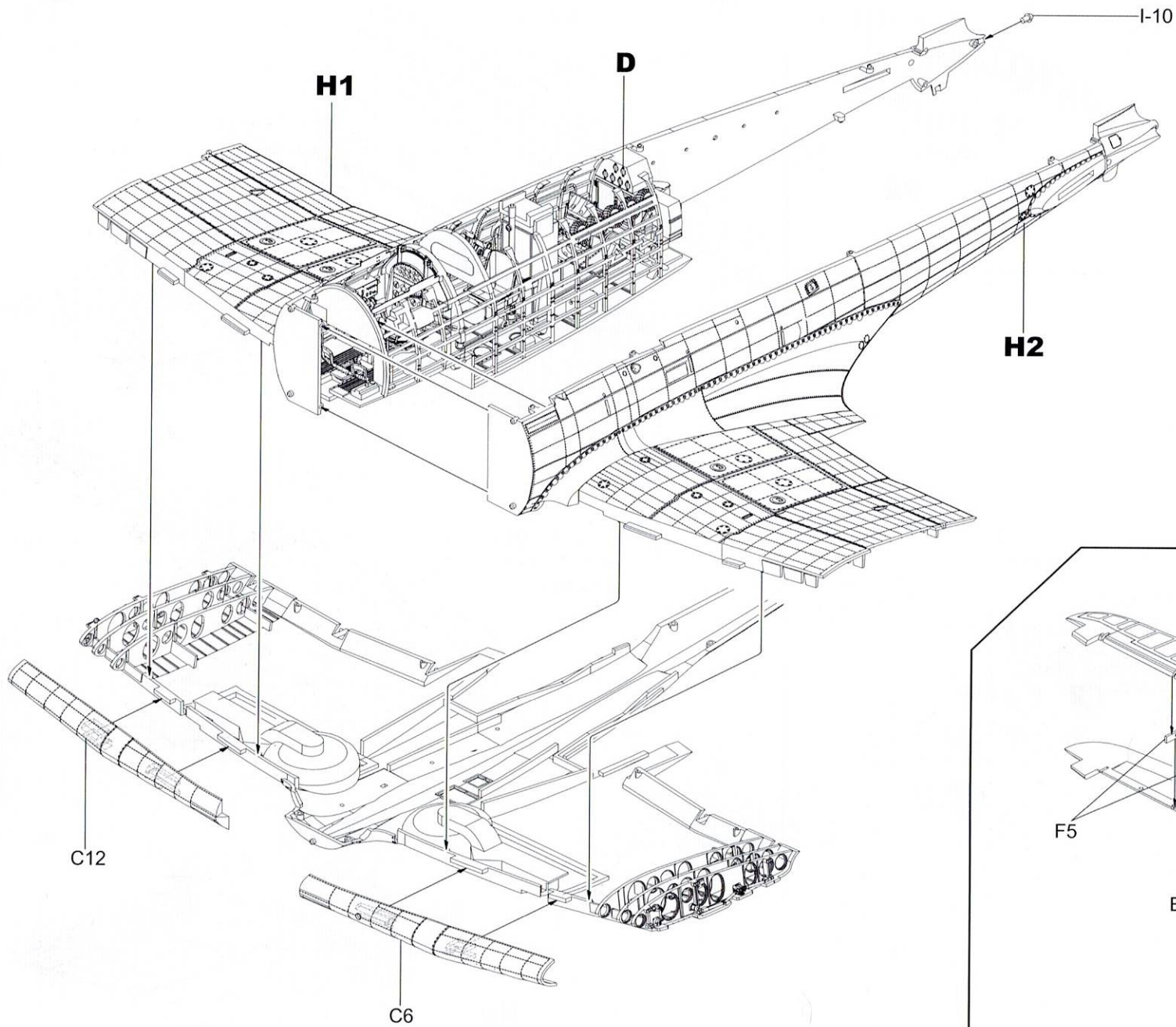

13

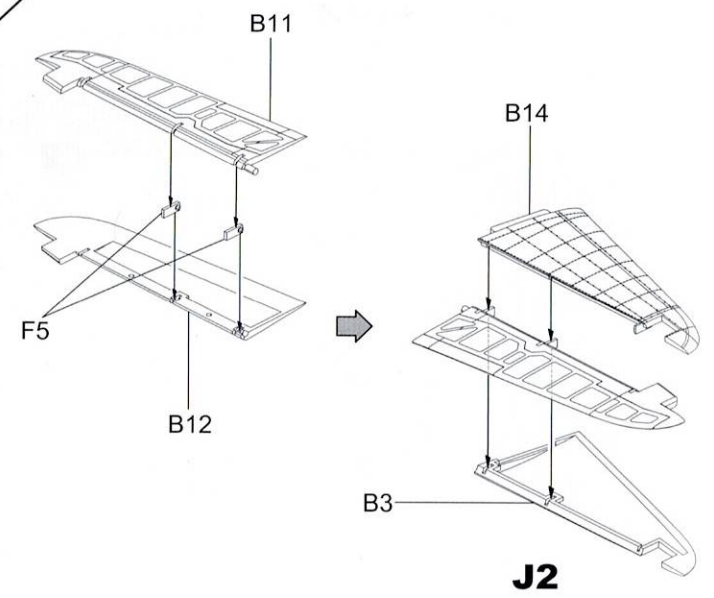
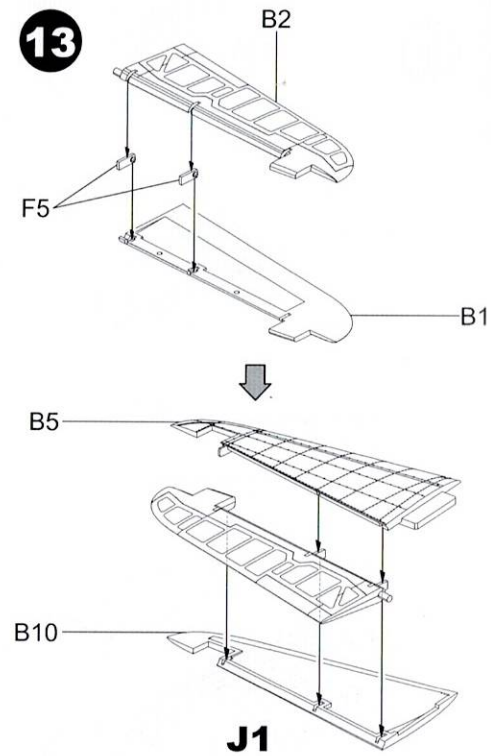

14

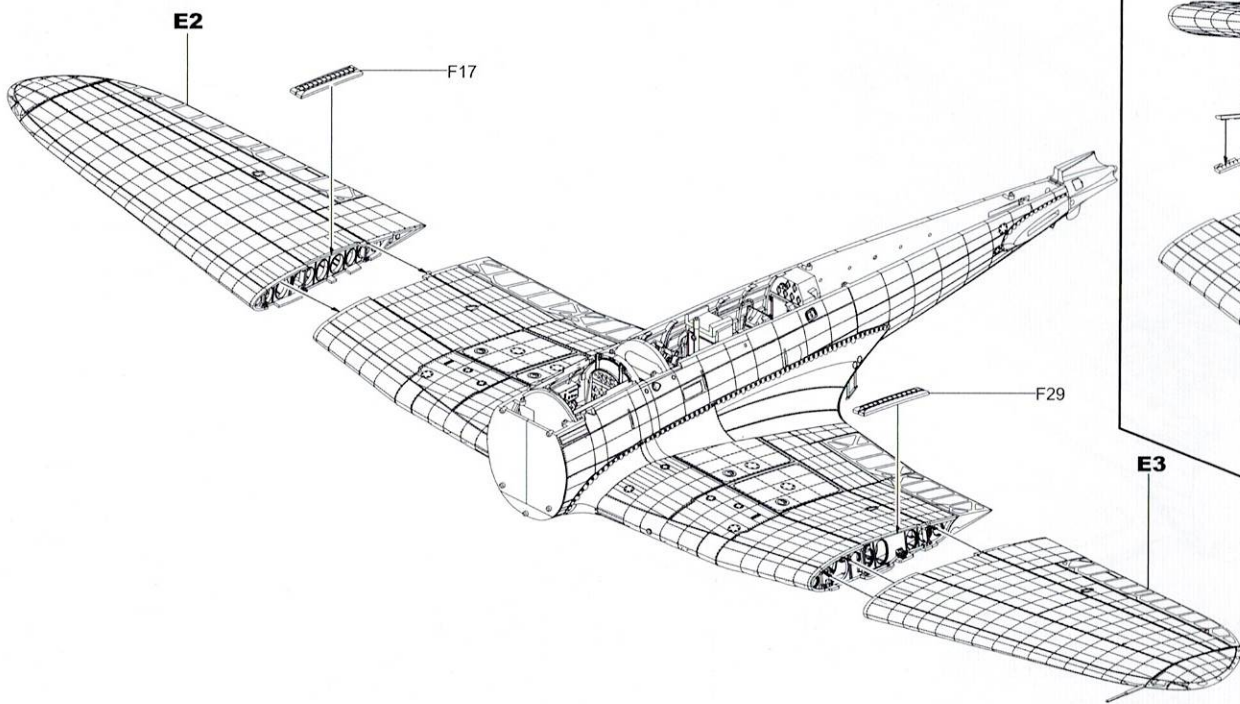

15

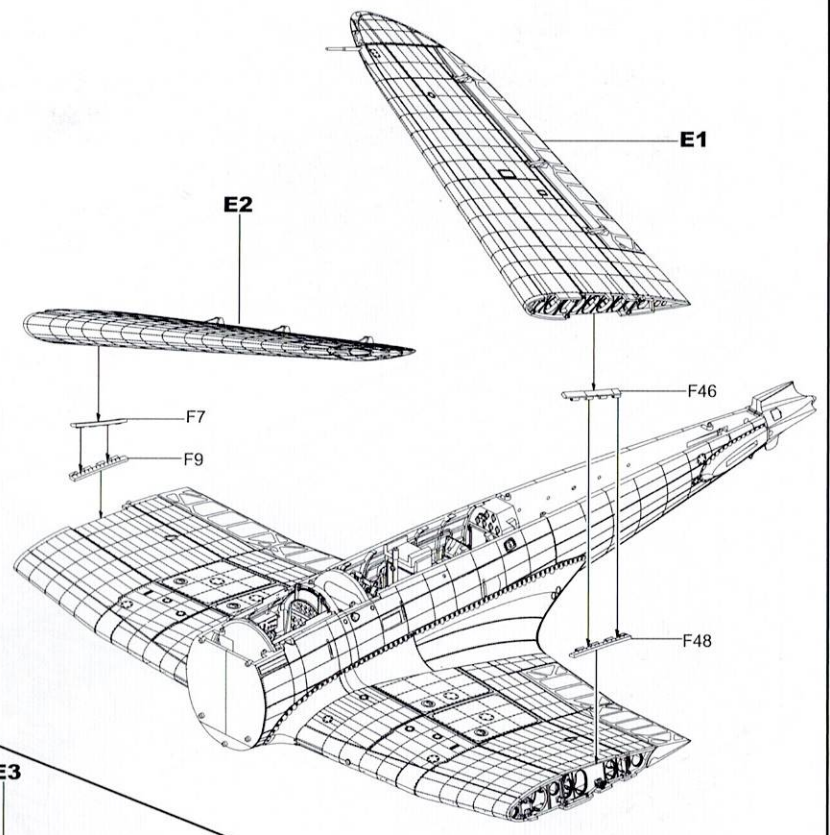

16

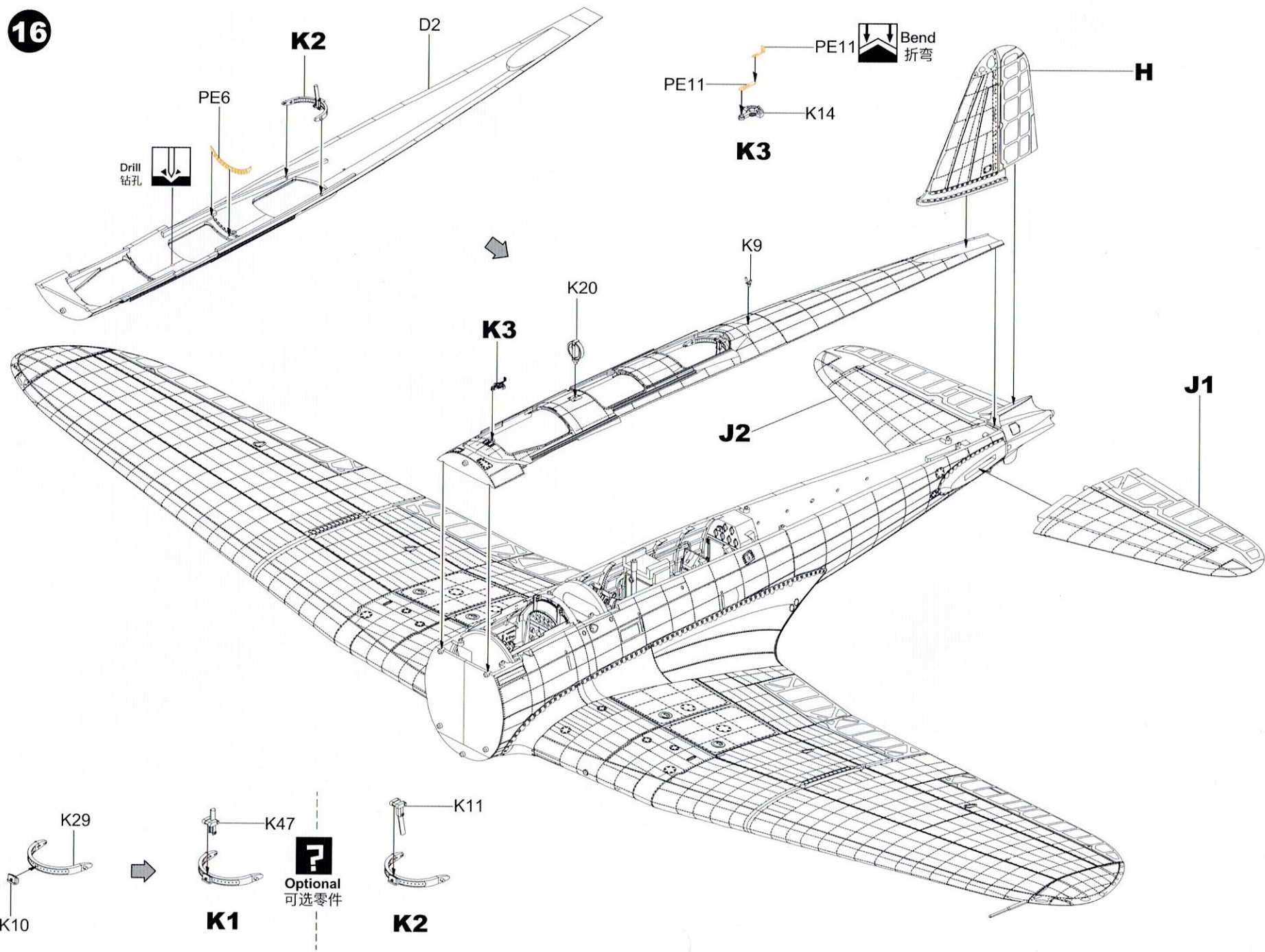

17

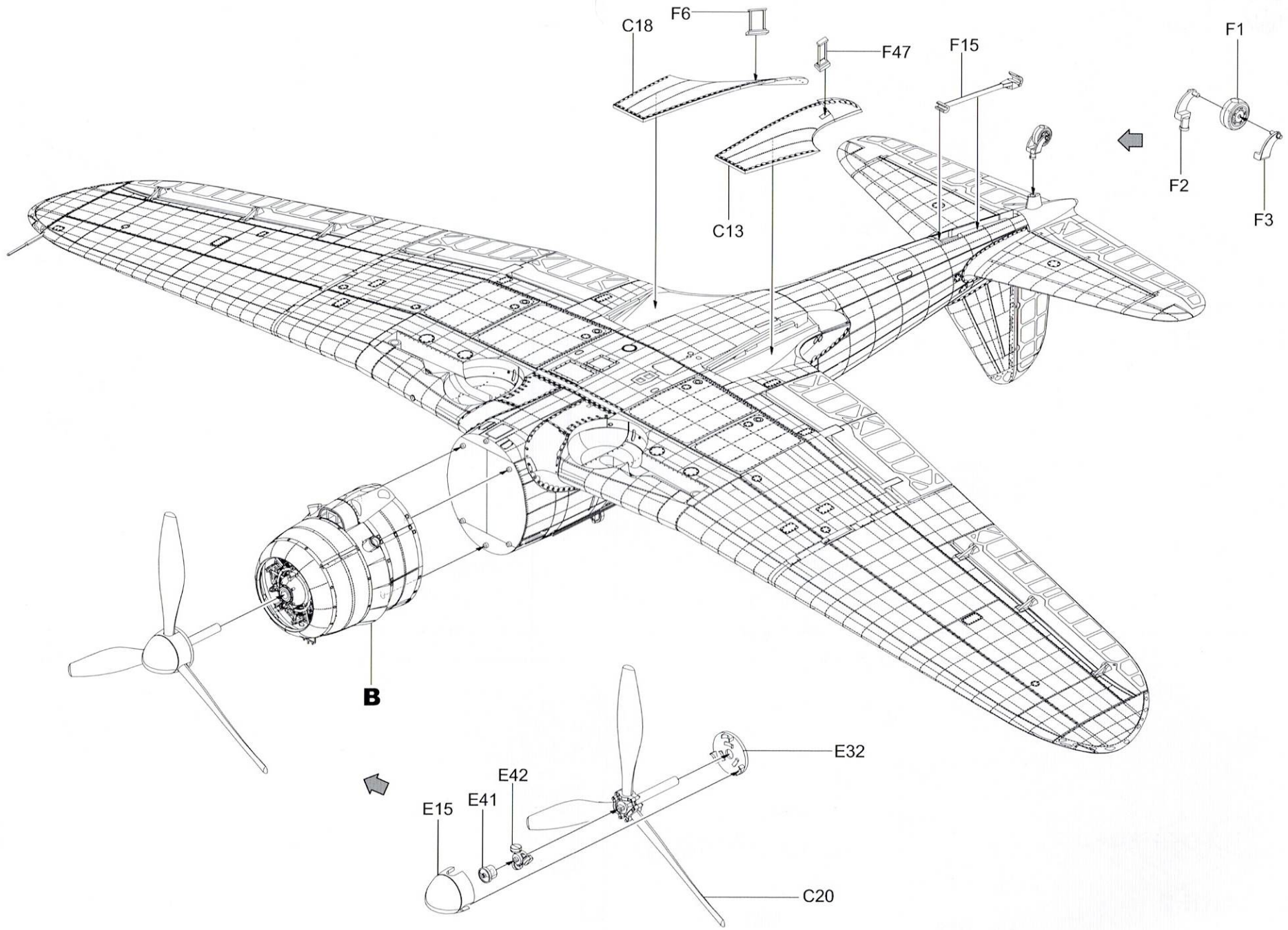

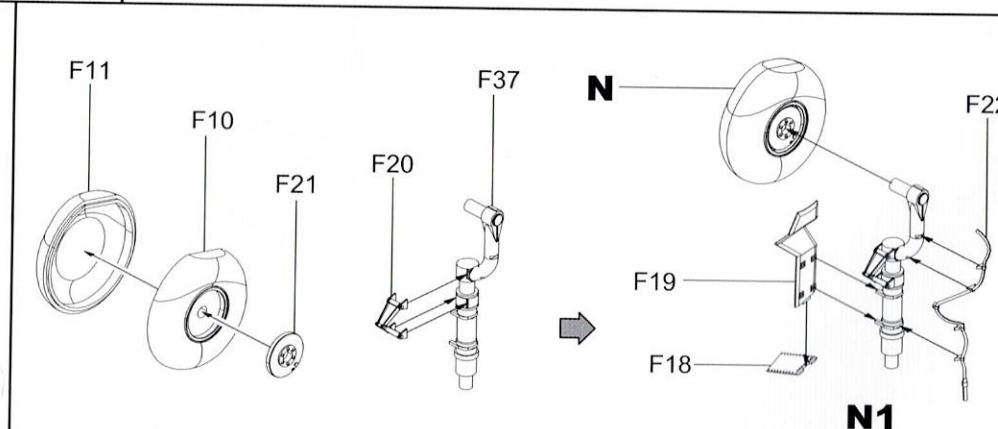
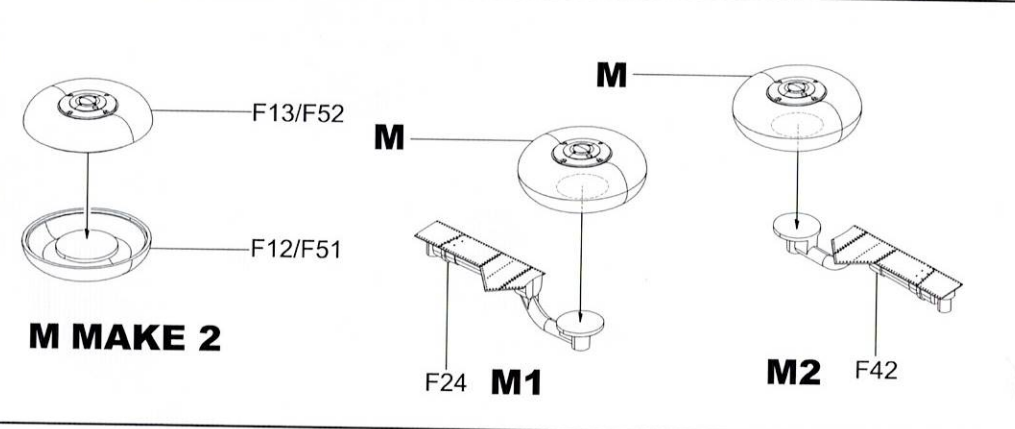
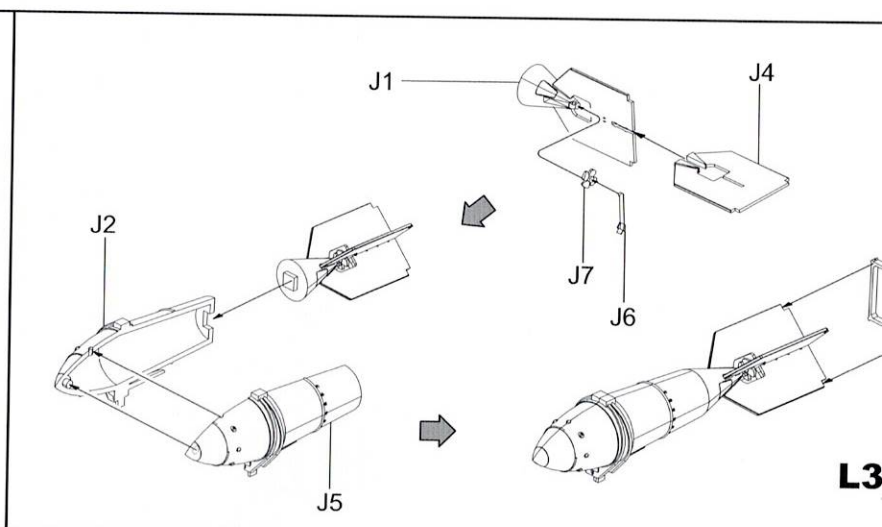
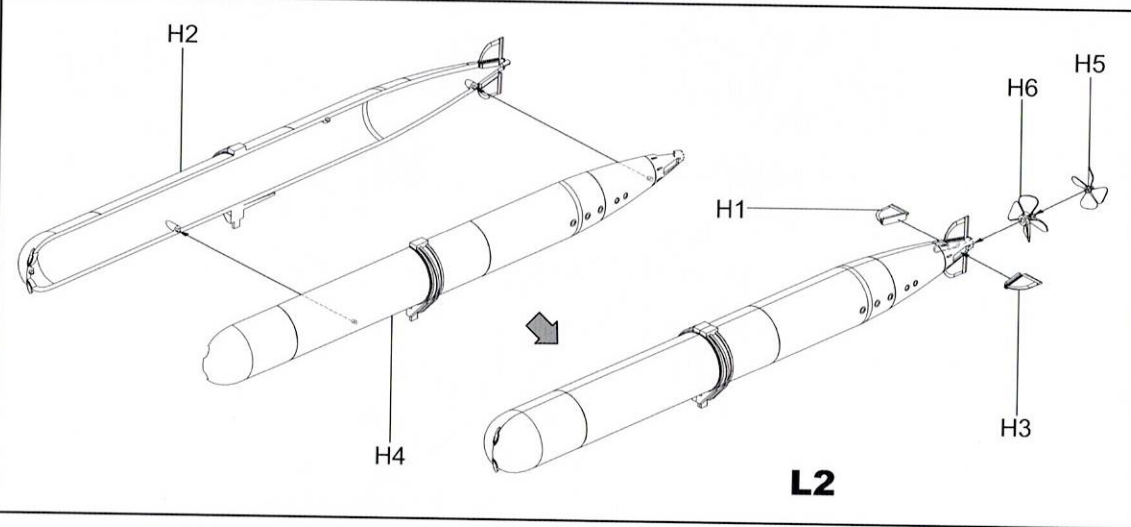
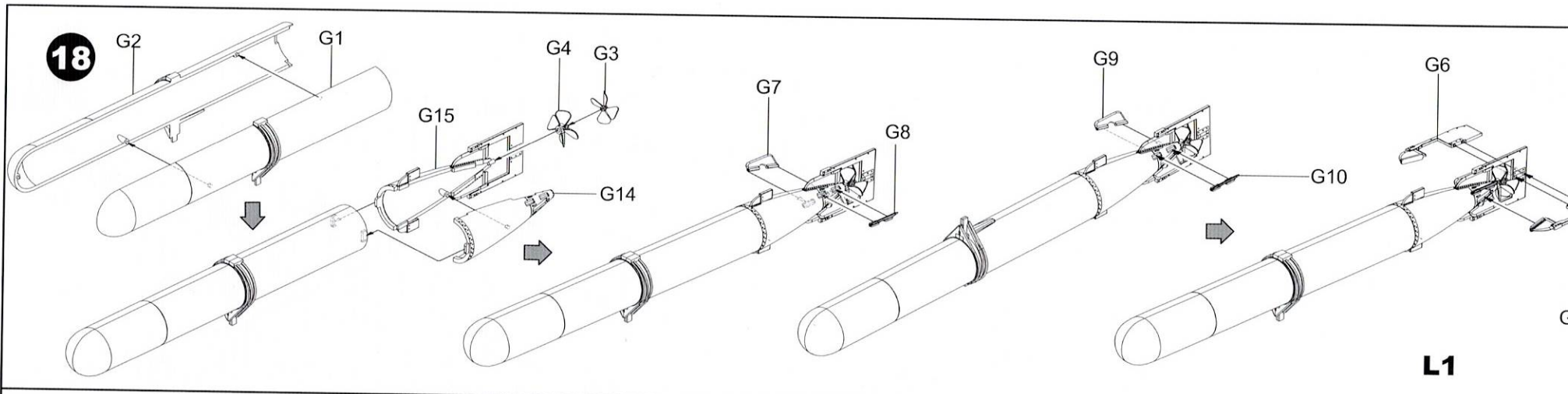

**21** 飞行状态

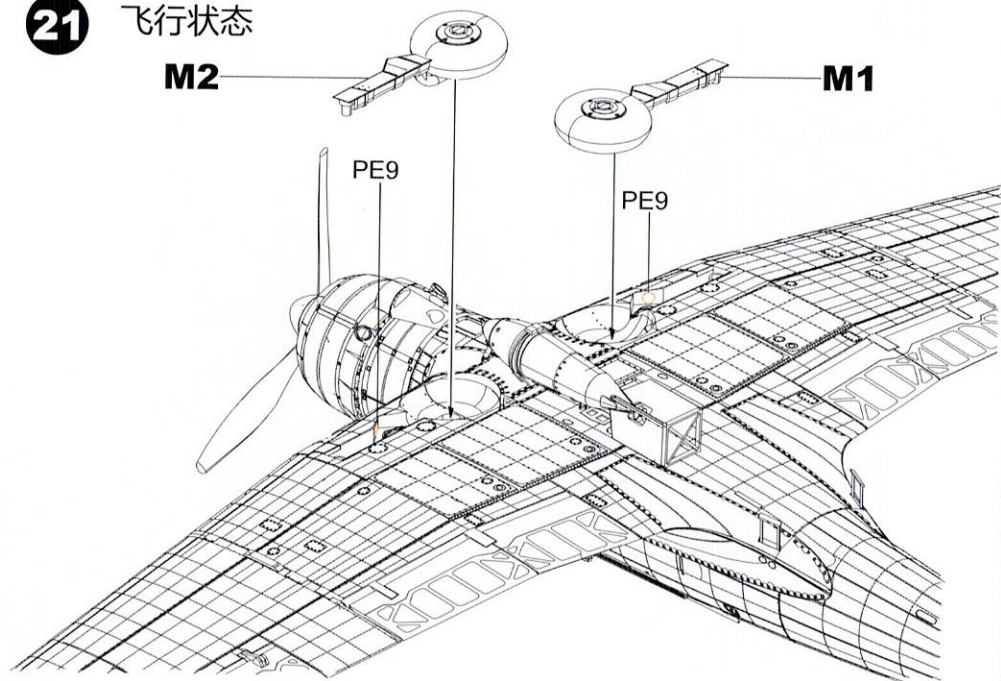

**22**

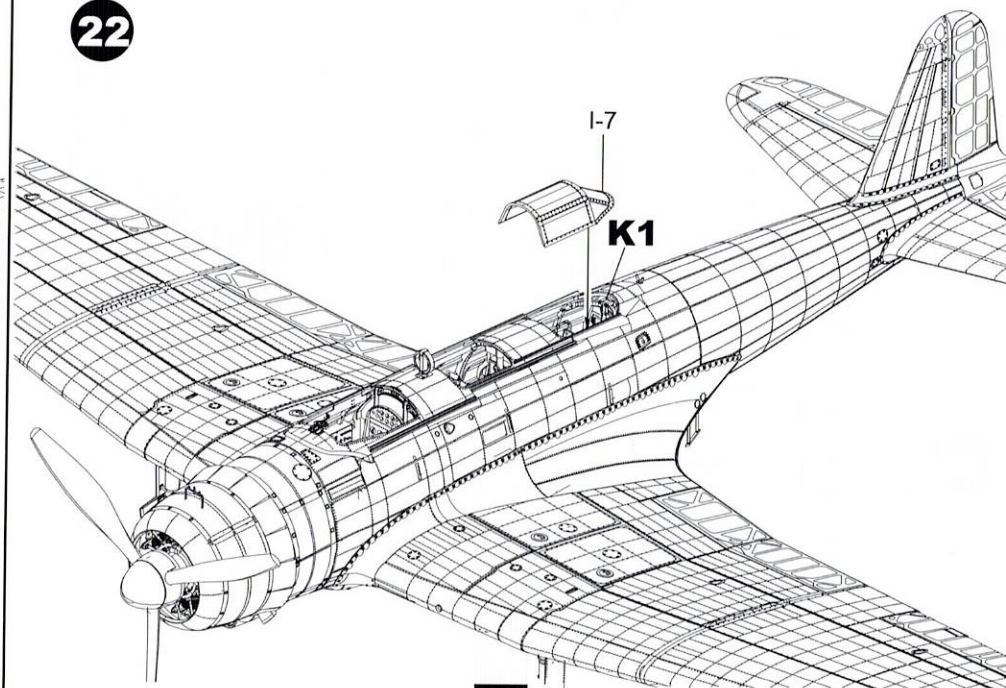

降落状态

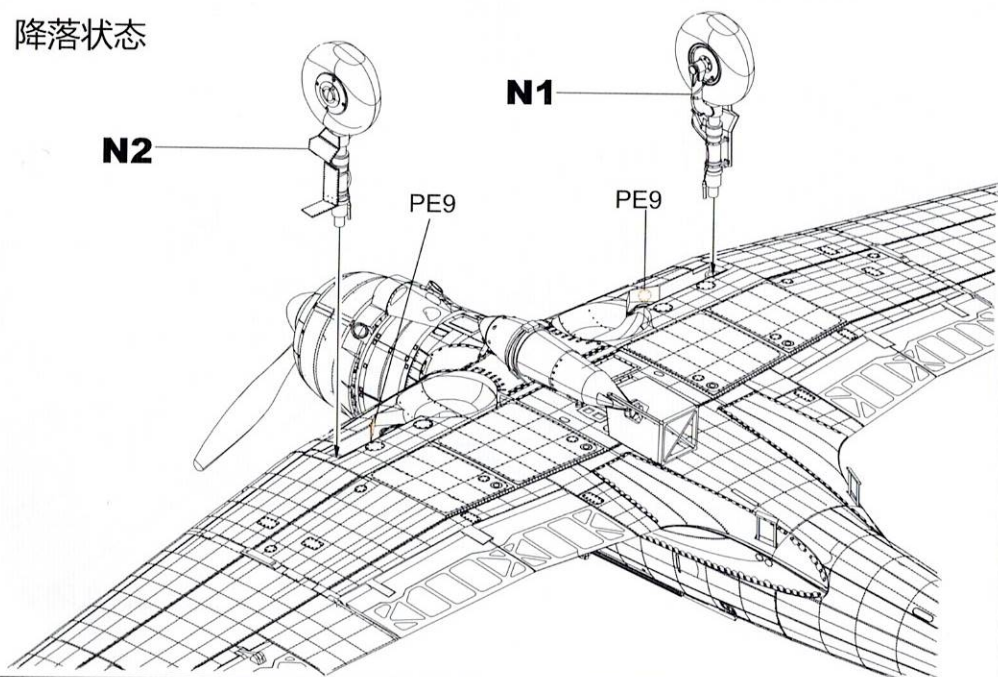

Optional  
可选零件

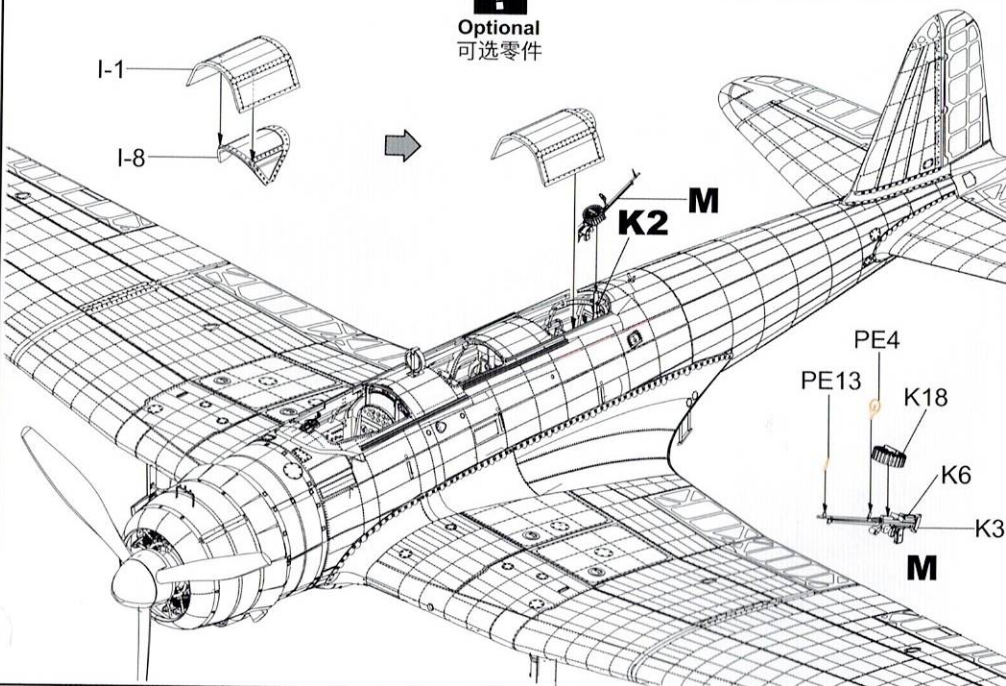
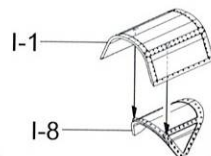

23

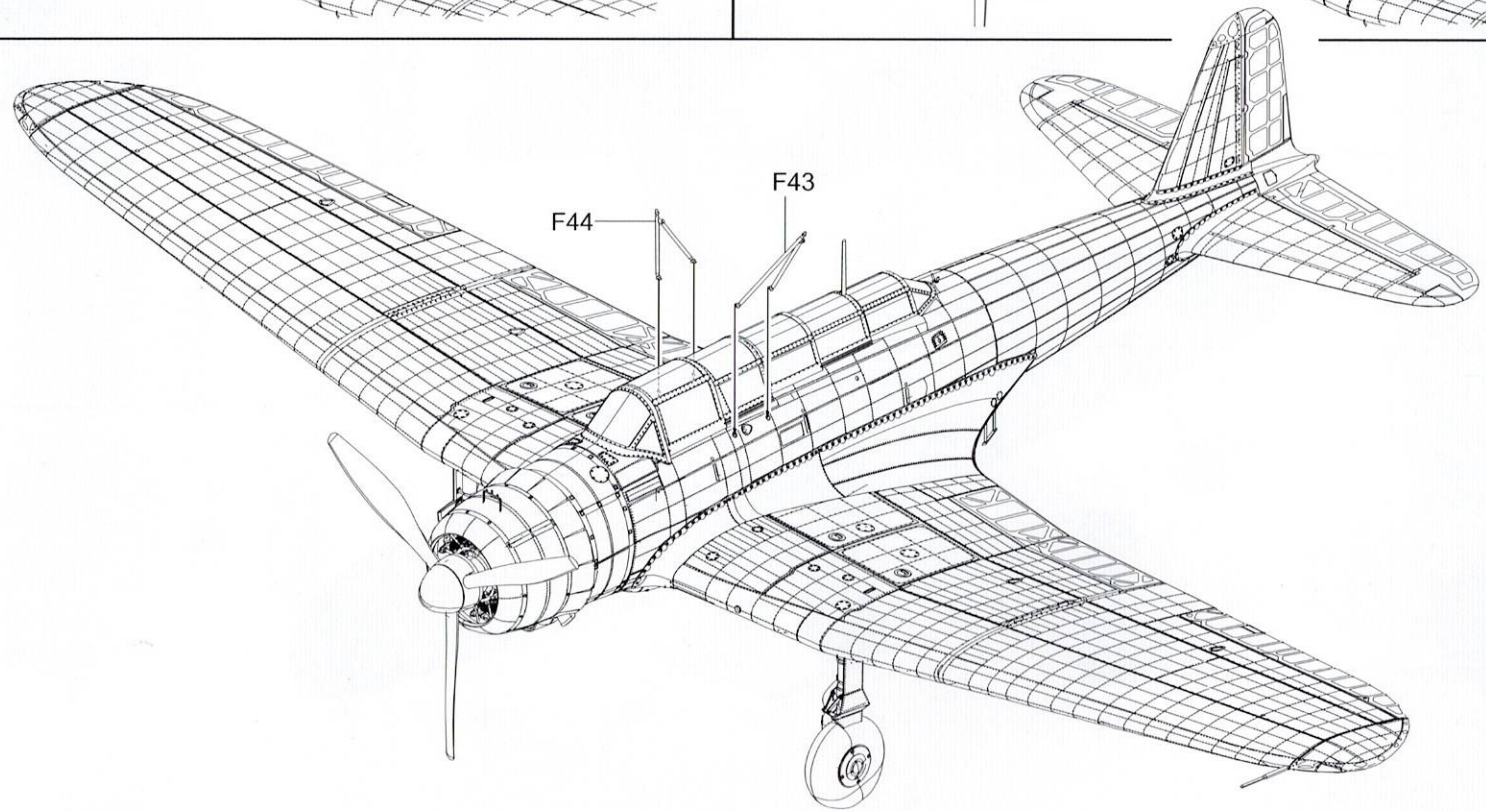
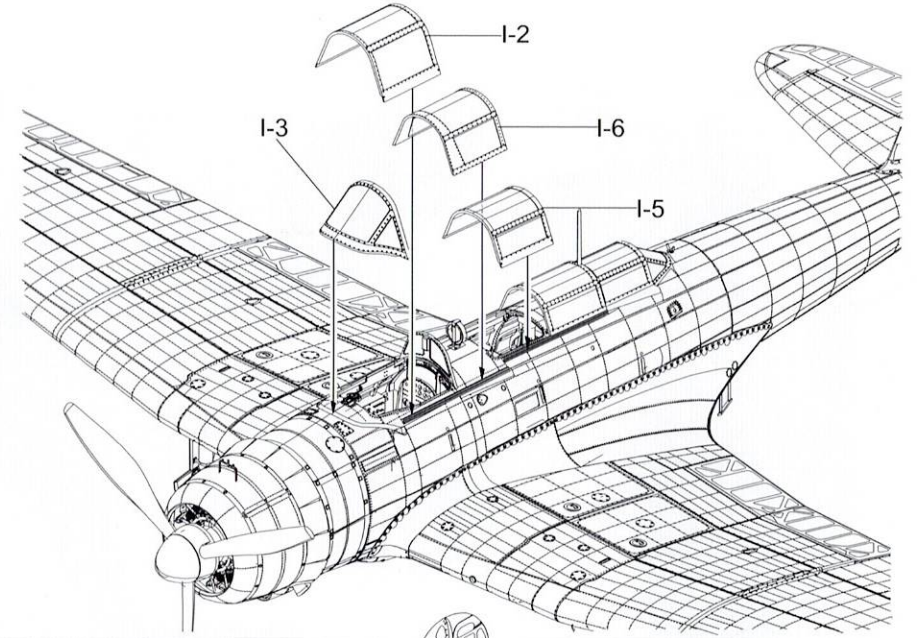
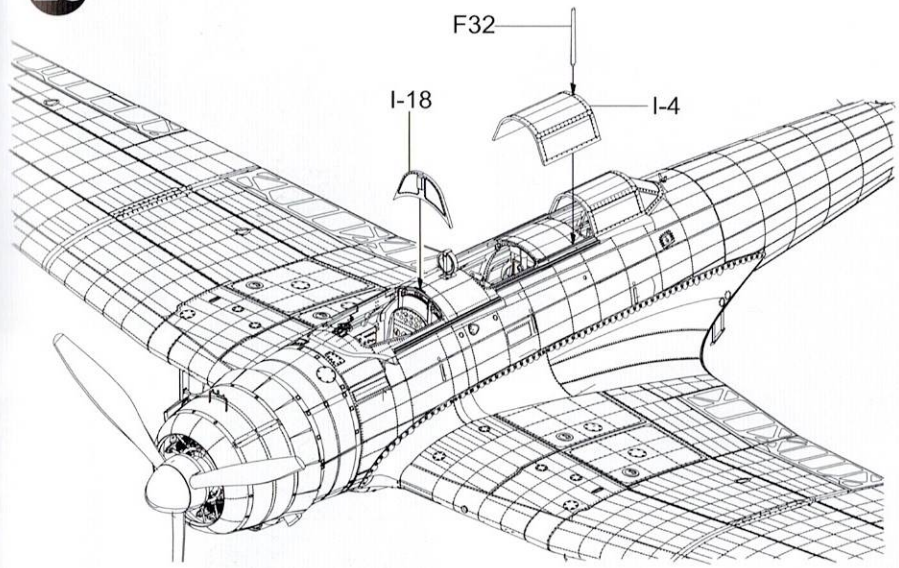





1/35 Nakajima B5N2 Kate

A.MIG-263 IJN Medium Grey

A.MIG-264 IJN Nakajima Dark Green

A.MIG-264

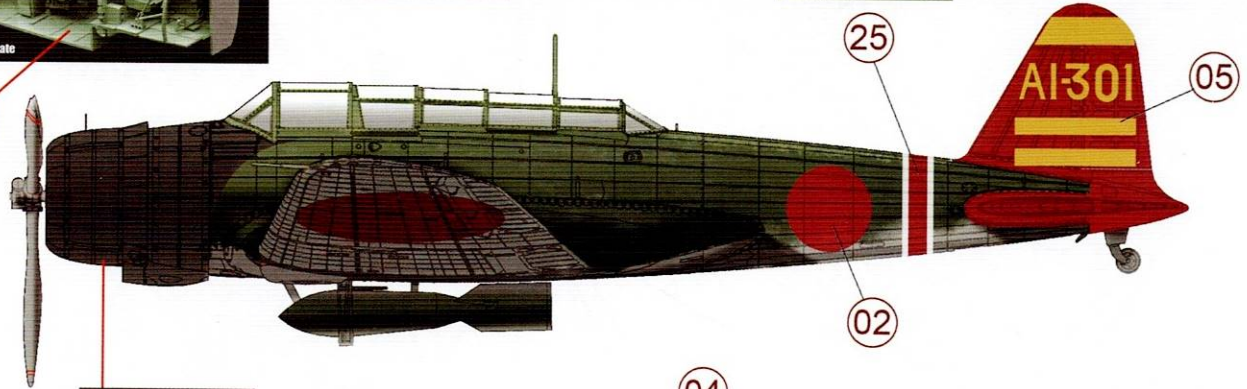

A.MIG-046

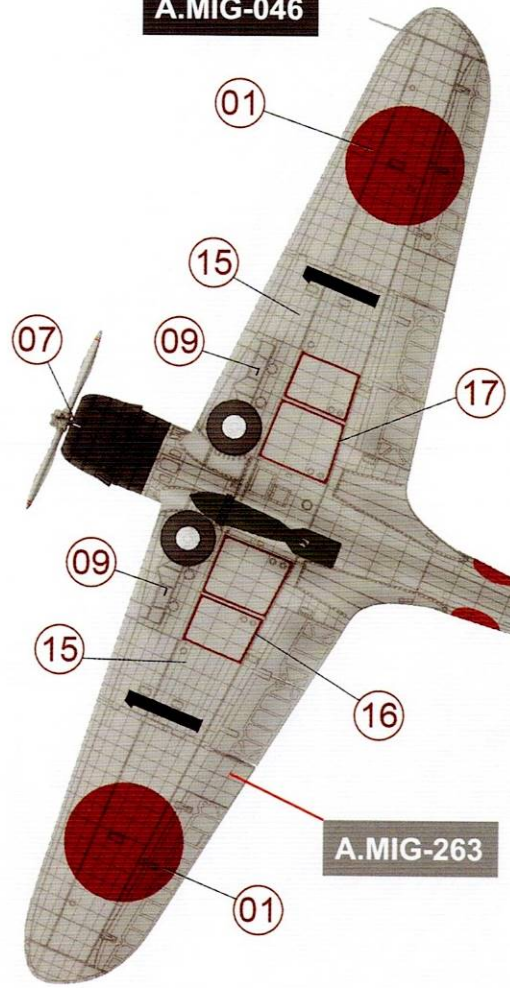

A.MIG-121

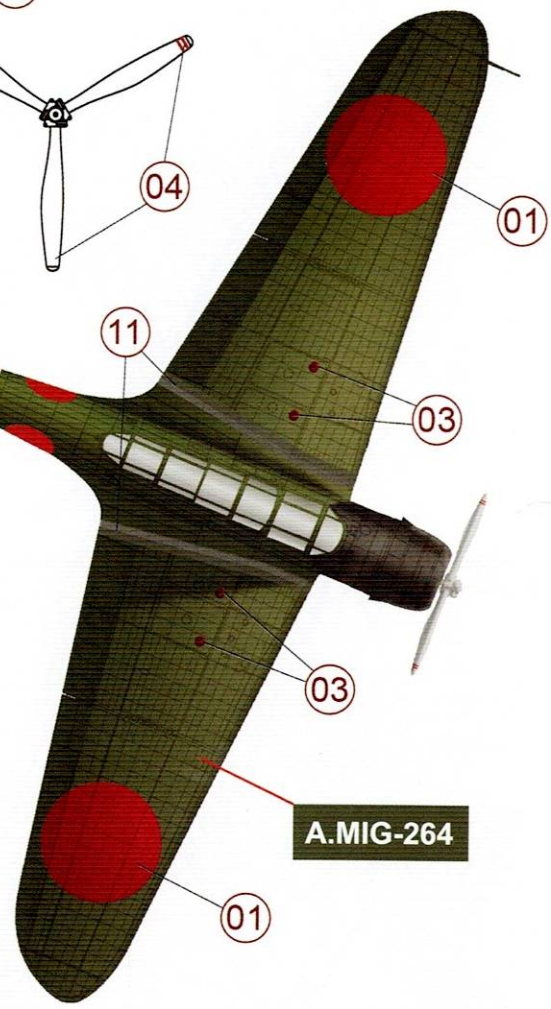
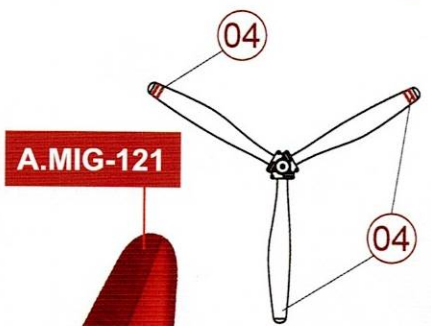

A.MIG-264

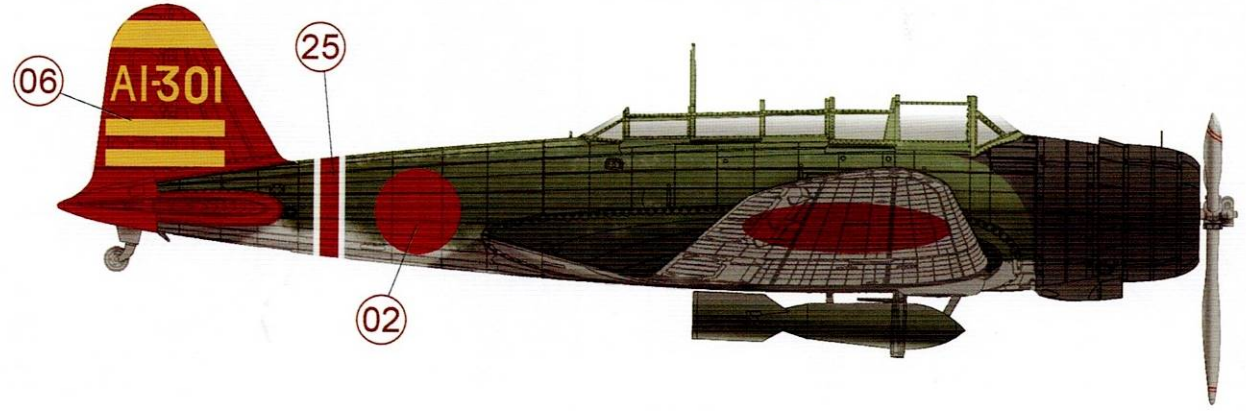

真珠湾「赤城」第1次攻撃隊 指揮官機 AI-301 淵田美津雄中佐

A.MIG-264 IJN Nakajima Dark Green

A.MIG-046 Matt Black

A.MIG-263 IJN Medium Grey

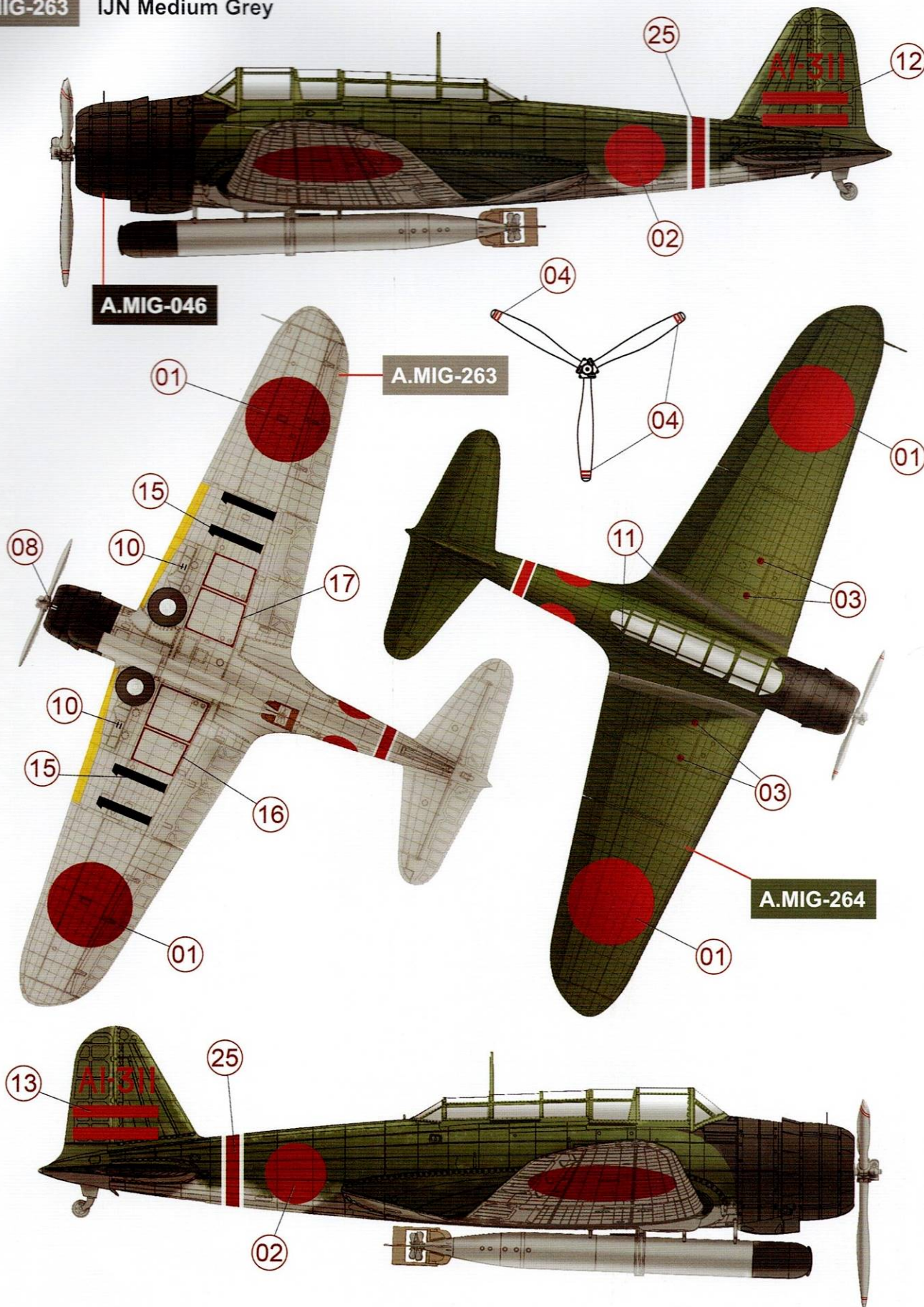

真珠湾「赤城」第4中隊第46小隊1番機 AI-311 村田重治少佐

Border

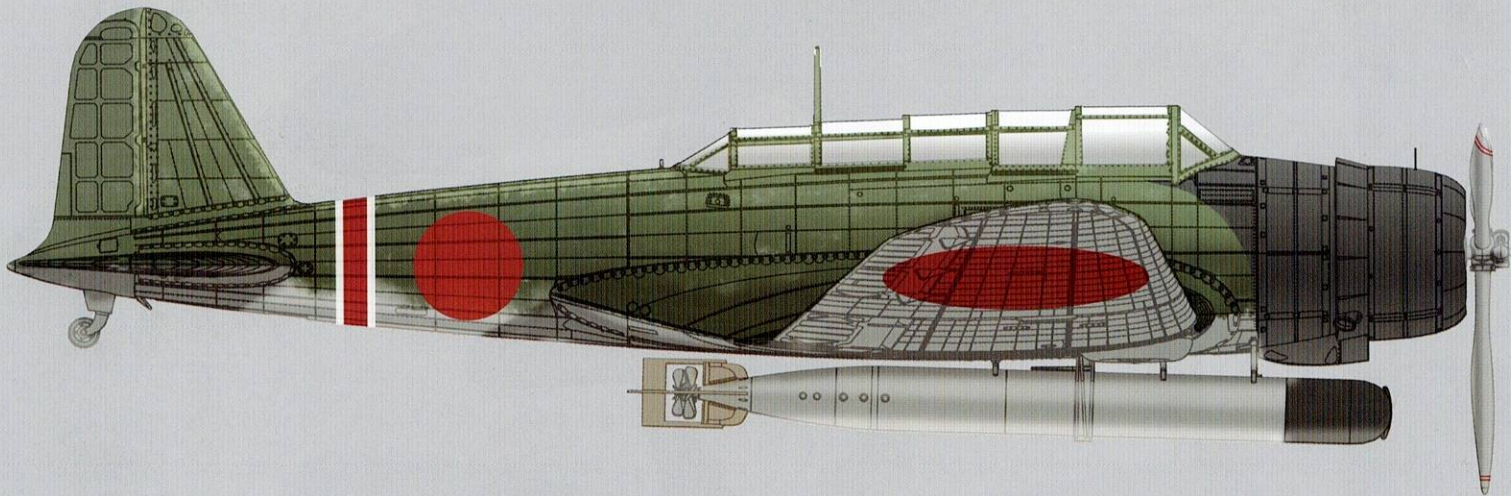

WWW.BORDERMODEL.COM