

IDF M113 ZELDA

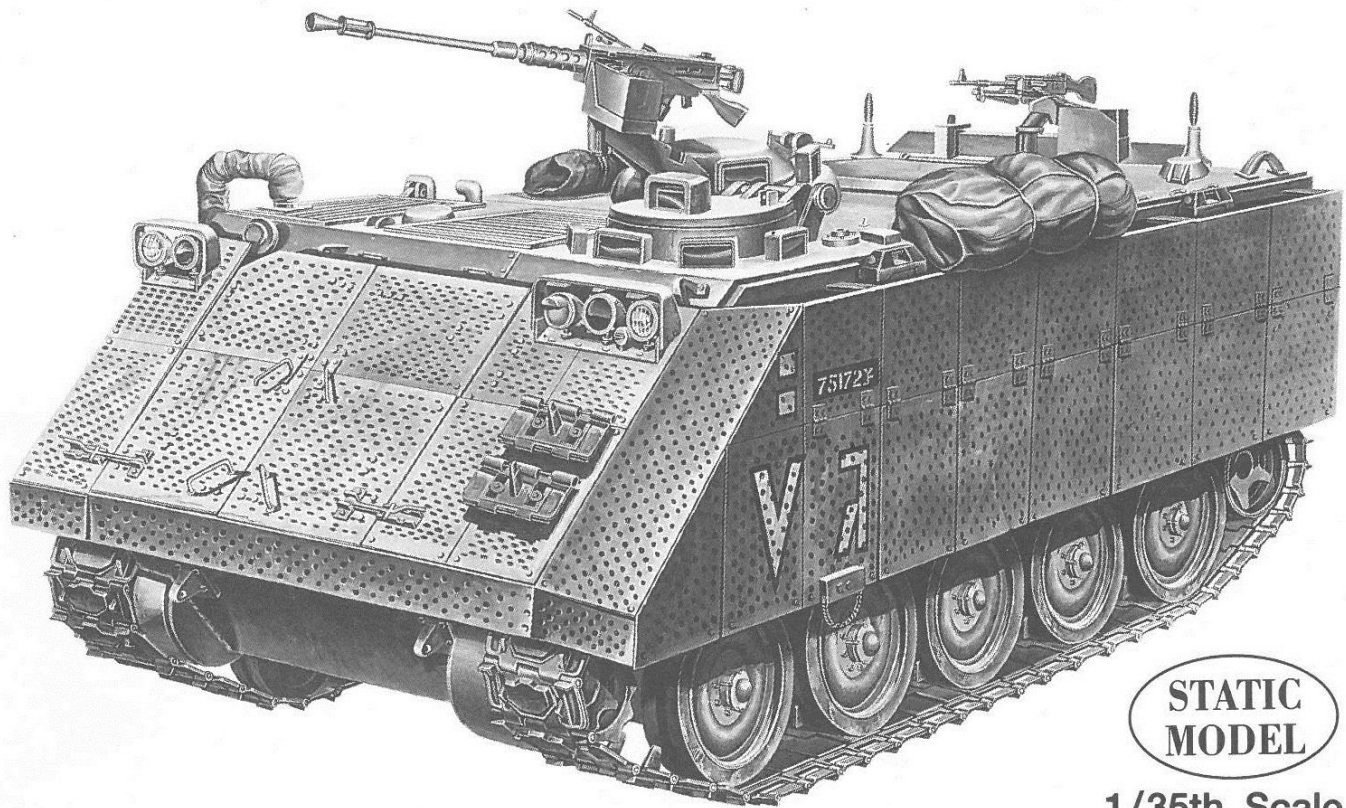

STATIC
MODEL

1/35th Scale

ACADEMY

HOBBY MODEL KITS

- Add-on Armor system accurately reproduced. (Rafael Toga Passive Armor System)
- Can be assembled as either an Add-on Armor or Command Communications Vehicle
- Many optional position hatches and doors for interior viewing of engine and troops space.
- Many accessories included for "customizing" the appearance.

1372

■ IDF M113 ZELDA ARMORED PERSONNEL CARRIER

Highly modified to IDF official and often unofficial requirements, the Zelda starts its life as a standard M-113 APC, but soon takes on an identity all its own and sometimes highly personal as befits an armored vehicle carrying a woman's name, Zelda.

The IDF employs thousands of M-113 Zeldas as fighting machines, to transport troops, service the other armored units and be a universal do-all to the army.

If you review all the available pictures of Zeldas in action, it is difficult to find any two that look alike!

Some have added spaced-out armor; many have exterior fuel tanks; practically all of them have additional machine guns mounted or stowed for quick use. Additionally, the IDF troops have a penchant for hanging almost all their worldly belongings on the sides and tops of Zelda.

Just as the exteriors have been heavily modified, the interiors have received well thought-out stowage racks, bins and lockers all designed to keep the contents from rattling around inside the vehicle. Seating for a squad of troops is standard in Zelda, but many special purpose Zeldas have seen their bench seats removed for additional storage space of supplies or ammunition.

The Israelis have had many years of battle-tested experience in which to perfect their modifications to the M-113.

Many "ideas" developed by the IDF have since appeared on the M-113 APC's of the US and other nations using this weapons system. Considering how much equipment has been added to the basic M-113, it is a wonder that the engine and power-train can provide enough power to move this vehicle at a decent rate of speed.

Your Academy kits of Zelda contains many optional parts from which you can assemble any one of several different types such as the spaced-armor version or the command communications vehicle.



Cement Parts
Coller
Kleben
Pegar
Incollare
Cola
Kleven



DO NOT cement
Ne pas coller
Nicht kleben
No pegar
Non incollare
Nao colar
Niet kleven



Cut away
Couper
Scheiden
Cortar
Tagliare
Cortar
Snijden



Optional parts
Choix
Auswahlmöglichkeit
Eleccion
Scelta
Opcao
Keuze



3

Repeat operation
Répéter l'opération
Vorgang wiederholen
Repitir la operacion
Repitire
Repitir a operação
Herhalen

1 Engine Assembly

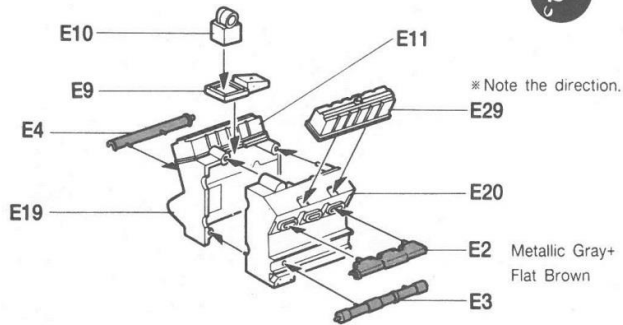

※ Choose between the Add-on Armor vehicle and the Command/Communications vehicle.

● Engine: Metallic Gray

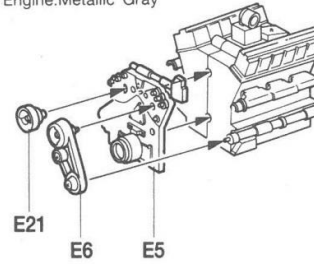

2 Seat Assembly

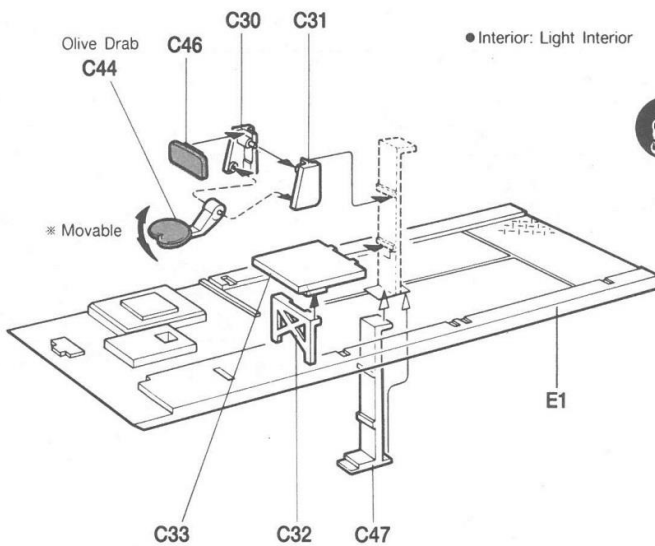

3 Transmission Assembly

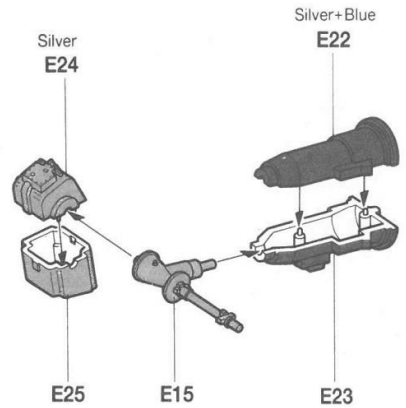

4 Engine Installation

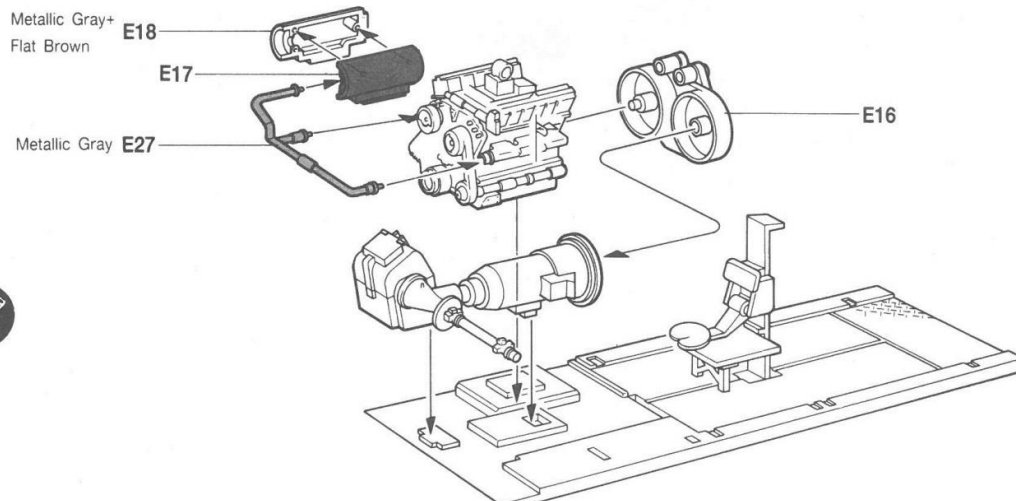

5 Bench Assembly

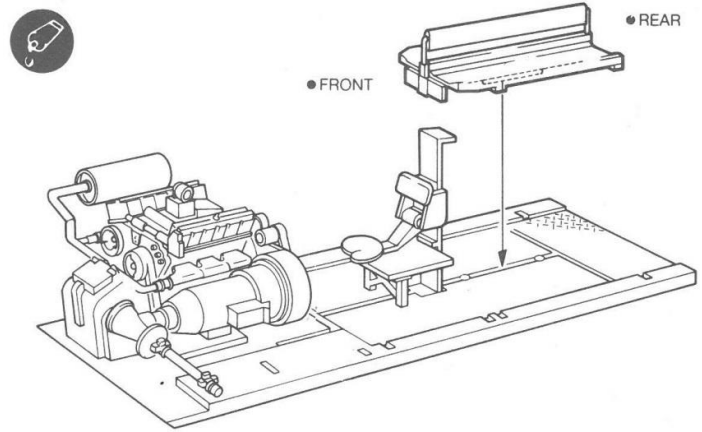
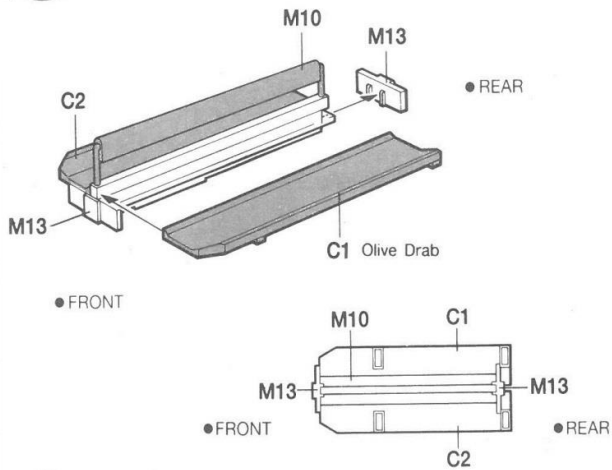

6 Driver's Compartment Assembly

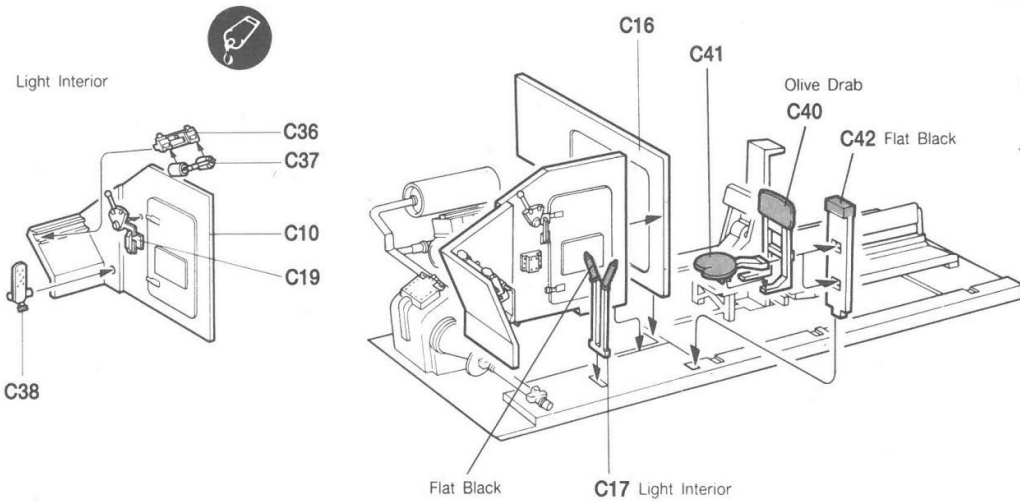

Decal Apply

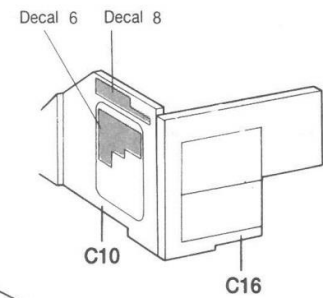

* Apply decals after painting.

7 Interior Assembly

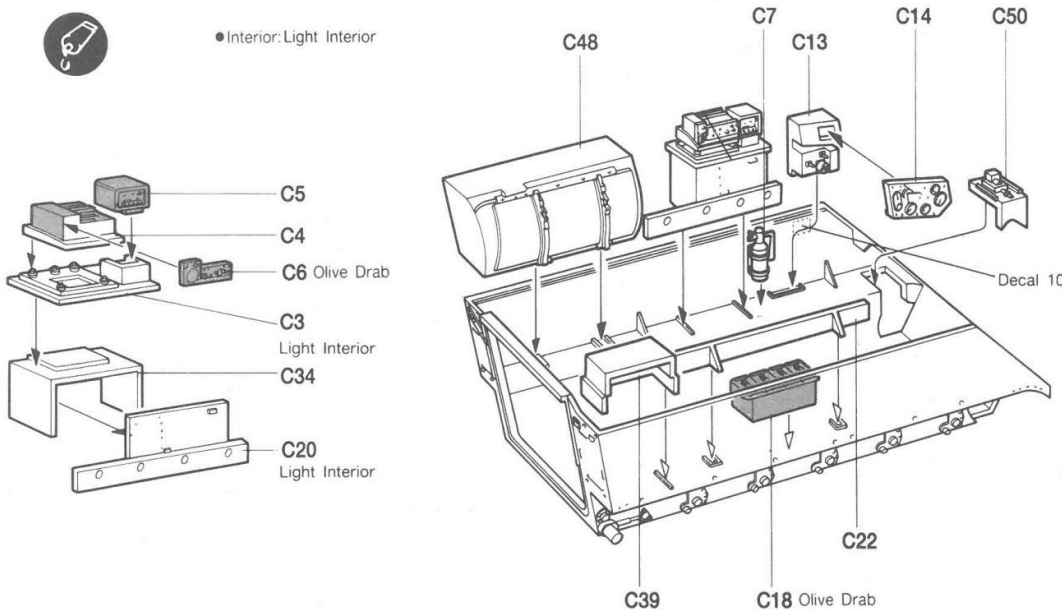

Painting(C14)

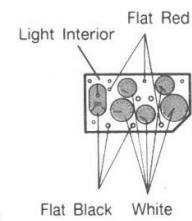

Painting(C7)

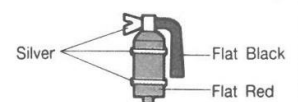

8 Interior Installation

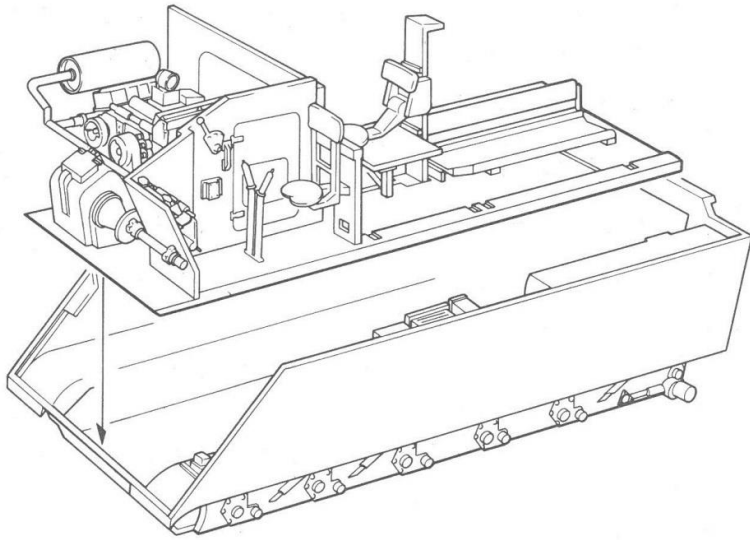

Jerry Can Assembly

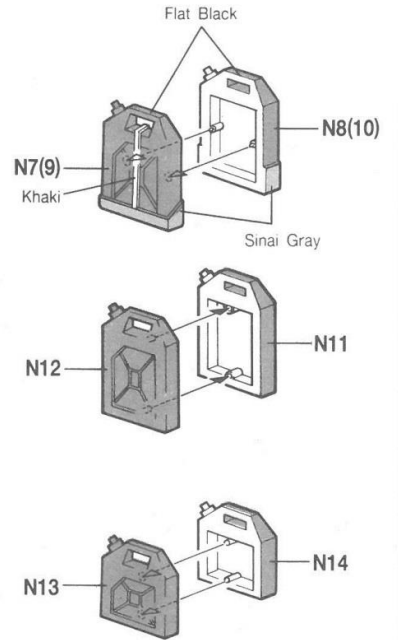

9 Rear Hull Assembly

Storage box assembly

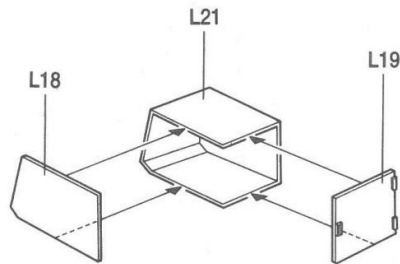
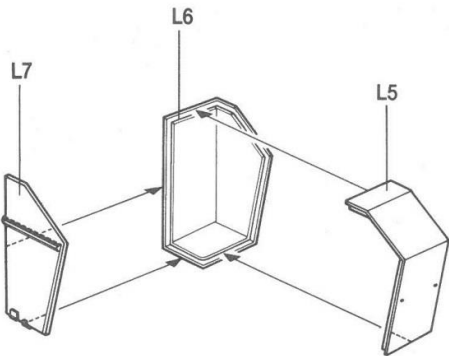

Command & communications vehicle

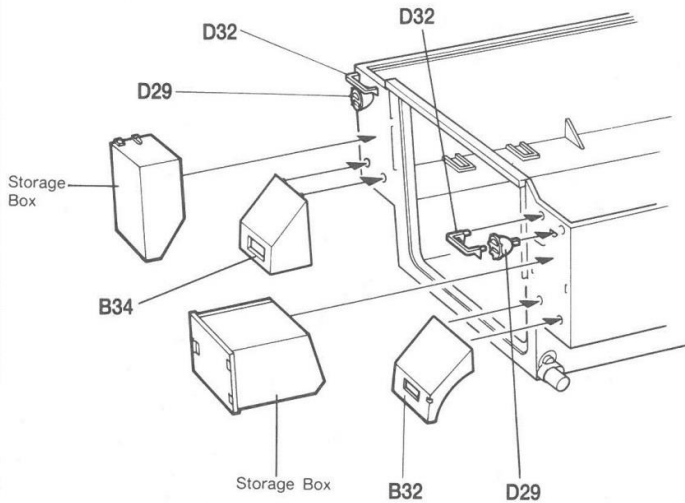

Add-on Armor vehicle

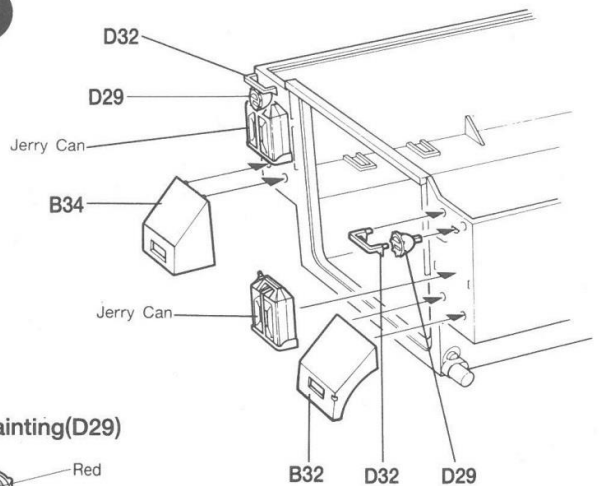

Painting(D29)

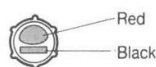

10 Rear Door Assembly

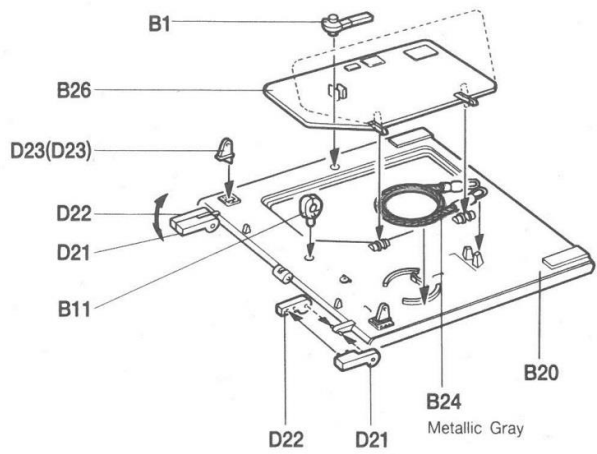

• () is opposite number.

■ Accessories Painting

< Comouflage net >

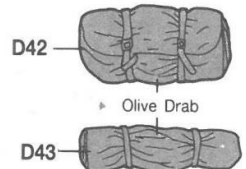

< (M18) Stretcher >

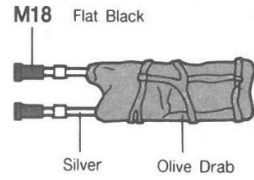

< (N17) Spare road wheel >

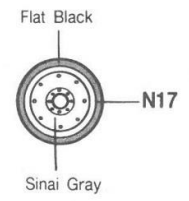

• Attach accessories your desire.

11 Suspension Assembly

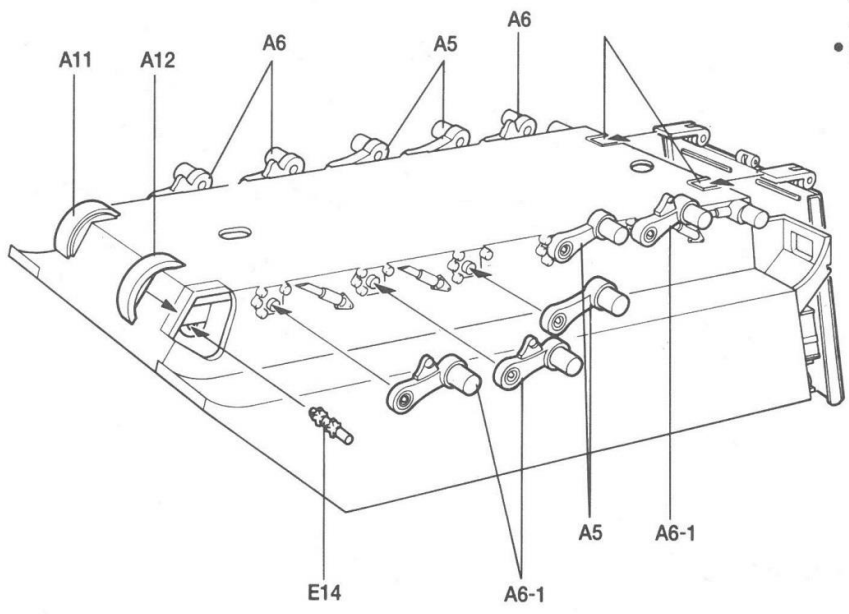

* Note the direction.

12 Wheel Assembly

■ Road Wheel

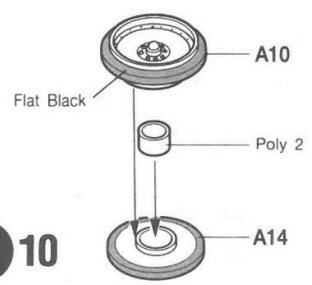

■ Idler Wheel

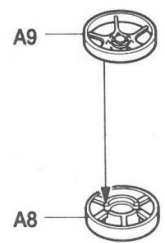

■ Sprocket Wheel

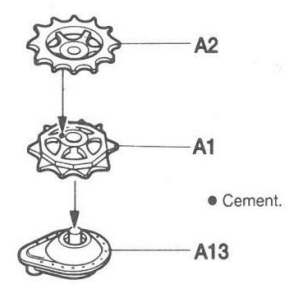

13 Wheel Installation

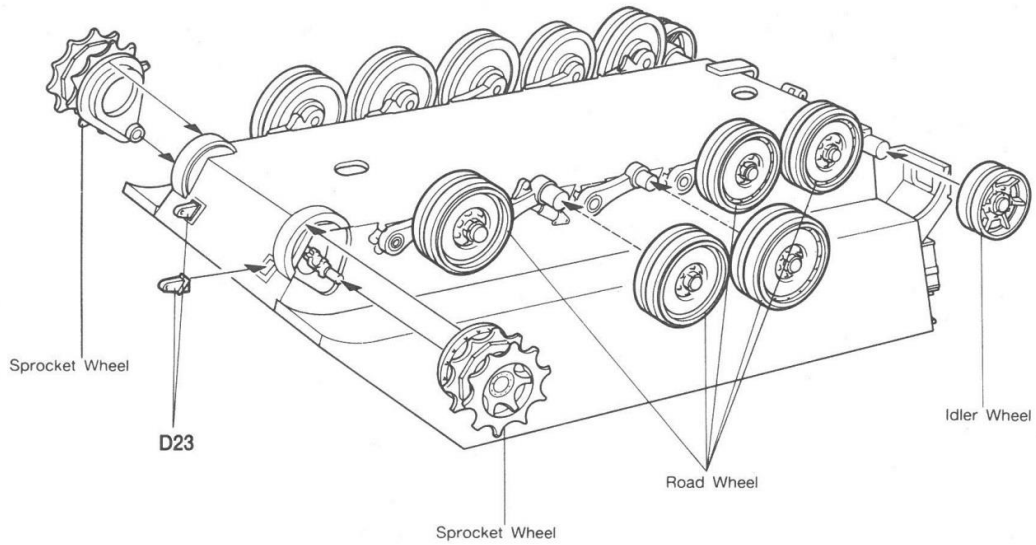

14 Open Holes

* Open holes at places as shown below each version.

- Command & communications vehicle: ①, ③, ⑤
- Add-on Armor vehicle: ②, ④, ⑤, ⑥

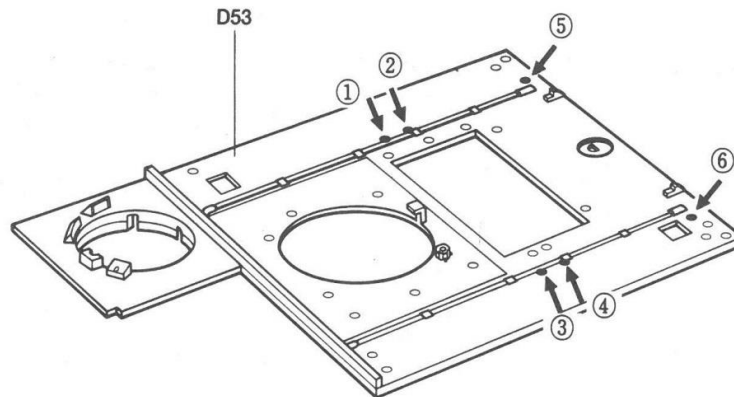

15 Upper Hull Assembly I

- Inside: Light Interior
- Outside: Body Color

■ Painting(C29)

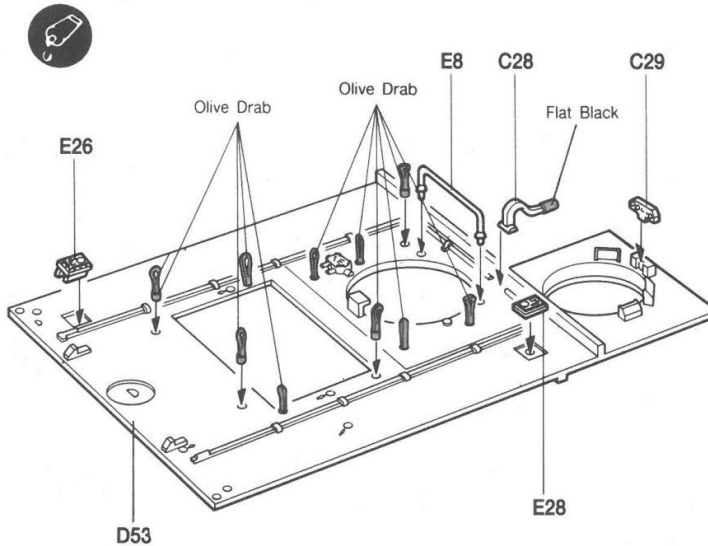

16 Upper Hull Assembly II

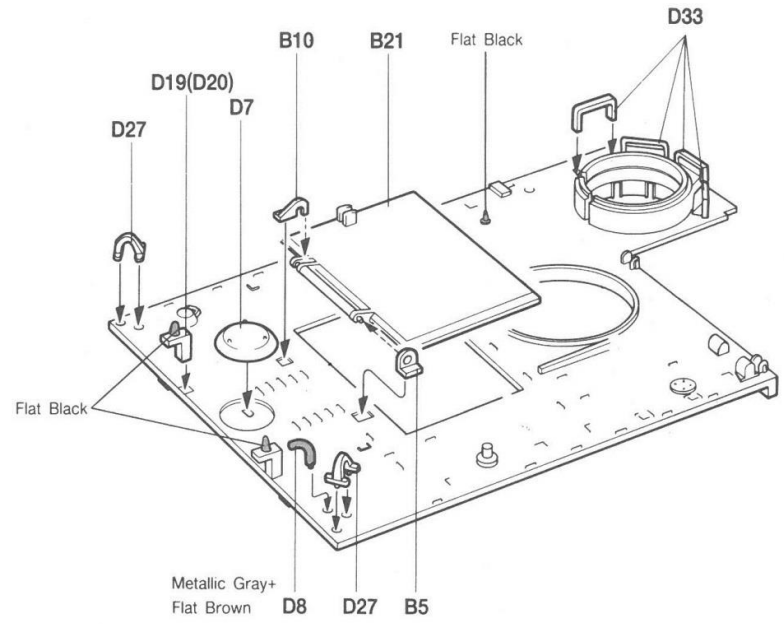
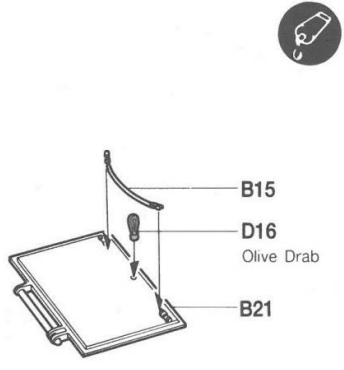

17 Upper Hull Installation

* Melt pin heads with a heated screw driver blade and immediately press pin head by finger pressure.

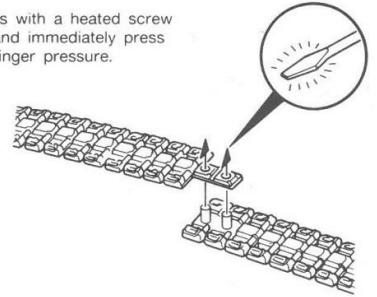
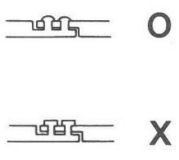

Equipment Painting

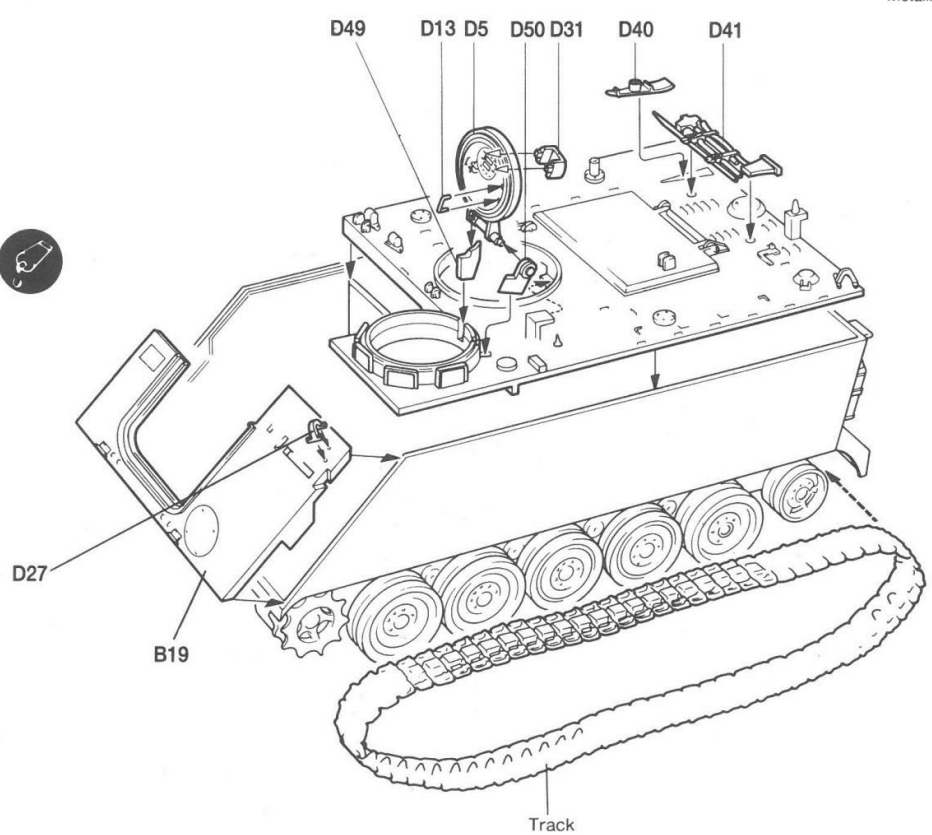
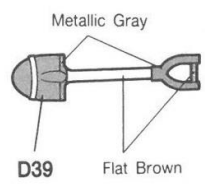
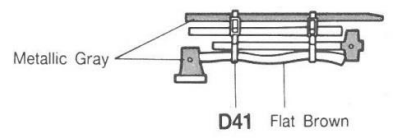

18

Cupola & Armament Assembly

■ Cupola Assembly

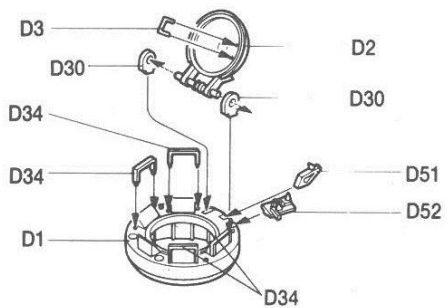

■ Cal. 50 Assembly

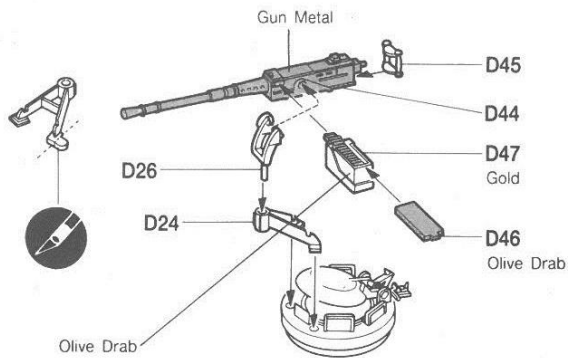

19

Engine Grill Assembly

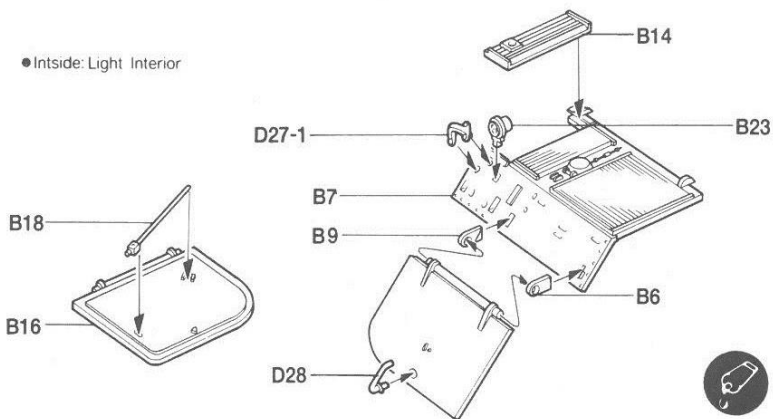

● Inside: Light Interior

20

Radiator Assembly

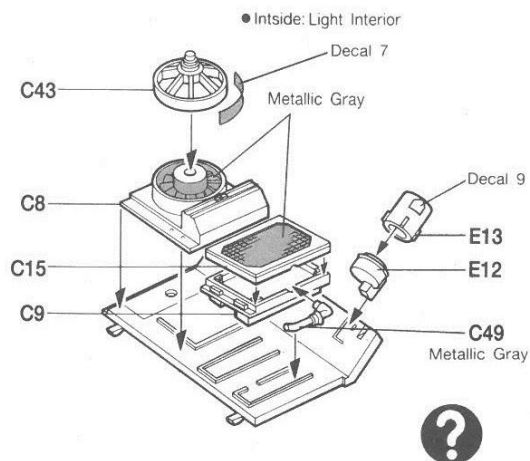

● Inside: Light Interior

* D28 is only attached command & communications vehicle.

* Do not fix C49, when you assemble closed position.

21

Cupola & Engine Grill Installation

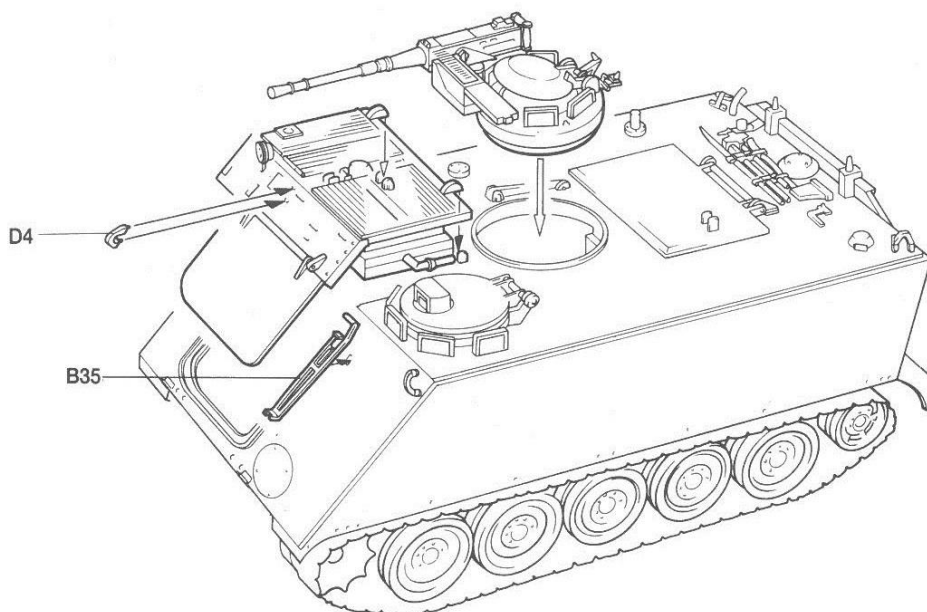

22 Add-on Armor Vehicle Assembly

■ FN MAG 7.62mm

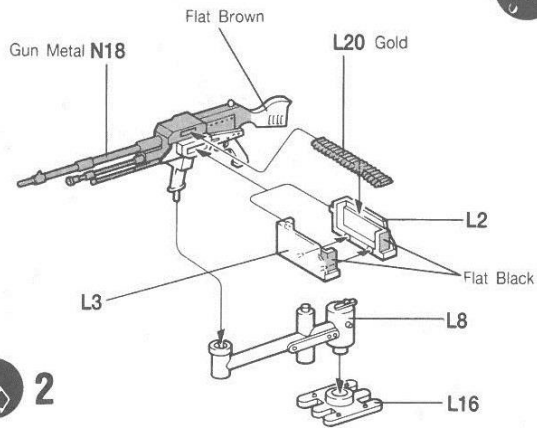

■ Front armor plate

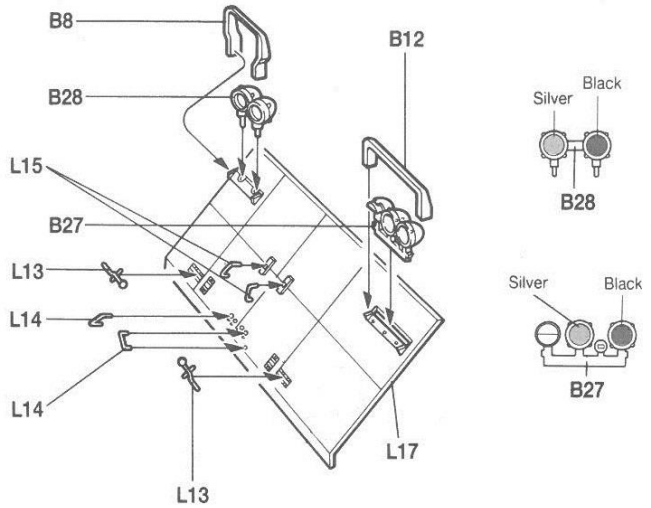

2

■ Side armor plates

● () is opposite number.

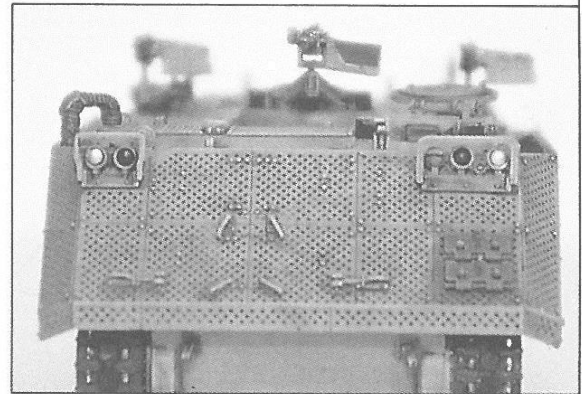
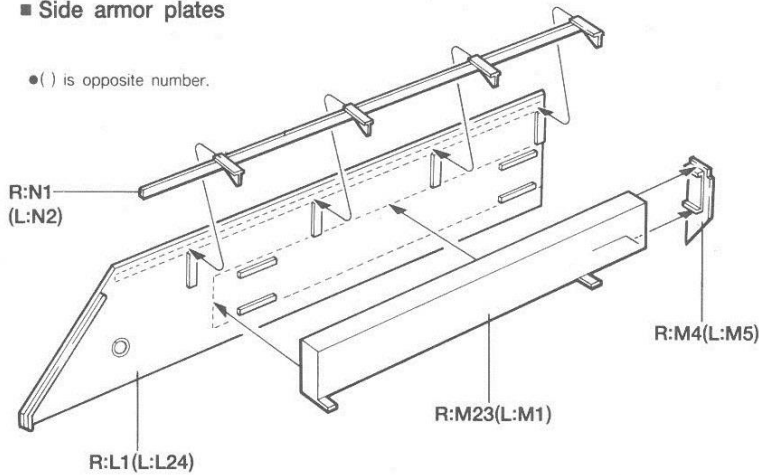

■ Front view

■ Armor plates installation

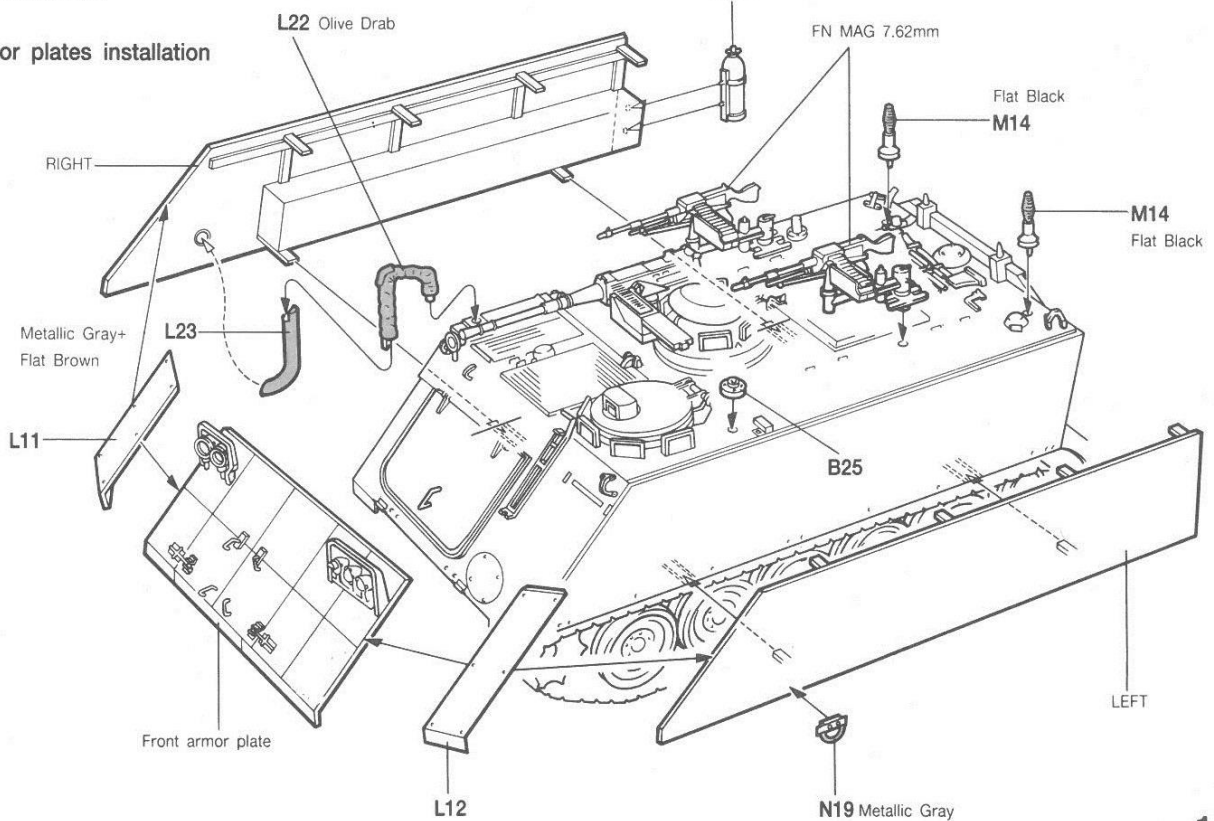

23 Command & Communications Vehicle Assembly

Roller Assembly

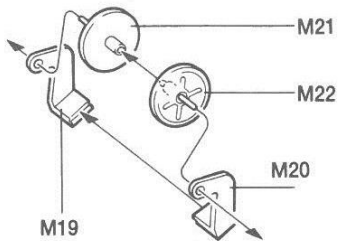

Left side view

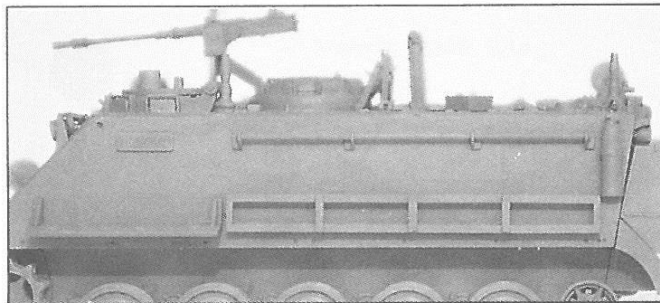

2

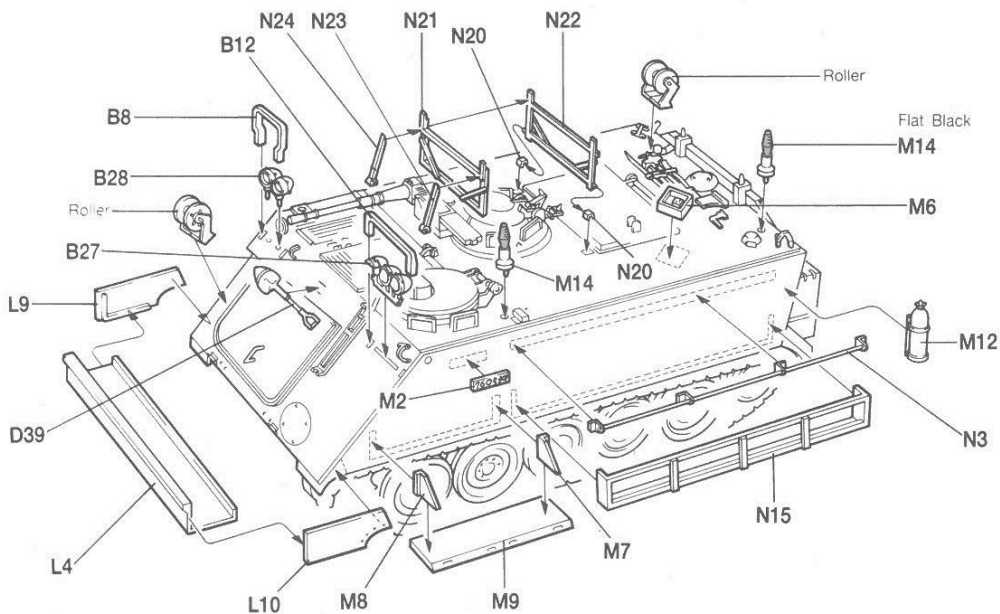
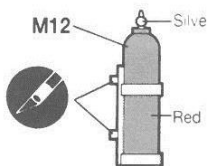

Right side view

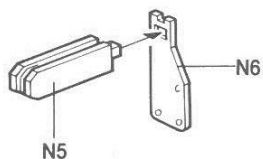
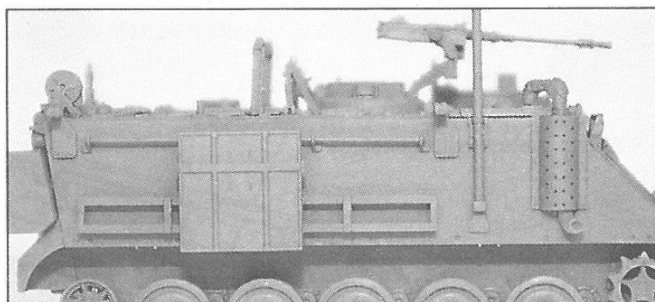

2

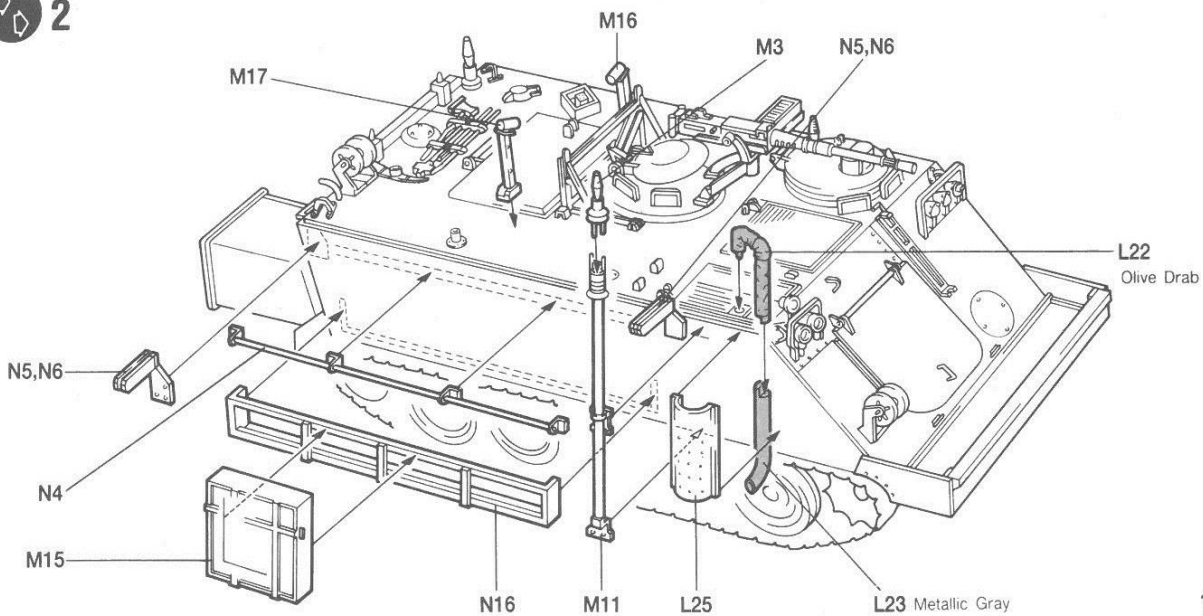

Painting & Decal Placement

● Body Color: Sinai Gray

● () is opposite decal number.

■ Command & communications vehicle

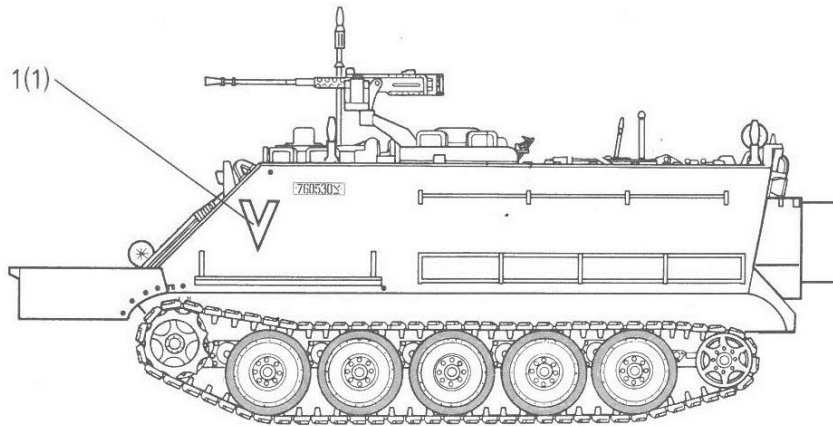

■ Add-on Armor vehicle

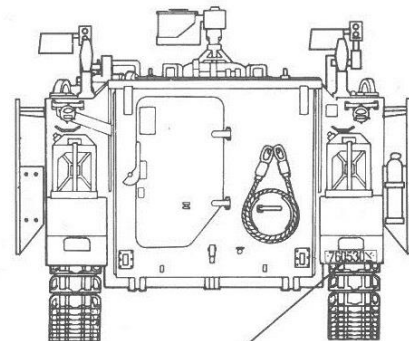
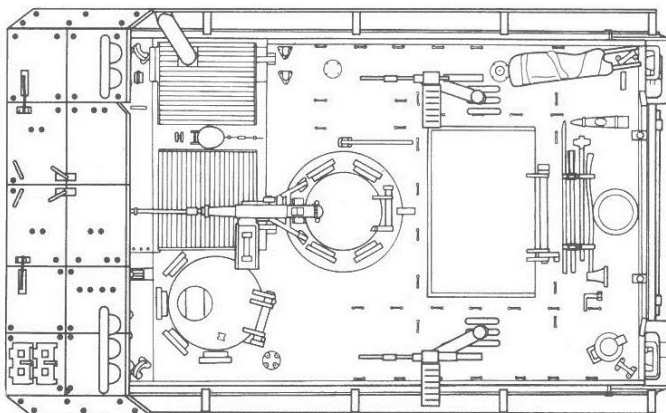
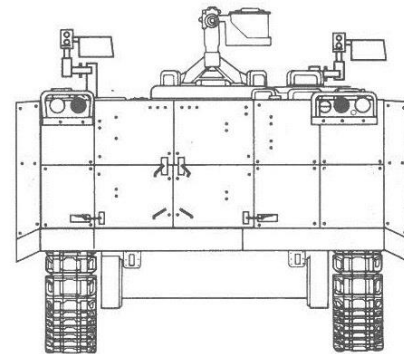
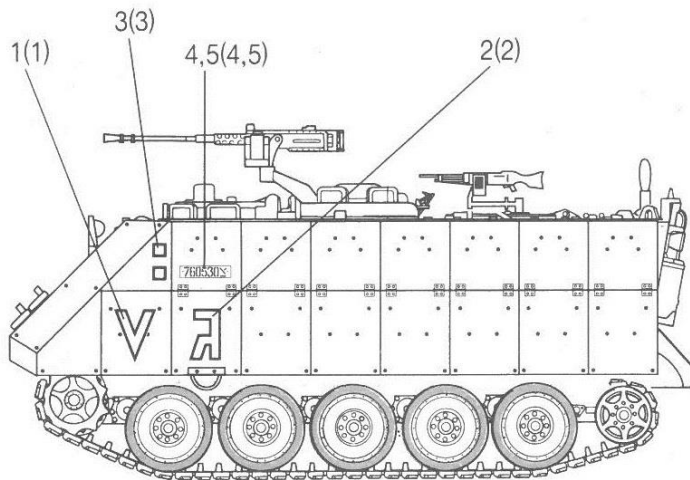

4,5

Parts Locating Diagram

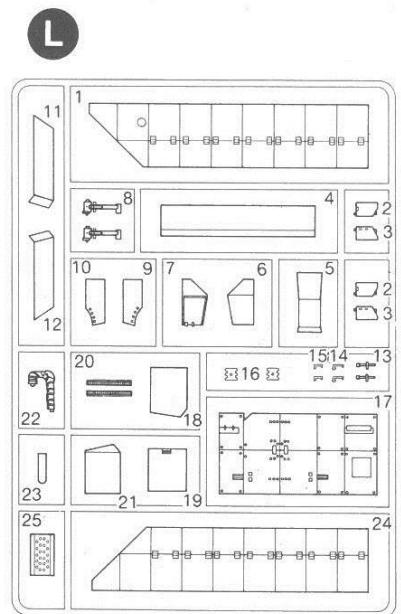
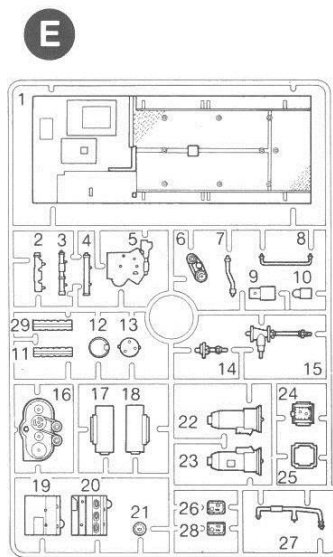
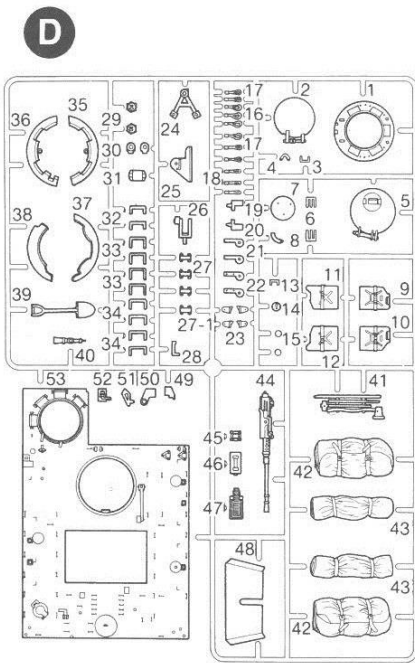
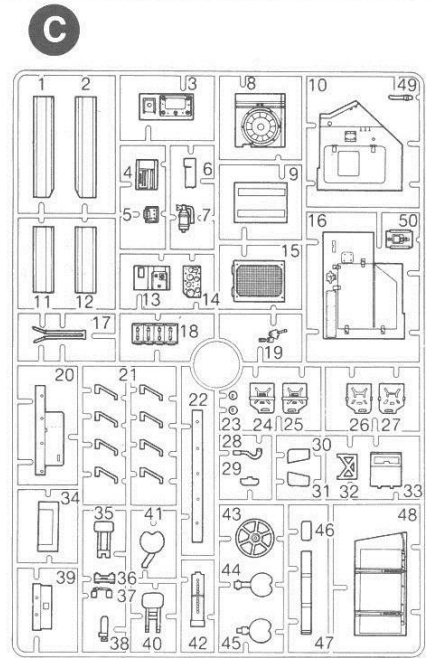
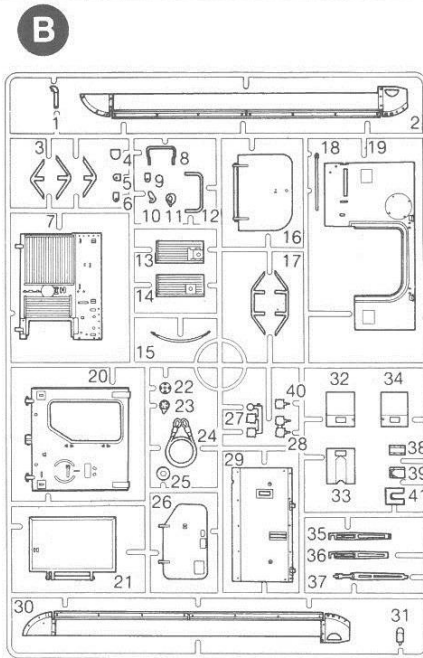
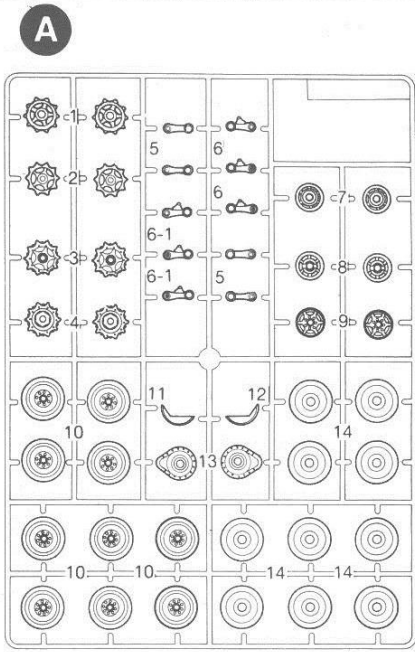

● Unused Parts:

- A: 3, 4, 7
 - B: 2, 3, 4, 13, 17, 22, 29, 30, 31, 33, 36, 37, 38, 39, 40, 41
 - C: 11, 12, 21, 23, 24, 25, 26, 27, 35, 45
 - D: 6, 9, 10, 11, 12, 14, 15, 25, 35, 36, 37, 38, 48
 - E: 7
- POLY No.1, No.2 (2EA)

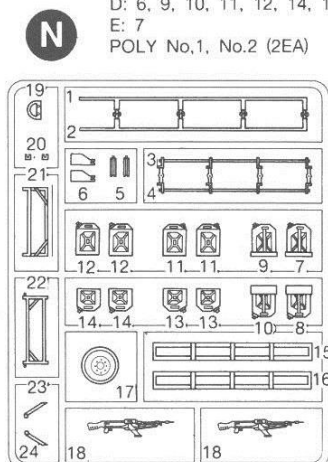
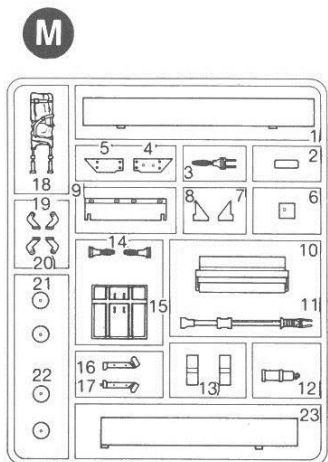

ENGLISH	FRENCH	GERMAN	SPANISH	ITALIAN
WHITE	BLANCO	WEISS	BLANC	BIANCO
YELLOW	JAUNE	GELB	AMARILLO	GIALLO
RED	ROUGE	ROT	ROJO	ROSSO
BLUE	BLEU	BLAU	AZUL	BLU
GRAY	GRIS	GRAU	GRIS	GRIGIO
GUNMETAL	METALLIC	METALLIC	METALICO	METALLICO
GREEN	VERT	GRUN	VERDE	VERDE
SILVER	ARGENT	SILBERN	PLATA	ARGENTO
BLACK	NOIR	SCHWARZ	NEGRO	NERO
ORANGE	ORANGE	ORANGE	NARANJADO	ARANCIO
AMBER	AMBRE	BERNSTEINFARBEN	AMBAR	AMBRA
ALUMINUM	ALUMINIUM	ALUMINIUMFARBEN	ALUMINIO	ALLUMINIO
GLOSS	LUSTRE	GLANZENDES	BRILLANTE	BRILLANTE
FLAT	TERNE	GLANZLOSES	APAGADO	OPACO

ACADEMY
HOBBY MODEL KITS