

Mod Rod

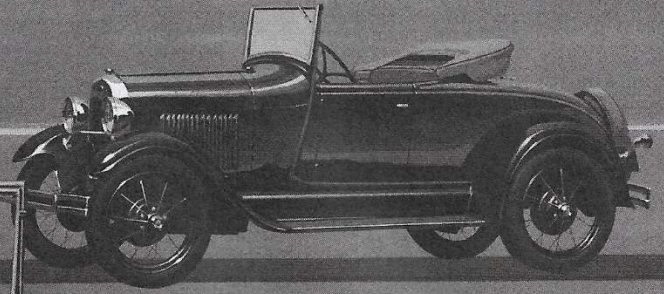

1929 FORD MODEL A ROADSTER

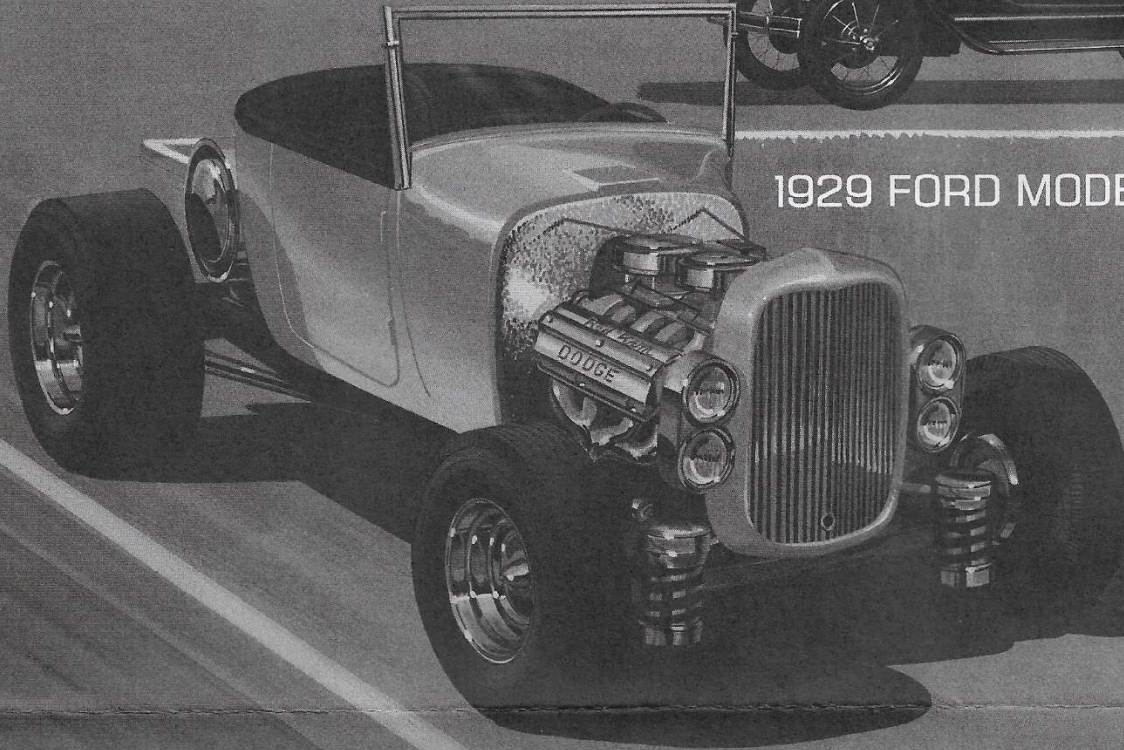

A1000/1002-200

READ THIS BEFORE YOU BEGIN

This kit may be built more than one way. Look over this instruction sheet carefully before you begin building. You may decide to combine parts from the different versions shown, or use parts from other AMT® kits. After you've planned your car, follow the assembly instructions and "TEST FIT" the parts without cementing. This will familiarize you with the location of parts.

For best results, the various sub-assemblies and components should be painted before any "CHROME" parts are attached. For example: When attaching "NON CHROME" engine parts, it is best to cement them in place and paint as a unit. **"CHROME" PARTS ARE INDICATED BY (C).**

AMT® kits are molded from the finest high-impact styrene plastic. Use only paint and cement made for styrene. Trim excess plastic from parts before joining. When attaching "CHROME" or painted parts, scrape plating or paint away where parts are to be joined. Cement all parts unless otherwise indicated by the instructions. Use just enough cement to join parts and be careful not to smear cement on exposed surfaces.

Built according to the instructions on this sheet, you should have no trouble assembling your kit. Just **FOLLOW THE NUMBERS** as the instructions are numbered in order of assembly.

PAINT COLORS

A Black	H Aluminum	O Transparent Red	V Dark Blue	BC Body Color
B Flat Black	I Steel	P Orange	W Transparent Blue	IC Interior Color
C Semi-Gloss Black	J Brass	Q Yellow	X Lt. Green	▲ Semi-Gloss
D White	K Gold	R Tan	Y Dark Green	△ Gloss
E Flat White	L Amber	S Brown	Z Gray	▲ Metallic
F Silver	M Transparent Amber	T Lt. Blue	AA Purple	
G Chrome (Bright Silver)	N Red	U Med. Blue	BB Beige	



Ford Motor Company Trademarks and Trade Dress used under license to Round 2, LLC. Goodyear (and wing foot design) and Eagle are trademarks of The Goodyear Tire & Rubber Company, Akron, Ohio USA used under license by Round 2, LLC. Firestone and F Shield Logo are registered trademarks of BFS Brands, LLC and are used with permission. AMT and design is a registered trademark of Round 2, LLC. ©2016 Round 2, LLC, South Bend, IN 46628 USA. Product and packaging designed in the USA. Made in China. All rights reserved.

I. ENGINE

STOCK & VINTAGE RACING

Use * parts for racing version

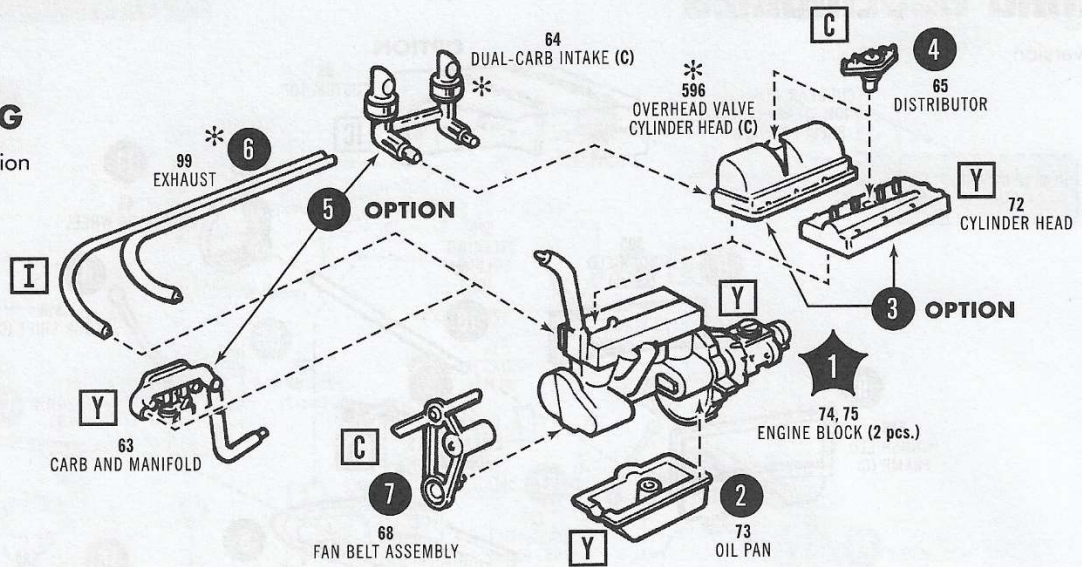

STREET ROD

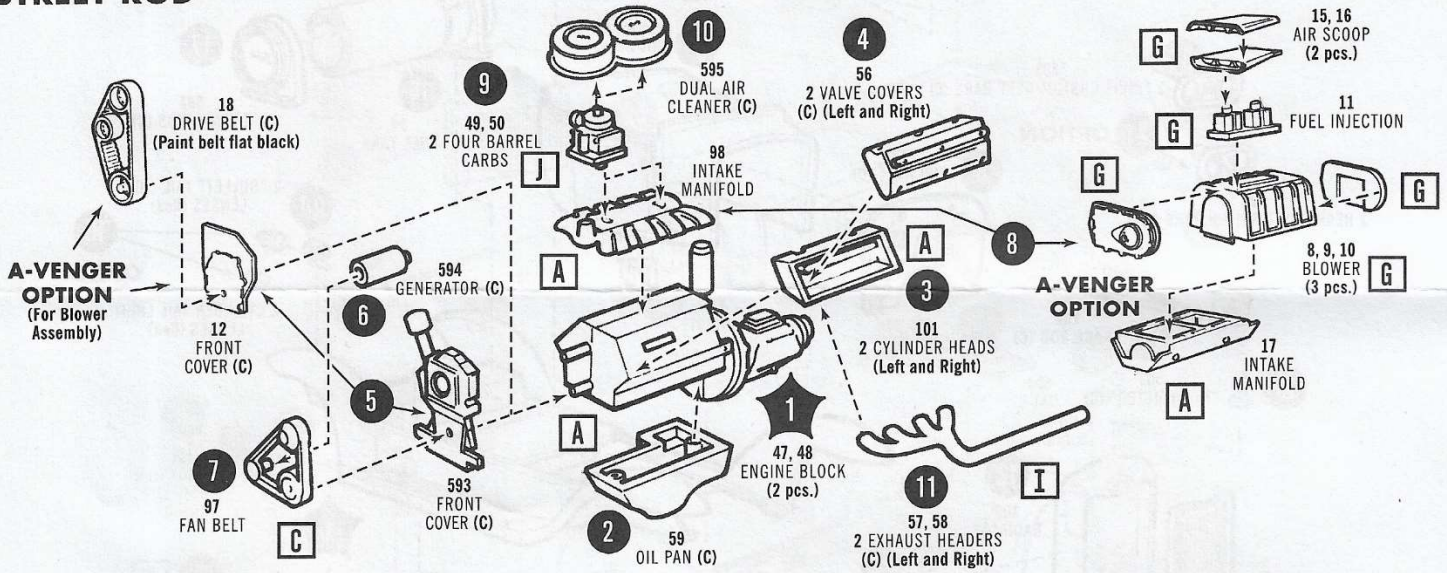

2. WHEELS

STOCK

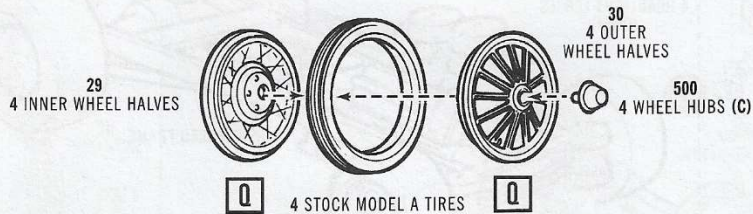

STREET ROD

Mod Rod & A-Venger version

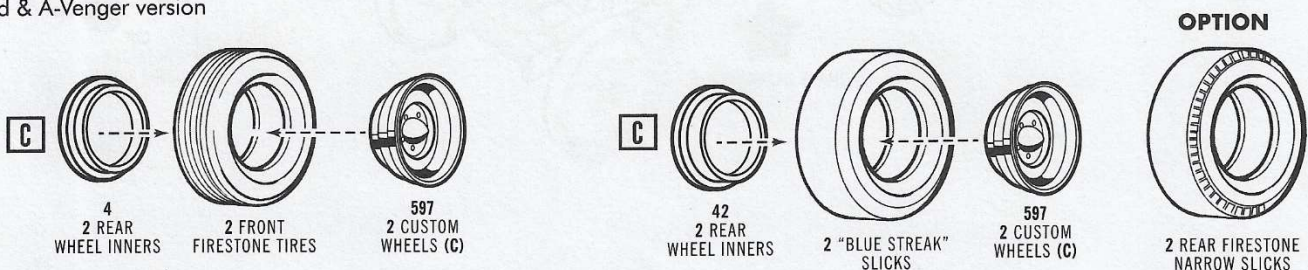

3. CHASSIS

STOCK & VINTAGE RACING

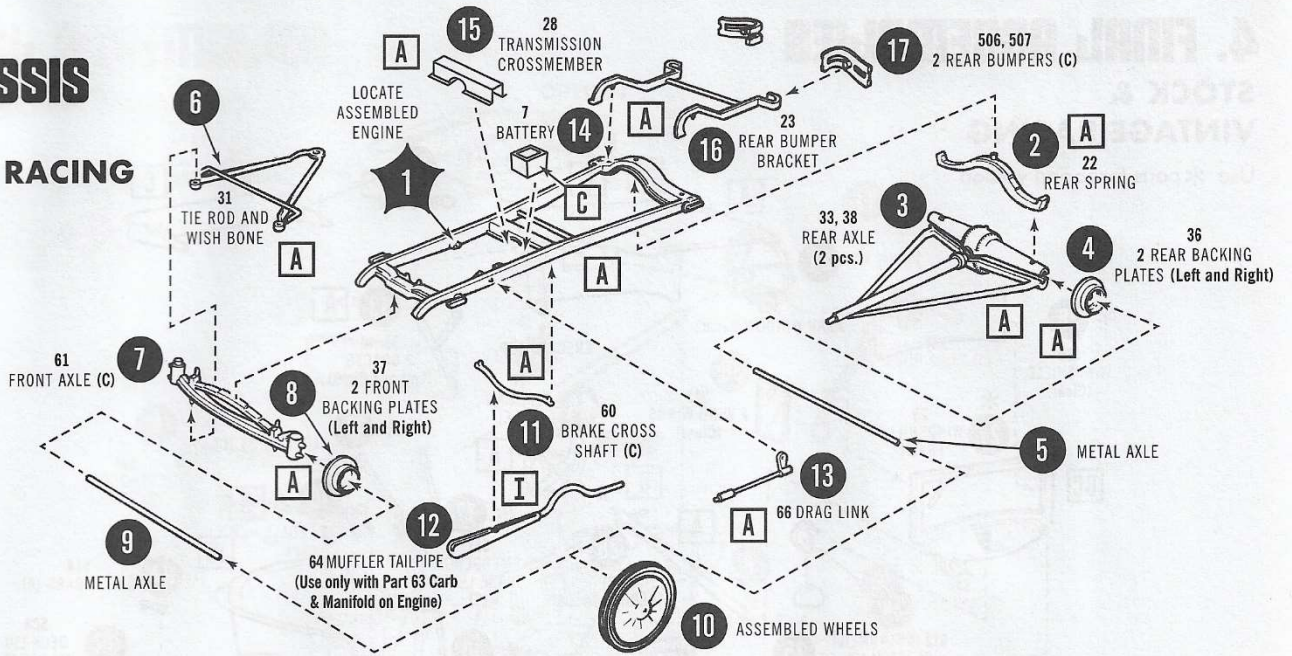

STREET ROD

Mod Rod version

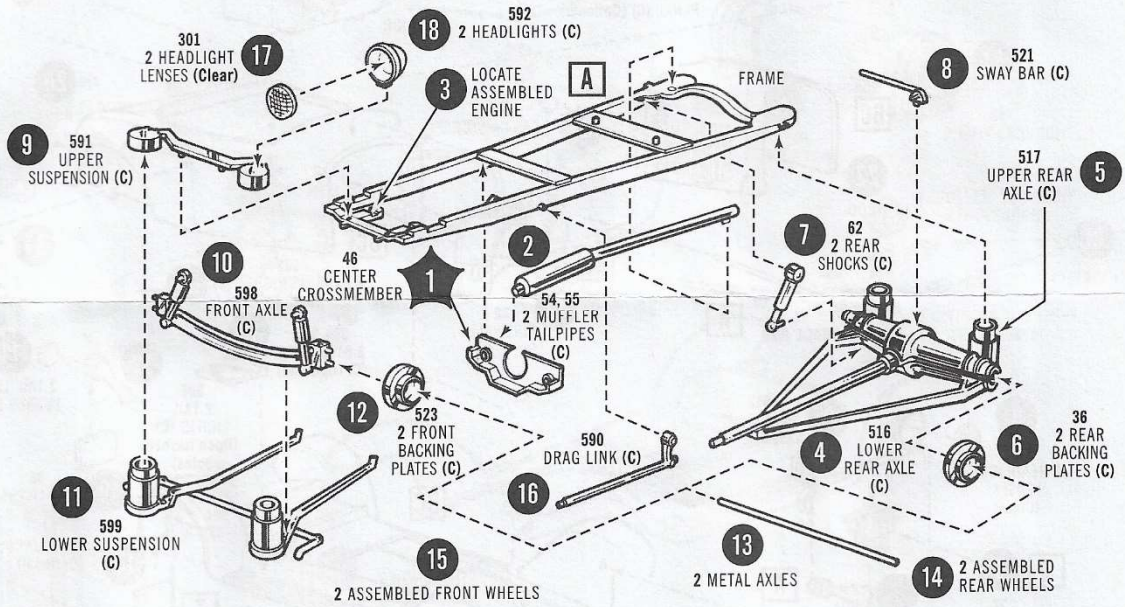

STREET ROD

A-Venger version

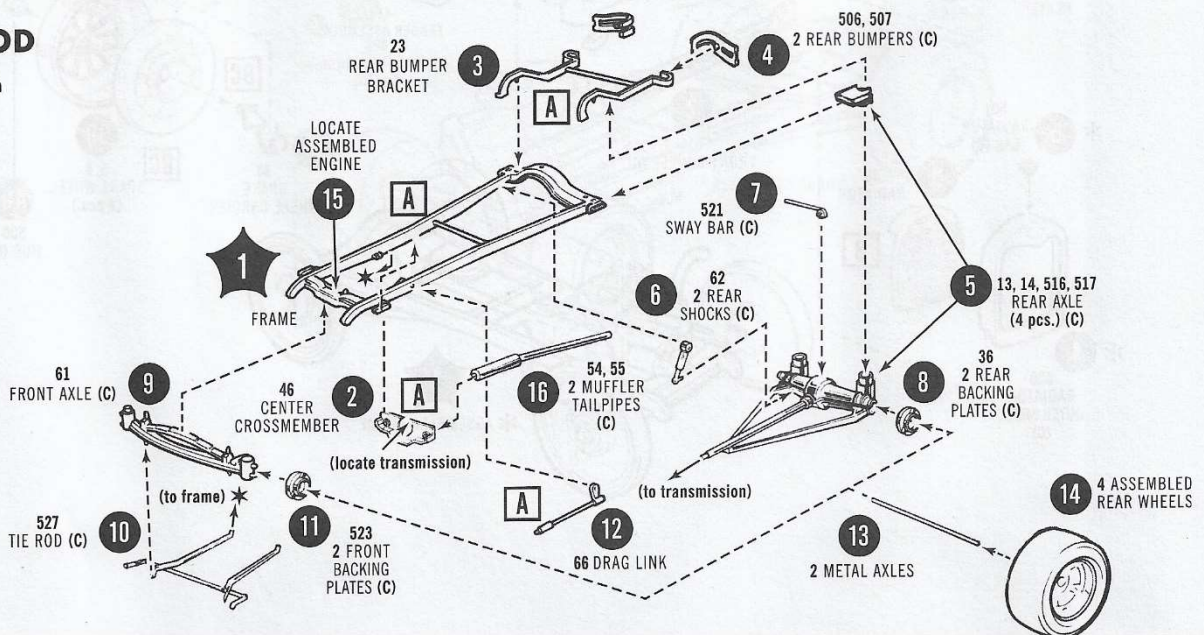

4. FINAL ASSEMBLIES

STOCK & VINTAGE RACING

Use * parts for racing version

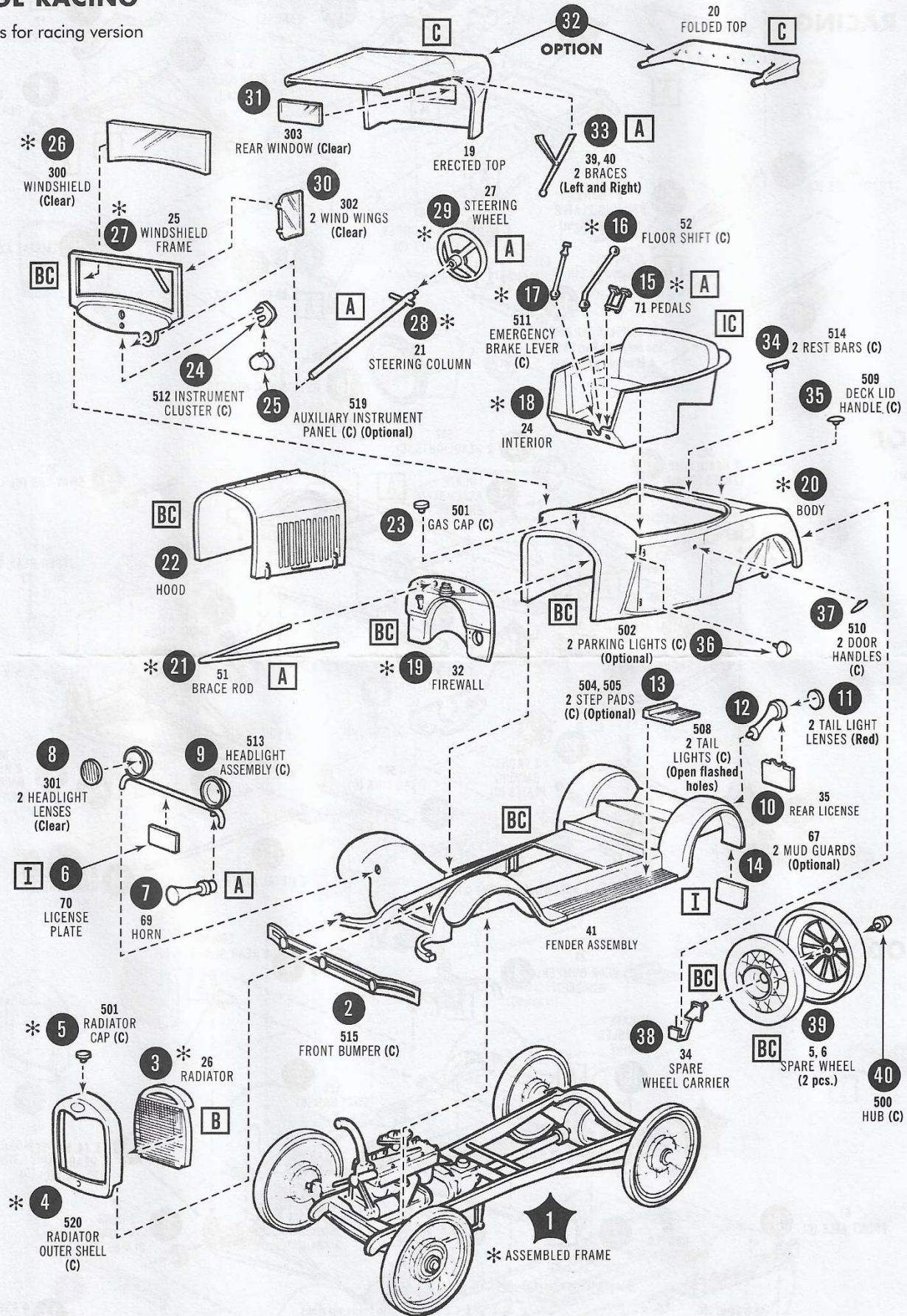

4. FINAL ASSEMBLIES

Mod Rod version

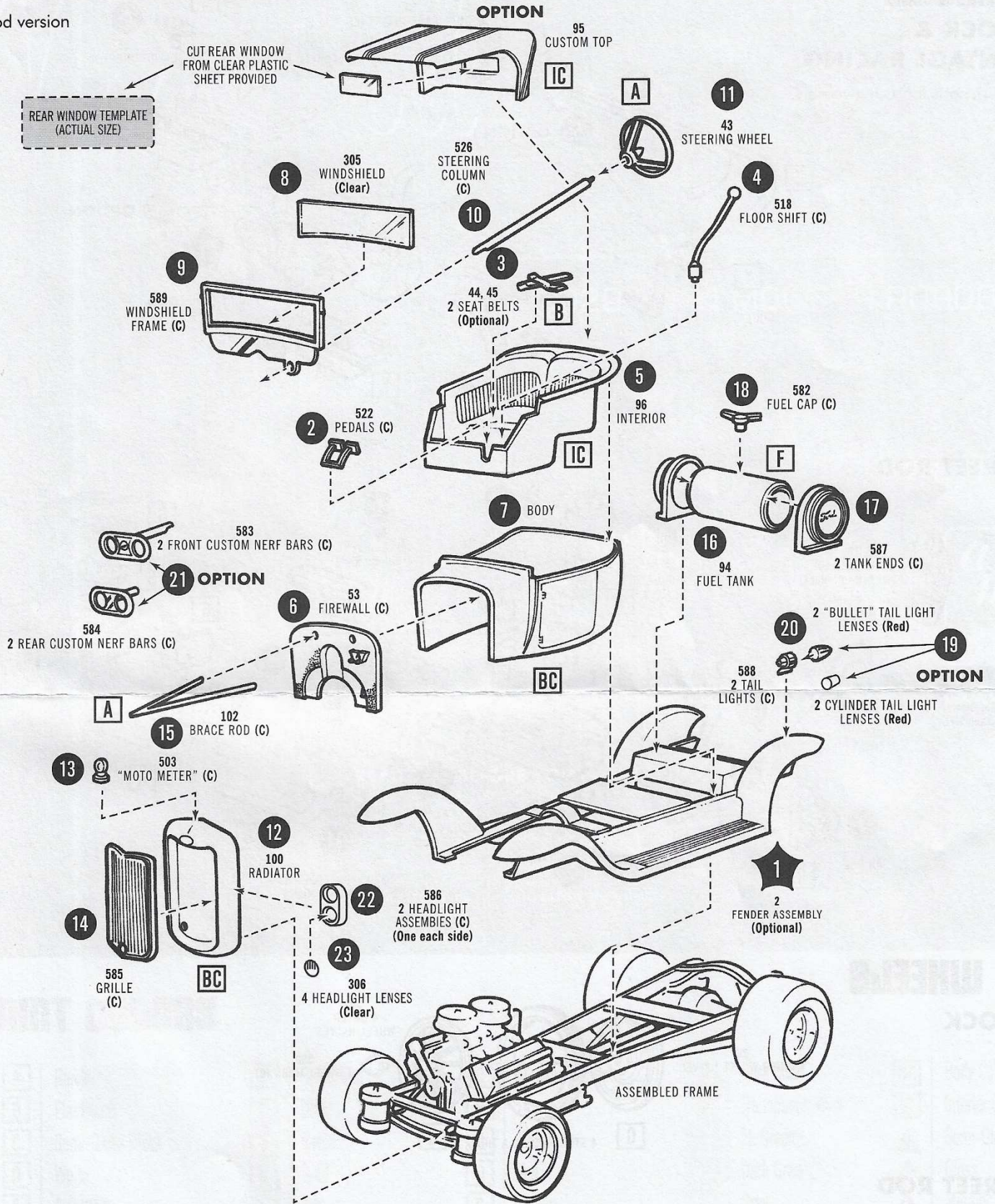

FINAL ASSEMBLIES

A-Venger version

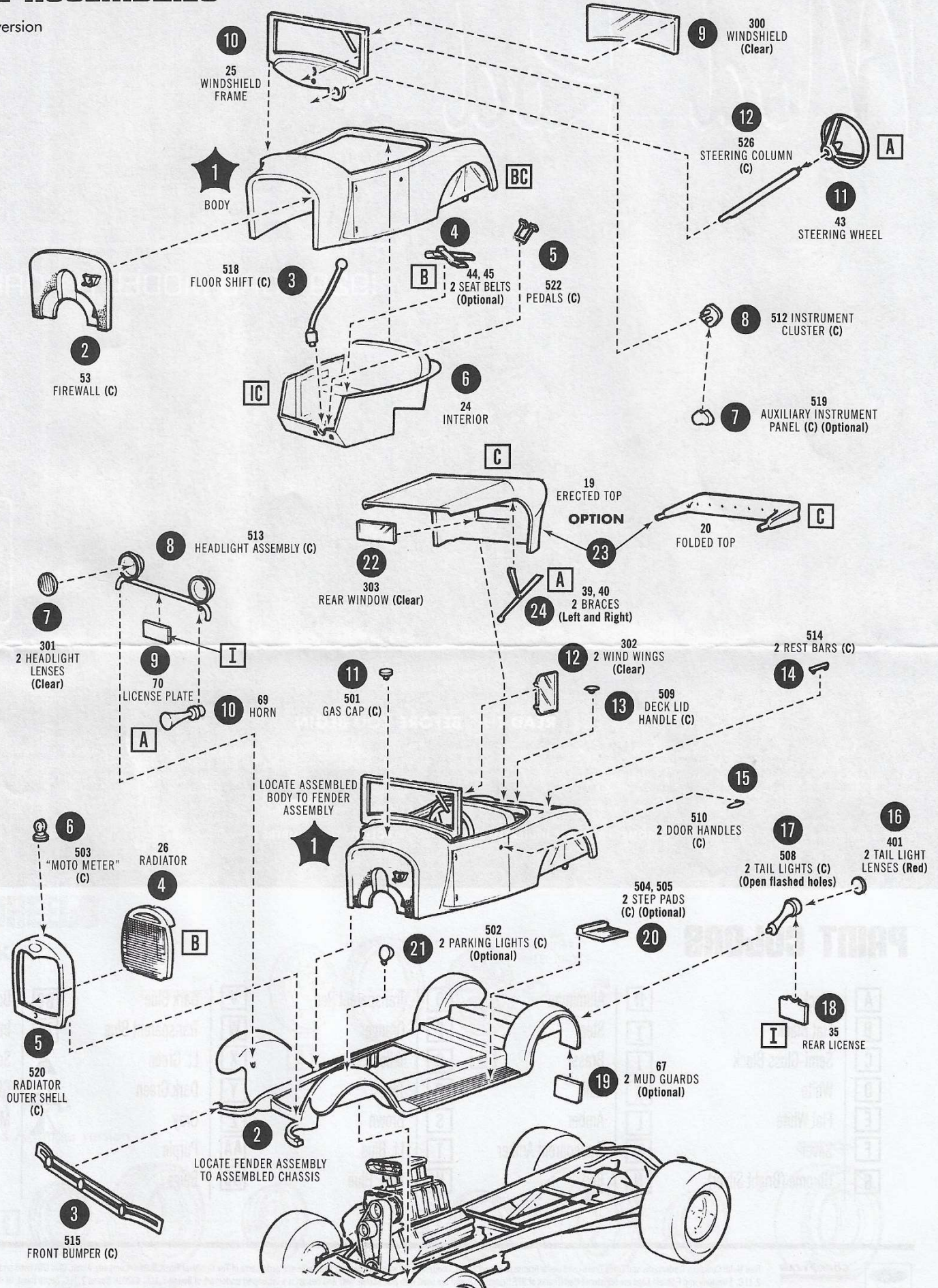



1/25 SCALE PLASTIC MODEL KIT / KIT MAQUETTE EN PLASTIQUE À L'ÉCHELLE 1/25 / KIT DE MODELISMO DE PLÁSTICO ESCALA 1/25



FEATURES • CARACTÉRISTIQUES • MERKMALE • CARACTERÍSTICAS • CARATTERISTICHE

ENG Fun to assemble model kit. Contents include: All plastic pieces necessary and pictorial instructions describing assembly. Skill Level 2 - Ages 10 and over. Paint and cement required.

FSP Kit de modelo divertido de armar. Contiene: Todas las piezas plásticas que se necesitan para completar el modelo e instrucciones con imágenes que describen el armado. Nivel de habilidad 2 - Edades de 10 y más. Se necesitan pintura y cemento.

FRA Kit Maquette amusant à monter. Contient de la boîte : Toutes les pièces en plastique pour l'assemblage de la maquette ainsi que les instructions illustrées qui décrivent la méthode. Niveau de difficulté 2 - 10 ans et plus. Peinture et colle requises.

ITA Modello divertente da assemblare. Contiene: Tutti i pezzi di plastica necessari per completare il modello, istruzioni per l'assemblaggio per immagini. Livello di abilità 2 - Età superiore ai 10 anni. Necessari vernice e cemento.

DEU Modellbausatz der Spaß macht. Inhalt: Alle Kunststoffteile zur Fertigstellung des Modells sowie eine Aufbauanleitung mit Illustrationen. Schwierigkeitsgrad 2 - Ab 10 Jahren. Lack und Kleber nicht enthalten.

PRT Kit de modelo de montagem divertida. Conteúdo inclui: Todas as peças plásticas necessárias para concluir as instruções ilustradas e de montagem que descrevem a montagem. Habilidade nível 2 - 10 anos de idade ou mais. São necessárias tinta e cola.

GOOD YEAR Ford Motor Company Trademarks and Trade Dress used under license to Round 2, LLC. Goodyear (and wing foot design) and Eagle are trademarks of The Goodyear Tire & Rubber Company, Akron, Ohio USA used under license by Round 2, LLC. Firestone and F-Shell Logo are registered trademarks of BPS Brands, LLC and are used with permission. Other names and trademarks used under license to Round 2, LLC or by permission. AMT and design is a registered trademark of Round 2, LLC. ©2016 Round 2, LLC, South Bend, IN 46628 USA. Product and packaging designed in the USA. Made in China. All rights reserved.

WARNING: CHOKING HAZARD - Small parts. Not for children under 3 yrs.

AVERTISSEMENT : DANGER DE SUFFOCATION - Petites pièces. Ne convient pas pour les enfants de moins de 3 ans.

ADVERTENCIA: PELIGRO DE ASFIXIA - Contiene piezas pequeñas. No apto para niños menores de 3 años.

AMT 1002/12
1929 FORD MODEL A

8 49398 01143 0
01/20/2016 A1

CE

ROUND 2, LLC
4073 MEGHAN BEELER COURT
SOUTH BEND, IN 46628

INTERNATIONAL HOBBY/CRAFT (UK) LTD.
21 ST. THOMAS STREET
BRISTOL BS1 6JS ENGLAND

Manufacturing Location: Dongguan, Guangdong Province, China
Site de fabrication: Dongguan, province de Guangdong, Chine
Ubicación de la fábrica: Dongguan, provincia de Guangdong, China

round2models.com

PARTS OVERVIEW / PRÉSENTATION DES PIÈCES / VISTA GENERAL DE LAS PIEZAS

PARTS MOLDED IN YELLOW UNLESS OTHERWISE INDICATED • LES PIÈCES SONT MOLDÉES EN JAUNE SAUF INDICATION CONTRAIRE • PIEZAS MOLDEADAS EN AMARILLO A MENOS QUE SE INDIQUE LO CONTRARIO

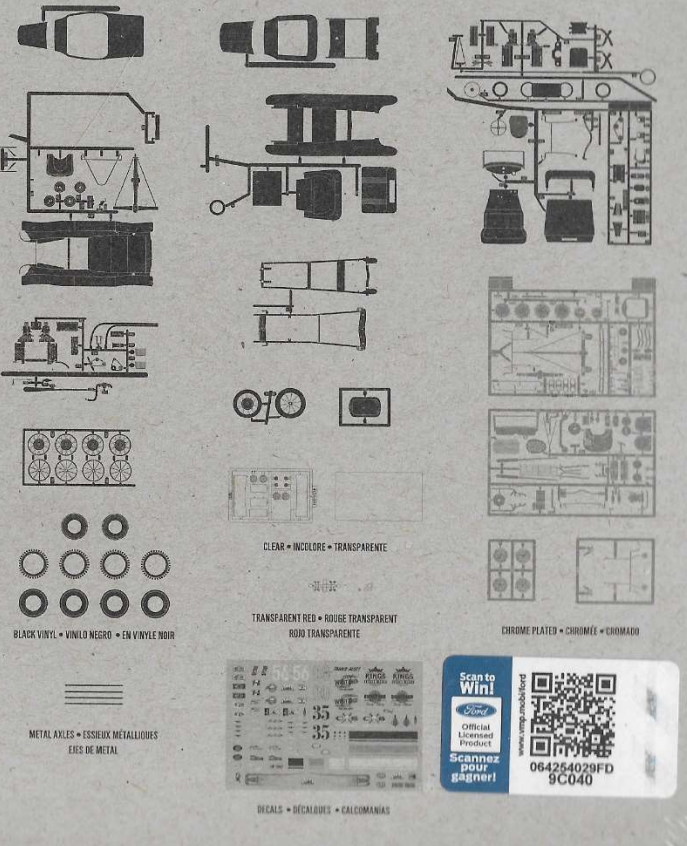

COLLECTOR # 102

1929 FORD MODEL A INSTRUCTIONS: (1) Cut out main display box along solid grey line. (2) Lightly score along dotted fold lines. (3) Add drops of glue to white dots. (4) Follow the numbers 1 - 4 and carefully fold the fit portion together, making sure all sides are aligned and the glue is properly applied. (5) Repeat steps 1-4 for the remaining numbers 5-7. (6) Glue bottom panel flaps into the fit. Allow to dry. (7) Display with your built model!

AMT'S 1929 FORD MODEL A IS COMPLETE WITH A "KART-LOAD" OF KOOL CUSTOMIZING COMPONENTS! BUILD IT AS AN EARLY HOT ROD WITH "STOCK" ENGINE OR A RADICAL FULL-POWERED ROADSTER!

4 KITS IN ONE... 2 COMPLETE CARS!

MOD ROD BOSS ROADSTER

MODEL "A" '29 FORD ROADSTER

MOD ROD BOSS ROADSTER

MOD ROD BOSS ROADSTER

FEATURING: 4-BARREL VEEVEE ENGINE • 1/25 SCALE FULL-POWERED ROADSTER • 1/25 SCALE MODEL

A1002P-MB

KINGS CUSTOM BODY

BOMFORD

WEST END

STP

MOD ROD

56 56 35 35

AMT