

 www.fb.com/bigplaneskits

 www.bigplaneskits.com

 e-mail: bigplaneskits@gmail.com

PLASTIC MODEL KITS CAT.NO. 7215



**1/72
SCALE**

SPAN: 549 mm. • LENGTH: 476 mm. • PARTS: 261 pieces

Boeing 737-800 став подовженим варіантом модифікації 737-700, а замінює 737-400, відрізняється від останнього новим крилом, хвостовим оперенням, цифровим кокпітом та більш досконалішими двигунами. Boeing 737-800 експлуатується в авіакомпаніях з квітня 1998 р. та продовжує вироблятися серійно. При цьому 737-800 є найпопулярнішою моделлю серед всіх літаків покоління NG. На базі літака також розроблені та виробляються: салонний бізнес-варіант BBJ2 (Boeing Business Jet 2) та військова модифікація Boeing 737-800ERX.

The Boeing 737-800 became an extended version of the 737-700 modification and replaced the 737-400, differs from the latter with a new wing, tail, digital cockpit and more advanced engines. The Boeing 737-800 has been operating in airlines since April 1998 and continues to be mass-produced. At the same time, the 737-800 is the most popular model among all aircraft of the NG generation. On the basis of the aircraft, the following are also developed and produced: cabin business option BBJ2 (Boeing Business Jet 2) and military modification of the Boeing 737-800ERX.

Технічні характеристики:

- Довжина - 34,3 м; Розмах - 39,5 м; Висота - 12,5 м;
- Злітна вага (макс.) - 79000 кг;
- Комерційне навантаження - 20540 кг;
- Дальність польоту - 5400 км;
- Крейсерська швидкість - 850 км/ч;
- Макс. висота польоту - 12 500 м;
- Кількість крісел - 160-189.

Technical specifications:

- Length - 34.3 m; Span - 39.5 m; Height - 12.5 m;
- Take-off weight (max) - 79000 kg;
- Payload capacity - 20540 kg;
- Range - 5400 km;
- Cruising speed - 850 km/h;
- Ceiling - 12 500 m;
- Number of seats - 160-189.

USED SYMBOLS / ВИКОРИСТОВУВАНІ СИМВОЛИ

1 STAGES OF ASSEMBLY
ЕТАПИ СБОРКИ

A1 NUMBER PARTS
НОМЕР ДЕТАЛІ

A TO PAINT
ОКРАСИТЬ

1 APPLY DECALS
НАНЕСТИ ДЕКОЛЬ

 GLUE
КЛЕИТЬ

 DON'T GLUE
НЕ КЛЕИТЬ

 OPTIONAL
ВАРИАНТИ

 MAKE A HOLE
СВЕРЛИТЬ

 DETACH WITH KNIFE
ОТДЕЛИТЬ НОЖОМ

 SHAPE WITH HOT KNIFE
ФОРМОВАТЬ ГОРЯЧИМ НОЖОМ

2x QUANTITY OF OPERATIONS (PARTS)
ПОВТОРЕННЯ ОПЕРАЦІЙ (ДЕТАЛЕЙ)

COMPLETE SET / КОМПЛЕКТНОСТЬ

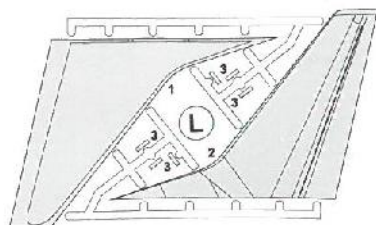
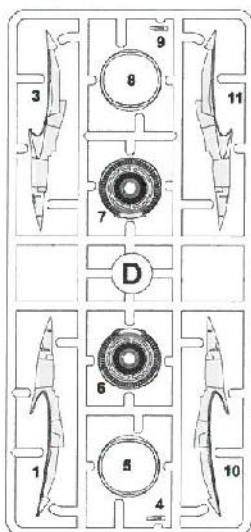
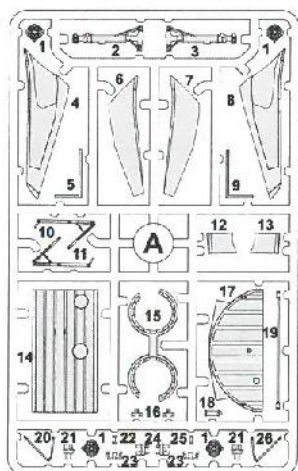
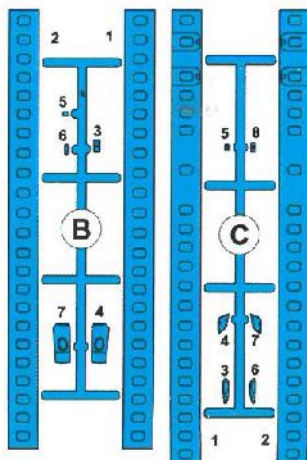
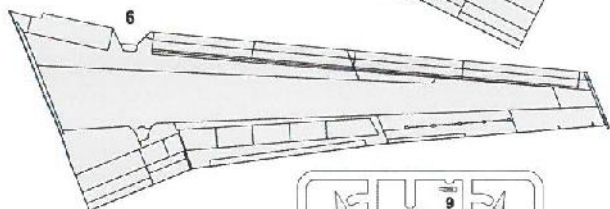
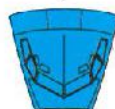
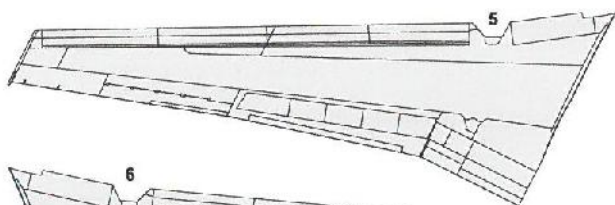
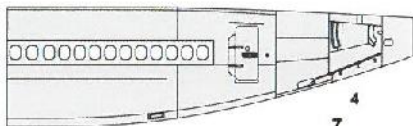
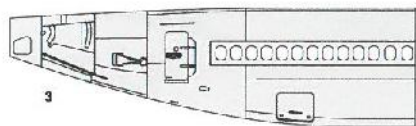
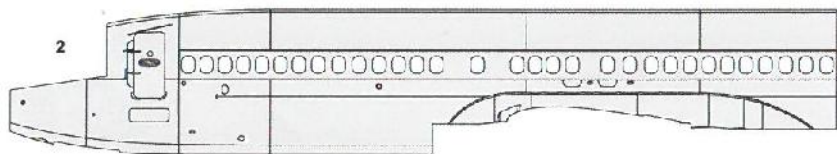

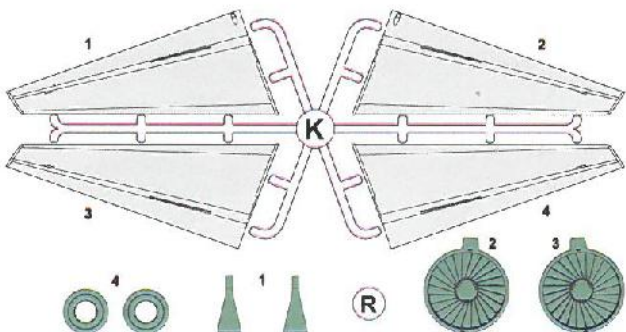
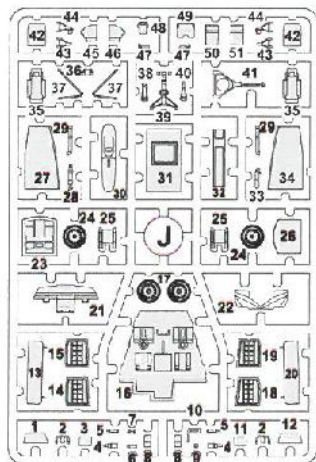
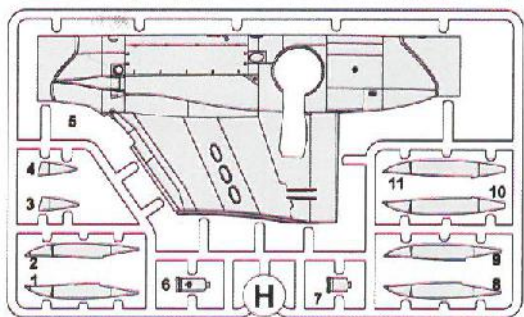
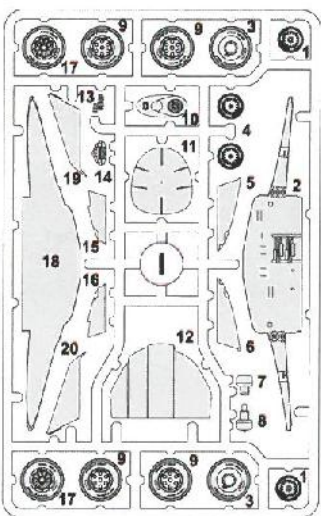
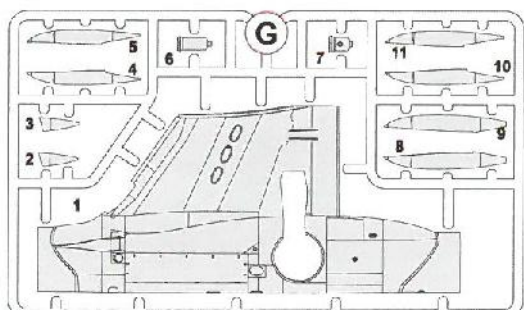
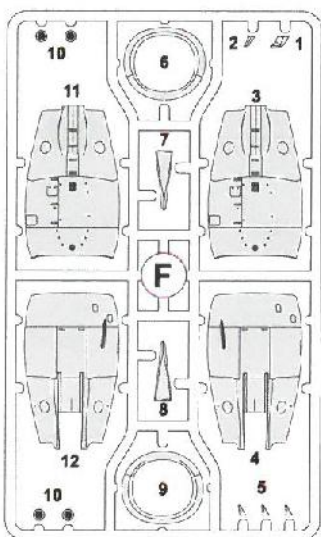
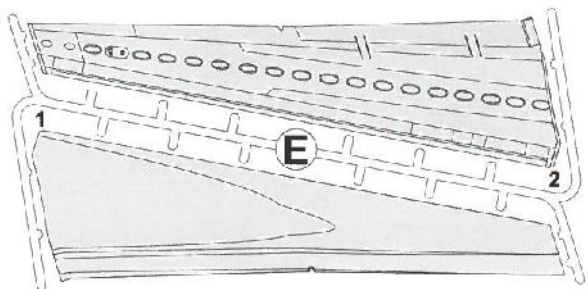

THE SCHEME OF ASSEMBLY / СХЕМА СБОРКИ

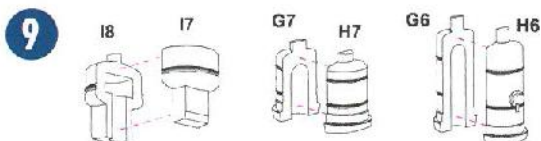
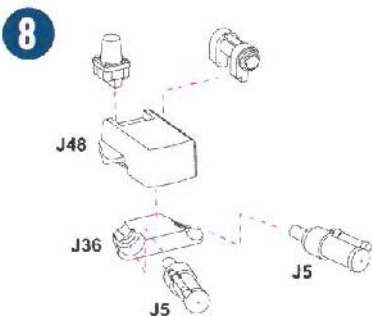
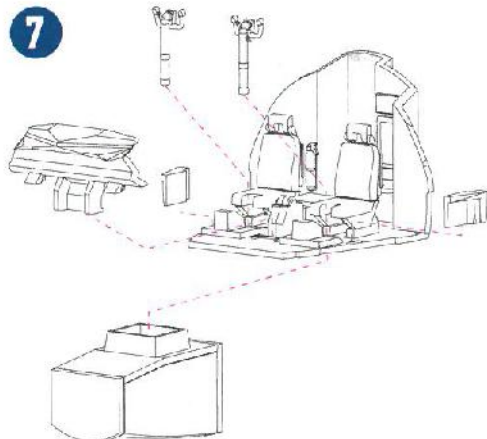
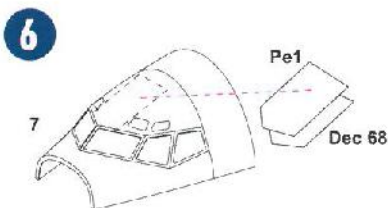
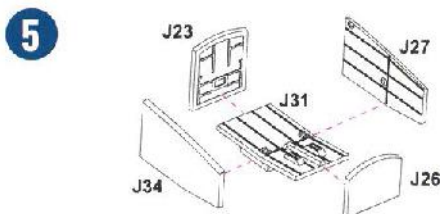
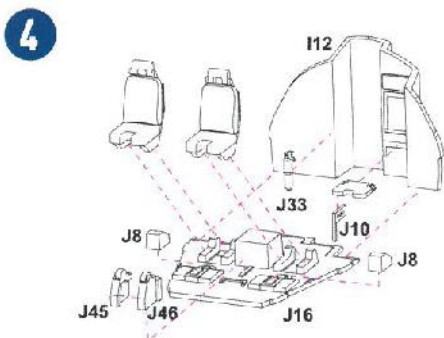
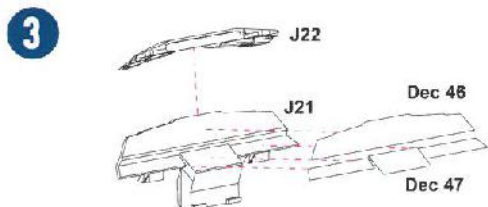
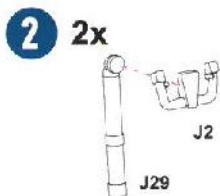
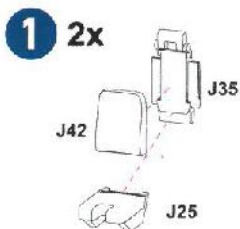

10 2x

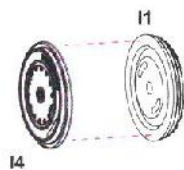
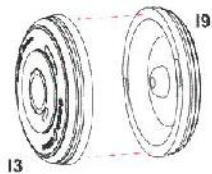
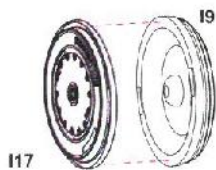

11

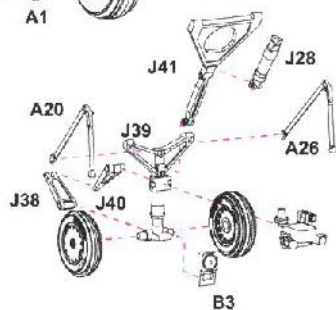
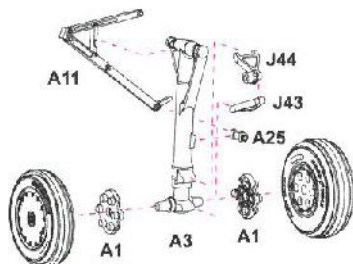
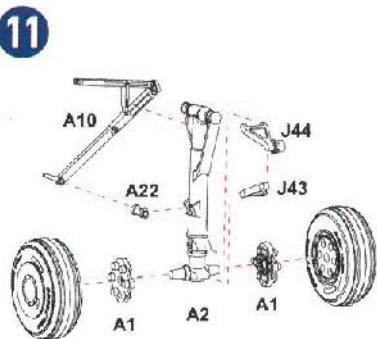

12

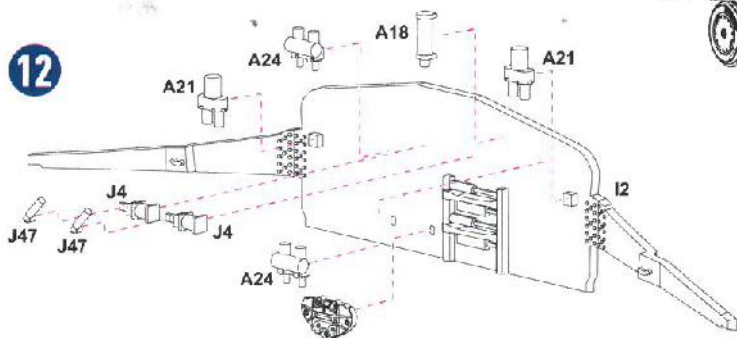

13

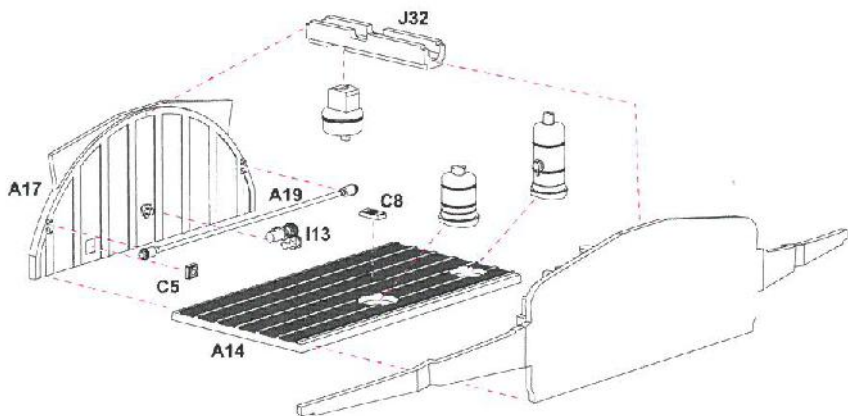

Boeing 737-838, VH-VXM, Qantas Airways,
Melbourne Tullamarine Int'l Airport, Australia, Dec 26, 2018

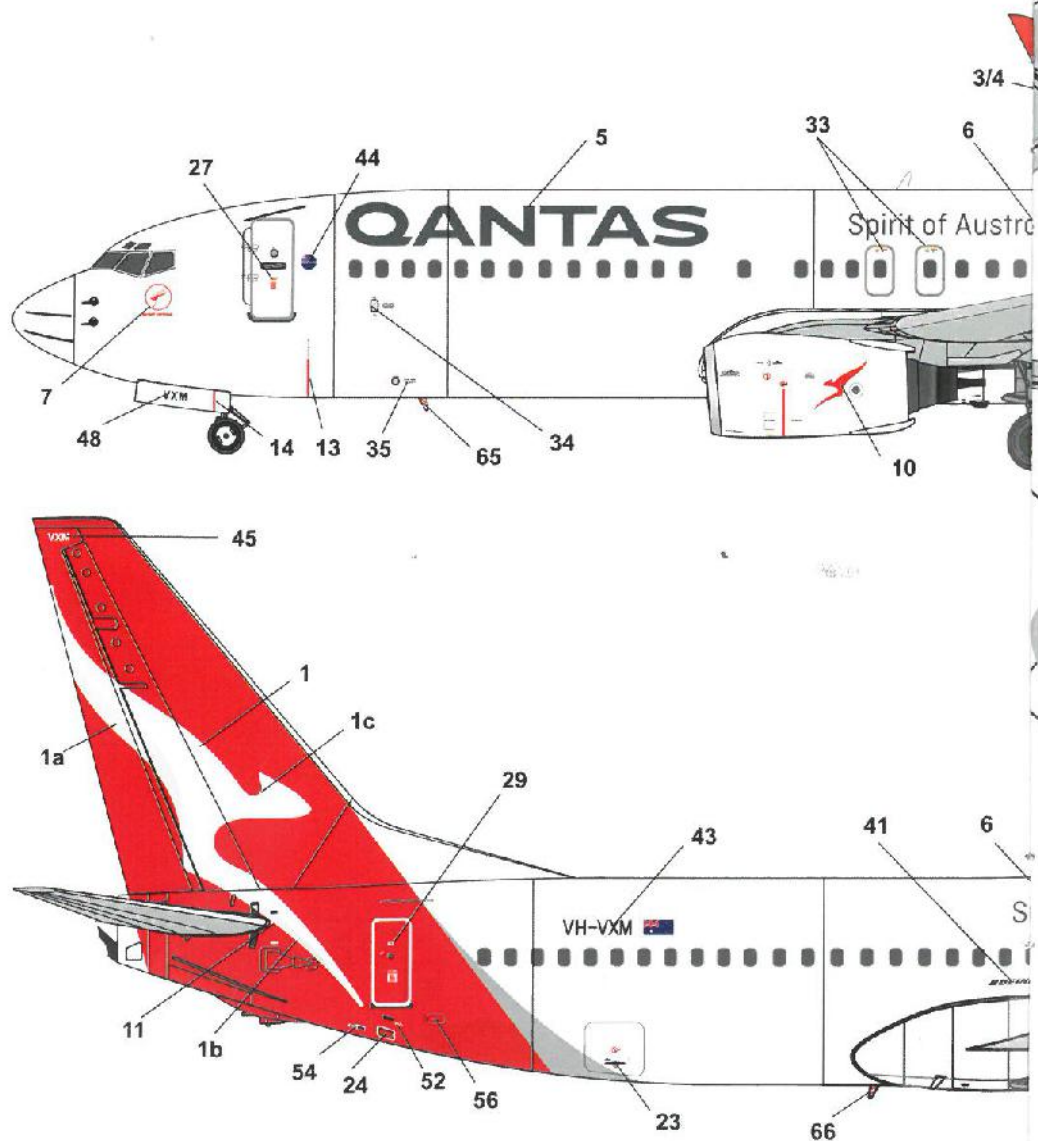

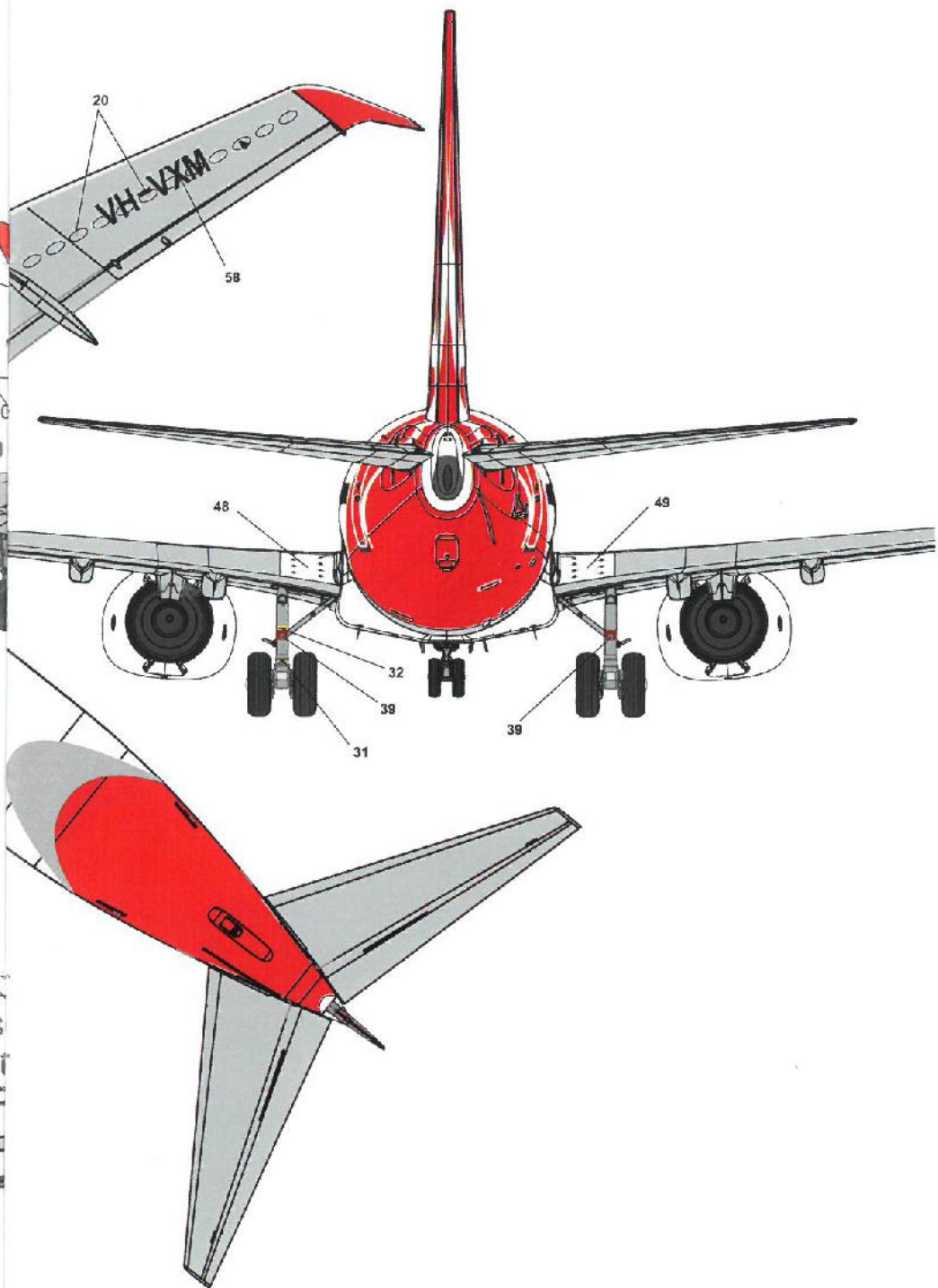

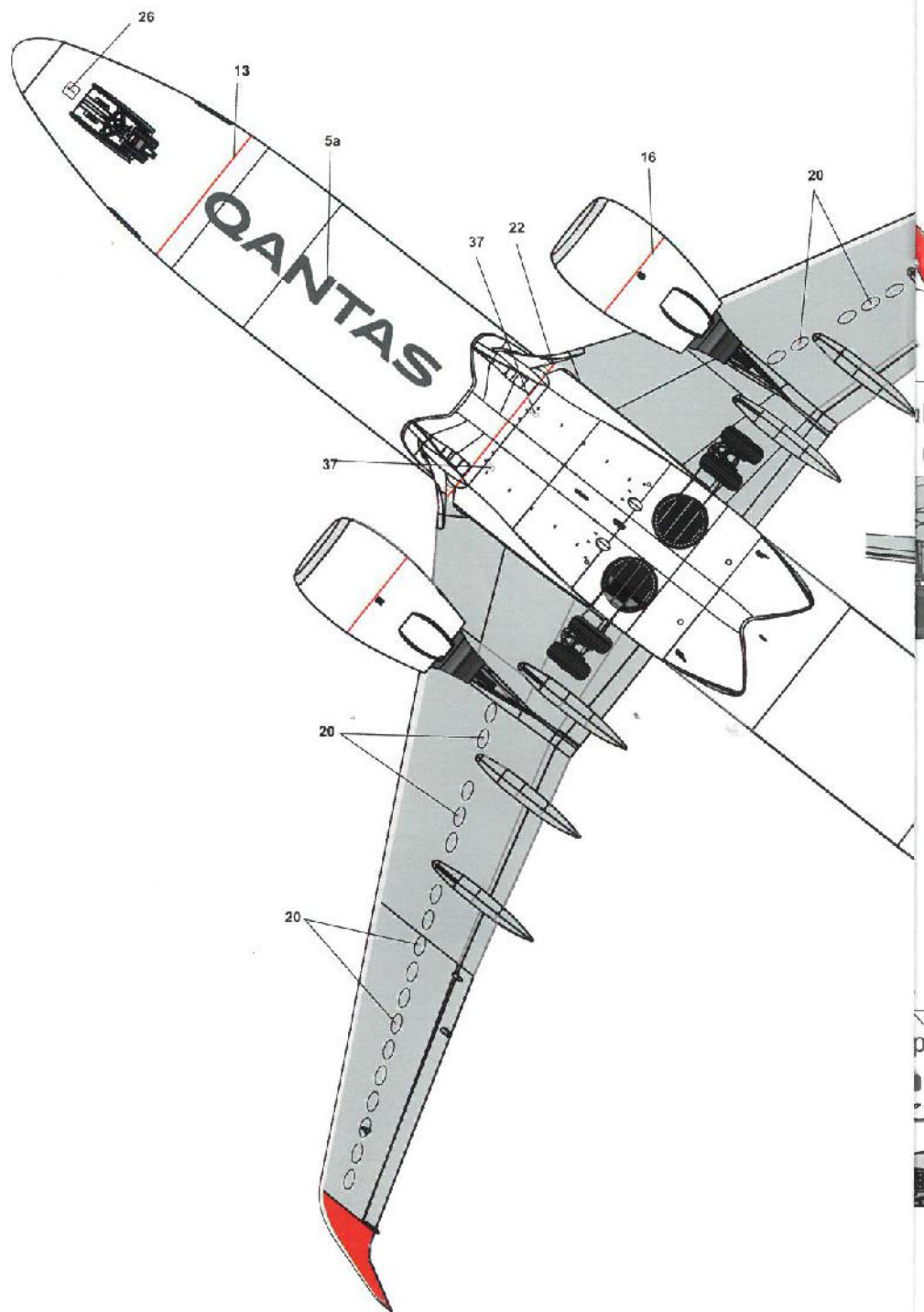

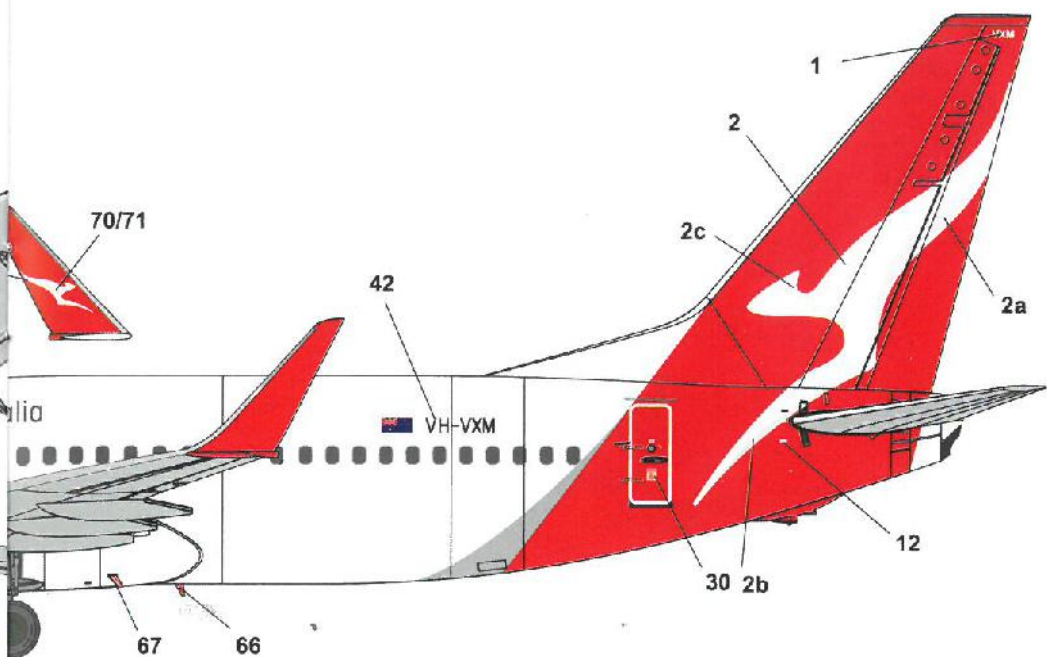

Boeing 737-838, VH-VXM, Qantas Airways,
Melbourne Tullamarine Int'l Airport, Australia, Dec 26, 2018

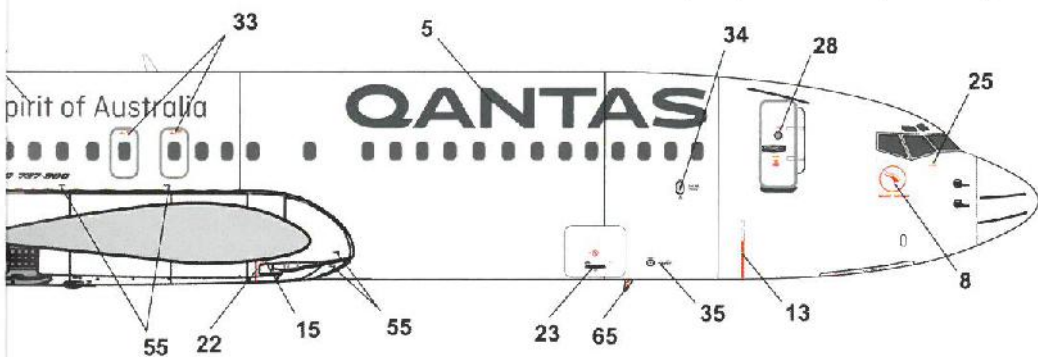

14

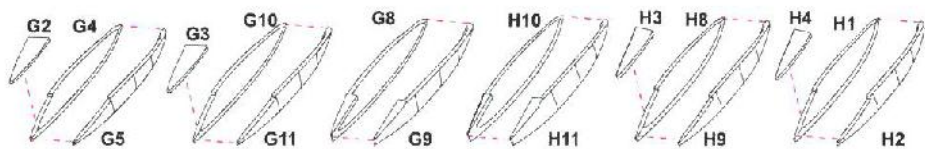

15

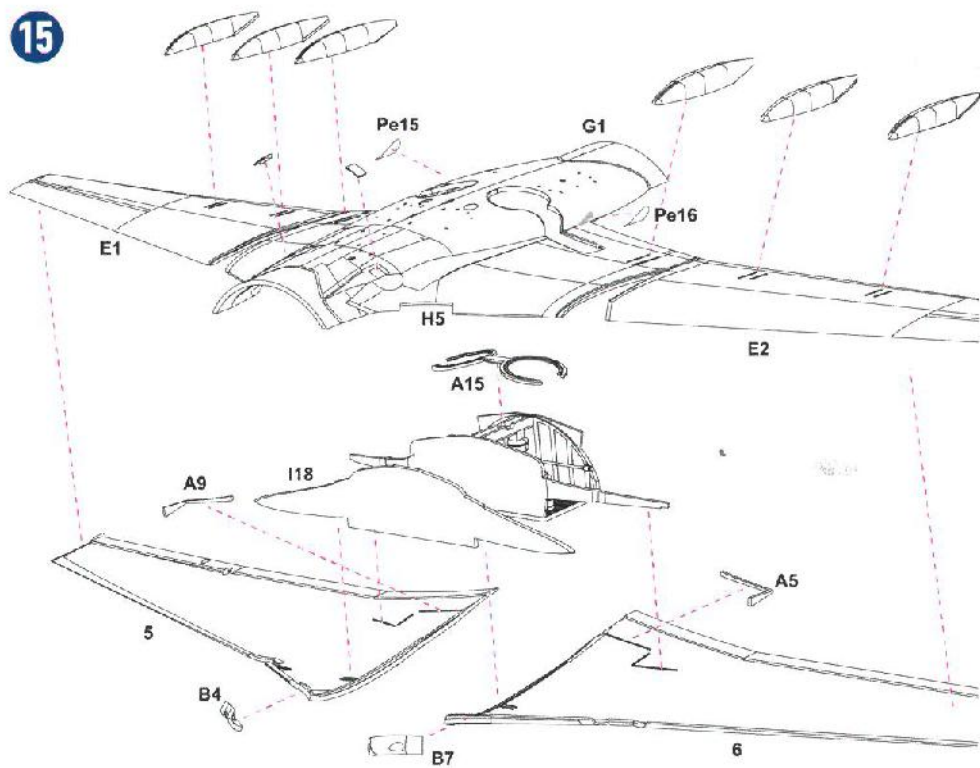

16

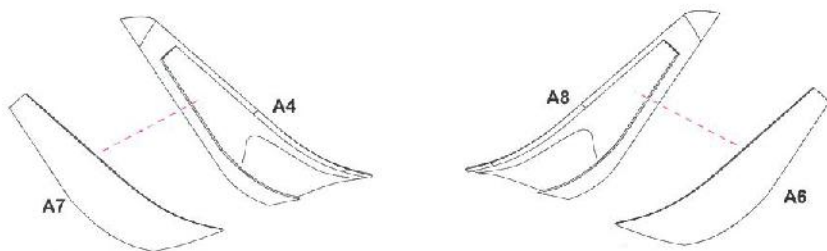

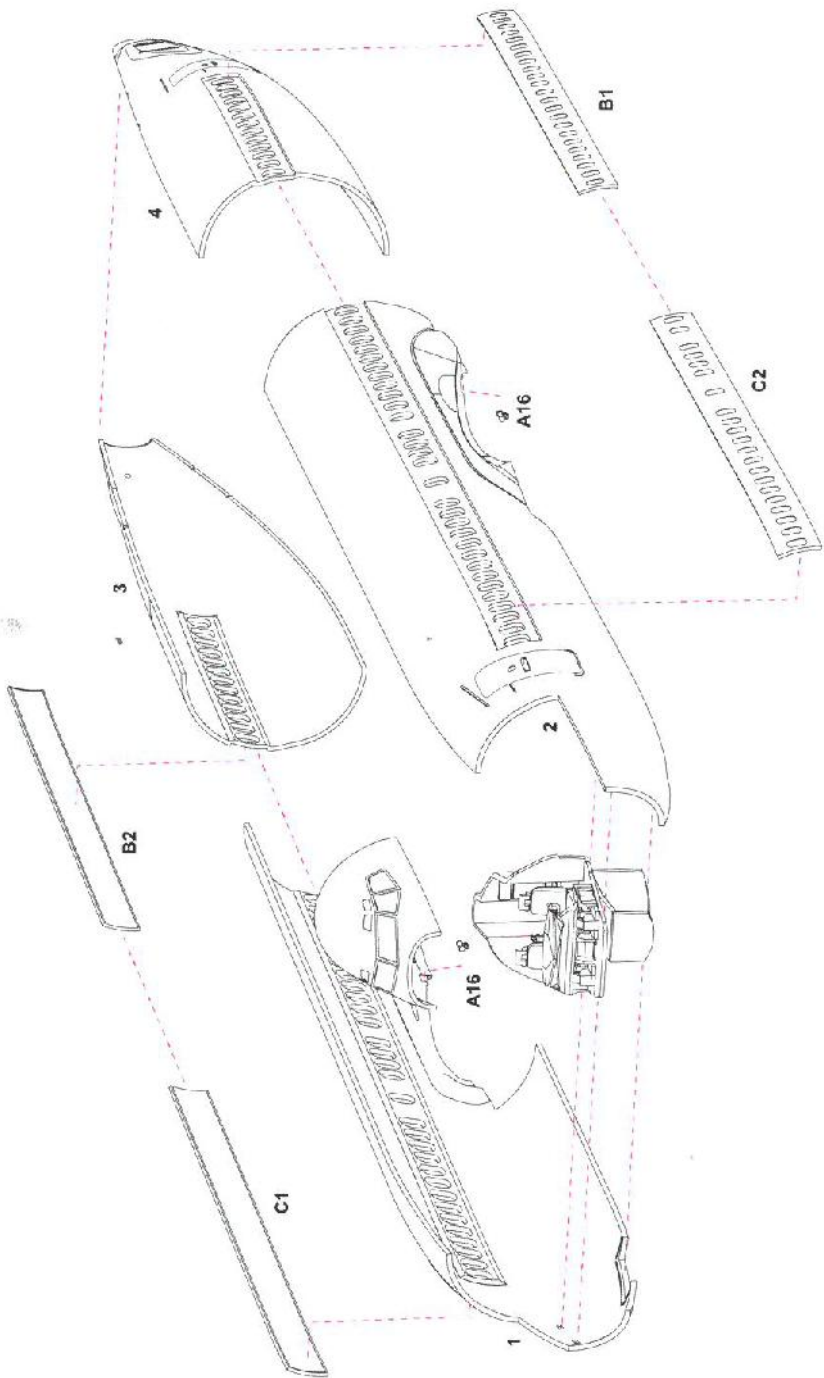

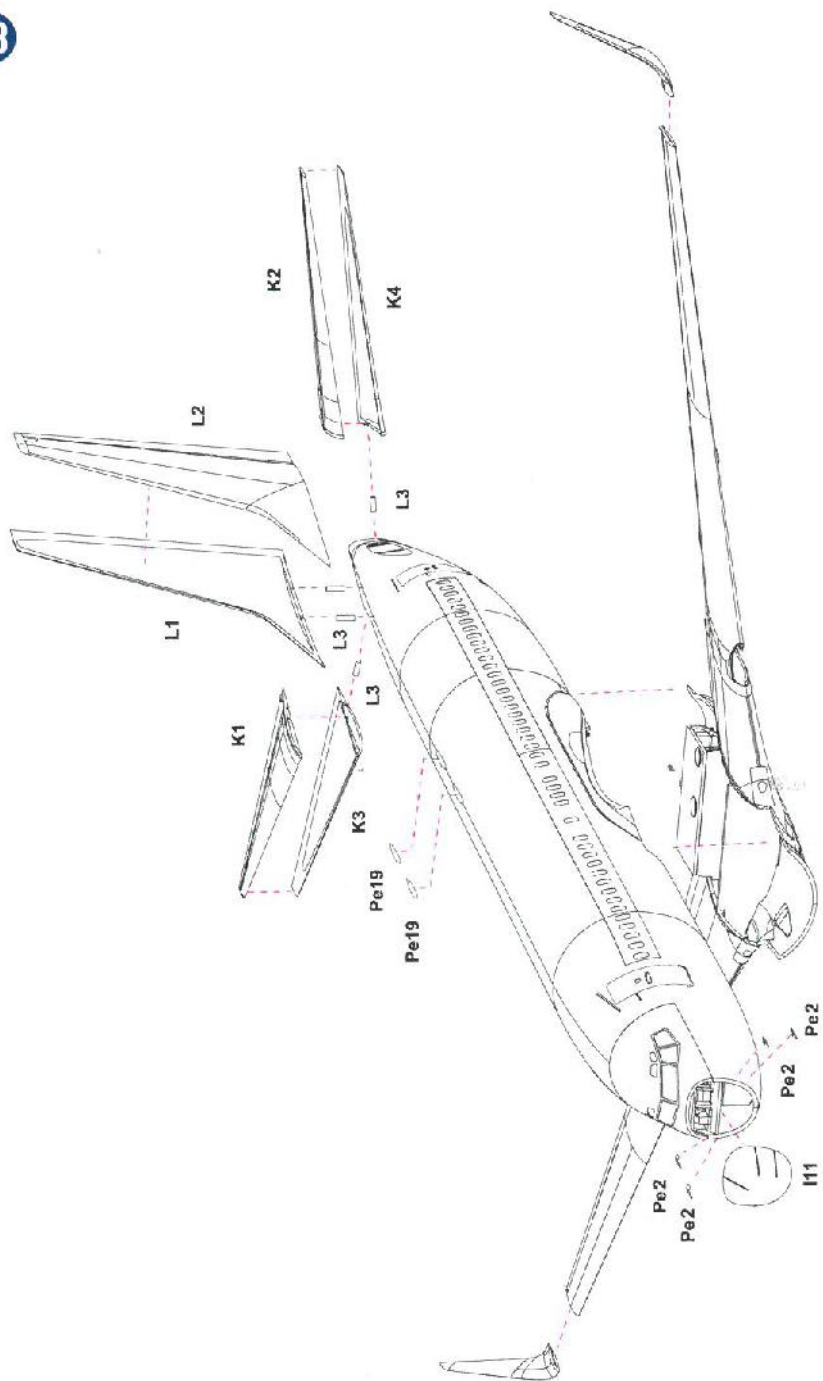

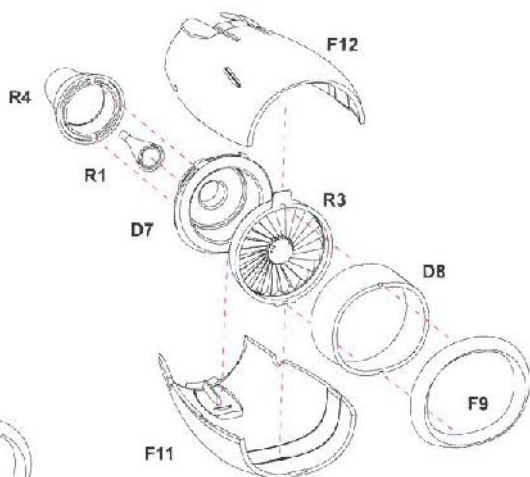
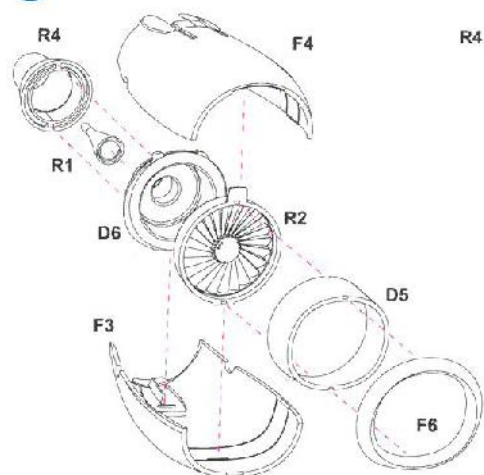
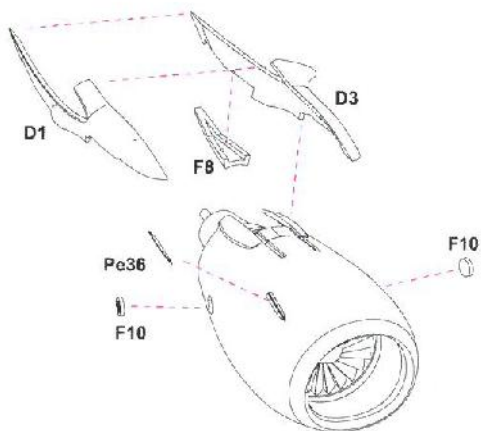
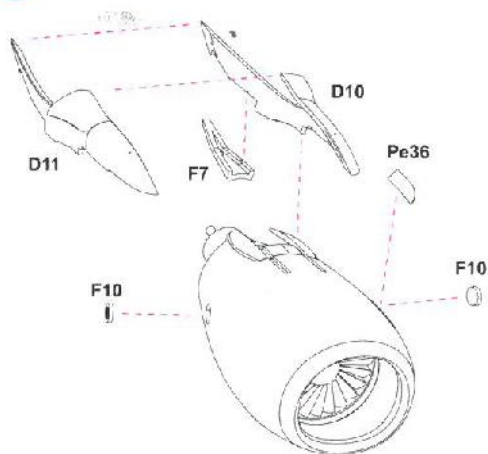
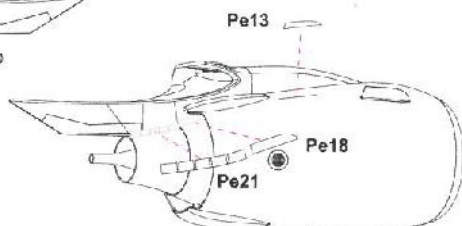
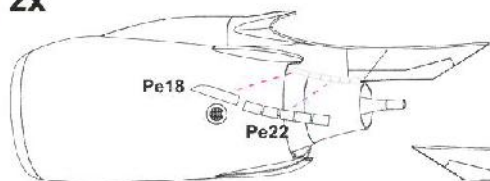
19**20****21 2x**

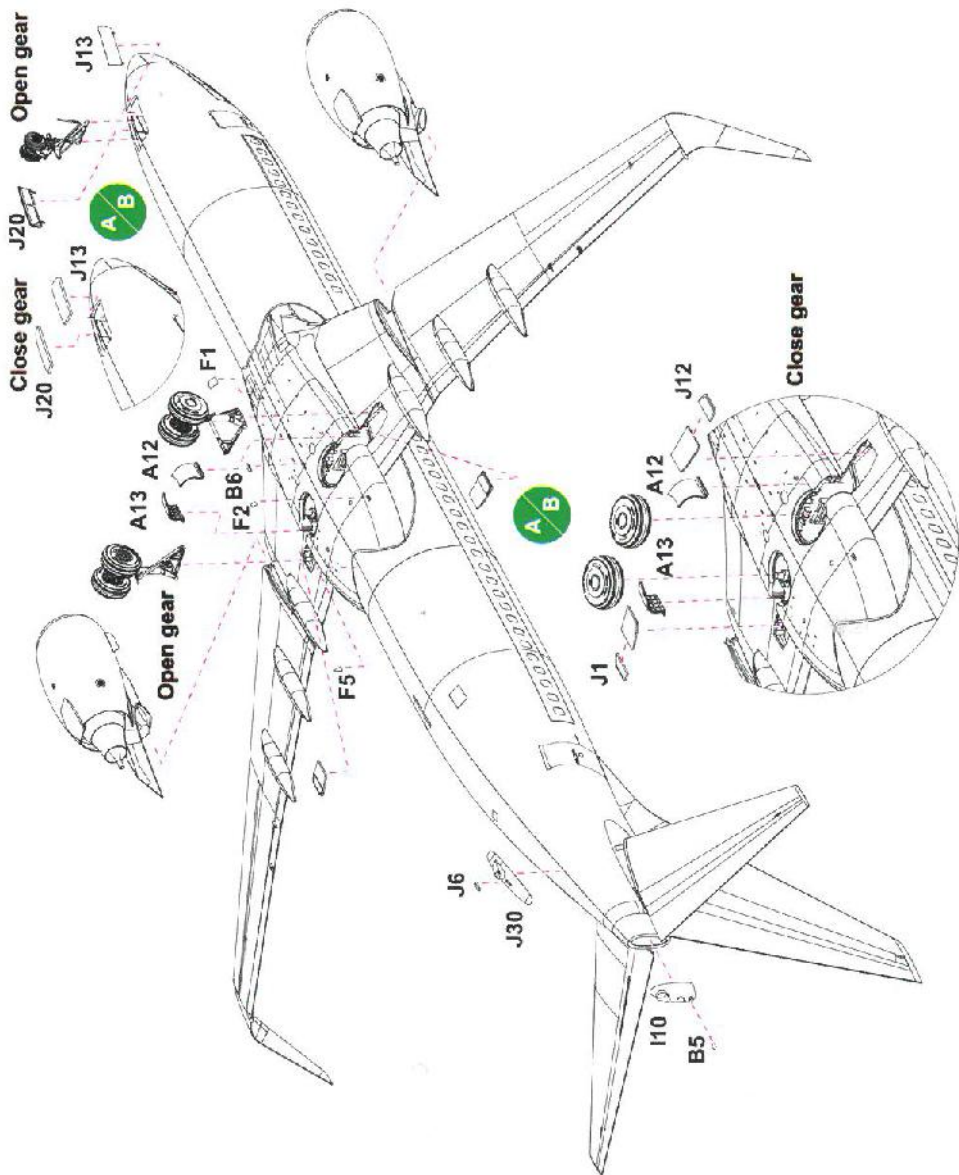

QANTAS QANTAS QANTAS

VH-VXM

VXM VXM
VXM VXM

BPB 7218
Boeing 737-800



Spirit of Australia
Spirit of Australia



65
14
25
26
22
21
66
31
32
66
62
60
48
67
38
57
56
50
53
52
36
55
24

55
36
67
59
68
69
53
44
4
2
31
4
1
3
10
11
12
41

BOEING 737-800
BOEING 737-800
BOEING 737-800

VH-VXM