

MONOGRAM**1996 MUSTANG COBRA CONVERTIBLE**

KIT 2460

1/25 SCALE

MASSTAB 1:25

ESCALA 1/25

1/25 ECHELLE



2460M0200

The results are in and the all new Mustang, now in it's third year, is a decided winner. But Ford decided they just couldn't leave well enough alone and Mustang Cobra for '96 is even more of a good thing!

To Ford loyalists, merely uttering "Cobra" conjures up the demigods of Total Performance, so when the new Cobra was announced, the critics were quick to respond. And the verdict: The Cobra is a car that America can be proud of and that car enthusiasts are going to adore.

With new styling touches applied to the front fascia, hood and tail lights, the Cobra has a mean, lean look all it's own. And, of course, it's no slouch in the performance department either. With it's 32-valve DOHC V-8 4.6L engine, the new '96 Mustang Cobra will be running with the best of 'em for a long time to come.

The Cobra is back and your new Monogram kit captures this great car in every exciting detail. Long live the Mustang Cobra!

READ THIS BEFORE YOU BEGIN

- Study the assembly drawings.
- Each plastic part is identified by a number.
- In the assembly drawings, some parts will be marked by a star (*) to indicate plated plastic.
- Scrape plating from areas to be cemented.
- Check the fit of each piece before cementing into place.
- Do not use too much cement to join parts.
- Use only cement for polystyrene plastic.
- Models may be painted to match photos on box.
- Allow paint to dry thoroughly before handling parts.
- Scrape paint from areas to be cemented.
- For better paint and decal adhesion, wash the plastic parts in a mild detergent solution. Rinse and let air dry.

ALLGEMEINE HINWEISE

- Die Anordnung der Bauteile ist den Zeichnungen der Anleitung ersichtlich.
- Jedes Plastikteil ist durch eine Nummer gekennzeichnet.
- Beschichtete Teile sind in den Zeichnungen mit einem Stern (*) bezeichnet.
- Bei Beschichtung muss von allen Klebestellen vorher entfernt werden.
- Die Teile vor dem Verkleben ungeliebt zusammenhalten um ihrer Passitz zu prüfen.
- Klebstoff nicht zu dick auftragen.
- Nur Modellbaukleber für Polystyrol verwenden.
- Man Kann das Modell nach den fotos auf der schachtel anstreichen.
- Bemalte Teile vor der Weltverwendung gut trocknen lassen.
- Die Farbe muss von allen späteren Klebestellen abgeschabt werden.
- Damit sie Farbe und die Abziehbilder kleben sind die Plastikteile in einer milden Seifenlauge zu waschen. Dann abspülen und an der Luft trocknen lassen.

LEA ESTO ANTES DE EMPEZAR

- Estudie los dibujos de ensamble.
- Cada pieza de plástico se identificapor un número.
- En los dibujos de ensamble, algunos números de las piezas están marcados con una estrella (*) indicar plástico laminado.
- Raspe el laminado de las superficies que serán pegadas.
- Verifique que cada pieza encaje bien antes de posición.
- No use demasiado pegamento para unir las piezas.
- Use únicamente pegamento paraplastico de poliestireno.
- El modelo puede pintarse de acuerdo con las fotografías de la caja.
- Permita que se seque la pintura completa mente antes de tocar las piezas.
- Raspe la pintura de las superficies que serán pegadas.
- Para una mejor fijación de la pintura y de las calcomanias lèveense las piezas plásti cas en una solu-ción de detergente suave. Enjuague y dejense secar al aire.

LISEZ CE QUI SUIT AVANT DE COMMENCER LE MONTAGE

- Etudier les schémas d'assemblage.
- Chaque pièce plastique porte un numéro d'identification.
- Sur les schémas d'assemblage les pièces dont le numéro comporte une astérisque (*) sont en plastique chrome.
- Grattez le chromage sur les surfaces a coller.
- Contrôler que chaque pièce soit bien cinfirmé avant de la coller a sa pièce.
- N'utilisez pas trop de colle pour réunir les pièces.
- Utilisez uniquement une colle spéciale pour polystyrene.
- Le modèle peut être peint conformément aux photos surboite.
- Laissez sécher la peinture complètement avant de manipuler les pièces.
- Grattez la peinture sur les surfaces devant être collées.
- Pour assurer la meilleure adhésion possible de la peinture des décalomanies, laver les pièces de plastique avecune légère solution savonneuse. Rinsé et laissez sécher a l'aire.

TO COMPLETE THIS KIT AS SHOWN, WE RECOMMEND THE FOLLOWING PROMODELER PAINTS.

GLOSS RED 88-0026	GLÄNZENDES ROT	ROJO BRILLANTE	ROUGÉ LUSTRE
GLOSS GREEN 88-0006	GLÄNZENDES GRÜN	VERDE BRILLANTE	VERT LUSTRE
GLOSS WHITE 88-0002	GLÄNZENDES WEISS	BLANCO BRILLANTE	BLANC LUSTRE
STEEL 88-0015	METALLIC	METALICO	MATALLIC
SILVER 88-0013	SILBERN	PLATA	ARGENT
ALUMINUM 88-0014	ALUMINIUMFARBEN	ALUMINIO	ALUMINIUM
DESERT TAN 88-0025	GELBRAUN	CANELA	BRUN CLAIR
ENGINE BLUE 88-0019	BLAU	AZUL	BLEU
TURN SIGNAL AMBER 88-0017	BERNSTEINFARBEN	AMBAR	AMBRE
GLOSS BLACK 88-0001	GLÄNZENDES SCHWARZ	NEGRO BRILLANTE	NOIR LUSTRE
FLAT BLACK 88-0022	GLANZLOSES SCHWARZ	NEGRO APAGADO	NOIR TERNE
SATIN BLACK 88-0016	HALBGLÄNZENDES SCHWARZ	NEGRO MATE	NOIR MAT



**DO NOT CEMENT
NICHT KLEBEN
NO USE PEGAMENTO
NE PAS COLLER**



**OPTIONAL PARTS
BAUTEILE NACH WAHL
PIEZAS OPCIONALES
PIECÉS EN OPTION**



**REMOVE AND THROW AWAY
ENTFERNEN (ABFALL)
QUITE Y TIRE
À RETIRER ET JETER**



**REPEAT SEVERAL TIMES
ARBEITSGANG MEHRMALS WIEDERHOLEN
REPITA VARIAS VECES
A RÉPÉTER PLUSIEURS**



**DECAL (DIP IN WATER)
ABZIEHBILD
DECALCOMANIA (MOJE CON AGUA)
DECALCOMANIE (À PLONGER DANS L'EAU)**

If you have any problems building this model, call our modeling tips hotline at: (800) 833-3570
REVELL-MONOGRAM, INC. Morton Grove, IL. Copyright©1996. All rights reserved. Made in U.S.A.

1 ENGINE ASSEMBLY

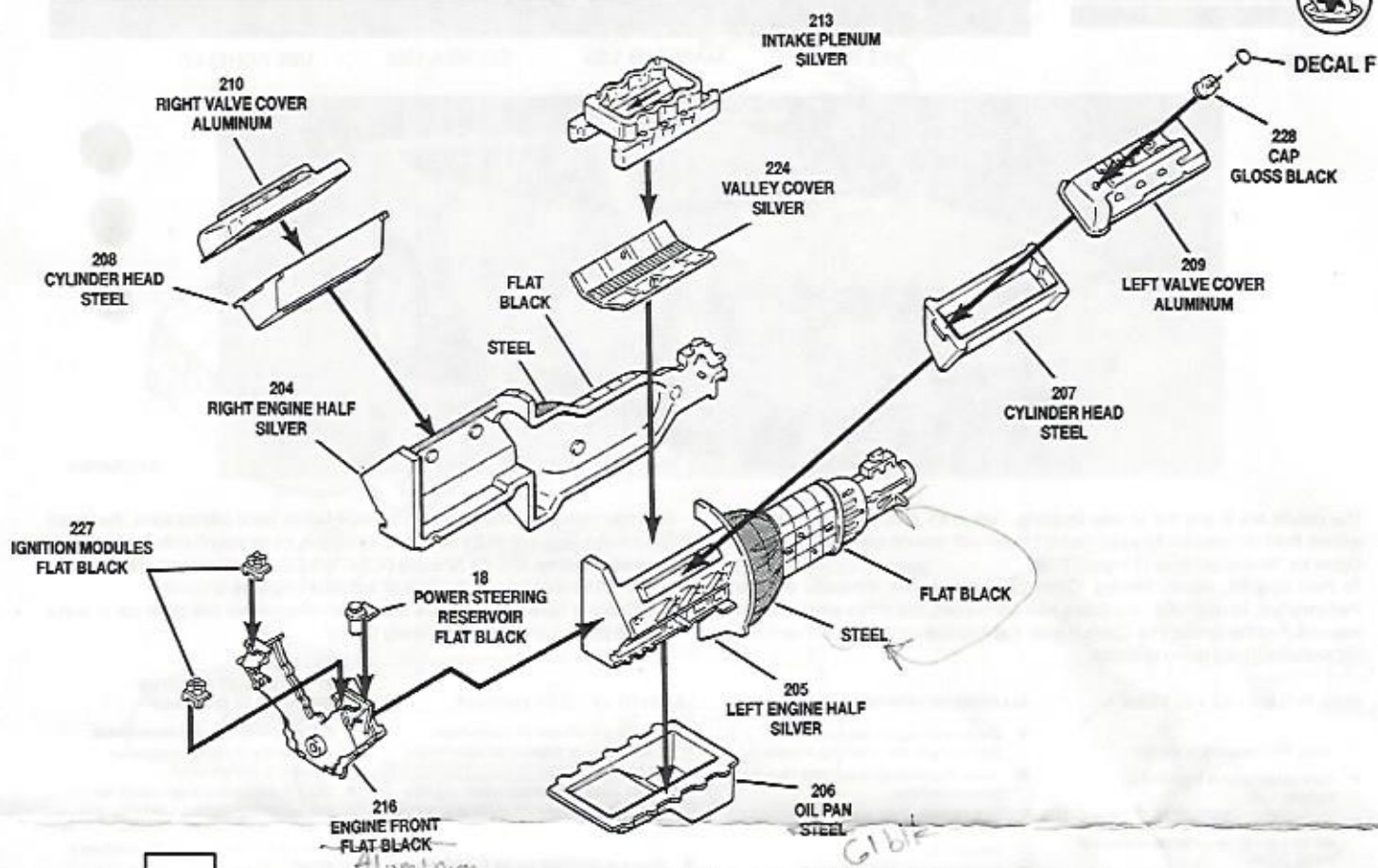

DECAL APPLICATION INSTRUCTIONS

- 1.) Wash plastic parts in mild detergent solution. Rinse and let dry.
- 2.) Cut desired decal from sheet.
- 3.) Dip decal in water for a few seconds.
- 4.) Place wet decal on paper towel.
- 5.) Wait until decal is movable on paper backing.
- 6.) Place decal in position on model, face up and slide backing away.
- 7.) Press out air bubbles with a soft damp cloth.
- 8.) Milkiness that may appear is for better decal adhesion and will dry clear. Wipe away any excess adhesive.
- 9.) Do not touch decal until fully dry.

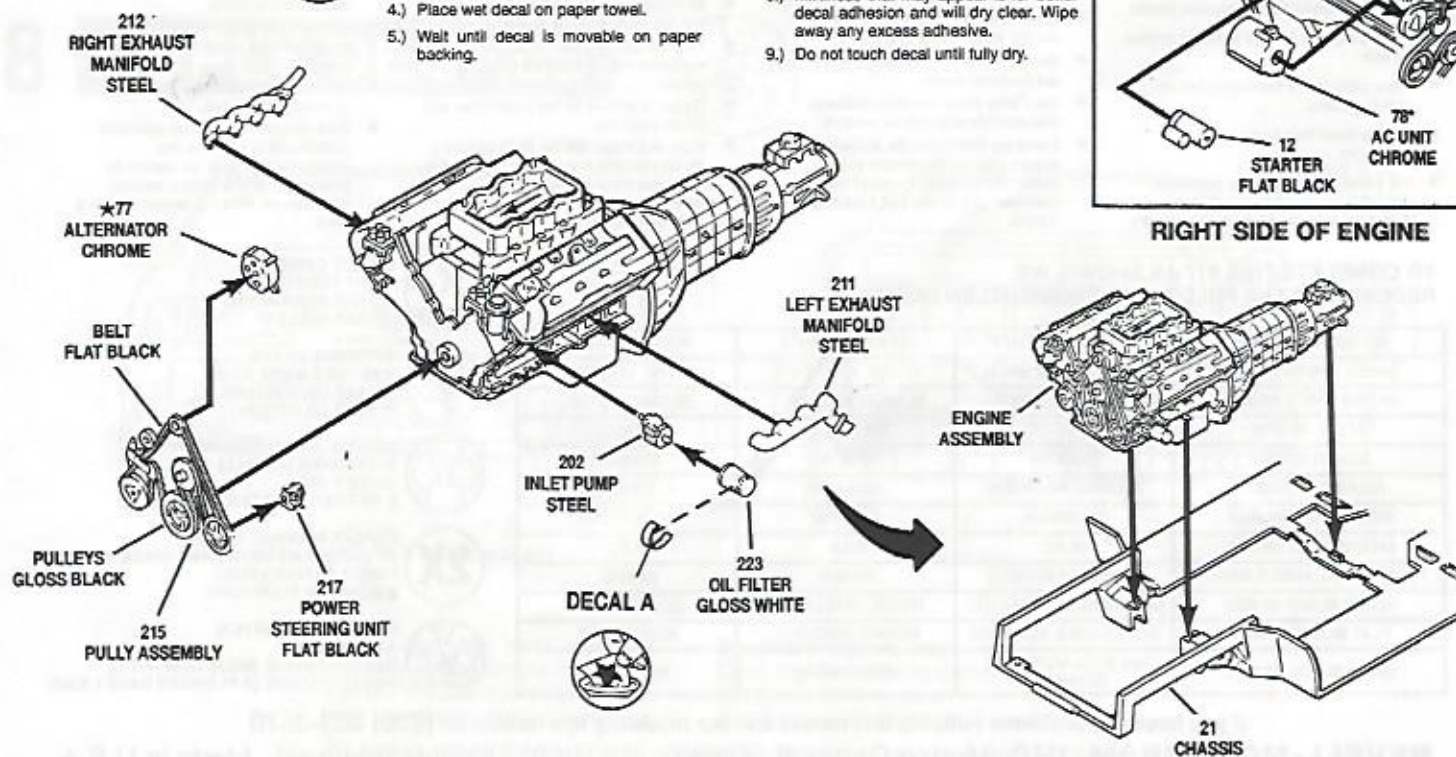

2 INTERIOR ASSEMBLY

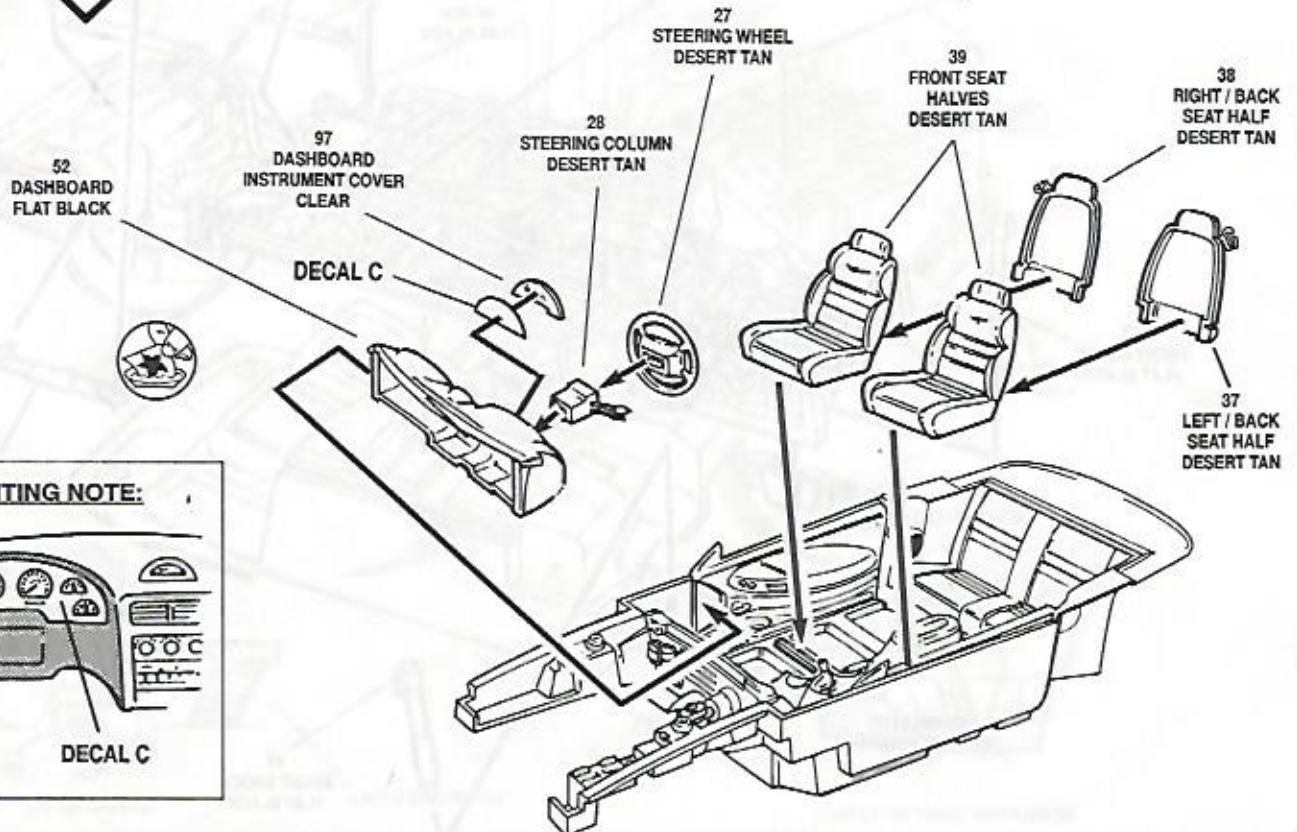
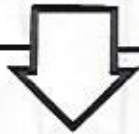
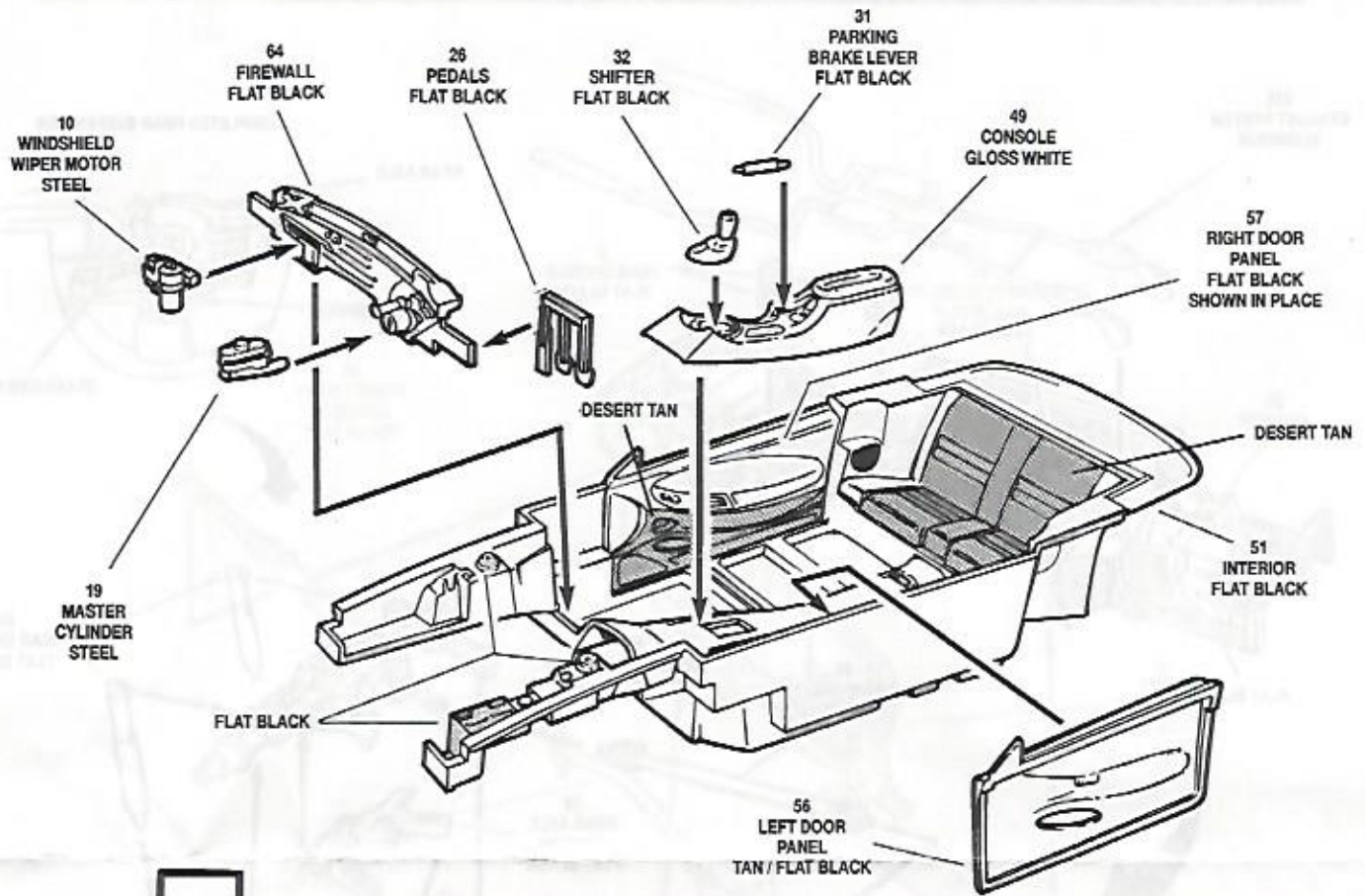

PAINTING NOTE:

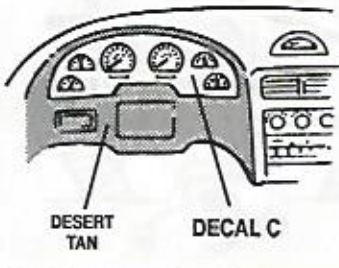

3

CHASSIS ASSEMBLY / DETAILS

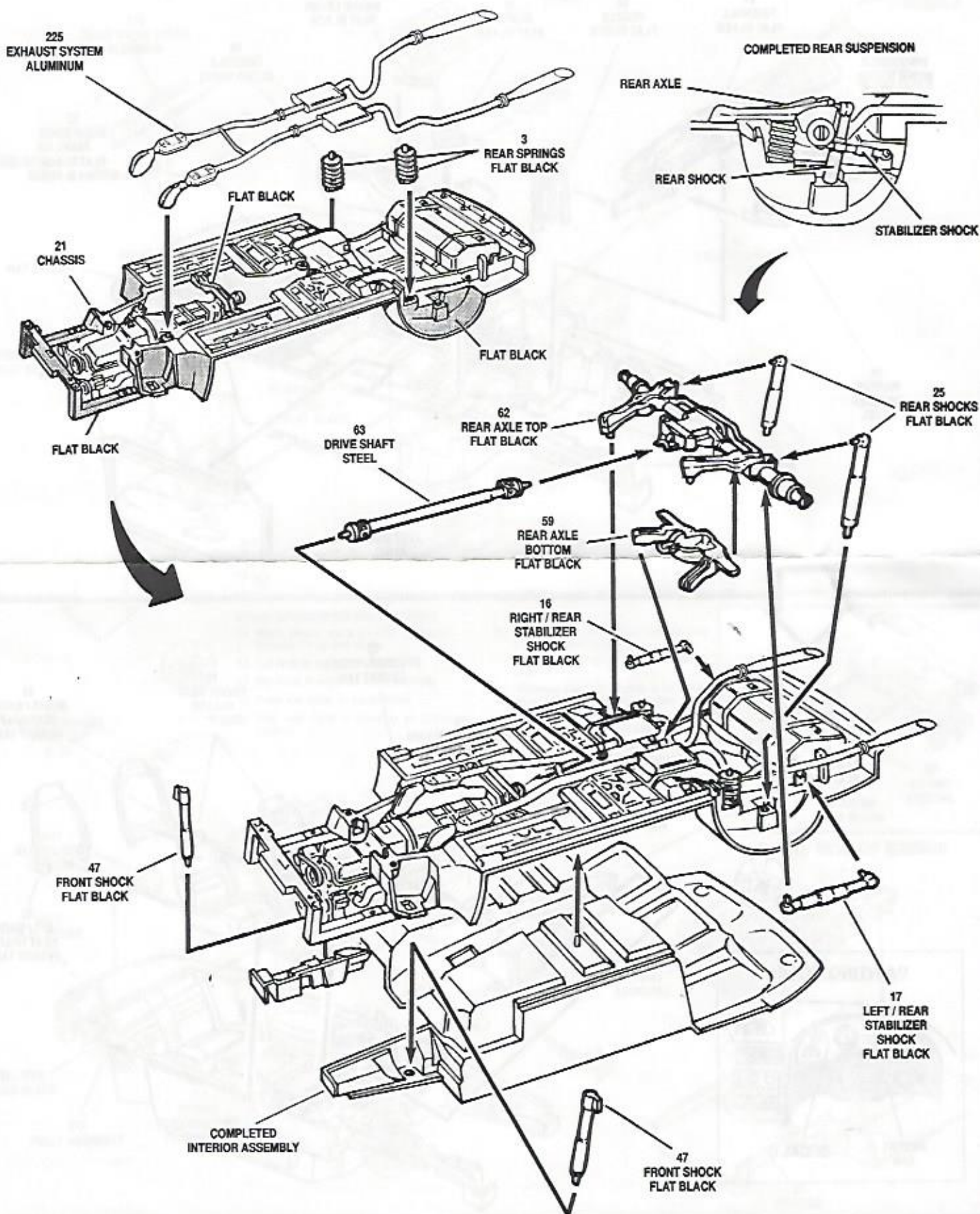

4 SUSPENSION ASSEMBLY

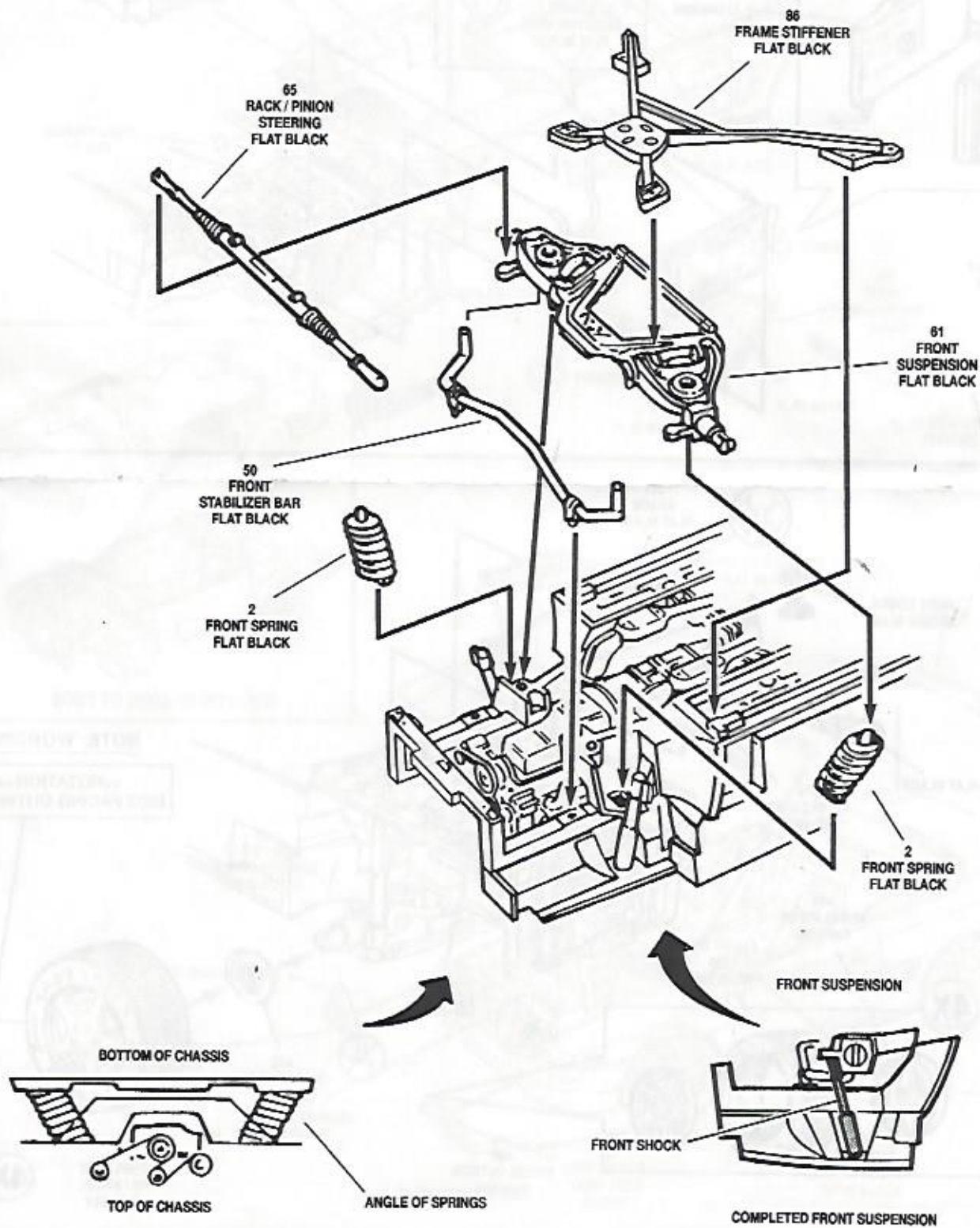

5

FINAL CHASSIS DETAILS

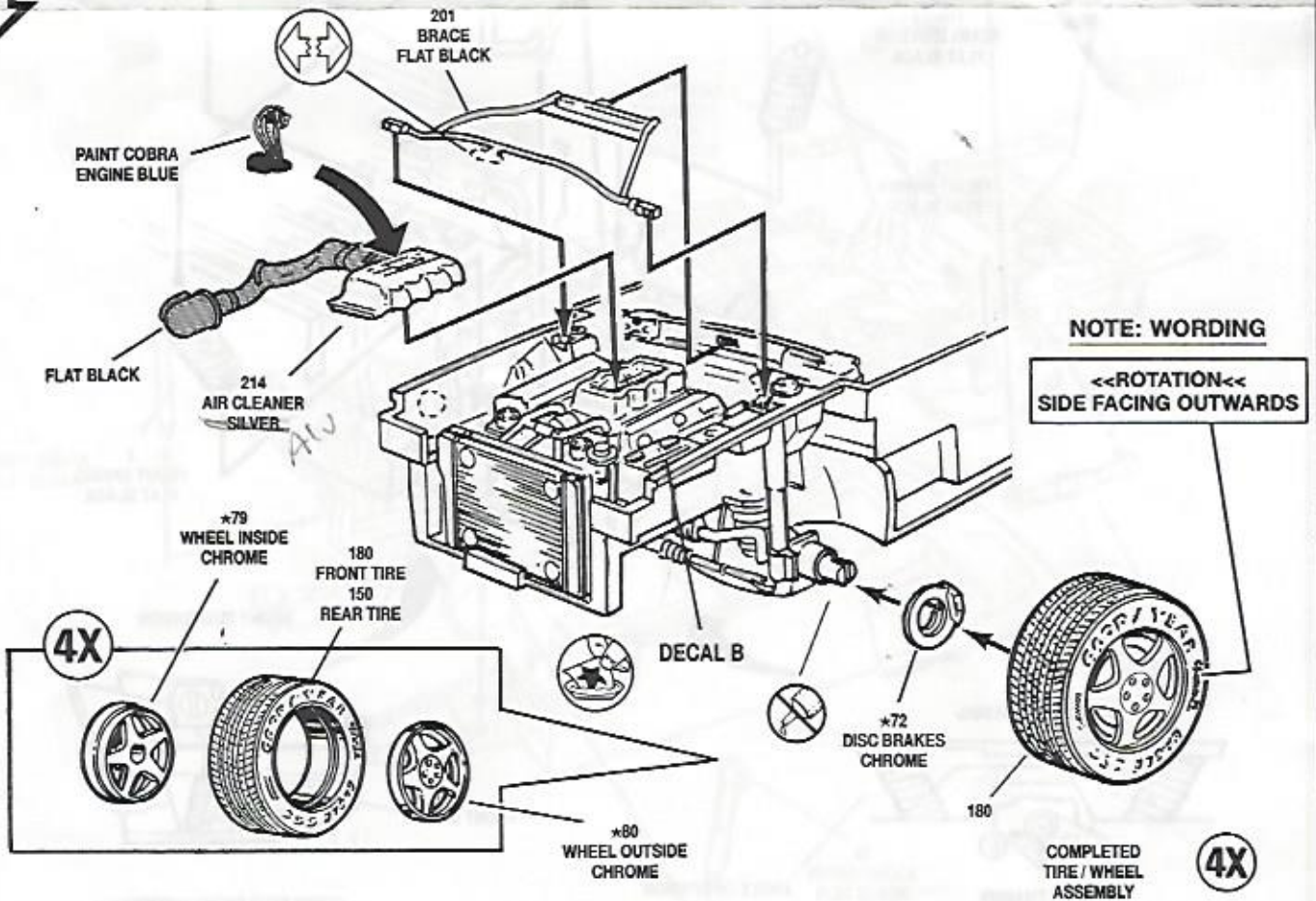
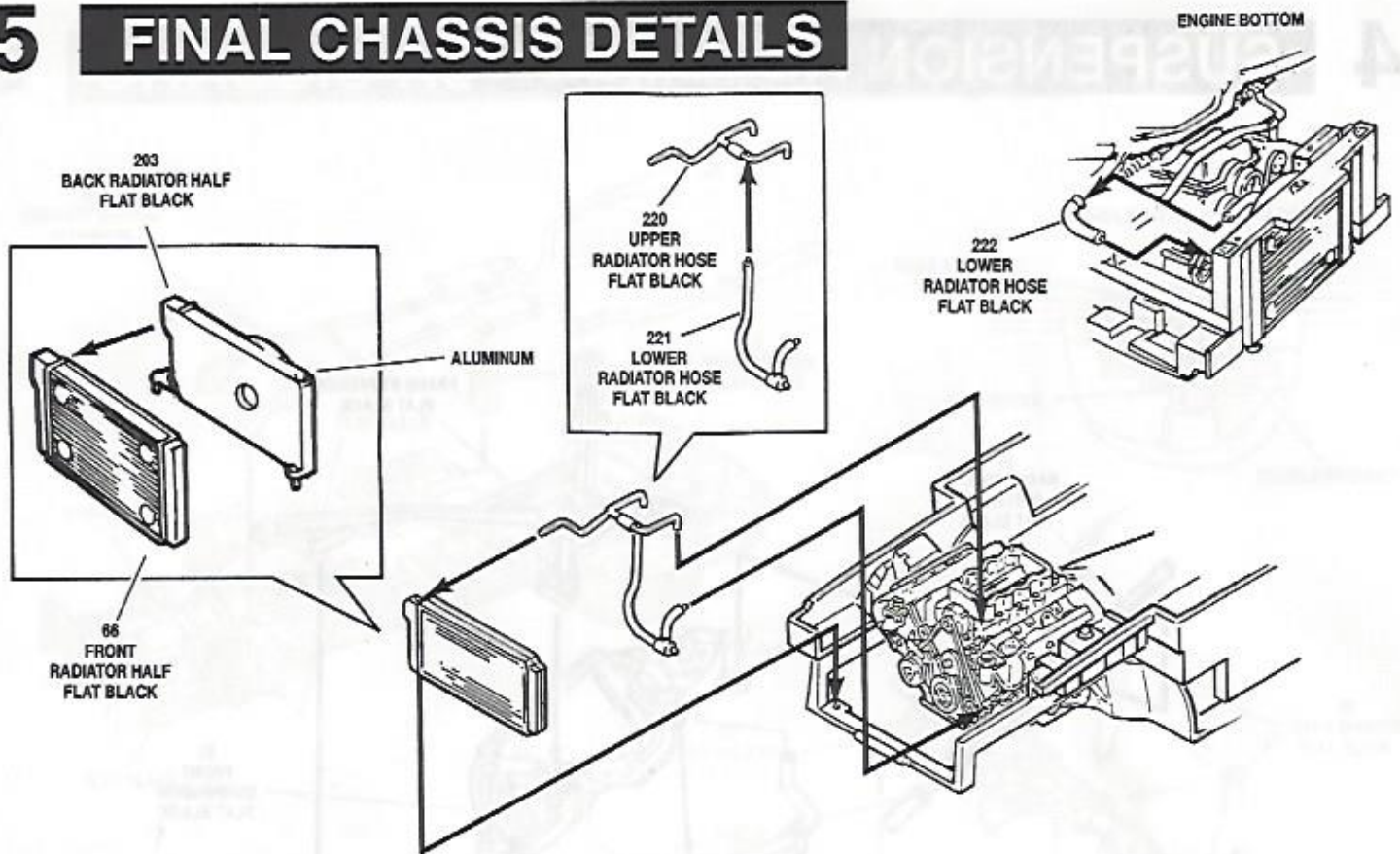

6 BODY ASSEMBLY

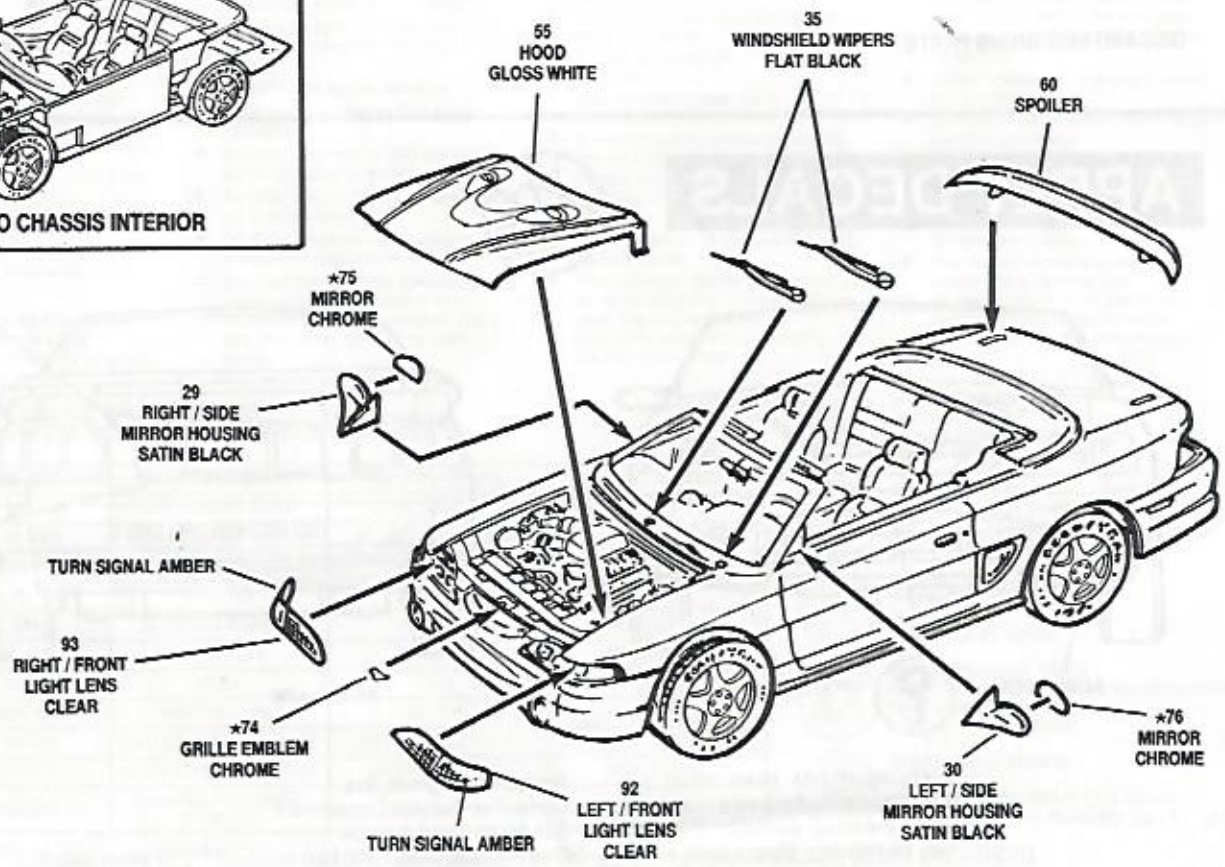
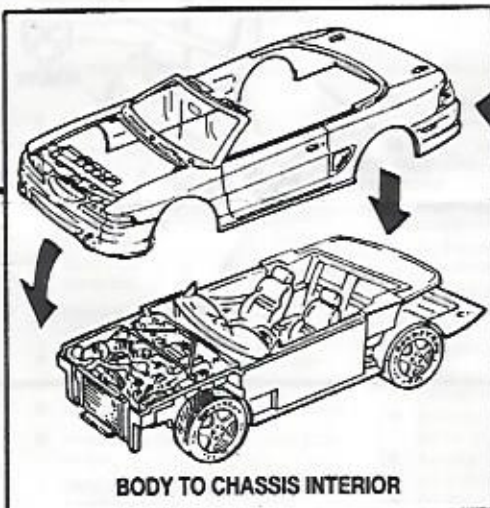
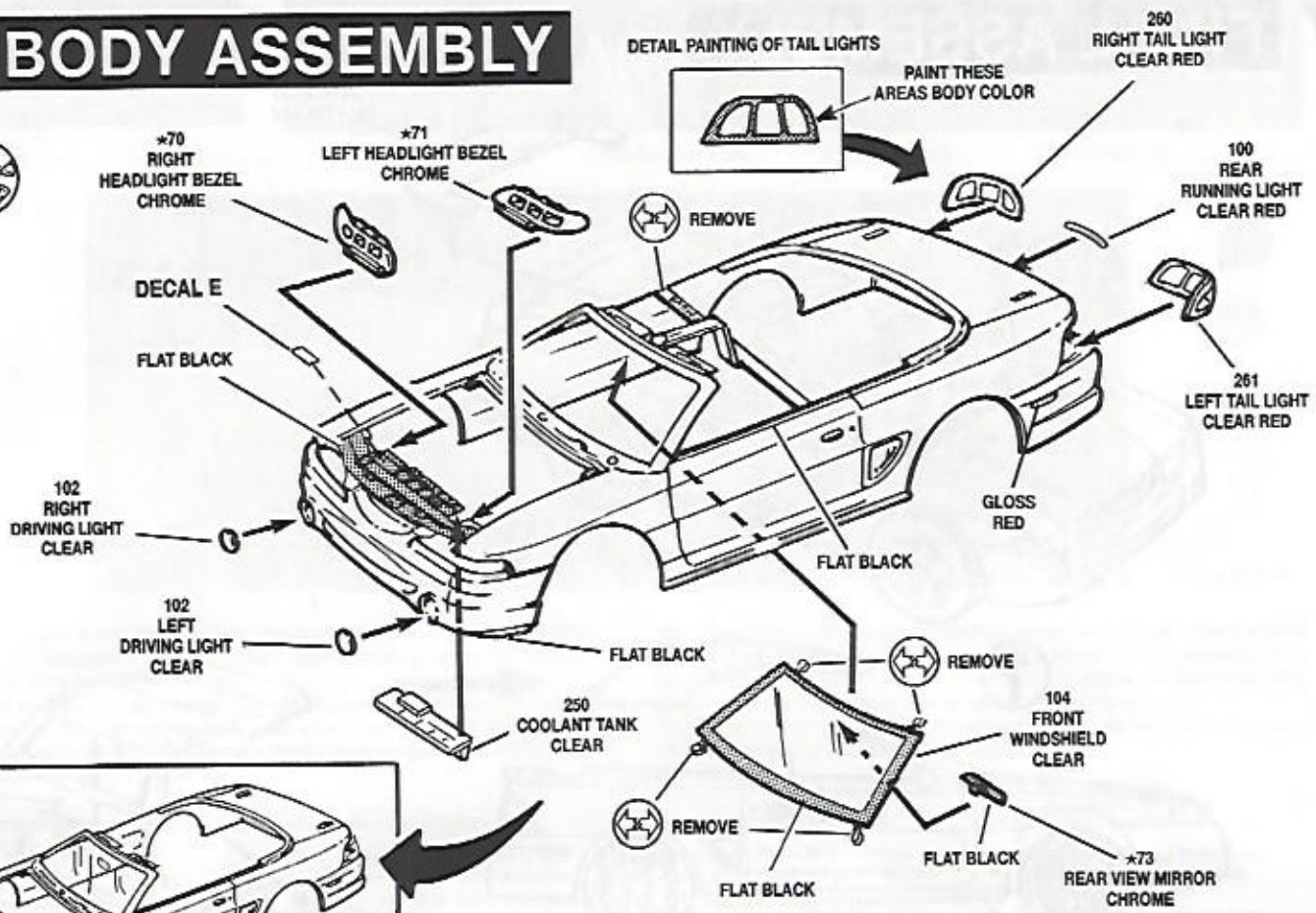

7 FINAL ASSEMBLY

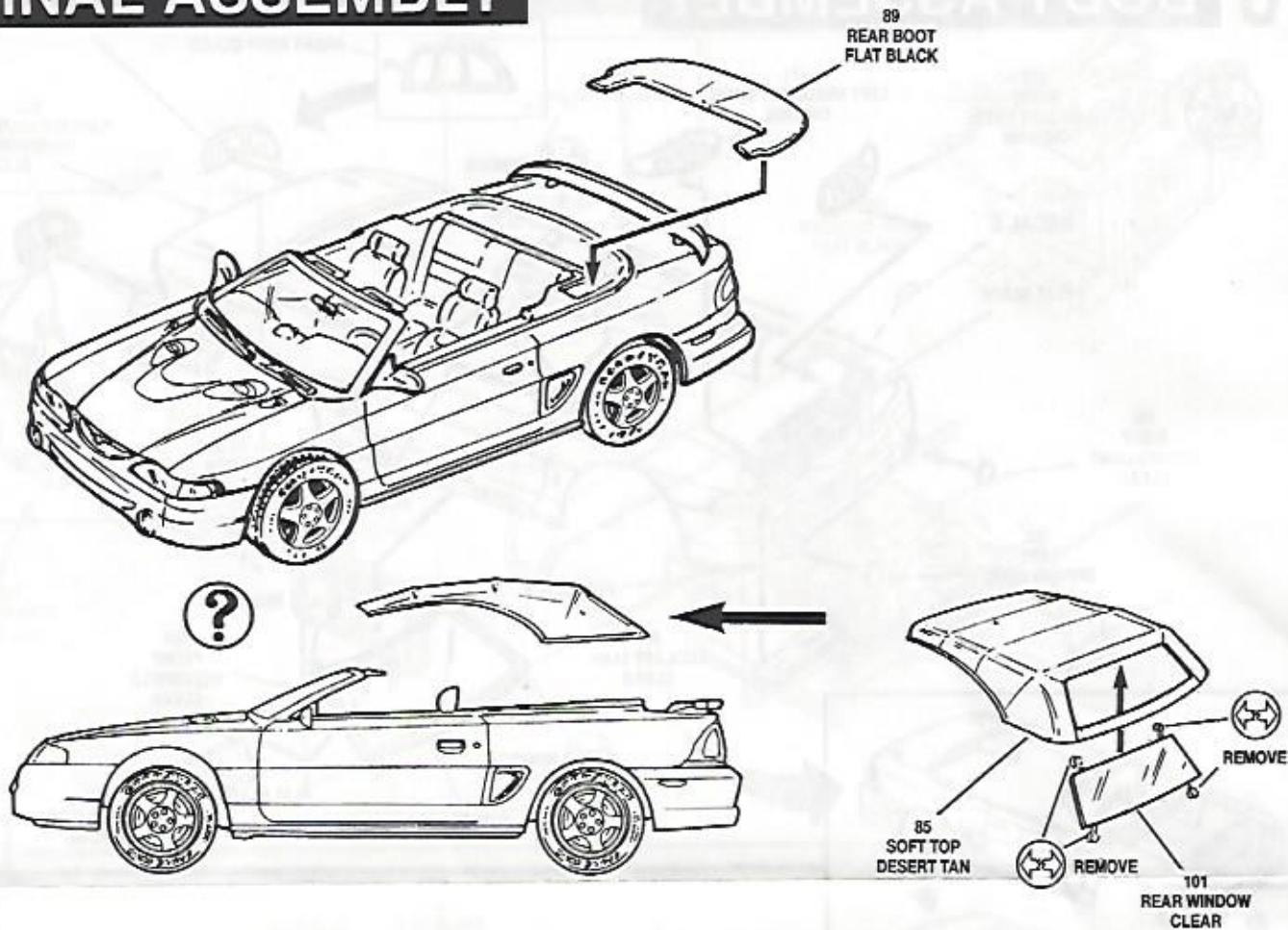

DISCARD REMAINING PARTS

8 APPLY DECALS

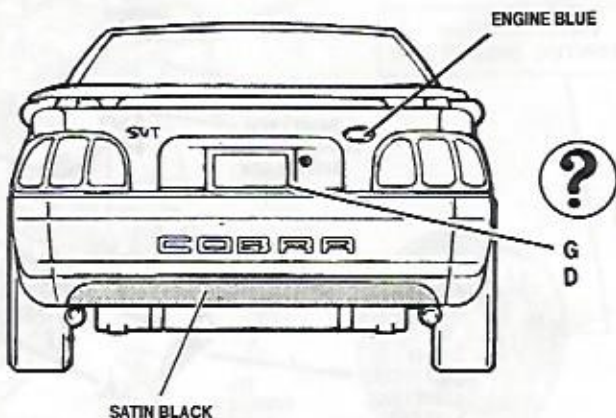
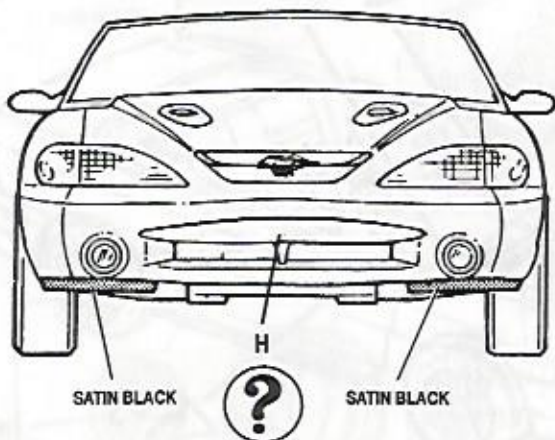

Every effort has been made to create and manufacture a model kit that is the finest available. If a part may be missing, please write to:

Revell-Monogram, Inc.
Consumer Service Department
301 North Third Avenue
Des Plaines, Illinois 60016

Be sure to include the kit number, part number, description, and your return address.