

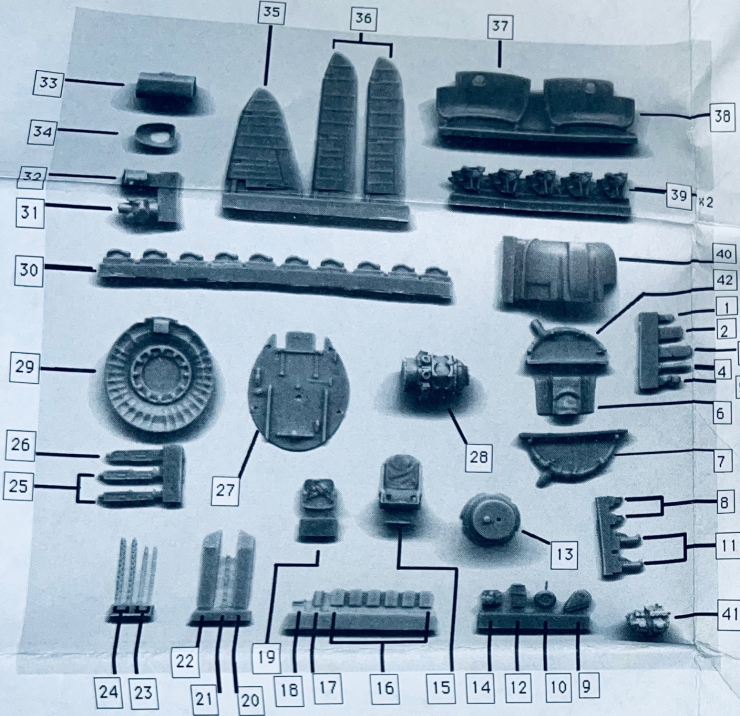

VERLINDEN PRODUCTIONS

811 Lone Star Drive
O'Fallon MO 63366

N°1378
SBD 1-2-3 Early A-24 Dauntless Superdetail
1:48 Scale



Step 1

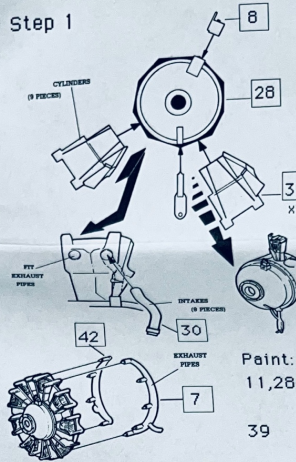

Assemble the cylinders **39** to the crankcase and make sure the raised line on the top of each one is in line with the next. Part **11** should sit at 6 o'clock and part **8** facing 1 o'clock, copper wire is provided for ignition wires.

Paint:

- 11, 28 engine crankcase governor Semi gloss Grey
- 39 Cylinders - Matt Aluminium
- Pushrods - Semi gloss Black
- 30, 8 Semi gloss Black
- 42, 7 Rust

Step 3

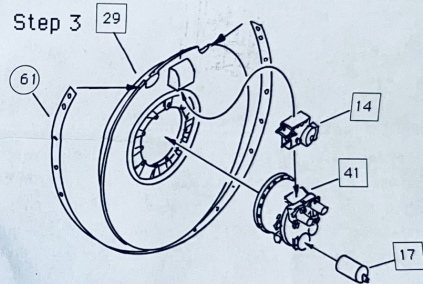

Note: if displaying engine as 'removed' from Aircraft glue **41**, **14** and **17** to engine part **28** and open flashed over hole in **29**. Set Aside

- Paint: 29, 61 - Bell housing - Matte aluminum
- 14, 41, 17 - semi gloss black

Step 2

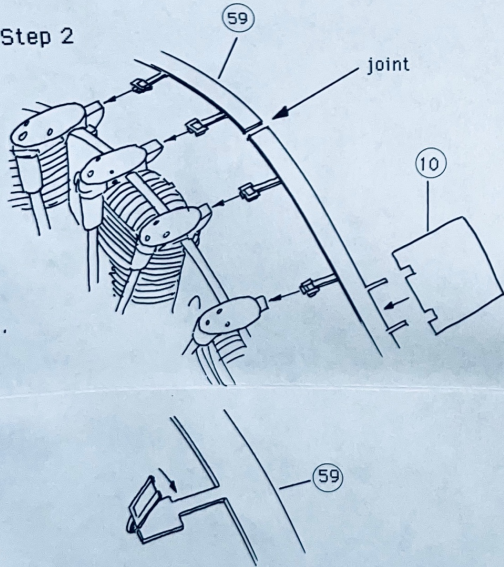

12 o'clock

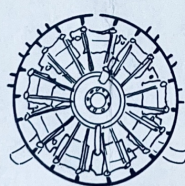

Looking at the front should look like this. Set aside for later

Step 4

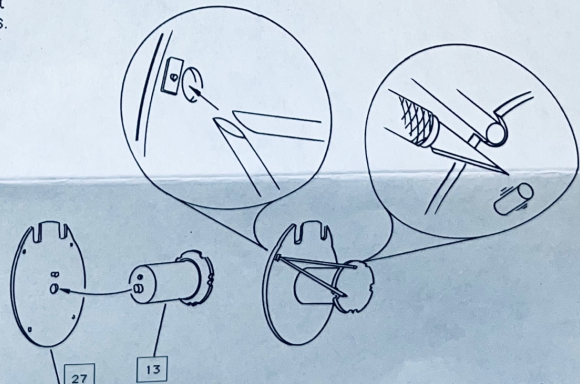

Bend the end of attachment points on **59** and wrap **59** around engine and glue to the small studs on the backside of each cylinder head. Special note: the ends should meet at the top center cylinder. This is to ensure the cowl flaps **10** are aligned properly on each side. Attach cowl flaps **10** to small studs facing rearward. Paint: 10, 59 - Cowl Flap / Ring - interior green

Glue engine frame jig lightly to **27** making sure it is flush. Next cut 8 pieces of plastic rod 25mm long and angle cut one end of each one so that two share each hole in **27**. Lightly tack with super glue the forward end in the corresponding notch on the jig **13**. Use diagram for arrangement. When satisfied with position flush cut at the extending forward portion so all are uniform. Next carefully remove jig and discard. Paint: all parts interior green with exception of 13

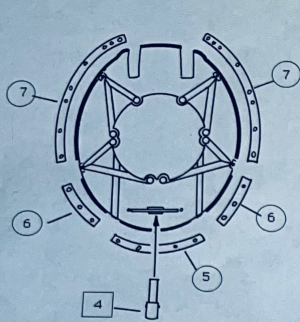
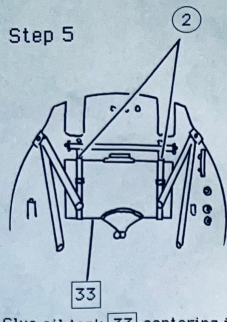
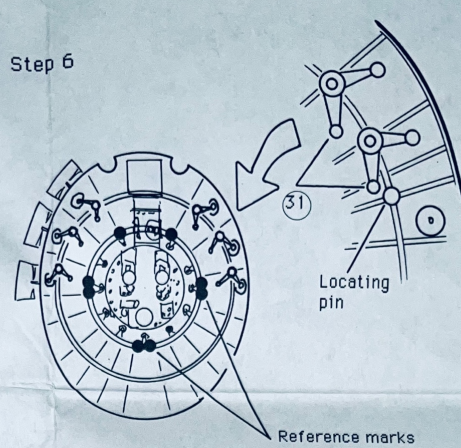

diagram and location of cowl panel attachments.
 Paint: 7,6,5 - interior green
 4 exterior color



Step 5
 Glue oil tank **33** centering it on rails on **27** straps **2** correspond with rails on **27**
 Paint: 33,2 straps, oil tank - interior green.



Glue **31** to locating studs inside **29**. For additional detail fine stretched sprue can be added to connect the cowl flaps linkages. Cowl flaps are shown for reference. The reference marks indicate where the engine framework is to be glued along inner ring.
 Paint:
 31 - Matt Aluminium

Step 7

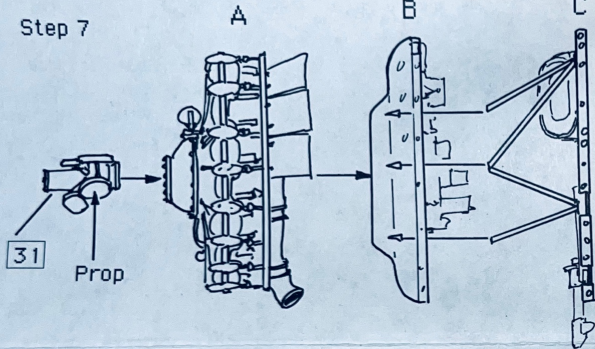

Glue sub-assembly C to sub-assembly B using diagram from step 6. Sub-assembly A can be glued at this point but is not recommended so that it isn't damaged. remove kit props and attach to **31**. At this point remove the very forward position of each fuselage half so part **27** can mount flush with airframe. Paint: 31 - propeller hub - semi-gloss or Aluminium

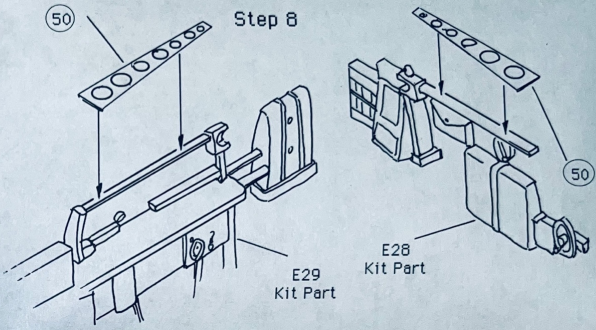

Step 10

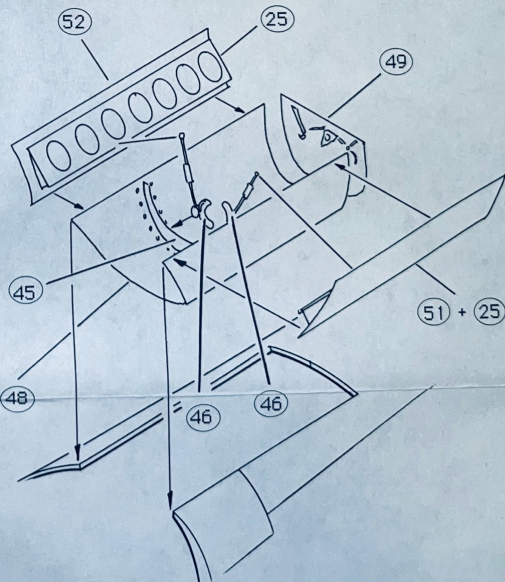

Step 9 Assemble .30 ammo rack and use in place of Kit Part A46

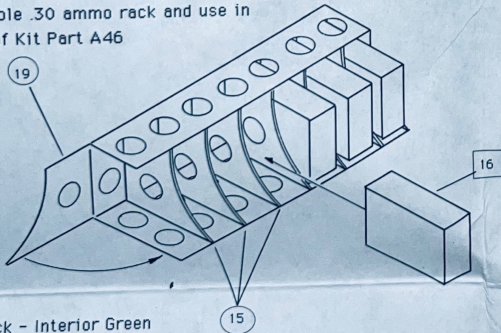

Paint:
 19 Ammo Rack - Interior Green
 16 Ammo Cans - Matt Aluminium

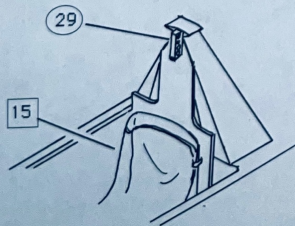

Step 11

Add new pilot seat and fold **29** onto itself
 Paint:
 29, seat - Int. Green // Pads - Canvas //
 Harness - Off White // Buckles - Steel

Remove gun tray panels from the fuselage, and molded on gun bay from Kit Part E38. Assemble the rest of the cockpit except pilots seat and glue fuselage halves together. Dry fit new gun tray and save the doors and actuators **46** for later to avoid damage.
 Paint: all interior green except for exterior of doors fuselage color.

Step 12

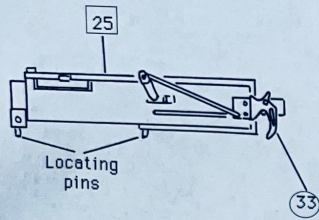

Locating pins correspond with holes in part 6
 Paint: 33 - Matt Aluminium
 25 - .50 cal - Gun Metal

Step 14

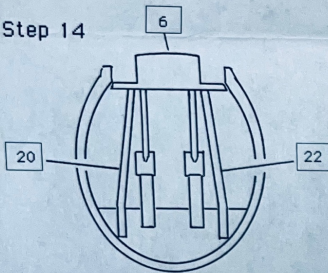

View looking into forward fuselage.
 Glue 20 and 22 flush with opening.
 Paint:
 20, 20 - Ammo Chutes - Matt Aluminium

Step 13

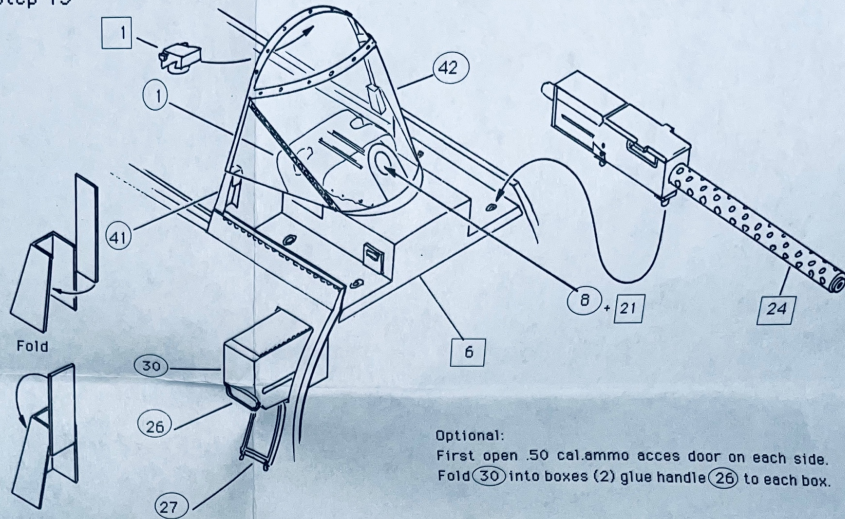

Optional:
 First open .50 cal ammo access door on each side.
 Fold 30 into boxes (2) glue handle 26 to each box.

Note: it is not known that the ammo boxes come all the way out or just slide to a stop. Attach access panel 27 if open. Cowl shelf 6 inserts from the front until flush. Shape instrument coaming 1 over 6 and rests on top of instrument panel and over hangs 3mm. Fold windscreen supports 41, 42. Note: windscreen is shown for orientation and should be installed later. 1 pilot compass is glued to the inside of the windscreen. 8 glued to windscreen with gunsight 21 passing thru.
 Paint: 27, 41, 42, 6 - Int.Green // 1, 1, 24 - Semi gloss Black // 30 matt aluminium

Step 15

Note: Cowl panels from kit parts A17R and A17L are not included and can be cut and used for display.

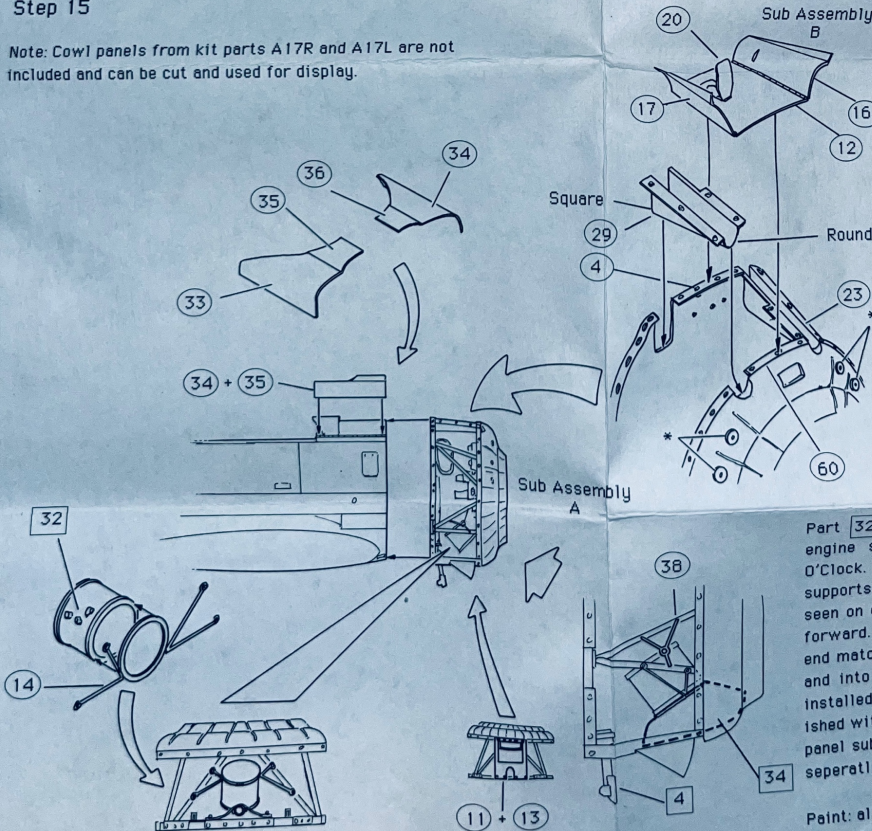

* Fine stretched sprue can be added here for cowl flap pushrods and attached to the inside of cowl flap.

Part 32 with bracket 14 mounts to bottom two engine supports fittings on 32 should face 11 O'Clock. Engine starter guide 38 mounts on engine supports as shown. Intake shroud 34 is optional as seen on only few aircraft. Part 4 angles slightly forward. Shape 24 and 23 as shown with a round end matching forward bell housing 29 and square and into bulkhead 27. Parts 60 and 4 are installed after 24 and 23 are in place. When finished with sub-assembly A attach to fuselage. Cowl panel sub-assembly B can be attached or displayed separately.

Paint: all interior structures interior green.
 Part 32 - oil cooler - copper.

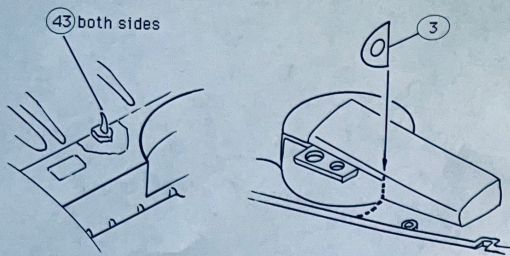

Both sides kit part C52
Paint: Interior green

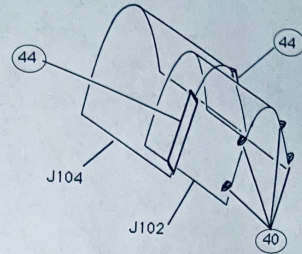
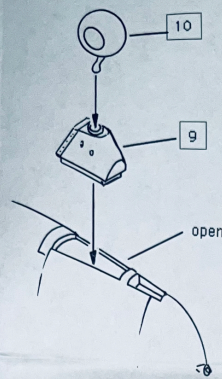

Remove molded on windscreen deflectors off Kit Part J104, attach windscreen deflectors (44). Remove actuators from J102 and add new ones (40).

Step 16

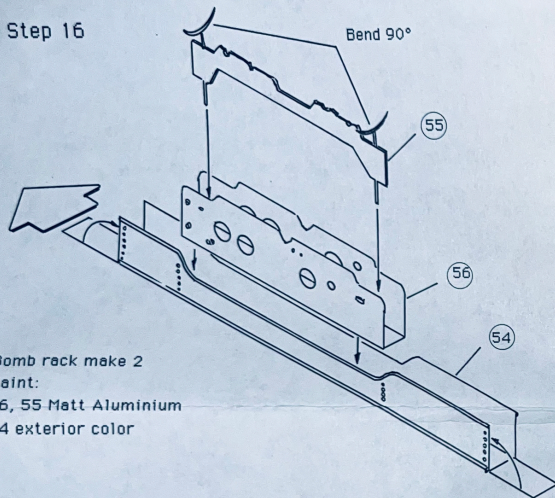

Bomb rack make 2
Paint:
56, 55 Matt Aluminium
54 exterior color

for A-24 Banshee use only
(use part 5 for replacing kit wheel on Navy Dauntless)

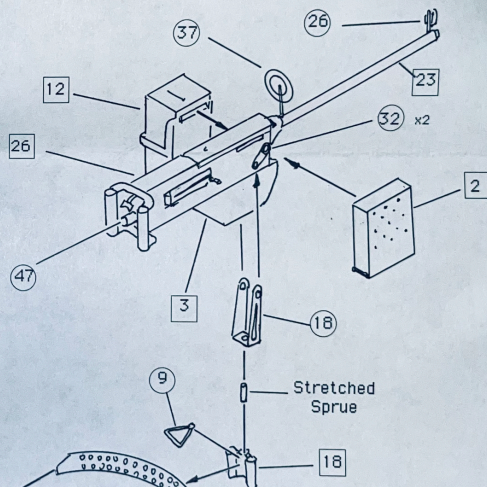

Step 17

Final Assembly :

Glue slide (18) onto track (21) in desired position.
Gun lock (9) glues onto (18). Stretched sprue can be used to connect slide (18).
Stretched sprue should be used to make handles and bolt on part (47).
Note: Make sure trigger is facing up. Cocking handle can be made from stretched sprue. Parts (57) connect and lace up to create web belt.

Paint:

19, 22, 21, 9 and 18 - Interior green
12, 2, 3 - Matt Aluminium
26, 23 - Matt Black
Web belt and seatharness - Canvas

- Indicates Photo-etched part
- Indicates Resin part

Excellent source of reference :
Detail & Scale Vol.48 SBD Dauntless

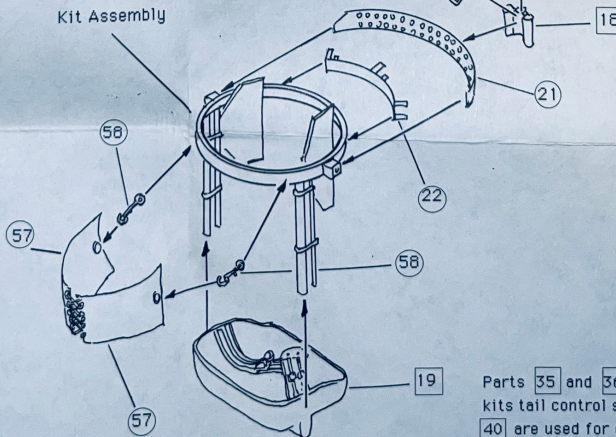

Parts (35) and (36) are used to replace kits tail control surfaces. Parts (37) (38) (40) are used for diorama display.