

# Pz.Kpfw.IV Ausf.D w/5cm KwK L/60

Smart Kit

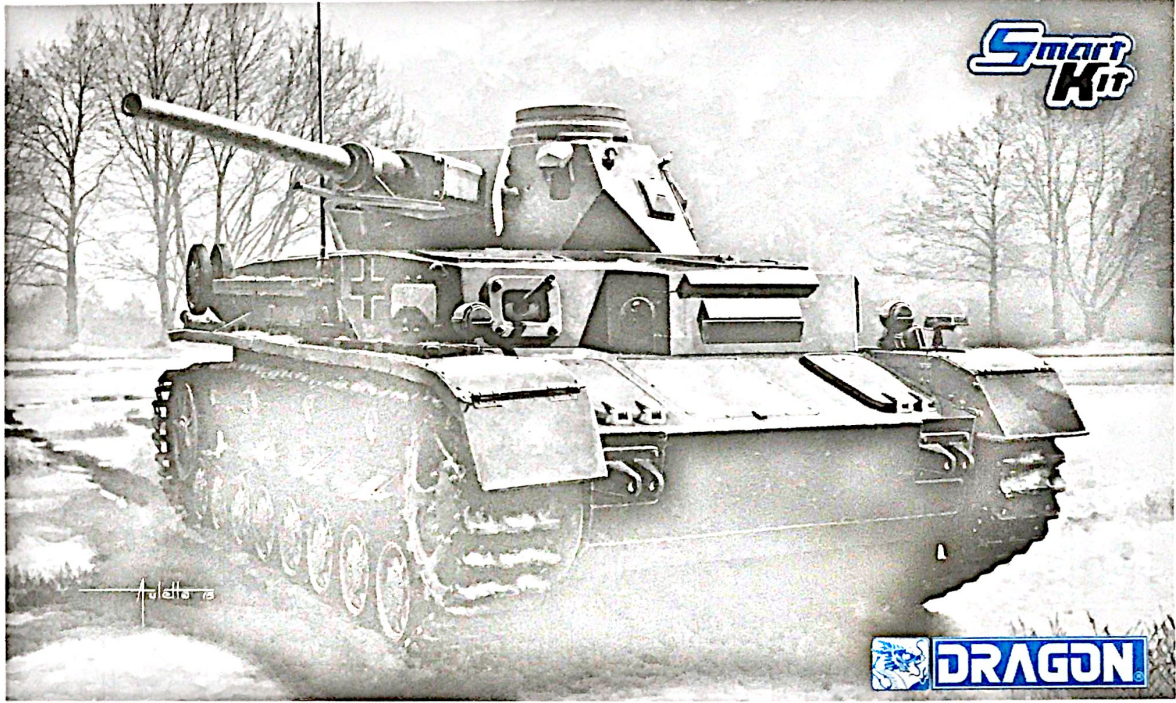

**DRAGON**

Technical assistance provided by NOTGER SCHLEGENDAL.  
Thanks to TOM COCKLE and GARY EDMUNDSON as Technical Consultants.

KIT NO. 6736

**Ax2**

**D**

**E**

**S**

**C**

**Ax2**

**B**

**J**

**U**

**H**

**G**

**L1**

**P**

**Q**

**F**

**D**

**MA (Photo-etched Parts)**

**X**

**Z DS**

の部品は使用しません  
Parts not for use.  
Telle werden nicht verwendet.  
Pièces a ne pas utiliser.  
Parti nin ulizzati.  
不需要使用的部件



**組立ての注意**

- 接着剤や塗料は火の近くで使わないでください。使う時はときどき窓を開けて換気をお願いします。
  - 塗料指定の■は GSI CREOS CORP. Mr カラーの番号です。
  - 接着剤や塗料は入っていませんので別にお買い求めください。
  - 部品をランナーから切り離す時は模型用ハサミ等を使い、余分な部分はカッターやヤスリ等で仕上げてください。
  - 組立図のサインマークは下記の説明をごらんください。
- 《注意》
- 勿於近火處使用膠水或油漆，並打開窗戶保持空氣流通。
  - 代表 GSI CREOS CORP 出品 MR.COLOR 的顏色編號，不包括膠水及油漆。
  - 自膠架中取出部件時，應用模型專用剪，並用界刀或小鋸除去多餘的膠料。
  - 各圖型的含意可參考本欄以下的說明。

**ZUR BEACHTUNG**

- Kleber und Farbe nicht nahe von offenem Feuer verwenden und das Fenster von Zeit zu Zeit zur Belüftung öffnen.
  - Der ■ der Farbkennzeichnung bedeutet die Farbnummer von GSI CREOS CORP. MR. COLOR. Kleber und Farbe sind nicht enthalten.
  - Zum Abschneiden der Teile vom Verbundstück eine Modellierschere verwenden und die überstehenden Plastikteile mit einem Messer oder einer Feile beseitigen.
  - Die Bedeutung der Symbole finden Sie unten in dieser Spalte.
- CAUTION**
- When you use glue or paint, do not use near a naked flame, and use in a well-ventilated room.
  - Symbols such as ■ refer to the color number of GSI CREOS CORPS. MR. COLOR. Glue and paint are not included.
  - When you take parts off the runner frame, use modeling scissors and trim excess plastic with a cutter or a file.
  - See below for the meaning of symbols.

**ATTENTION**

- Ne pas utiliser de colle ou de peinture a proximite d'une flamme nue, et aérer la pièce de temps en temps.
  - Le numéro ■ pour l'indication de couleurs correspond au numéro de GSI CREOS CORP MR. COLOR. La colle et la peinture ne sont pas comprises.
  - Pour retirer les pièces hors du cadre, utiliser des ciseaux spéciaux pour maquetter la plastique en excès avec un cutter ou une lime.
  - Voilà la fin de cette colonne pour la signification des symboles
- ATTENZIONE**
- Non usare colla e vernice vicino a fiamme esposte, e aprire le finestre di tanto in tanto per cambiare l'aria.
  - delle indicazioni di colore si riferisce al numero di colore di GSI CREOS CORP MR. COLOR. Colla e vernice non sono incluse.
  - Quando si staccano parti del carrello, usare forbici da modellismo e eliminare la plastica in eccesso con un coltello o una lima.
  - Verdere in fondo a questa colonna per il significato dei simboli.

2つ製作してください MAKE 2PCS 2 TEILE FERTIGEN EFFETUER 2 PIECES FARE DUE PEZZI TEE 2 KPL GOR 2 ST 製作二個	切り取ってください REMOVE ENTFERNEN RETIREF SEPARARE POISTA AVLJASNA 切	接着しないでください DO NOT CEMENT NICHT KLEBEN NE PAS COLLER NON INCOLLARE ELIMAA LIMAAEI 不用粘合	ステッカーを貼ってください APPLY DECAL HIER ABZIEHBLD APPLIQUER DECALCOMANIE APPLICARE DECALCOMANIE ASETA SIIRTOKUVA APPLICERA DECALEN 貼上水貼紙	穴を埋めてください FILL HOLE SCHLIESSEN BOUCHER LE TROU FOTO PIENO TAYTA REIKA FILLI MALET 補充 補充剤が乾くまで2-3分待つてください RESEK MOTO AFIN UNITESE MOTO ENKE UNTER WARTEN 30S KLEBSTOFF SETZUNGEN NELEIT REPERE 30S SEZES KLEBEZE VINO MASA MLETER TILL 30S 200S MOTO MOTO KLEBSTOFF SETZUNGEN 補充剤分調 直 互換等用剤
注意してください BE CAREFUL HIER VORSICHT FAIRE ATTENTION USARE ATTENZIONE VAROASTI FORIKTIG 小心慎重	穴を開けてください OPEN HOLE OFFNEN FAIRE UN TROU FORD APERTO AVIA REKA OPPNÄ HALET 開孔	接着してください CEMENT TOGETHER ZUSAMMENKLEBEN COLLER ENSEMBLE INCOLLARE INSIEME LIMAA YITTEEN LIMAA HOP 用膠粘合	折り曲げてください BEND BITTE BIEGEN PLIER SIL VOUS PLAIT PIEGARE TAITA SOCKA 屈曲	どちらか選択してください OPTIONAL NACH BELIEBEN FACULTATIV VALIKANN VÄRANEN VALBAR 可以選擇用 瞬間接着剤(金属用) INSTANT GLUE FOR METAL METALLKLEBER COLLA A METAL INSTANTANEE COLLA INSTANTANEA PER METALLI PÄÄLÄMÄ METALLIOSIA VÄRTEN SNÄBLIM FOR METALLDELAR 金屬用速乾膠

**H ■ GSI CREOS CORP. AQUEOUS HOBBY COLOR ■ GSI CREOS CORP. MR. COLOR ■ MODEL MASTER COLOR**

**DS** Dragon is always at the forefront in utilizing new technology and material in the development of its various product lines. Such innovation is geared to reduce the modeler's construction time and effort, but at the same time brings high detail to the end product. Dragon is proud to introduce DRAGON STYRENE 100, a cross breed that has the advantage of both polystyrene and PVC vinyl, developed and formulated by the Dragon R&D Team.

1 it allows filing, cutting, sanding and polishing

2 easy to get rid of parting lines by modeling thinner

3 can be glued using normal modeling liquid cement

H 1 ■	ホワイト(白)	1745	WHITE	WEISS	BLANC	BLANCO	白色
H 2 ■	ブラック(黒)	1747	BLACK	SCHWARZ	NOIR	NERO	黒色
H 8 ■	シルバー(銀)	1546	SILVER	SILBER	ARGENT	ARGENTO	銀色
H 12 ■	つや消しブラック	1749	FLAT BLACK	MATTSCHWARZ	NOIR MAT	NERO OPACO	啞黒色
H 18 ■	黒鉄色	1415	STEEL	STAHL	ACIER	ACCIAIO	黒銀色
H 32 ■	ダークグレー(フィールドグレー)	2036	FIELD GRAY(1)	FELD GRAU(1)	GRIS DES TROUPES ALLEMANDES(1)	GRIGIO CAMPO	田灰色
H 37 ■	ウッドブラウン	1735	WOOD BROWN	HOLZBRAUN	BRUN BOIS	MARRONE LEGNO	木棕色
H 76 ■	焼鉄色	1406	BURNT IRON	GEBR, EISEN	FER BRULÉ	FERRO BRUCIATO	燒鐵色
H 90 ■	クリアーレッド	4630	CLEAR RED	ROT, REIN	ROUGE CLAIR	ROSSO CHIARO	透明紅

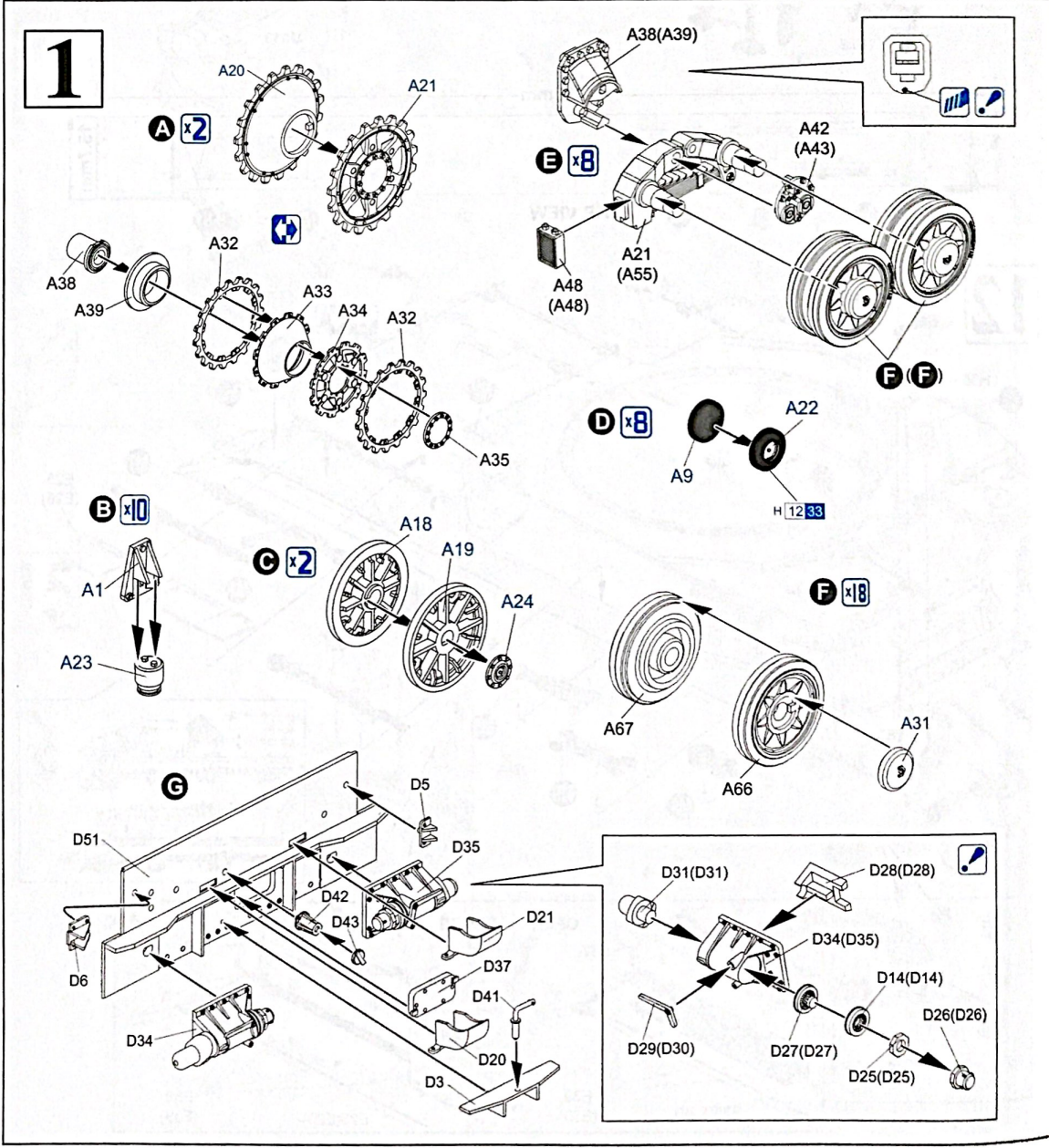



2

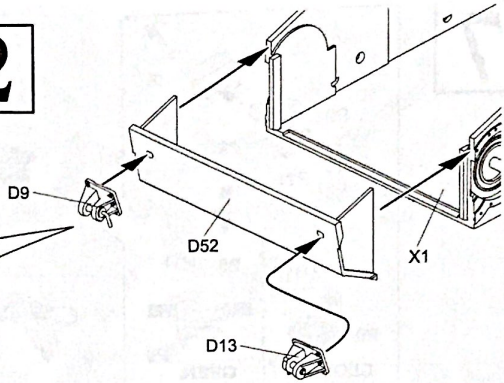
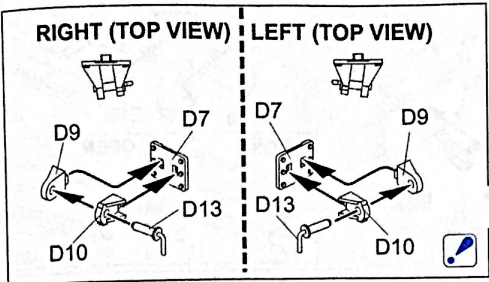

3

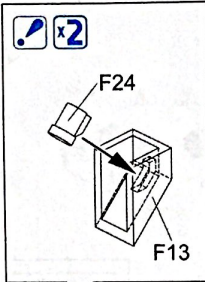
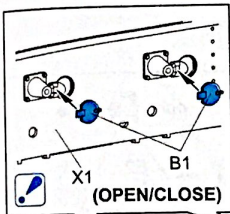

4

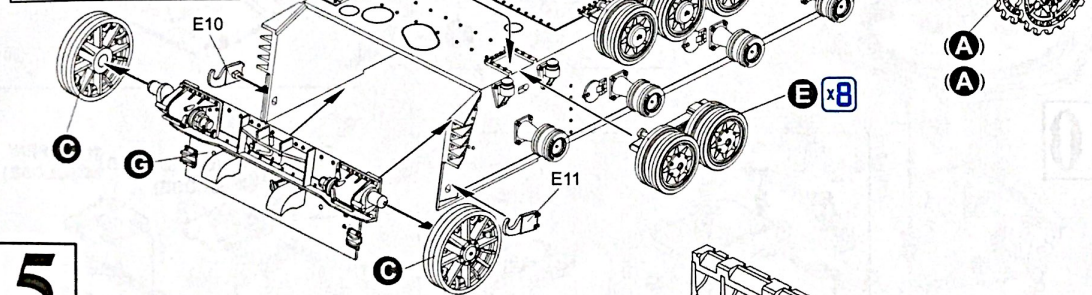
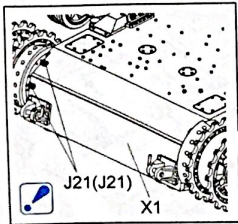
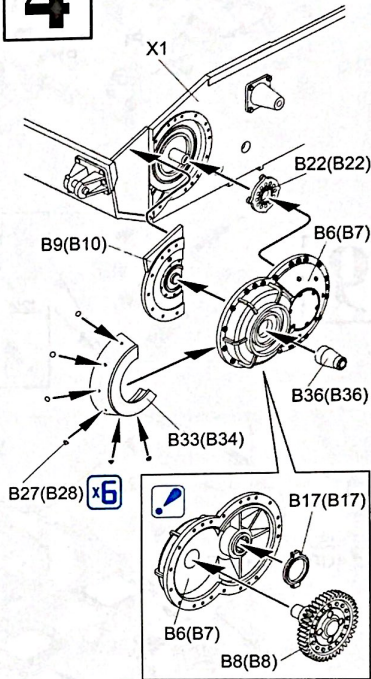

5

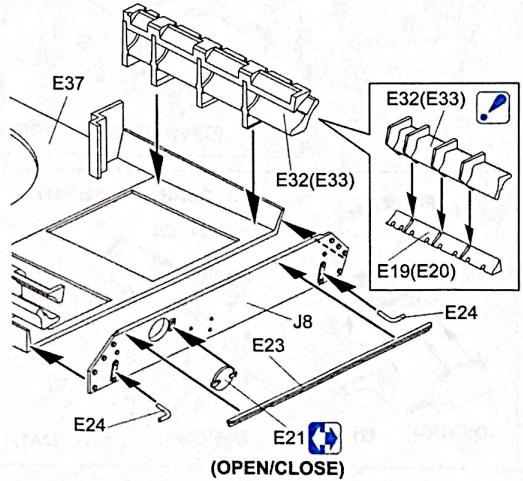

6



7

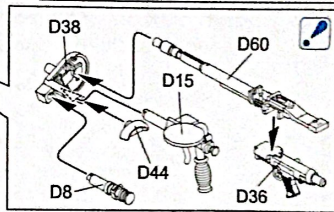
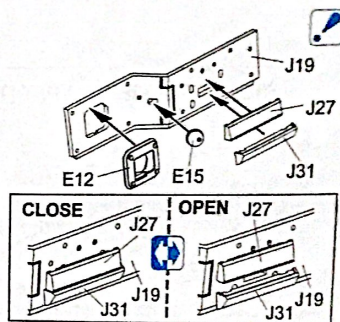
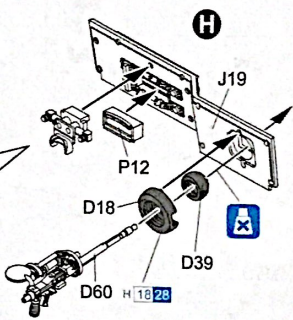
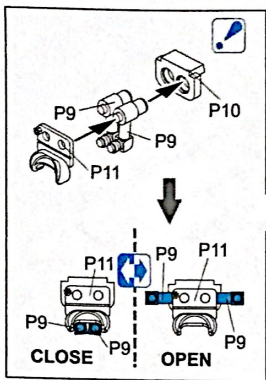

8

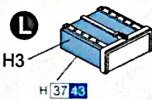
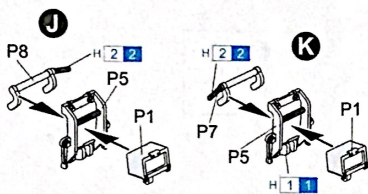

9

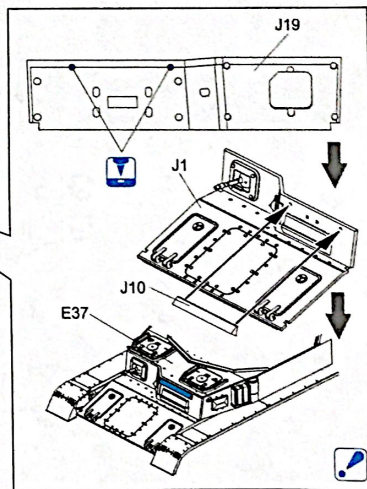
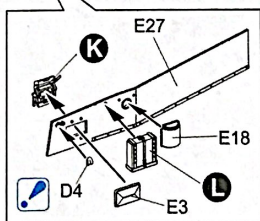
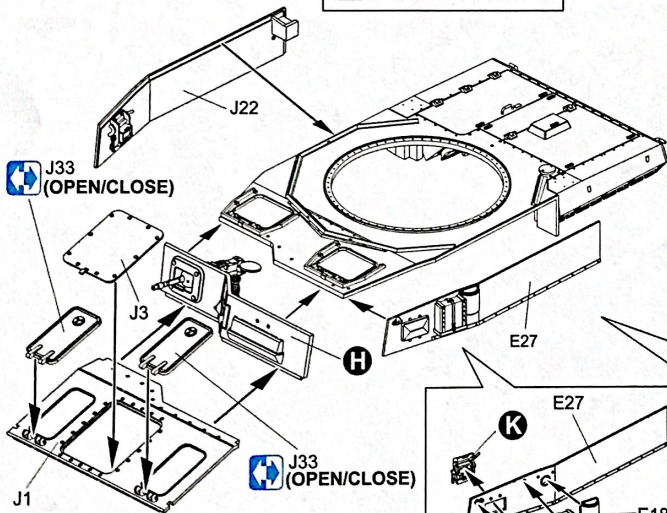
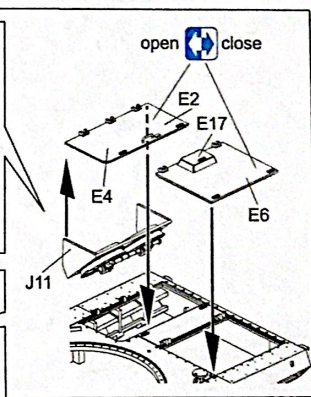
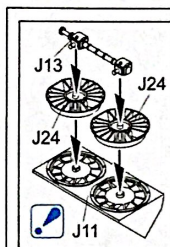
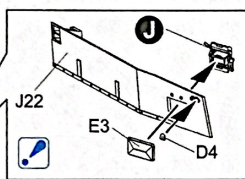

10

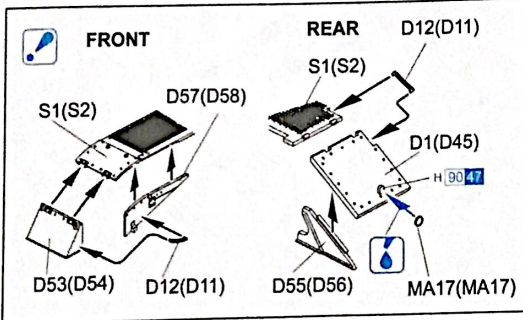
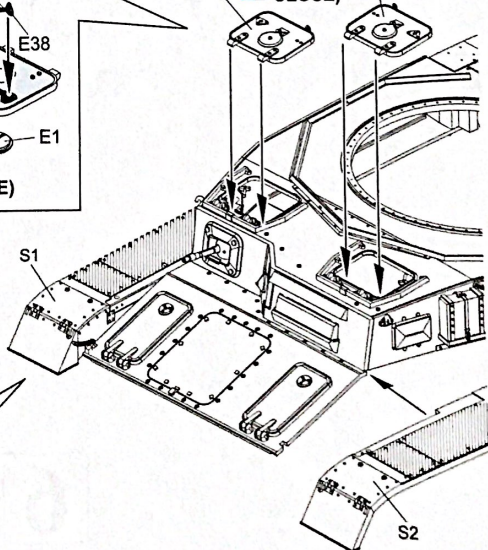
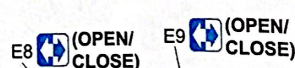
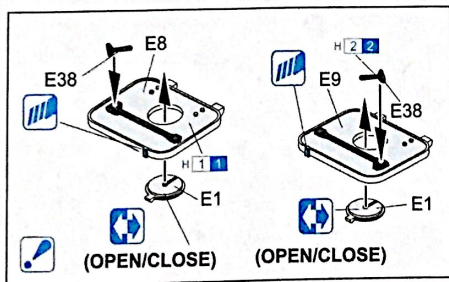



# 11

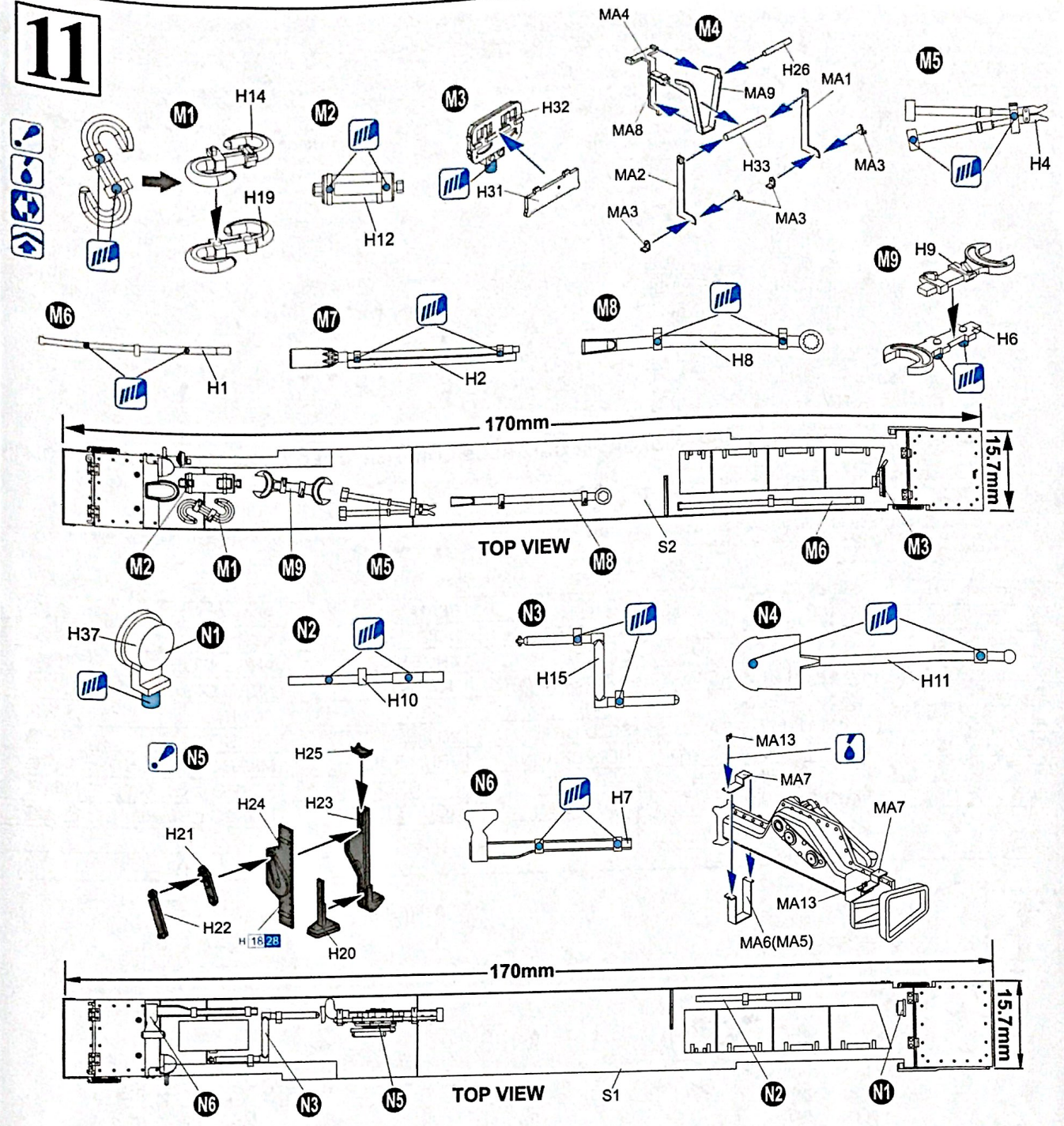

# 12

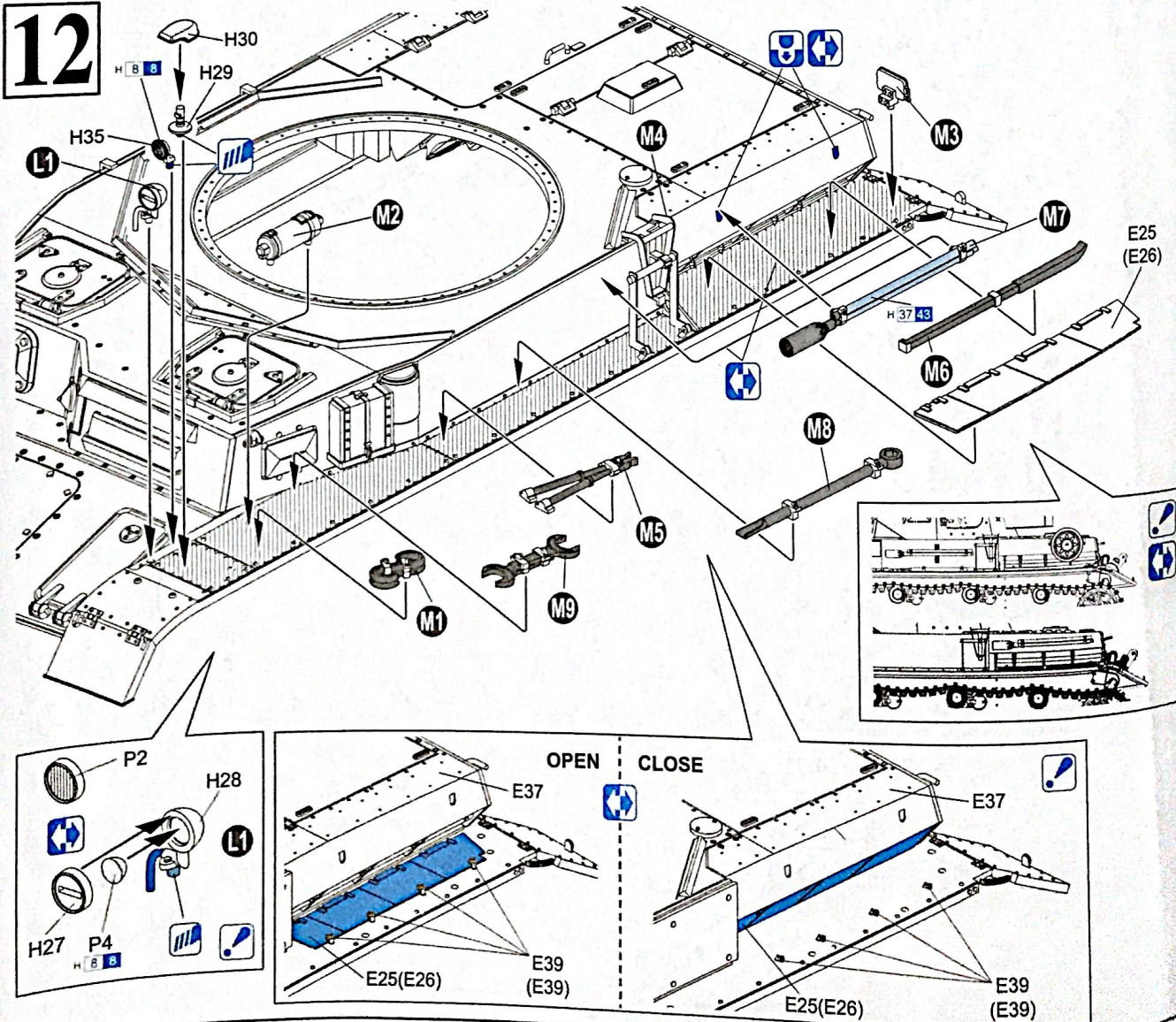



# 13

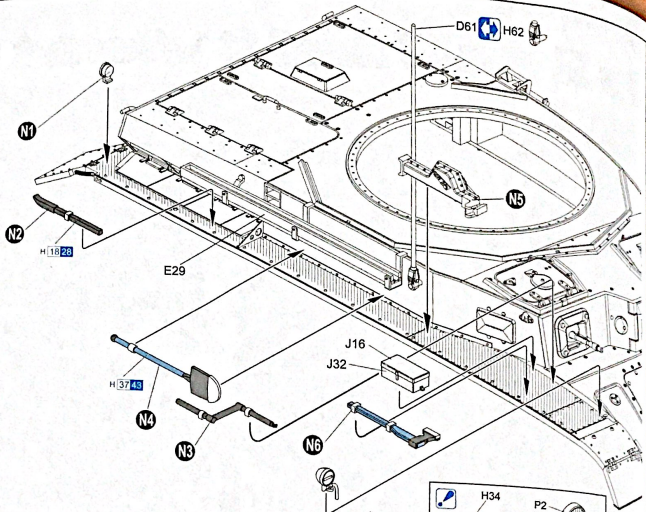

# 14

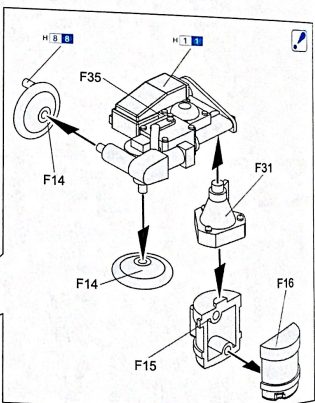
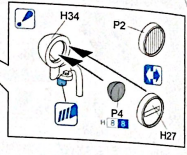
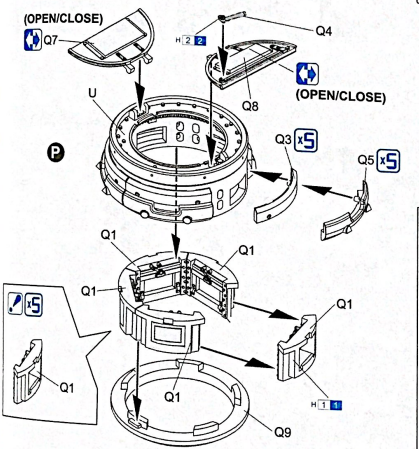

# 15

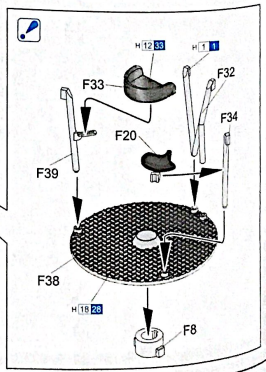
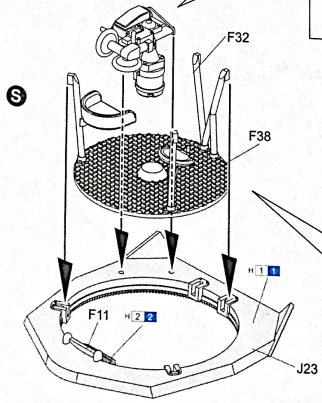



16

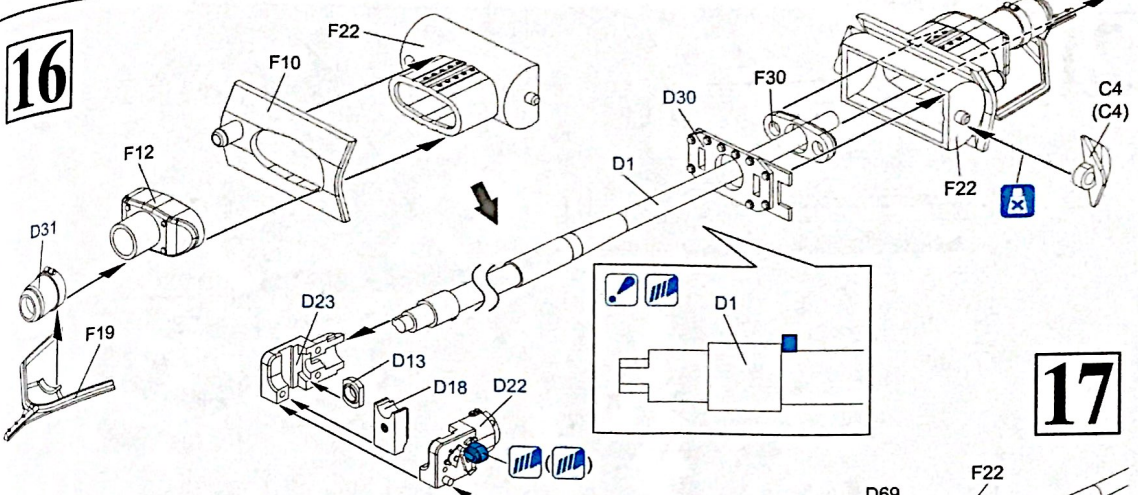

17

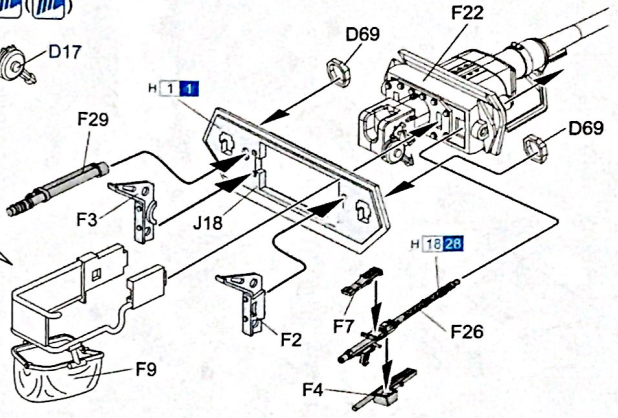
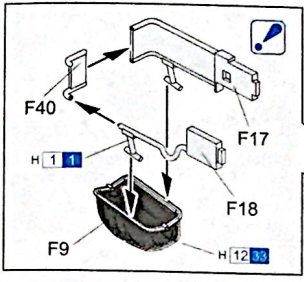

18

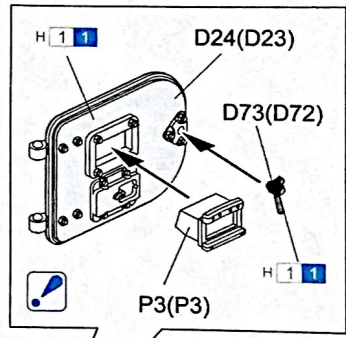
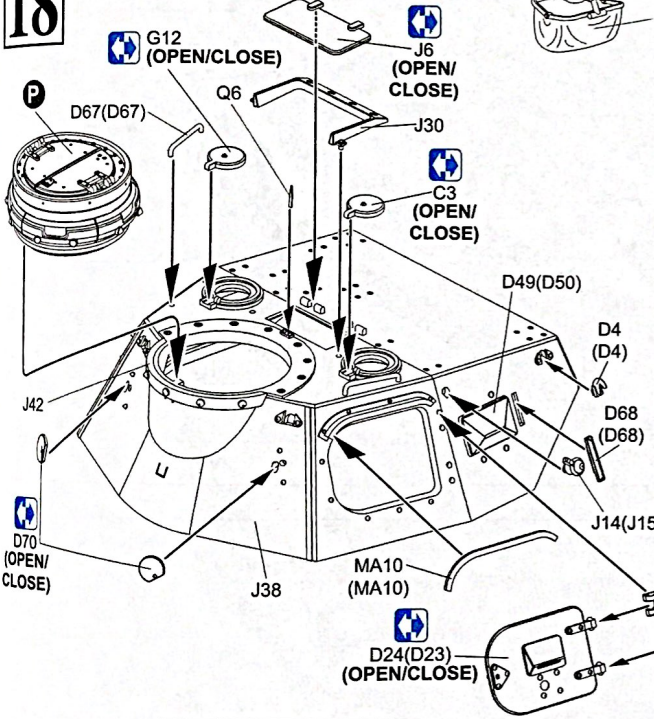

19

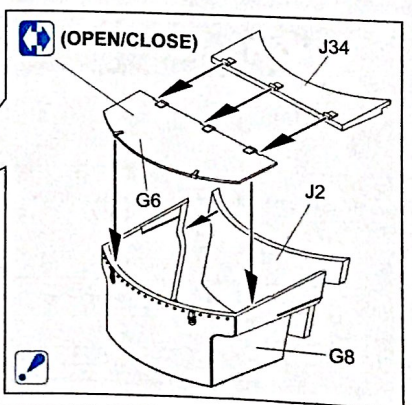
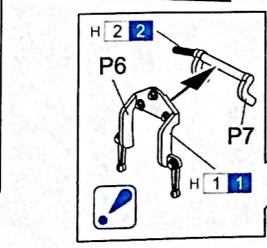
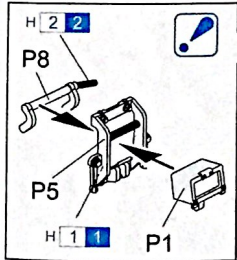
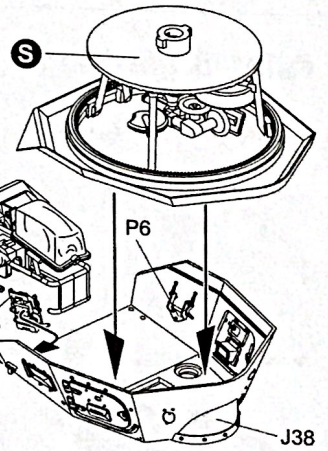

20

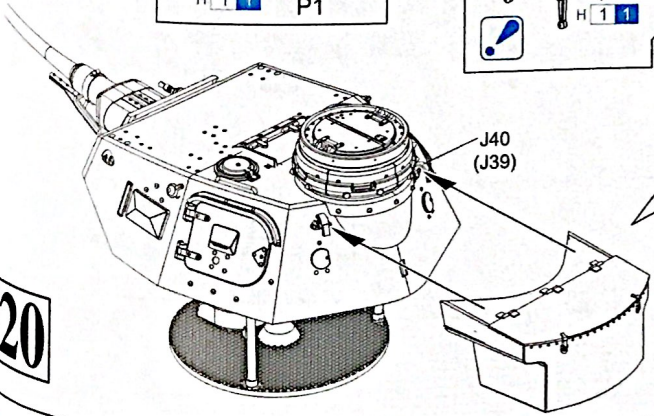



# 21

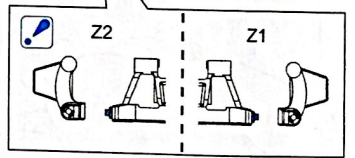
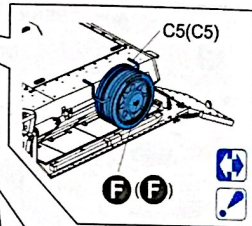
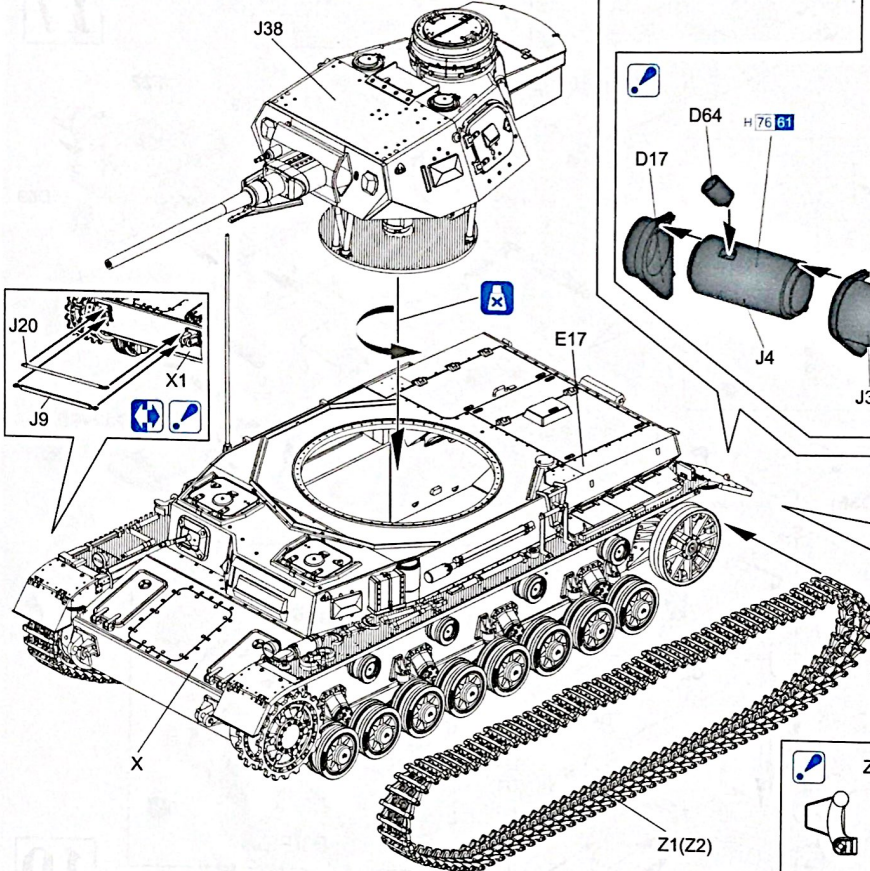
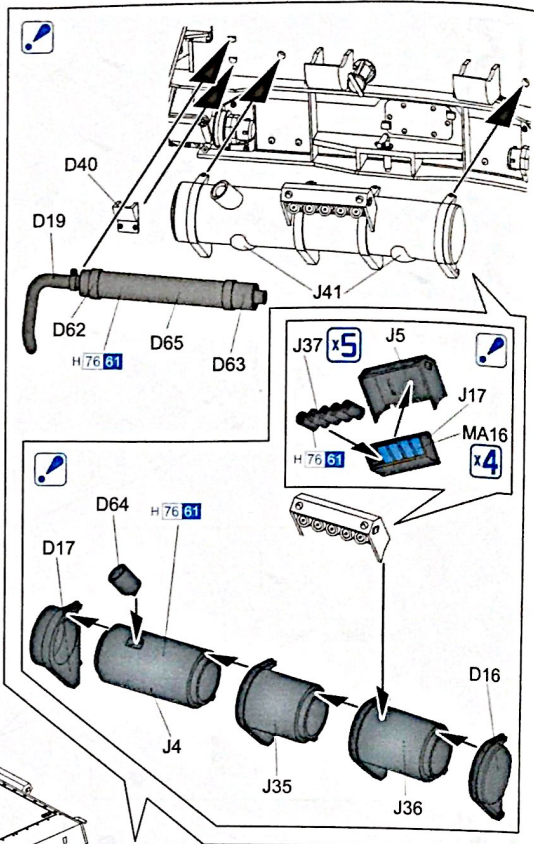
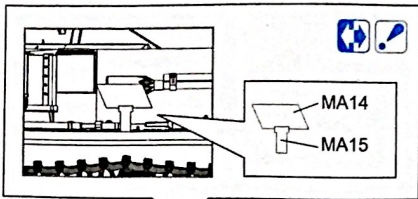

## Paint & Marking

マーキング及び塗装図    Markierungen und Bemalung    標記及着色指示    Decoration et Peinture    Marchio & Pitture

Pz.Kpfw.IV Ausf.D, St. Johann, Tirol, 1942

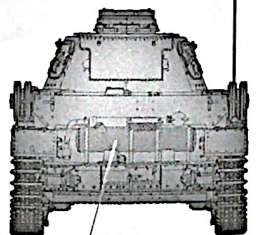
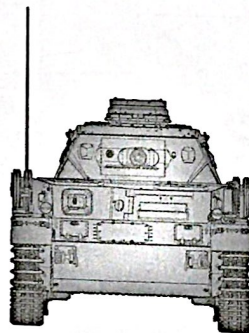
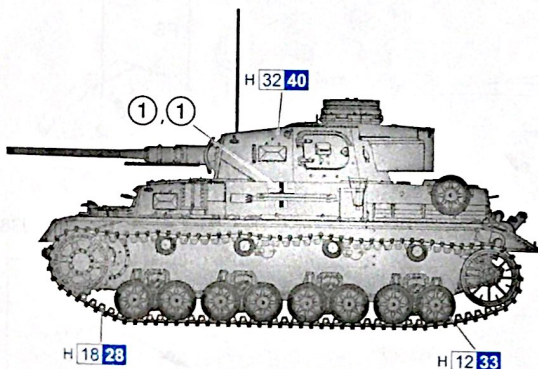

Dragon Europe: c/o Hobby Pro Marketing Ges. m.b.H.  
Am Leonhardbach 7, A-8010 GRAZ, AUSTRIA



Copyright © 2015  
6736-01

<p>■ 正しく貼る方法</p> <ul style="list-style-type: none"> <li>1. 貼る前に、貼る場所をきれいに拭き、乾燥させます。</li> <li>2. 貼る前に、貼る場所をきれいに拭き、乾燥させます。</li> <li>3. 貼る前に、貼る場所をきれいに拭き、乾燥させます。</li> <li>4. 貼る前に、貼る場所をきれいに拭き、乾燥させます。</li> <li>5. 貼る前に、貼る場所をきれいに拭き、乾燥させます。</li> <li>6. 貼る前に、貼る場所をきれいに拭き、乾燥させます。</li> <li>7. 貼る前に、貼る場所をきれいに拭き、乾燥させます。</li> <li>8. 貼る前に、貼る場所をきれいに拭き、乾燥させます。</li> <li>9. 貼る前に、貼る場所をきれいに拭き、乾燥させます。</li> <li>10. 貼る前に、貼る場所をきれいに拭き、乾燥させます。</li> </ul>	<p>■ Correct Method for Applying Decals</p> <ul style="list-style-type: none"> <li>1. Clean the model surface with a wet cloth.</li> <li>2. Cut out each decal design from the decal sheet, and dry it in warm water for 20 seconds.</li> <li>3. Hold the figure in place if the decal is taken from the backing paper. If so, place it in the proper position on the model and slide it off the backing paper with the proper pressure. Hold it in place for a few seconds.</li> <li>4. Gently tap the decal with a soft cotton cloth.</li> <li>5. After the decal is dry, use a wet cloth to gently wipe away any residue left around them.</li> </ul>	<p>■ Die Korrekte Aufbringen der Abziehbilder</p> <ul style="list-style-type: none"> <li>1. Reinigen Sie das Modell mit einem feuchten Tuch ab.</li> <li>2. Schneiden Sie jedes Bild aus dem Abziehbildbogen und trocknen Sie es in warmem Wasser für 20 Sekunden.</li> <li>3. Halten Sie das Figurenmodell fest, wenn Sie das Abziehbild von dem Trägerpapier nehmen. Wenn dies der Fall ist, setzen Sie es an die richtige Position auf das Modell und gleiten Sie es mit dem richtigen Druck von dem Trägerpapier ab. Halten Sie es für ein paar Sekunden fest.</li> <li>4. Klopfen Sie das Abziehbild leicht mit einem weichen Baumwolltuch ab.</li> <li>5. Nachdem das Abziehbild trocken ist, verwenden Sie ein feuchtes Tuch, um das überschüssige Kleber um das Abziehbild herum abzuwischen.</li> </ul>	<p>■ Modulo esatto per applicare le decalcomanie</p> <ul style="list-style-type: none"> <li>1. Pulire la superficie del modello con un panno umido.</li> <li>2. Ritagliare ciascun disegno dal foglio decalcomanie e asciugare in acqua calda per 20 secondi.</li> <li>3. Mantenere in posizione sul modello il disegno e sfiorare con la punta delle dita il foglio di supporto per staccare il disegno dal supporto. Se non è possibile il foglio staccare dal supporto, premere il disegno sul modello con la giusta pressione e mantenerlo in posizione per alcuni secondi.</li> <li>4. Battete il disegno con un panno morbido e pulito.</li> <li>5. Quando le decalcomanie sono secche, togliete con un panno umido l'eccesso di colla intorno alle decalcomanie stesse.</li> </ul>	<p>■ Comment appliquer les décalcomanies correctement</p> <ul style="list-style-type: none"> <li>1. Nettoyer la surface du modèle avec un chiffon humide.</li> <li>2. Découper chaque décalcomanie sur sa feuille de papier et la laisser sécher dans l'eau chaude pendant 20 secondes.</li> <li>3. Maintenir le modèle en position et appuyer sur le dessin à appliquer. Si cela n'est pas possible, appuyer le dessin sur le modèle avec la bonne pression et le maintenir en position pendant quelques secondes.</li> <li>4. Frotter le décalcomanie avec un chiffon doux et propre.</li> <li>5. Lorsque les décalcomanies sont sèches, ôter le surplus de colle autour des décalcomanies avec un chiffon humide.</li> </ul>	<p>■ 貼る上水印標記の正解方法</p> <ul style="list-style-type: none"> <li>1. 貼る前に、貼る場所をきれいに拭き、乾燥させます。</li> <li>2. 貼る前に、貼る場所をきれいに拭き、乾燥させます。</li> <li>3. 貼る前に、貼る場所をきれいに拭き、乾燥させます。</li> <li>4. 貼る前に、貼る場所をきれいに拭き、乾燥させます。</li> <li>5. 貼る前に、貼る場所をきれいに拭き、乾燥させます。</li> <li>6. 貼る前に、貼る場所をきれいに拭き、乾燥させます。</li> <li>7. 貼る前に、貼る場所をきれいに拭き、乾燥させます。</li> <li>8. 貼る前に、貼る場所をきれいに拭き、乾燥させます。</li> <li>9. 貼る前に、貼る場所をきれいに拭き、乾燥させます。</li> <li>10. 貼る前に、貼る場所をきれいに拭き、乾燥させます。</li> </ul>
--	--	--	---	---	---