

1/24 SPORTS CAR SERIES

ACURA NSX

- *HIGHLY ACCURATE DISPLAY MODEL
- *AUTHENTIC UNDERSURFACE AND SUSPENSION
- *COMPLETE ENGINE DETAIL
- *COMPLETELY DETAILED EXTERIOR AND INTERIOR
- *REALISTIC RUBBER LIKE TIRES

KIT NO. 24101A

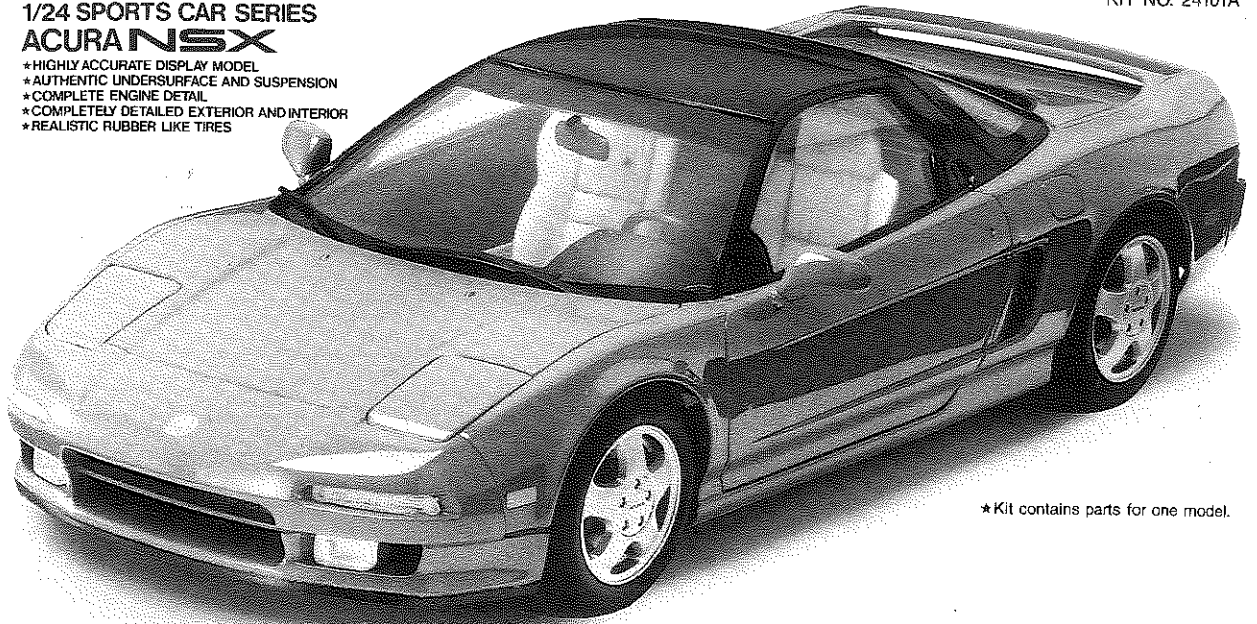

*Kit contains parts for one model.

Starting as a motorcycle manufacturer in 1948, the Honda Motor Company of Japan has risen to a point in racing, where their engines now dominate the Formula-One circuits, the pinnacle in automotive achievement. During the 1989 Geneva Show in Switzerland, onlookers were in awe, as top-ranked Formula-One race drivers Ayrton Senna and Alain Prost debuted Honda's most recent accomplishment, the Acura NSX. The latest in automotive technology, is blended with Honda's competitive experience and

passenger compartment. This lightweight, compact and high revving engine uses variable valve timing, called VTEC. Through a unique camshaft and rocker arm design, VTEC literally changes the valve timing and rise over the entire powerband, making for optimum low-end torque and high-end speed. The forged aluminum, double-wishbone suspension system is designed to take sport-driving abuse while providing excellent street-driving comfort. The car is furnished with a 4-channel anti-lock braking sys-

ACURA NSX

introduced into this totally new sports car. It is a car that reflects an engineers goal of a lightweight chassis matched to an engine that can provide speed and quickness without overpowering the car's responsiveness and road feel. The car has been kept as compact as possible and most of the vehicle is constructed from various aluminum alloys. The body shell, suspension and chassis components are fabricated from aluminum. The all-aluminum powerplant in the NSX is a transverse mounted, 3 liter, twin-cam V-6 cylinder engine, mounted amidship just behind the

tem specifically designed for a rear-wheel drive car. Using four separate channels, each wheel can be independently controlled for optimal performance on even the worst road surfaces. The ergonomically designed interior is spacious and intelligently laid-out for both the driver and passenger. All of the gauges and controls are well within the driver's line of sight and reach, and the large canopy-type windows that provide excellent outward visibility. The Acura NSX....Formula-One technology for the driving public.

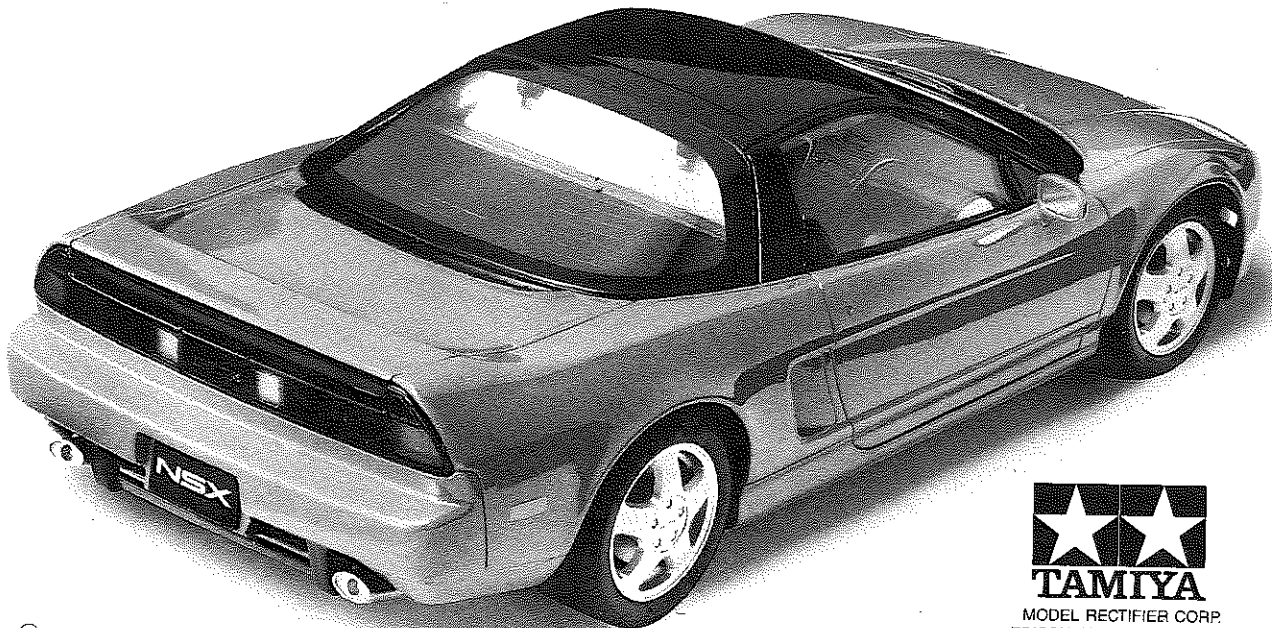

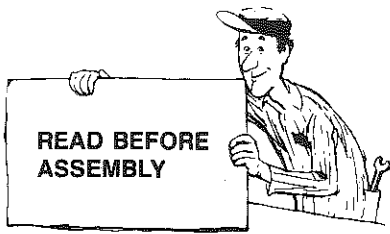

- ★ Study the instructions thoroughly before assembly.
- ★ Use plastic cement and paints only (available separately).
- ★ Use cement sparingly and ventilate room while constructing.
- ★ Remove plating from areas to be cemented.

BODY COLOR

★ Body color called out during construction is the "Sebring Silver". Refer below for body colors.

Body color	Tamiya Color No.
Formula Red	TS-8 (X-7)
Berlina Black	TS-14 (X-1)
Sebring Silver	TS-17
Kaiser Silver	TS-38 (X-10)
Neutron White	TS-26 (X-2)
Indy Yellow	TS-16 (X-8)
Charlotte Green	X-1:8+X-5:2+X-10:1

★ Tools required.

Cement



Side cutter

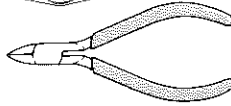

Modeling knife

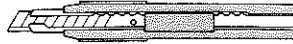

Tweezers

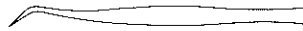

Scissors

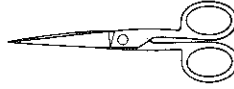

★ Cellophane tape is required.
★ Tamiya Finishing Abrasives are also available.

☛ This mark denotes numbers for Tamiya paint colors (X and XF for Acrylic and Enamel; TS for Spray Paints). Page 10 has painting instructions. Some parts should be painted prior to model's completion, and they are called out during construction. Take care if overspraying the model with clear, as it could harm the decals.

Italian red	TS-8
Black	TS-14
Yellow	TS-16
Gloss aluminum	TS-17
Pure white	TS-26
Gun metal	TS-38
Black	X-1
White	X-2
Green	X-5
Red	X-7
Lemon yellow	X-8
Gun metal	X-10
Chrome silver	X-11
Gold leaf	X-12
Semi gloss black	X-18
Clear orange	X-26
Clear red	X-27
Flat black	XF-1
Flat white	XF-2
Flat aluminum	XF-16
Metallic grey	XF-56

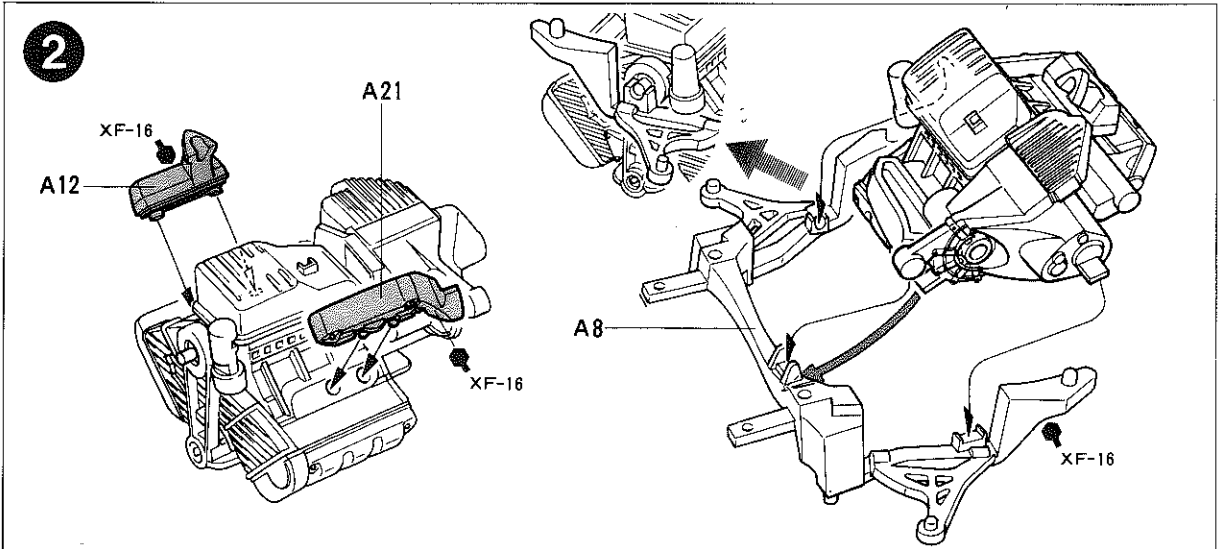
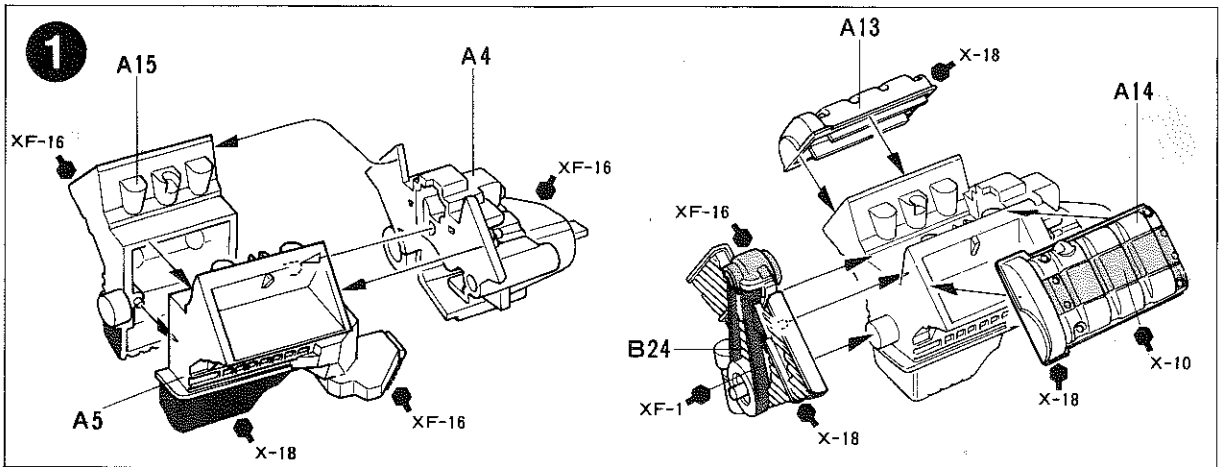

3

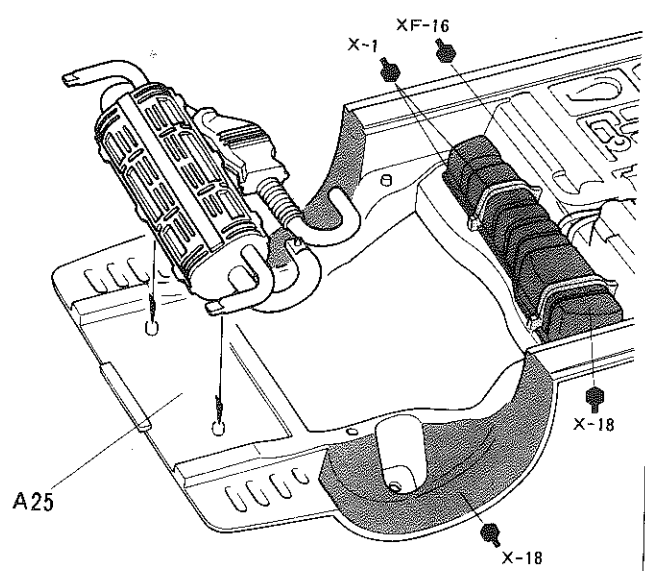
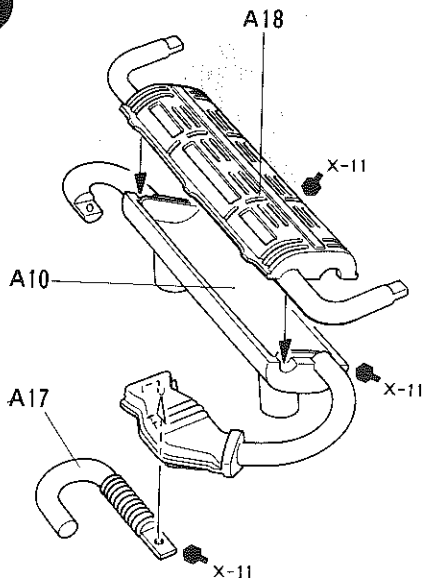

4

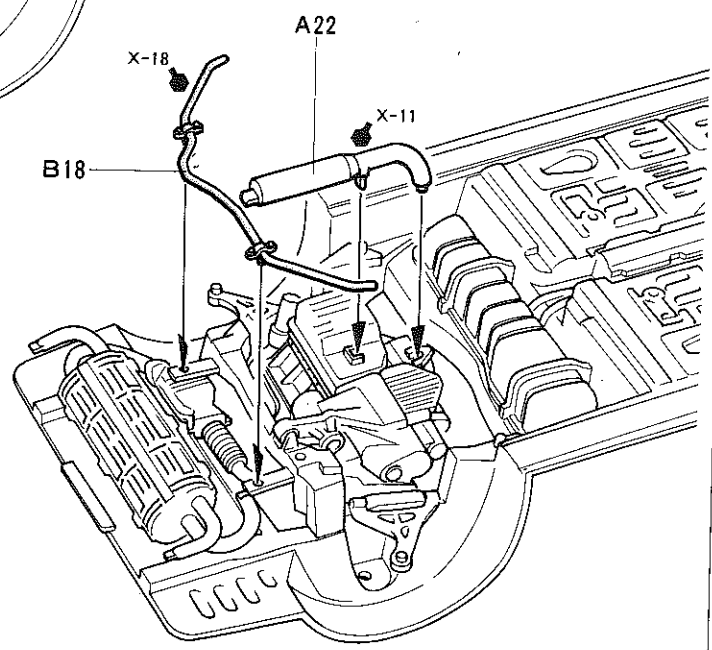
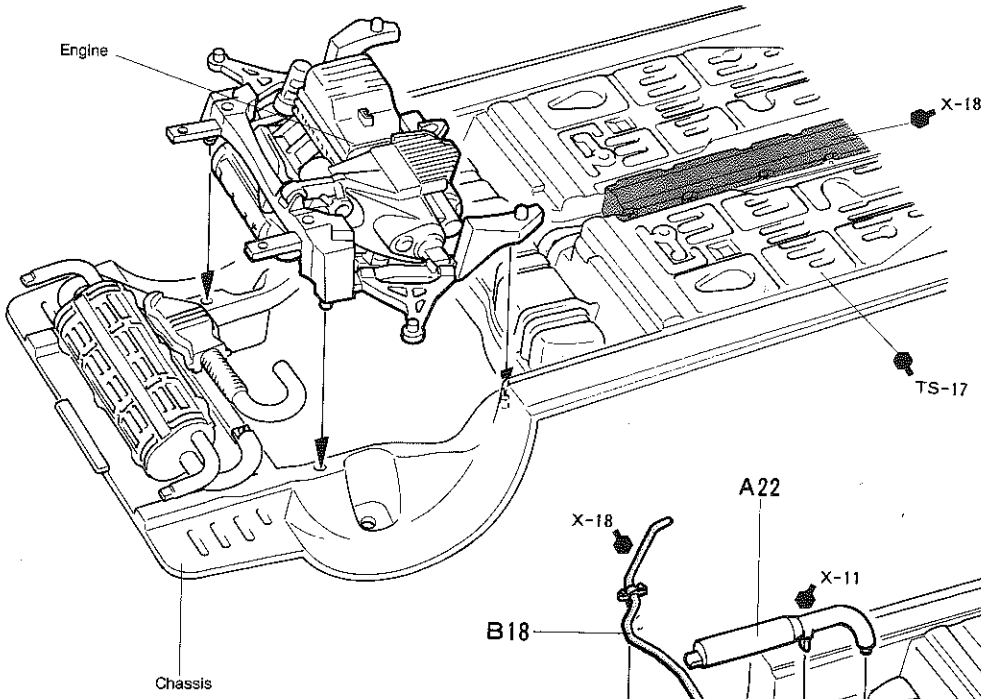

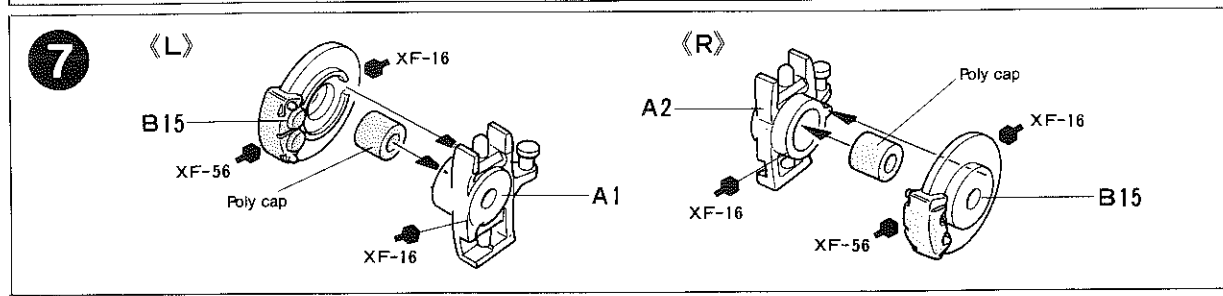
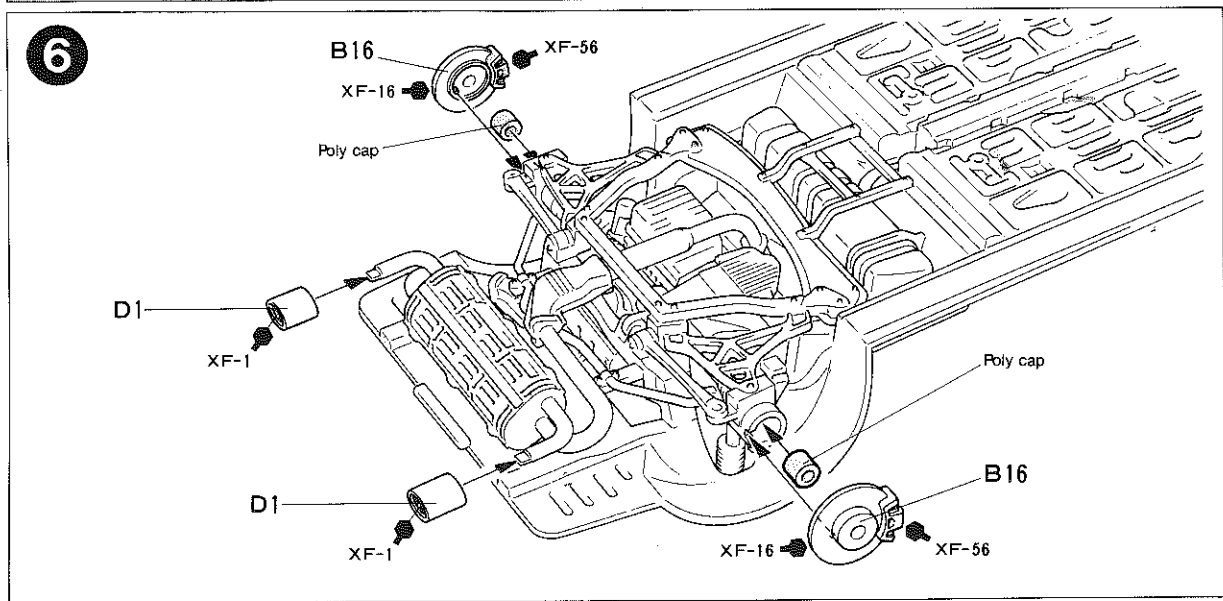
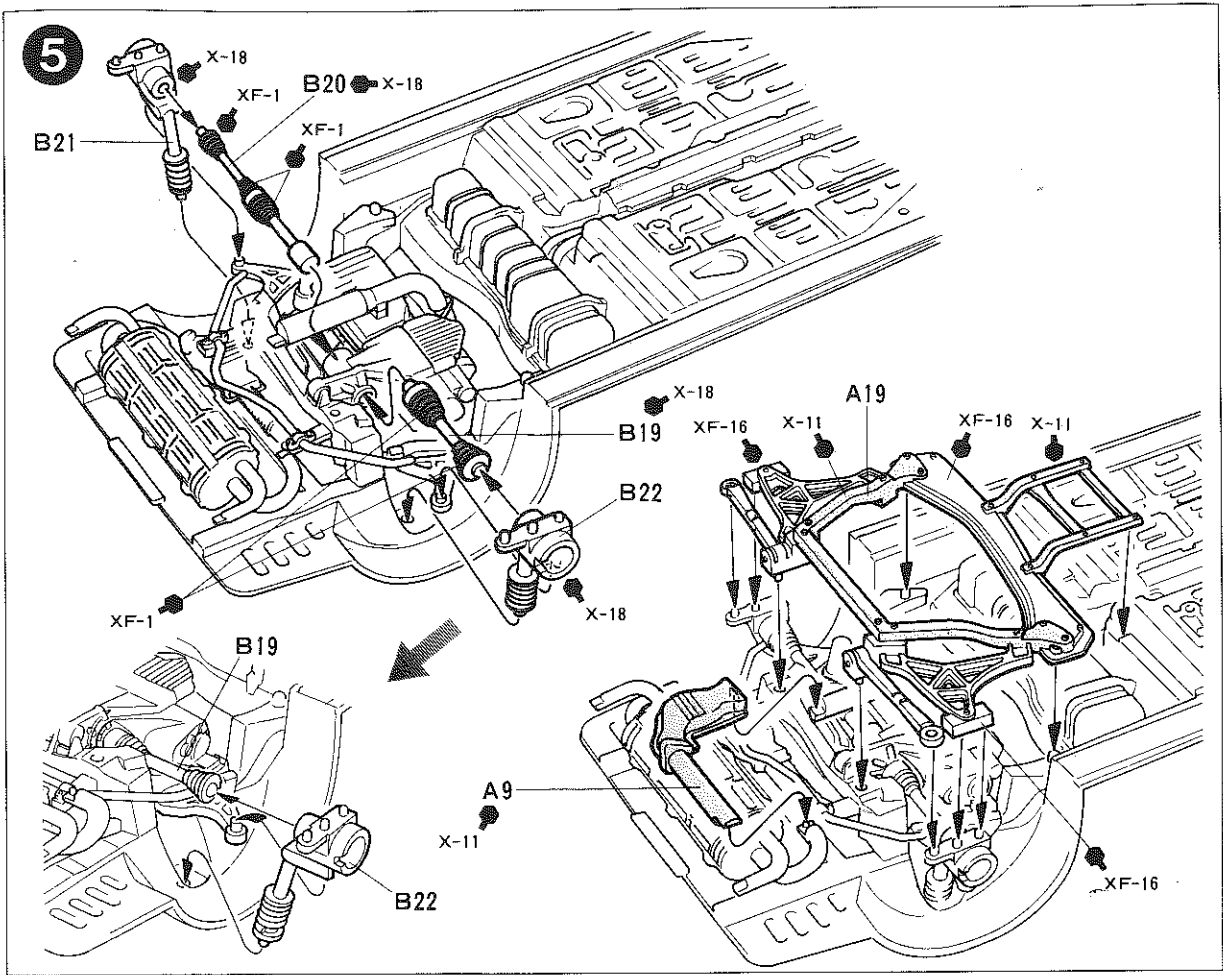

8

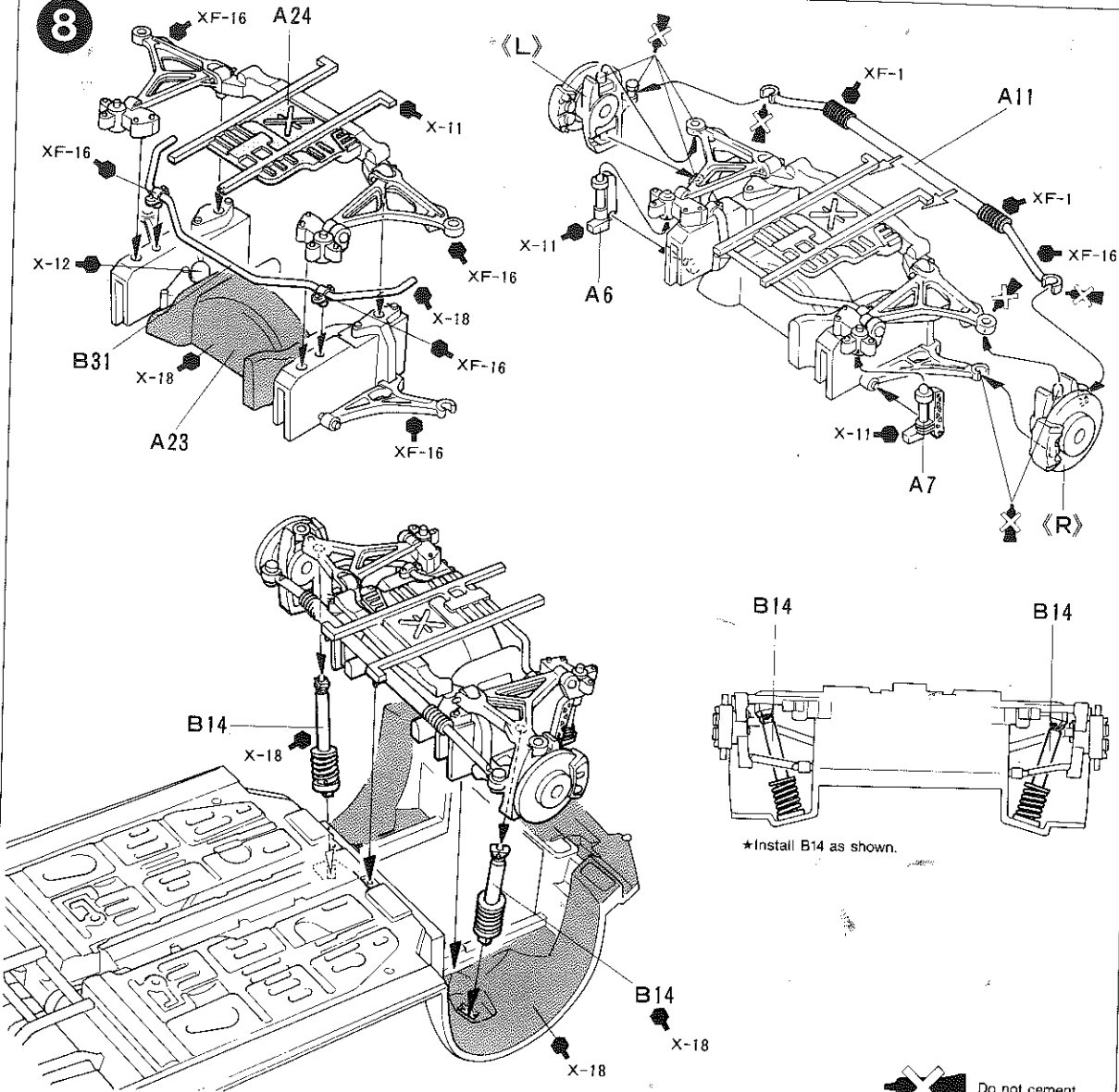

9

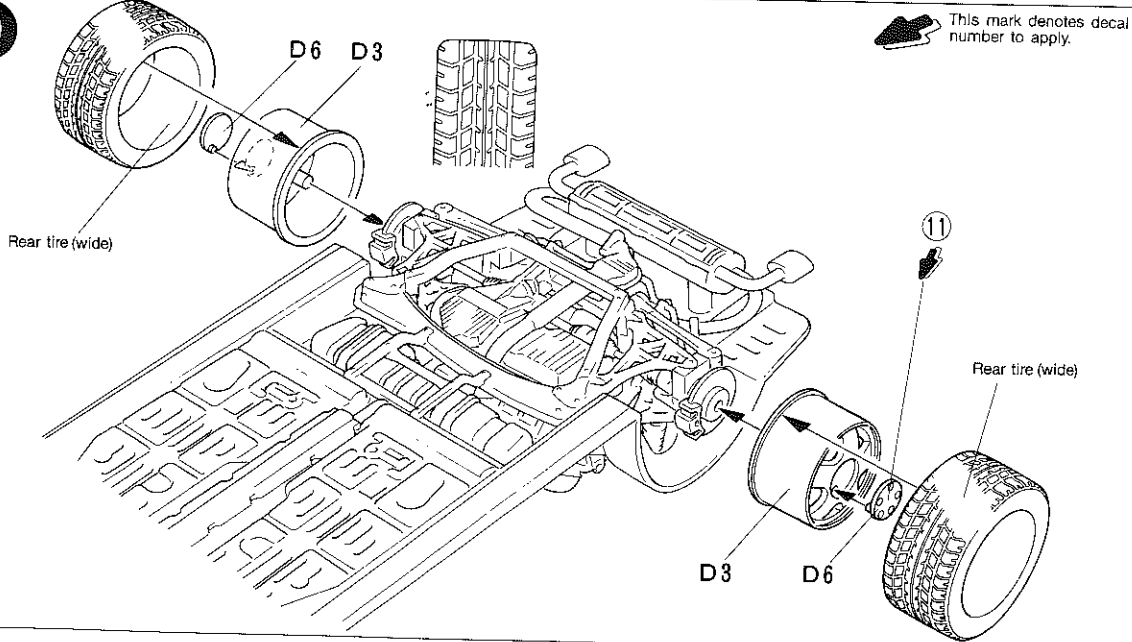

10

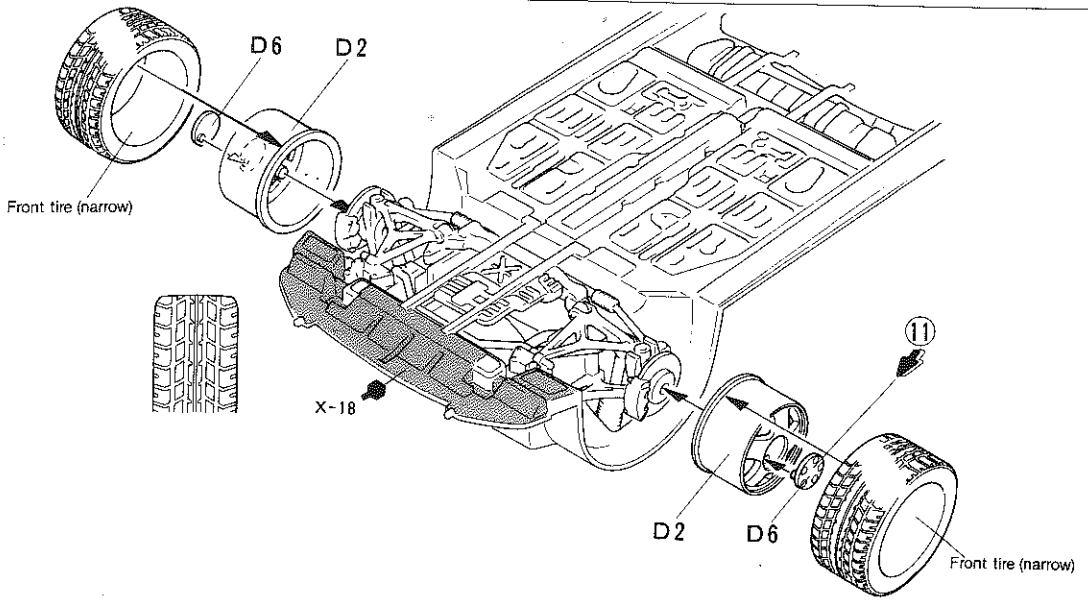

11

<<Center console>>

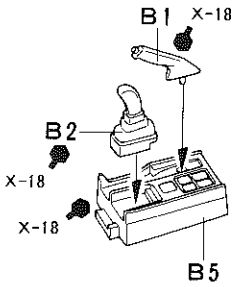

<<Dashboard>>

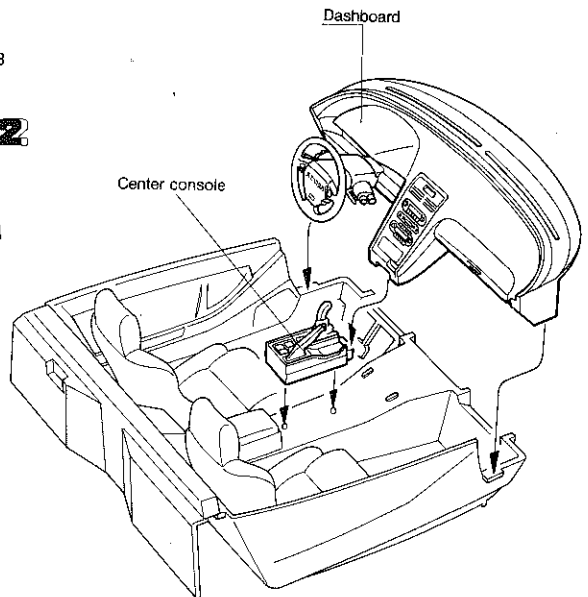
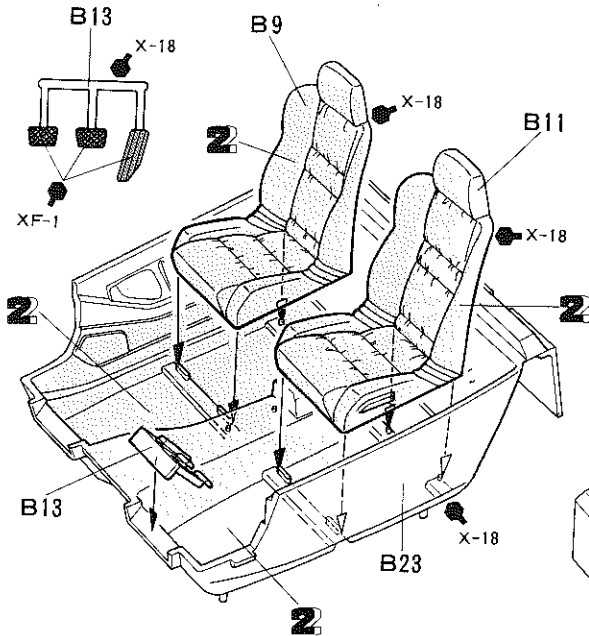
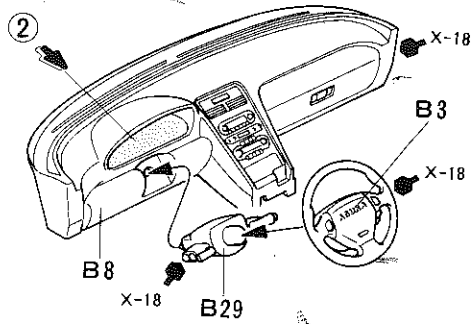

2 This mark shows using XF-2 Flat White for a two-toned interior.

12

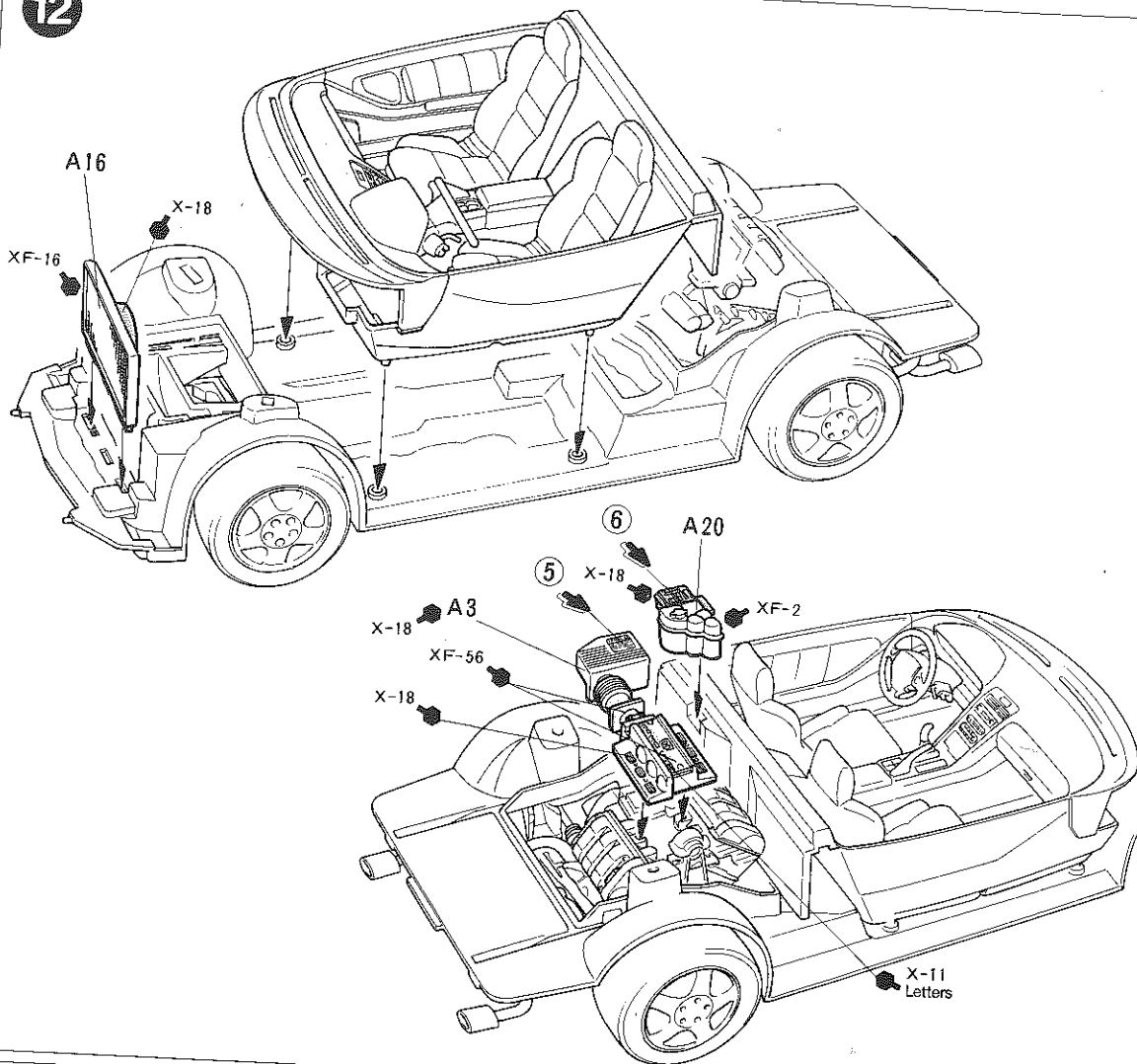

13

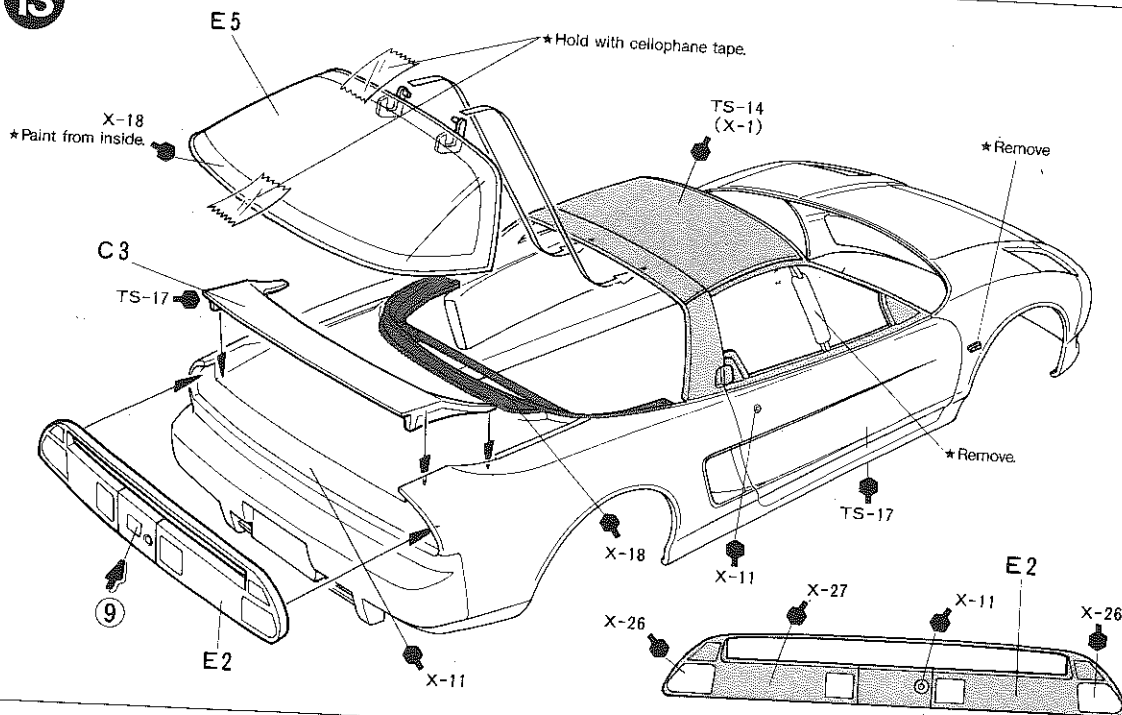

16

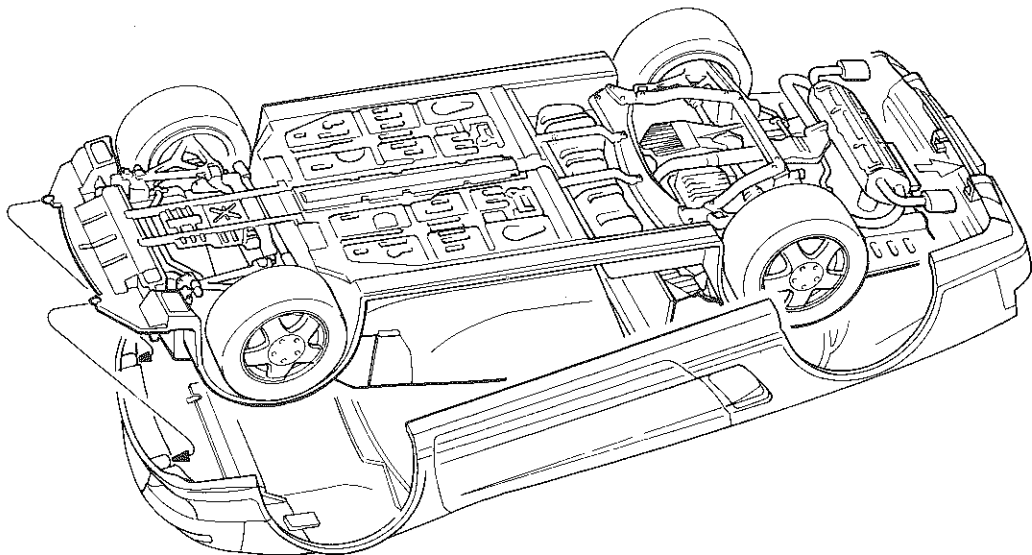

17

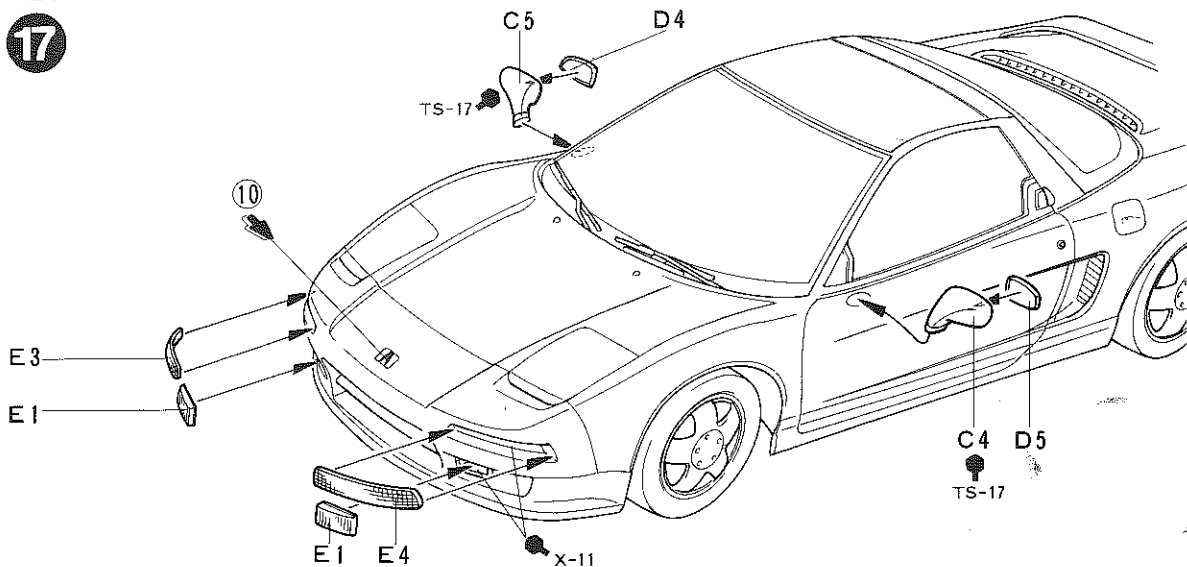

18

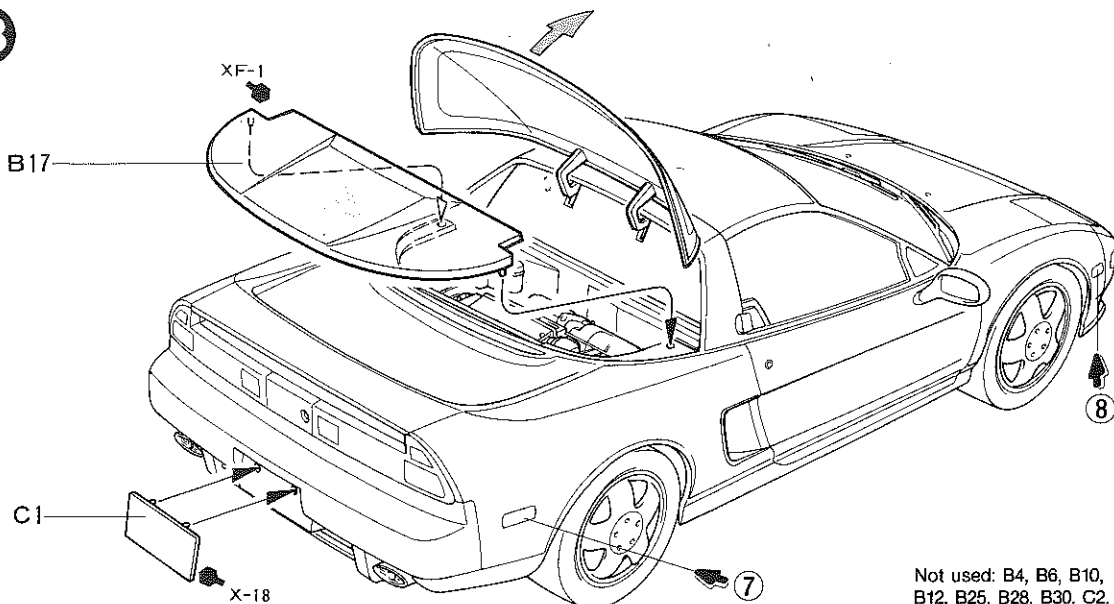

Not used: B4, B6, B10, B12, B25, B28, B30, C2.

PAINTING

PAINTING THE ACURA NSX

The Acura NSX is offered in 7 different body colors. 3 pearl colors of green, white, yellow; 2 different shades of silver; and a solid red or black. Interior is finished in black or black & white two-tone. Detail painting is called out during construction and should be done at that time. Take care if overspraying the model with clear, as it could harm the decals.

PAINTING & MARKINGS OF THE ACURA NSX

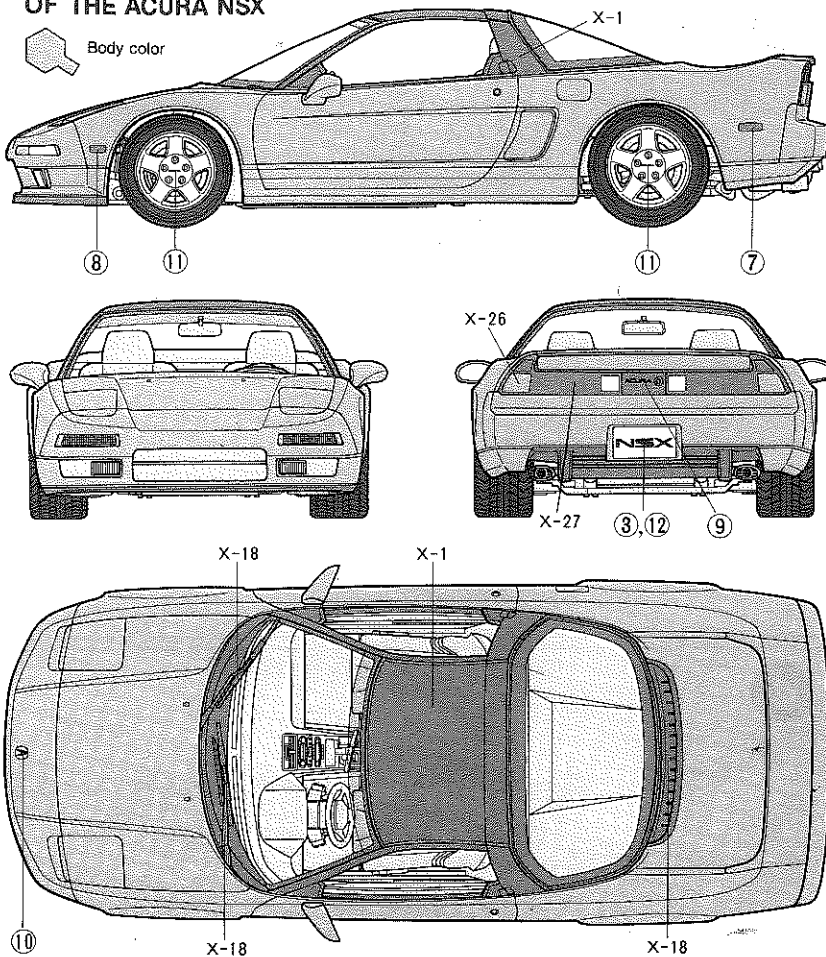

APPLYING DECALS

DECAL APPLICATION

- (1) Remove all dust, dirt and adhesive smears with a wet cloth before applying any decals.
- (2) The decal to be applied should be cut out beforehand from the decal sheet. Cut off translucent film along colored edge.
- (3) Dip the decal in tepid water for about 10 seconds and then place it onto a clean cloth. Be careful of over immersion to avoid loss of decal's adhesive.
- (4) Hold the backing sheet edge and slide the decal onto the model.
- (5) Wet the decal with a little water on your finger so that it can be moved more easily into position.
- (6) Press the decal down gently with a clean soft cloth to remove air bubbles and until all excess water has been fully absorbed. When a decal has to be applied to a surface which is uneven or curved, press the decal down with a hot towel so that the decal will fit the contours perfectly. Cut off the excess transparent portion around each decal. The decal must then not be touched until dry.

BUILD A COLLECTION OF TAMIYA PRECISION MODEL CARS.

MERCEDES-BENZ AMG 500SL 6.0-4V (24095)

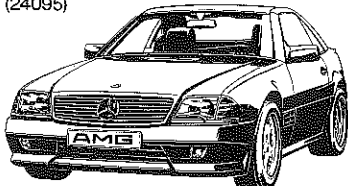

TOYOTA CELSIOR (24096)

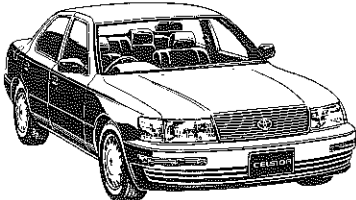

ACURA NSX TECHNICAL DATA

Overall length	4405mm	Engine	DOHC, V-6 cylinder
Overall width	1810mm	Displacement	2977cc
Overall height	1170mm	Maximum power output ..	270PS/7100rpm (5MT)
		Maximum torque	29.0kg-m/5300rpm

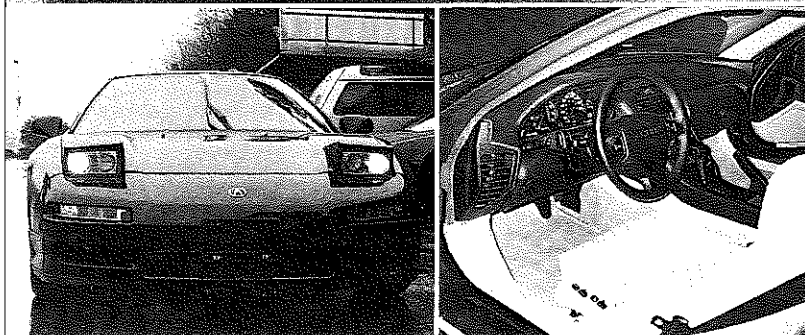

TAMIYA MODEL ★★ MAGAZINE INTERNATIONAL

A magazine for enthusiasts who make or modify models of all kinds. From the neophyte to the expert, articles of interest about modeling and the full sized vehicle. Coverage of all plastic kit maker's products.

TAMIYA COLOR CATALOGUE

The latest in cars, boats, tanks and ships. Motorized, radio controlled and museum quality models are all shown in full color in Tamiya's latest catalogue. English, German, French and Japanese versions available.