

M60A1 RISE WITH M9 DOZER BLADE

ACADEMY

HOBBY MODEL KITS

TA987
#1390

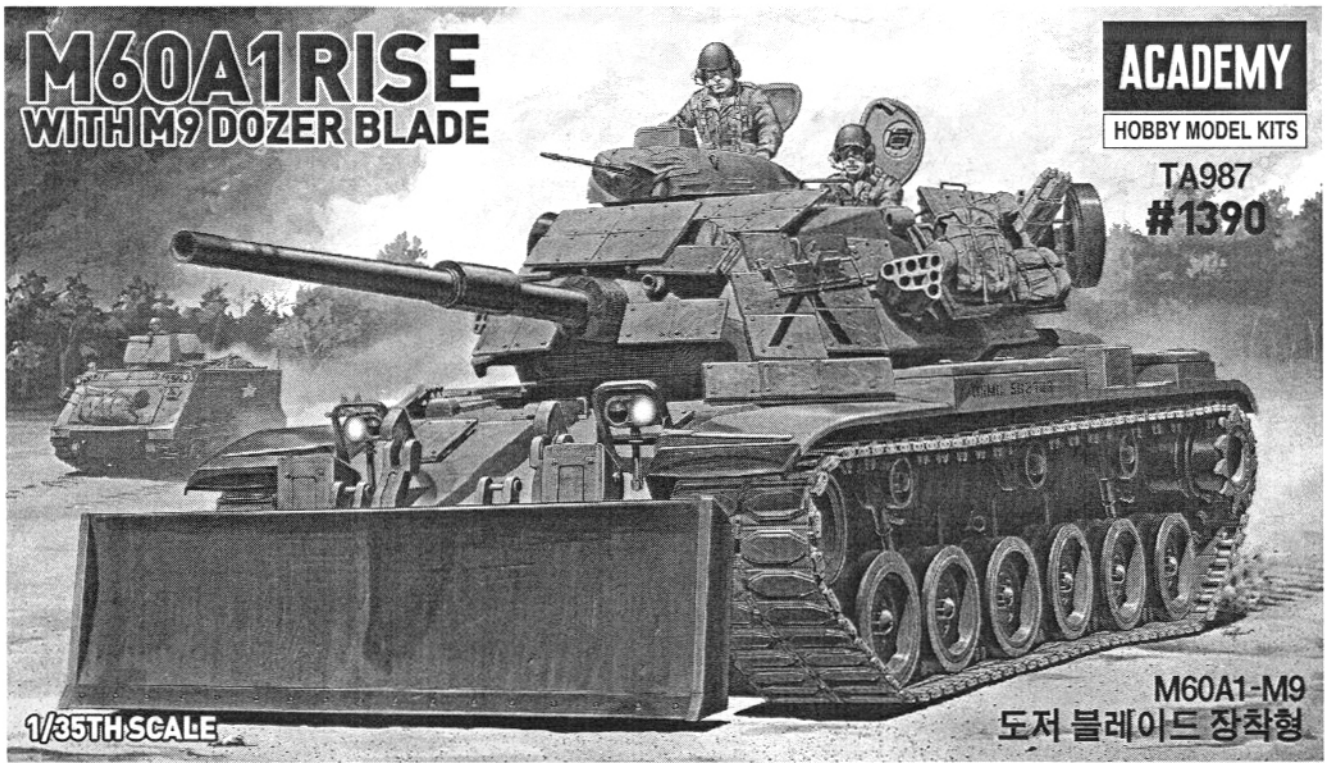

1/35TH SCALE

M60A1-M9
도저 블레이드 장착형

U.S. M9 DOZER BLADE

The value of a bulldozer for removing obstacles or debris became clear in World War 2. The advantage of having such a device mounted on a combat tank, which in the mean time retained its fire power, was even greater. In World War 2, dozer blades were mounted on the M4 Sherman which on many occasions came to the aid of standard convoys while under fire, capable of anticipating any hostile threat. After World War 2, dozer blade kits were mounted to the M46 and M47 tanks to further improve the system. When the M48 and M60 tank became available, a standardized newly bulldozer blade assembly was fitted and more test runs were accomplished until the late 1960's. The M9 dozer blade became the standard configuration of the U.S. Forces.

Der Wert eines Dozer Blades für die Abschaffung von Hindernissen oder Trümmern wurde klar im zweiten Weltkrieg. Der Vorteil dadurch, daß man eine solche Vorrichtung an einem Kampfpanzer montierte, der seine Feuerkraft behielt, war enorm. Im zweiten Weltkrieg wurden Dozer Blades am M4 Sherman montiert, der in meisten Fällen zur Hilfe beim Standardkonvoi kam, während er unter Beschuß eine gegnerische Drohung antizipieren konnte. Nach dem zweiten Weltkrieg wurden Dozer Blade-Ausrüstungen an den M4 und M47 Panzern montiert, um das System noch zu verbessern. Als der M48 und der M60 Panzer verfügbar wurden, wurde ein standardisierter und neuer Bulldozer Blade montiert und wurden mehr Proberennen unternommen bis zum Ende der 60er Jahren. Der M9 Dozer Blade wurde zur Standardkonfiguration der U.S. Forces.

La capacité, pour un bulldozer, de franchir des obstacles ou des débris est devenue une réalité durant la seconde guerre mondiale. L'avantage d'avoir un engin solide et très mobile, qui plus est bien armé, était énorme. Pendant la seconde guerre mondiale, des lames de bulldozers furent montées sur des Shermans M4, qui aidèrent à déblayer sous les tirs ennemis tout en opposant leur puissance de feu. Après la seconde guerre mondiale, des lames furent également montées sur des M46 et des M47 pour éprouver le système. Lorsque les M48 et les M60 furent disponibles, un nouveau tank bulldozer standard fut créé et des tests furent effectués jusqu'à la fin des années 60. Pour les forces armées Américaines, le standard des tanks bulldozers est devenu le M9.

파괴된 장애나 장애물을 처리하는 임무를 수행하는 불도저의 효용성은 2차 대전 중 크게 부각되었다. 게다가 일정한 화력을 보유하고 있는 전투 전차에 이러한 장치를 부착했을 경우 그 효과는 더욱 커지기 마련이다. 2차 대전 중 도저 블레이드는 M-4 셔먼 전차에 장착되어 어떠한 적의 위협에도 대응할 수 있는 화력으로 많은 작전에서 선도 임무를 수행하였다. 2차 대전 후 도저 블레이드 장치는 더욱 향상된 시스템으로 M-46과 M-47 전차에 장착되었고, M-48과 M-60 전차가 등장한 시점에서는, 새로운 도저 블레이드 장비가 정식 채용되어 60년대 후반 까지 시험 가동이 이루어 졌다. 현재 M-9형 도저 블레이드는 미군의 표준 제식 장비로 현역에서 활약하고 있다.



접착한다.
Cement Parts
Collar
Kleben
Pagar
Incollare
Colar
Kleben



접착하지 않는다.
DO NOT cement
Ne pas coller
Nicht kleben
No pegar
Non incollare
Nao colar
Niet kleven



잘라낸다.
Cut away
Couper
schneiden
Cortar
Tagliare
Cortar
Snijden



선택한다.
Optional parts
Choix
Auswahlmöglichkeit
Eleccion
Soelta
Opcao
Keuze



수만큼 조립한다.
Repeat operation
Répéter l'opération
Vorgang wiederholen
Repetir la operación
Ripetere
Repitir a operação
Herhalen

3

<Read this before you begin>

- Study the instructions before assembling.
- Check the fit of each piece before cementing into place.
- Do not use too much cement to join parts.
- Never use cement or paint near open flame.
- Open a window or make area well ventilated when cement or paint is in use.
- Tear up and throw away the empty plastic bags to avoid danger of suffocation for little children.

- 조립하기 전에
 - 부품을 조립하기 전에 설명서를 잘 읽어본 후 조립한다.
 - 부품을 자를 때에는 칼이나 니퍼로 깨끗이 잘라준다.
 - 접착제를 사용할 곳과 사용하지 않는 곳에 주의하고 너무 많이 바르지 않도록 한다.
 - 접착하기 전에 부품을 맞추어 확인한 후 조립한다.
 - 에나멜 페인트나 접착제를 사용할 때는 창문을 열어 환기를 시키고 화기를 멀리한다.
 - 사용 후 남은 부품은 어린 아이들의 손에 닿지 않도록 잘 처리한다.

1

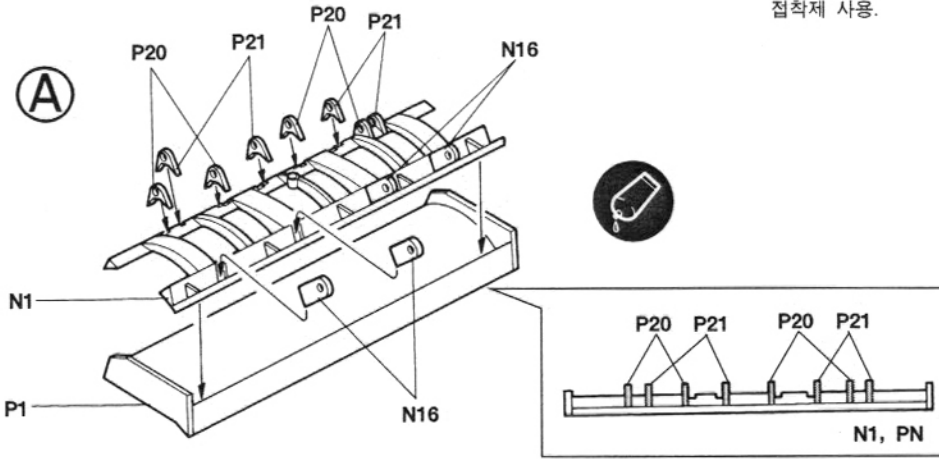

→ Cement
Kleben
Coller
접착제 사용.

--> Do not cement
Nicht kleben
Ne pas coller
접착제 사용금지.

2

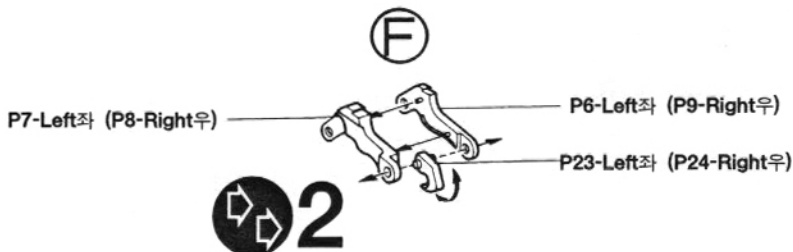
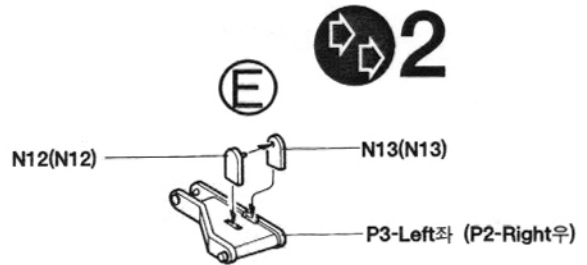
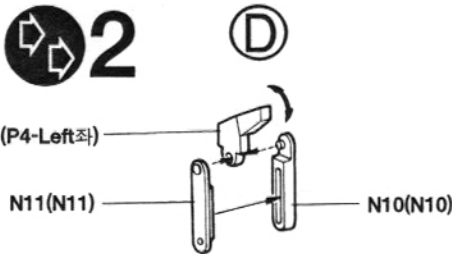
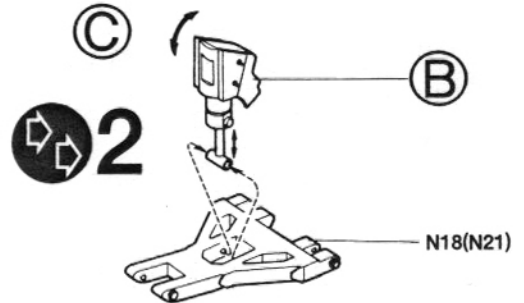
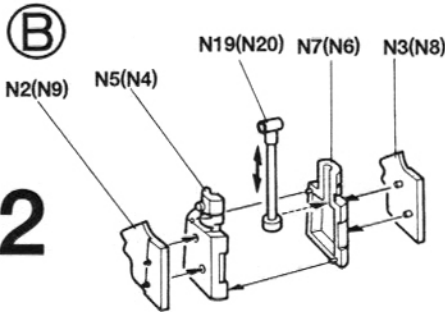

3

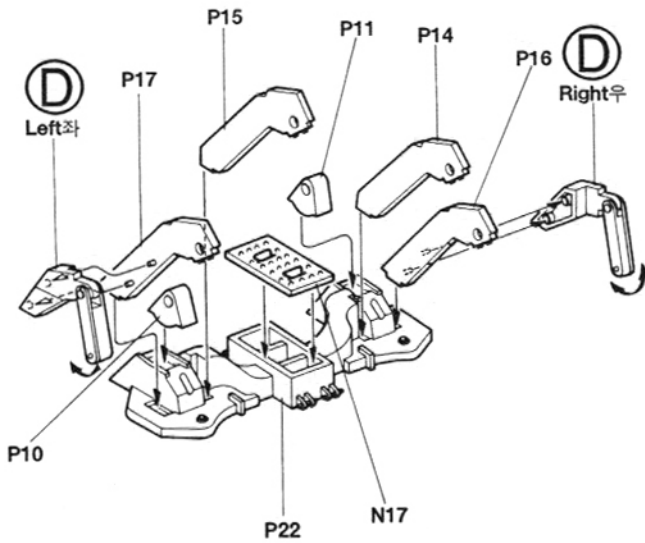

4

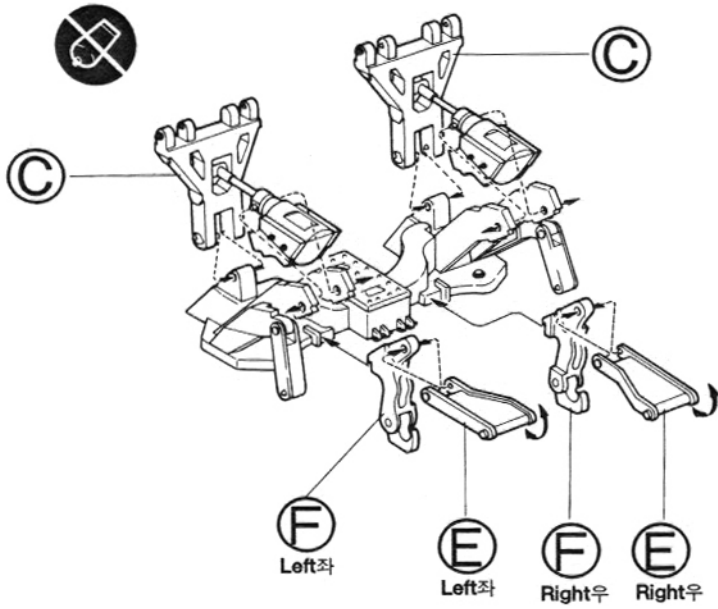

5

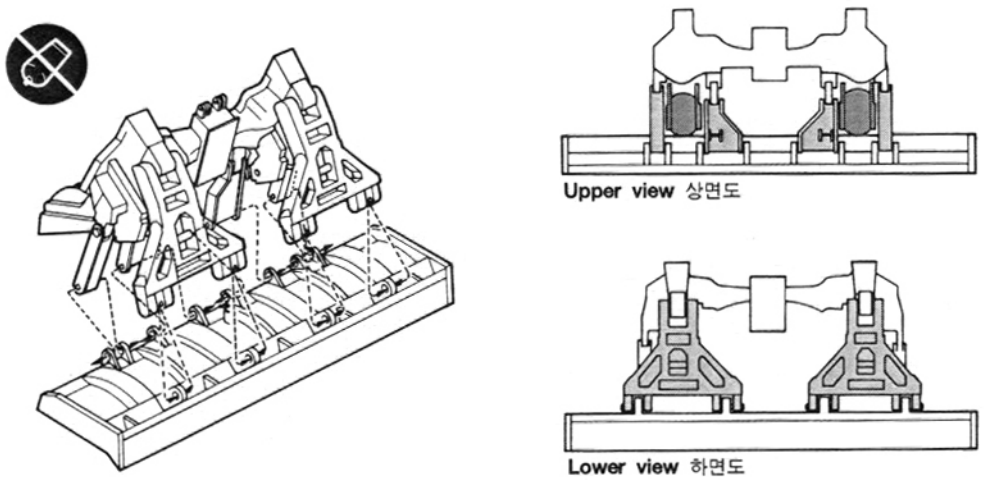

6

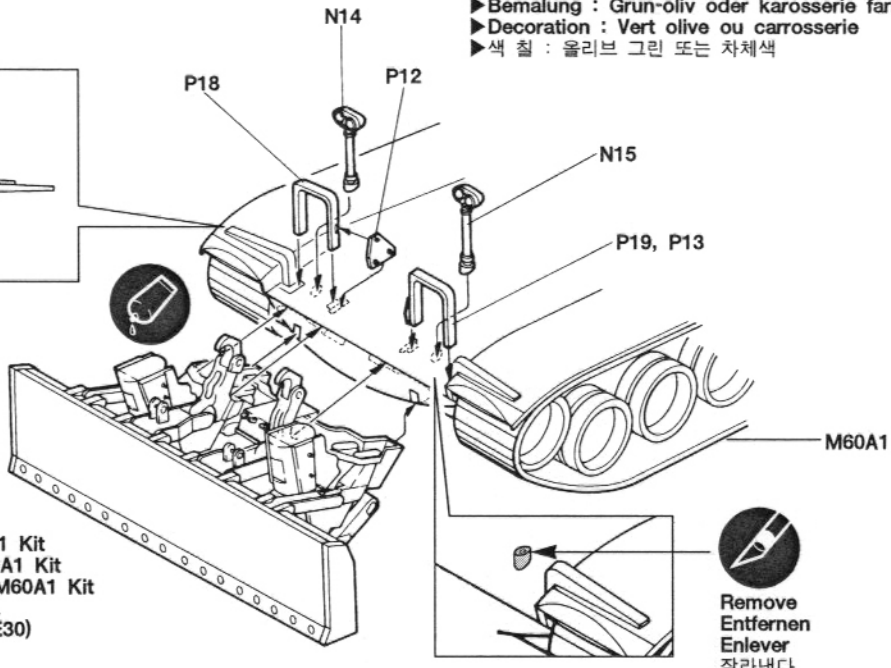
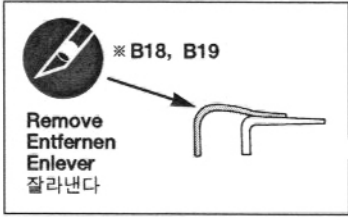

Parts not used - M60A1 Kit
 Nicht verwenden - M60A1 Kit
 Pièces non utilisées - M60A1 Kit
 불필요 부품 - M60A1 키트
 (G26, G27, C30, C31, E30)

Parts Locating Diagram 부품도

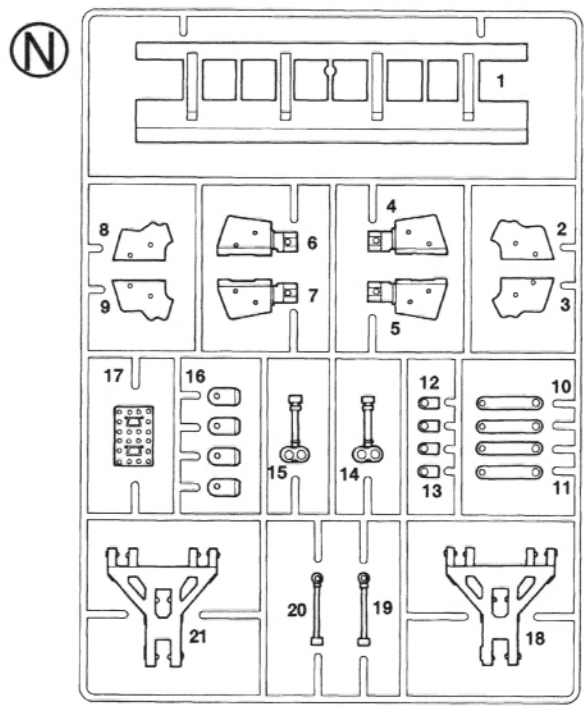
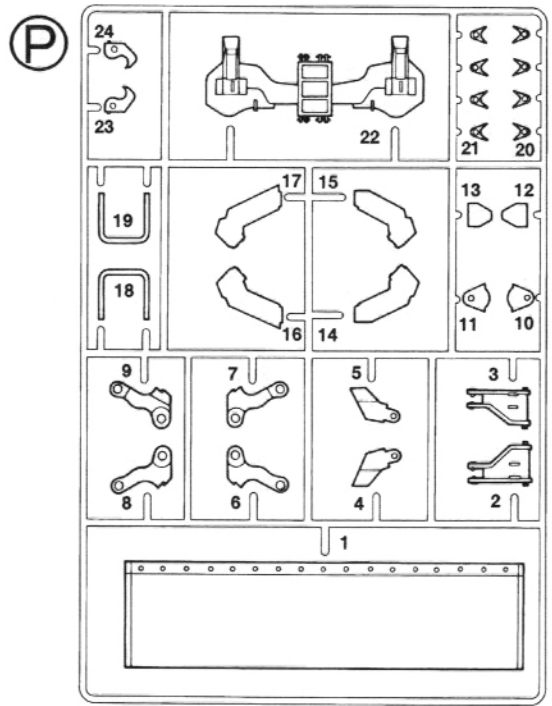

■ 직매점 겸 A/S센터 삼선교:742-9293, 대치동:552-9293, 양재동:575-9997, 용산:706-9293
 ■ A/S센터 본사:908-7000(교환147), 동대문:745-9293, 천호동:473-9293
 ■ 휴먼점 겸 A/S센터 노원아카데미:907-0940, 양천아카데미:691-7108, 강남아카데미:522-1577, 안양아카데미:(0343)58-5591,
 부산아카데미:(051)293-7449, 대구아카데미:(053)744-9293

☎고객상담문의 : 080-969-7000

ACADEMY HOBBY MODEL KITS **ACADEMY PLASTIC MODEL CO., LTD.**
 273-64, Suyu-dong, Kangbuk-gu, Seoul, Korea
 TEL:82-2-908-7000 FAX:82-2-997-3003