

# EINHEITSDIESEL with Bilstein recovery crane



Cat. no. 35006

Scale 1/35



Project, design & artwork: Jarosław Leoniec  
Research: IBG crew

Special thanks for his priceless help  
for Mr. Volker Ruff

- ▲ 1 Element złożony we wcześniejszym etapie  
Element assembled in previous step
- ▲ 1 Element po złożeniu w aktualnym etapie  
Element after assembly in actual step
- ? Wersja do wyboru  
Version to choose
- ▼ 1 Kalkomania  
Decal
- ▲ A Kolor farby  
Paint colour
- Część nie do użycia  
Part not for use

	Gunze Mr.Color	Model Master Acrylic	Humbrol	Valleyo MC
black ▲ A	C002	4695	21	861
wood ▲ B	C043	4673	110	846
gunmetal ▲ C	C104	4681	53	863
panzer gray ▲ D	C040	4795	67	995
rust ▲ E	C029	4675	113	846
leather ▲ F	C019	4674	62	843
white ▲ G	C062	4769	34	951

Przed montażem przeczytać instrukcję. Przestrzegać kolejności montażu podanego w instrukcji! Klej i farby nie wchodzą w skład zestawu. Sugerujemy używanie rzadkiego kleju np. Tamiya Thin Cement.  
Please read instruction before assembly. Obey sequence of assembly like in instruction. Glue and paints not included. We strongly recommend using thin glue - for example Tamiya Thin Cement.

## Ramka C / Frame C

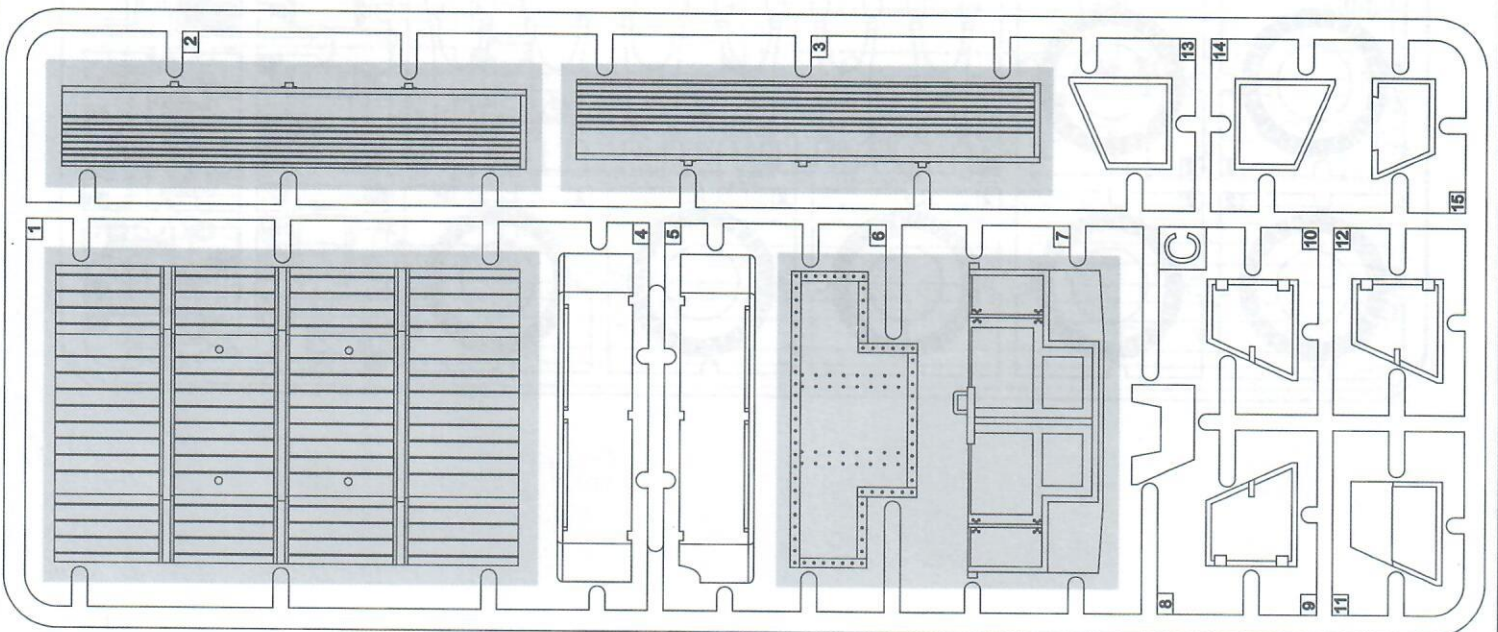

International Business Group  
ul. Benedykta Hertza 2  
04-603 Warszawa  
Poland

tel +48 22 8159150  
fax +48 22 8159151  
ibgsc@ibg.com.pl  
www.ibg.com.pl

# Ramka X / Frame X

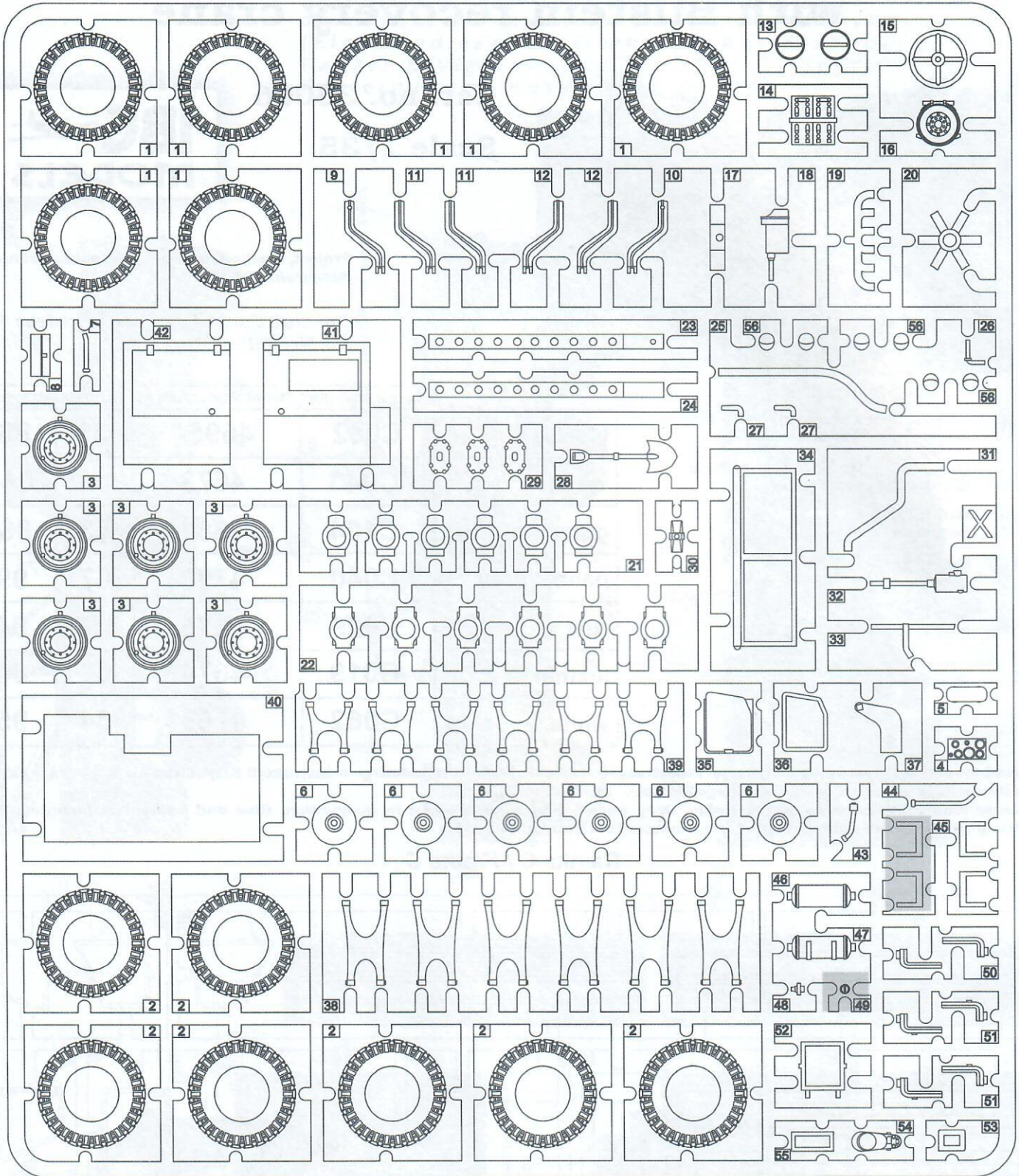

# Ramka Y / Frame Y

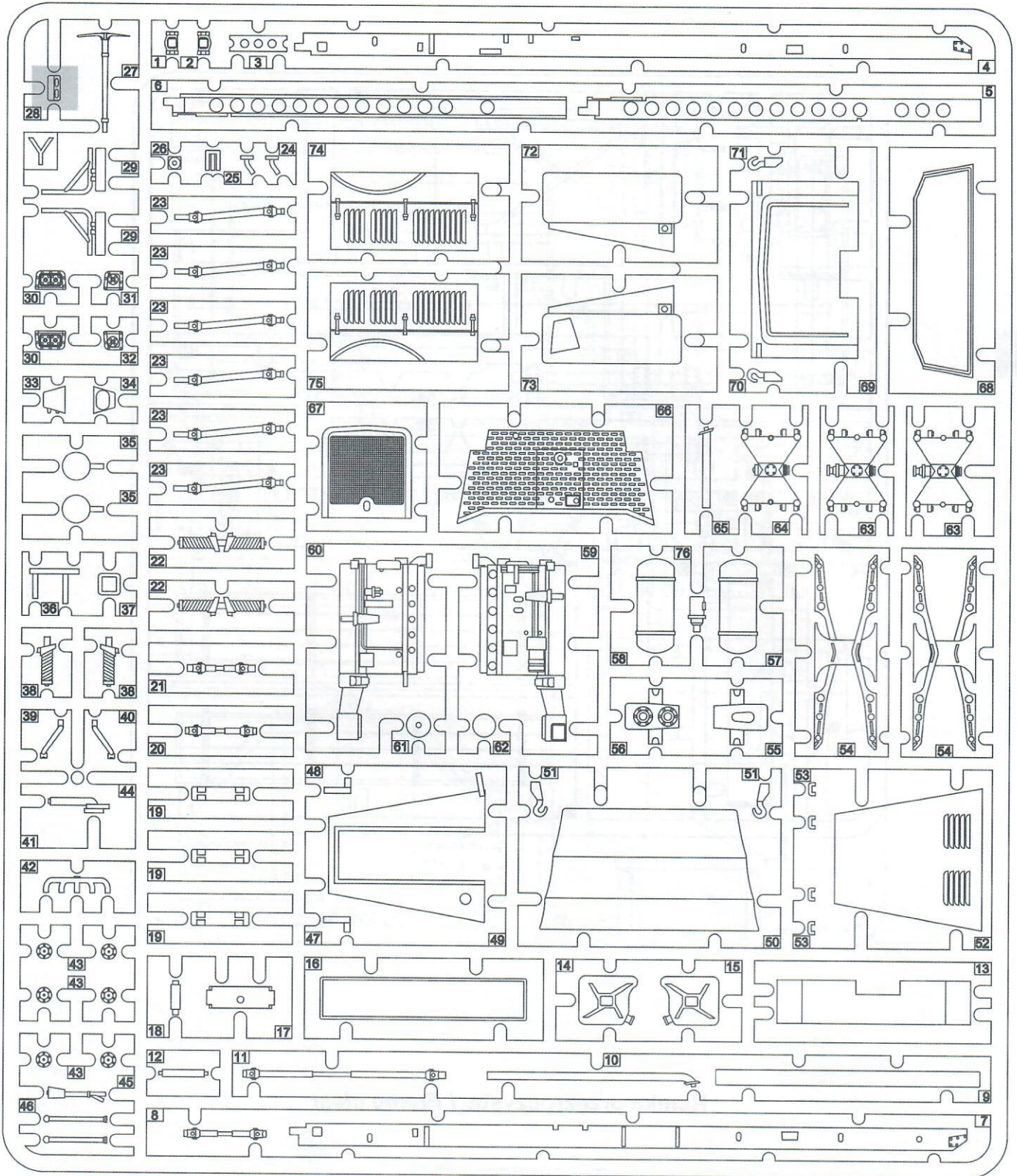

## Ramka H / Frame H

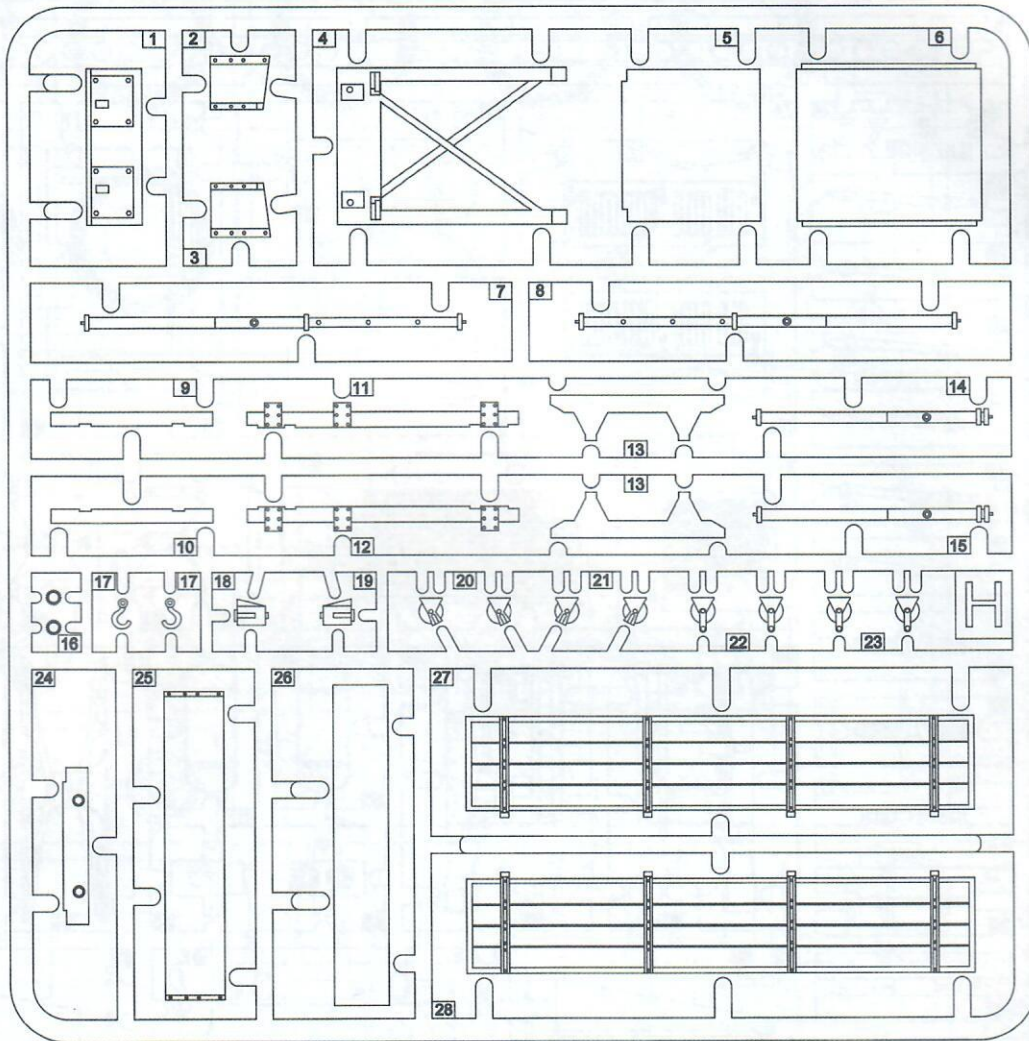

## Ramka przezroczysta / Frame clear

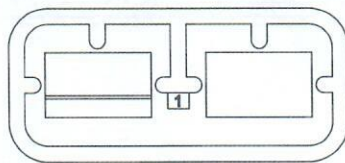

# Ramka G / Frame G

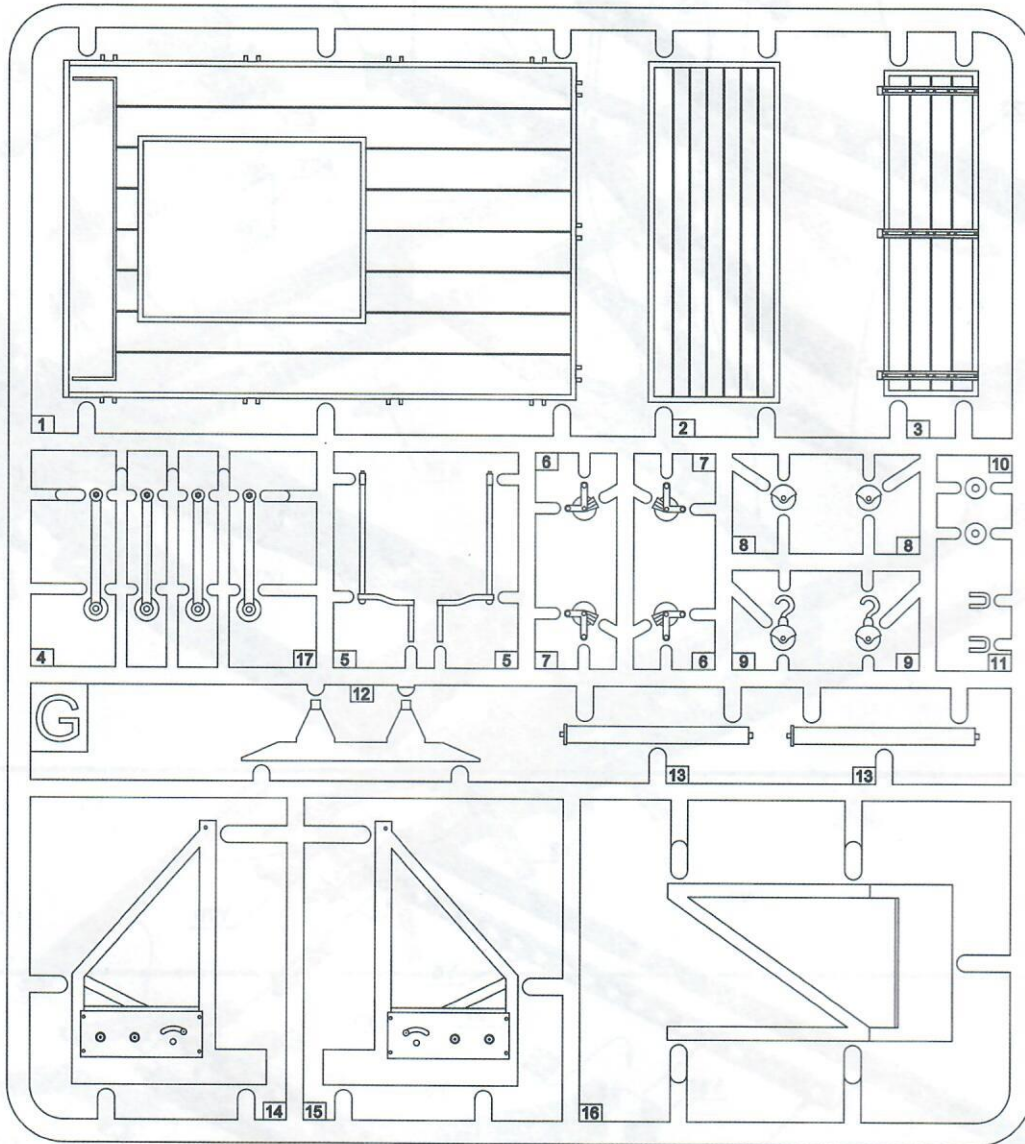

**ETAP 1  
STEP 1**

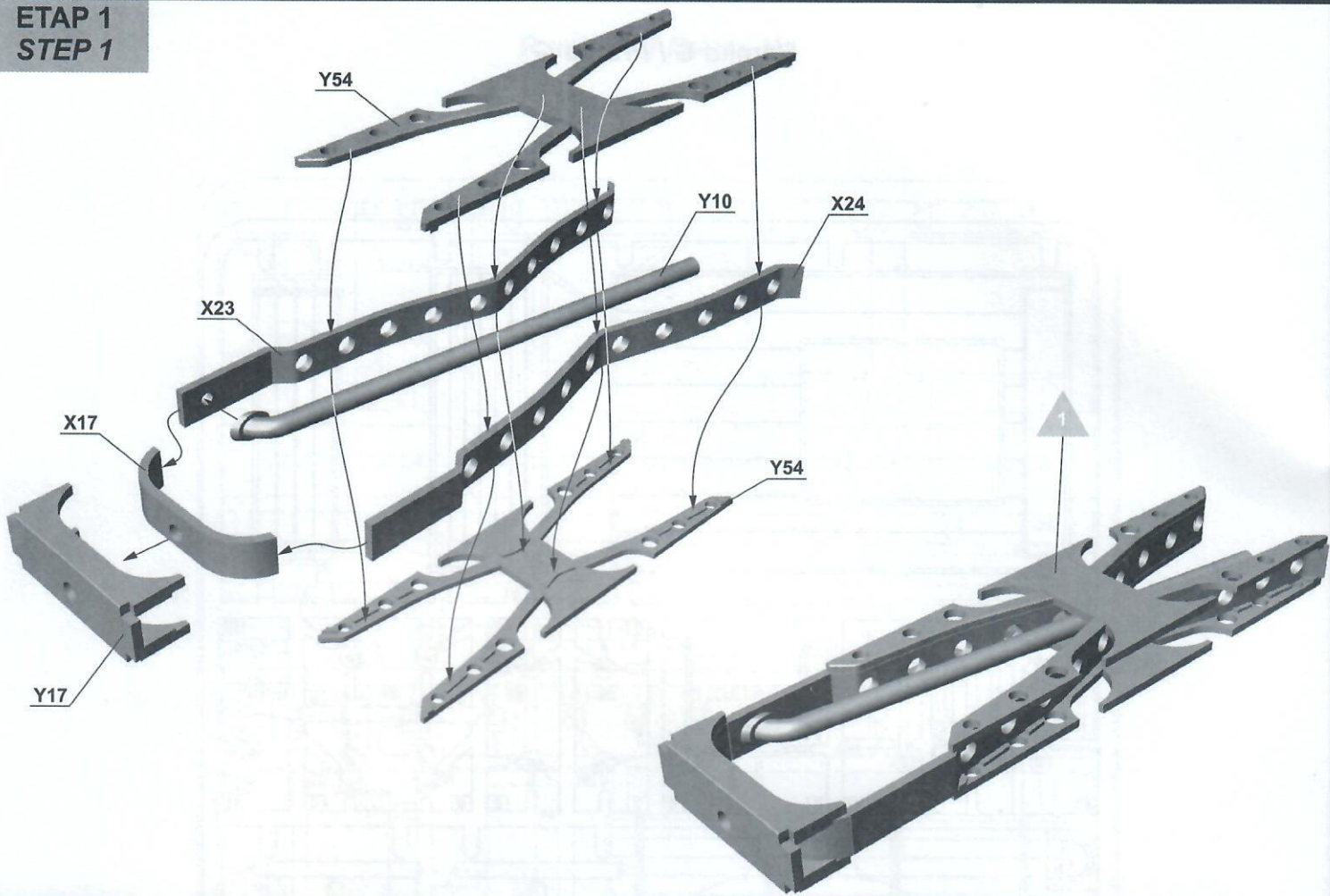

**ETAP 2  
STEP 2**

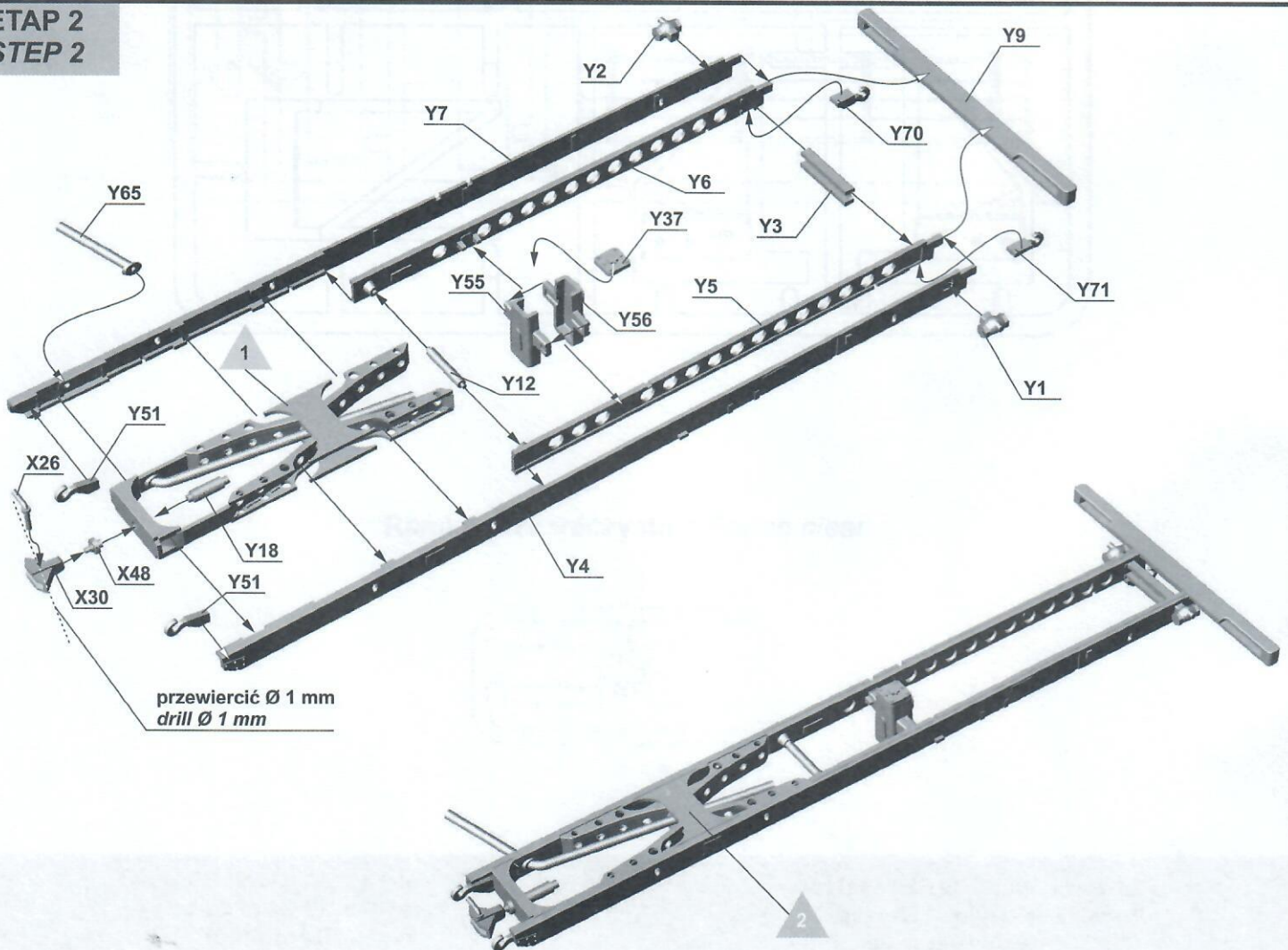

**ETAP 3  
STEP 3**

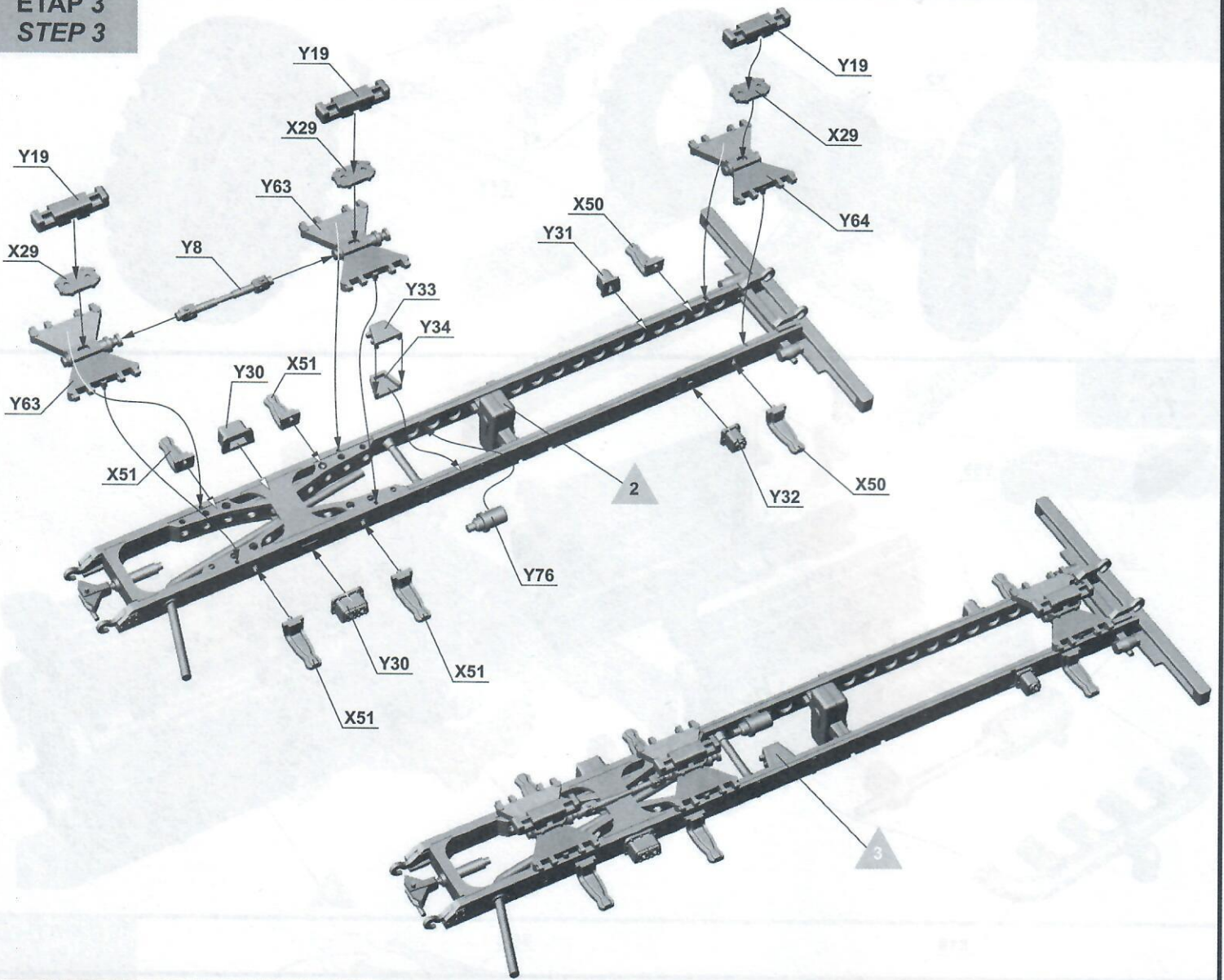

**ETAP 4  
STEP 4**

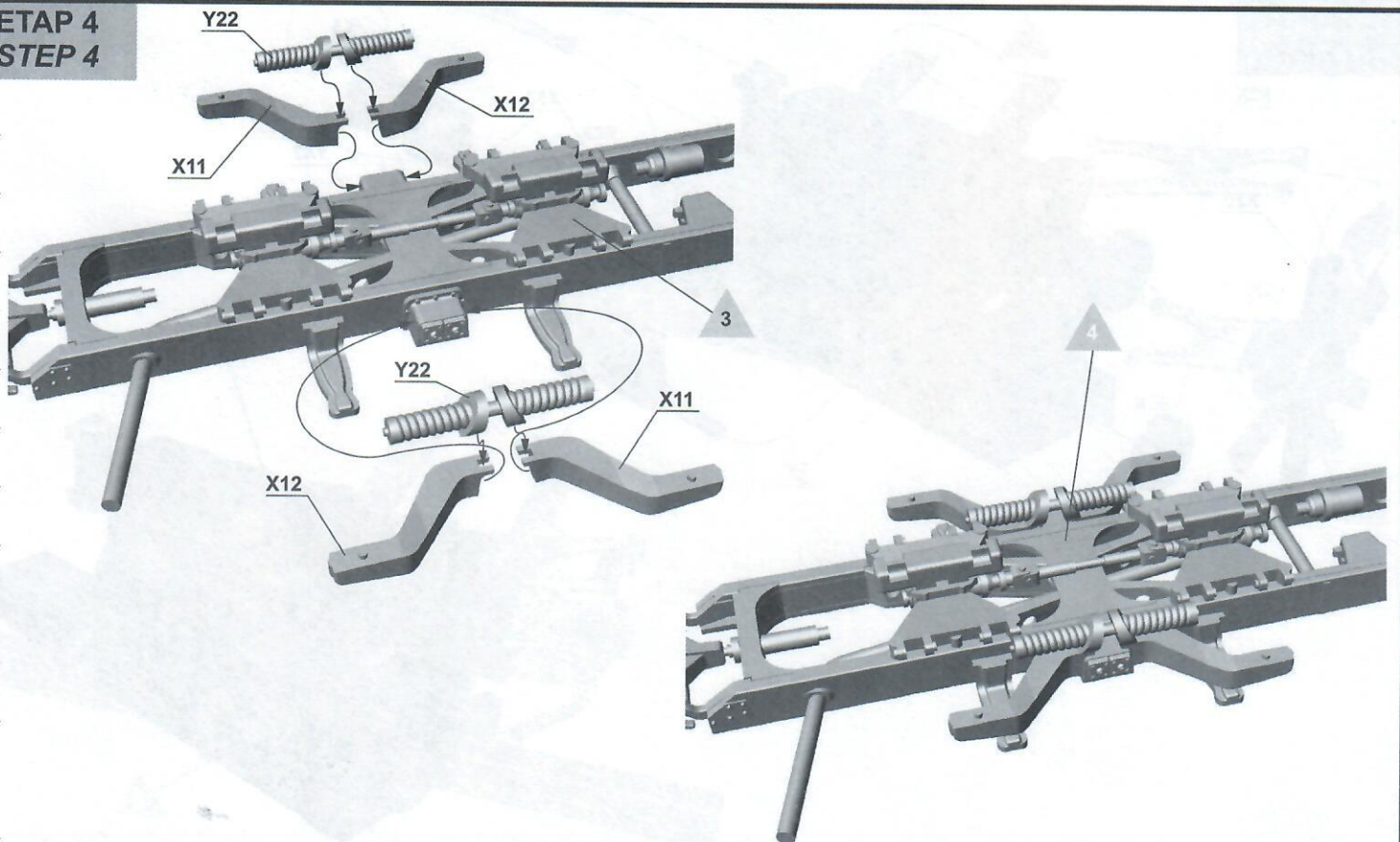

ETAP 5  
STEP 5 x 7

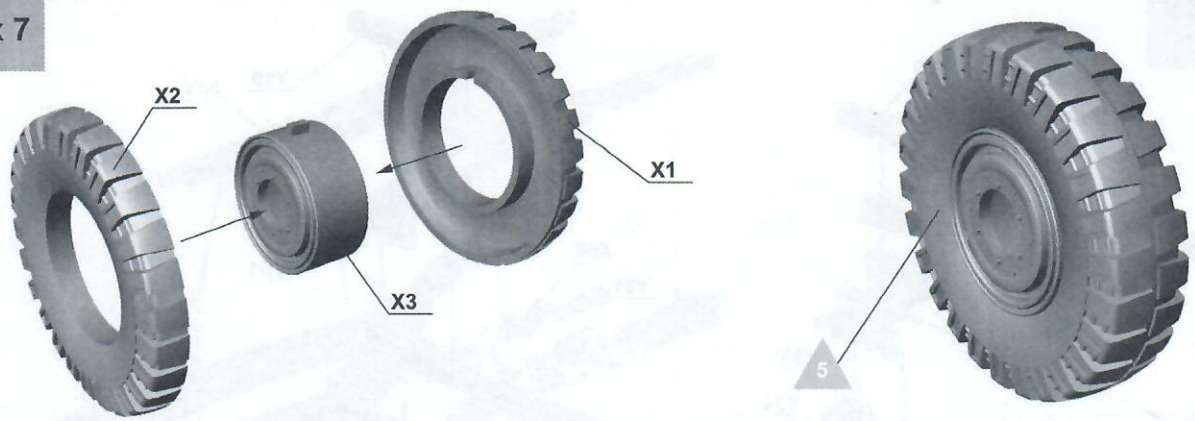

ETAP 6  
STEP 6

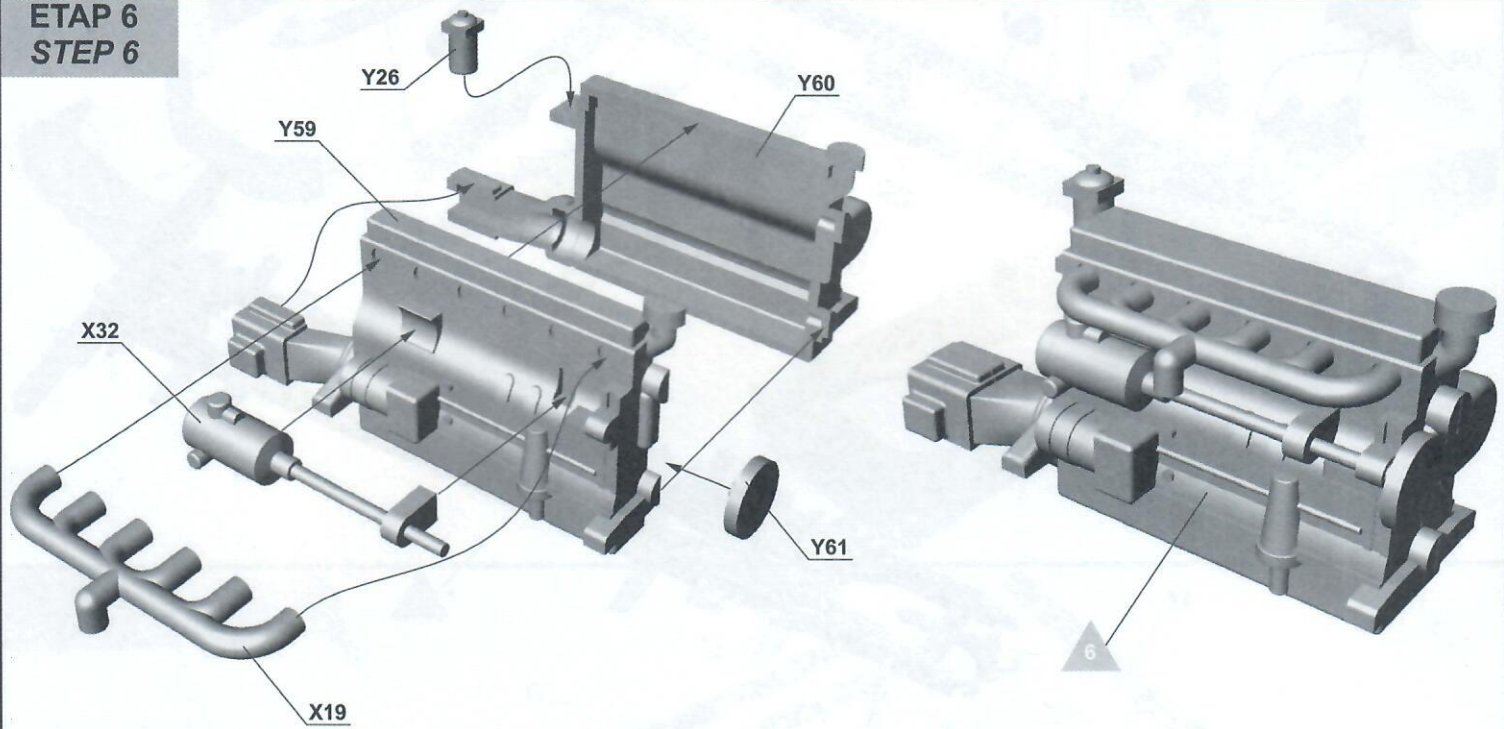

ETAP 7  
STEP 7

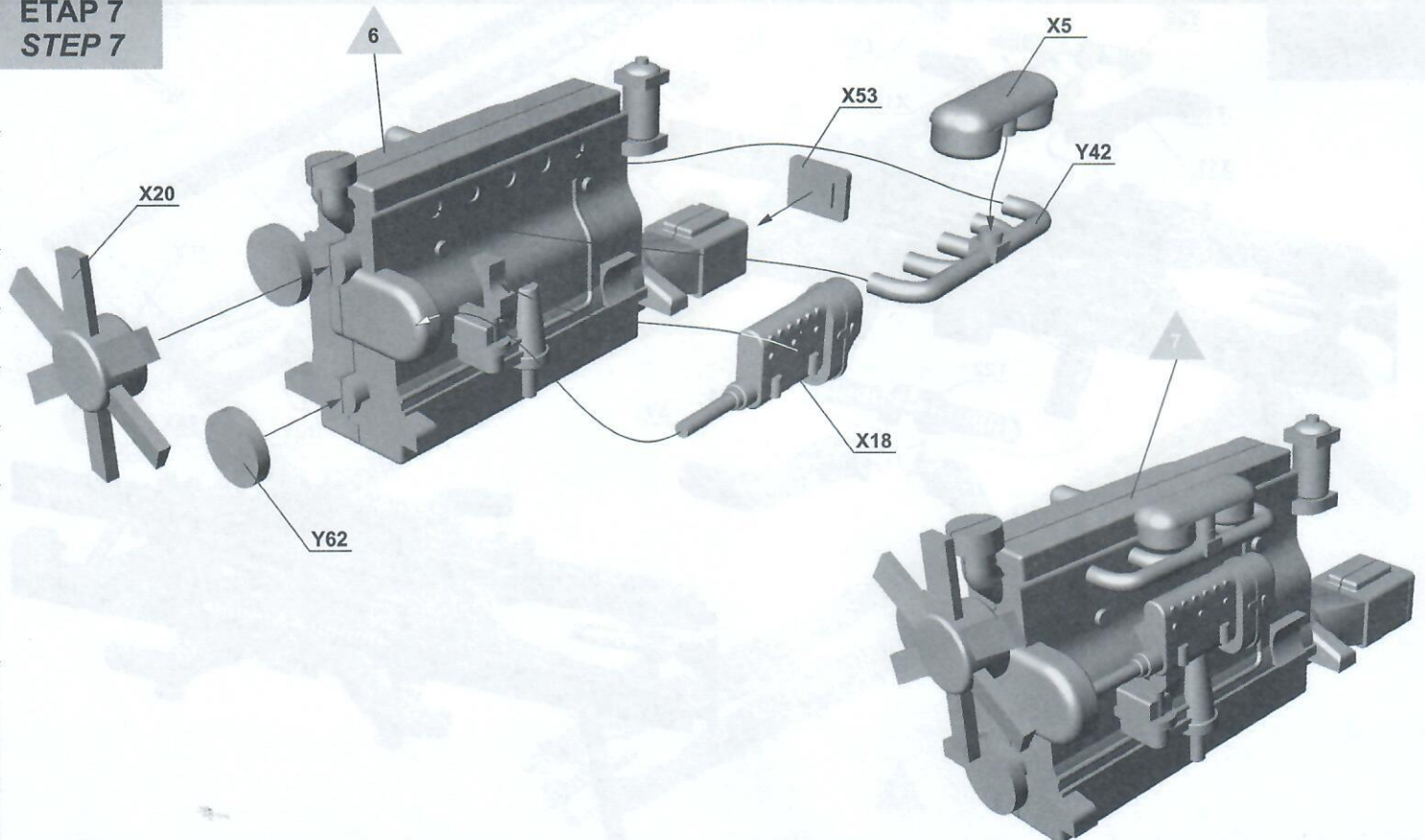



**ETAP 8**  
**STEP 8**

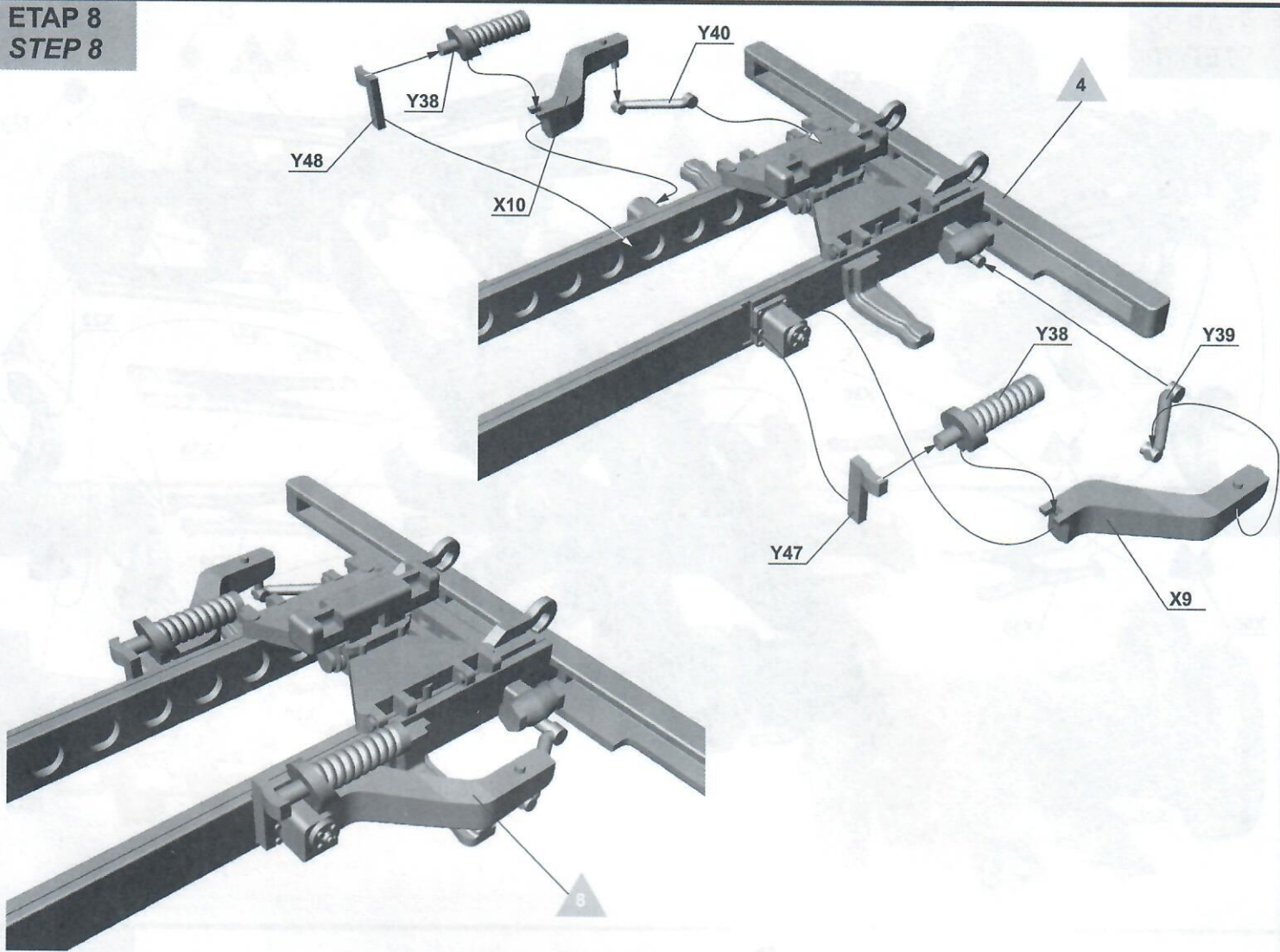

**ETAP 9**  
**STEP 9**

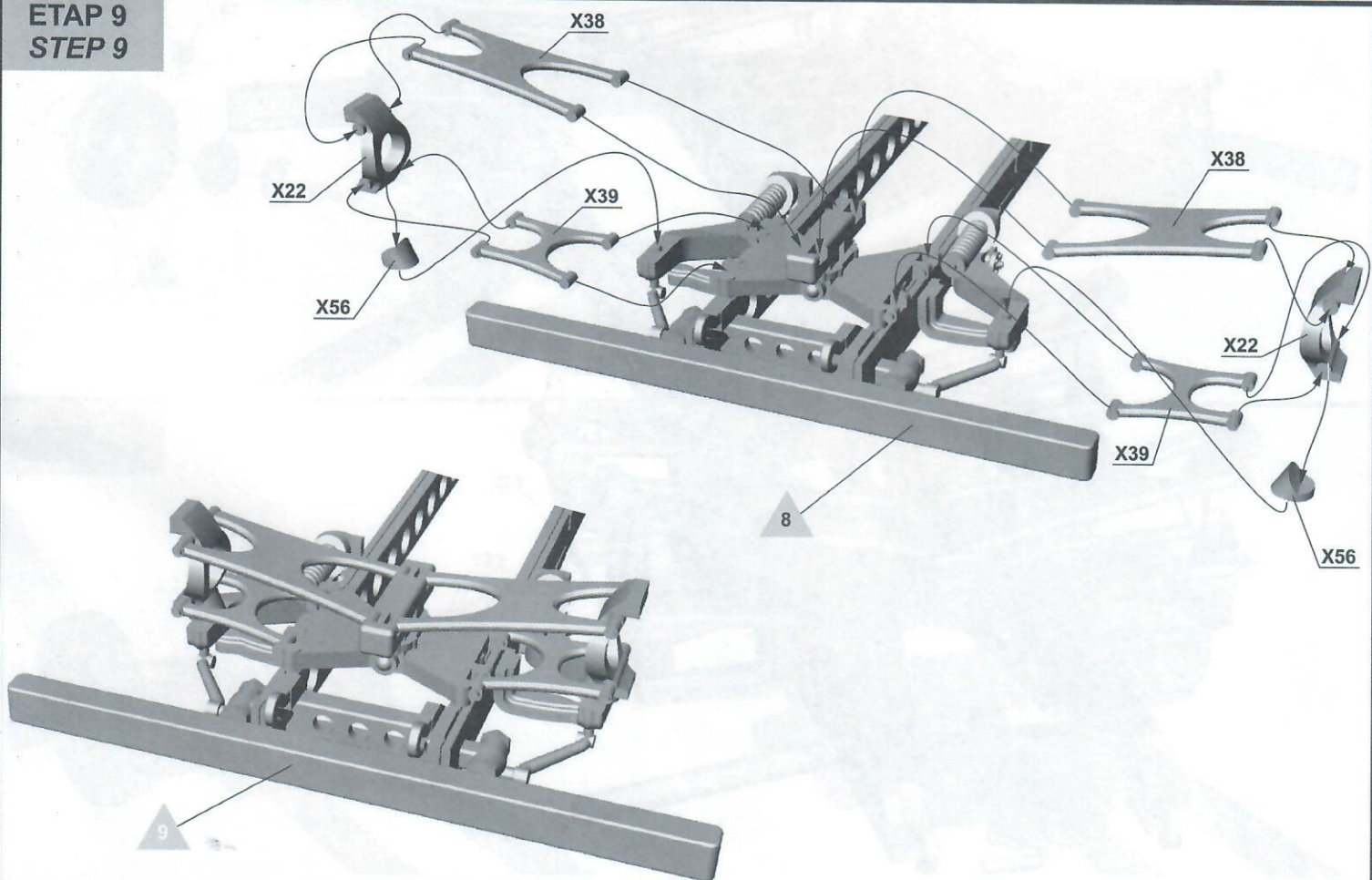

ETAP 10  
STEP 10

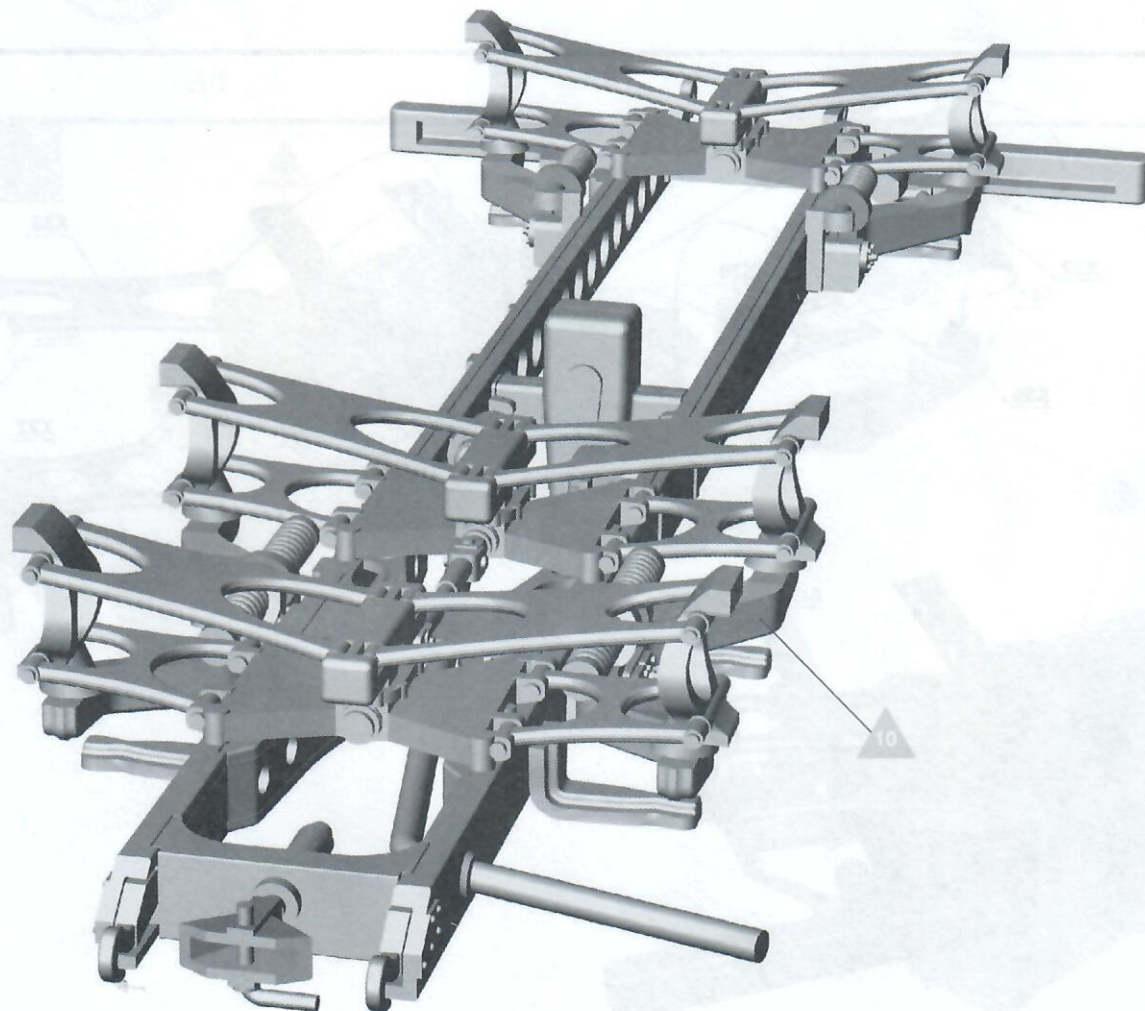
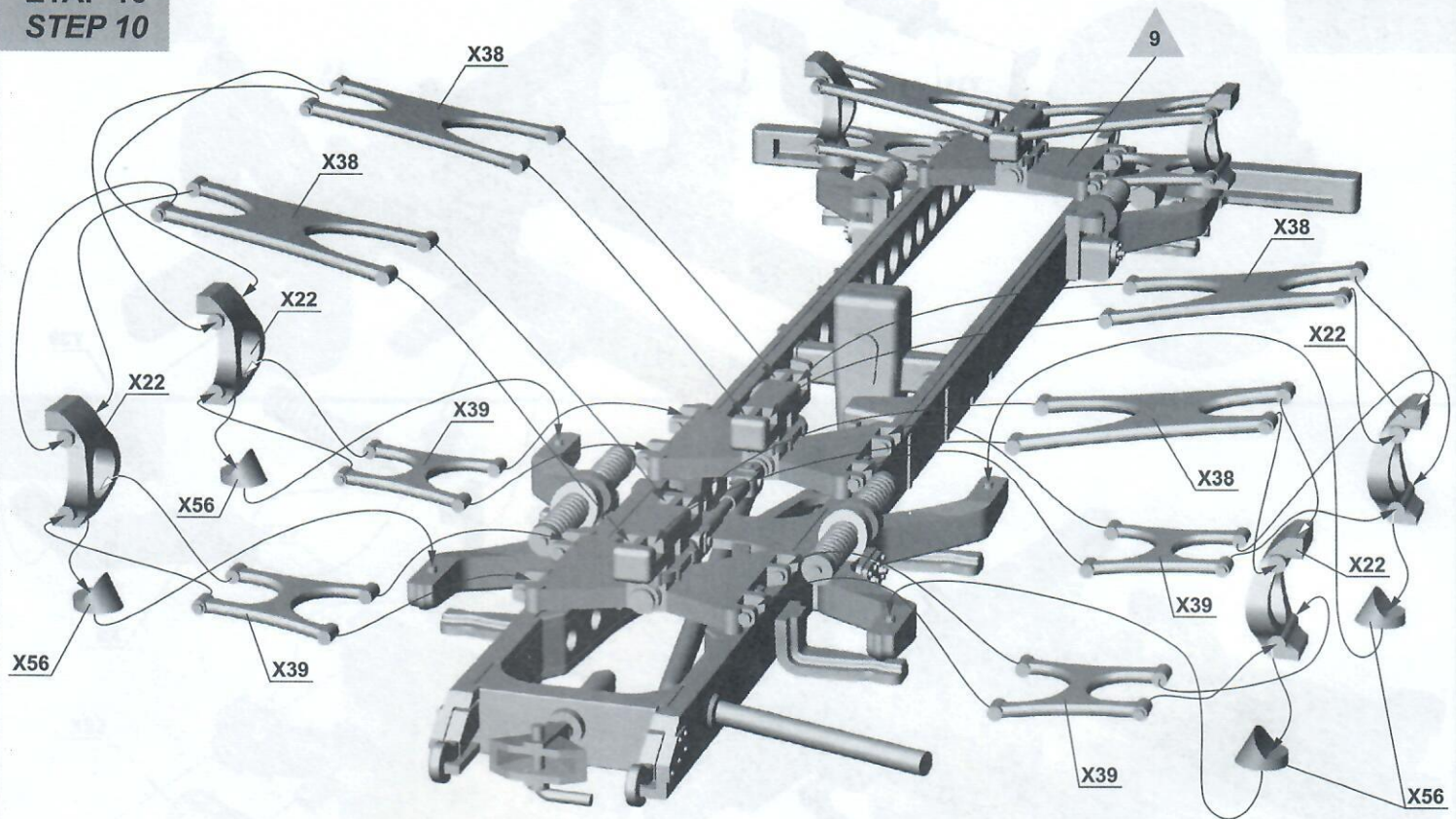

**ETAP 11  
STEP 11**

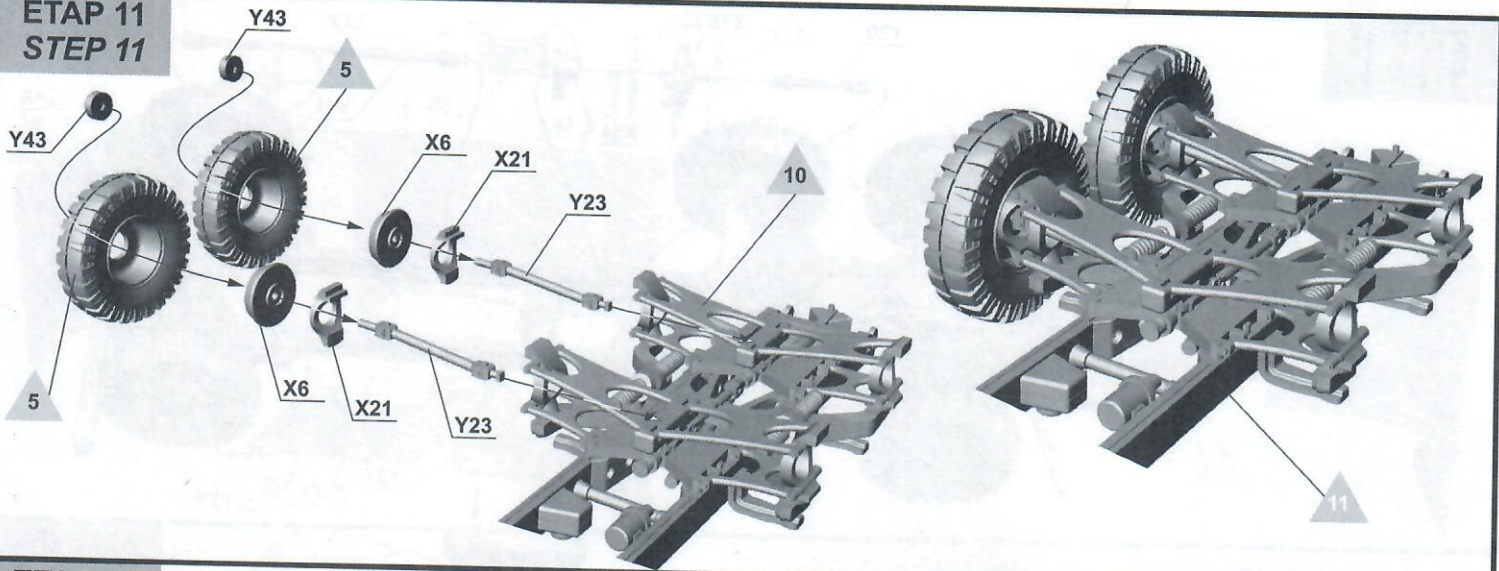

**ETAP 12  
STEP 12**

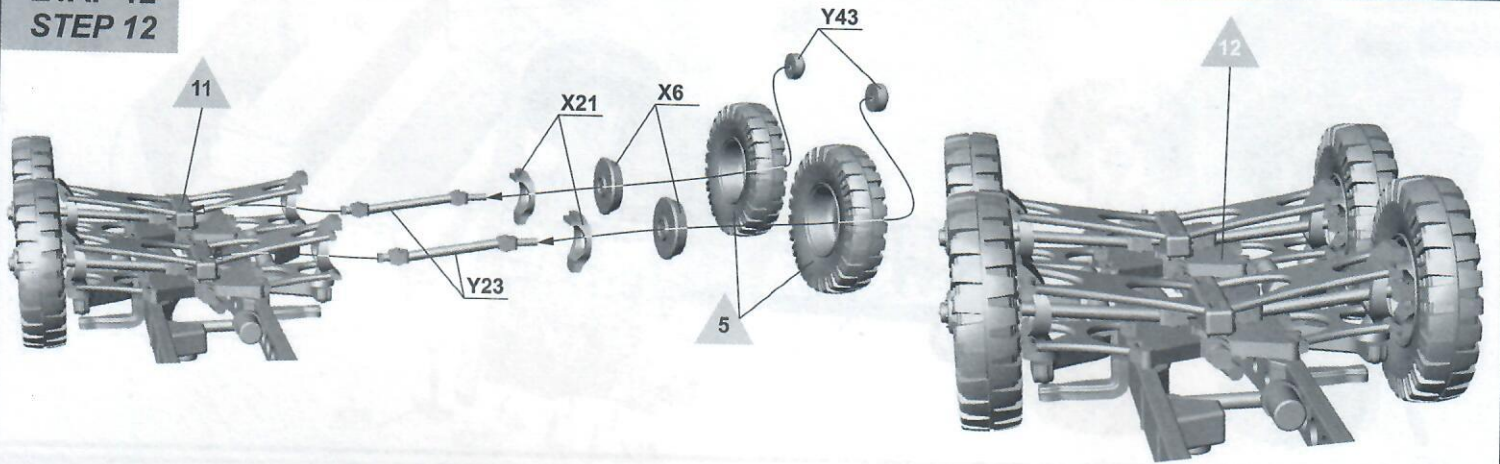

**ETAP 13  
STEP 13**

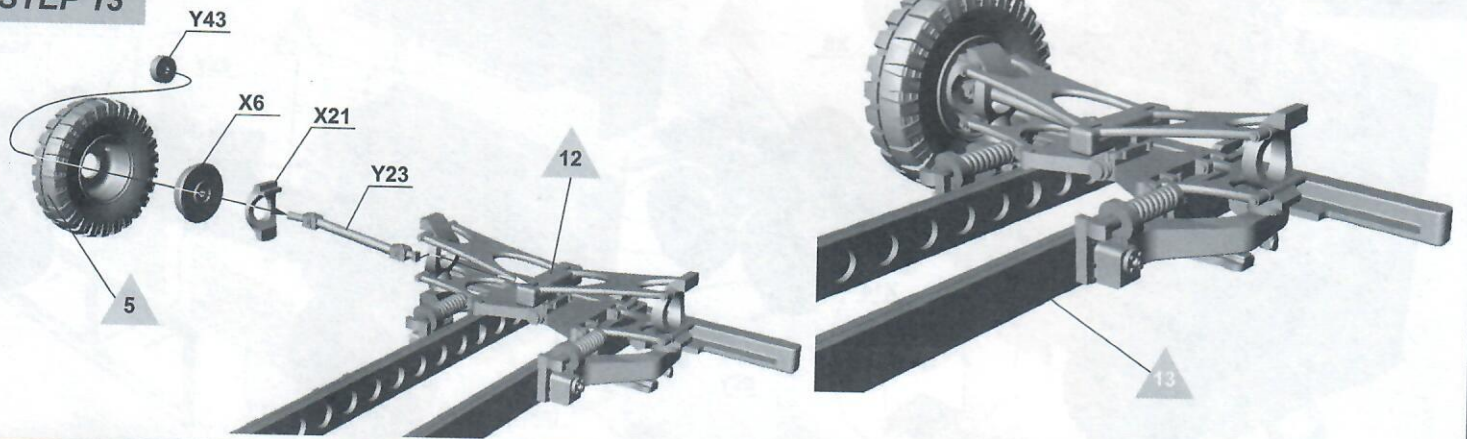

**ETAP 14  
STEP 14**

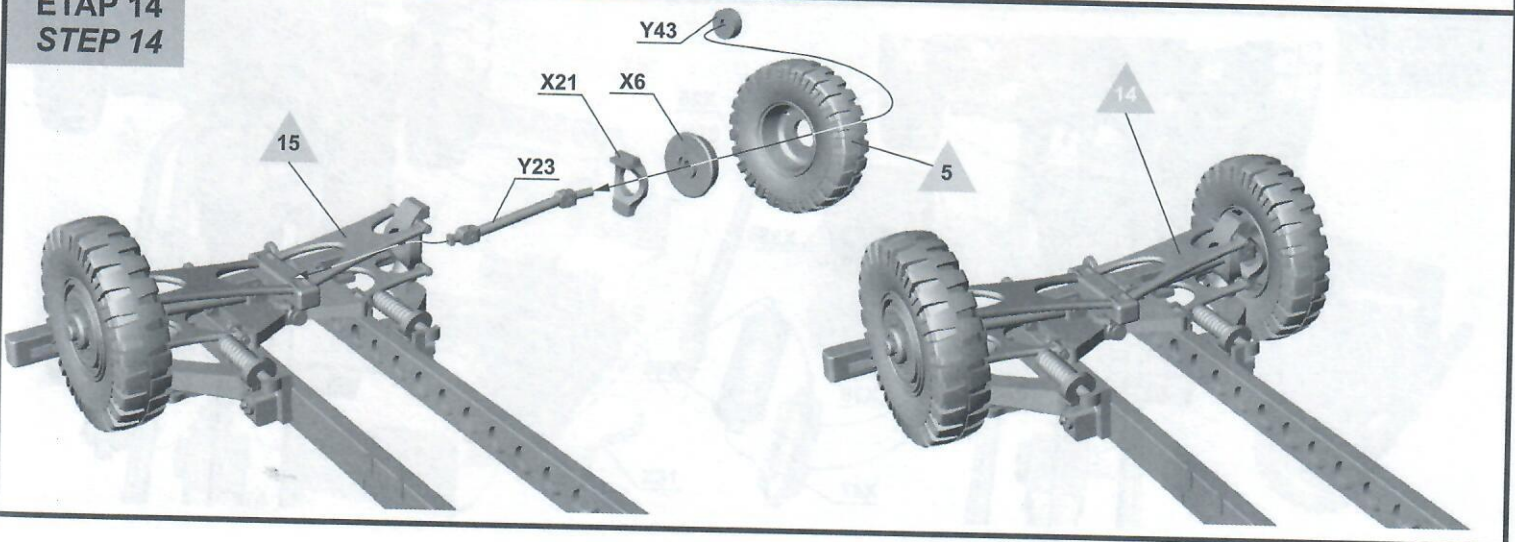

**ETAP 15**  
**STEP 15**

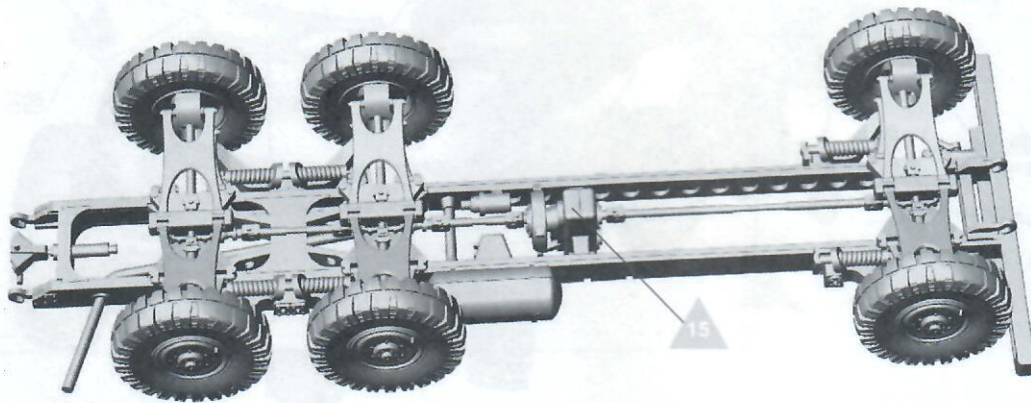
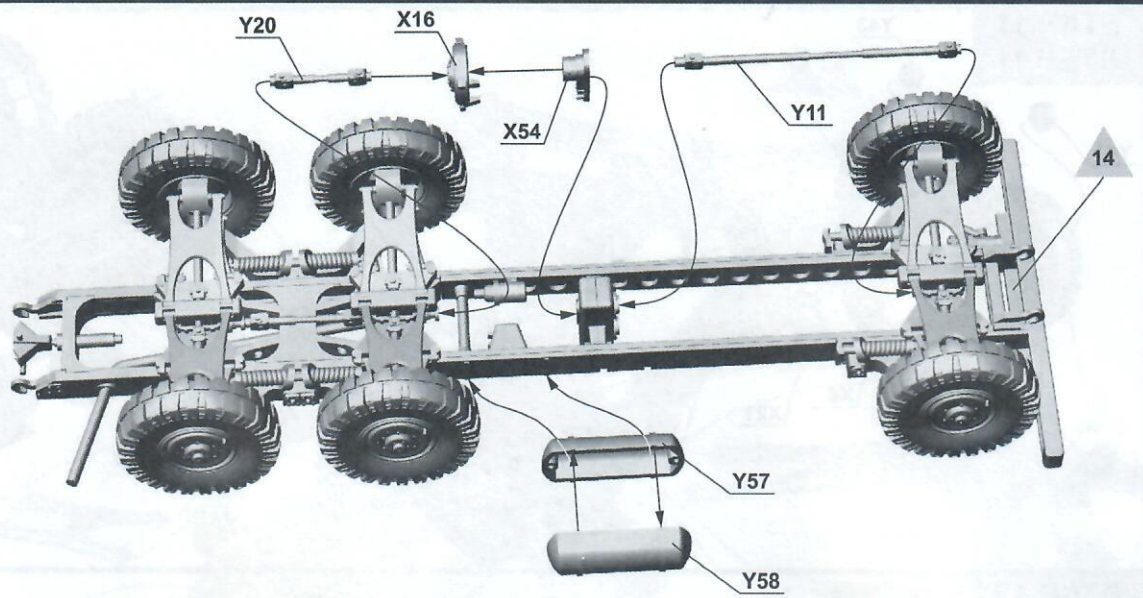

**ETAP 16**  
**STEP 16**

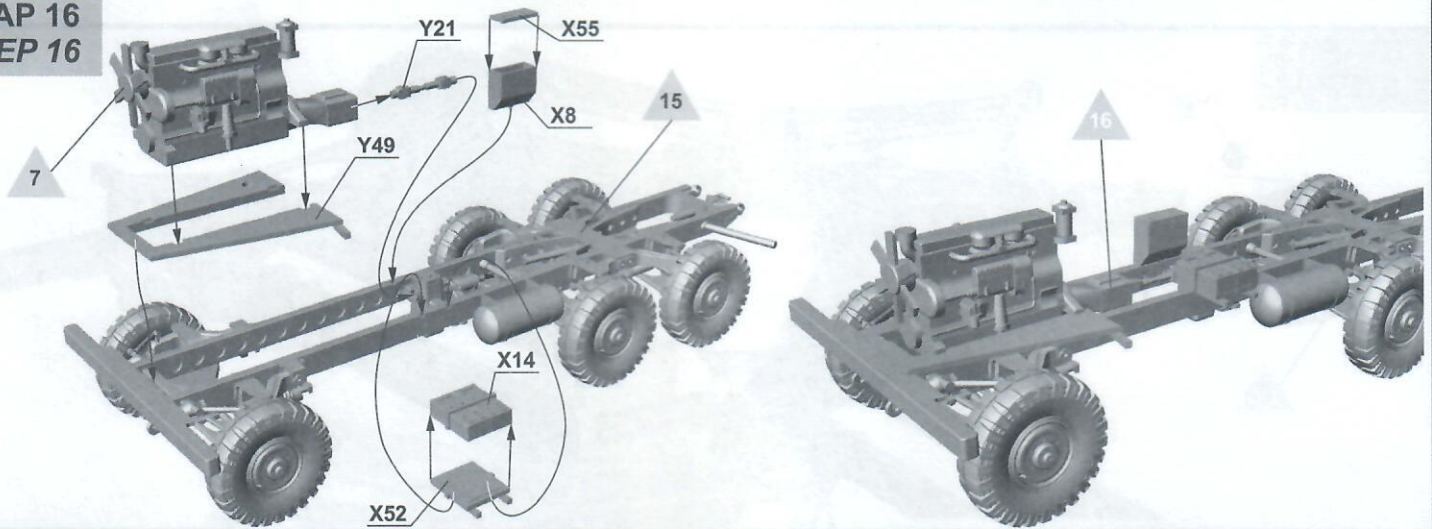

**ETAP 17**  
**STEP 17**

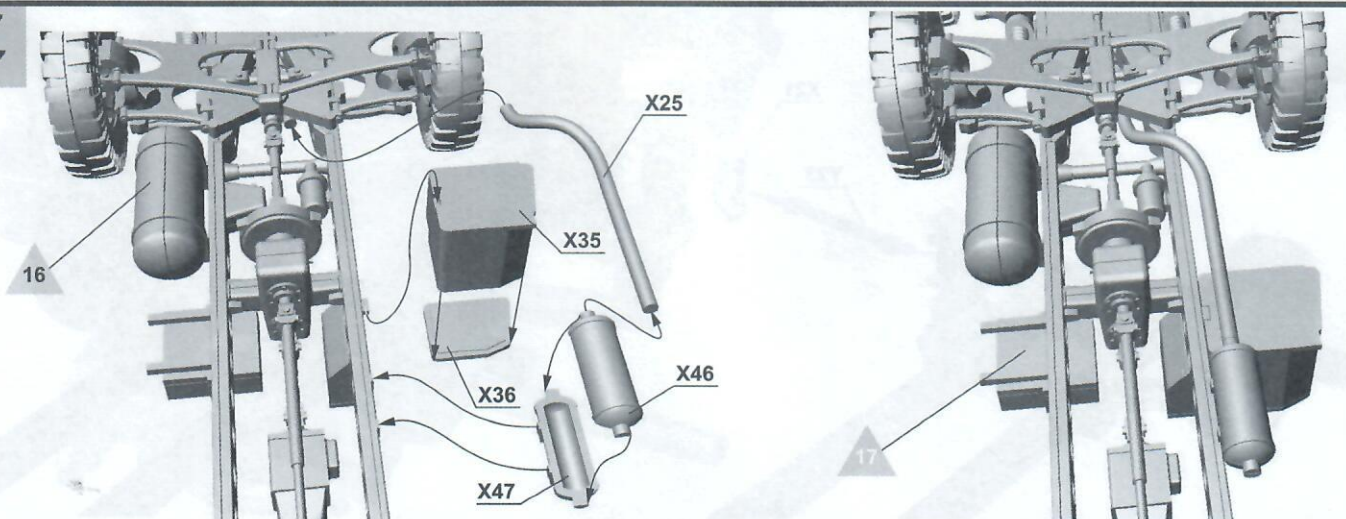

**ETAP 18  
STEP 18**

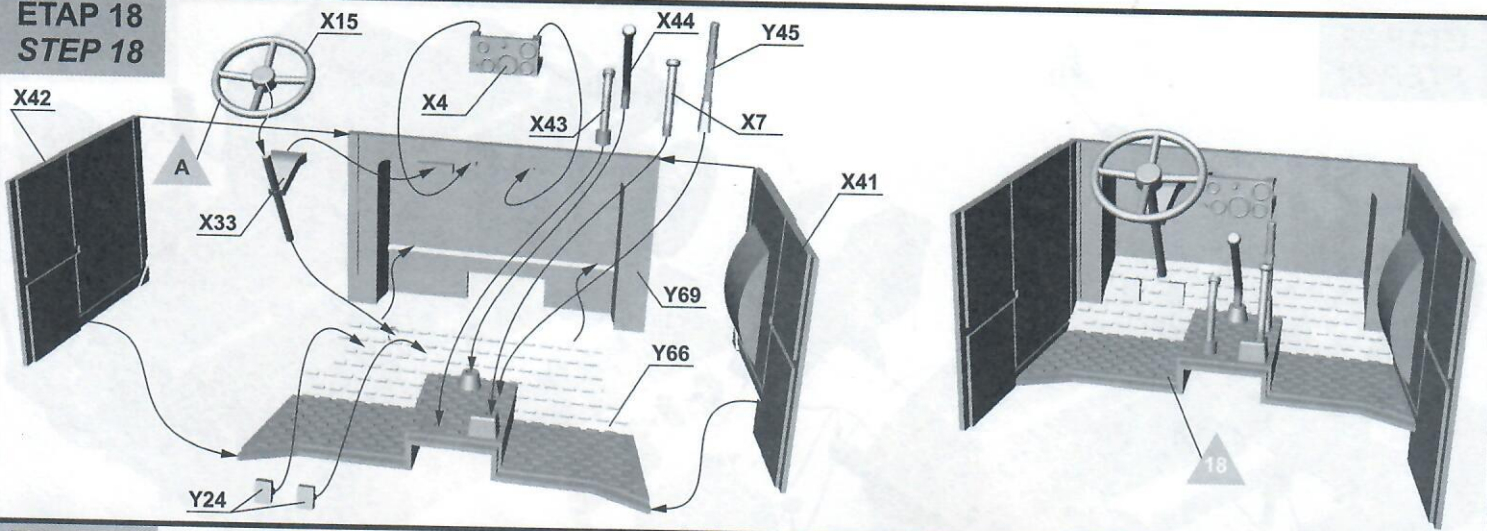

**ETAP 19  
STEP 19**

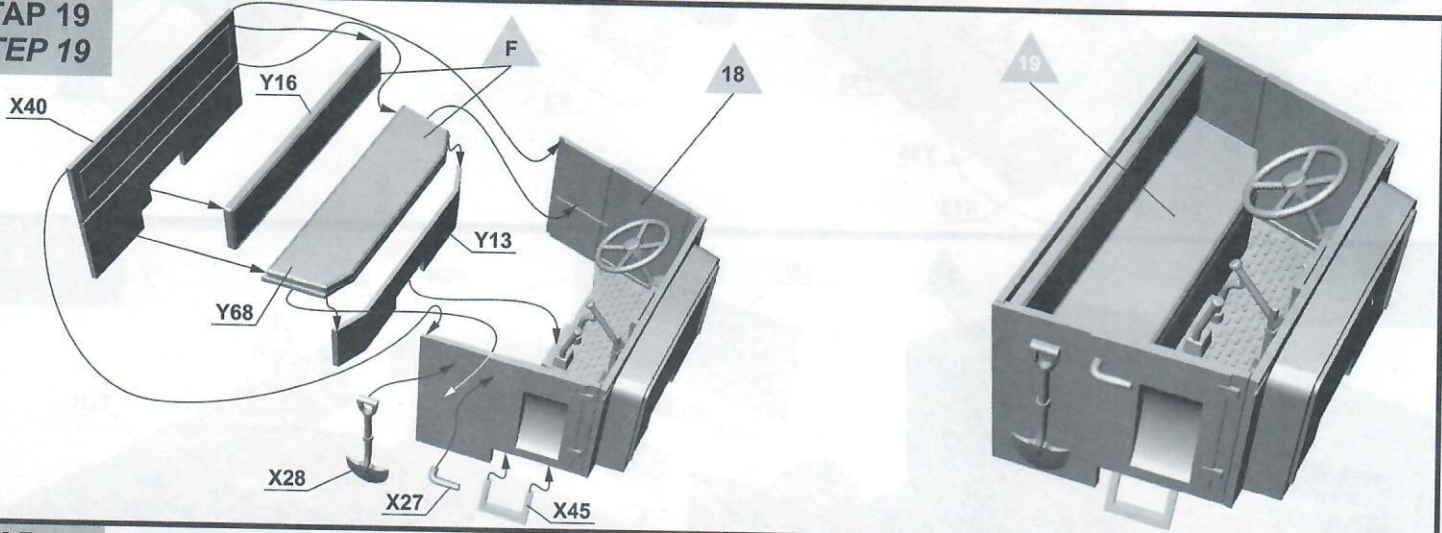

**ETAP 20  
STEP 20**

Przezroczysta 1  
Clear 1

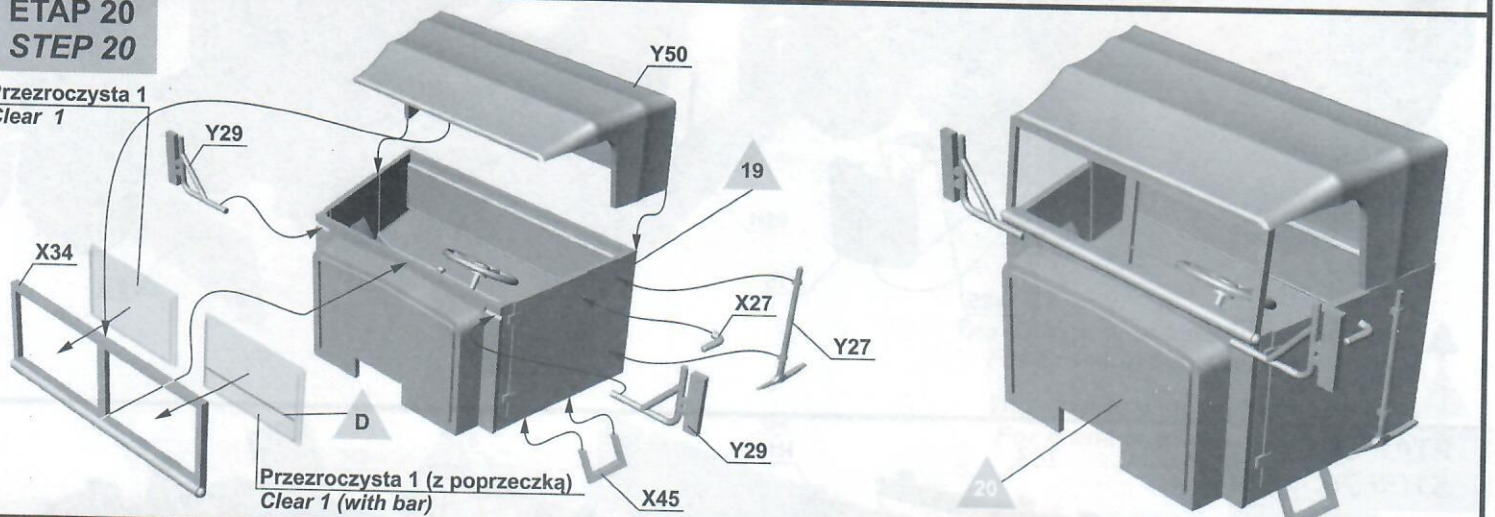

Przezroczysta 1 (z poprzeczką)  
Clear 1 (with bar)

**ETAP 21  
STEP 21**

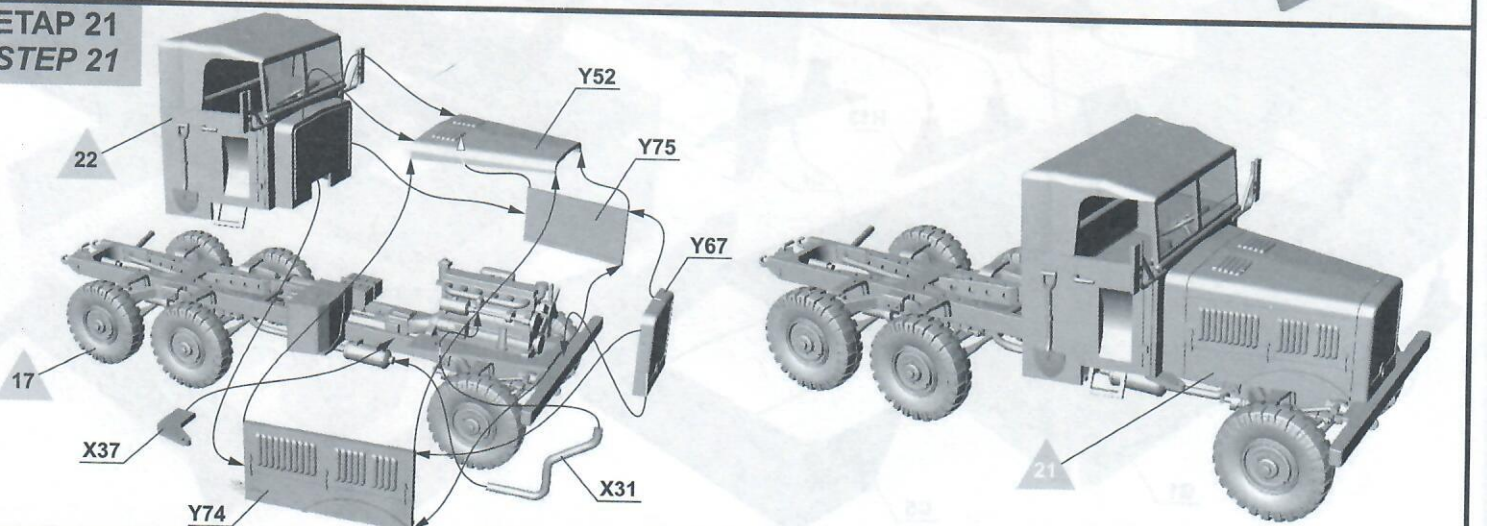

**ETAP 22  
STEP 22**

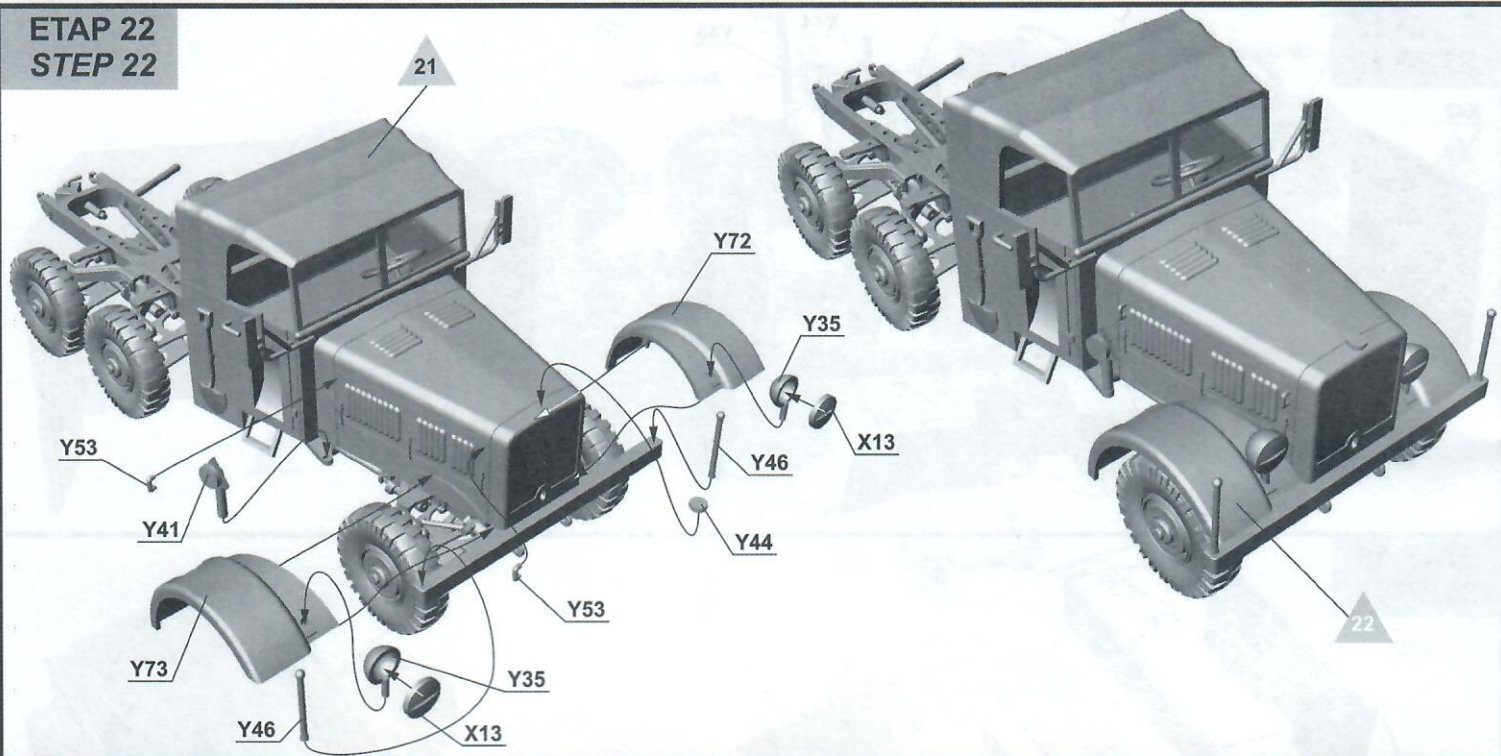

**ETAP 23  
STEP 23**

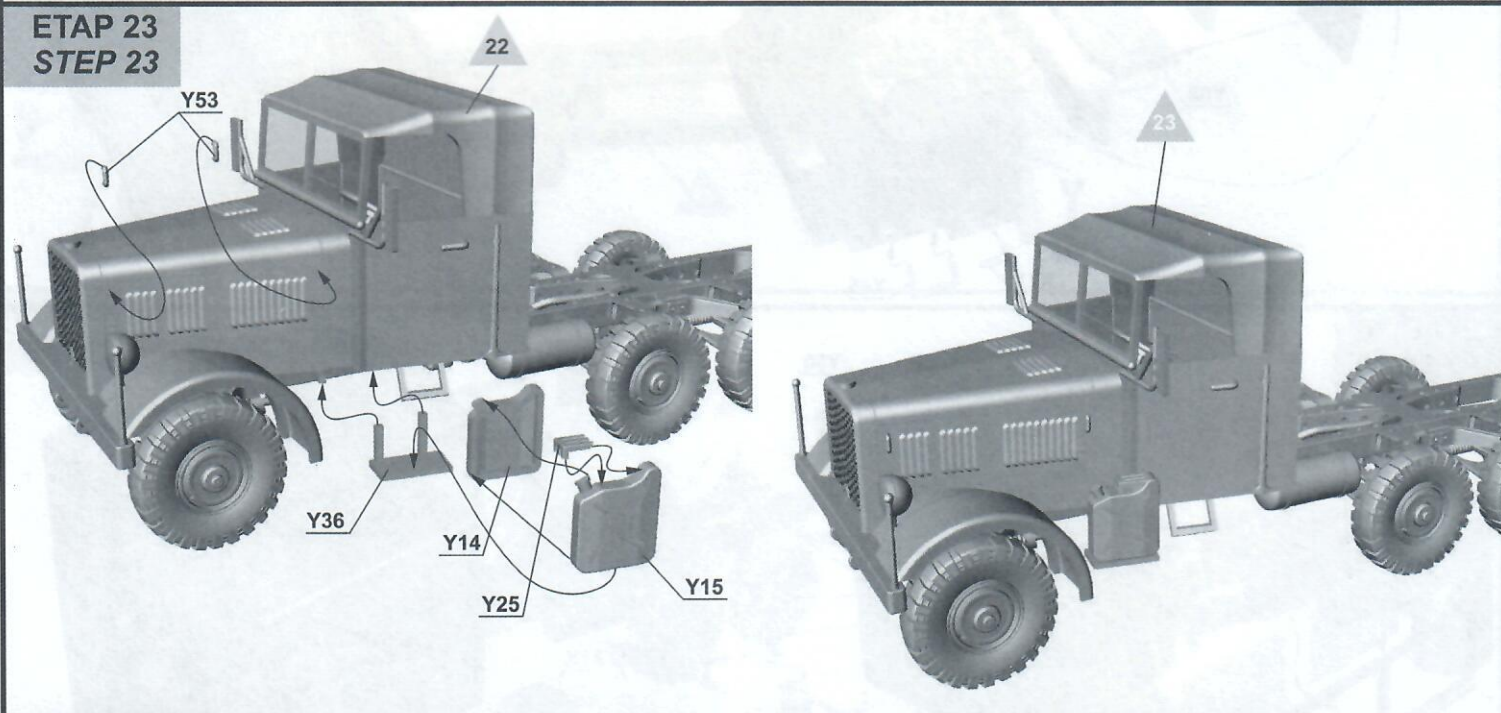

**ETAP 24  
STEP 24**

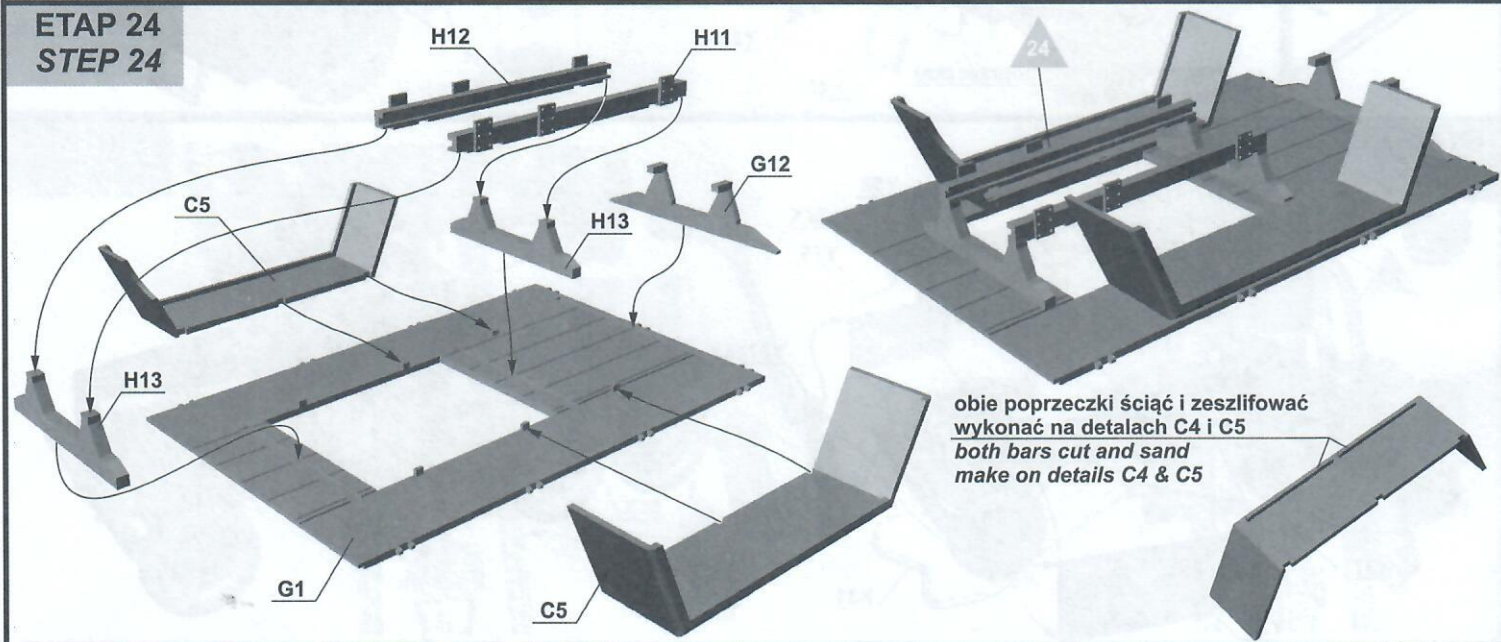

**ETAP 25  
STEP 25**

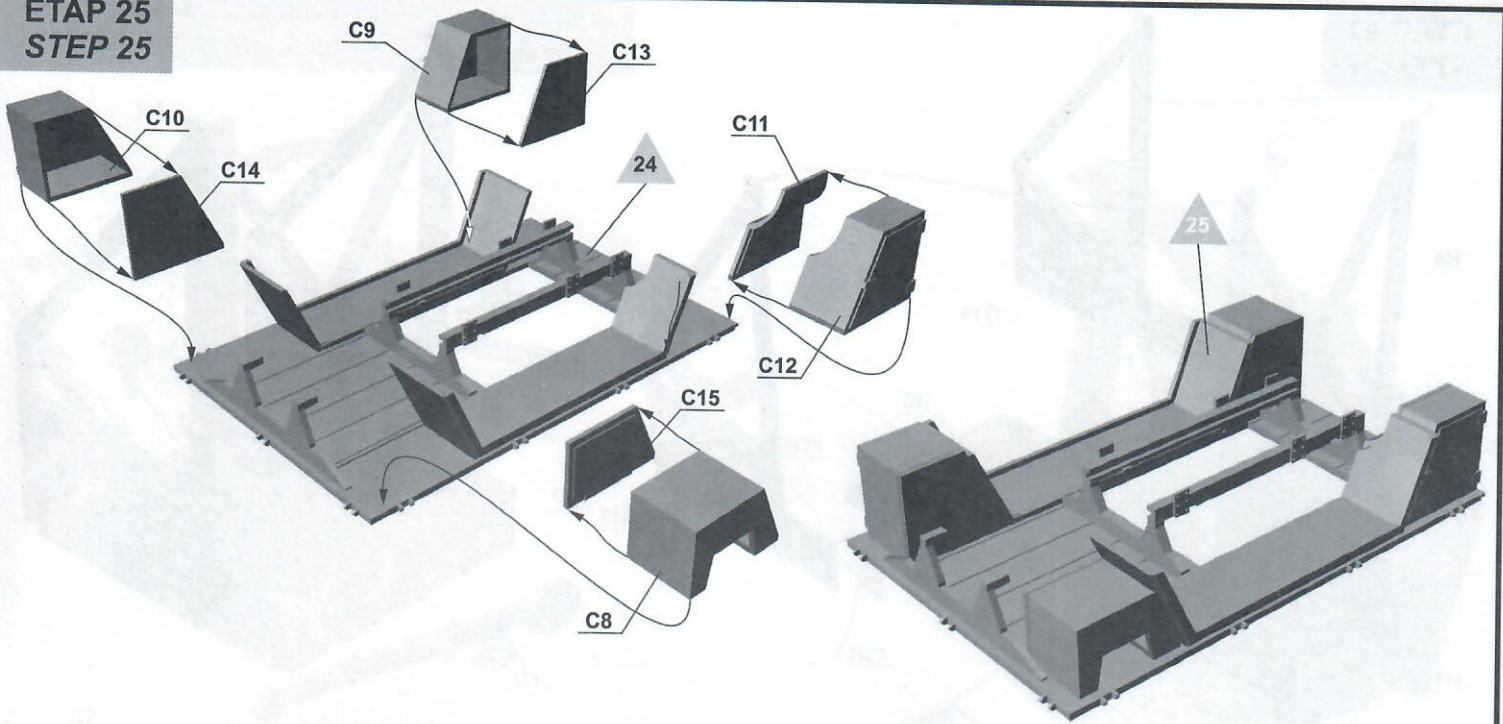

**ETAP 26  
STEP 26**

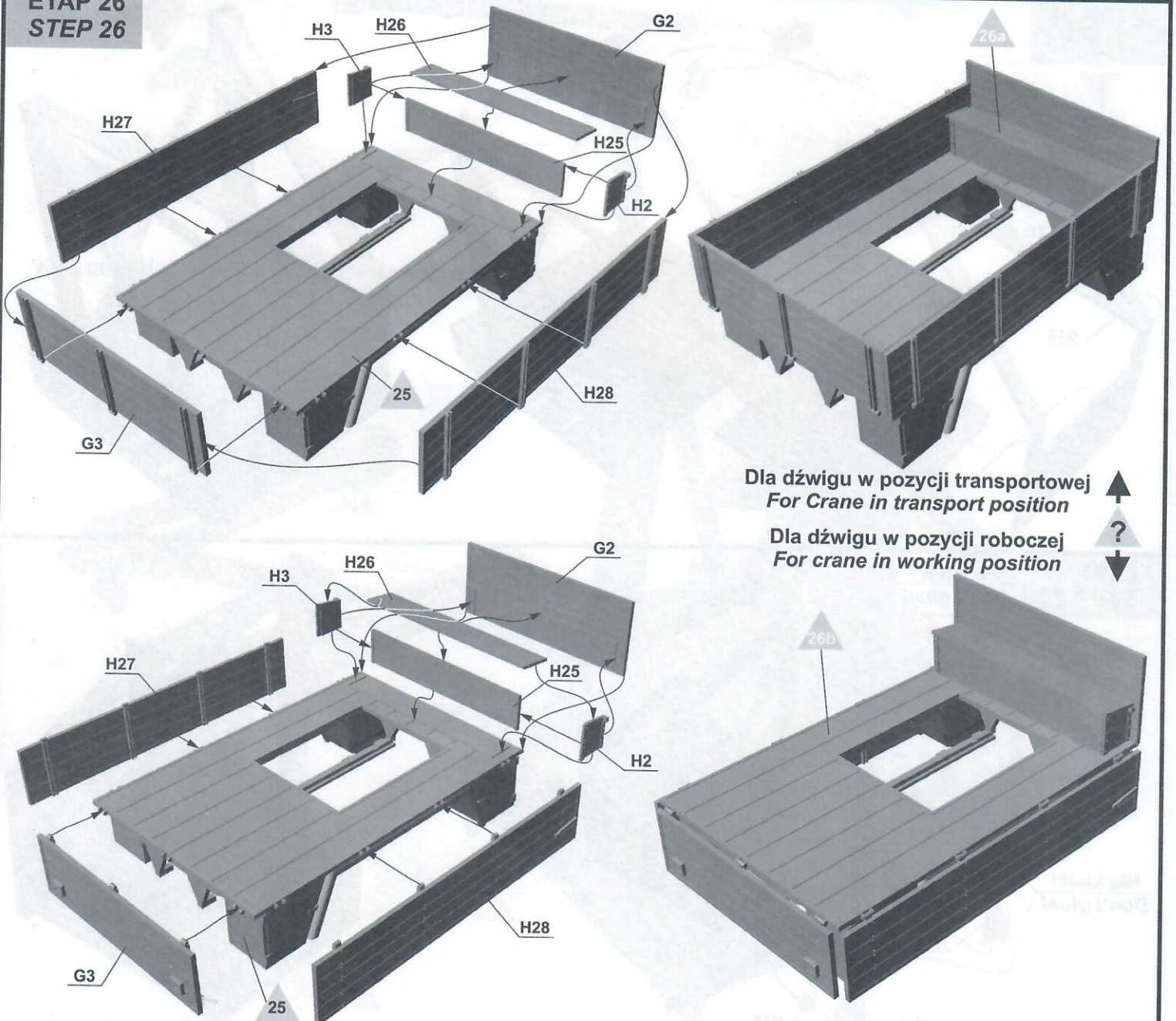

**ETAP 27  
STEP 27**

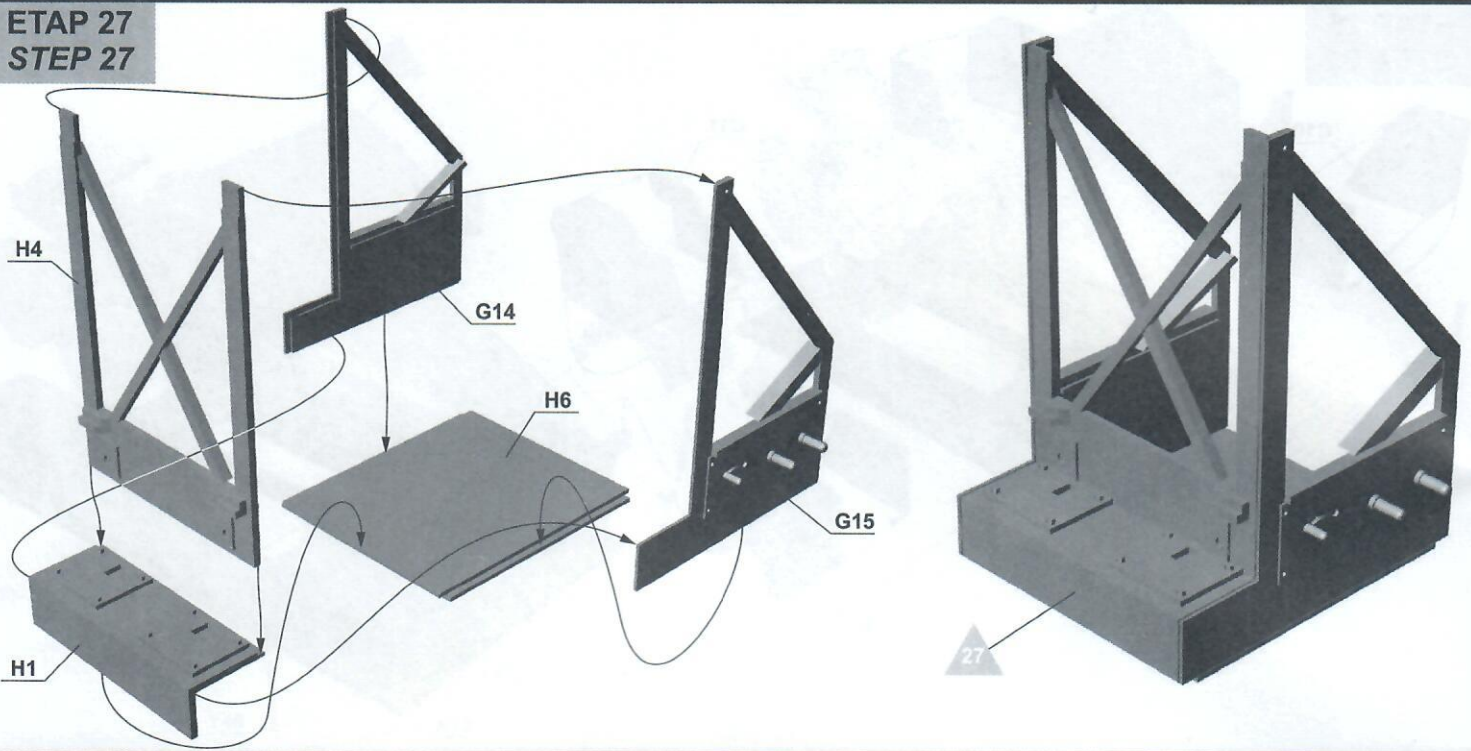

**ETAP 28  
STEP 28**

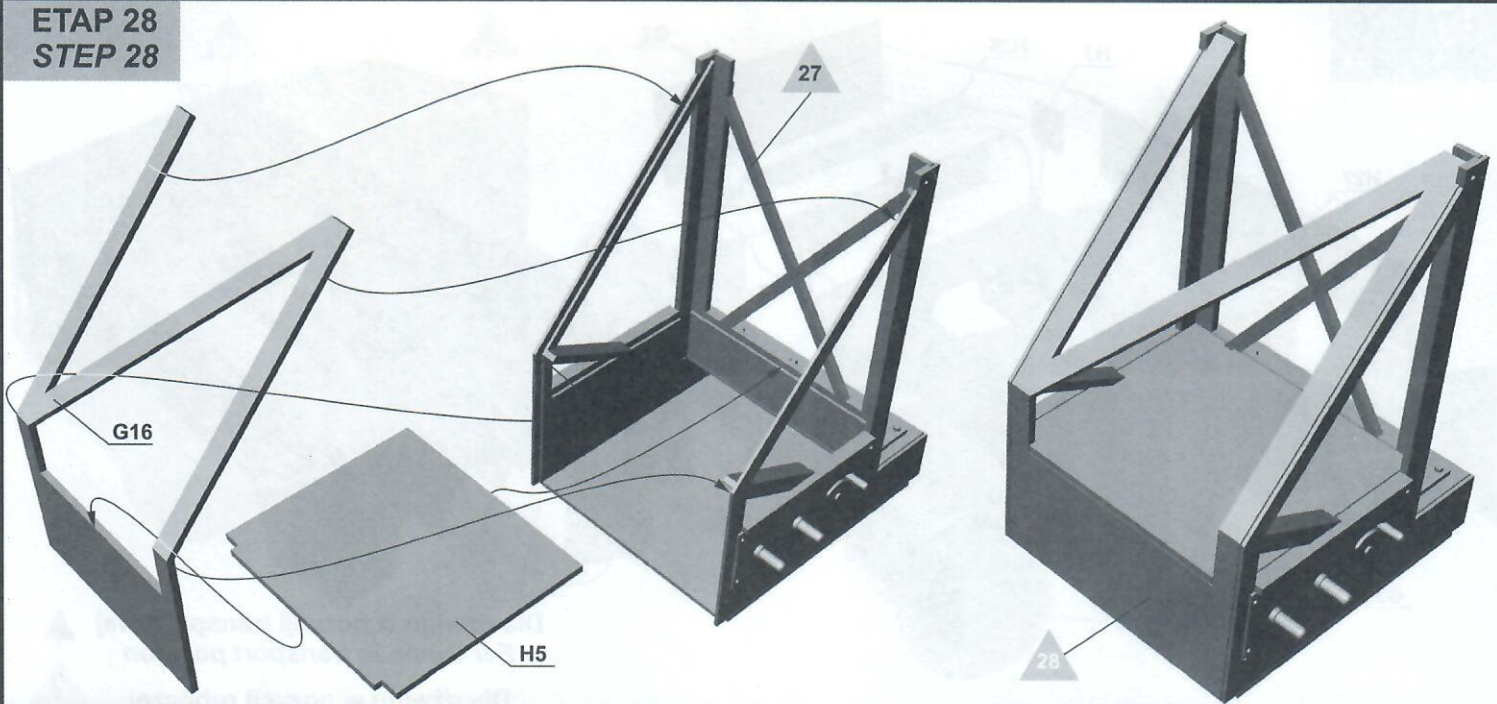

**ETAP 29  
STEP 29**

**Nie kleić!  
Don't glue!**

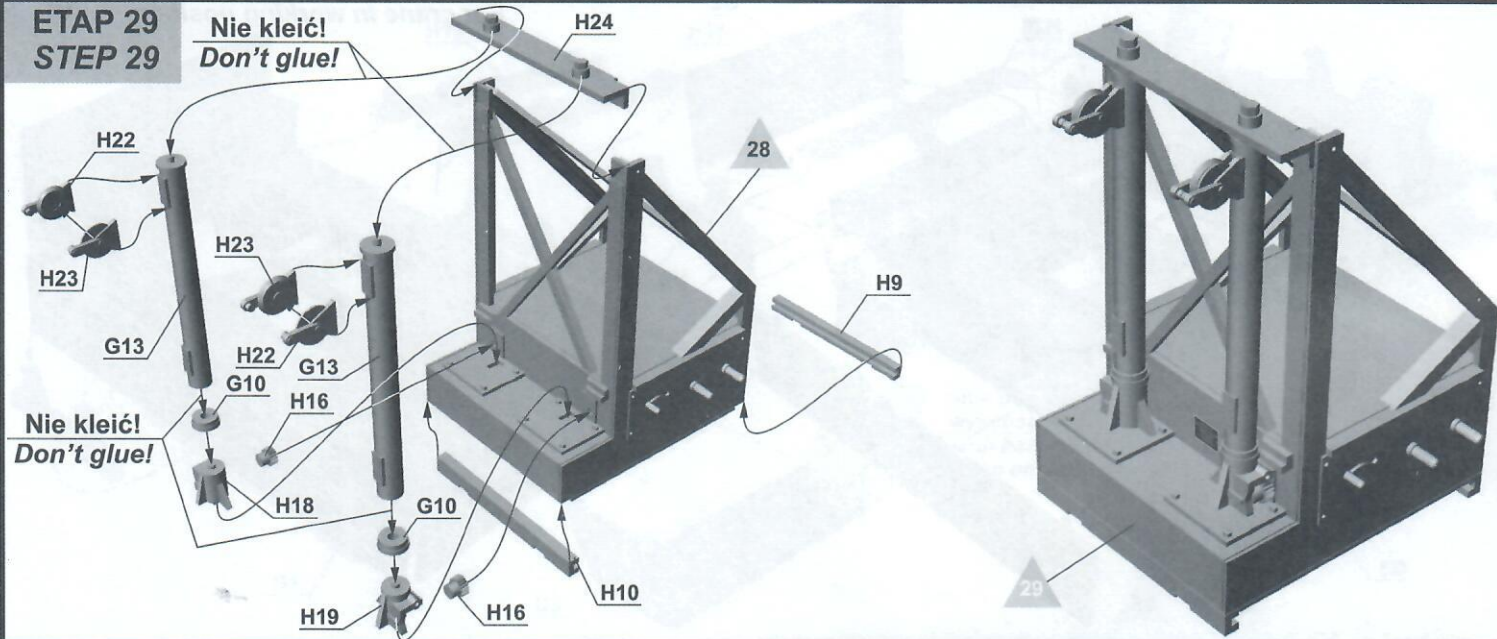



**ETAP 30a Dla dźwigu w pozycji transportowej**  
**STEP 30a For Crane in transport position**

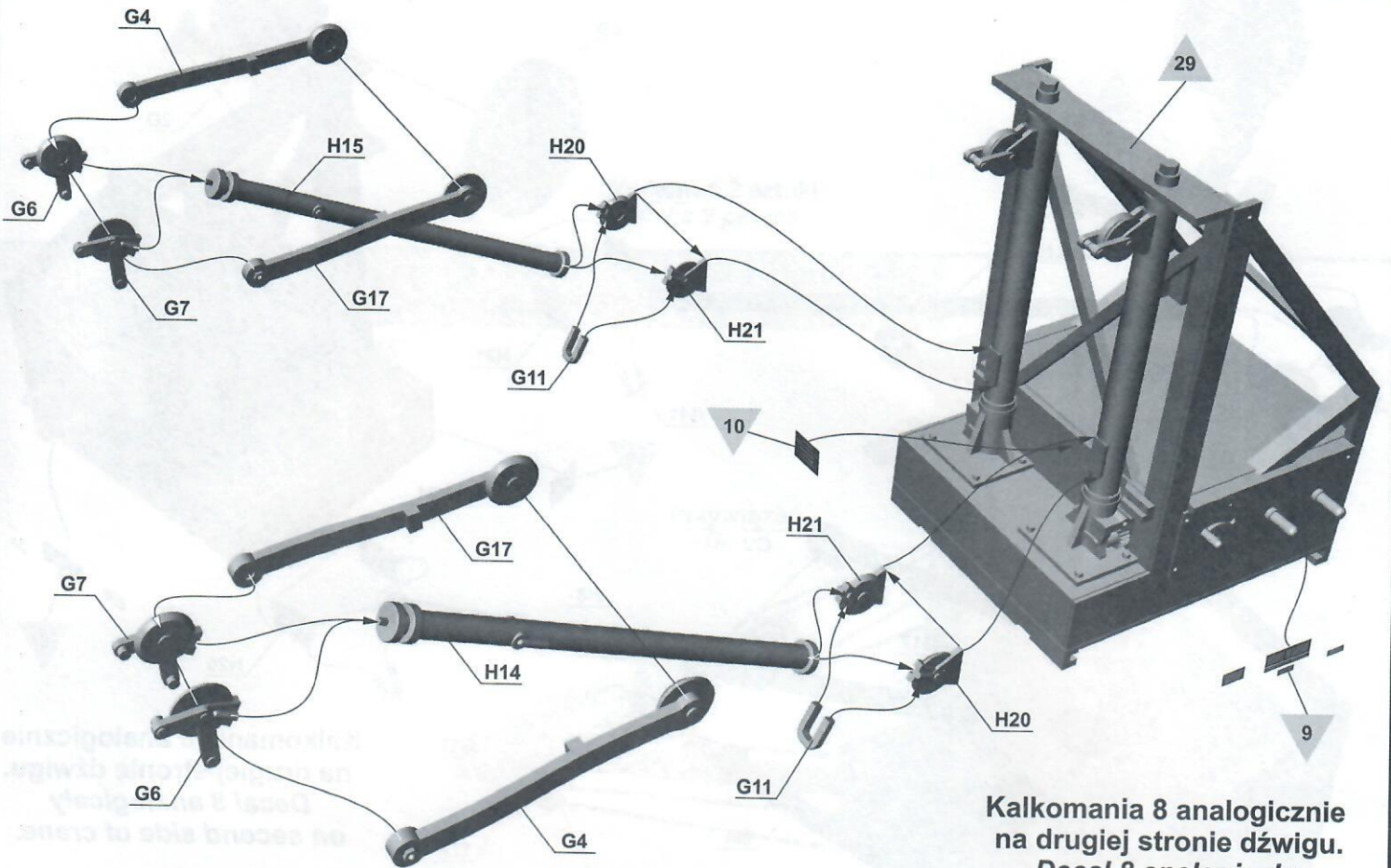

**Kalkomania 8 analogicznie  
na drugiej stronie dźwigu.**  
**Decal 8 analogically  
on second side of crane.**

**Kalkomanie nakładać po pomalowaniu.**  
**Apply decals after painting.**

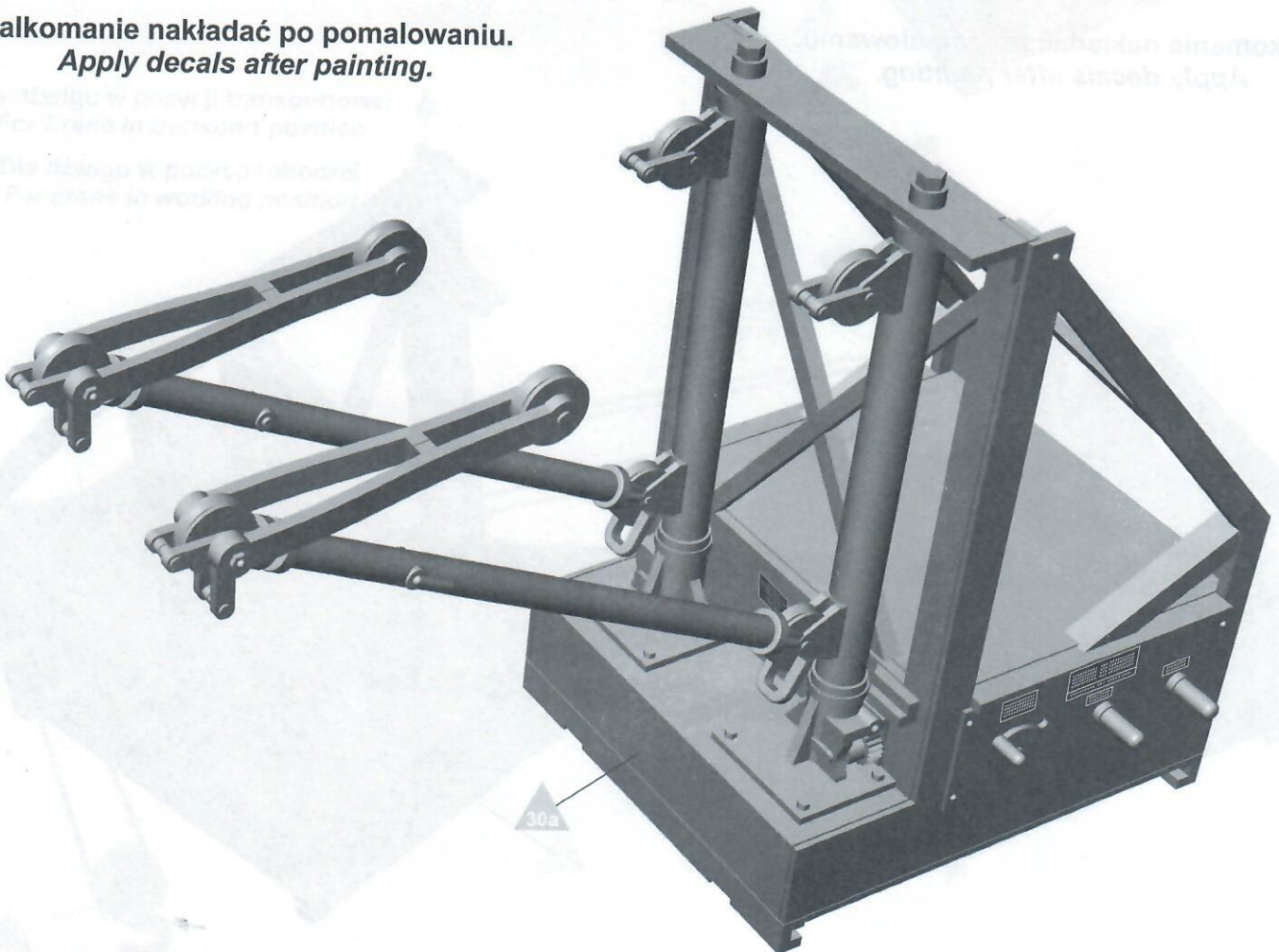

**ETAP 30b Dla dźwigu w pozycji roboczej**  
**STEP 30b For Crane in working position**

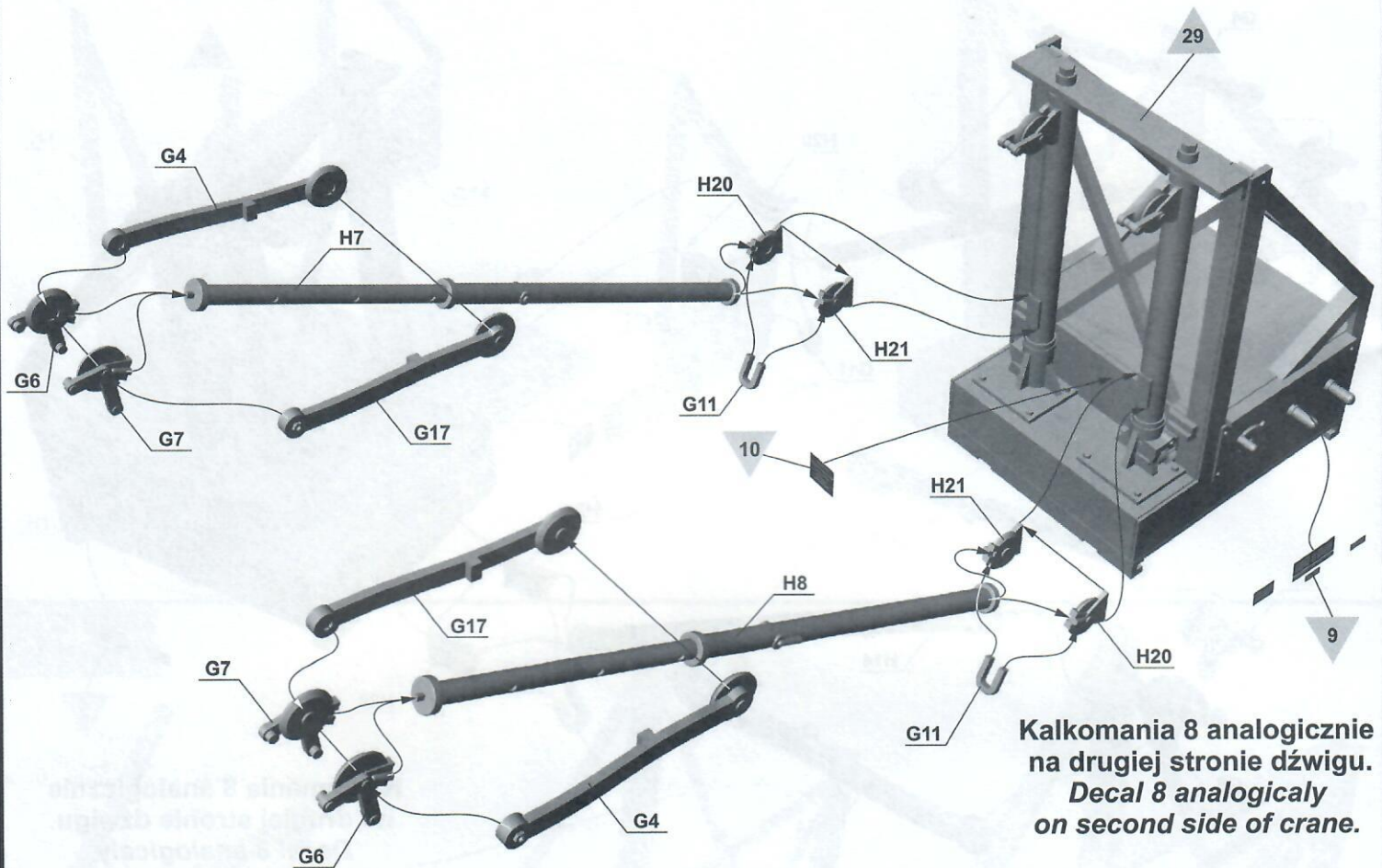

**Kalkomanie nakładać po pomalowaniu.**  
**Apply decals after painting.**

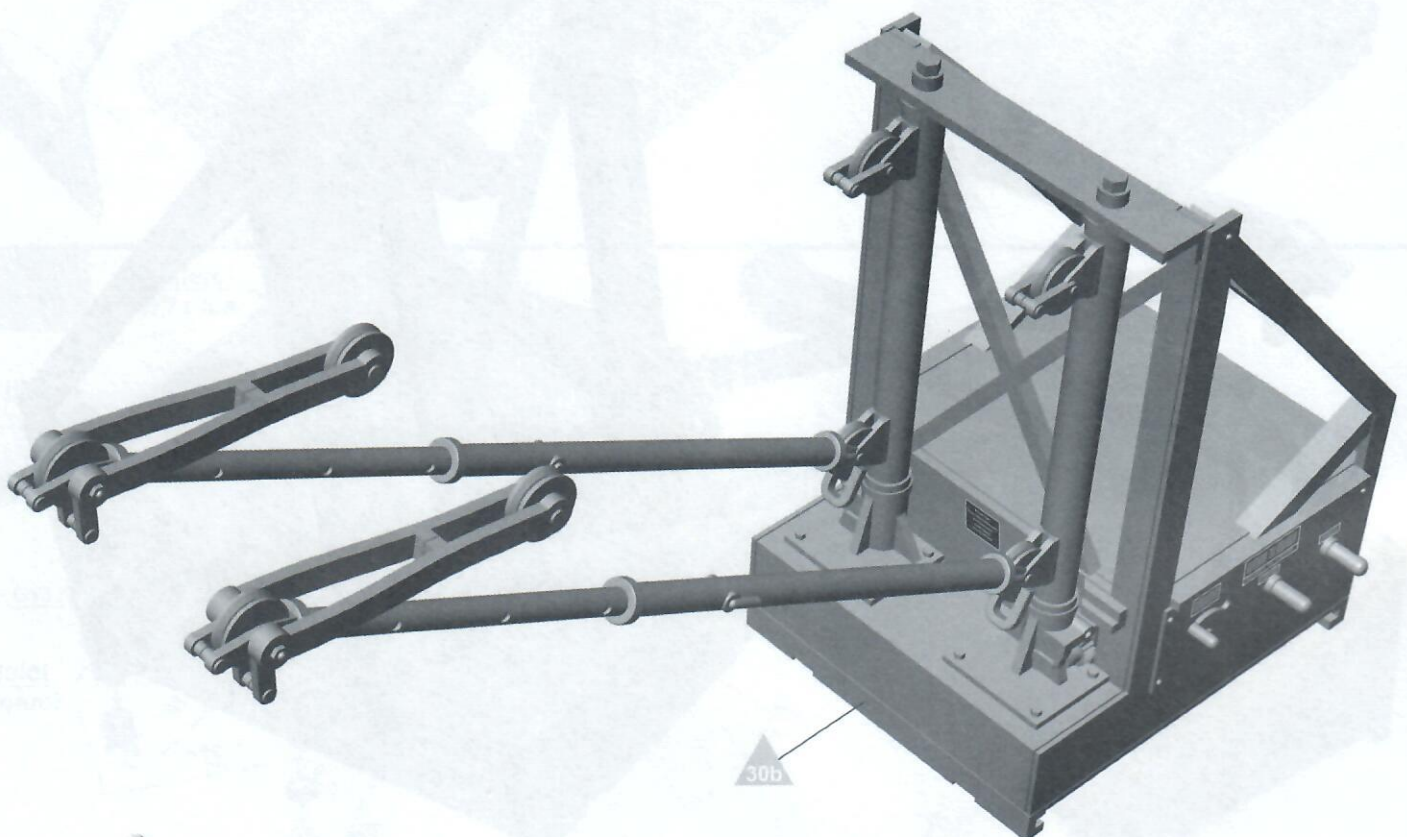

**ETAP 31**  
**STEP 31**

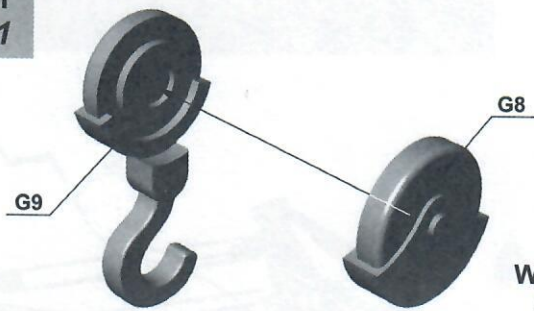

Wykonać 2 sztuki  
Make 2 pieces

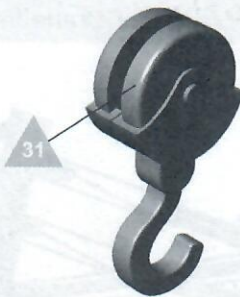

**ETAP 32** Liny nośne dźwigu - identycznie dla obu ramion dźwigu  
**STEP 32** Hoisting cables - identical for both arm of crane

Używać kleju cyjanoakrylowego  
Please use cyanoacrylate glue

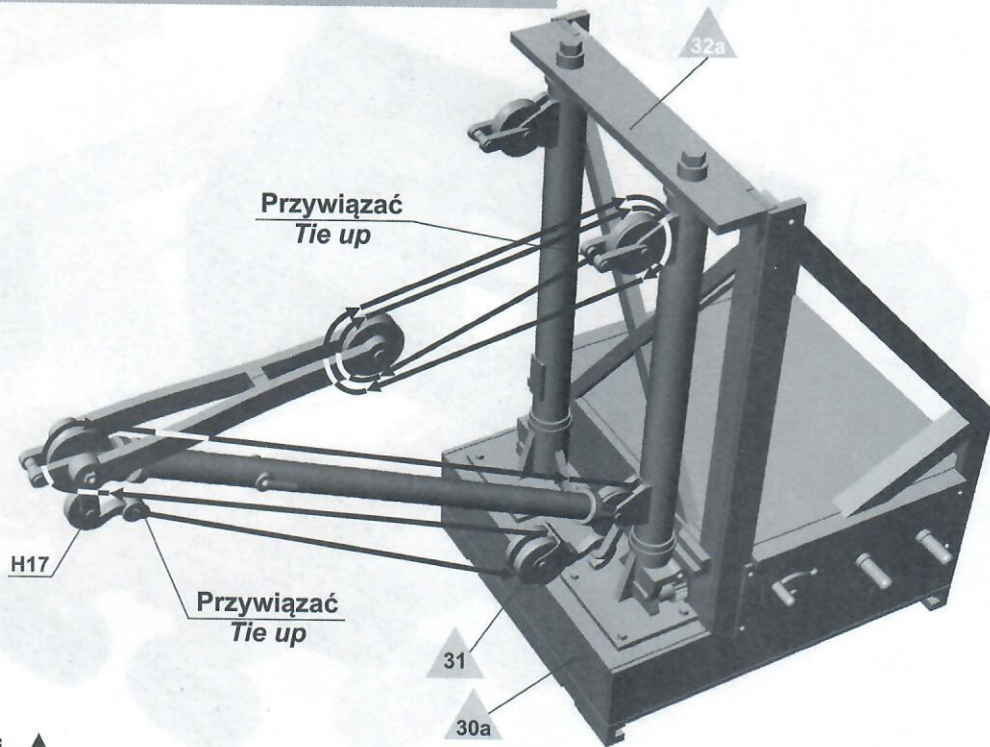

Dla dźwigu w pozycji transportowej  
For Crane in transport position



Dla dźwigu w pozycji roboczej  
For crane in working position

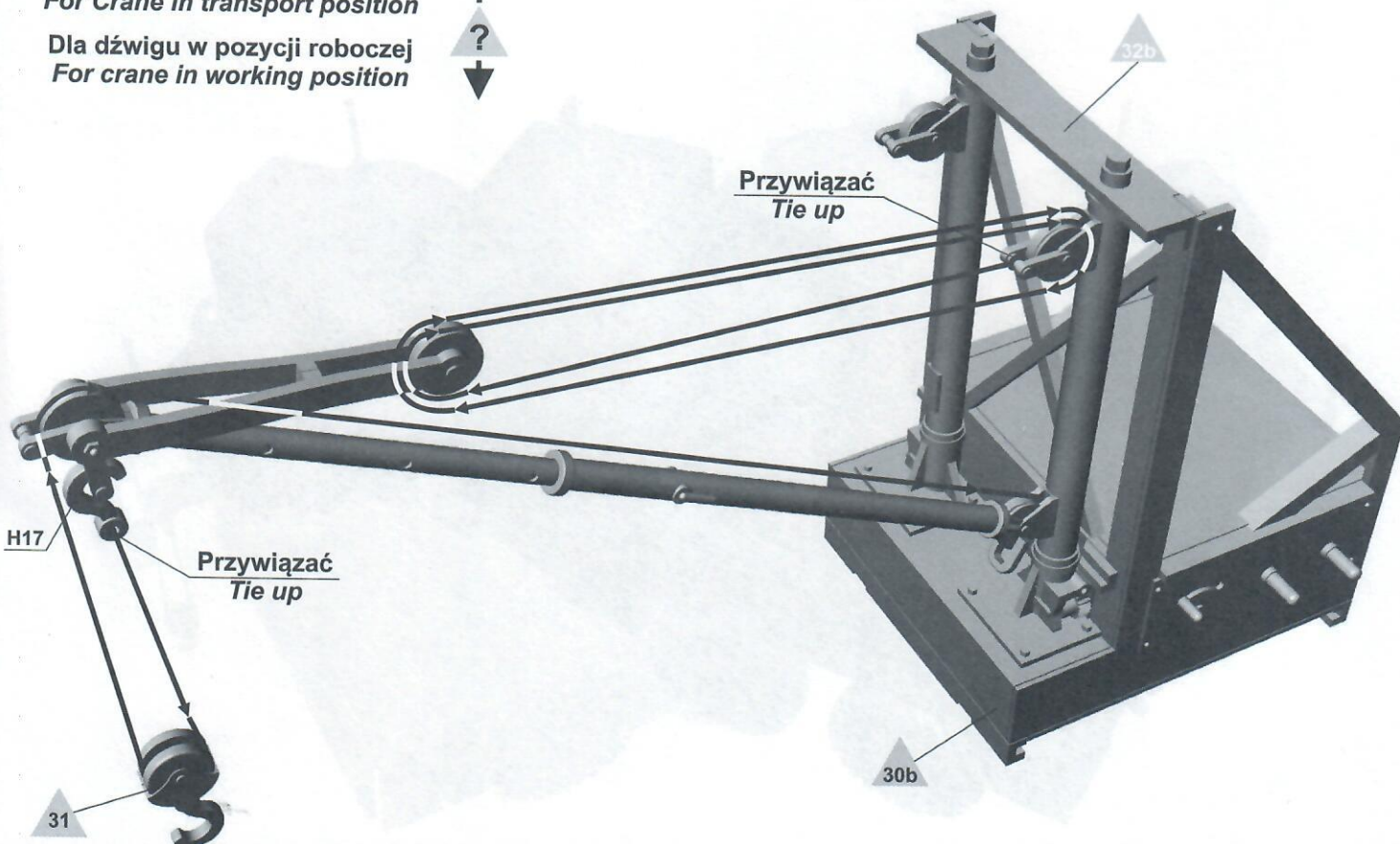

**ETAP 33a Dla dźwigu w pozycji transportowej**  
**STEP 33a For Crane in transport position**

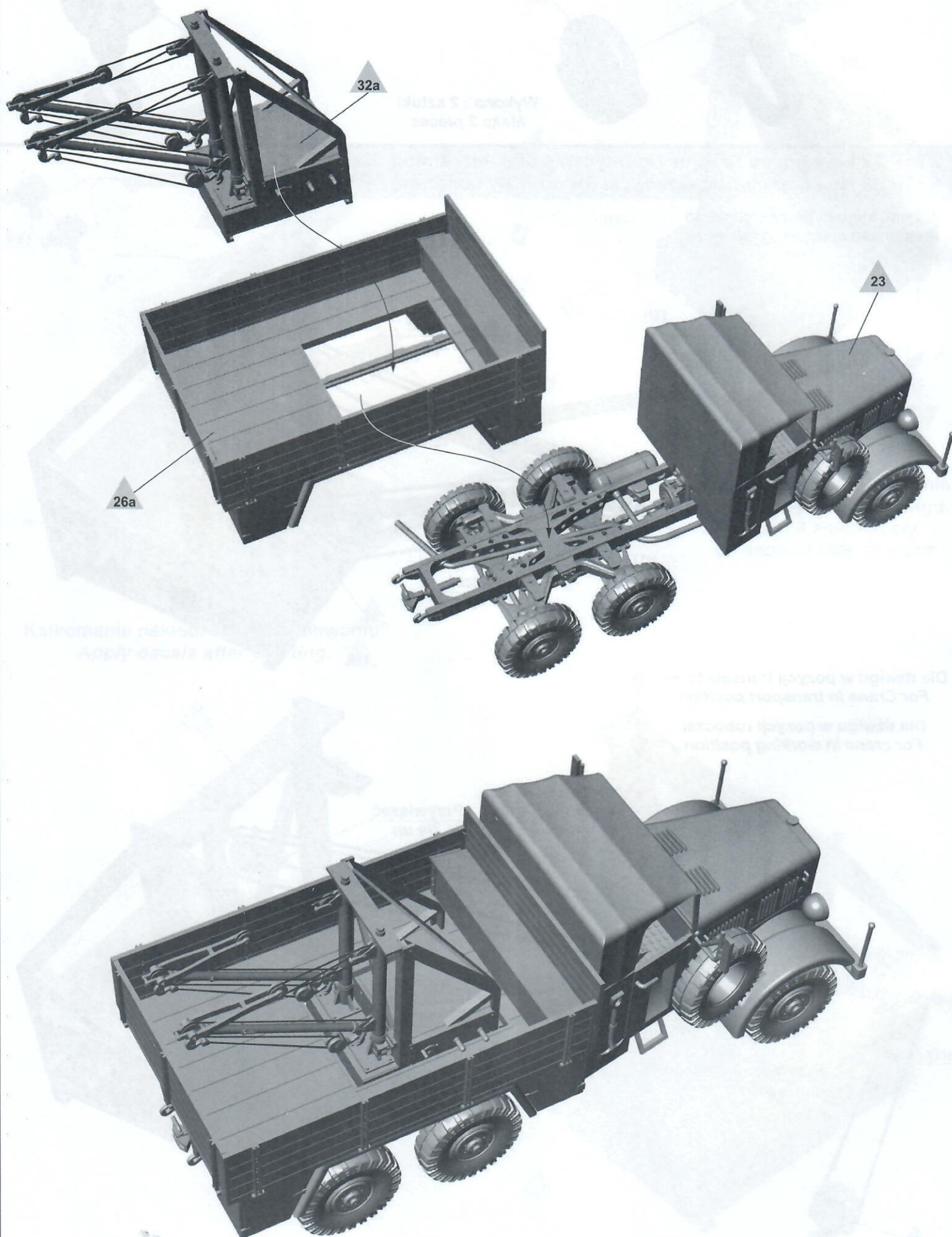

**ETAP 33b Dla dźwigu w pozycji roboczej**  
**STEP 33b For Crane in working position**

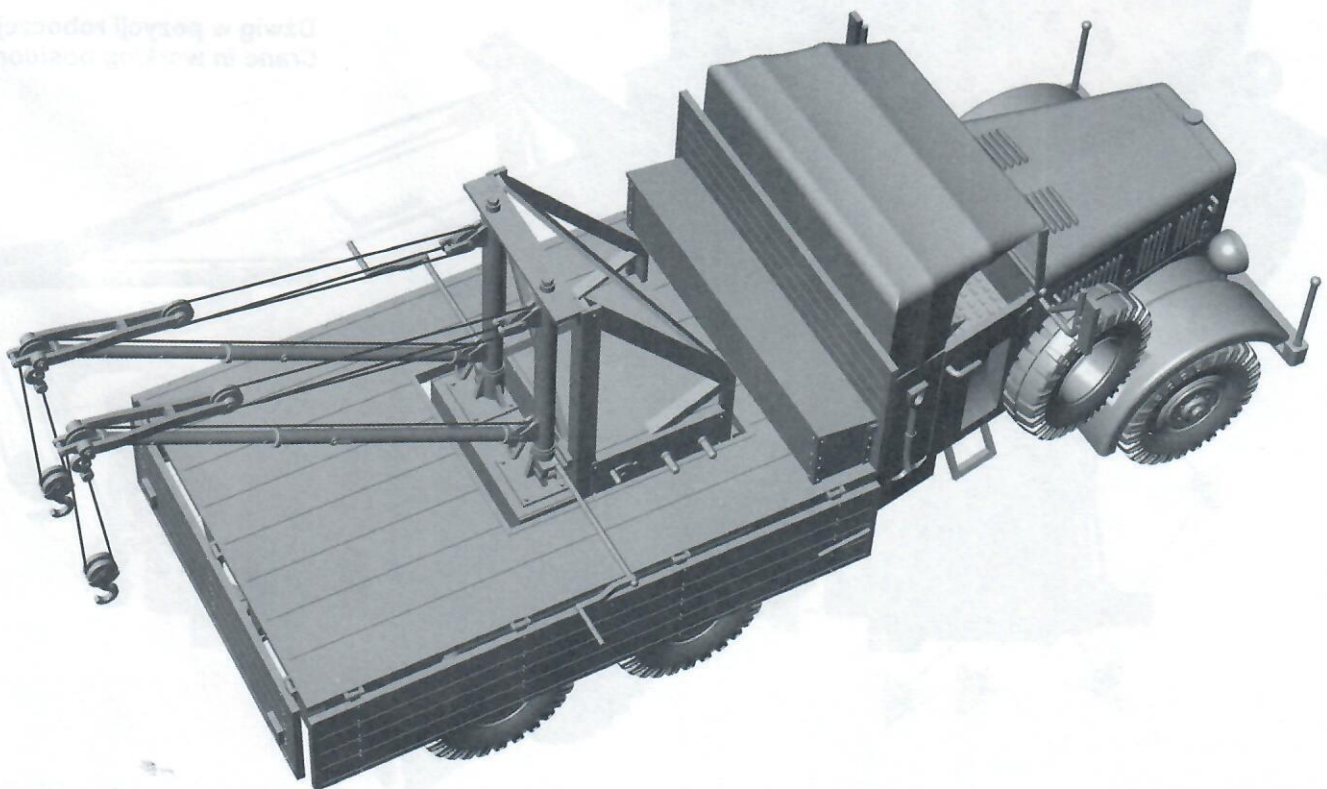
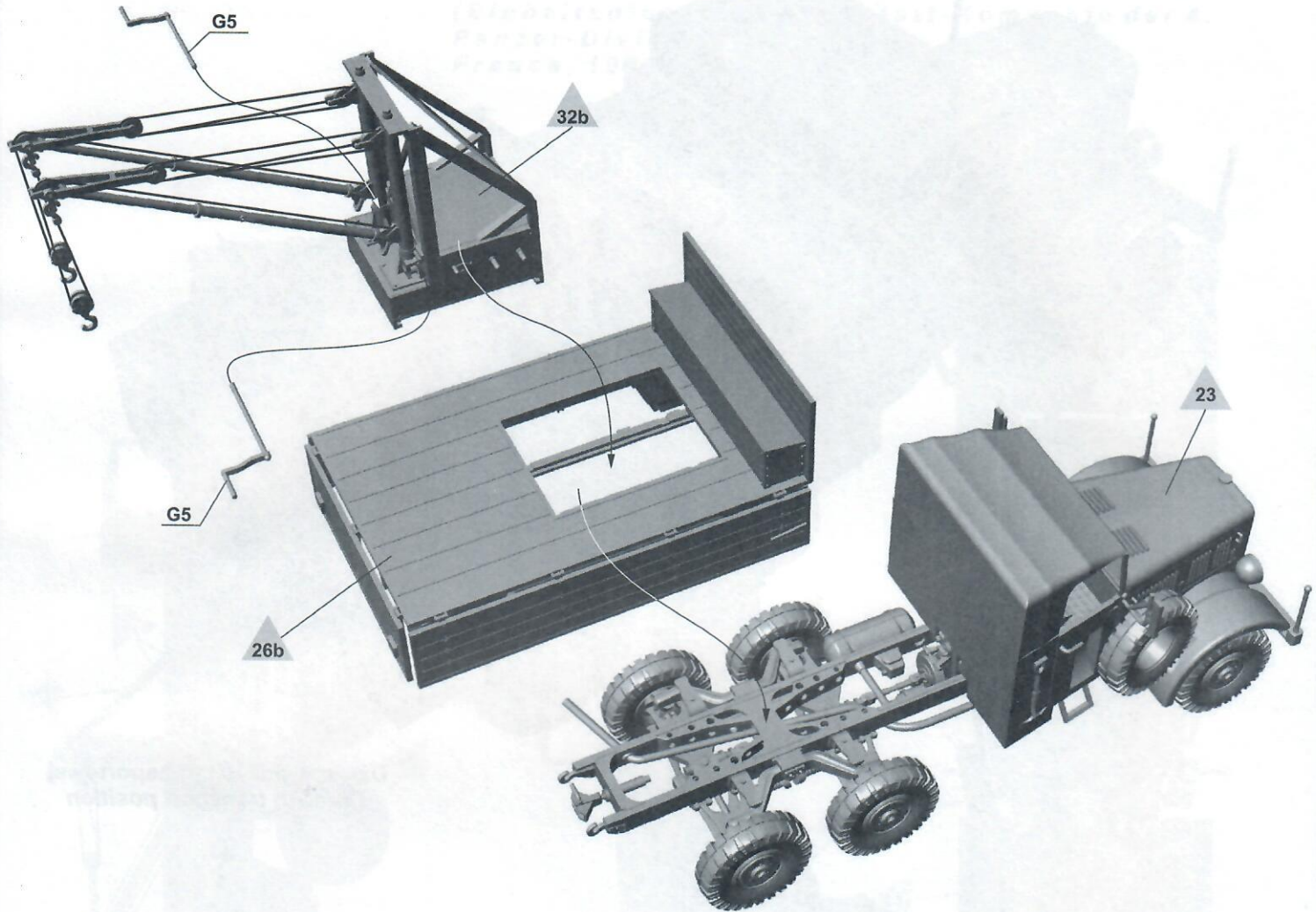

WYKONANY MODEL  
FINISHED MODEL

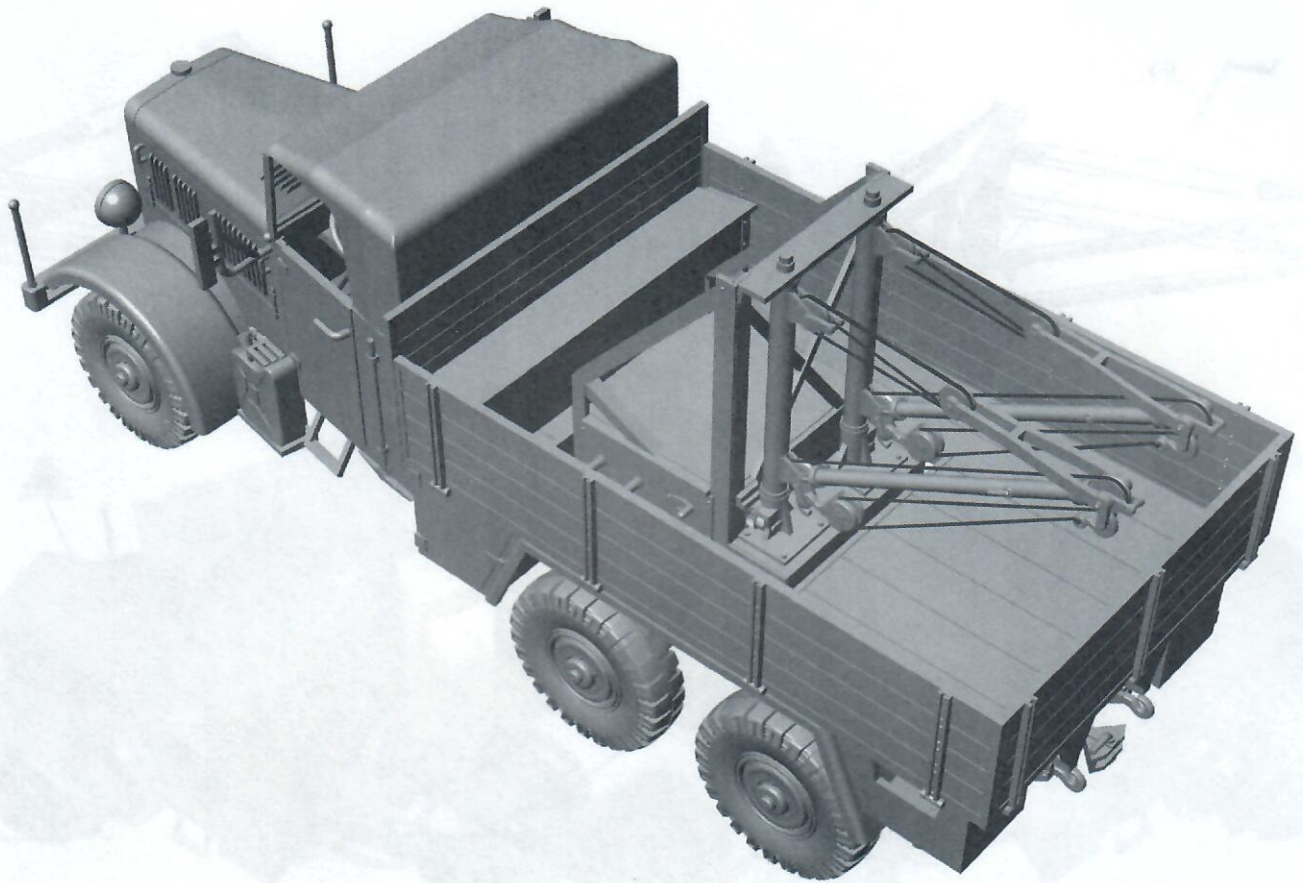

Dźwig w pozycji transportowej  
*Crane in transport position*

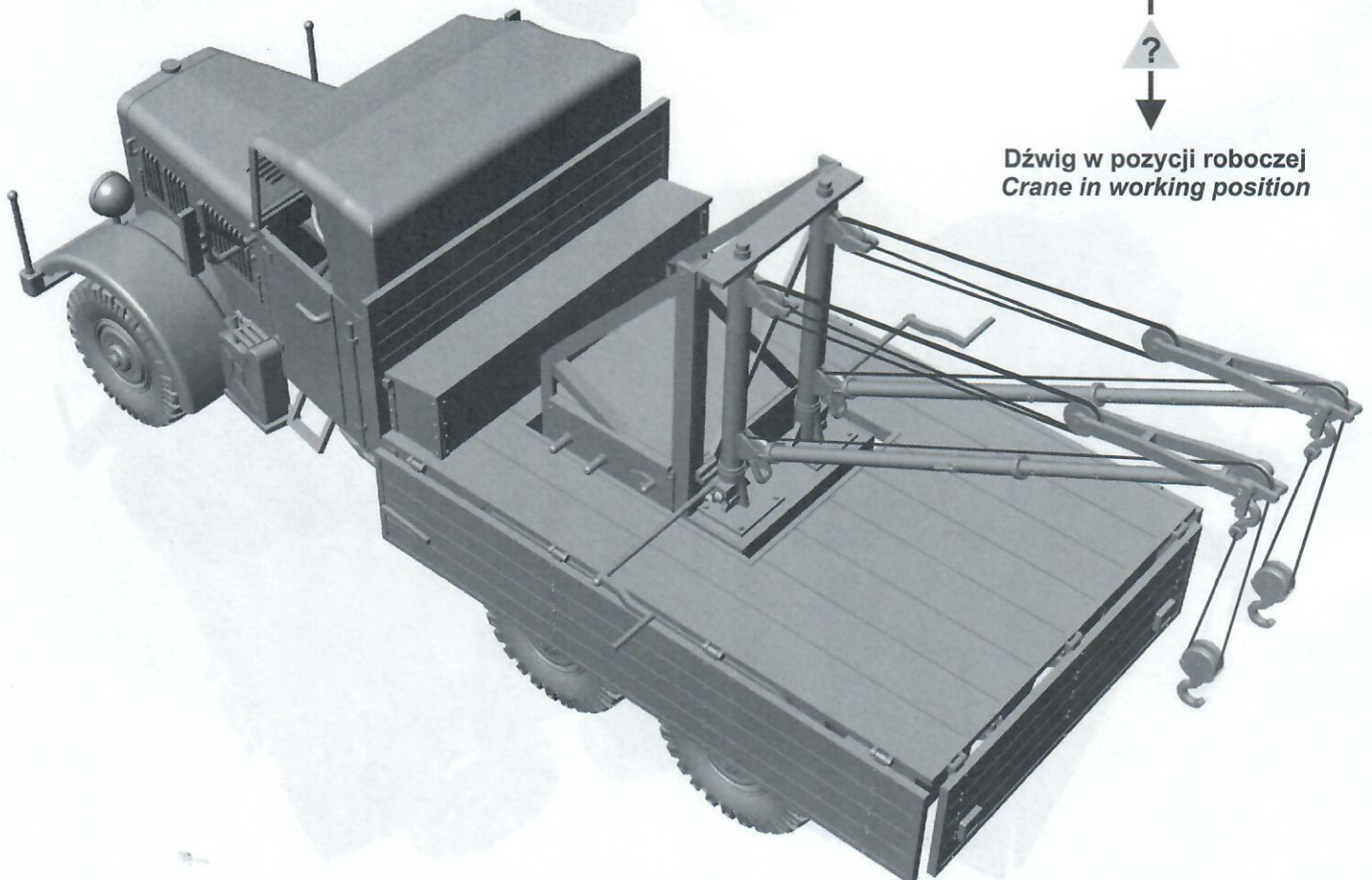

Dźwig w pozycji roboczej  
*Crane in working position*

**MALOWANIE I KALKOMANIE  
COLOURS AND DECALS**

**Einheitsdiesel z dźwigiem Bilstein z Kompanii  
Remontowej 4 Dywizji Panczernej  
Francja, 1940**

*Einheitsdiesel with Bilstein recovery crane from  
Maintenance Company of 4th Armoured Division  
(Einheitsdiesel der Werkstatt-Kompanie der 4.  
Panzer-Division)  
France, 1940*

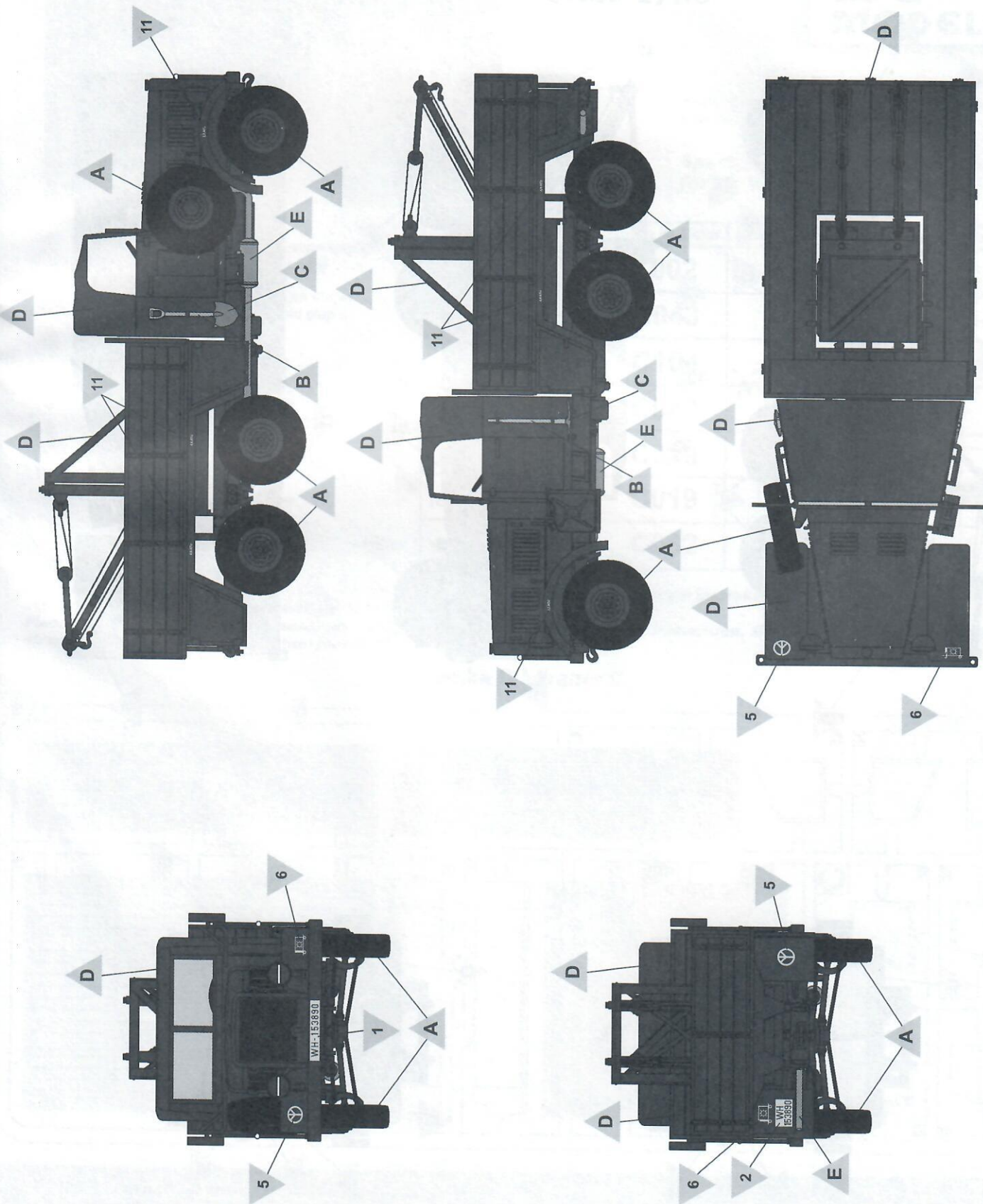

**MALOWANIE I KALKOMANIE**  
**COLOURS AND DECALS**

Einheitsdiesel z dźwigiem Bilstein z Kompanii  
 Remontowej 6 Dywizji Panczernej  
 Front Wschodni, Rosja, zima 1941  
*Einheitsdiesel with Bilstein recovery crane from  
 Maintenance Company of 6th Armoured Division  
 (Einheitsdiesel der Werkstatt-Kompanie der 6.  
 Panzer-Division)  
 Eastern Front, Russia, winter 1941*

