



Bronco Models

Kit No. CB-35062

Versuchsflakwagen 8.8cm Flak 41 auf Sonderfahrgestell (Pz.Sfl.IVc)

8.8cm 41型实验防空自走炮

1/35 SCALE

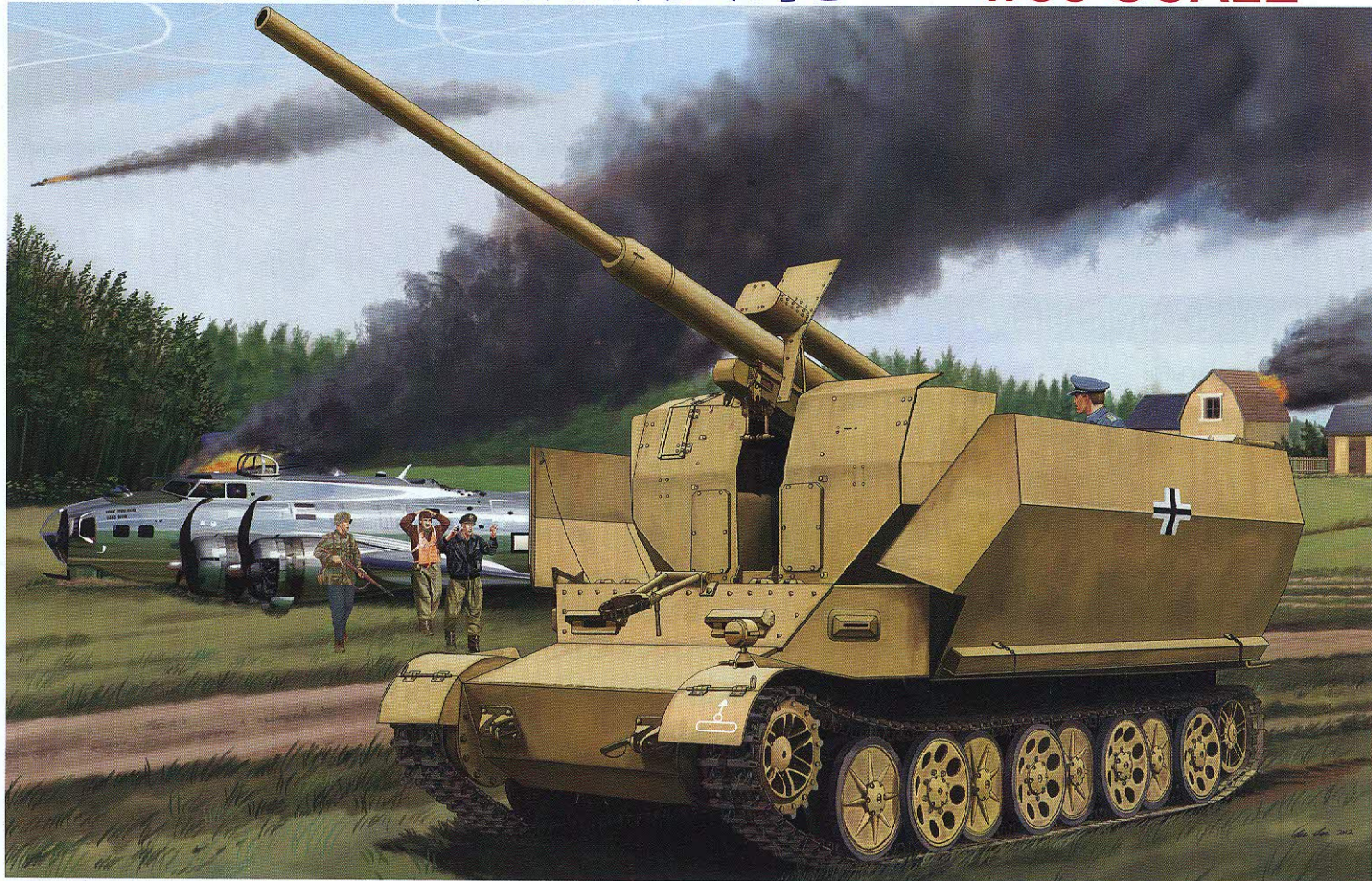

As the war progressed it was German policy to adapt old tank hulls to carry artillery pieces. One of the most utilized chassis was that of the Panzerkampfwagen IV, adapted to mount a whole series of anti-tank and assault guns. The Grille 10 was a heavily modified PzKpfw IV, with track work from the Sd.Kfz.9 artillery tractor. It was originally designed to carry an 8.8cm anti-tank gun. However the design was changed in 1942 and three prototype vehicles were built mounting the 8.8cm Flak.37 anti-aircraft gun. These were designated Versuchsflakwagen (Vfw) für 8.8cm Flak.37, and were ready for testing in late 1943. The idea was to provide a highly mobile anti-aircraft gun to the Panzer Divisions, protecting the tanks from air attack. In 1944 these vehicles were fitted with the 8.8cm Flak.41, though a single vehicle was refitted with a Flak.37 and sent for battle testing in Italy. The two remaining Vfw für 8.8cm Flak.41 vehicles were successful in their trials, but the war ended before mass production could begin in 1945.

Short Story by Phil Greenwood

Im Verlauf des zweiten Weltkrieges bestückte die Wehrmacht immer öfter ältere Panzertypen mit Artilleriewaffen. Das Fahrgestell des Panzerkampfwagen IV wurde für diese Zwecke am häufigsten genutzt. Die Grille 10 war ein stark modifizierter PzKpfw IV mit Laufwerksteilen der Sd.Kfz. 9 Halbketten. Ursprünglich sollte eine 8,8cm PaK darauf Platz finden. Dieser Entwurf wurde 1942 geändert und es entstanden drei Prototypen mit der 8,8 Flak 37. Man nannte das Fahrzeug Versuchsflakwagen (Vfw) für 8,8cm Flak 37 und testete sie Ende 1943. Die Grundidee war eine mobile Flugabwehr zum Schutz der Panzertruppen. 1944 erfolgte eine Umrüstung auf die 8,8cm Flak von zwei Fahrzeugen. Das andere schickte man nach Italien zum Gefechtstest. Die beiden übrigen Vfw bestanden die Erprobungen, doch das Kriegsende 1945 verhinderte die Massenherstellung.

© Translation Michael Knoblich Academy Europe

由于战时需要，德国人进行灵活的循环再用政策将火炮改装在合适的旧坦克底盘上再作使用。其中一个被运用的底盘是四号坦克，不少这种坦克的底盘被改装为防空或反坦克自走炮。蟋蟀 10 自走炮是其中一款把四号坦克底盘作重大改装的好例子。它最初的设计是被装上 8.8 厘米 Pak43 反坦克炮，然而这计划在 1942 年被修改了，在 1943 年底三辆装上 8.8 厘米 Flak.37 型防空炮的原型车被制造出来供测试。这种车被称“试作防空战车”，原本构思是想为装甲师提供一高机动性的高炮以保护坦克免受空袭。在 1944 年其中两台试验车被改装上 8.8 厘米 Flak.41 型防空炮作测试，而唯一一辆仍装有 8.8 厘米 Flak.37 型防空炮的试验车则被送往意大利战线作实战测试。余下之两辆 8.8 厘米 Flak.41 型防空炮的试验车经测试后发现是非常成功的，但可惜在决定大量生产前战争已结束了。



ILLUSTRATION 图示说明:

CORRECT METHOD FOR APPLYING DECALS : HINWEISE ZUM ANBRINGEN DER DECALS : 正确使用水贴纸的方法:

1. Clean model parts surface with wet cloth. Entsprechende Stellen am Modell feucht reinigen.
将需要贴水贴纸之部位表面擦干净。
2. Cut out the decal parts and dip them in cold water for 15 ~20 seconds. Decal ausschneiden und für 15-20 Sek. ins Wasser legen.
将所需之贴纸剪下泡在清水里约15至20秒。
3. Place it on correct position of the model kit. Decal an der richtigen Stelle auflagen.
将湿透之贴纸取出置放于正确之位置旁。
4. Slide off the decal from the base paper on to the model kit surface with a cotton stick. Decal mit Wattestäbchen festhalten und Papier darunter wegziehen.
用棉花棒轻推贴纸表面使其从底纸滑出至模型表面之正确位置。
5. When decal get dry then complete. Decal mit Papiertuch andrücken und trocknen.
待其自然干透后即完成。

ICON INSTRUCTION: 图标说明:



Open Hole
Loch bohren
钻孔



Remove
Abtrennen
切除



2 Sets needed
Vorgang wiederholen
同样的制作二组



Bend
Biegen
曲折



Optional
Auswahl
可以选择采用



Apply Decal
Decal anbringen
贴水贴纸



Instant Glue For Metal
Sekundenkleber verwenden
瞬间接着剂,金属用



Fill Hole
Verspachteln
把孔填平



Do not cement
Nicht kleben
不用粘合

COLOR SUGGESTION: FARBTABELLE: 涂装指引:

Color 涂料表	MR. Hobby	Hobby Color	Humbrol	Tamiya
Steel Stahl 黑铁色	H-18	C-28	53	/
Sand 沙黄色	H-78	C-38	66	XF-62
Tyre black Reifenschwarz 轮胎黑	H-77	C-137	85	/
Semi-gloss black Schwarz Seidenmatt 半光黑色	/	C-82	/	/
Rust Rust 铁锈色	H-334	/	113	/
Dark green Dunkelgrün 深绿色	H-36	C-17	30	XF-61
German Gray Deutsch Grau 德国灰	H-32	C-40	92	XF-63
Dark Yellow Dunkelgelb 深黄色	H-78	C-38	66	XF-62
Flat Black Mattschwarz 消光黑	H-12	C-33	33	XF-1
Neutral Grey Neutralen Grau 中灰色	H-53	C-13	/	XF-53
Copper 铜色	H-10	C-10	12	XF-6
Burnt iron Metall brüniert 烧铁色	H-76	C-61	/	/
Wood brown Holzbraun 木啡色	H-37	C-43	/	/
Red Rot 红色	H-3	C-3	19	X-7
Field gray Feldgrau 原野灰	H-48	C-52	/	XF-65

READ BEFORE ASSEMBLING: VOR ZUSAMMENBAU LESEN: 组装必读:

- Carefully Study instruction before assembling. Anleitung studieren und verständlich machen. 组装前请阅读清楚制作指引。
- Keep plastic model glue and tools away from children. Kleber, Farben, Werkzeuge und Plastiktüten von Kindern fernhalten. 胶水,油漆及工具勿让小孩接触。
- Do not use cement or paint near open flame or sparks. Kleber/Farbe nicht in Nähe von offenen Flammen. 胶水及油漆勿接触火种。
- Do not work in closed room. Nur in ausreichend belüfteten Räumen arbeiten. 勿在密封地方制作模型。

PARTS LIST 零件展示表:

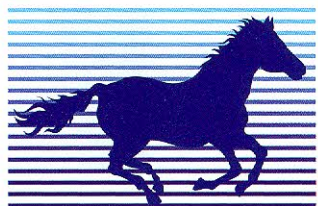

BRONCO
Bronco Models

Copyright © 2013

Made in China

中国制造

No use parts
不要部件



(Ba) × 4

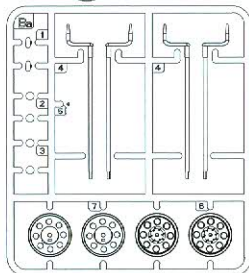

(Eb) × 1

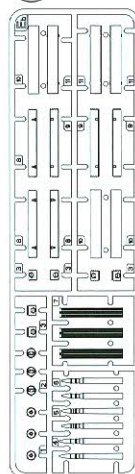

(D) × 1

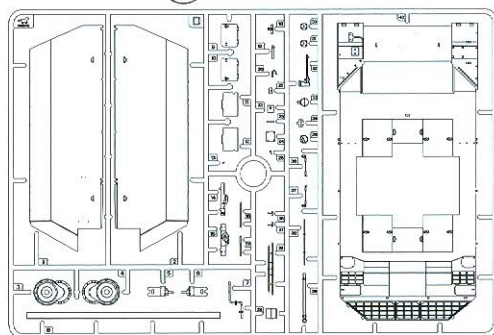

(A) × 1

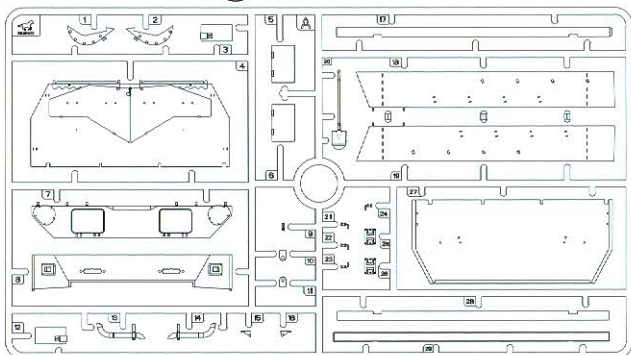

(F) × 1

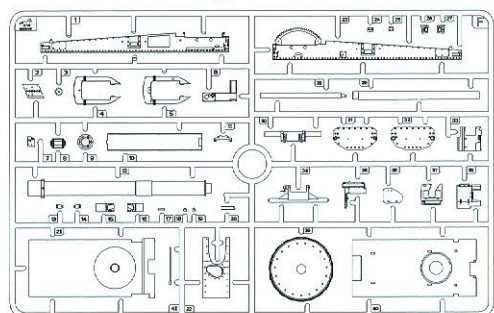

(Da) × 2

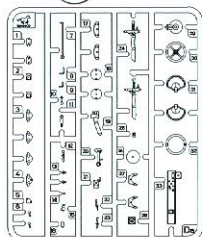

(B) × 1

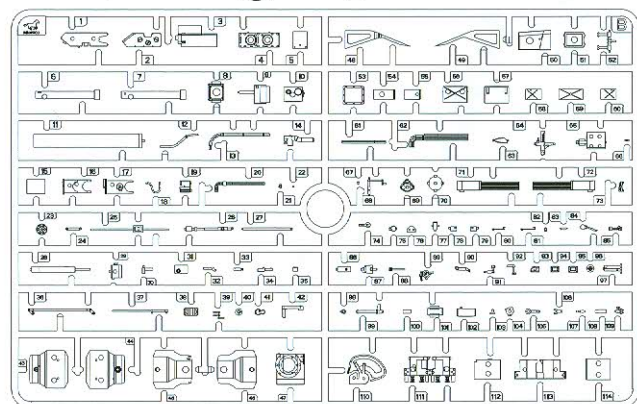

(B) × 2

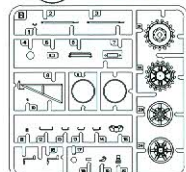

(C1) × 1

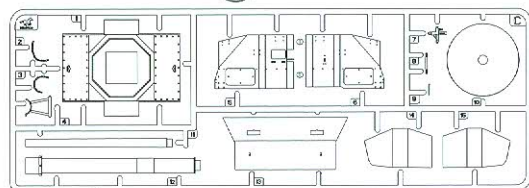

(M) × 8

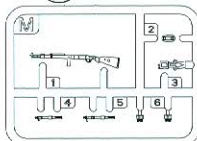

(F1) × 1

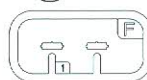

(Bc) × 4



(C) × 1

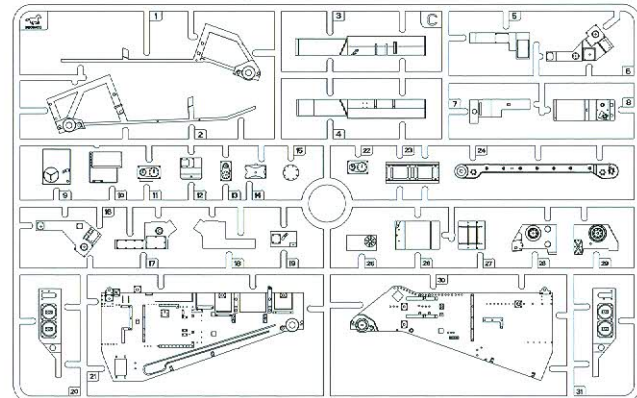

(N) × 1



(G) × 1

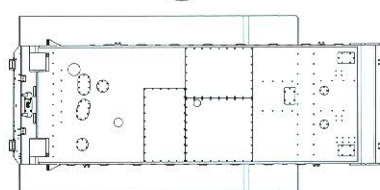

(Ea) × 12

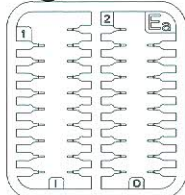

(L) × 19



DECAL × 1

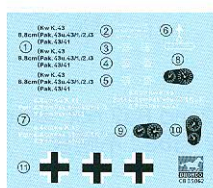

(P) × 1

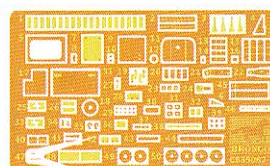

(Pa) × 1

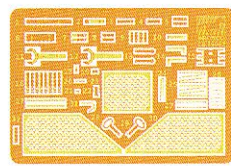

(S) × 3



CB35062

(Q) × 1



(Fa) × 1

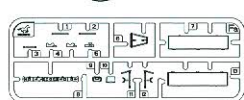

ILLUSTRATION 图示说明:

Caution:

This kit contains a lot of small accurate parts, please carefully to read before to assembly.

此套件包含不少精细零件, 请在制作前先翻阅说明书了解清楚。

1

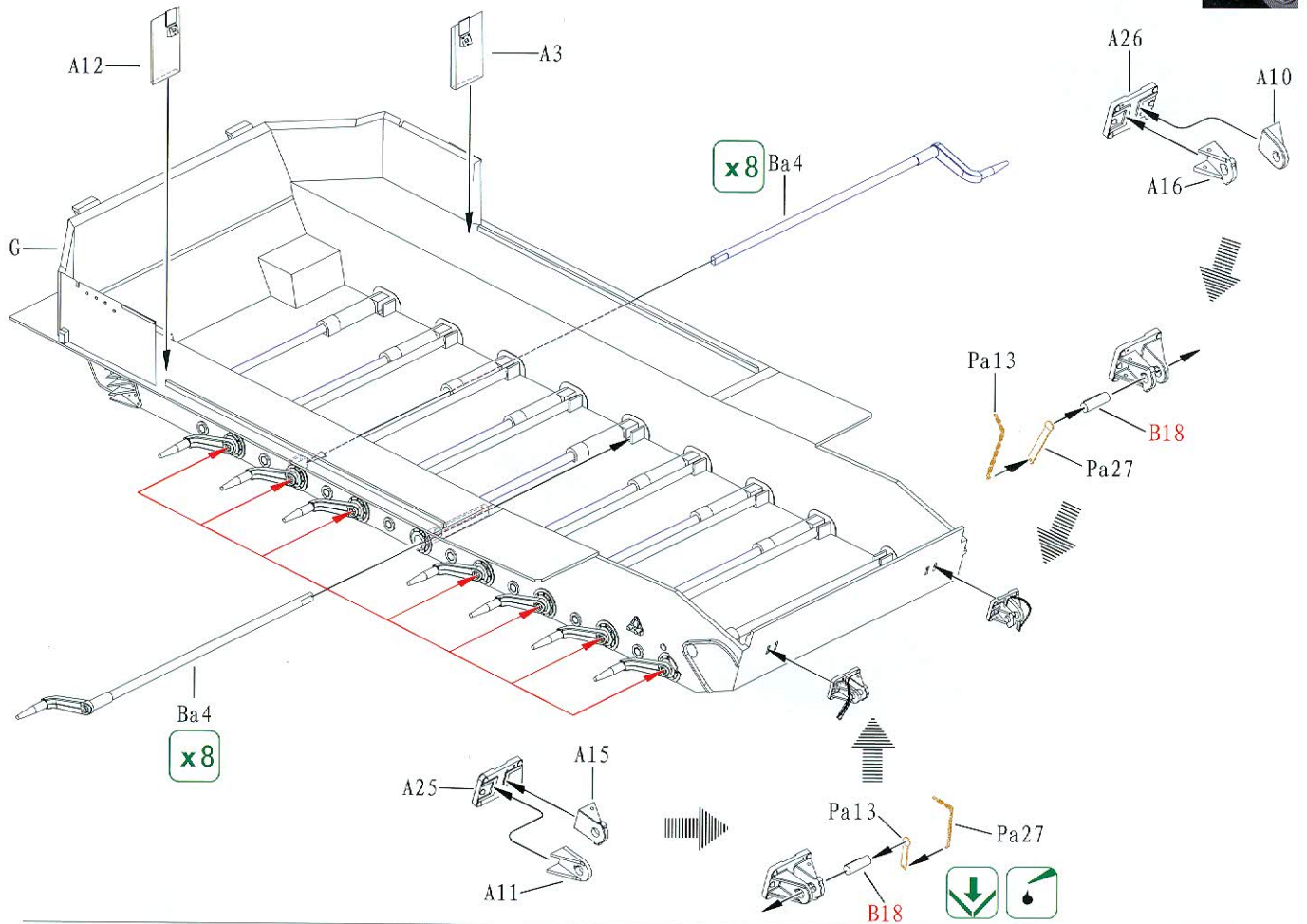

2

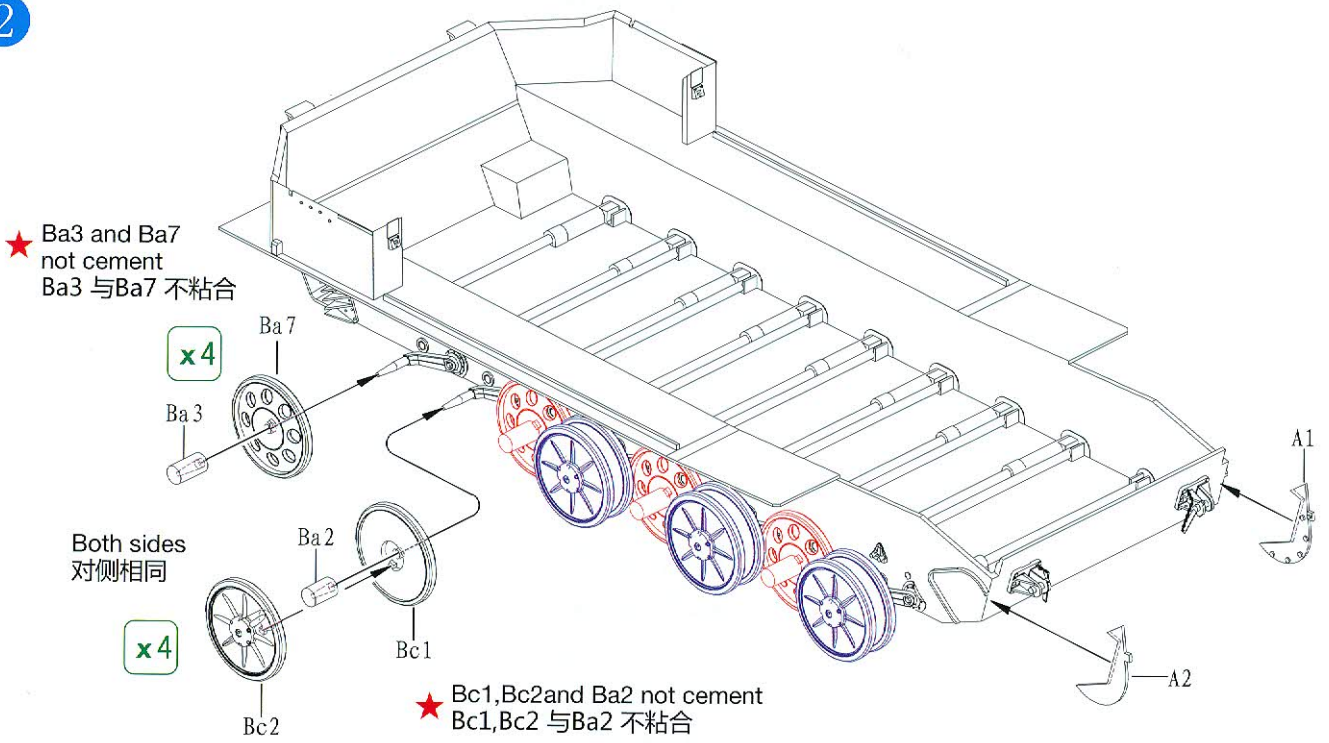

3

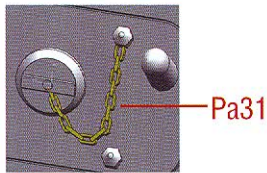
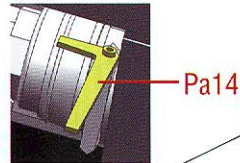
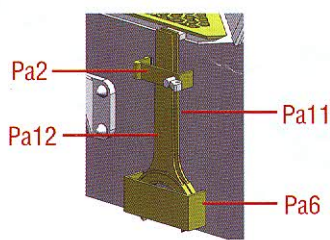
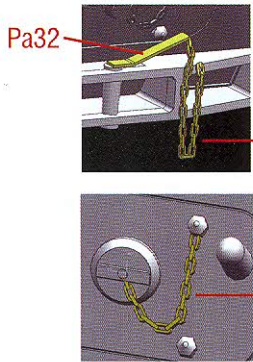
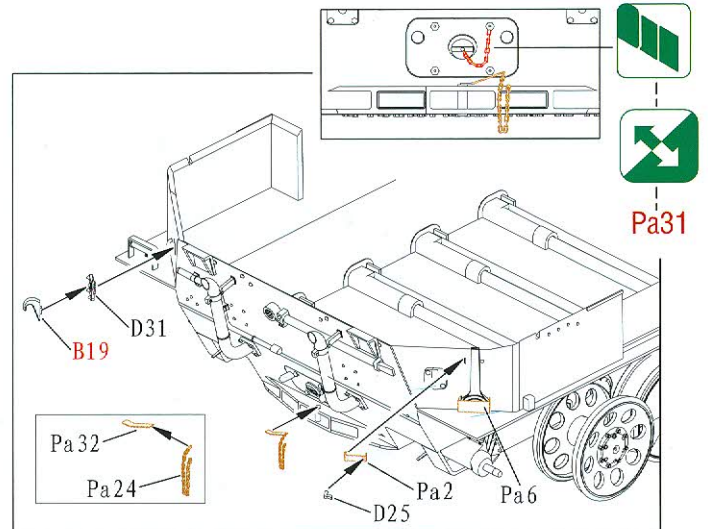
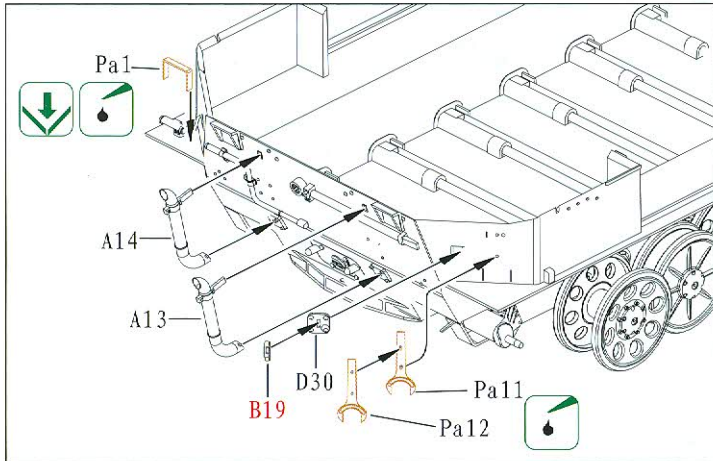
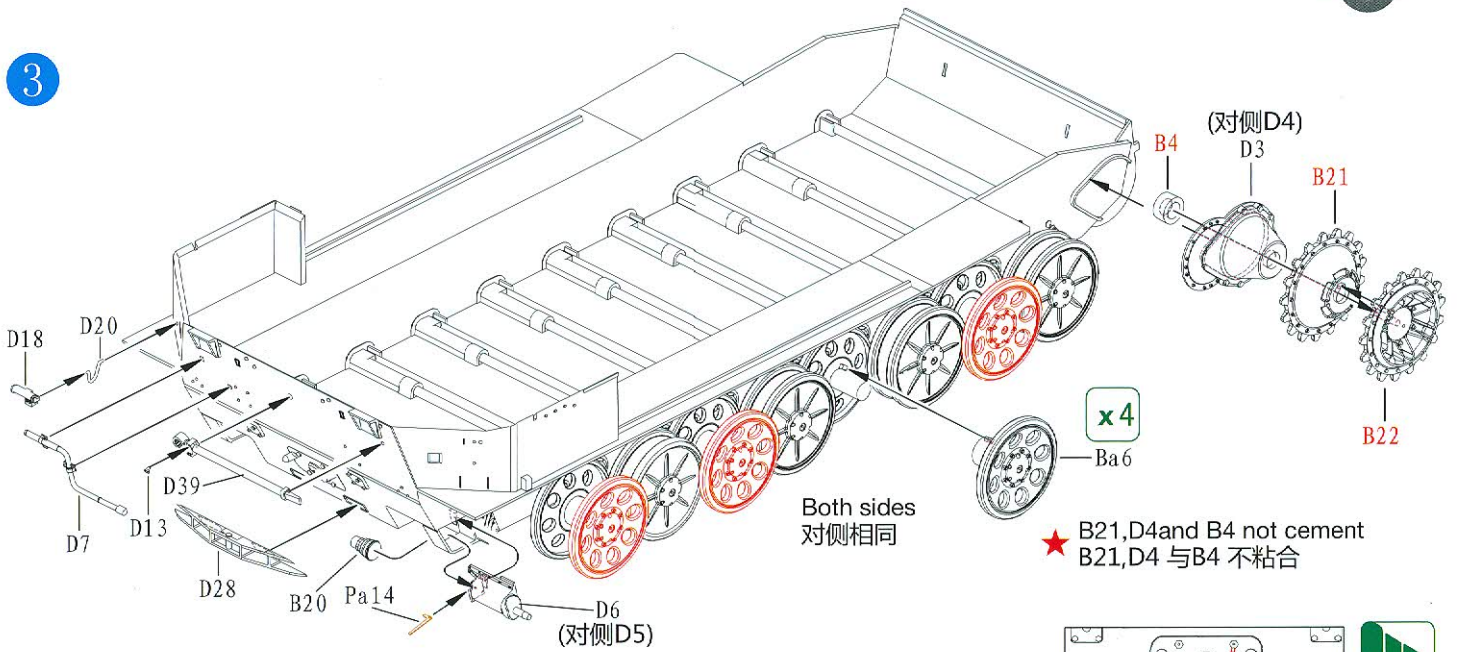

4

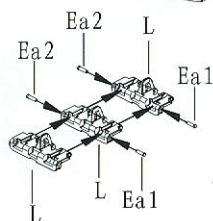
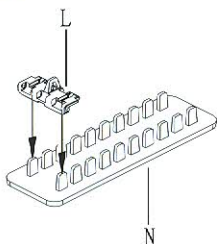

★ Caution: Each set x109 pc
注意：每组需要109枚

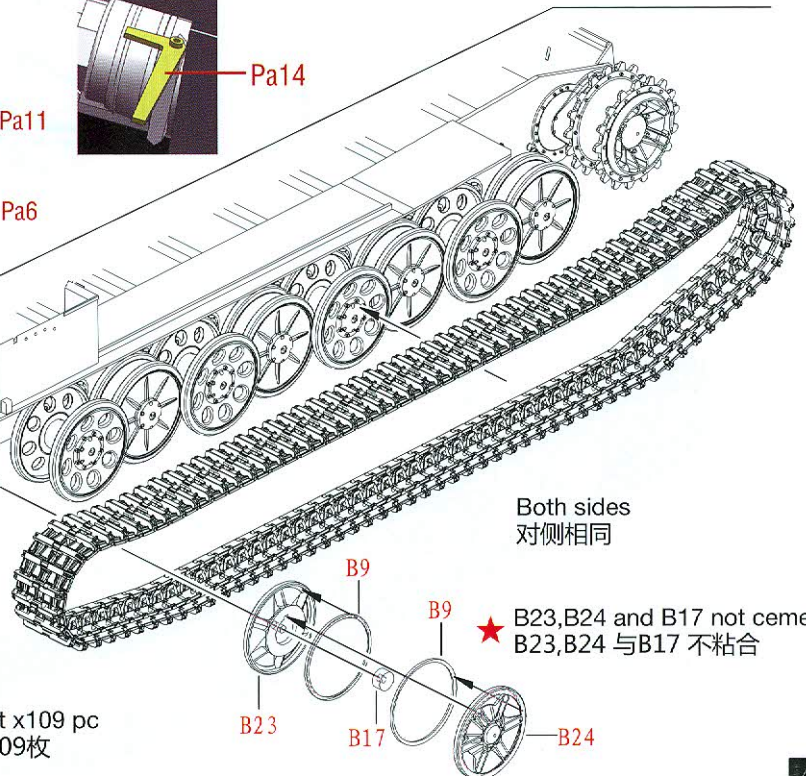
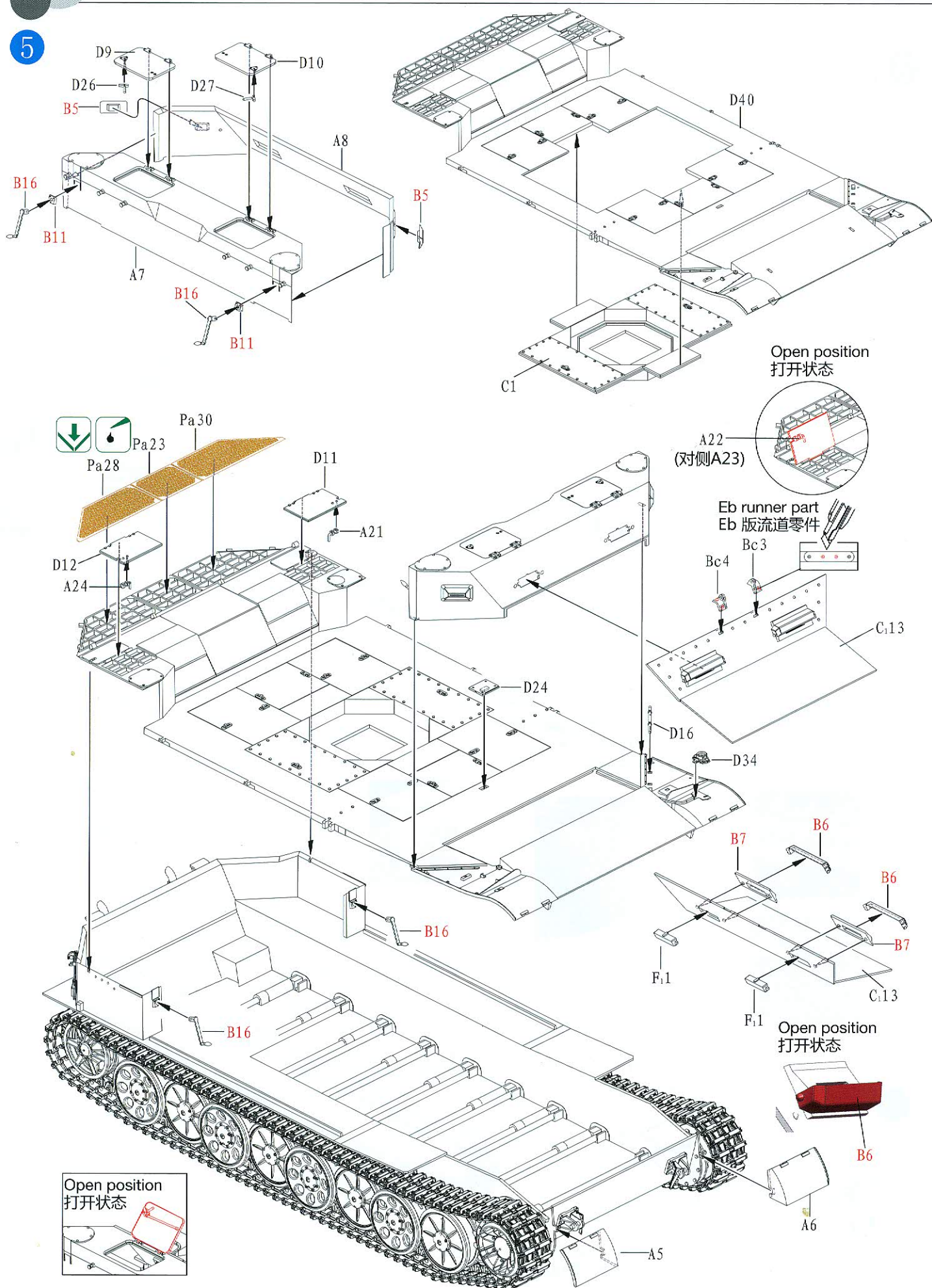
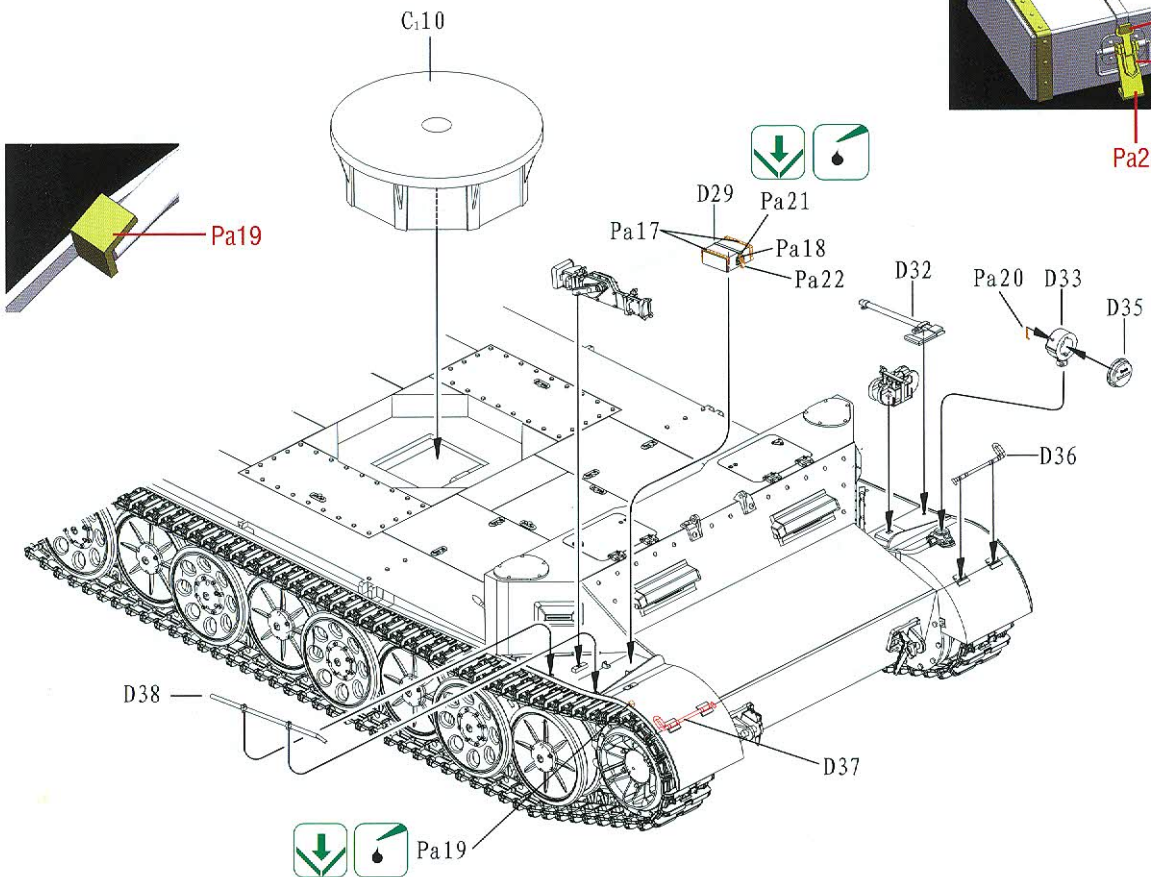
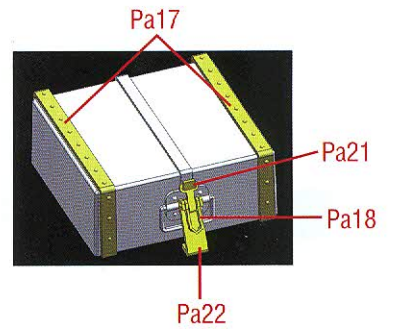
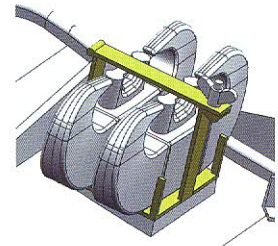
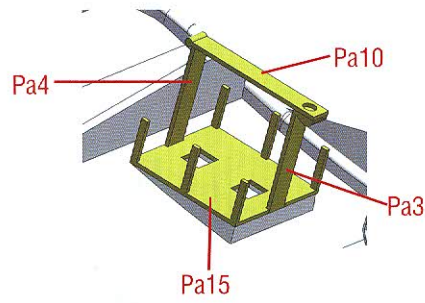
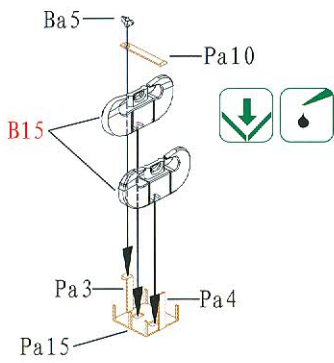
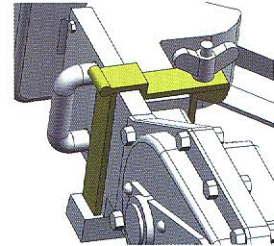
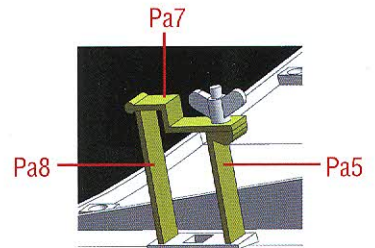
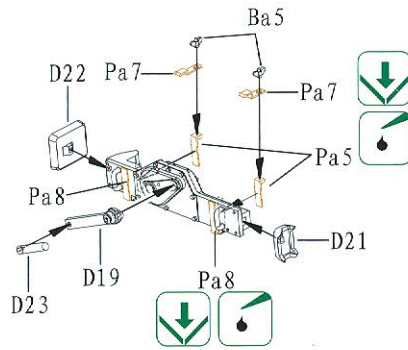
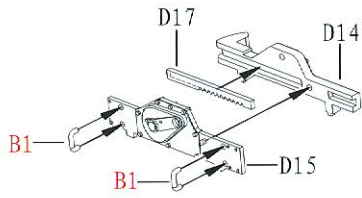

ILLUSTRATION 图示说明:

5



6



7

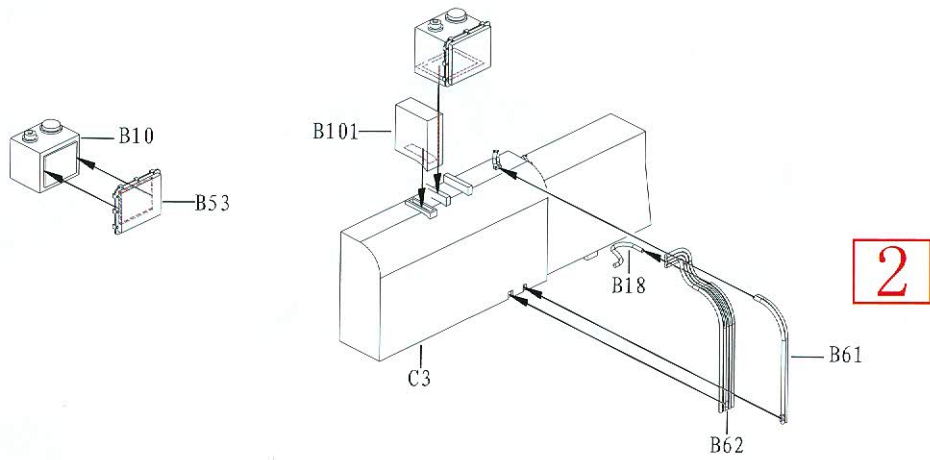
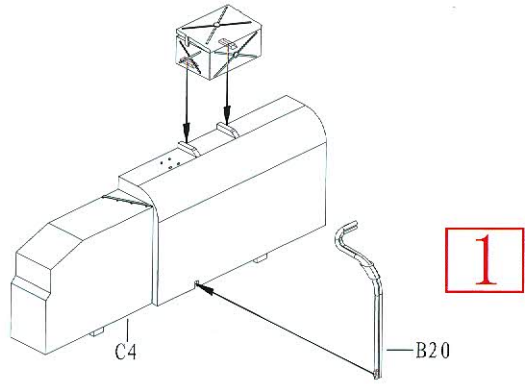
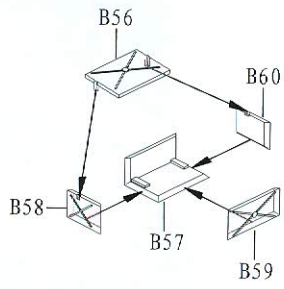

8

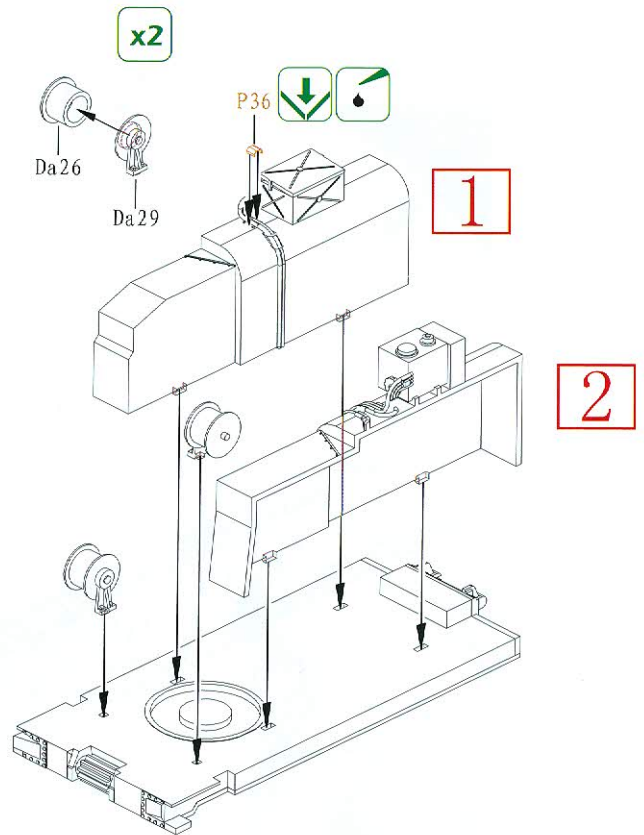
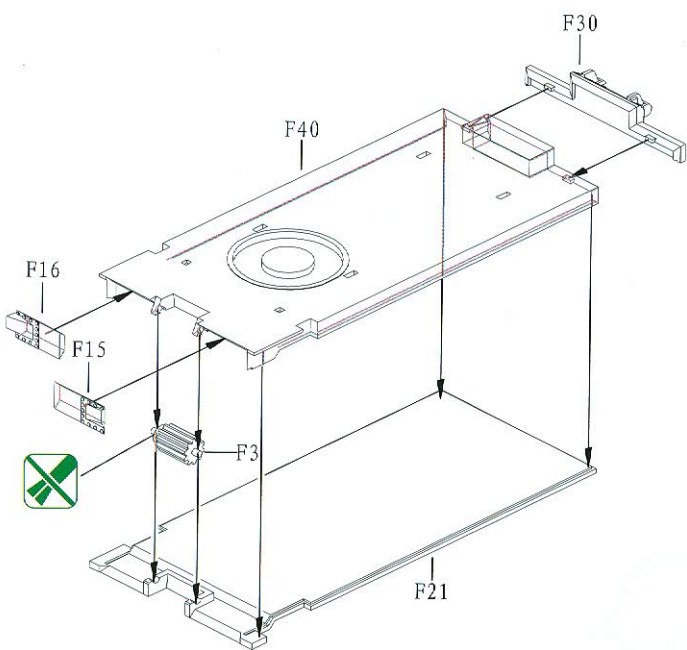

9

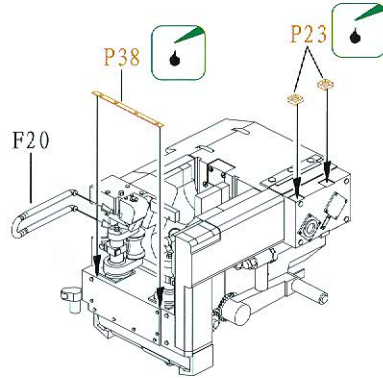
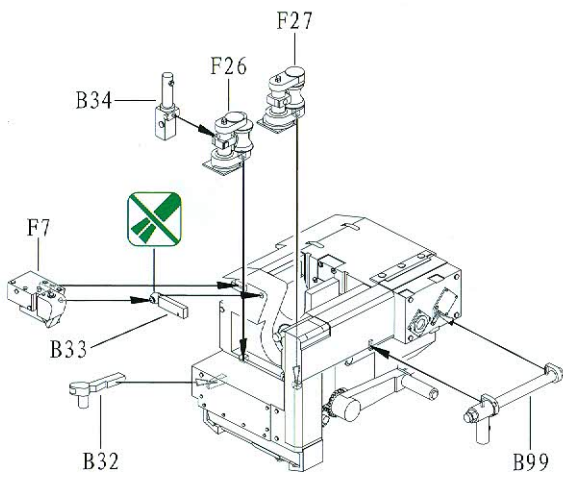
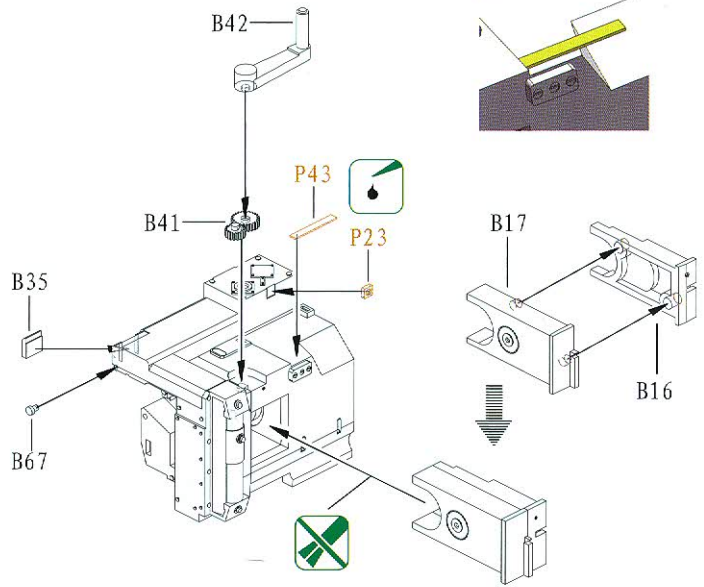
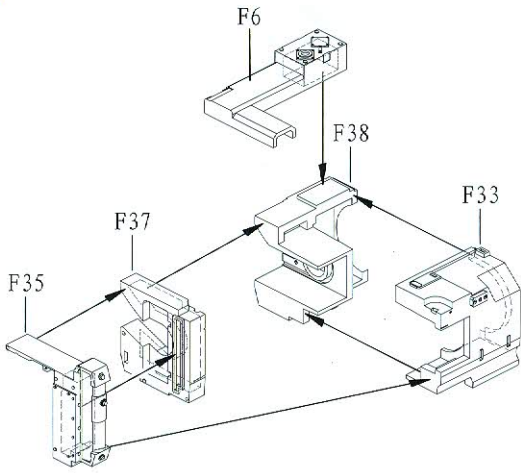

10

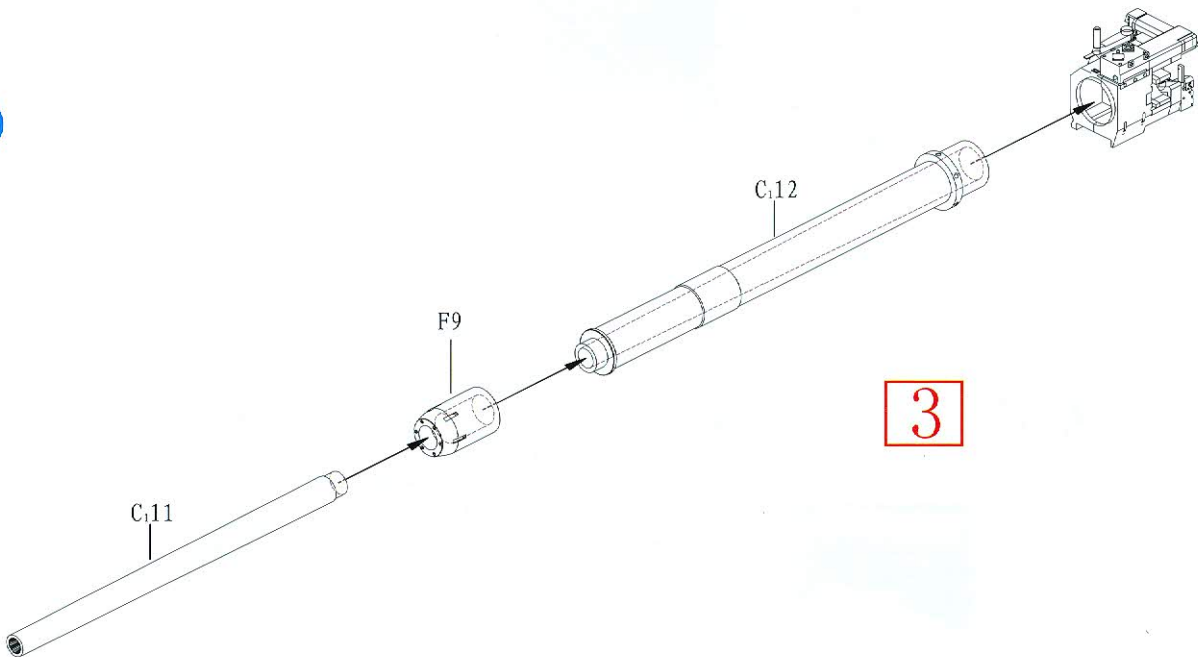
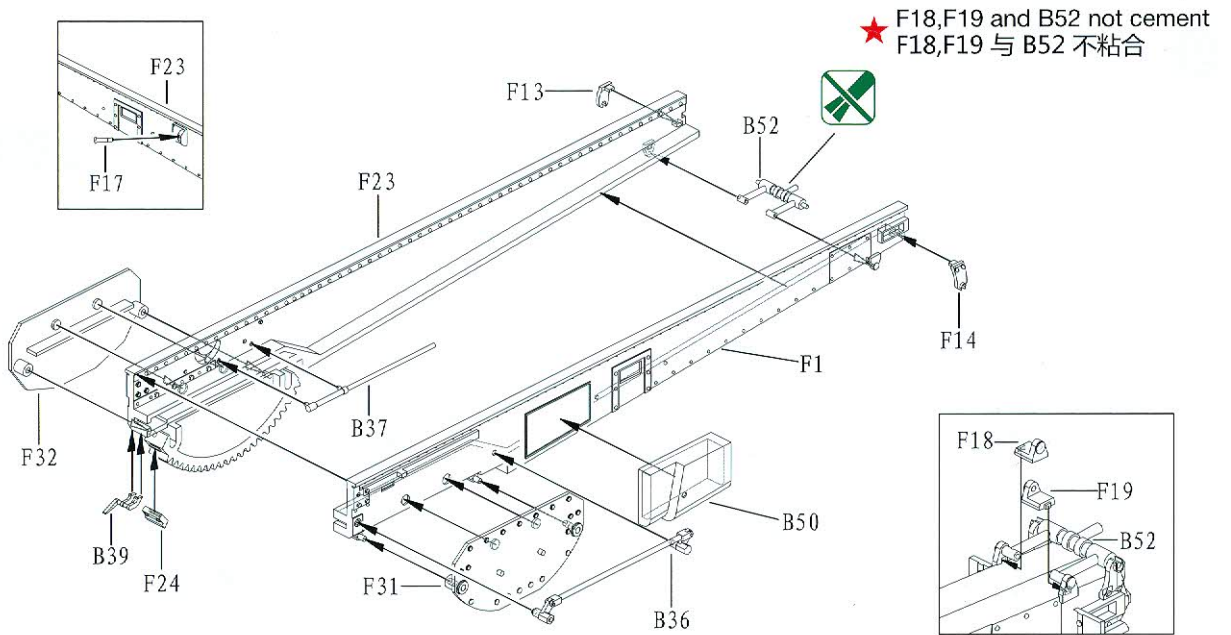

ILLUSTRATION 图示说明:

11



12

★ F10, F11, **3** and F1, F23 not cement
F10, F11, **3** 与 F1, F23 不粘合

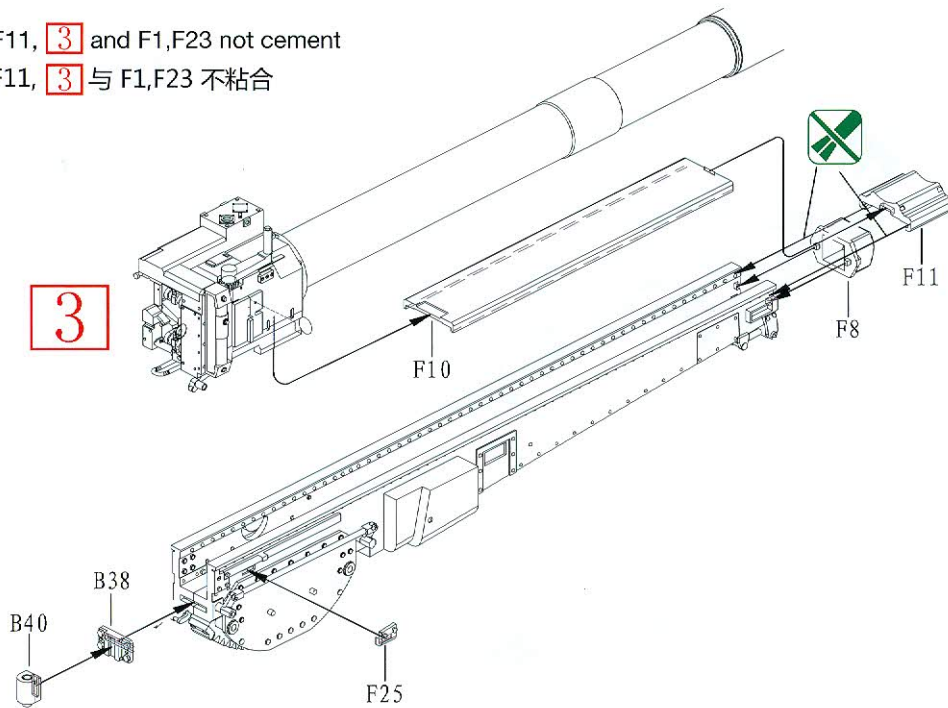

13

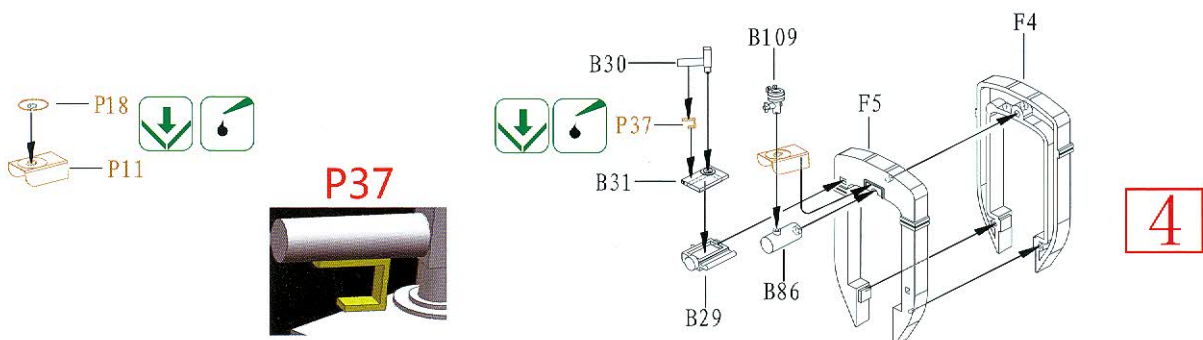

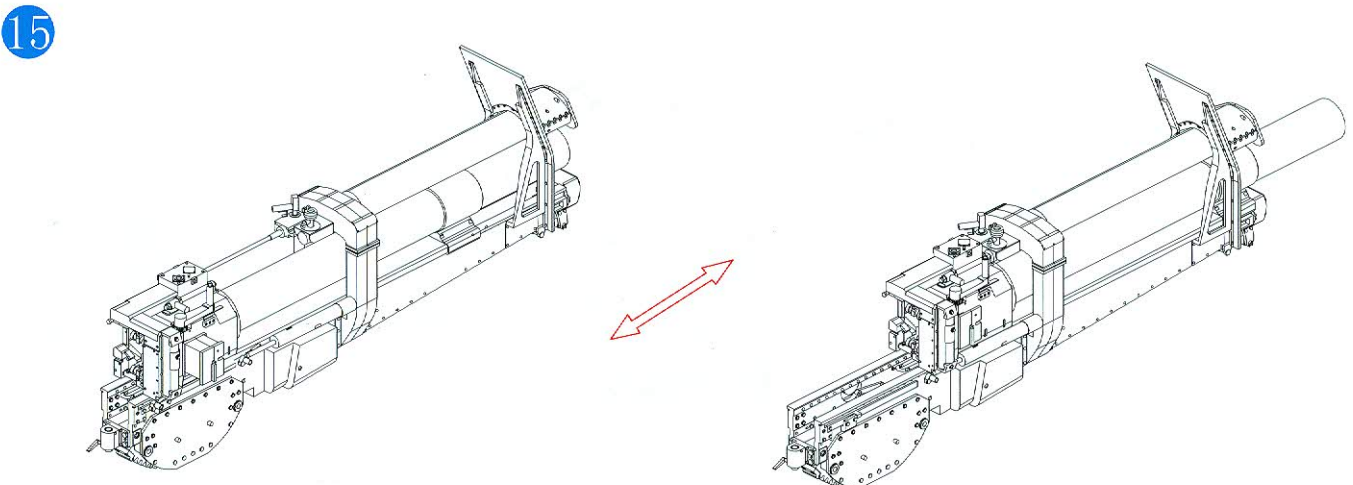
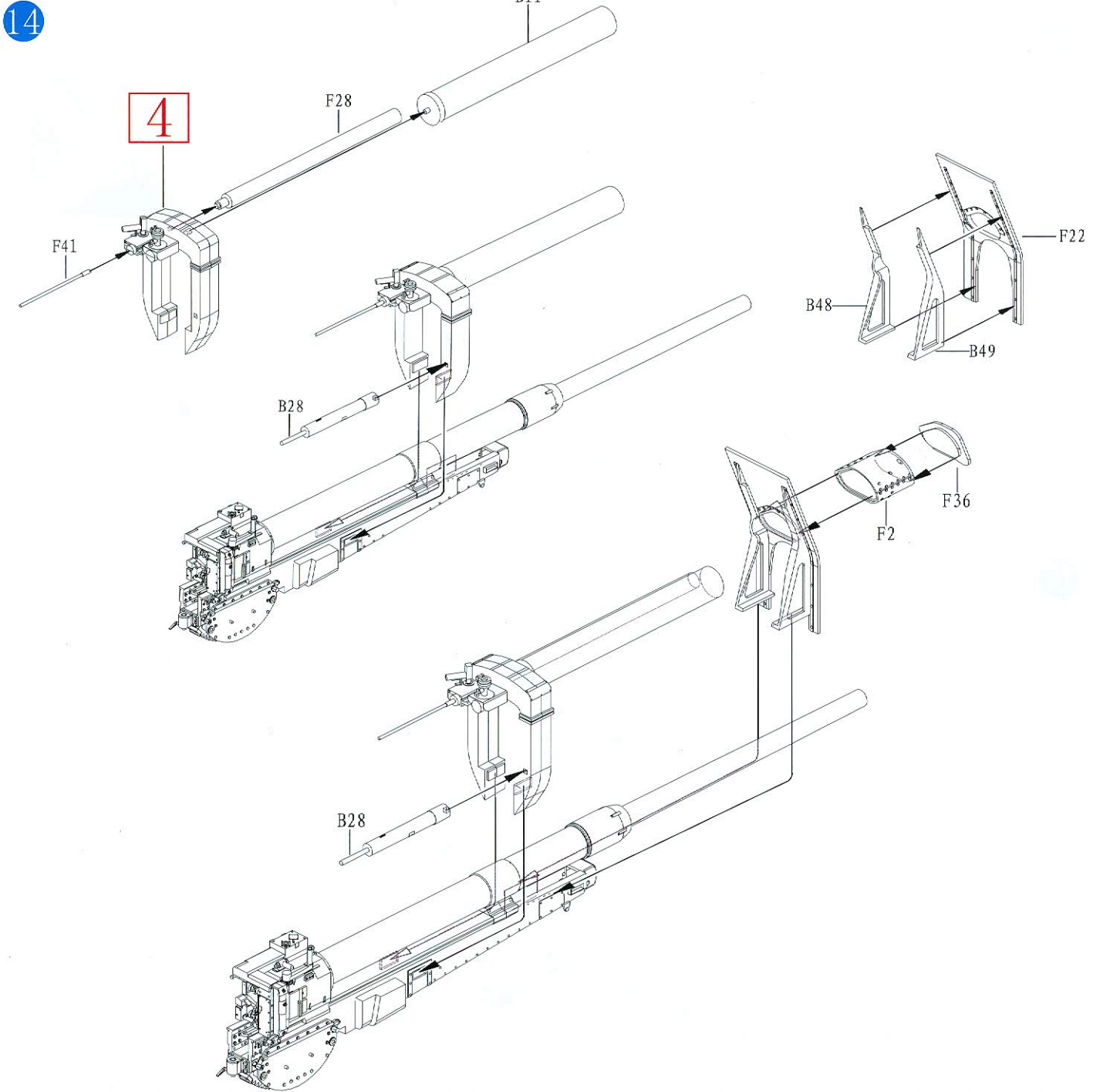

16

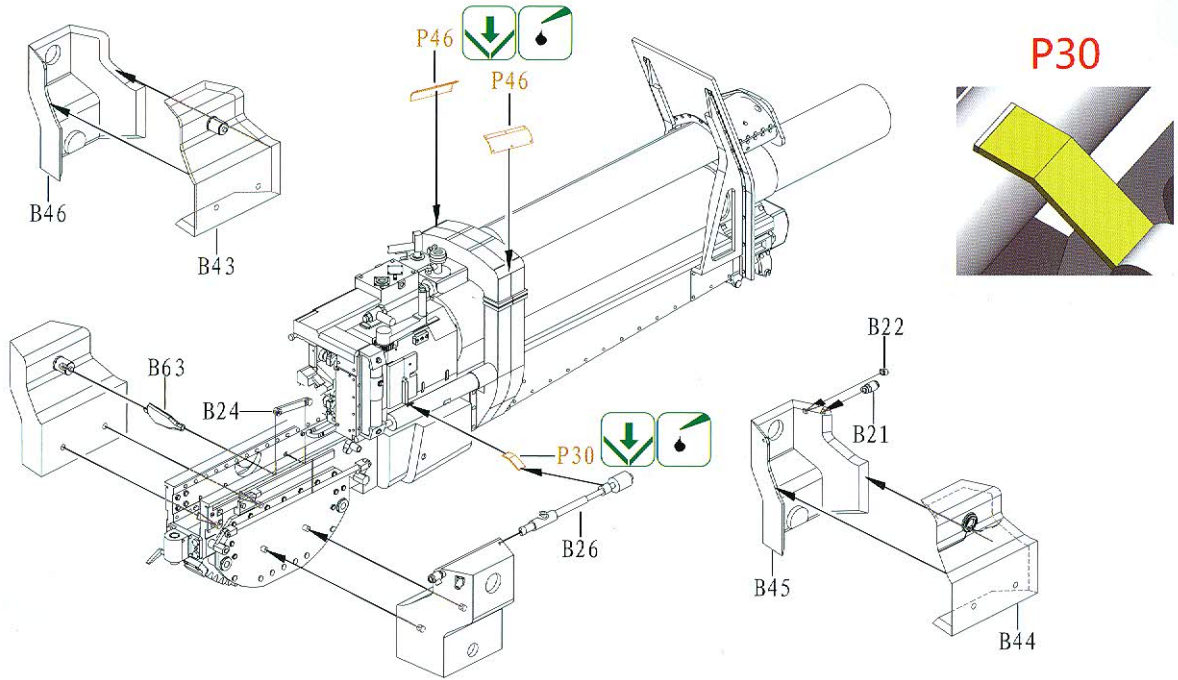

17

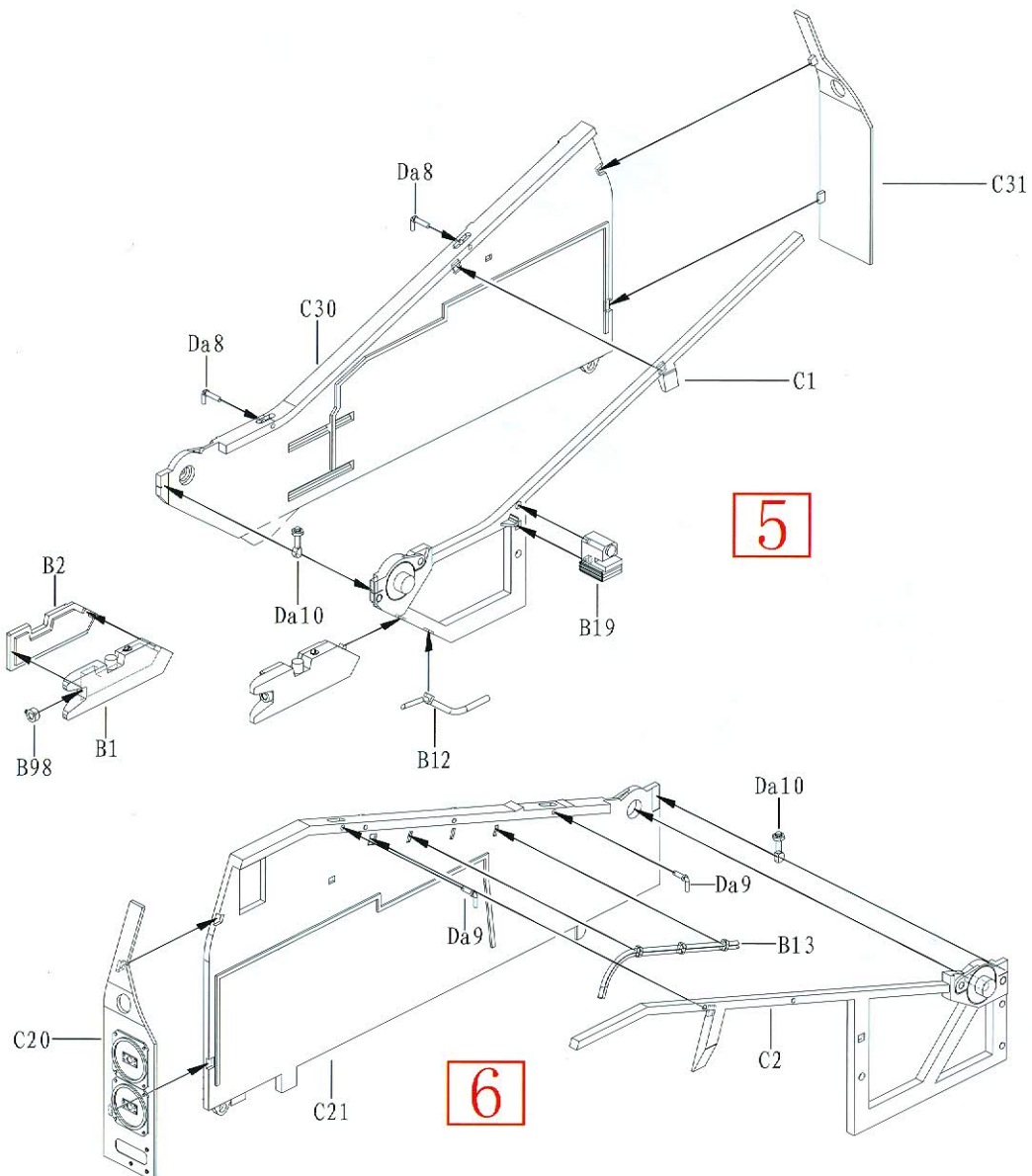

18

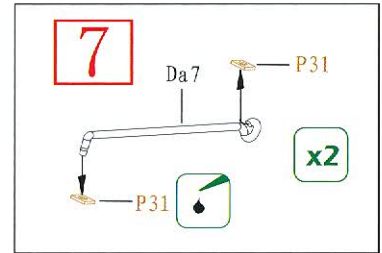
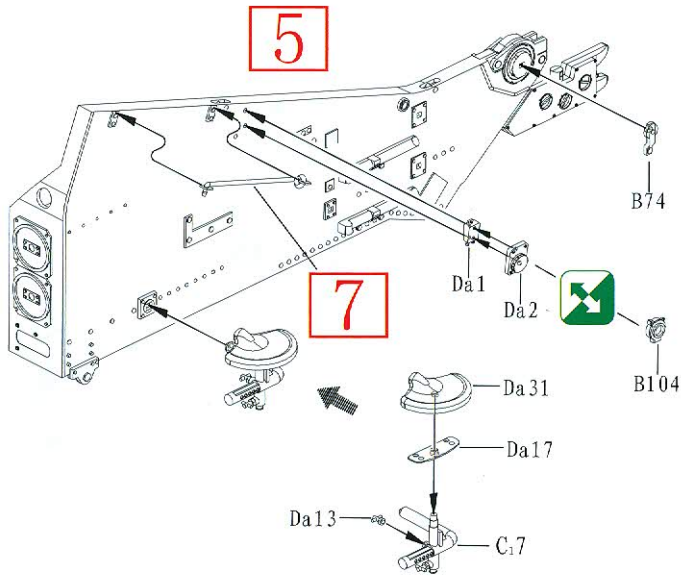

19

★ B105, B103 and C17 not cement
B105, B103 与 C17 不粘合

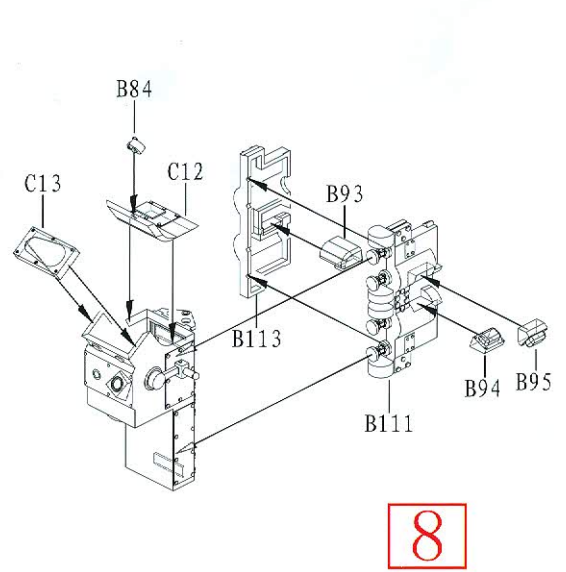
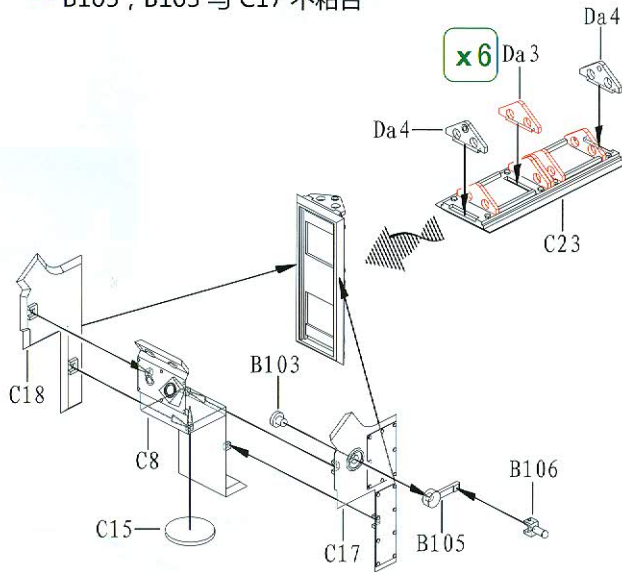

20

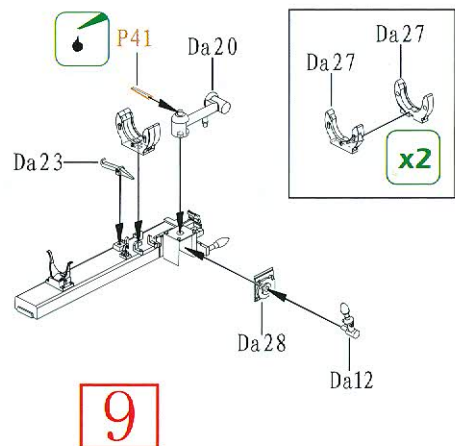
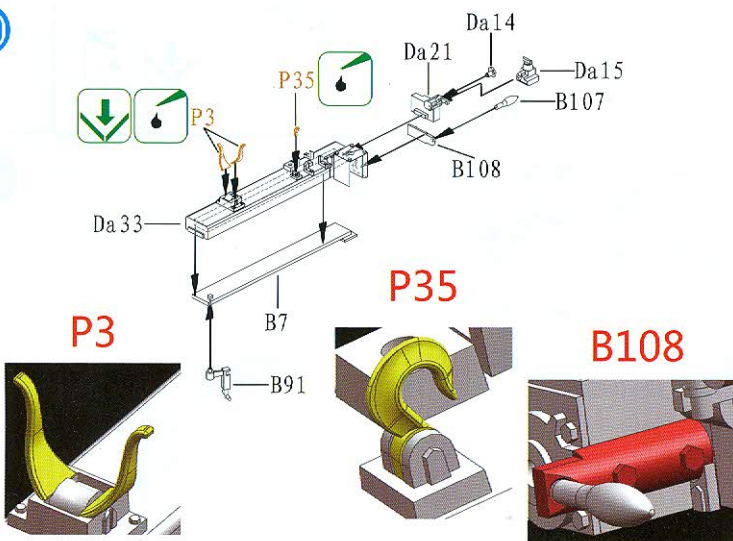
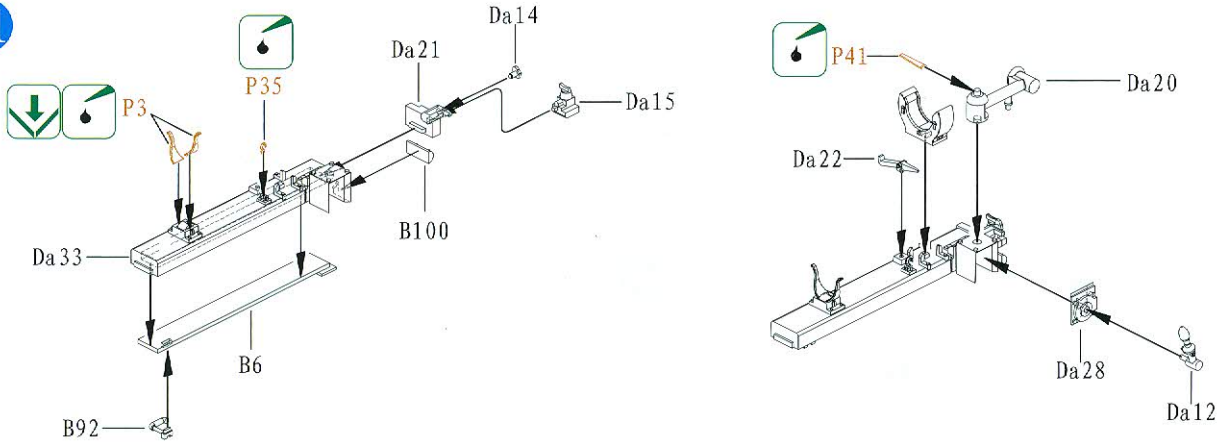
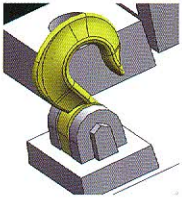

ILLUSTRATION 图示说明:

21



P35



9

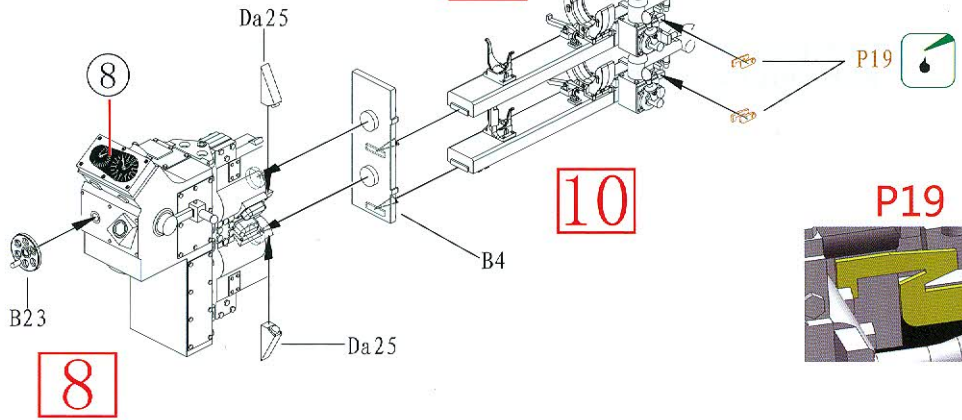

8

P19

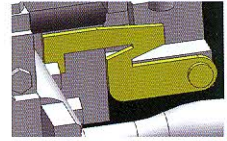

22

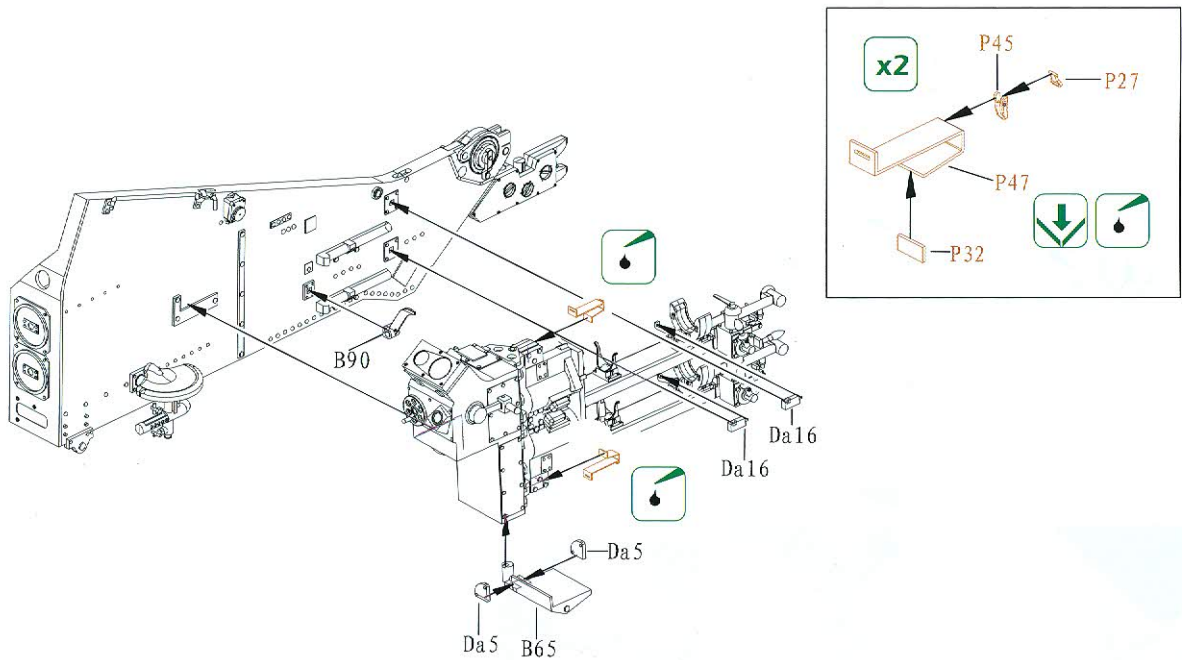

23

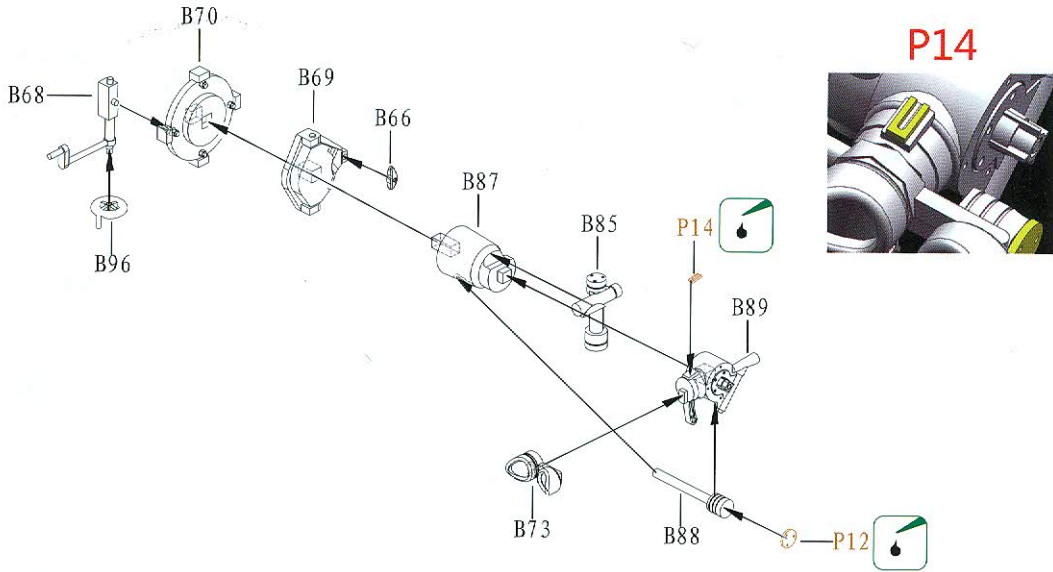

24

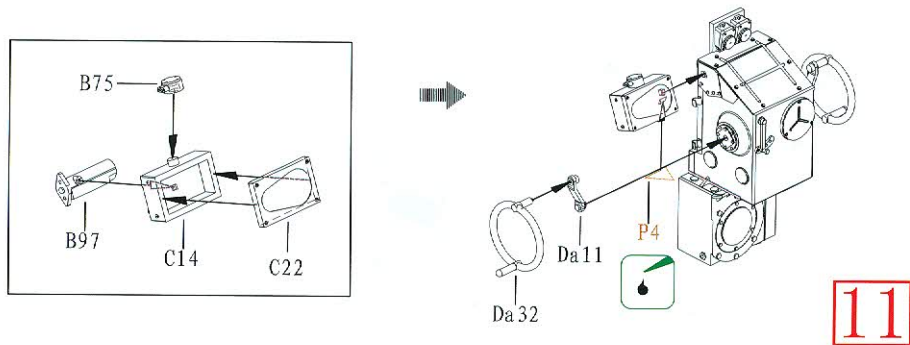
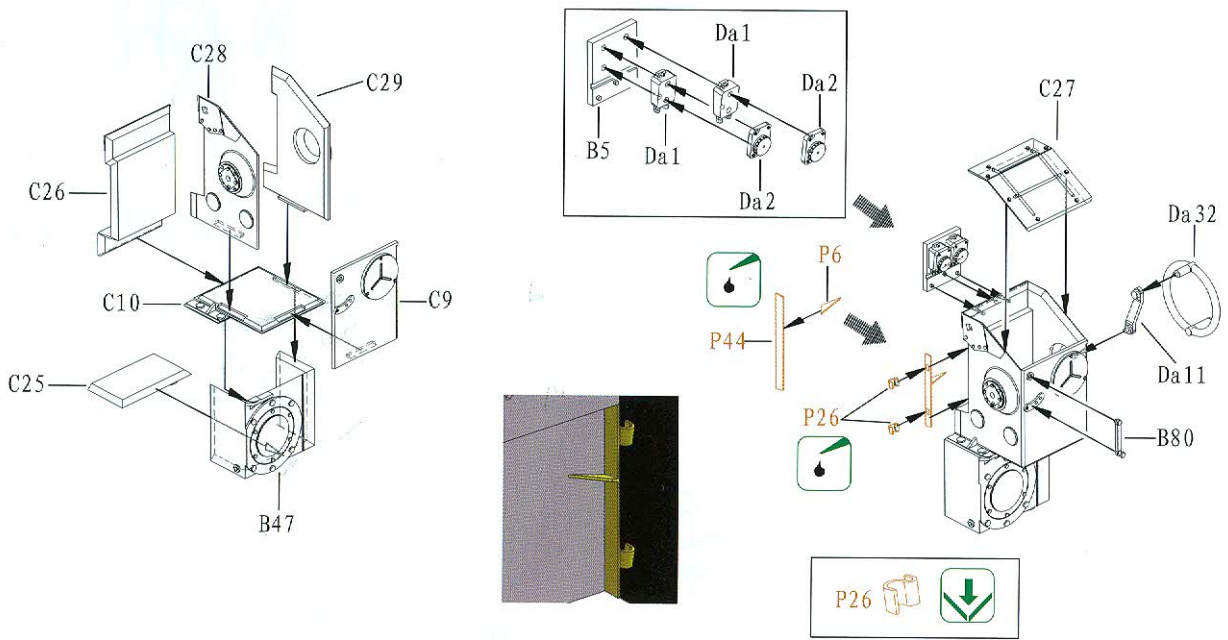
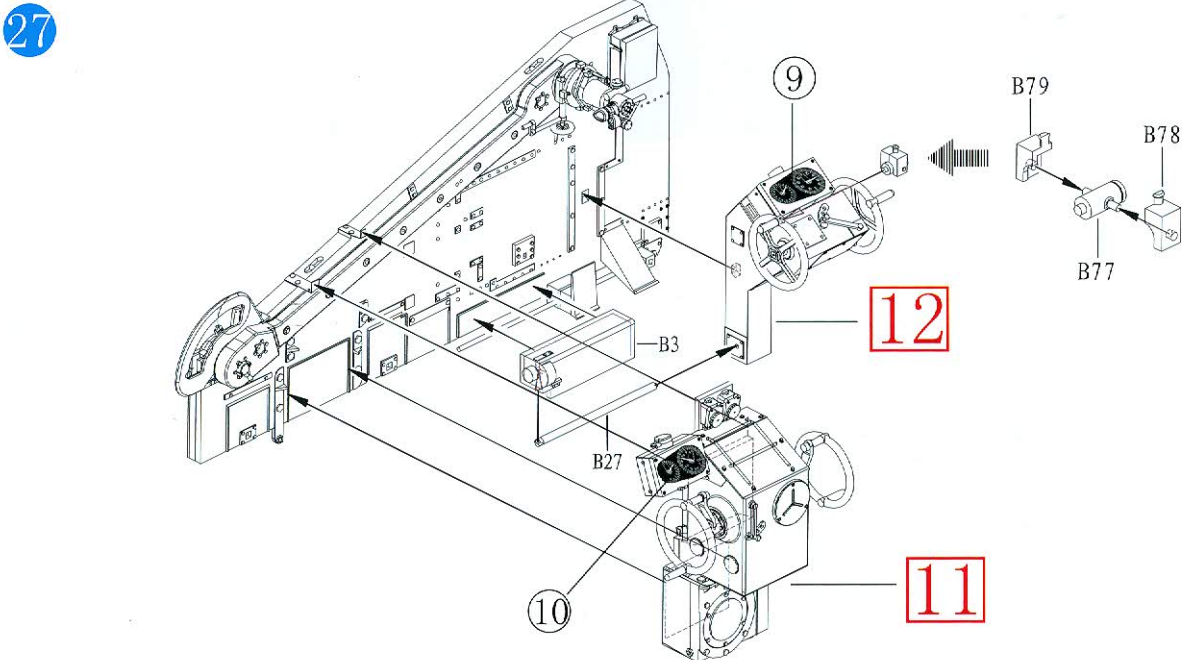
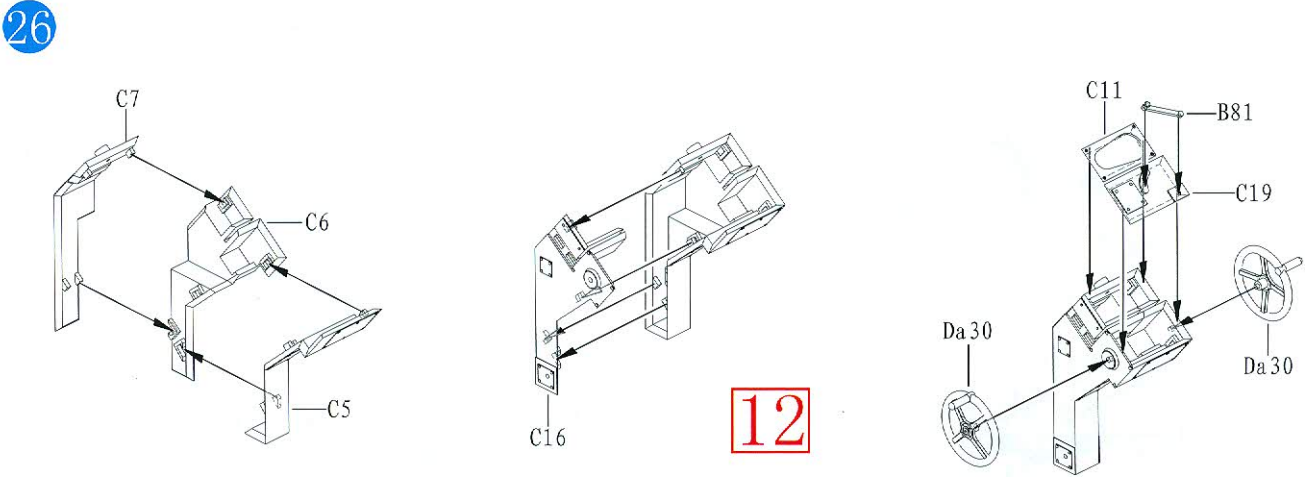
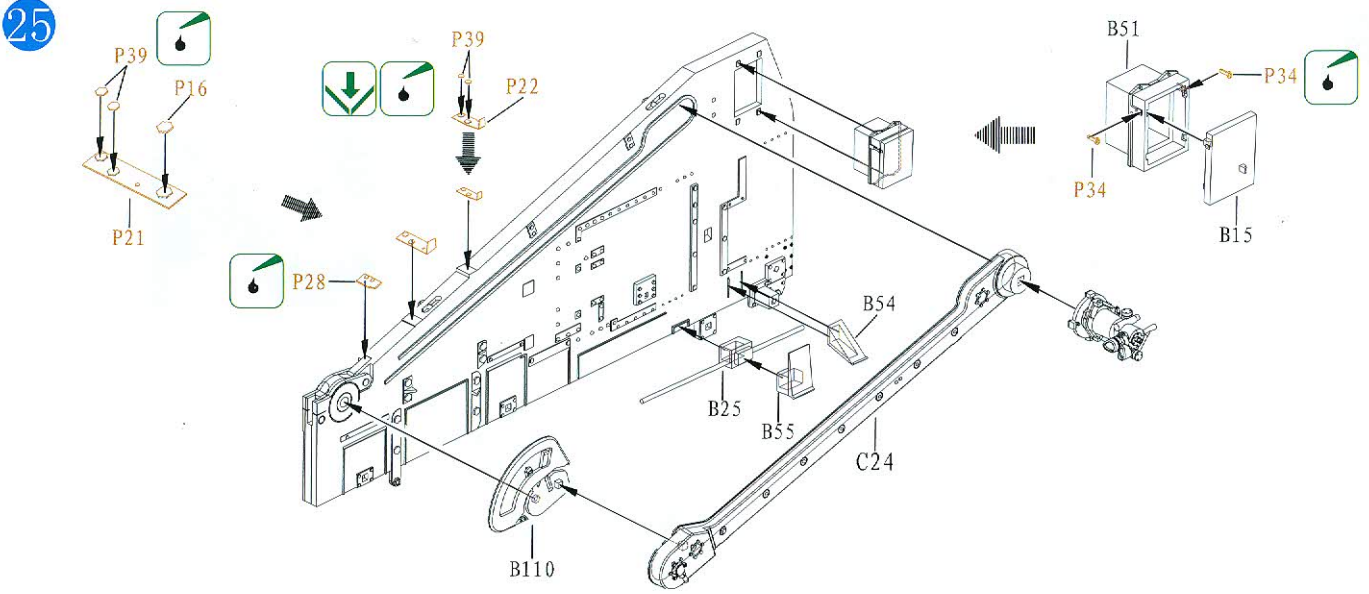
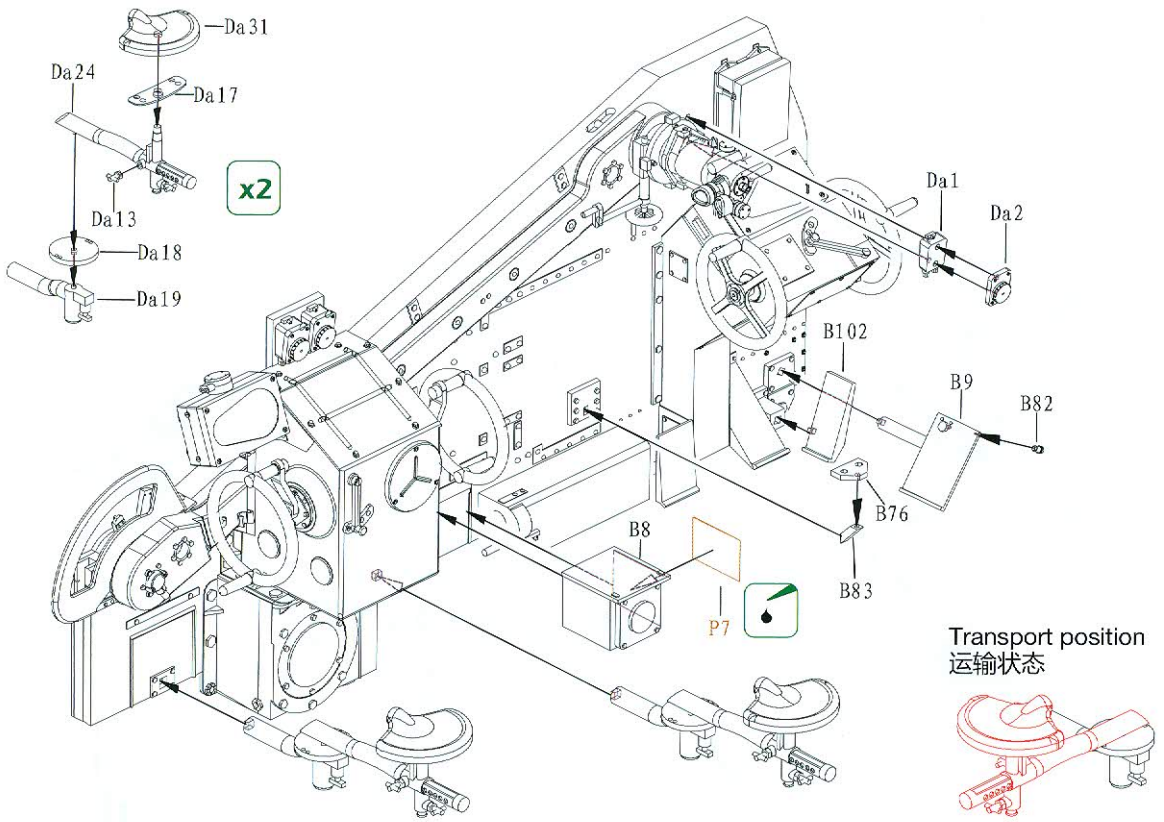

ILLUSTRATION 图示说明:



28



29

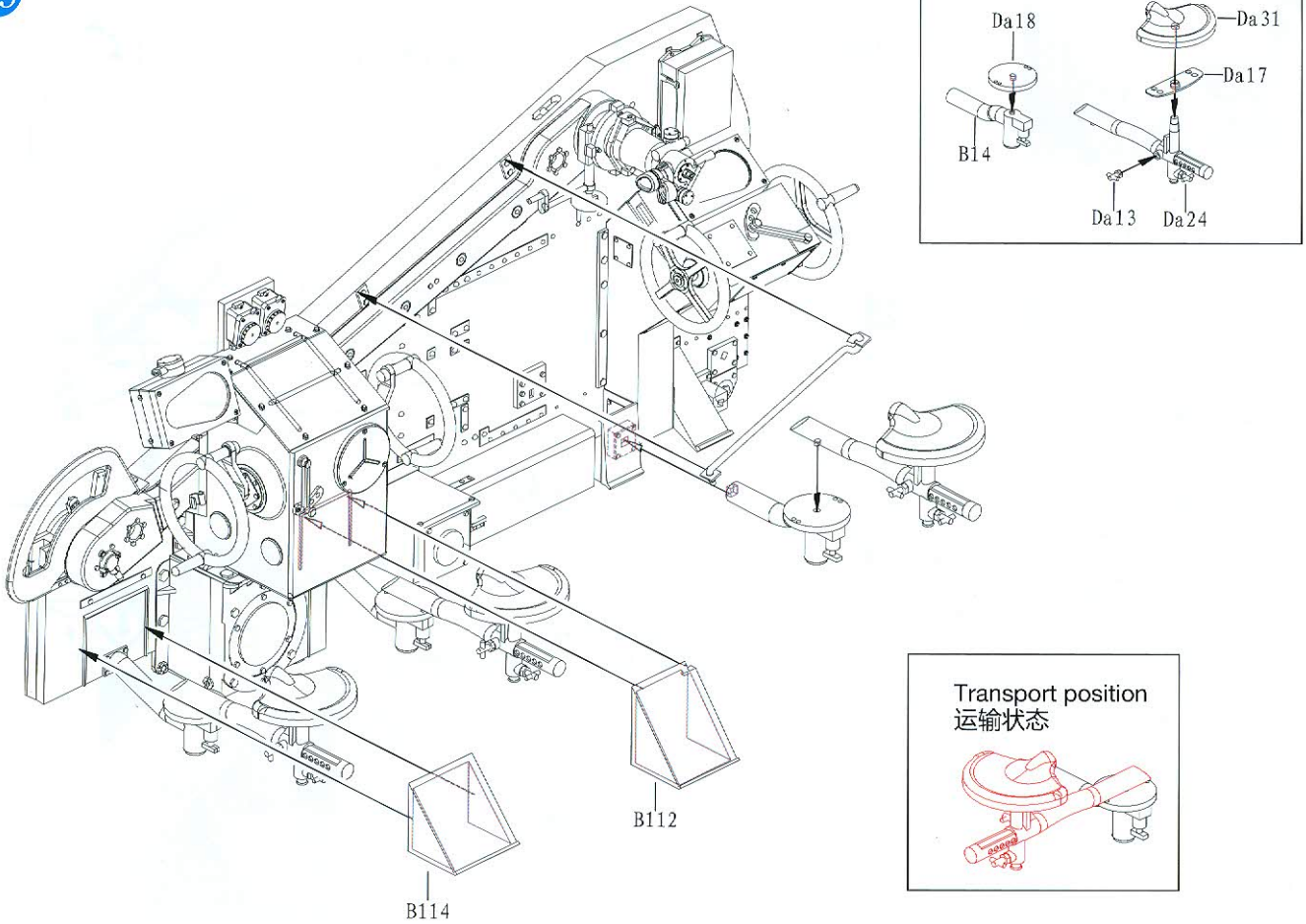

30

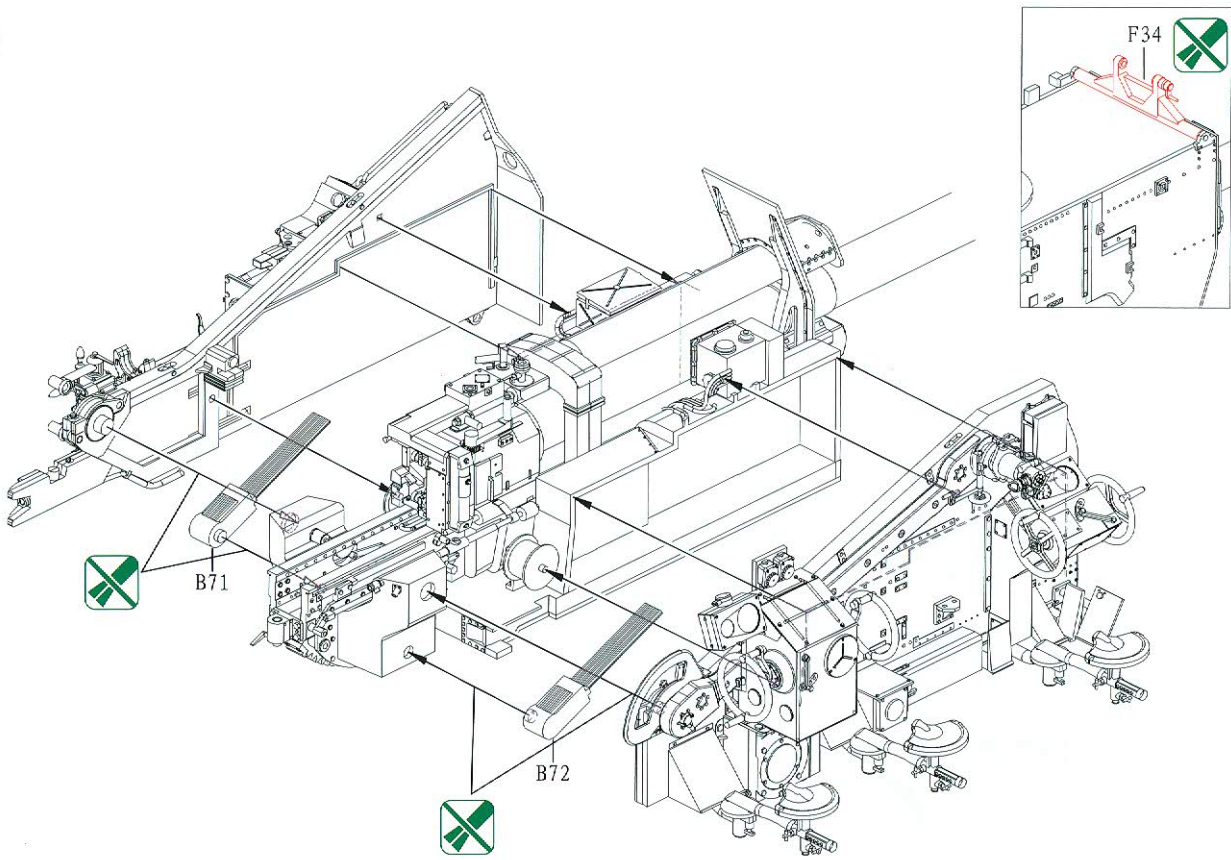

31

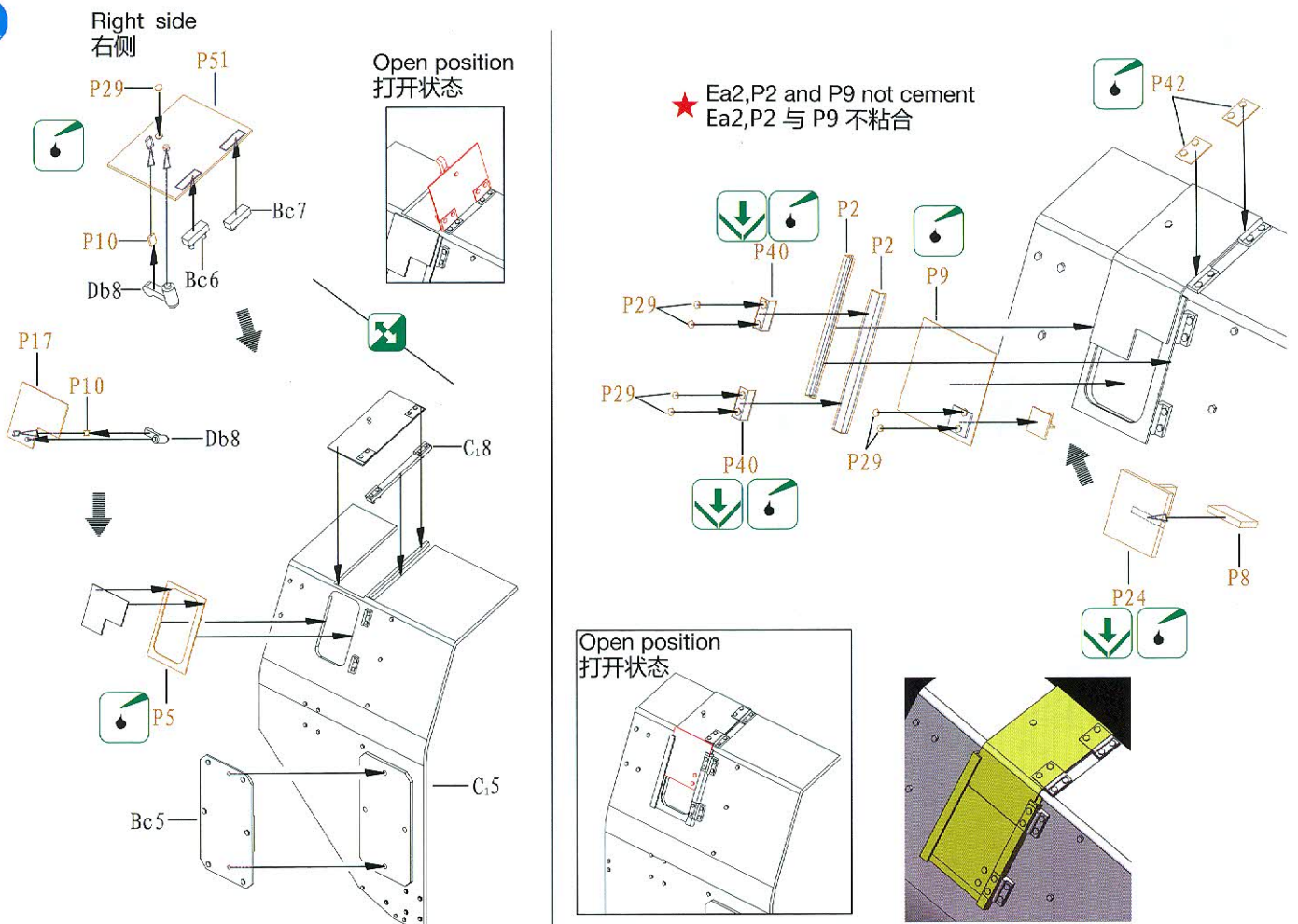

32

Transport position
运输状态

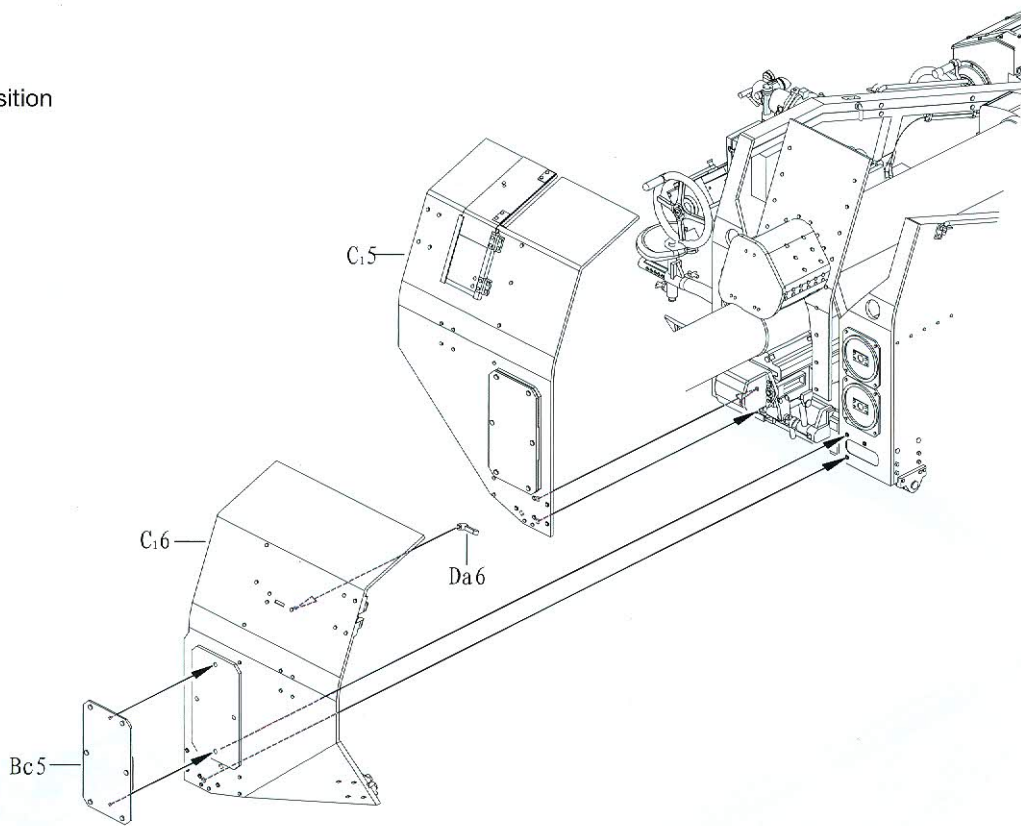

Combat position
战斗状态

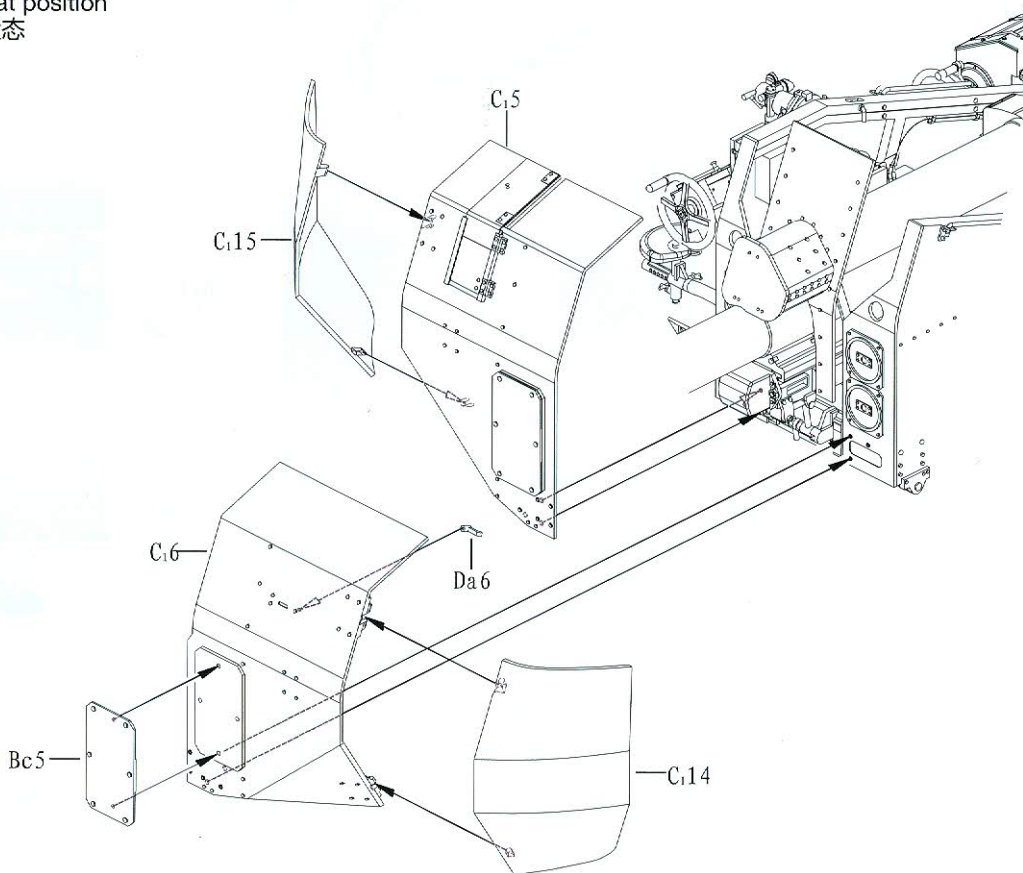

33

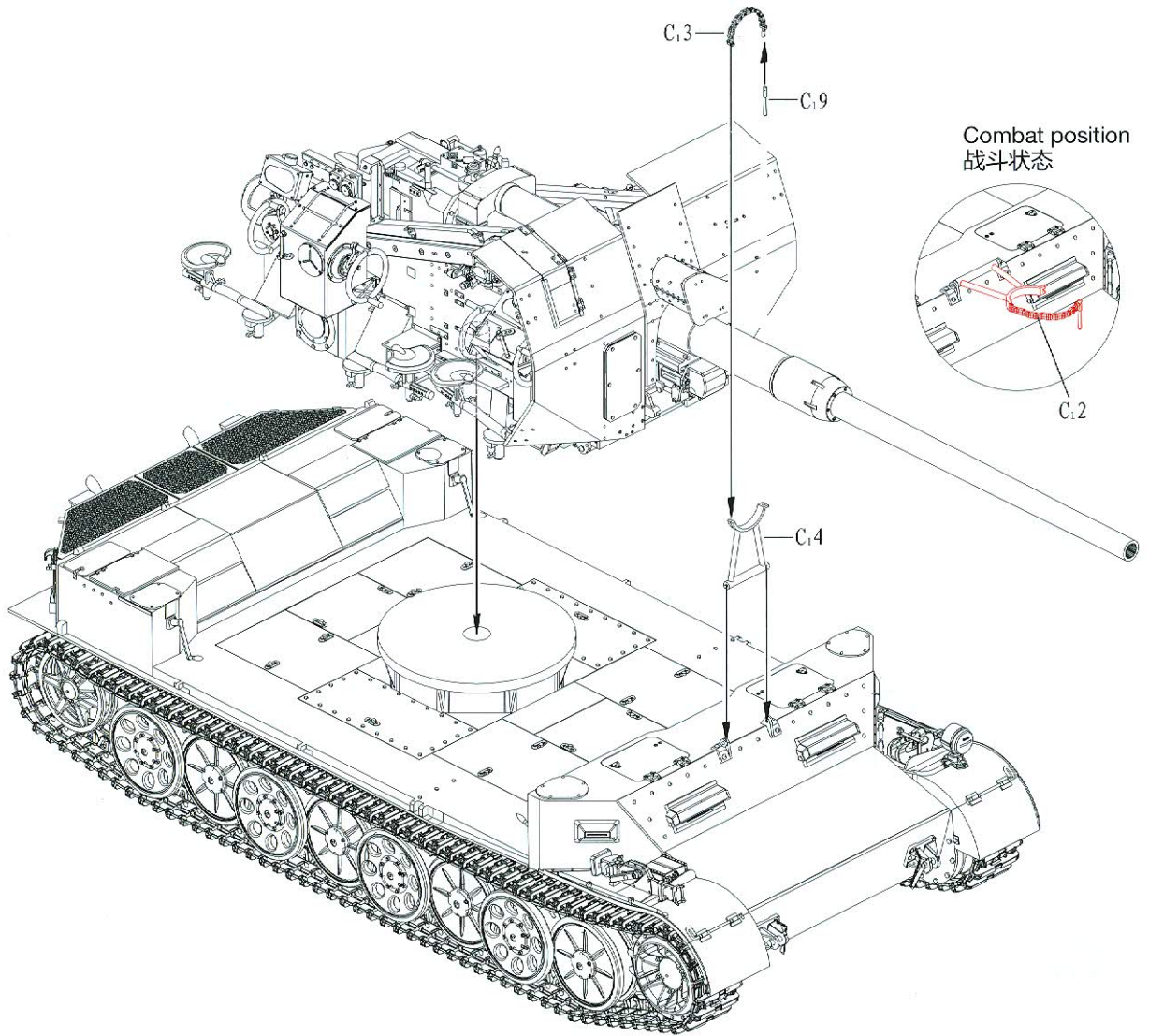

34

Left side
左侧

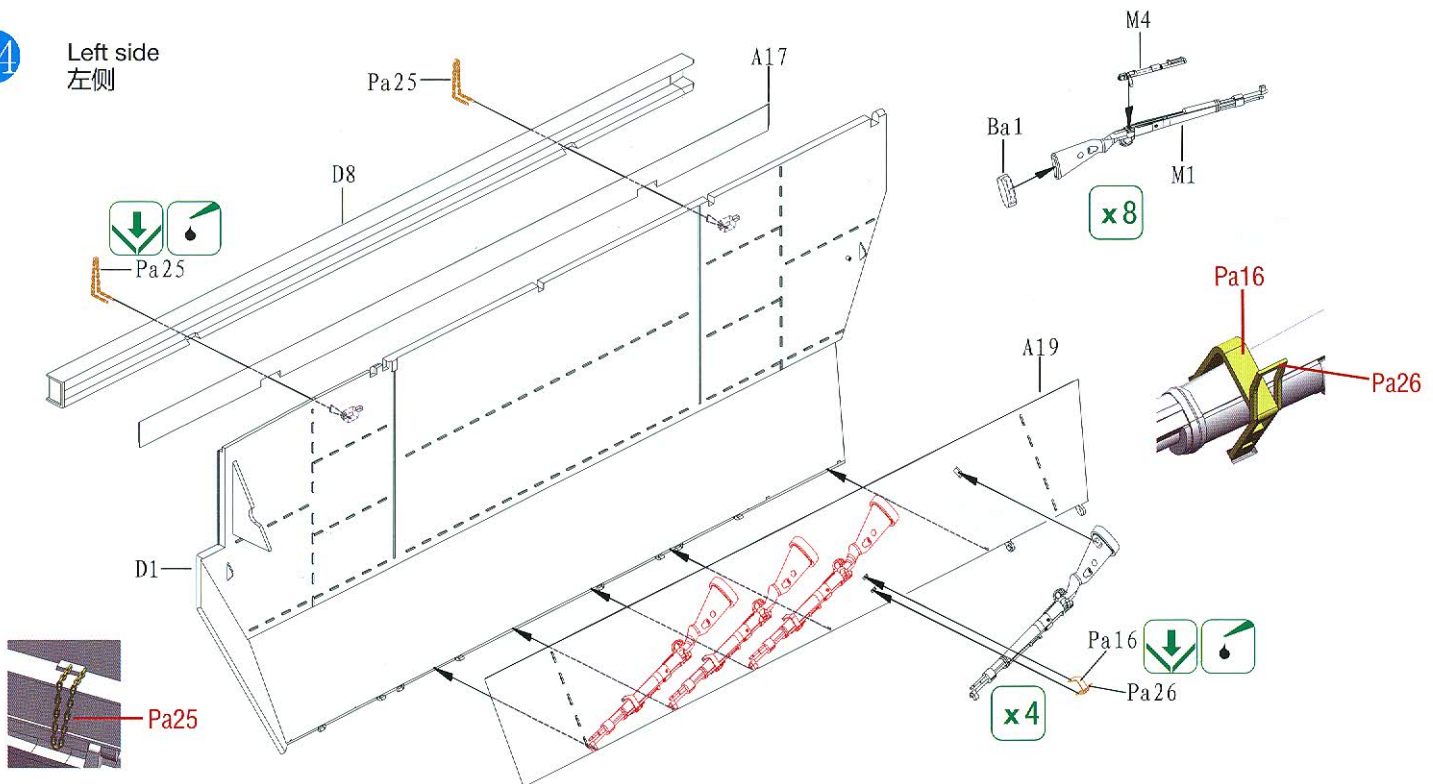

35

Right side
右侧

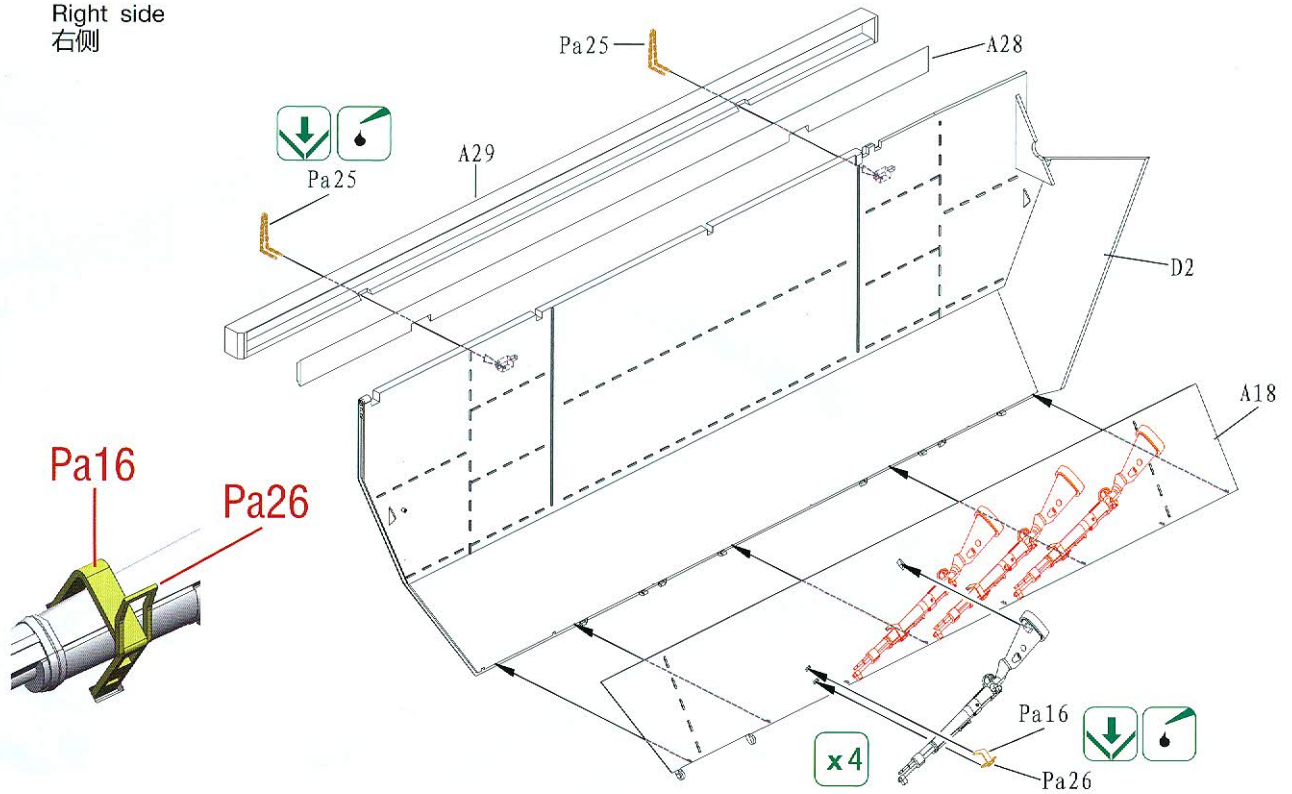

36

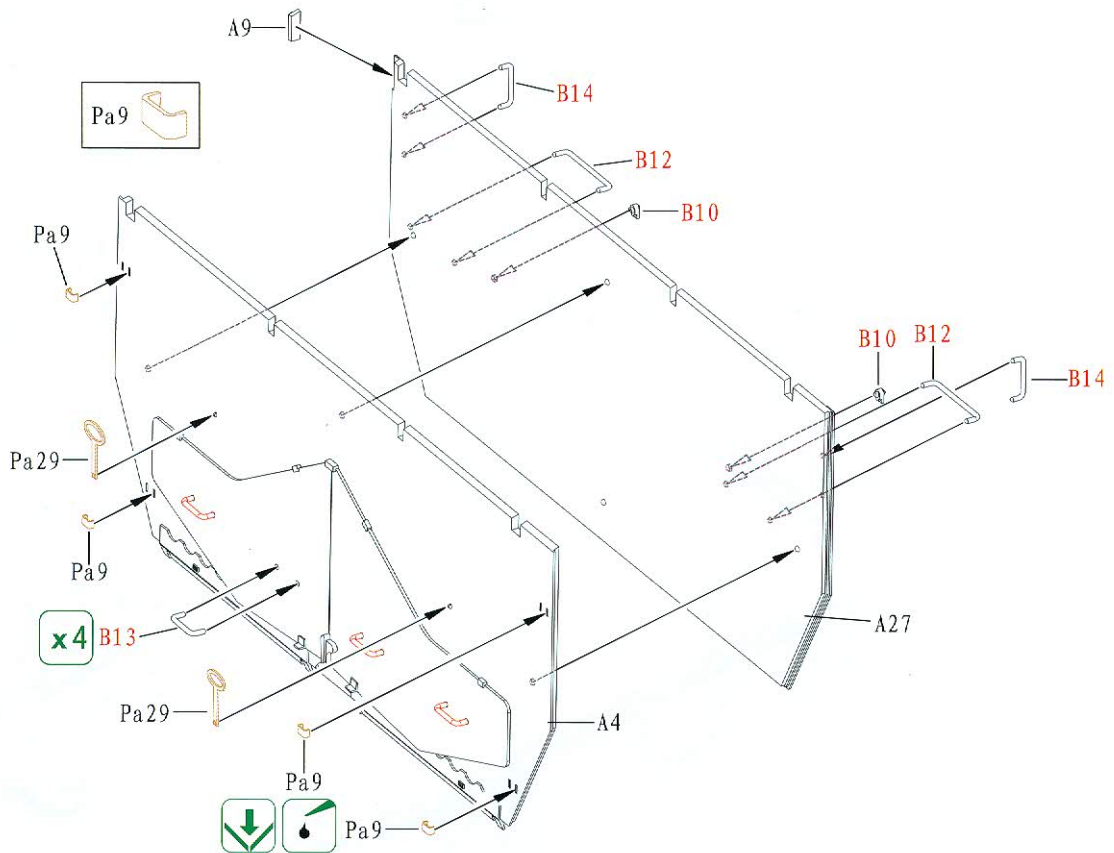

37

Close position
关闭状态

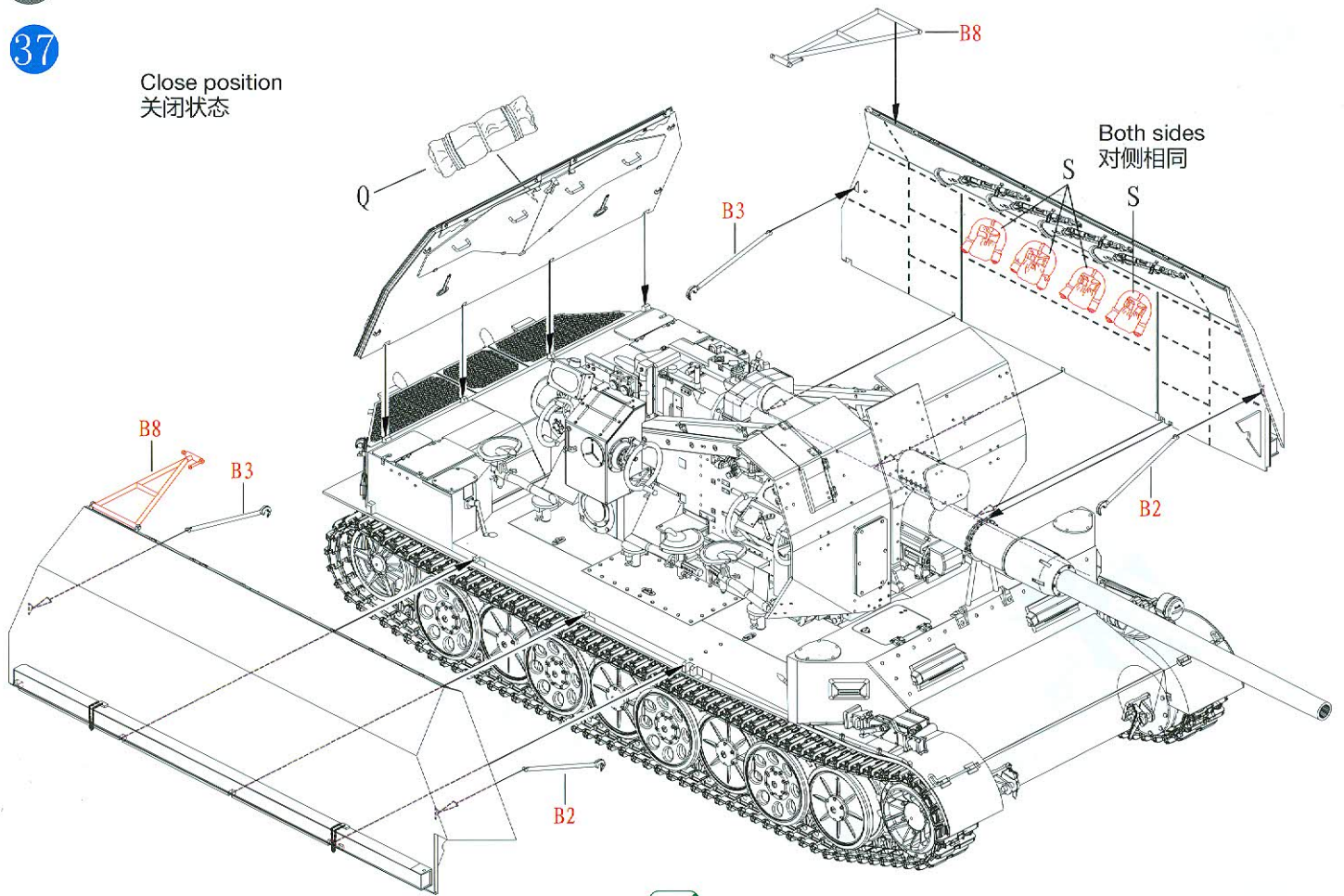

Open position
打开状态

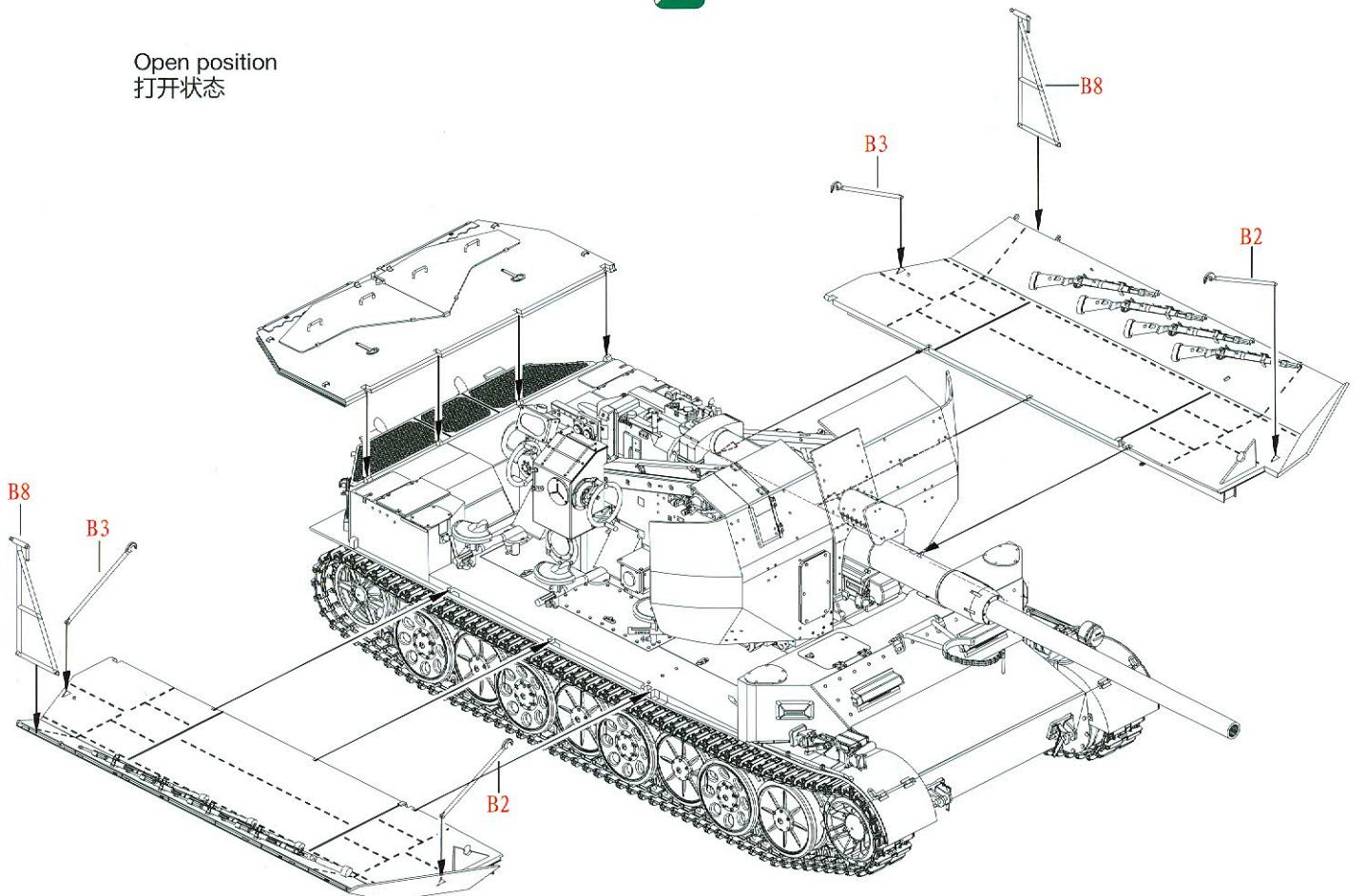

38

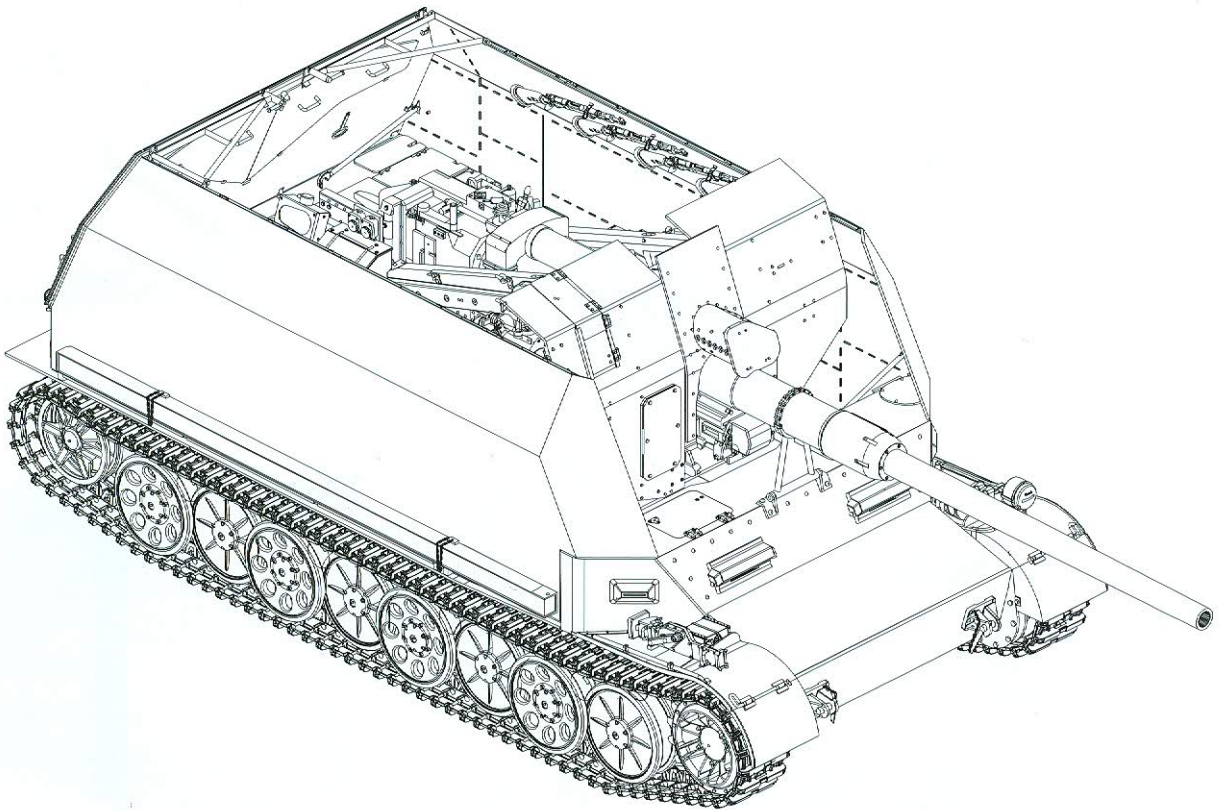

39

★ Assembly for German R36 Range Finder & Container
德军R36测距仪及储存箱的组装方法

German gray or Dark yellow
德国灰或深黄色

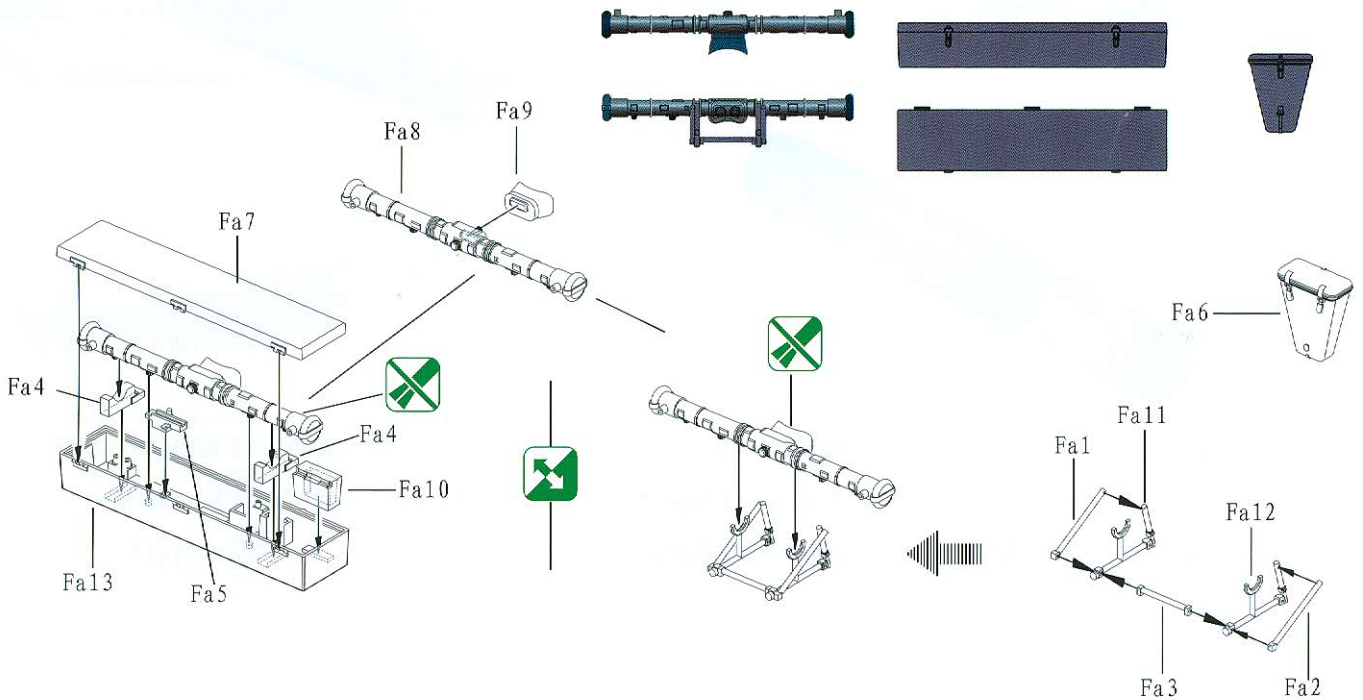

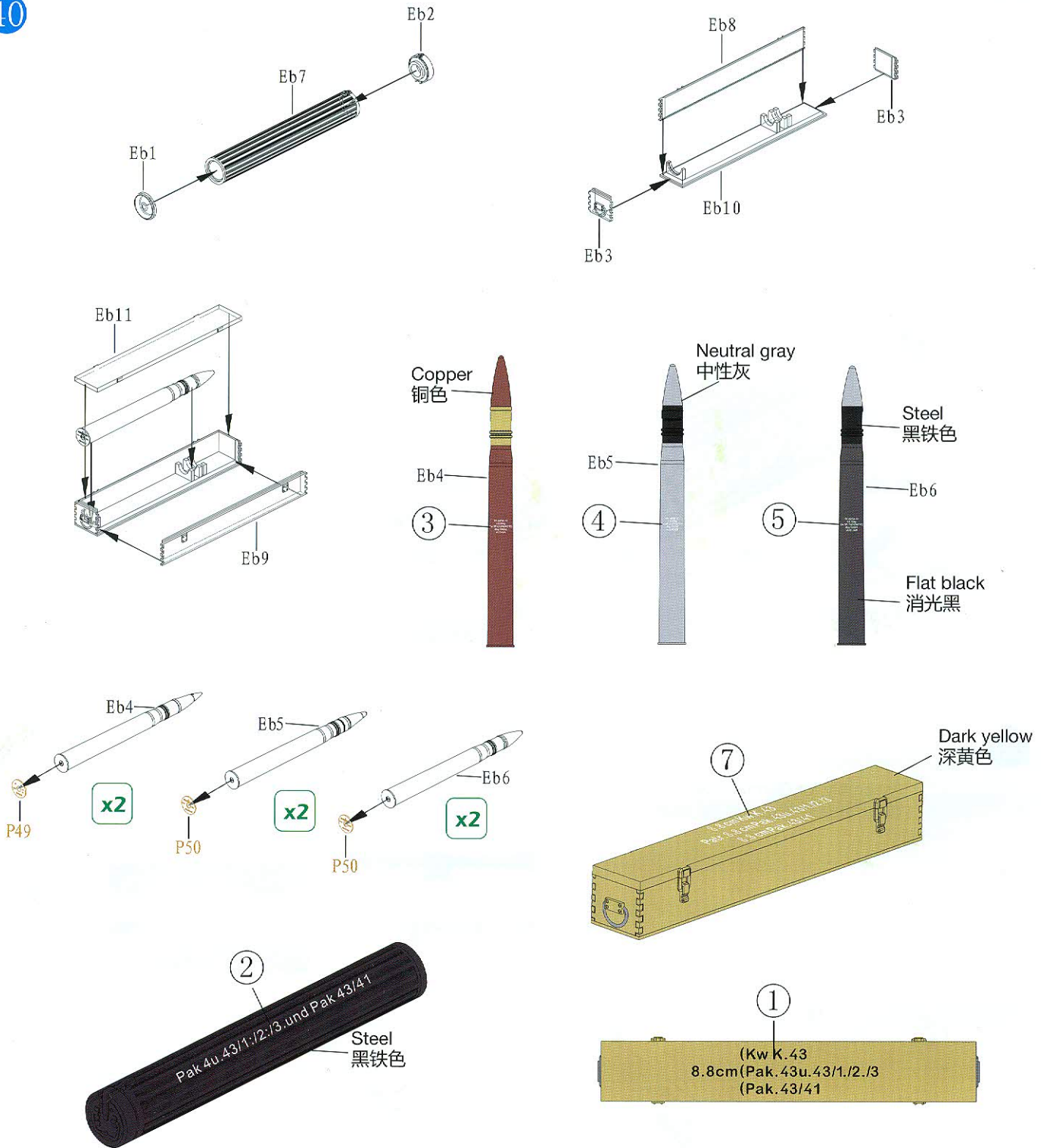

★ This is a precision molded plastic kit with exceptionally fine detail. It will require a little more care during assembly, but you feel the end result is well worth the effort.
 本套件设计精密,零件繁多可能让你在制作过程中有所不便,但完成后会让你产生无穷之成功快感。

Happy modelling!
 祝愿制作愉快!

DECAL & COLOUR GUIDE 水贴及涂色指示:

Option 1: 8.8cm Flak 41 auf Sonderfahrzeug (Pz.Sfl. IVc) in trial at Oxbol, Denmark, Summer 1944.
 1944年夏天在丹麦测试的8.8cm 41型实验防空自走炮。

