

**Fairey Gannet ASW & ECM Variants  
Undercarriage Wells**

This Detail set is manufactured from photo - etched brass sheet and is for the Revell / Frog Novo model kit.  
Etched brass should be thoroughly cleaned by gently wiping with a solvent such as White Spirit and primed for painting.  
To separate parts, support fret on a firm surface, (i.e., a small sheet of glass or a plain ceramic tile) and cut as near to the part as possible using a sharp blade.

To fold part use Airwaves Folding Tool AM022 for a good and even fold.  
For fixing parts, use Cyanoacrylate Adhesive (Superglue) or Epoxy resin.

Manufactured for and by:-  
**E.D. Models, 64 Stratford Road, Shirley,  
Solithull, B90 3LP, England.**  
Telephone (44)- 0121-744-7488 Fax (44)- 0121-733-2591

For further helpful hints to using etched brass and for full details of the extensive Airwaves range, get a copy of the latest Airwaves catalogue.

**General Notes**

1. Replace the arrester hook (Kit part 4) with the new white metal item.
2. The nose gear doors require a curvature to follow the contour of the fuselage. This can be done by rolling the door around a metal cylinder such as a knife handle.
3. The interior colour of the bays is usually Sky or White with the Undercarriage legs being natural aluminium alloy.

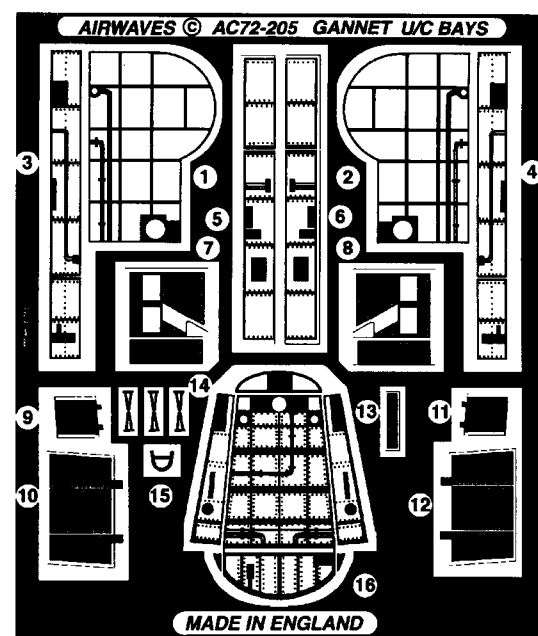
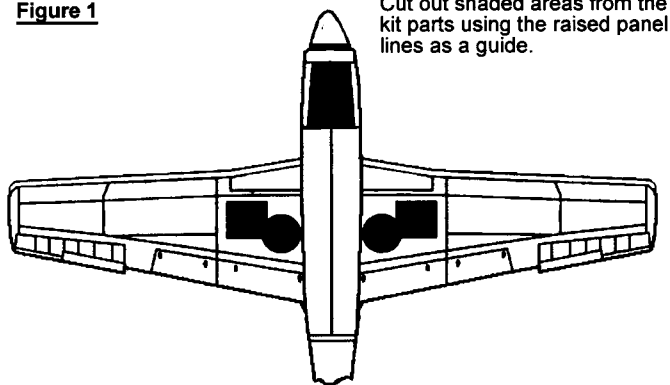
**Figure 1**

Cut out shaded areas from the kit parts using the raised panel lines as a guide.

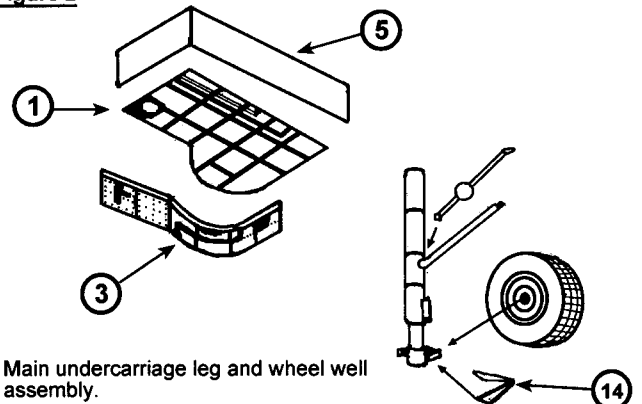
**Figure 2**

Main undercarriage leg and wheel well assembly.

**Figure 3**

Fold down sides and ends of etched part 16 to form the nose undercarriage well.

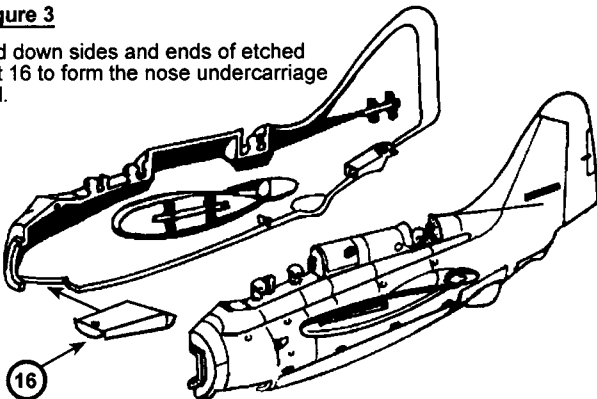
**Figure 4**

Remove locating lugs from undersides of upper wings before assembling.

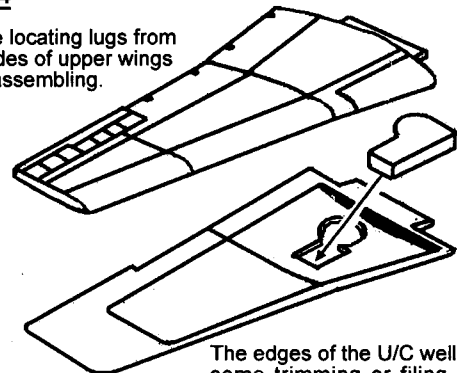

The edges of the U/C well may require some trimming or filing to ensure a snug fit.

**Figure 5**

Ensure that the nose leg stays are positioned to fit into small locating holes in well floor.

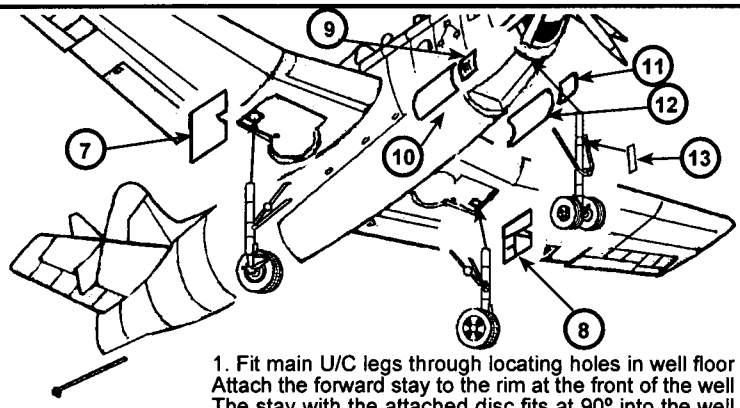
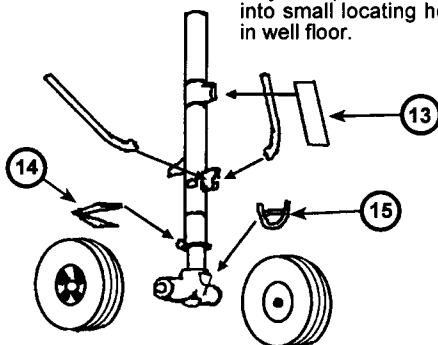
**Figure 6**

1. Fit main U/C legs through locating holes in well floor. Attach the forward stay to the rim at the front of the well floor. The stay with the attached disc fits at 90° into the well floor.
2. The nose U/C leg fits in a similar manner