



T511601

ALASKAN HAULER

KENWORTH
CONVENTIONAL

INSTRUCTION SHEET

IMPORTANT!

READ THESE POINTS BEFORE YOU BEGIN

- 1 "TEST FIT" all parts before cementing. Trim excess plastic from parts before joining.
- 2 Cement all parts unless otherwise indicated by the instructions.
- 3 Use paint and cement made for styrene plastic only.
- 4 Paint all sub-assemblies before attaching parts.
- 5 Scrape paint away from surfaces to be cemented together.
- 6 Follow all of the numbers on the instruction sheet beginning with number one.

PARTS NOT USED

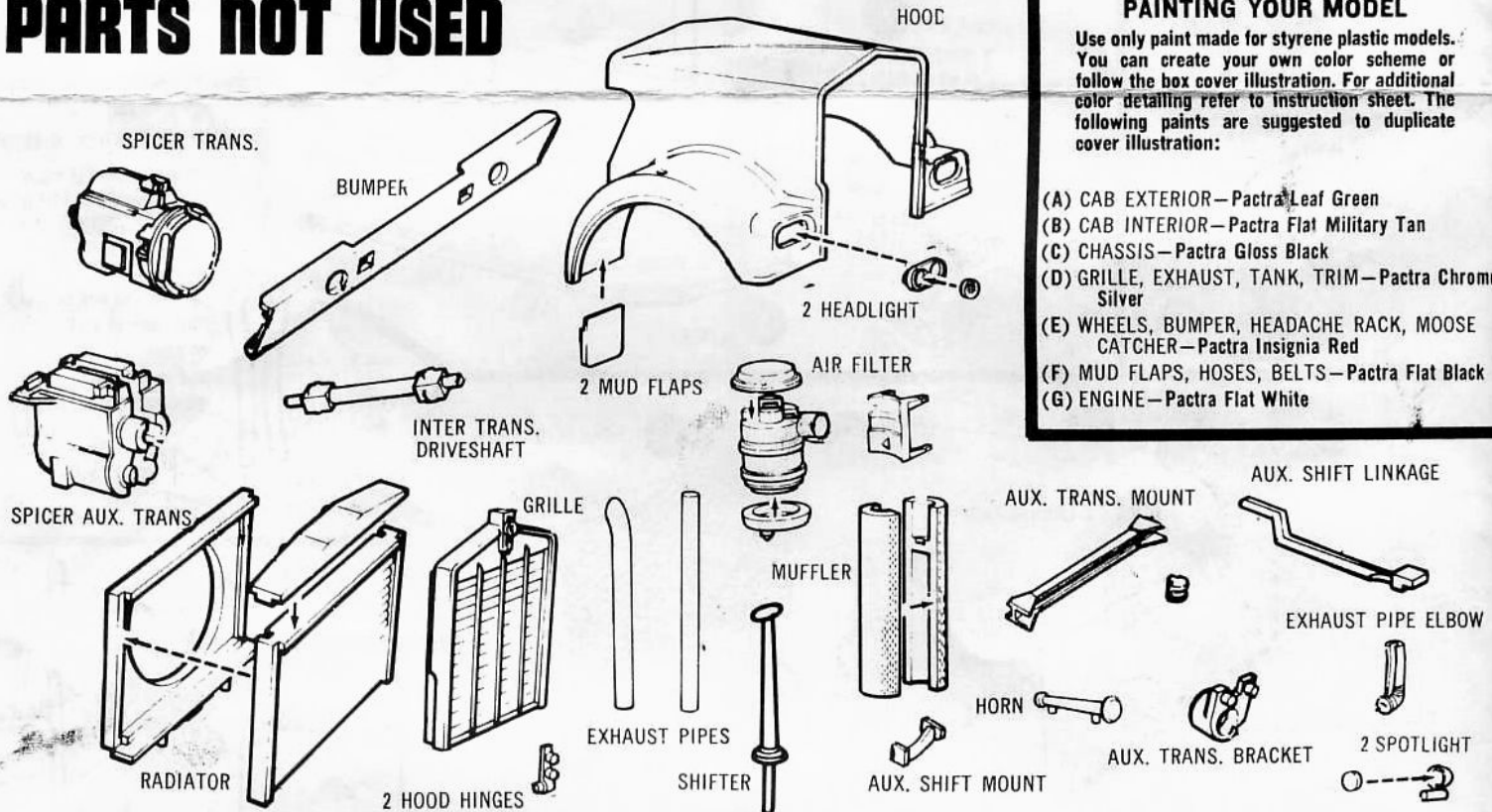

PAINTING YOUR MODEL

Use only paint made for styrene plastic models. You can create your own color scheme or follow the box cover illustration. For additional color detailing refer to instruction sheet. The following paints are suggested to duplicate cover illustration:

- (A) CAB EXTERIOR—Pactra Leaf Green
- (B) CAB INTERIOR—Pactra Flat Military Tan
- (C) CHASSIS—Pactra Gloss Black
- (D) GRILLE, EXHAUST, TANK, TRIM—Pactra Chrome Silver
- (E) WHEELS, BUMPER, HEADACHE RACK, MOOSE CATCHER—Pactra Insignia Red
- (F) MUD FLAPS, HOSES, BELTS—Pactra Flat Black
- (G) ENGINE—Pactra Flat White

ENGINE 1 31

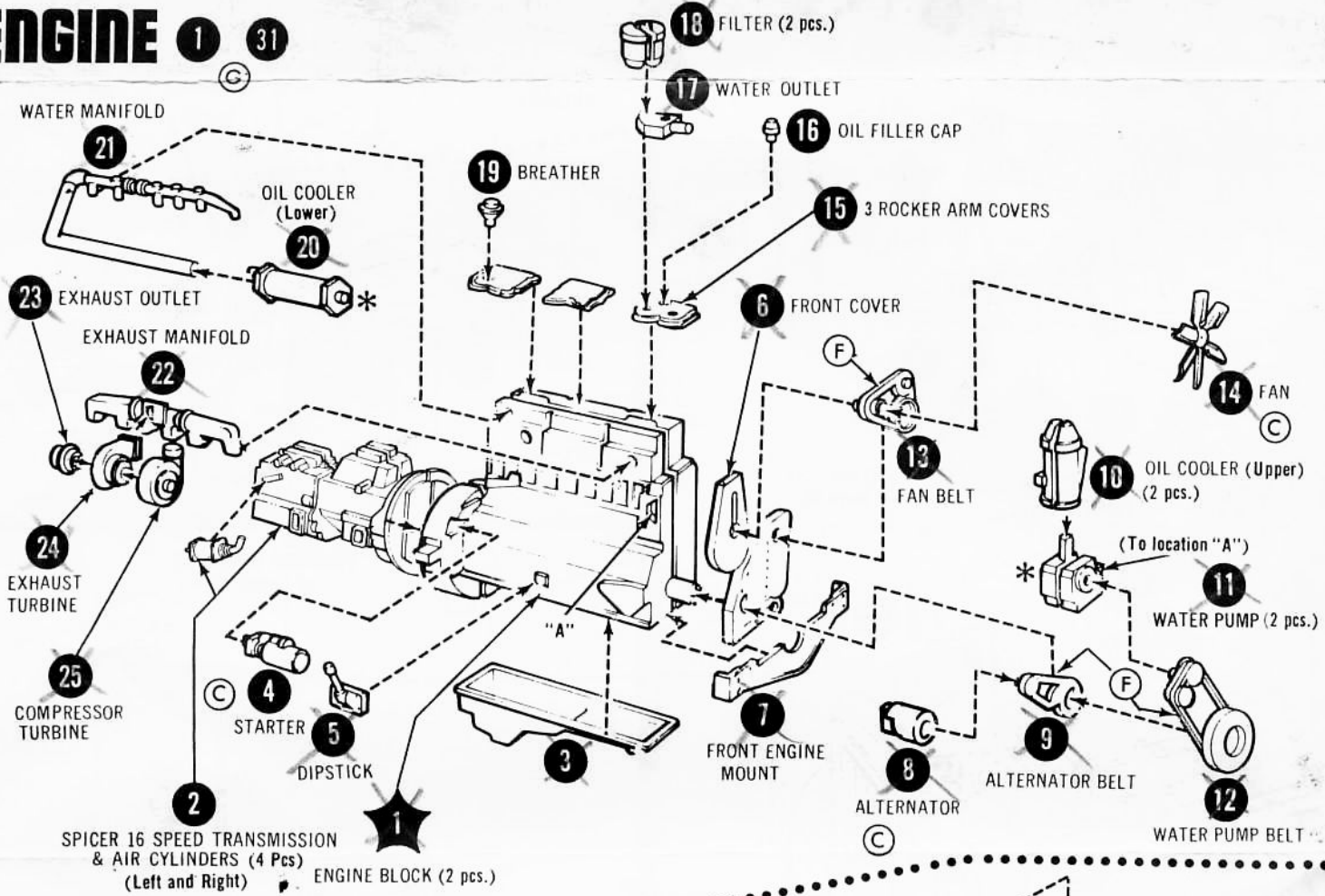

LENSES TO BE USED

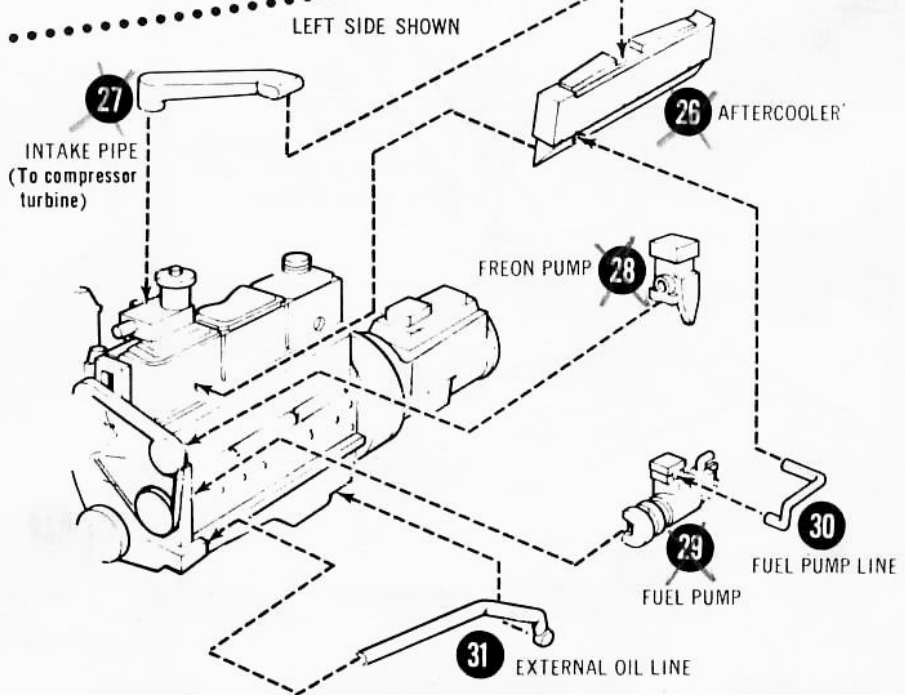
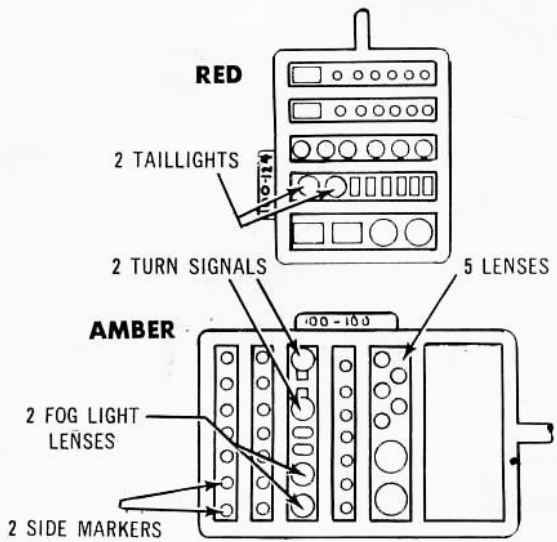

REAR WHEELS [ⓔ]

4 WHEEL OUTERS
(With lug nuts)

NOTE: Remove center of tires

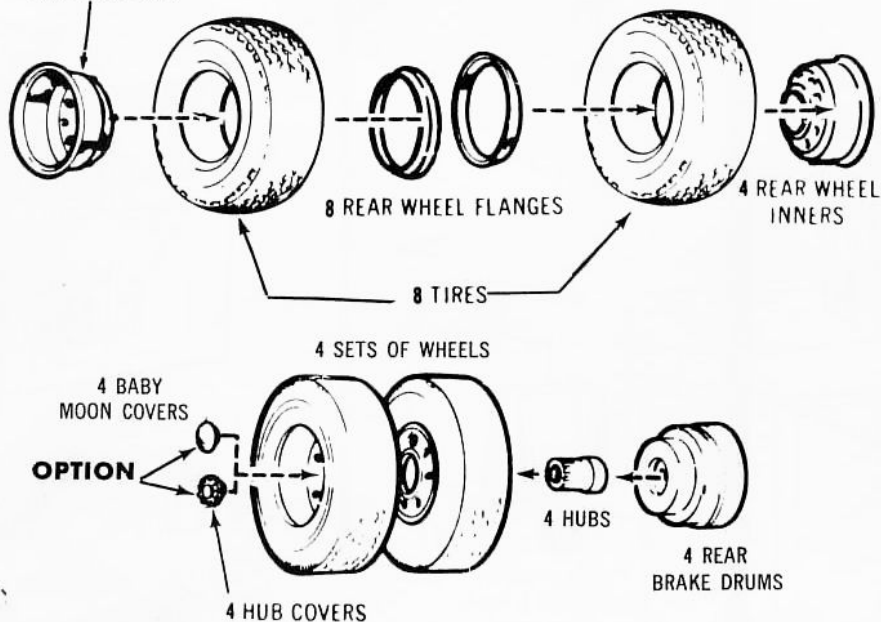

FRONT WHEELS [ⓔ]

Note: Remove center of tires.

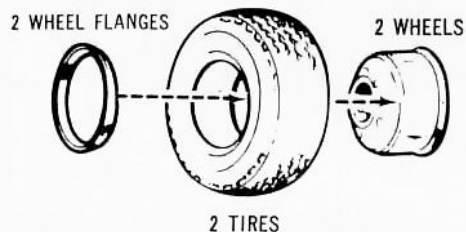

BASIC CHASSIS

1 - 13 [ⓐ]

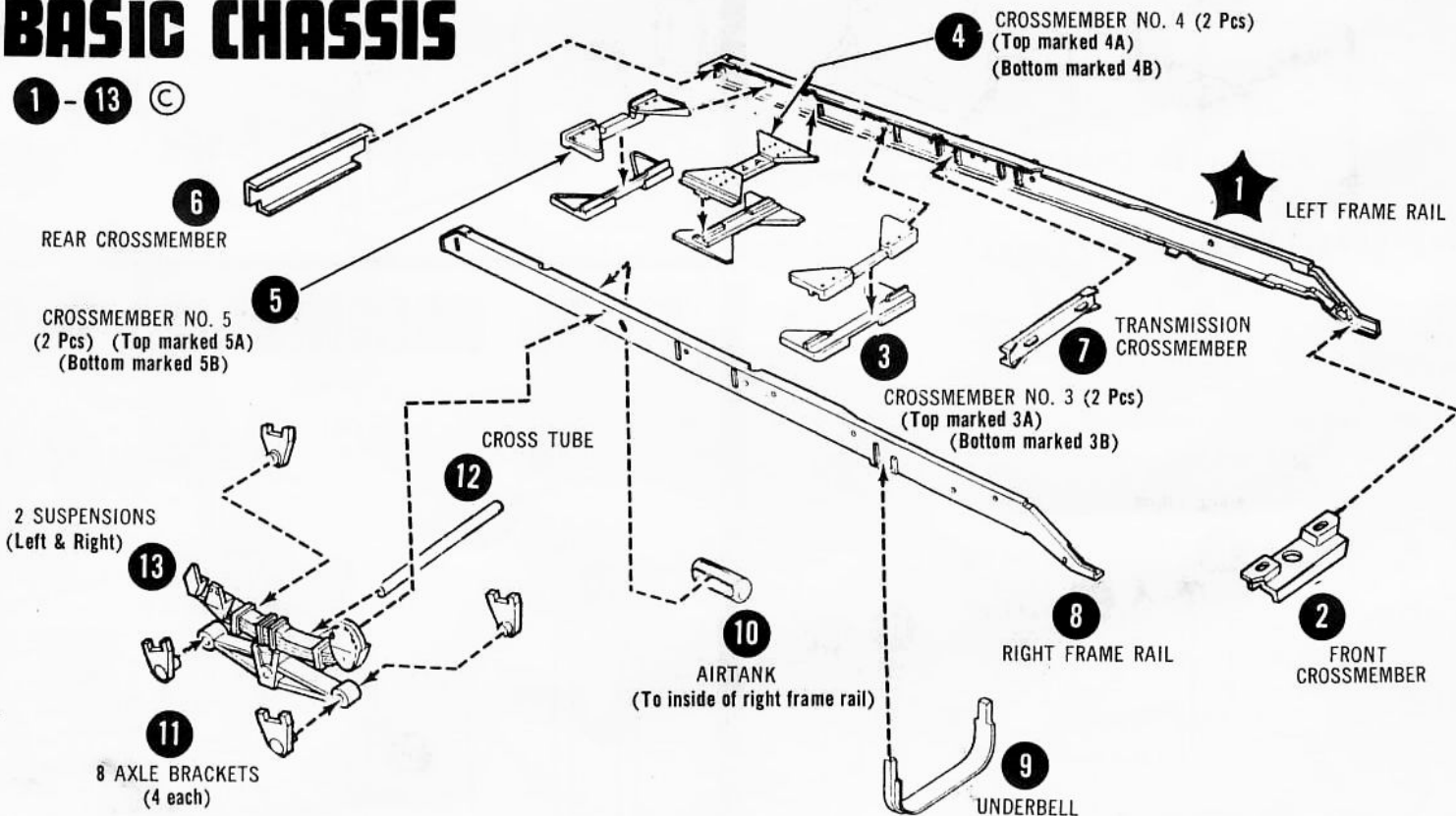

REAR DRIVE TRAIN 1 - 19

(C)

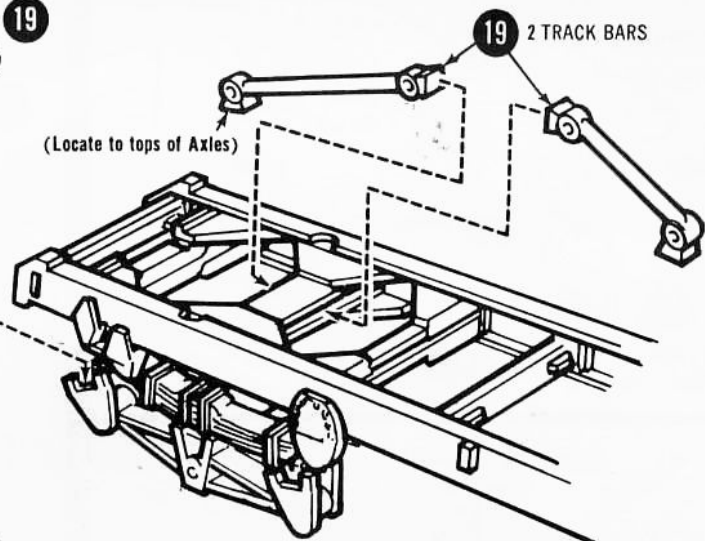

8 AIR BRAKE CYLINDER (Rear) (Large)

9 BRAKE MOUNT

10 BACKING PLATE (Left Rear)

12 BRAKE MOUNT

13 BACKING PLATE (Left Front)

INTER AXLE DRIVE SHAFT 3

4 REAR AXLE (2 pcs.)

11 AIR BRAKE CYLINDER (Front) (Small)

2 CENTER AXLE (2 pcs.)

1 CENTER AXLE GEAR BOX (2 pcs.)

5 AIR BRAKE CYLINDER (Rear) (Large)

6 BRAKE MOUNT

7 BACKING PLATE (Right Rear)

15 BRAKE MOUNT

16 BACKING PLATE (Right Front)

14 AIR BRAKE CYLINDER (Front) (Small)

17 2 METAL AXLES

18 4 ASSEMBLED WHEELS

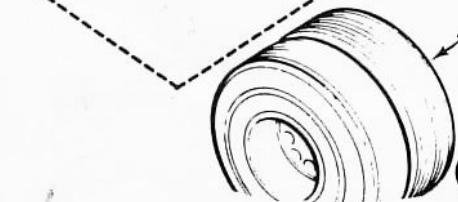

FRONT AXLE 1-13

(C)

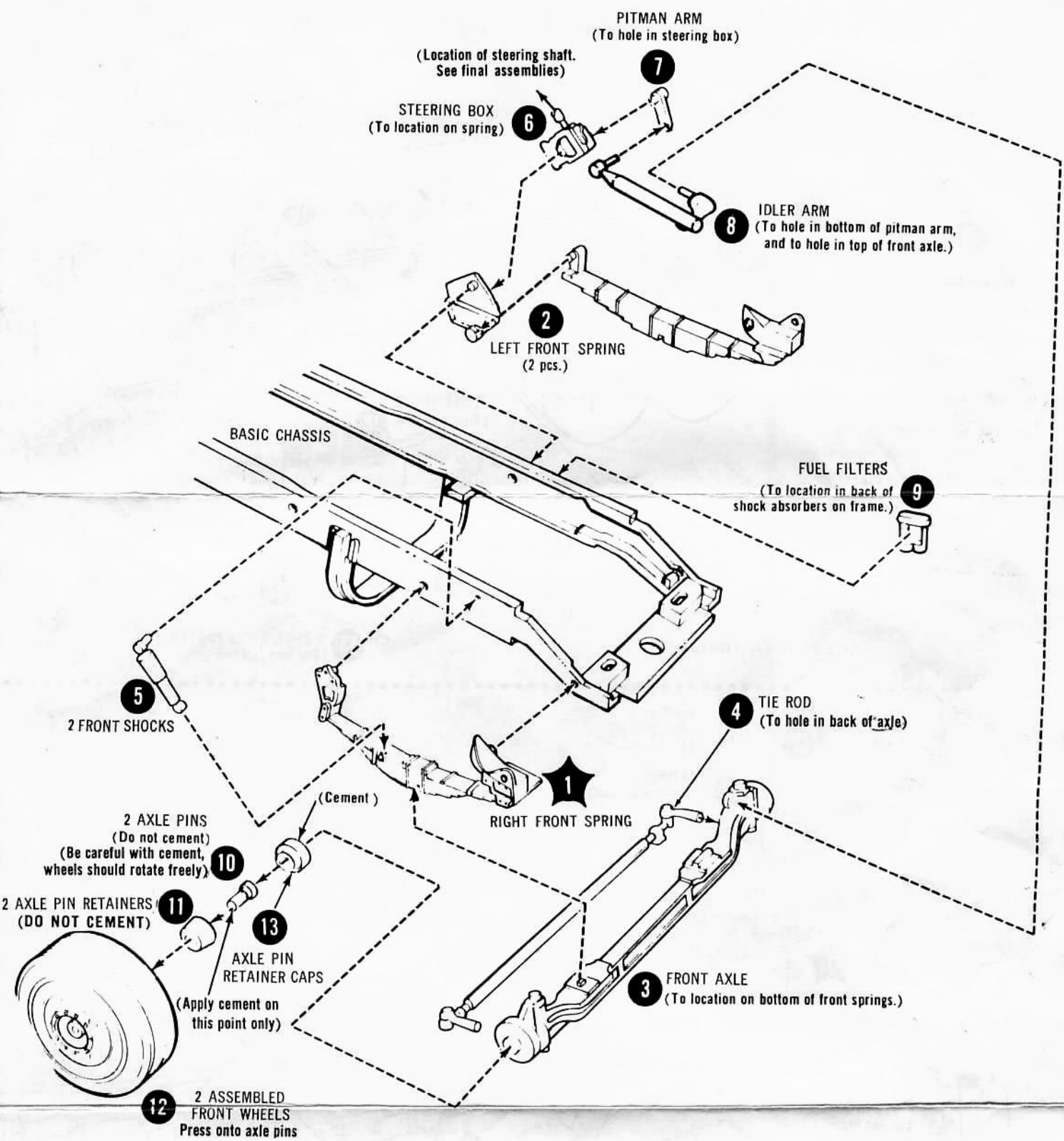

ENGINE TO CHASSIS 1-6

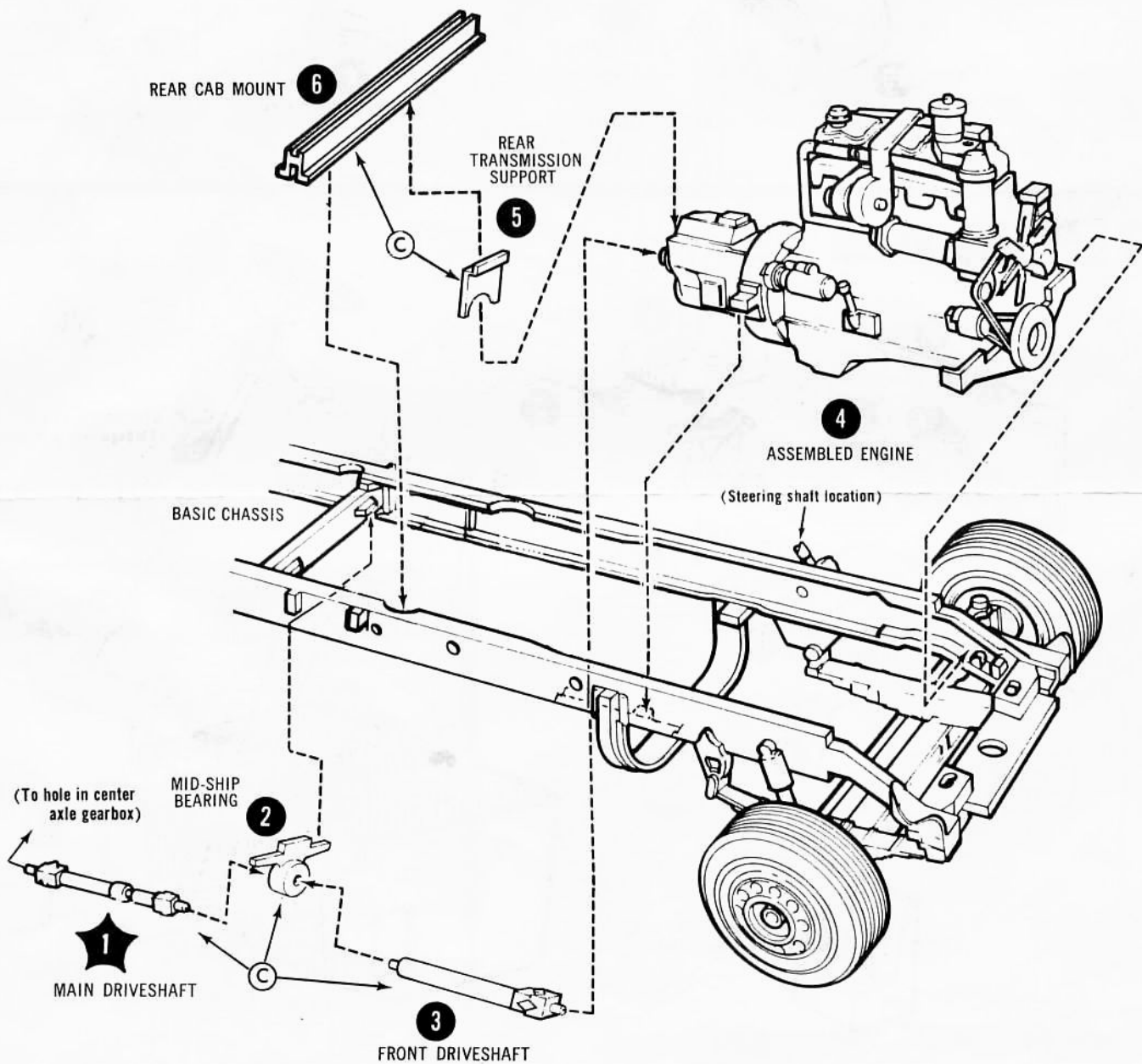

CHASSIS ACCESSORIES 1 - 22

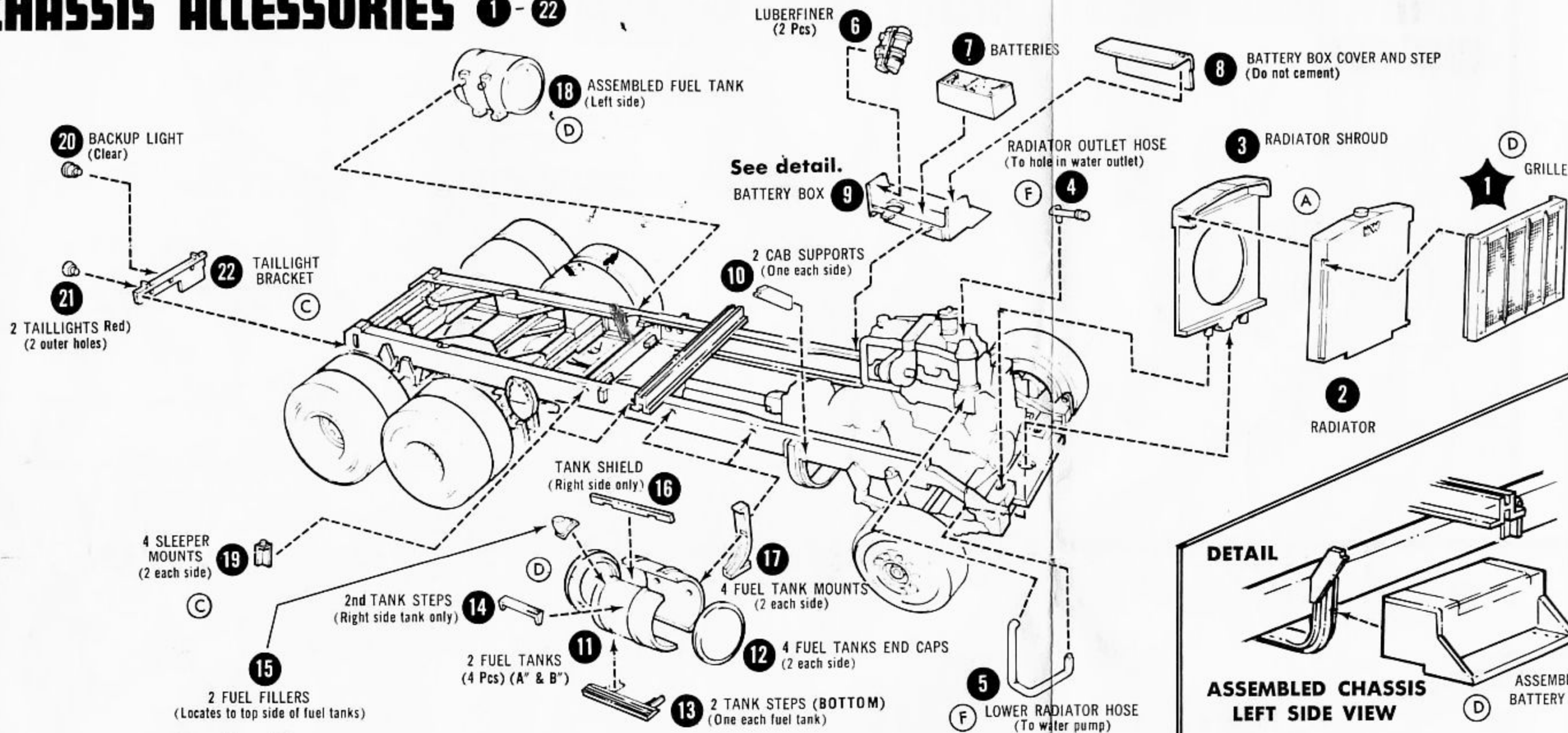

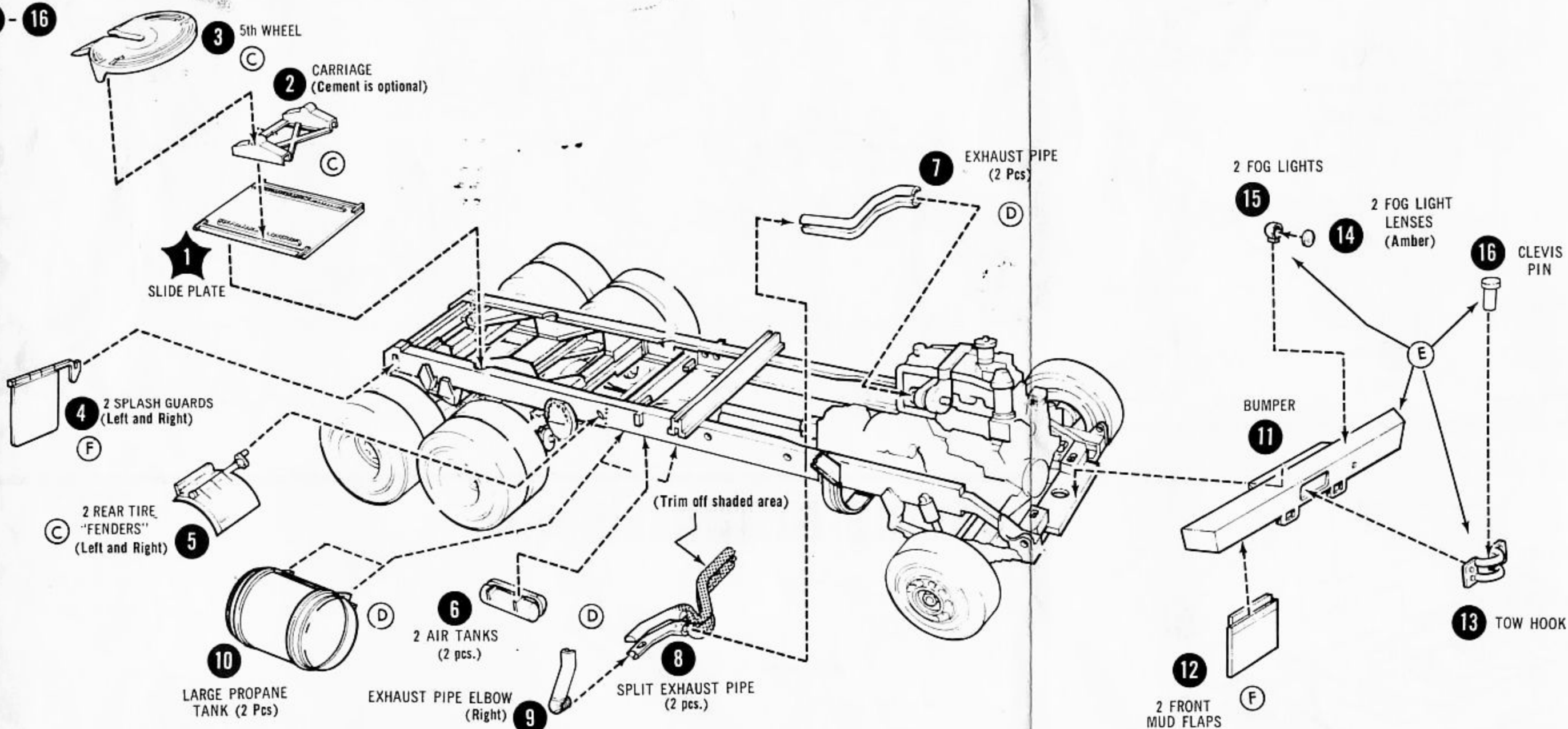

INTERIOR 1-19 (B) (D)

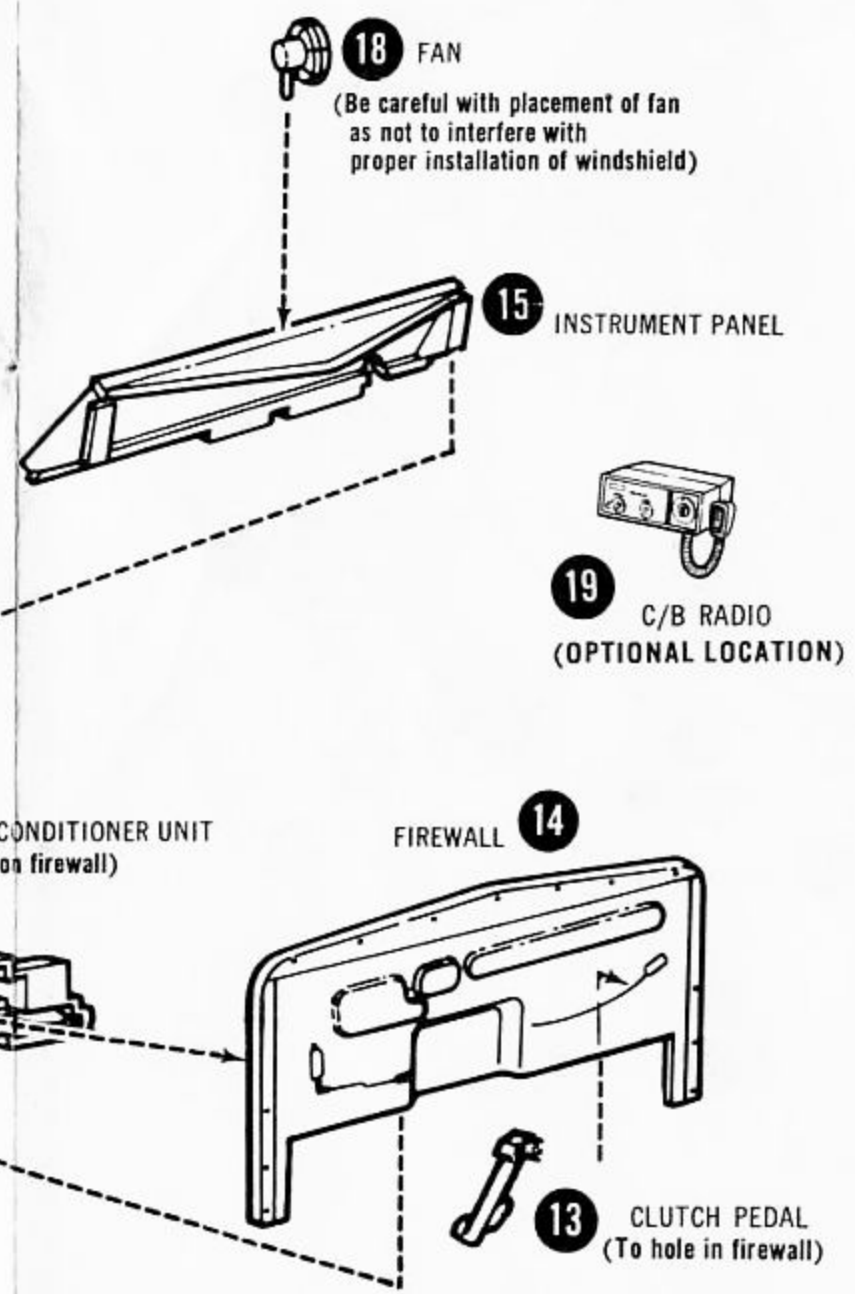
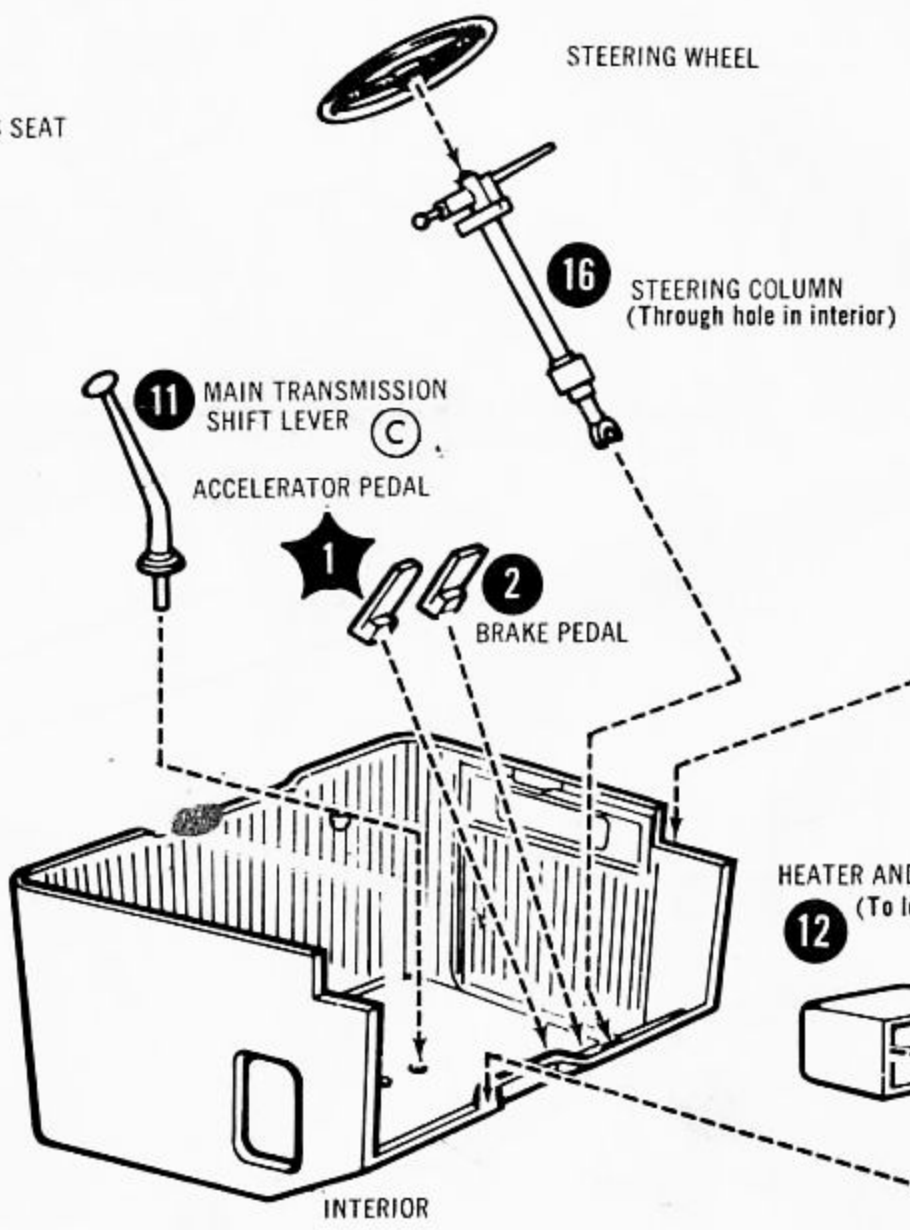
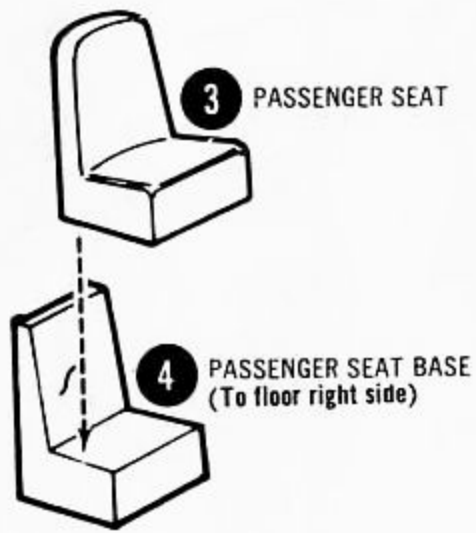
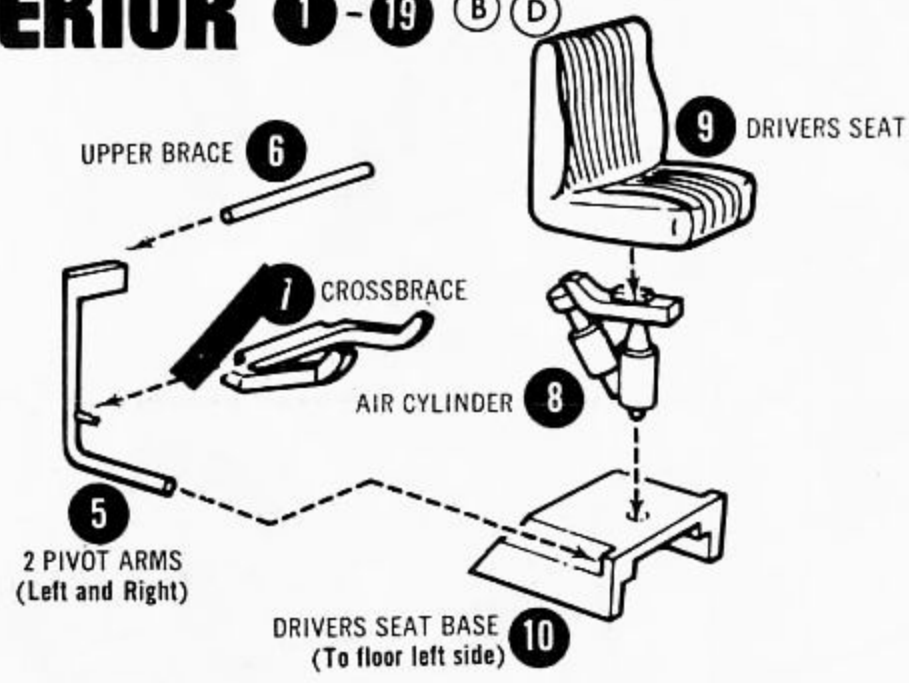

WINDOWS 1-6

INTERIOR TO CAB

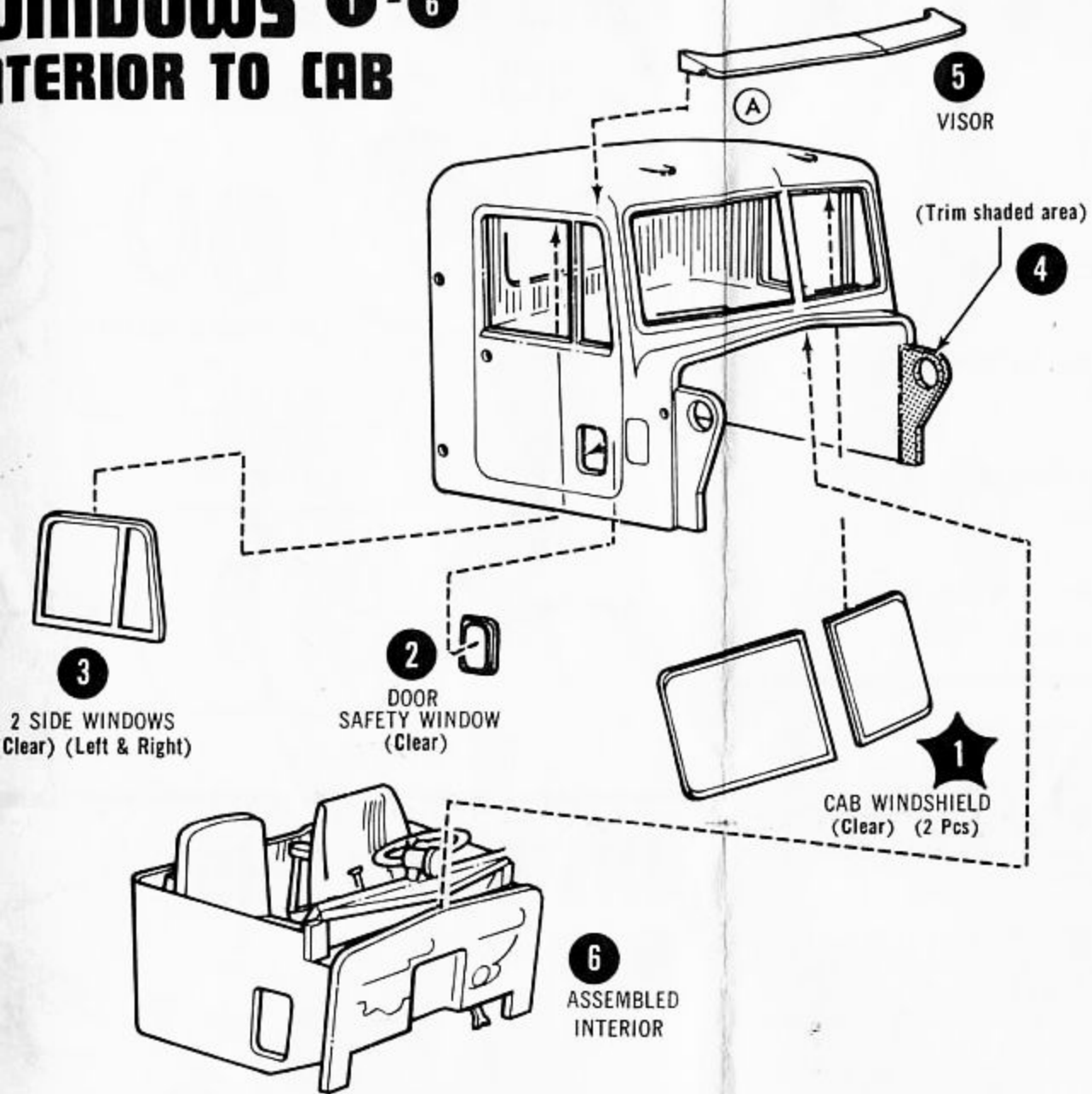

SLEEPER 1-6 (A)

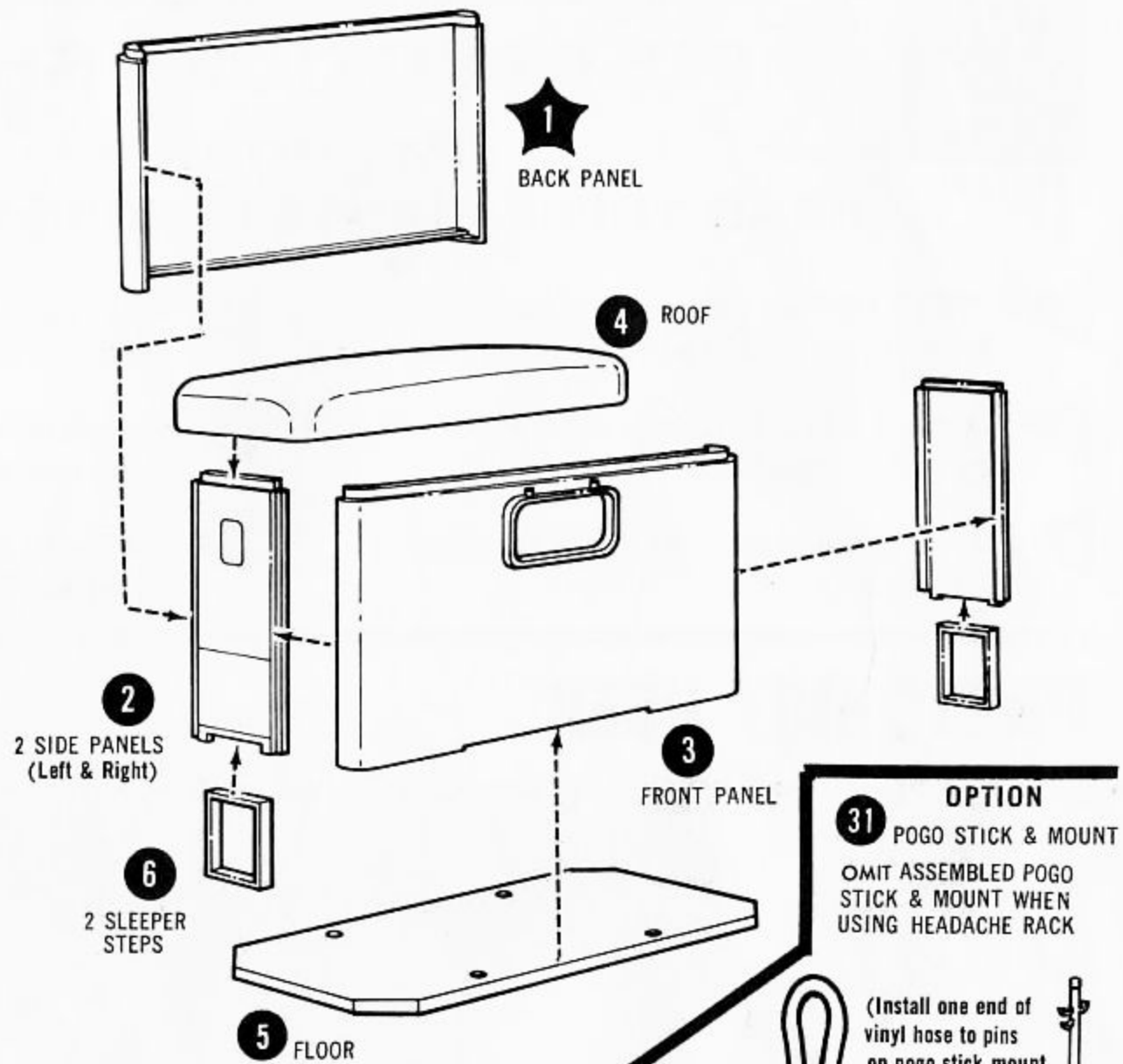

FINAL ASSEMBLIES 1-39

5 LIGHTS 26

25 5 LENSES

2 LENSES (Clear) 34

32 2 CROSSBRACES

33 HEADACHE RACK

VINYL HOSE

(OPTIONAL LOCATION)

(Install one end of vinyl hose to pins on pogo stick mount and wrap around pogo stick)

ORIGINAL ASSEMBLIES 1 - 39

