

AERO L-29 DELFÍN

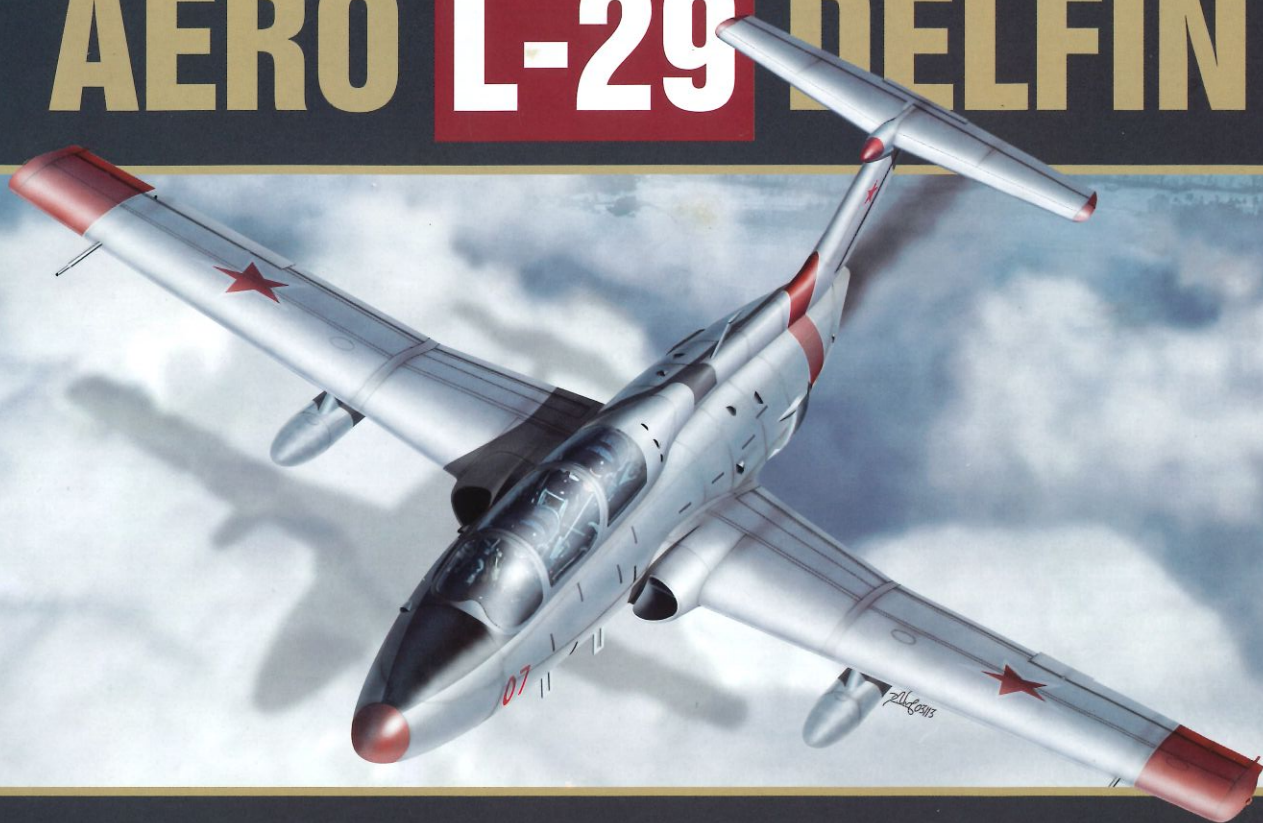

1/48 UNASSEMBLED MODEL KIT



INSTRUCTIONS

THE AERO L-29 DELFÍN

“海豚”教練機

L-29 海豚 [捷克語: Delfin、北約代號: Maya (瑪雅)] 是一款捷克制軍用噴射教練機、20世紀60年代華沙公約國成員國的標準教練機。L-29海豚也是捷克第一次自行設計並生產的噴射機。

在20世紀50年代末，蘇聯空軍尋找一款噴射教練機以取代當時的活塞引擎教練機。這一需求不久便擴大到了其它東方集團中的空軍。於是，沃多喬迪航空推出了名為「XL-29」的原型機，第一架採用英國西德利公司的蝰蛇引擎，於1959年4月5日首飛；第二架則換裝了捷克制M-701引擎，隨後該型號的飛機都採用了這一款引擎。

L-29海豚的基本設計概念是簡約、易於生產和易於操控。其簡單和耐用的特性體現於全手動飛行操控、大的襟翼和機身兩側使飛機平滑、穩定地航行的穿孔氣閘，這些特性使它獲得了良好的安全飛行記錄。L-29海豚能夠從草地、沙地或無道面的機場跑道上起降。教練及學生的座椅都是彈射椅，採用串列式布置，後方的教練座椅略高於學員座椅。

1961年，L-29海豚與TS-11火星、雅克-30進行評估，L-29海豚最後脫穎而出。除了波蘭選擇了繼續開發本國研制的TS-11火星外，所有其他華約成員國都在經濟互助委員會的協議下採用了L-29海豚。

L-29海豚於1963年4月投入生產，持續11年，共產出3,500架。

L-29海豚用來進行基本、中級和帶武器的訓練。在進行武器訓練時，可在飛機的硬點（外挂點）上掛載機槍、炸彈或火箭。在贖罪日戰爭中，埃及空軍曾派遣多架武裝L-29海豚攻擊以色列坦克。蘇聯空軍取得了2000多架L-29，並獲得了北約代號「Maya」（瑪雅）。

The Aero L-29 Delfin (English: Dolphin, NATO reporting name: Maya) is a military jet trainer aircraft that became the standard jet trainer for the air forces of Warsaw Pact nations in the 1960s. It was Czechoslovakia's first locally designed and built jet aircraft.

In the late 1950s, the Soviet Air Force was seeking a jet-powered replacement for its fleet of piston-engined trainers, and this requirement was soon broadened to finding a trainer aircraft that could be adopted in common by Eastern Bloc air forces. Aero's response, the prototype XL-29 designed by Z. Rublič and K. Tomáš first flew on 5 April 1959, powered by a British Bristol Siddeley Viper engine. The second prototype was powered by the Czech-designed M701 engine, which was used in all subsequent aircraft.

The basic design concept was to produce a straightforward, easy-to-build and operate aircraft. Simplicity and ruggedness were stressed with manual flight controls, large flaps and the incorporation of perforated airbrakes on the fuselage sides providing stable and docile flight characteristics, leading to an enviable safety record for the type. The sturdy L-29 was able to operate from grass, sand or unprepared fields. Both student pilot and instructor had ejection seats, and were positioned in tandem, under separate canopies with a slightly raised instructor position.

In 1961, the L-29 was evaluated against the PZL TS-11 Iskra and Yakovlev Yak-30 and emerged the winner. Poland chose to pursue the development of the TS-11 Iskra anyway, but all other Warsaw Pact countries adopted the Delfin under the agreements of COMECON.

Production began April 1963 and continued for 11 years, with 3,600 eventually built until 1974.

The Delfin served in basic, intermediate and weapons training roles. For this latter mission, they were equipped with hardpoints to carry gunpods, bombs or rockets, and thus armed, Egyptian L-29s were sent into combat against Israeli tanks during the Yom Kippur War. More than 2,000 L-29s were supplied to the Soviet Air Force, acquiring the NATO reporting name "Maya".



- ★ 產品不適合8歲以下的兒童。
- ★ 產品中含有帶尖點的小零件。
- ★ 對於3歲以下兒童當心因窒息產生的危害。

**NOT SUITABLE FOR CHILDREN UNDER 8 YEARS.
CONTAINS FUNCTIONAL SHARP POINTS
CONTAINS SMALL PARTS. BEWARE OF CHOKING HAZARD OF
CHILDREN UNDER 3 YEARS.**

PAINT AND COLOR USED

1 白色 White	44 沙漠黃色 San	304 橄欖色·Olive Drab (FS 34087)
3 紅色 Red	47 透明紅 Clear Red	310 棕啡色·Brown (FS 30219)
4 黃色 Yellow	50 透明藍 Clear Blue	317 灰色·Gray (FS 36231)
8 銀色 Silver	61 燒鐵色 Burnt Iron	332 灰色·Gray (BS 627)
12 橄欖色 Olive Drab	73 飛機灰色 Aircraft Gray	FS 30117
28 黑鐵色 Steel	118 淺藍色·Light Blue (RLM 78)	
33 啞黑色 Flat Black	137 車鈹黑 Tire Black	
34 淺藍色 Light Blue	302 綠色·Green (FS 34092)	

1 彈射座椅 Ejection seats

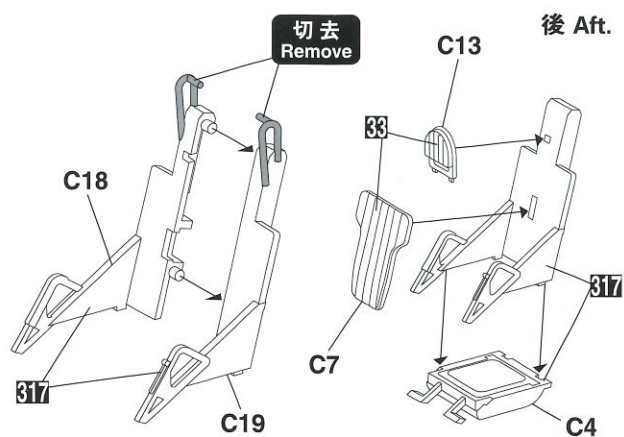
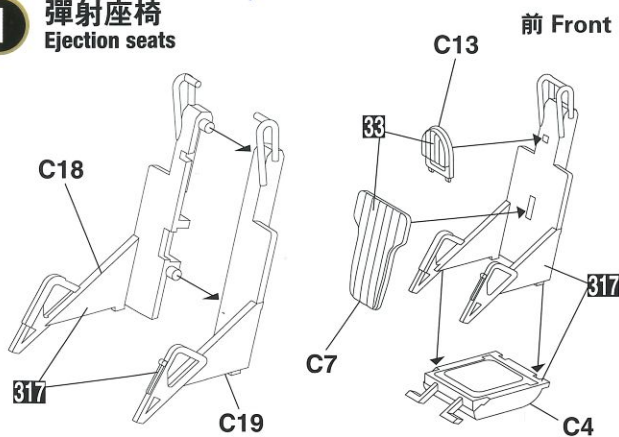

2 駕駛艙 Cockpit

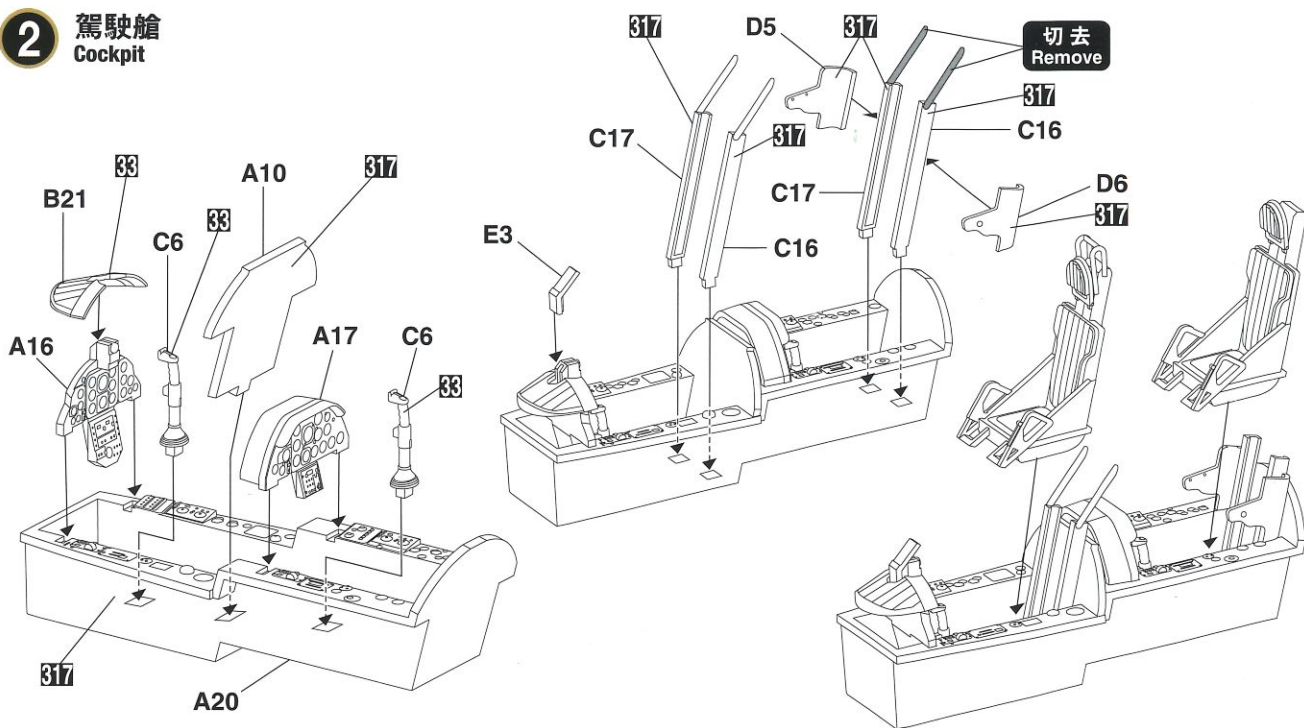

3 駕駛表板水貼紙位置 Panel decals placement

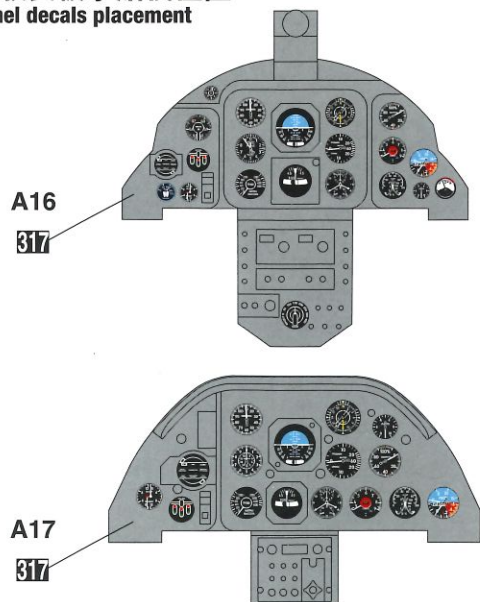

4 前起落架艙和噴嘴 Nose landing gear bay and Nozzle

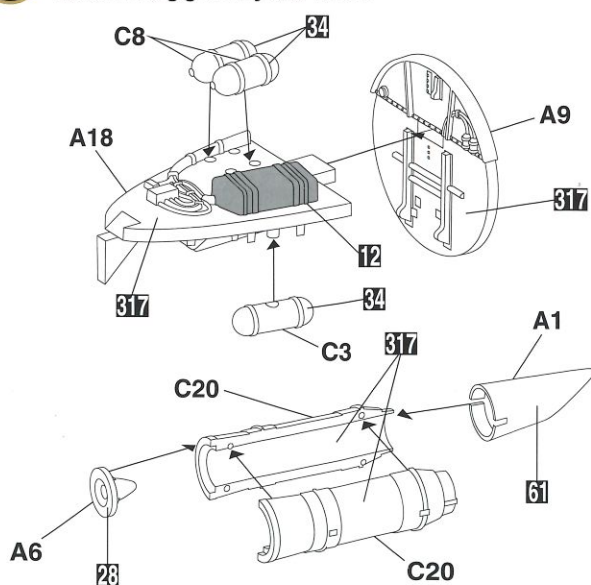

5 主機身裝配 Attaching fuselage halves

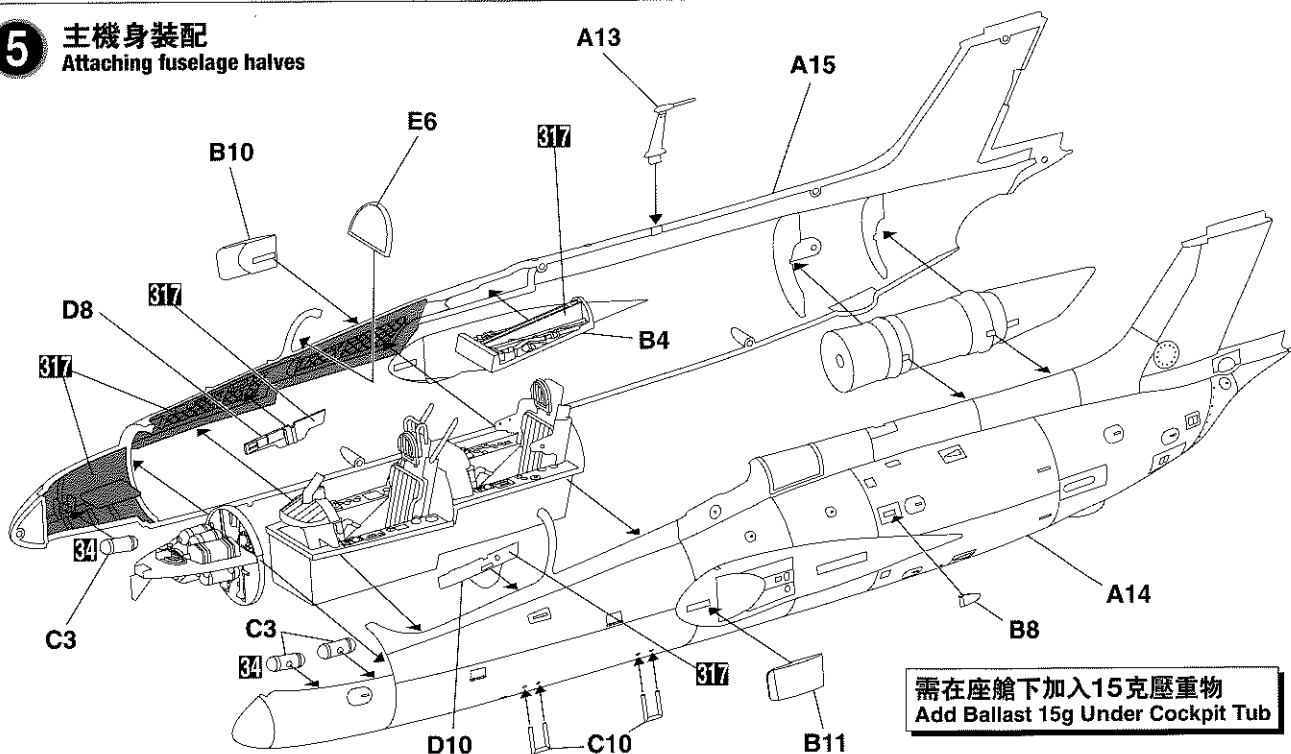

6 主翼組裝 Main wings assembly

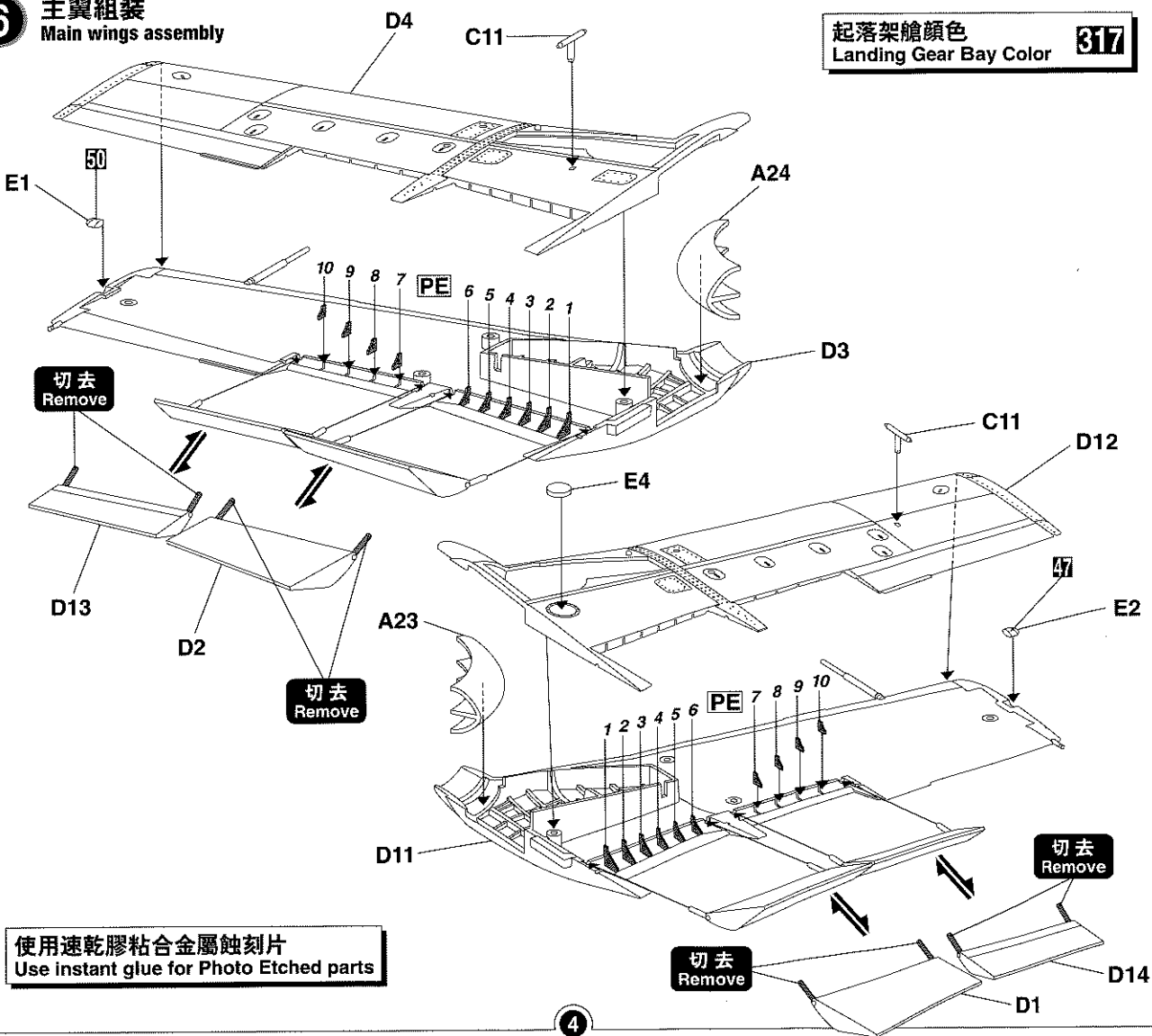

7 安裝機翼 Attaching wings to fuselage

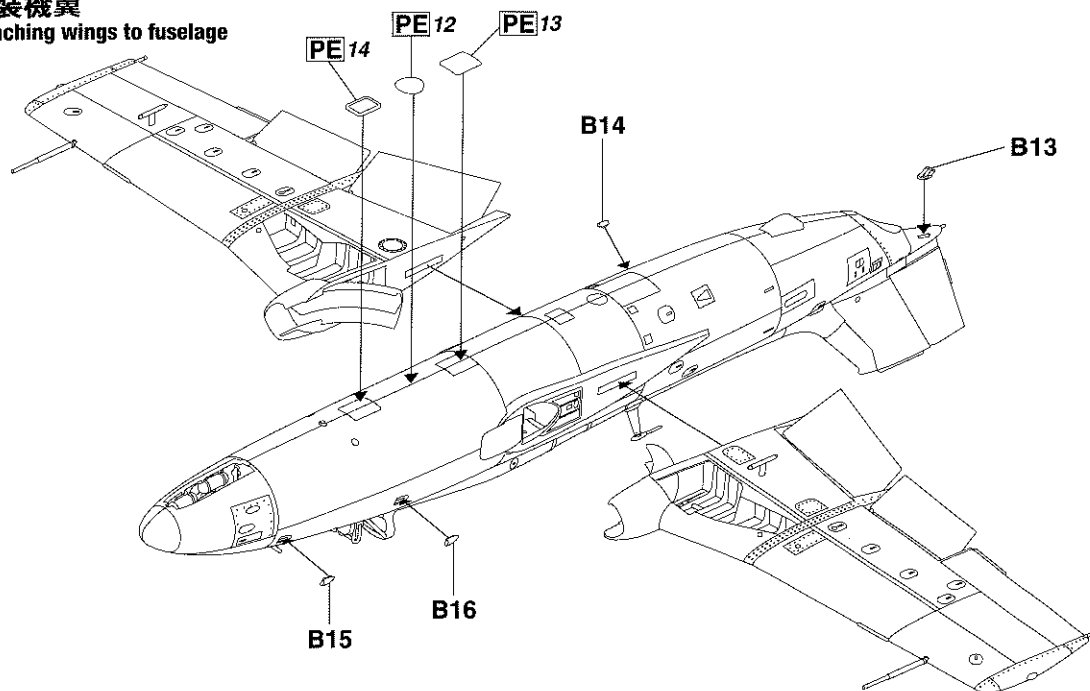

8 垂直尾翼 Tail rudder

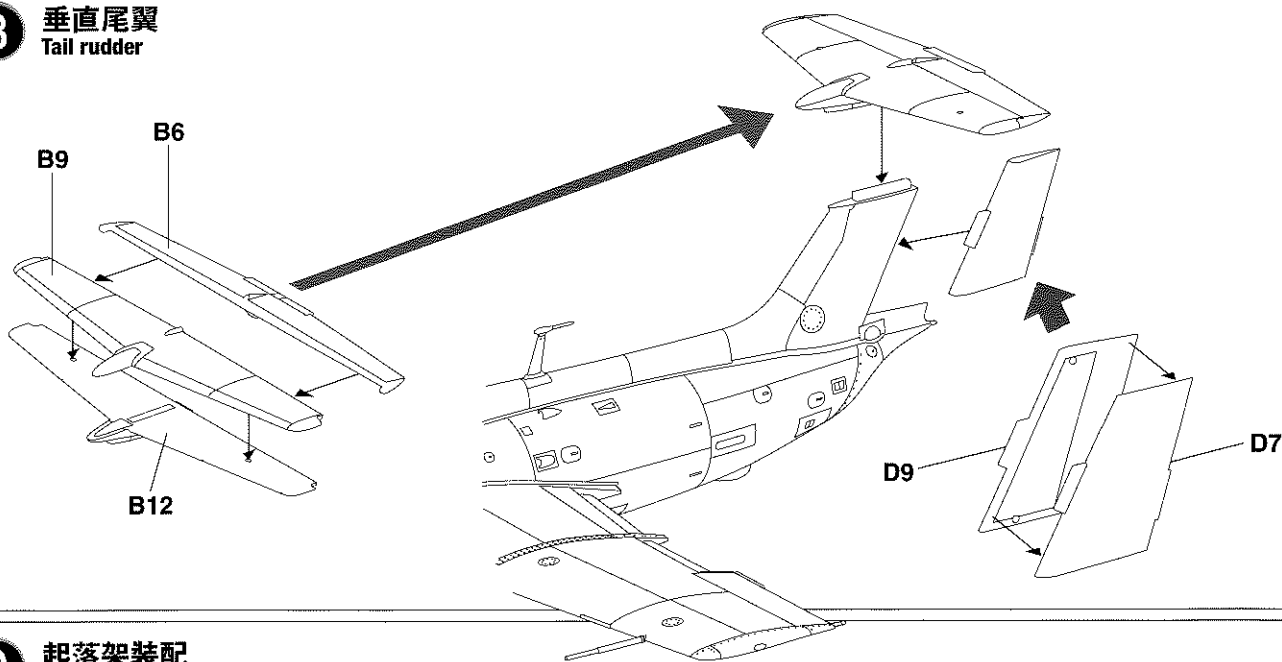

9 起落架裝配 Landing gears

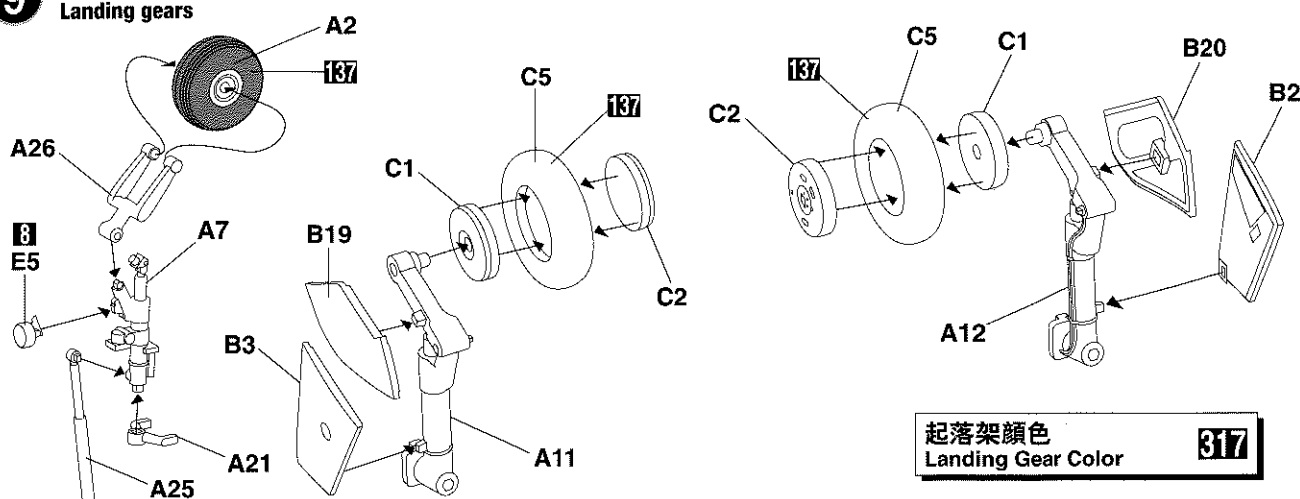

起落架顏色
Landing Gear Color

317

10 起落架輪艙門裝配 Attaching landing gear doors

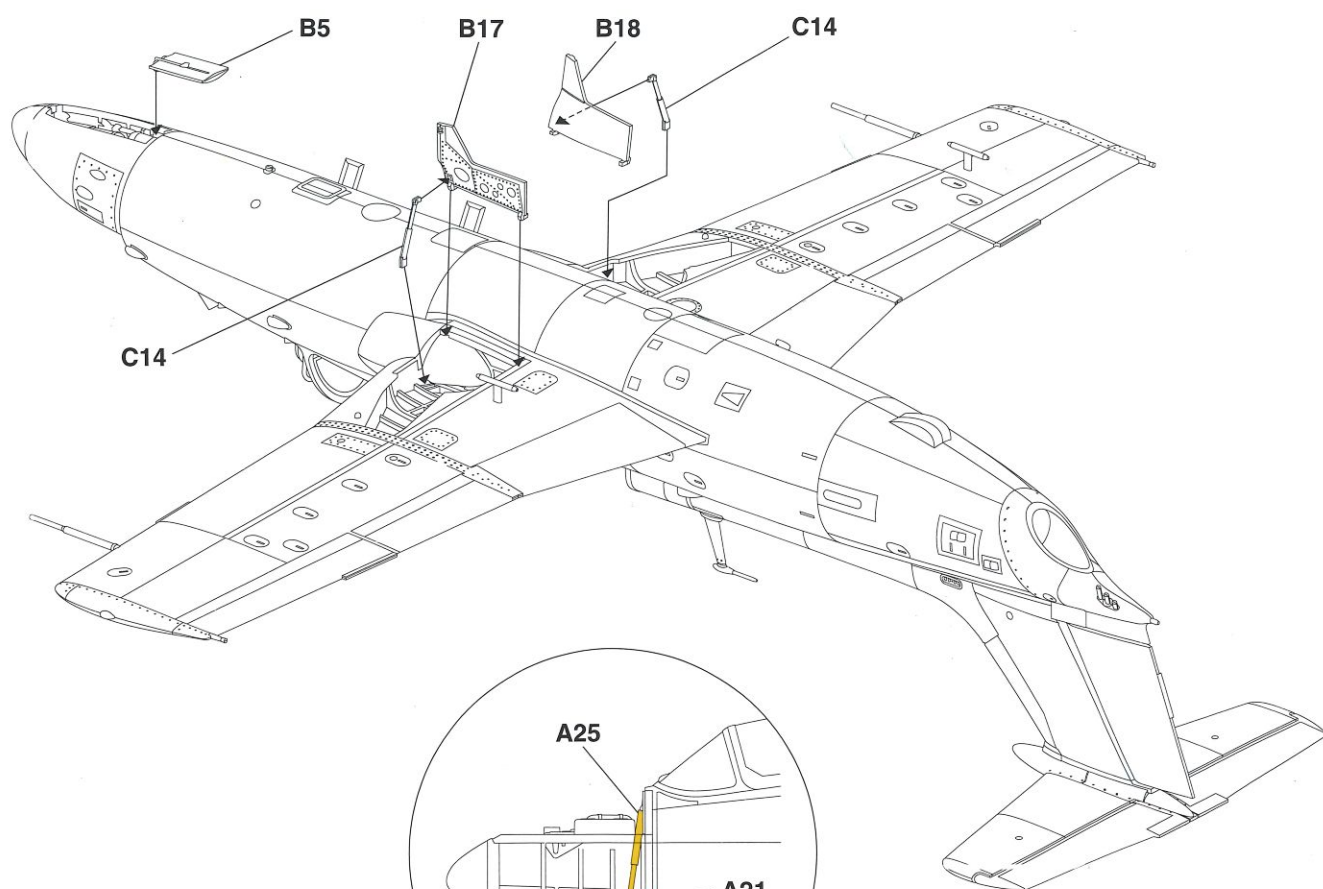

11 起落架裝配 Attaching landing gears

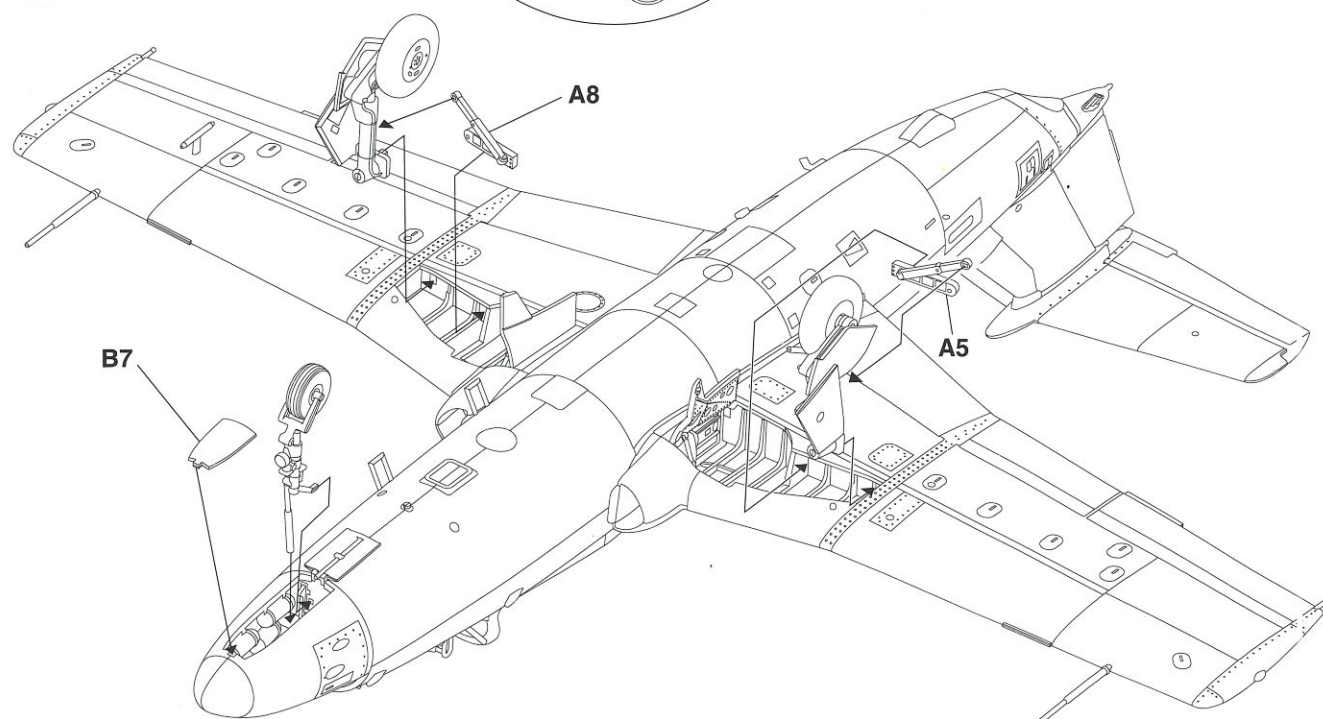

12 空氣制動器 Air brakes

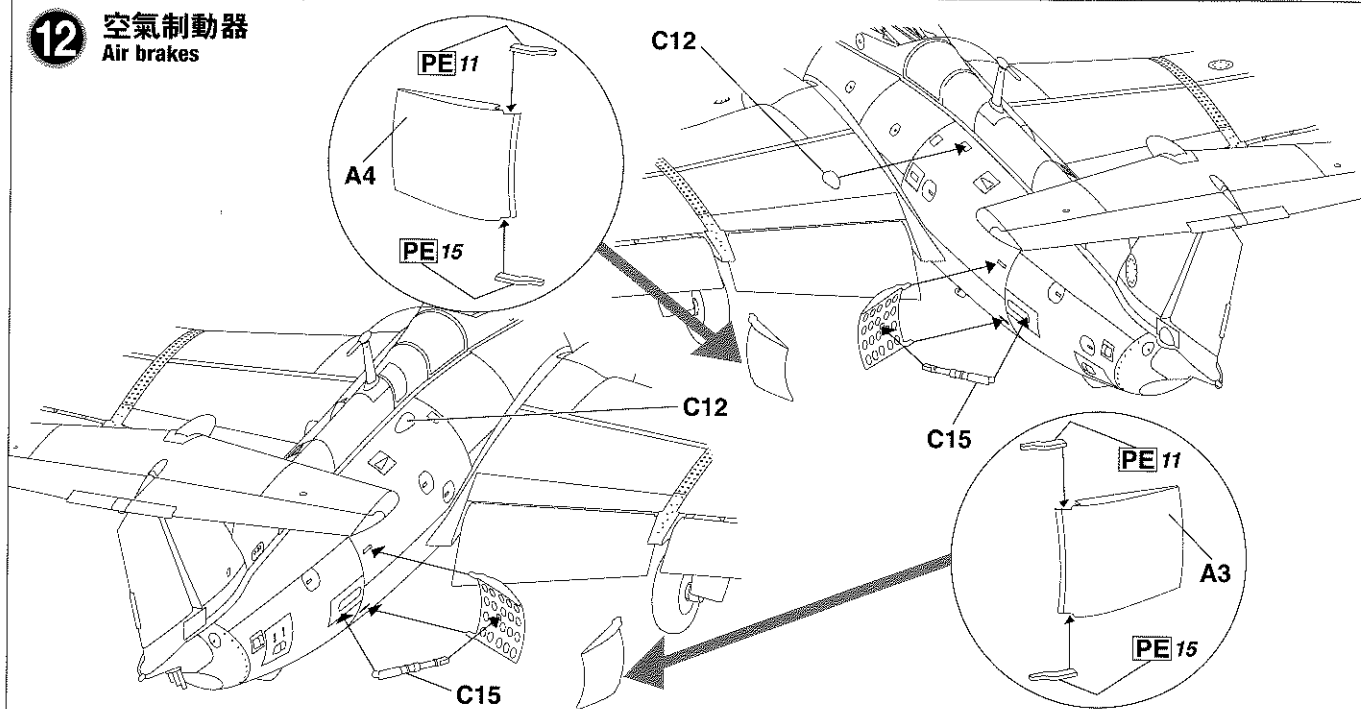

13 外部燃料箱裝配 Attaching external fuel tanks

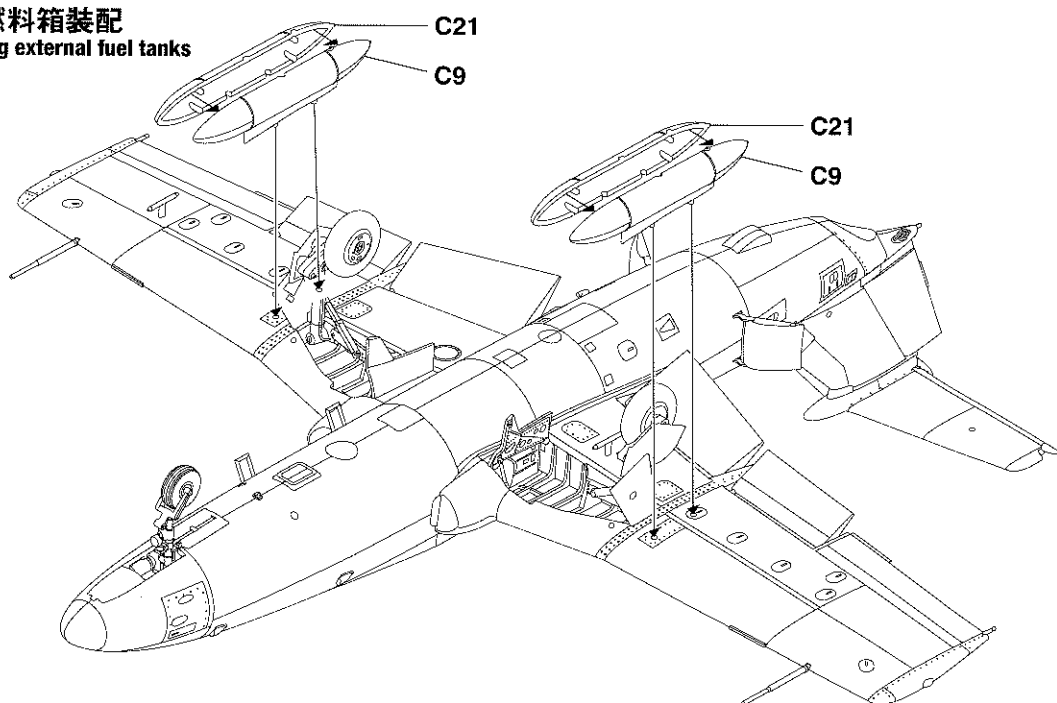

14 機鼻艙蓋 Nose bay cover

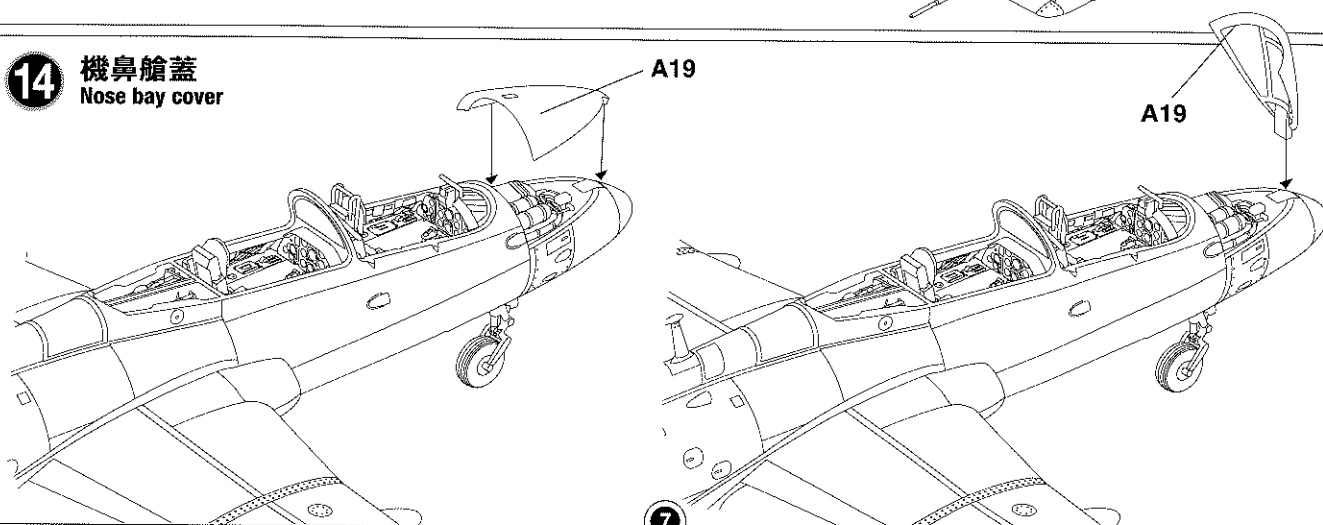

15 駕駛艙蓋組裝 Attaching canopies

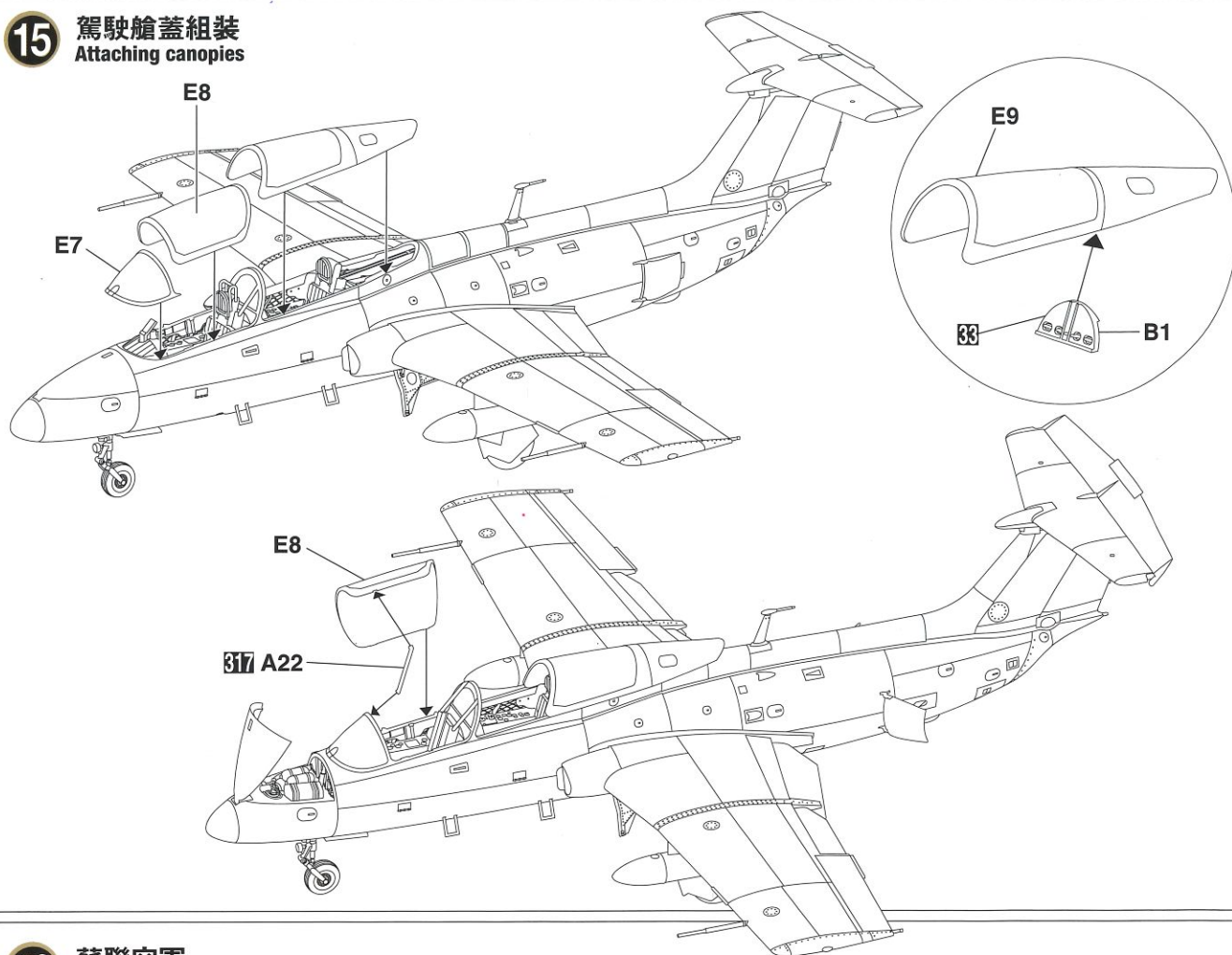

16 蘇聯空軍 USSR Air Force

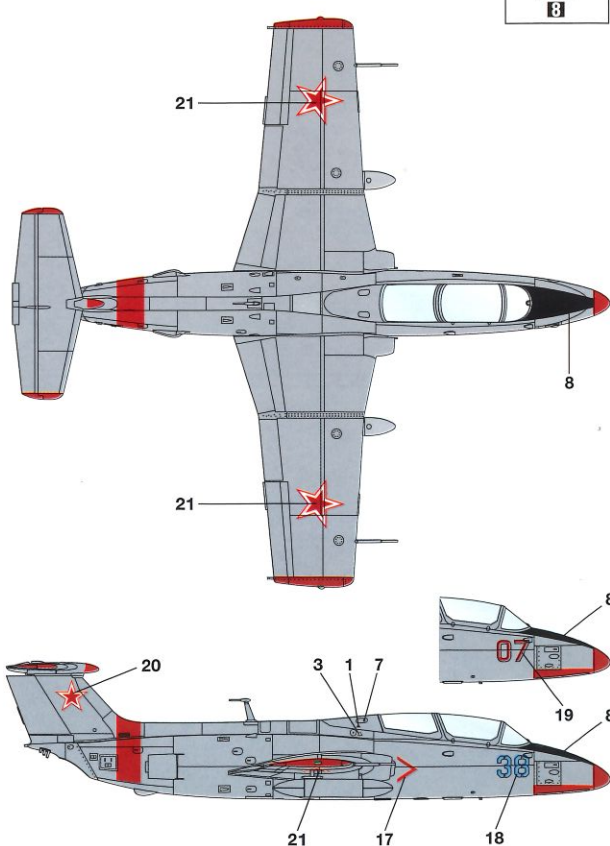
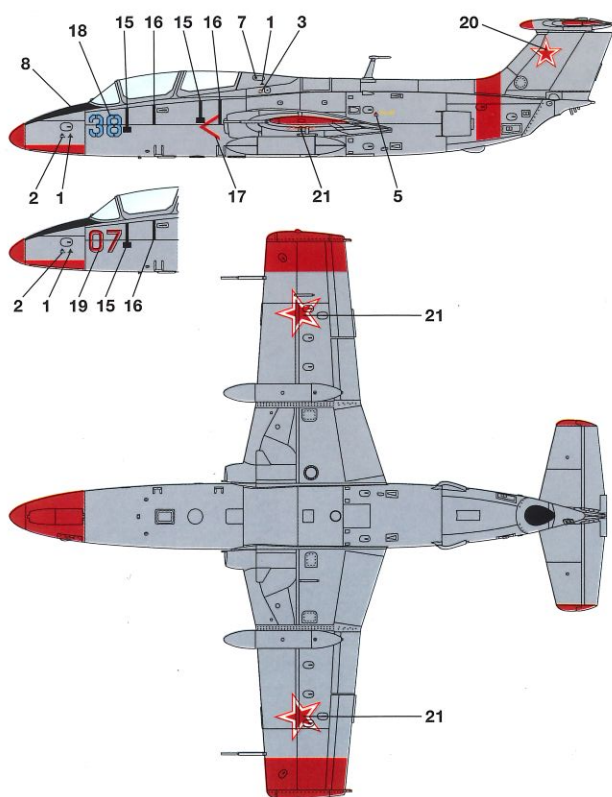

Silver
8

17 捷克空軍
Czech Republic 1996

Light Aircraft Gray
662 淺飛機灰
BS 627

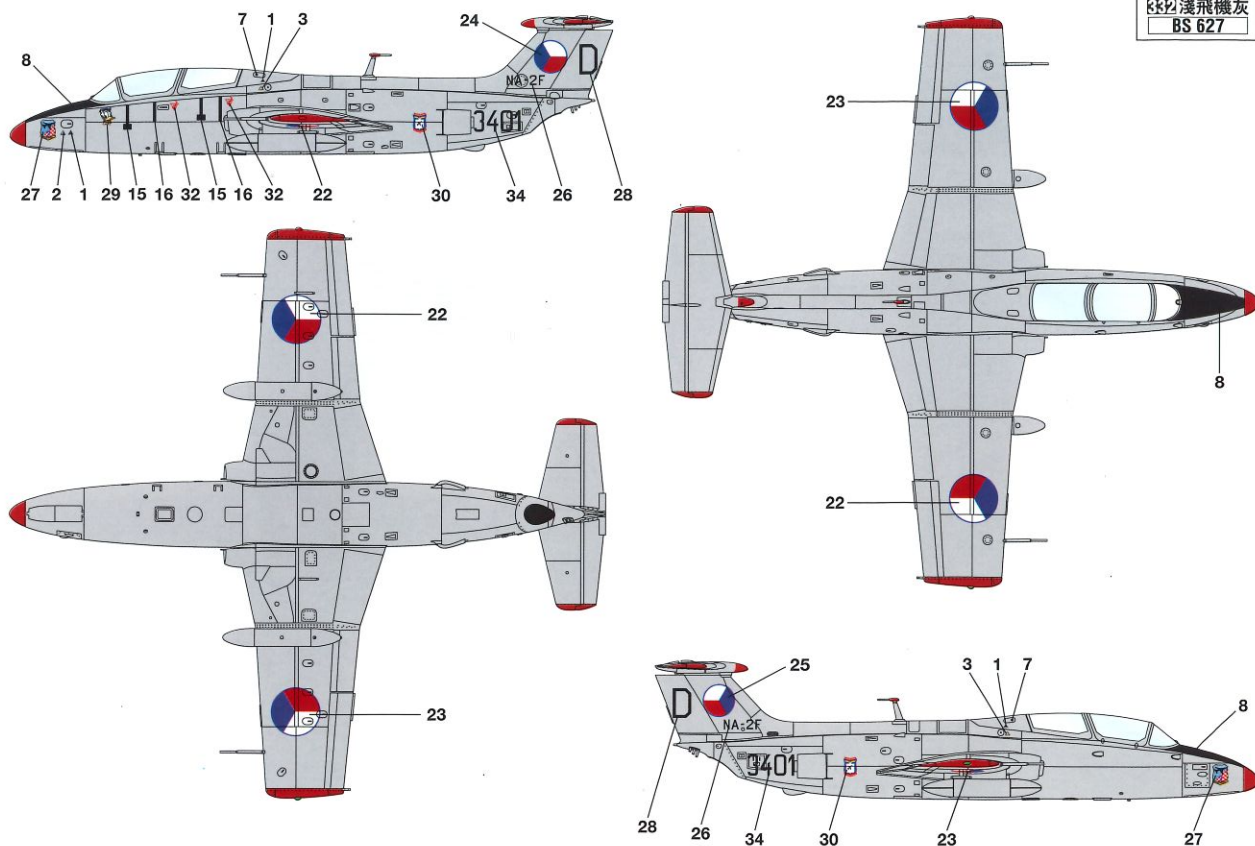

18 捷克空軍
Czech Air Force

Silver
B

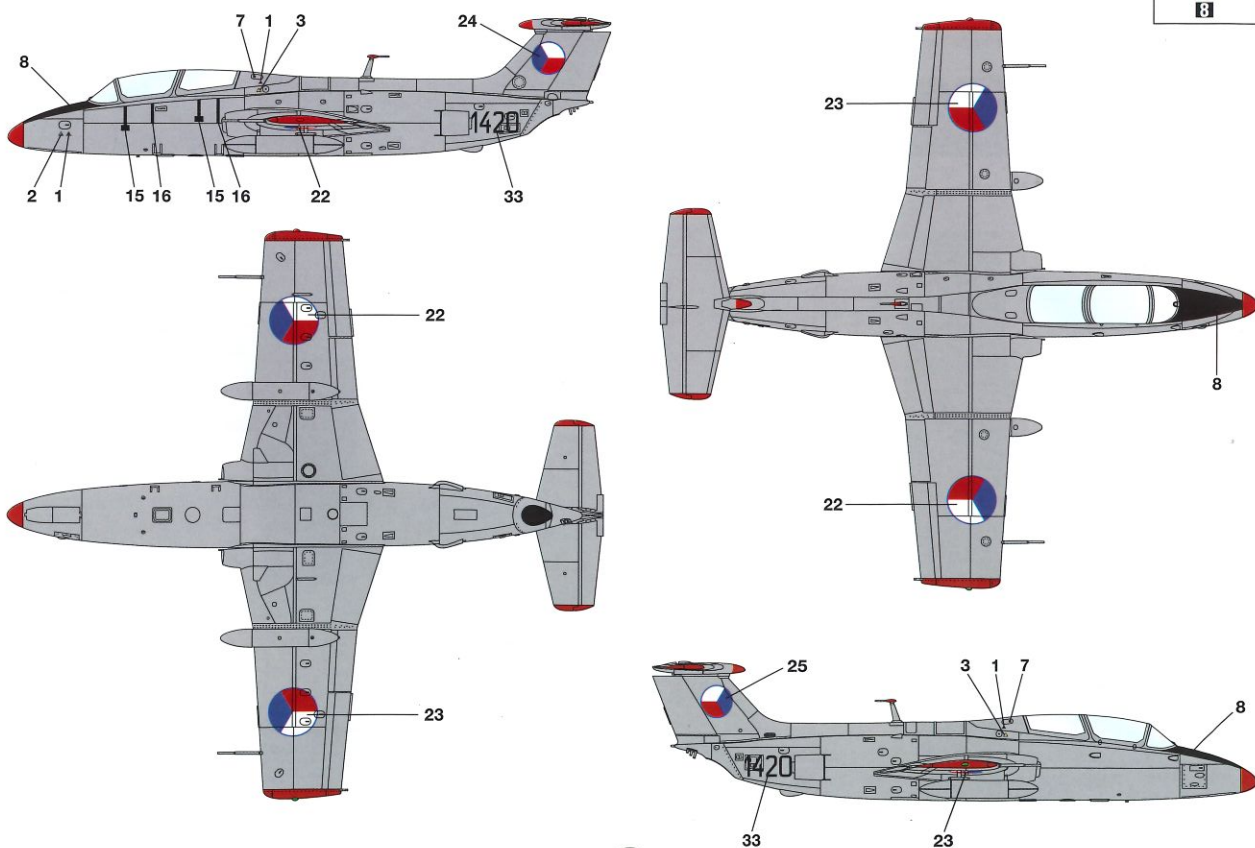

19

斯洛伐克空軍

Slovak Air Force

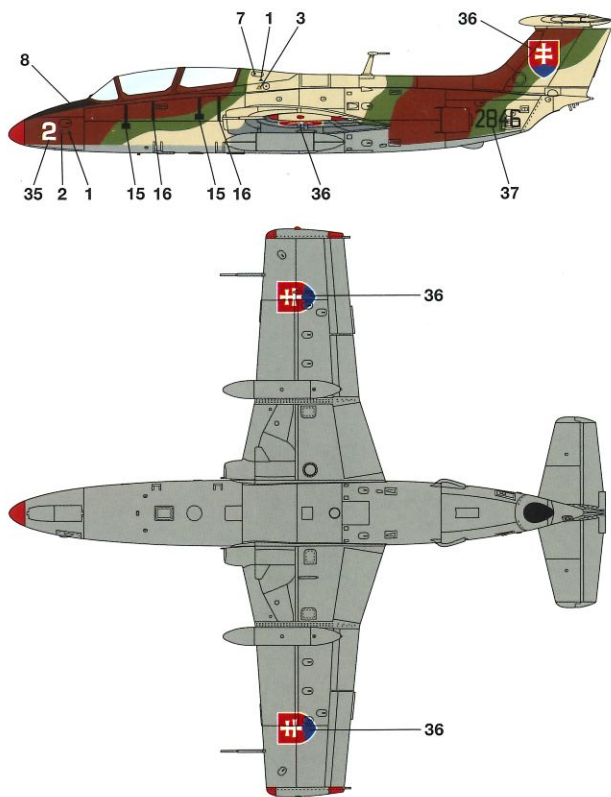

44	
310	FS 30219
304	FS 34087
332	BS 627

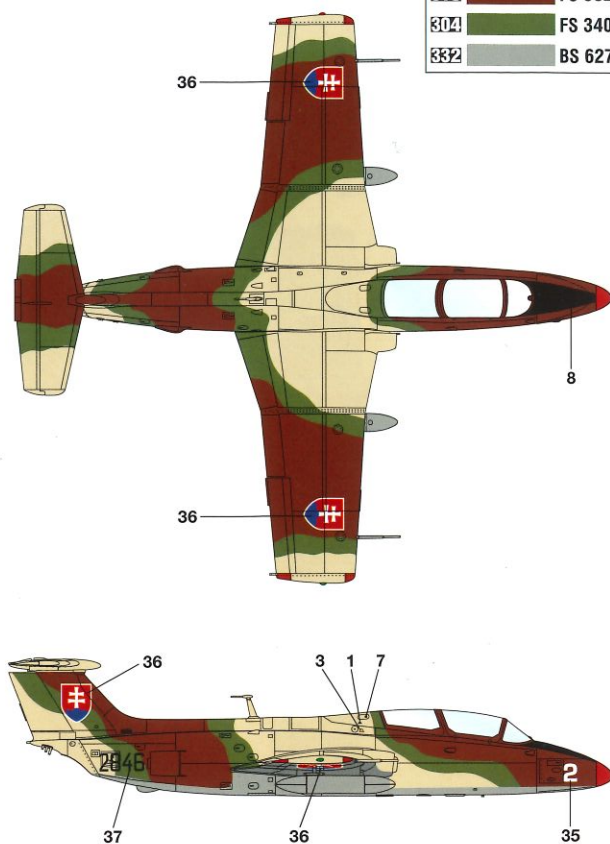

20

東德空軍

German Democratic Republic Air Force

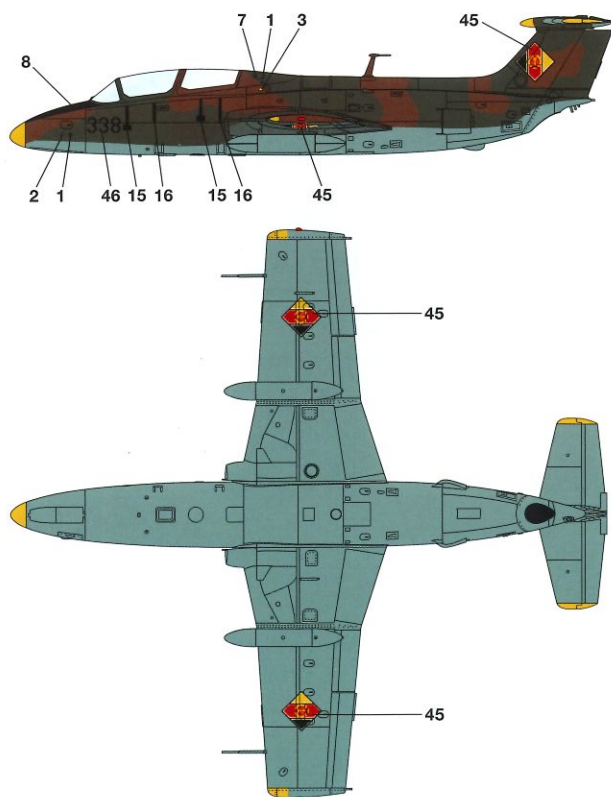

118	RLM 78
302	FS 34092
	FS 30117

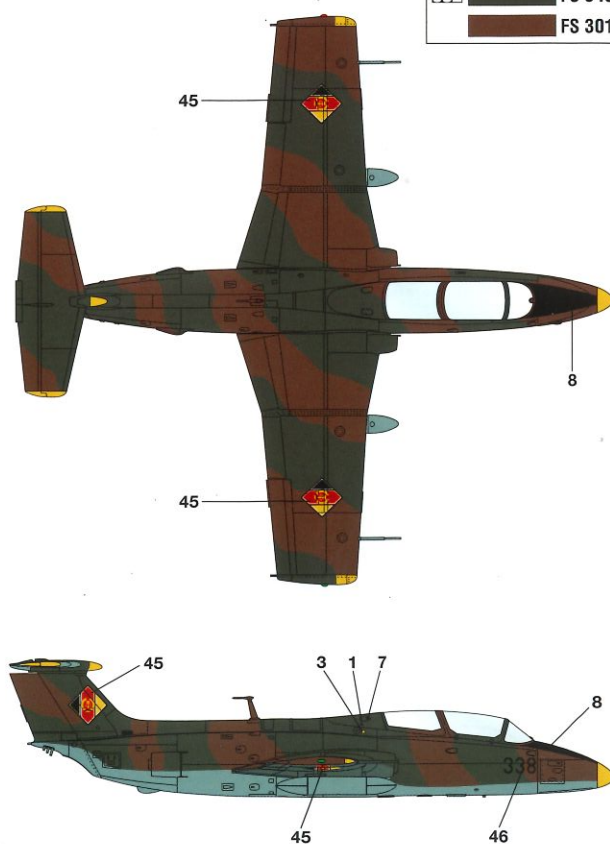

21 伊拉克空軍 Iraqi Air Force

Silver
[8]

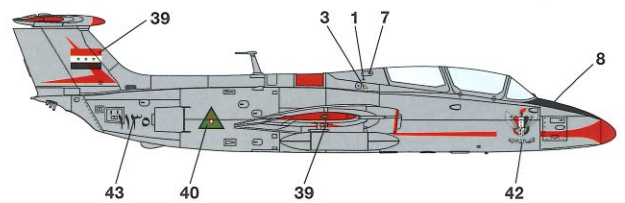
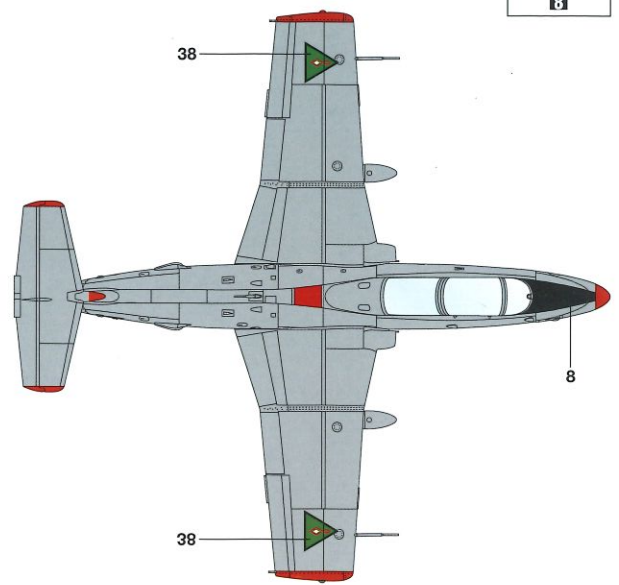
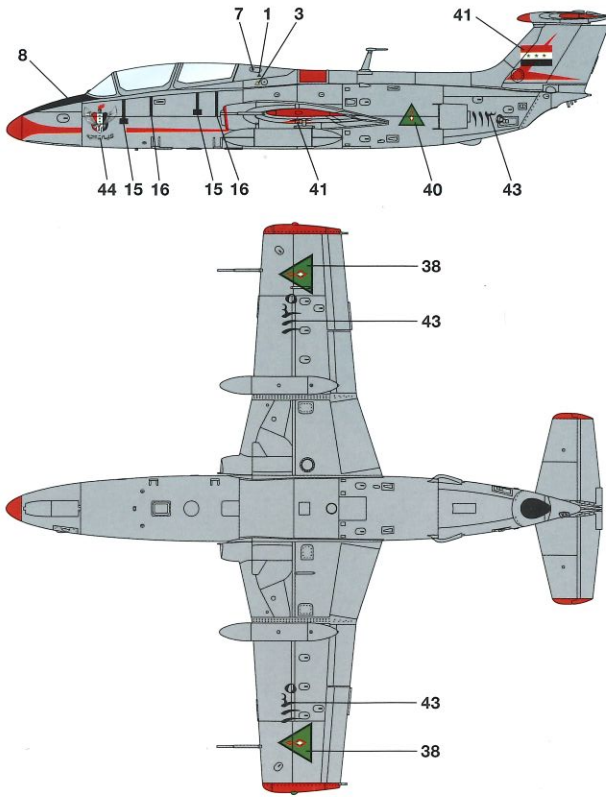

22 印度尼西亞空軍 Indonesian Air Force

Aircraft Gray
[8] 飛機灰色

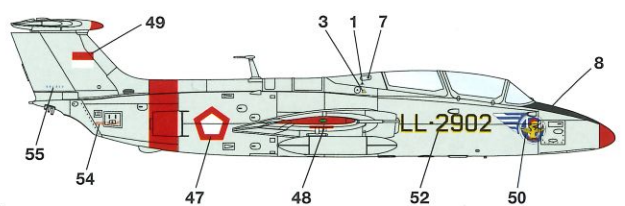
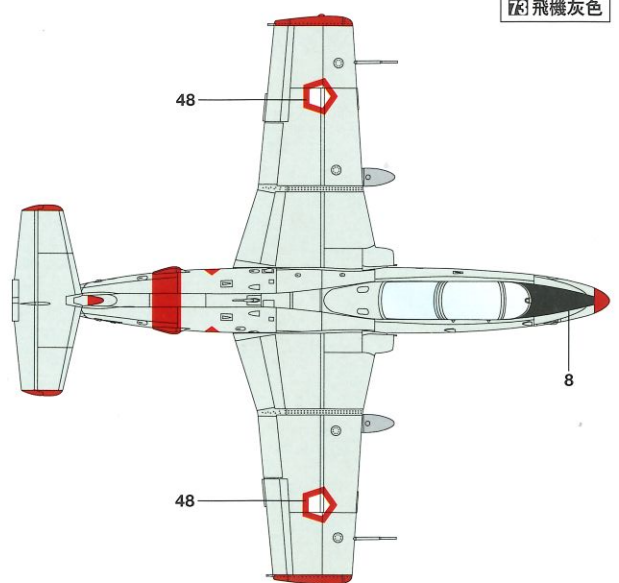
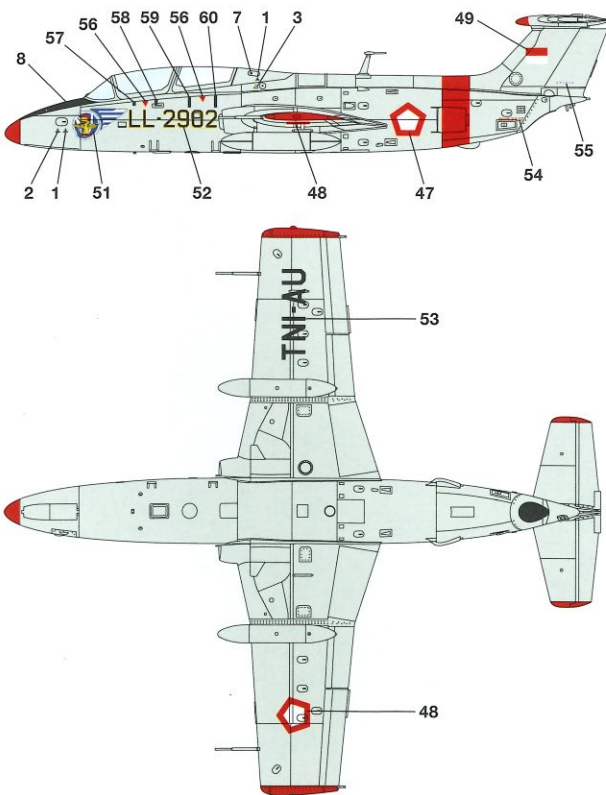

THE AERO L-29 DELFÍN

The Aero L-29 Delfín (English: Dolphin, NATO reporting name: Maya) is a military jet trainer aircraft that became the standard jet trainer for the air forces of Warsaw Pact nations in the 1960s. It was Czechoslovakia's first locally designed and built jet aircraft.



AERO L-29 DELFÍN

1/48 SCALE

www.amkhobby.com

Designed in MACAU
MADE IN CHINA

© Copyright 2013

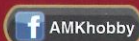

88002