

Sea King Detail Set

This set supplies a selection of fittings for the Hasegawa kit as supplied. It also includes a highly-detailed entry-step assembly, connected to a section of forward cabin floor, together with seats, partitioning, and other fittings.

Parts are included to assist in the modelling of a Sea King with the tail section folded back. The kit is split in this way, but includes no detail.

Assembly -

Section A

1. Fit windscreen wiper units [1 - handed] in place of kit parts B41 & B42. Fit the side window frames [2 - handed] as shown, adding mirrors [3 - handed], and 4. Discard kit parts B37 & B38.

2. Assemble FOD guards from parts 5 & 6,

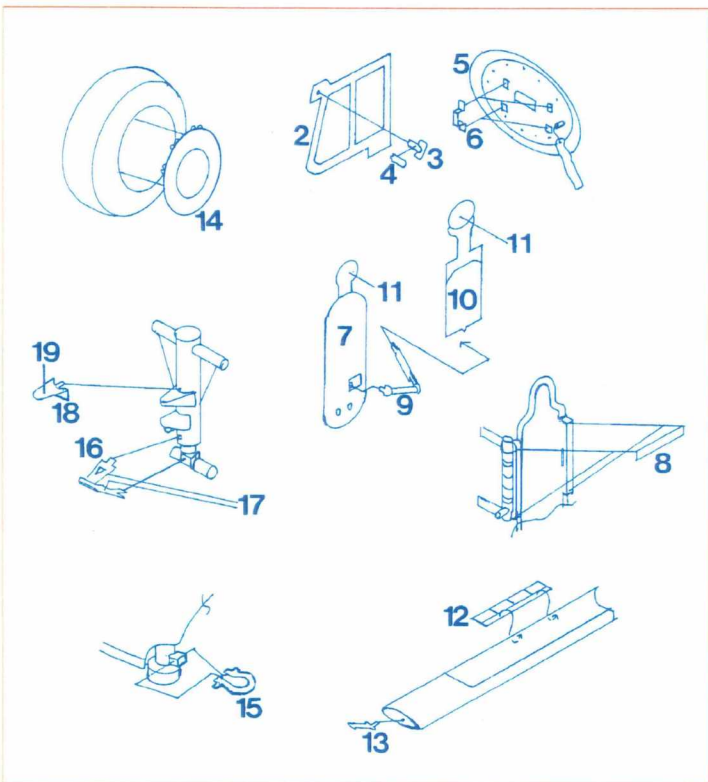

adding an RBF tag [such as those in our Ejector Seat, Canopy Mirrors & HUD Frames Set] onto a piece of fine wire fitted into holes in these parts. Note that the tags are at the rear of the FOD guards when fitted to the aircraft.

3. If you wish to assemble the kit with the tail section folded back, you should assemble and fit parts 7-9 + 1 x part 11 into the rear of the main fuselage halves, and parts 10 & 11 into the tail unit. Parts 12 should be fitted to the mid-outer trailing edges of the five main rotor blades [kit parts C14], and the five static dischargers [13] added to the tips of the blades, as shown.

4. Fit brake hubs [14] to the inside faces of the main wheels [kit parts C11], and assemble torque links from parts 16 & 17 - fitting these to main legs in place of kit parts C17. Assemble parts 18-9 as shown, and fit to the front of the main legs. Laminate shackle rings from parts 15, and fit to rear wheel housing.

Section B

1. Carefully remove the two parts of the crew entry door from the port side fuselage, and clean up the edges. Fit part 1 to the inside face of the upper door section that you have removed. Fit part 2 into the slot in part 1. Set assembly aside.

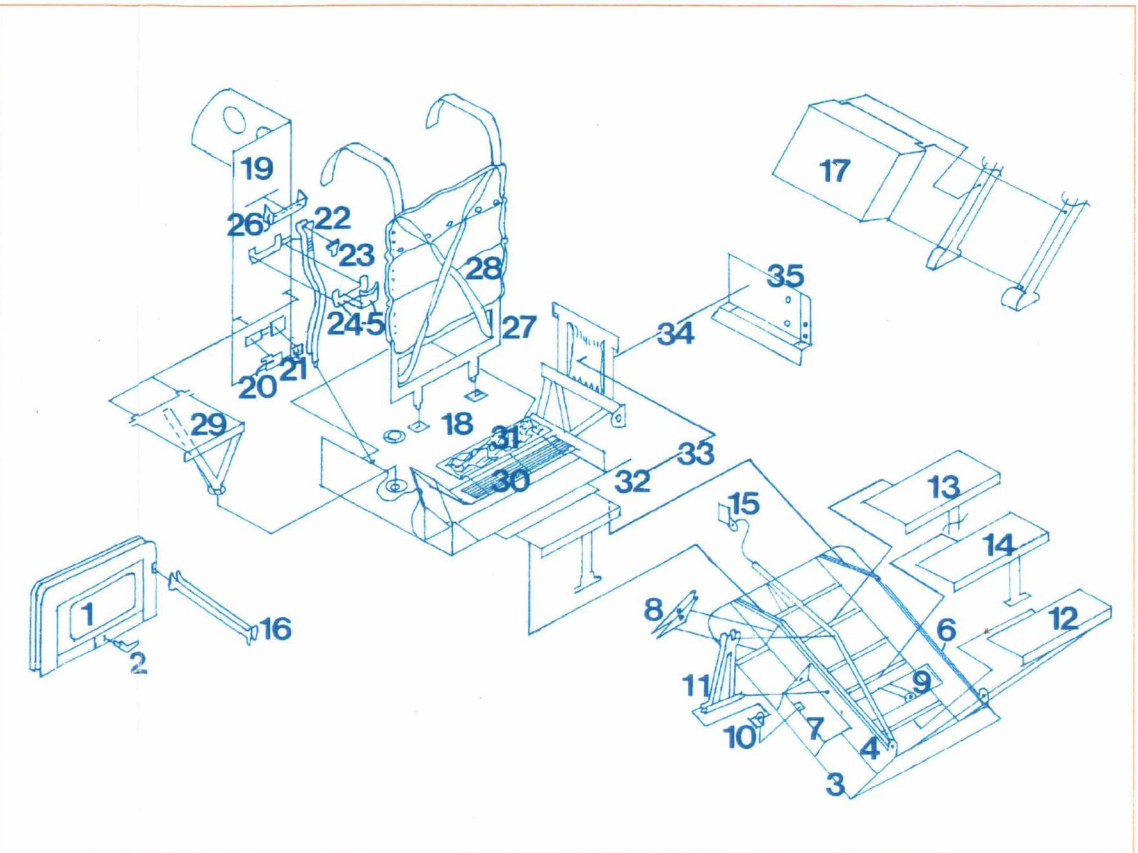

2. Form and fit part 3 to the lower section of the door, and proceed with the assembly of the complete entry step unit using parts 4-14 inclusive.

3. Form and fit part 18 to kit part B1, as shown, and form and add part 19, fixing this also to kit part B52. Add all details to part 19, using parts 20-26 inclusive. Laminate parts 27 & 28 and fit into slots in part 18. Form and add seat [29] into slots in parts 18 & 19.

4. Laminate parts 32 & 33 and fit to the front face of the relevant section of part 18, adding part 34 to the rear. Form and add part 35 to the bottom rear of part 34. Fit part 30 to the outer edge of part 18, adding the non-slip overlay [31] if this is

fitted on the version you are modelling [this detail varies considerably]. Form and fit part 17 to the rear of the LH side cockpit seat supports [kit parts C31 & C32].

5. Join the entry step assembly to part 18, as shown, and fit the two small brackets [15] to the sides of the door opening in the fuselage side. Add grab rails from fine twine [that used in model boat rigging is ideal]. Finally, the upper door unit dealt with in paragraph 1 of this section, can be fitted by use of the strut [laminated from parts 16].