

**STAR
WARS****IMPERIAL SHUTTLE TYDIRIUM™**

Stock No. 8733

mpe
ERTL

Form No. 099 - 8733

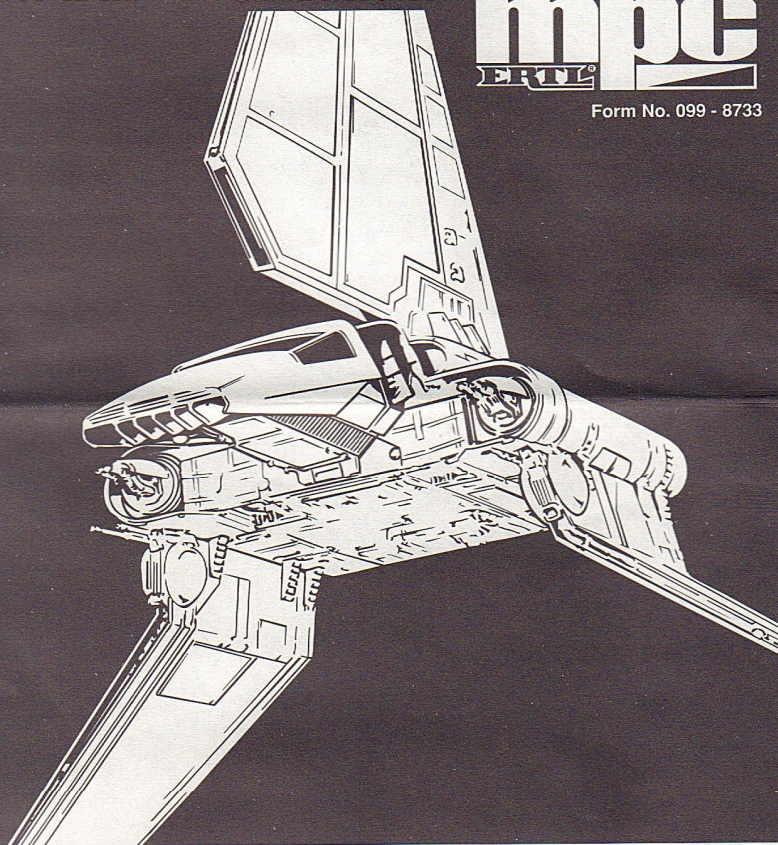

IMPORTANT

Before you begin to assemble your model kit, study the instructions carefully. This will help you to familiarize yourself with the part locations as you proceed. Prior to cementing parts together, be sure to "TEST FIT" them in order to assure proper alignment and also to check for excess "FLASH" that may occur along parting lines. Use a sharp hobby knife or file to remove flash if necessary.

If you wish to paint your model, various sub-assemblies and components should be painted before any parts are attached. During assembly, you may note that the recommended color is stated after the part name.

This model kit is molded from the finest high-impact styrene plastic. Use only paints and cements which are specifically formulated for styrene. Read all labels and warnings carefully. Because the cement will only adhere to bare plastic, it is necessary to remove any paint or "plating" from the area to which the cement is to be applied.

HOBBY KNIFE

Use a sharp hobby knife to remove parts from the trees. Some parts may appear to have an extra "tab" on them, these should be removed.

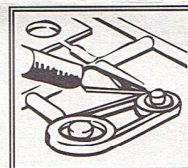

TWEEZERS

Tweezers are handy for holding very small parts during assembly or painting.

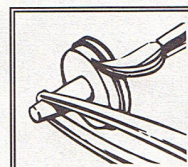

CEMENT

We recommend the use of liquid polystyrene cement. Apply with a fine brush or toothpick. Use cement sparingly or a sloppy job will result.

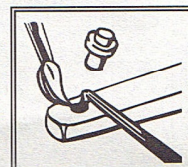

BUILDING TIPS FOR THE ADVANCED MODELER

For the best possible finish, your kit should be painted, even if molded in color. Paint should be applied evenly, in several thin coats rather than one heavy coat. The first coat should not completely cover the surface. Each layer should be allowed to thoroughly dry before the next is applied. Also, each coat should be "wet sanded", except for the final coat, using No.1200 wet or dry sandpaper which is slightly damp. Be careful not to remove any detail while sanding.

It is important to keep your hands clean when working with your model and wash parts thoroughly before painting to remove any mold release agent that may have been used during manufacture, body oil from your hands, sanding residue, and dust, which is naturally attracted to plastic by static electricity. Use a mild solution of dishwashing detergent and water. A tack rag should be used to dry the parts, DO NOT use paper towels or tissues, since they will leave lint on the part.

Parting lines and glue joints should be sanded or filed prior to painting and cementing. Because paint has a tendency to draw away from sharp edges, they should be lightly filed. Use filler putty designed for plastic to fill small gaps that may occur between parts and to blend contours. This should be done only after the first, or "primer," coat of paint is applied.

When painting a two-tone body, the lightest color should be painted first. Use frosted, or "magic," tape to mask off the area you do not want painted. After the second color is dry to the touch, the tape can be removed. Use a very fine brush to touch up edges if necessary. If decals are to be added, do so before adding any gloss coat. A gloss coat will help even out the edges between the two colors as well as set the decals.

We take great pride in providing the finest model kits available, giving strong attention to detail and craftsmanship. Should you have any difficulty with assembly or missing parts, please call the appropriate number listed below between the hours of 8:00 am to 4:30 pm central time, Monday through Friday.

In the U.S.A. call toll free 1 - 800 - 553 - 4886
Outside of the United States call 1 - 319 - 875 - 2000

When in the Midwest, please visit the ERTL Company for a tour of the AMT production facilities, 10am & 1pm weekdays. Reservations suggested.

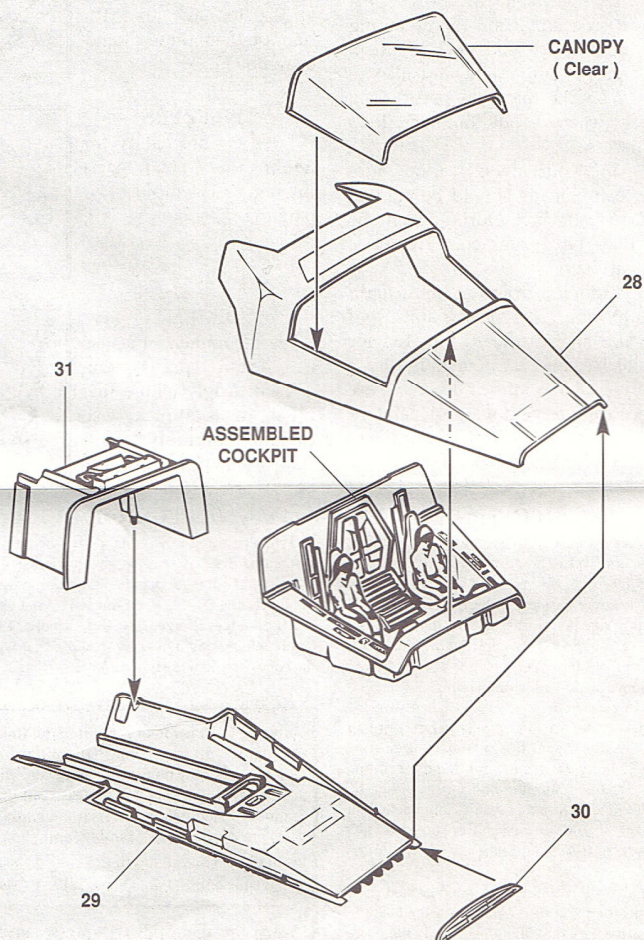
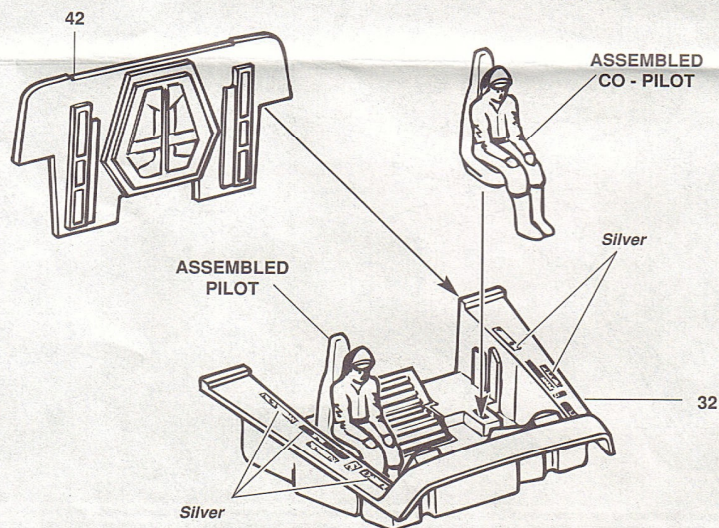
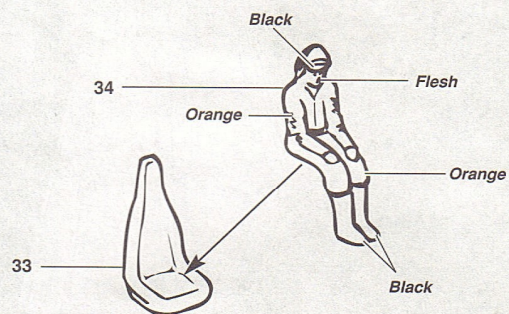

NOTE: * - DO NOT CEMENT

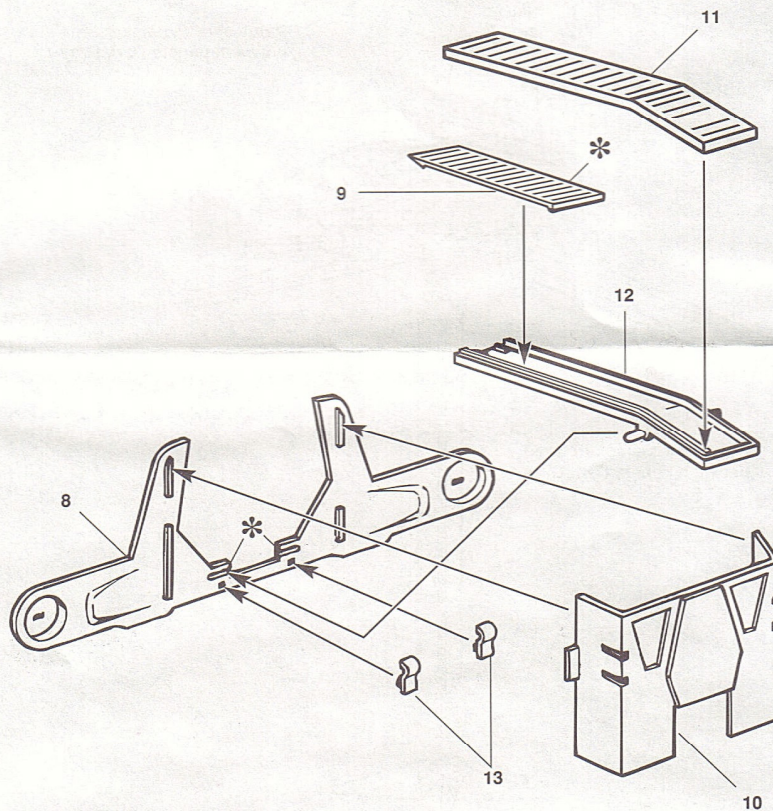

NOTE: After parts 37 and 39 have been cemented together, press parts 41A and 41B together.

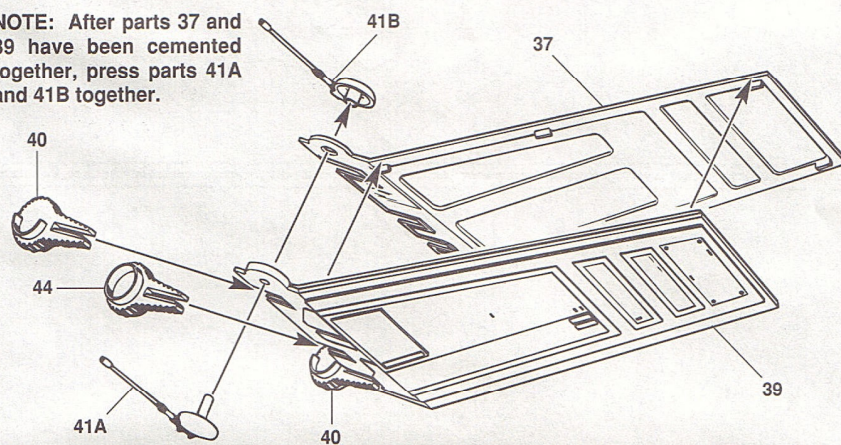

B

NOTE: After parts 36 and 38 have been cemented together, press parts 41A and 41B together.

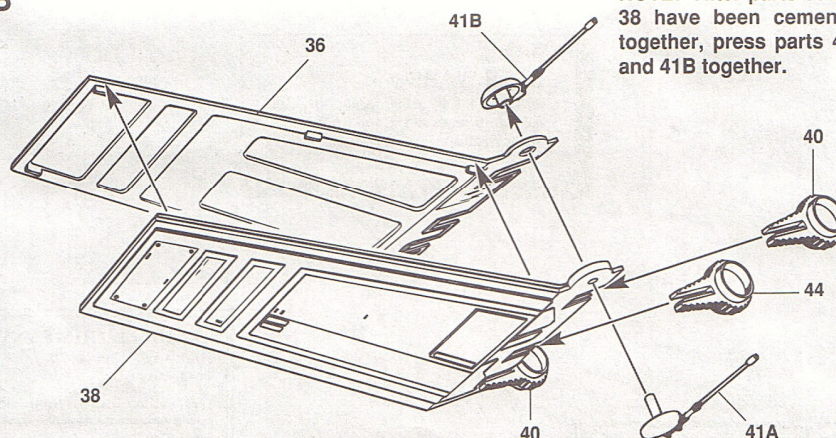

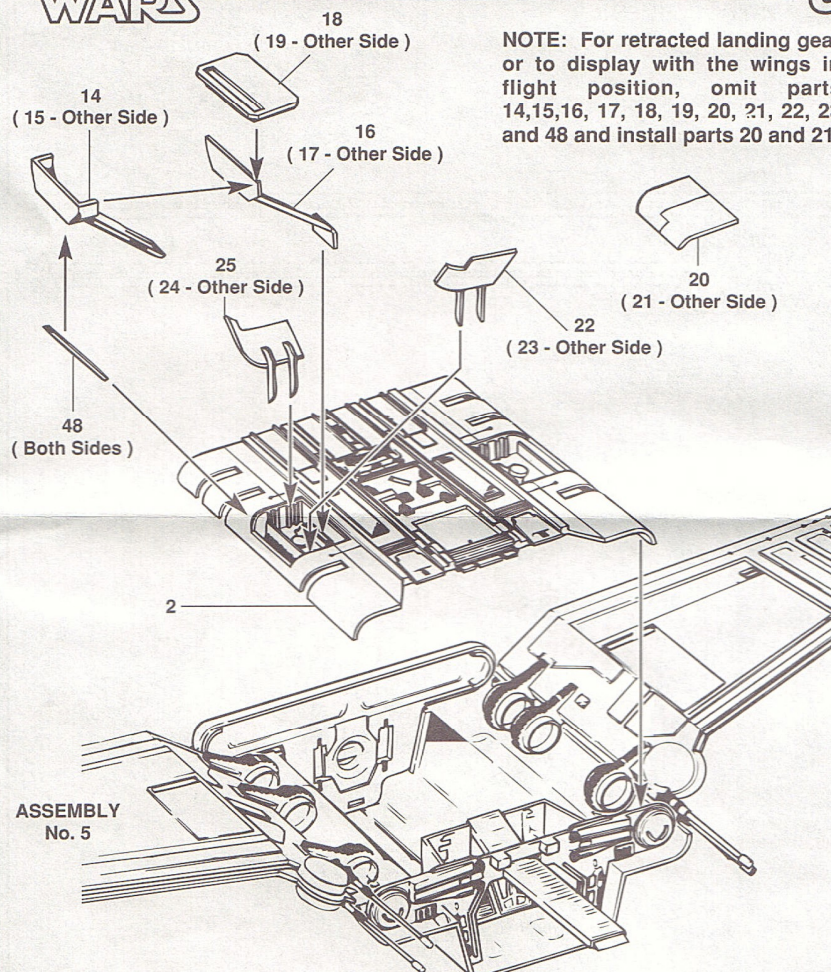
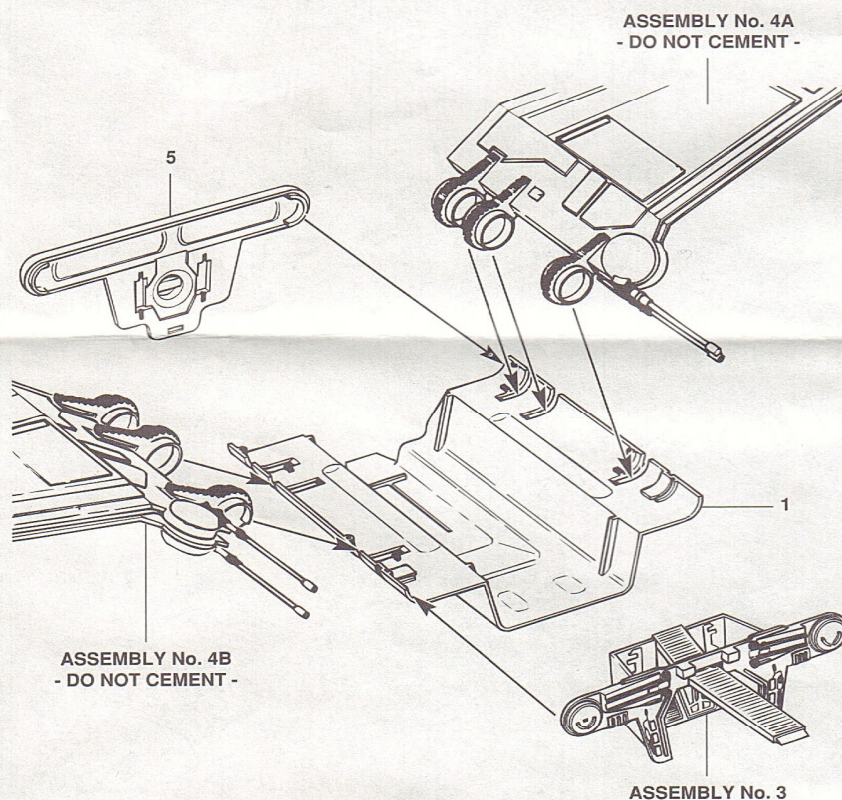

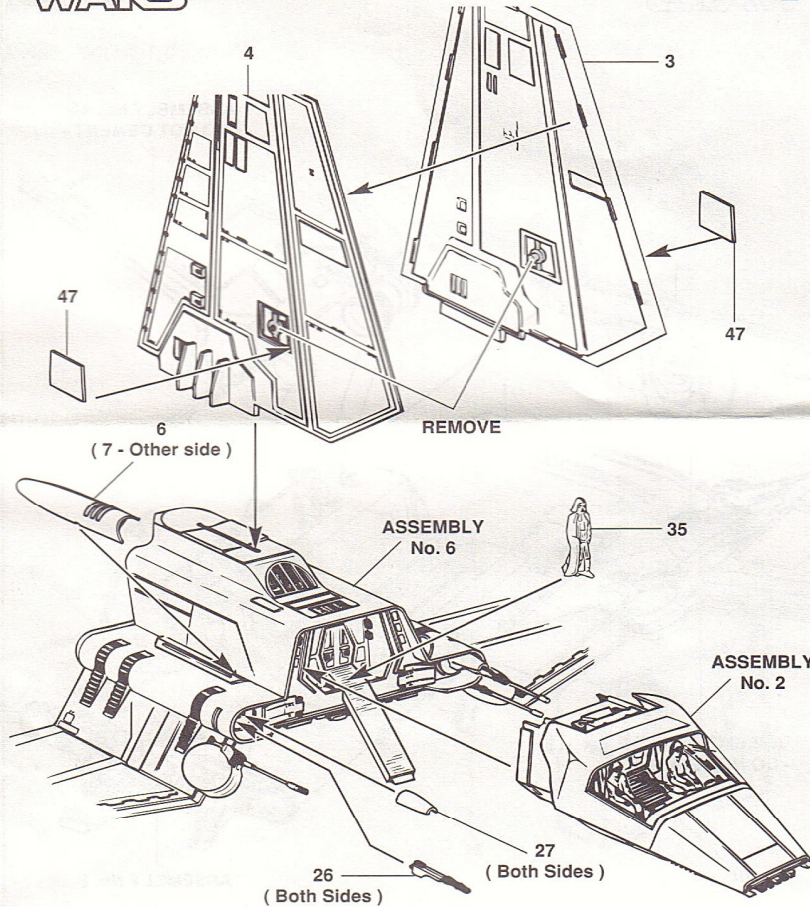

NOTE: To lock the ramp in the retracted position, slide the ramp into the recessed opening.
DO NOT CEMENT.

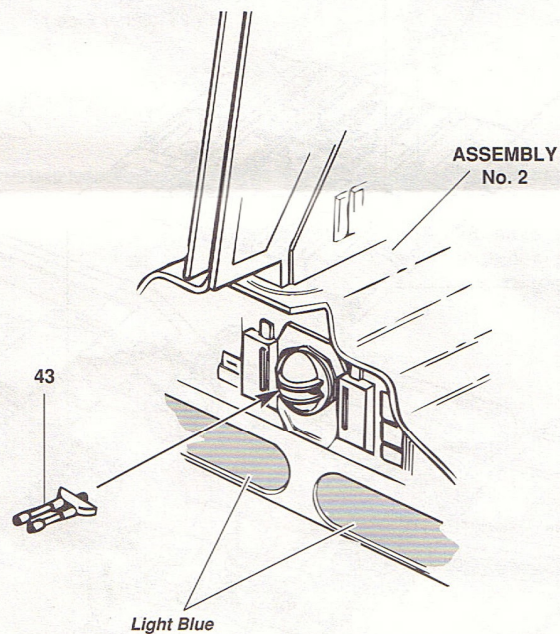
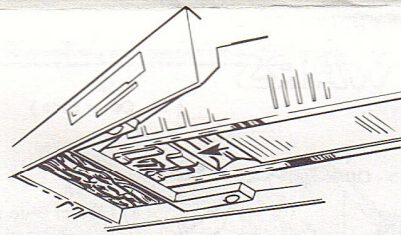

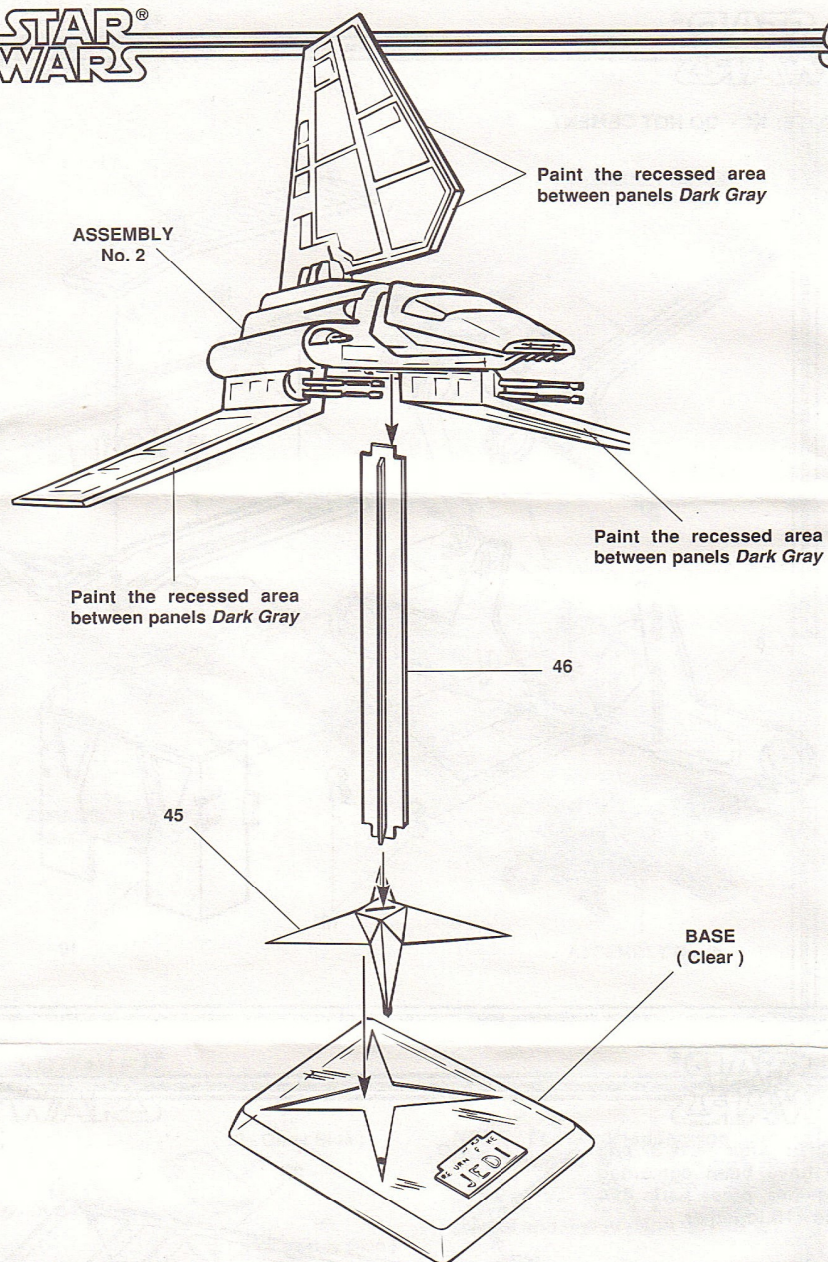

STAR WARS®

©, TM & © 1982, 1990 Lucasfilm Ltd.
All rights reserved. Used under
authorization.

The ERTL COMPANY, Inc.
Highways 136 & 20
P. O. Box 500
Dyersville, Iowa 52040 - 0500
Printed in the U. S. A.