

F/A-18C



F/A-18C VFA-27 Royal Maces

The F/A-18 Hornet is an all-weather jet aircraft that is used by the U.S. Navy and Marine Corps as both a fighter and attack platform. In its fighter mode, the F/A-18 is used primarily as a fighter escort and for fleet air defense; in its attack mode, it is used for force projection, interdiction and close and deep air support.

The F/A-18 demonstrated its capabilities and versatility during Operation Desert Storm, shooting down enemy fighters and subsequently bombing enemy targets with the same aircraft on the same mission, and breaking all records for tactical aircraft in availability, reliability, and maintainability. The F/A-18 is a twin engine, mid-wing, multi-mission tactical aircraft.

All F/A-18s can be configured quickly to perform either fighter or attack roles or both, through selected use of external equipment to accomplish specific missions. This "force multiplier" capability gives the operational commander more flexibility in employing tactical aircraft in a rapidly changing battle scenario. The fighter missions are primarily fighter escort and fleet air defense; while the attack missions are force projection, interdiction, and close and deep air support.

The F/A-18C and D models are the result of a block upgrade in 1987 incorporating provisions for employing updated missiles and jamming devices against enemy ordnance. C and D models delivered since 1989 also include an improved night attack capability.

Strike Fighter Squadron 27 (VFA-27), also known as the "Royal Maces". They are a part of Carrier Air Wing 5 and are attached to the aircraft carrier USS Ronald Reagan. Their tail code is NF.

CAUTION

- *Read carefully and fully understand the instructions before commencing assembly.
- *Keep out of reach of children. Children must not be allowed to put any parts in their mouths, or pull plastic bag over their heads.
- *When using adhesives and paints, please make sure not to use them in closed room or near the fire.
- *When assembling this kit, tools including knives are used. Extra care should be taken to avoid injury.

WARNING: CONTAIN SMALL PARTS NOT FOR CHILDREN UNDER 14 YEARS OF AGE.



TOOLS RECOMMENDED



AFTERMARKET SERVICES CARD

When requesting replacement parts, please take or send this form to your local dealer so that the parts required can be correctly identified. Please note that specifications and availability are subject to change without notice. Or visit <http://www.kineticmodel.com> for latest information. For more information, please contact services@kineticmodel.com

Part Code	K48114	Qty	Item	Part Code	Qty	Item	
00-100-021	WEAPON SET(AIM-9X, 120B/C, GUB-12) PART	2	M	00-112-006	1/48 F/A-18 FUELTANKS, PYLON F	1	F
00-100-032	SNIPER XR POD PARTS II	1	II	00-112-007	1/48 F/A- 18 A/C CANOPY G	1	G
00-103-006	CLEAR PARTS FOR AGM-84	1	G	00-112-008	1/48 F/A-18 COCKPIT, LANDING GEAR H	1	H
00-103-009	AGM-84E/G	1	F	00-112-009	1/48 F/A- 18 A/C PARTS I	1	I
00-103-014	SLAM E-R	1	A	00-112-012	1/48 F/A-18 COMMON CLEAR PARTS L	1	L
00-112-001	1/48 F/A-18 UPPER FUESLAGE A	1	A	01-103-003	WEAPON STENCIL	1	DECAL
00-112-002	1/48 F/A-18 LOWER FUESLAGE B	1	B	01-112-48114	1/48 F/A-18C	1	DECAL
00-112-003	1/48 F/A-18 FLAPS C	1	C	03-112-48114	1/48 F/A-18C MANUAL	1	MANUAL
00-112-004	1/48 F/A-18 C/D VERTICAL TAIL D	1	D	06-112-48033	1/48 F/A-18A/B/C/D/ATARS	1	PE
00-112-005	1/48 F/A-18 WHEEL, PYLONS E	1	E	00-103-015	AGM-154 JSOW	1	B

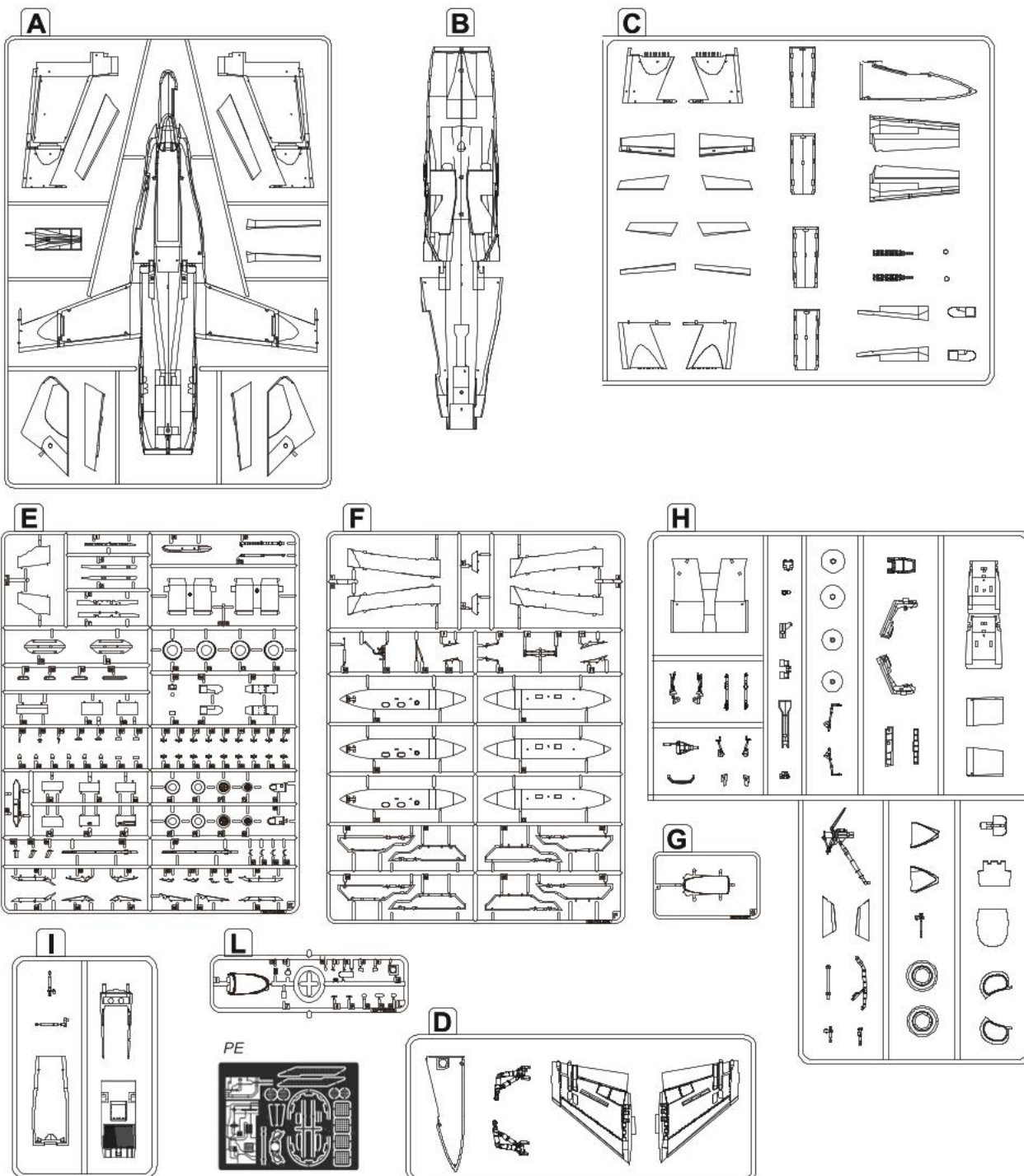

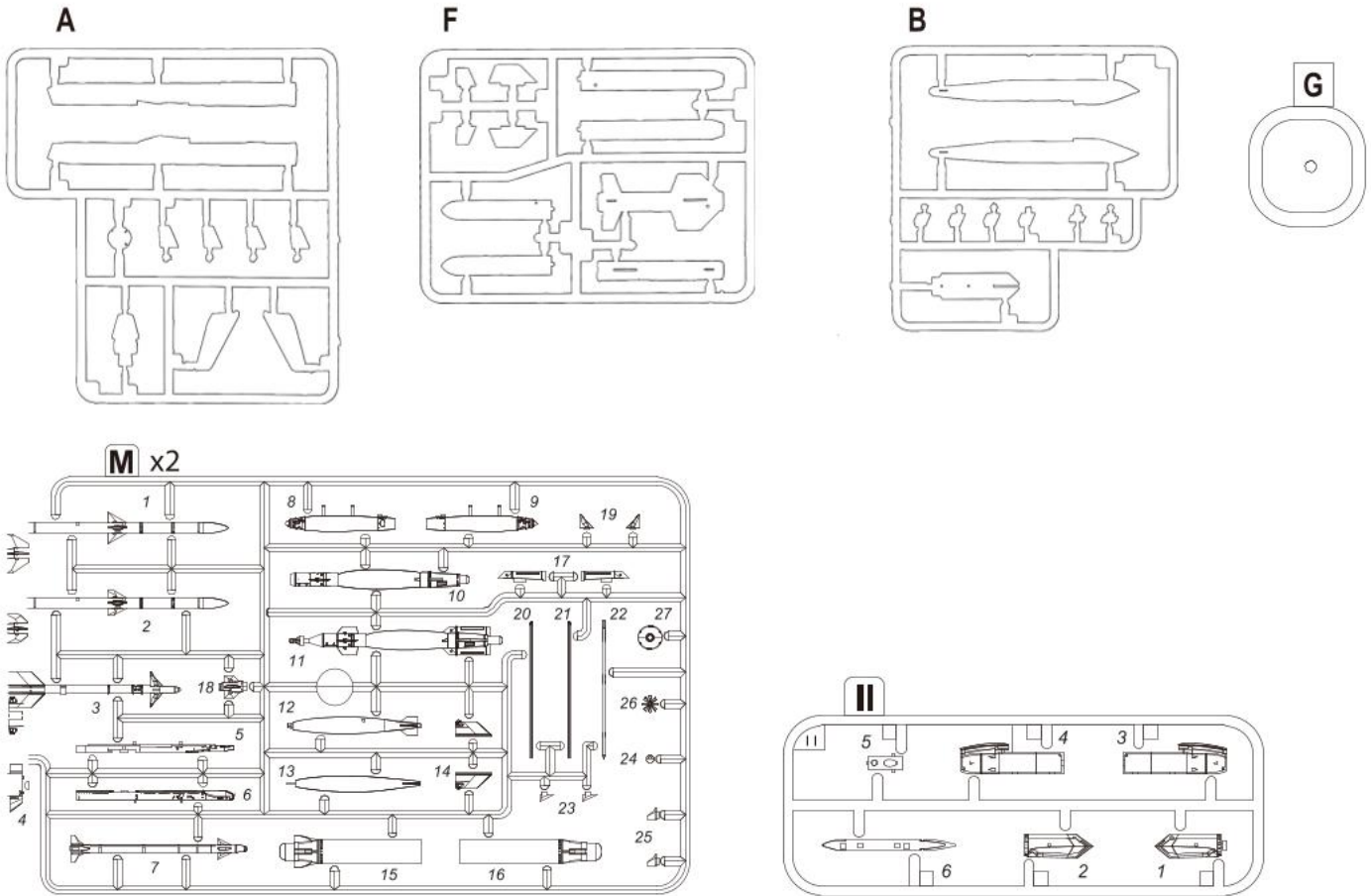

PAINT INDEX

COLOR	AMMO MIG	VALLEJO MODEL COLOR	GSI CREOS MR. COLOR	TAMIYA ENAMEL/ACRYLIC	HUMBROL ENAMEL
DUNKELGELB AUS '44 DG I	A.MIG-011	830	-	XF62	66
SATIN BLACK	A.MIG-032	861	2	-	21
OLD WOOD	A.MIG-036	879	81	-	-
GUN METAL	A.MIG-045	863	76	XF56	53
MATT BLACK	A.MIG-046	950	12	XF1	33
SATIN WHITE	A.MIG-047	842	1	-	22
YELLOW	A.MIG-048	953	413	XF3	15
RED	A.MIG-049	957	-	XF07	153
MATT WHITE	A.MIG-050	951	11	XF2	34
CRYSTAL RED	A.MIG-093	934	-	-	220
CRYSTAL PERISCOPE GREEN	A.MIG-096	936	-	-	-
CRYSTAL ORANGE	A.MIG-097	935	-	-	-
CRYSTAL LIGHT BLUE	A.MIG-098	938	-	-	-
MEDIUM BLUE	A.MIG-103	71.090	328	-	-
A.MIG-908	A.MIG-119	71.219	-	-	-
GOLD YELLOW	A.MIG-125	996	-	-	-
FADED YELLOW	A.MIG-130	71.270	318	-	-
SILVER	A.MIG-195	997	8	XF16	11
LIGHT COMPASS GHOST GRAY	A.MIG-203	70.990	308	-	-
GHOST GRAY	A.MIG-208	991	317	XF54	27
MEDIUM GRAY	A.MIG-211	989	-	XF19	127
INTERMEDIATE BLUE	A.MIG-228	867	36	XF54	79
GRAY BASE	A.MIG-908	70.995	301/339	-	-
FS30219	A.MIG-202	71.125	310	XF-59	118
FS33538	-	71.078	-	-	-

For Color Profile, please go to www.kineticmodel.com for download (type the kit# and go for manual/painting guide)

1

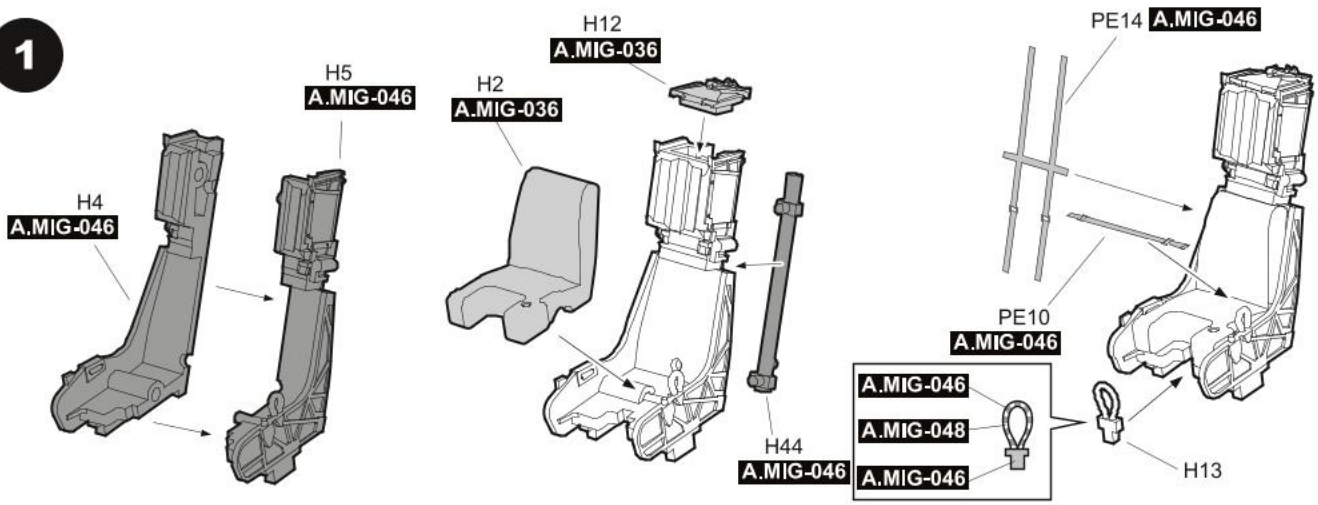

2

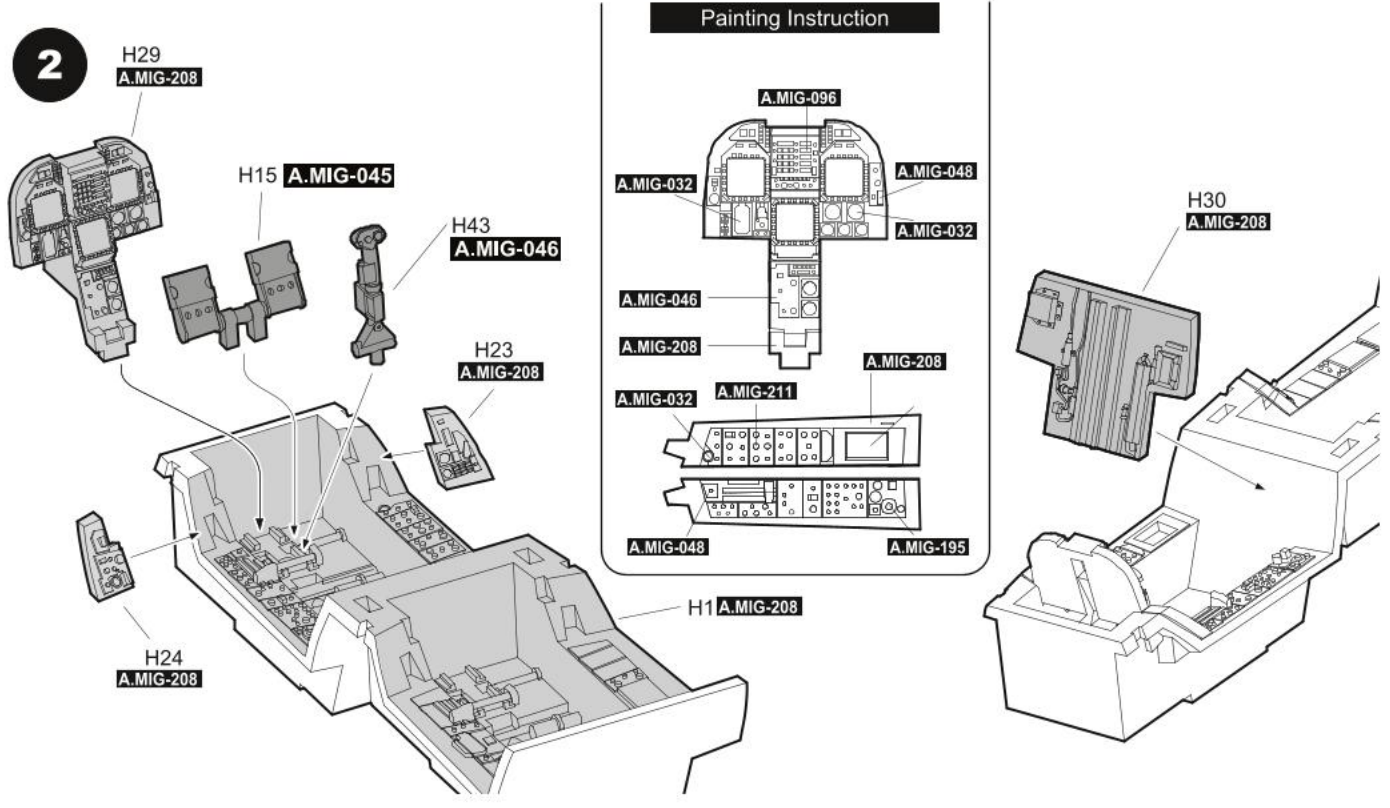

3

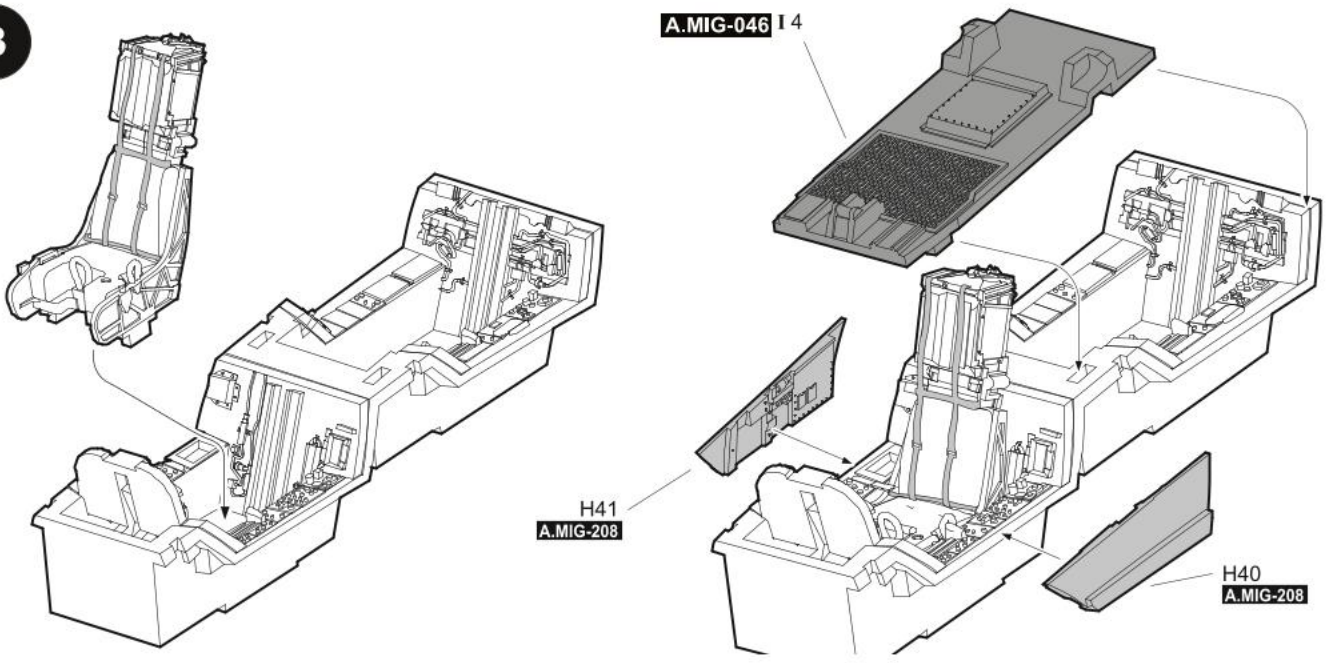

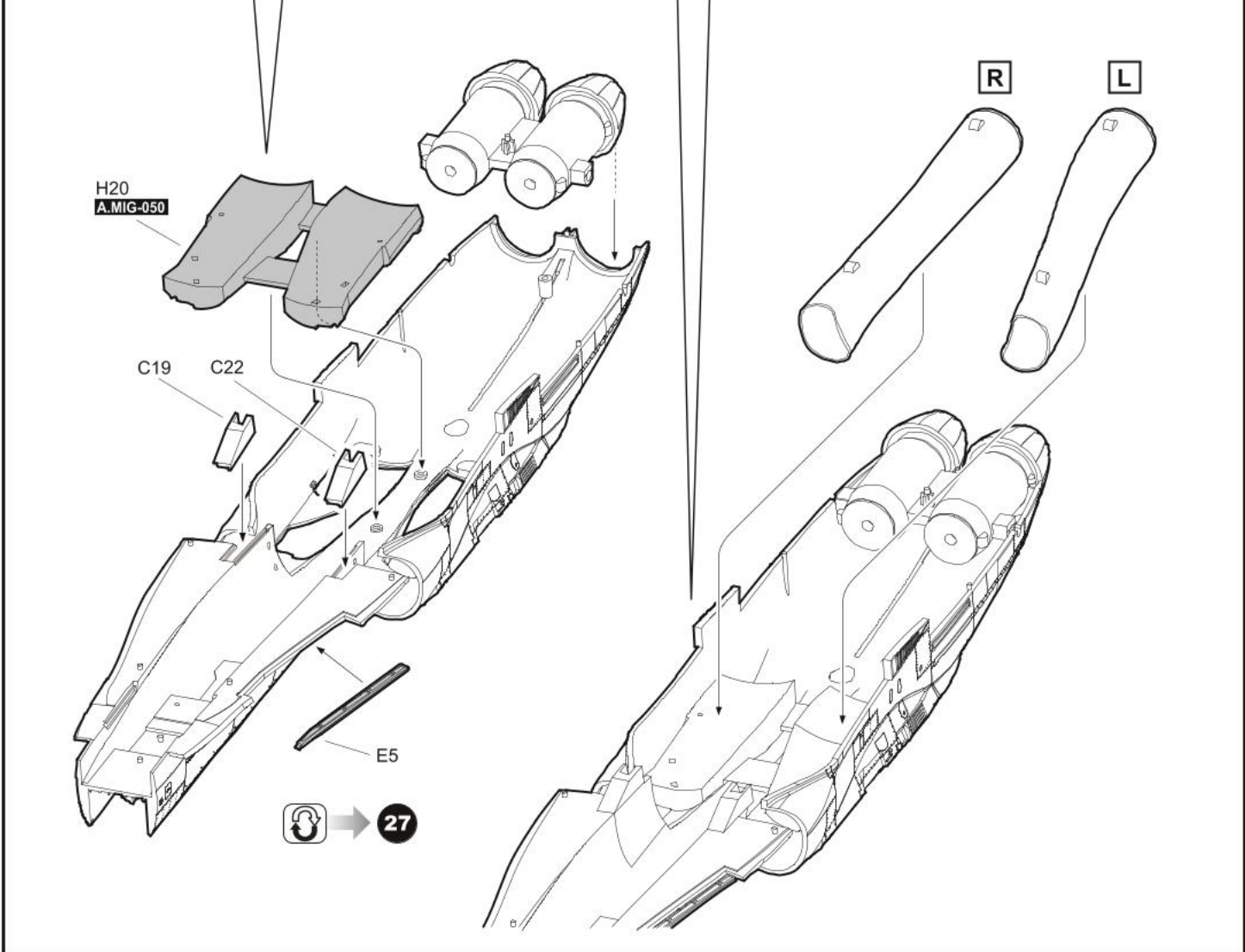
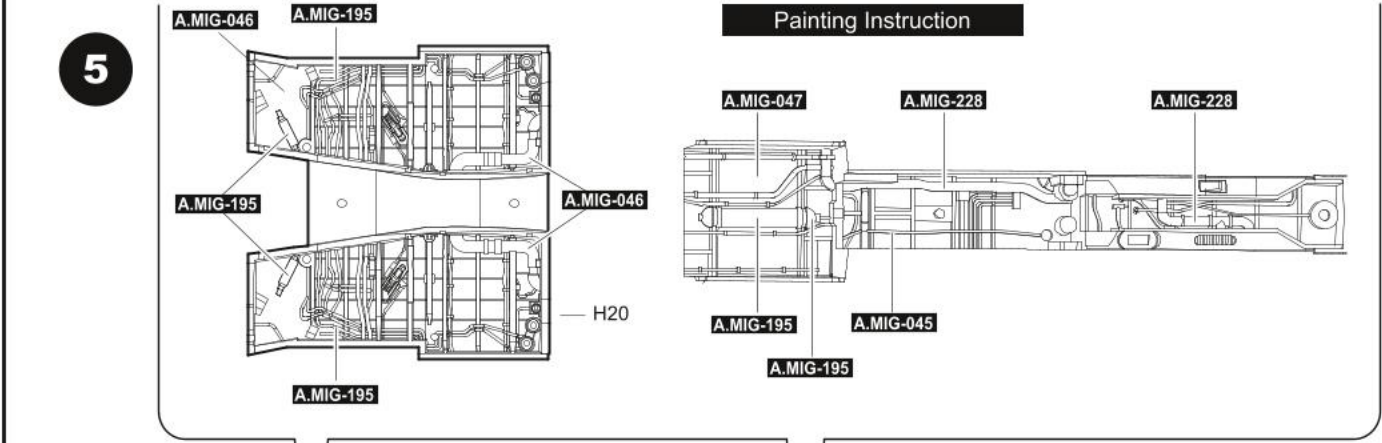
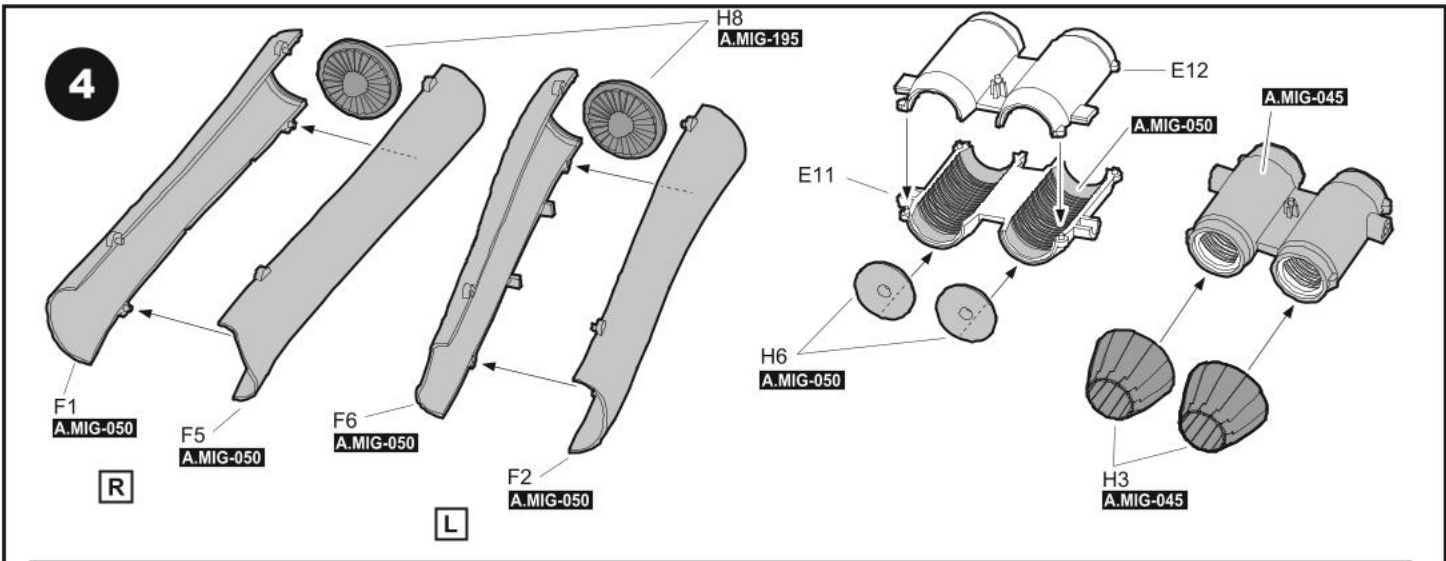

6

Refuelling Probe Open



Refuelling Probe Close

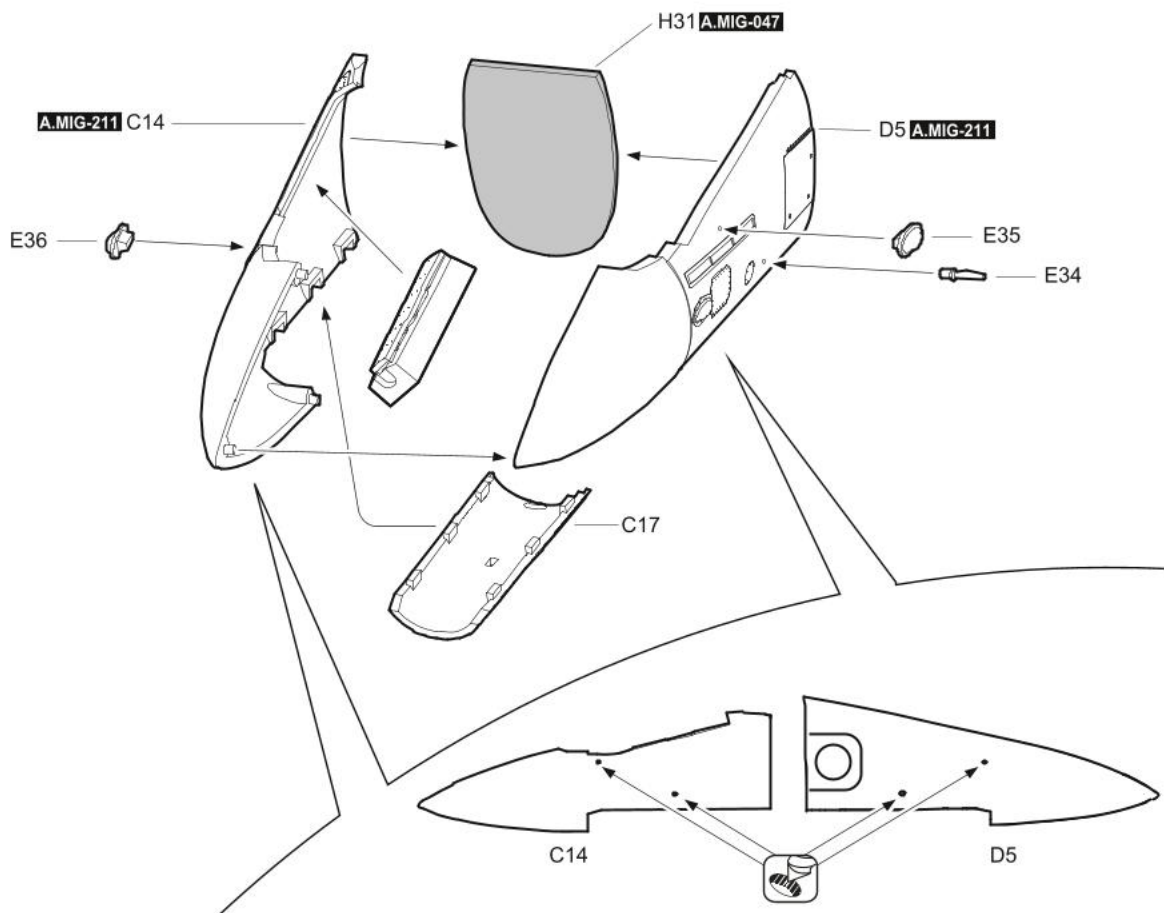
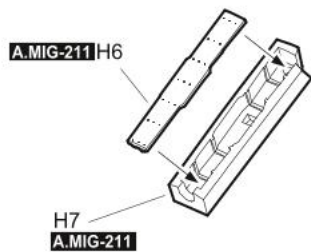
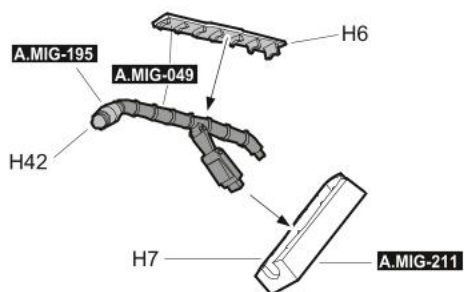

7

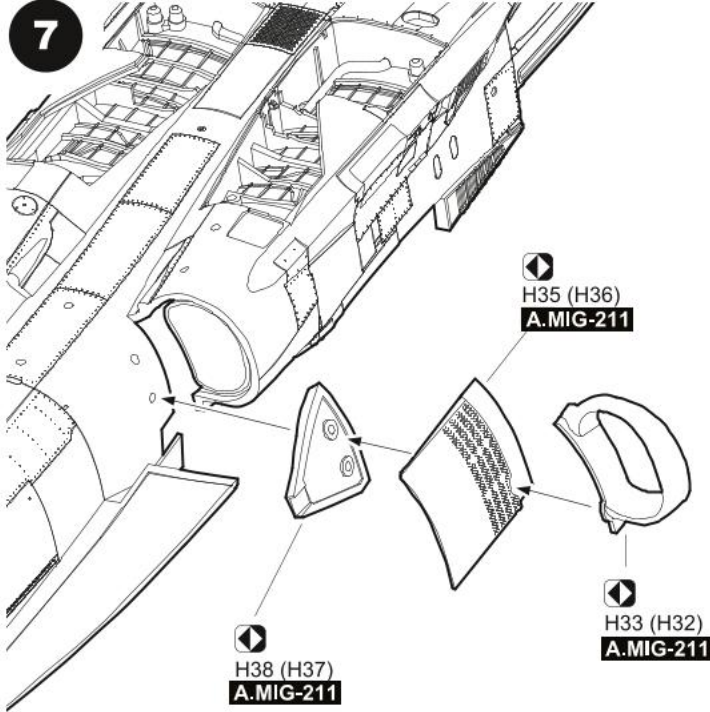

8

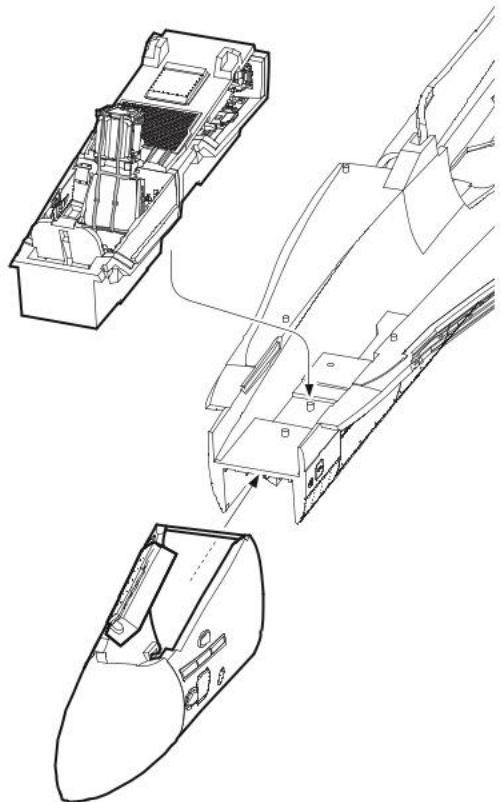

9

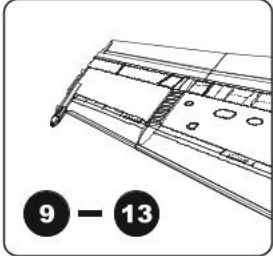

Wings extended

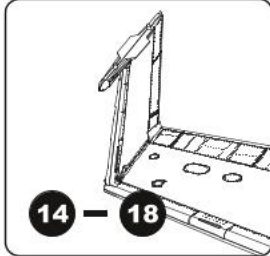

Fold Wings

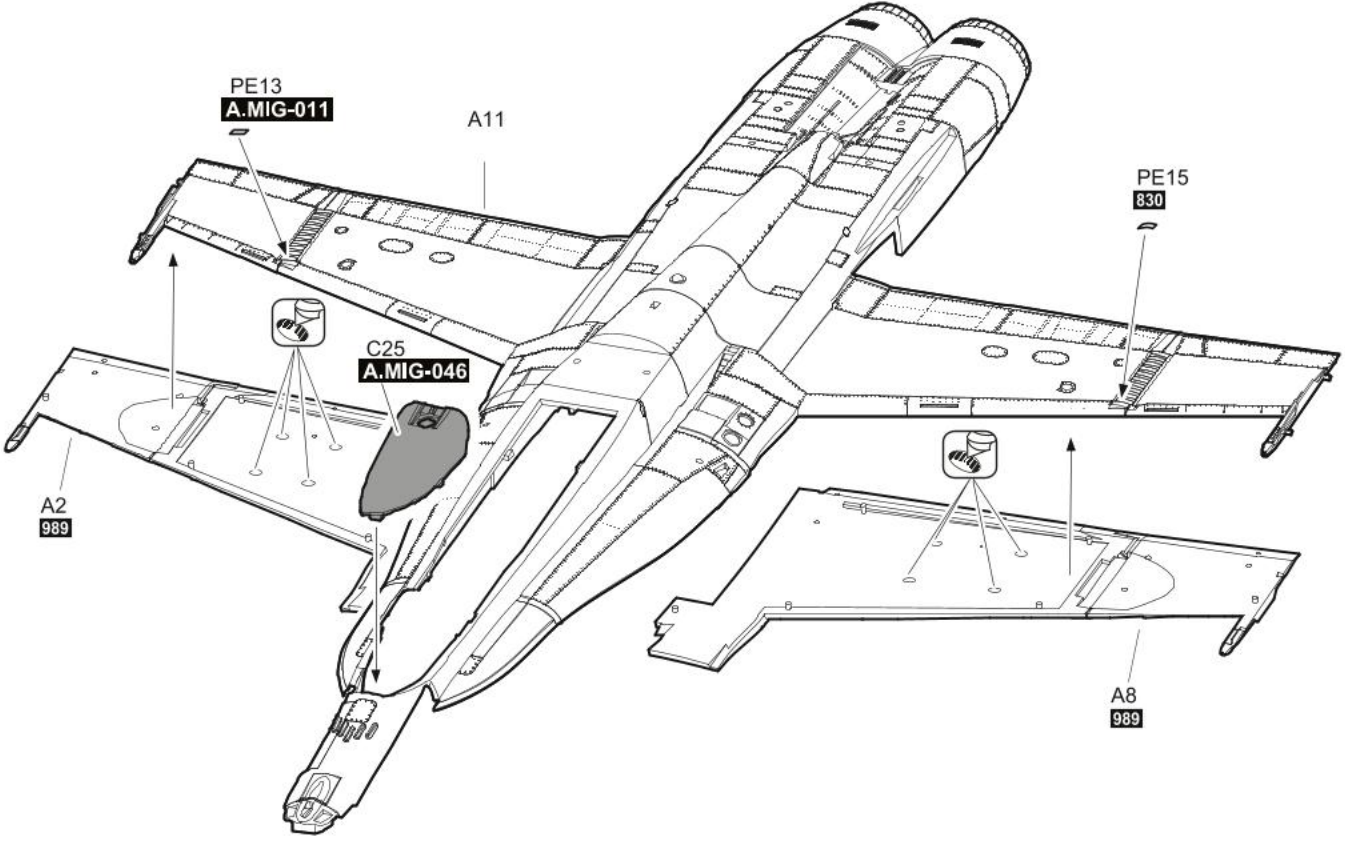

10

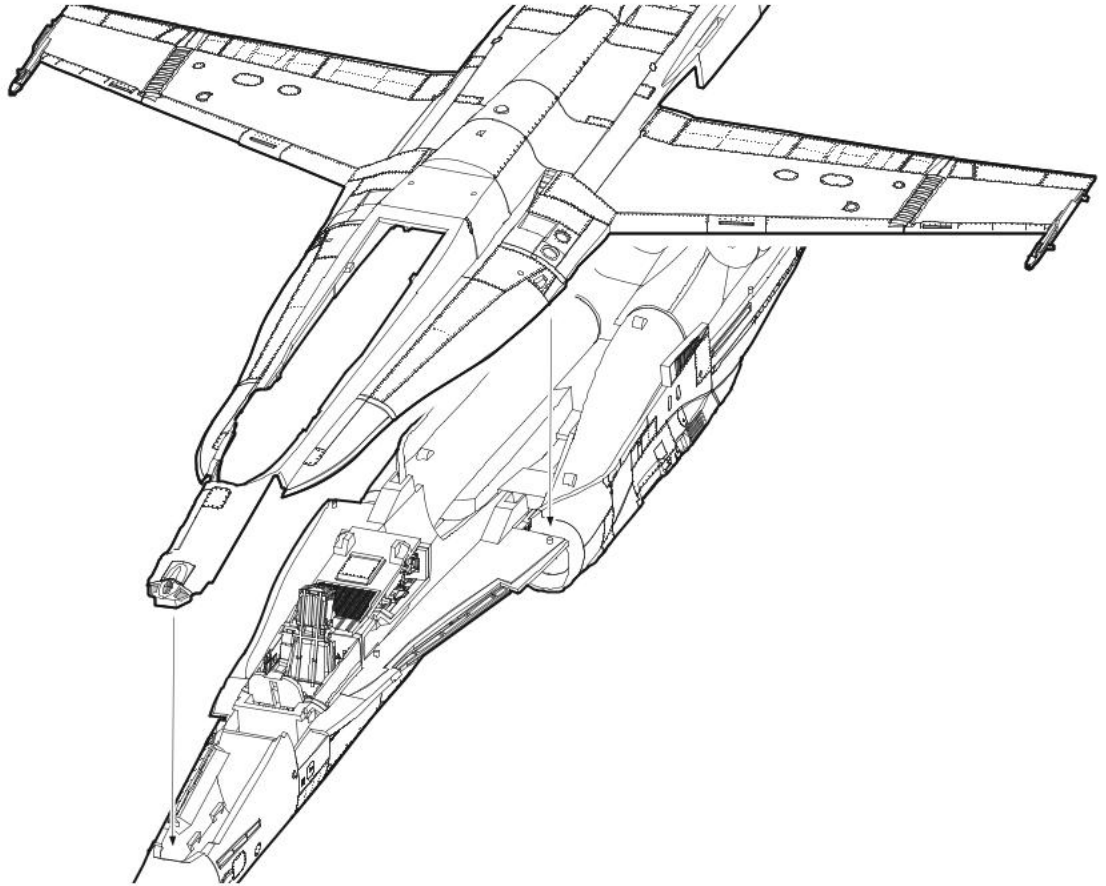

11

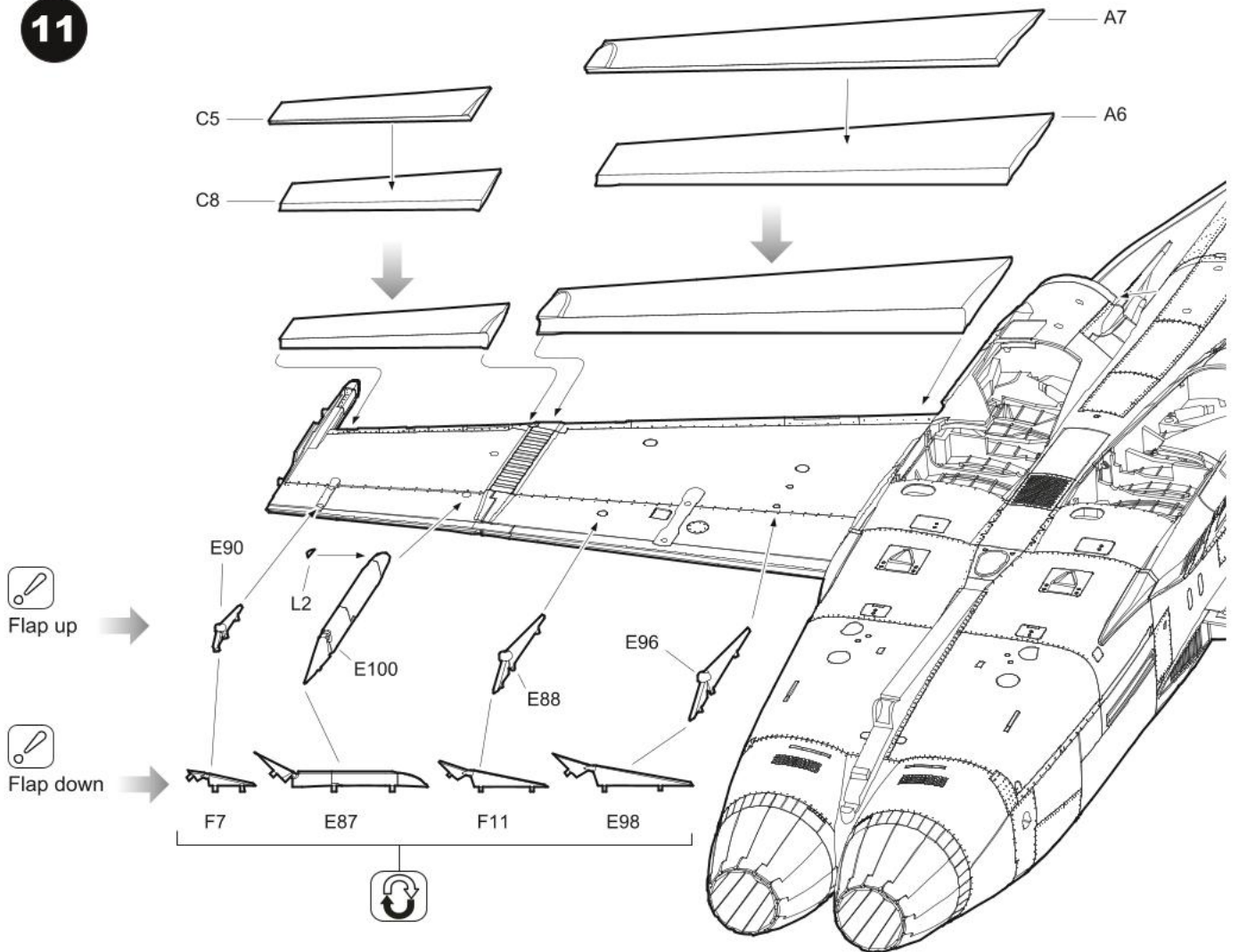

12

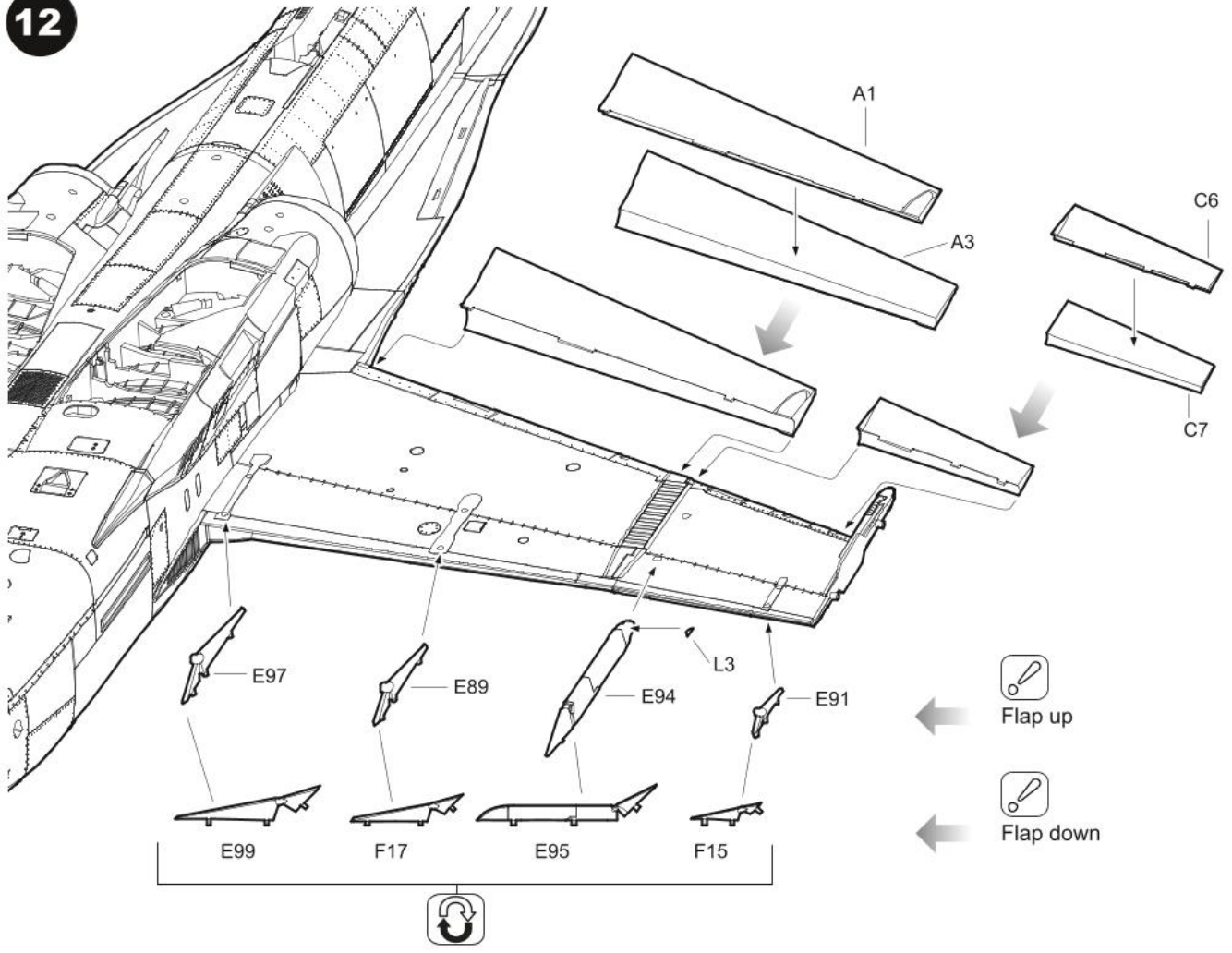

13

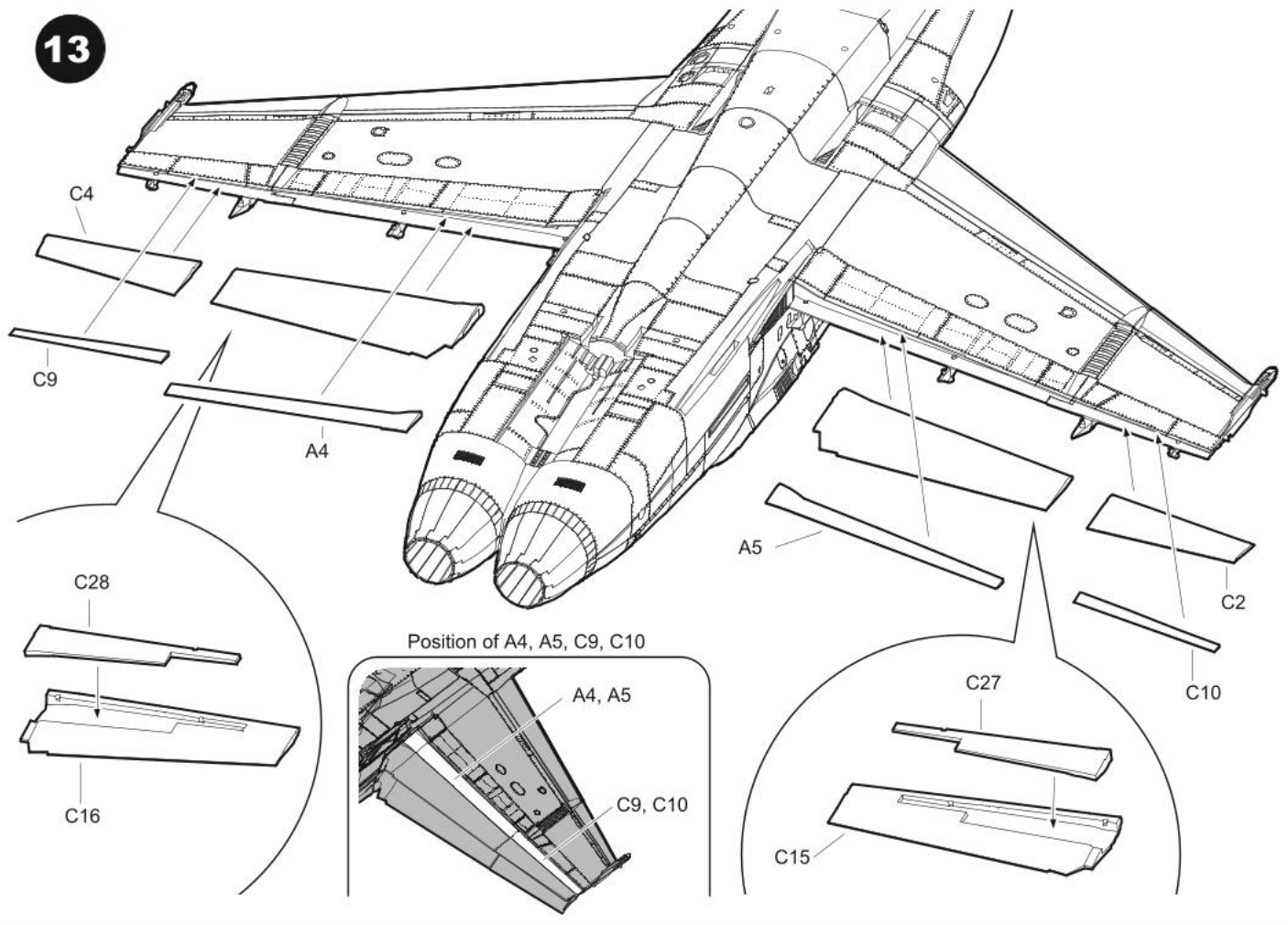

14

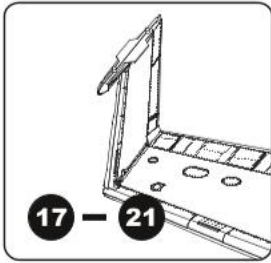

Fold Wings

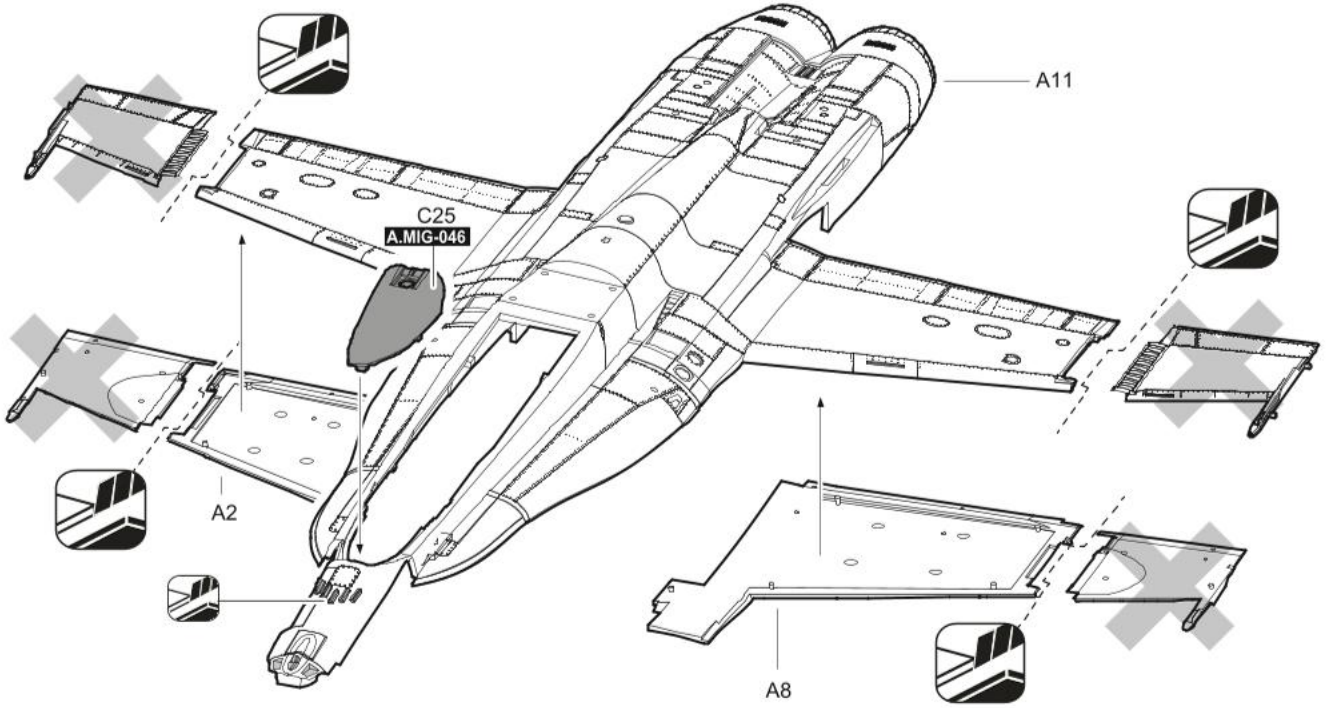

15

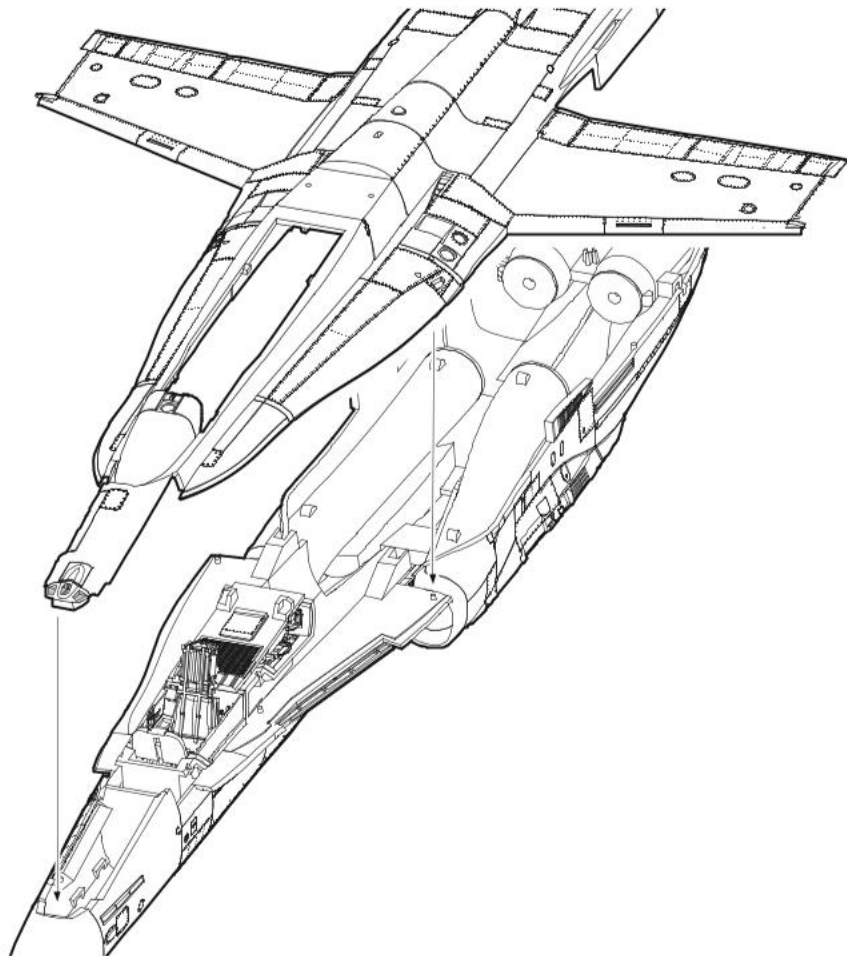

16

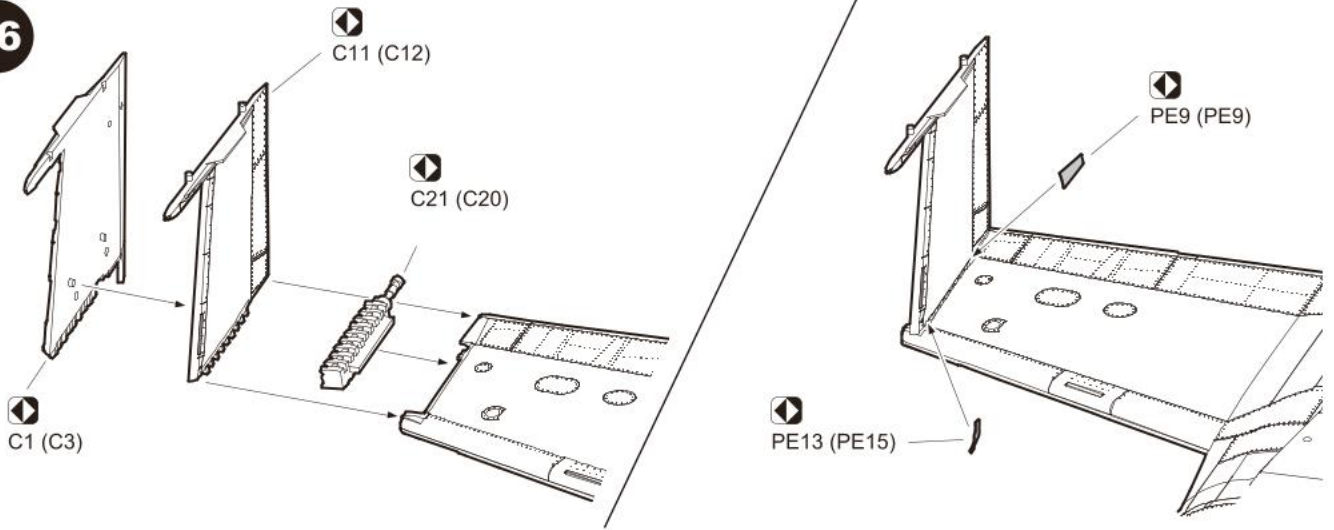

17

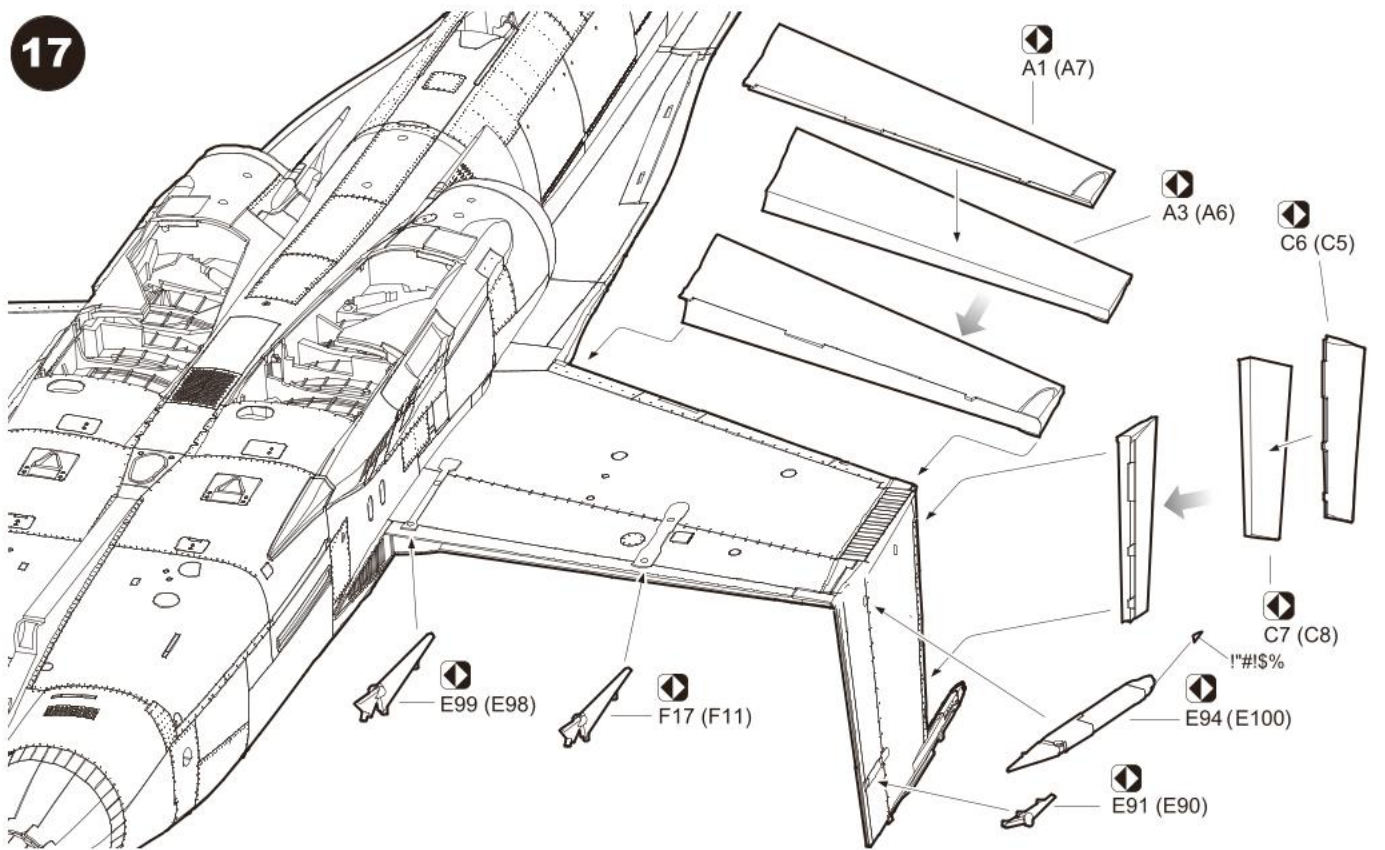

18

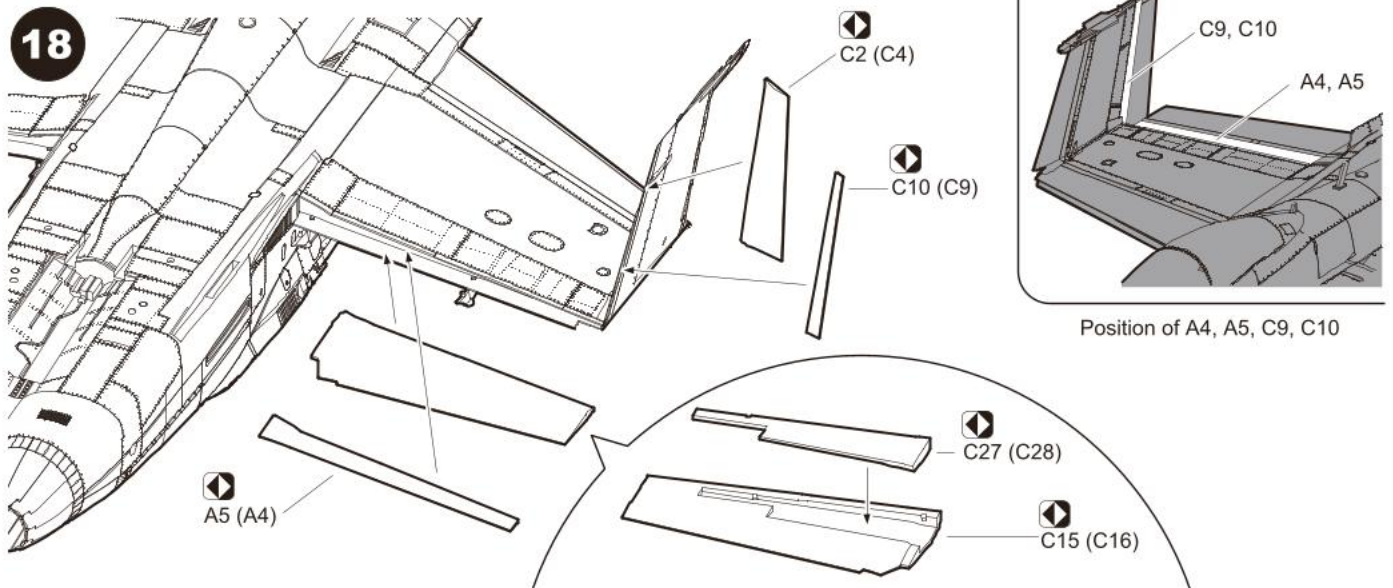

19

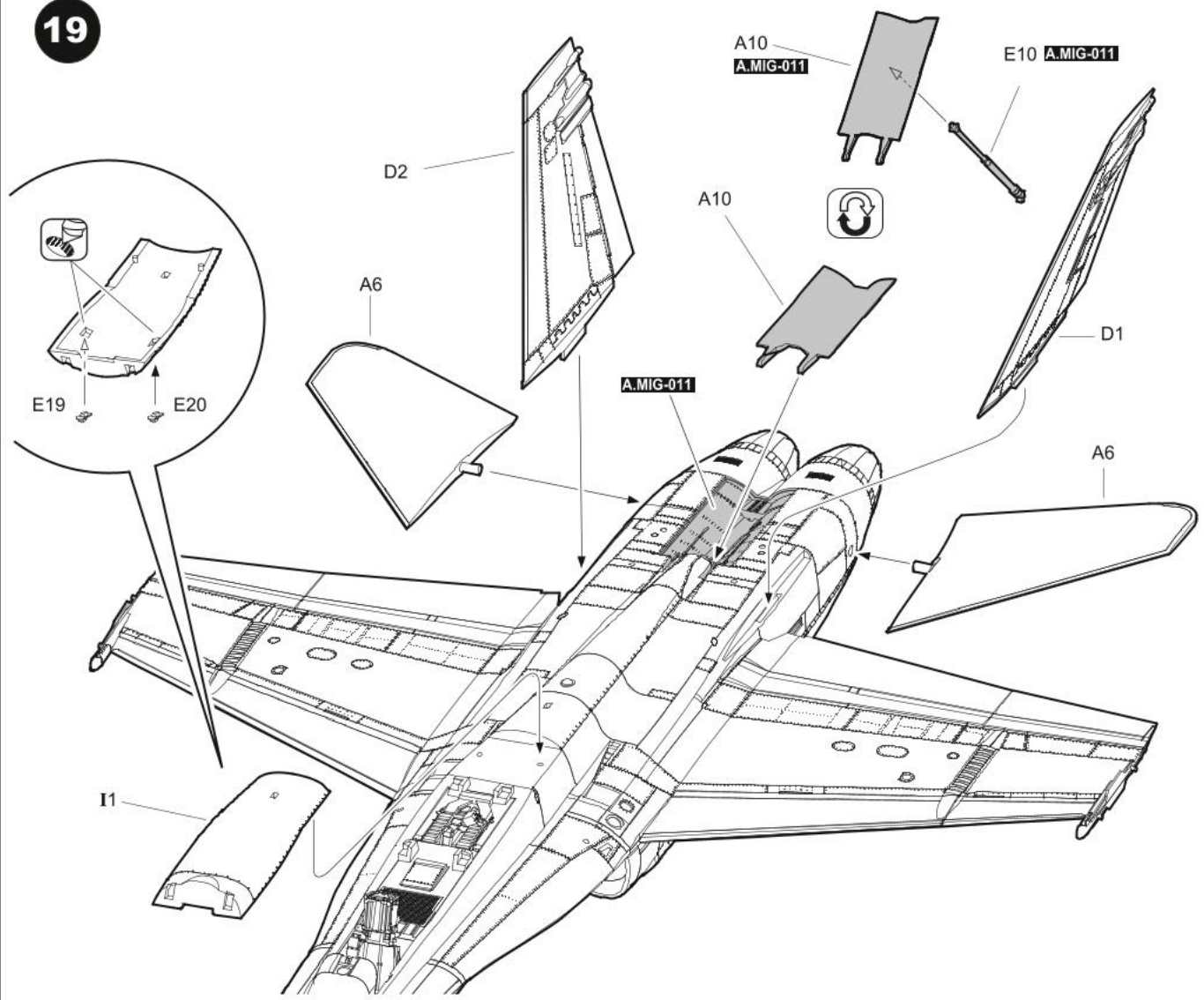

20

Close Canopy  Open Canopy 

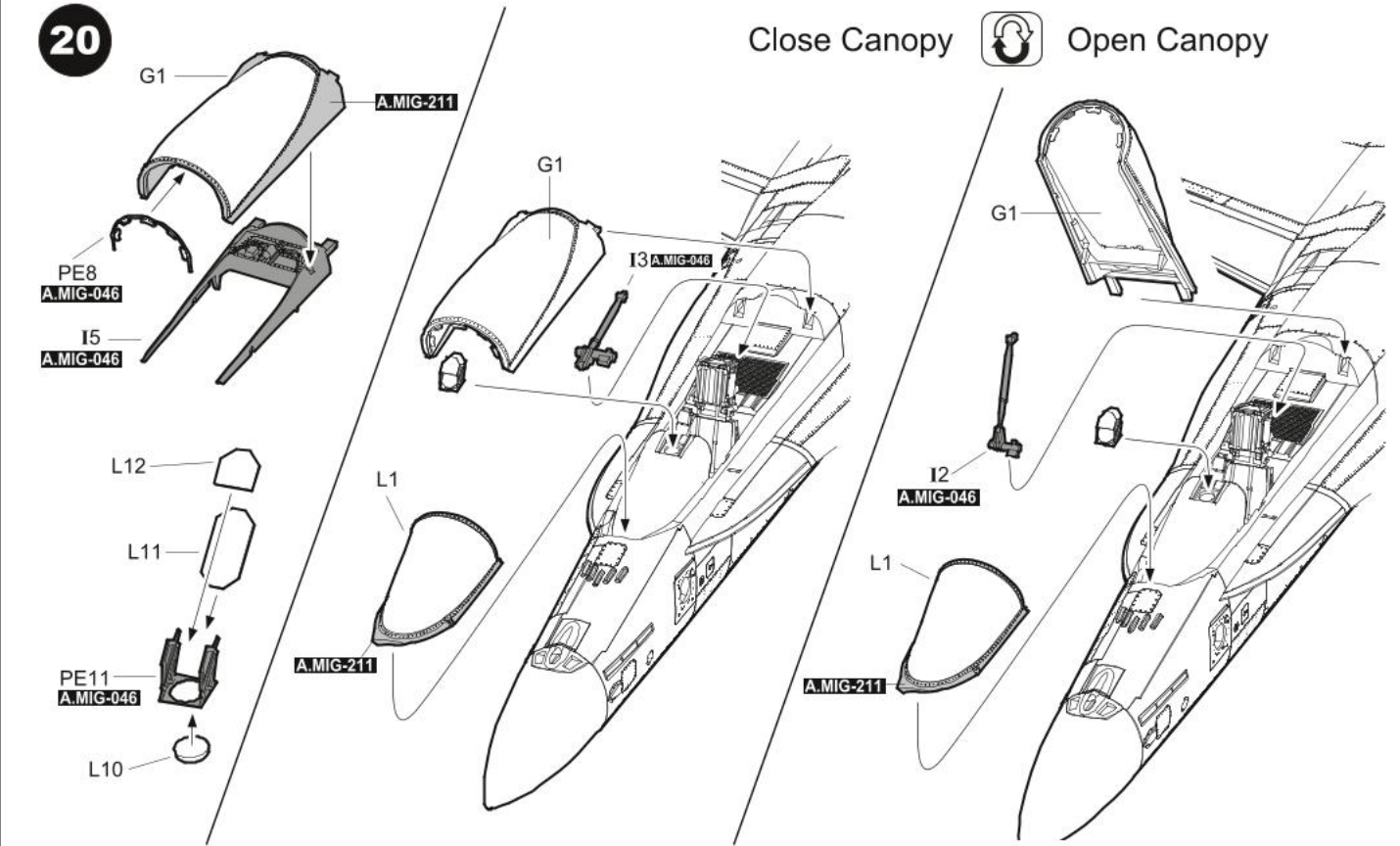

21

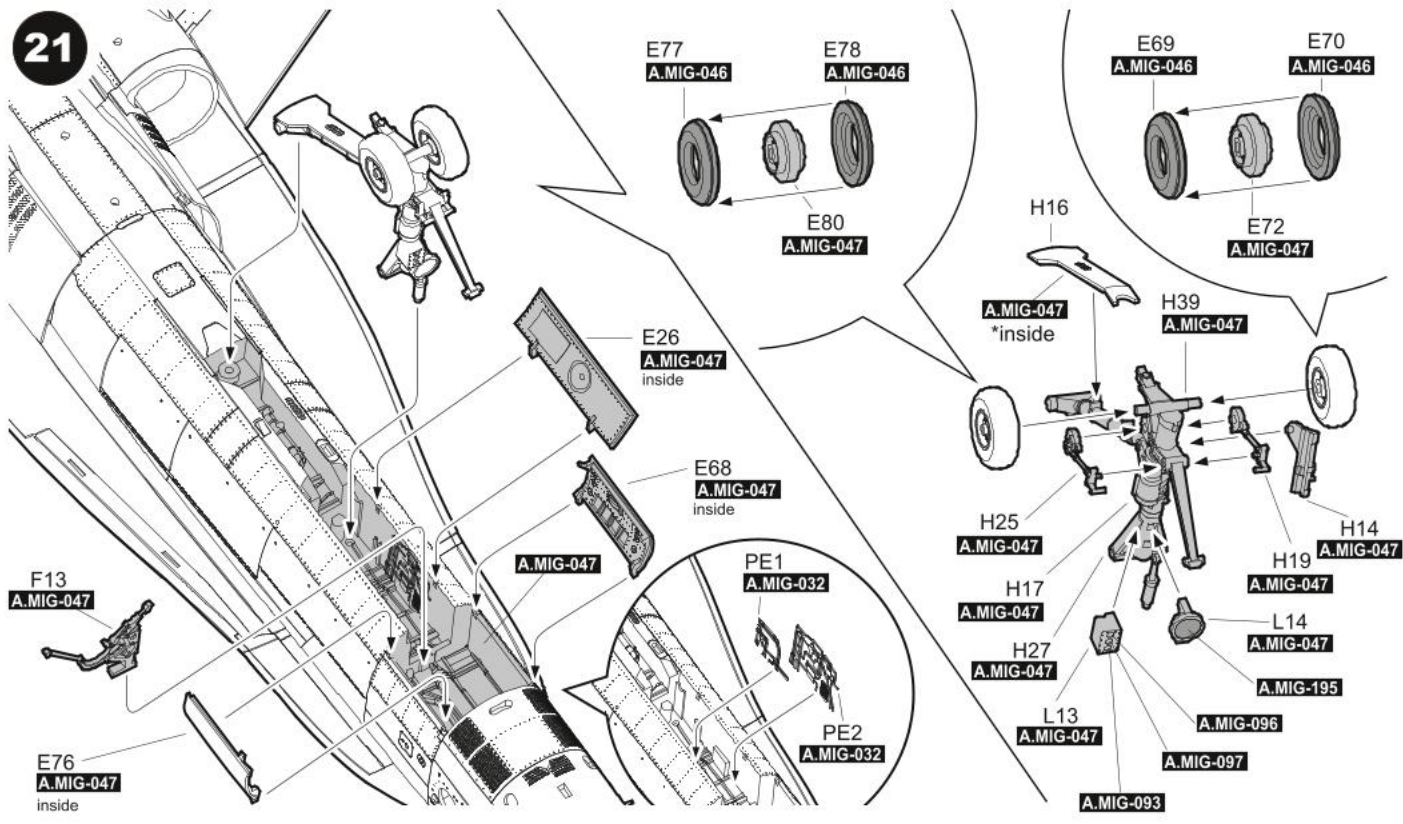

22

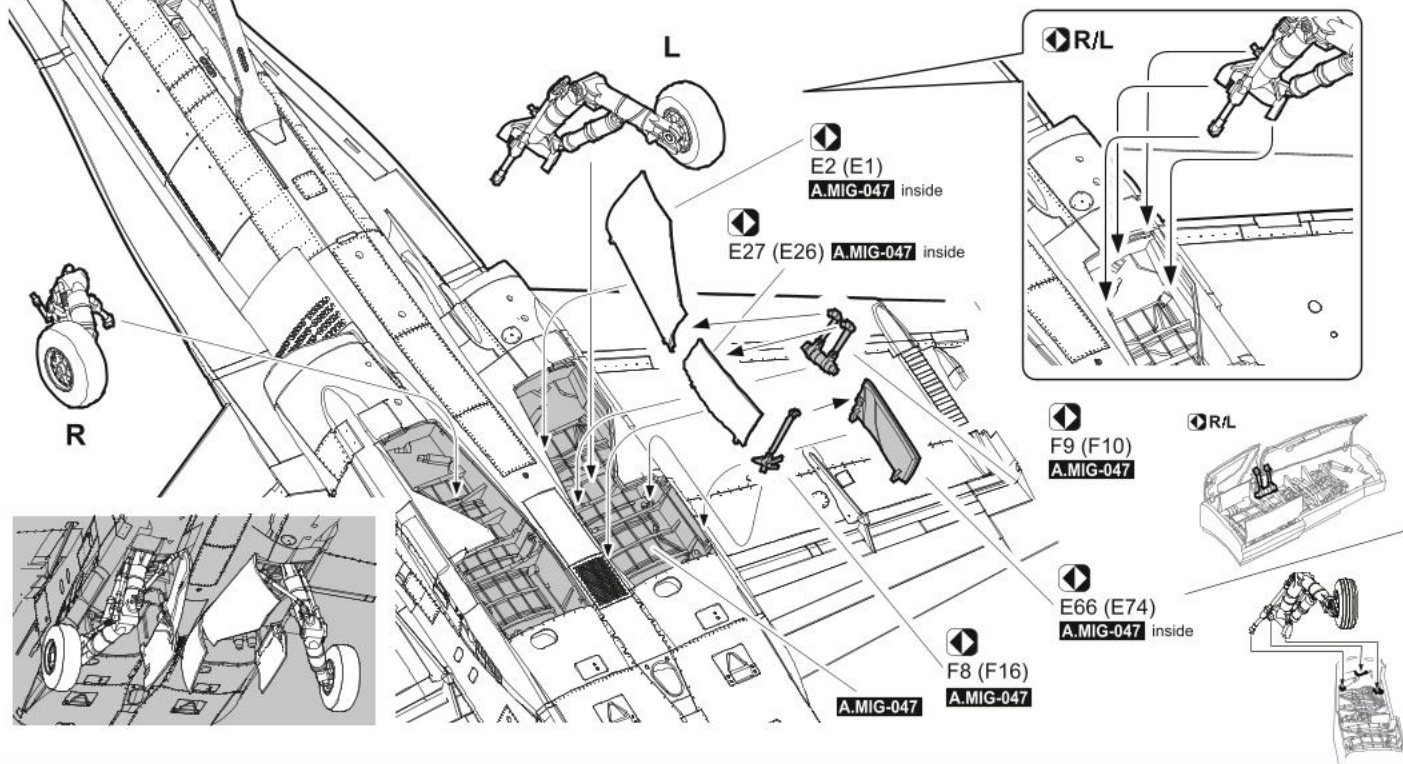
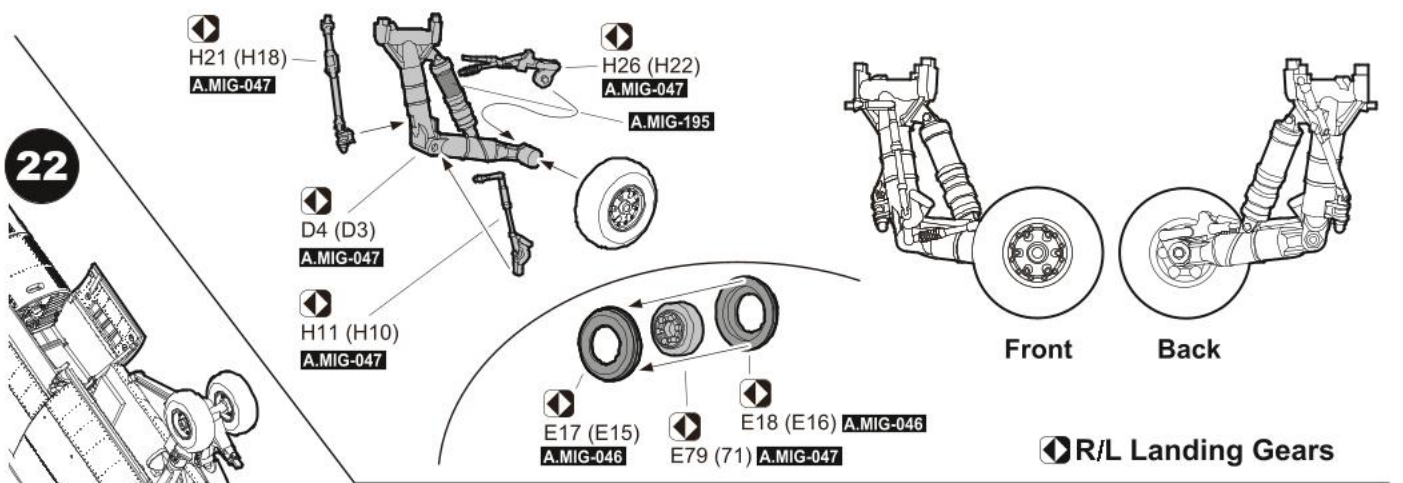

23

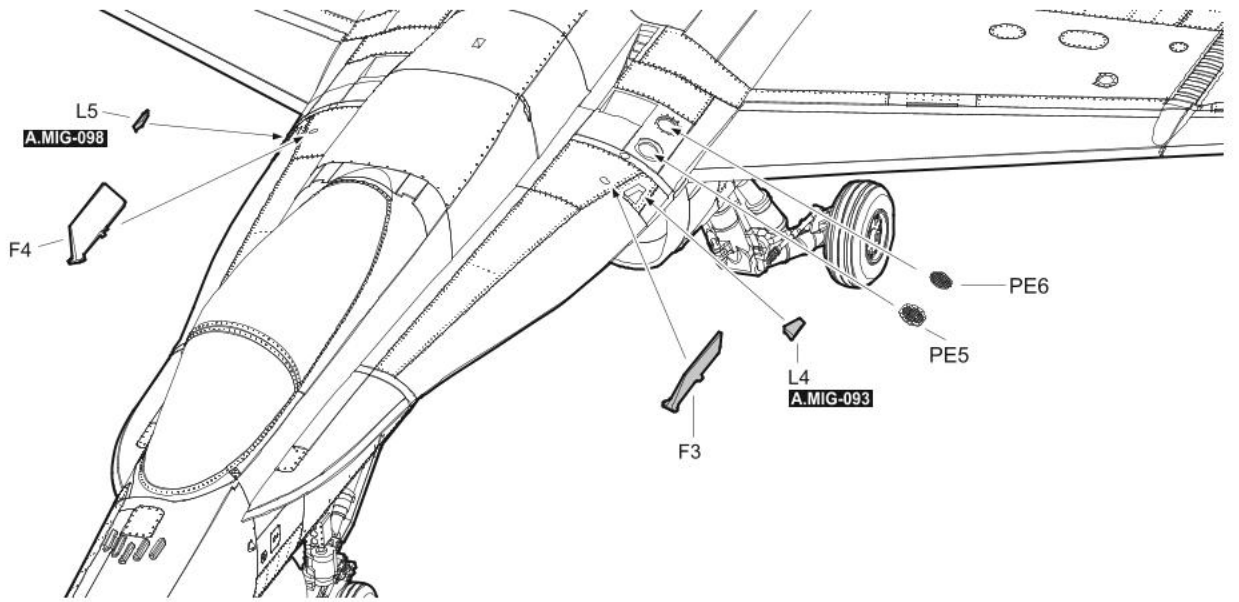

24

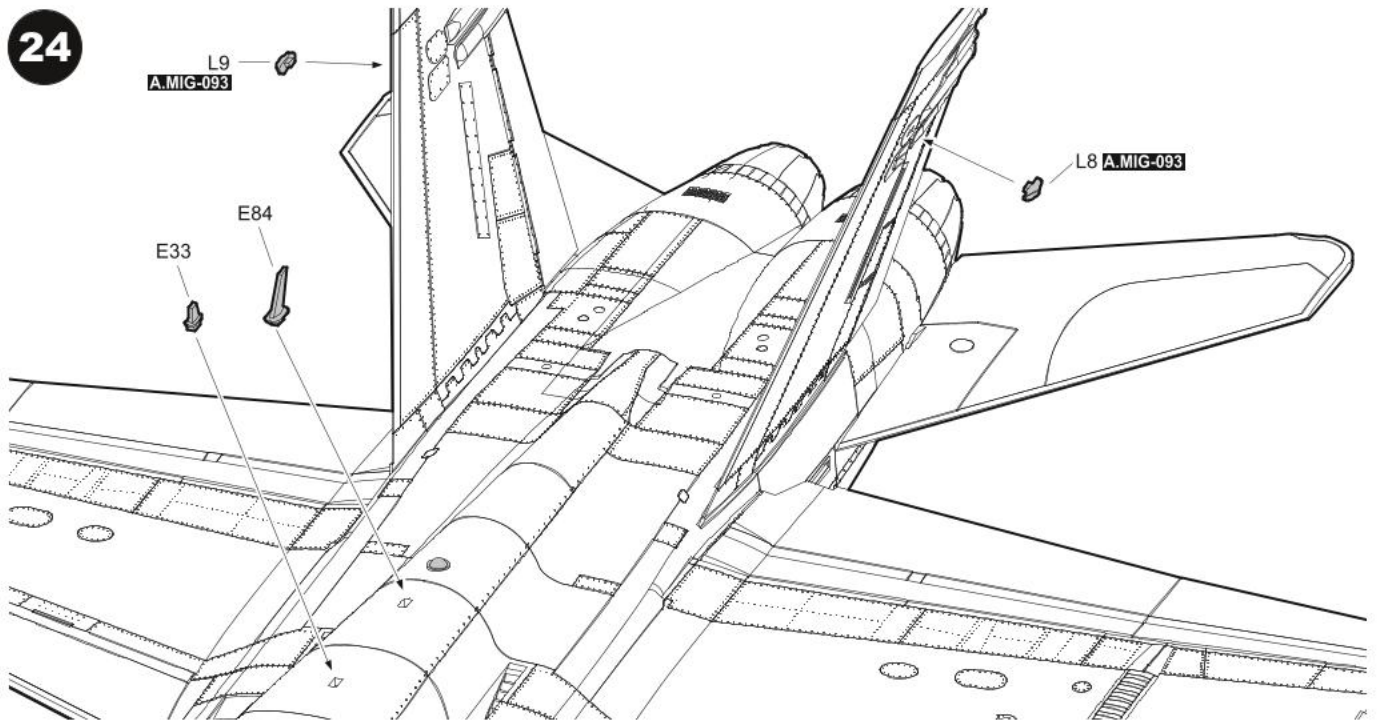

25

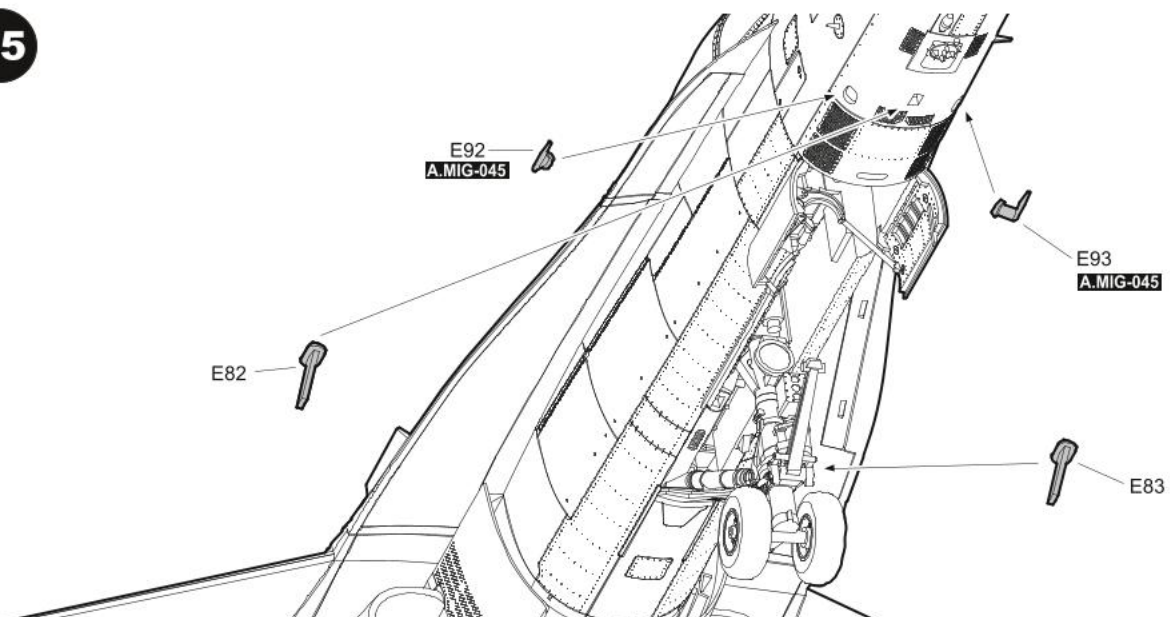

26

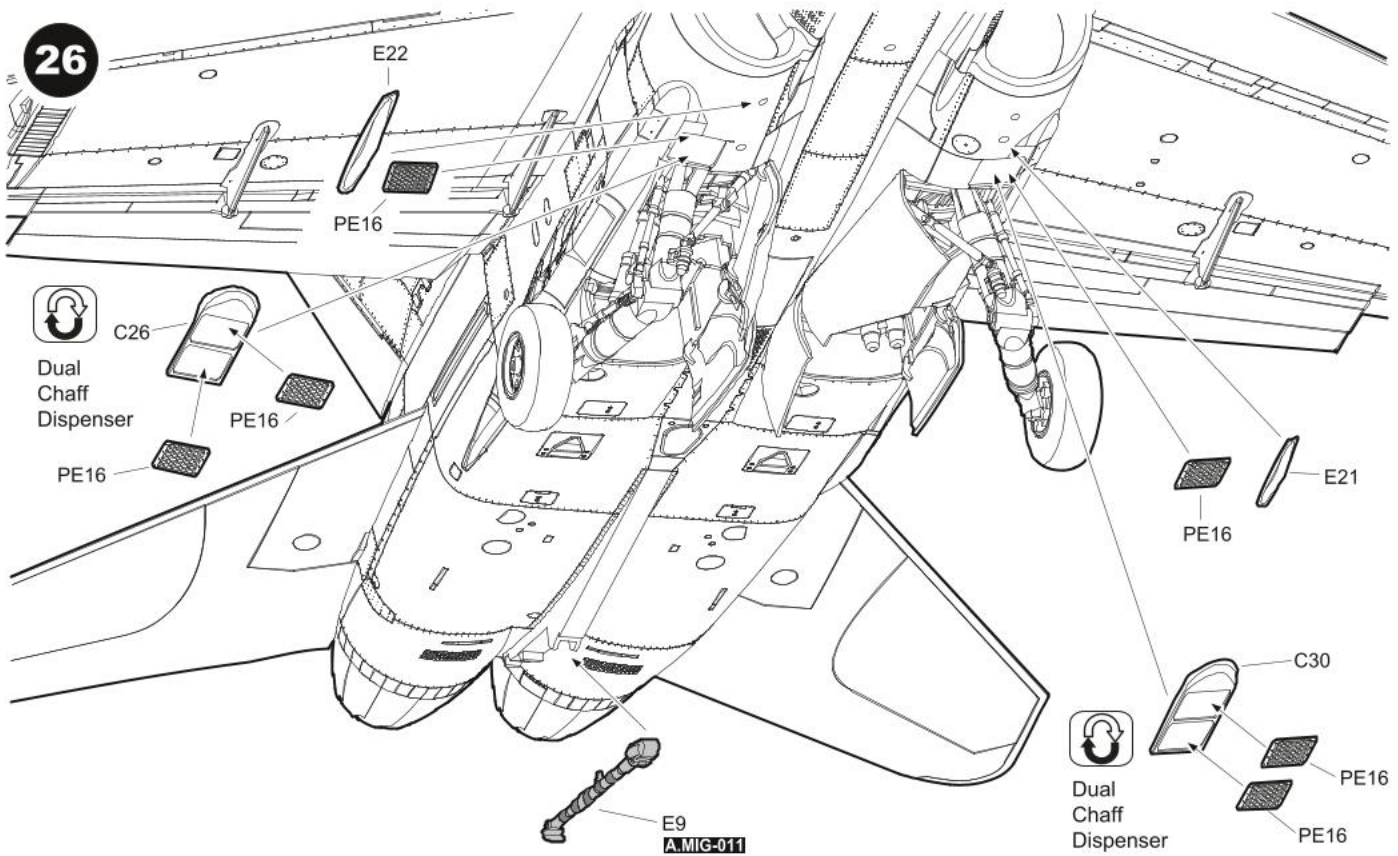

27

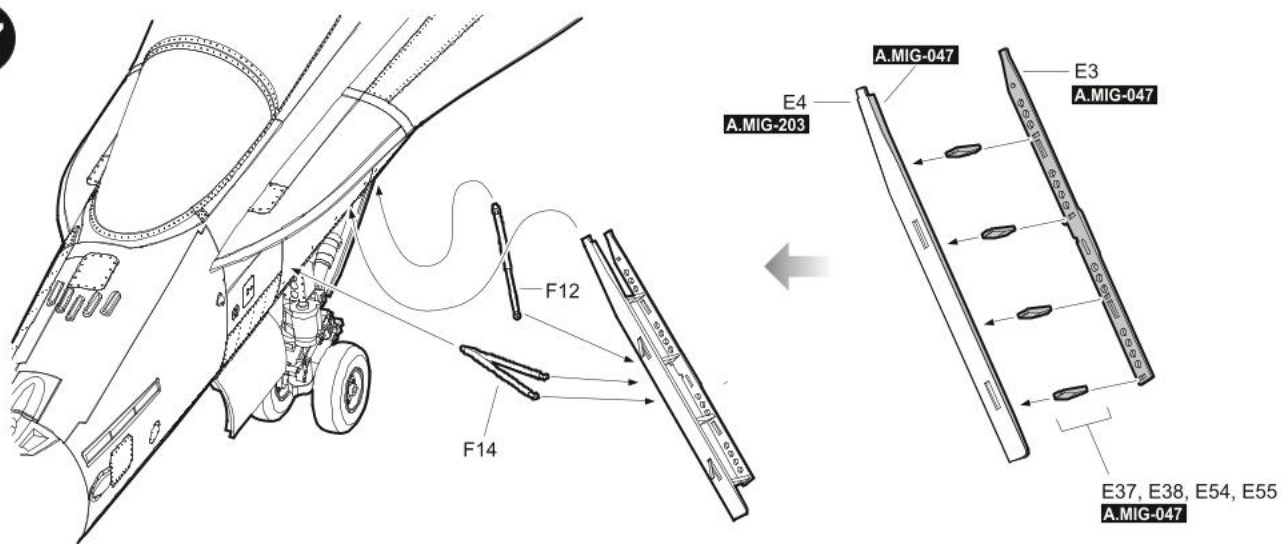

28

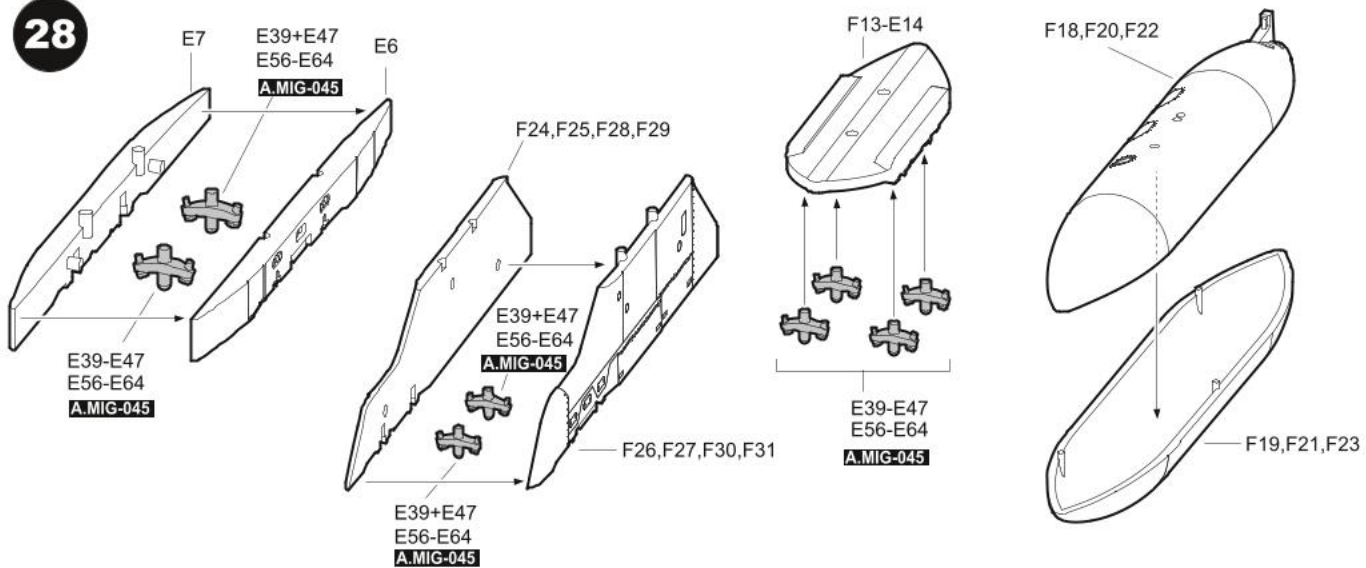

29

AIM-120B

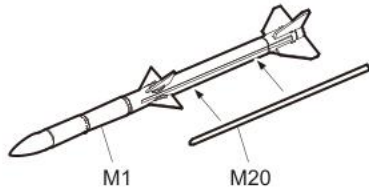

AIM-9M

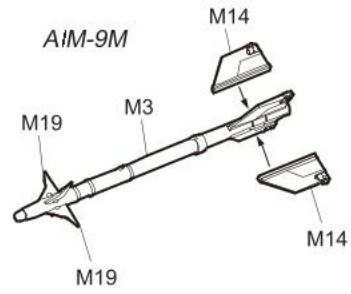

30

GBU-87

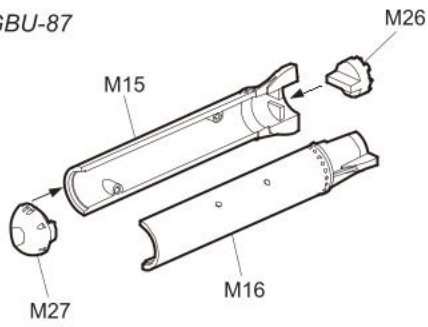

GBU-12

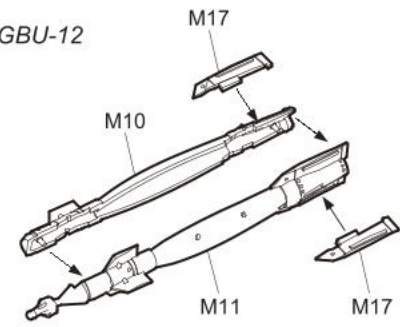

31

AAS-38

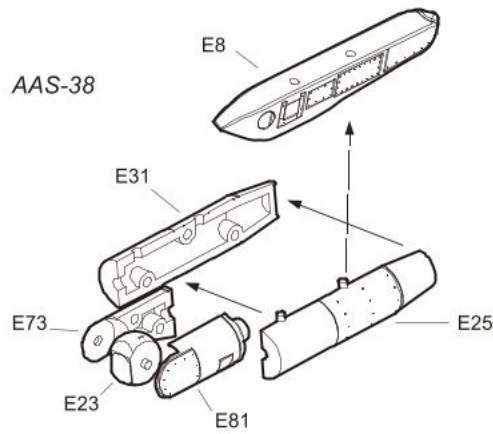

32

SNIPER XR

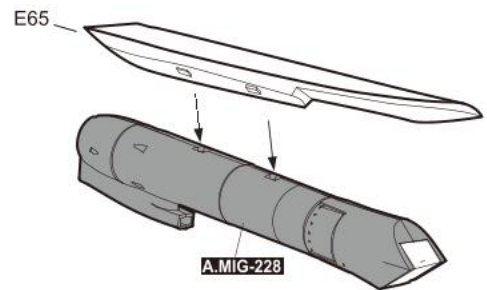
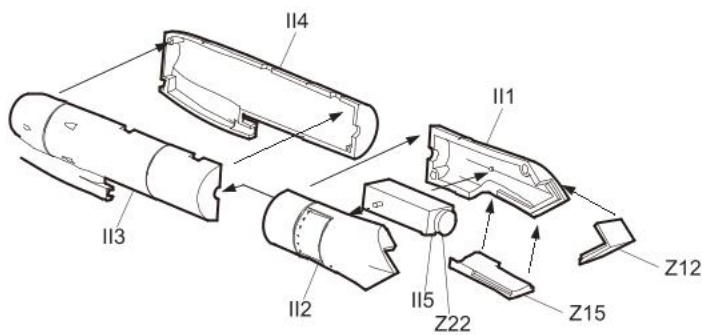

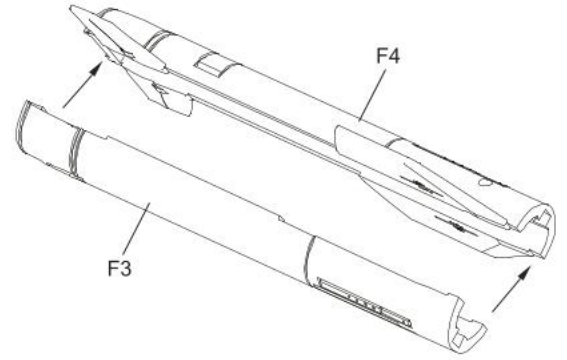

AGM - 84D HARPOON

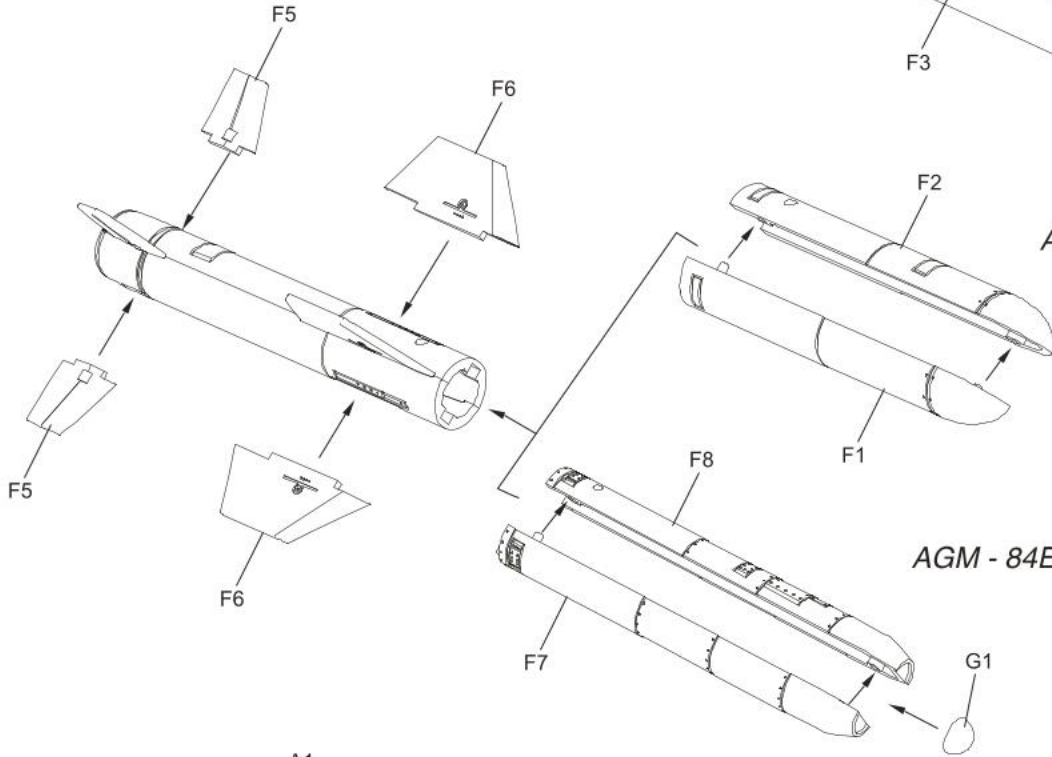

AGM - 84E SLEM

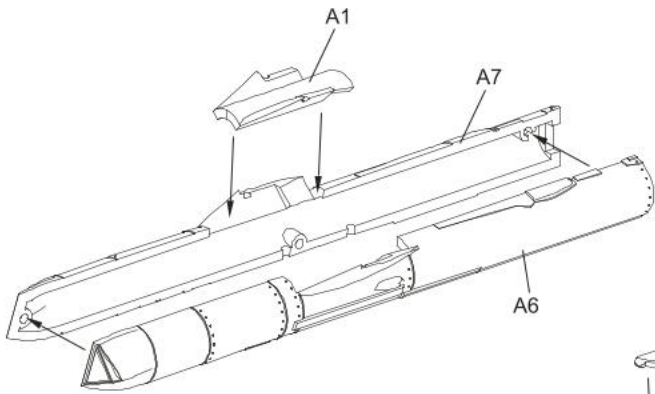

AGM - 84H SLAM - ER

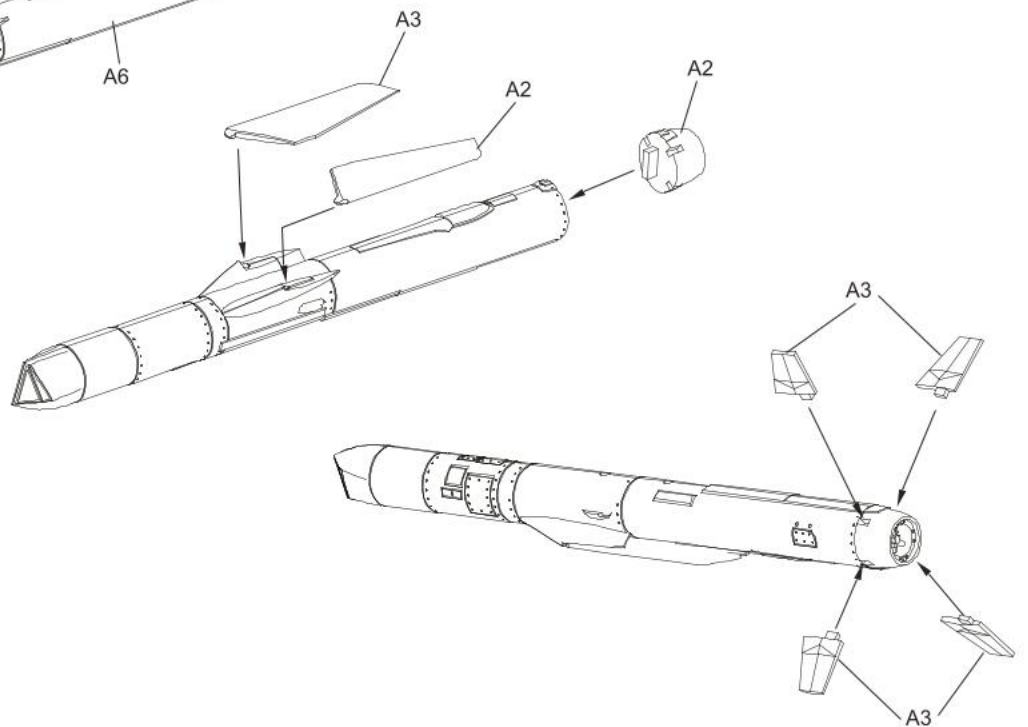

34

AGM - 154

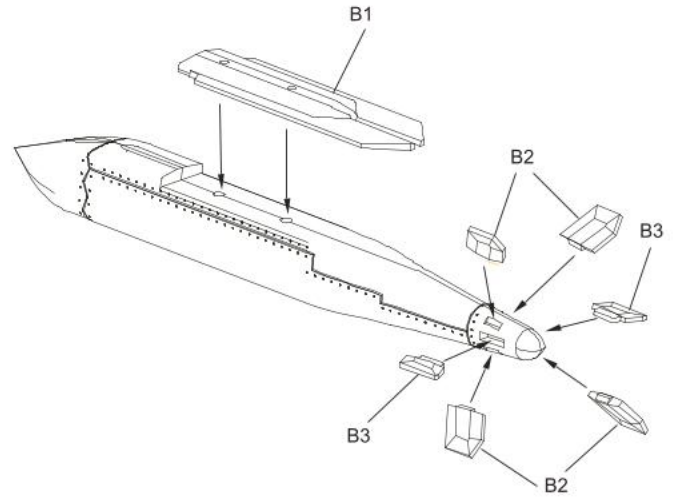
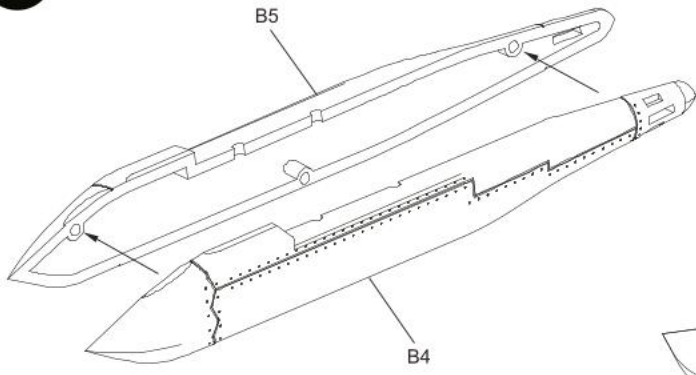

Painting & Decal Placement - External Stores

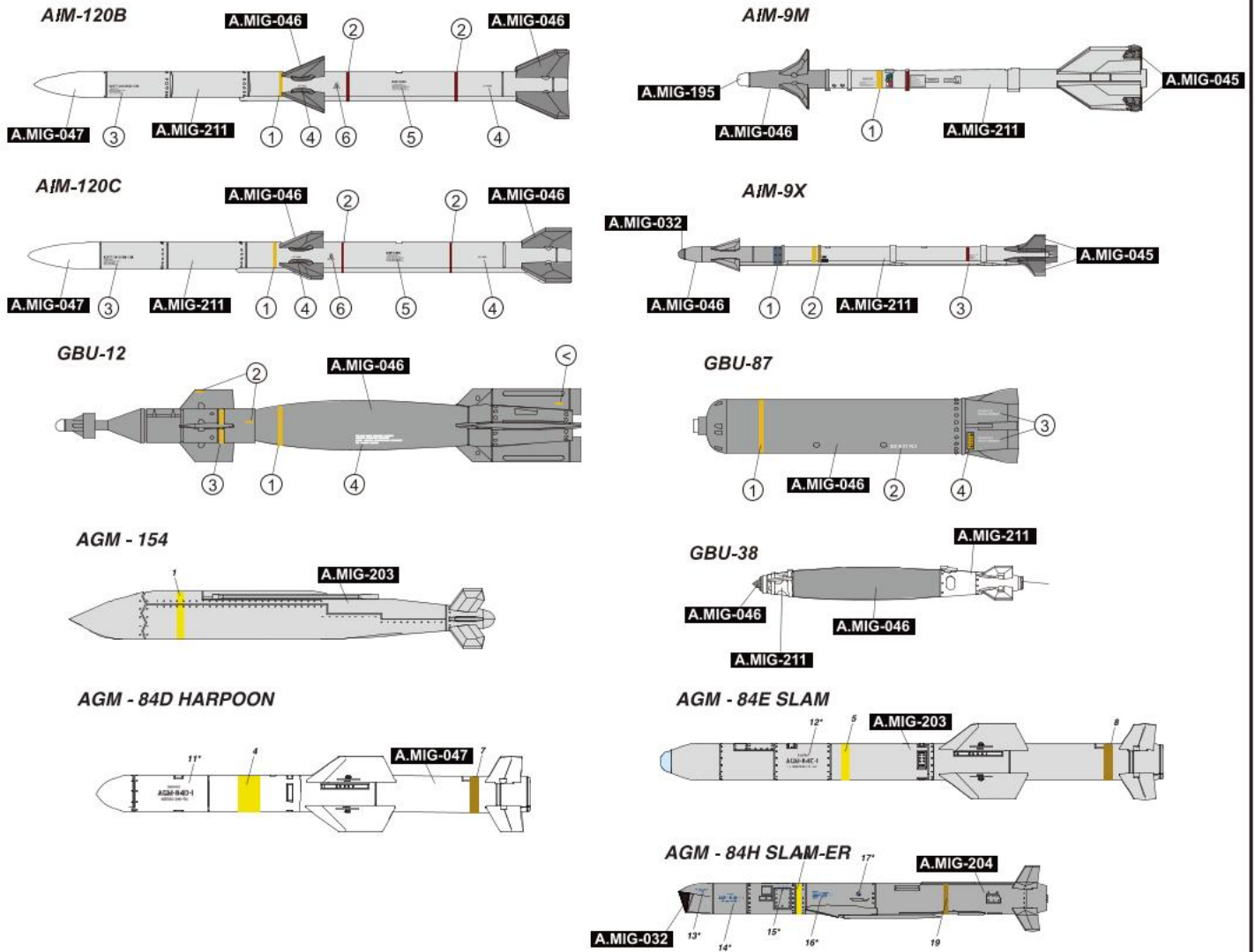

EXTERNAL STORES

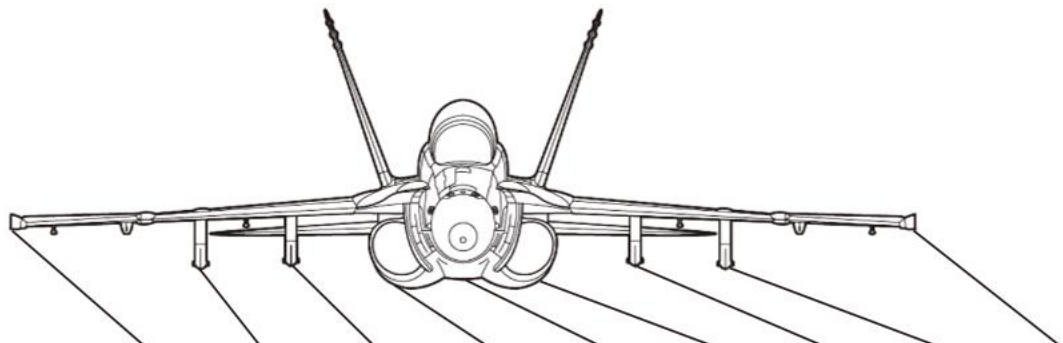

Weapons	Sta.No.	<9>	<8>	<7>	<6>	<5>	<4>	<3>	<2>	<1>
AIM-9M/X		●	● ●						● ●	
AGM-84D/E/H			●	●				●	●	
AIM-120			● ●		●		●		● ●	●
330 gal. Fuel Tank				●		●		●		
GBU-12			●	●				●		
AGM-154			●	●				●	●	
AN/ASQ-173 LDT/SCAM					●				●	
AN/AAR-50 TINS					●				●	
AN/AAS-38 FLIR							●			
AAQ-32							●			
CBU-10			●	●				●	●	

A.MIG-032 A.MIG-208 A.MIG-203 71.078 A.MIG-202



**F/A-18C VFA-27
ROYAL MACES
1999**

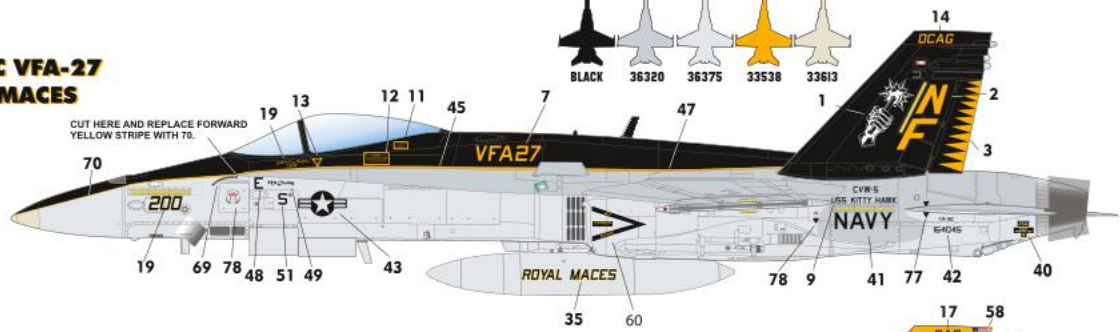

**F/A-18C VFA-27
ROYAL MACES
2002**

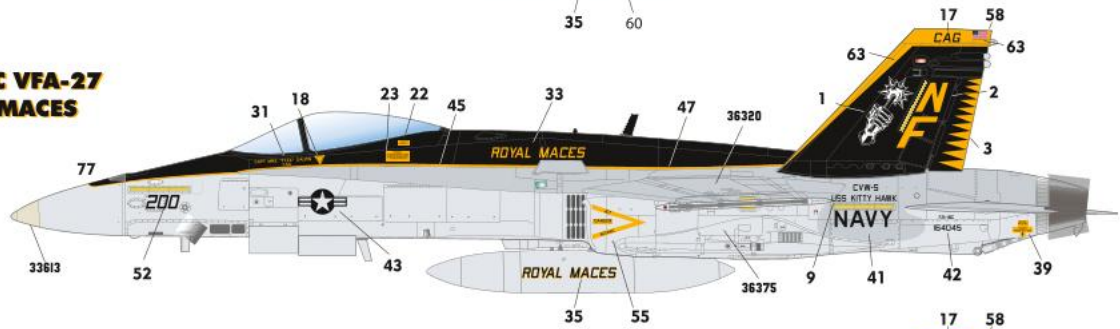

**F/A-18C VFA-27
ROYAL MACES
2003**

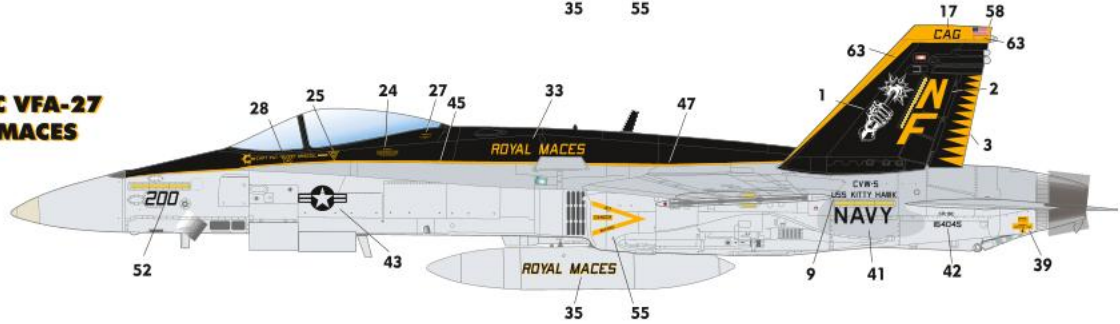

**F/A-18C VFA-27
ROYAL MACES
1999**

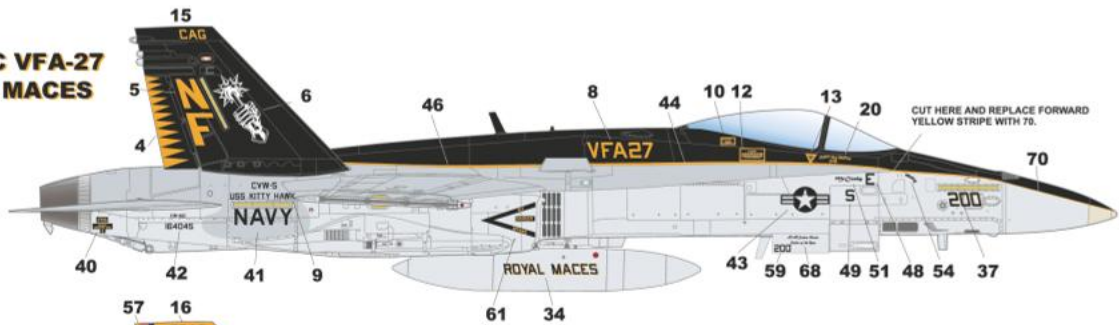

**F/A-18C VFA-27
ROYAL MACES
2002**

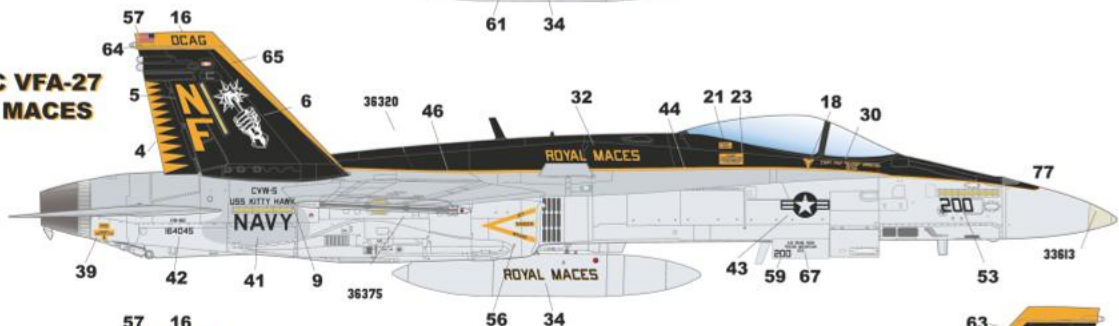

**F/A-18C VFA-27
ROYAL MACES
2003**

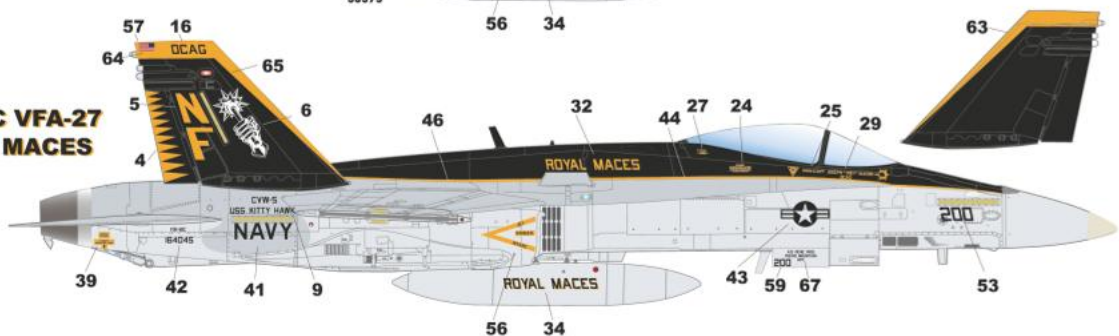

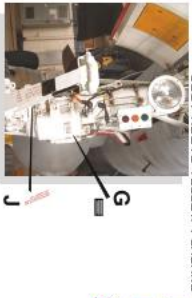
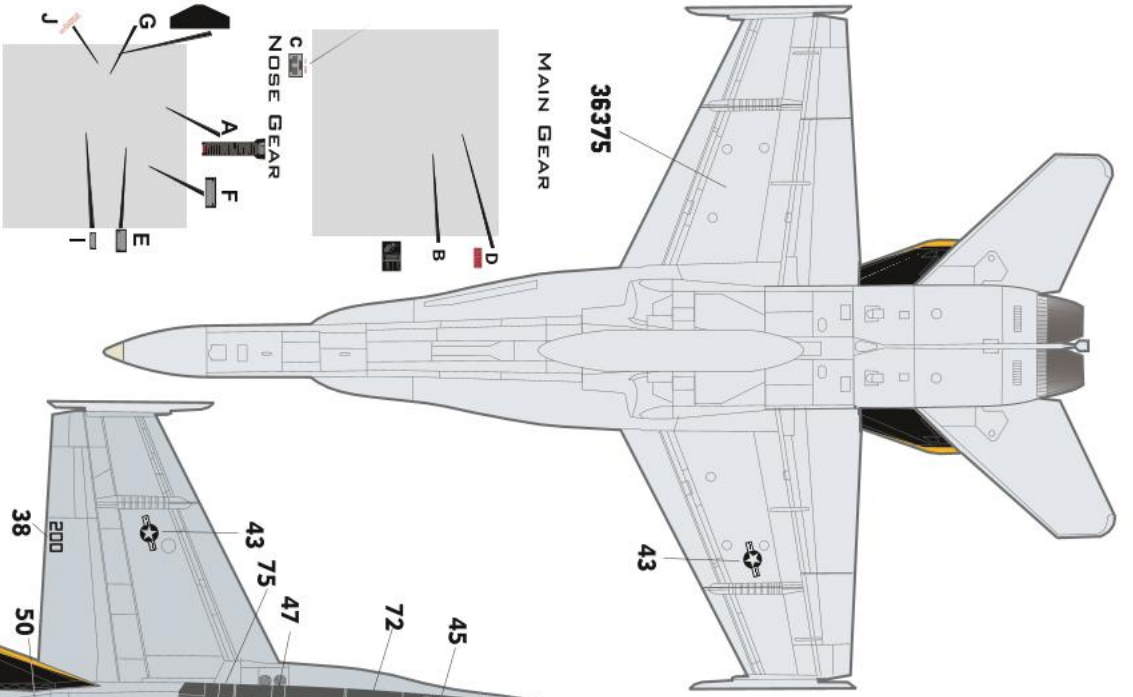

**F/A-18C VFA-27
ROYAL MACES
2002**

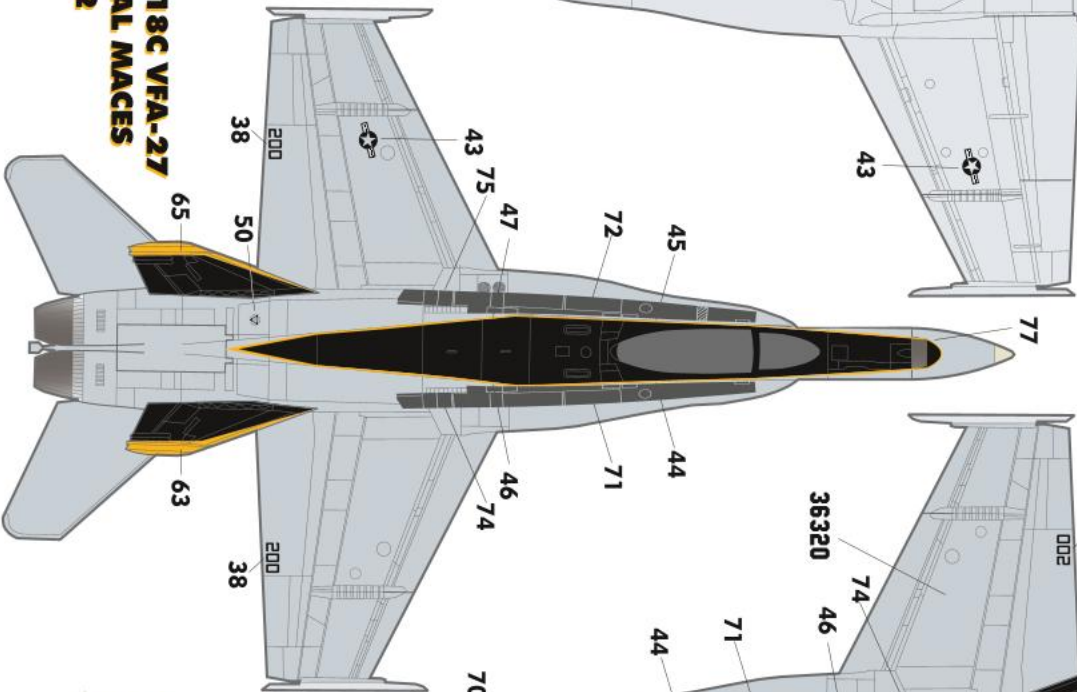

**F/A-18C VFA-27
ROYAL MACES
1999**

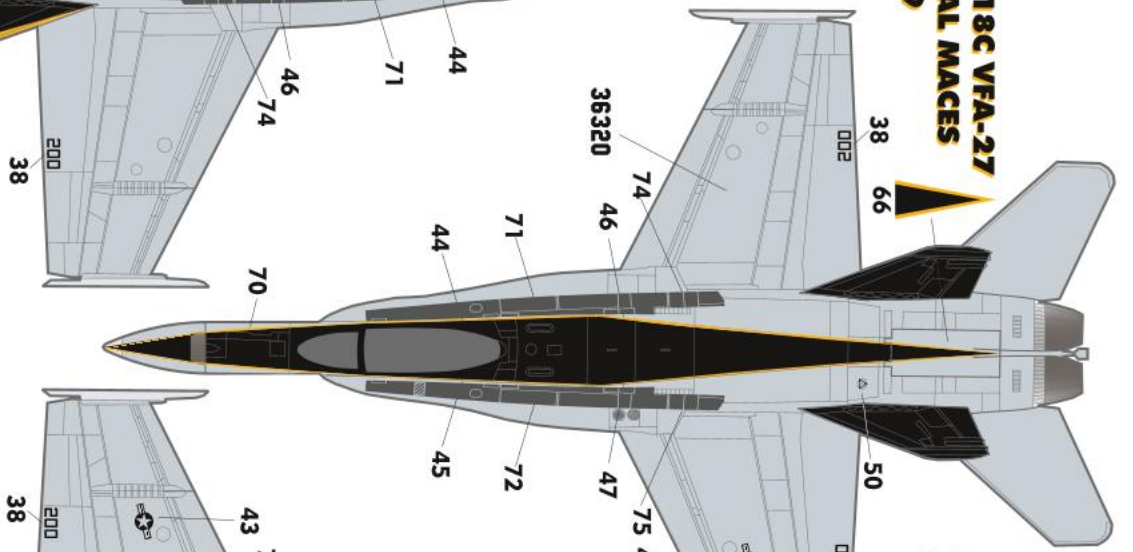

**F/A-18C VFA-27
ROYAL MACES
2003**

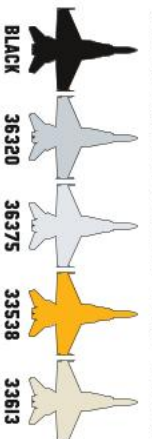
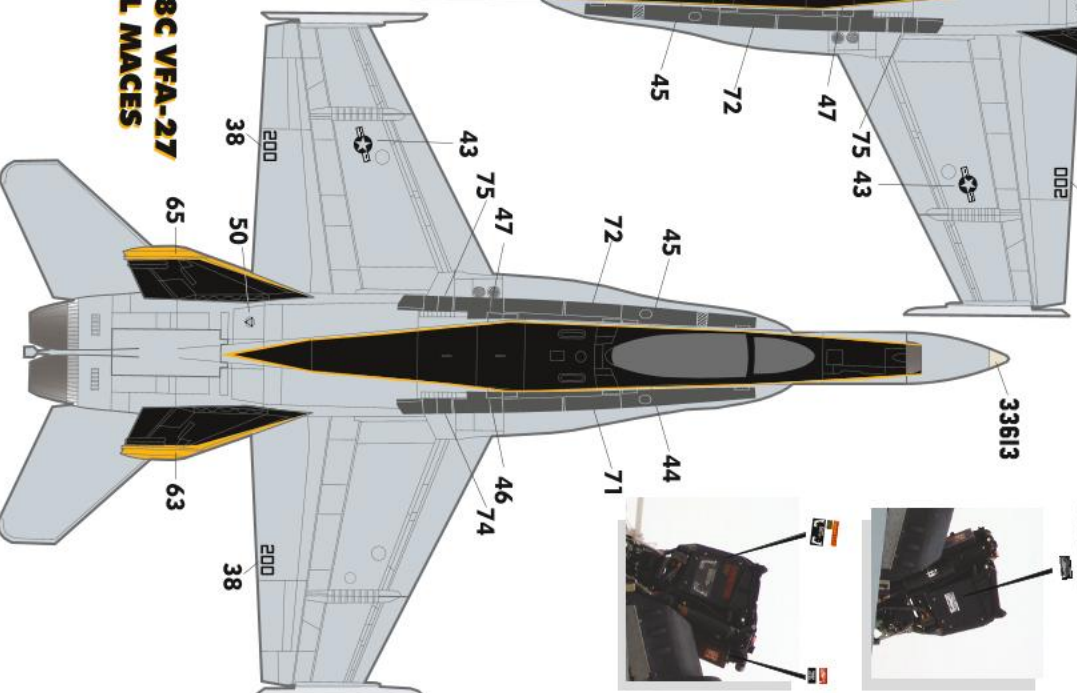

PARTS 46/47 MAY NEED TO BE CUT
AND ADJUSTED TO ACCOUNT FOR
THE DIFFERENCES IN THE SPINE STRIPES.

NACES

