

B-24D Formation Ship

11689

Plastic Model Kit

Skill Level 2

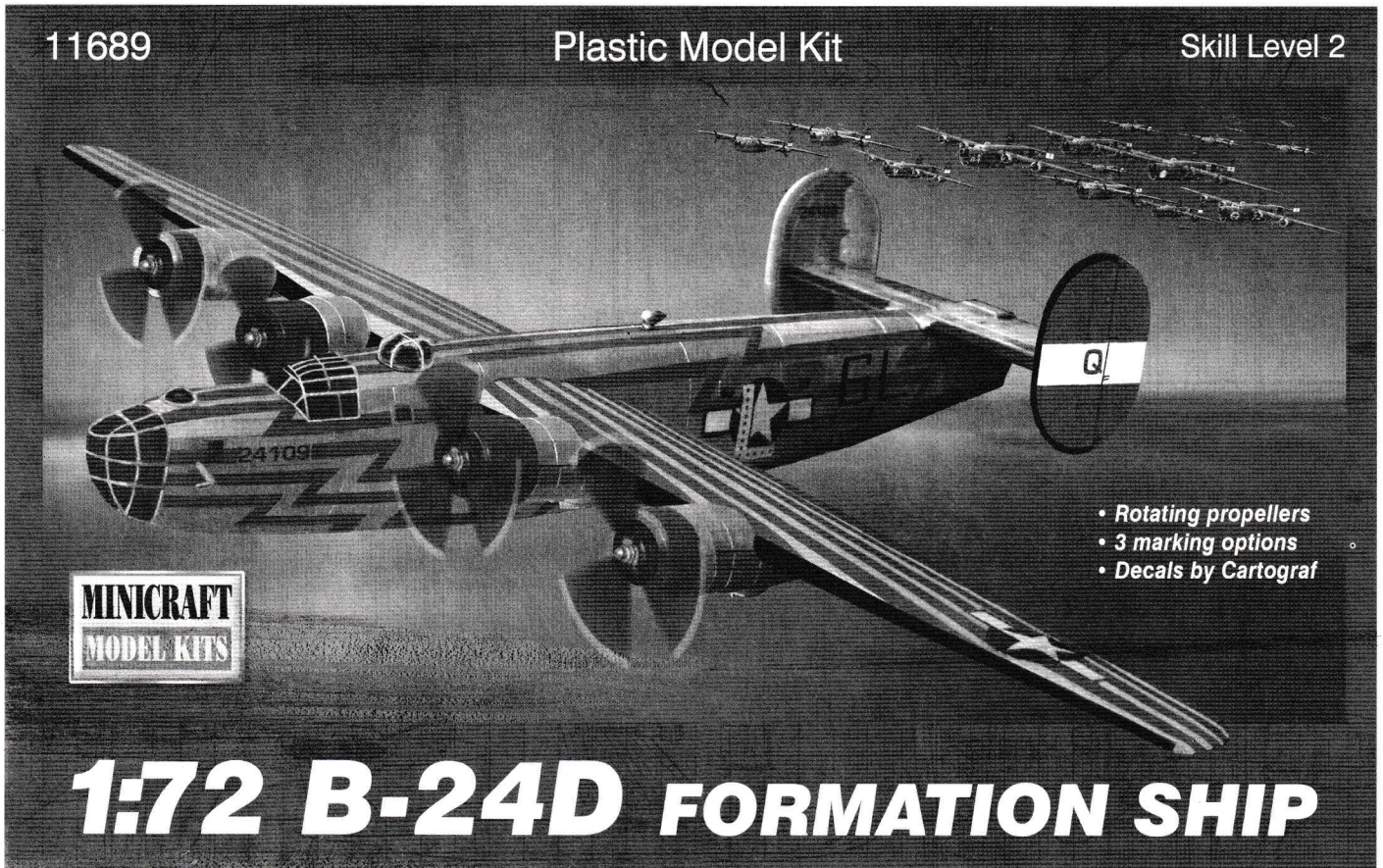

- Rotating propellers
- 3 marking options
- Decals by Cartograf

1:72 B-24D FORMATION SHIP

The B-24 Liberator was used in every theatre of operation in World War II and produced in greater quantities than any other aircraft in history. The B-24 evolved through its service life beginning as a heavy maritime patrol bomber. It was the longest-range heavy bomber in United States inventory during much of WWII.

The United States Army Air Force introduced the concept of daylight strategic bombing early in World War II. The strategy was designed to destroy enemy armament production and raw materials needed to conduct modern warfare. The B-24 was one of 2 principle aircraft used. The B-24D was the early version of the B-24 that served in all theatres of operation during WWII.

This model kit represents the United States Army Air Force B-24D formation ship. Formation ships were decorated in distinctive markings to assemble bombing formations before the flight into hostile territory. This new kit features new markings and decals representing 2 unique formation ships.

Minicraft Models US LLC.
2136 12th Street Rockford IL. 61104 USA
www.minicraftmodels.com

Printed in China

11689

IMPORTANT NOTE!

B-24 Assembly Ships did not carry armanent nor bombs. All parts are proved in this kit to assemble a fully armed aircraft if you choose to.

PARTS LOCATING DIAGRAM

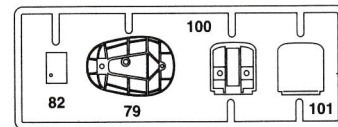
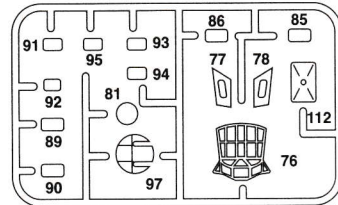
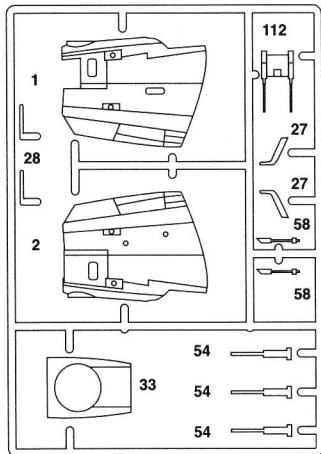
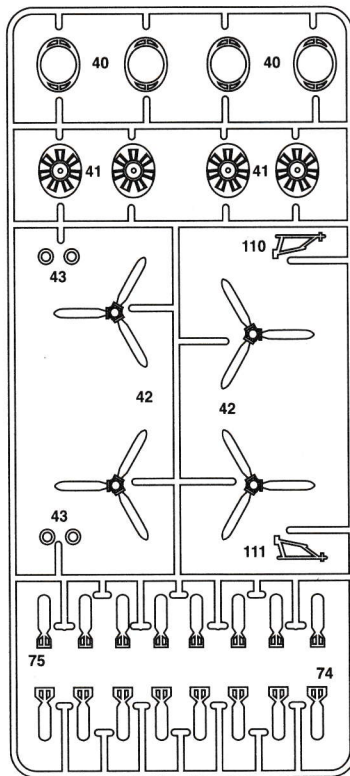
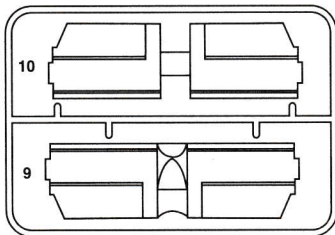
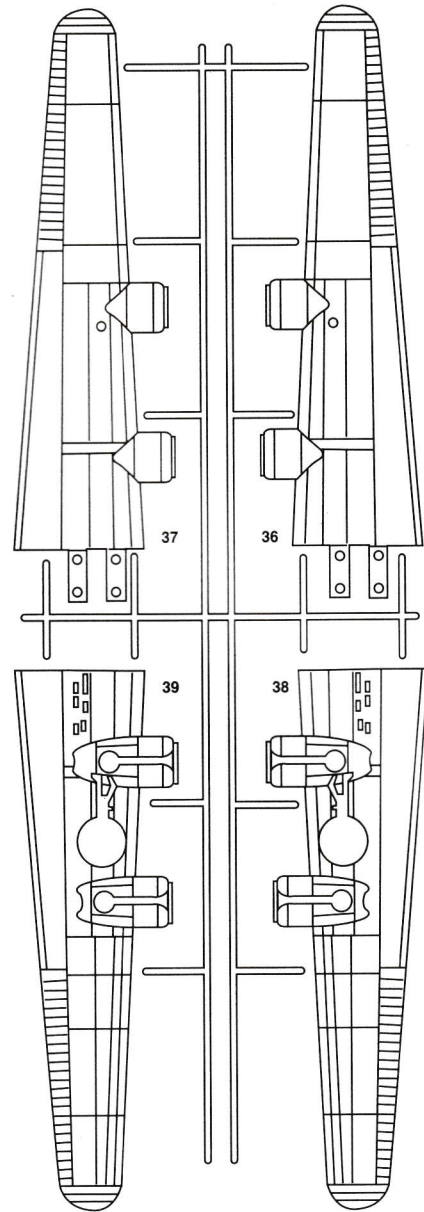
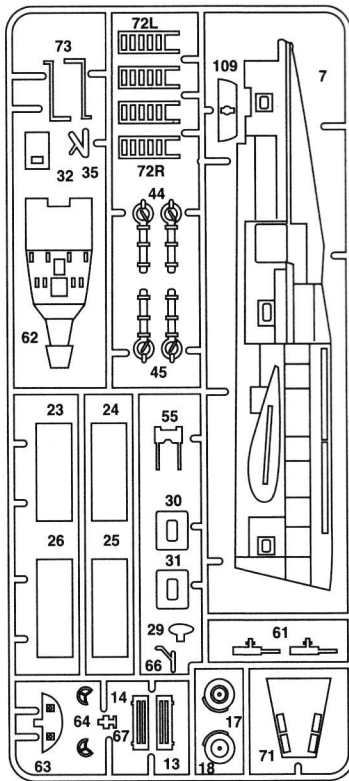
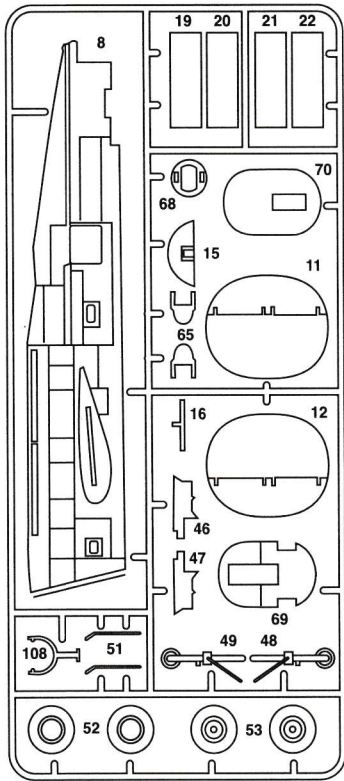



- 

Cement
Coller
Kleben
Pegar
Incollare
Colar
Kleven
- 

DO NOT Cement
Ne pas Coller
Nicht Kleben
No Pegar
Non Incollare
Nao Colar
Niet Kleven
- 

Cut away
Couper
Scheiden
Cortar
Tagliere
Cortar
Snijden
- 

Optional parts
Choix
Auswahlmöglichkeit
Eleccion
Scelta
Opaco
Keuze
- 

Repeat operation
Répéter l'opération
Vorgang wiederholen
Repitir la operacion
Ripetere
Repitir a operação
Herhalen
- 

Symmetrical assembly
- 

Drill hole

1 WAIST GUNS

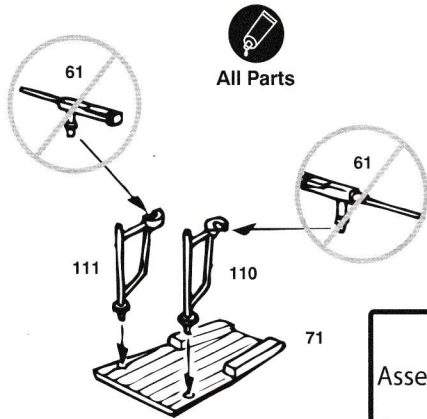

Floor WOOD TAN
Gun mounts INTERIOR GREEN
Guns FLAT BLACK / GUNMETAL

2 FLIGHT DECK

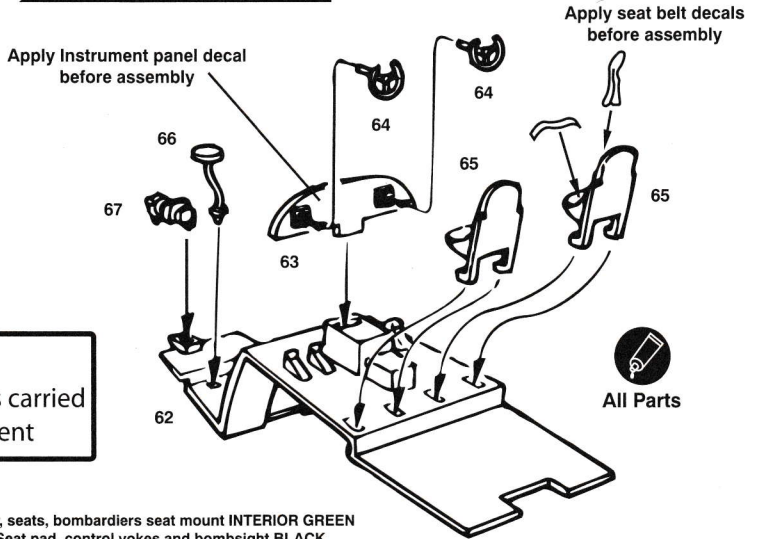

NOTE
Assembly ships carried
no armament

Floor, seats, bombardiers seat mount INTERIOR GREEN
Seat pad, control yokes and bombsight BLACK

3 INTERIOR ASSEMBLY RIGHT

All Parts

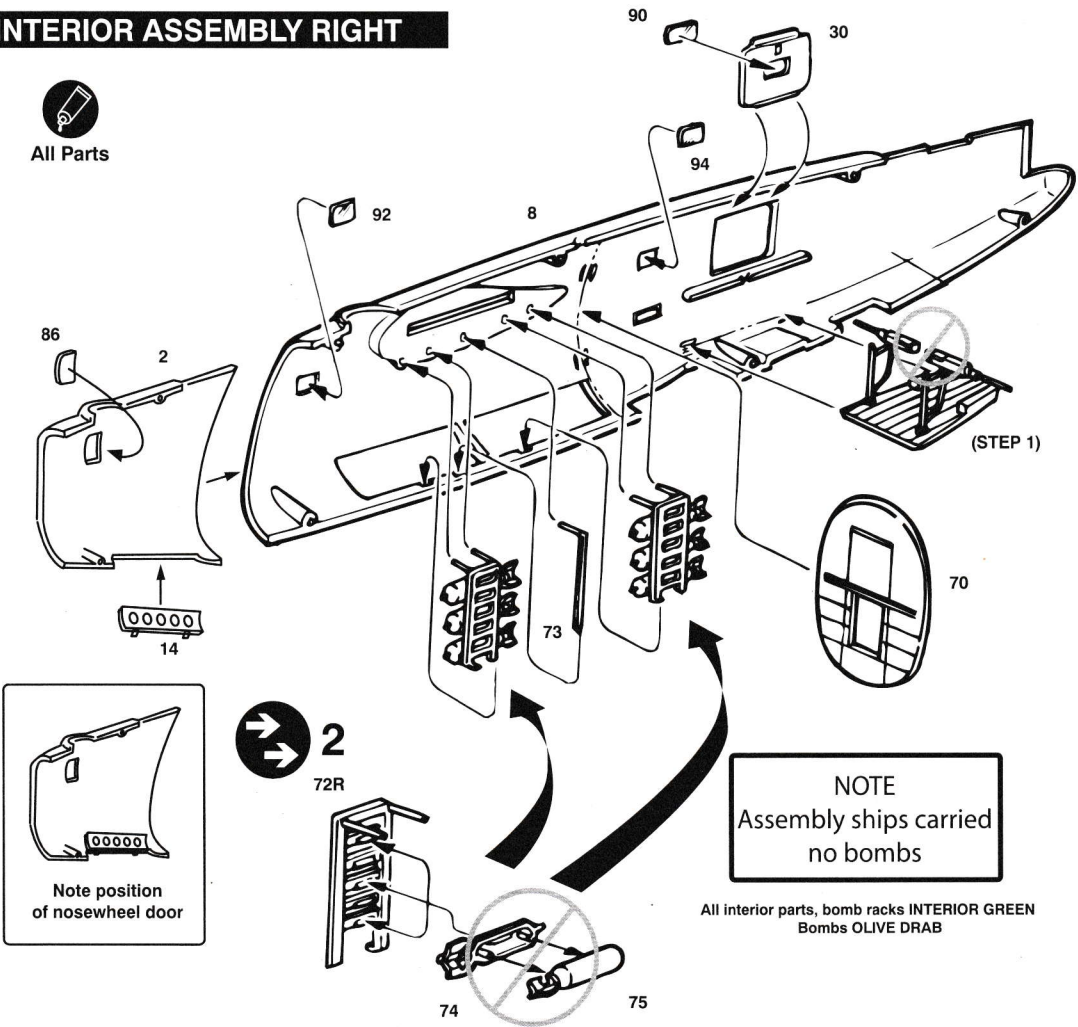

NOTE
Assembly ships carried
no bombs

All interior parts, bomb racks INTERIOR GREEN
Bombs OLIVE DRAB

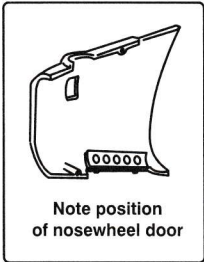

4 INTERIOR ASSEMBLY LEFT

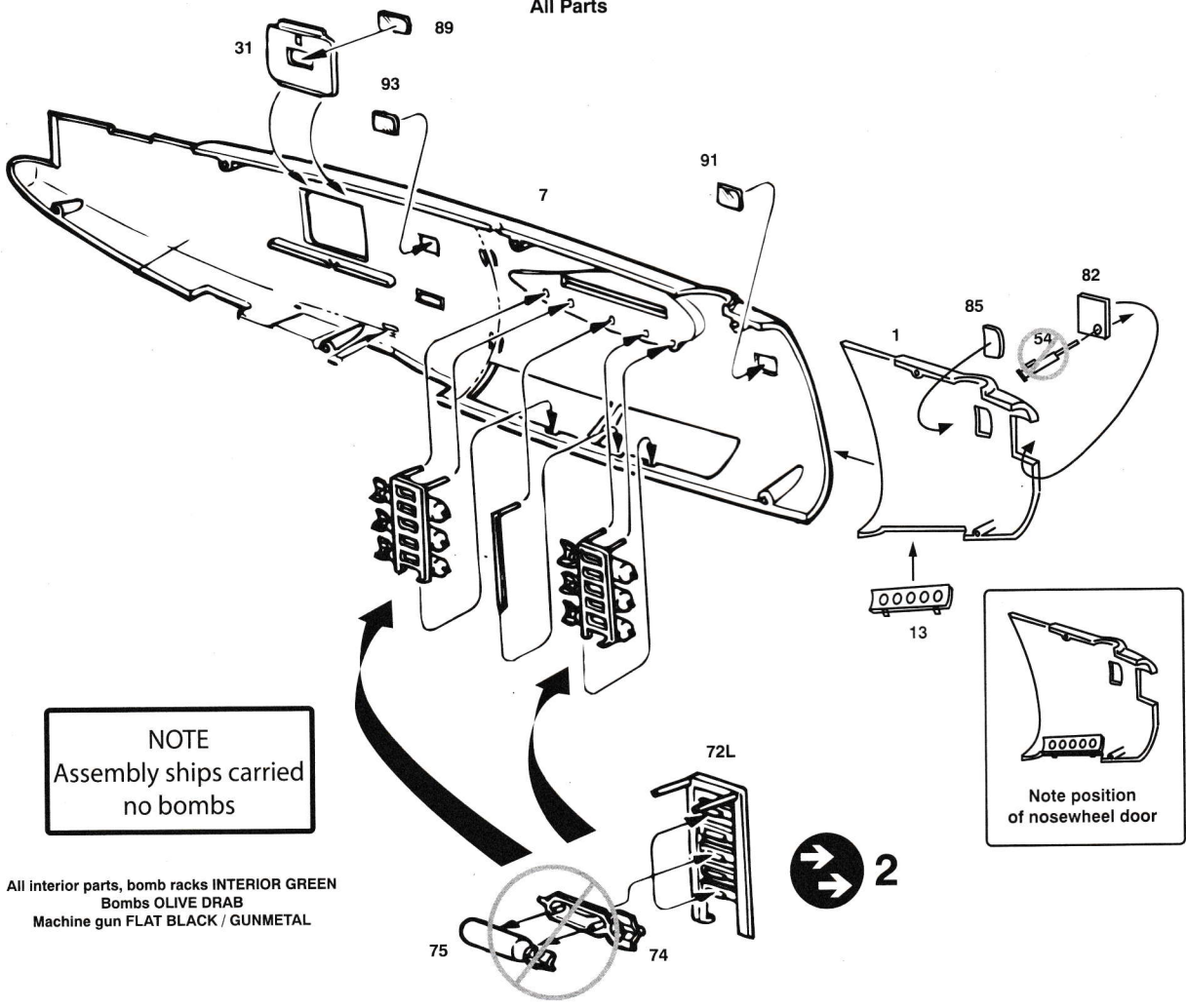

NOTE
Assembly ships carried
no bombs

All interior parts, bomb racks INTERIOR GREEN
Bombs OLIVE DRAB
Machine gun FLAT BLACK / GUNMETAL

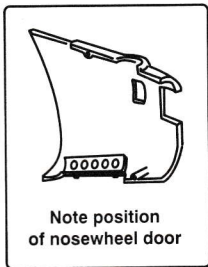

5 NOSEWHEEL ASSEMBLY

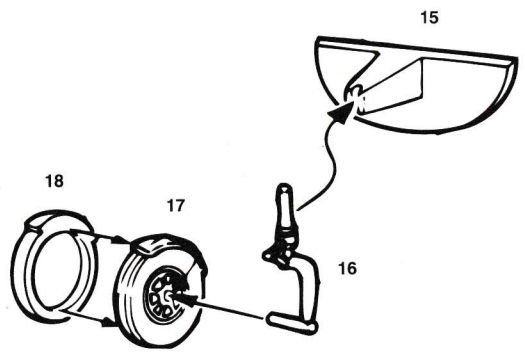

Bulkhead INTERIOR GREEN
Strut, mudguard and wheel hubs ALUMINUM
Tire FLAT BLACK-GRAY

6 TAIL TURRET

Guns FLAT BLACK / GUNMETAL
Turret frames MATCH EXTERIOR COLOR

NOTE
Assembly ships carried
no armament

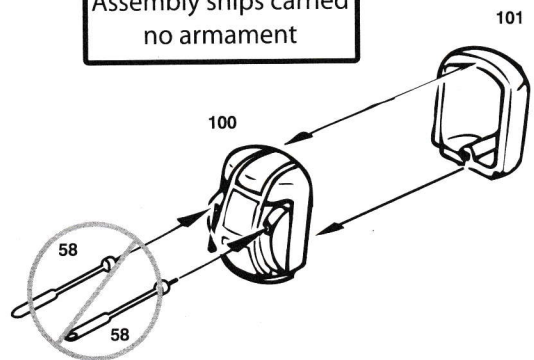

7 COCKPIT INSTALLATION



All Parts

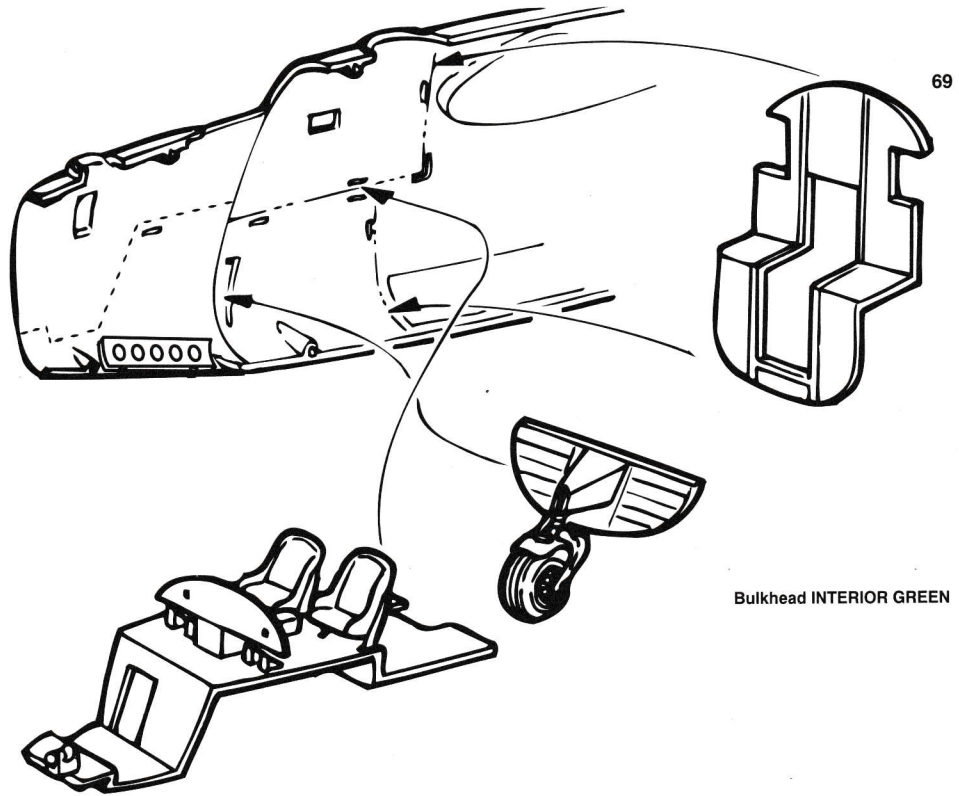

8 MAIN FUSELAGE ASSEMBLY

NOTE
Assembly ships carried
no armament



All parts except where noted

Upper turret interior INTERIOR GREEN
Guns FLAT BLACK

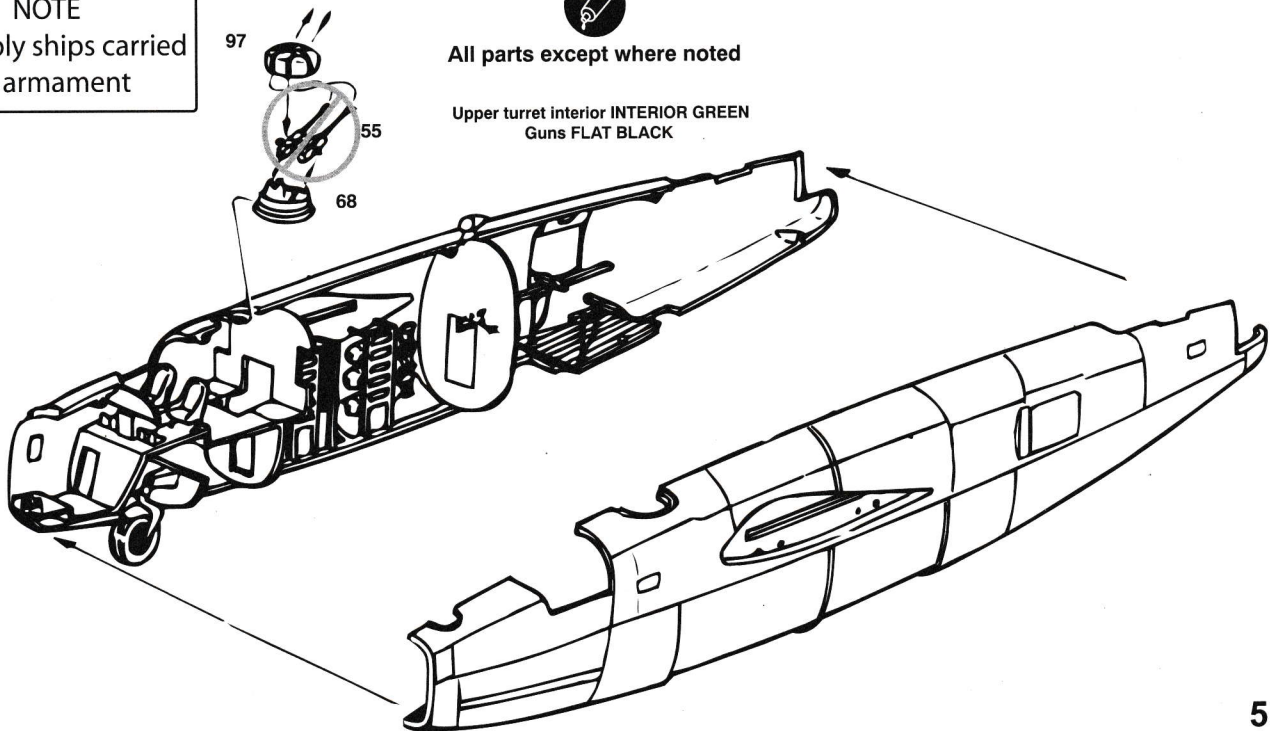

9 FORWARD FUSELAGE ASSEMBLY

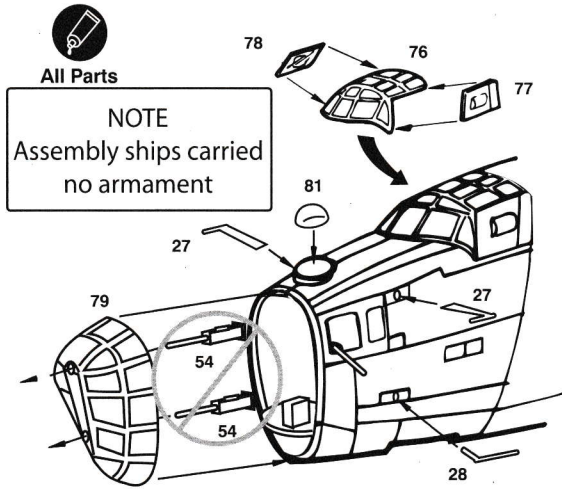

• Guns FLAT BLACK / GUNMETAL

10 BOMB BAY DOORS

DOORS OPEN



DOORS CLOSED

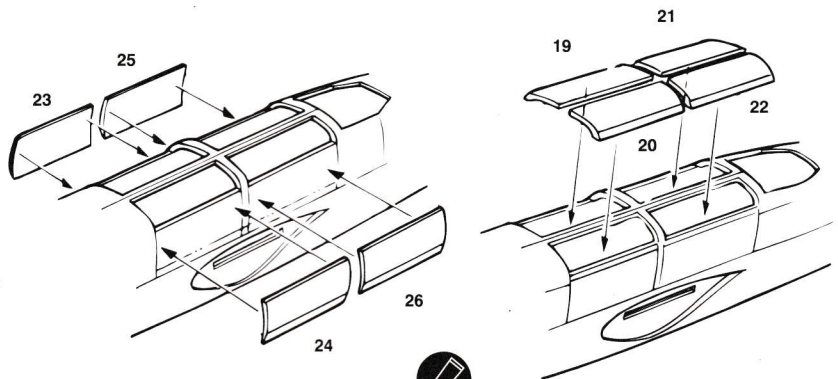

All Parts

11 UNDERSIDE FAIRING

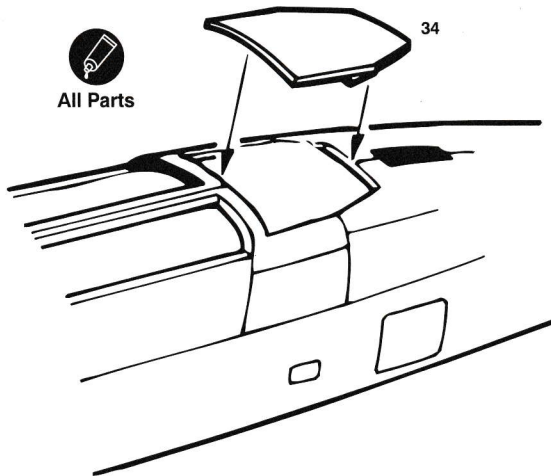

All Parts

12 TAILSKID AND HATCH

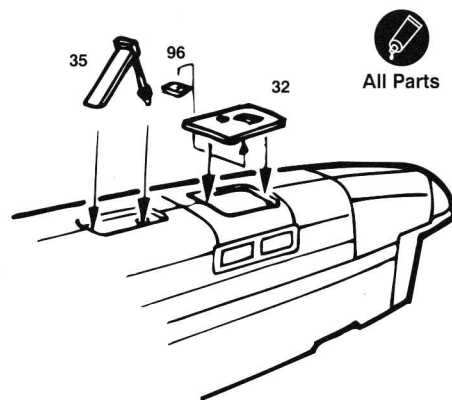

All Parts

13 TAIL TURRET INSTALLATION

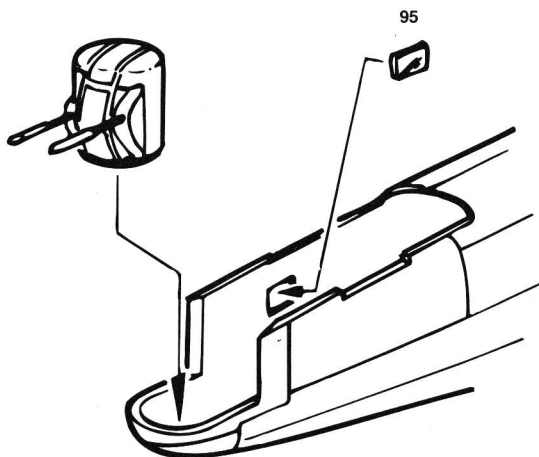

All Parts

14 ENGINE ASSEMBLY

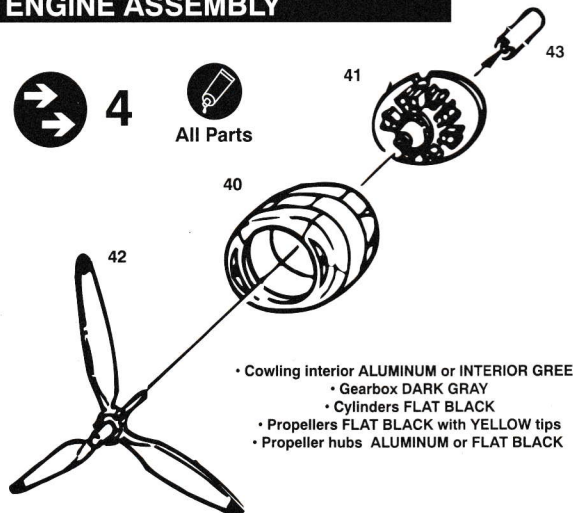

All Parts

- Cowling interior ALUMINUM or INTERIOR GREEN
- Gearbox DARK GRAY
- Cylinders FLAT BLACK
- Propellers FLAT BLACK with YELLOW tips
- Propeller hubs ALUMINUM or FLAT BLACK

15 LEFT AND RIGHT WING ASSEMBLY

- Wheel well and door interiors INTERIOR GREEN
- Main gear struts and wheel hubs ALUMINUM
- Tires FLAT BLACK-GRAY
- Wheel door actuator strut SILVER
- Superchargers/exhausts DULL RUST

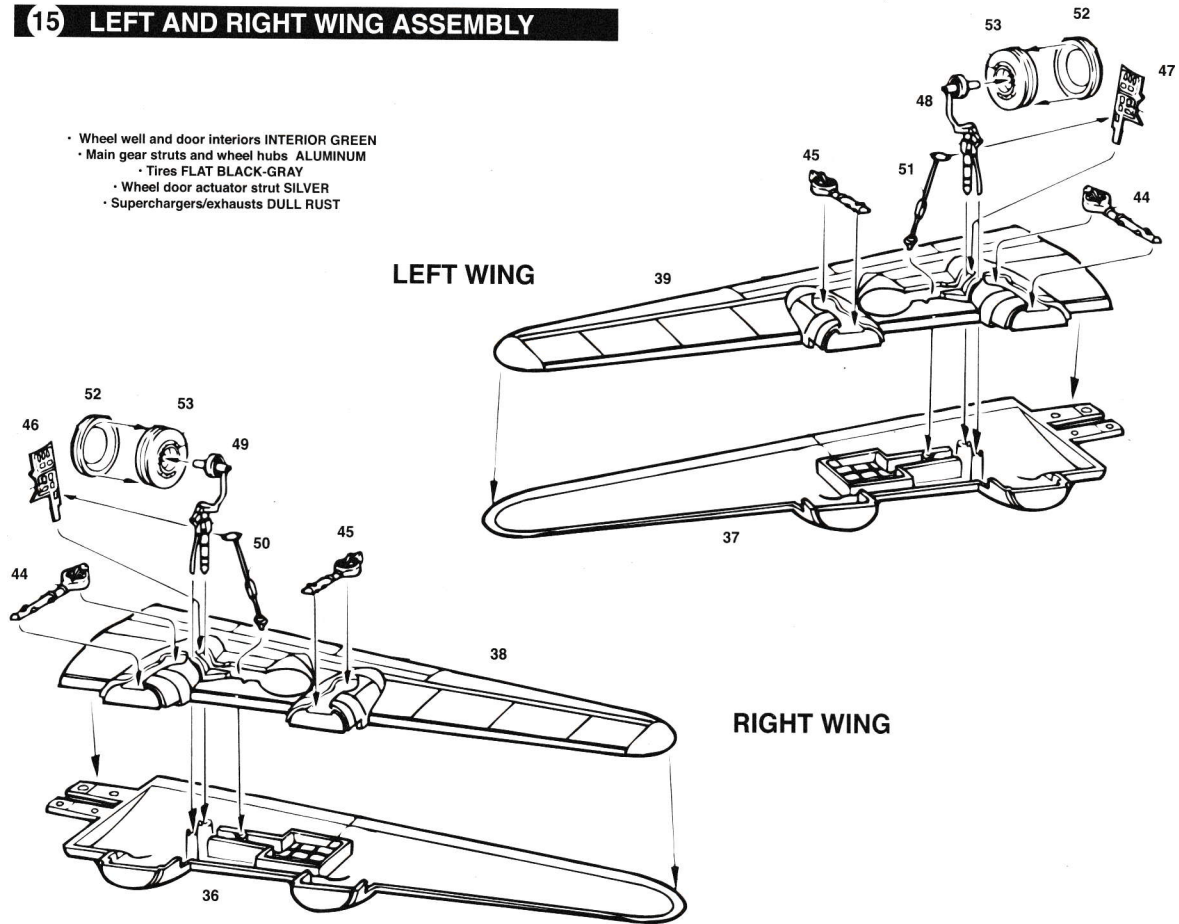

NOTE!
"Silver Streak" fuselage decals MUST be applied before attaching the wings to the fuselage.
Refer to color guide and decal placement information.

16 TAIL AND FINAL ASSEMBLY

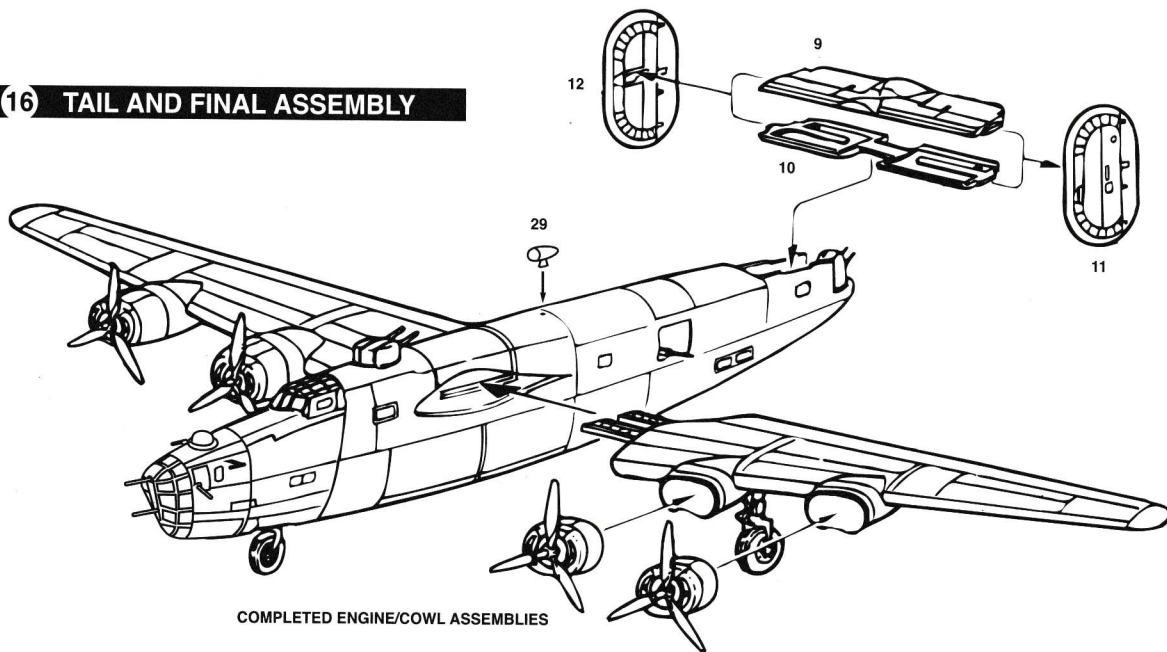

PAINT & DECAL GUIDE

B-24D "Silver Streak" 466th BG Assembly ship (early version)

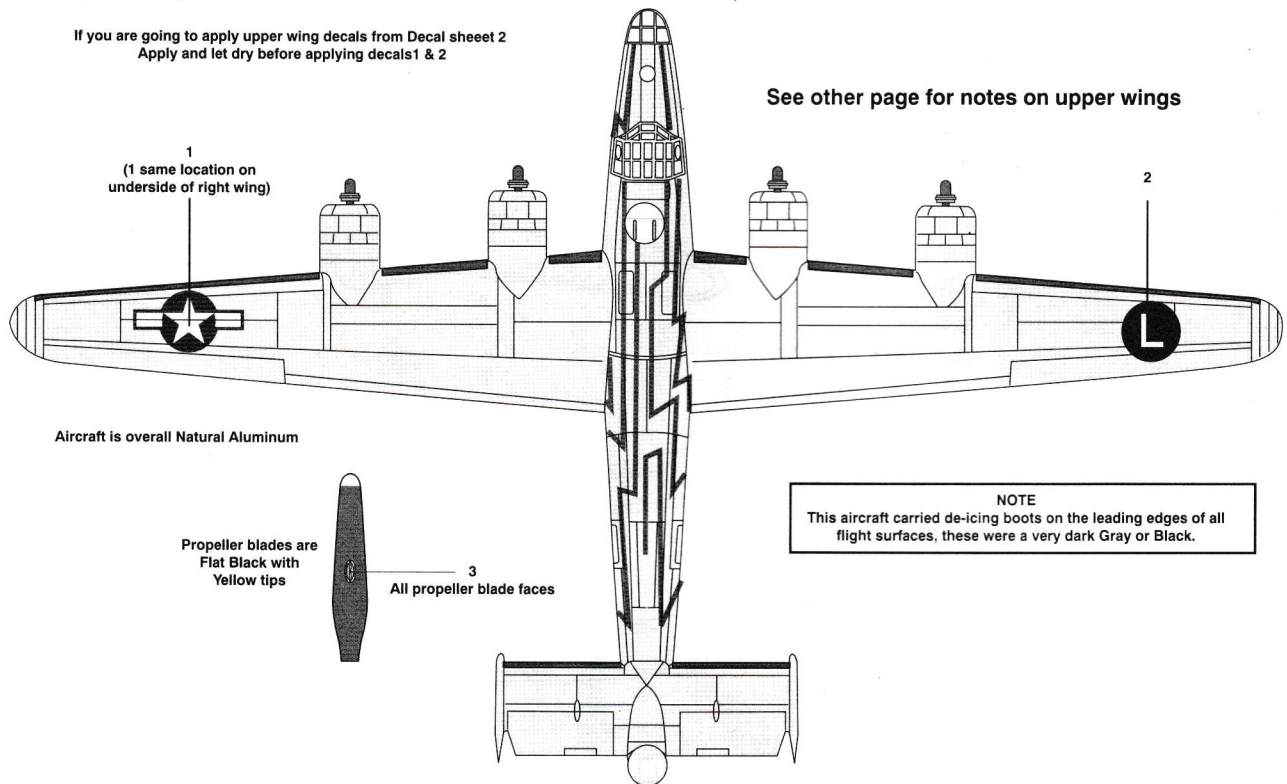

Special note for "Silver Streak"

Various references indicate "Silver Streak" initially carried no wing stripes. Several artistic impressions suggest it may have carried a series of zig-zag stripes on the upper wing on the early version. Photographs indicate the late version at one time carried a series of horizontal stripes from wing root to wing tip. We have provided decals for the later version.

For the earlier version, we have provided a template on the back page.

These templates are provided at size for the advanced modeler to mask and paint the variations of upper wing stripes if desired.

Decal Application:

Your Minicraft model includes high-quality waterslide decals. These decals adhere best to a glossy surface.

Use a sharp scissors or knife to cut individual decals from the carrier sheet.

Do not cut into the clear film surrounding the individual decals.

It is recommended that you apply one decal at a time.

Place the decal section in warm water, when first inserted in the water your decal will curl, after approximately ten seconds the decal will uncurl.

Remove from water and lay on a paper towel.

After approximately 10 - 20 seconds the decal will slide freely from the backing paper.

Use a small brush to help slide the decal from the backing paper and into position on the model.

Carefully blot excess water from the decal, using care not to move the decal or tear it.

If you choose to use a setting solution, apply a thin coat over the decal following the manufacturer's instruction.

Allow the decal to dry overnight. Wash any adhesive residue off the model with a small wet towel.

B-24D "Silver Streak" 466th BG Assembly ship (early version)

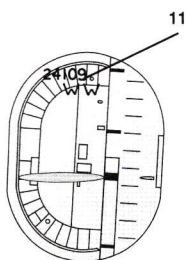
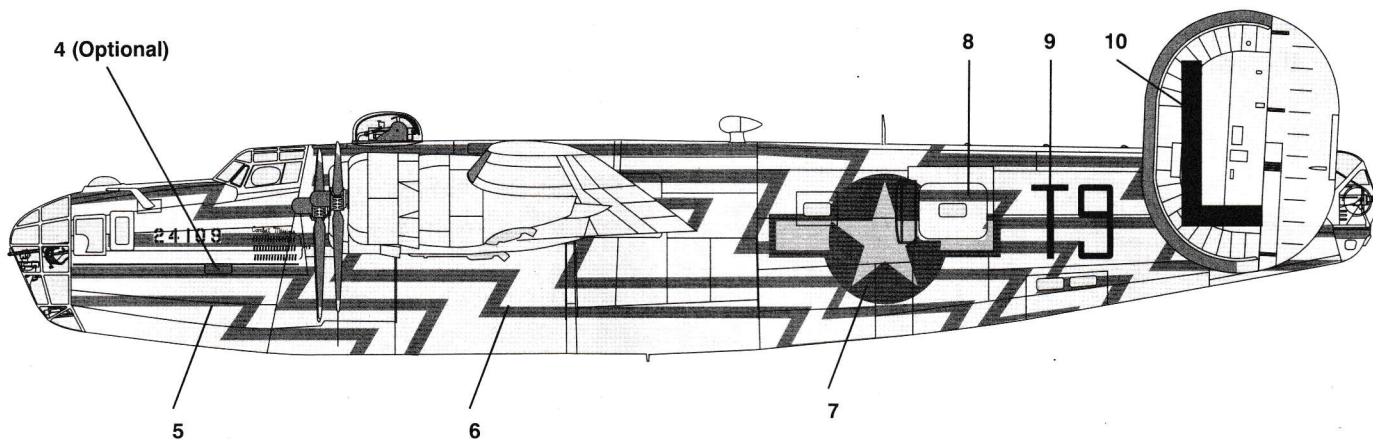

Inside Starboard (Right) tail

16 (Apply to part 23 OR 19)



18 (Apply to part 25 OR 21)

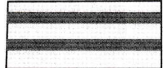

17 (Apply to part 24 OR 20)

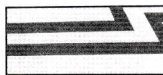

19 (Apply to part 26 OR 22)

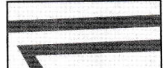

Bomb bay doors

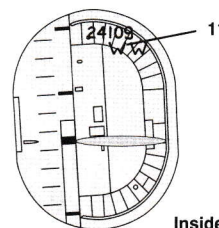

Inside Port (Left) tail

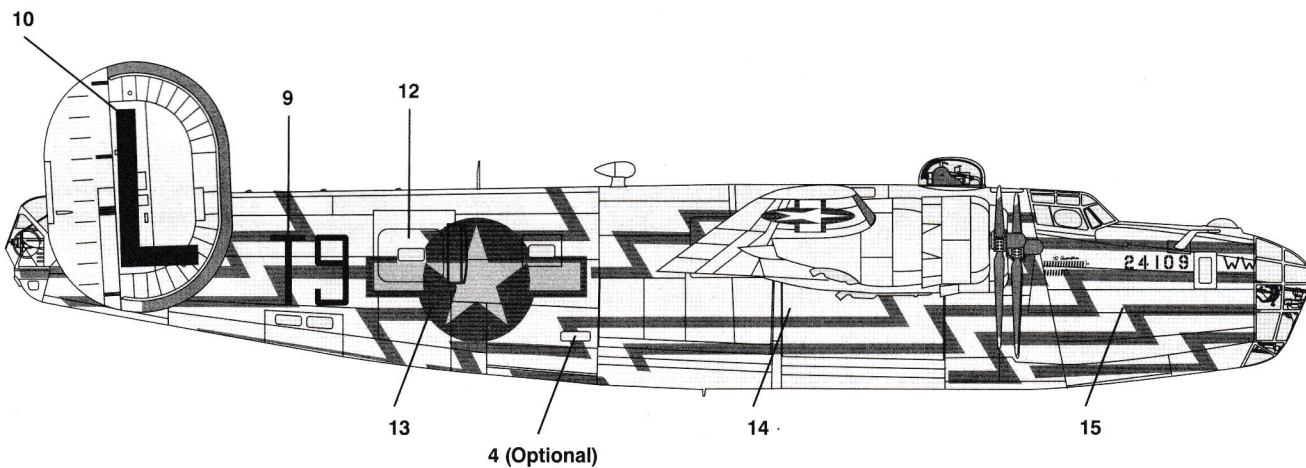

IMPORTANT!

Fuselage decals for "Silver Steak" are in three parts per side. Start with the middle decal (Right side 14, Left side 6). Use plenty of water or mild decal solution to allow the decal to 'float' into position. Carefully slide the decal to align with the thin outline of the wing root opening. Then apply the forward and rear decal, aligning the stripes to the center decals. It is best to cut the decals from the sheet and familiarize yourself with the alignment before dipping them in water.

B-24D "Silver Streak" 466th BG Assembly ship (late version)

NOTE: All markings are the same as the early version except as noted.

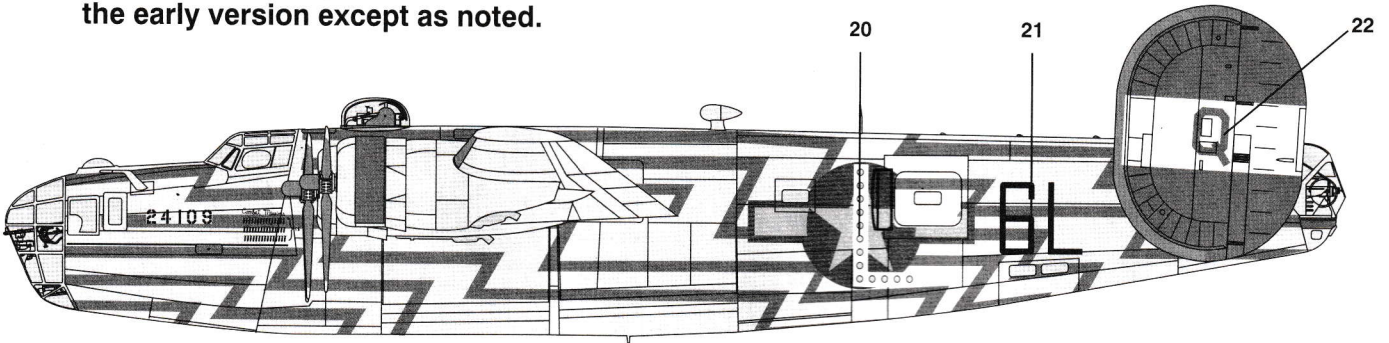

Paint outside faces of vertical tails as shown.

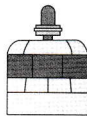

**Inboard cowlings
(Left and Right)**

**Outboard cowling
(Left and Right)**

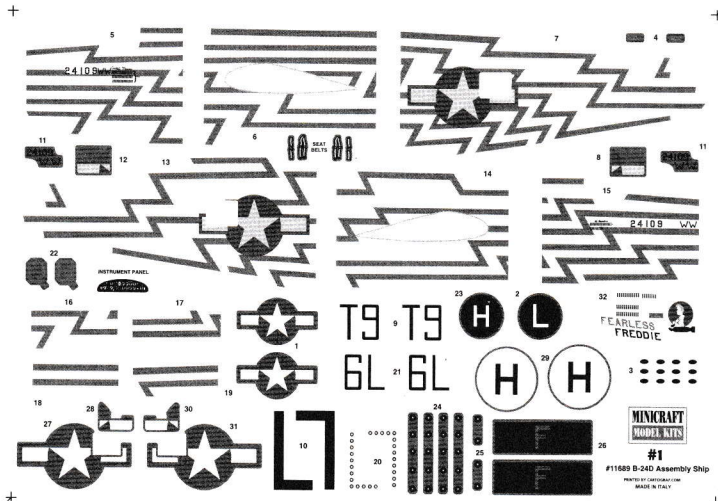
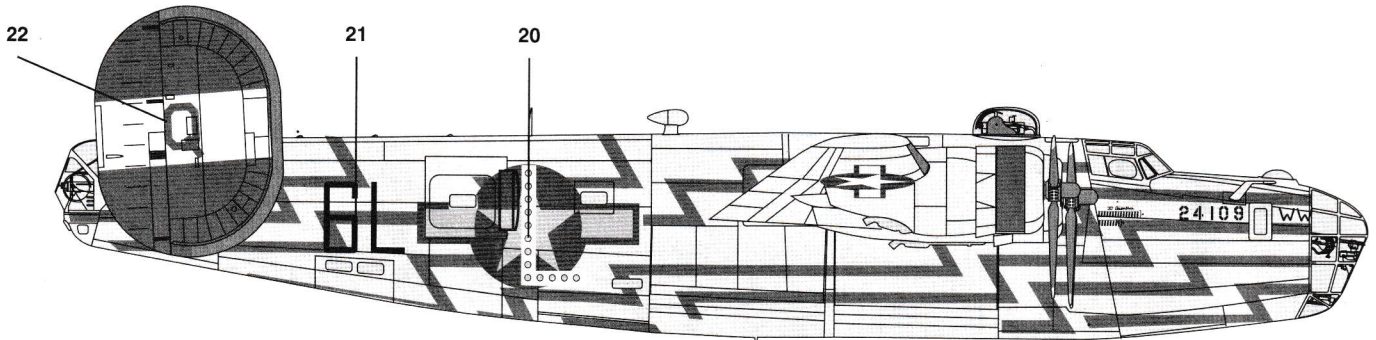

B-24D "Fearless Freddie" 446th BG Assembly ship

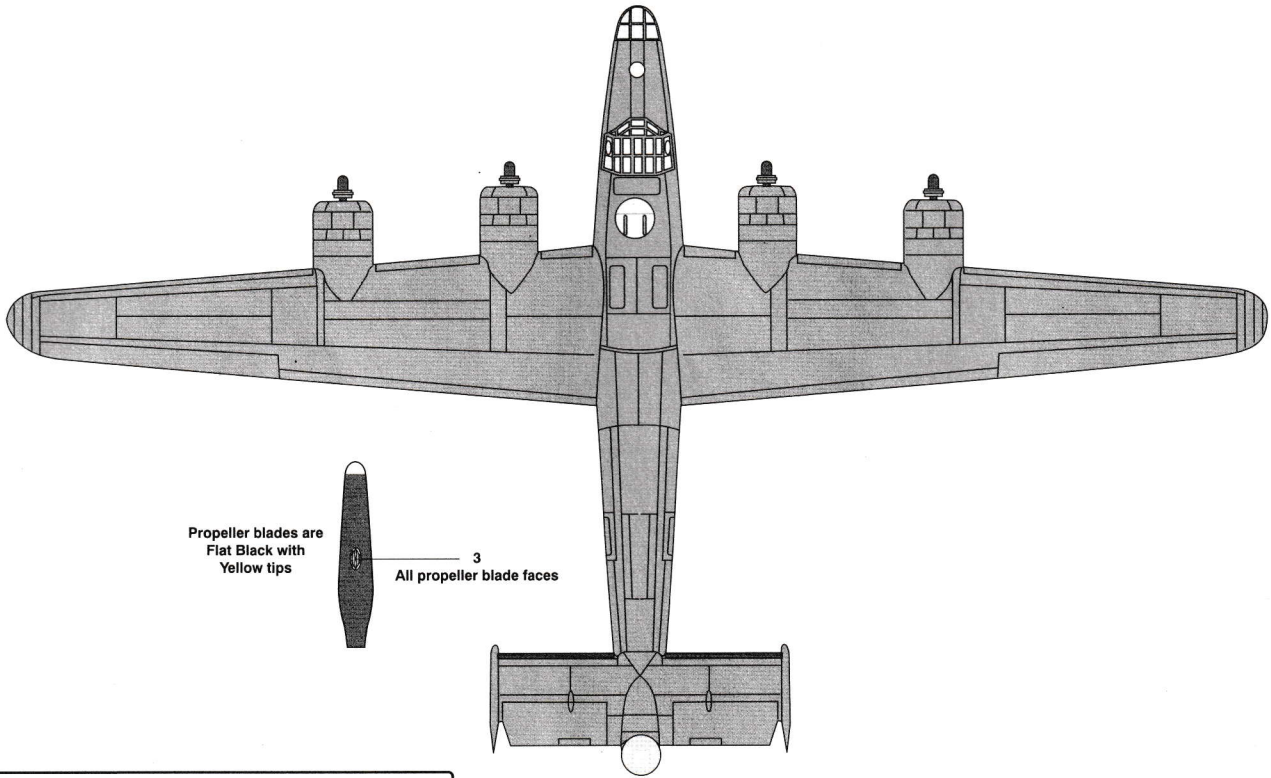

Aircraft is overall Yellow, though some sources state overall Orange except for the tail markings

Late tail markings and fuselage lights

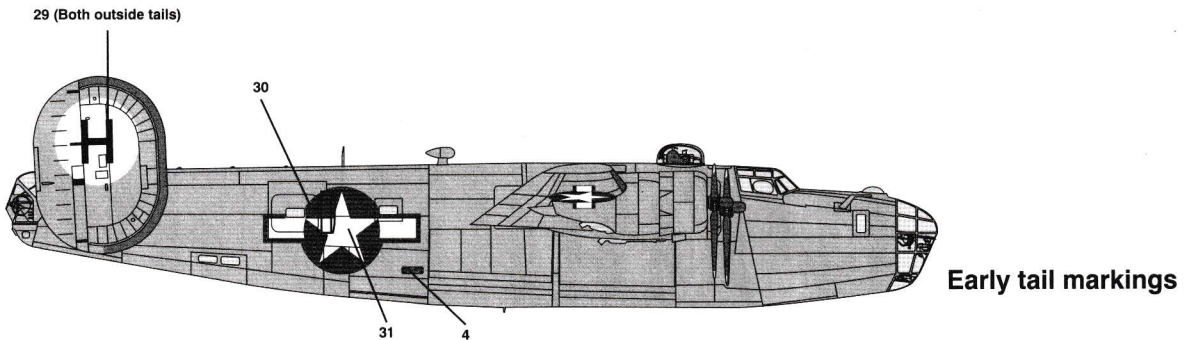
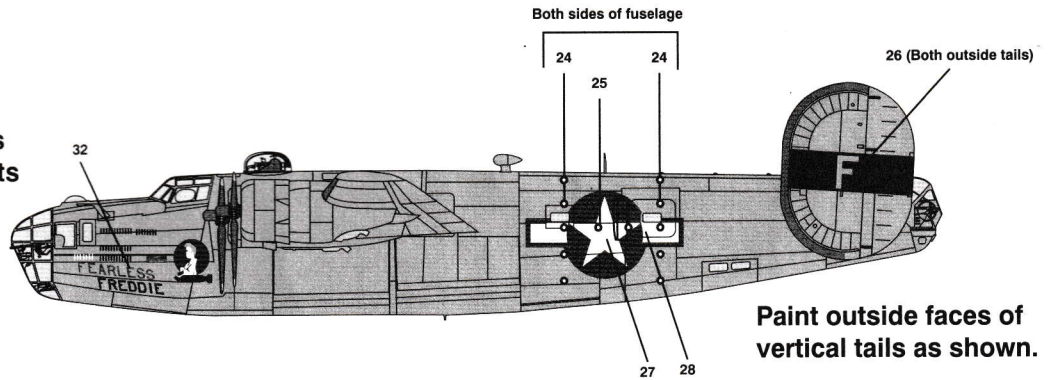

Special note for "Silver Streak"

Various references indicate "Silver Streak" initially carried no wing stripes. Several artistic impressions suggest it may have carried a series of zig-zag stripes on the upper wing on the early version. Photographs indicate the late version at one time carried a series of horizontal stripes from wing root to wing tip. These templates are provided at size for the advanced modeler to mask and paint the variations of upper wing stripes if desired.

Early version

Late version

