

MIL MI-24 HIND GUNSHIP

MONOGRAM

KIT 5819

1/48 SCALE MASSTAB 1:48
 ESCALA 1/48 SCHAAL 1:48 1/48 ECHELLE
 SKALA 1/48 SCALA 1/48

MONOGRAM MODELS, INC. Des Plaines, IL Copyright ©1987. All rights reserved. Made in U.S.A. 5819-0201

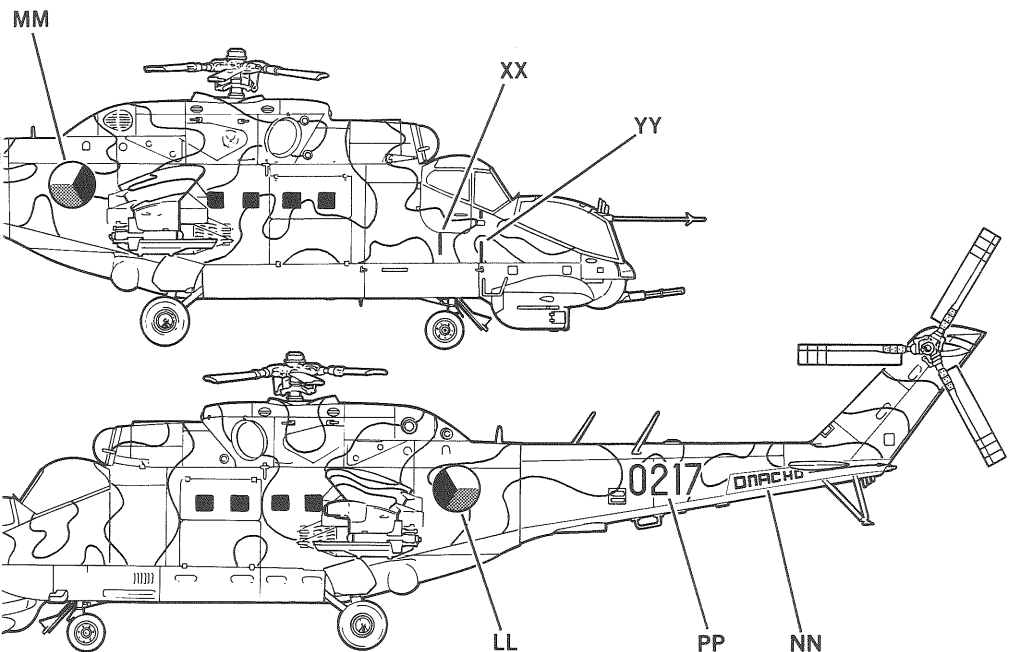
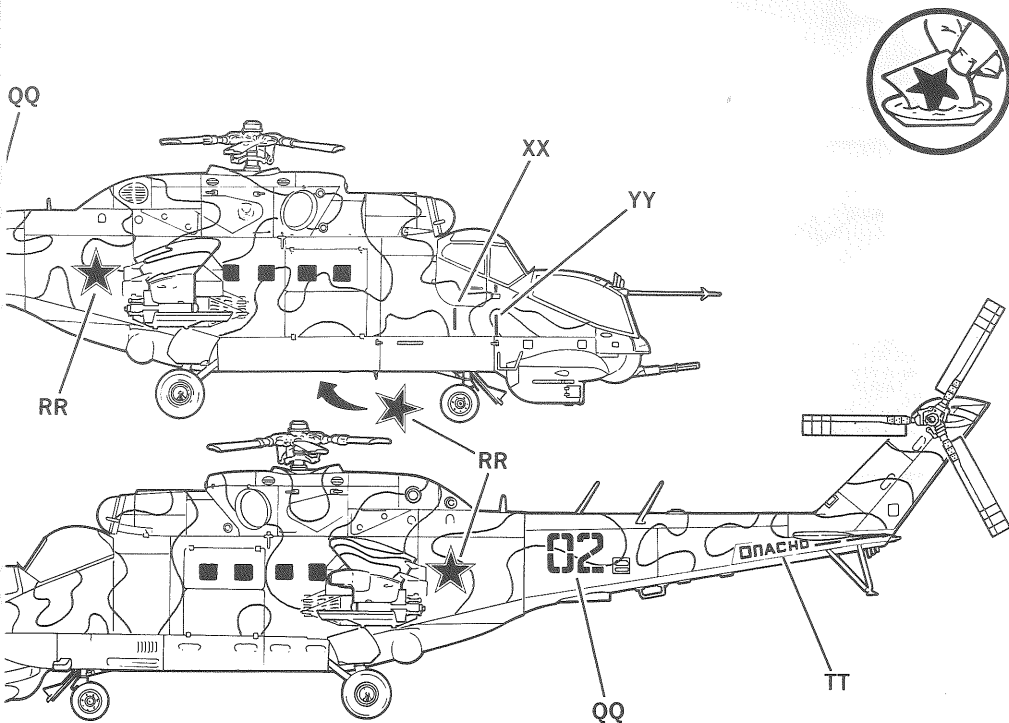

One of the deadliest weapons in the skies today is the attack helicopter, the most formidable of these being the Soviet Mil Mi-24 Hind. This weapon is seen in two major variations, The Hind A, with an angular cockpit greenhouse, and the Hind D, with a unique double-bubble arrangement for the two pilots. Both versions are equipped to carry up to eight fully armed troops plus heavy loads of weapons and support equipment, a characteristic unique to the Hind.

The Hind D version, depicted by this Monogram model, is specifically designed for the ground attack role, and carries a nose-mounted 12.7mm four barrel rotary cannon. Additional guns can be mounted on the stubby wings, along with a variety of the ground attack missiles and bombs. Two of these helicopters were delivered to the West by defectors in 1986.

Production of this deadly machine began over ten years ago and several hundred have been exported to countries outside the Warsaw Pact. Most notable have been the Hinds used by the Soviet-backed puppet government in Afghanistan and those now fighting with the Sandinistas in Nicaragua, about 300 miles south of Mexico.

The Mi-24 is fast, having a top speed of nearly 200 mph, due to a pair of stubby wings which provide nearly 25% of the lift at cruise. This also makes the Hind quite maneuverable, but it has a combat range of only 99 miles.

Your kit of the Hind D comes with markings for these helicopters used in Afghanistan, Czechoslovakia, Nicaragua and by the Soviet Union.



CEMENT TOGETHER
 VERKLEBEN
 UNIR CON PEGAMENTO
 LJIMEN
 À COLLER
 LIMMAS
 INCOLLA INSIEME



DO NOT CEMENT
 NICHT KLEBEN
 NO USE PEGAMENTO
 NIET LJIMEN
 NE PAS COLLER
 LIMMAS INTE
 NON INCOLLARE



OPTIONAL PARTS
 BAUTEILE NACH WAHL
 PIEZAS OPCIONALES
 KEUZE-ONDERDELEN
 PIÈCES EN OPTION
 VALFRIA DELAR
 PARTI FACOLTATIVE



REMOVE AND THROW AWAY
 ENTFERNEN (ABFALL)
 QUITE Y TIRE
 VERWIJDEREN EN WEGGOOIEN
 À RETIRER ET JETER
 AVLAGSNAS OCH MAKULERAS
 RIMOUVI ED ELIMINA



REPEAT SEVERAL TIMES
 ARBEITSGANG MEHRMALS WIEDERHOLEN
 REPITA VARIAS VECES
 ENIGE KEREN HERHALEN
 À RÉPÉTER PLUSIEURS FOIS
 ARBETSMOMENT SOM UPPREPAS
 RIFETI DIVERSE VOLTE



DECAL (DIP IN WATER)
 ABZIEHBILD
 DECALCOMANIA (MOJE CON AGUA)
 TRANSFERS (IN WATER DOPEN)
 DECALCOMANIE (À PLONGER DANS L'EAU)
 DEKAL (DOPPAS I VATTEN)
 DECALCOMANIA (IMMERGI IN ACQUA)

If you have any problems building this model, call our modeling tips hotline at: **(800) 833-3570**

Every effort has been made to create and manufacture a model kit that is the finest available. If a part may be missing, please write to:

Monogram Models, Incorporated
 Consumer Service Department
 395 North Third Avenue
 Des Plaines, Illinois 60016

Be sure to include the kit number, part number, description, and your return address.

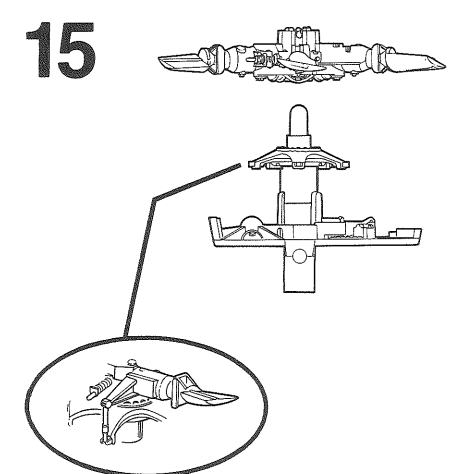
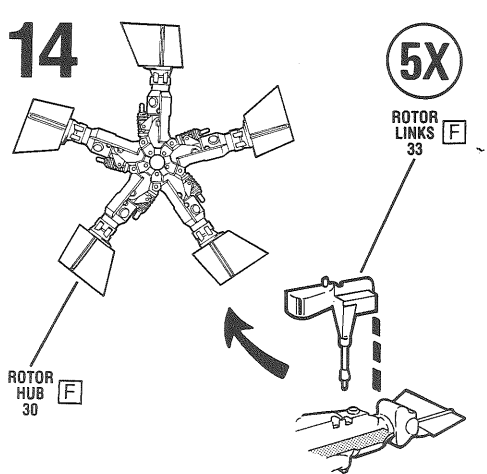
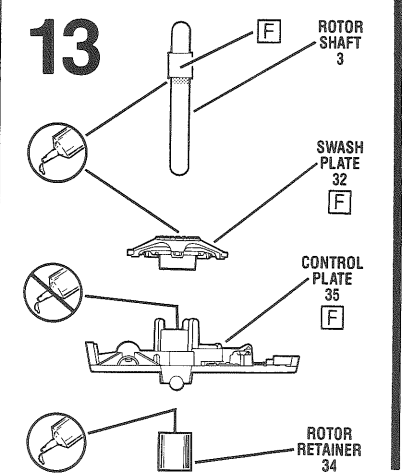
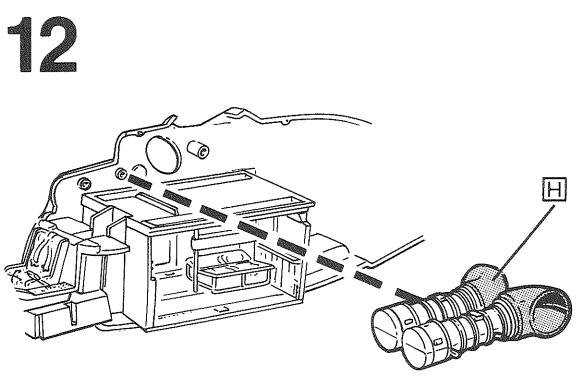
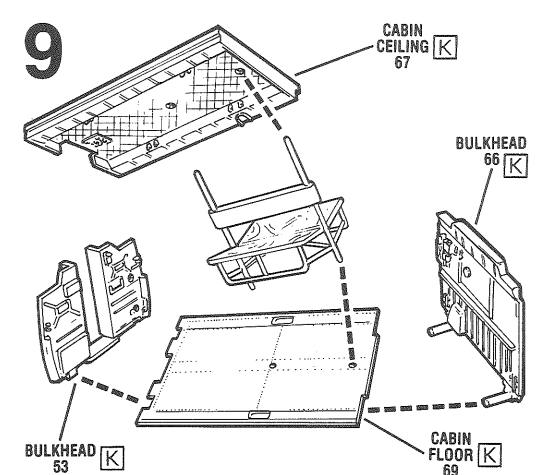
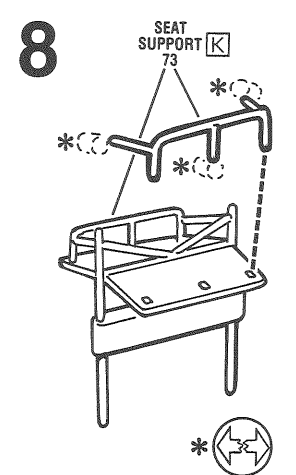
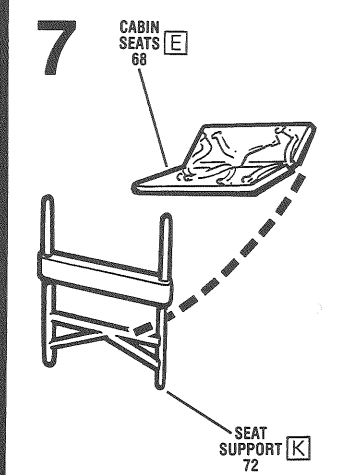
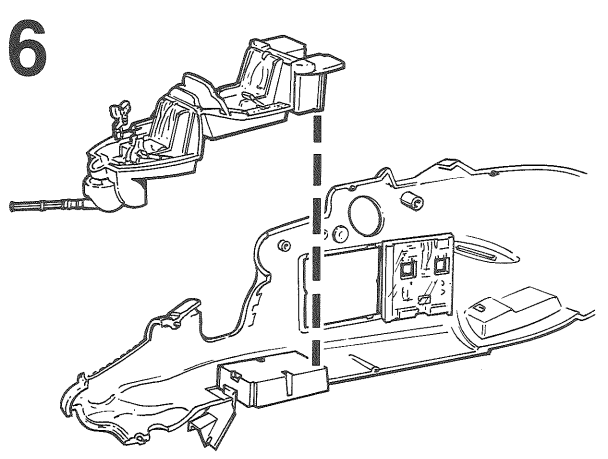
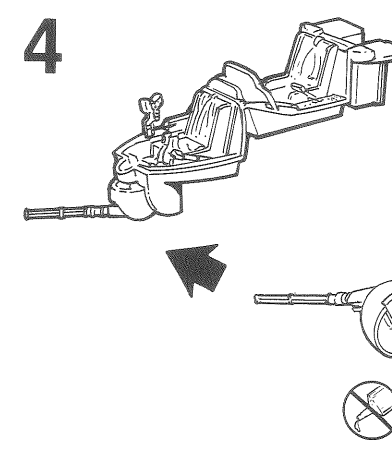
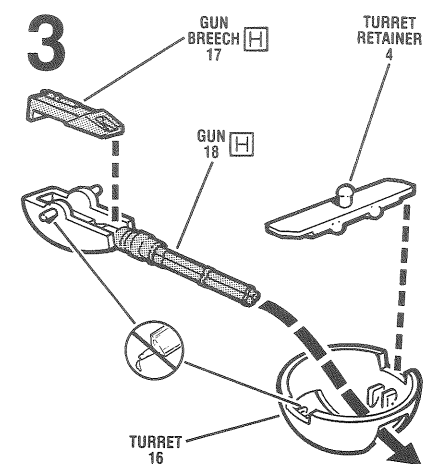
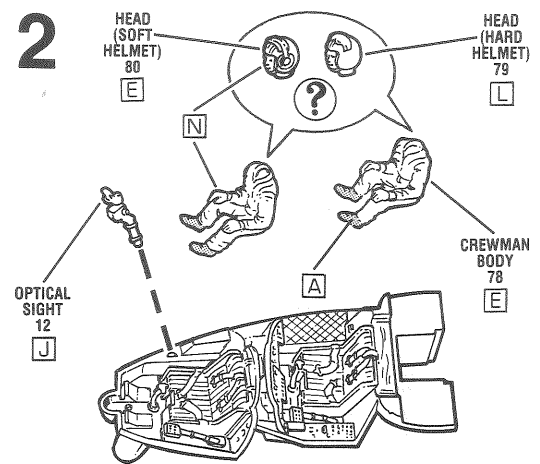
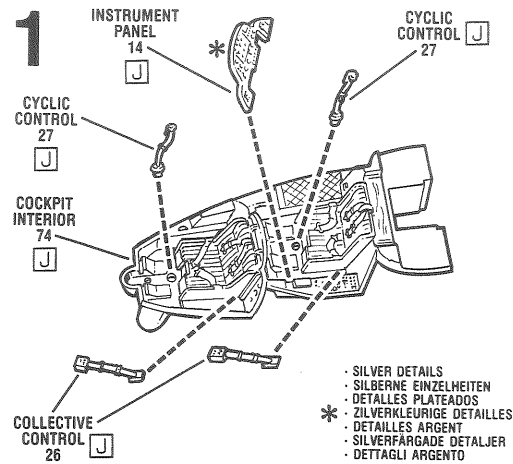

HIARO
 HIARO
 IVA
 HIARO
 SCURD
 IO
 O
 CO
 URD
 PELLE

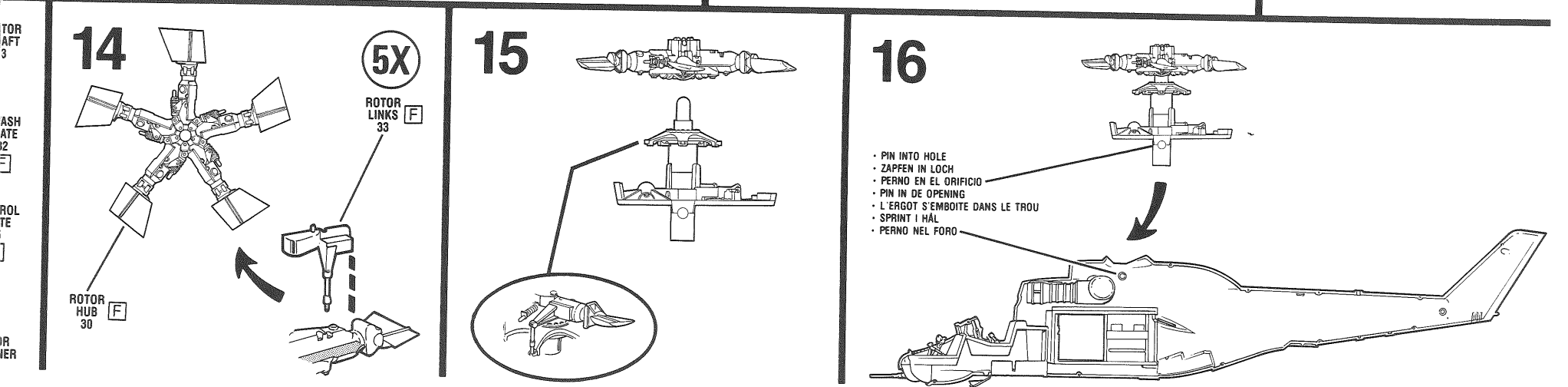
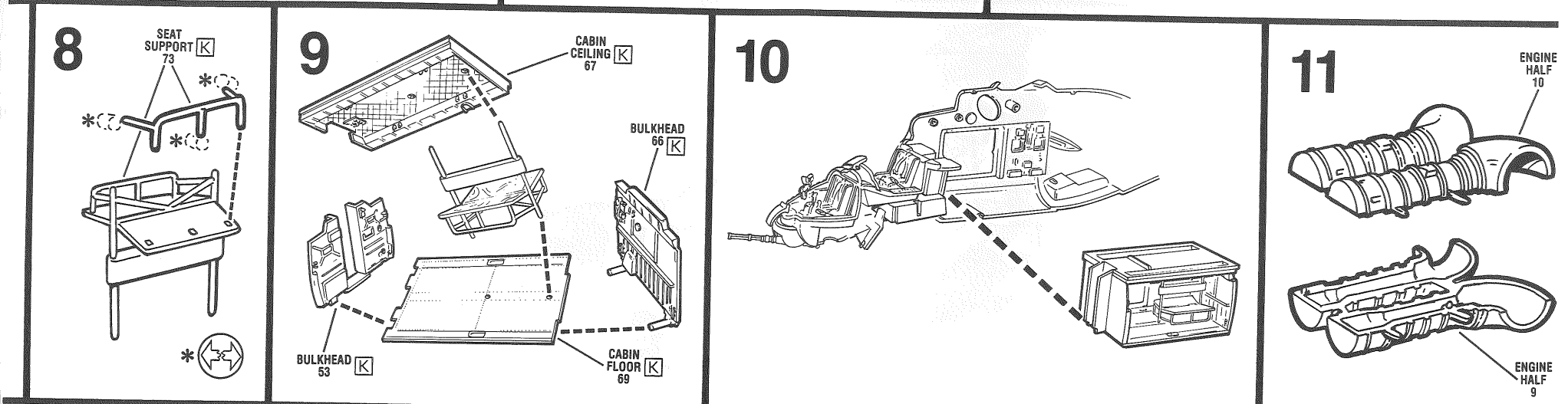
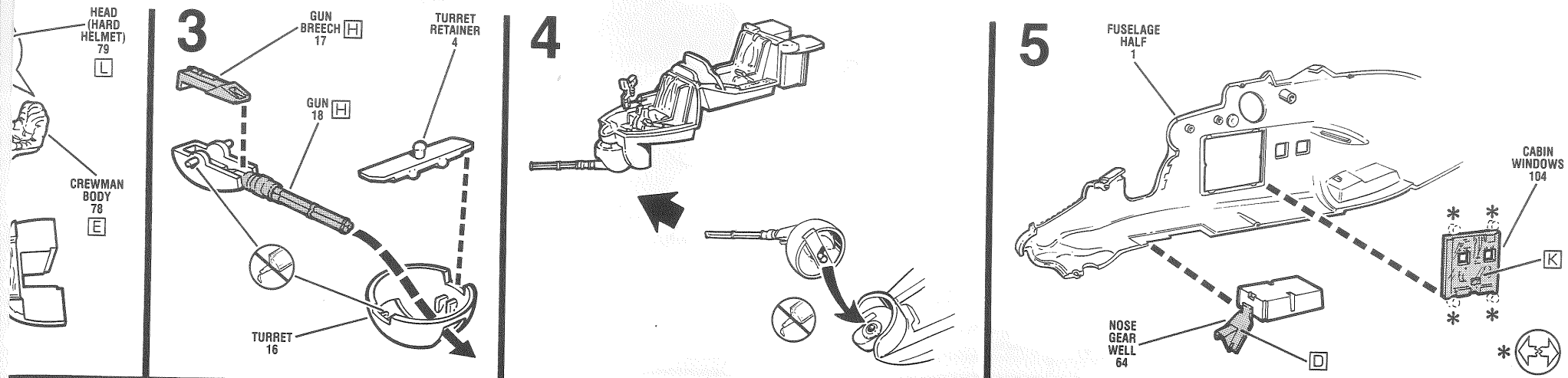

17

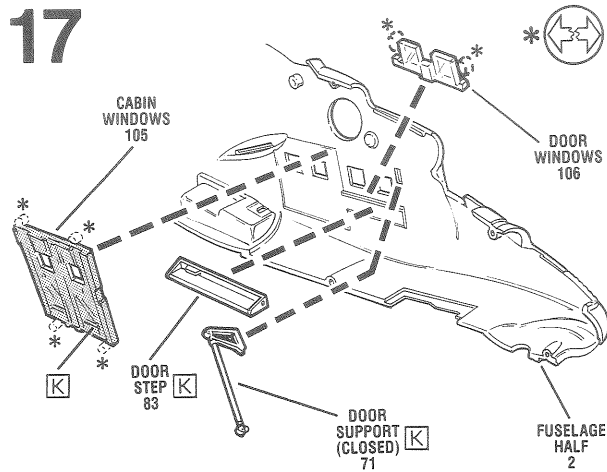

18

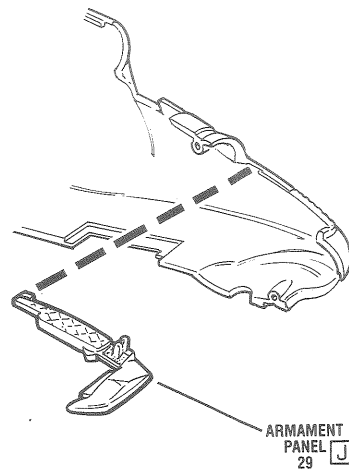

19

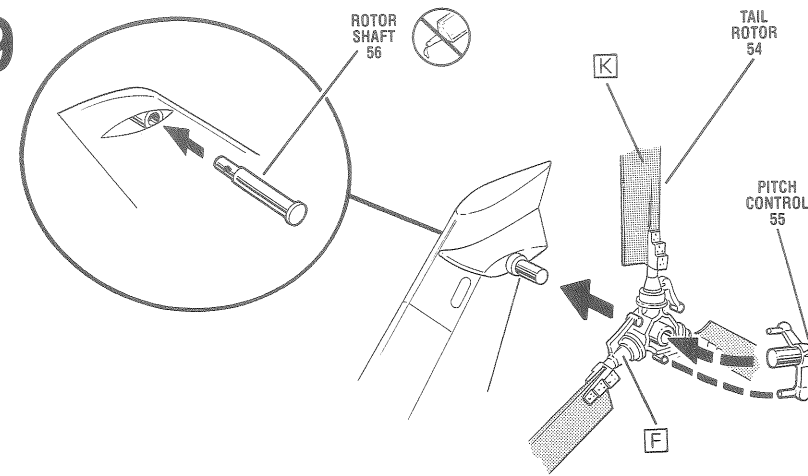

23

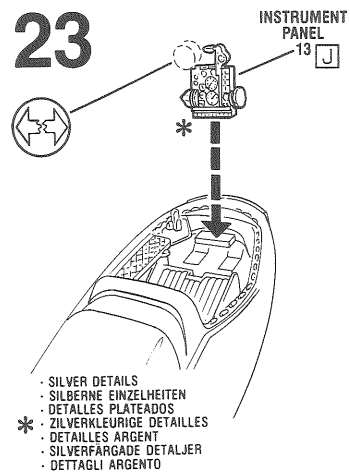

24

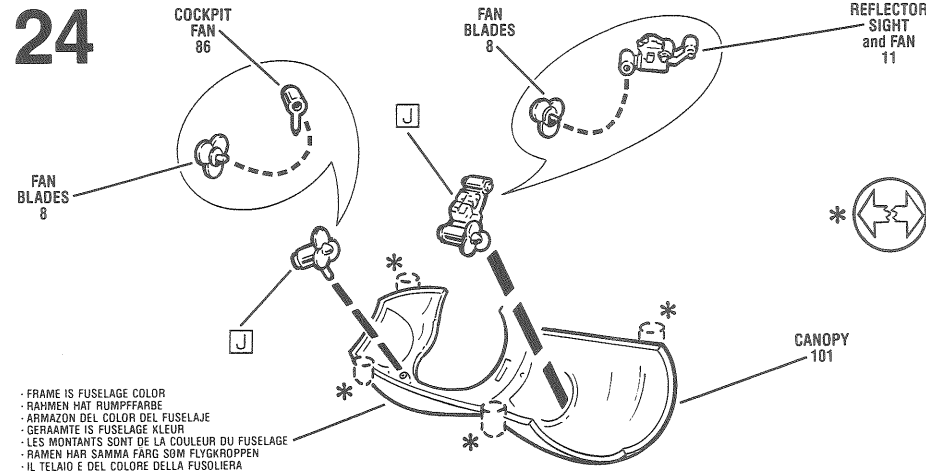

25

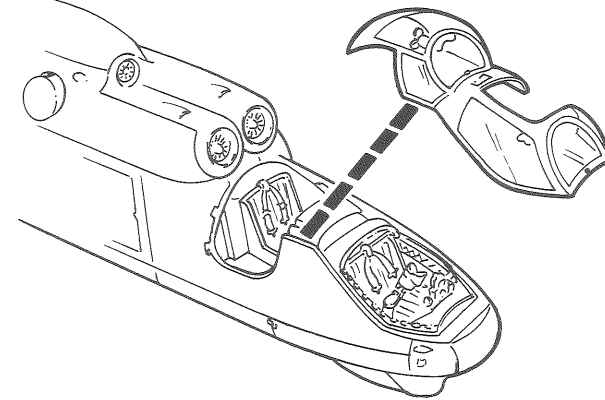

29

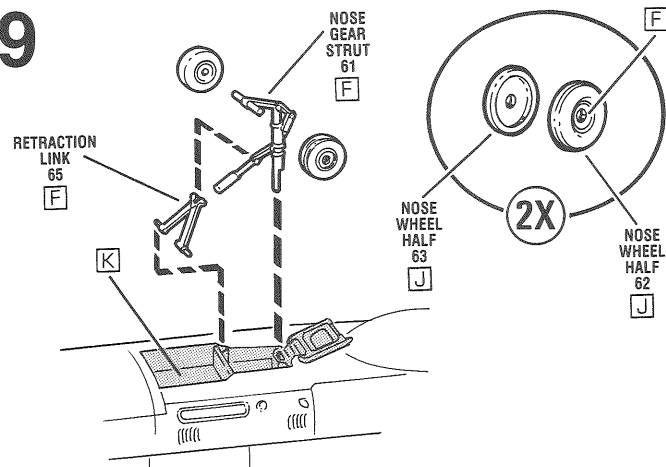

30

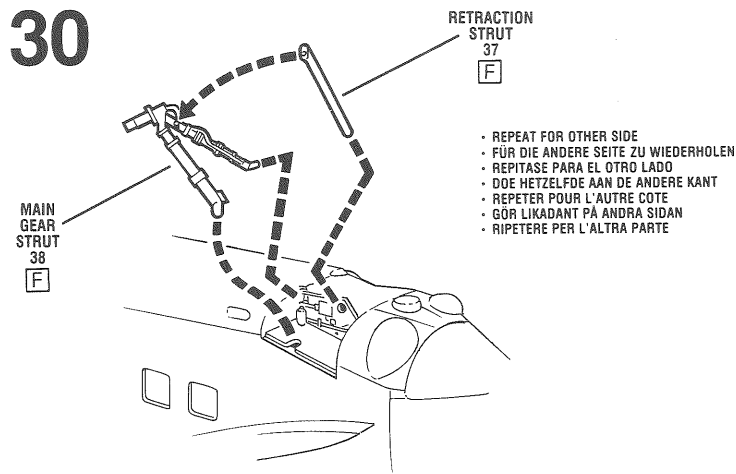

31

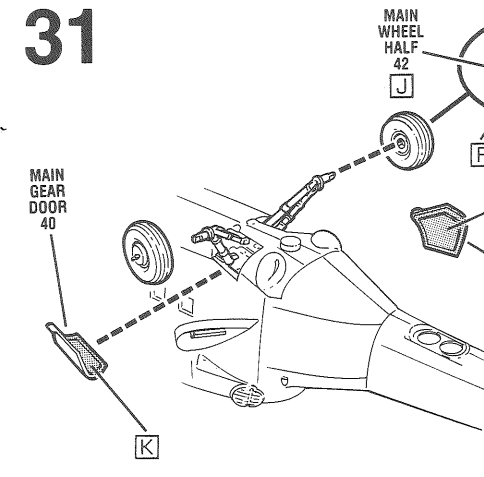

- SILVER DETAILS
- SILBERNE EINZELHEITEN
- DETALLES PLATEADOS
- * ZILVERKLEURIGE DETAILLES
- DETAILLES ARGENT
- SILVERFÄRGADE DETALJER
- DETTAGLI ARGENTO

- FRAME IS FUSELAGE COLOR
- RAHMEN HAT RUMPFARBE
- ARMAZON DEL COLOR DEL FUSELAJE
- GERAMANTE IS FUSELAGE KLEUR
- LES MONTANTS SONT DE LA COULEUR DU FUSELAGE
- RAMEN HAR SAMMA FÄRG SOM FLYGKROPPEN
- IL TELAIO E DEL COLORE DELLA FUSOLIERA

- REPEAT FOR OTHER SIDE
- FÜR DIE ANDERE SEITE ZU WIEDERHOLEN
- REPITASE PARA EL OTRO LADO
- DOE HETZELFOE AAN DE ANDERE KANT
- REPETER POUR L'AUTRE COTE
- GÖR LIKADANT PÅ ANDRA SIDAN
- RIPETERE PER L'ALTRA PARTE

20

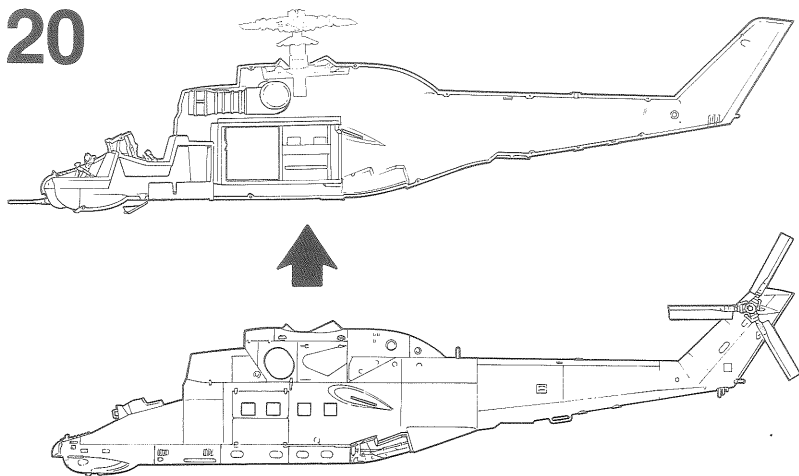

21

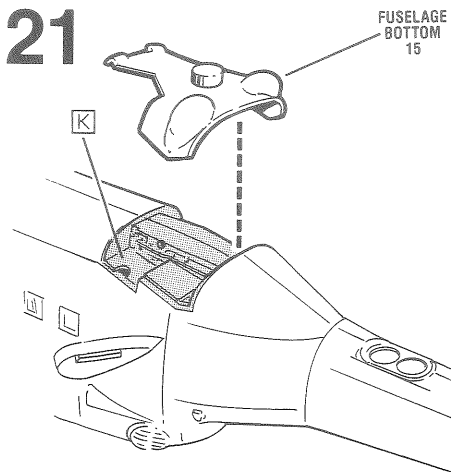

22

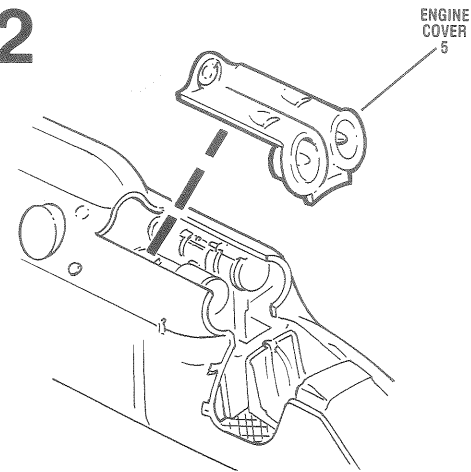

26

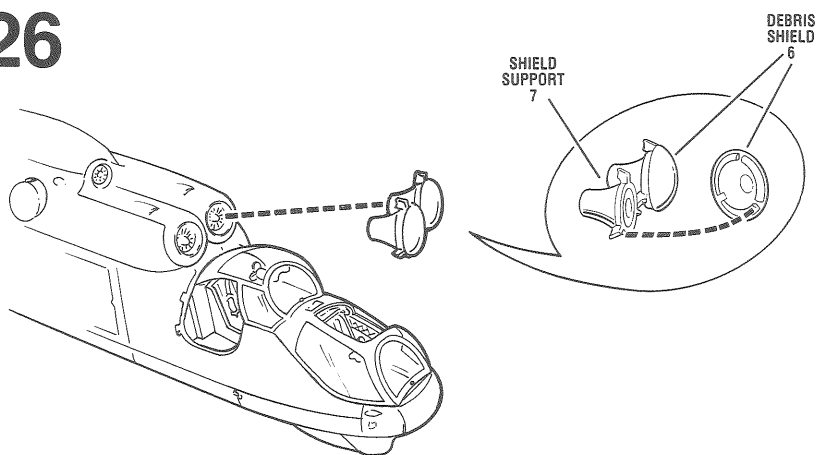

27

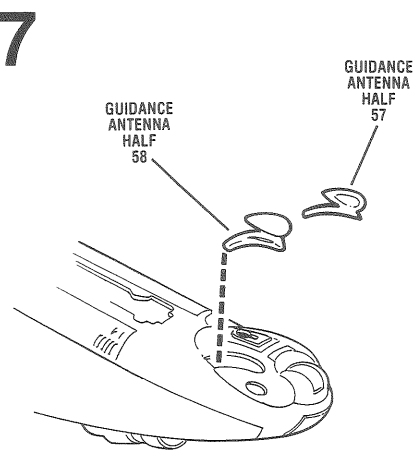

28

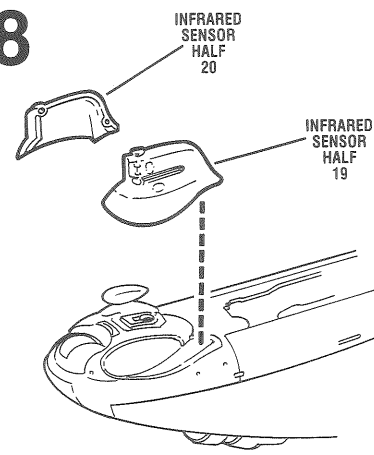

MAIN WHEEL HALF 43

K

MAIN GEAR DOOR 41

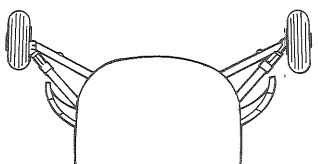

32

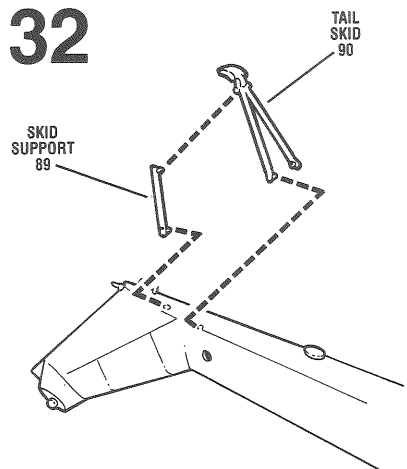

33

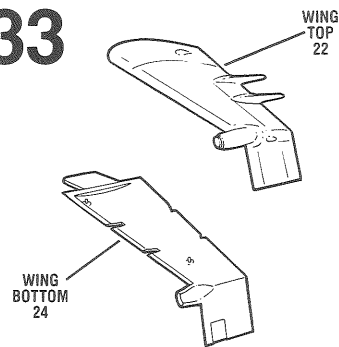

- REPEAT FOR OTHER SIDE
- FÜR DIE ANDERE SEITE ZU WIEDERHOLEN
- REPETASE PARA EL OTRO LADO
- DOE HETZELFDE AAN DE ANDERE KANT
- REPETER POUR L'AUTRE COTE
- GÖR LIKADANT PÄ ANDRA SIDAN
- RIPETERE PER L'ALTRA PARTE

34

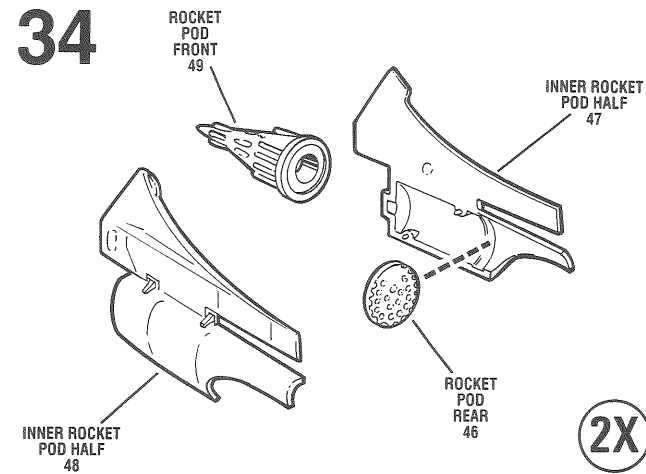

2X

35

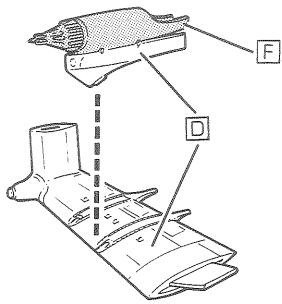

- REPEAT FOR OTHER SIDE
- FÜR DIE ANDERE SEITE ZU WIEDERHOLEN
- REPITASE PARA EL OTRO LADO
- DOE HETZELFDE AAN DE ANDERE KANT
- REPETER POUR L'AUTRE COTE
- GÖR LIKADANT PÅ ANDRA SIDAN
- RIPETERE PER L'ALTRA PARTE

36

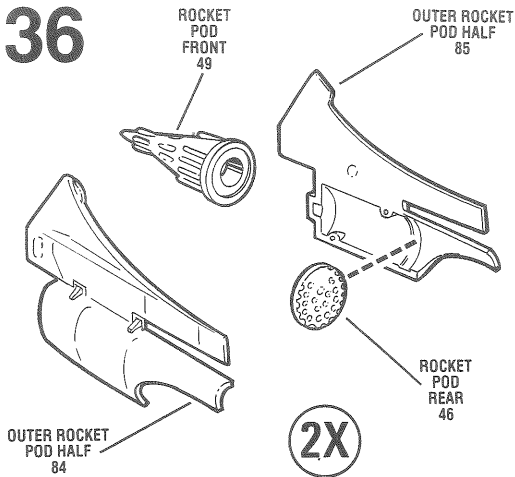
**2X**

37

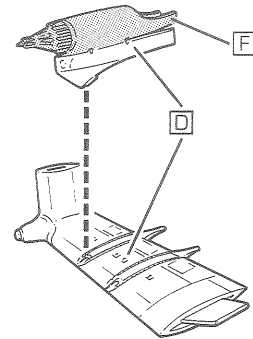

- REPEAT FOR OTHER SIDE
- FÜR DIE ANDERE SEITE ZU WIEDERHOLEN
- REPITASE PARA EL OTRO LADO
- DOE HETZELFDE AAN DE ANDERE KANT
- REPETER POUR L'AUTRE COTE
- GÖR LIKADANT PÅ ANDRA SIDAN
- RIPETERE PER L'ALTRA PARTE

38

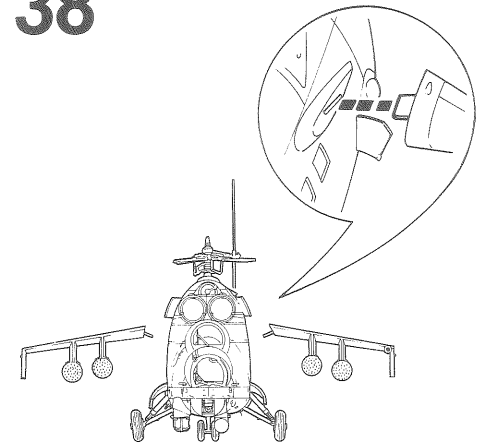

42

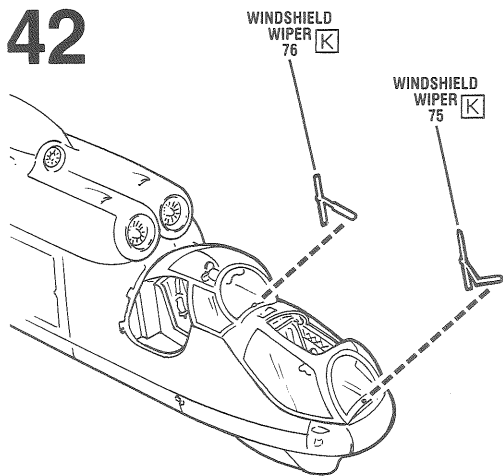

43

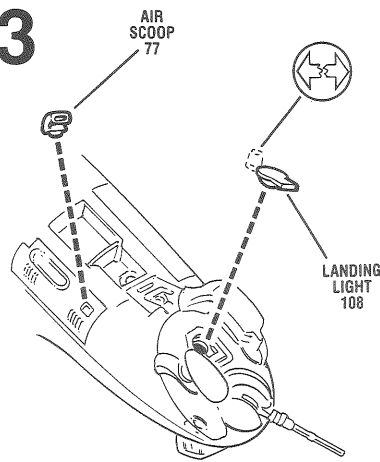

44

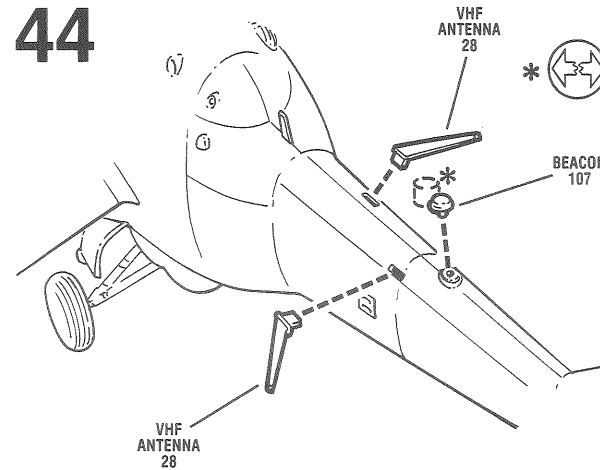

45

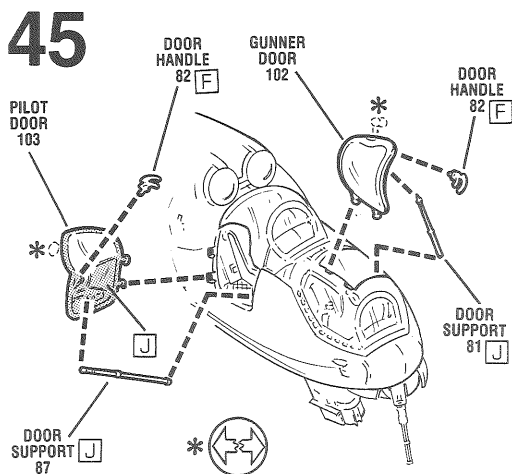

46

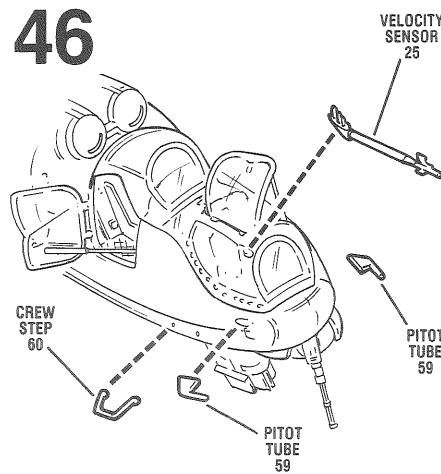

47

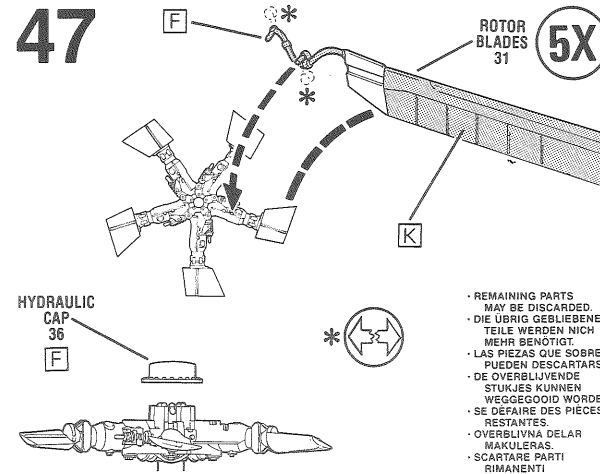

- REMAINING PARTS MAY BE DISCARDED.
- DIE ÜBRIG GESIEBENEN TEILE WERDEN NICHT MEHR BENÖTIGT.
- LAS PIEZAS QUE SOBREN PUEDEN DESCARTARSE.
- DE OVERBLIJVENDE STUKJES KUNNEN WEGGOEDD WORDEN.
- SE DÉFAIRE DES PIÈCES RESTANTES.
- ÖVERBLIVNA DELAR MAKULERAS.
- SCARTARE PARTI RIMANENTI

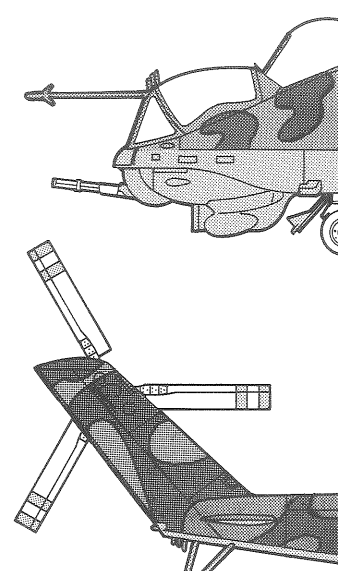

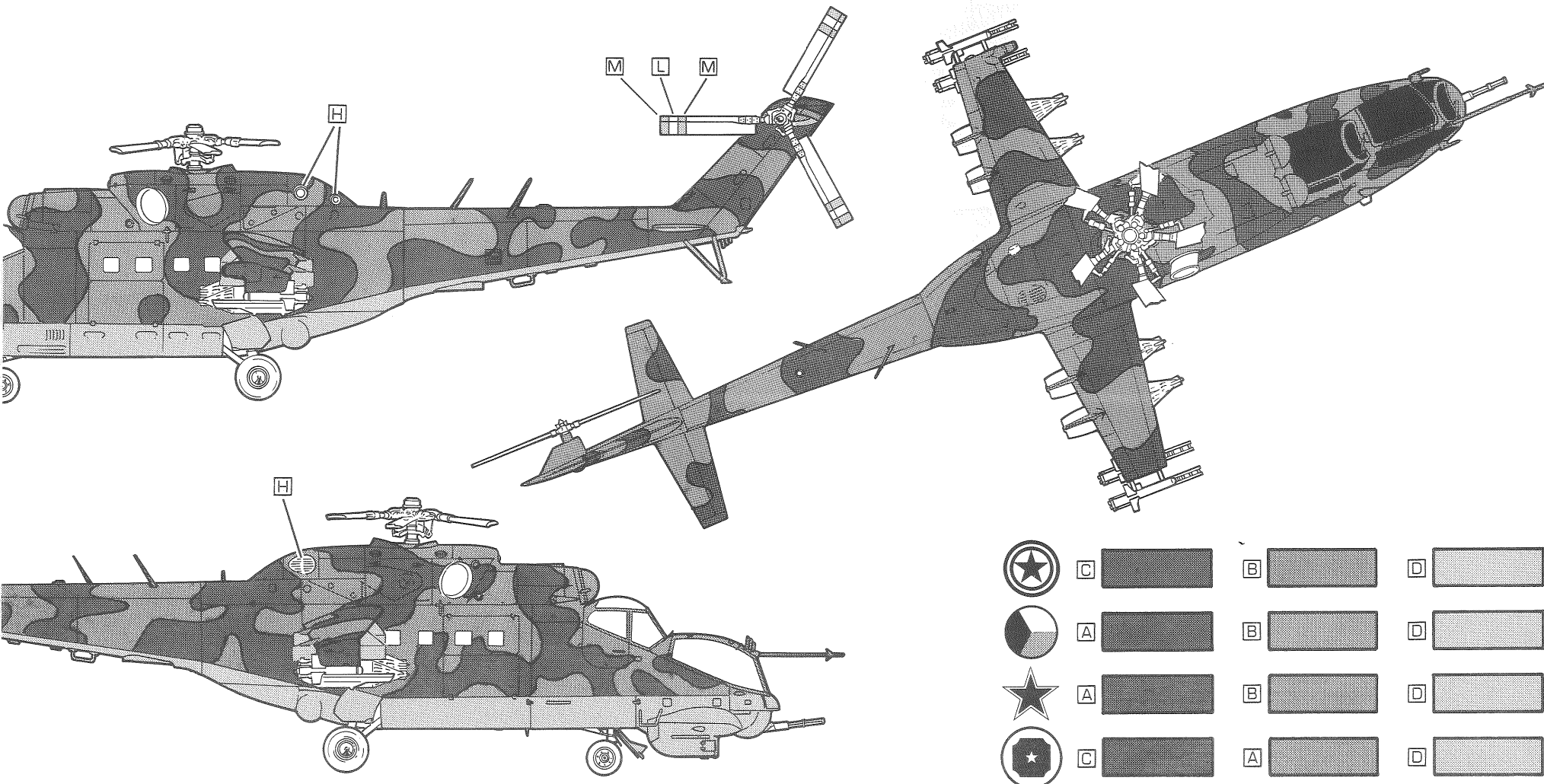
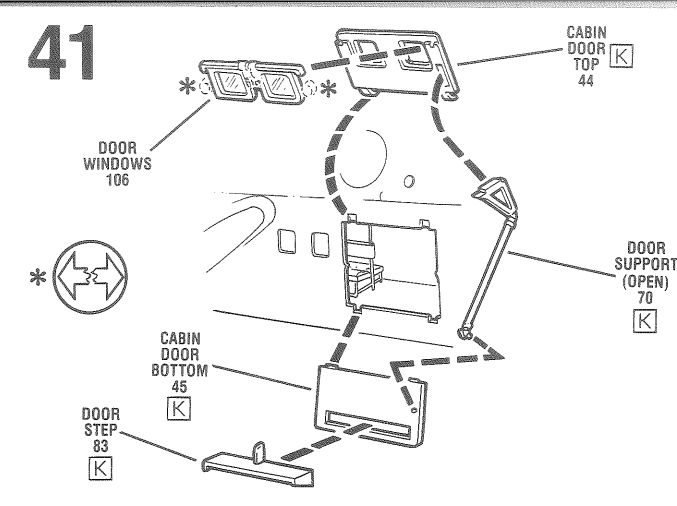
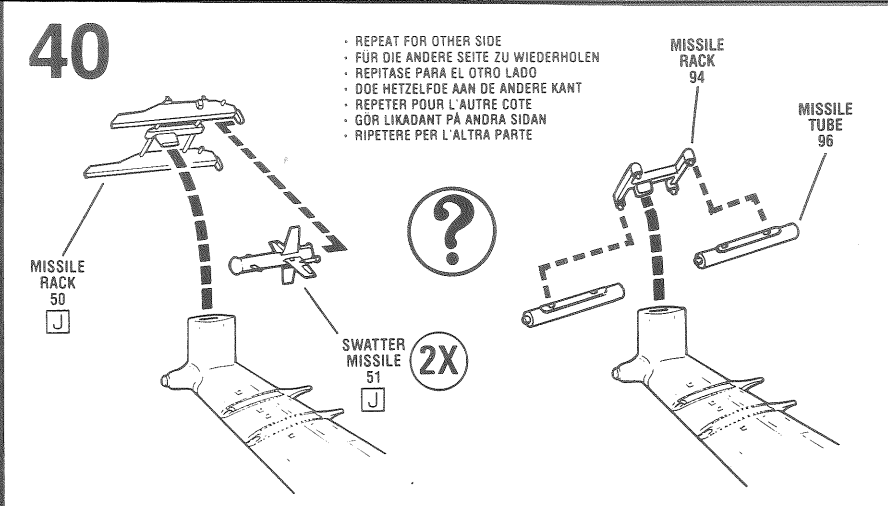
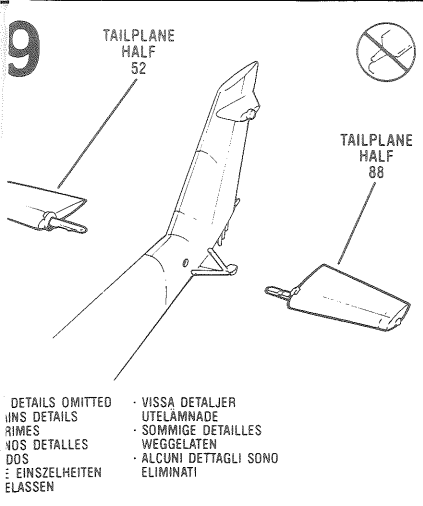

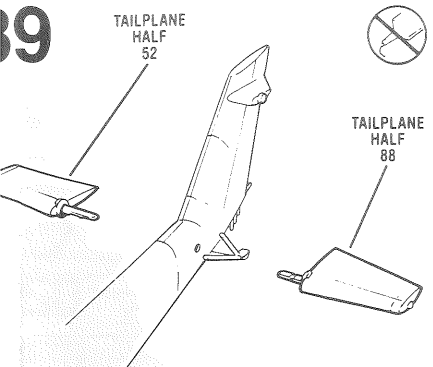

SOME DETAILS OMITTED
 REMAINS DETAILS
 ÖFFRIMES
 GUNOS DETAILLES
 MITTODS
 NIGE EINSZELHEITEN
 USGELASSEN

VISSA DETALJER
 UTELÄMNÅDE
 SOMMIGE DETAILLES
 WEGGELÅTEN
 ALCUNI DETTAGLI SONO
 ELIMINATI

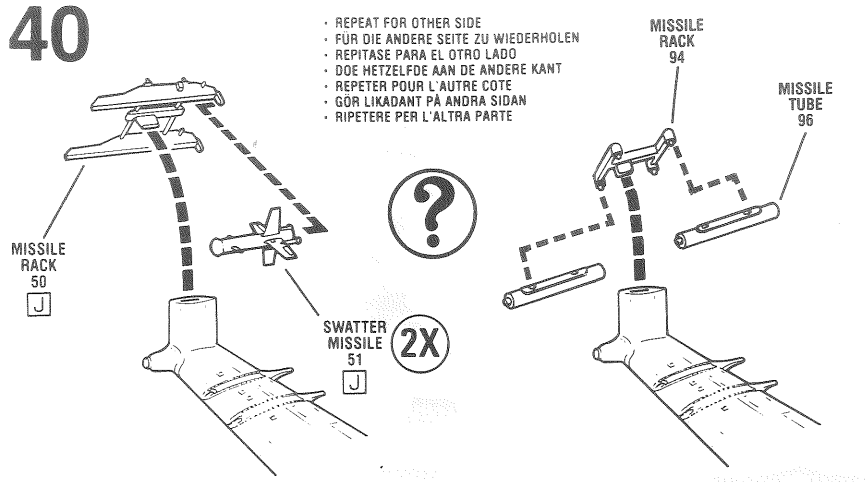

• REPEAT FOR OTHER SIDE
 • FÜR DIE ANDERE SEITE ZU WIEDERHOLEN
 • REPITASE PARA EL OTRO LADO
 • DOE HETZELFDE AAN DE ANDERE KANT
 • REPETER POUR L'AUTRE COTE
 • GOR LIKADANT PÅ ANDRA SIDAN
 • RIPETERE PER L'ALTRA PARTE

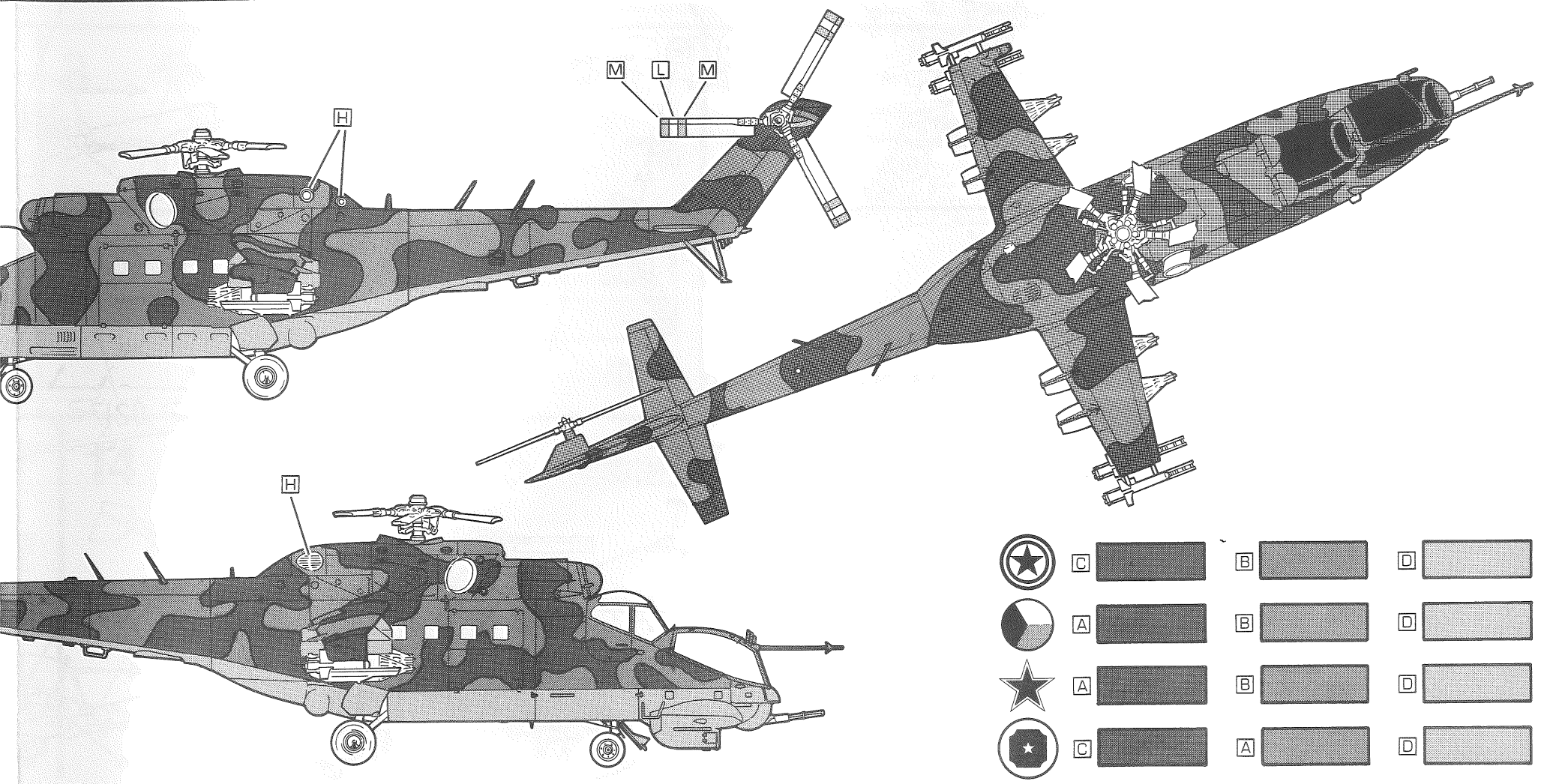
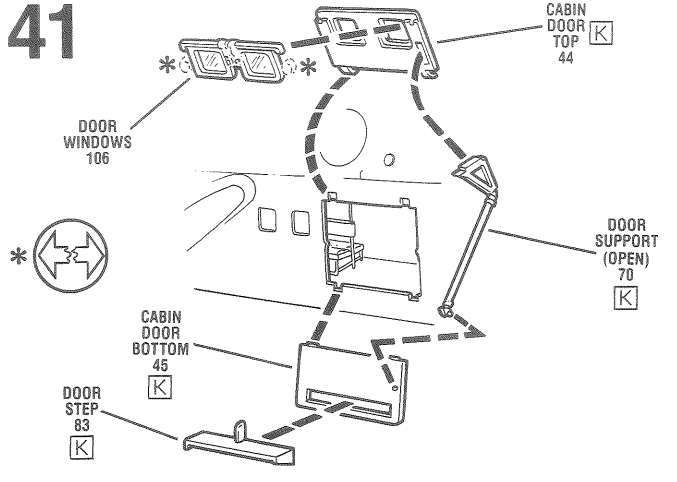

	C		B		D	
	A		B		D	
	A		B		D	
	C		A		D	