

Clear Prop!

STARTER



I-16 TYPE 5

THE SKY OF
SPAIN

EARLY
VERSION

1:48
model # CP4821



scale model kit

SPAN: 187,9 mm

LENGTH: 126,8mm

NUMBER OF PARTS: 101 pcs

- stages of assembly
- optional
- variants of assembly
- glue by super glue
- part number
- do not glue
- fill with putty
- make a hole
- apply decals
- detach with knife
- apply the adhesive mask
- paint
- bend
- repeat the operation N times

Role	Fighter
National origin	Soviet Union
Manufacturer	USSR, Plant No. 21, Plant No. 39, Plant No. 153, Plant No. 458
First flight	30 December 1933 (TsKB-12)
Primary users	Soviet Air Force, Spanish Republican Air Force, Chinese Nationalist Air Force
Produced	November 1934 – 1942
Number built	10,292 (6,848 fighters and 3,444 trainers)

I-16 (TsKB-12) - a Soviet single-engine monoplane fighter of the 1930s, created at the Central Design Bureau by a team led by aircraft designer Nikolai Polikarpov. One of the world's first mass-produced monoplane fighters with retractable landing gear in flight. The aircraft had a mixed design. The serial production of the aircraft, originally with the M-22 engine, started in 1934, and really unfolded only the next year. In 1935, it became possible to install M-25 engines on the aircraft, which were a Soviet copy of the American Wright-Cyclone F-3. The production of these engines was launched at the newly built aircraft factory No.19 in Perm. In 1935, using often American parts, the plant produced 660 M-25 engines. Some of these engines were intended for the I-16. In general, this aircraft was very reminiscent of the third prototype with the Wright-Cyclone F-3. However, the engine cowling has changed somewhat and received frontal blinds, which have become a characteristic feature of this aircraft. At production plant No.21 in Gorky, the aircraft received the designation type 5 and became the most massive single-seat modification of the I-16. Until the end of 1937, more than 2,500 planes were built. I-16 type 5 fought in Spain, China, were widely used at the initial stage of the Second World War

- A A.MIG-0915 Allz DARK GREEN
- B A.MIG-0931 PROTECTIVE GREEN ALLZ LATE
- C A.MIG-0249 Allg LIGHT GRAY BLUE
- D A.MIG-0224 + 15% A.MIG-0050 LIGHT BLUE
- G A.MIG-0195 SILVER
- H A.MIG-0191 POLISHED STEEL
- I A.MIG-0046 BLACK
- J A.MIG-0212 MEDIUM GRAY A-14
- K A.MIG-0049 RED
- L A.MIG-0050 WHITE
- M A.MIG-0224 BLUE
- N A.MIG-0191 BURNT METALL
- O A.MIG-0045 GUN METALL
- P A.MIG-0033 TIRE BLACK
- R A.MIG-0058 GREEN KHAKI
- S A.MIG-0122 SAND
- T A.MIG-0093 RED CRYSTAL
- U A.MIG-0092 GREEN CRYSTAL



THIS MODEL IS PRODUCED FOR EXPERIENCED MODELERS OVER 14 YEARS

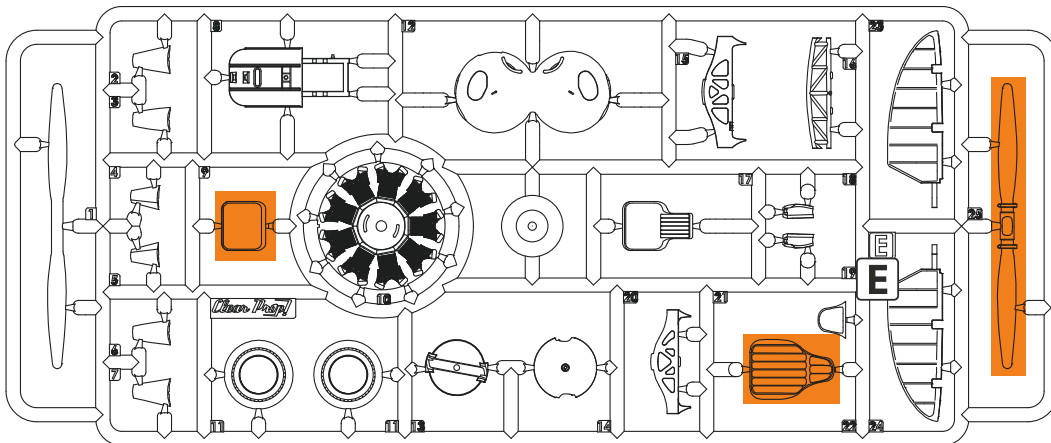
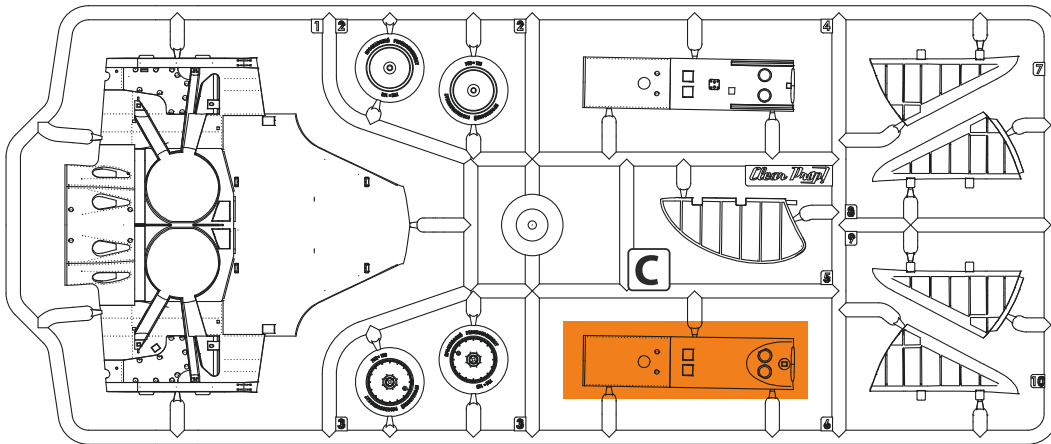
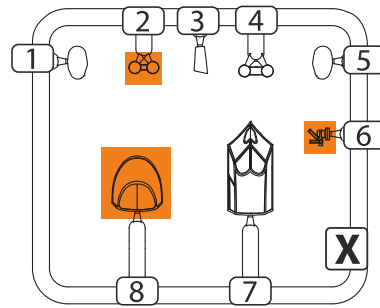
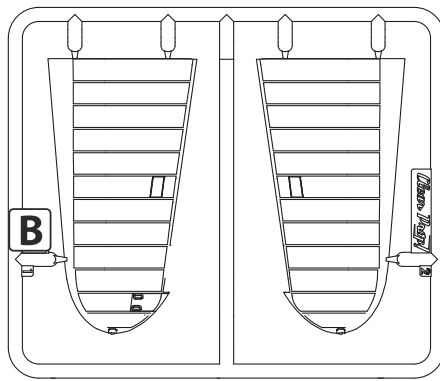
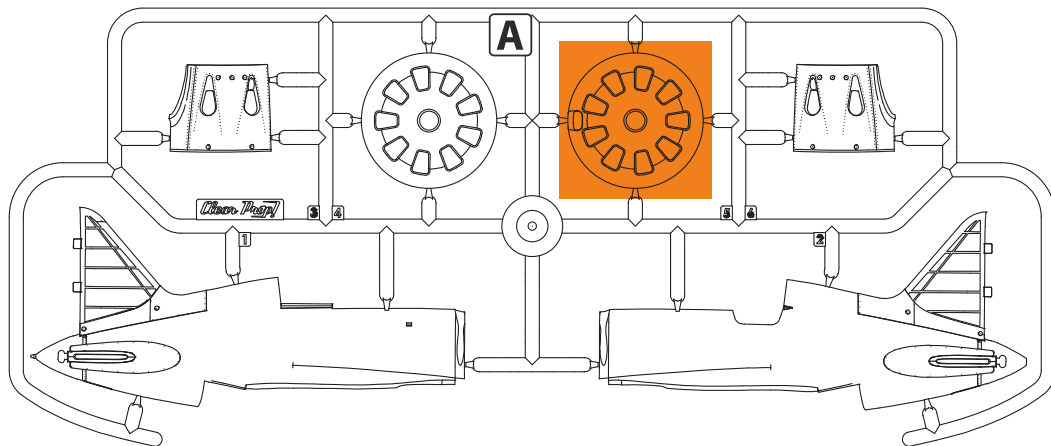

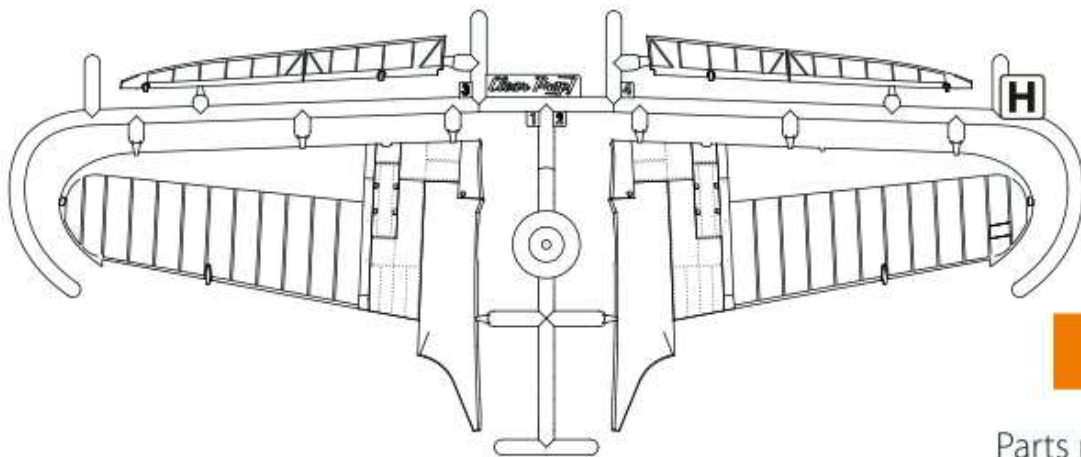
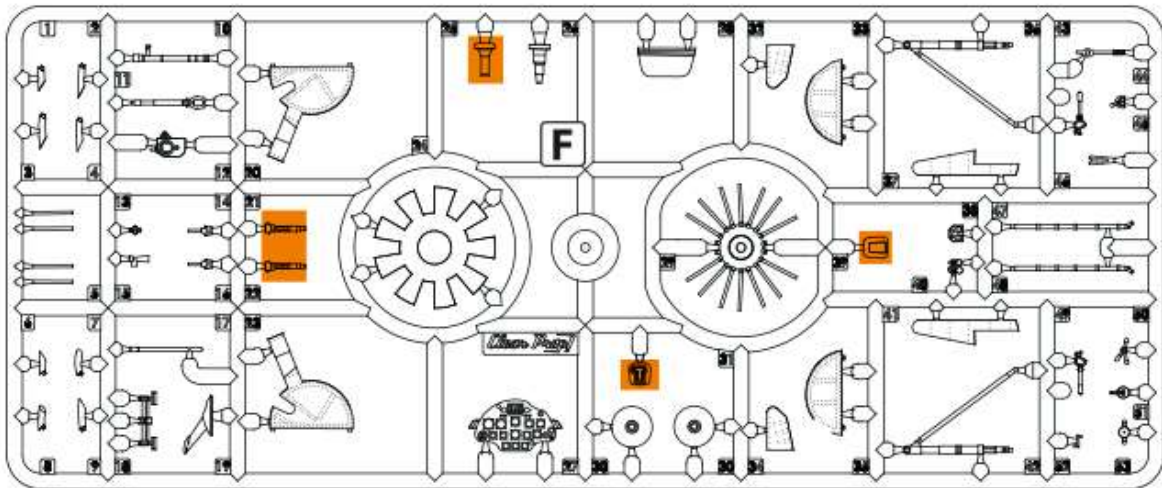

Parts not for use

DECAL SHEET

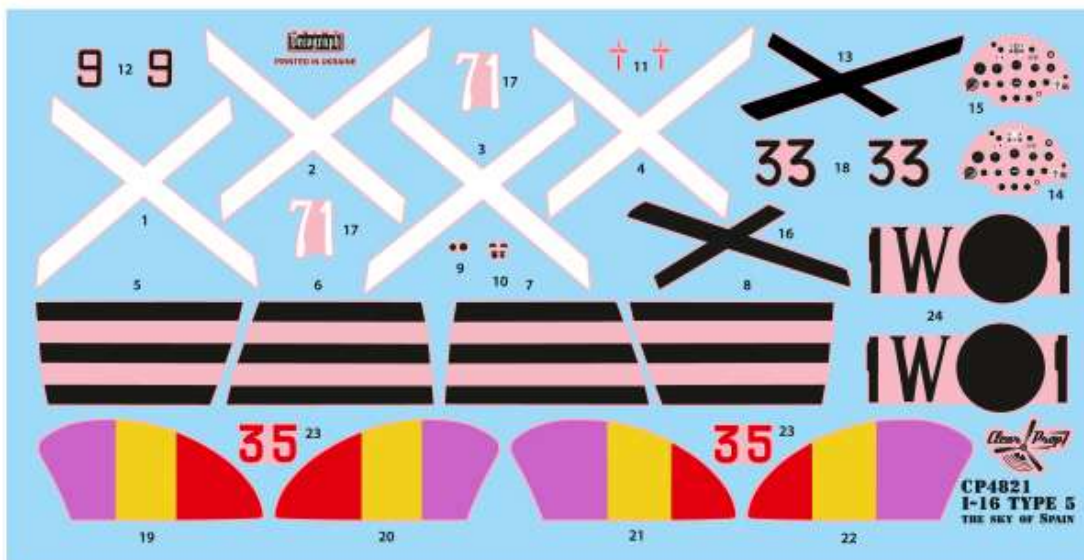

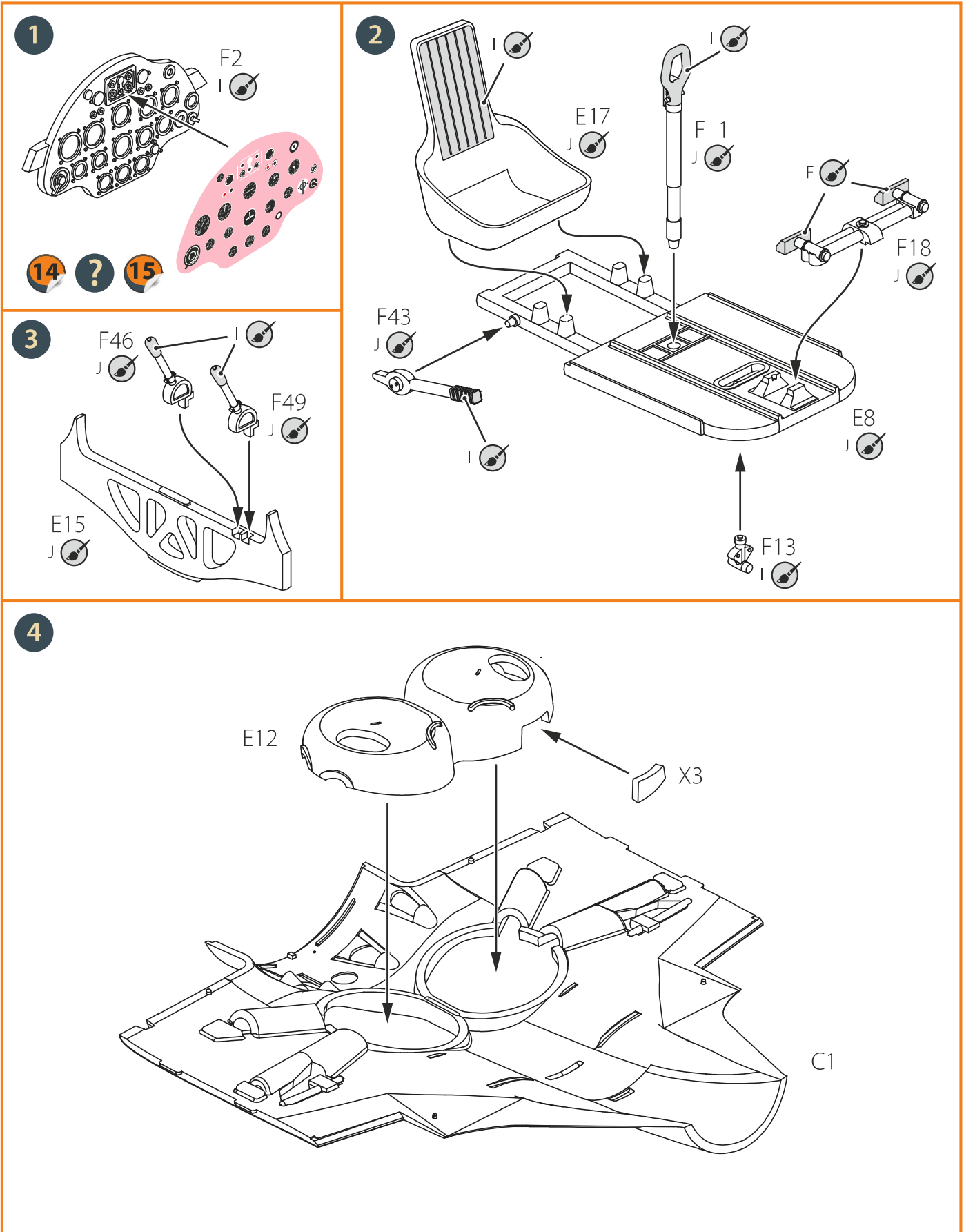

5

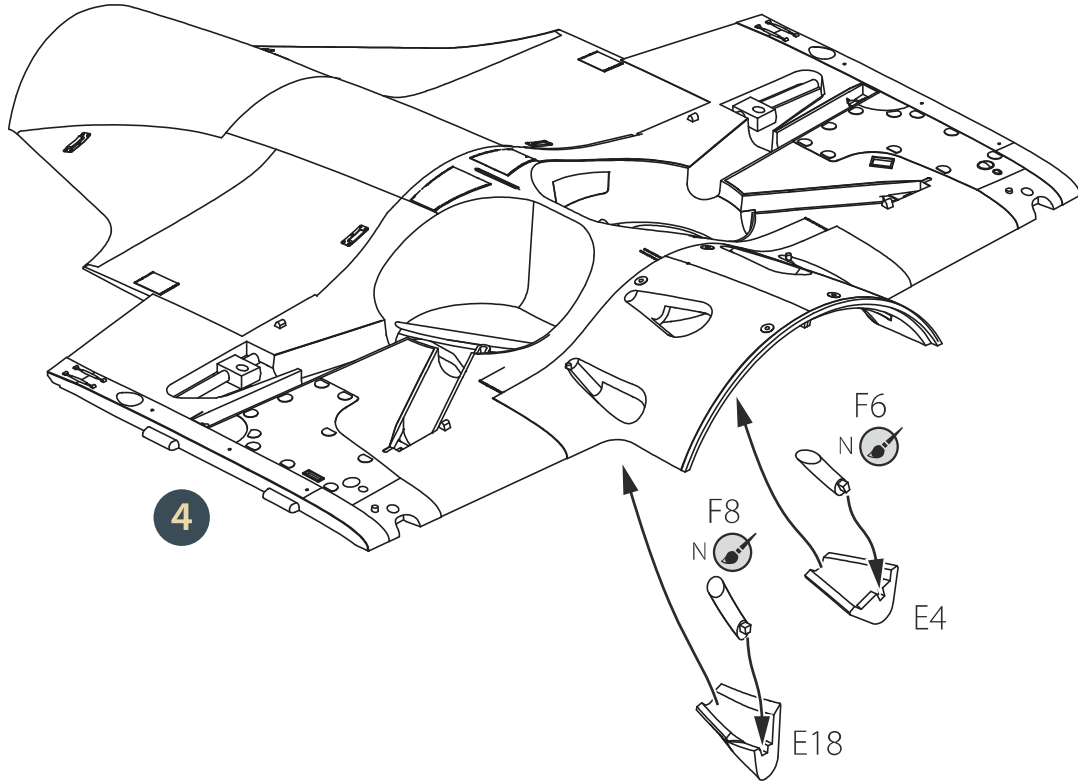

6

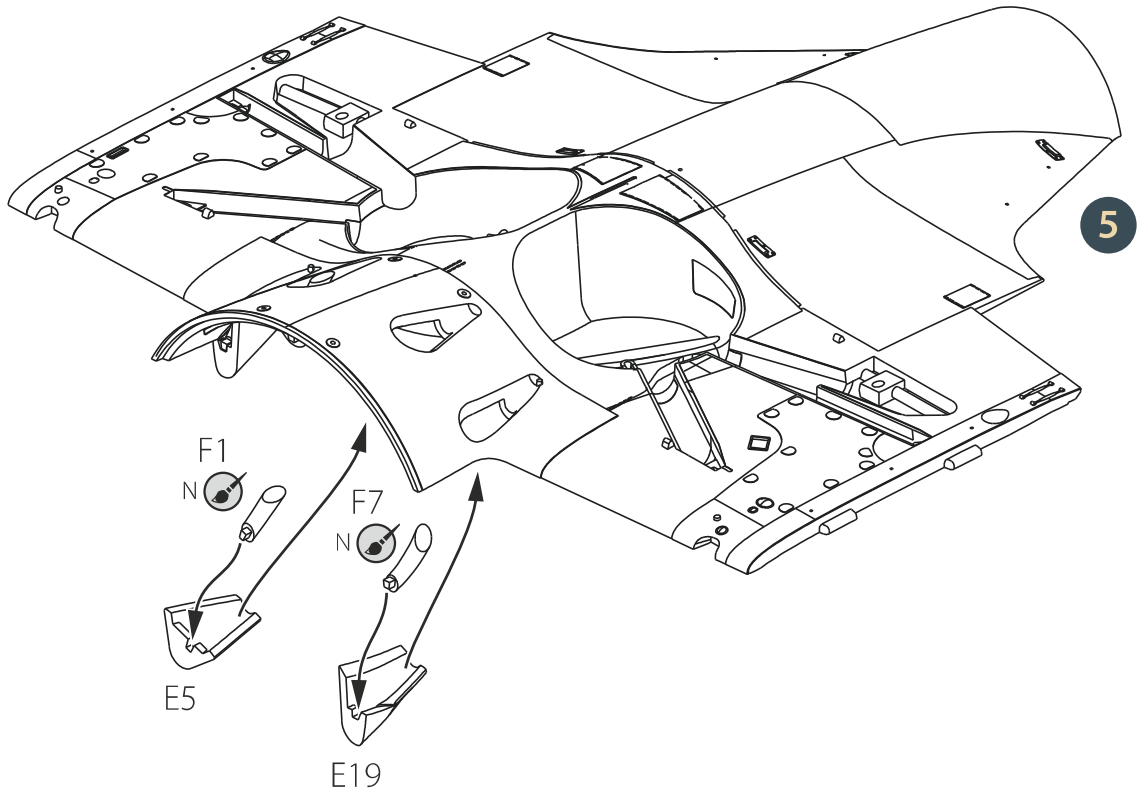

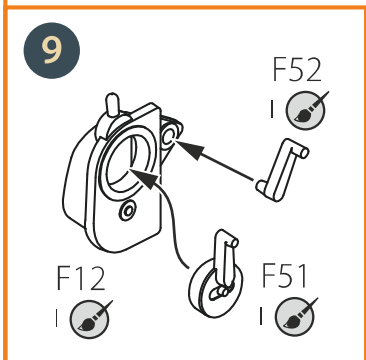
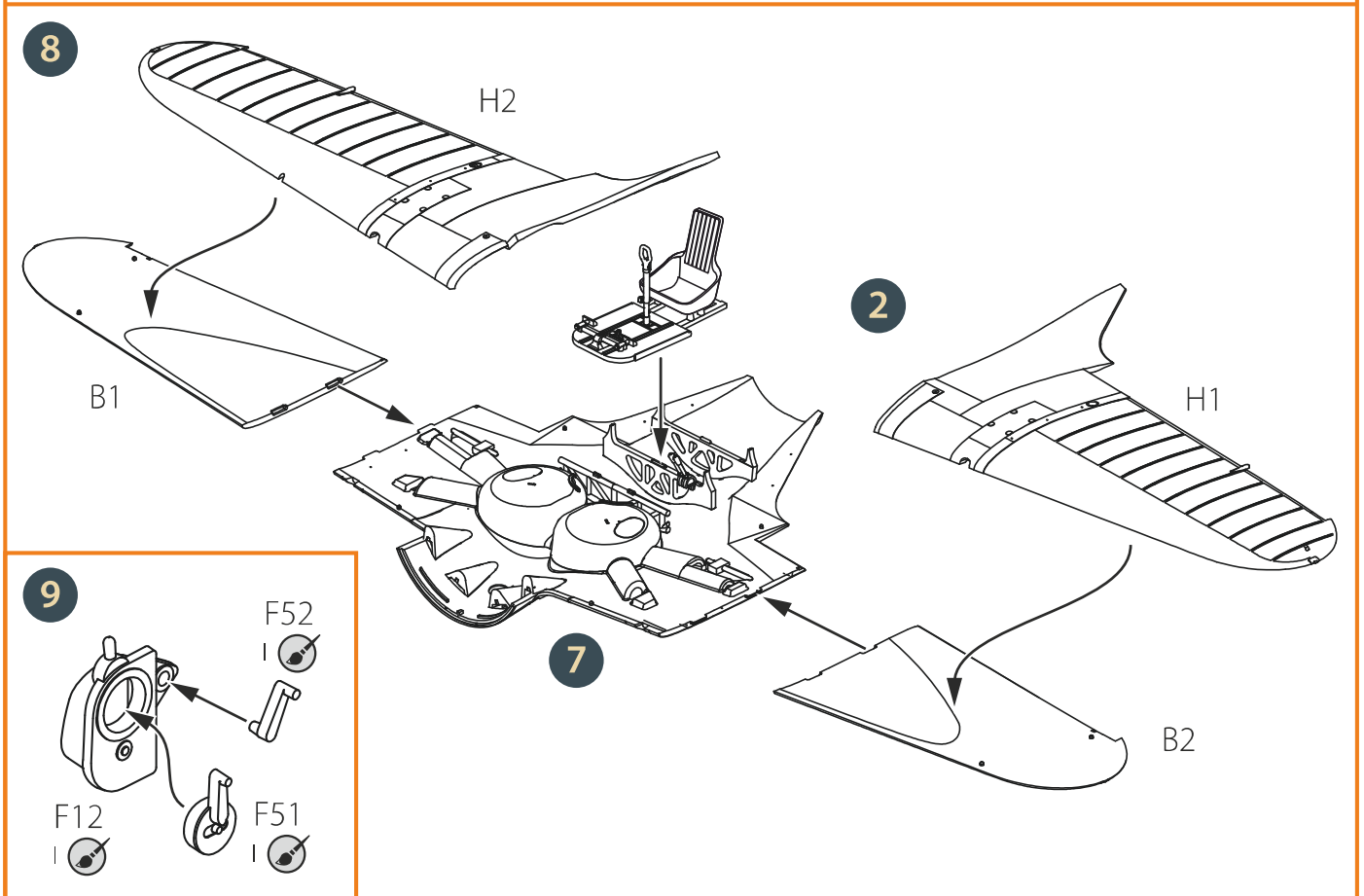
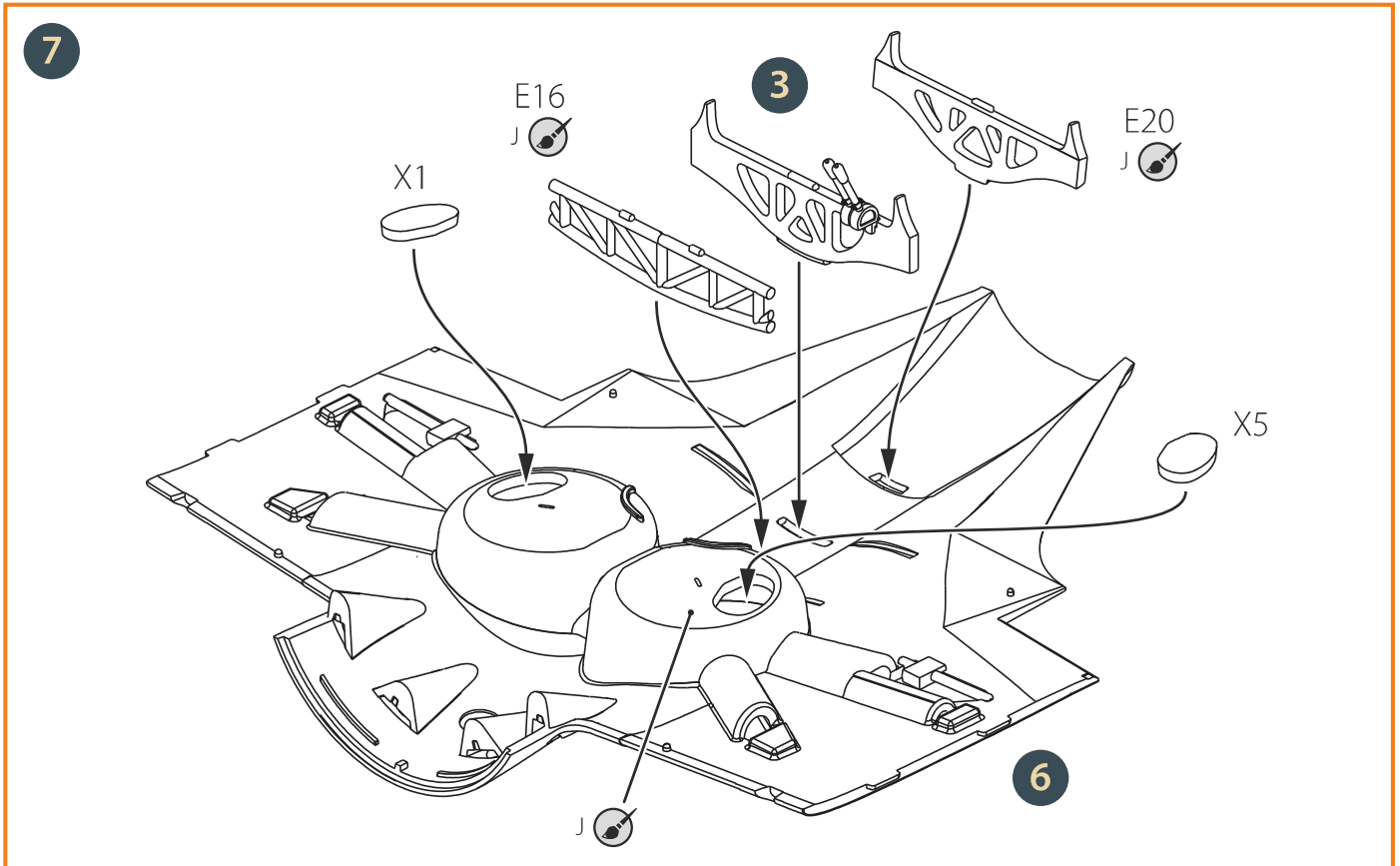

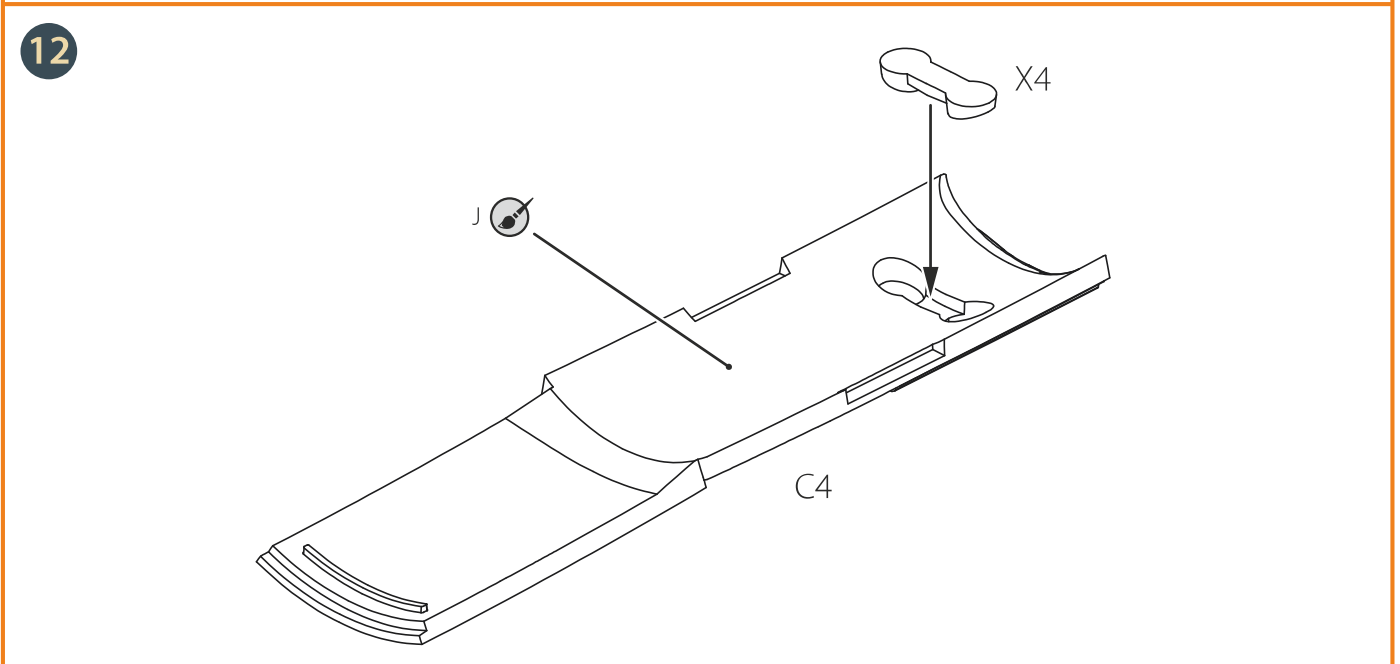
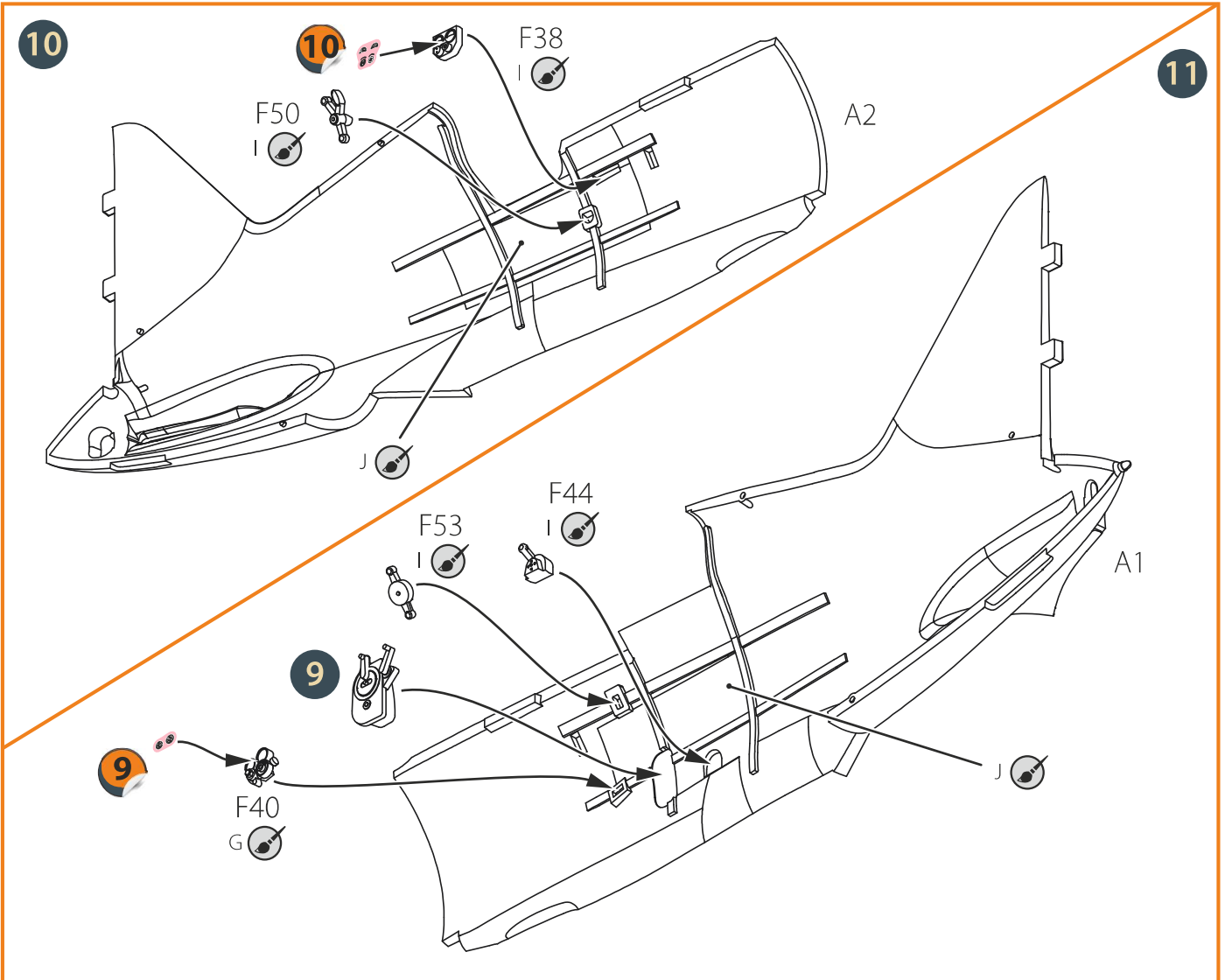

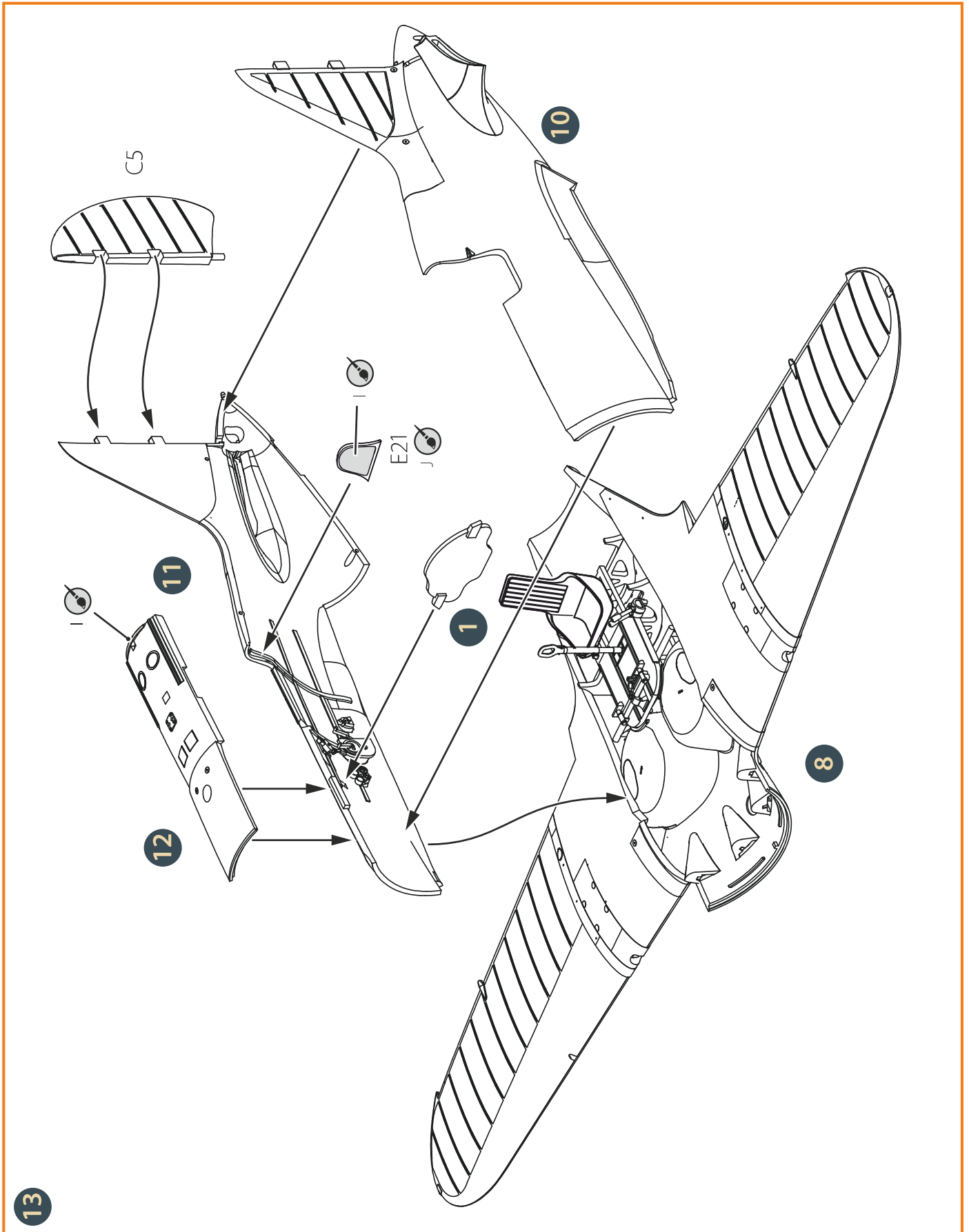

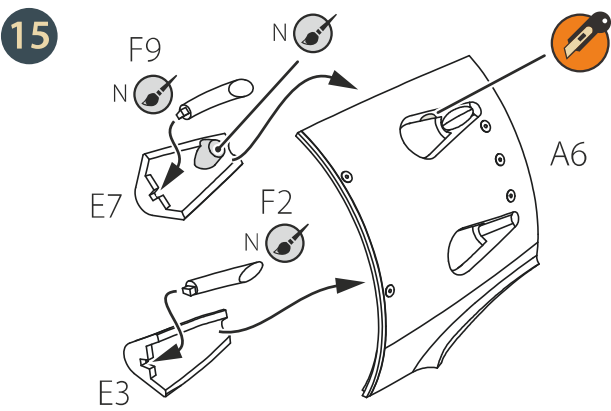
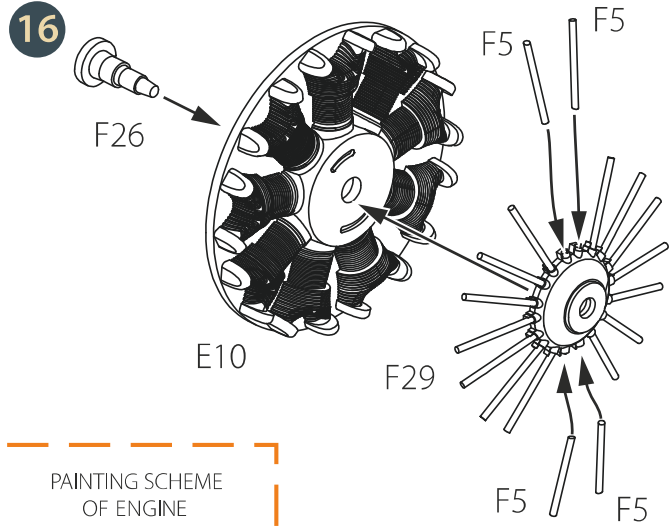
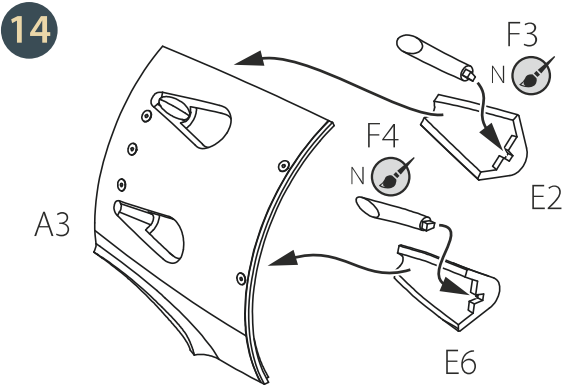

PAINTING SCHEME OF ENGINE

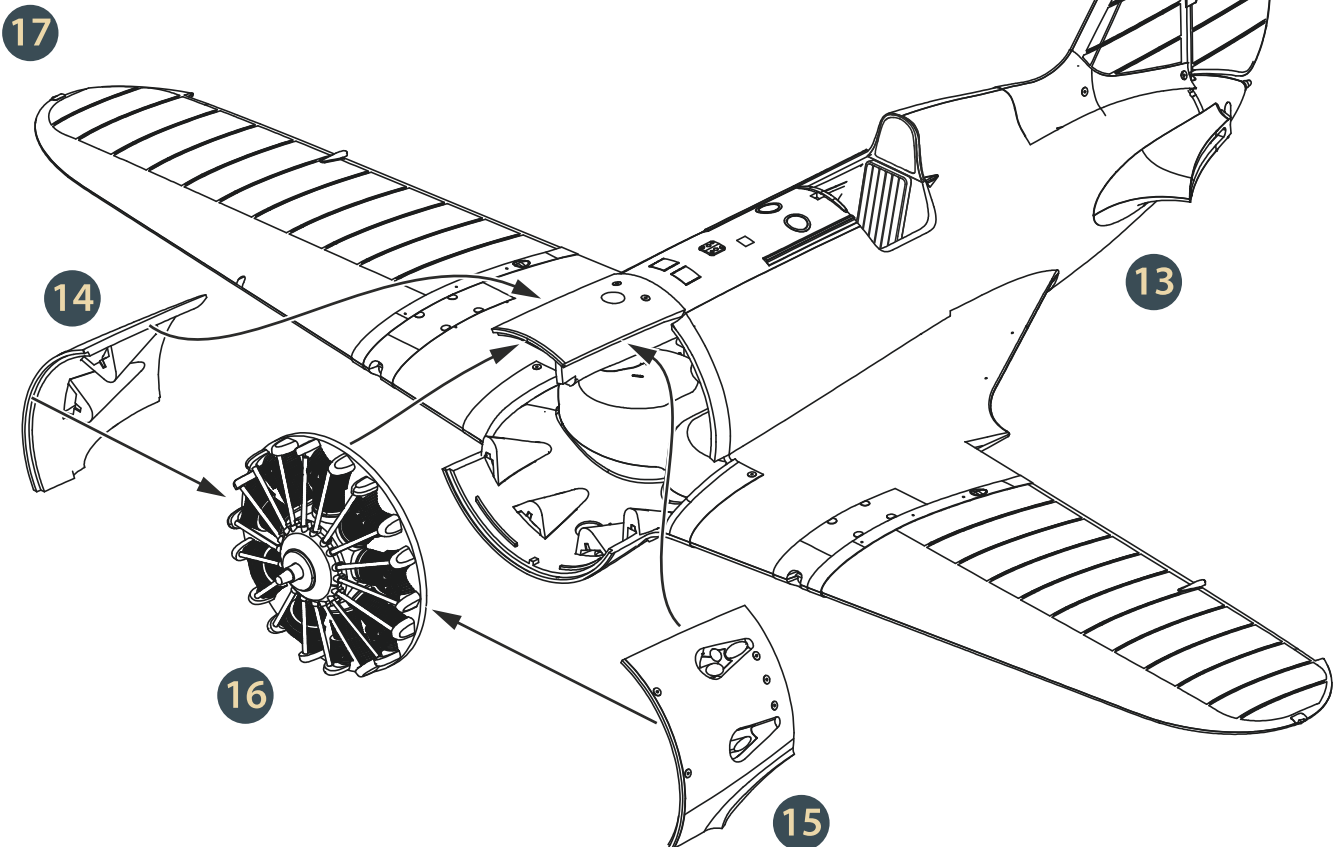
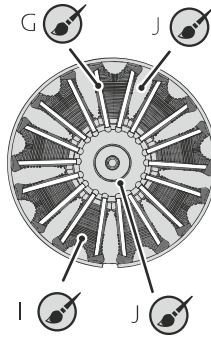

18

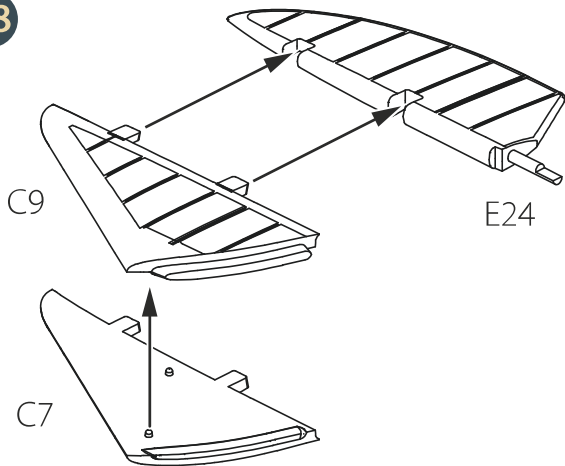

19

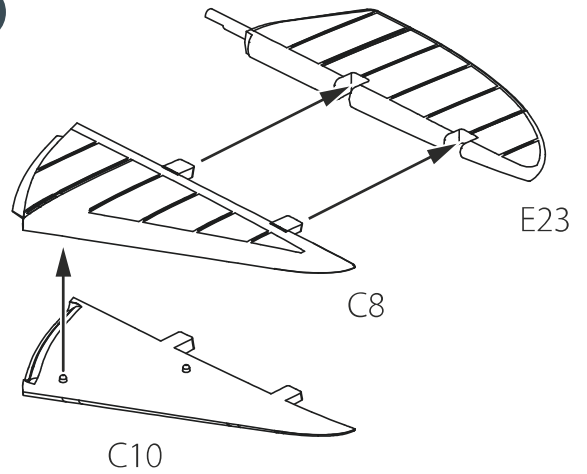

20

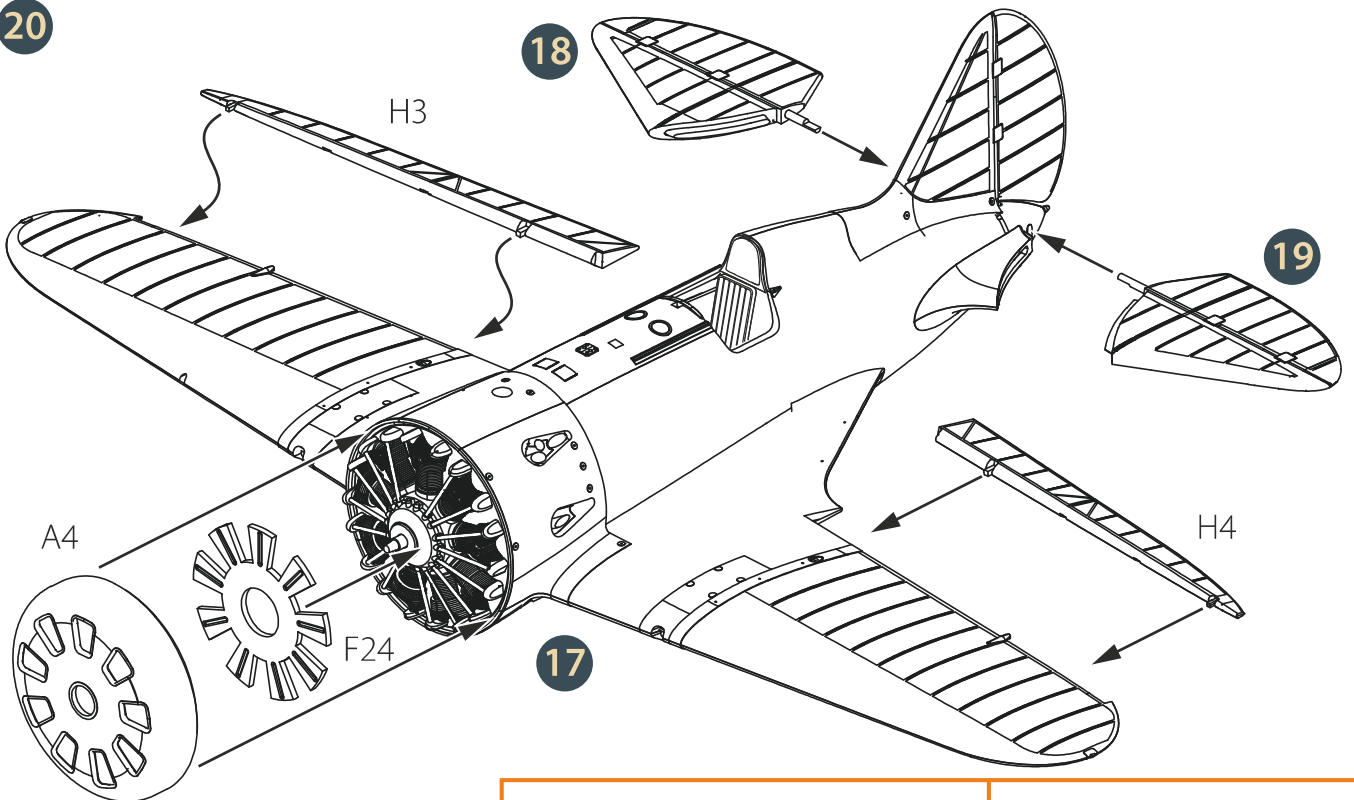

CORRECT POSITION OF THE PART A4

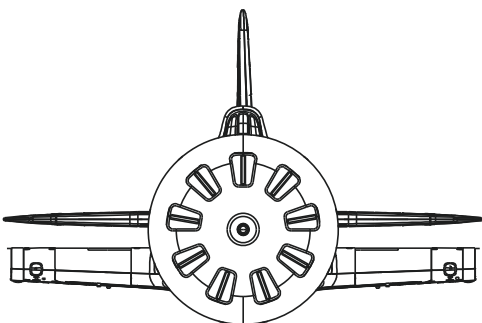

21



FOR PAINT SCHEME 2 4 5

* - FOR PAINT SCHEME 5

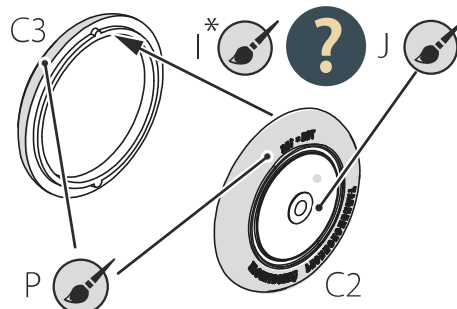

22

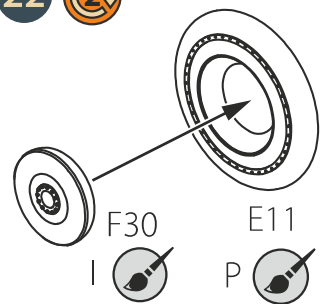

FOR PAINT SCHEME 1 3

23

* FOR PAINT SCHEME 5

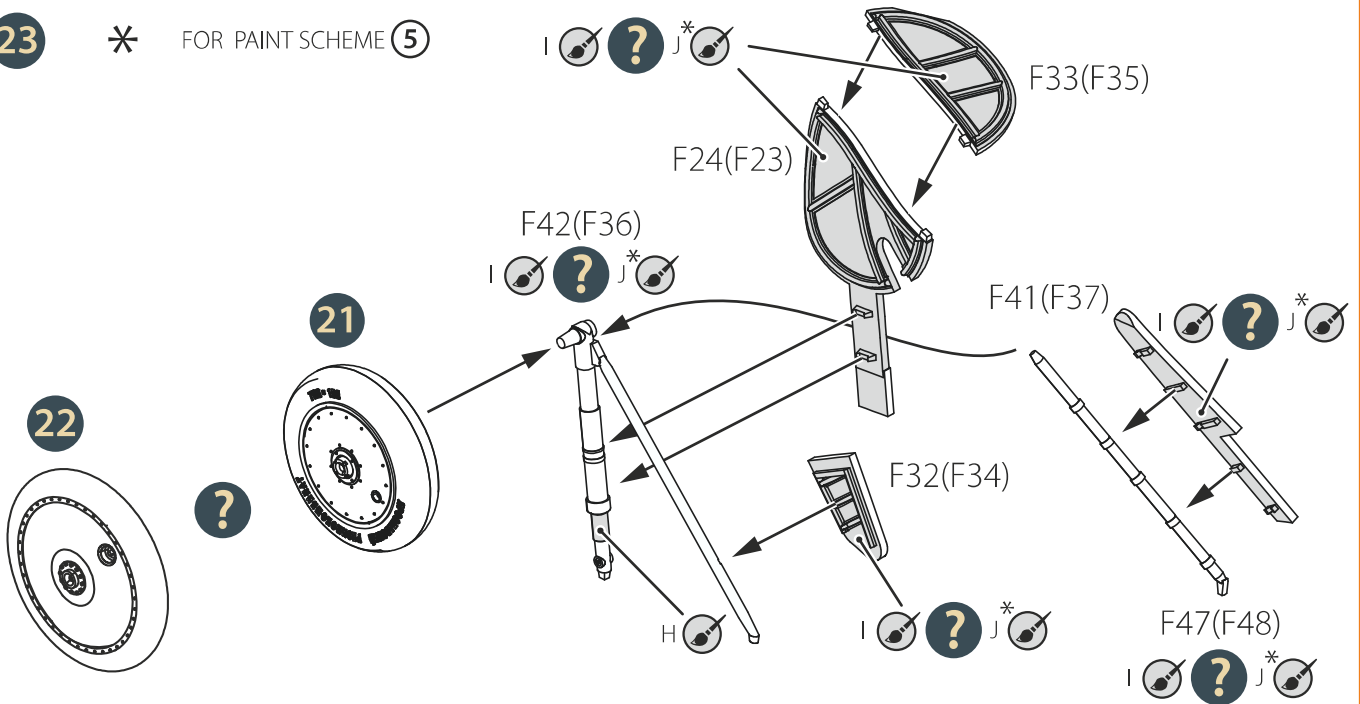

24

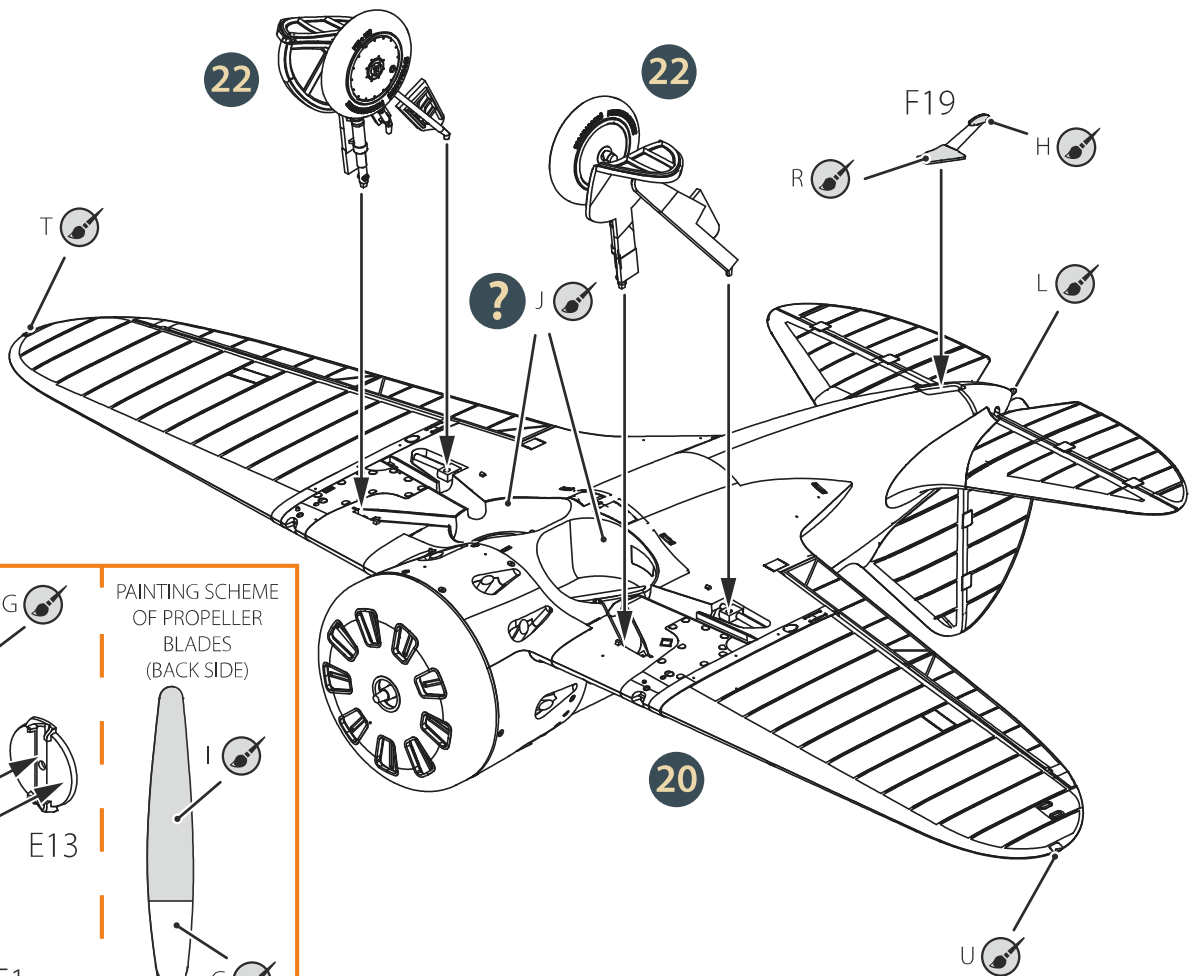

25

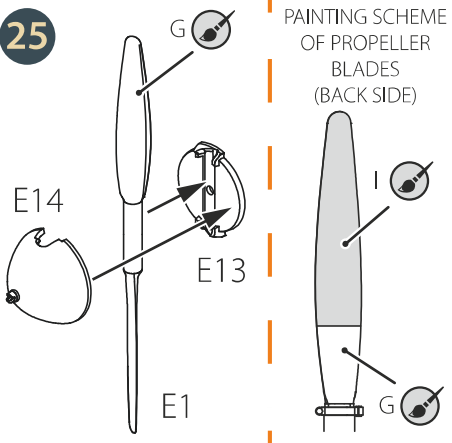

PAINTING SCHEME OF PROPELLER BLADES (BACK SIDE)

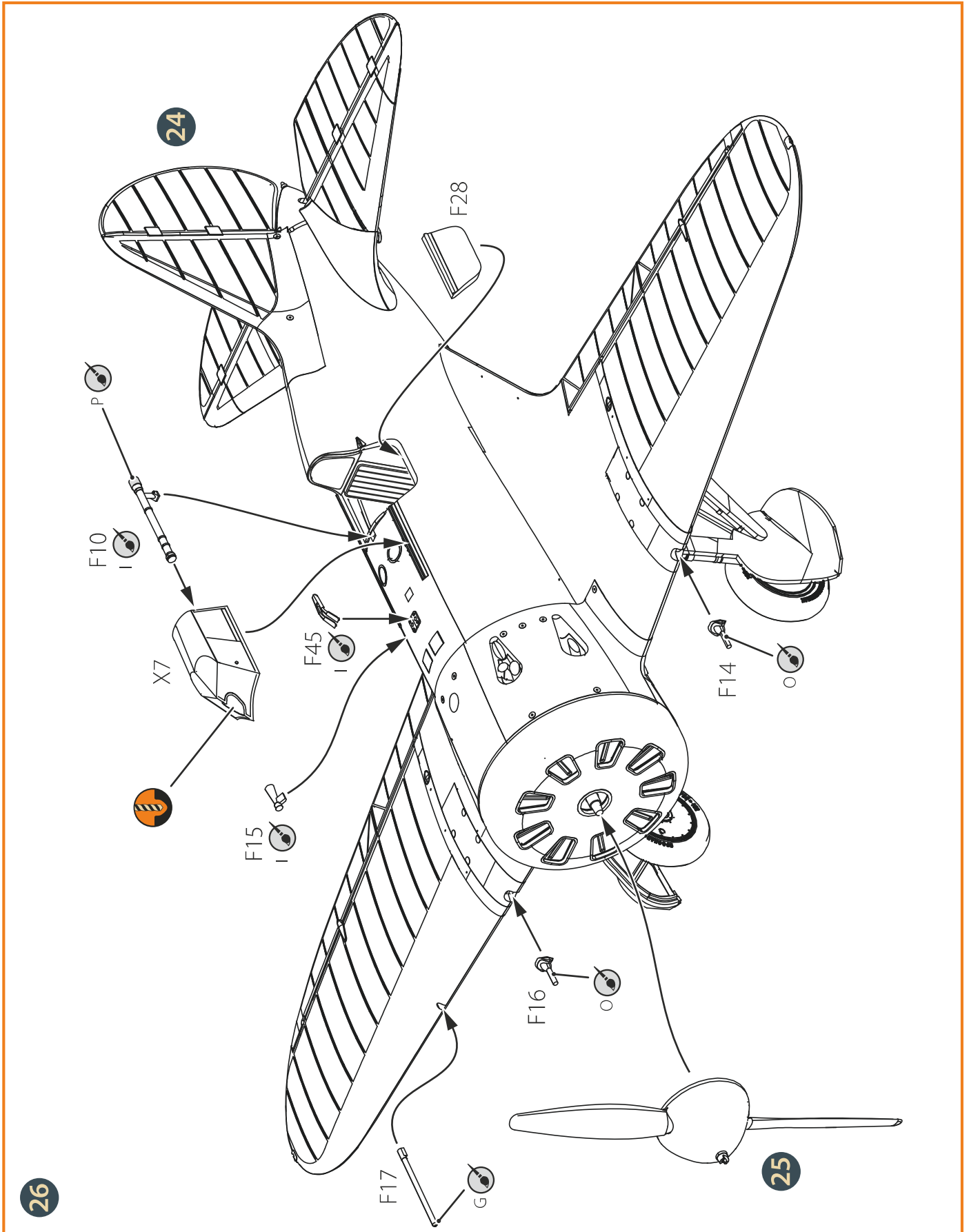

- | | | | | | | | |
|----------------------------------|--------------------------------------|---------------------------------|---------------------|-----------------------------------|-------------------|---------------------|--------------------|
| A | C | H | I | J | K | L | S |
| A.MIG-0915
Allz DARK
GREEN | A.MIG-0249
AllgLIGHT
GRAY BLUE | A.MIG-0191
POLISHED
STEEL | A.MIG-0046
BLACK | A.MIG-0212
MEDIUM GRAY
A-14 | A.MIG-0049
RED | A.MIG-0050
WHITE | A.MIG-0122
SAND |

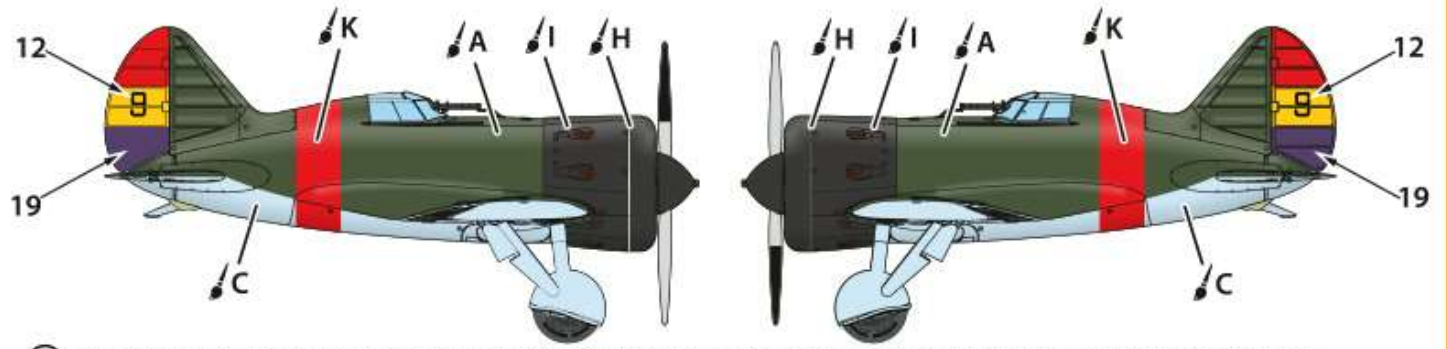

① I-16 type 5. 21st Air Group, 1 aero. (1 Escuadrilla de Mosca). Aircraft of the Hero of the Soviet Union Senior Lieutenant Vladimir Bocharov. Madrid, 11/13/1936.

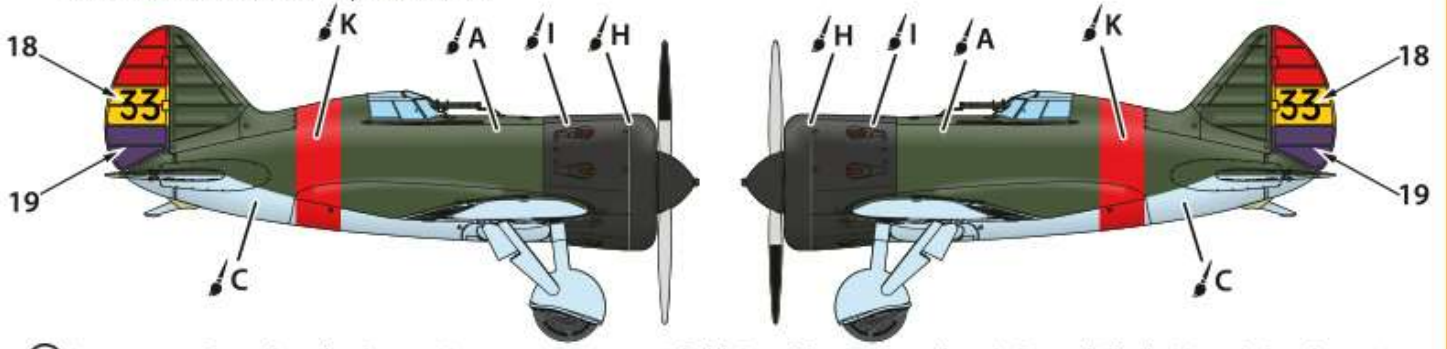

② I-16 type 5. Alown by pilot Sergey Kuznetsov, Carreno airfield. Possibly 1 air squadron (1 Escuadrilla de Mosca), October 1937.

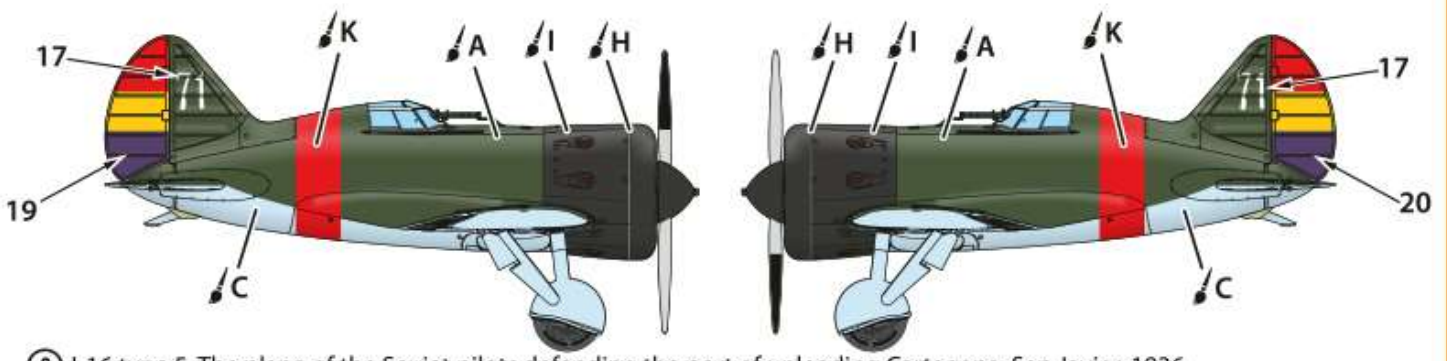

③ I-16 type 5. The plane of the Soviet pilots defending the port of unloading Cartagena, San Javier, 1936.

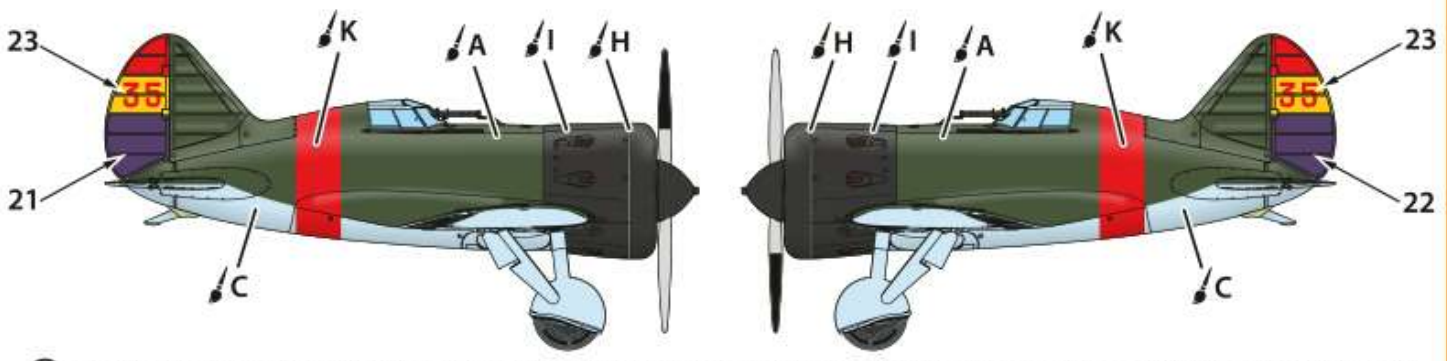

④ I-16 type 5. Torrijos Airfield. This aircraft was shot down during the Battle of Brunete Baitenente Tocci by Fiat CR.32 in July 1937.

- | | | | | | | | |
|----------------------------------|--------------------------------------|---------------------------------|---------------------|-----------------------------------|-------------------|---------------------|--------------------|
| A | C | H | I | J | K | L | S |
| A.MIG-0915
Allz DARK
GREEN | A.MIG-0249
AllgLIGHT
GRAY BLUE | A.MIG-0191
POLISHED
STEEL | A.MIG-0046
BLACK | A.MIG-0212
MEDIUM GRAY
A-14 | A.MIG-0049
RED | A.MIG-0050
WHITE | A.MIG-0122
SAND |

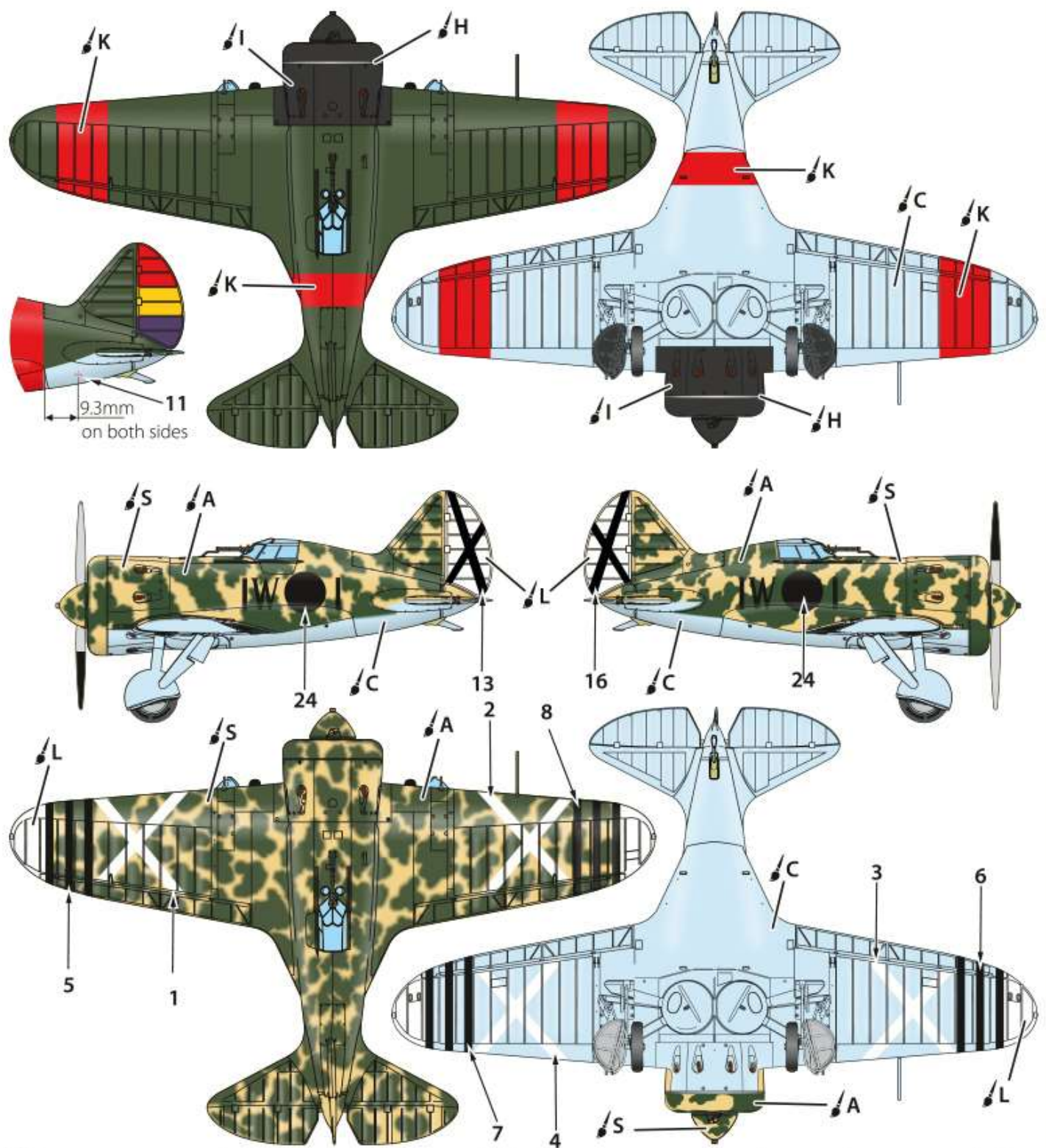

⑤ I-16 type 5. Nationalist trophy, Cuatro Vientos airfield (de Cuatro Vientos.) According to other sources airfield - Seville-Tablada. March 1938.