

### Avro 626

The Model 626 was developed by Avro from the company's Model 621 for export to smaller air forces, the idea being that the 626 would be a single aircraft that could carry out training as well as a number of other roles. Compared with the pilot training oriented 621, the 626 had an additional cockpit with a scarff ring and carried equipment for air navigation, wireless and gunnery training (a third cockpit was provided behind the normal two-seat configuration). Like the Tutor, it was a conventional fabric-covered, metal airframe with single bay wings, with open cockpits in line astern. The prototype was first flown in 1930.

- **Crew:** Two or three
- **Length:** 26 ft 6 in (8.08 m)
- **Wingspan:** 34 ft 0 in (10.36 m)
- **Height:** 9 ft 7 in (2.92m)
- **Range:** 386 km
- **Service ceiling:** 14,800 ft (4,511 m)
- **Powerplant:** 1 × Armstrong Siddeley Cheetah V 260 hp

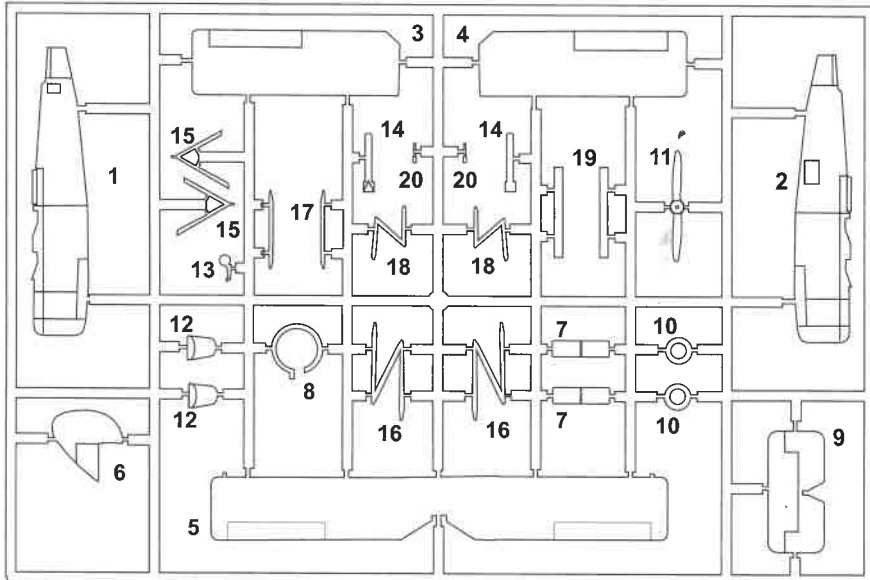

#### Foto-Etched parts



#### Transparent parts



#### Decals

#### PUR parts



R1

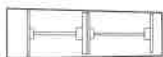

R2



R3



OPTIONAL

VOLBA



BEND

OHNOUT



OPEN HOLE

VYVRTAT OTVOR



SYMMETRICAL ASSEMBLY

SYMETRICKÁ MONTÁŽ



A NOTH

ZÁŘEZ



REMOVE

ODŘIZNOUT

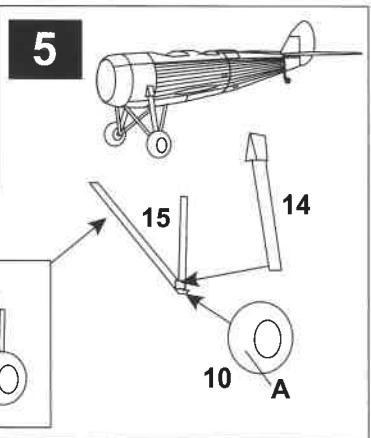
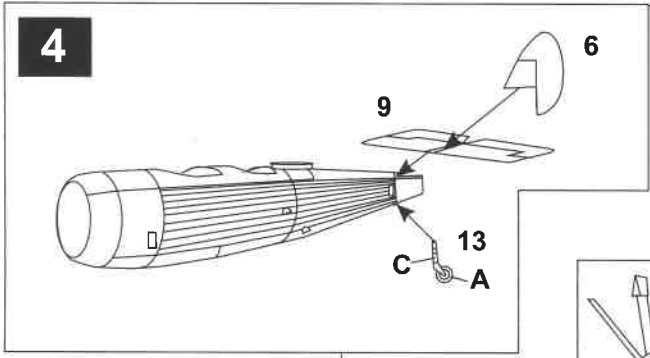
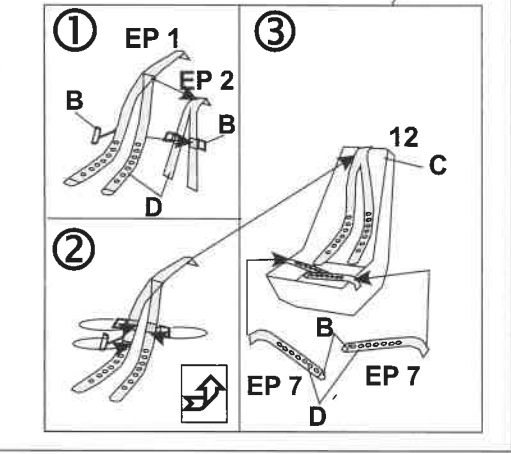
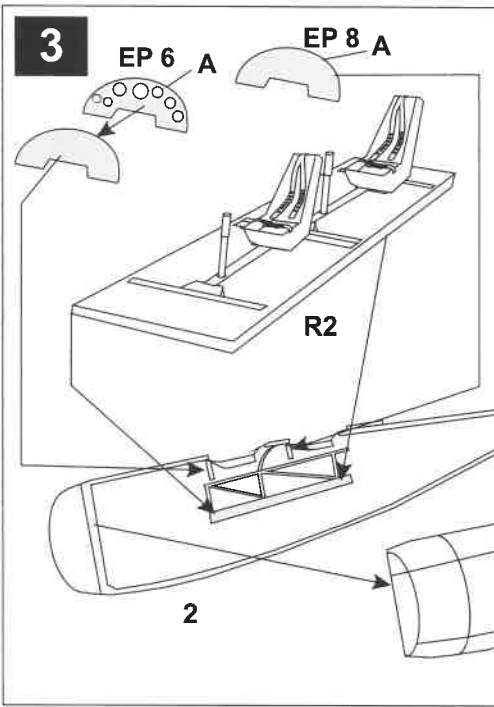
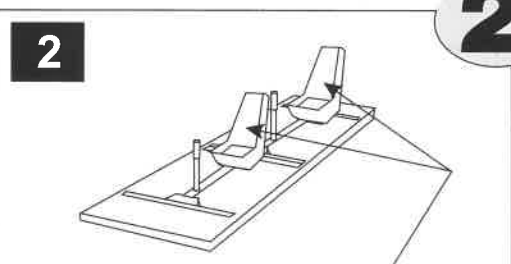
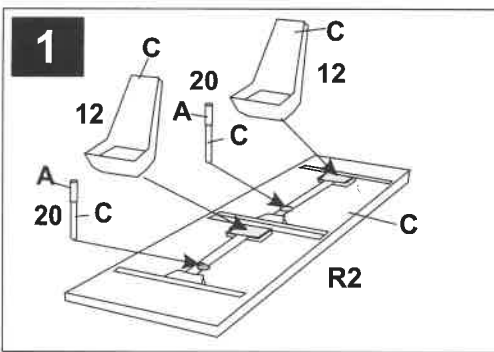

6

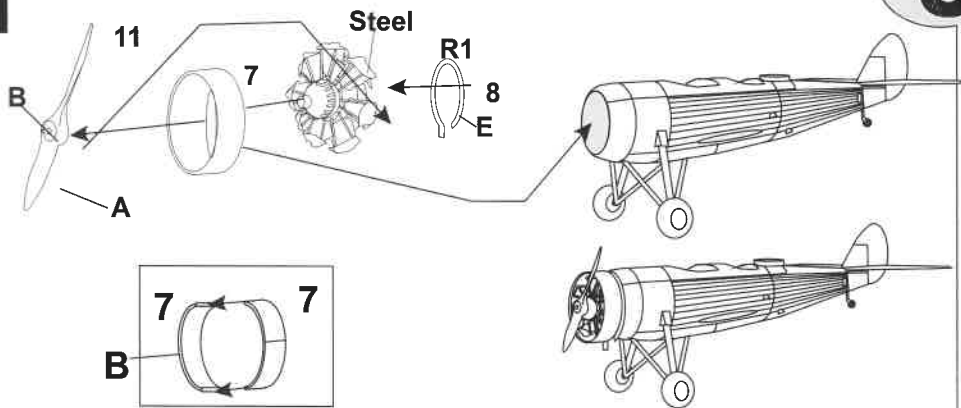

7

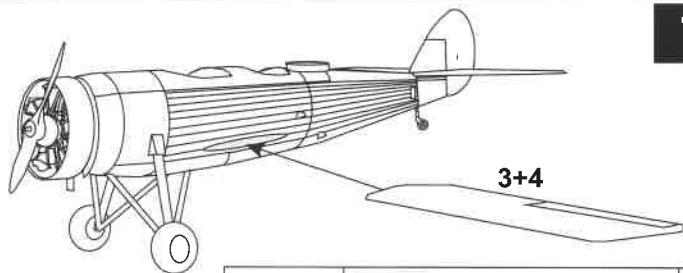

1

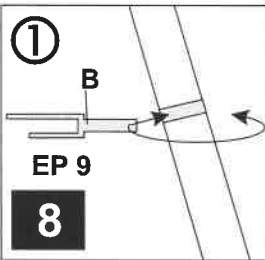

8

9

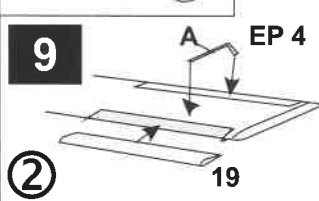

2

10

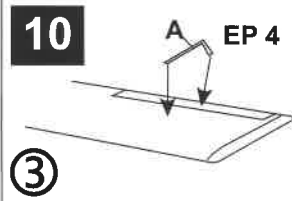

3

11

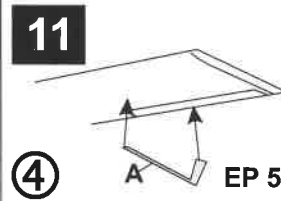

4

12

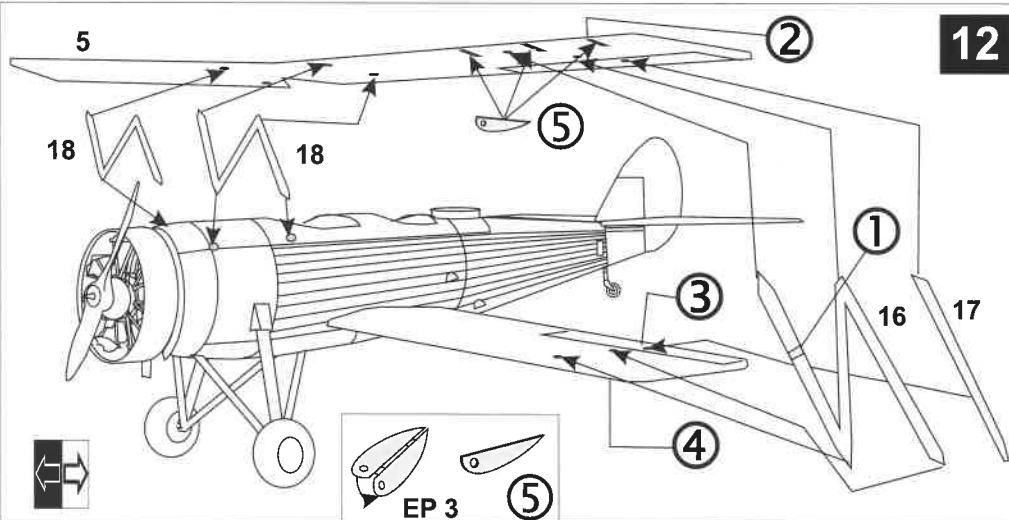

13

Transparent parts

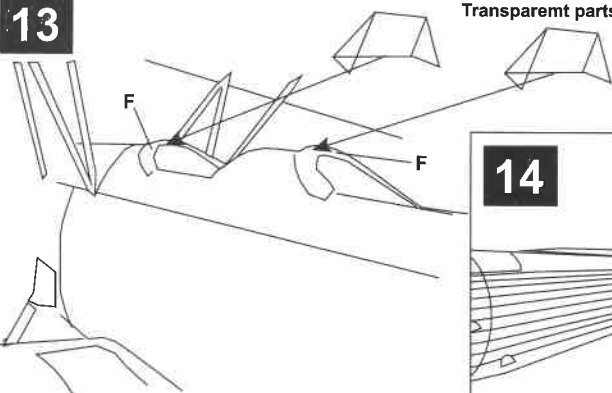

14

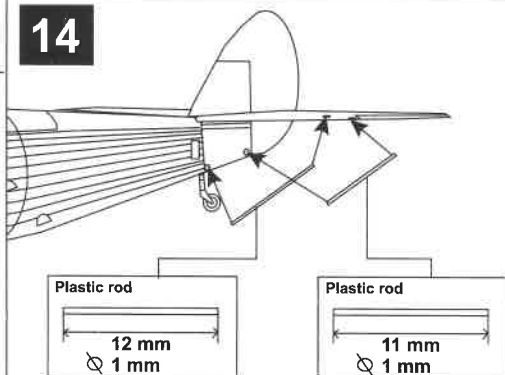

15

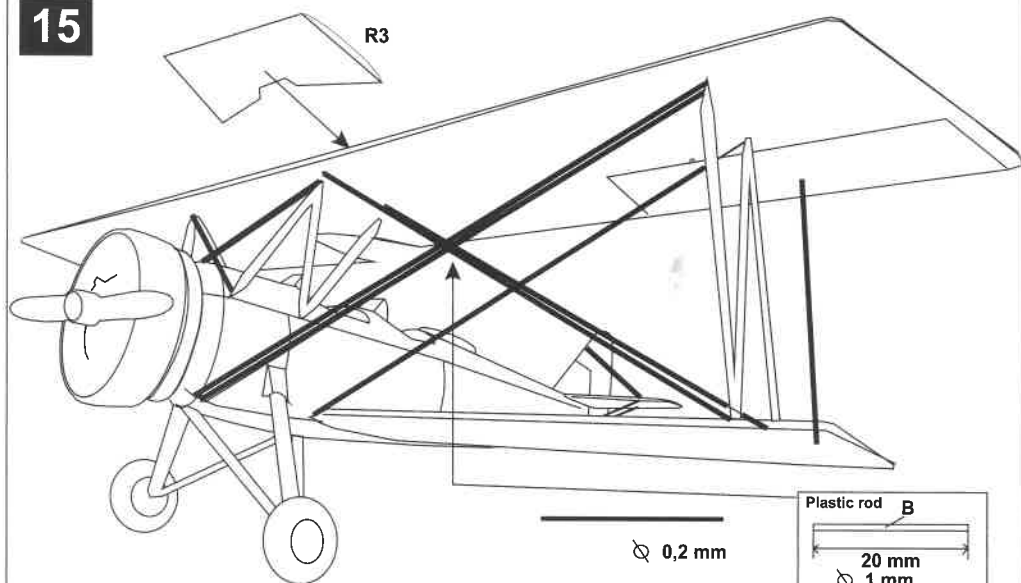

	Colour name	Humbrol colour	Agama colour		Colour name	Humbrol colour	Agama colour
A	Black	33	07 M	F	Red Brown	100	12 M
B	Aluminium	27002	46 Me	G	Red	60	04 M
C	Light Grey	64	B21 P				
D	Leather	62	30 M				
E	Antique Bronze	27005	43 Me				



NZ 11  
203



178 9

156

178 9

156



NZ 11  
203

