

**KIT Contents**

Photo Etched Parts (PE)

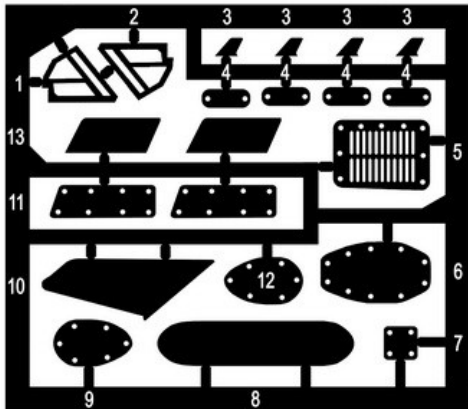

Decal (D)

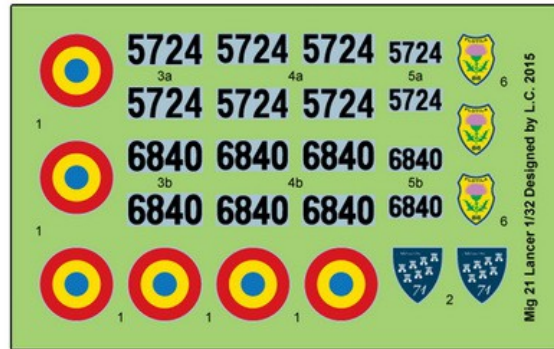

Printed Paper (PP)



Transparency Film (TF)

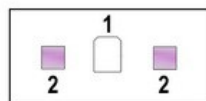

Mask (M)

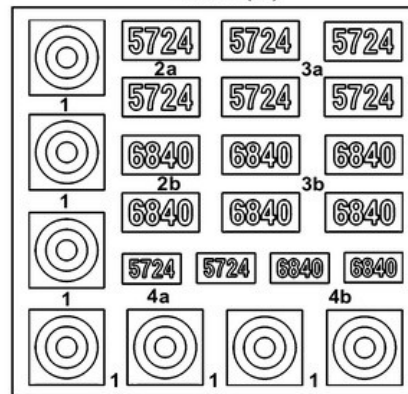

**Resin Parts (R)**

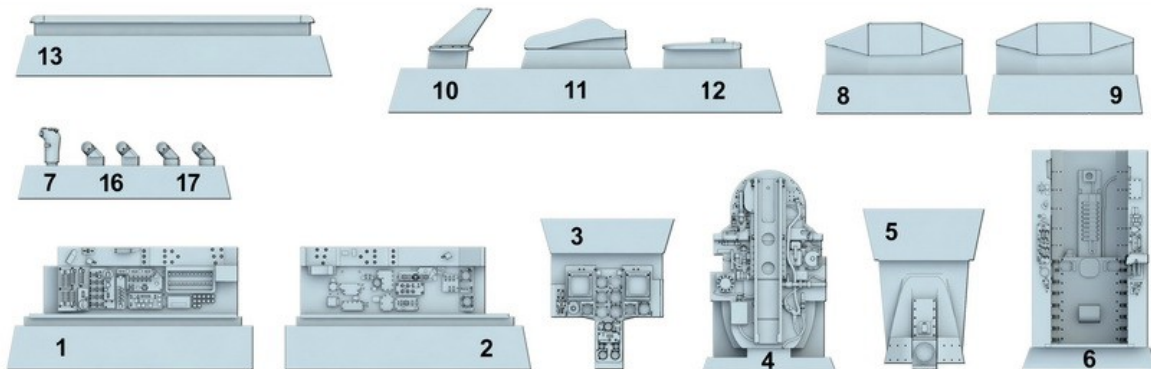

- 1 - It is a good idea to paint cockpit pannels and parts before assembling (see STEP 5).
- 2 - After that apply a dry brush.
- 3 - A clear glossy coat and a dark wash might help.
- 4 -Finally seal your work with a clear satin coat.



**STEP 1**

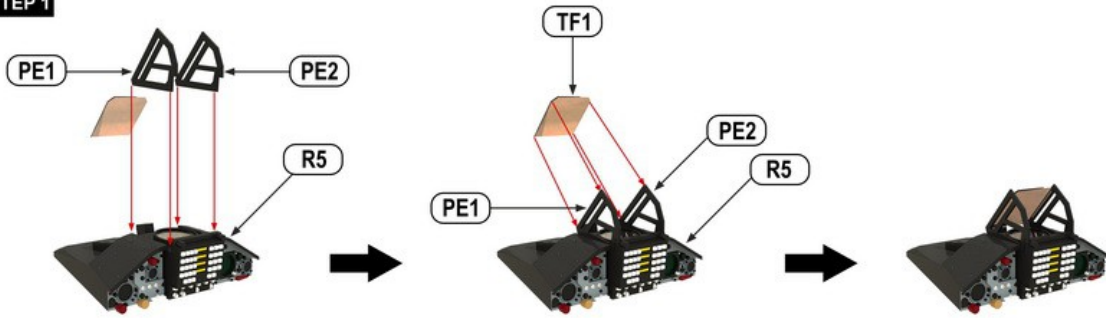

**STEP 2**

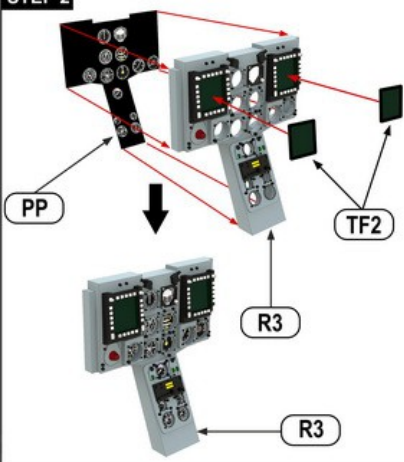

**STEP 3**

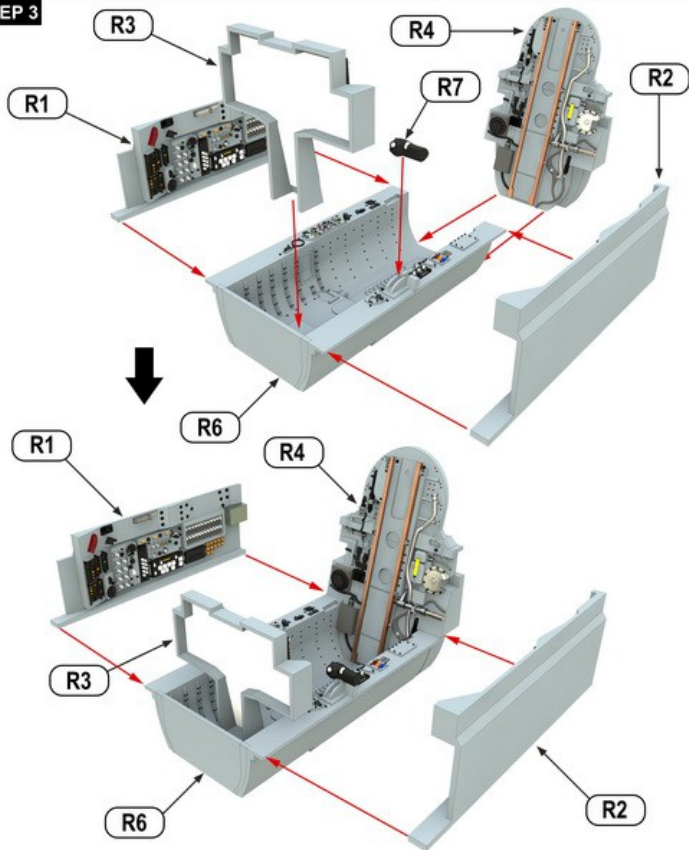

**STEP 4**

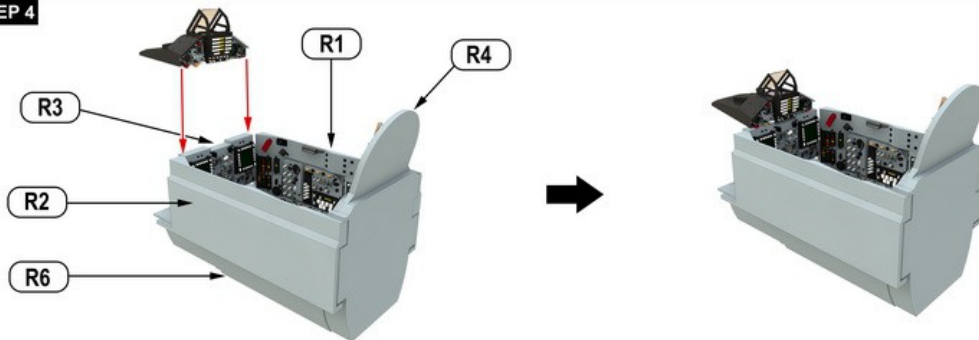



STEP 5

Cockpit Paint Reference

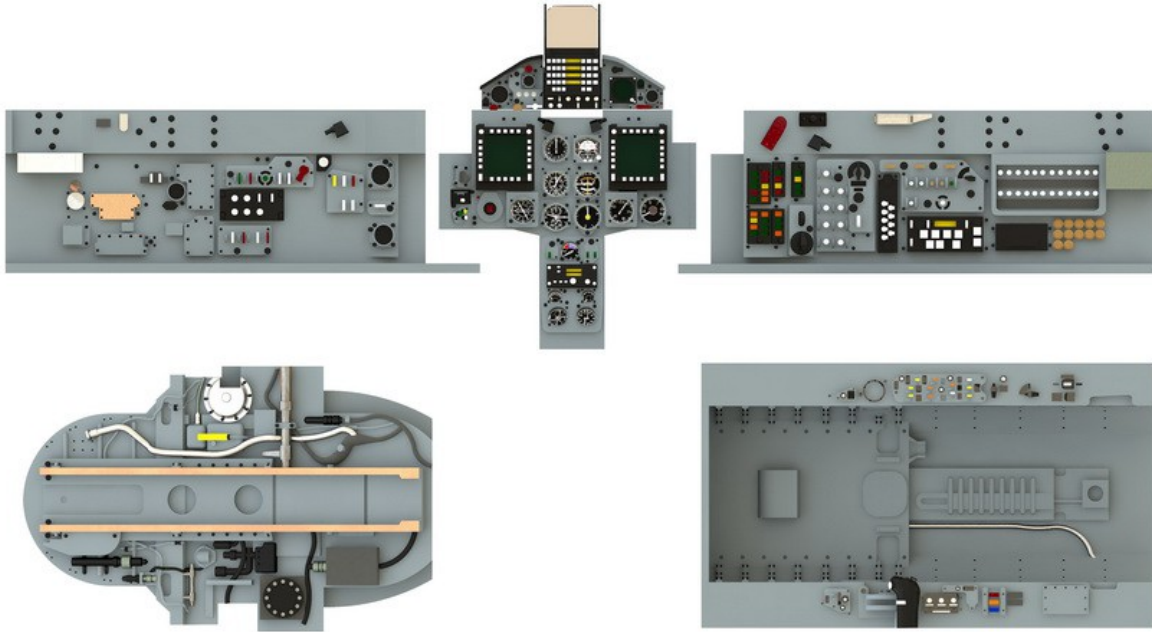

- Glossy Dark Green
- Black Matt
- Red
- Yellow

- Orange
- Blue
- Silver
- Bronze

- Glossy green
- Tan
- White
- Iron



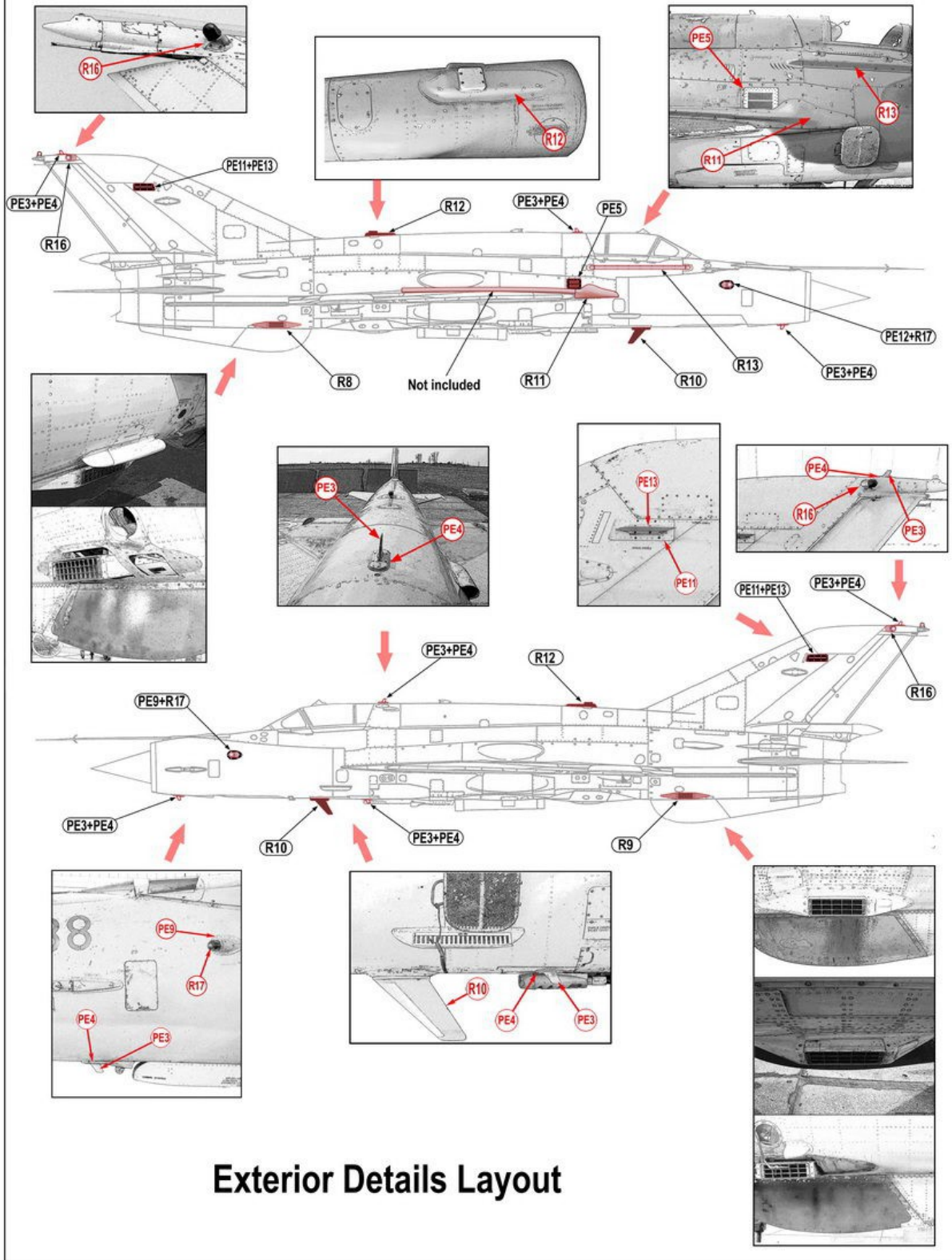

# MIG-21 LANCER C

## 86<sup>th</sup> AFB FETESTI

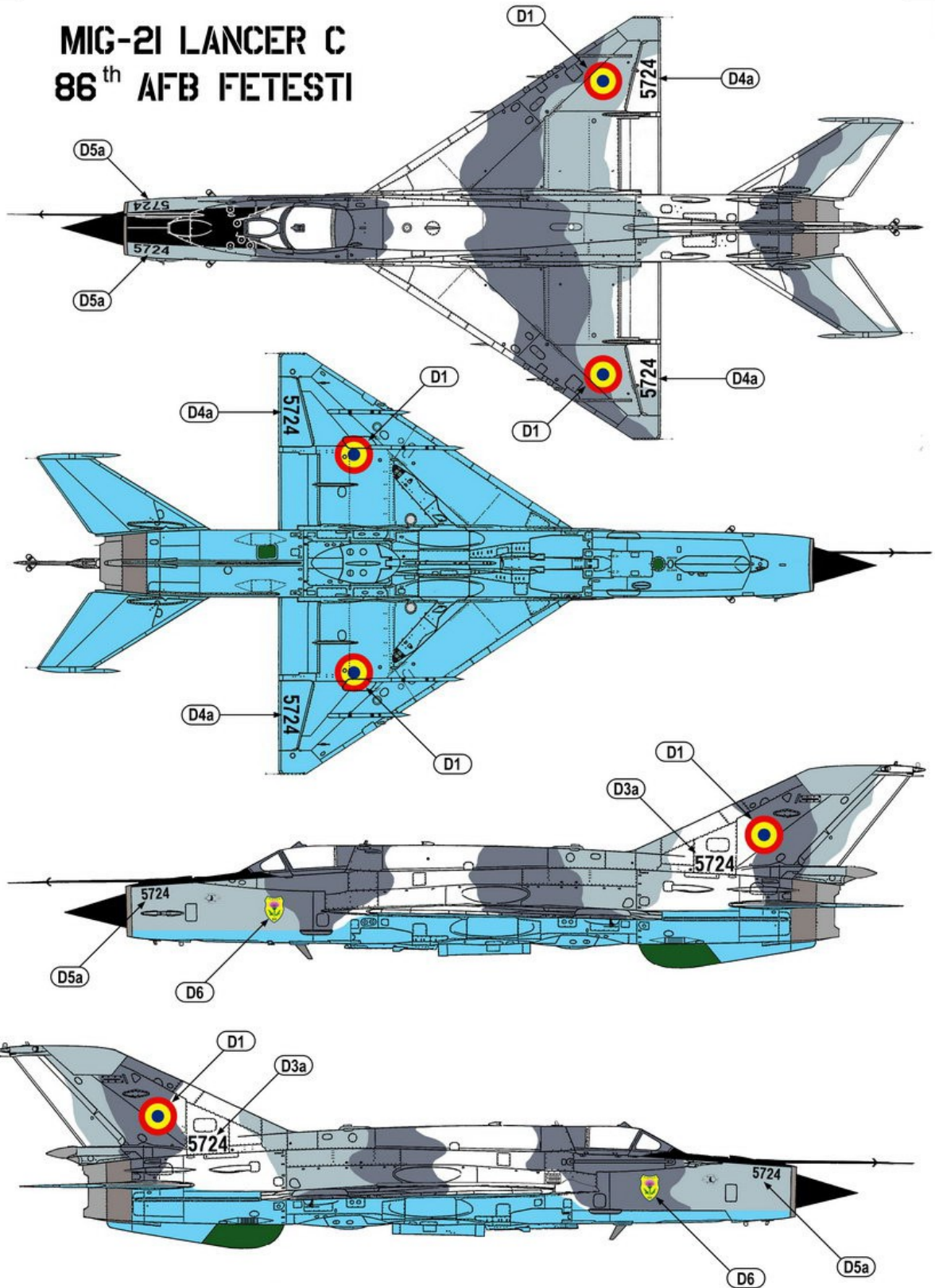

- |  |  |   |  |
|--|--|---|--|
|  Light Blue |  Light Gray |  Steel       |  White      |
|  Green      |  Gray       |  Jet Exhaust |  Black Matt |



# MIG-21 LANCER C

## 71<sup>st</sup> AFB CAMPIA TURZII

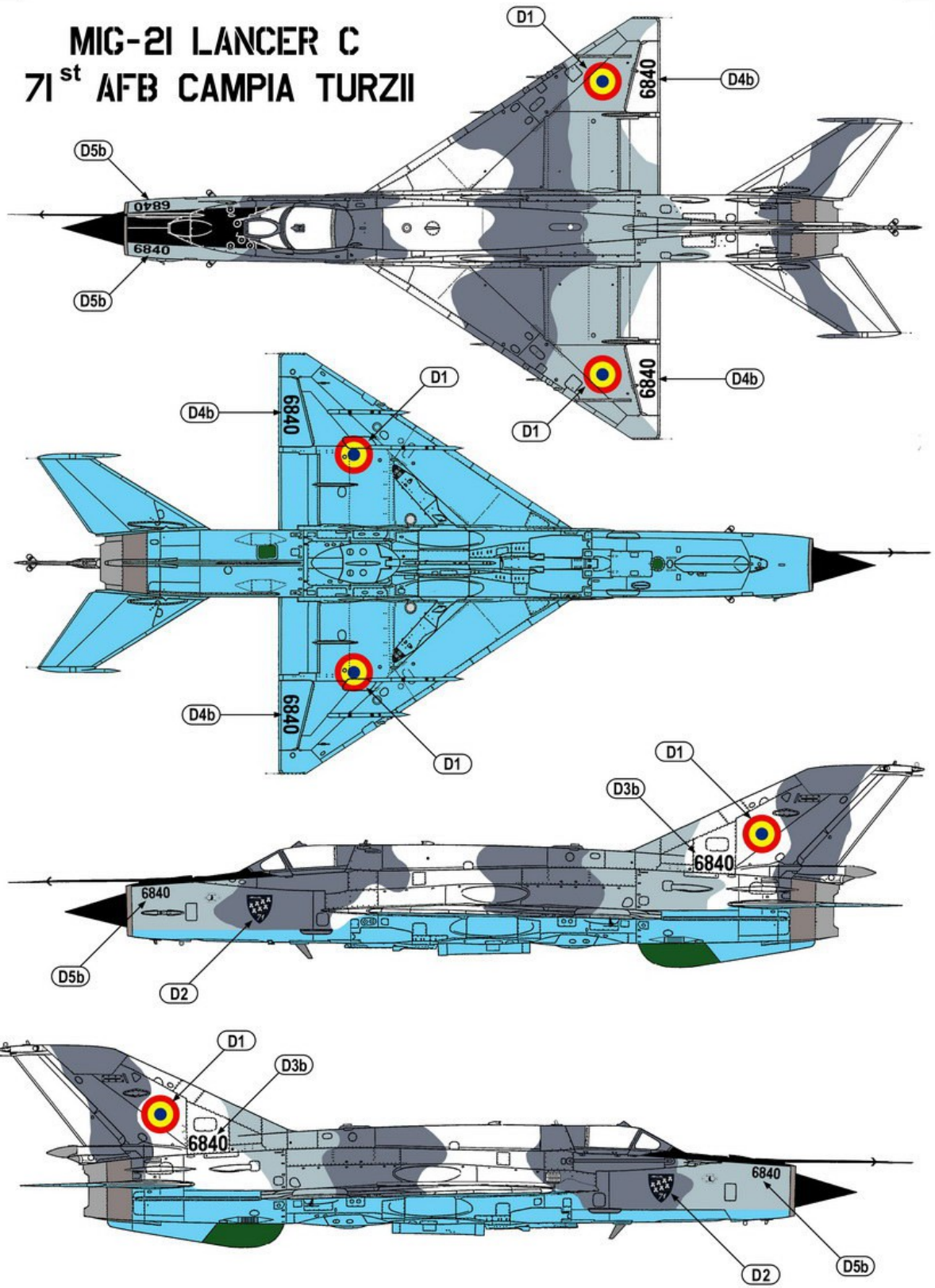

- |  |  |   |  |
|--|--|---|--|
|  Light Blue |  Light Gray |  Steel       |  White      |
|  Green      |  Gray       |  Jet Exhaust |  Black Matt |

**KIT Contents**

*Resin Parts*

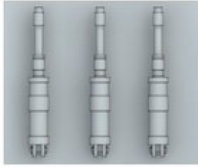

18



14



15

**STEP 1**

Trumpeter engine plastic parts

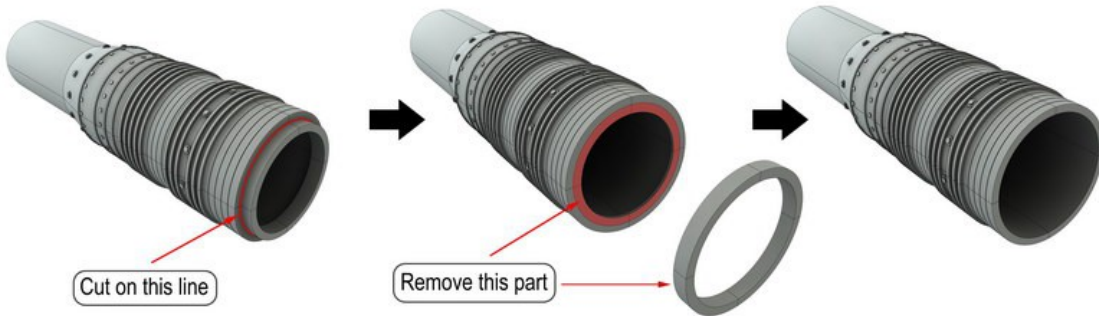

**STEP 2**

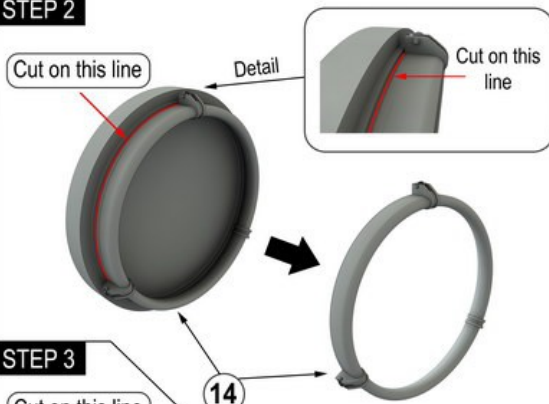

**STEP 3**

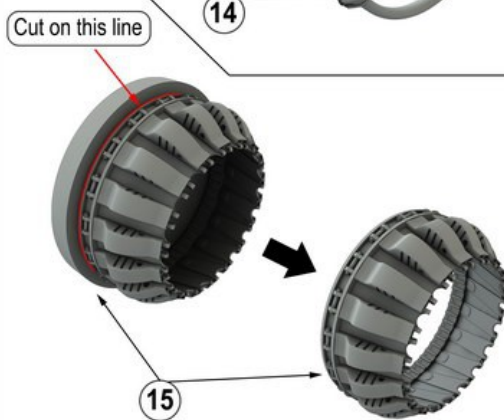

**STEP 4**

