

2

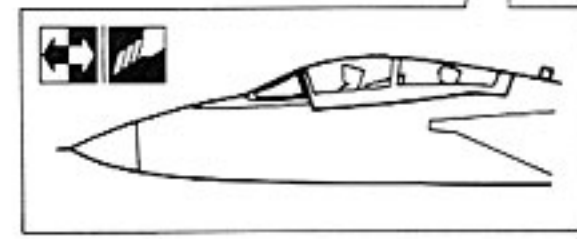

3

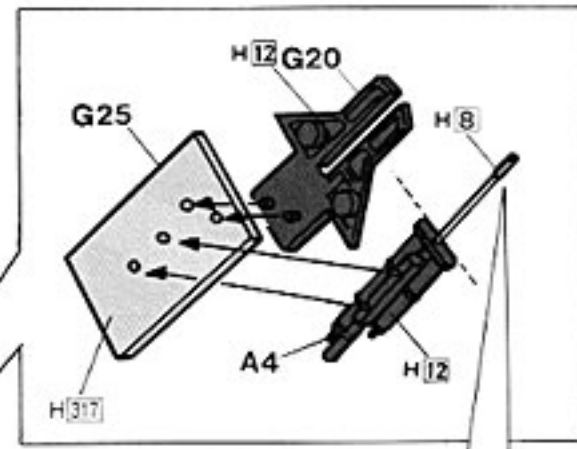
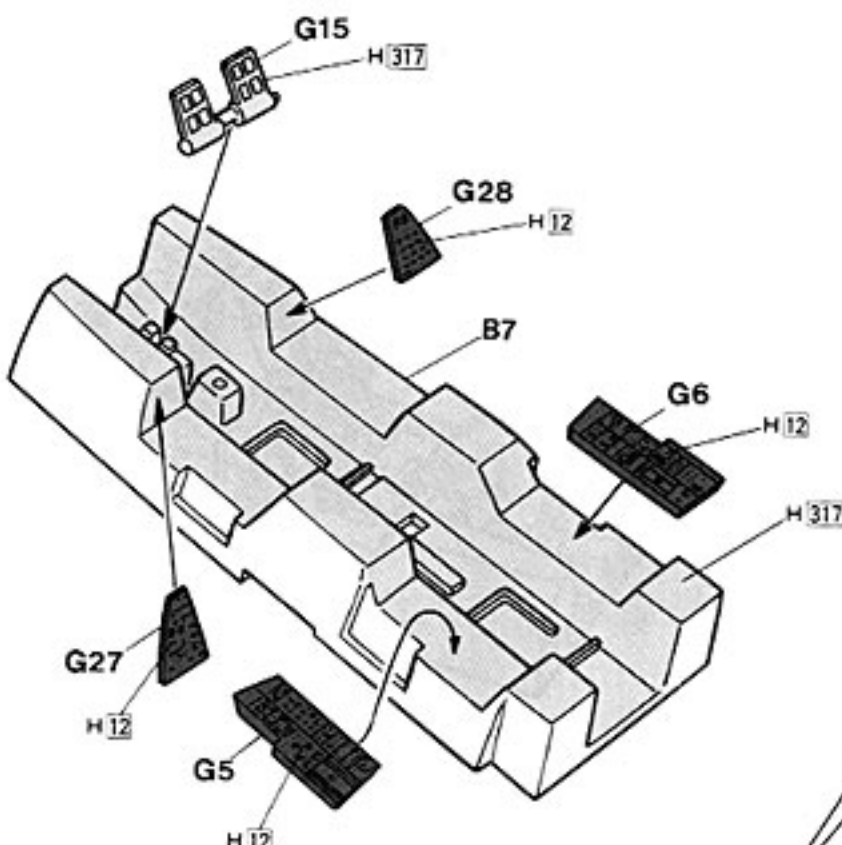
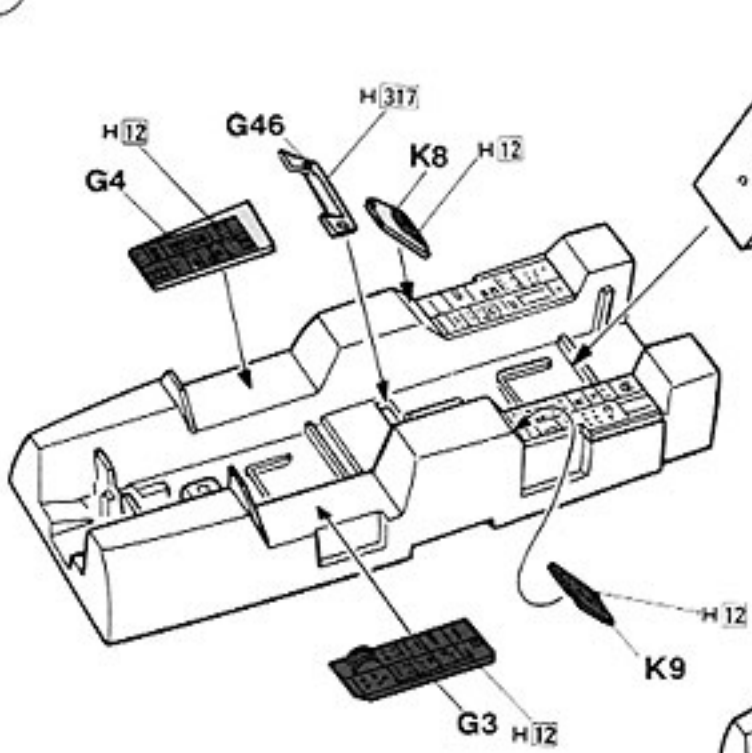

4

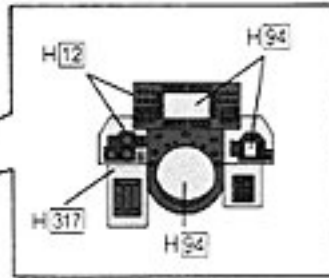
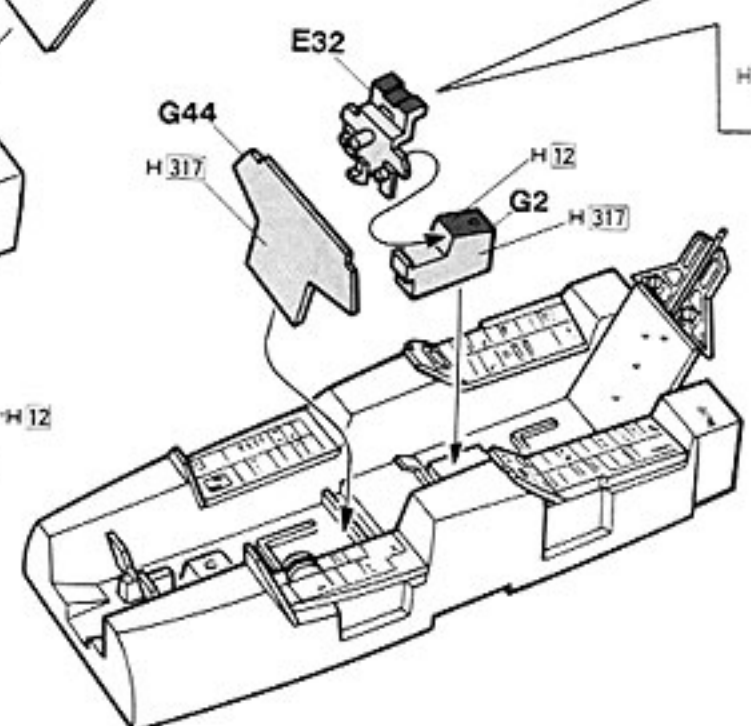

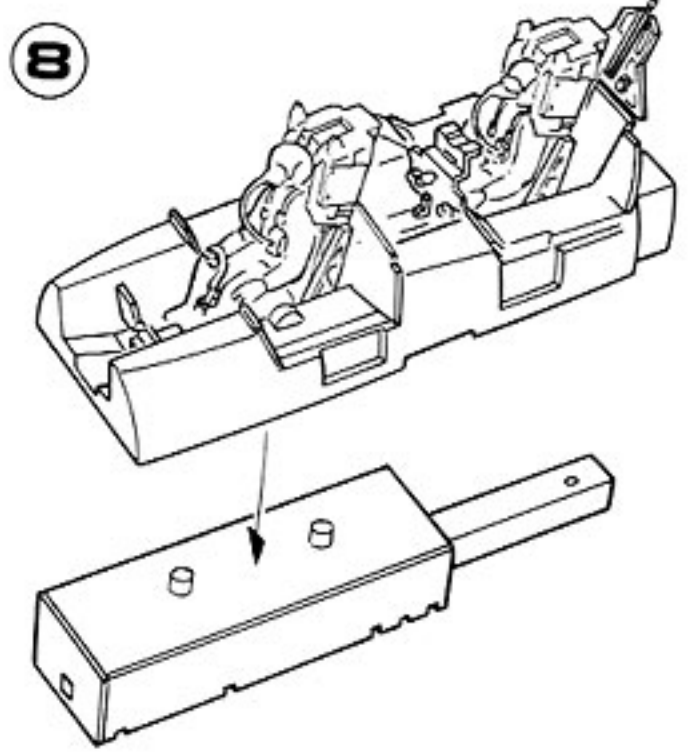
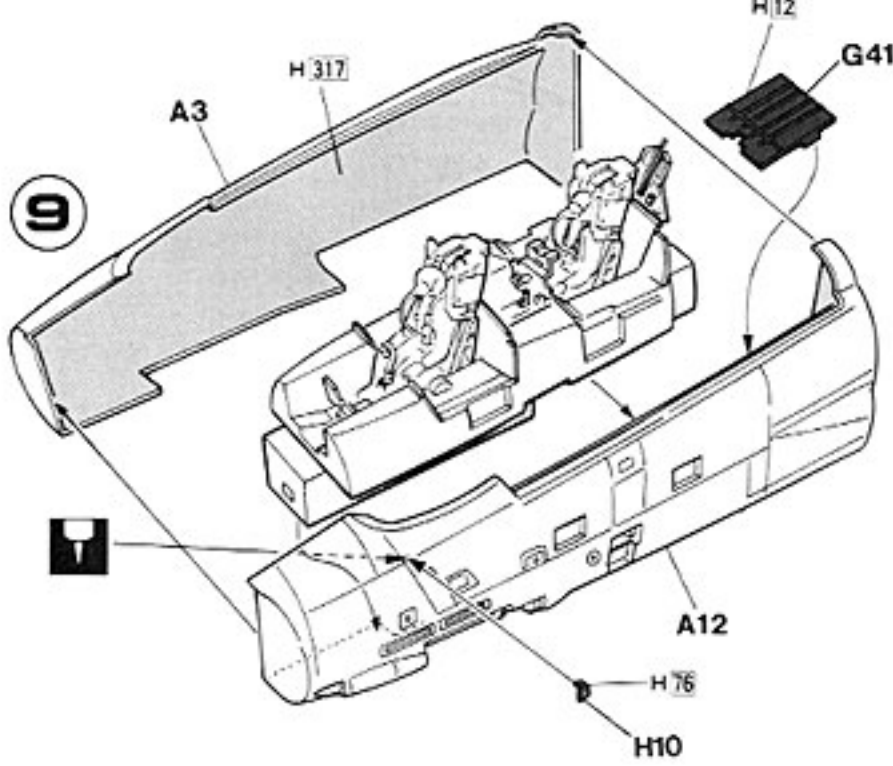
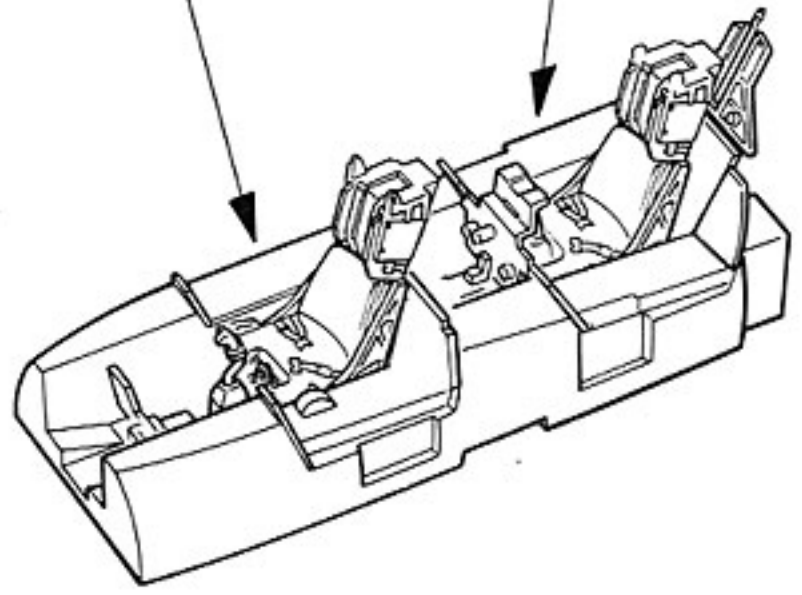
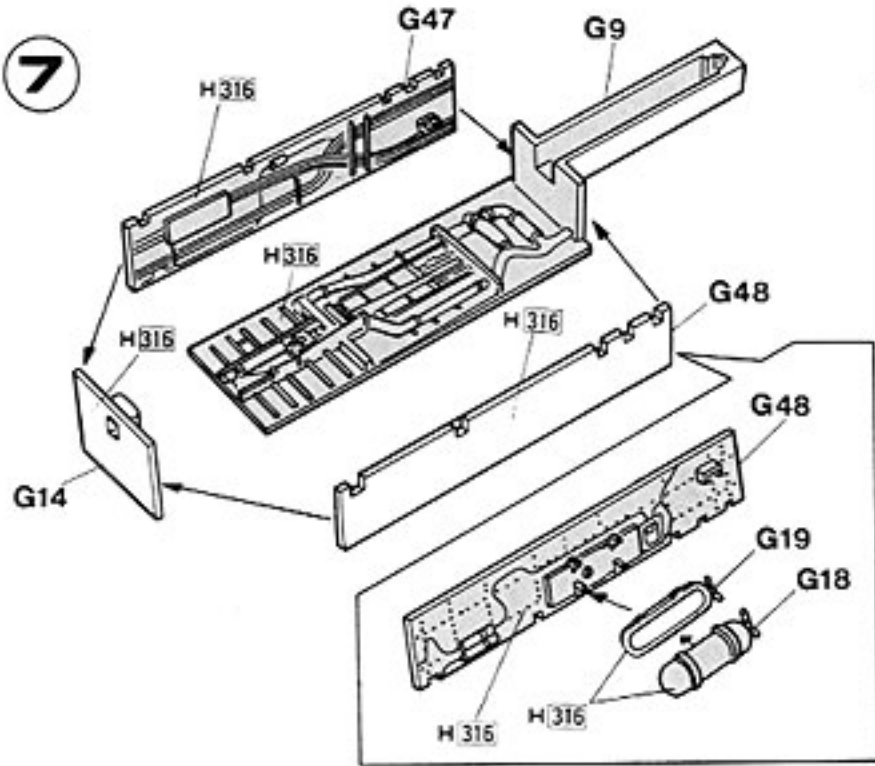
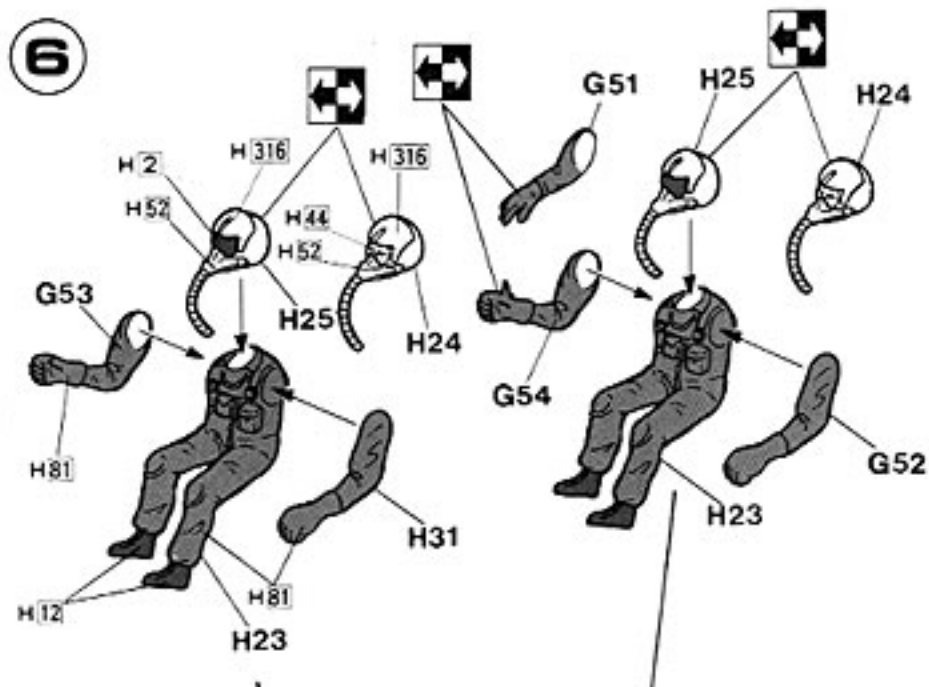
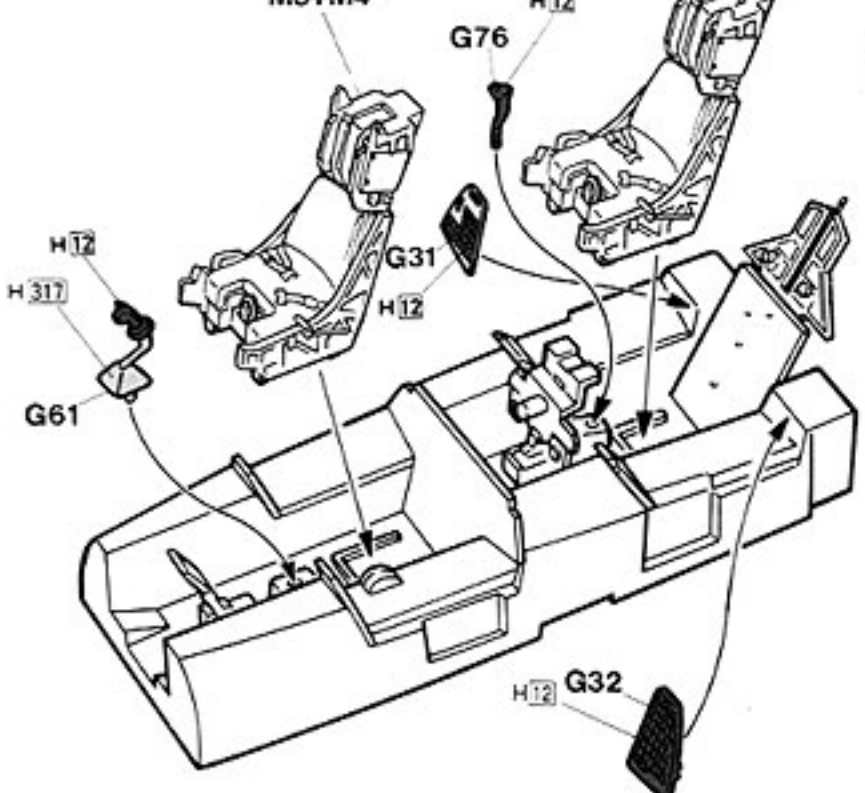

10

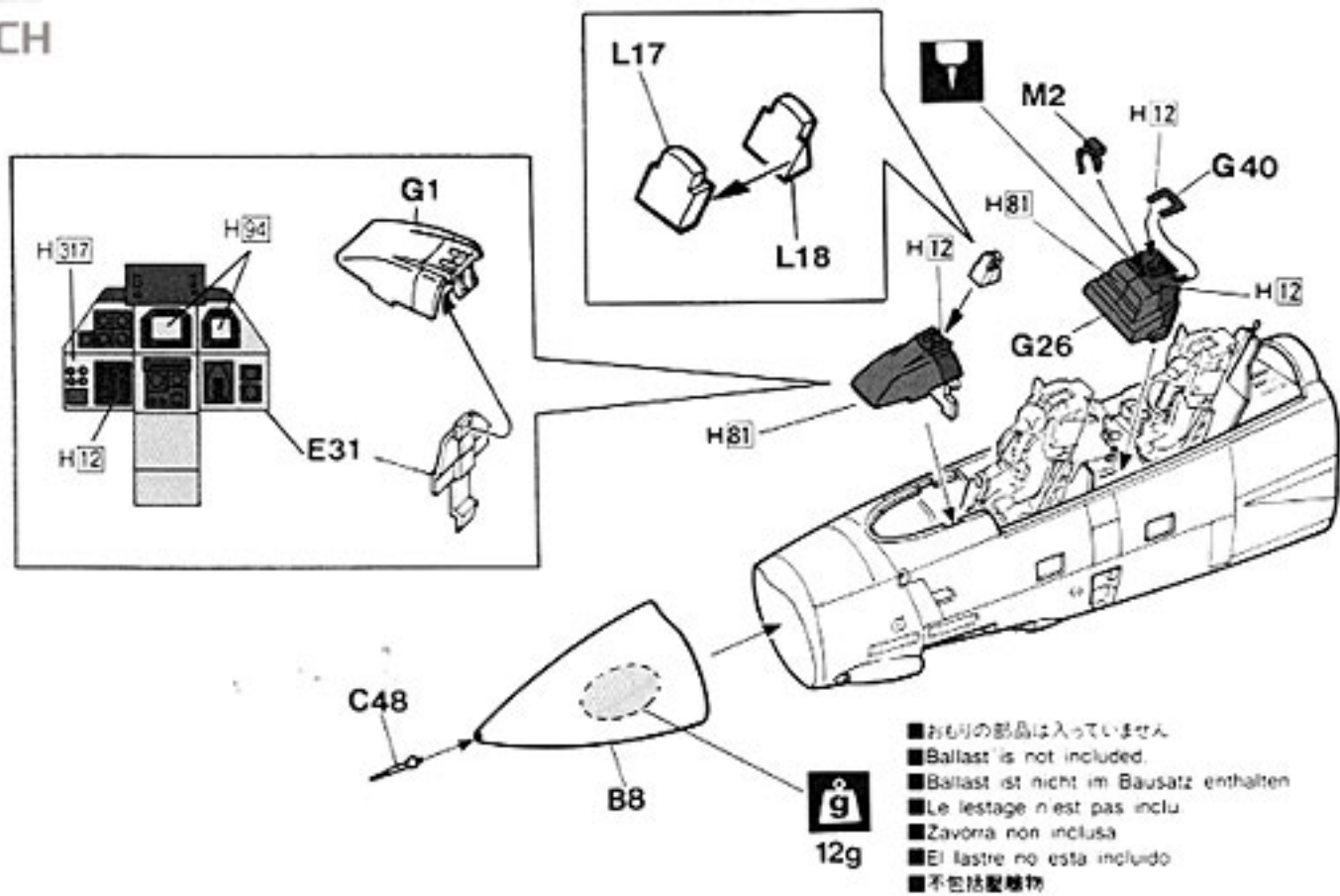

11

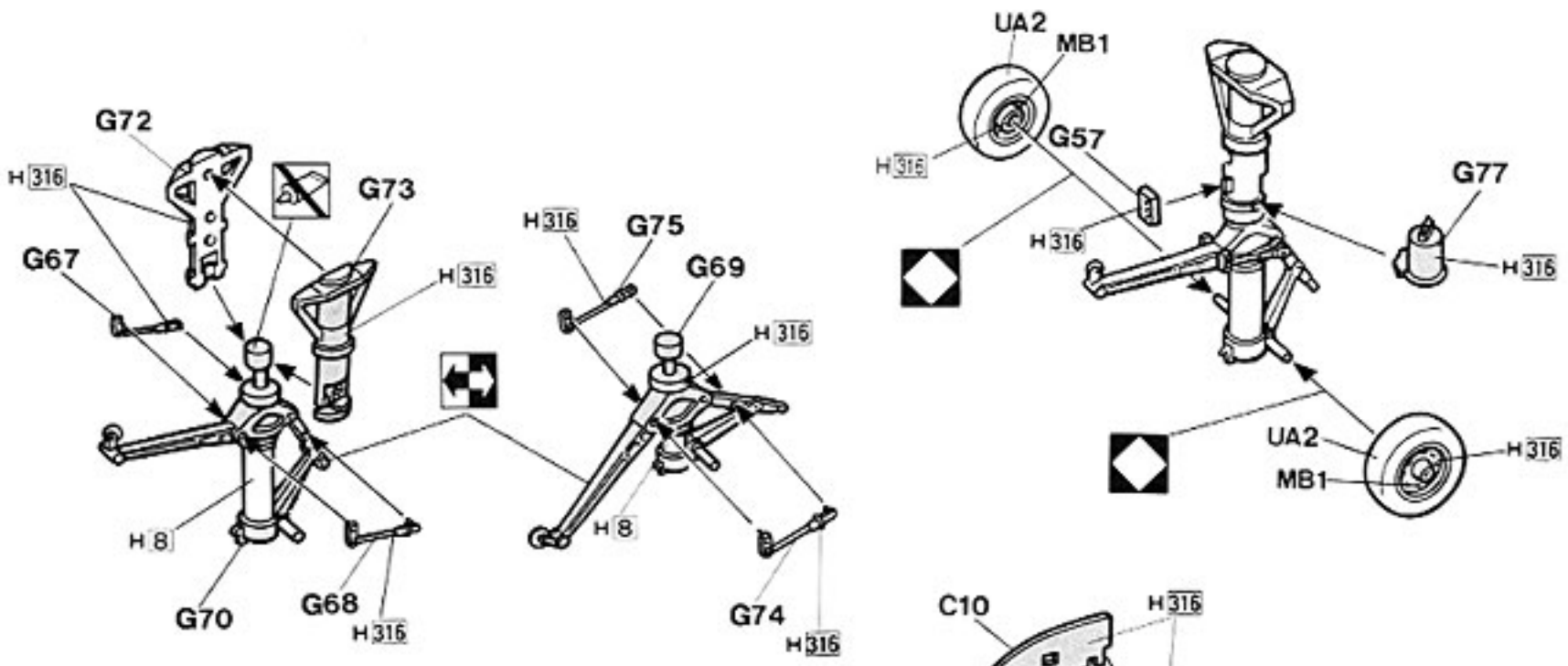

12

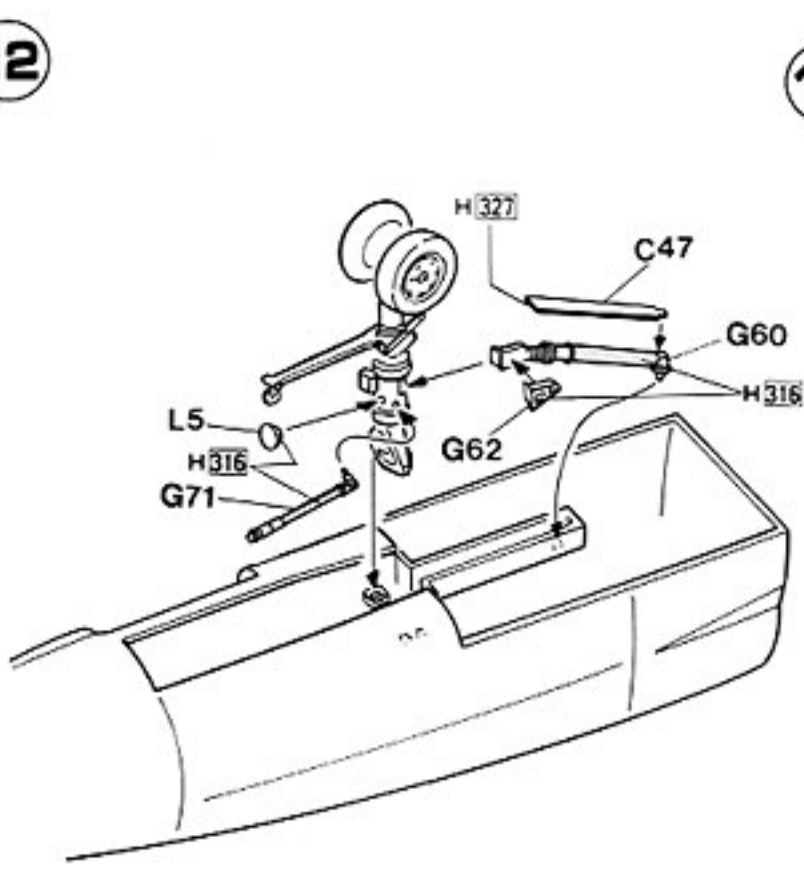

13

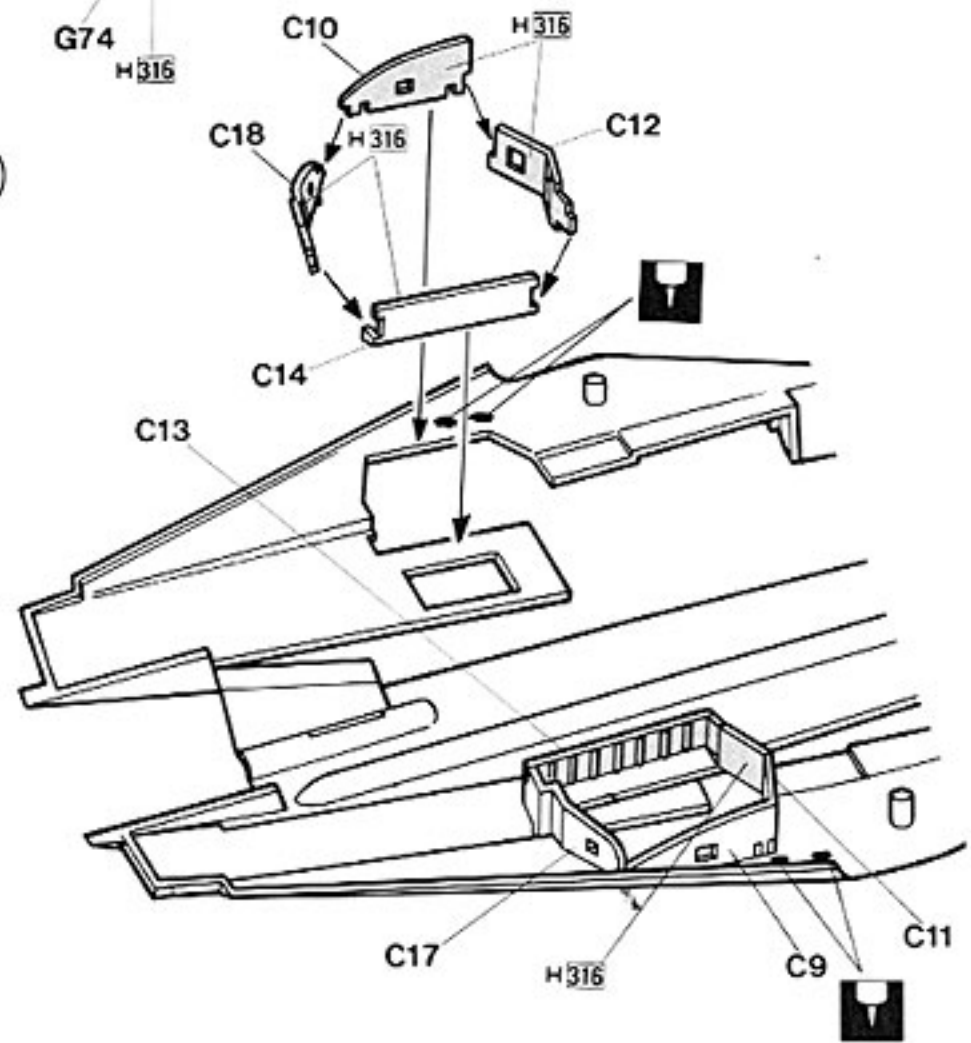

14

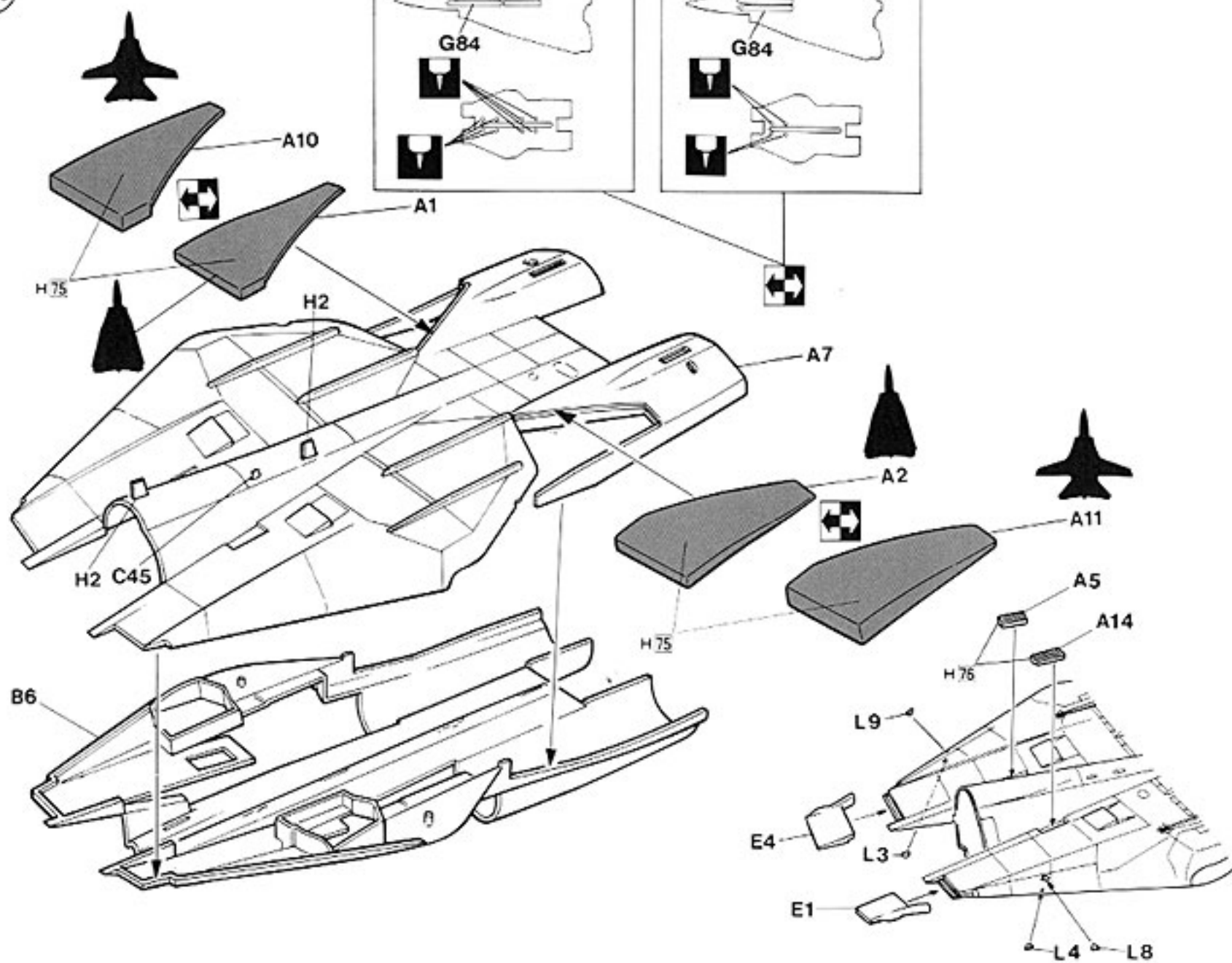

15

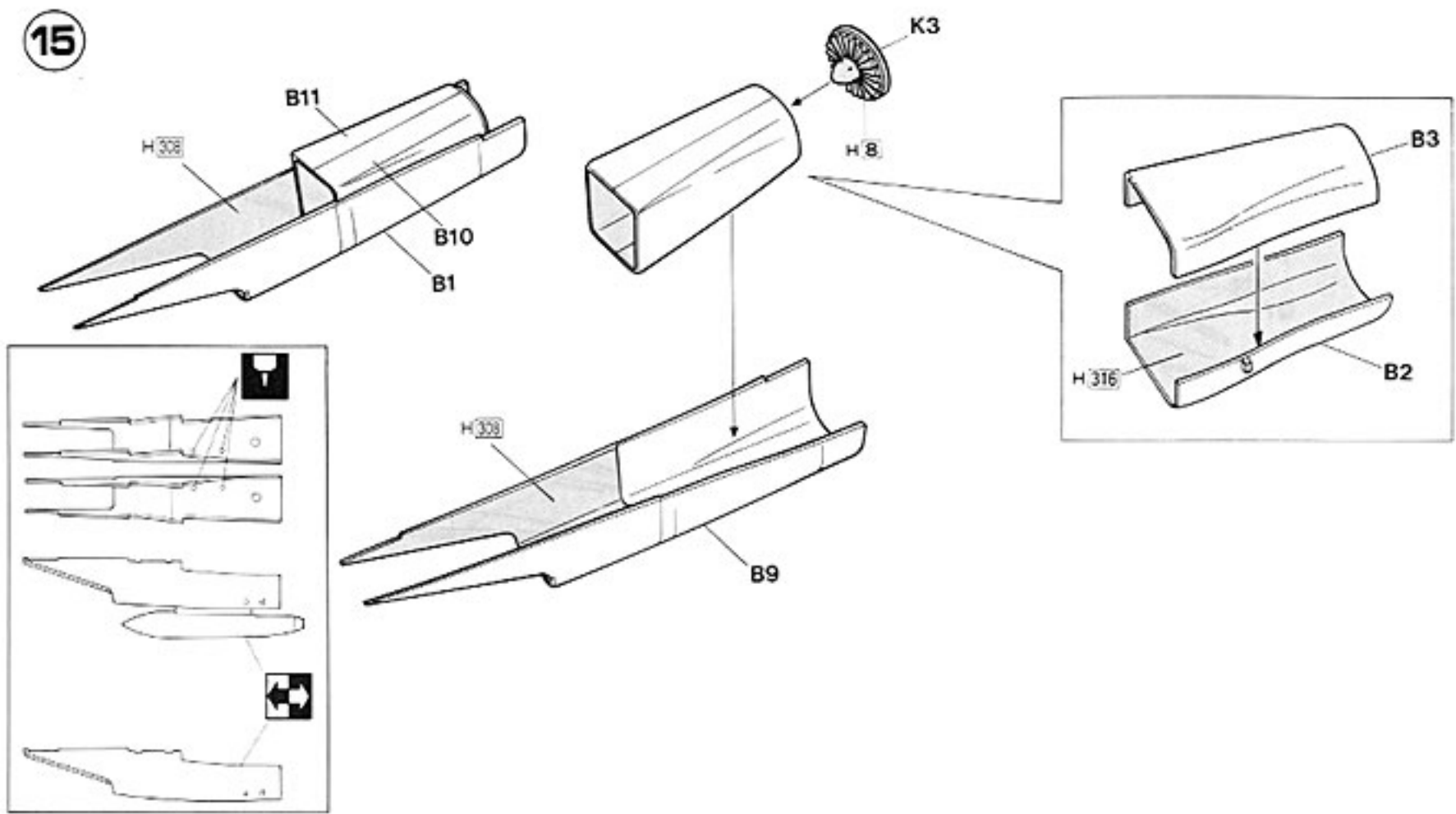

16

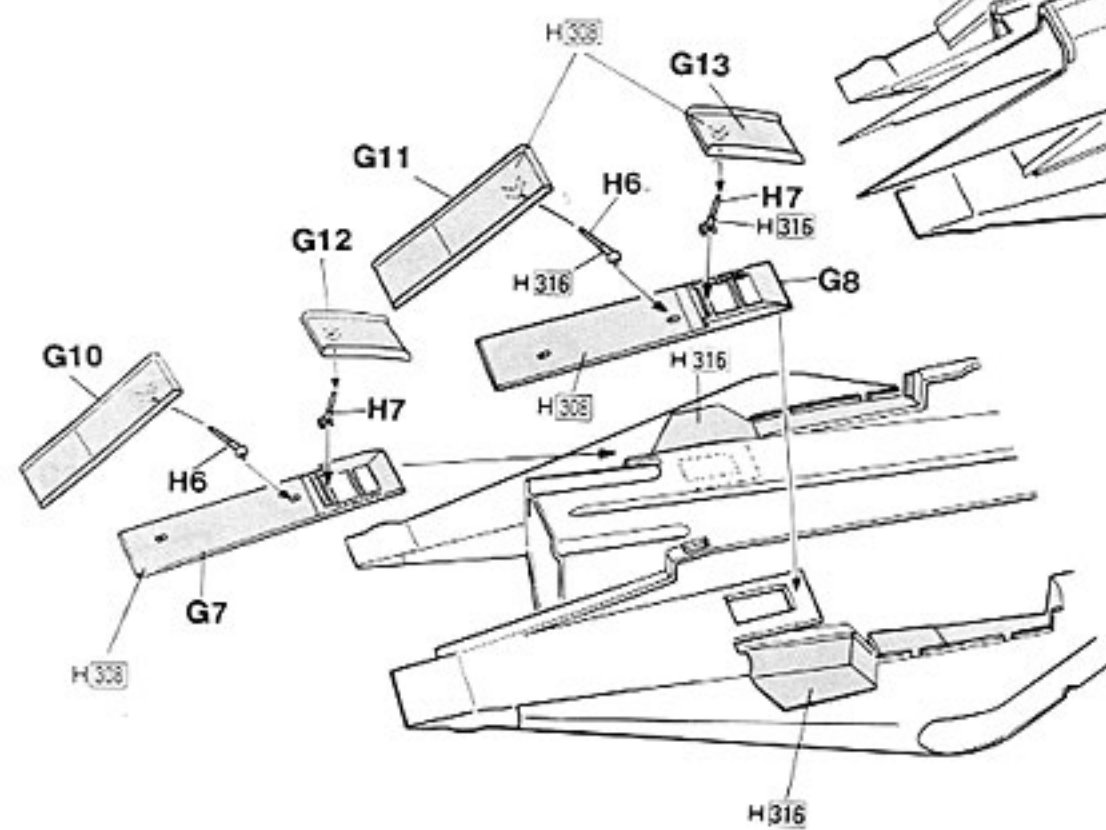

17

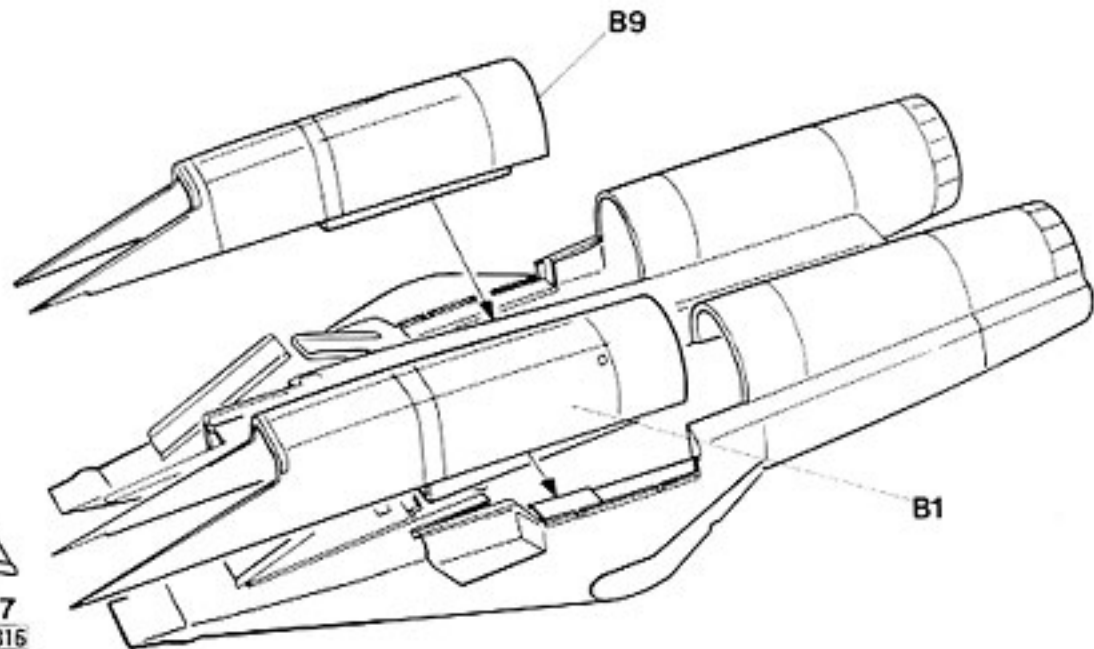

18

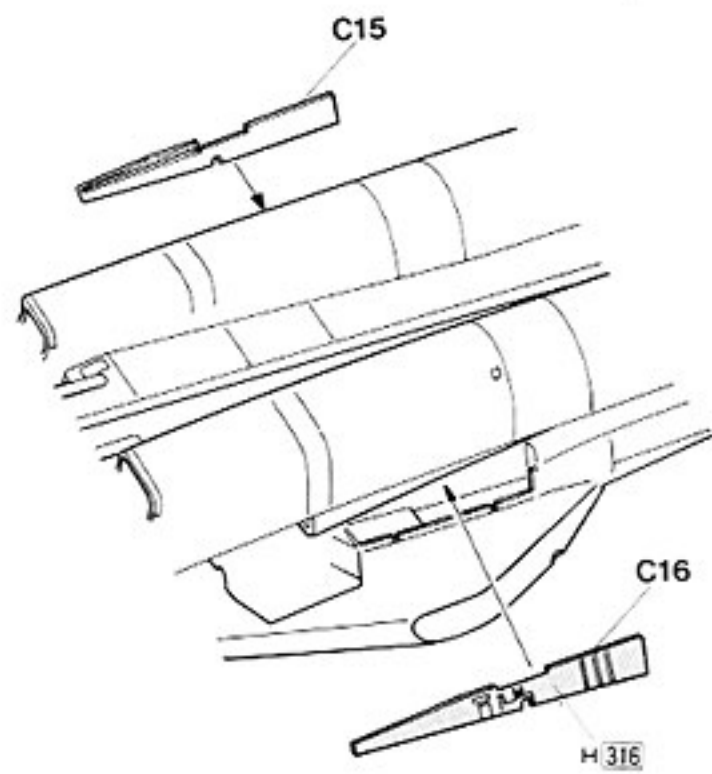

19 x2

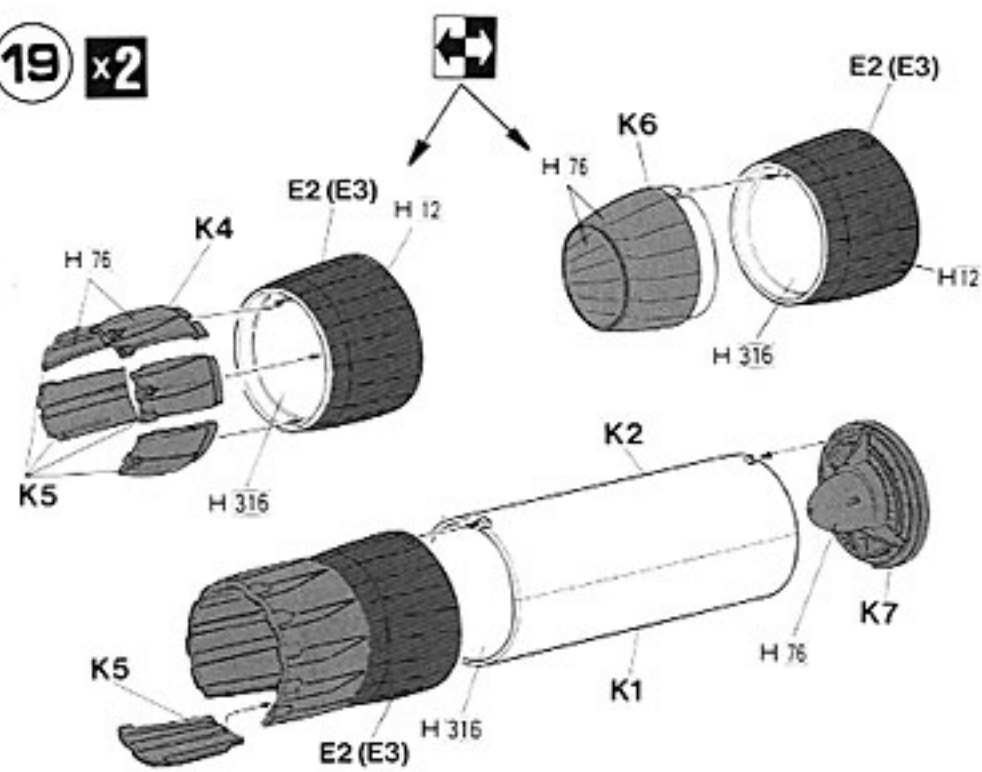

20

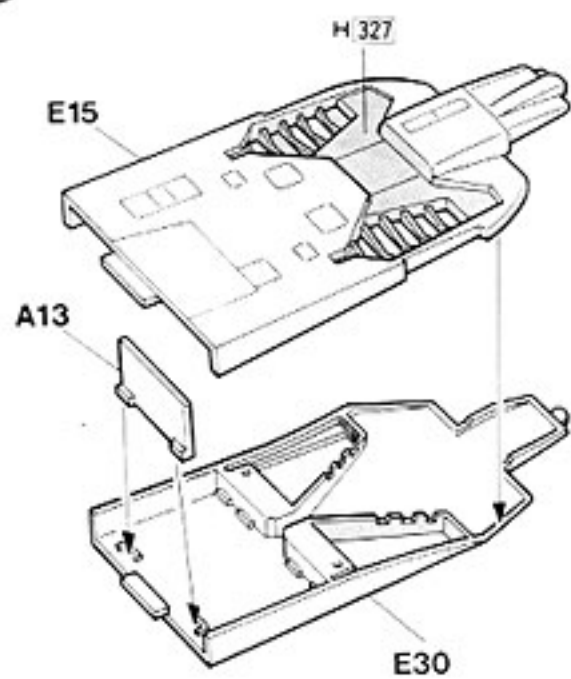

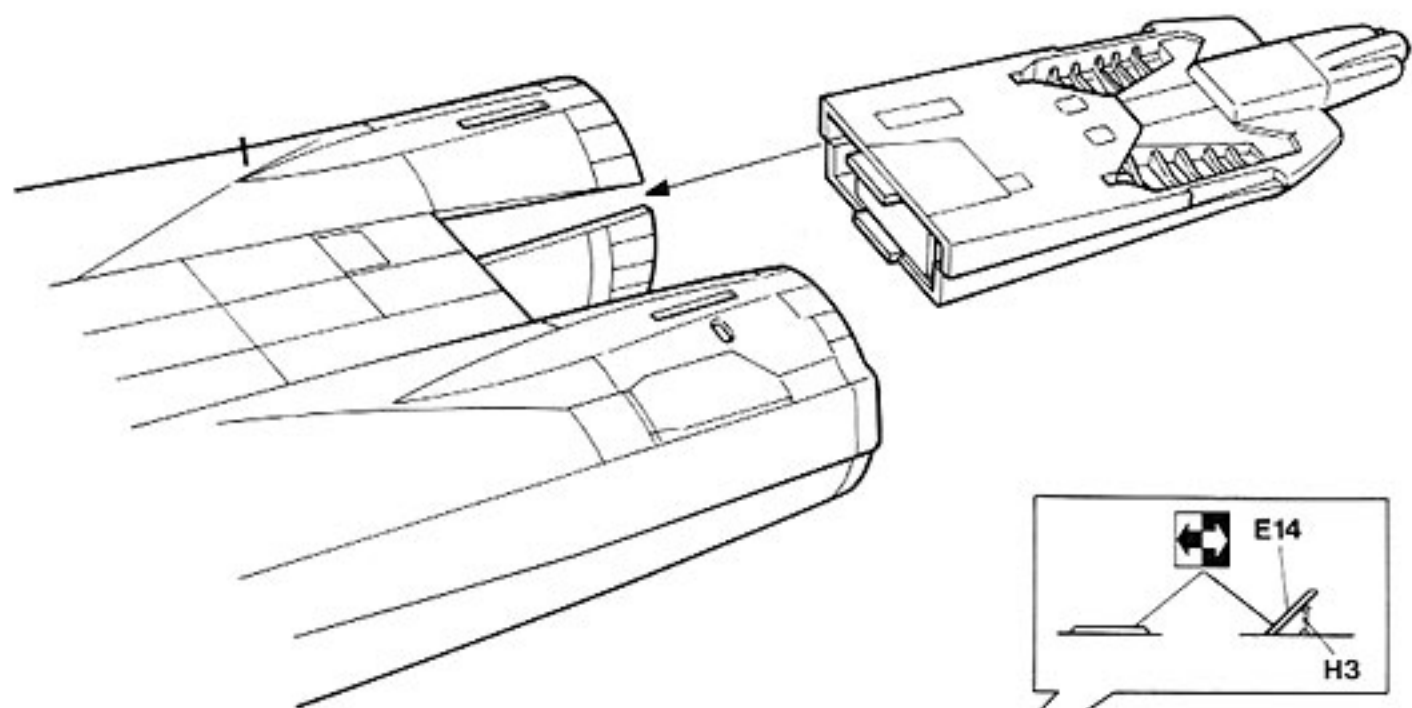

22

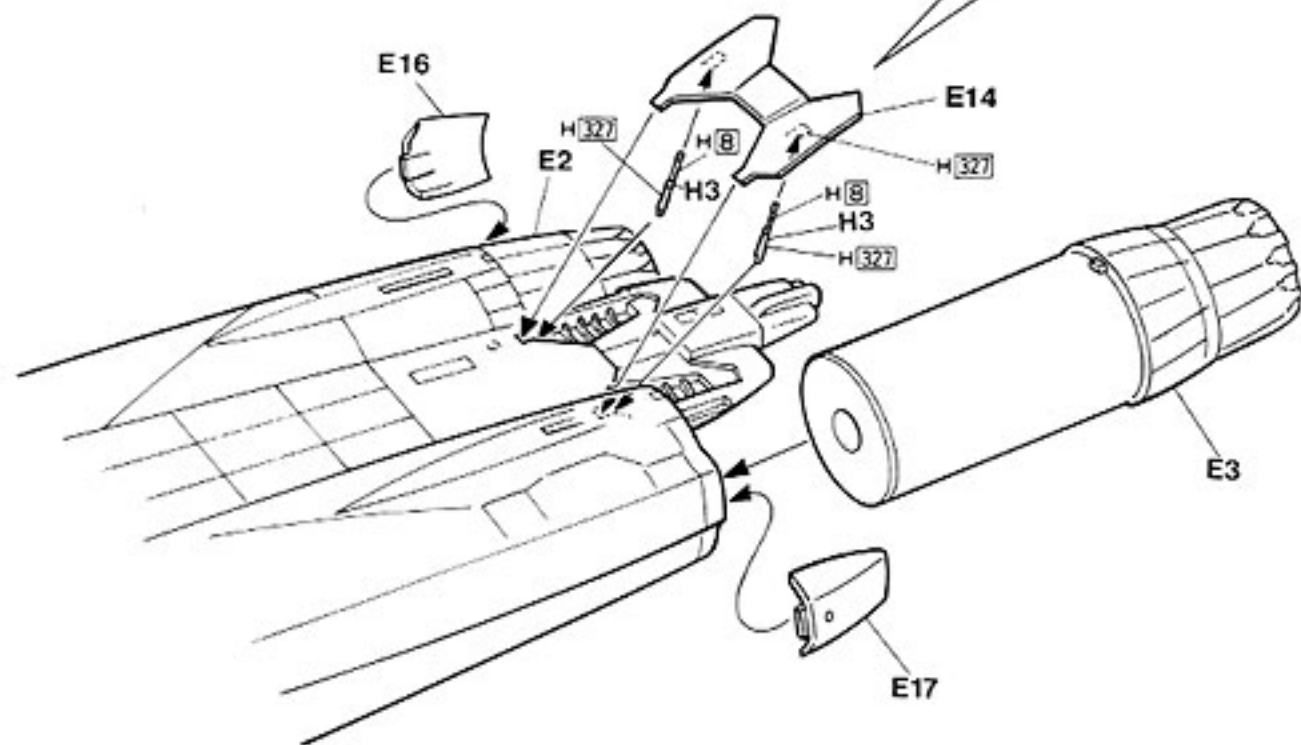

23

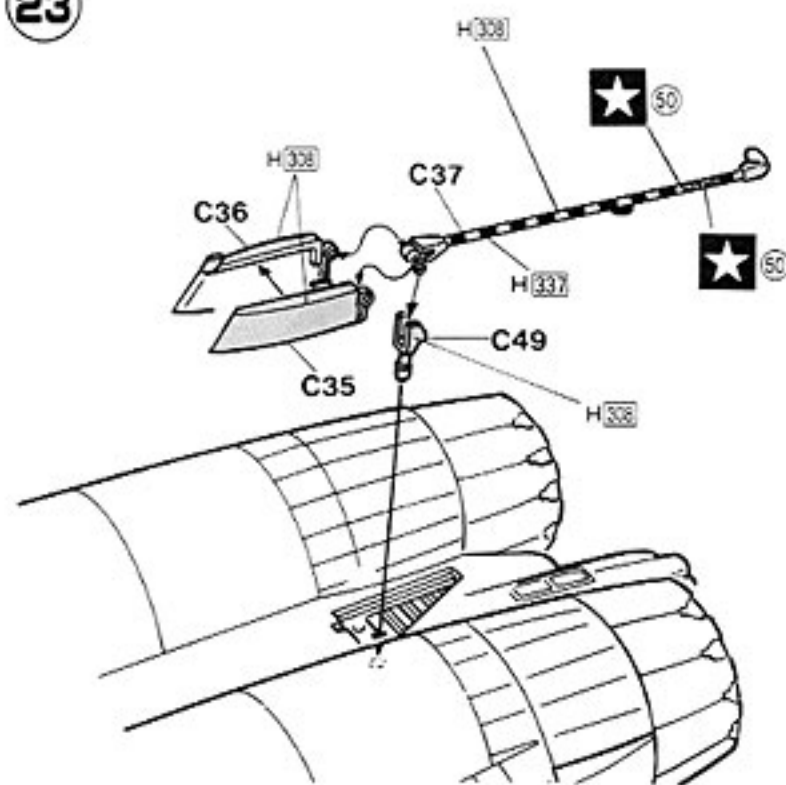

24

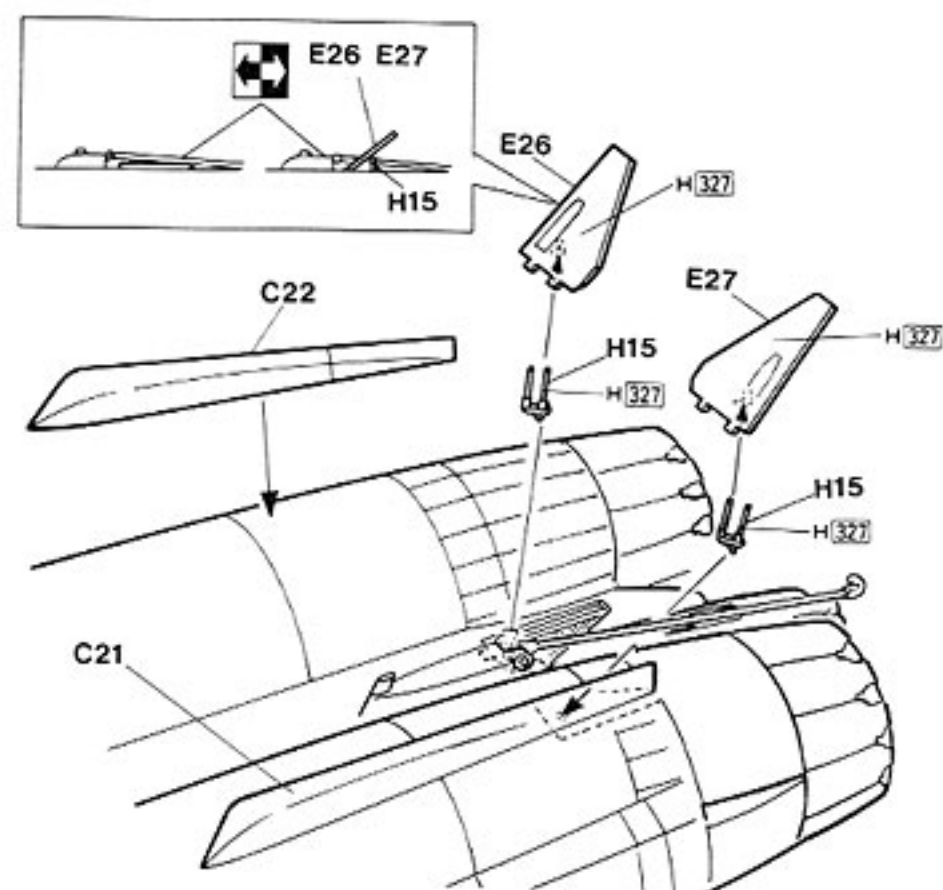

25

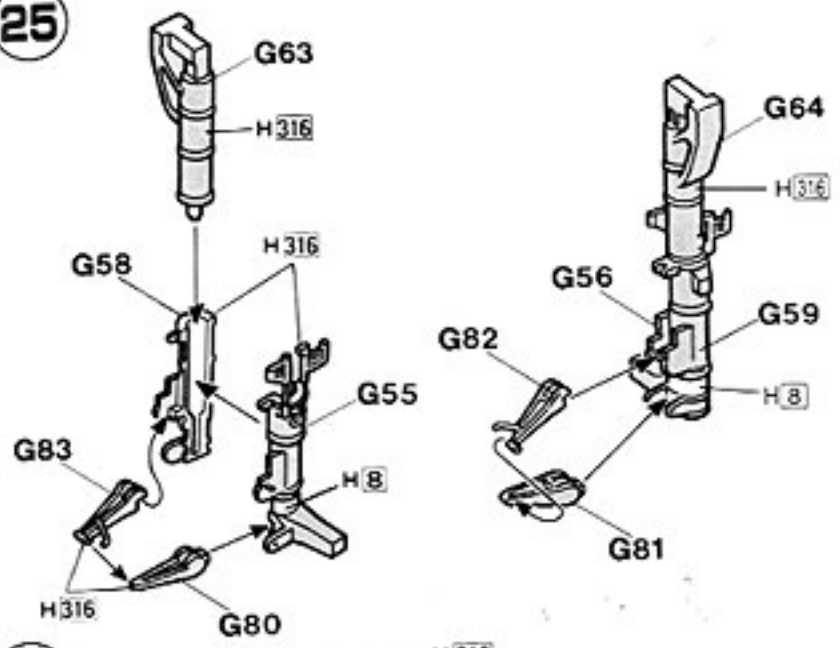

26

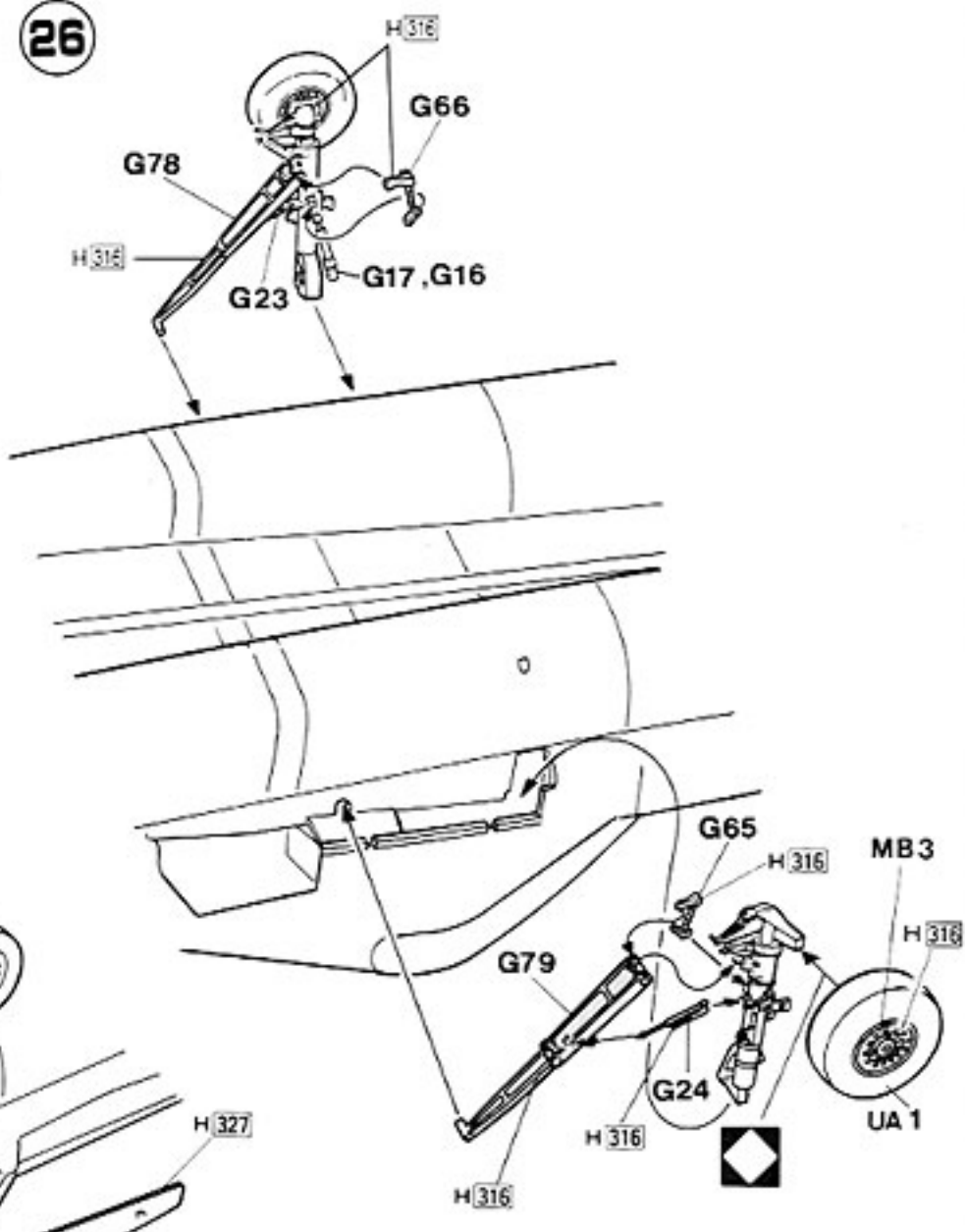

27

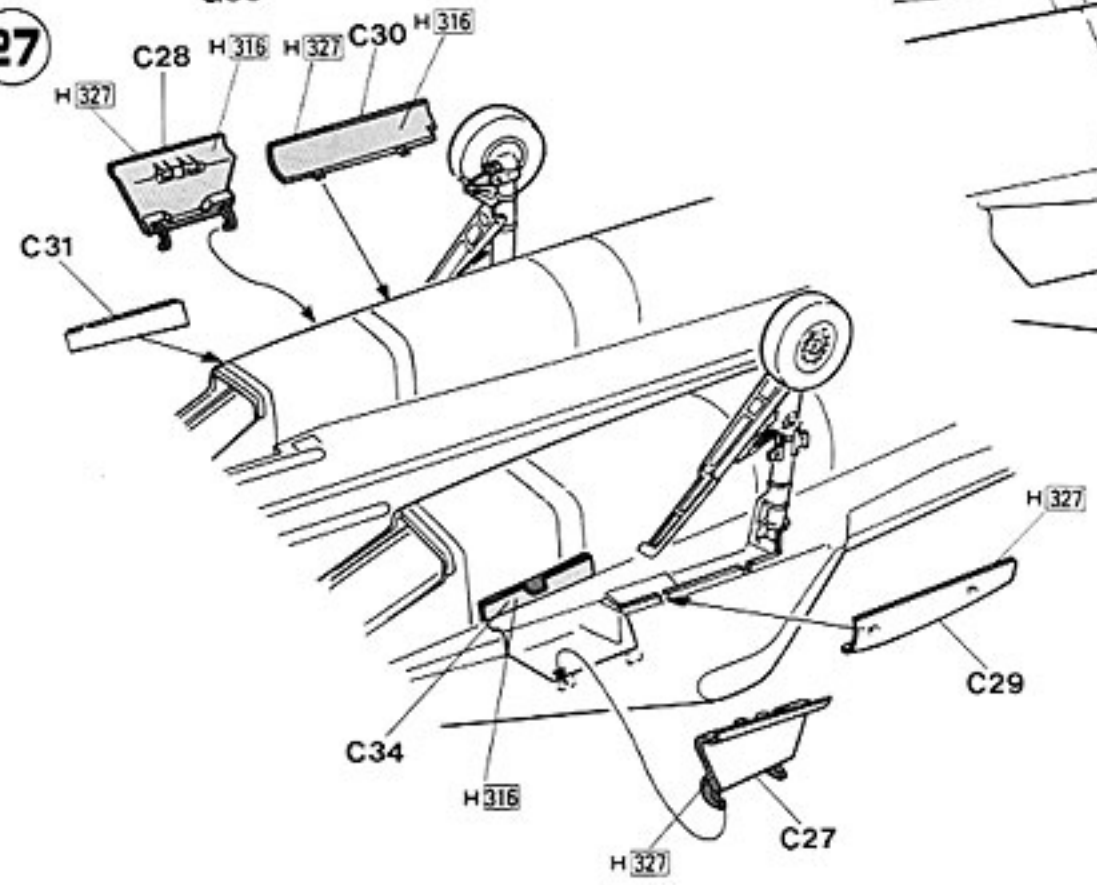

28

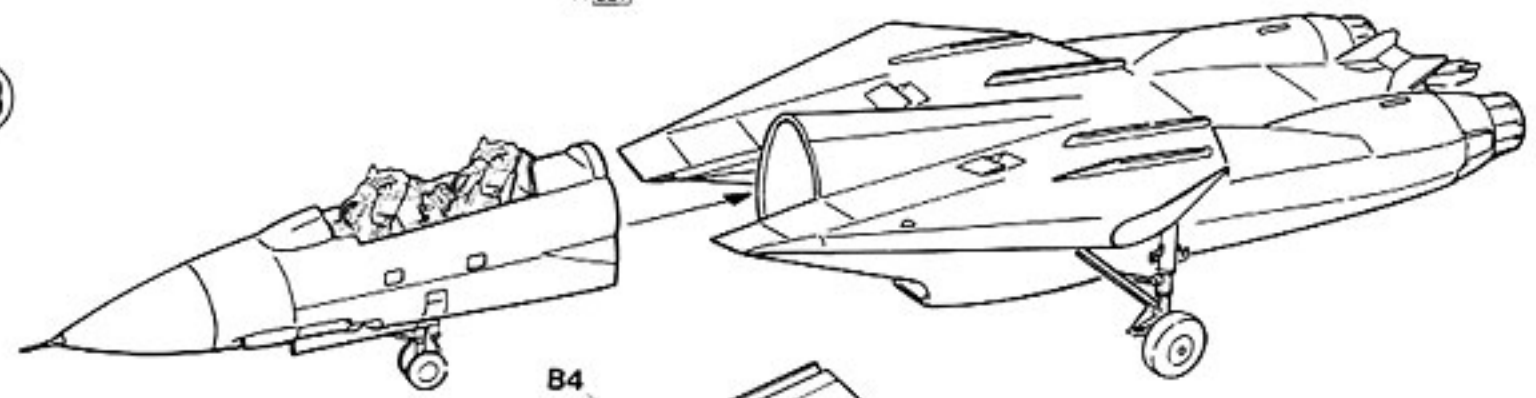

29

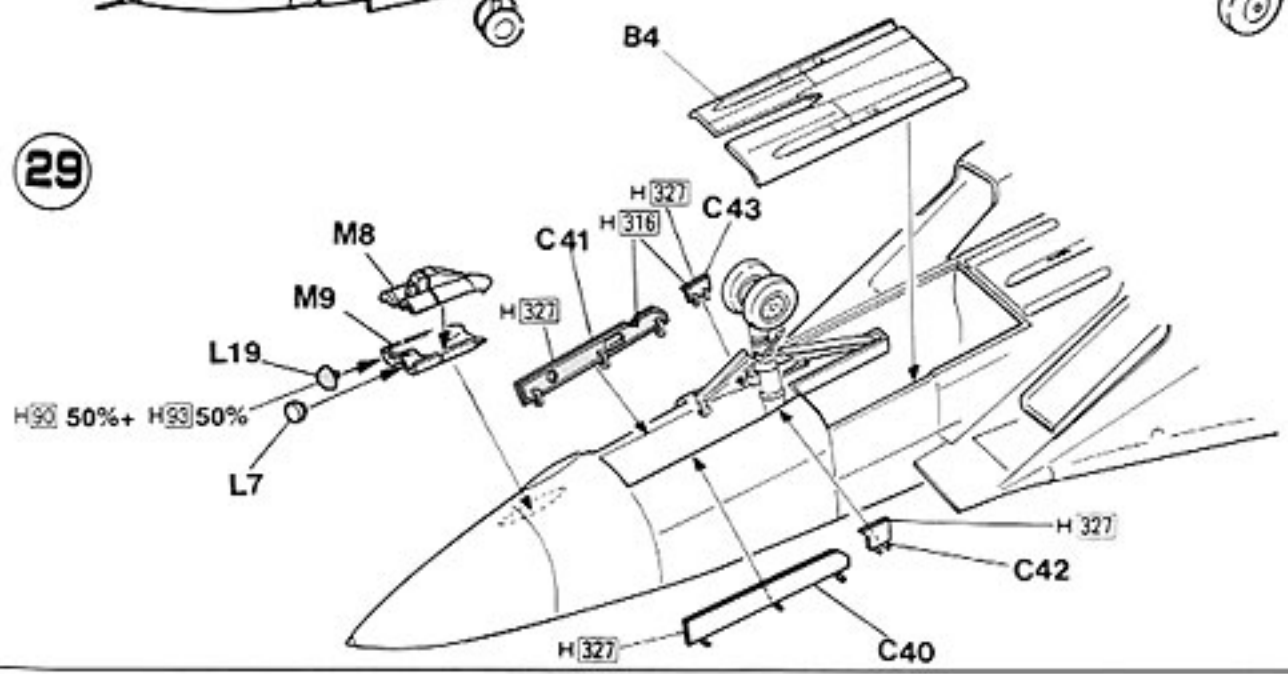

H90 50%+ H93 50%

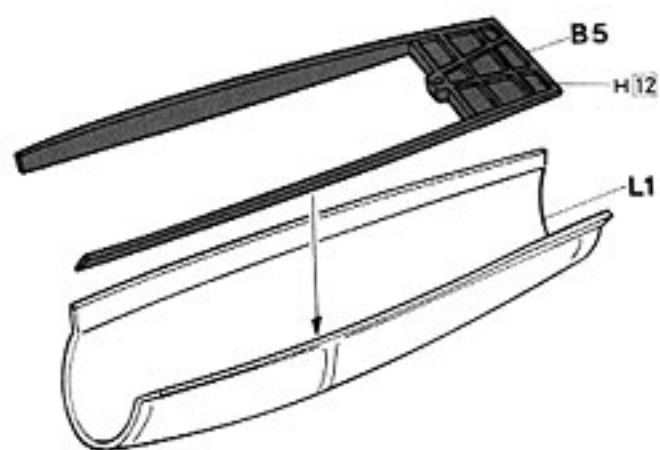

31

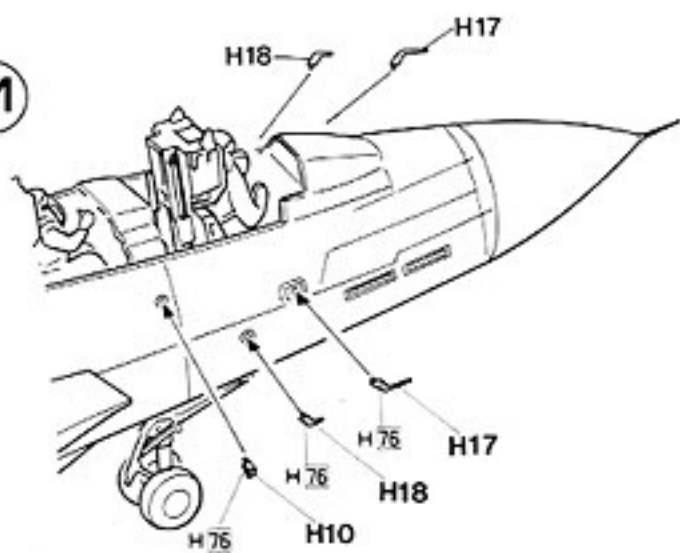

32

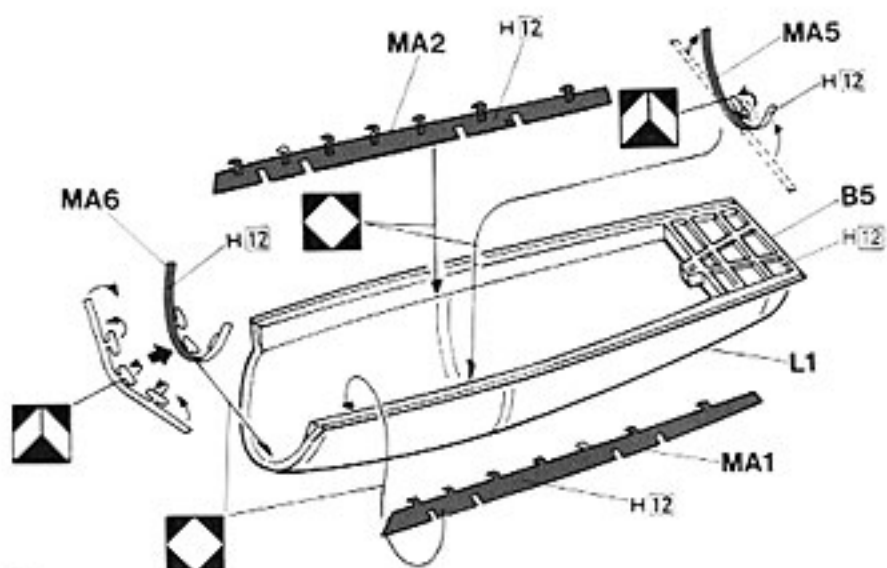

33

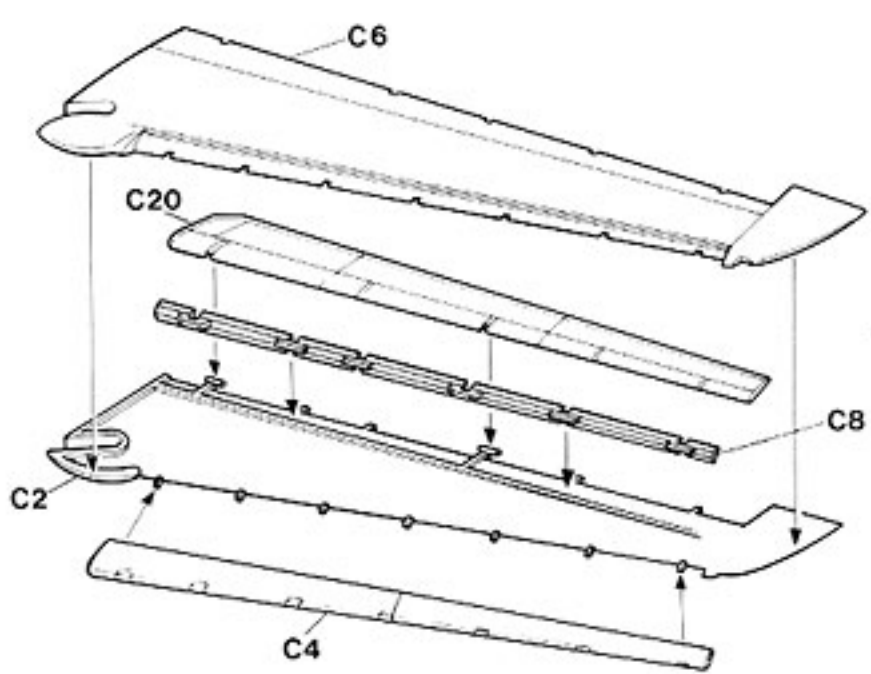
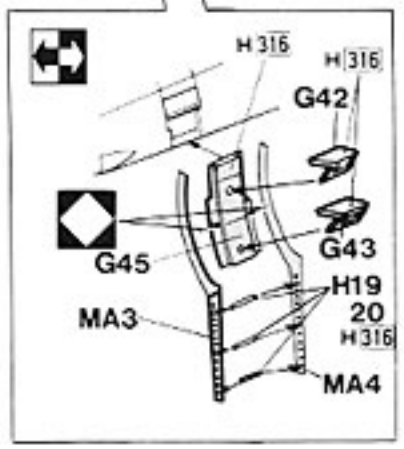
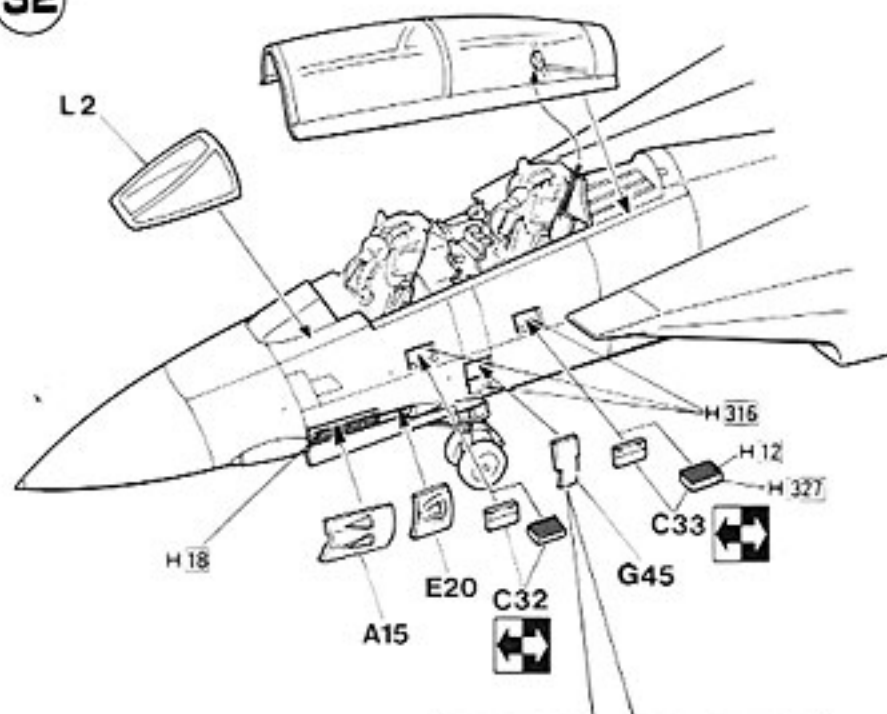
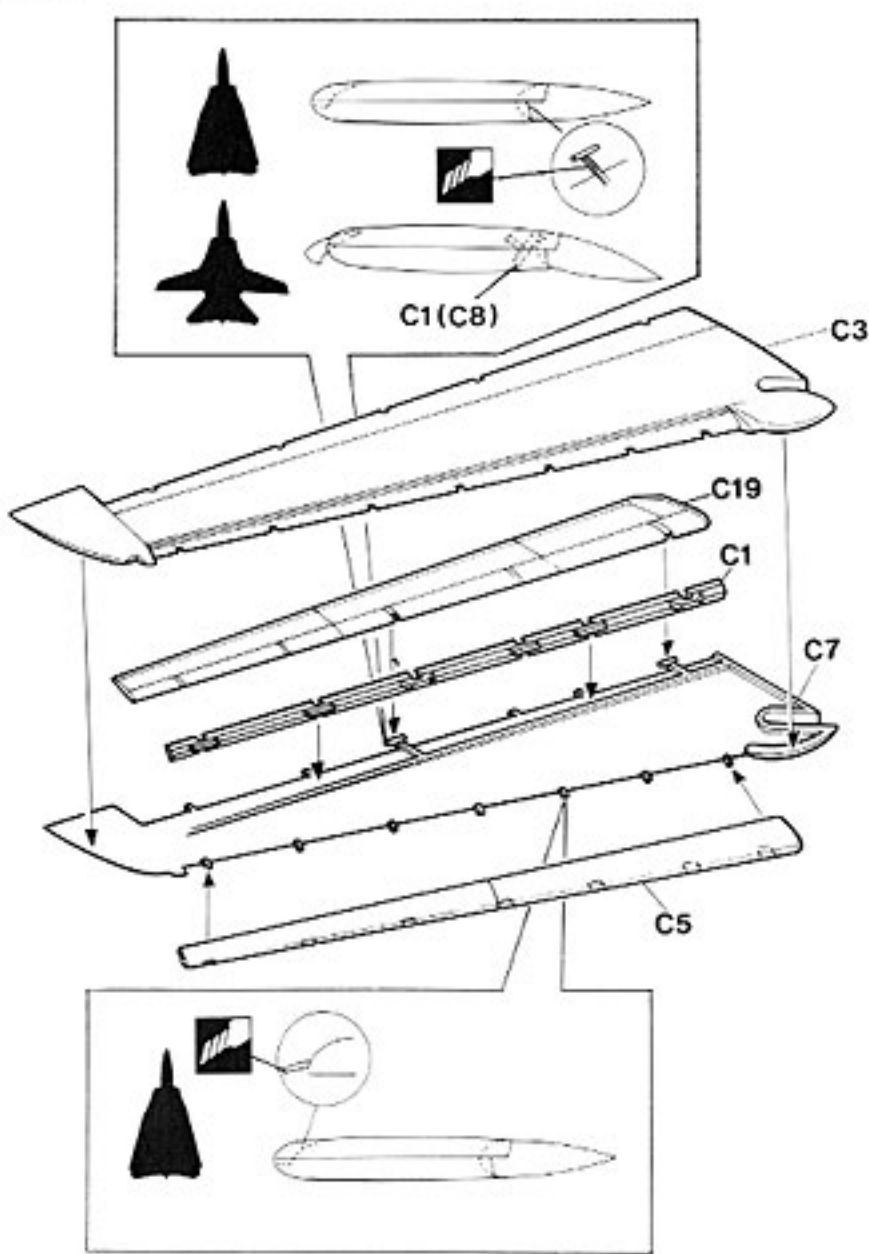

34

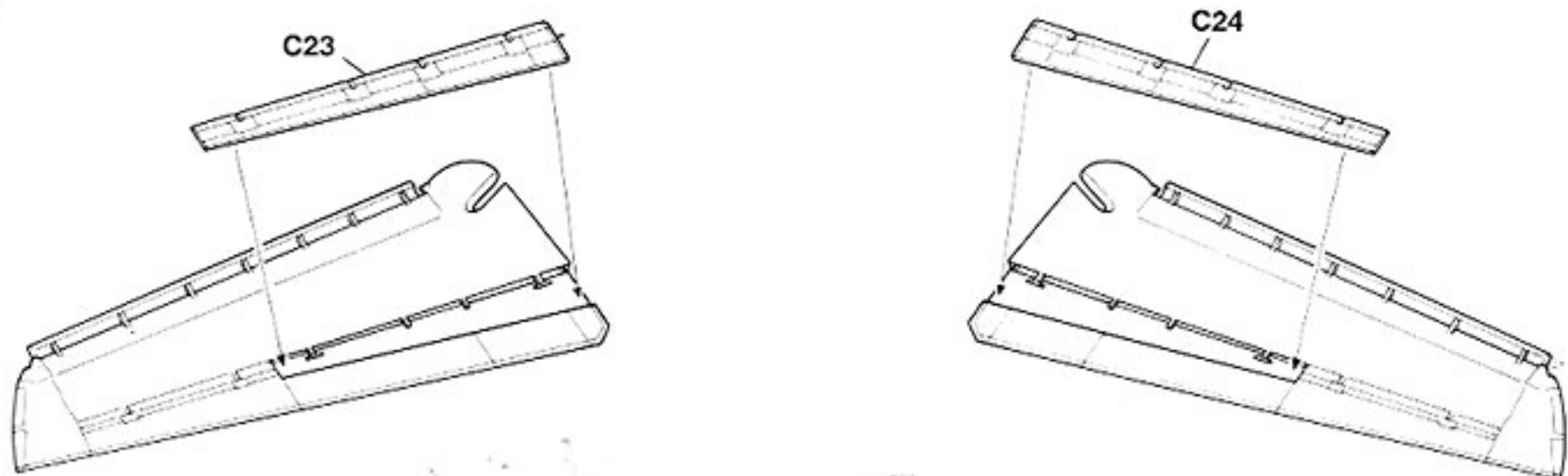

35

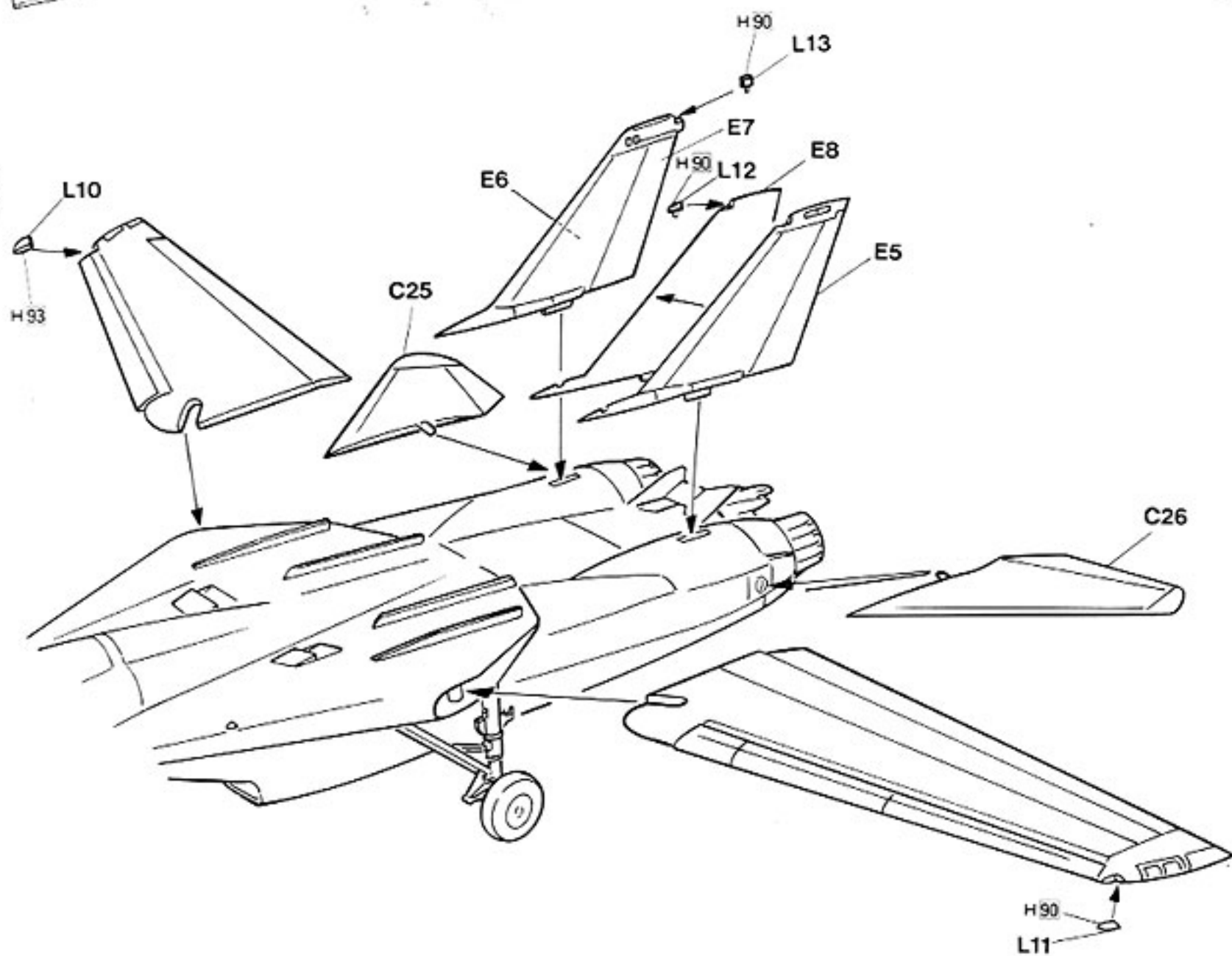

36

x2

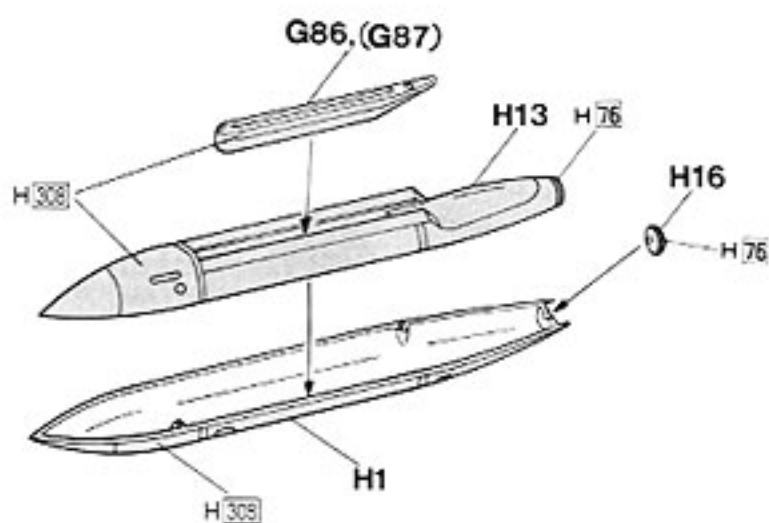

37

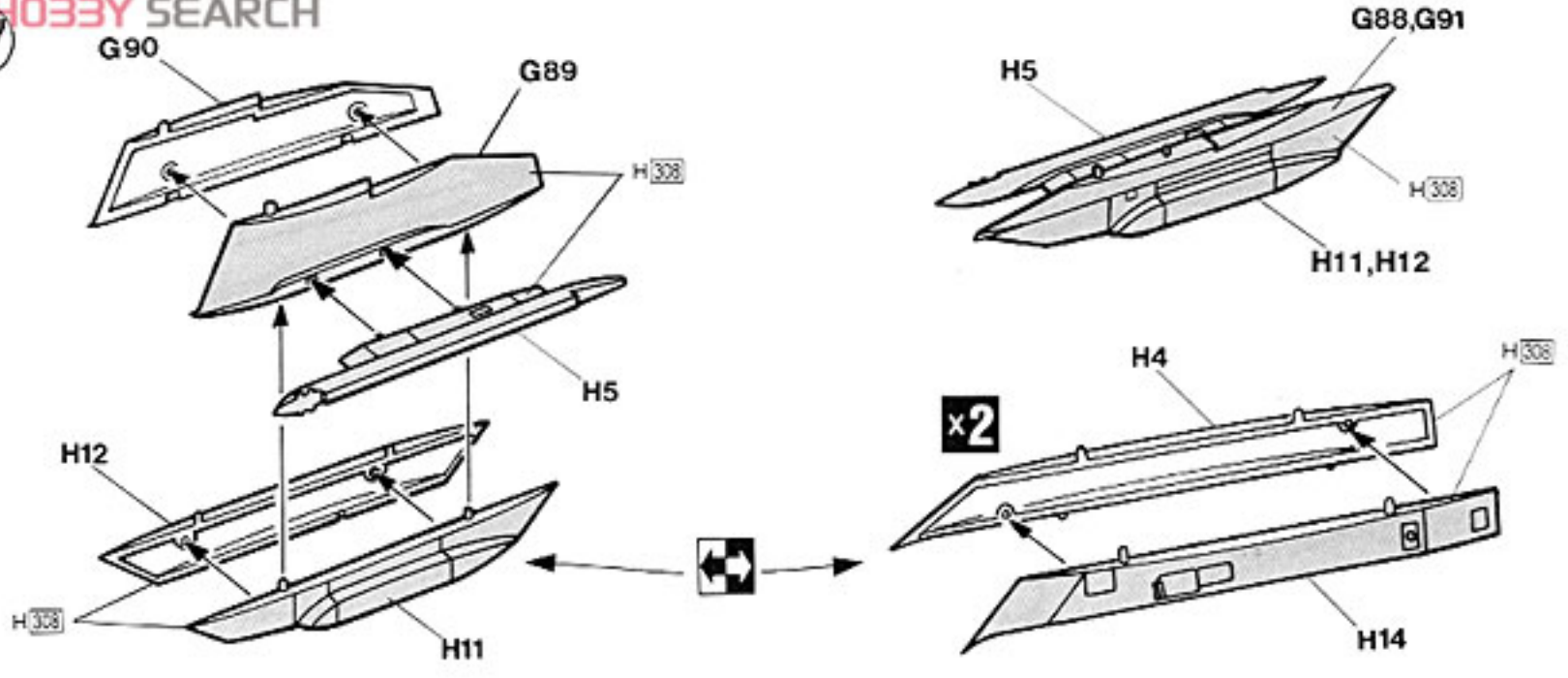

38

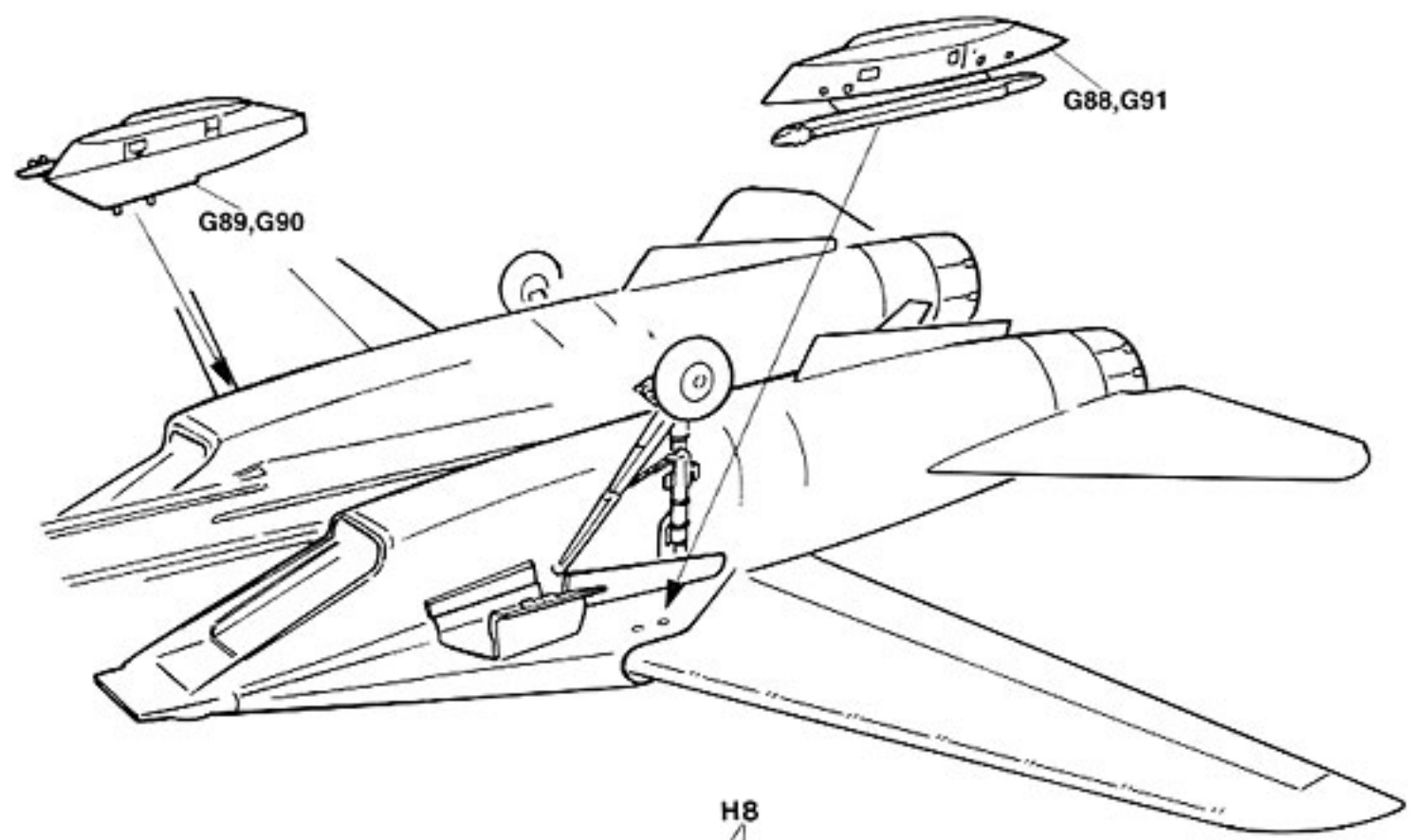

39

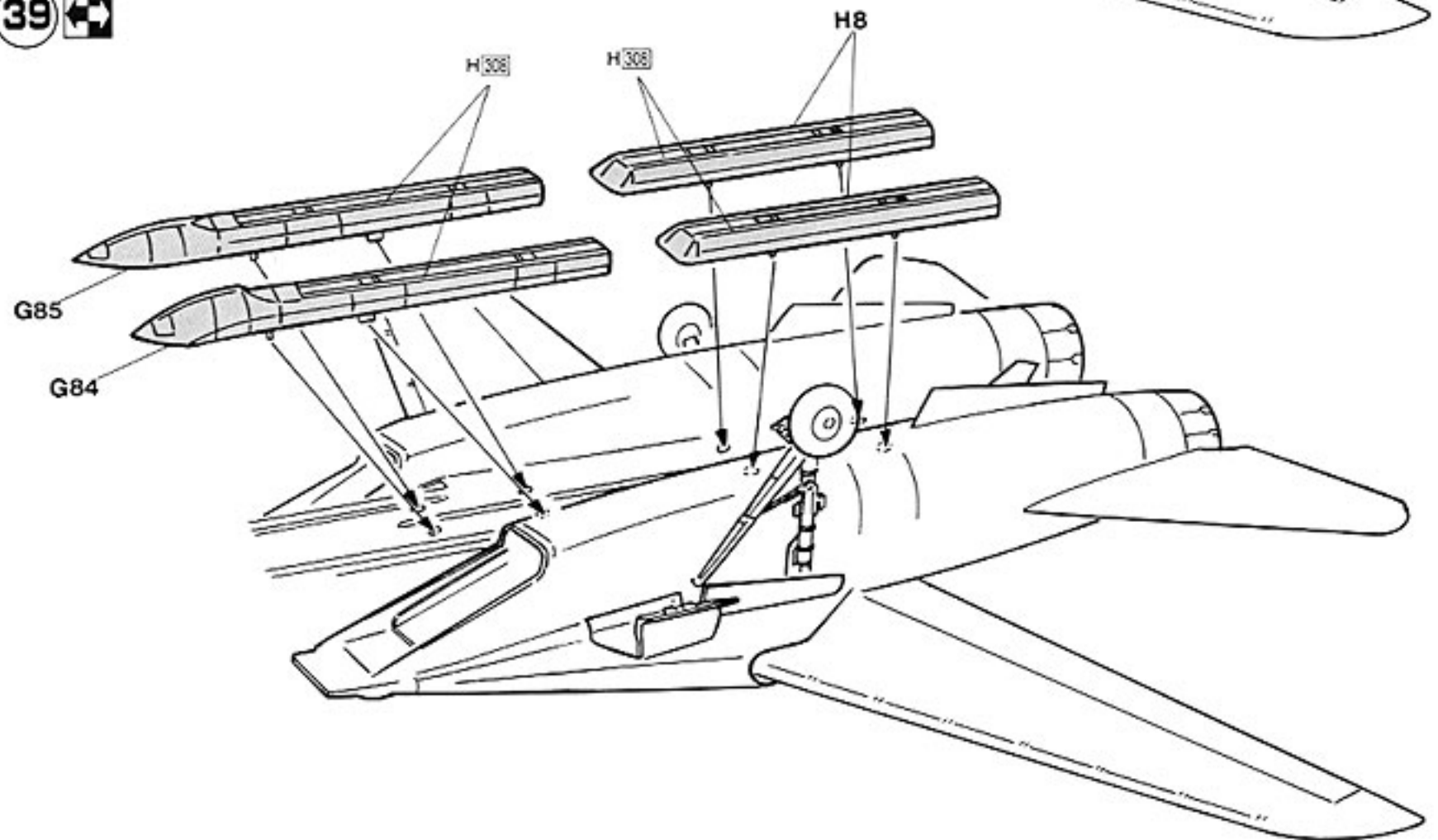

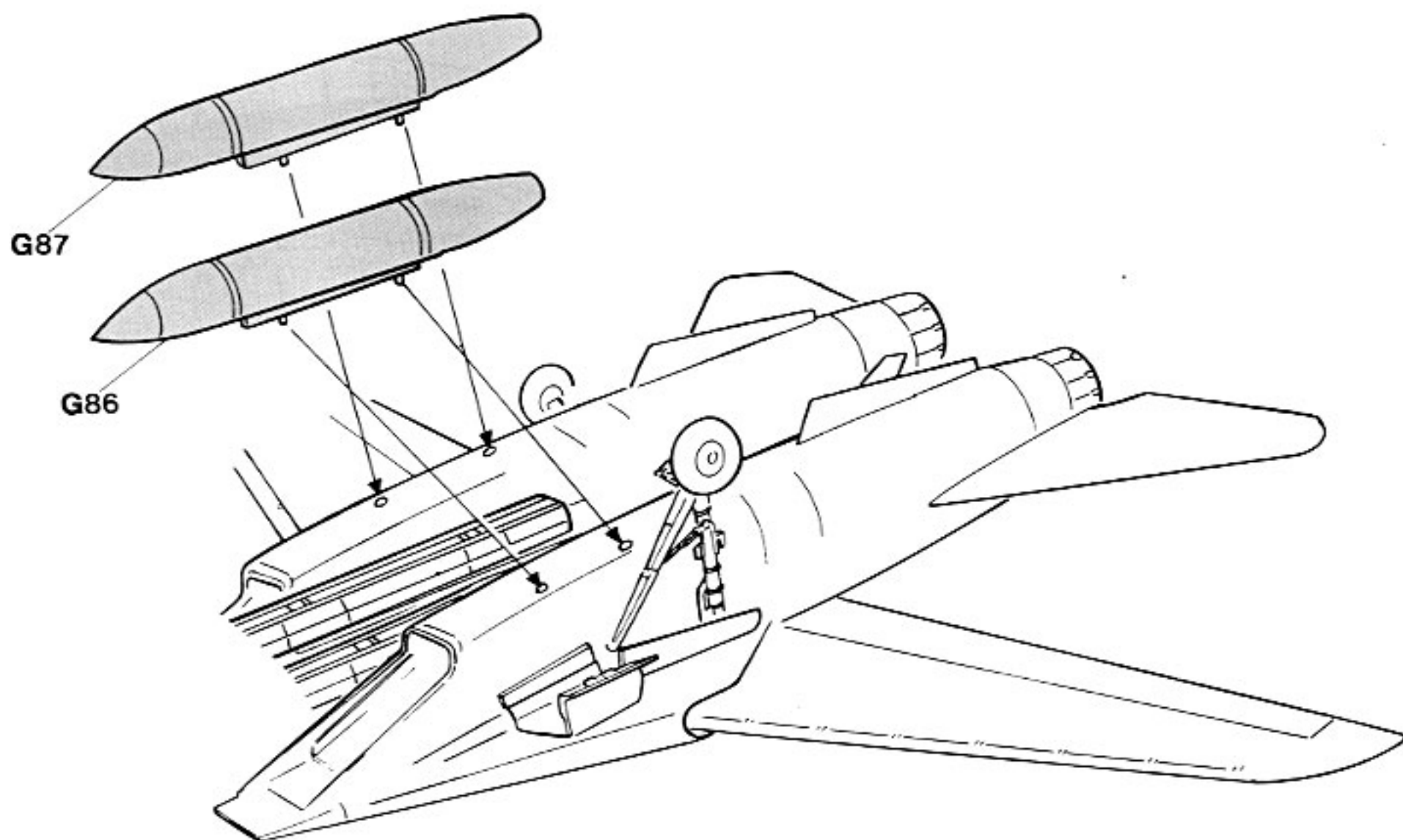
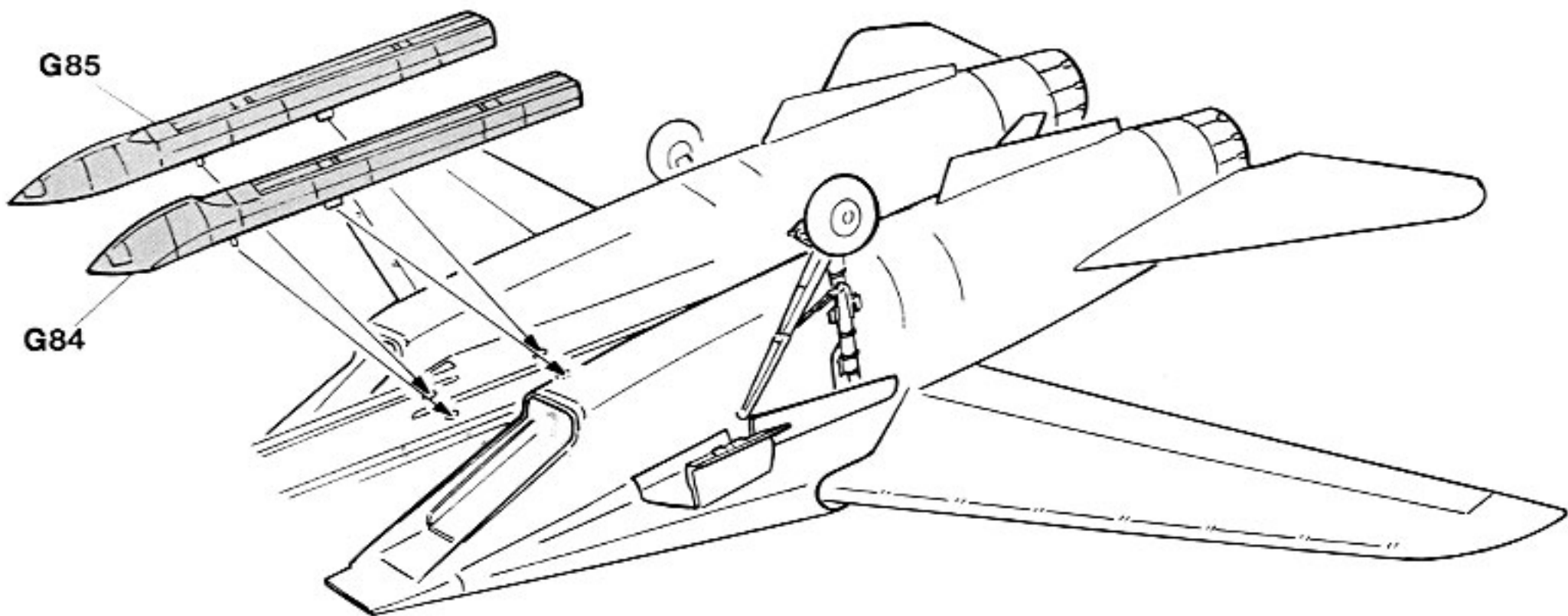

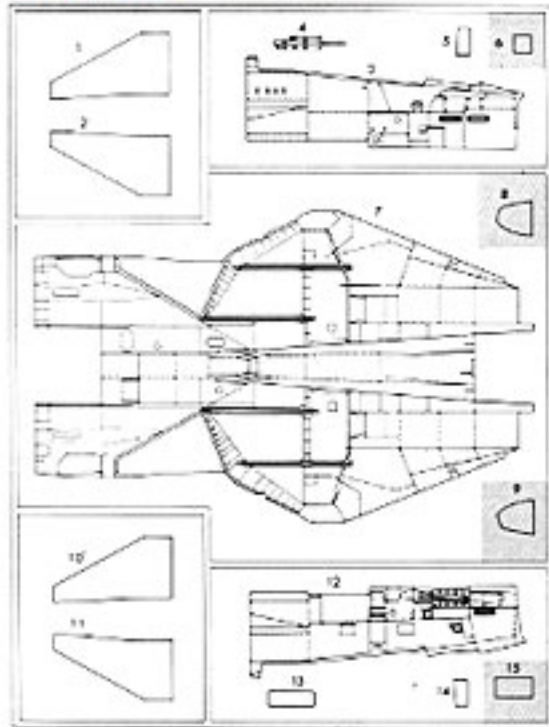

《E》

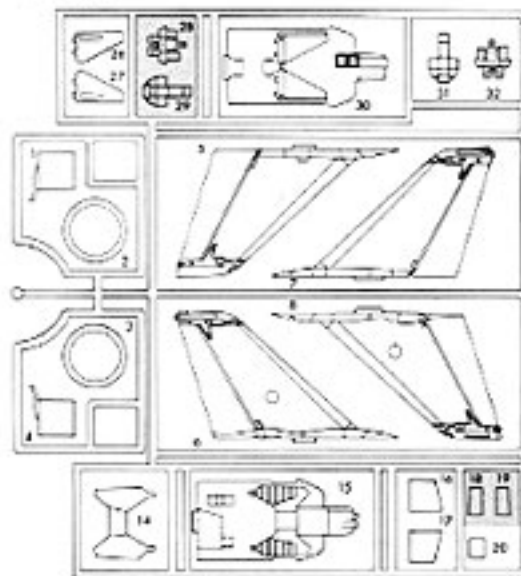

《H》×2

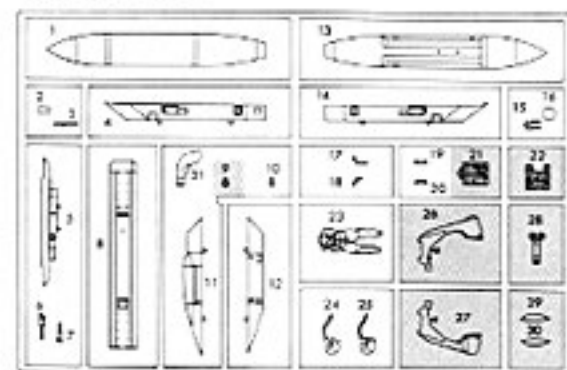

《B》

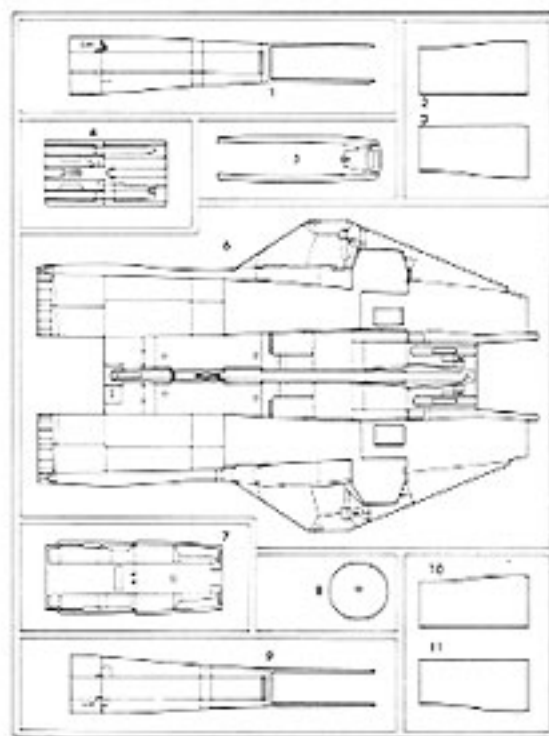

《G》



《K》×2



《M》

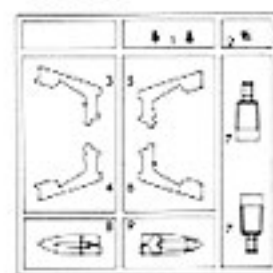

《L》

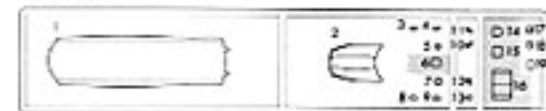

《MA》



《MB》×2



《UA》×2



《C》

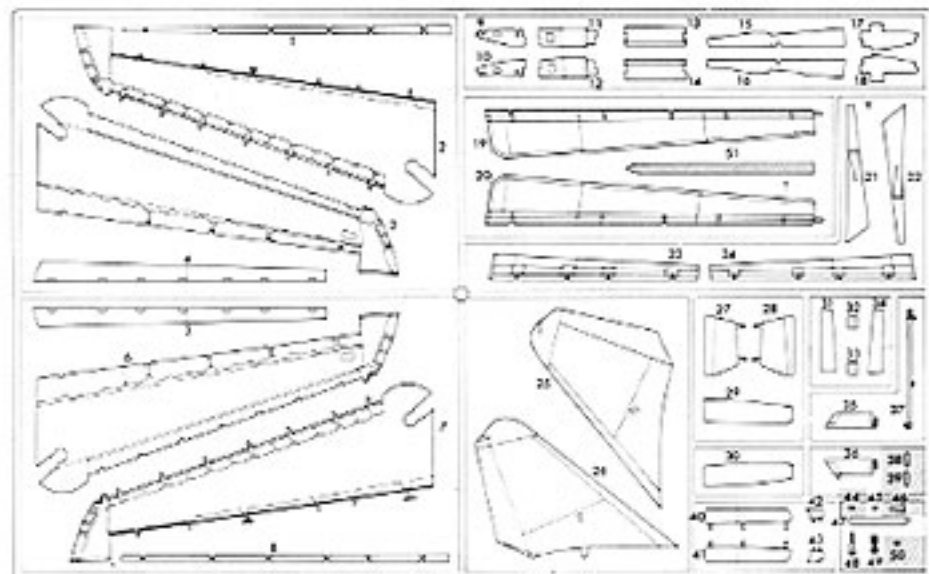

 の部品は使用しません。
 Parts not for use.
 Teile werden nicht verwendet.
 Pièces à ne pas utiliser.

Parti non per uso.
 Partes para não usar.
 不需要使用的零件

マーキング及び塗装図
 Markierungen und Bemalung
 Decoration et Peinture
 Marchio & Pittura
 Decoracion y Pintura
 標貼及著色指示

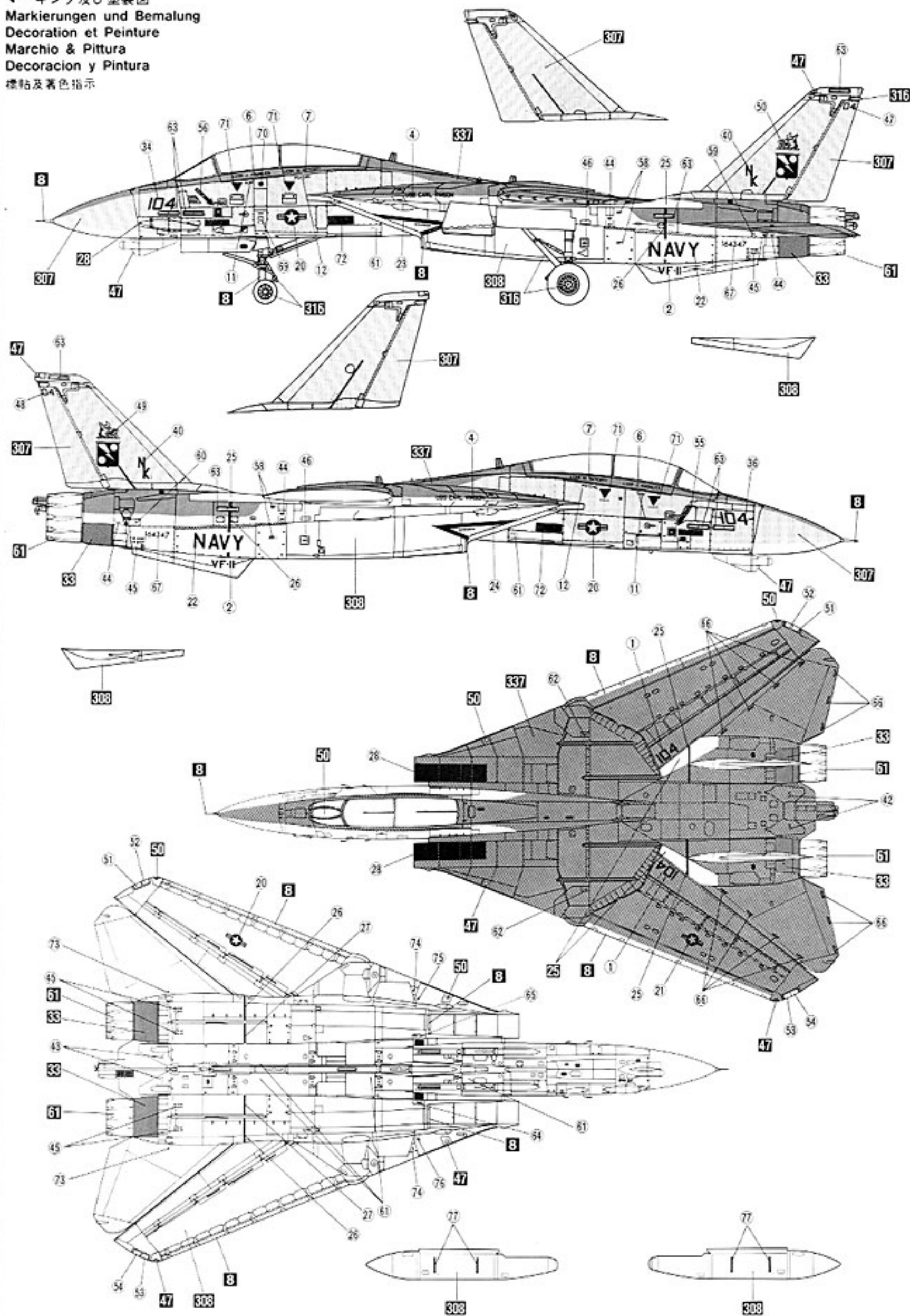

アメリカ海軍 第31戦闘飛行隊 "トムキャッターズ"
"TOMCATTERS" VF-31 U.S.NAVY

- 細部のマーク及び塗装は塗装図1と同じです。
 ■Details are painted and decorated as shown in painting scheme 1.
 ■Einzelheiten der Lackierung und Dekorationen sind in Abbildung 1 dargestellt.
 ■Le schéma de peinture 1 indique les détails des décorations à la peinture.
 ■I dettagli dei colori e delle decorazioni sono come mostrato nello schema di colorazione 1.
 ■Los detalles se han pintado y decorado tal como se muestra en el diagrama de colores 1.
 ■細部の標記と塗装は塗装図1相同的。

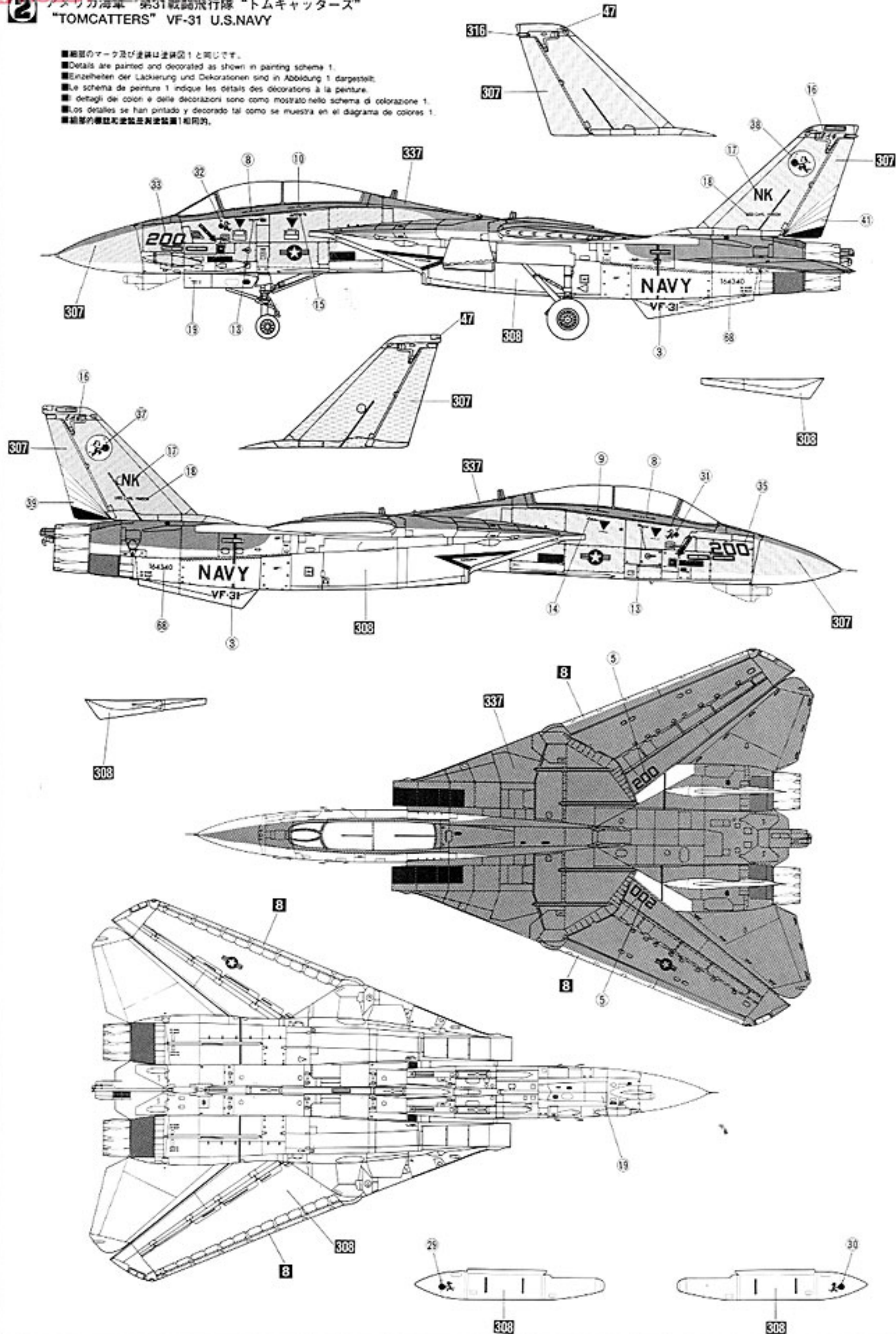

2	2	ブラック	BLACK	SCHWARZ	NOIR	NERO	NEGRO	黒色
H 8	3	シルバー	SILVER	SILBER	ARGENT	ARGENTO	PLATA	銀色
H 12	33	つや消しブラック	FLAT BLACK	MATTSCHWARZ	NOIR MAT	NERO OPACO	NEGRO MATE	啞黒色
H 18	28	黒鉄色	STEEL	STAHL	ACIER	ACCIAIO	ACERO	黒鐵色
H 44	51	はだ色	FLESH	FLEISCHFARBE	CHAIR	COLOR CARNE	CARNE	肌肉色
H 52	12	オリーブドラブ (1)	OLIVE DRAB (1)	OLIVE DRAB (1)	OLIVE DRAB (1)	OLIVA SBIADITO	OLIVA OSCURO	橄欖綠色
H 75	25	ダークシーグレー	DARK SEA GRAY	SEEGRAU, DUNKEL	GRIS MER FONCÉ	GRIGIO MARE SCURO	GRIS MAR OSCURO	深海灰色
H 76	61	焼鉄色	BURNT IRON	GEBER, EISEN	FER BRULE	FERRO BRUCIATO	HIERRO BRUÑIDO	燒鐵色
H 77		タイヤブラック	TIRE BLACK	REIFENSCHWARZ	NOIR DE PNEU	NERO PNEUMATICO	NEGRO NEUMATICO	胎黒色
H 81	55	カーキ	KHAKI	KHAKI	KHAKI	KAKI	KAKI	砵磯色
H 90	47	クリアーレッド	CLEAR RED	ROT, REIN	ROUGE CLAIR	ROSSO CHIARO	ROJO CLARO	透明紅色
H 93	50	クリアーブルー	CLEAR BLUE	BLAU, REIN	BLEU CLAIR	BLU CHIARO	AZUL CLARO	透明藍色
H 94		クリアーグリーン	CLEAR GREEN	GRÜN, REIN	VERT CLAIR	VERDE CHIARO	VERDE CLARO	透明綠色
H 305	305	グレー FS36118	DARK GRAY	DUNKEL GRAU	GRIS FONCÉ	GRIGIO SCURO	GRIS OSCURO	深灰色
H 307	307	グレー FS36320	GRAY	GRAU	GRIS	GRIGIO	GRIS	灰色
H 308	308	グレー FS36375	LIGHT GRAY	HELLGRAU	GRIS CLAIR	GRIGIO CHIARO	GRIS CLARO	淺灰色
H 316	316	ホワイト FS17875	WHITE	WEISS	BLANC	BIANCO	BLANCO	白色
H 317	317	グレー FS36231	GRAY	GRAU	GRIS	GRIGIO	GRIS	灰色
H 327	327	レッド FS11136	RED	ROT	ROUGE	ROSSO	ROJO	紅色
H 329	329	イエロー FS13538	YELLOW	GELB	JAUNE	GIALLO	AMARILLO	黄色
H 337	337	グレイッシュブルー FS35237	GRAYISH BLUE	GRAUBLAU	BLEU GRIS	GRIGIO AZZURRO	AZUL GRIS	灰藍色

The Hobby Search is the workhorse of the United States Navy's fighter aircraft inventory. Mounting an AWG-9 weapons control system, it can lock onto and track as many as 24 targets up to about 166 kilometers away, and fire an AIM-54 Phoenix missile (with a maximum range of 185 kilometers) at any six of them individually. The AWG-9 is also capable of simultaneous, multiple targeting during air-to-air combat when tracking is impossible. Another feature characteristic is the utilization of variable geometry wings. The Mach sweep program computer on board the aircraft maintains the variable sweep angle of the main wings at the optimum lift drag ratio at all times. While being stored or serviced on the deck of the aircraft carrier,

the wings may be swept back to a full 75 degrees to facilitate space-saving on a narrow deck. Model D is the latest one, and improvement in performances has been made with the engine replaced by that of General Electric F-110-GE-400 and the weapons control system by APG-71.

« Data » Crew:2 Wing span:19.54m Length:18.9m Height:4.88m

Powerplant:GE/F-110-GE-400 Fixed armament:M61A1 20mm vulcan cannon

First flight: December 8, 1987