

upper wing bottom

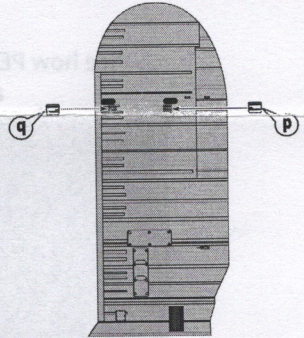

lower wing top

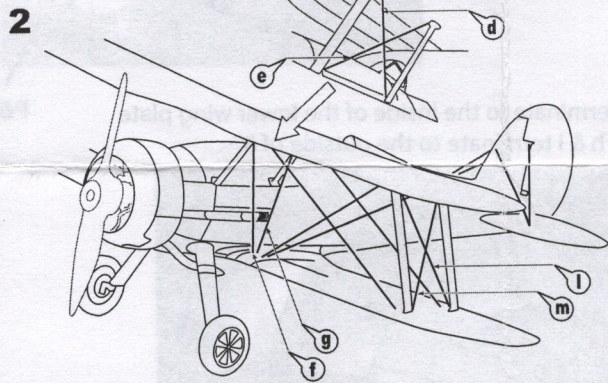
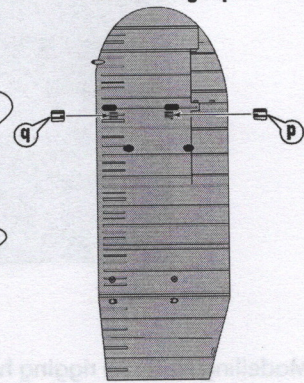
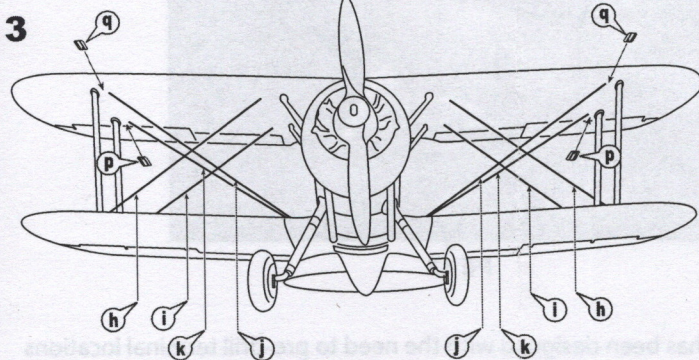
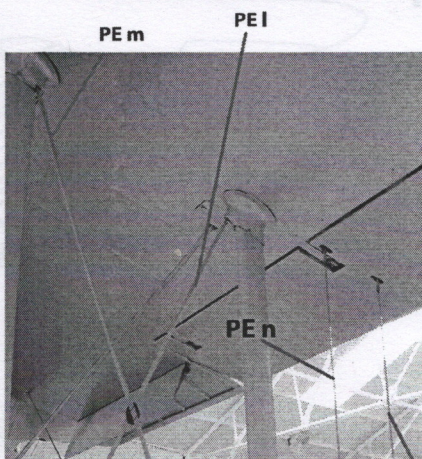

Photo Help

Note how the tops of PE a & b are angled flat to the surface of the fin - bend the section of half-etch accordingly



Note that on the outer-plane struts the rigging terminates at the end of the strut 'boot' not the base of it



See how PE g & f terminate to the inside of the lower wing plate and PE h & i terminate to the outside of it.

PE o

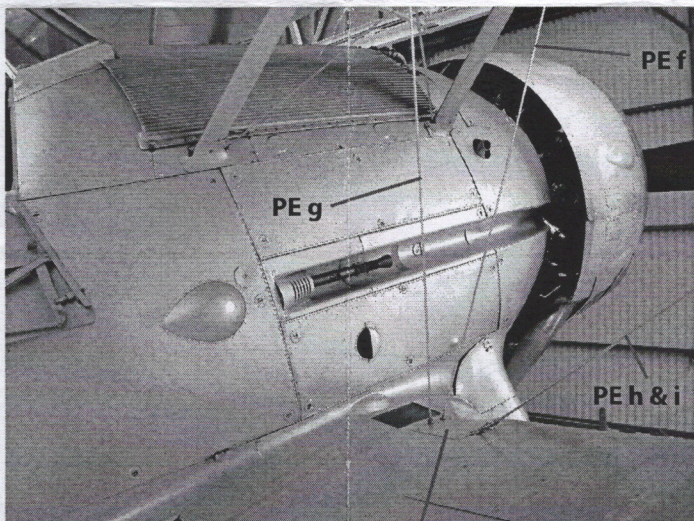

PE 13

Modelling Note: All rigging has been designed with the need to pre-drill terminal locations in order to anchor PE as well as give as much adjustment as possible