

ALBATROS W4 1/48

No. 016/0109

© GAVIA

Palackého 1128, 769 01 Holešov
Czech Republic

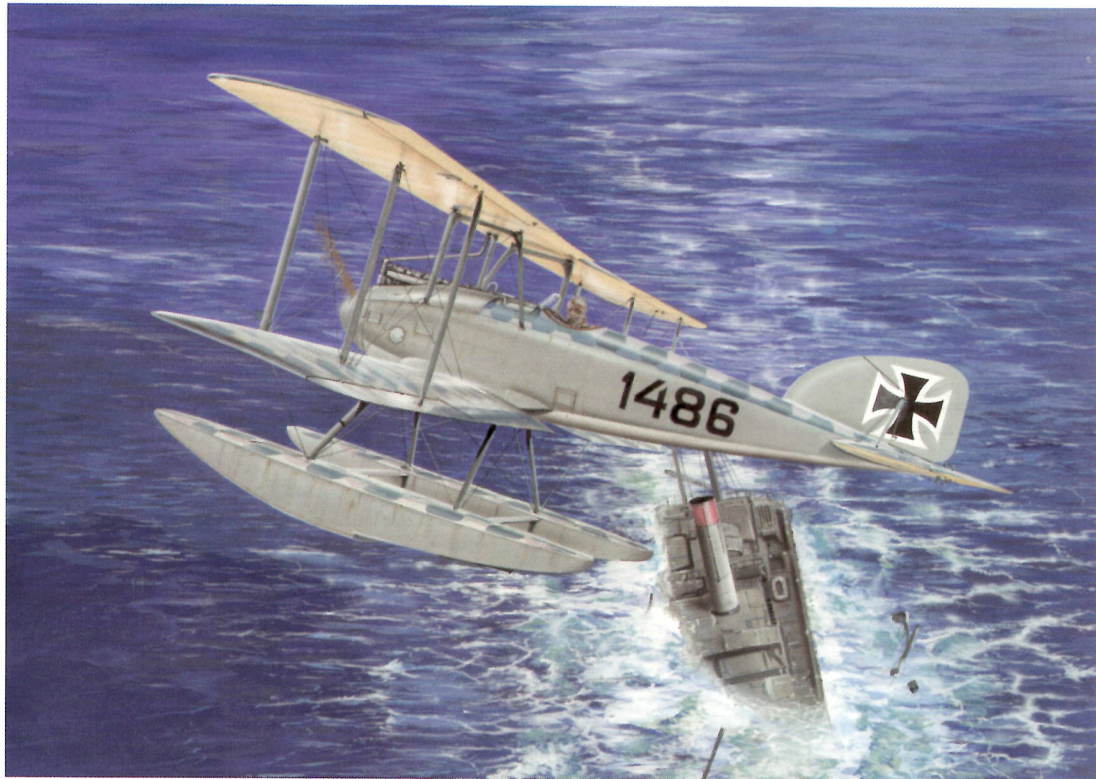

Albatros W 4

V červnu 1916 byl námořnictvem objednan jednomístný plovákový stíhací dvouplášník. Stroj se při zkouškách osvědčil a celkem bylo vyrobeno 118 letadel. Pozdější výrobní série měly chladič umístěn na horním křídle a křídélka na obou nosných plochách.

Německé námořnictvo tyto stroje převážně používalo v operačním prostoru Severního a Baltského moře a také k výcviku. Několik Albatrosů bylo předáno Rakousko Uherské armádě, bojově však nasazeny nebyly.

Technické údaje:

Posádka: 1 pilot
Rozpětí: 9,5 m
Výška: 3,65 m
Plocha křídel: 31,0 m²
Prázdná hmotnost: 709 - 790 kg
Vzletová hmotnost : 989 - 1070 kg
Pohonná jednotka: Mercedes D.III 160 k (119 kW)

Výkony:

Maximální rychlost: 155 - 160 km/h
Dostup: 3000 m
Stoupavost: 1000 m / 5,5 min

Výzbroj:

2x synchronizovaný kulomet LMG 08/15 (Spandau)
ráže 7,92 mm



Albatros W 4

There was ordered single-seater float-undercarriage biplane fighter by the navy in June 1916. The machine proved good while was tested and there were produced together 118 fighters. Later production series placed the cooler on the upper plane wing and the ailerons upon the both bearings. German navy mainly used the machines in operating space of German Ocean and the Baltic Sea and also to the flying training. Some Albatroses were passed to the Austro-Hungarian army, but they were never settled in the battle.

General characteristics:

Crew: one pilot
Length: 8.50 m
Wingspan: 9.50 m
Height: 3.65 m
Total area: 31.0 m²
Empty weight: 709 - 790 kg
Gross weight: 989 - 1070 kg

Performance:

Maximum speed: 155 - 160 km/h
Service ceiling: 3 000 m (9 840 ft)

Armament:

2 × forward-firing 7.92 mm LMG 08/15 machine guns

Engine:

1 × Mercedes D.III 160 hp (119 kW)

UPOZORNĚNÍ

ATTENTION



Před započítím stavby si pečlivě prostudujte stavební návod. Při používání barev a lepidel pracujte v dobře větrané místnosti. Lepidla ani barvy nepoužívejte v blízkosti otevřeného ohně. Model není určen malým dětem, mohlo by dojít k požití drobných dílů.



Carefully read instruction sheet before assembling. When you use glue or paint, do not use near open flame and use in well ventilated room. Keep out off reach of small children. Children must not be allowed to stuck any part or pull vinyl bag over the head.

INSTRUKČNÍ SYMBOLY

INSTRUCTIONS SIGNS



SESTAVA
GROUP



KYANOAKRYLÁTOVÉ
LEPIDLO
CYANOACRYLATE
PASTE



VRTAT
DRILL



ODŘÍZNOUT
REMOVE



BARVA
COLOUR



VOLBA
OPTIONAL

D

OBTISK
DECAL



KOVOVÉ DÍLY
PHOTO ETCHED
PARTS



RESINOVÉ DÍLY
RESIN PARTS



FOLIE
FOLIO

BARVY

COLOURS

KÓD CODE	BARVA / COLOUR	TAMIYA	HUMBROL	REVELL	TESTORS	GUNZE
A	LIGHT BLUE / HELLBLAU / CLAIR BLANC / SVĚTLE MODRÁ	XF 23	65	55	1741	H 67
B	DARK GREY / DUNKELGRAU / GRIS ANTH / TMAVĚ ŠEDÁ.	XF 54	106	75	1740	H 333
C	BROWN / BRAUN / BRUN / HNĚDÁ	XF 64	26	380	1533	H 47
D	LEATHER / LINNEN / TOILE / PLÁTNO	XF 55	94	314	1702+1768	H 313
E	RUST / ROST / ROUILLE / REZ	XF 52	29	83	1785	H 344
F	ALUMINIUM / ALUMINIUM / ALUMINIUM / HLINÍK	XF 16	56	99	1781	MC 218
G	GUN METAL / STAHLBLAU / GRIS METAL / DÉLOVINA	XF 56	53	91	1795	H 28
H	BLACK / SCHWARZ / NOIR / ČERNÁ	XF 1	33	8	1749	H 12
I	WHITE / WEIß / BLANC / BÍLÁ	XF 2	34	4	1596	H 11
J	GRAY / GRAU / GRIS / ŠEDÁ	RLM 02	141		1726	H 70
L	WOOD BROWN / HOLZ / BOIS / DŘEVO	XF 59	72	382	1735	H -37
M	LIGHT GRAY / HELLGRAU / GRIS CLAIR / SVĚTLE ŠEDÁ	XF 66	62	85	1736	H 338

PLASTIKOVÉ DÍLY A
PLASTIC PARTS A

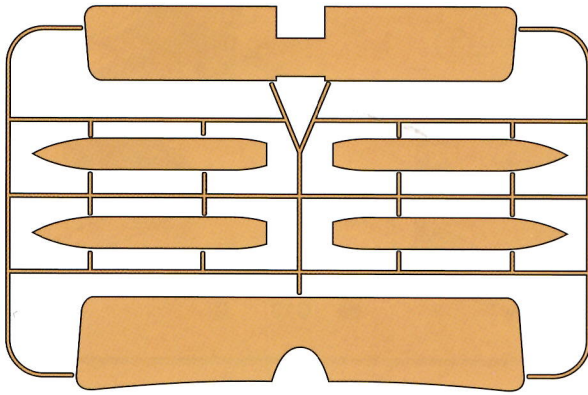

PLASTIKOVÉ DÍLY B
PLASTIC PARTS B

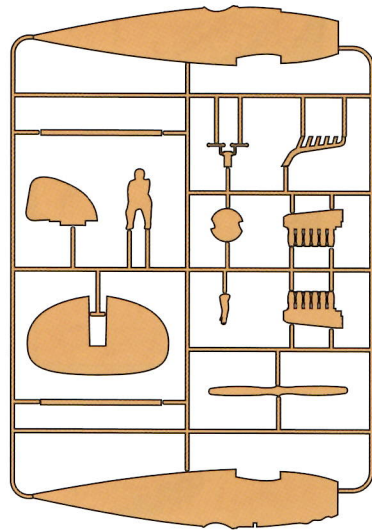

PLASTIKOVÉ DÍLY C
PLASTIC PARTS C

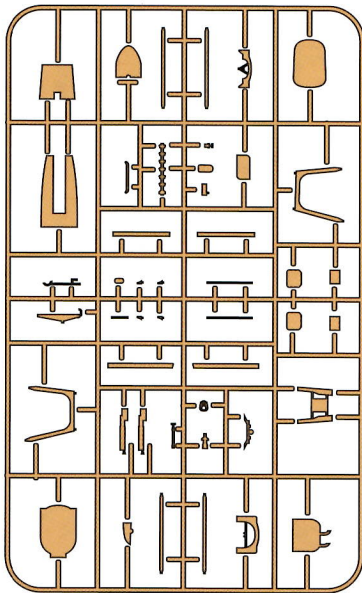

RESINOVÉ DÍLY
RESIN PARTS R

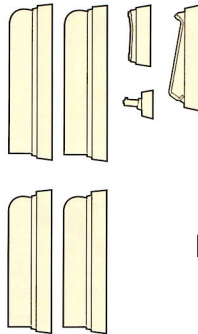

FOLIE
FOLIO



KOVOVÉ DÍLY
PHOTO ETCHED PARTS PE

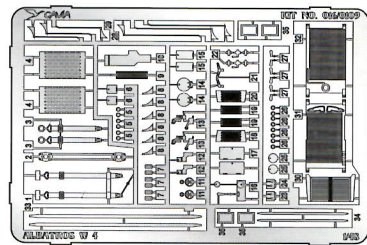

STAVEBNÍ POSTUP

ASSEMBLY INSTRUCTION

1

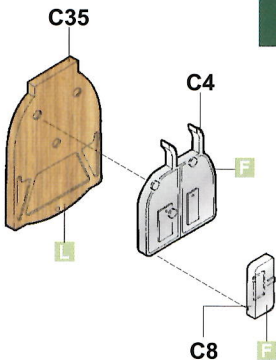

2

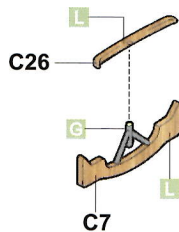

3

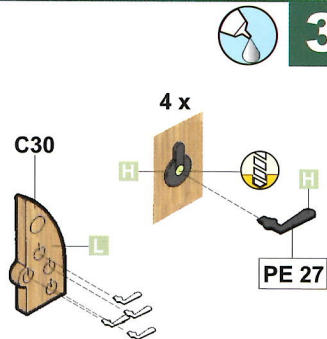

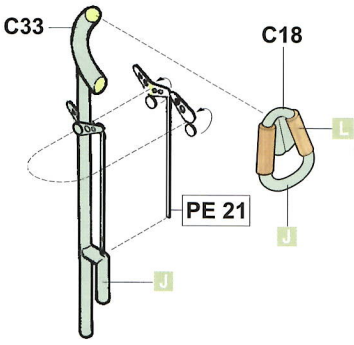
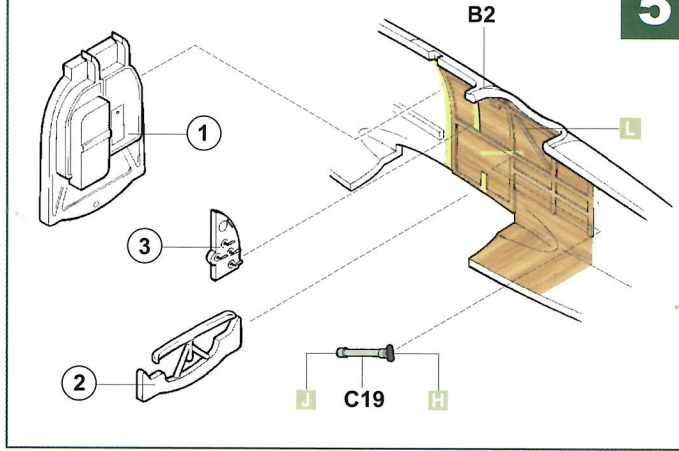
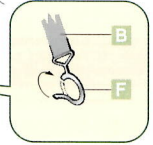
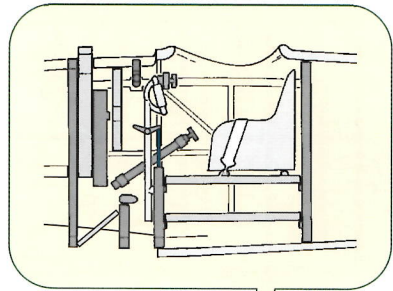
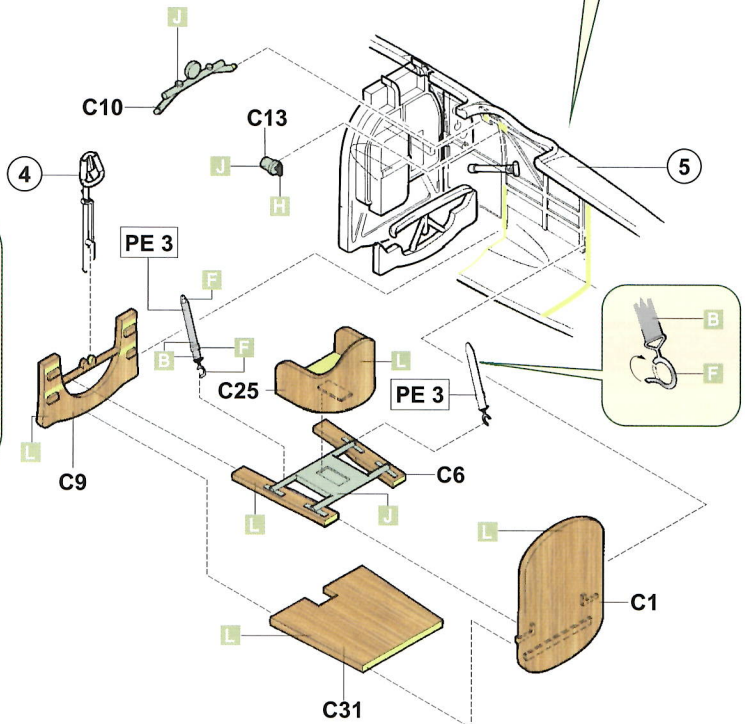
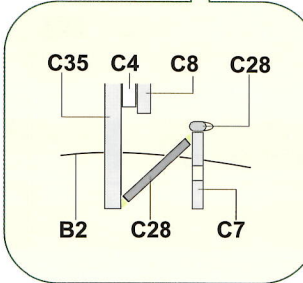
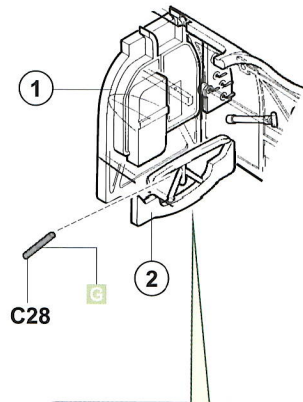
4**5****6**



7

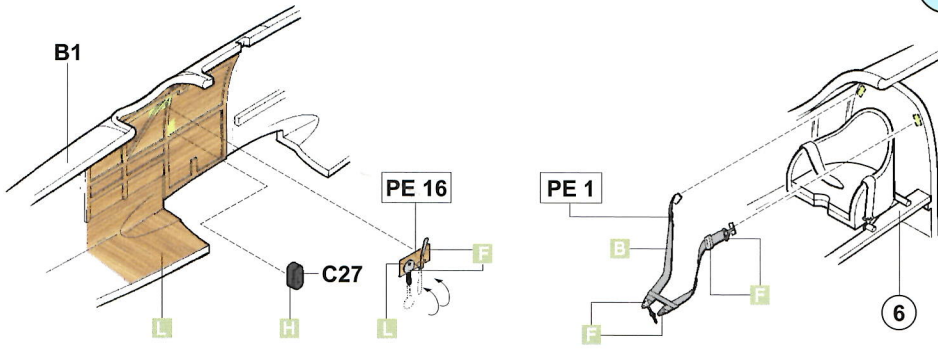

8

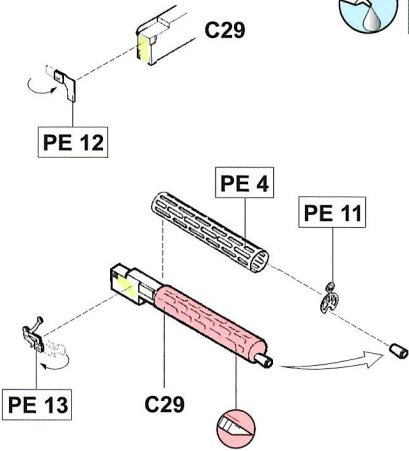

9

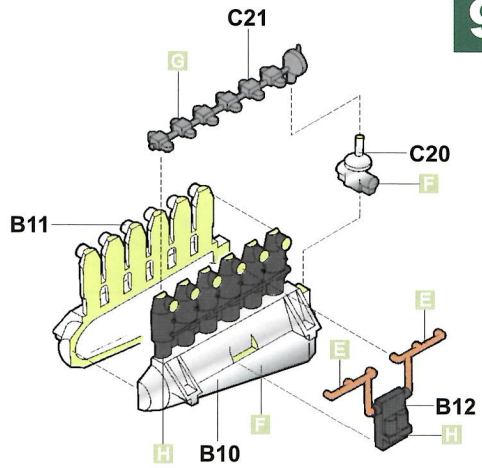

10

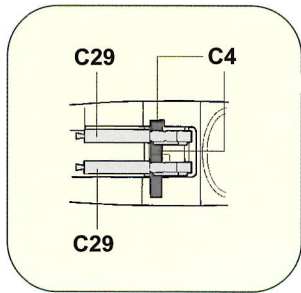

C29 ? 8

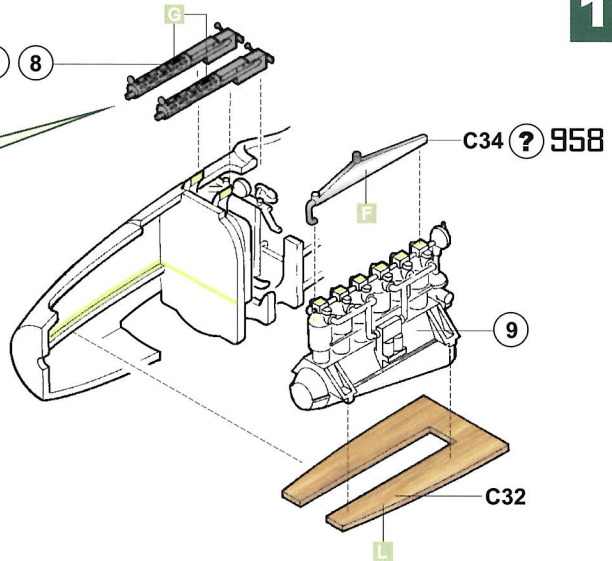

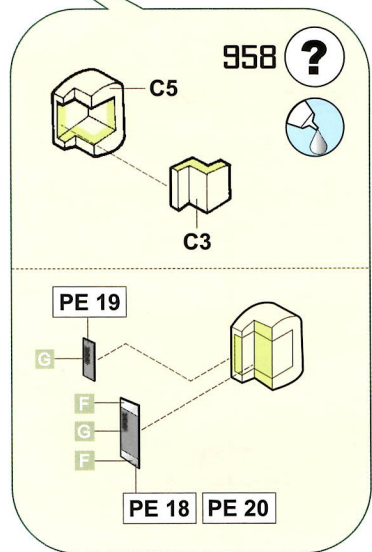
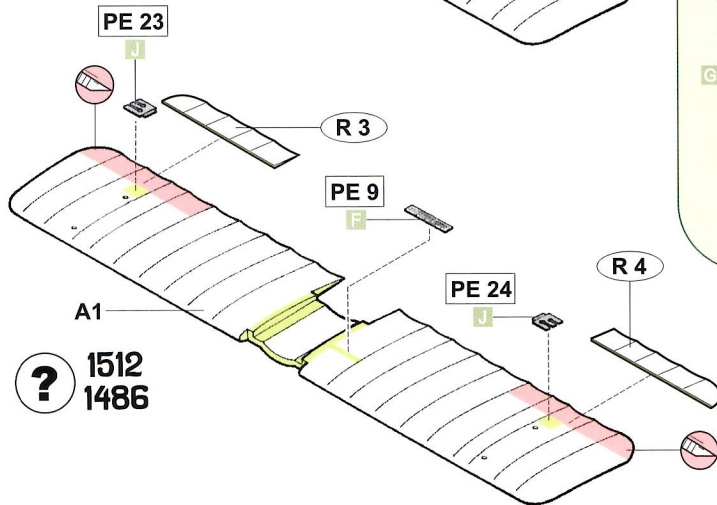
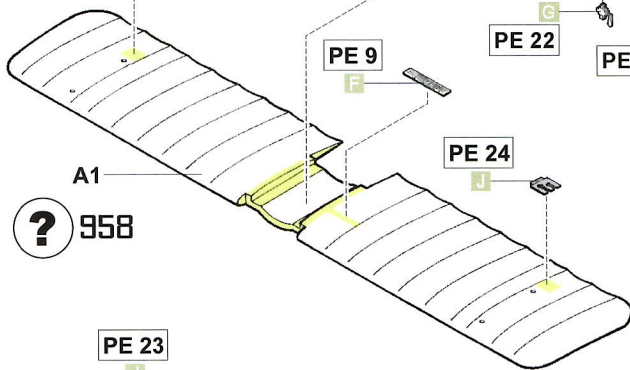
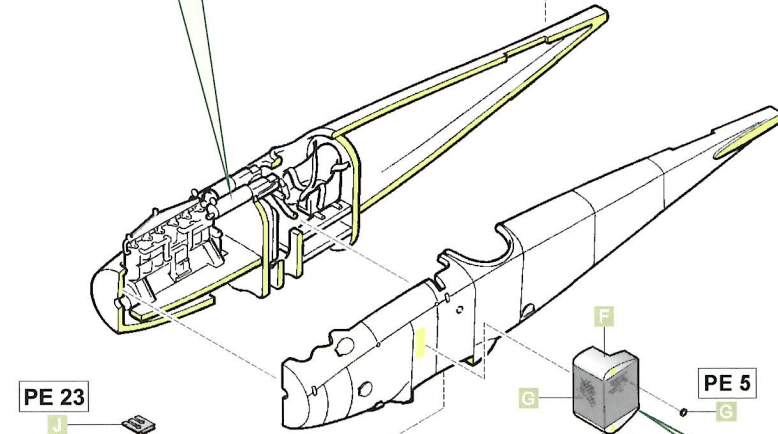
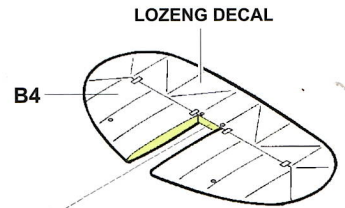
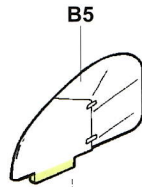
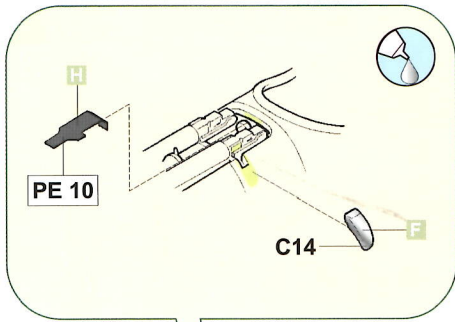

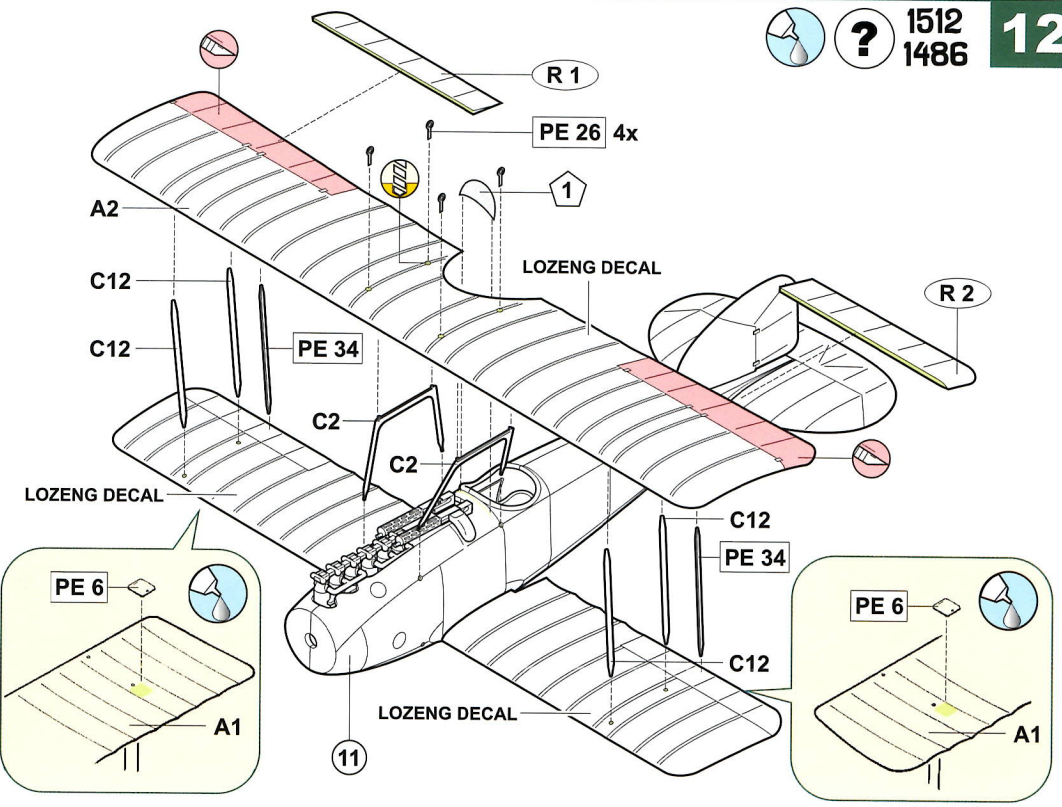
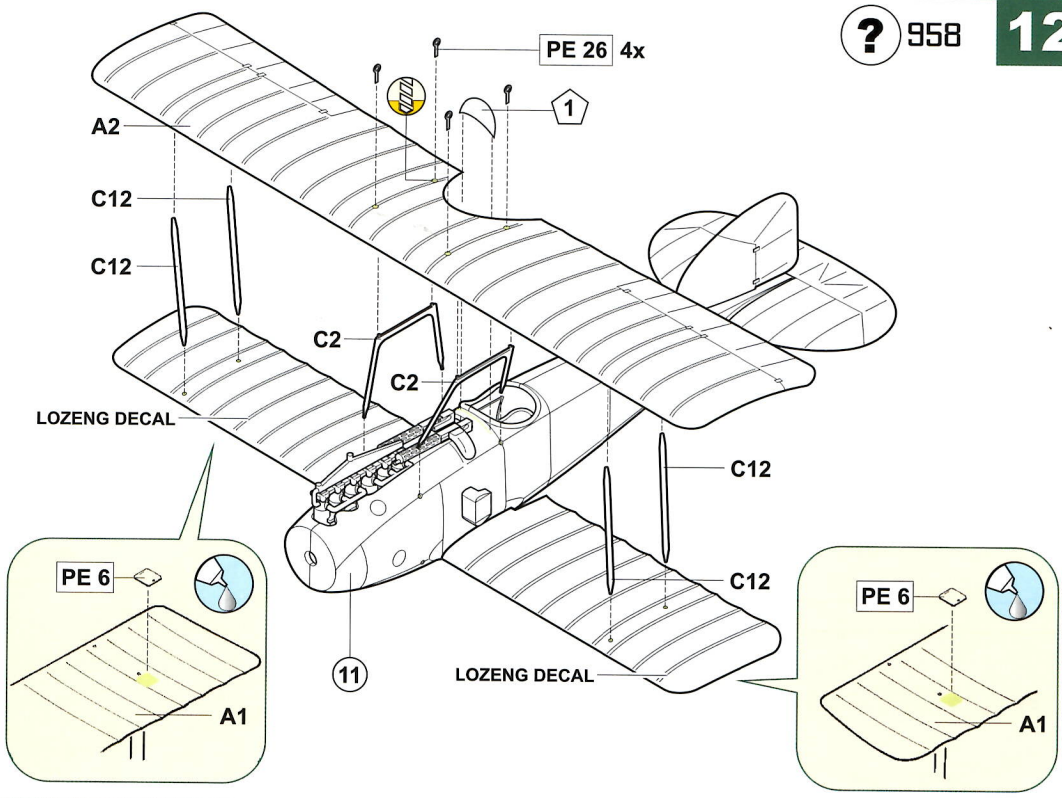

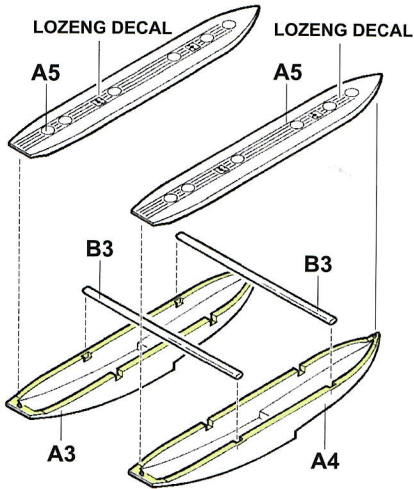
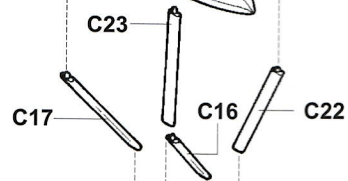
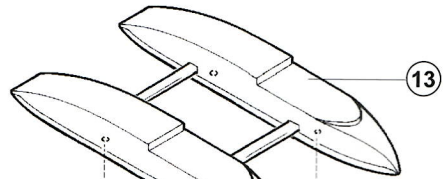
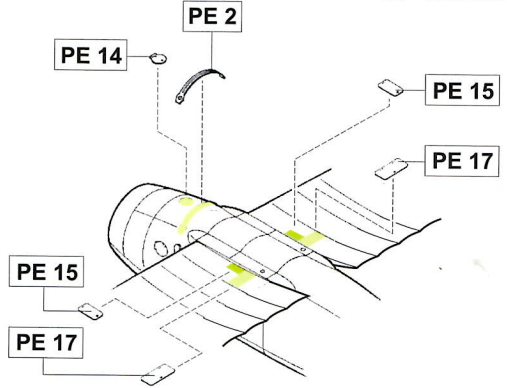
13**14****15**

PE 28 ? PE 8 PE 28 ? PE 8

PE 7

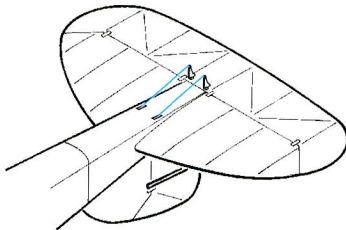
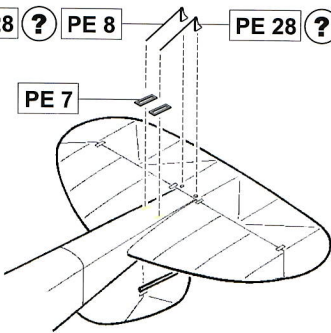

C11 ? PE 34

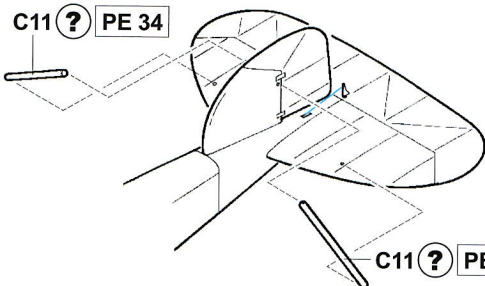

PE 29 ? PE 8

PE 29 ? PE 8

PE 7

PE 25 2x

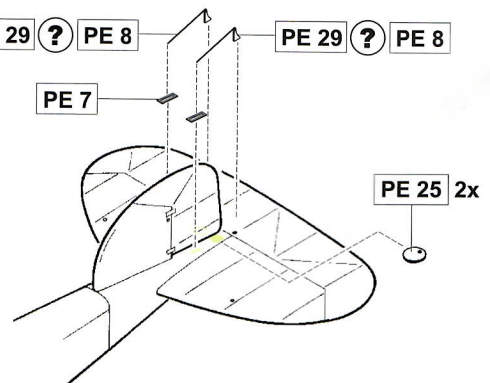

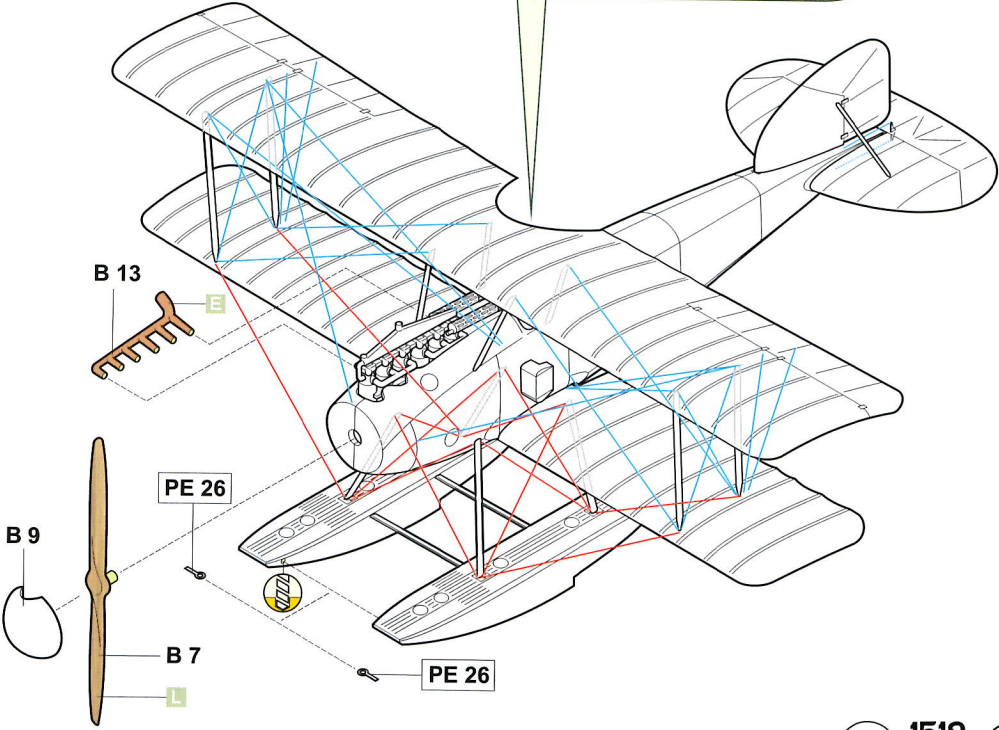
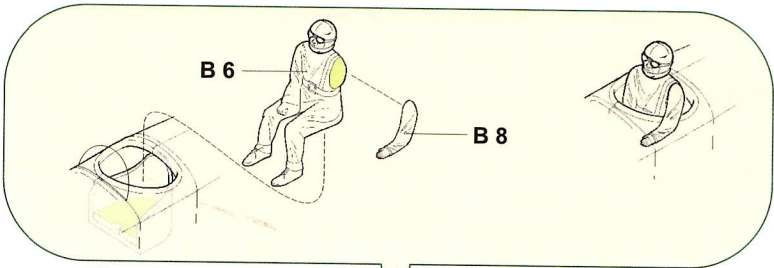

? 1512 1486

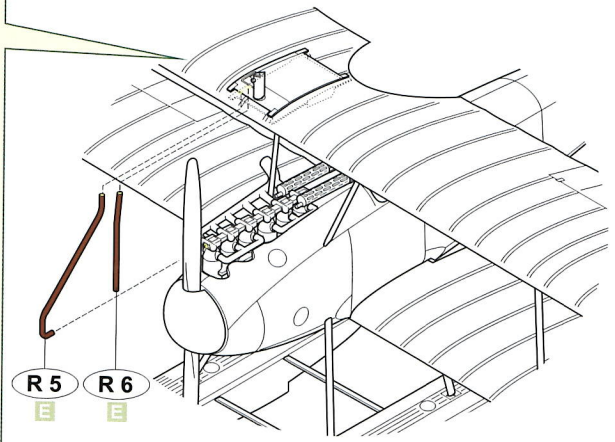
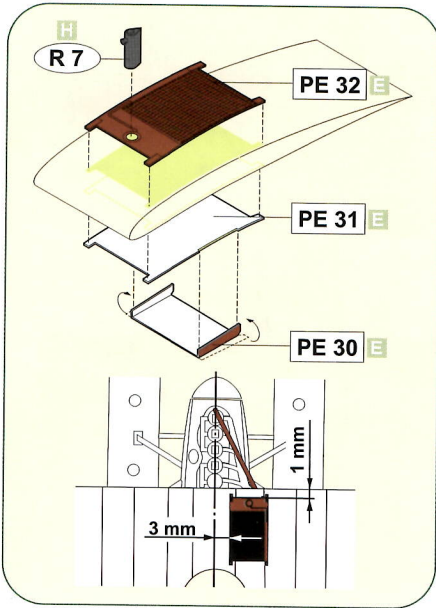

Albatros W4 1512

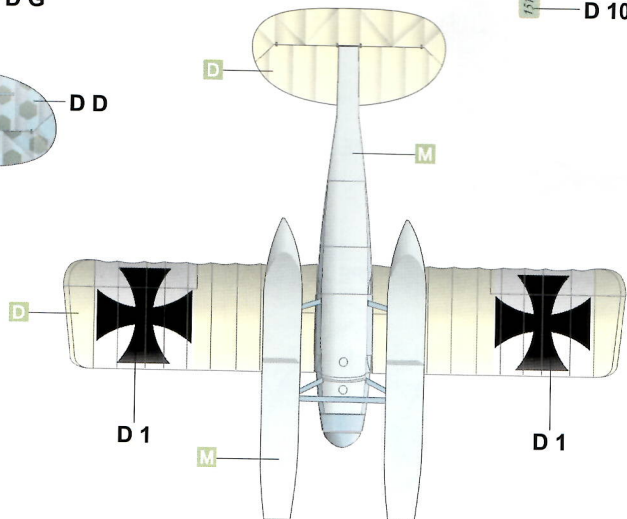
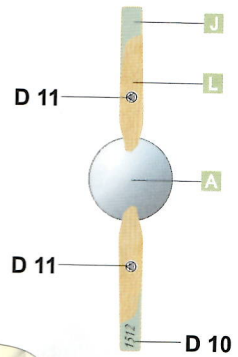
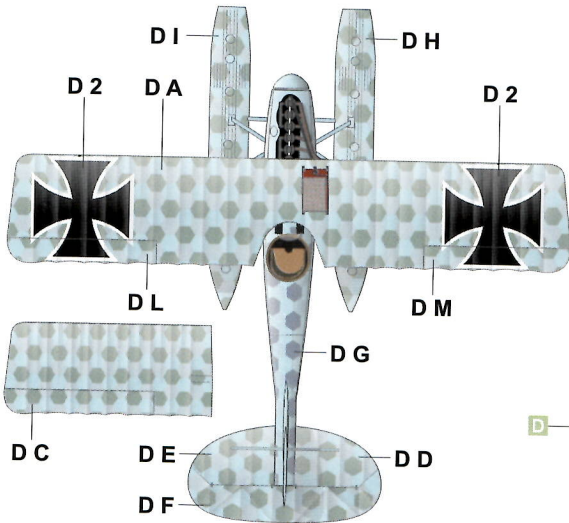
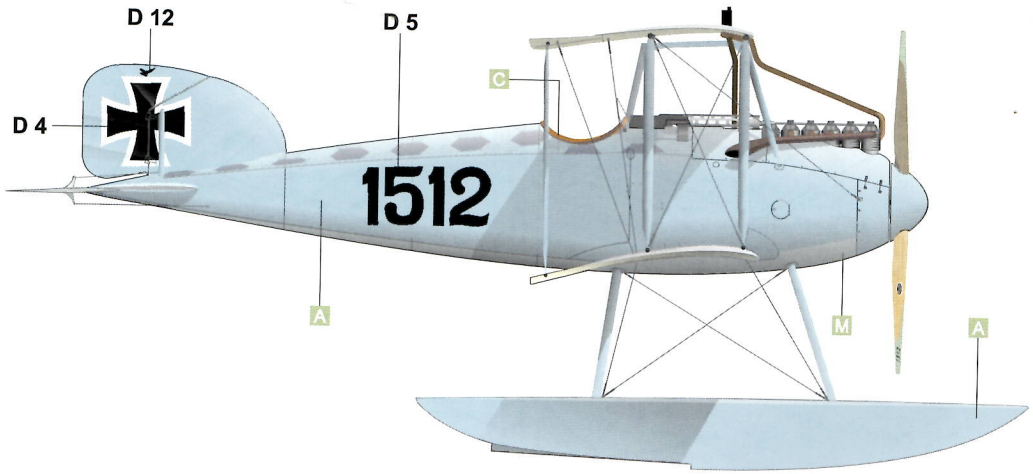

Albatros W4 1486

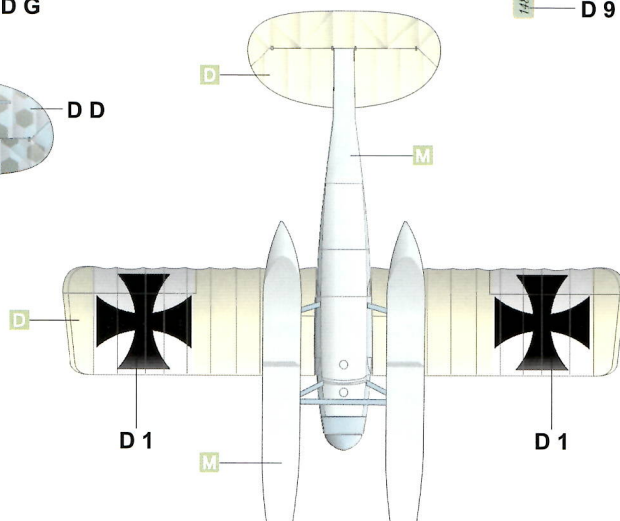
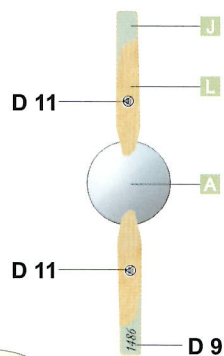
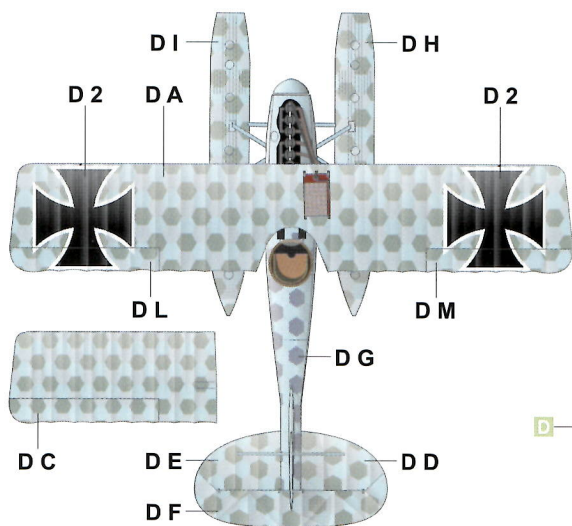
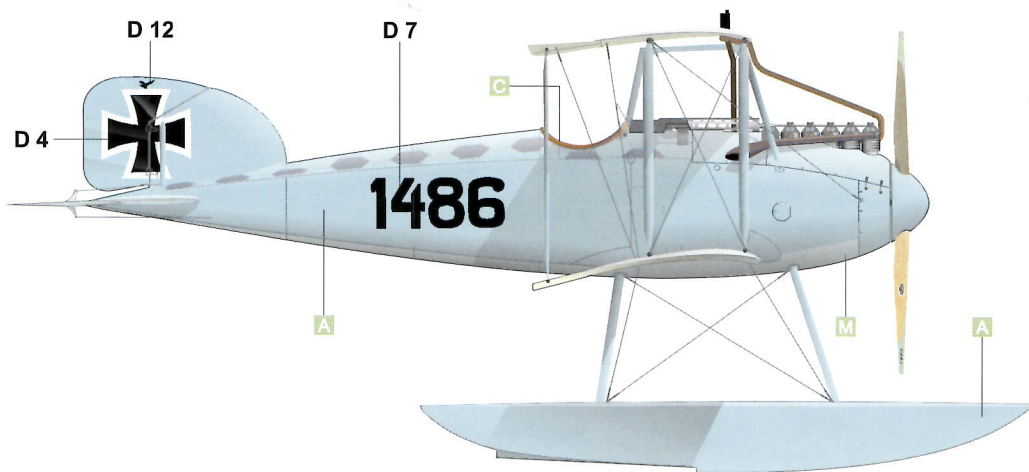

Albatros W4 958

