



PzKpfw I ausf B

GERMAN LIGHT TANK

Scale 1:35

Made in Russia

No3522

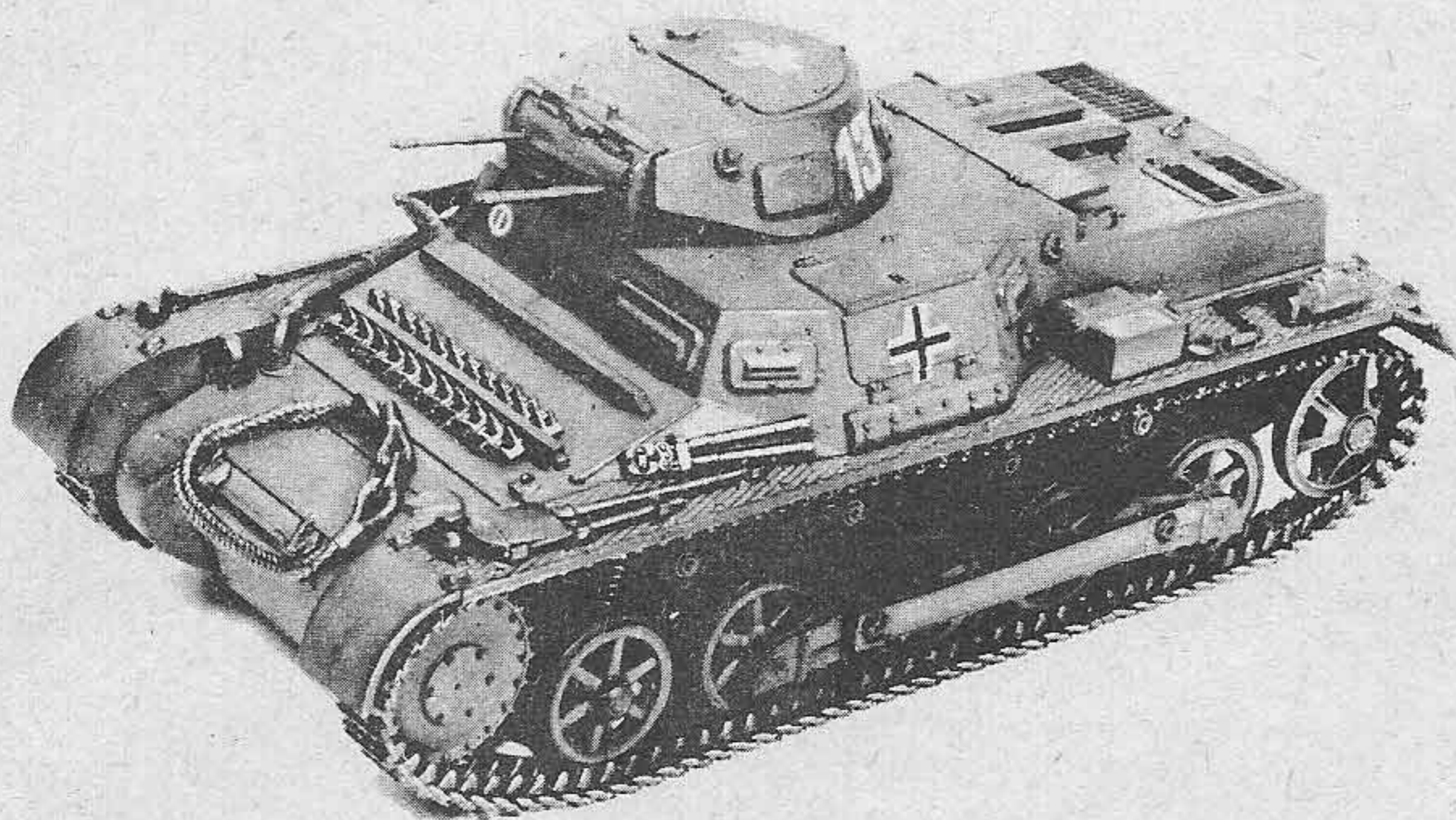

The PzKpfw I ausf B light tank was designed in 1933 by Krupp AG company and became the first serial-produced tank of Hitlerite Germany. In 1934-1935 the Krupp-Hudson production plants built 818 units of PzKpfw I ausf A tank - the first production version. They featured 5.4 t combat weight, the crew of two and their armament consisted of pair of 7.92 mm machine guns. The vehicle was protected by 13 mm thick armor and its 57 HP gasoline engine gave it a 37 kph top speed. In 1935 the PzKpfw I ausf B

modification was adopted. The vehicles of the type featured a longer body with additional pair of road wheels, more powerful 100 HP engine and a top speed of 40 kph in spite of increased weight (5.8 t). The crew, armor and armament remained the same. Until 1939 Wehrmacht acquired some 675 PzKpfw I ausf B vehicles and 179 turretless prime movers for tank crew training.

The new tank was inexpensive and easy to operate so not only tankers, but thousands motor-enthusiasts got on with this machine well. The PzKpfw I ausf B first time saw combat during Spanish Civil war when General Franco took delivery of some 200 vehicles of the type. Several PzKpfw Is were used by China in their war against Japanese - the soon be allies of Germany in W.W.II.

In Wehrmacht PzKpfw I tanks were operational in light tank battalions and light divisions. A battalion consisted of three light companies having four platoons of 5 vehicles each, and two command companies. The fourth and the eighth companies originally had the combined vehicle structure which included a medium tank platoon, and since 1940 light tanks remained only in the first platoons of these companies.

On September 1, 1939 Nazi Germany flooded Poland with 1445 PzKpfw I tanks. During the first Blitzkrieg Campaign the Germans lost 89 tanks of this type. PzKpfw I were used against the Scandinavian countries and France in 1940 and 182 vehicles of 523 total number were lost. In the Balkans and against the Soviet Union in 1941 180 vehicles were originally employed and along with others supplied from the reserves they suffered heavy losses - 523 tanks were lost until the end of 1942. The war revealed the main drawback of PzKpfw I - its weak armament (the armor met the 30-th standards) which made the vehicle a victim of any gun-armed tank. At the end of 1942 the PzKpfw I were withdrawn from service. In 1941 in Africa the 5th Light African (later on - 21st armored) Division had 25 PzKpfw I ausf B, virtually all were destroyed during a failure attack on Tobruq in June.

The PzKpfw I chassis was used for development of 4.7 cm self-propelled anti-tank guns, 15 cm heavy infantry support guns, 2cm anti-aircraft guns and ammunition transporters and maintenance vehicles (202, 38, 24, 51 and 30 units respectively).

Until 1940 the German vehicles were painted dark gray with brown camouflage applied on one-third of the surface and carried the white cross (Balkenkreuz) national insignia. After 1940 vehicles were painted dark gray and carried black Teutonic cross with thin white border. In winter 1941 the tanks were painted over with white wash. In Africa in 1941 the base color was yellow-brown camouflaged with grayish green irregular spots. Besides various tactical symbols German tanks carried division insignia and before 1941 - additional regiment insignia.

MANUFACTURER:

ZVEZDA, PROMYSHLENNAYA, 2 - LOBNYA, 141730, RUSSIA

SELLER:

ITALERY SPA VIA, PRADAZZO, 6 - CALDERARA (BO), ITALY

Assembly directions:

1. Use a sharp knife or a pair of scissors to remove parts from the sprue. For easy assembly each part is numbered. Paint small parts before removing from the sprue.
2. Care should be taken when using tools and modelling knives, as these can cause personal injury.
3. Plastic parts broken from sprues can have sharp, pointed or jagged edges. Remove these with a file or an emery board.
4. Keep out of the reach of children under 36 months old, as some parts are detachable. Children must not be allowed to suck any metal part or wire included with this kit.
5. This document should be retained for reference at a later date, if the need arises, as it includes the "EEC" company name and address as a means of identification of the importer and supplier.

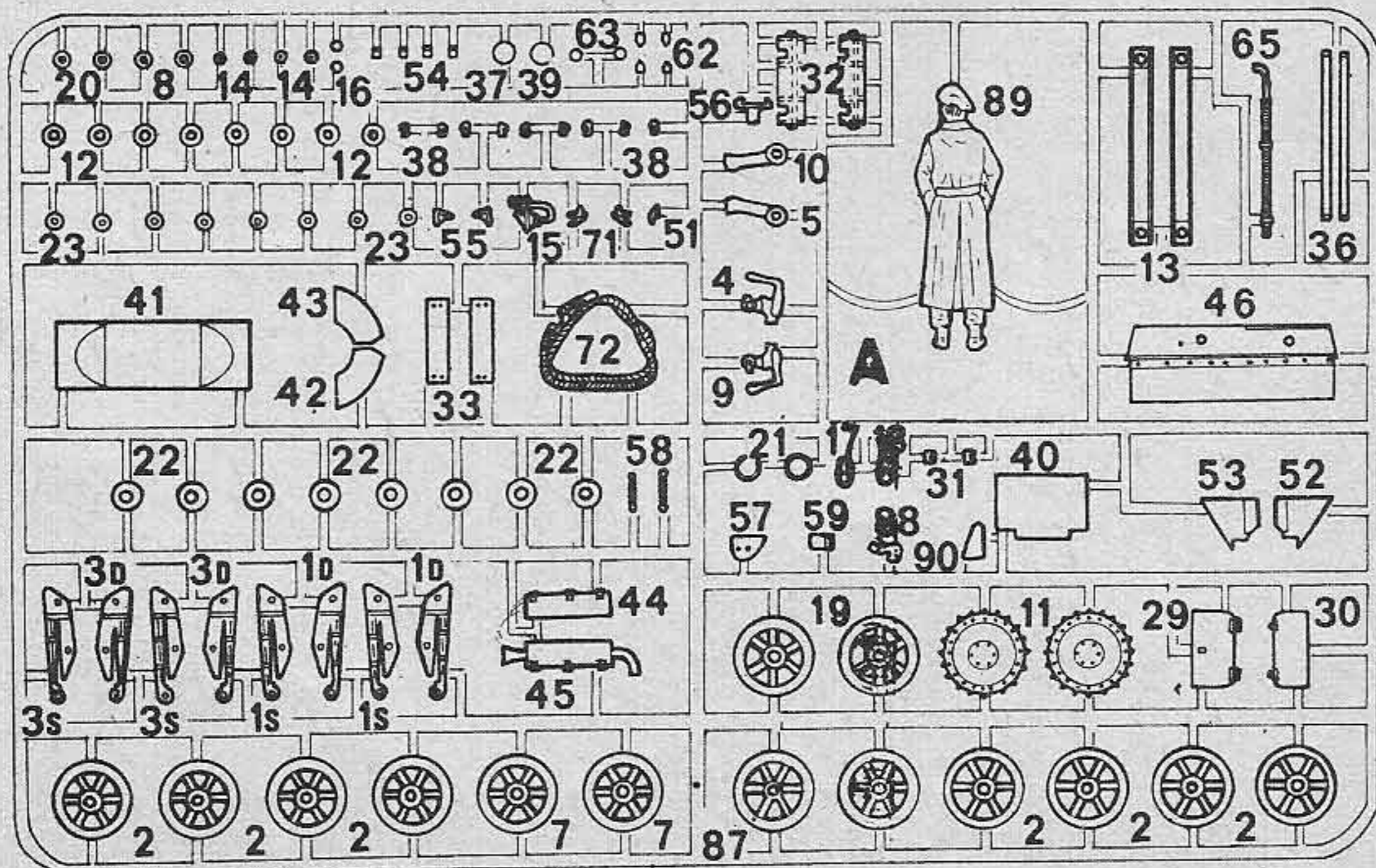
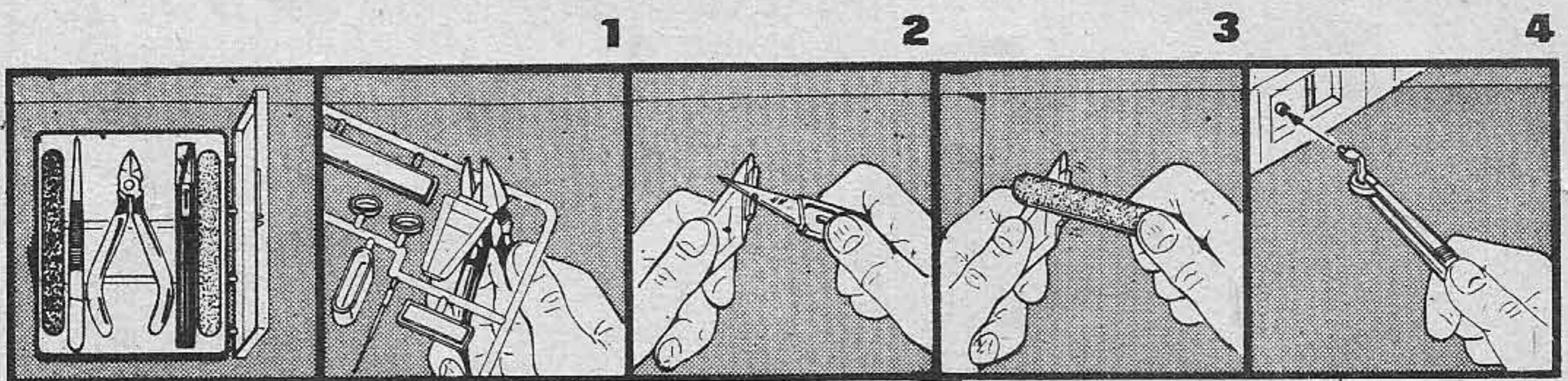

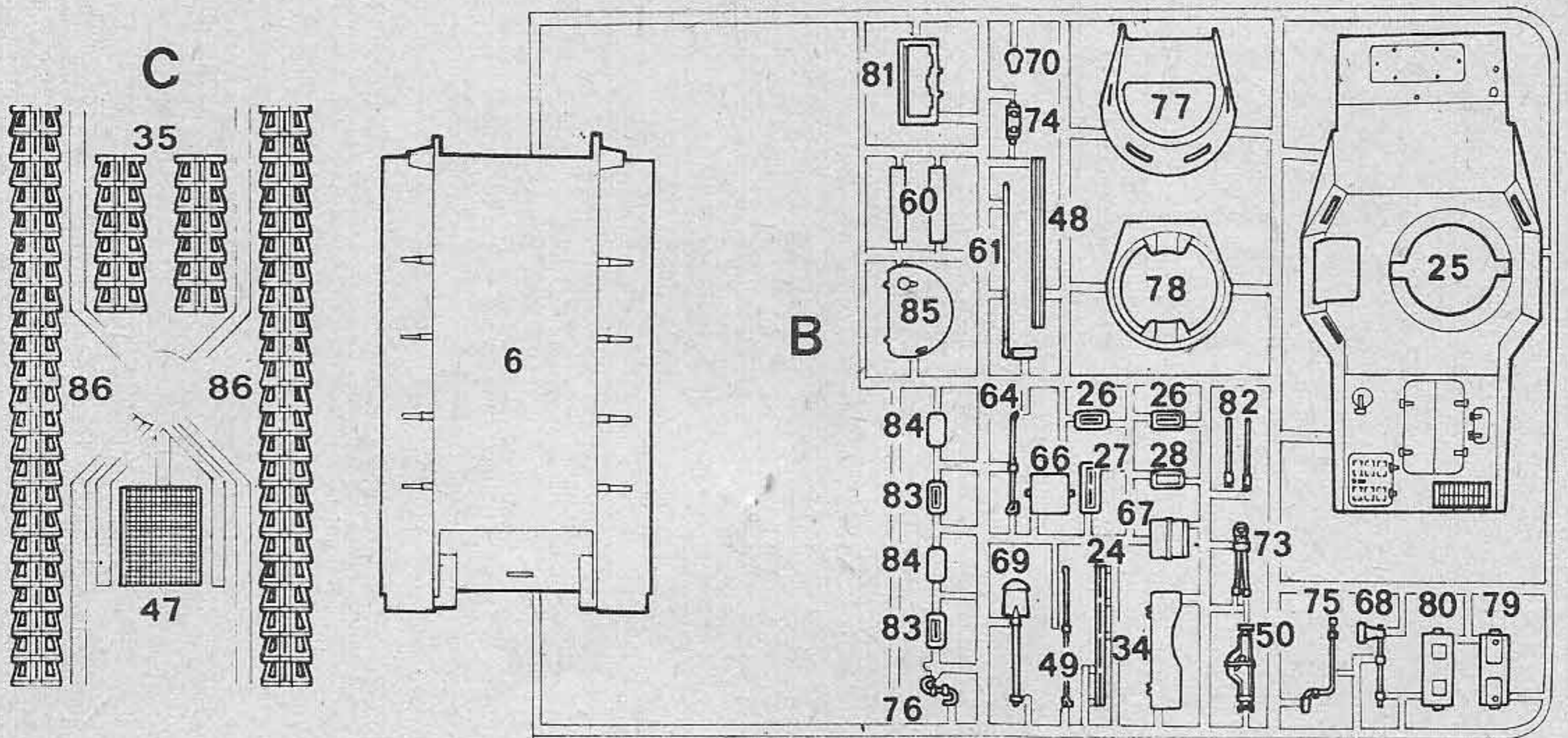

1 1-23

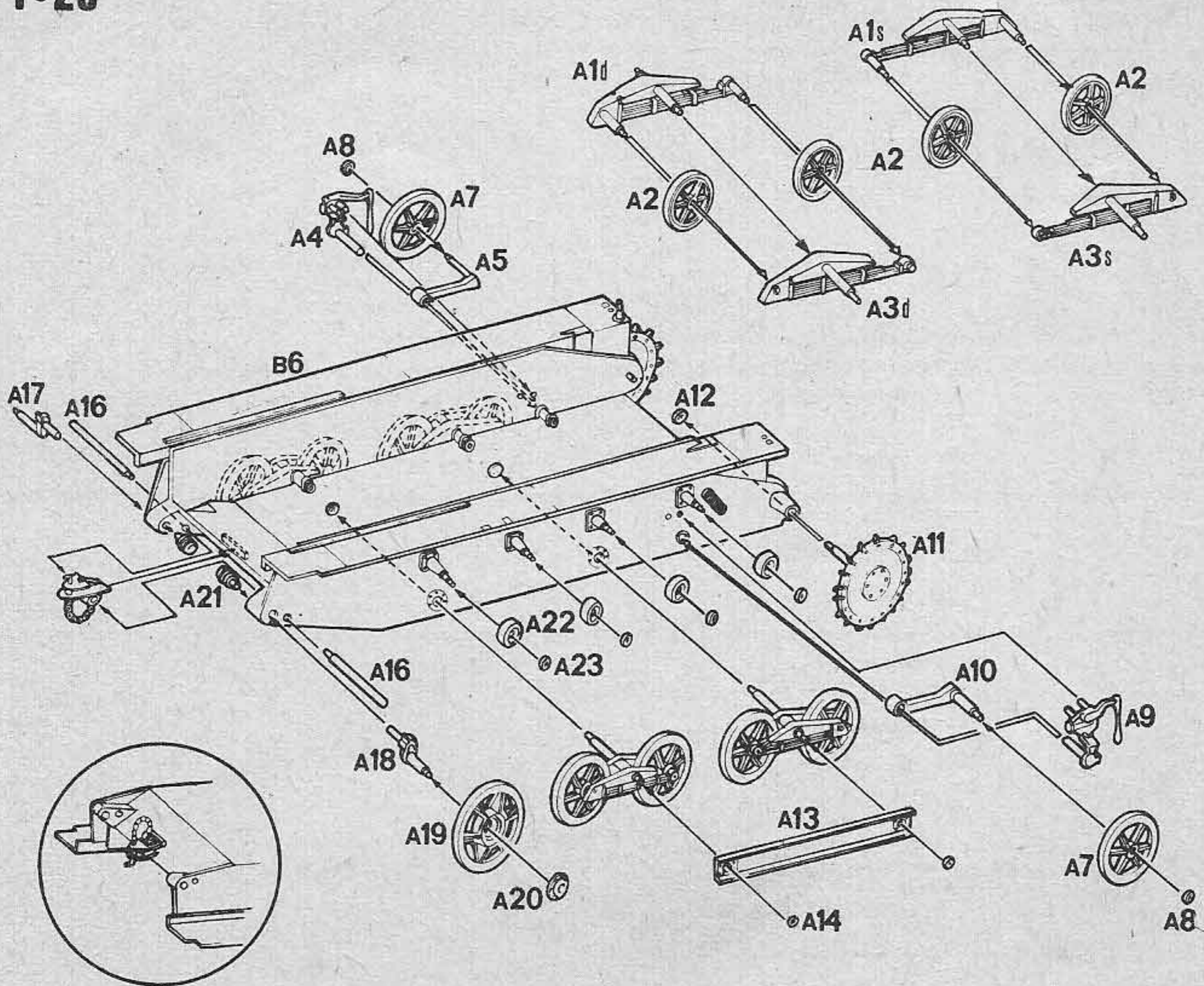

VERSION N. 1

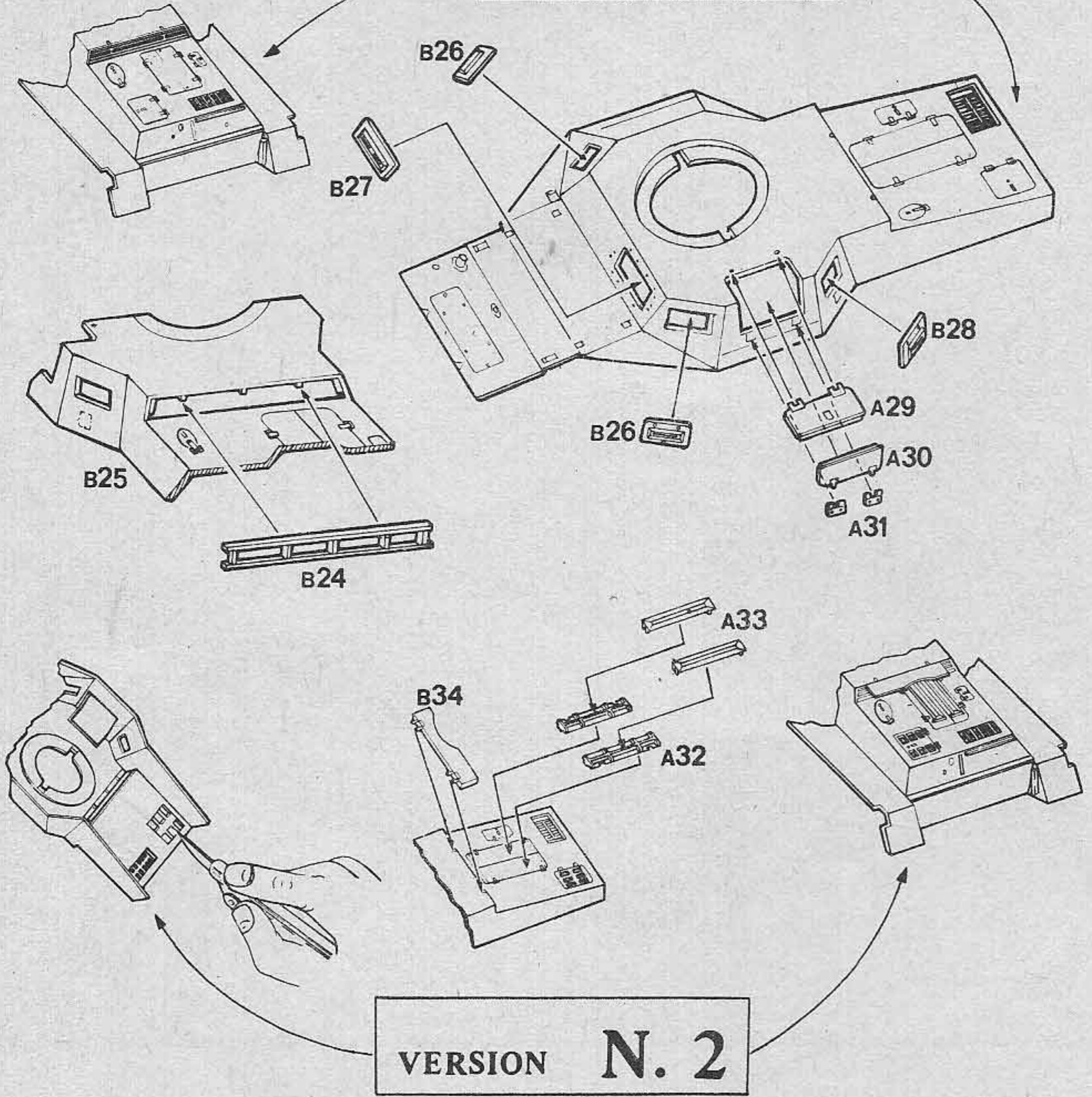

VERSION N. 2

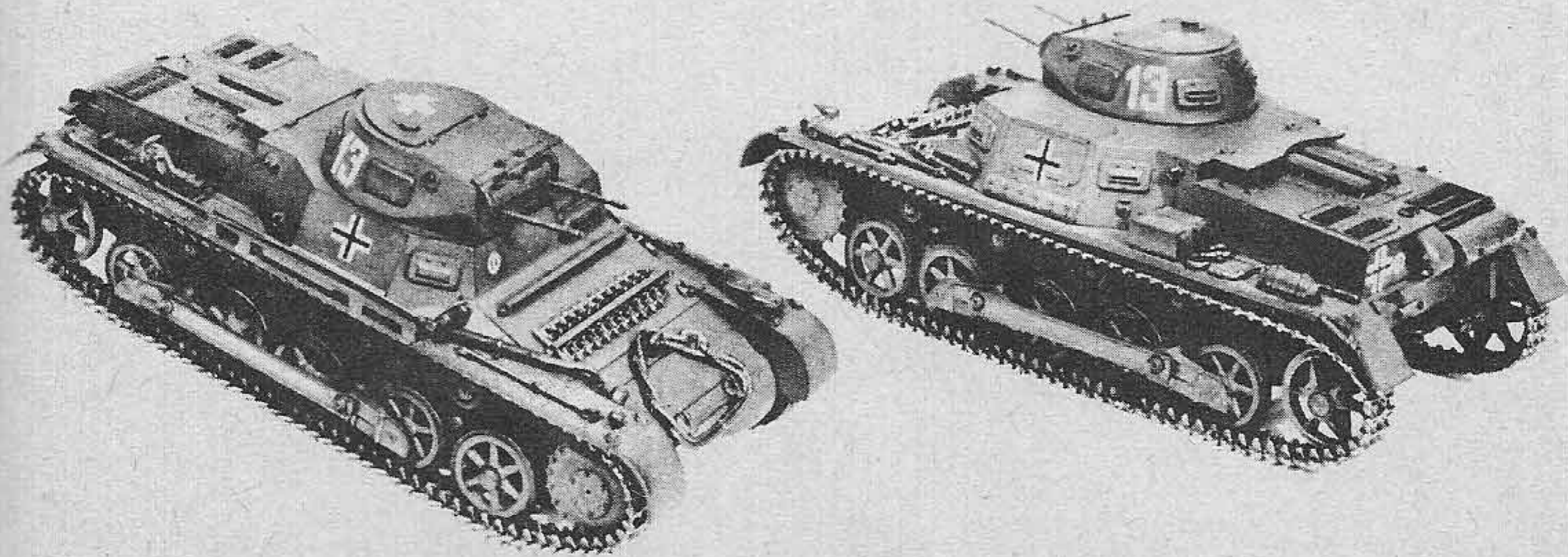

3 35•43

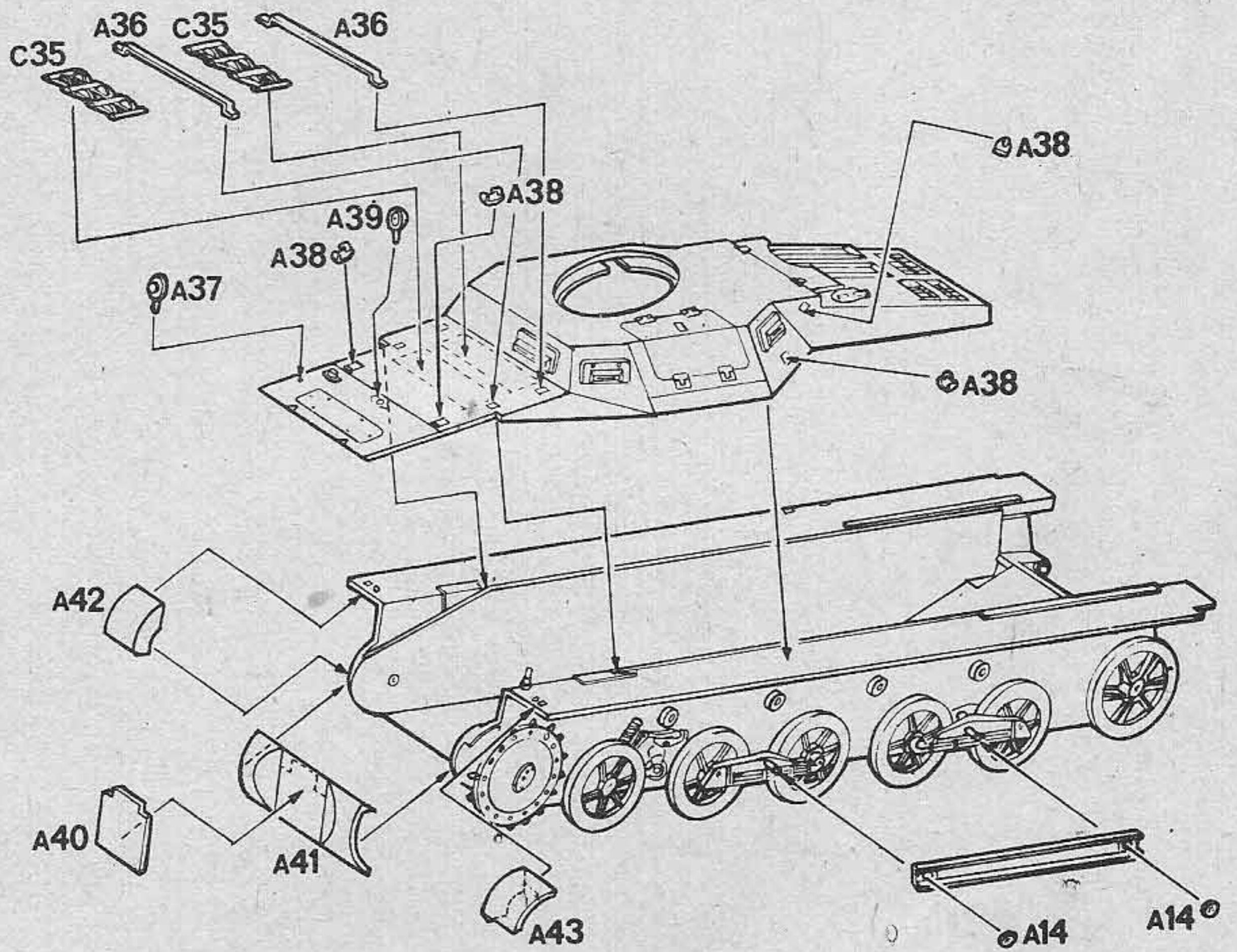

4 44•65

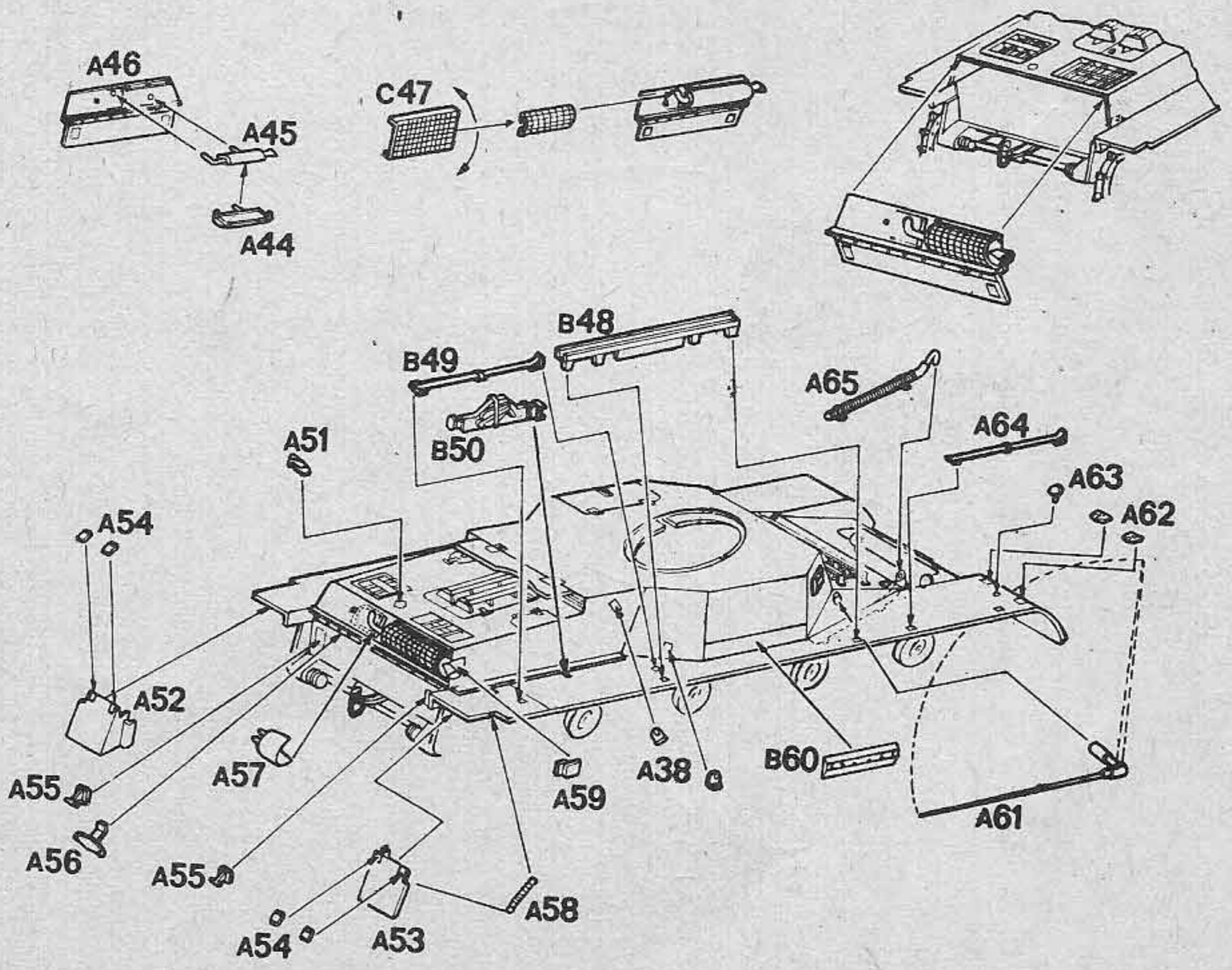

5 66-76

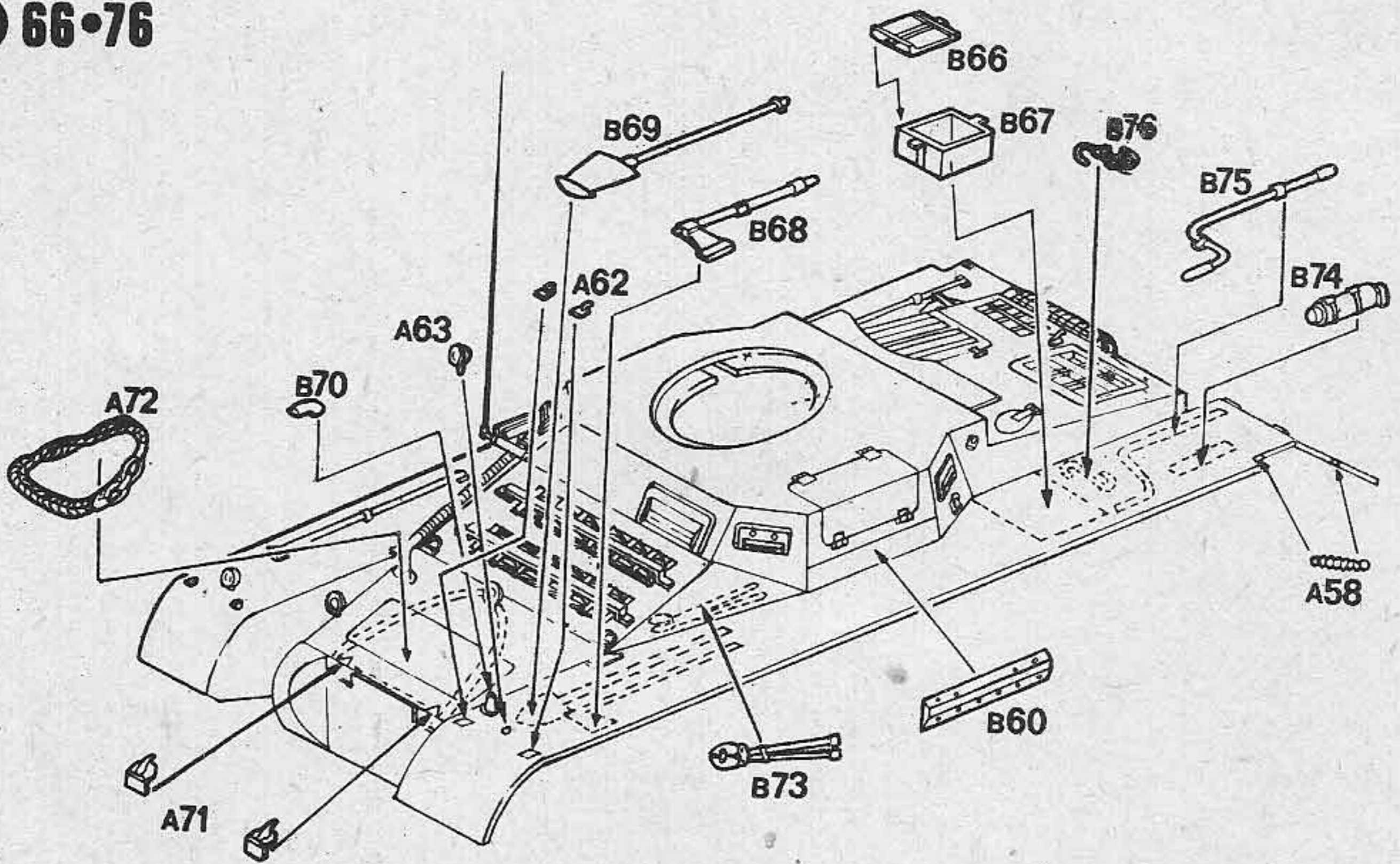

6 77-84

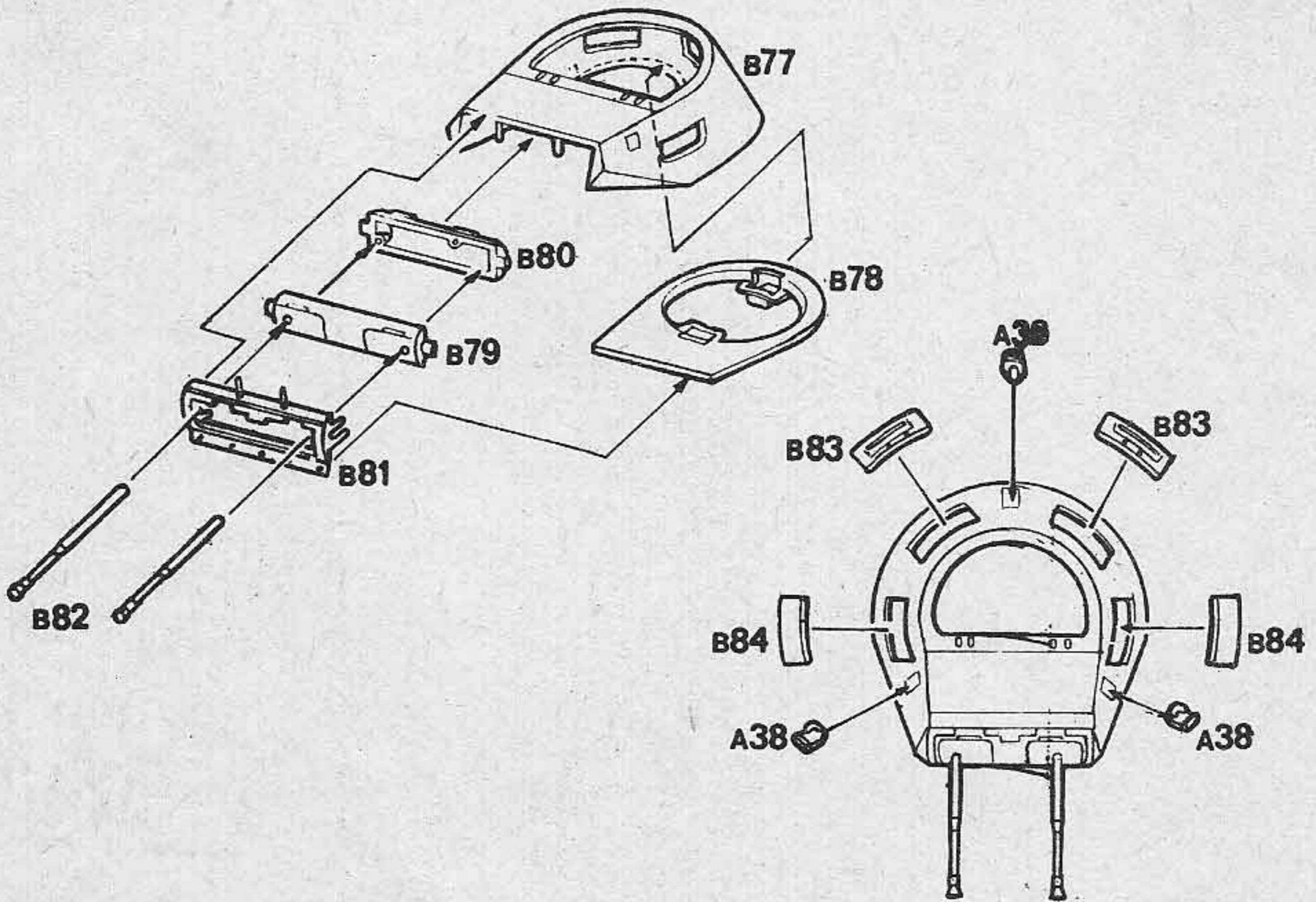

7 85•87

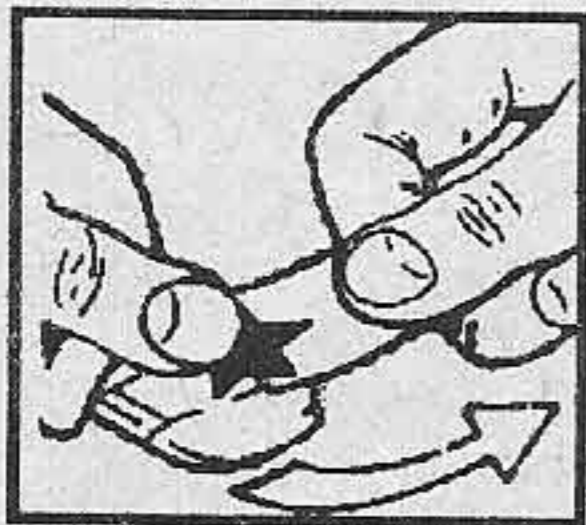
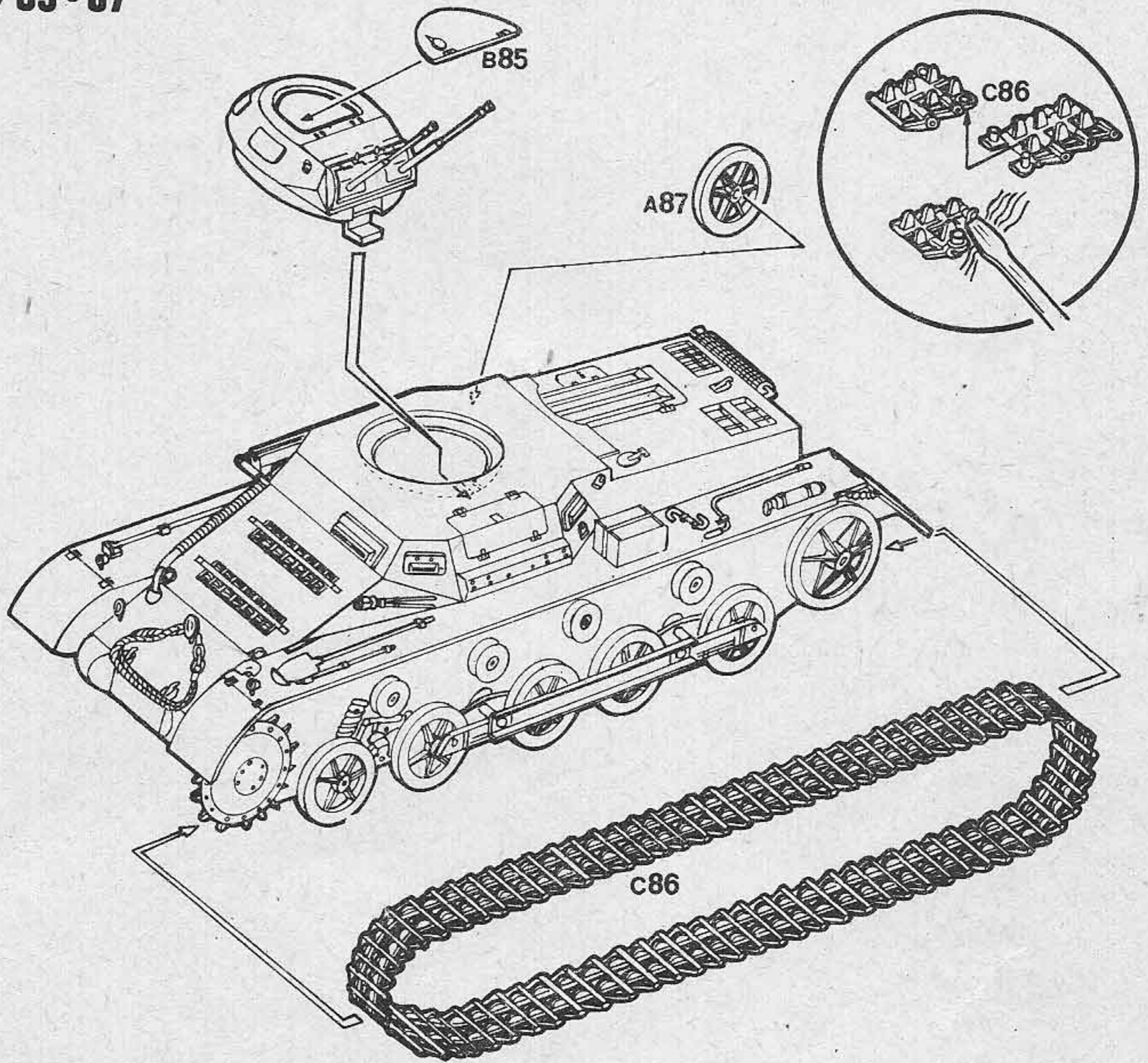

Direction for applying the decals:

Cut each image out of the backing sheet; soak in water for about 1/2 minute; place the décal in exact position and remove the backing sheet. Remove excess water with the cotton swab.

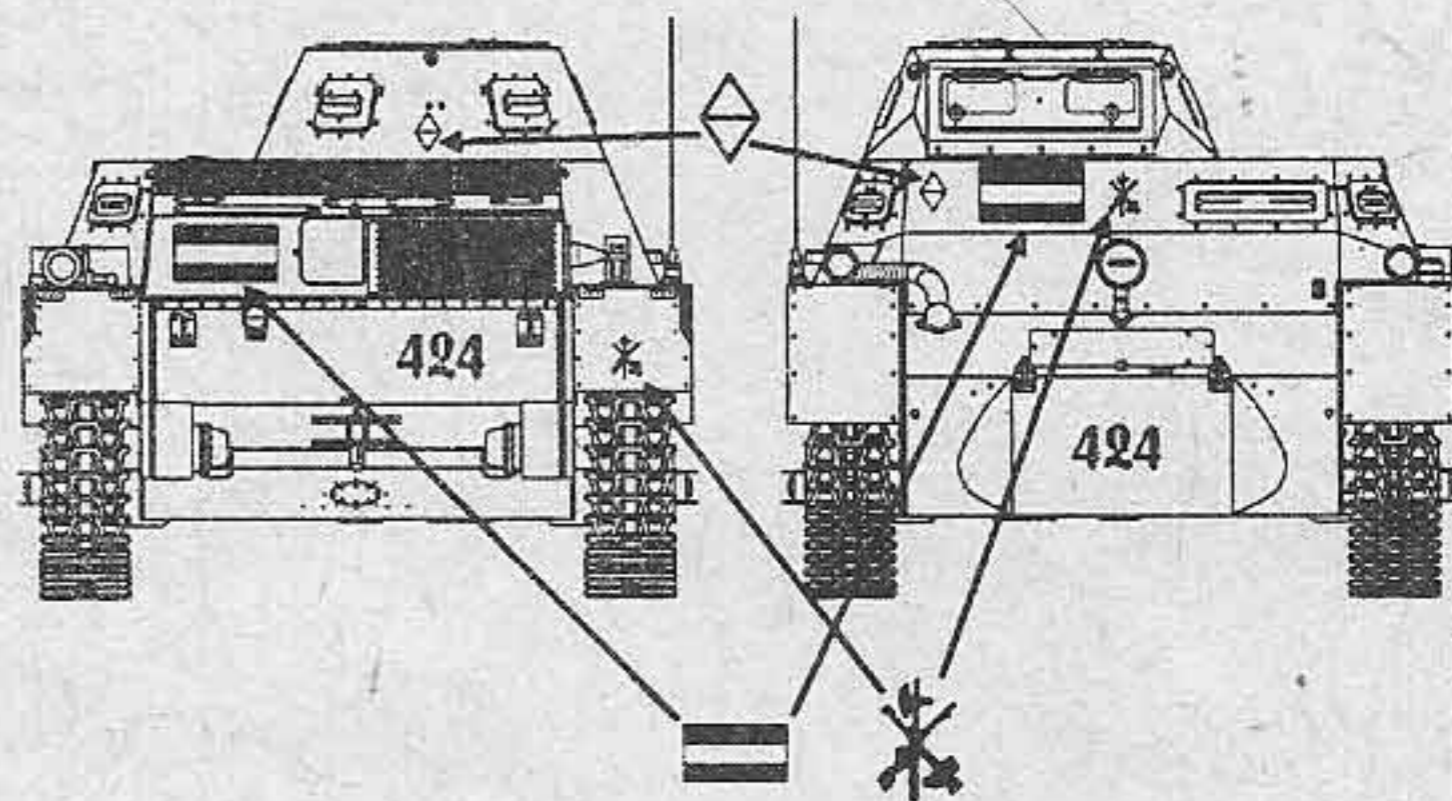
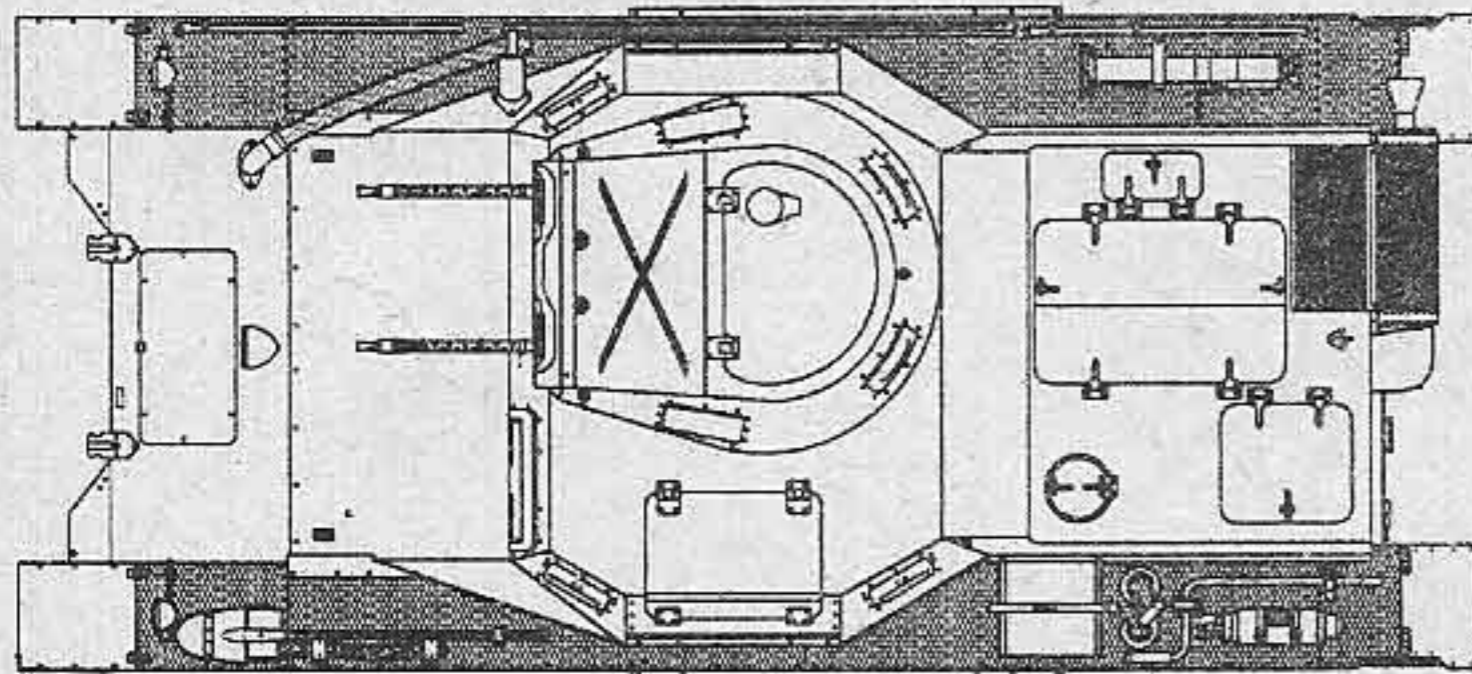
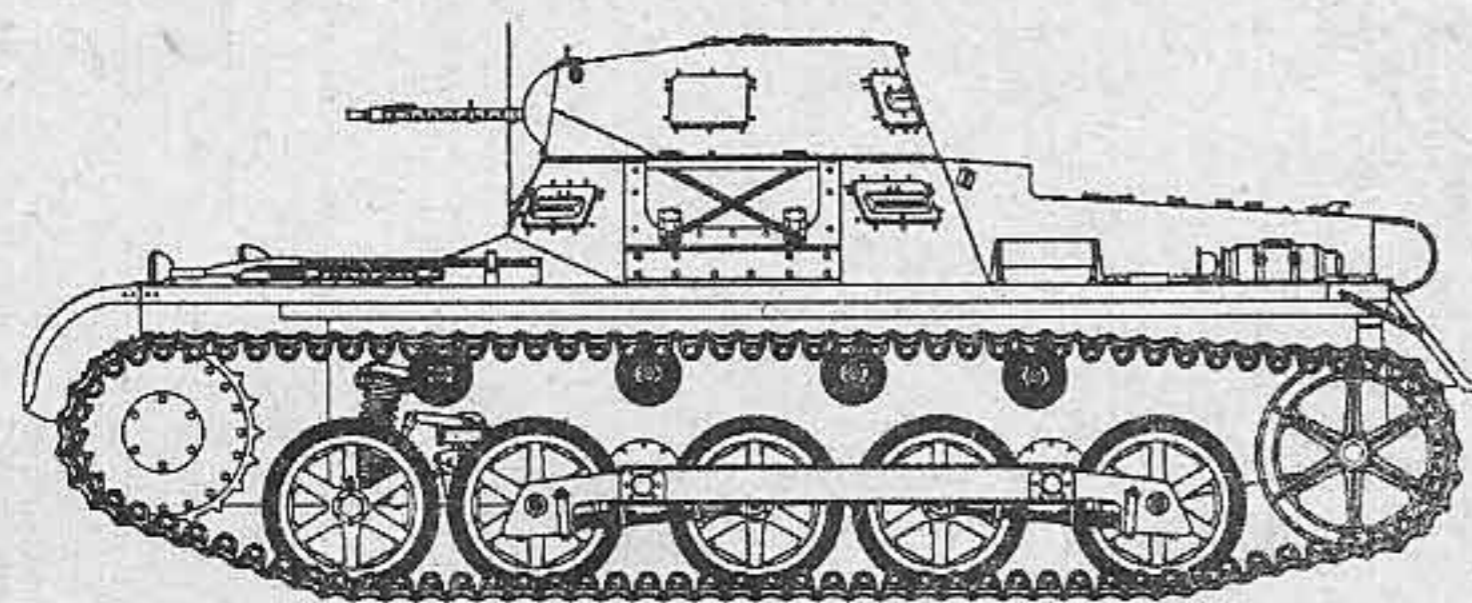
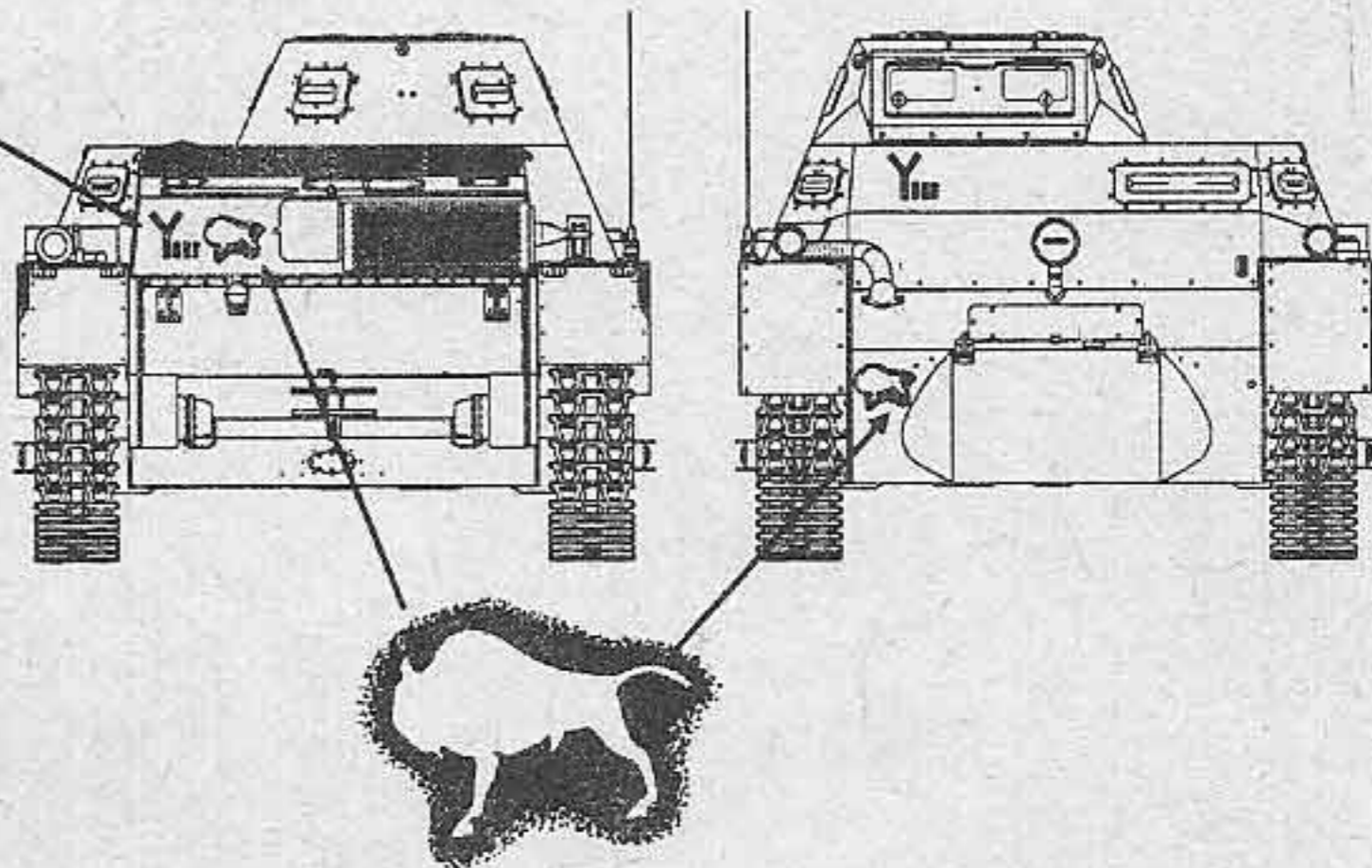
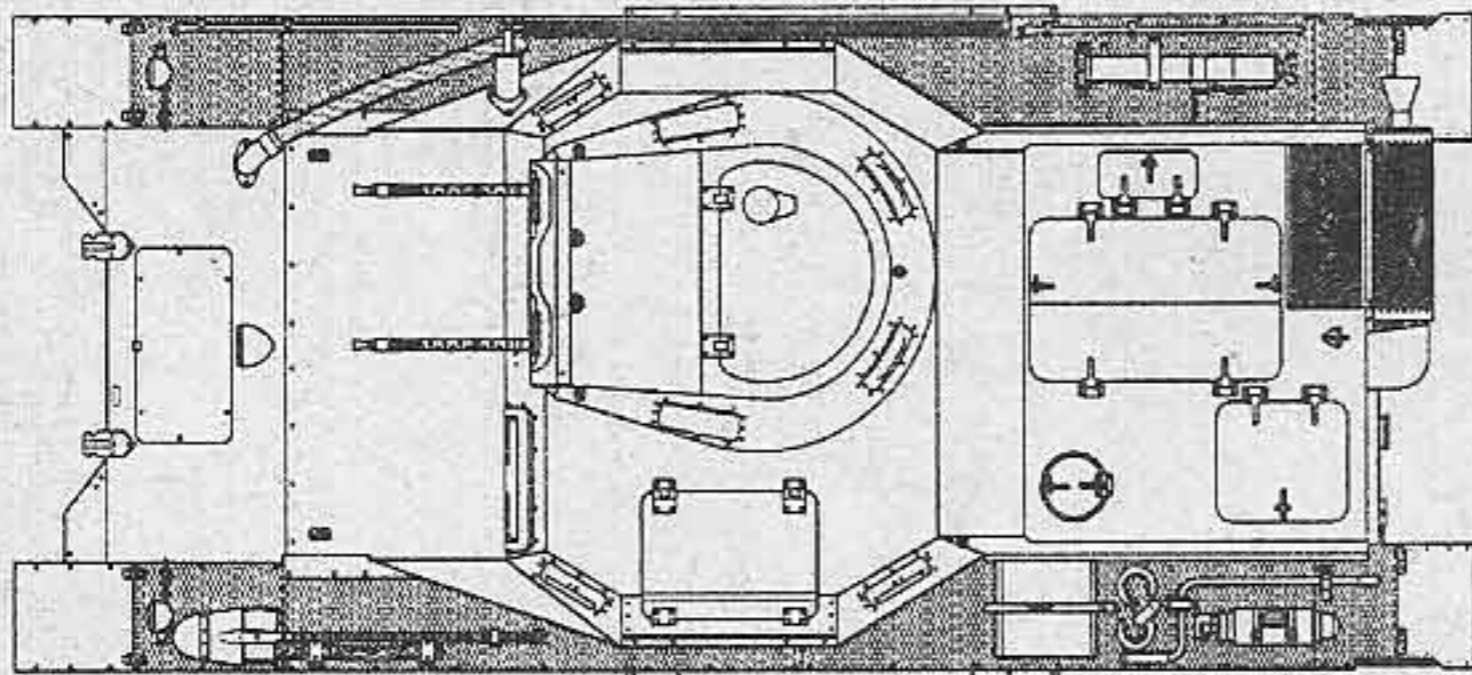
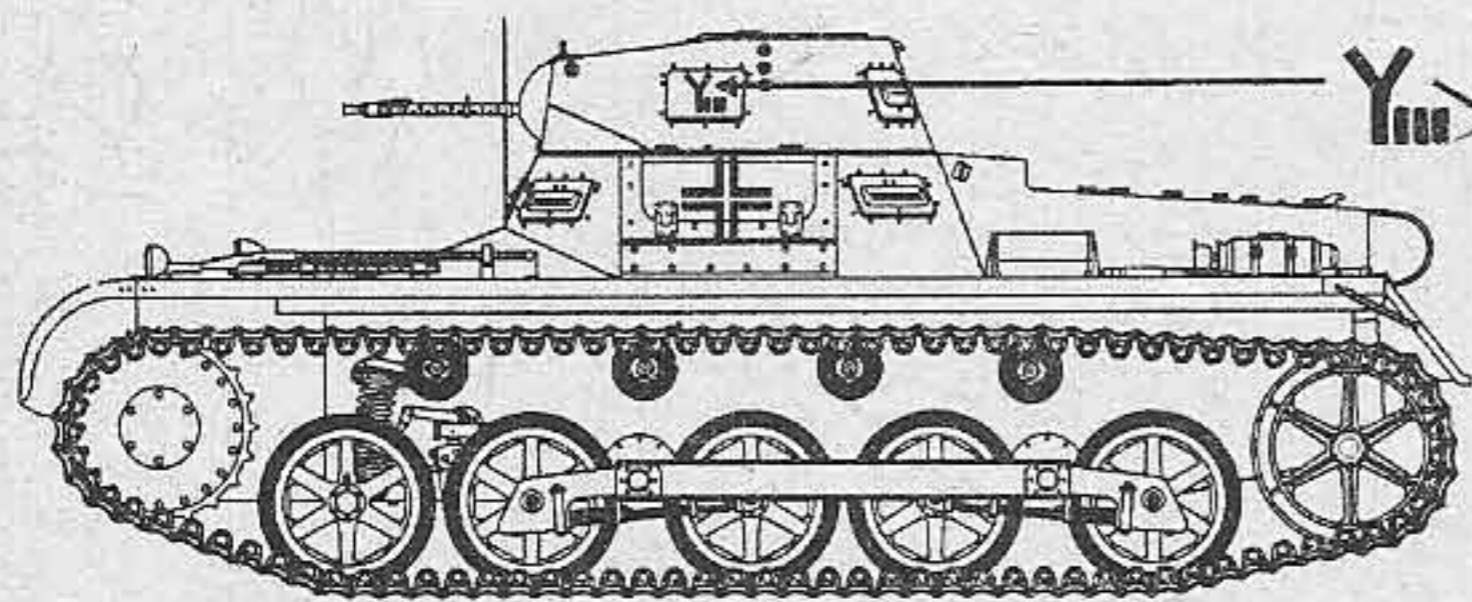

PANZER GREY

PANZER GREY

SAND YELLOW

DARK GREEN

BLACK

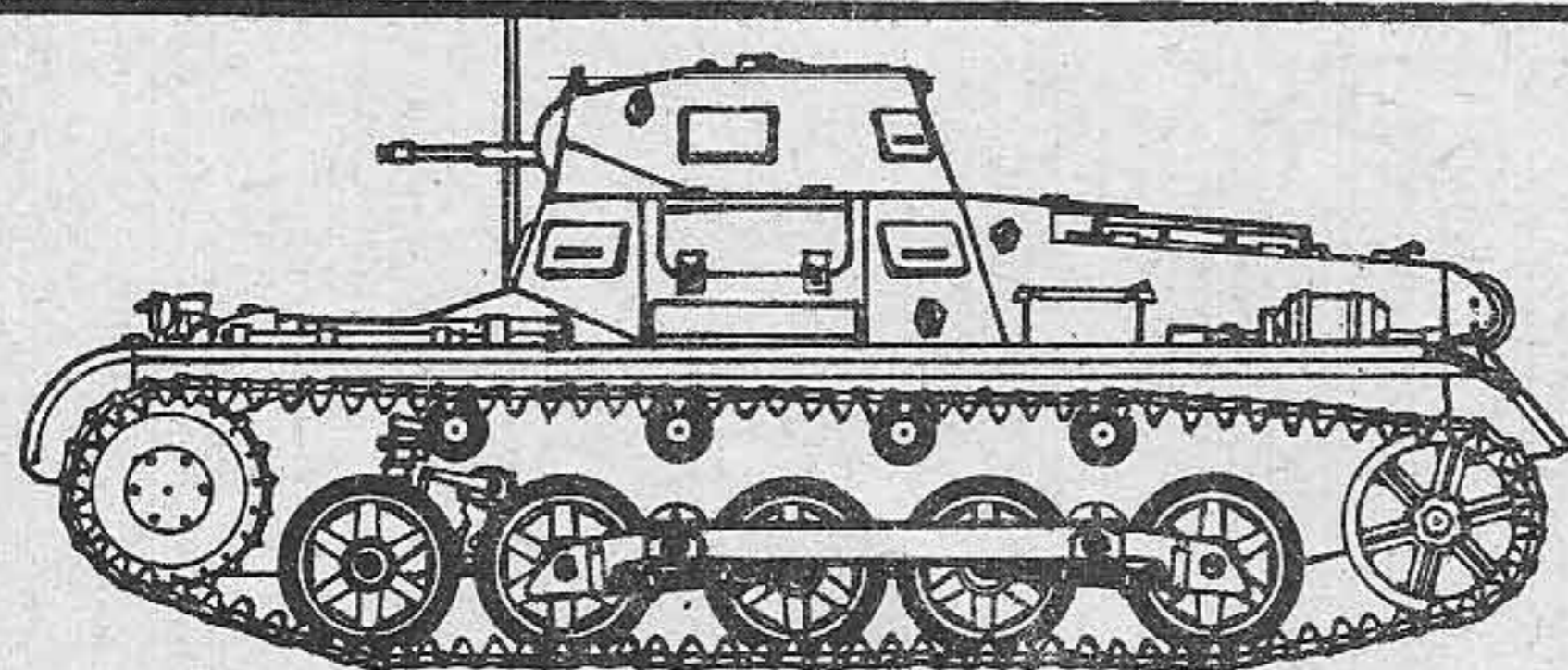

- 1 BLACK
- 2 BLACK LEATHER
- 3 GREY GREEN
- 4 DARK BLUE - GREEN

