

Pz.Kpfw.I Ausf.B

ABWURFVORRICHTUNG

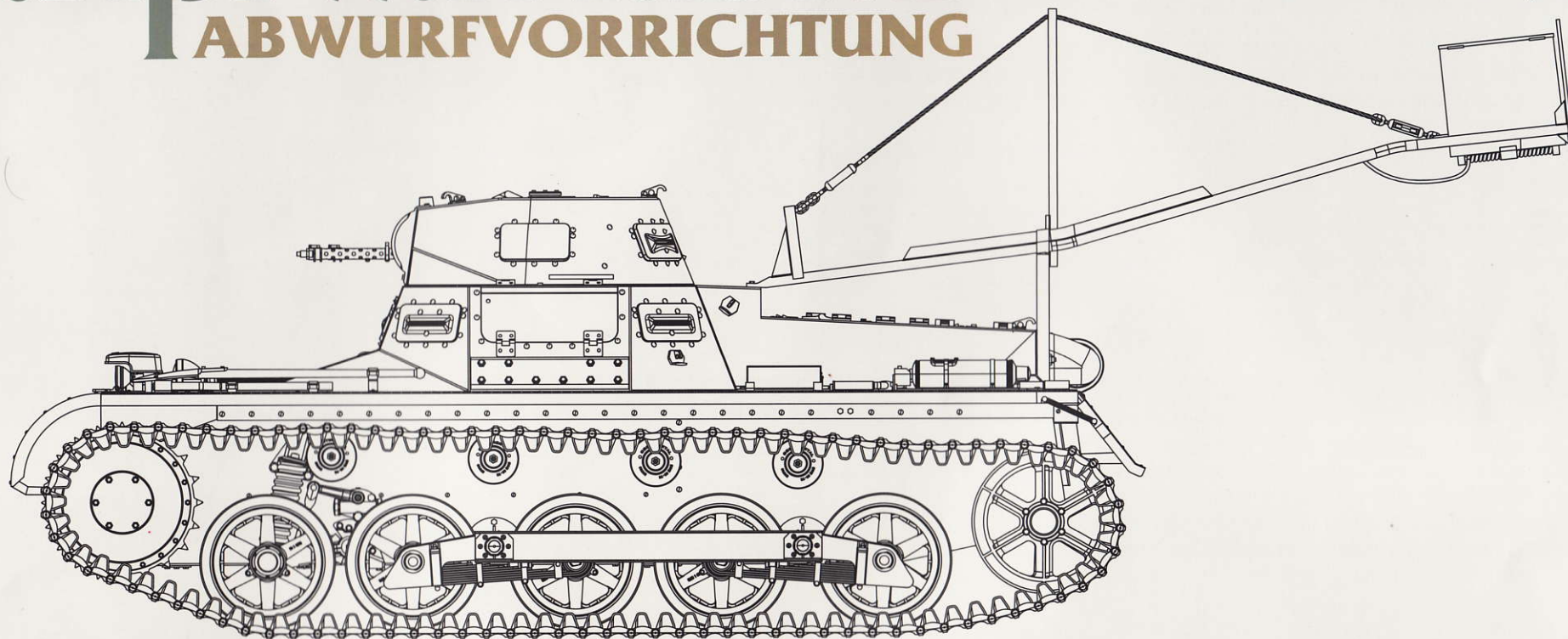

In 1930, Krupp was selected by Waffenpruefwesen 6 (the automotive and tank design office of the German army) to work on the design of a small light tracked tractor named Kleintraktor. It was to be equipped with a 20 mm (0.79 in) auto-cannon, powered by a 60 hp engine and weigh no more than 3000 kg. A year later, in 1931, Krupp sent a description of the Kleintraktor-Fahrgestell (chassis) to Wa.Prw.6. The Krupp Kleintraktor was described as a fast and maneuverable tracked vehicle that weighed about 3.5 tons and could achieve 45 km/h (28 mph). The hull of the tank was made of welded steel plates, it was armed with a 20 mm (0.79 in) auto-cannon and carried 500 rounds.

As development proceeded, several prototypes were made, with some flaws being removed from the tank. The turret was redesigned to fit 2 machine guns and armor protection was increased. In 1933, the Panzer I was considered ready and an order was placed for 150 training tanks, with another 1000 combat-ready tanks being ordered the following year. Neither of these orders were fully delivered.

The Panzerkampfwagen I Ausf.A went into production in late 1934 and continued until early 1936. Around 800 examples were built, having several limitations. The armour was insufficient, being only 13 mm (0.51 in) at its thickest. There were problems with the early suspension, making the tank pitch backwards at high speeds. There were also concerns about the propulsion, overheating, the commander being both gunner and loader of the two machine guns, and communication going through old-fashioned vocal tubes. With its two machine guns, light armor and speed, these machines were nothing more than training and scout tanks. Despite this, most of them fought in regular Panzer divisions alongside the improved Ausf.B until late 1941.

Many of the flaws of the Ausf. A were addressed with the introduction of the Ausf. B. This variant first appeared in 1936 and was built until 1938, with around 675 machines produced. The main difference was a longer chassis (by 40 cm), requiring the addition of one more bogie wheel and improved suspension in order to accommodate the much improved water-cooled, six-cylinder Maybach NL 38 TR delivering 90 bhp, along with a new & improved transmission. The weight rose to 5.8 tons, but neither the armament nor armor were modified.

Serving Pioneer Battalions, the Pz.I Ausf.B Abwurfvorrichtung received a field modification consisting of a boom fitted with explosives that was to be used to attack heavy fortifications.

READ BEFORE ASSEMBLY

CAUTION

- Read carefully and fully understand the instructions before commencing assembly. A supervising adult should also read the instructions if a child assembles the model.
- When assembling this kit, tools including knives used. Extra care should be taken to avoid personal injury.
- Keep out of reach of small children. Children must not be allowed to suck any part, or pull vinyl bag over their heads.



PAINTS REQUIRED

Color info and profiles by Mig Jimenez



APPLYING DECALS

1. Clean the model surface with a wet cloth.
2. Cut out each decal design from sheet, and dip it in tepid water for 15~20 sec.
3. Hold the backing sheet edge and slide decal onto the model.
4. Move decal into position by wetting decal with finger.
5. Press decal gently down with a soft cloth until excess water and air bubbles are gone.

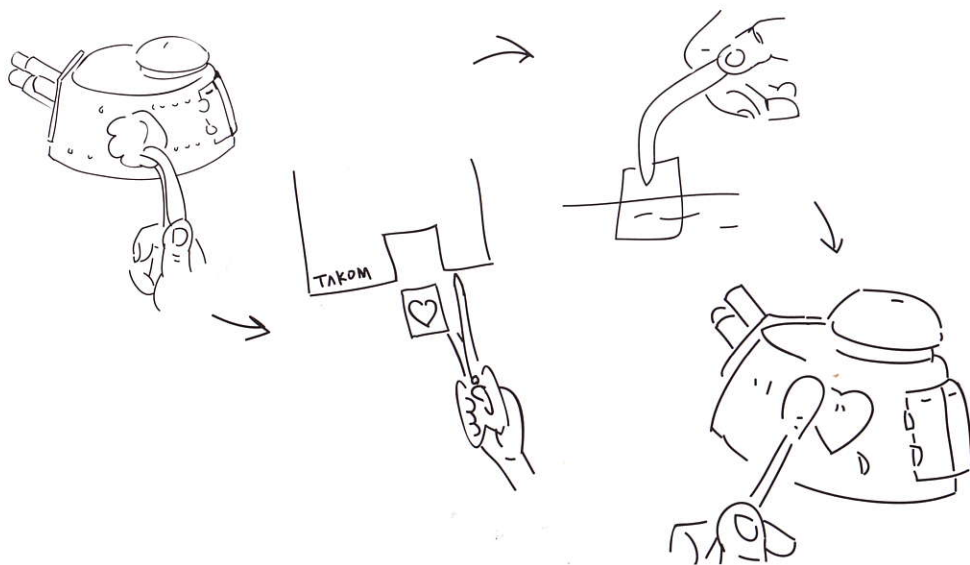

REMOVING PE

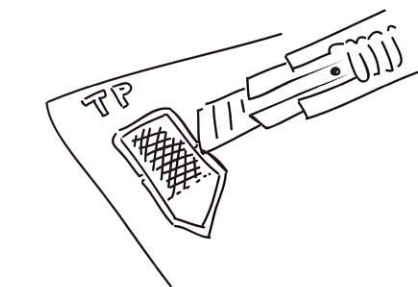

Be careful not to hurt when removing PE parts.

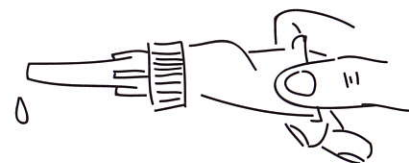

Secure using instant glue (not included).

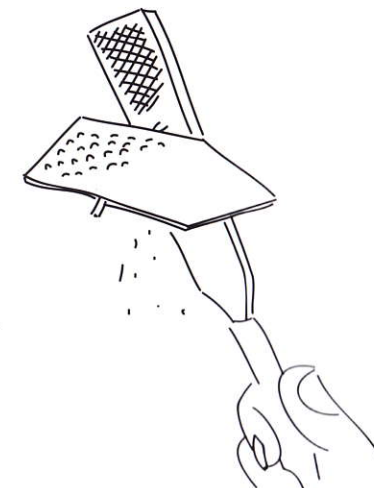

Finish using file.

PARTS

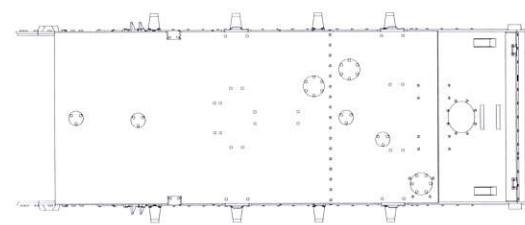
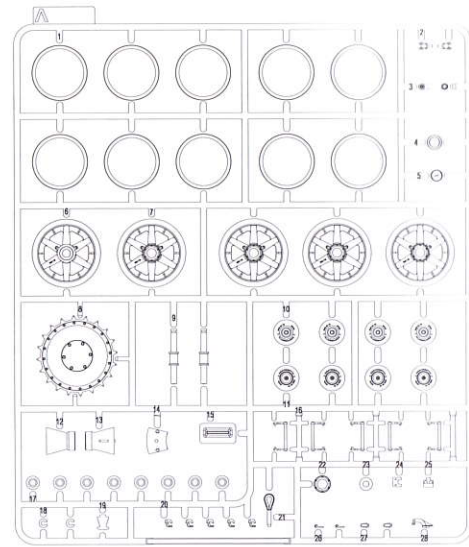
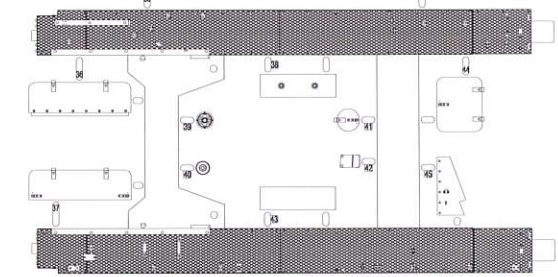
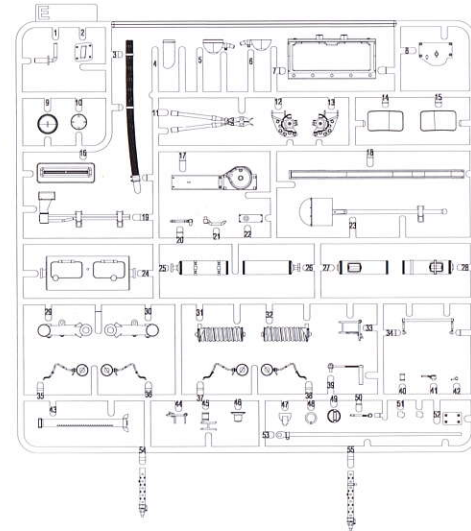
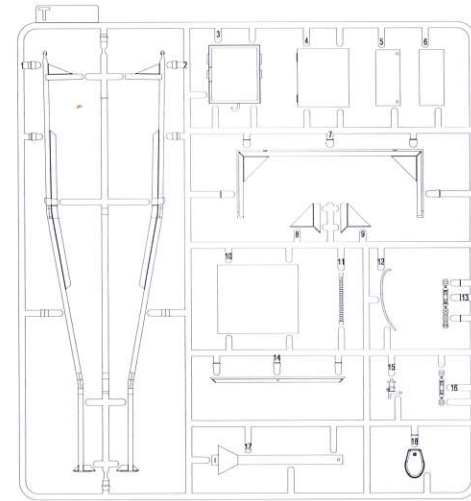
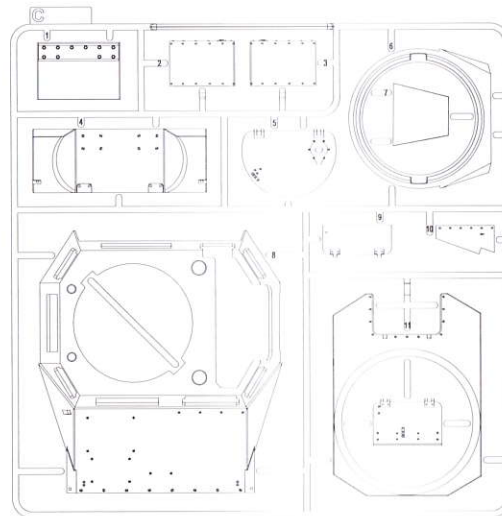
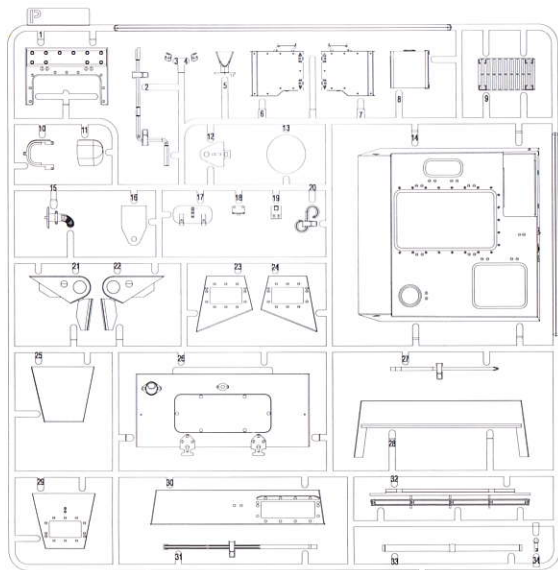

Lower Hull

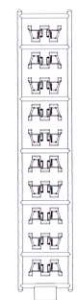

H X20



Cable

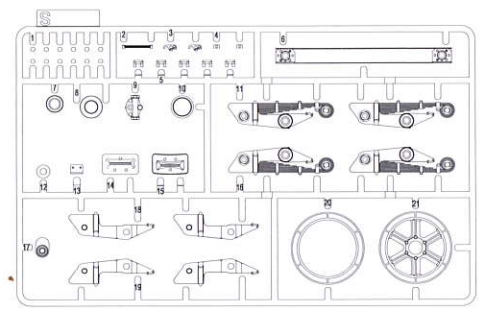

X2

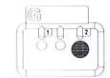

J X10

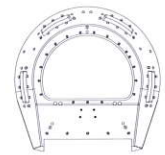

Turret



Decal



TP

1

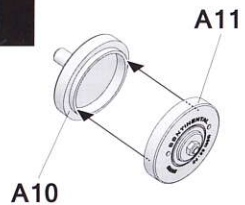

Make 4

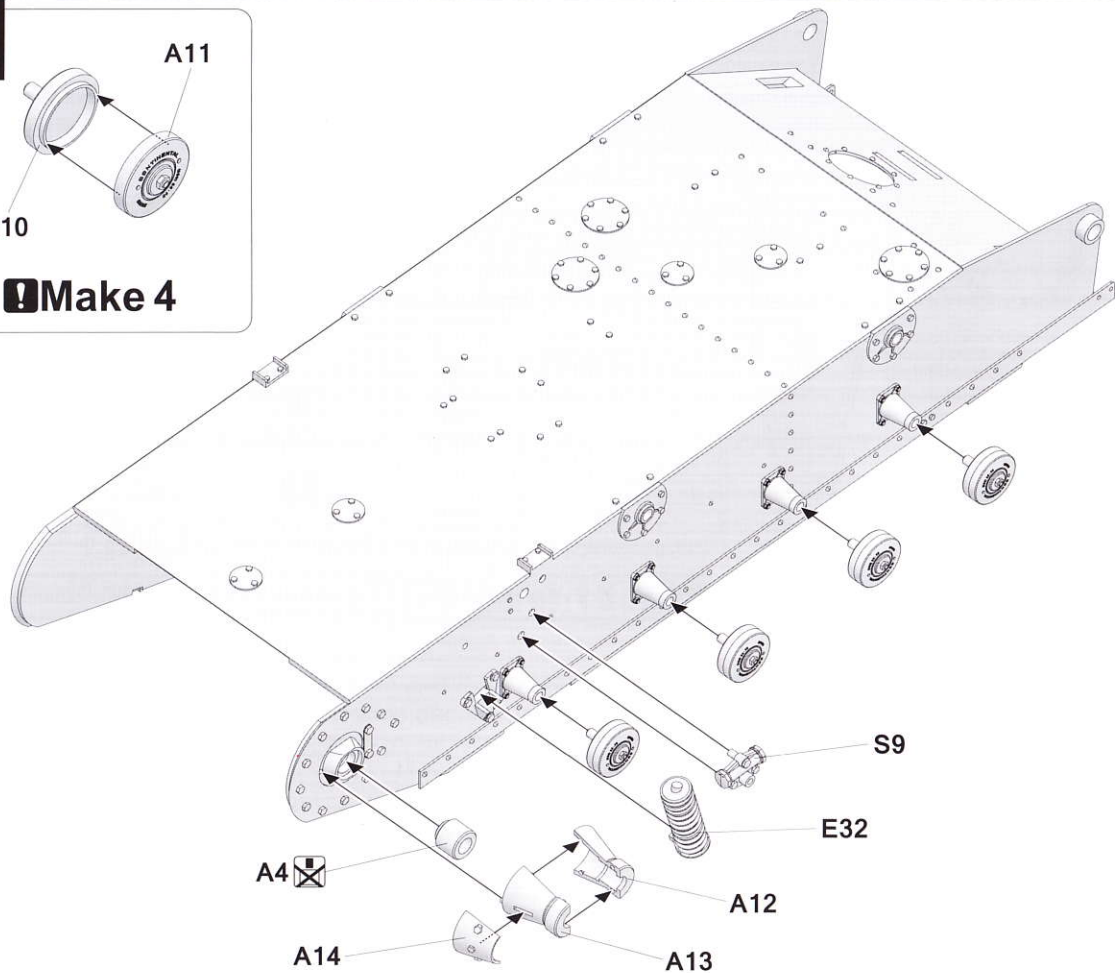

2

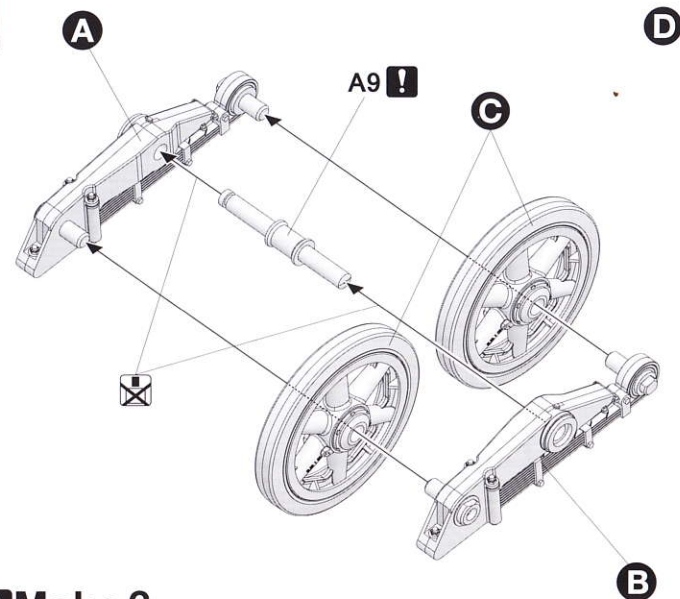

Make 2

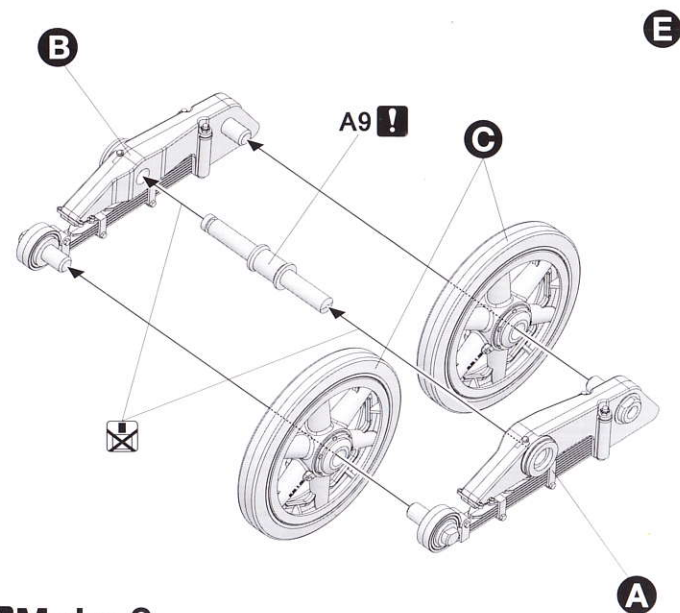

Make 2

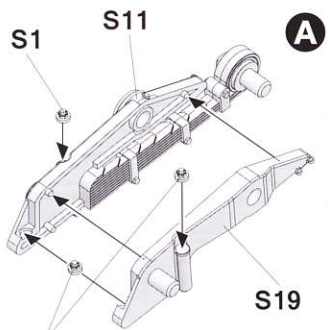

Make 4

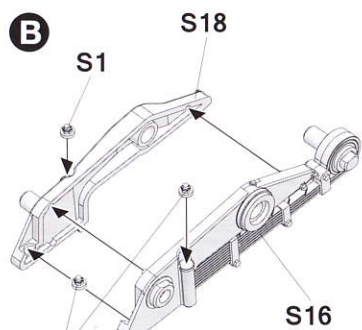

Make 4

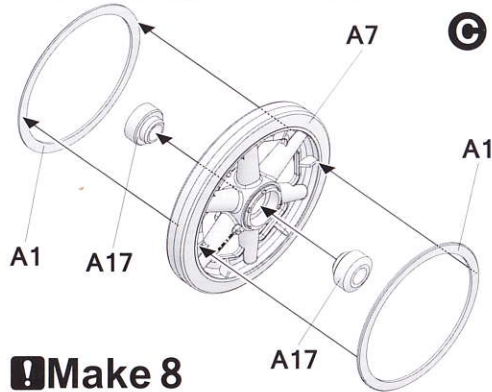

Make 8

3

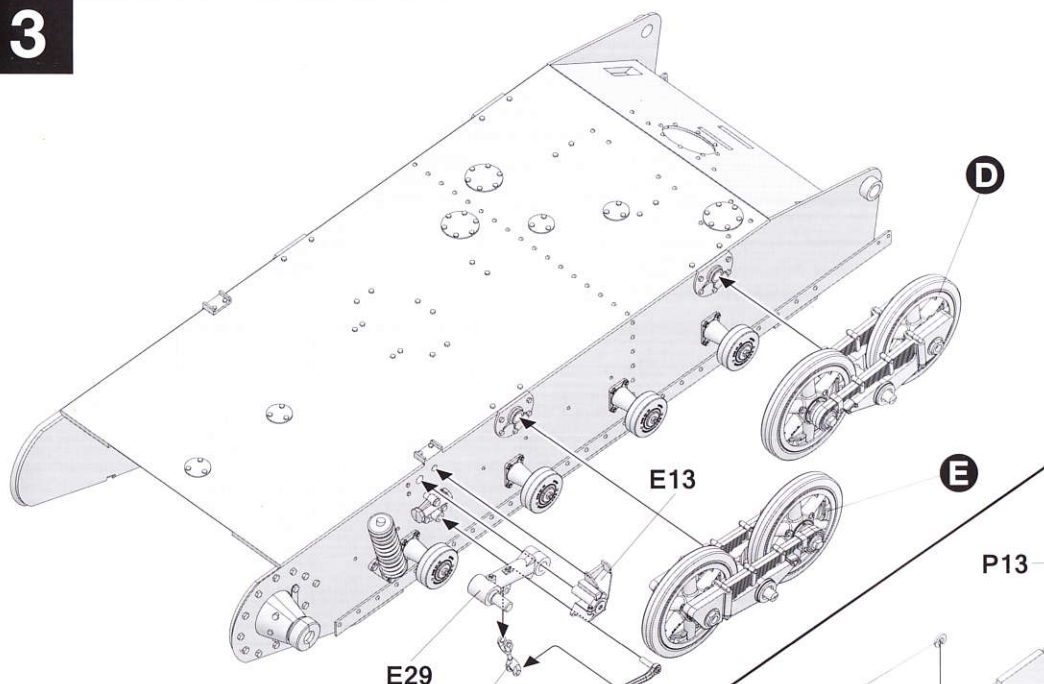

4

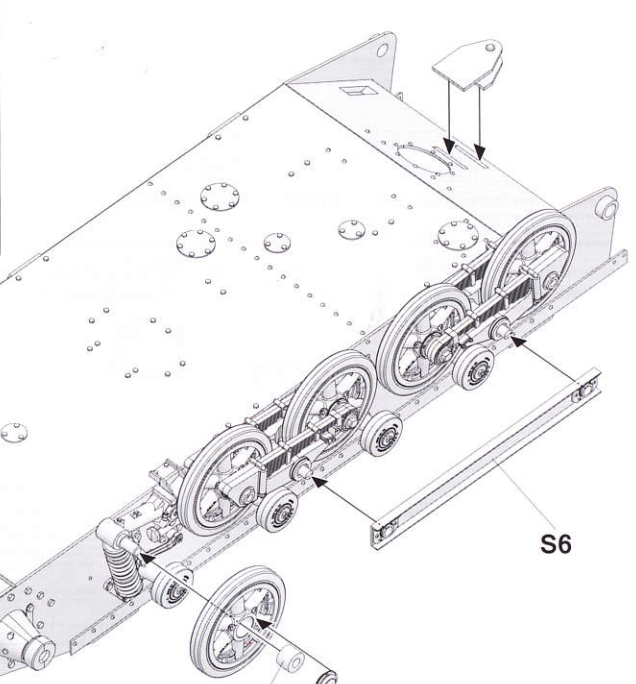
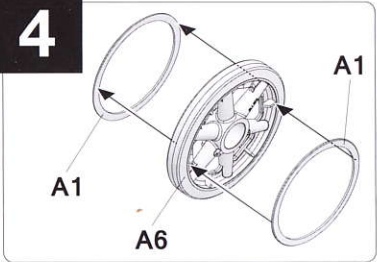

5

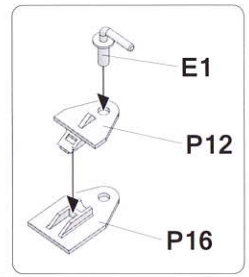
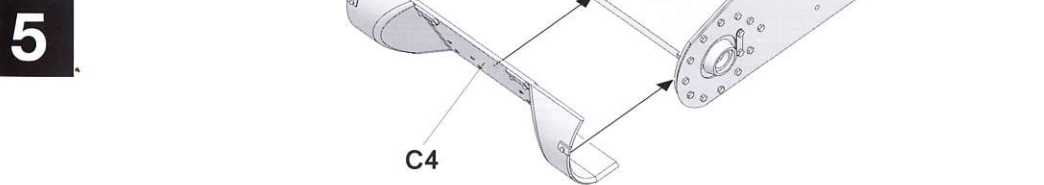

6

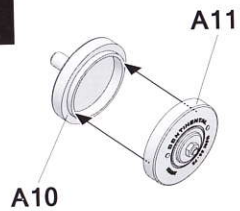

Make 4

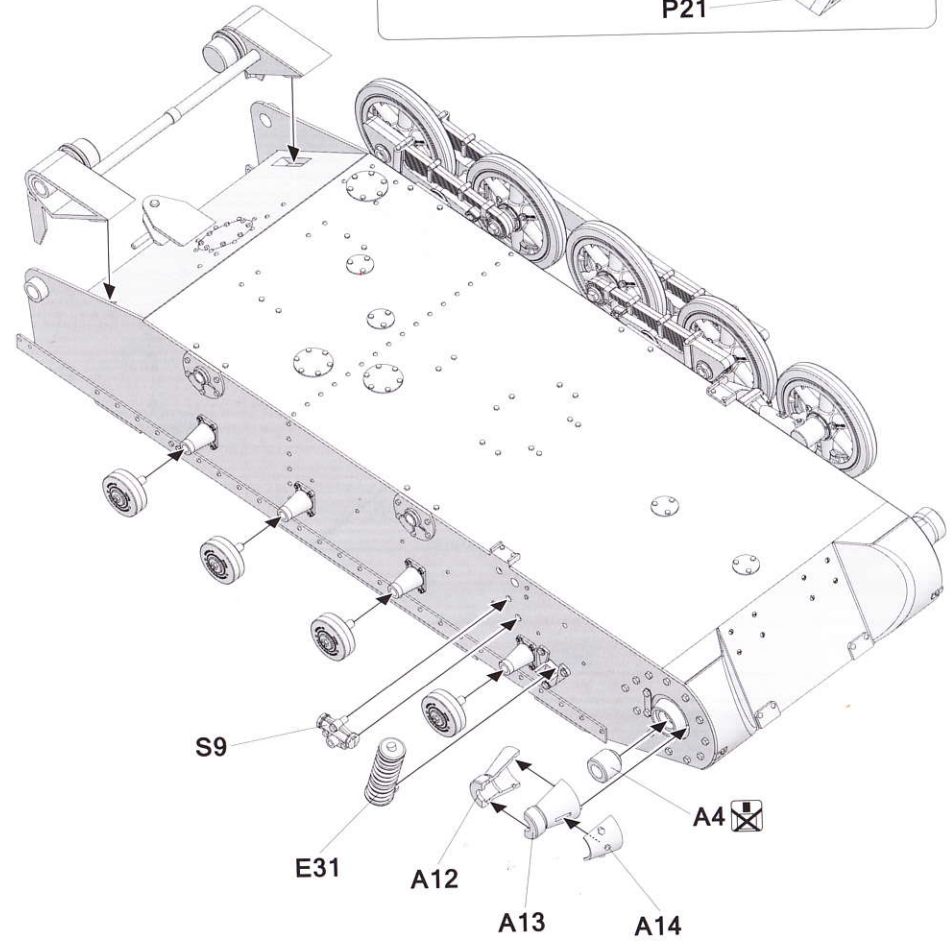
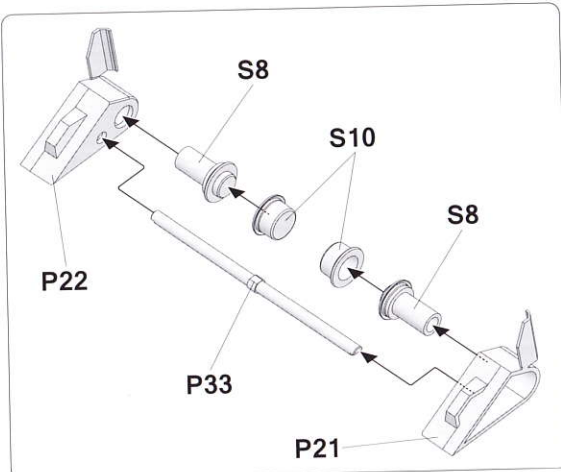

7

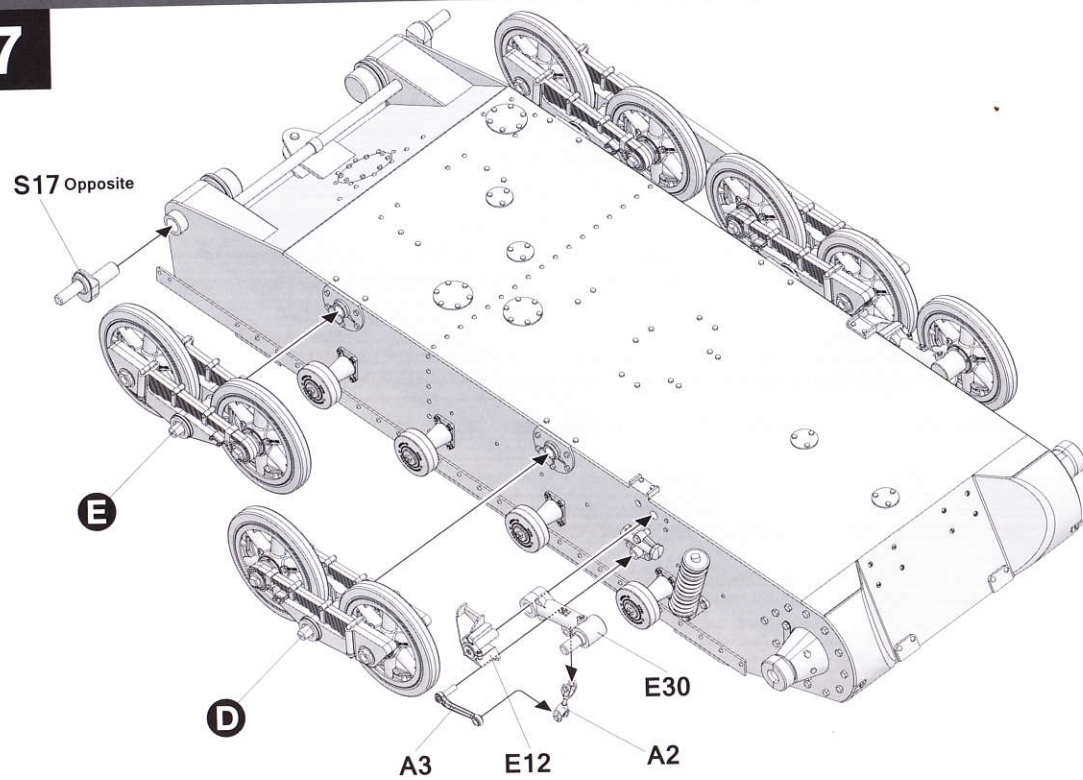

8

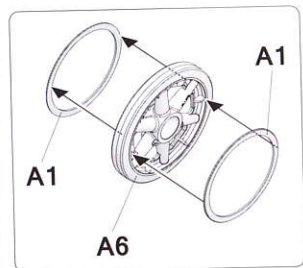
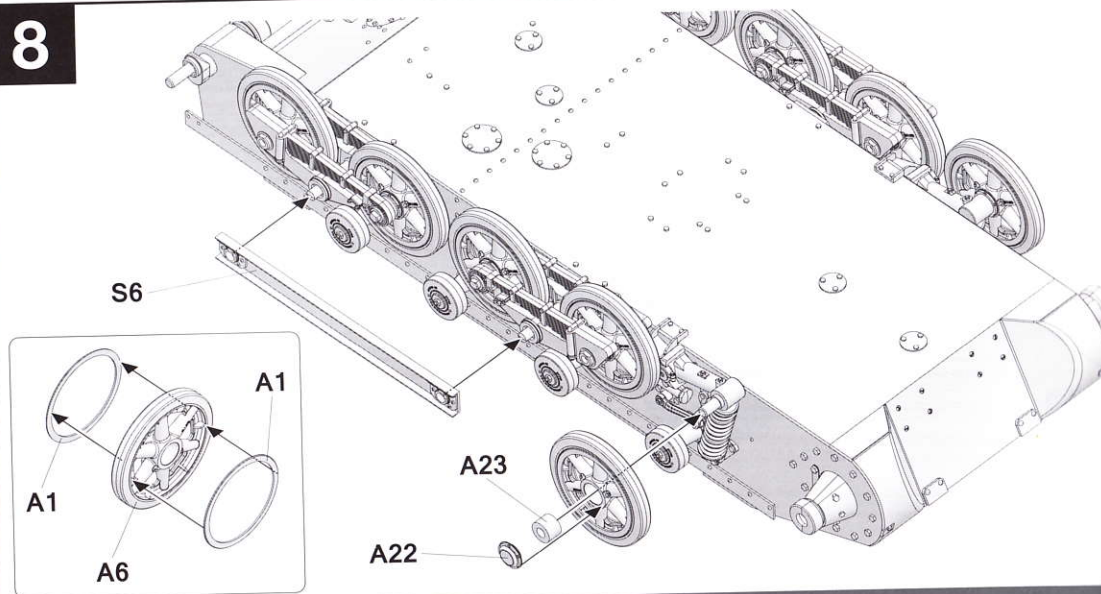

5

9

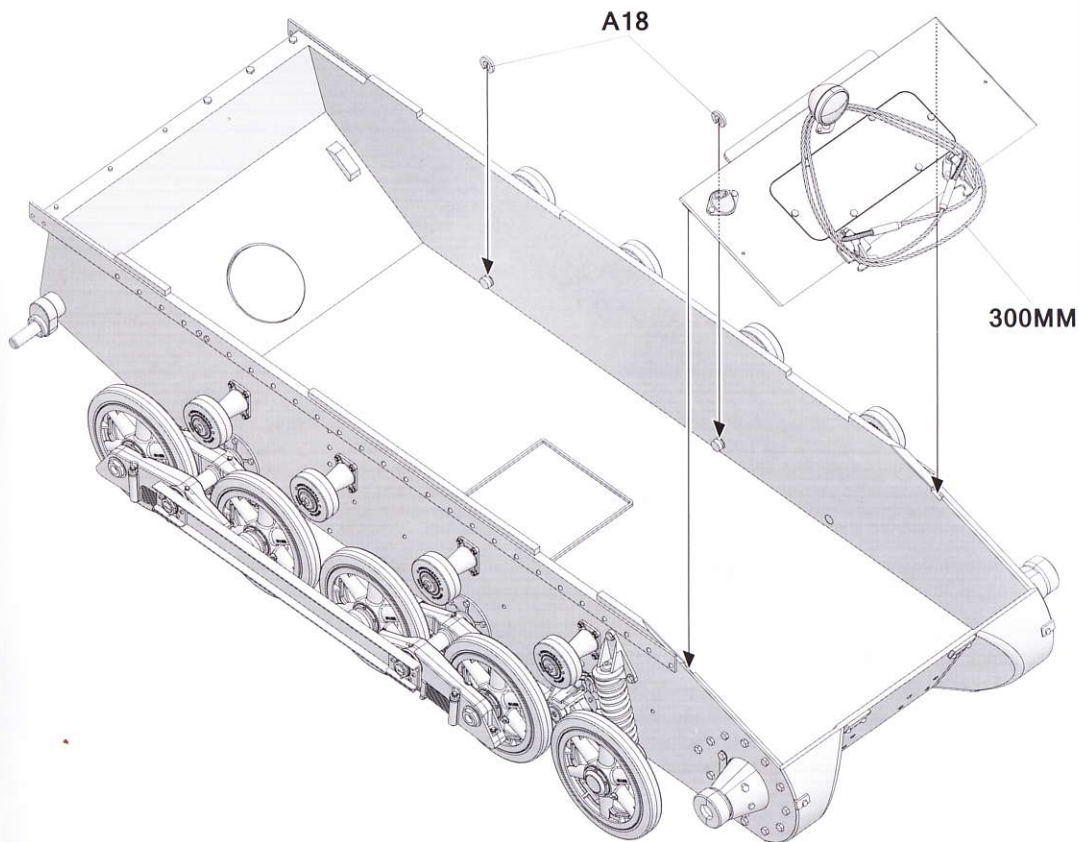
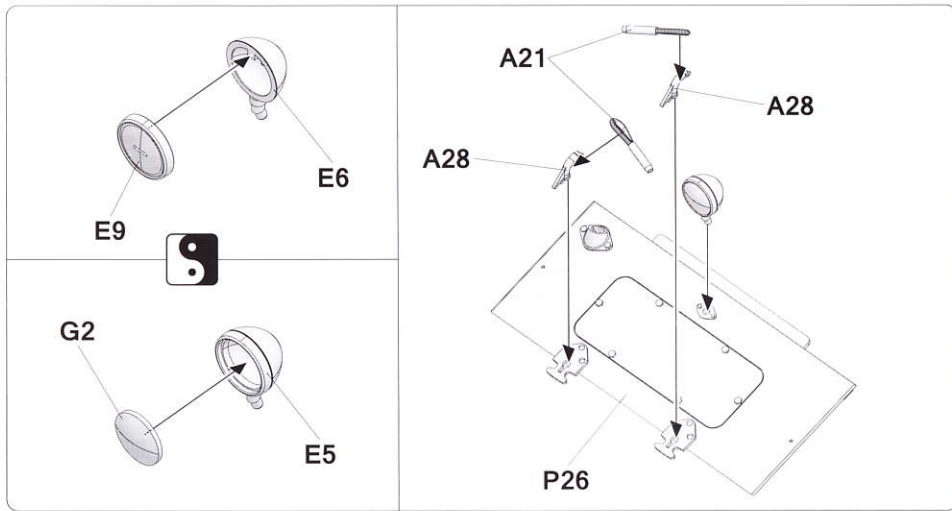

10

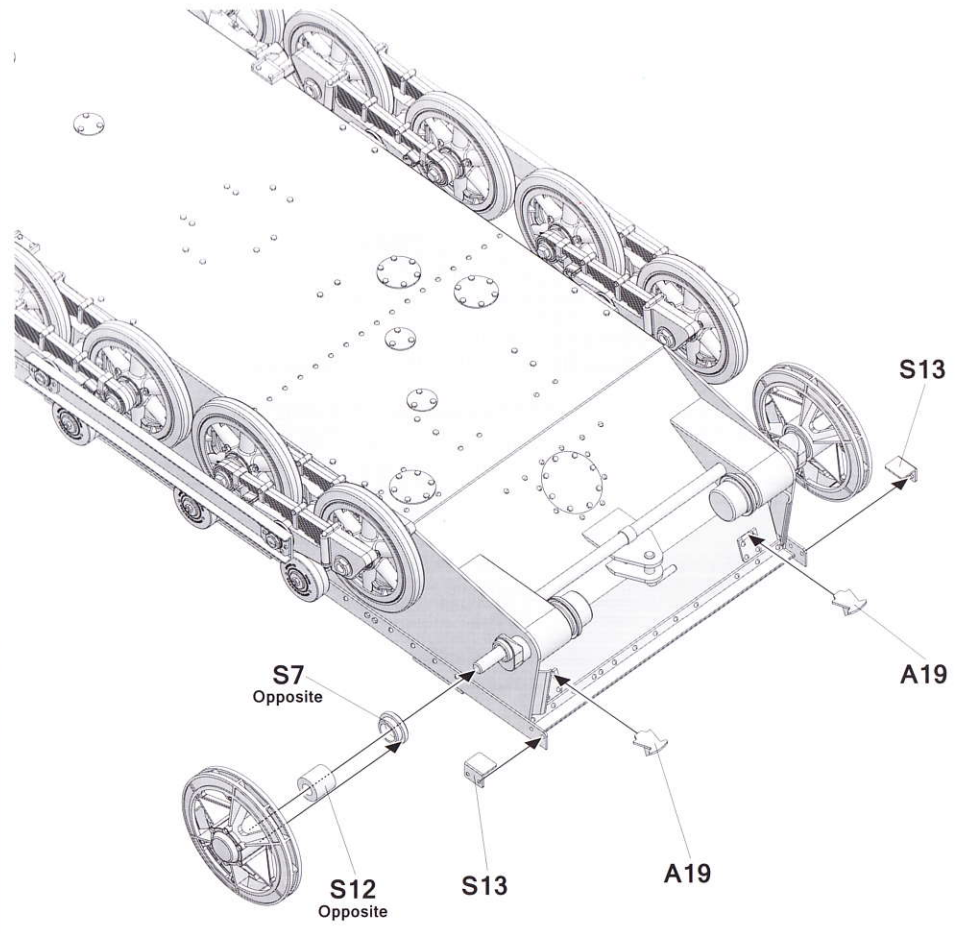
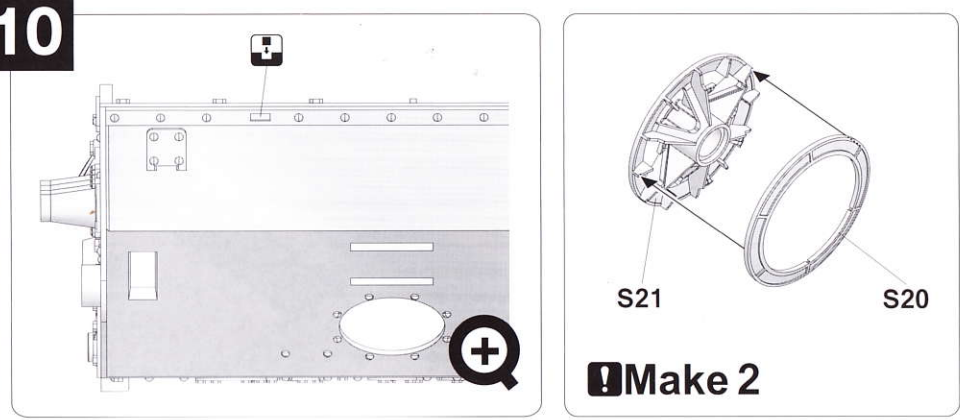

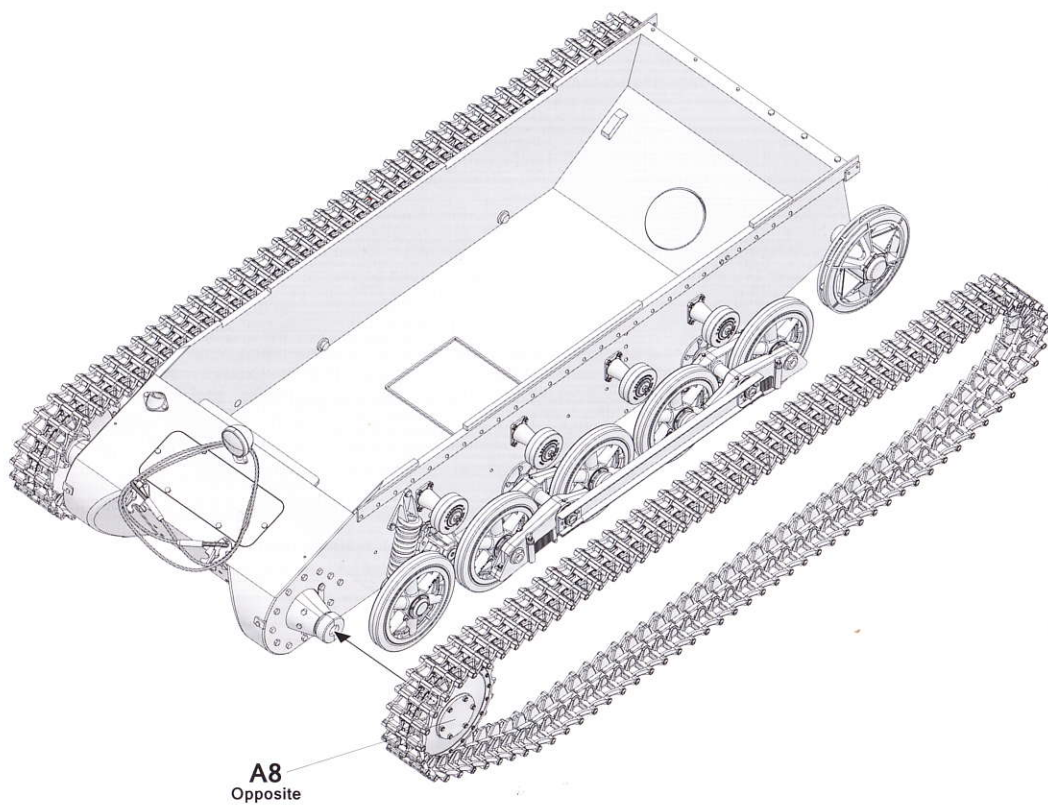
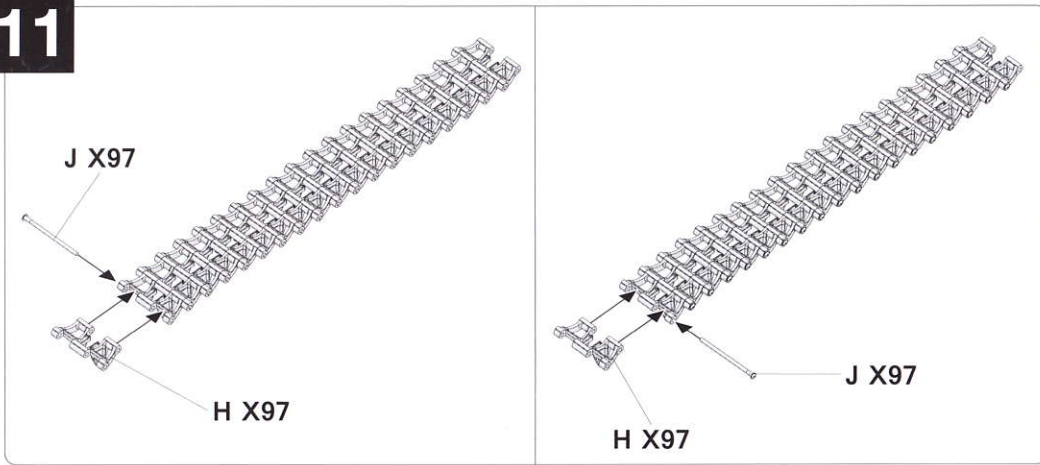
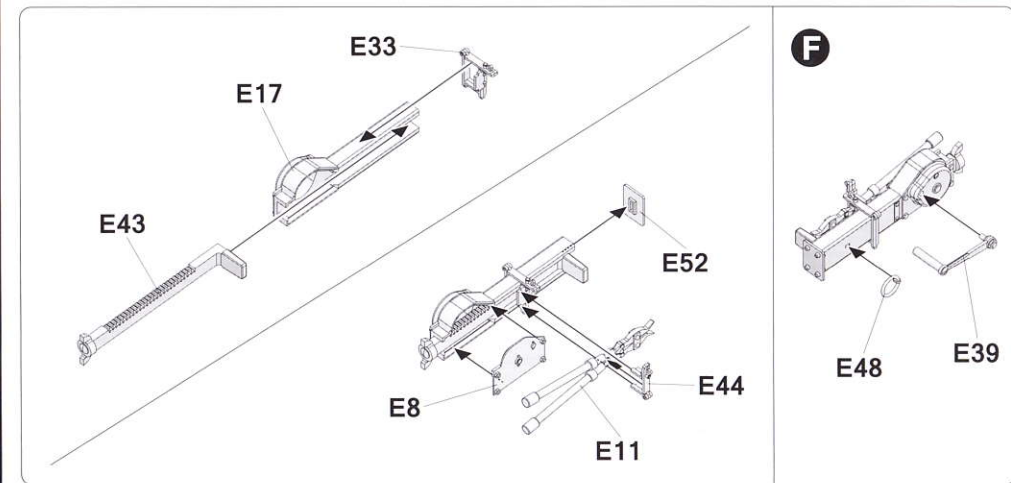
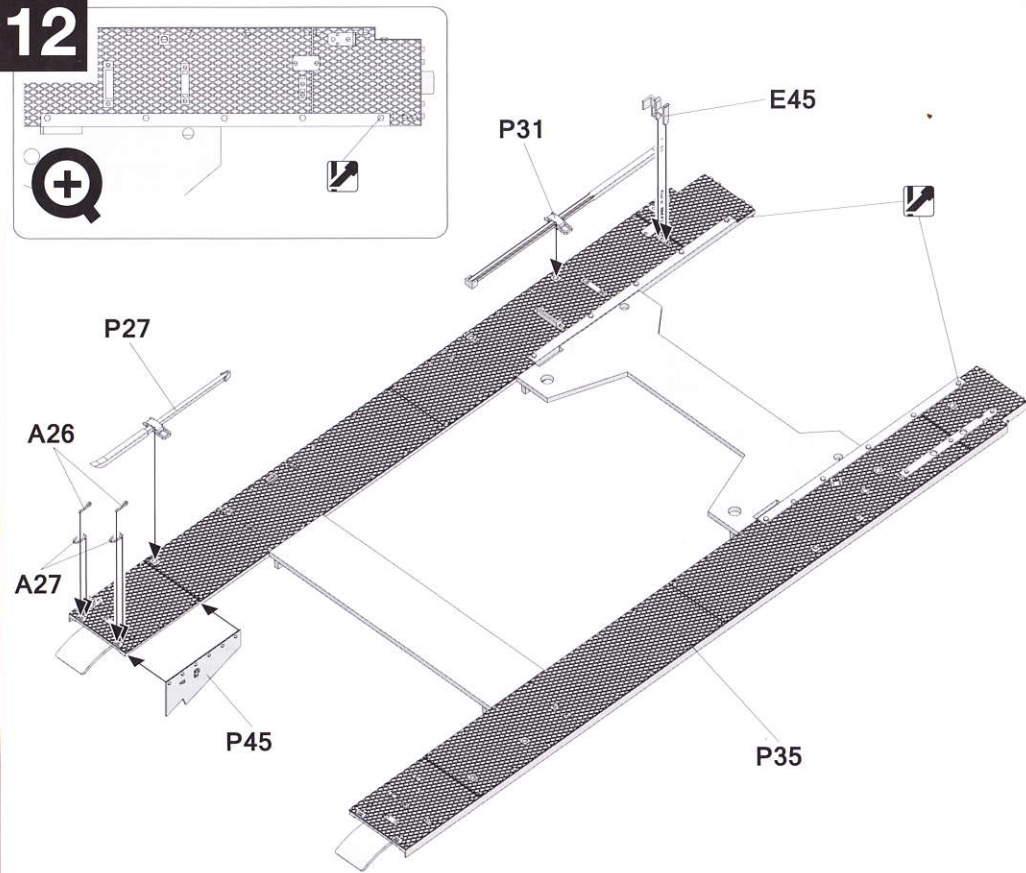
11**12**

13

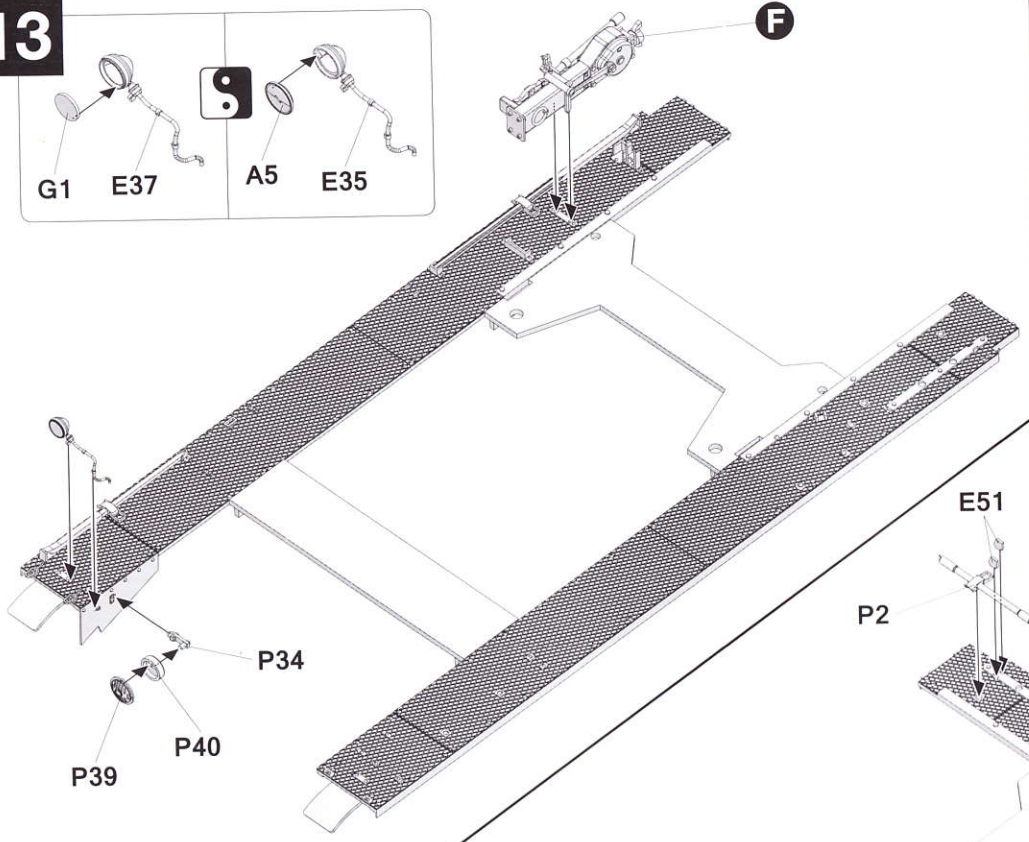
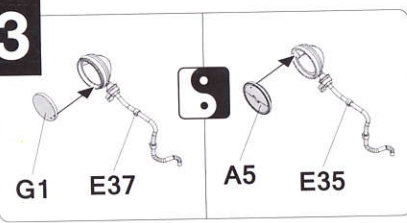

15

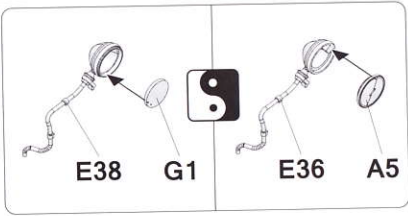
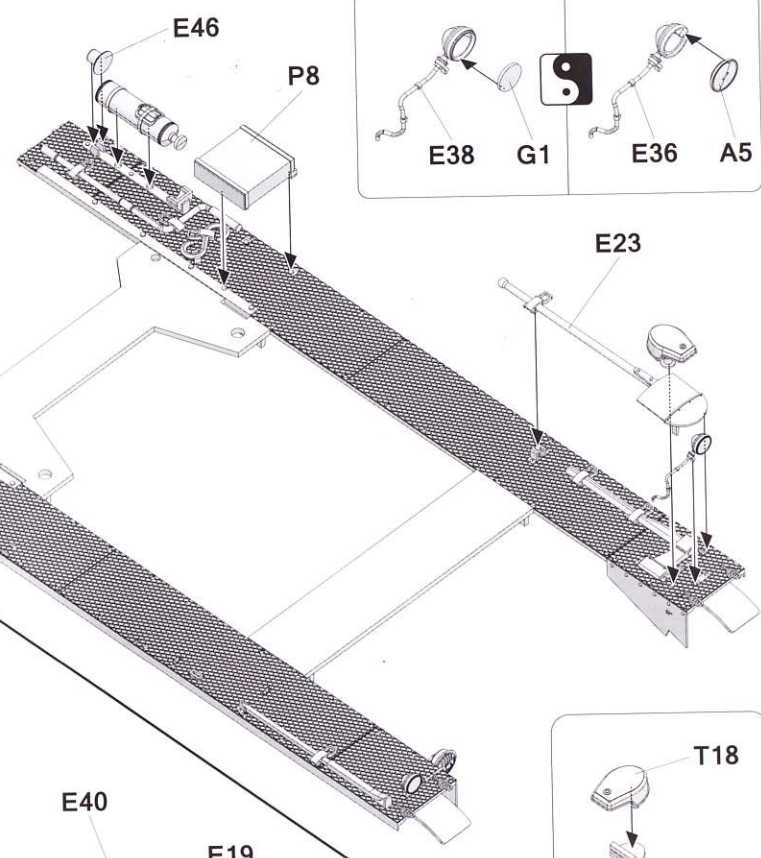
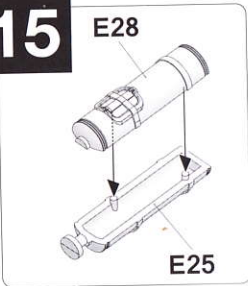

14

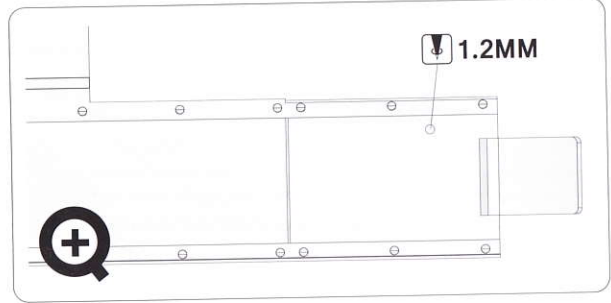

16

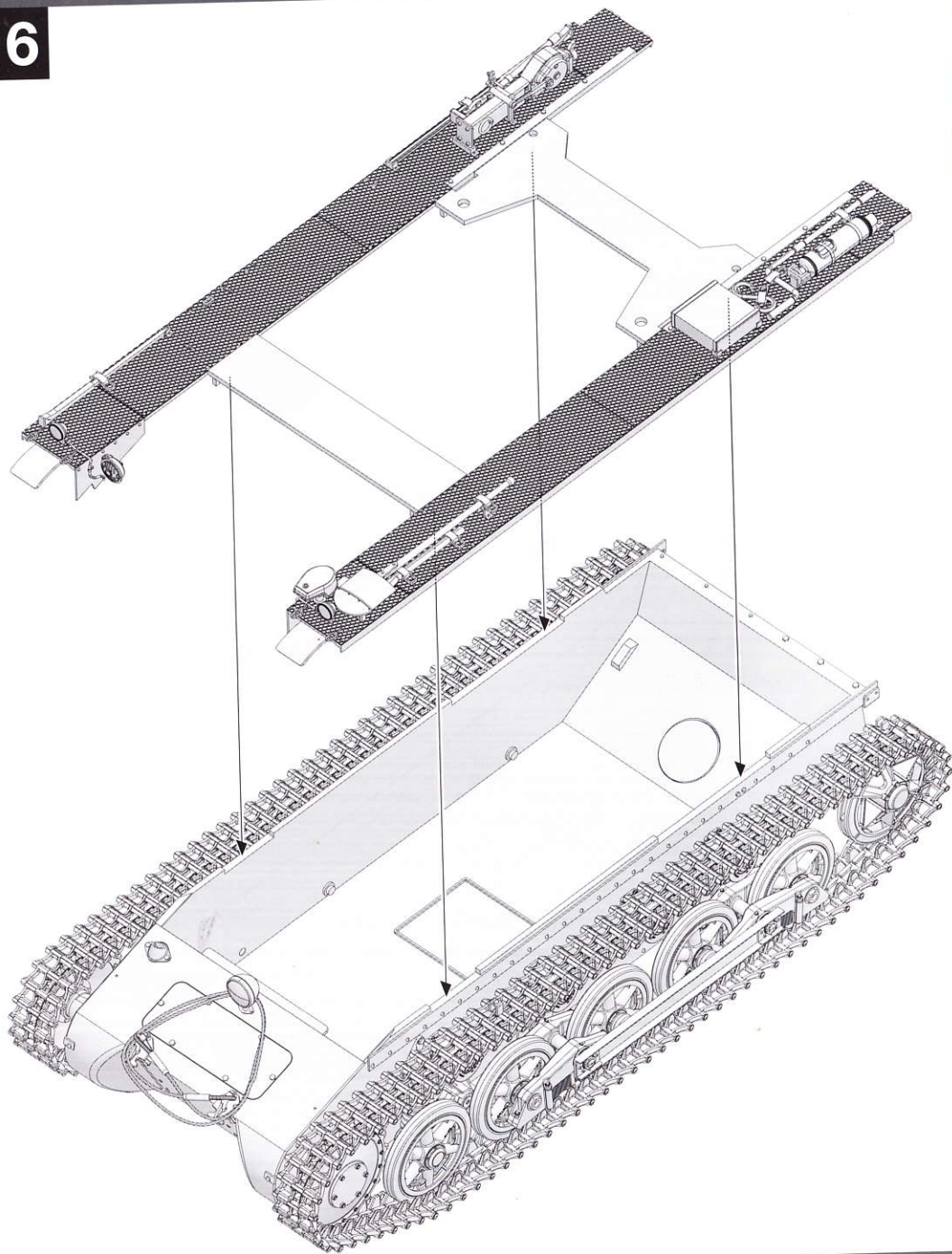

17

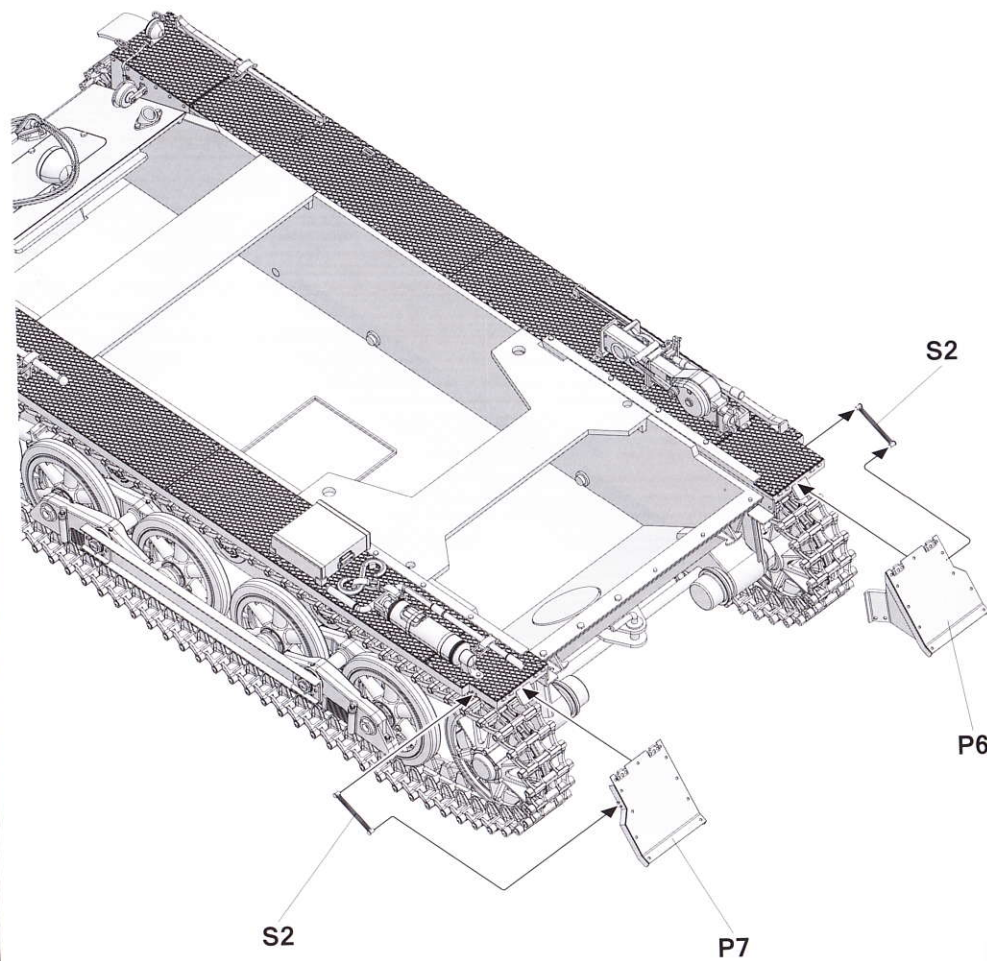

18

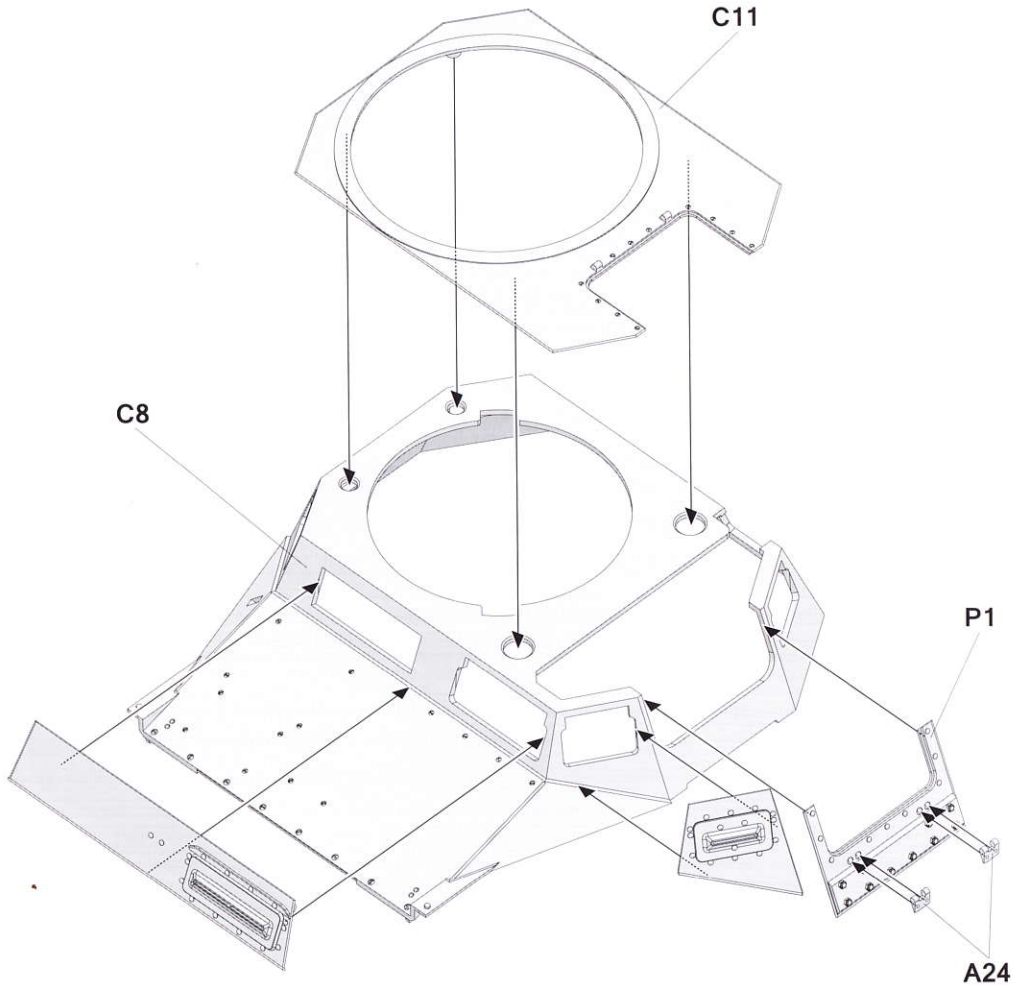
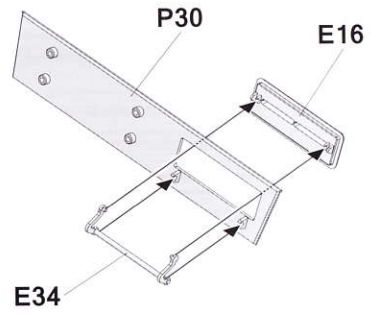
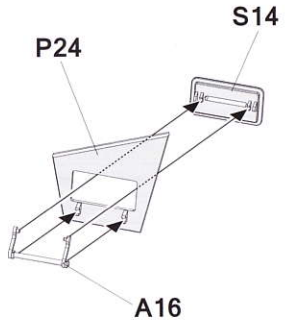

19

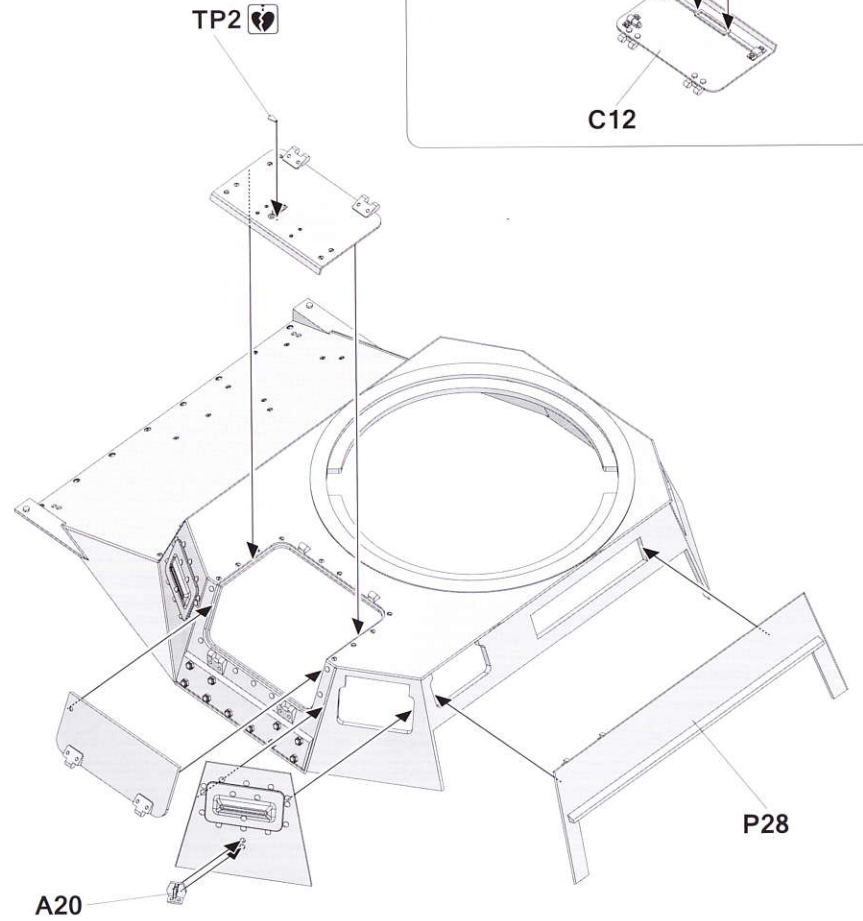
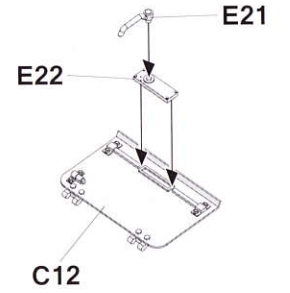
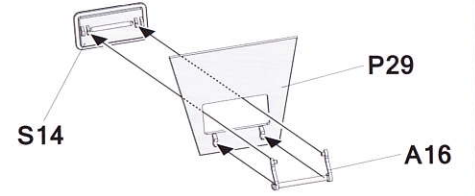
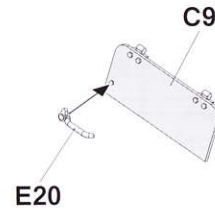

20

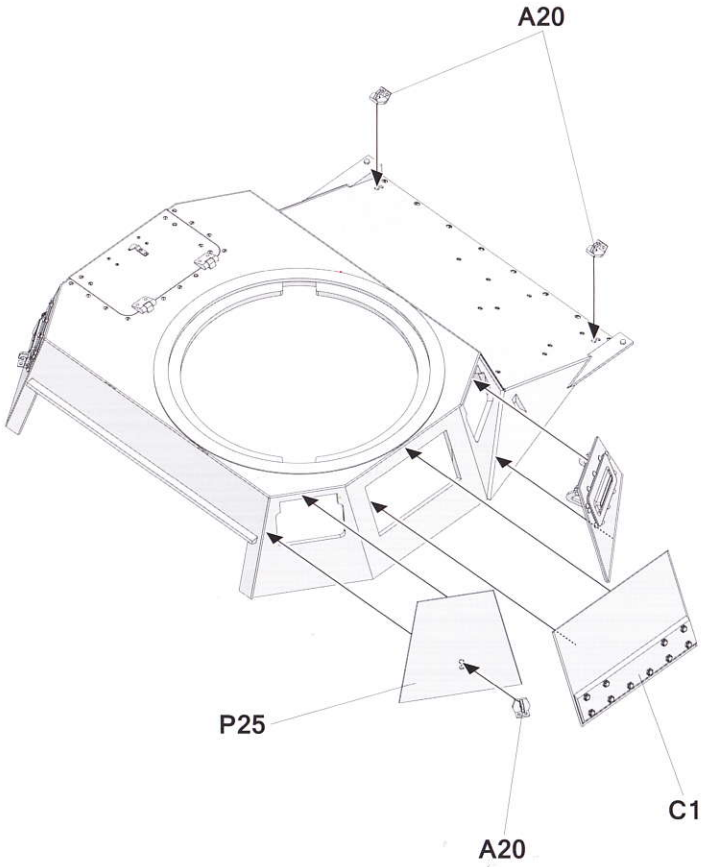
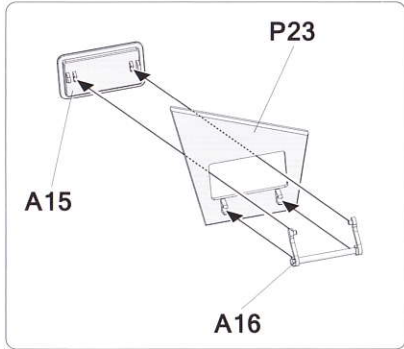

21

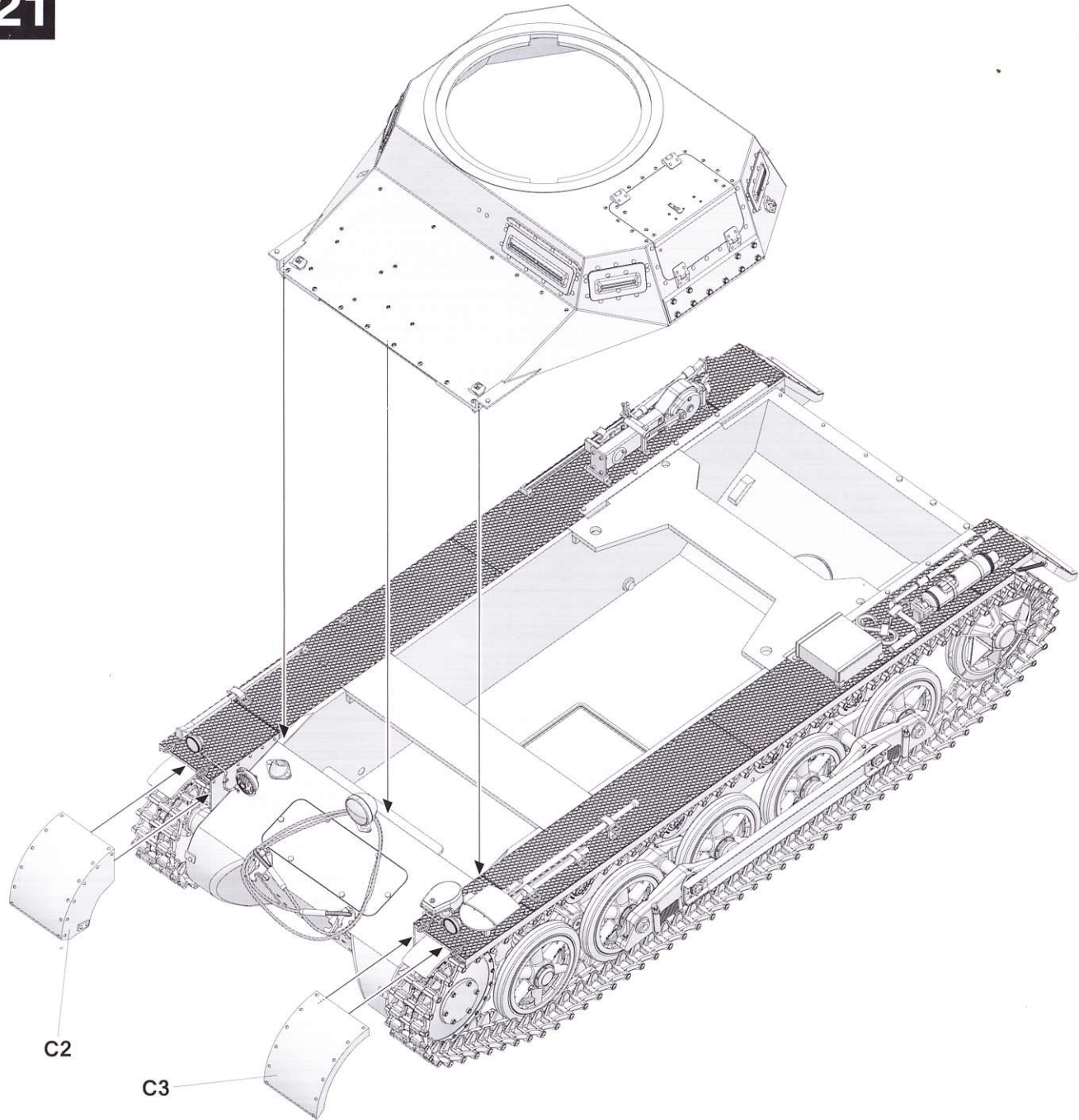

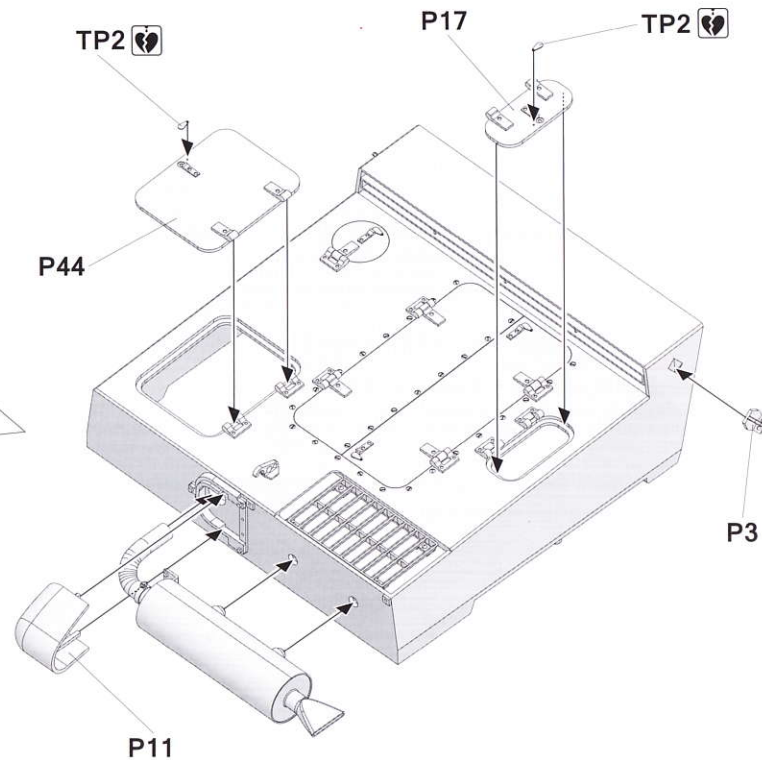
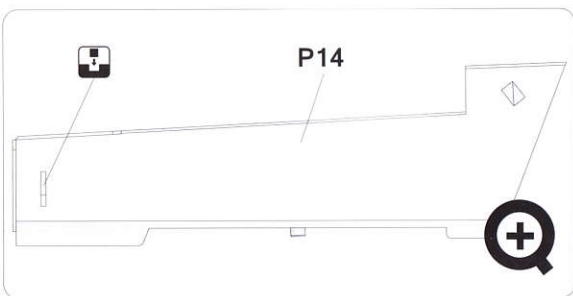
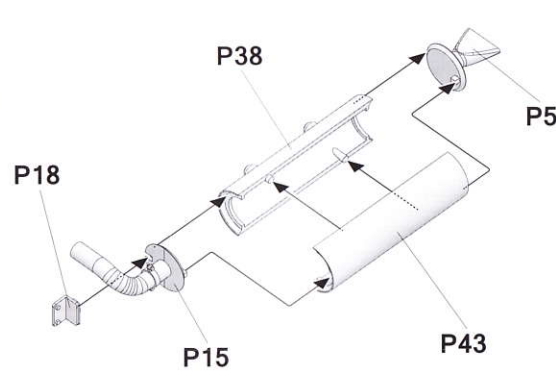
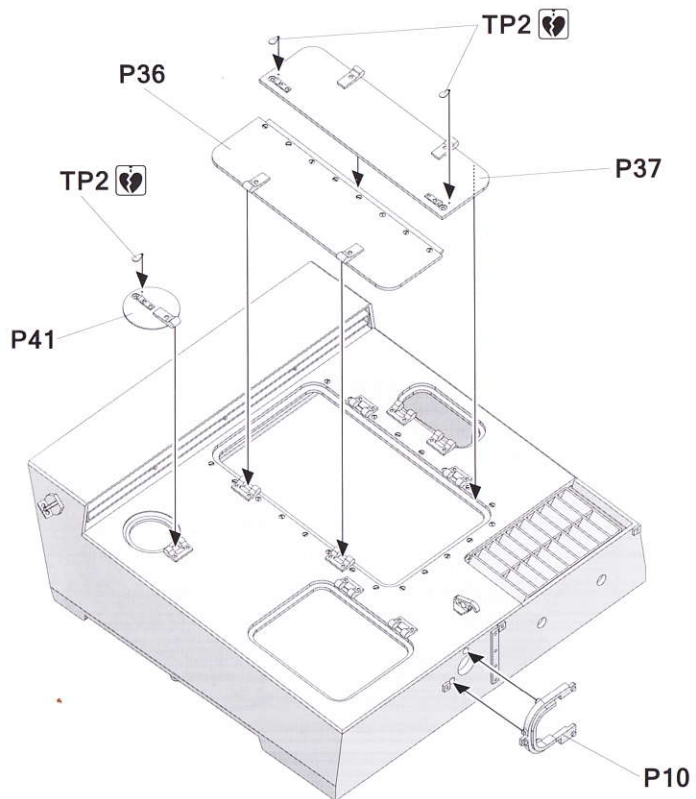
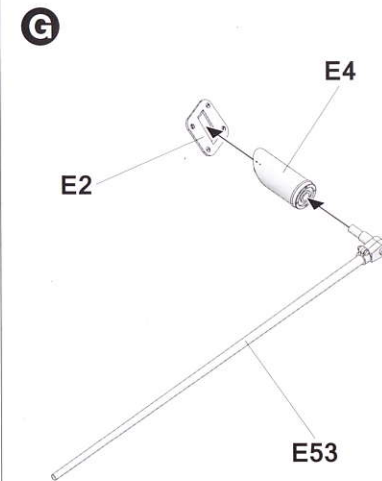
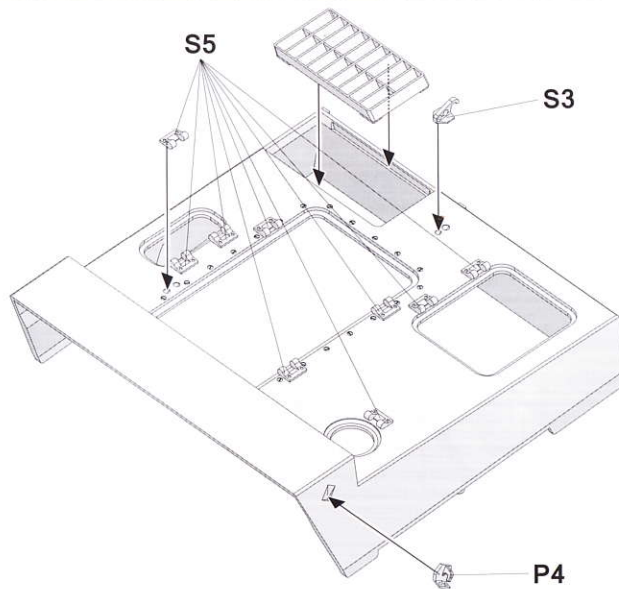
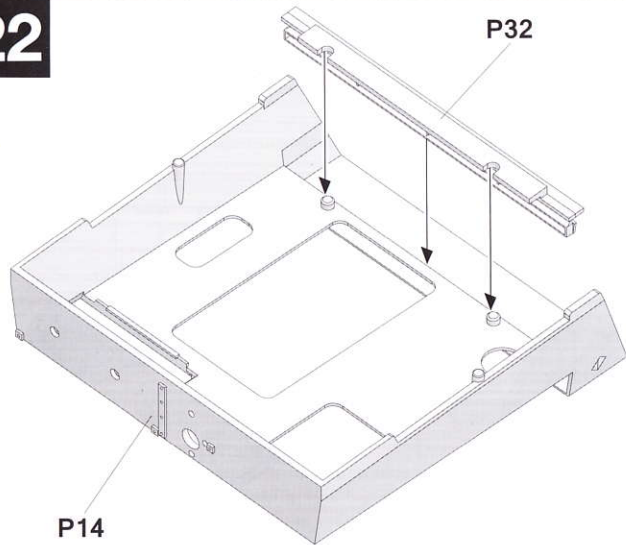

23

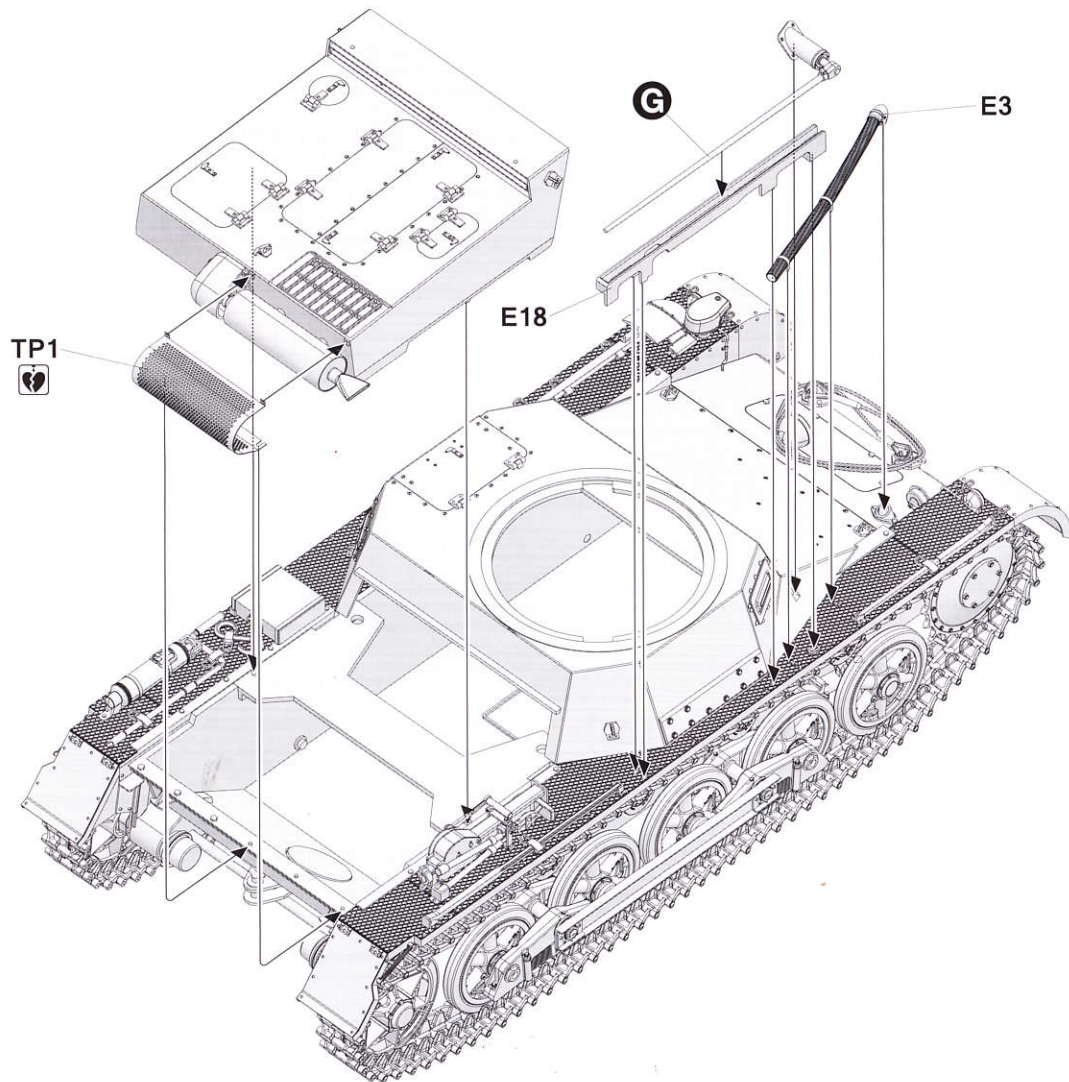
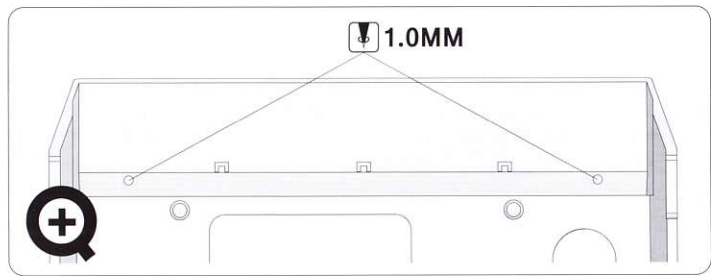

24

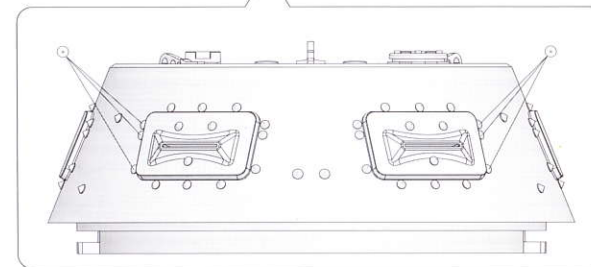
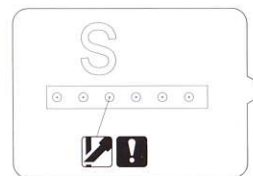
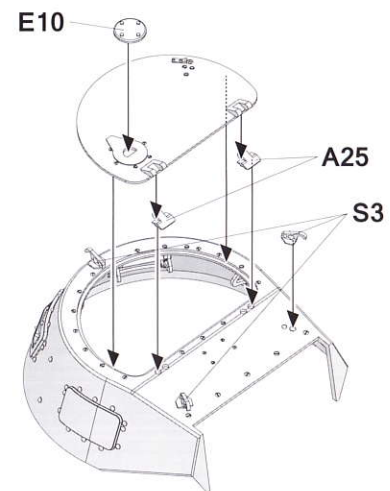
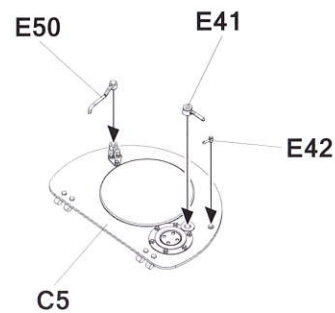
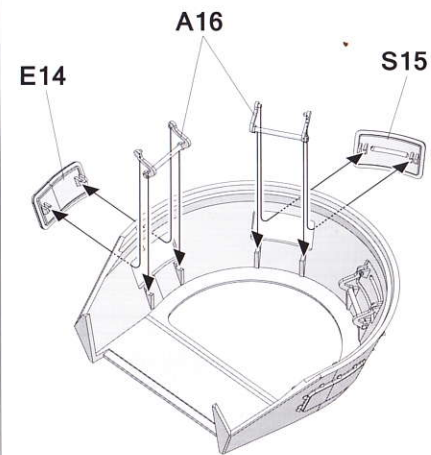
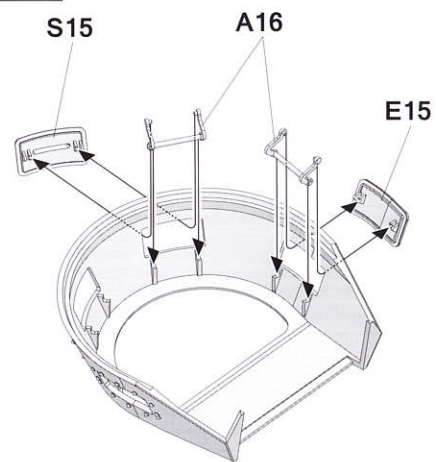

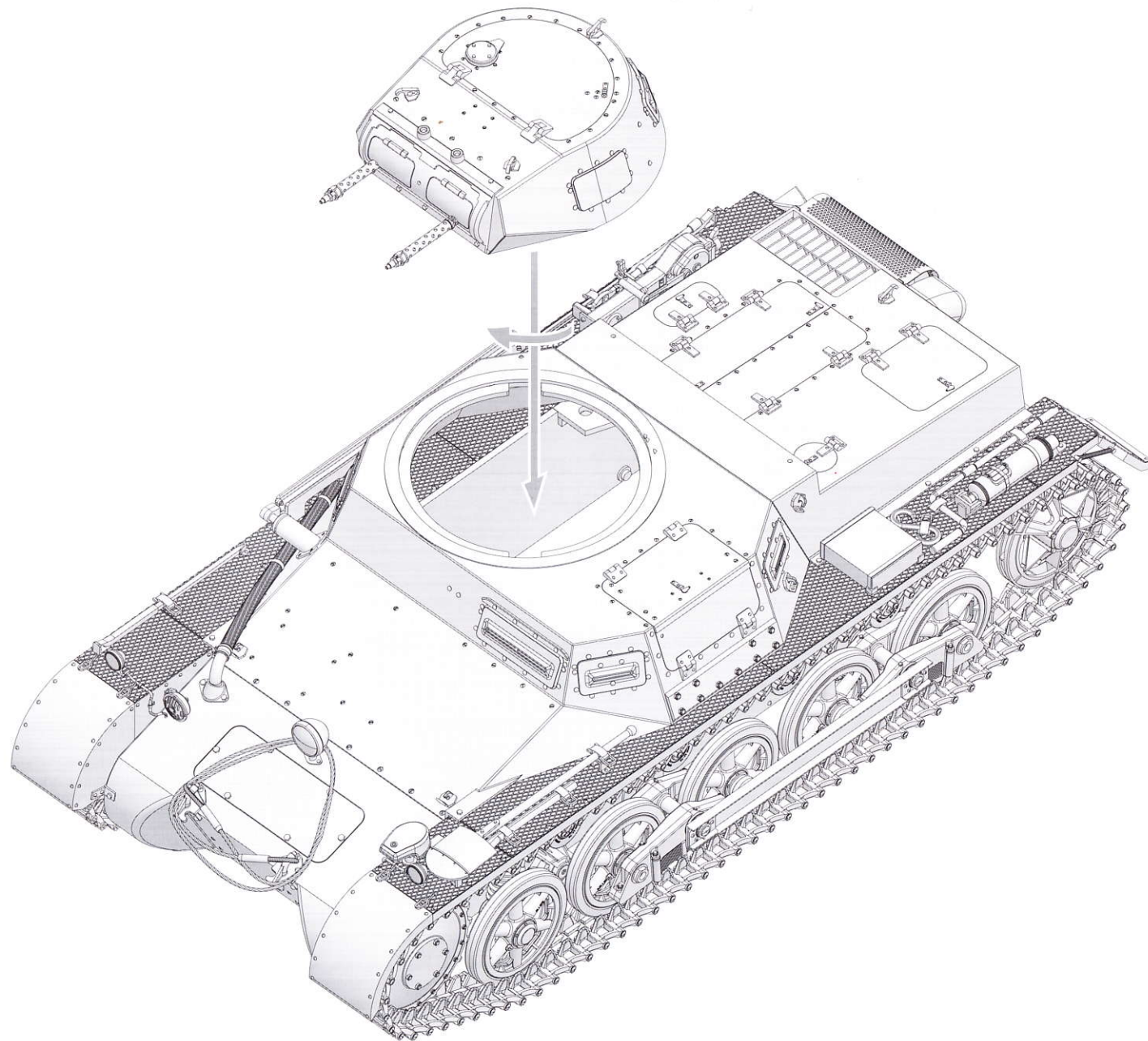
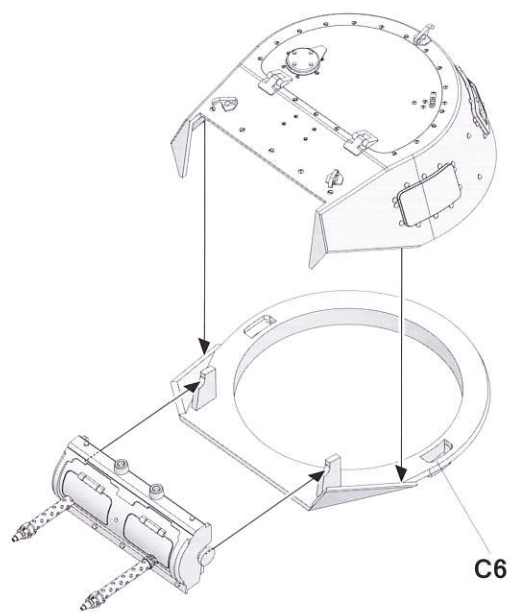
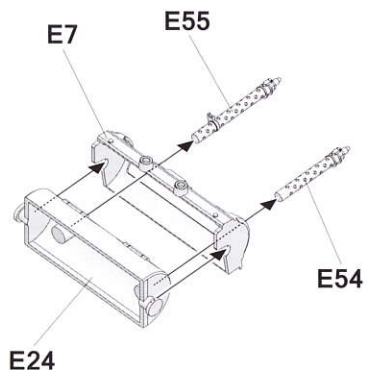

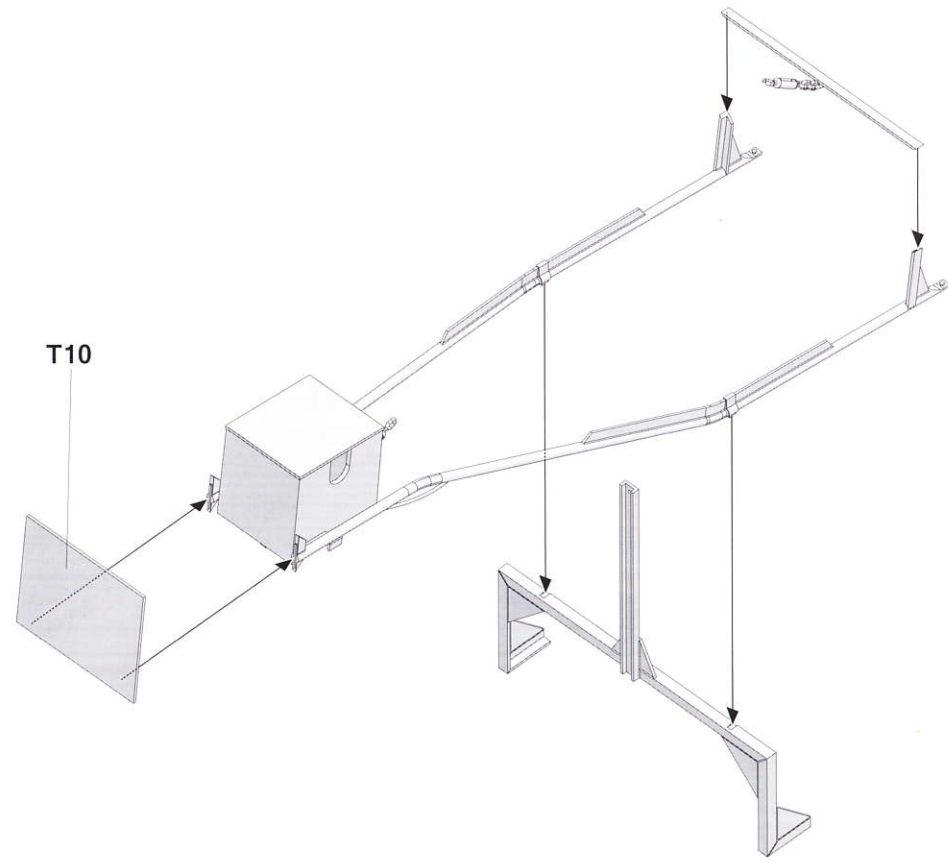
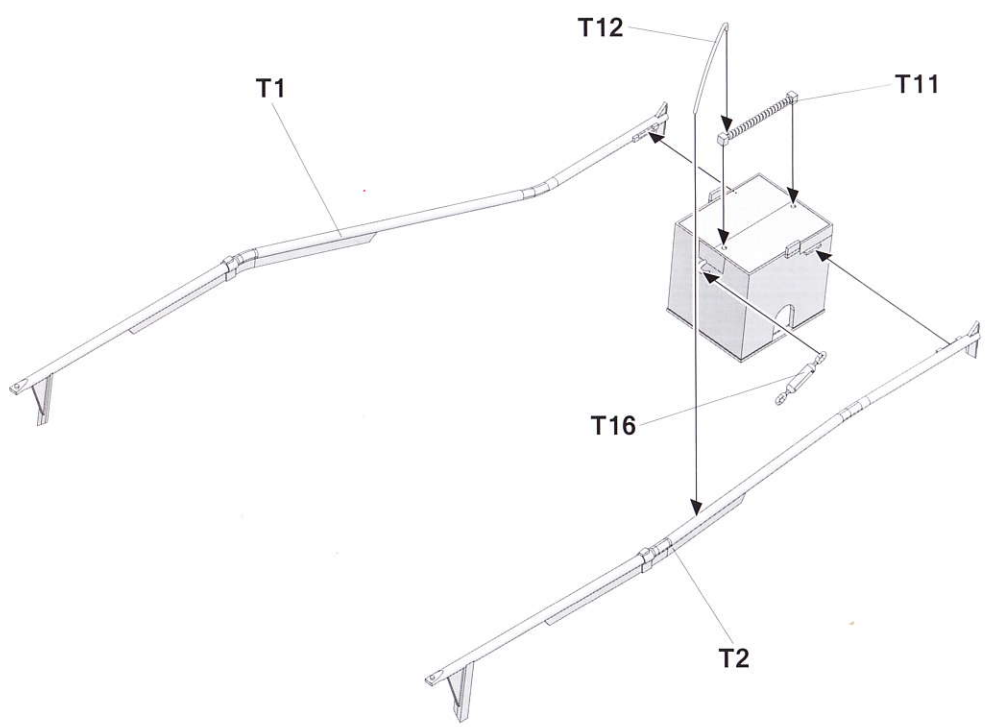
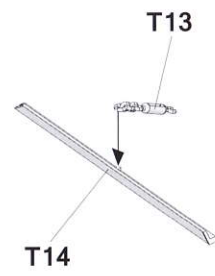
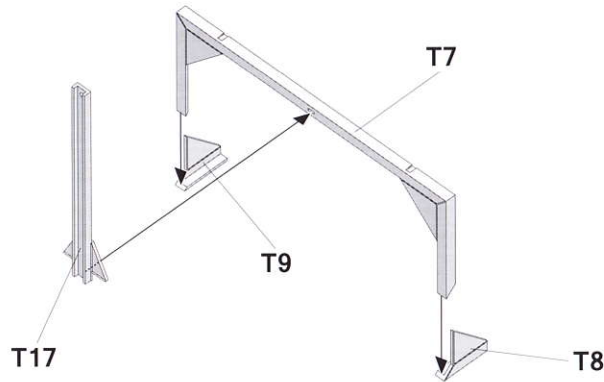
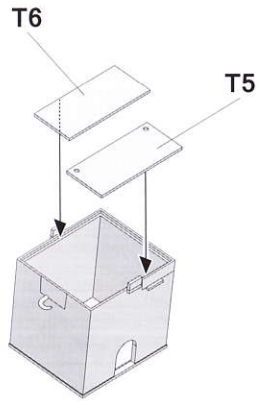
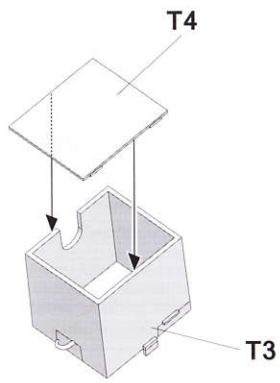

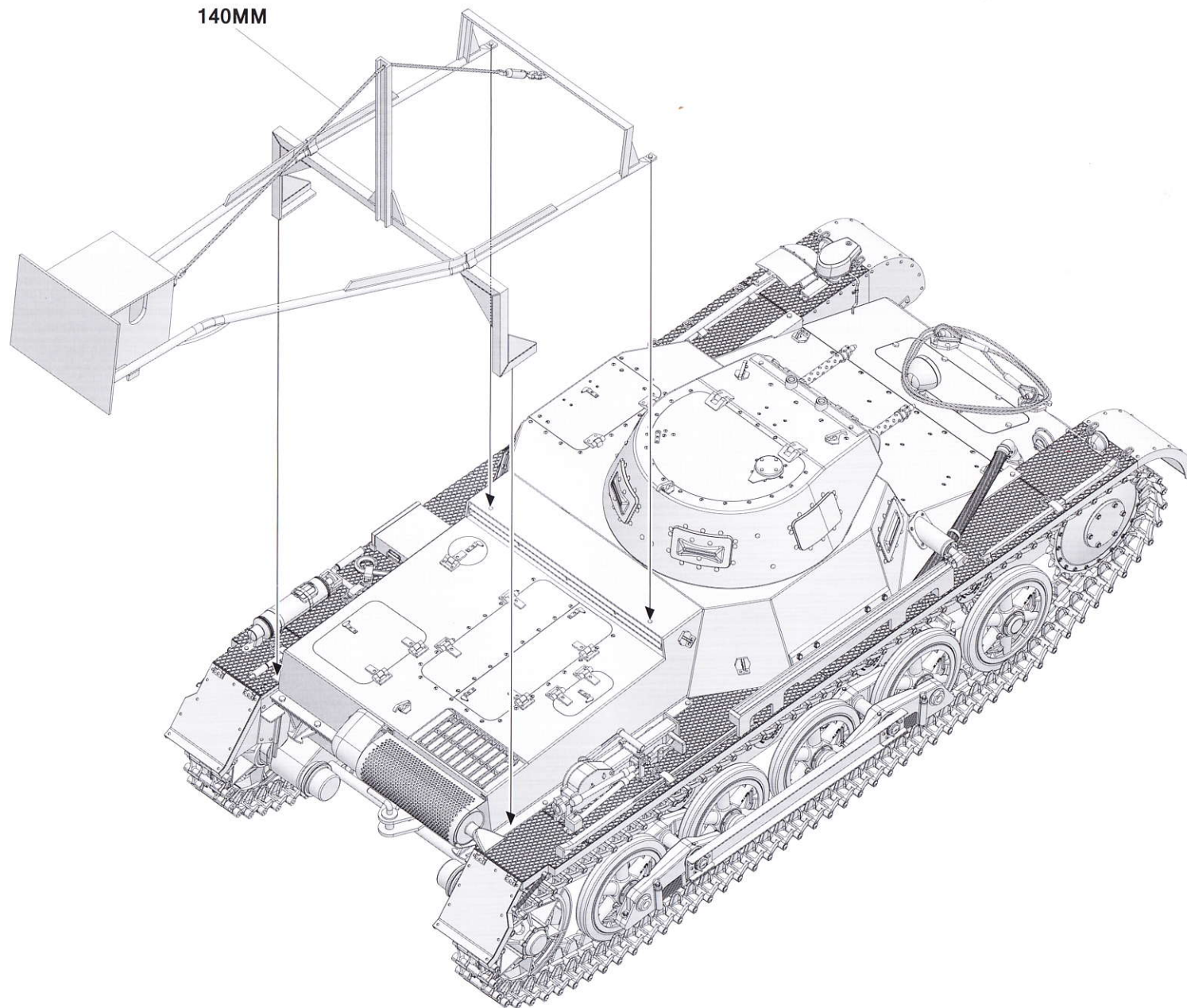

Painting and Marking Guide

A.MIG-0033 Rubber & Tires

A.MIG-0035 Dark Traks

A.MIG-0045 Gun Metal

A.MIG-0041 Dark Rust

TAKOM Ref: 1012

A.MIG-0008 RAL 7021 Olivgrün opt.1

A.MIG-0036 Old Wood

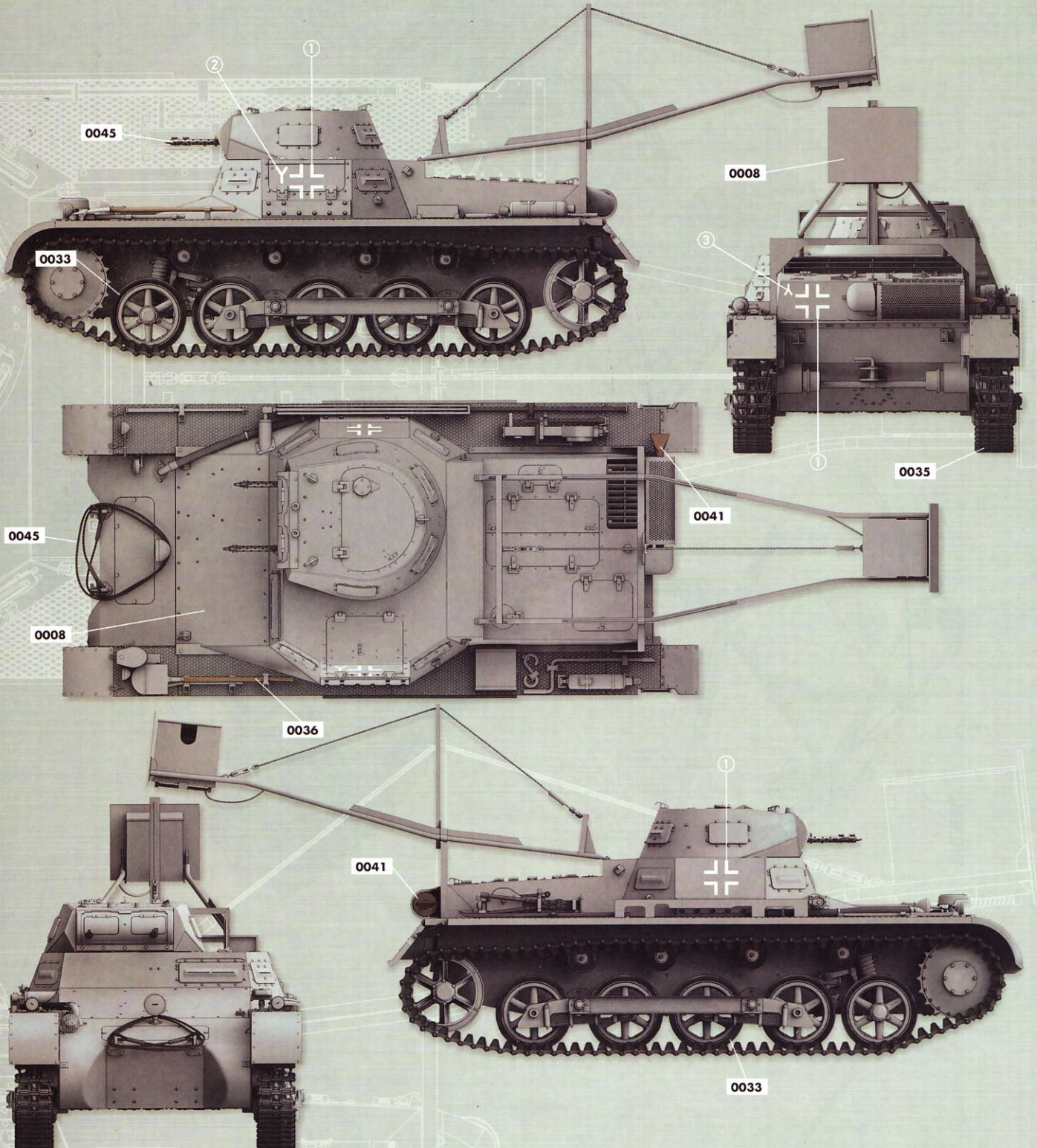

WEATHERING STEPS WITH AMMO PRODUCTS

1 GENERAL WASH

A.MIG-1006 Blue Wash for Panzer Grey

2 FILTER

A.MIG-1502 Dark Grey for White

3 STREAKING

A.MIG-1206 Dark Streaking Grime

4 TRACKS WASH

A.MIG-1002 Tracks Wash

5 RUST

A.MIG-1254 Streakingbrusher Rust

6 DUST

A.MIG-3004 Europe Earth

7 MUD & SPLASHES

A.MIG-1751 Dry Steppe

8 GREASE & OIL

A.MIG-1408 Fresh Engine Oil

PANTHER AUSF. G EARLY PRODUCTION w/Zimmerit



Zimmerit Pattern created by JASON

- ▲ ALL HATCHES CAN BE BUILT IN OPEN OR CLOSED POSITION
- ▲ TRACK ASSEMBLY IS AIDED WITH THE USE OF A JIG
- ▲ DETAILED STATIC DISPLAY PLASTIC MODEL
- ▲ LINKLENGTH STYLE TRACKS INCLUDED
- ▲ 5 TYPES OF MARKINGS
- ▲ FIGURE NOT INCLUDED
- ▲ PE INCLUDED

1/35
No. 2134



JASON 2020

▲ THIS IS NOT A TOY ▲ INTENDED FOR COLLECTORS OF AGE 14 YEARS AND ABOVE
▲ CEMENT AND PAINT NOT INCLUDED ▲ MODEL MAY VARY FROM IMAGE ON BOX ▲ READY TO ASSEMBLE PRECISION MODEL KIT

BERGEPANZER 2A2



- ▲ DETAILED STATIC DISPLAY PLASTIC MODEL
- ▲ ARTICULATING RECOVERY BOOM
- ▲ PE & CLEAR PARTS INCLUDED
- ▲ FIGURE NOT INCLUDED
- ▲ 8 TYPES OF MARKINGS
- ▲ WORKABLE TRACKS

1/35
No. 2135

Design supported by JASON

▲ THIS IS NOT A TOY ▲ READY TO ASSEMBLE PRECISION MODEL KIT
▲ MODEL MAY VARY FROM IMAGE ON BOX ▲ CEMENT AND PAINT NOT INCLUDED ▲ INTENDED FOR COLLECTORS OF AGE 14 YEARS AND ABOVE

JASON 2020

M60A3 w/ M9 BULLDOZER



- ▲ ALL HATCHES CAN BE BUILT IN OPEN OR CLOSED POSITION
- ▲ DETAILED STATIC DISPLAY PLASTIC MODEL
- ▲ PE/CLEAR PARTS INCLUDED
- ▲ 4 TYPES OF MARKINGS
- ▲ ONE-PIECE TRACKS

1/35
No. 2137

JASON 2020

▲ THIS IS NOT A TOY ▲ INTENDED FOR COLLECTORS OF AGE 14 YEARS AND ABOVE ▲ CEMENT AND PAINT NOT INCLUDED ▲ MODEL MAY VARY FROM IMAGE ON BOX ▲ READY TO ASSEMBLE PRECISION MODEL KIT

Pz.Kpfw.III Ausf.M mit schürzen

- ▲ ALL HATCHES CAN BE BUILT IN OPEN OR CLOSED POSITION
- ▲ DETAILED STATIC DISPLAY PLASTIC MODEL
- ▲ LINK & LENGTH STYLE TRACKS INCLUDED
- ▲ 4 TYPES OF MARKINGS
- ▲ PE PARTS INCLUDED

1/35
No. 8002



▲ THIS IS NOT A TOY
▲ CEMENT AND PAINT NOT INCLUDED
▲ MODEL MAY VARY FROM IMAGE ON BOX
▲ READY TO ASSEMBLE PRECISION MODEL KIT
▲ INTENDED FOR COLLECTORS OF AGE 14 YEARS AND ABOVE

JASON 2019

2021/1012

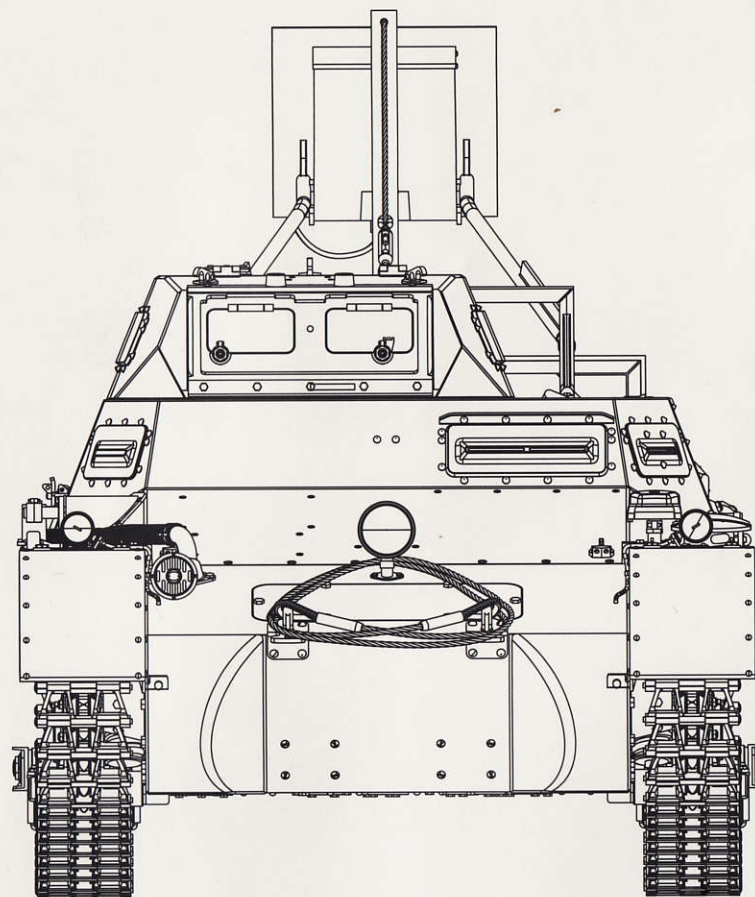

You can find TAKOM on Facebook.com