

F-15I IAF Ra'am

G.W.H.®

1/48
SCALE

L4816

以色列空军F-15I攻击鹰战斗机



The Israeli Air Force (IAF) was the first foreign buyer of the F-15 fighter series. In 1980's, IAF discovered its lack of capability in long range anti-ground attack missions. The gap was covered by acquiring the F-15 Fighters with its large weapon load and long range. The F-15s were modified to load precision-guided weapon such as GBU-15 and conformal fuel tanks (CFT) were added which were still under testing at the time. On October 1, 1985, in response to a terrorist attack, the Israeli air force carried out Operation "Wooden Leg". The strike involved the bombing of PLO Headquarters in Tunis by F-15 Eagles. This was the longest combat mission ever undertaken by the IAF, a stretch of 2,300 kilometres, involving in-flight refuelling. As a result PLO headquarters and barracks were either destroyed or damaged. The action promoted USAF's project of F-15E. In the next year it beat the General Dynamics' competitor F-16XL and in 1988 F-15E came into service.

As a dual-role long range fighter for attack and interception was urgently needed, IAF ordered the F-15E in 1994. The F-15I - arguably the best of its type in the Middle

Eastern arena - entered service in January of 1998, and became the IAF's leading aeroplane. It is a special version of the F-15E Strike Eagle that was designed specifically for Israel by McDonnell Douglas (now Boeing). It utilizes lots of special instruments designed by IAF themselves. Its tremendous payload capacity, combined with its advanced systems, enable it to carry out attacks with a large weapons load at long ranges and low altitude, 24 hours a day and in any weather conditions. Due to its high price (more than 1 billion USD each), only 25 aircraft were purchased. 24 planes entered the 69 "Hammers" Squadron, which is the combat unit with the longest history in IAF. The remaining one (No.201) was provided to 601 Squadron (Flight Test Center) in Tel Nof Airbase (Air Force Base 8) for weapon loading tests. The painting scheme of No.201 in the kit is for the aforementioned testbed F-15I. On Jan 1, 1999, F-15Is in 69 "Hammers" Squadron completed training and the first combat missions were flown in Lebanon on 11 January 1999. They attacked the terrorist in Lebanon with laser-guided bombs under target designation by AN/AAQ-13 LANTIRNAN navigation pods.

以色列空军是F-15系列战斗机的第一个海外用户，进入1980年代，以色列空军现有的对地攻击机在远程奔袭任务方面显得鞭长莫及，于是将目光转向具备强大挂载能力且航程较远的F-15战斗机身上，他们对F-15战斗机进行改装，使其能挂载GBU-15等精确制导炸弹，并且安装了尚在试验阶段的保形油箱（CFT）。在1985年10月1日，这些改进过的F-15进行了首次对地打击实战，长途奔袭远在突尼斯海岸的巴解总部（木腿行动），取得重大成功。这次行动对美国空军的F-15E“攻击鹰”计划起到了巨大的推动作用。次年，F-15E击败了F-16XL，1988进入美国空军服役。

F-15E服役后，出于远程打击作战的需要，以色列空军对其产生了巨大的兴趣。在1994年向美国订购了F-15E的以色列定制款，该型号配备了大量以色列自己研发的系统，就是今天的F-15I。F-15I成为以色列空军最先进的打击平台。由于采购成本高昂（每架飞机售价接近1亿美元！），最终只采购了25架，装备给历史悠久的轰炸机中队—第69“锤子”中队。这25架飞机中，除了24架装备给“锤子”中队，剩余的一架飞机（201号）配属给特尔诺夫基地的空军试飞评估中队，用于武器挂载测试。本套件中的201号机涂装方案就是测试中队装备的那架飞机。69中队的F-15I在1999年1月1日形成战斗力，并在当月进行了首次实战，用“兰盾”吊舱引导激光制导炸弹对黎巴嫩境内的恐怖分子目标实施了精确打击。

注意事項 CAUTION 組み立てのご注意

- (1) 勿于近火处使用胶水或油漆, 并打开窗户保持空气流通。
- (2) 涂料的号码请参考本栏以下的说明。本品本身不包括胶水和涂料。
- (3) 自板件中取出部件时, 应用模型专用剪, 并用介刀或小锉除去多余胶料。
- (4) 各图形的含义可参考本栏以下说明。

- (1) When you use glue or paint, do not use near a open flame, and use in a well-ventilated room.
- (2) See below for the color list. Glue and paint are not included in the kit.
- (3) When you take parts off the runner frame, use the modeling scissors and trim excess plastic with a cutter or a file.
- (4) See below for the meaning of symbols.

- (1) 接着剤や塗料は火の近くで使わないで下さい、使用の際は換気をよくして下さい。
- (2) 塗料指定のは下記のとおりです、接着剤や塗料は入っていませんので別に求めて下さい。
- (3) 部品のランナーから切り離す時は模型用ハサミ等を使い、余分な部分はカッターやヤスリ等で仕上げて下さい。
- (4) 組立図のサインマークは下の説明を御覧下さい。

图形含义 CAUTION マーク

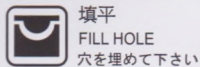

填平
FILL HOLE
穴を埋めて下さい

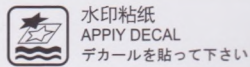

水印粘紙
APPLY DECAL
デカールを貼って下さい

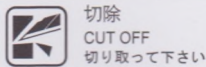

切除
CUT OFF
切り取って下さい

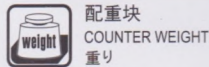

配重块
COUNTER WEIGHT
重り

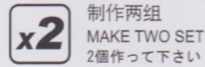

制作两组
MAKE TWO SET
2個作って下さい

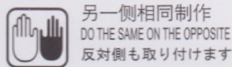

另一側相同制作
DO THE SAME ON THE OPPOSITE
反対側も取り付けます

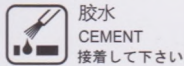

胶水
CEMENT
接着して下さい

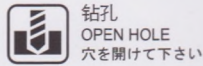

钻孔
OPEN HOLE
穴を開けて下さい

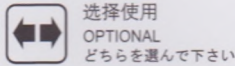

选择使用
OPTIONAL
どちらを選んで下さい

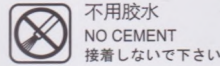

不用胶水
NO CEMENT
接着しないで下さい

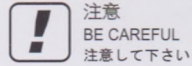

注意
BE CAREFUL
注意して下さい

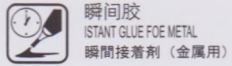

瞬間胶
INSTANT GLUE FOR METAL
瞬間接着剤 (金属用)

所使用工具 RECOMMENDED TOOLS 専用工具

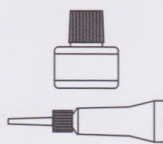

塑胶件用模型胶水
Cement
プラスチック用接着剤

模型用瞬間胶水
Instant Cement
瞬間接着剤

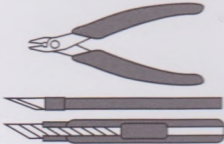

模型用剪钳
Side cutters
模型用ニッパー

模型用刻刀
Modeling knife
模型用ナイフ

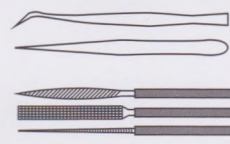

模型用镊子
Tweezers
ピンセット

模型用锉刀
Diamond file
模型用ヤスリ

水贴纸使用说明 DECAL APPLICATION スライドマークの貼り方

- (1) 用模型剪刀或刻刀切下所需的图案部分。
- (2) 将水贴纸浸泡在温水中10秒左右取出放置于戏水的干布上。
- (3) 手拿着水贴纸基的一角, 用模型镊子小心夹住浮起的水贴图案移至模型表面准确位置。
- (4) 用手指适当沾水均匀涂于水贴图案表面, 使其延展移动至精确位置。
- (5) 用柔软吸水的干布将水贴图案中的气泡向一边挤掉, 使水贴在模型表面保持平整。

- (1) Cut off decal from sheet.
- (2) Dip the decal in tepid water for about 10 sec. and place on a clean cloth.
- (3) Hold the backing sheet edge and slide decal onto the model.
- (4) Move decal into position by wetting decal with finger.
- (5) Press decal down gently with a soft cloth until excess water and air bubbles are gone.

- (1) 貼りたいマークをハサミで切り抜きます。
- (2) マークをぬるま湯に10秒ほど浸してからタオル等の布の上に置きます。
- (3) 台紙のはしを手で持ち、貼るところにマークをスライドさせてモデルに移して下さい。
- (4) 指に少し水を付けてマークを濡らしてながら、正しい位置にずらします。
- (5) 柔らかい布でマークの内側の気泡を押し出しながら、押しつけるようにして水分をとります。

蚀刻片使用说明 PHOTO-ETCHED PARTS エッチングパーツ

- (1) 使用蚀刻片专用剪刀或模型专用刻刀将蚀刻片零件切割下待用。
 - (2) 切割下的零件上有蚀刻片的残留连接点部分, 使用模型专用锉刀细心打磨干净。
 - (3) 蚀刻片部分在涂装之前必须使用专用的模型金属底漆打底。
- 注意事项: 蚀刻片很薄外延较为尖锐, 有刮伤手的可能, 在使用之时请务必小心。

- (1) Cut off photo-etched parts using a modeling knife.
 - (2) Carefully remove any excess using a file.
 - (3) Apply metal primer prior to painting.
- Attention, please: Extra care should be taken to avoid personal injury when handling photo-etched parts.

- (1) 切り離す時はカッターナイフを使用してパーツを切り離します。
 - (2) 切り出した時、部品に出張った部品が残っている場合は、ヤスリなどで丁寧に削り落とします。
 - (3) 塗装が必要なパーツは下地にメタルプライマーを吹きつけてから塗装します。
- ご注意: エッチングパーツは大変薄く、手などを切り恐れがあります。取扱いには十分注意して下さい。

涂装色表 PAINT REQUIRED カラー番号リスト

■ [C]000 GSI CREOS Mr.COLOR		■ [00-000] ACRYLICOS VALLEJO		■ A.MIG-000 米格色号		■ FS00000 联邦色号					
[C]1	—	—	—	光泽白	CLOSS WHITE	[C]306	—	—	FS36271	中灰色	GRAY
[C]2	—	—	—	光泽黑	CLOSS BLACK	[C]307	—	A.MIG-208	FS36320	中灰色	DARK COMPASS GHOST GRAY
[C]3	[71-084]	—	—	光泽红	RED	[C]308	[71-050]	A.MIG-203	FS36375	浅灰色	LIGHT COMPASS GHOST GRAY
[C]6	—	—	—	光泽绿	GREEN	[C]310	[70-929]	A.MIG-202	FS30219	棕色	TAN
[C]33	[71-057]	—	FS37038	消光黑	FLAT BLACK	[C]312/[C]26	[70-287]	A.MIG-201	FS34227	浅灰绿色	LIGHT GRAY GREEN
[C]47	[70-934]	—	—	透明红	CLEAR RED	[C]313	[70-847]	A.MIG-200	FS33531	沙漠色	MIDDLESTONE
[C]49	[70-956]	—	—	透明橙	CLEAR ORANGE	[C]316	[70-919]	—	FS17875	白	WHITE FS17875
[C]50	—	—	—	透明蓝	CLEAR BLUE	[C]319	[70-968]	—	—	薄松叶色	LIGHT GREEN
[C]57	[70-808]	—	—	青竹色	METALIC BLUE GREEN	[C]329	[70-915]	—	FS13538	亮光橙黄色	YELLOW FS13538
[C]73	[71-012]	—	—	飞机灰	AIRCRAFT GREY	[MC]213	[71-072]	—	—	不锈钢色	STAINLESS
[C]137	—	—	—	轮胎黑	TIRE BLACK	[MC]214	[71-865]	A.MIG-191	—	钢铁色	STEEL

涂装标识指示 PAINTING & MARKING GUIDE 基本塗装マーキング

A F-15I Israeli Air Force Test & Evaluation Squadron (Manat in Hebrew), No.201 Tel-Nof AFB
F-15I 以色列空军飞行测试评估中队, 201号机 特诺夫空军基地

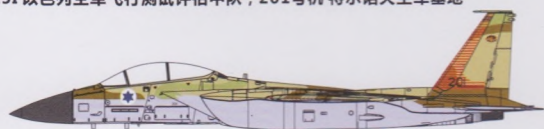

B F-15I Ra'am IAF 69 "Hammers" Squadron, No.241
F-15I Ra'am 以色列国防空军第69 "铁锤" 中队, 241号机



1

弹射座椅组装
Ejection Seat Assembly
射出シートの組み立て

弹射座椅尼龙材质安全带为浅灰色 (C307)
Paint safebelt into light grey (C307)

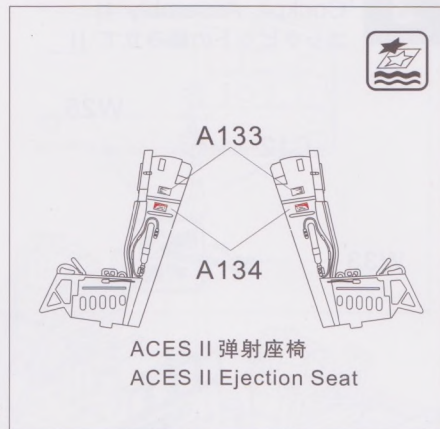
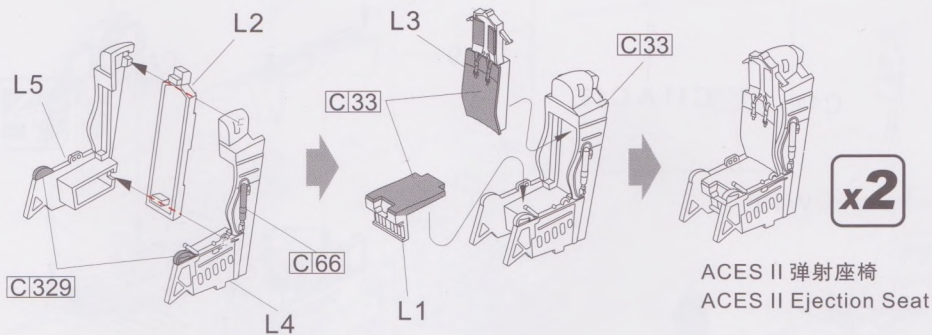

2

座舱组装 I
Cockpit Assembly I
コックピットの組み立て I

ACES II 弹射座椅
ACES II Ejection Seat

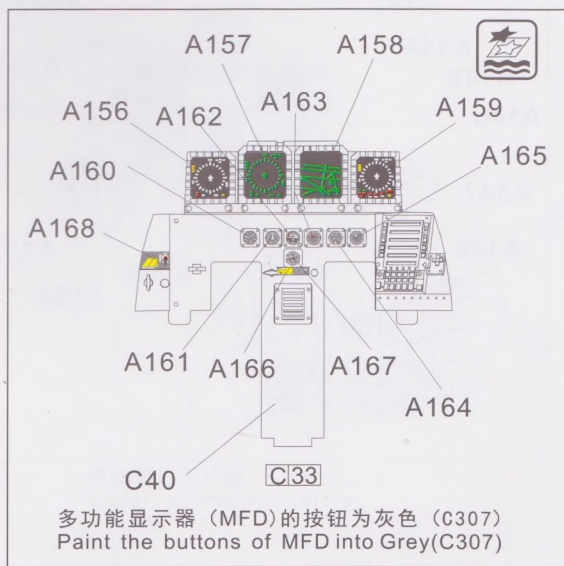
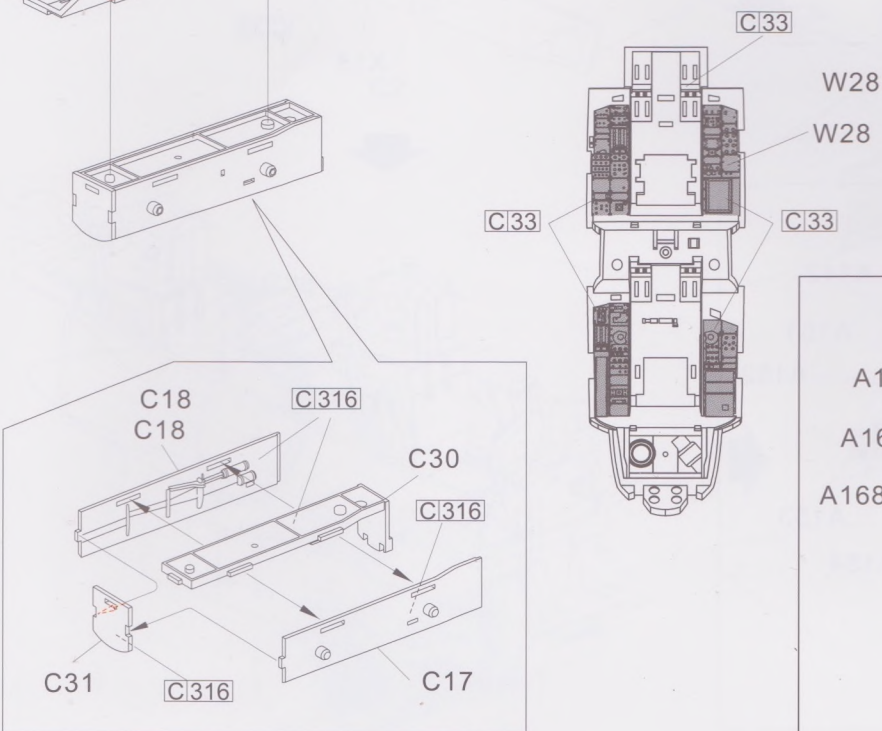
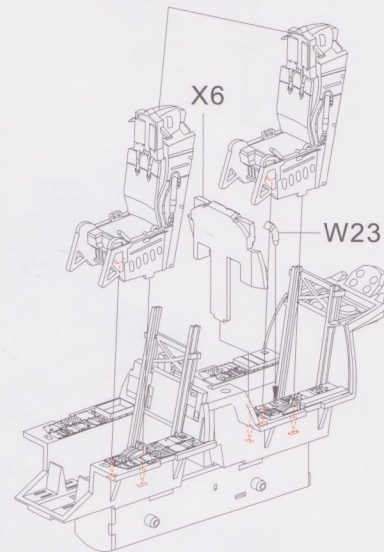
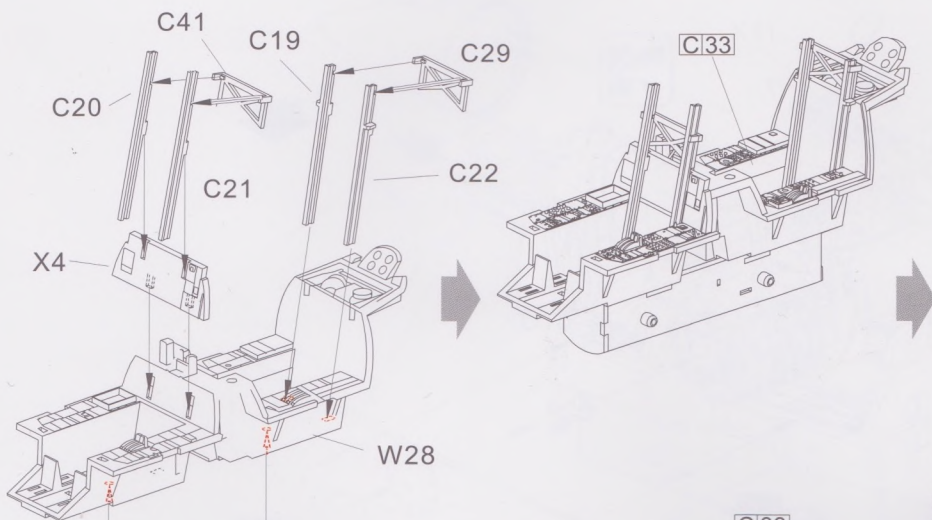

3

座舱组装 II Cockpit Assembly II コックピットの組み立て II

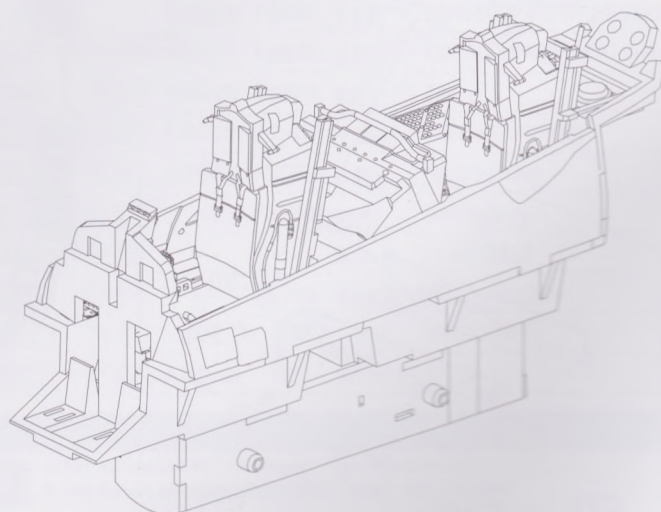
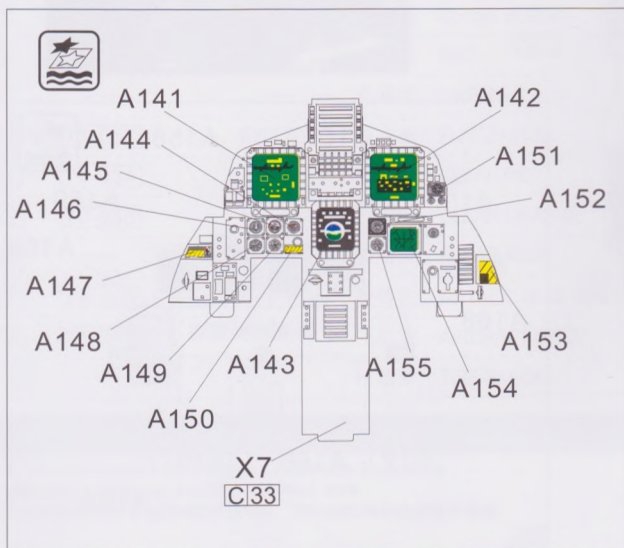
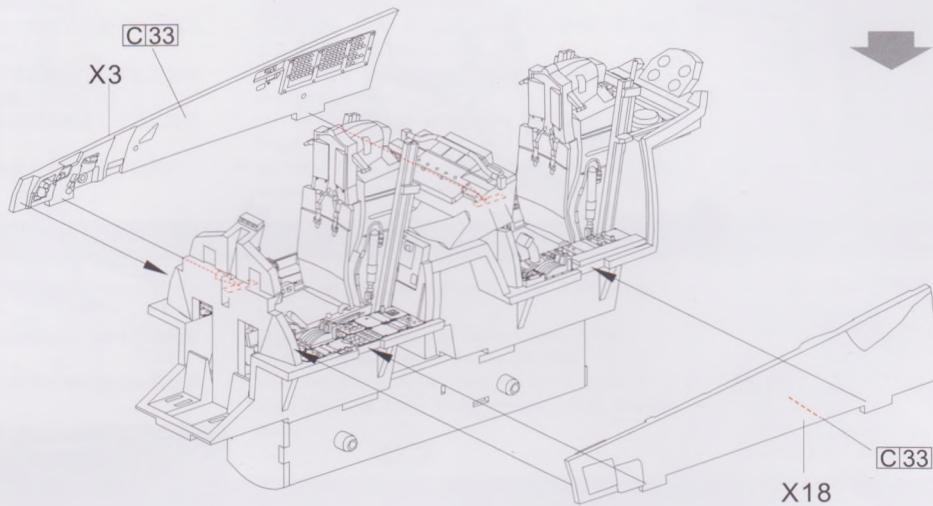
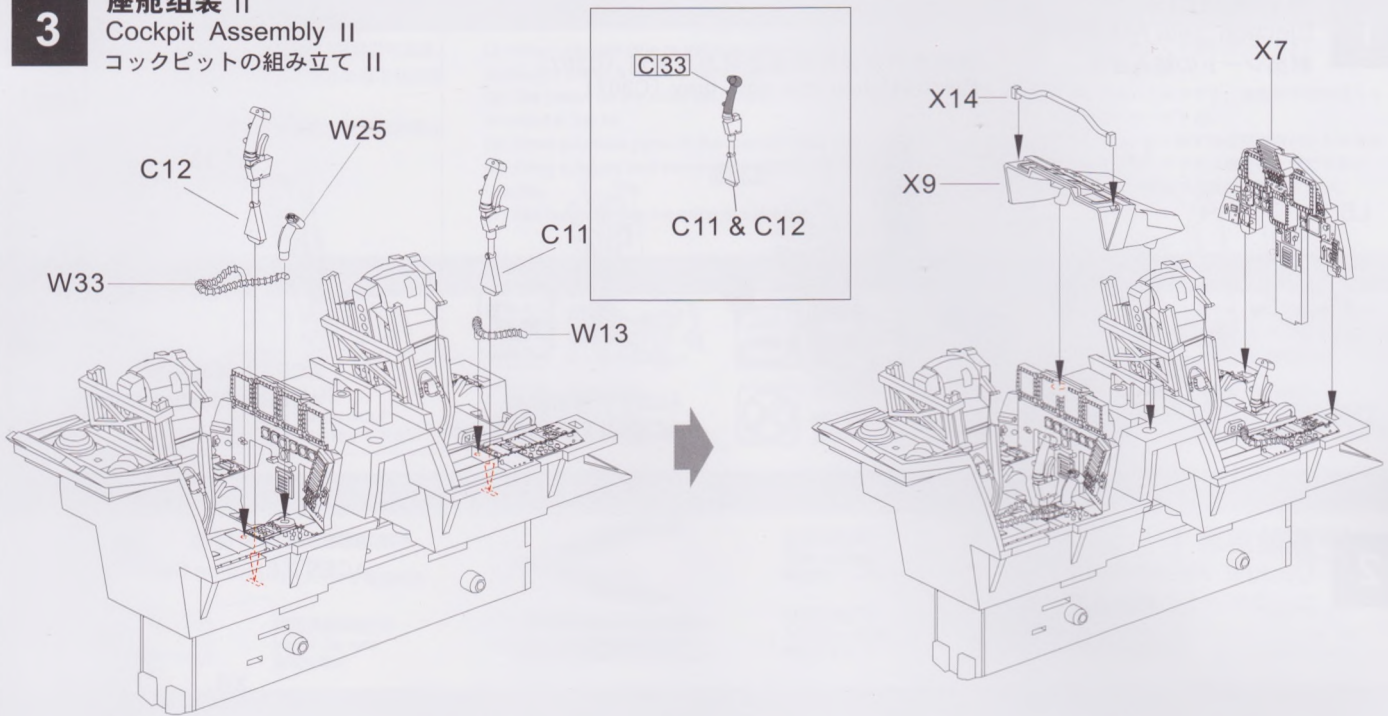

4

前机身组装
Forebody Assembly
機首の組み立て

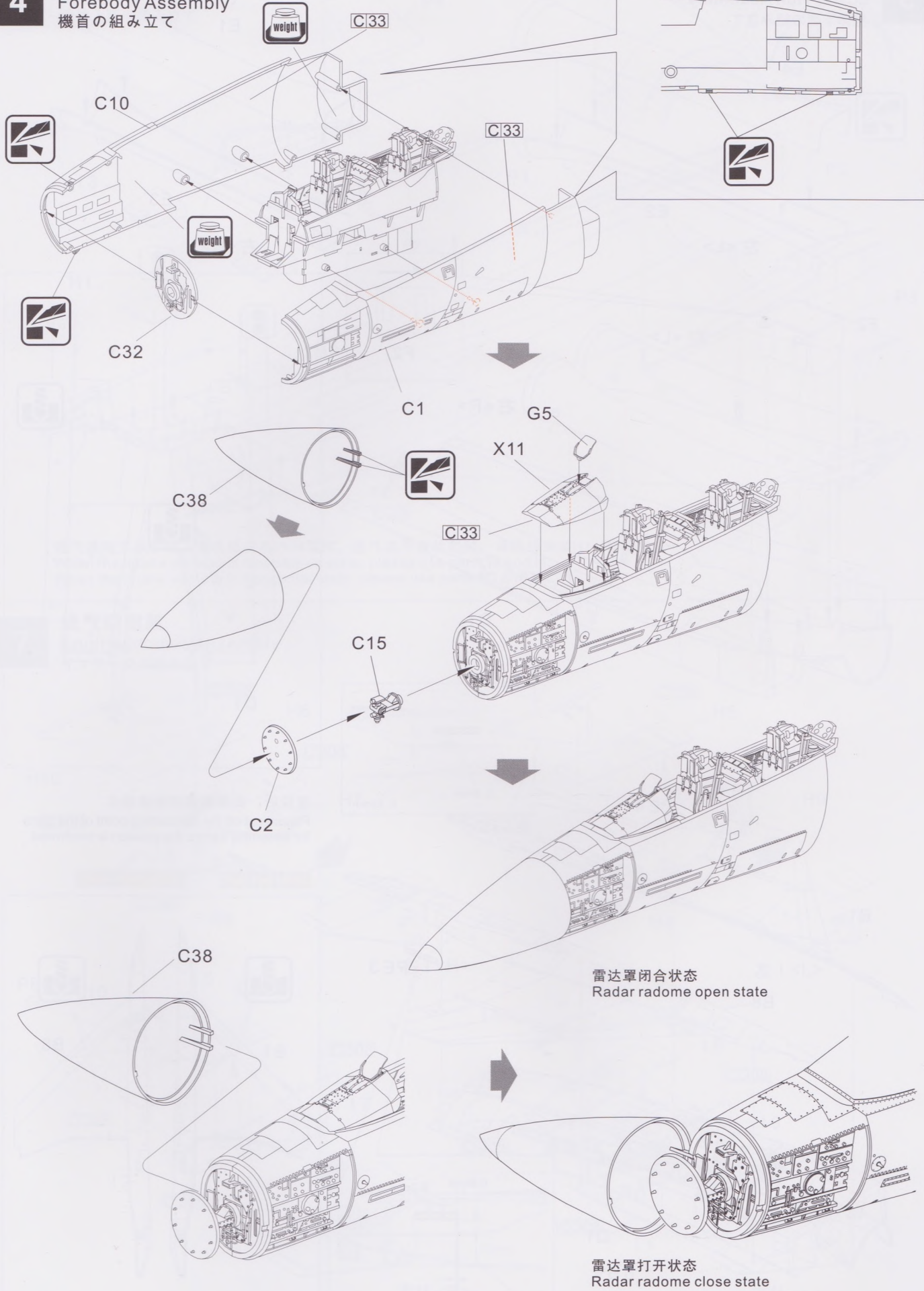

雷达罩闭合状态
Radar radome open state

雷达罩打开状态
Radar radome close state

5

下机身组装 Lower Hull Assembly 機体下面の組み立て

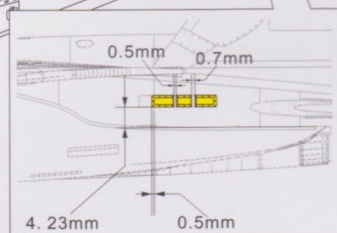
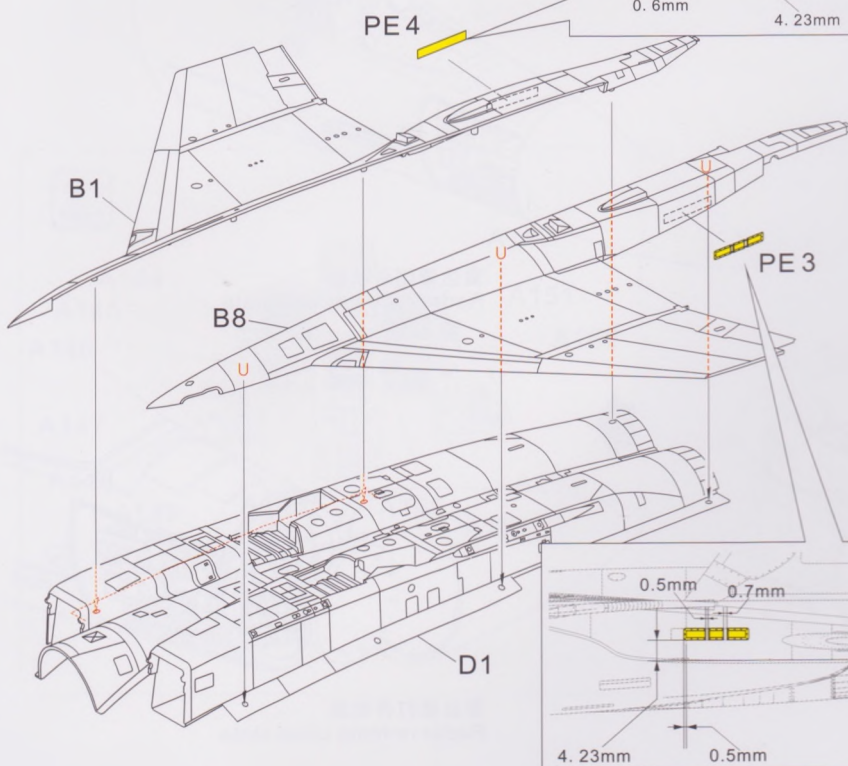
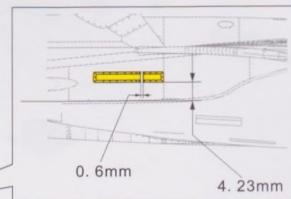
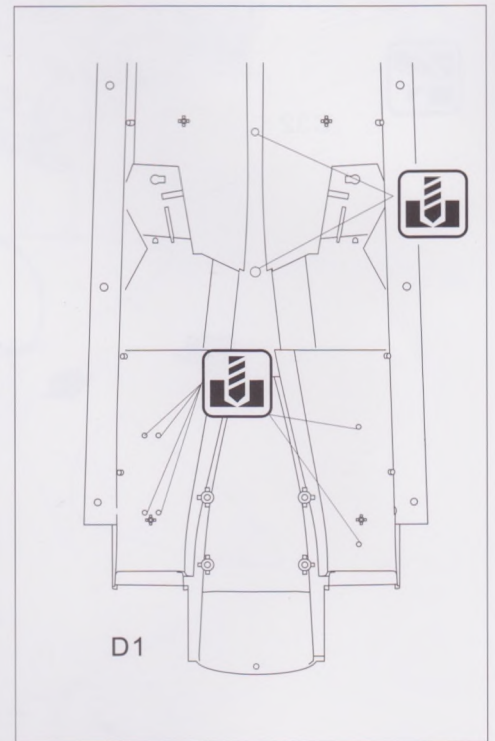
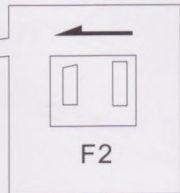
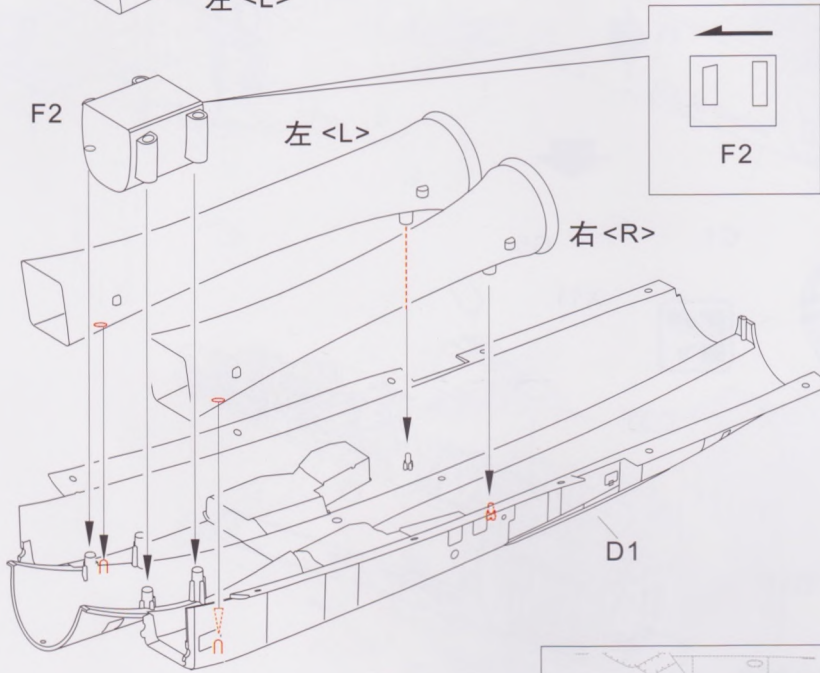
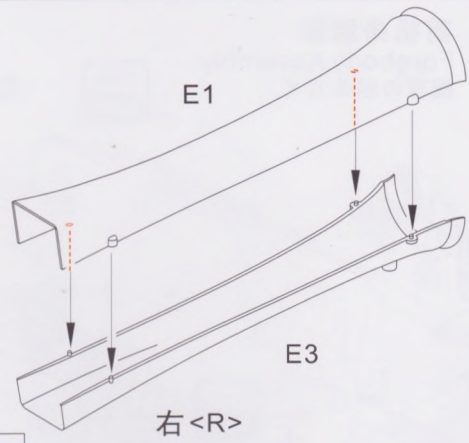
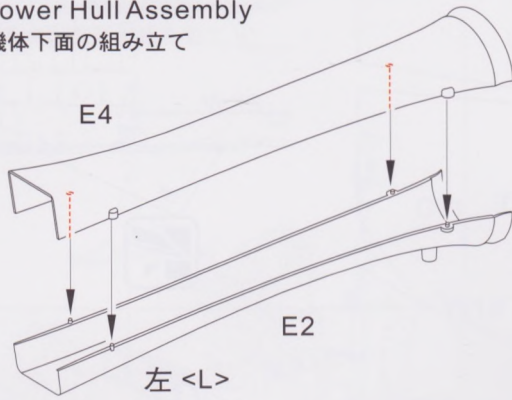

定位后，安装前请切除连接点
Please cut off the connecting point of the parts
for assembly before the position is confirmed

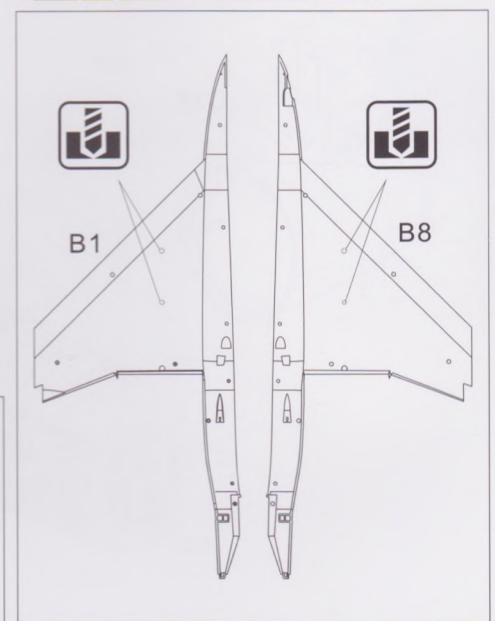
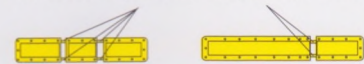

6

上机身组装 Upper Hull Assembly 機体上面の組み立て

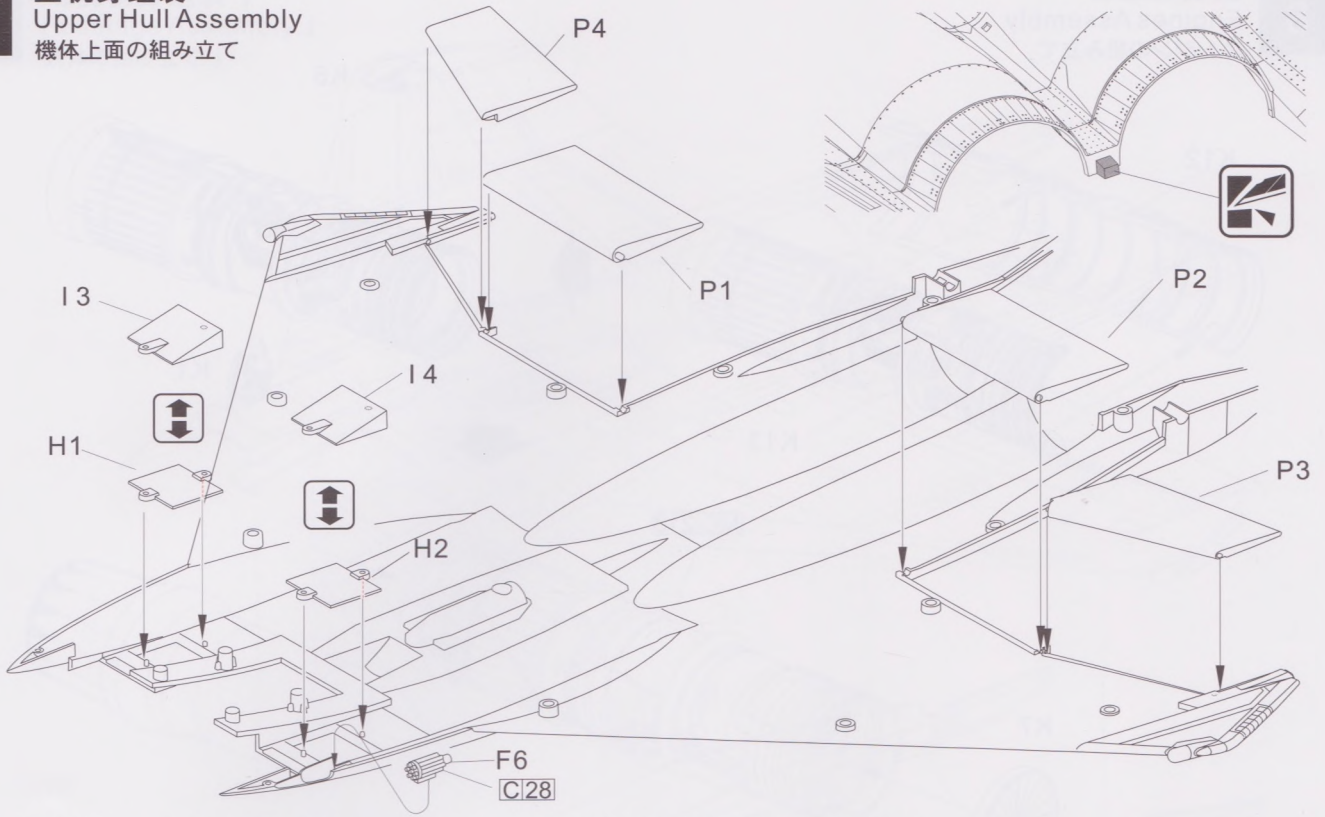

进气道向下状态时, 请选择安装I3.I4零件, 进气道平直状态时, 请选择安装H1. H2零件
When the intake vents is in downwards state, please use parts I3 and I4.
When the intake vents is in horizontal state, please use parts H1 and H2.

7

进气口组装 Engine Intakes Assembly インテークの組み立て

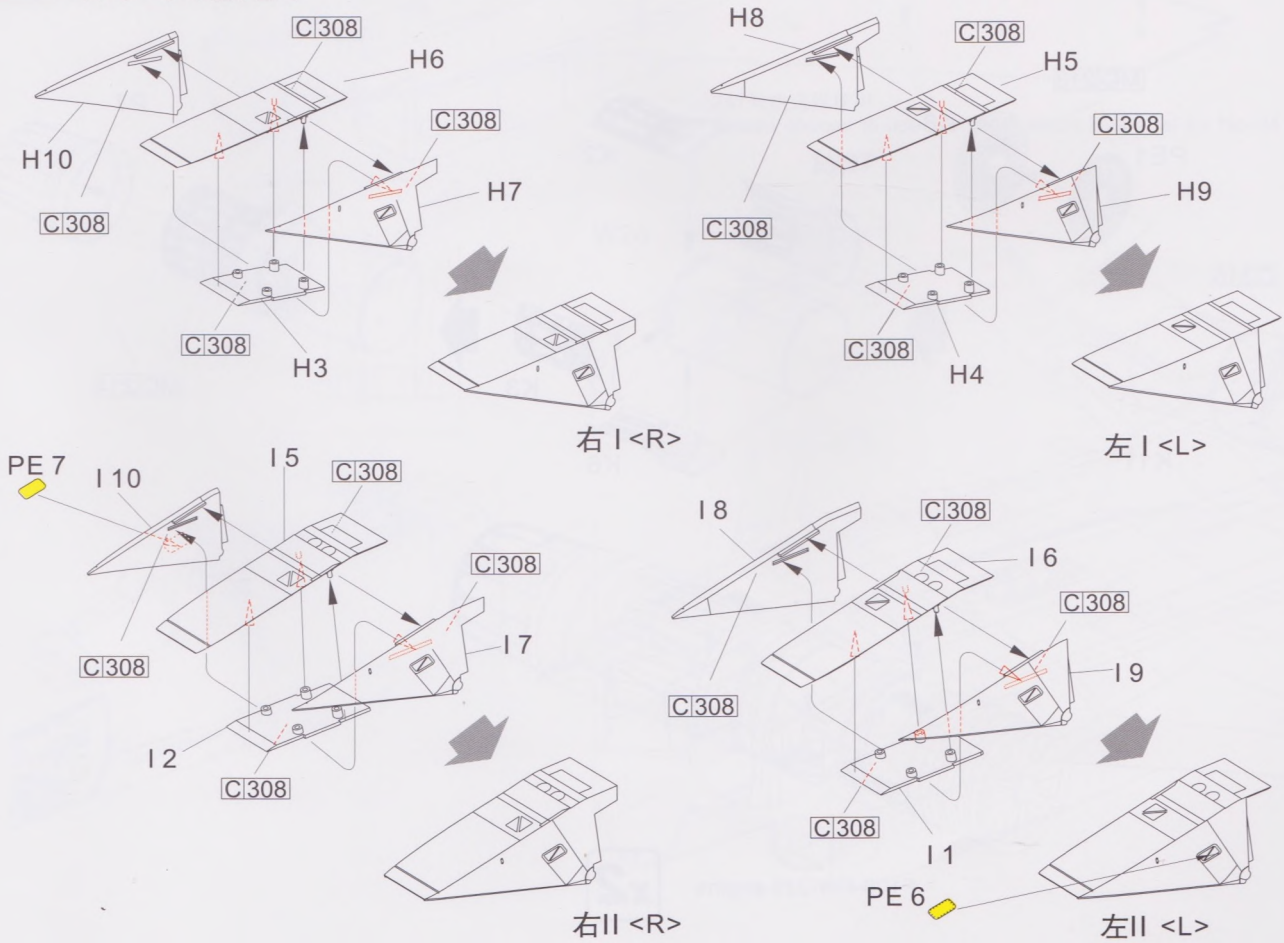

8

发动机组装 Engines Assembly エンジンの組み立て

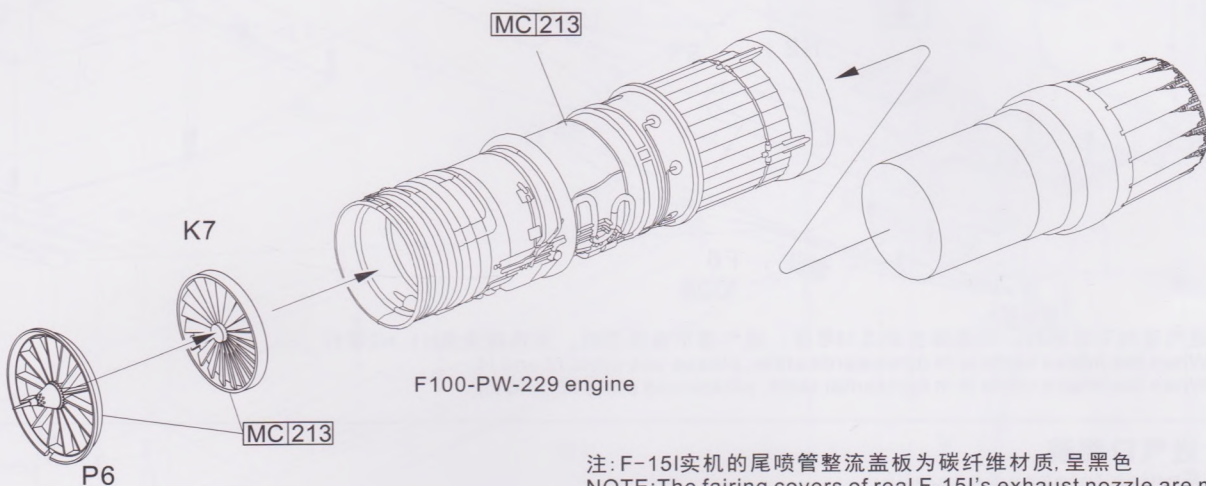
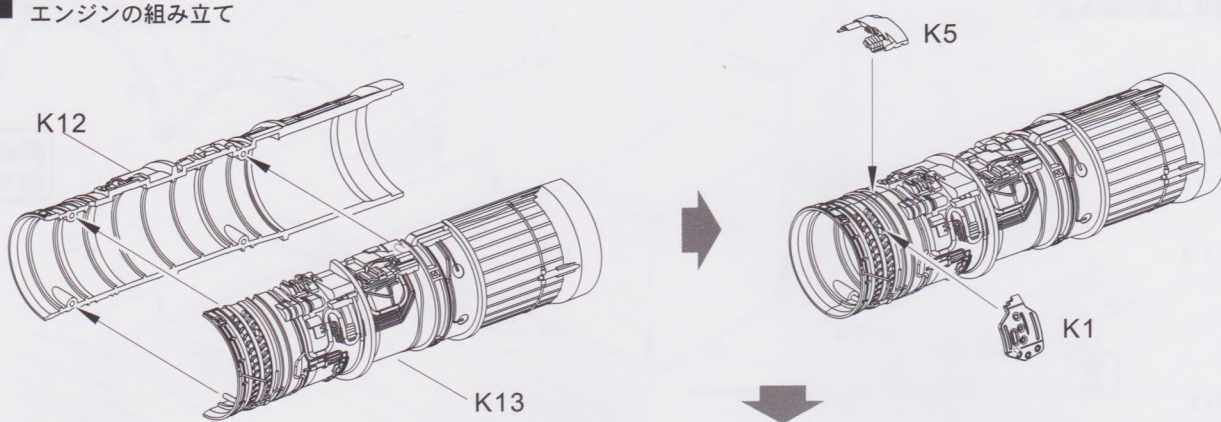

注: F-15I实机的尾喷管整流盖板为碳纤维材质, 呈黑色
NOTE: The fairing covers of real F-15I's exhaust nozzle are made from carbon-fiber composite, so these 'turkey feathers' are black.

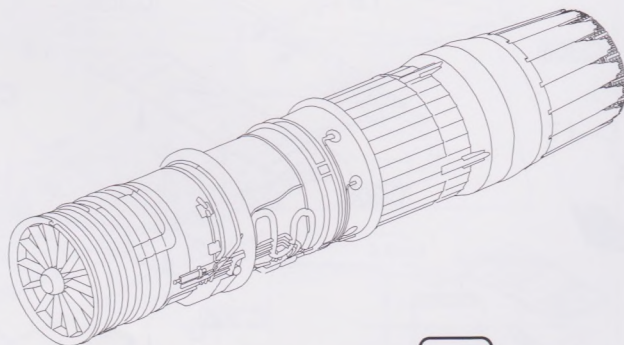
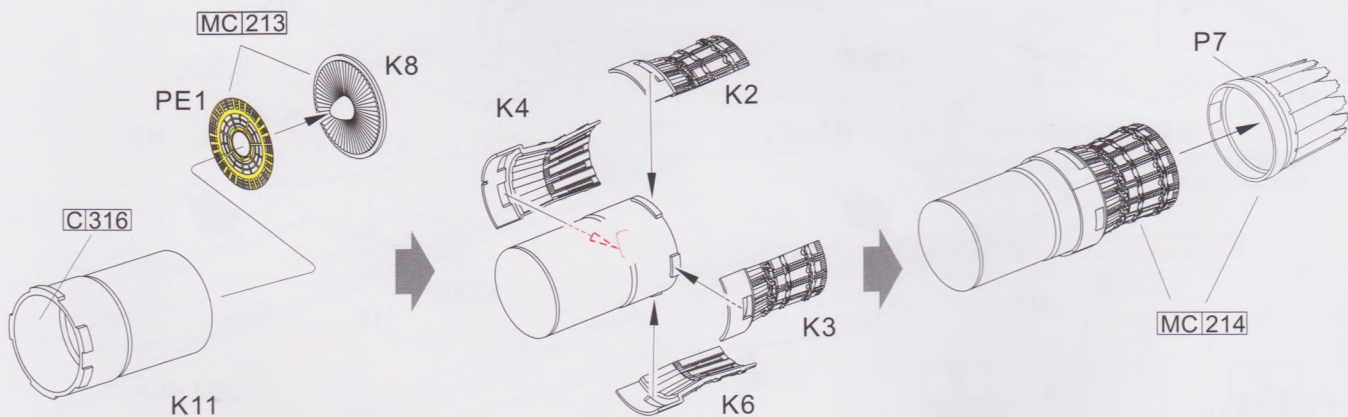

F100-PW-229 engine

x2

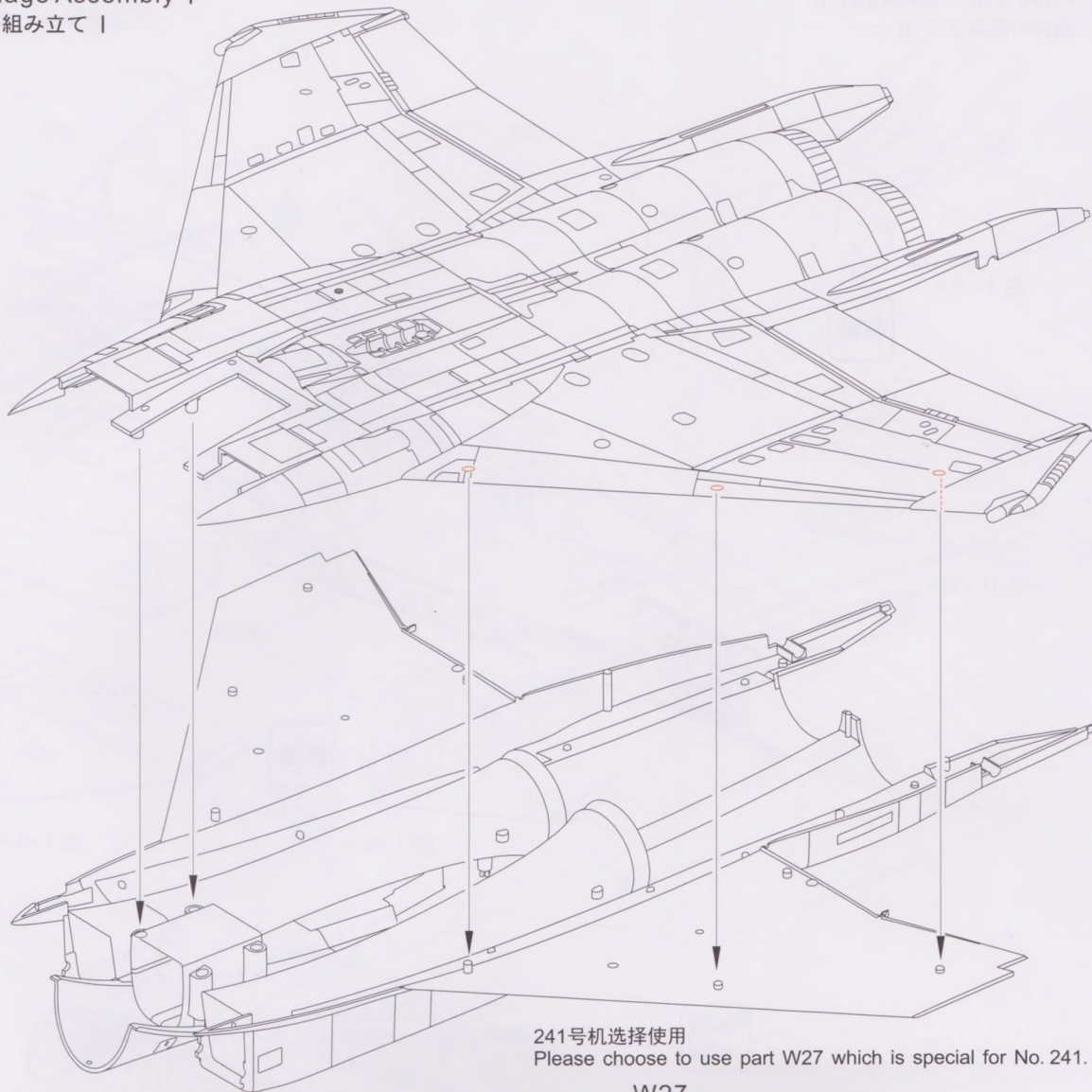

241号机选择使用
Please choose to use part W27 which is special for No. 241.

W27

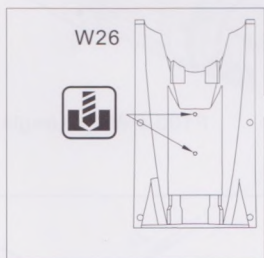

W26

W26

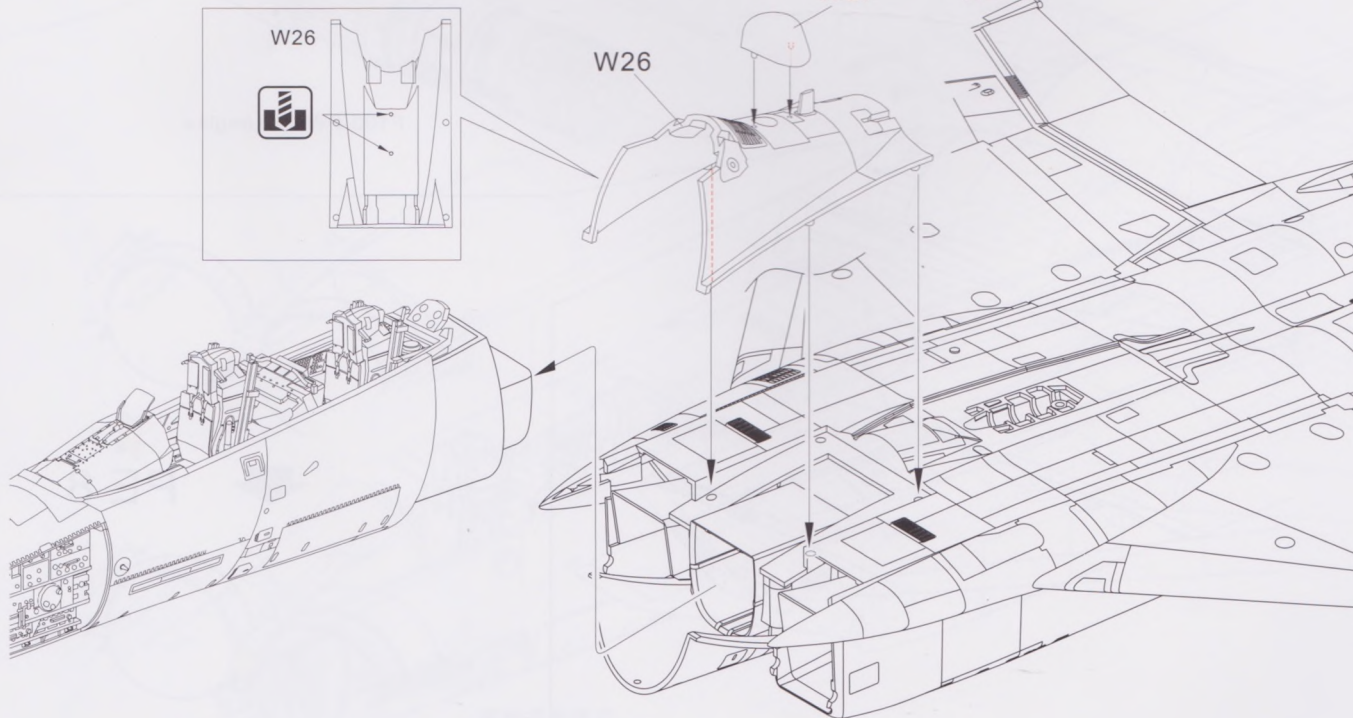

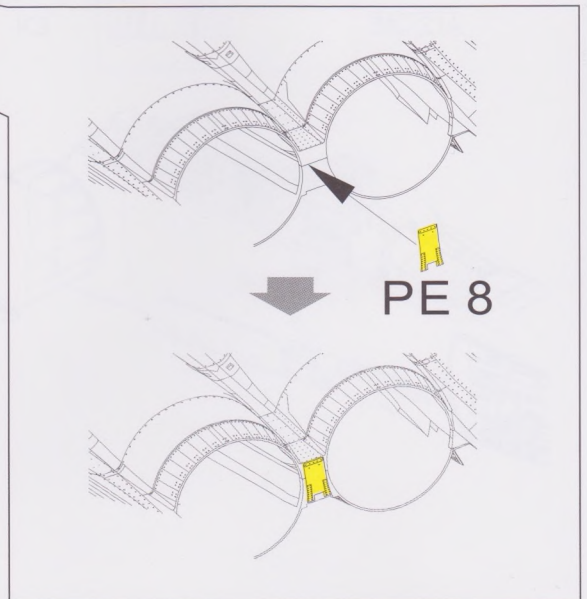
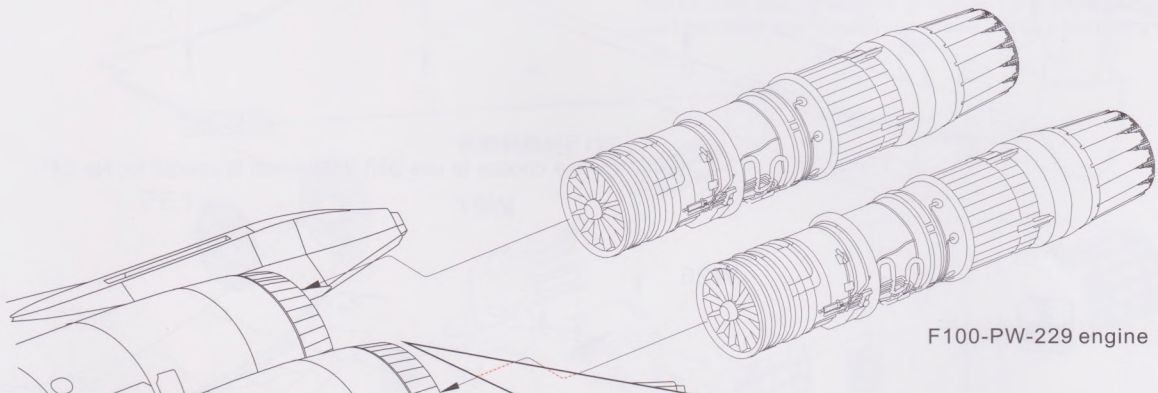
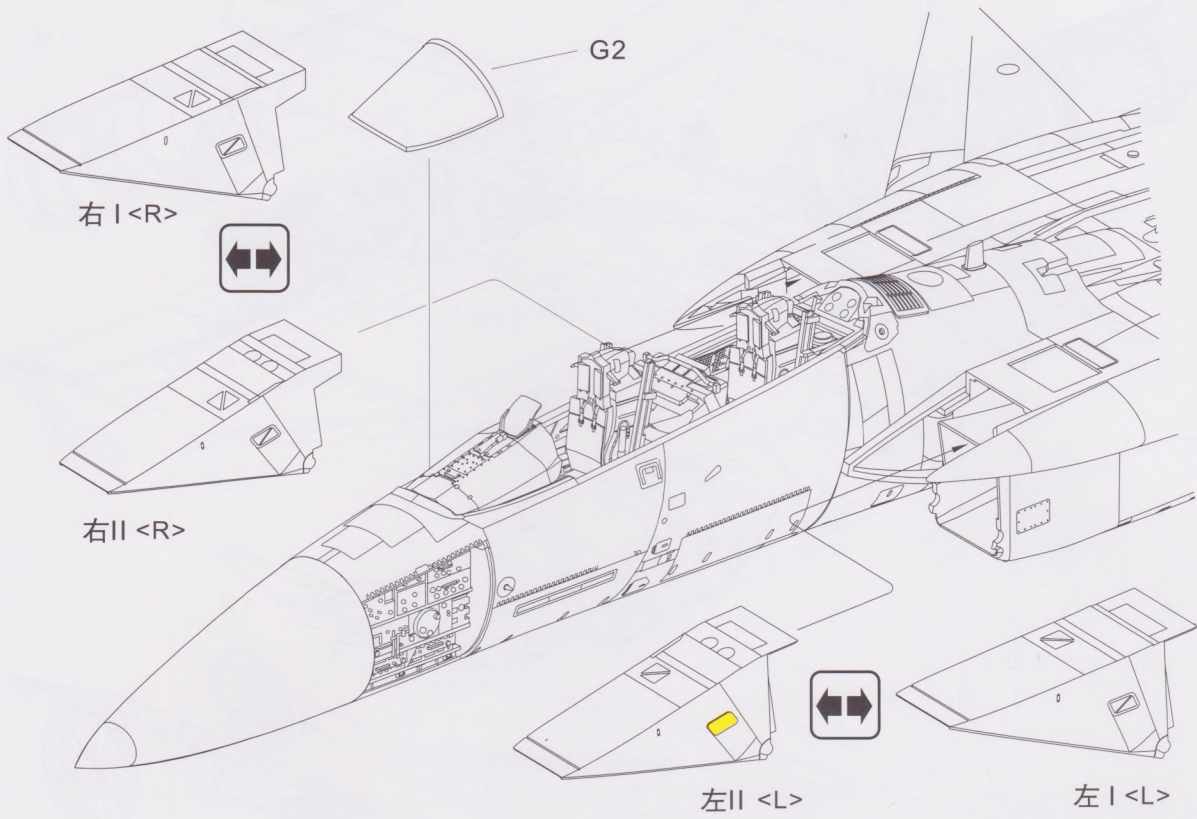

11

座舱舱盖组装 Canopy Assembly キャノピーの組み立て

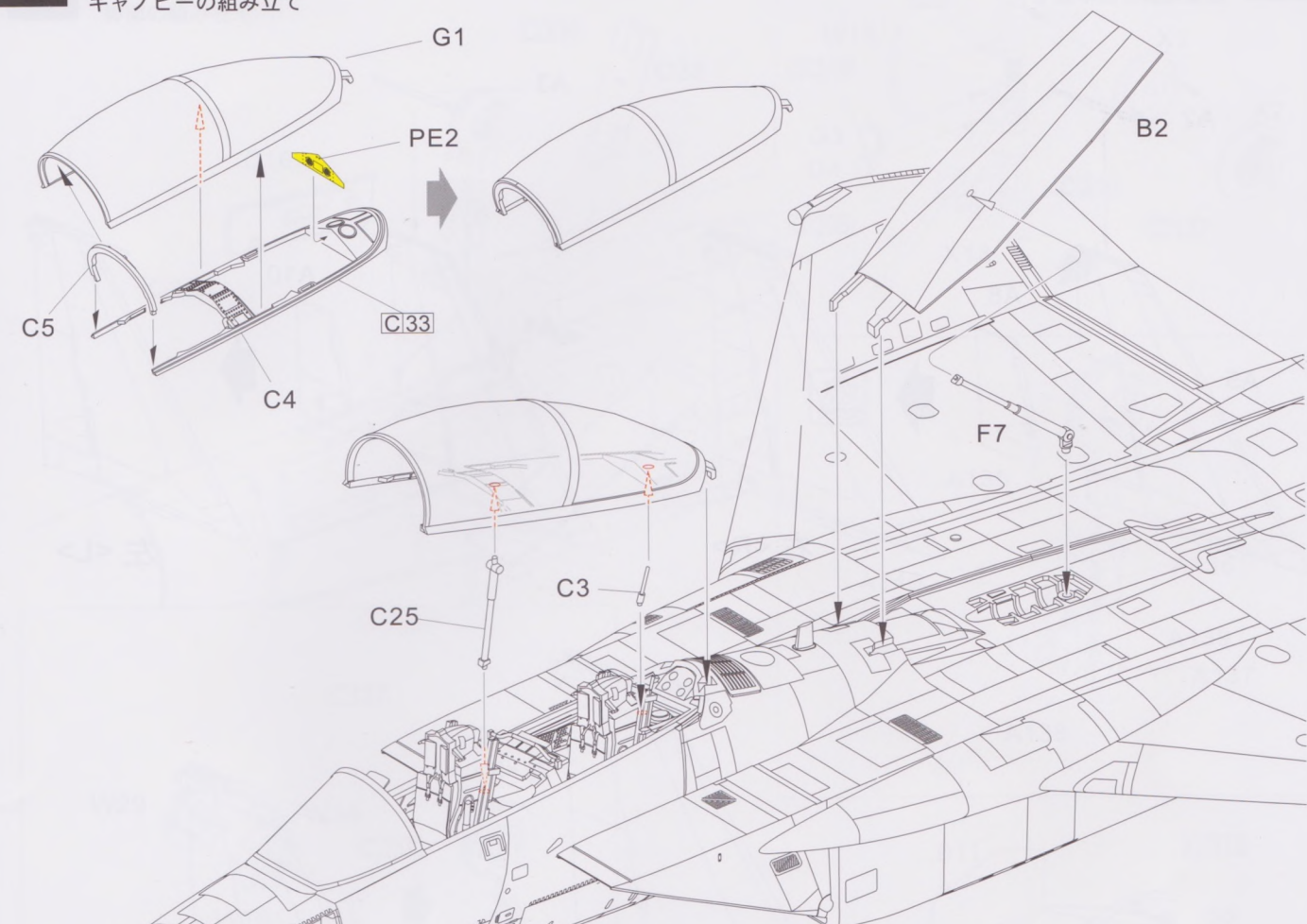

座舱开启状态
Canopy Opening State

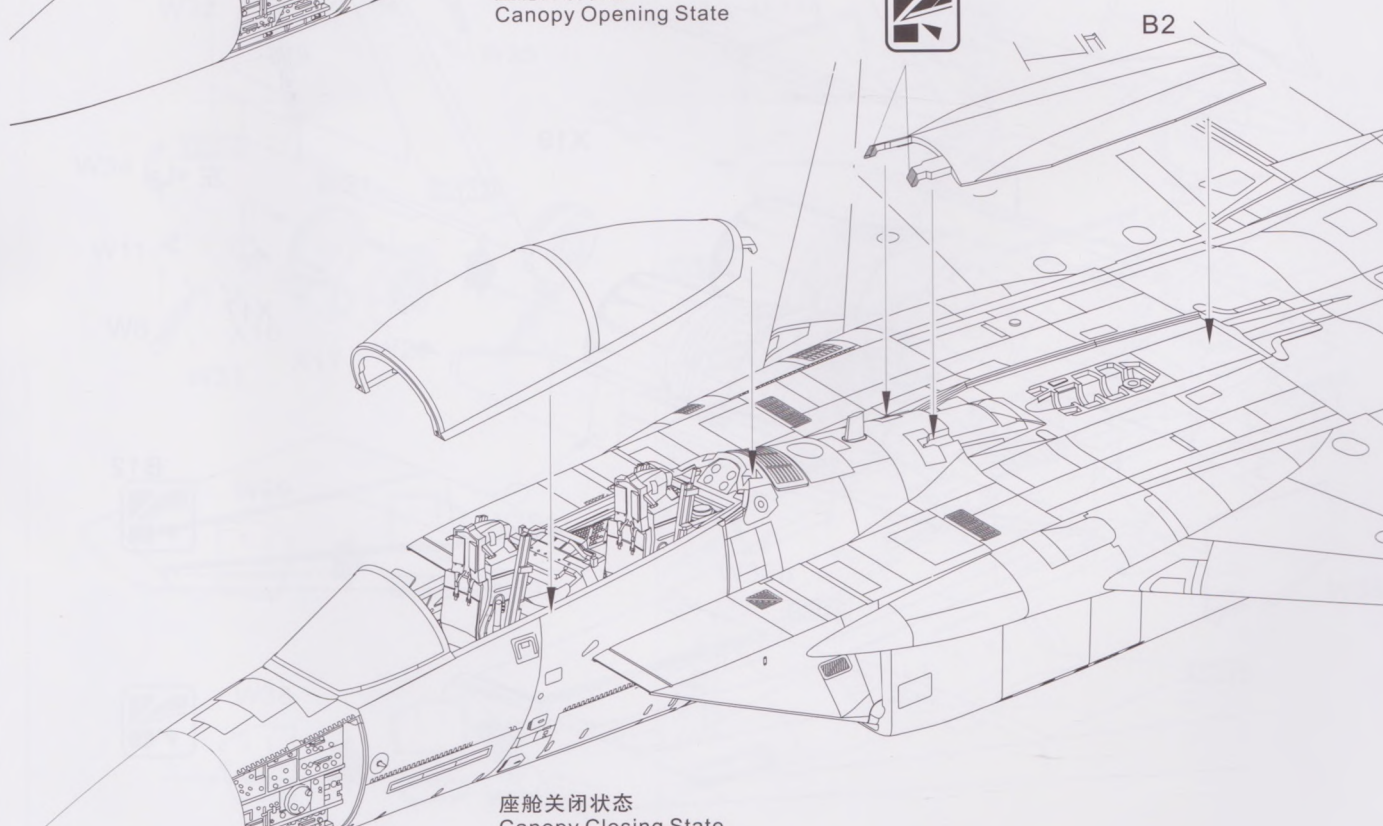

座舱关闭状态
Canopy Closing State

12

垂直尾翼组装

Vertical Tail Assembly

垂直尾翼の組み立て

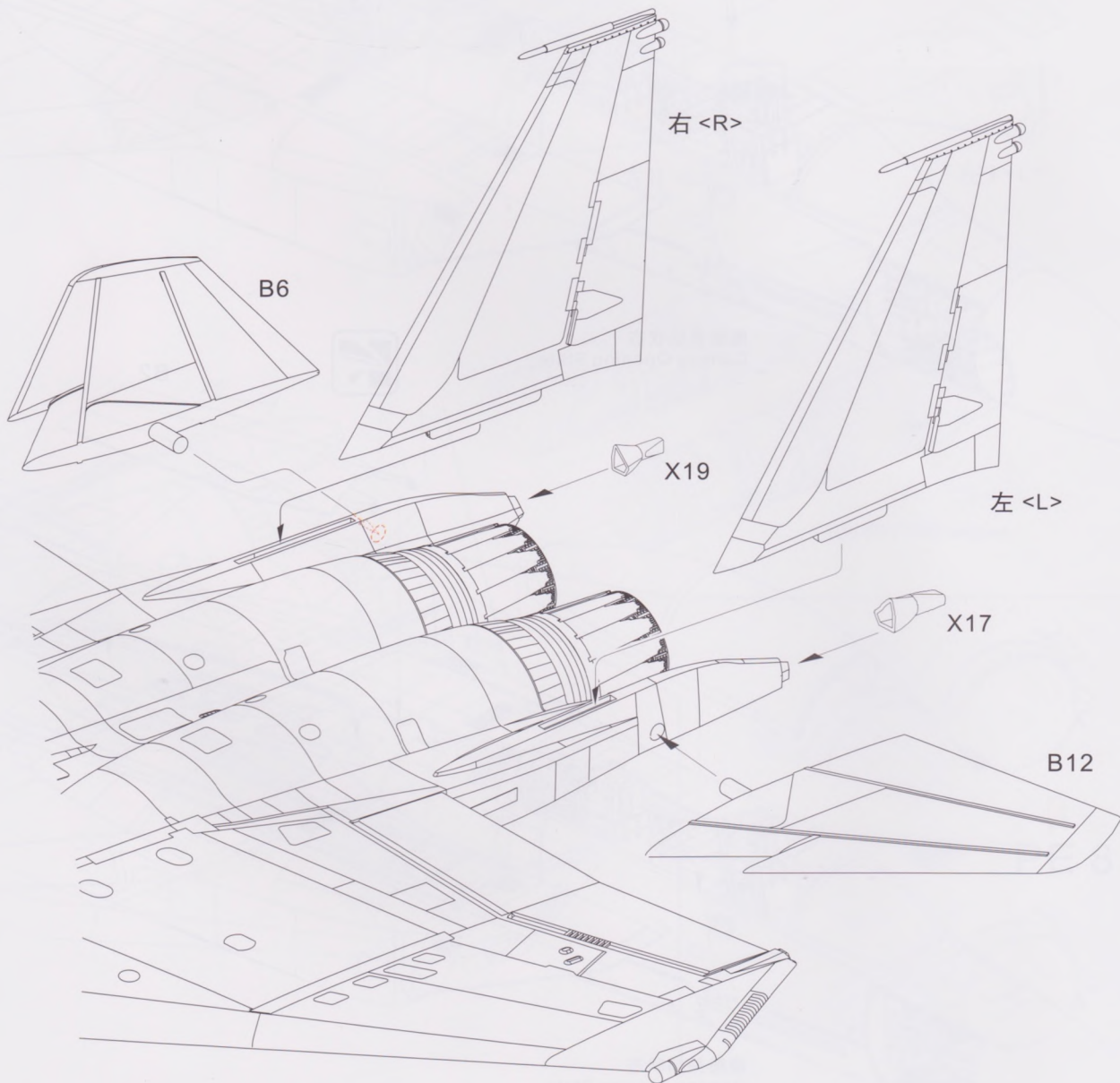
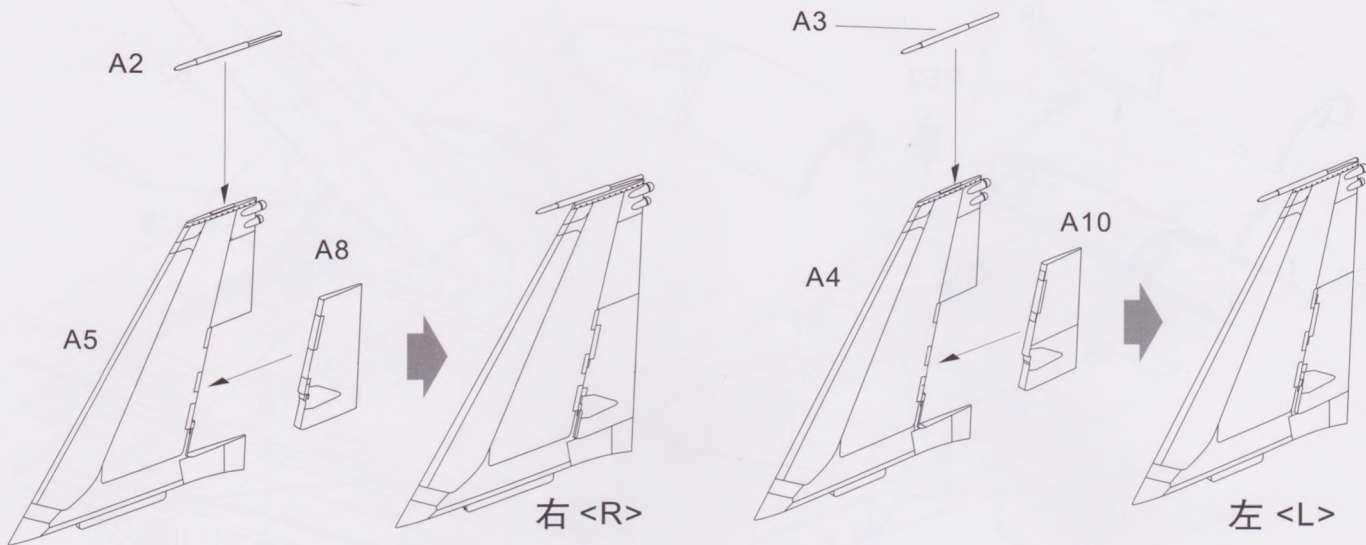

13

起落架组装

Landing Gear Assembly

脚部の組み立て

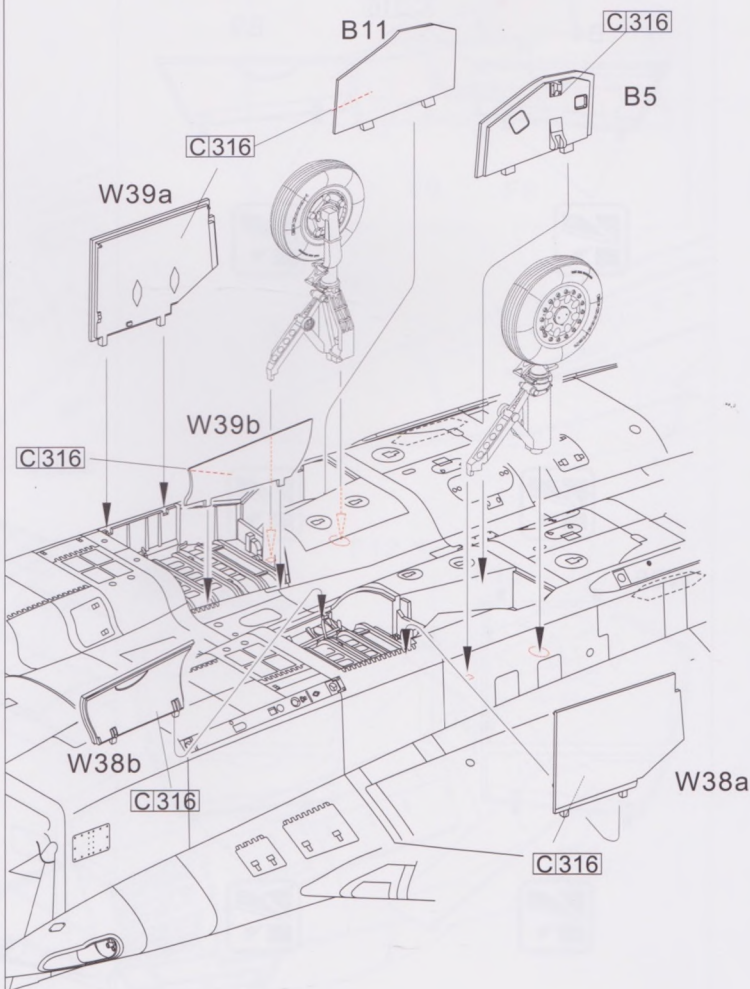
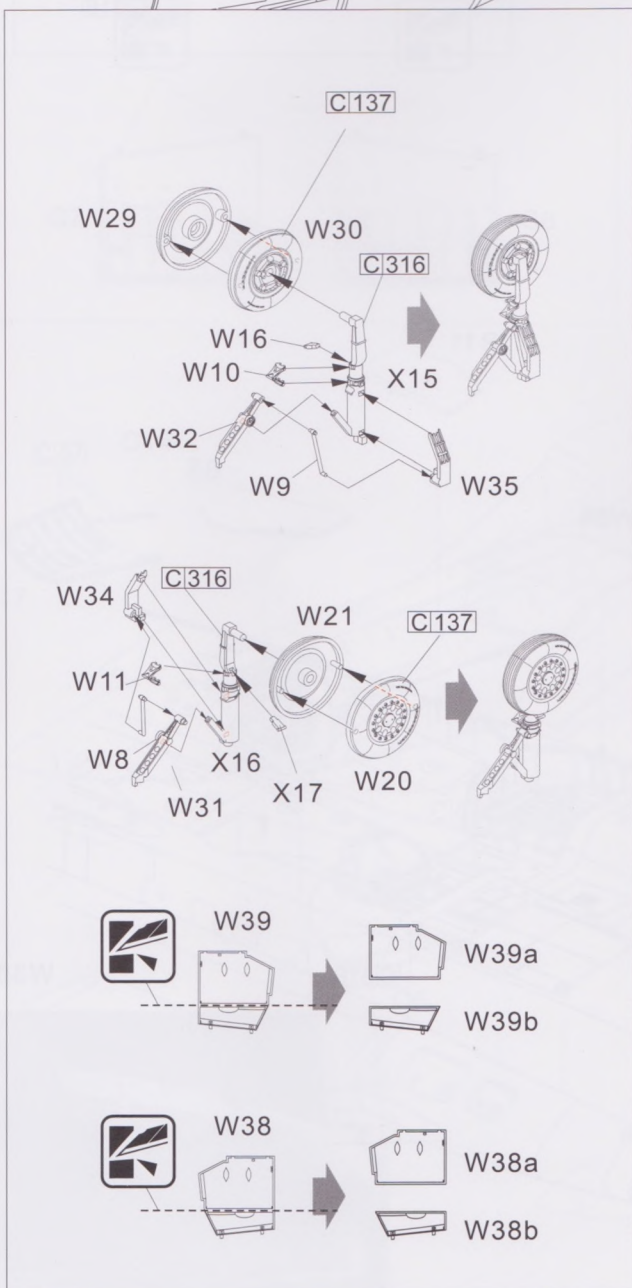
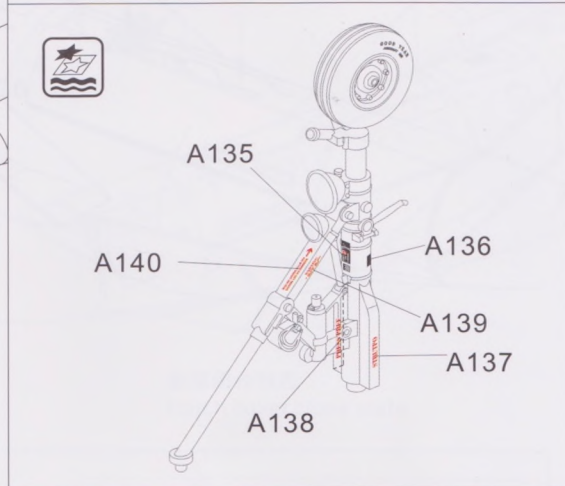
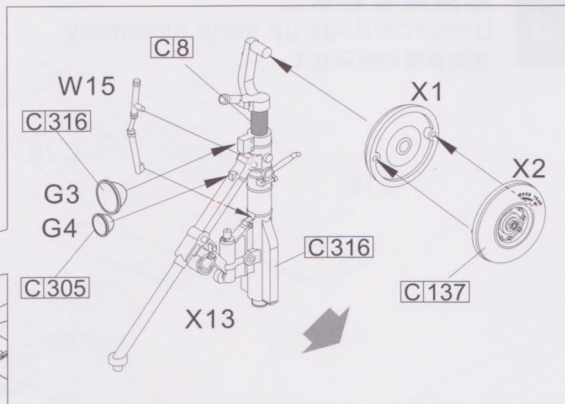
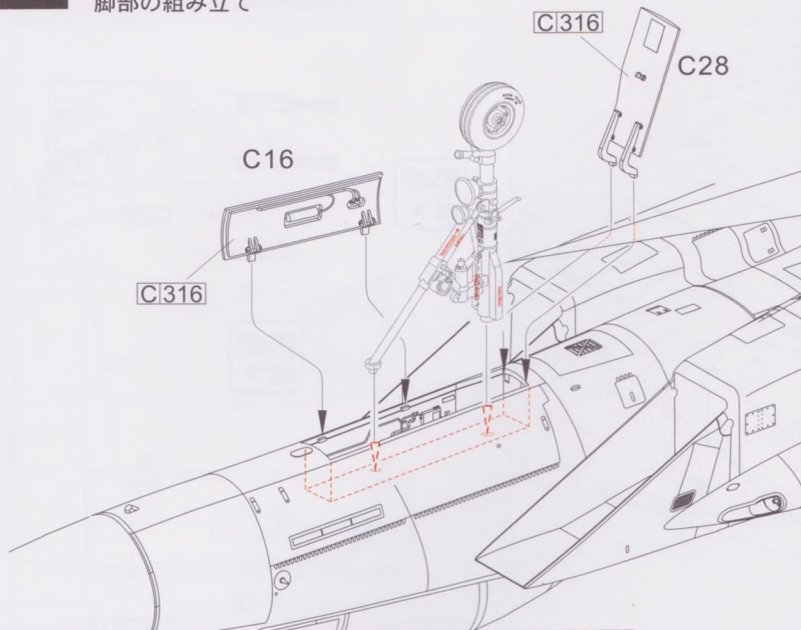

14

起落架收起状态

Undercarriage up state assembly

着陸装置の組み立て

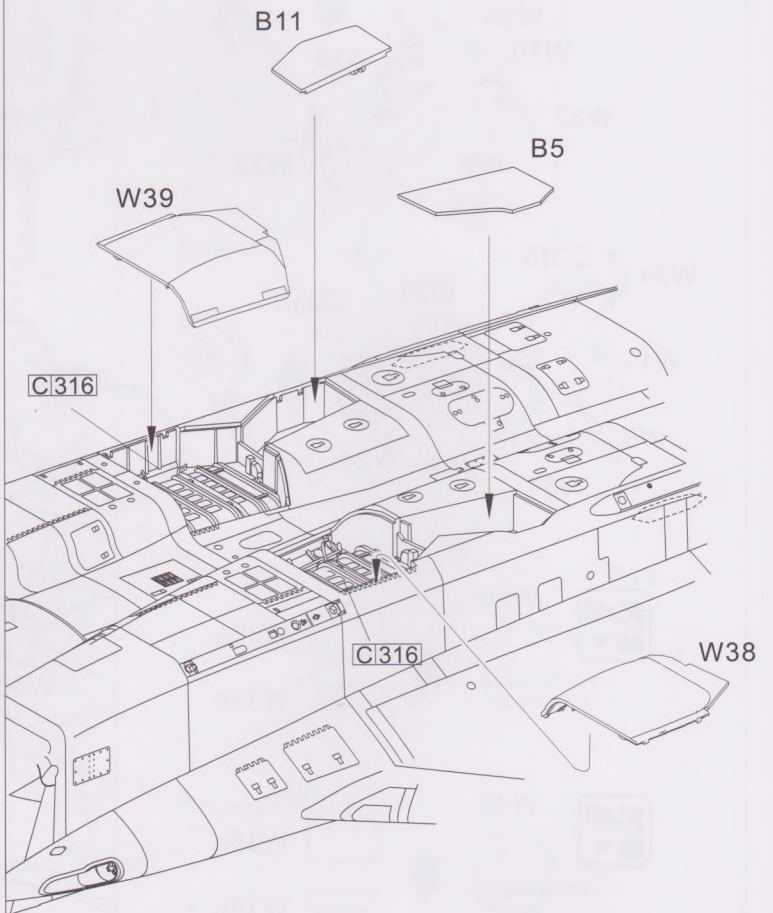
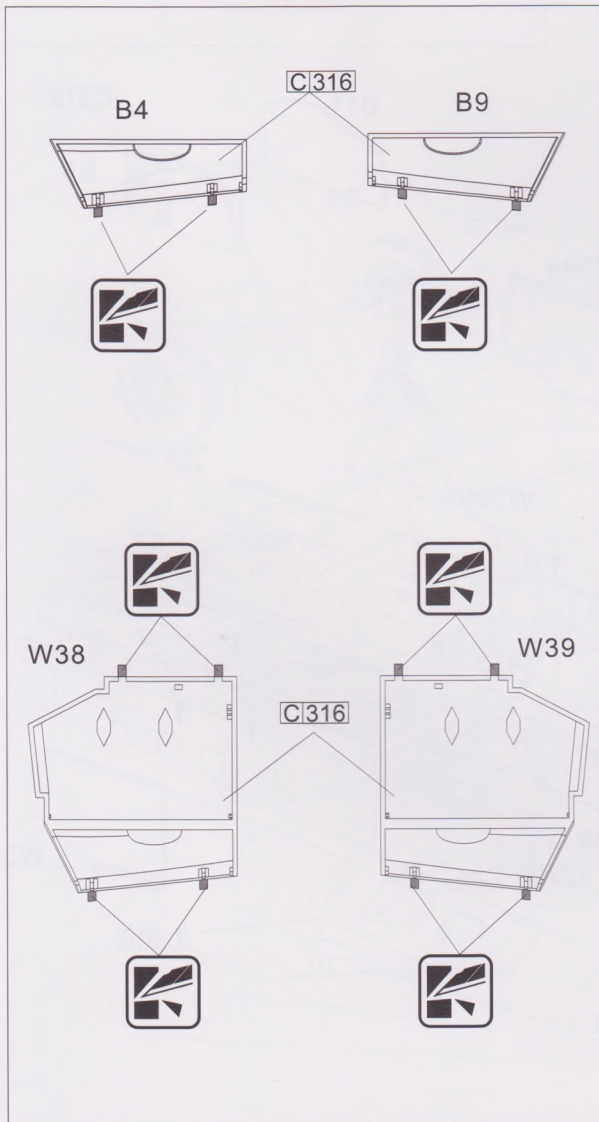
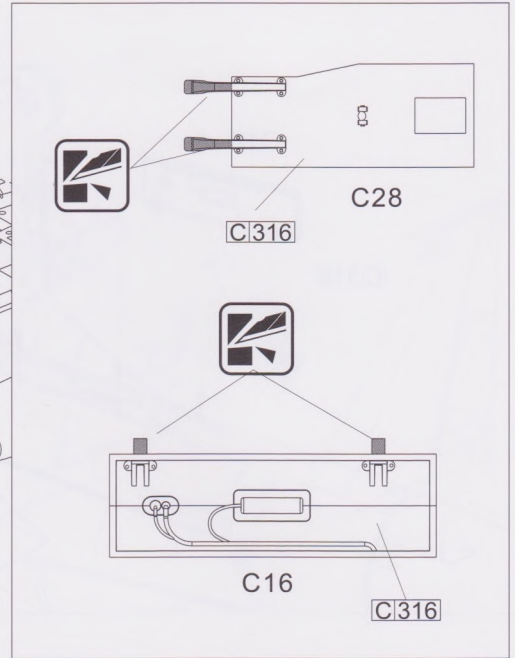
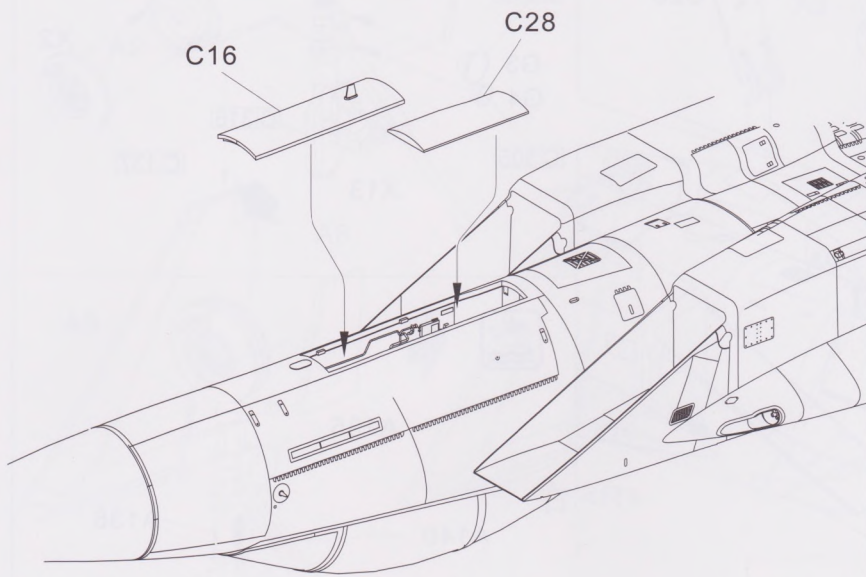

15

雷达检修仓盖组装

Radar Maintenance Cabin Assembly

点检パネルの組み合わせ

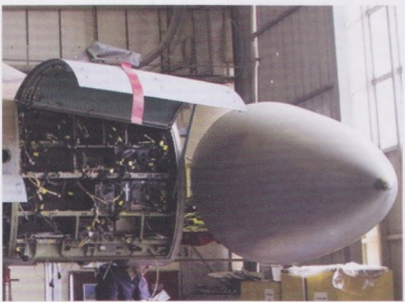
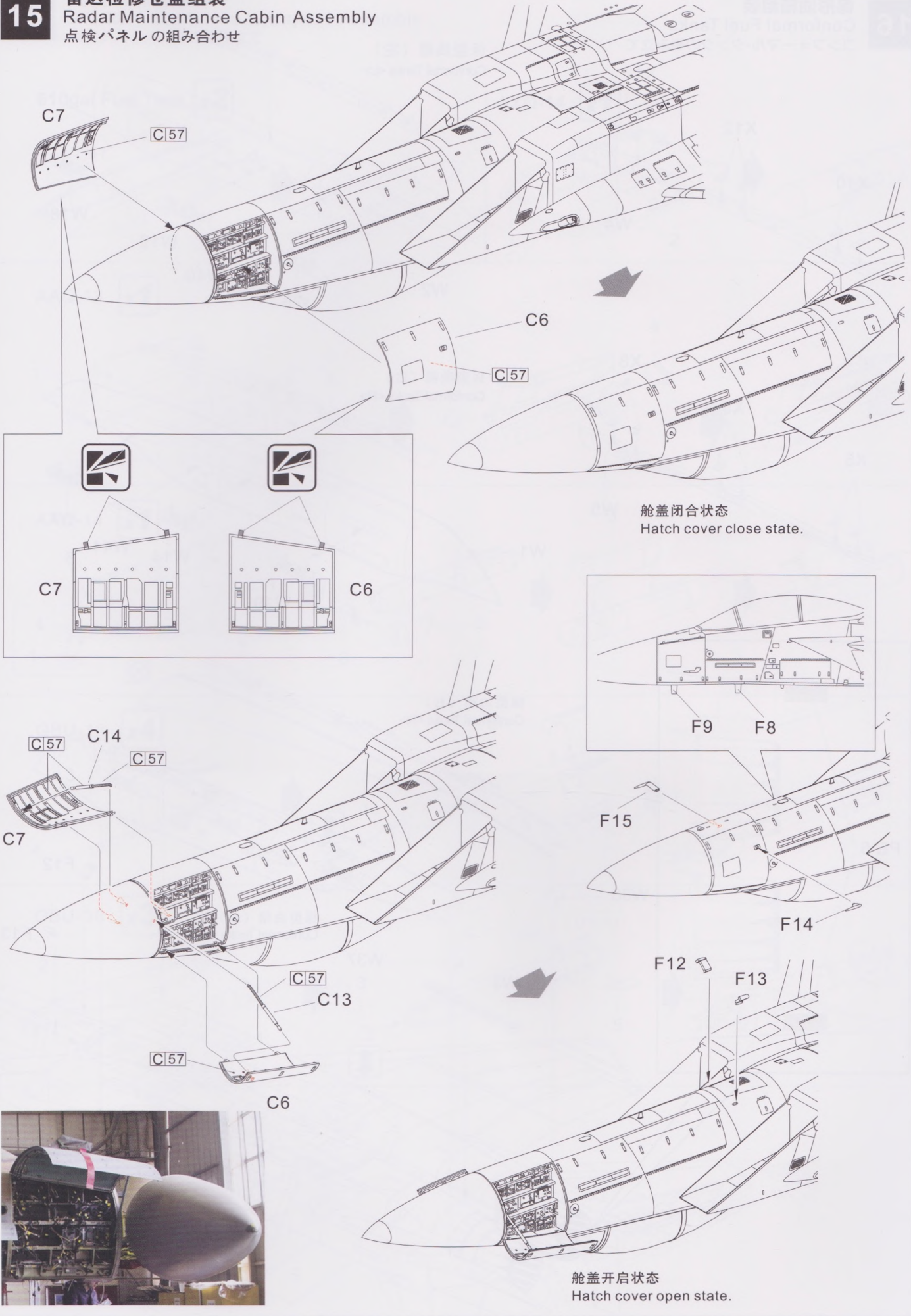

16

保形油箱组装 Conformal Fuel Tanks コンフォーマル・タンクの組み立て

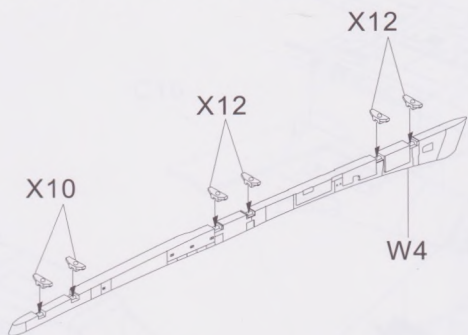

保形油箱 (左)
Conformal Tanks <L>

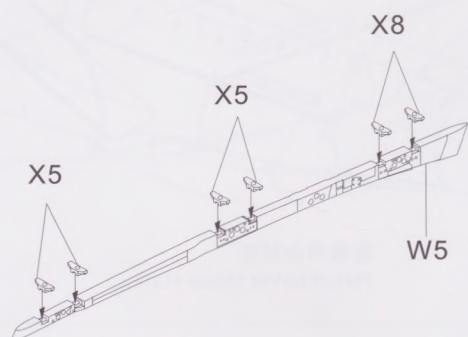
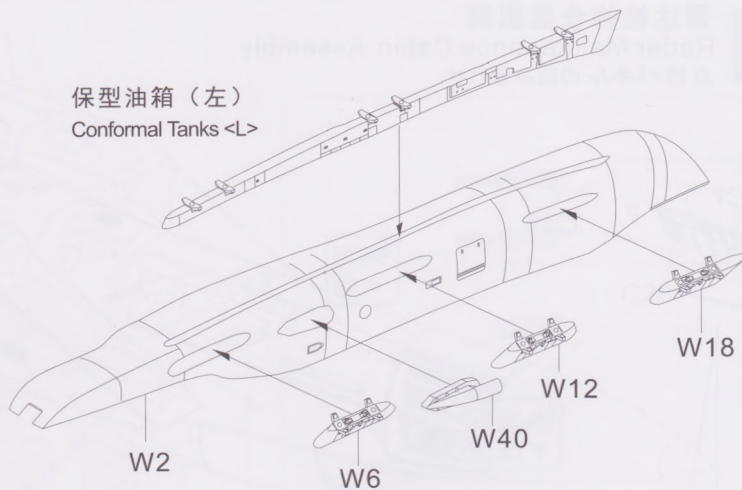

保形油箱 (右)
Conformal Tanks <R>

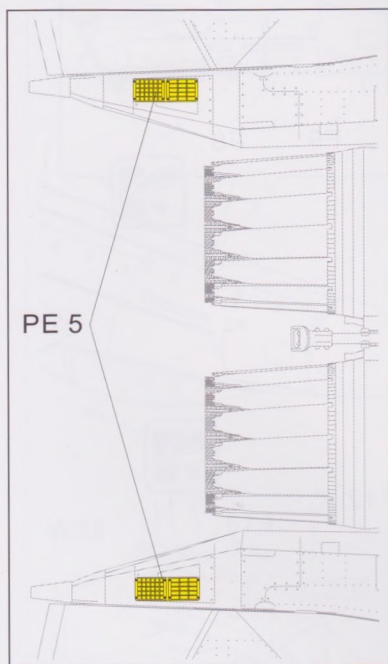
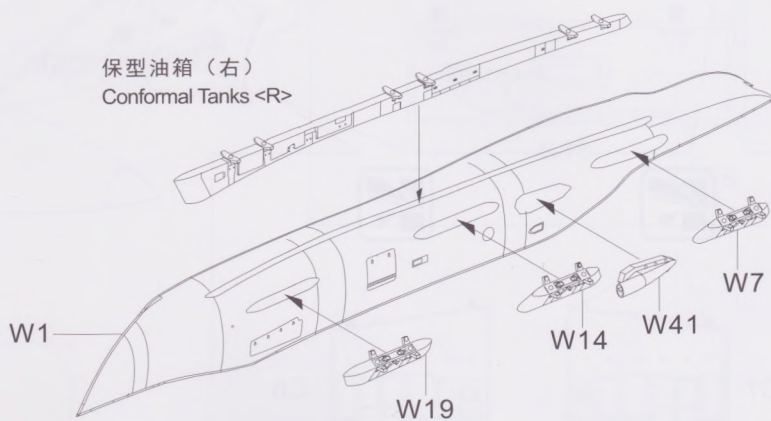

保形油箱 (右)
Conformal Tanks <R>

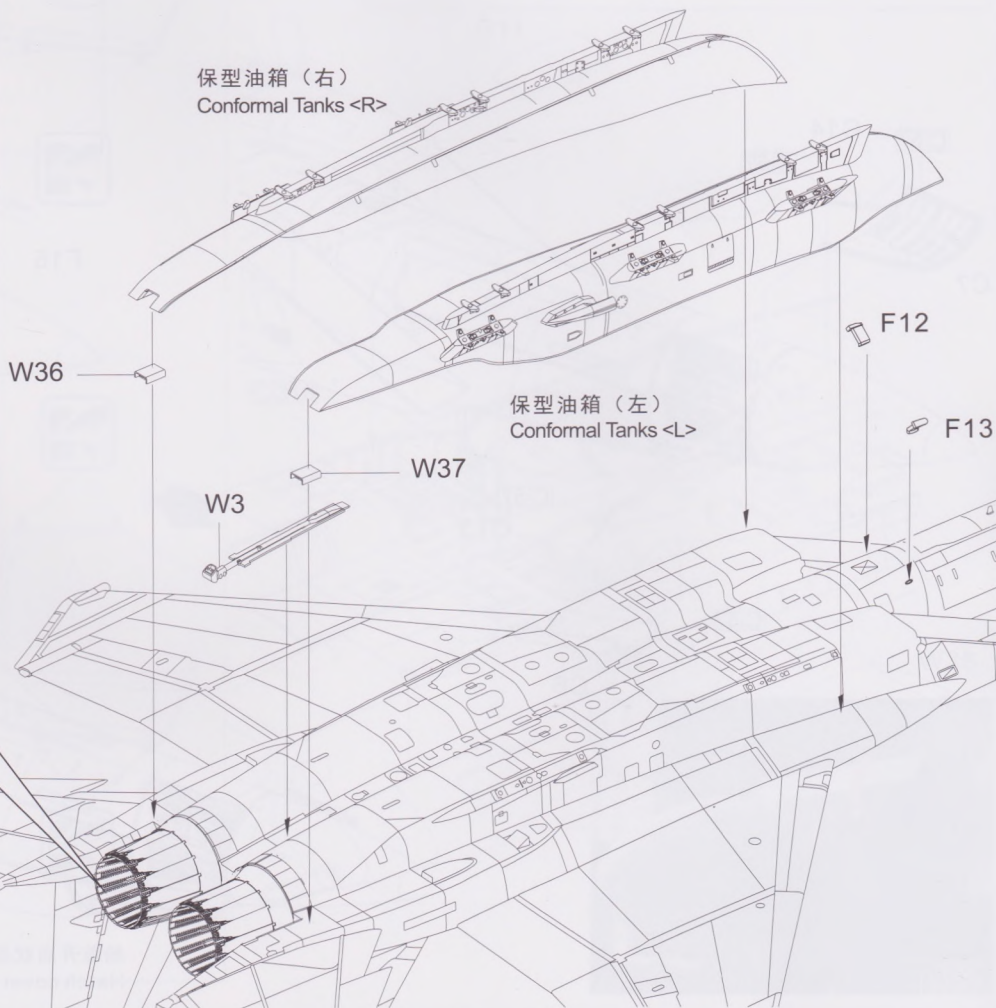

保形油箱 (左)
Conformal Tanks <L>

17

油箱和武器组装

Auxiliary Fuel Tanks / Weapons Assembly

増槽タンク/兵装の組み立て

610gal Fuel Tank **x2**

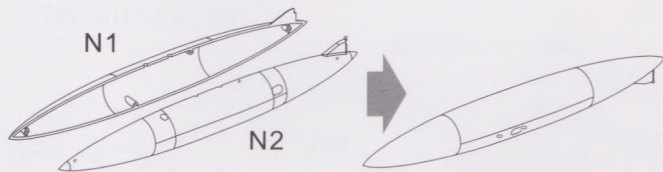

AXQ-14 **x1**

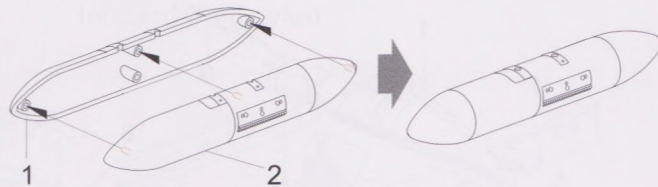

AAQ-13 **x1**

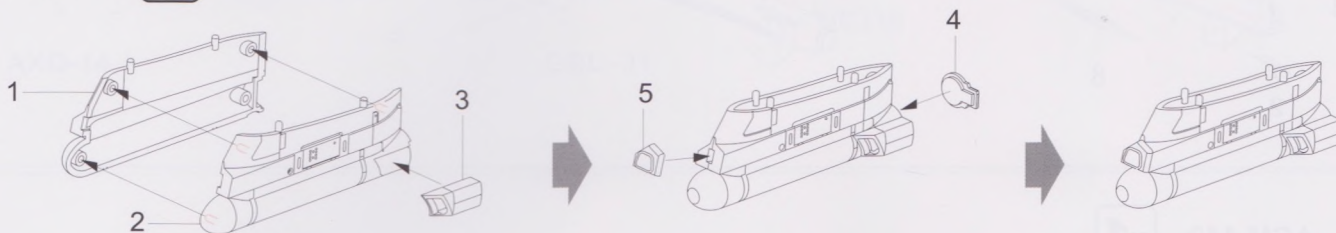

AAQ-14 **x1**

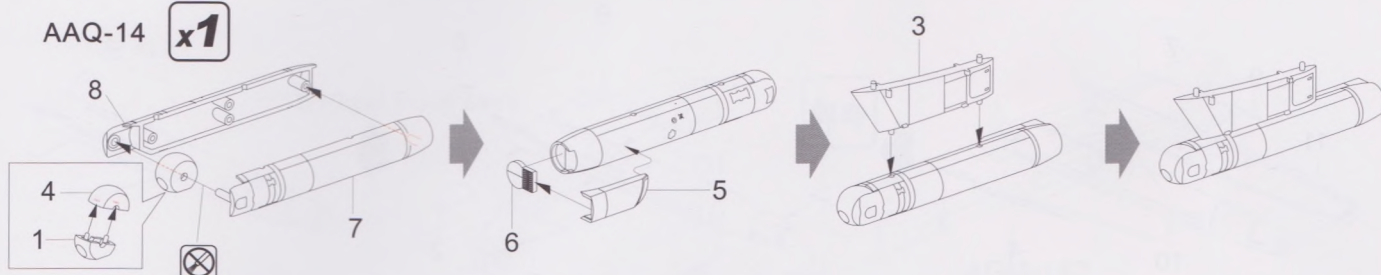

GBU-12 **x4**

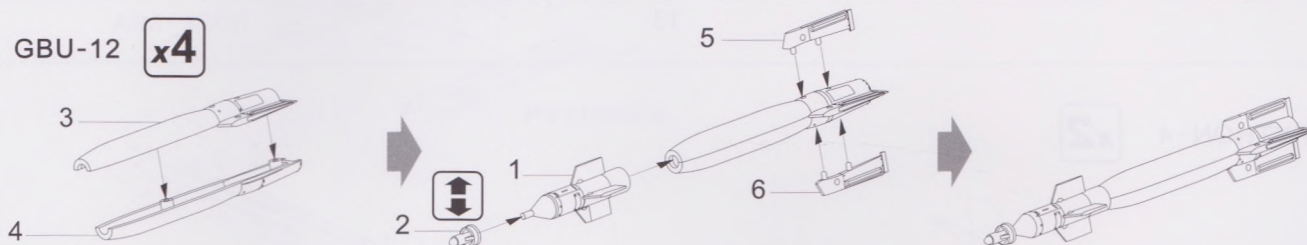

GBU-38 **x3**

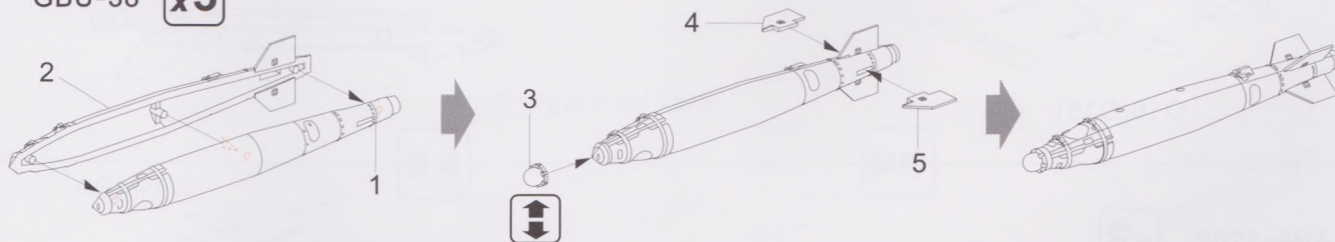

GBU-31 **x1**

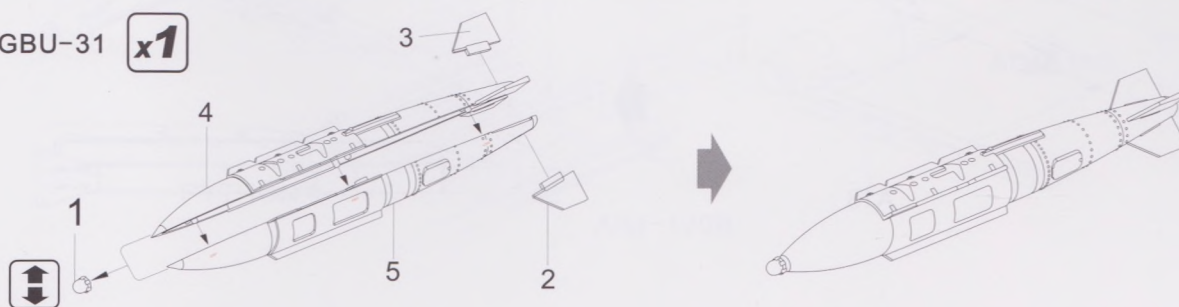

17

油箱和武器组装

Auxiliary Fuel Tanks / Weapons Assembly

増槽タンク/兵装の組み立て

AGM-130

x1

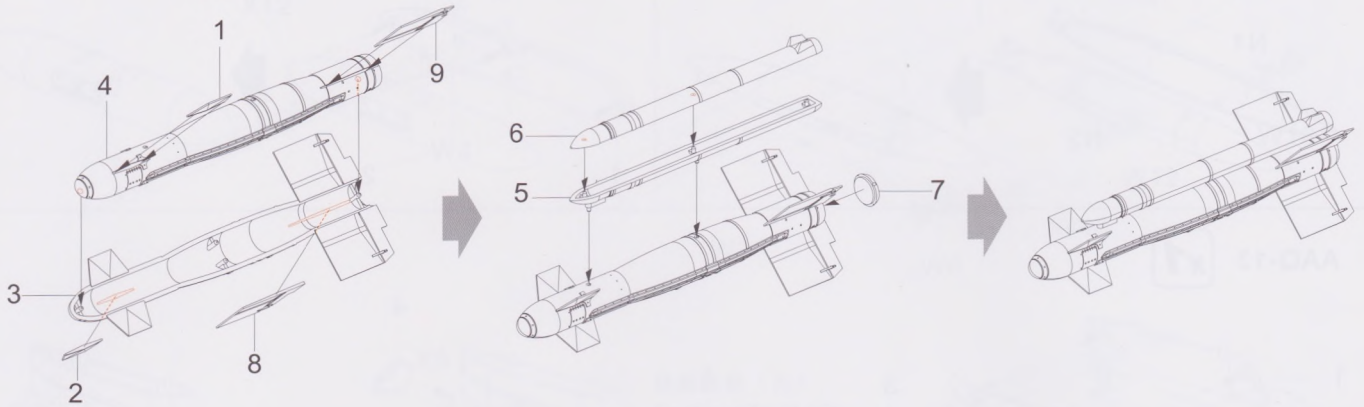

AGM-142

x1

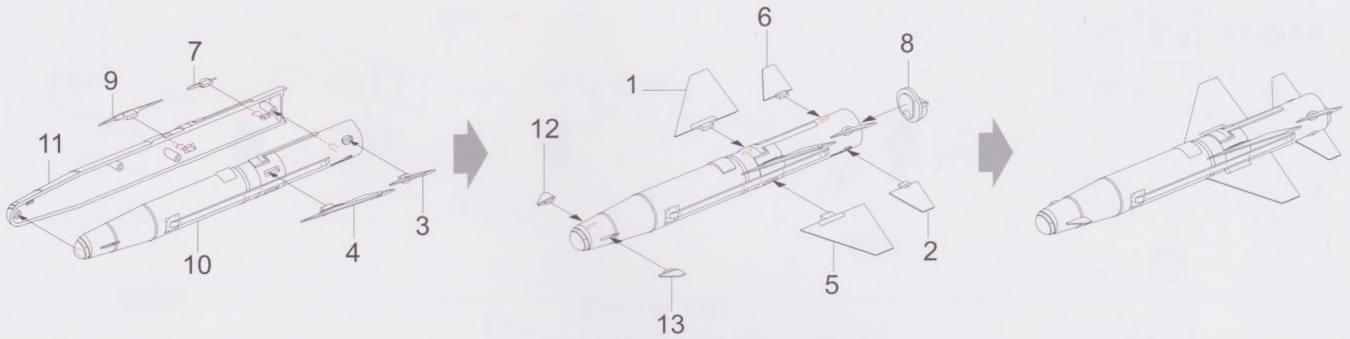

PYTHON-4

x2

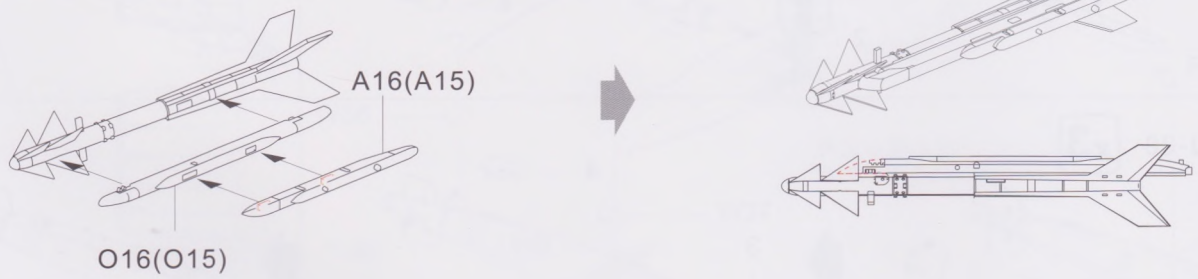

AIM-120B

x2

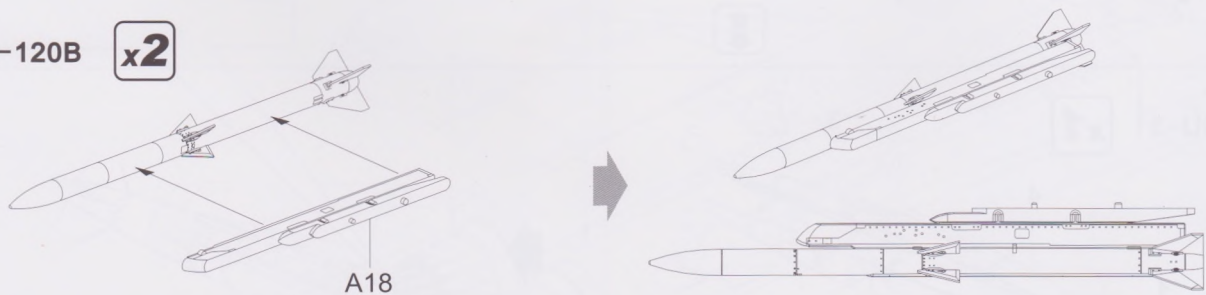

17

油箱和武器组装

Auxiliary Fuel Tanks / Weapons Assembly

増槽タンク / 兵装の組み立て

机腹中线挂架
Centerline pylon

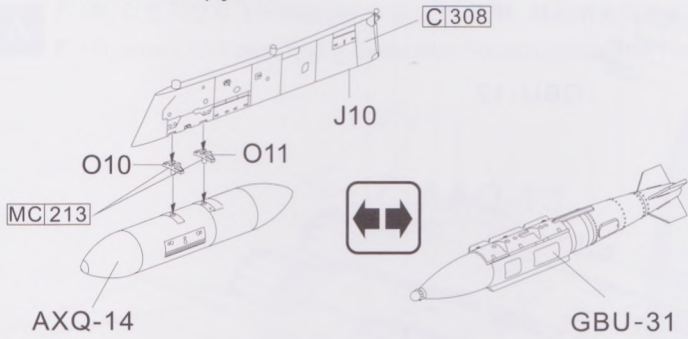

主翼主挂架
Inboard wing pylon

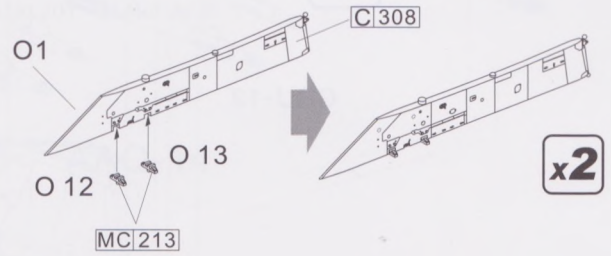

左 <L>

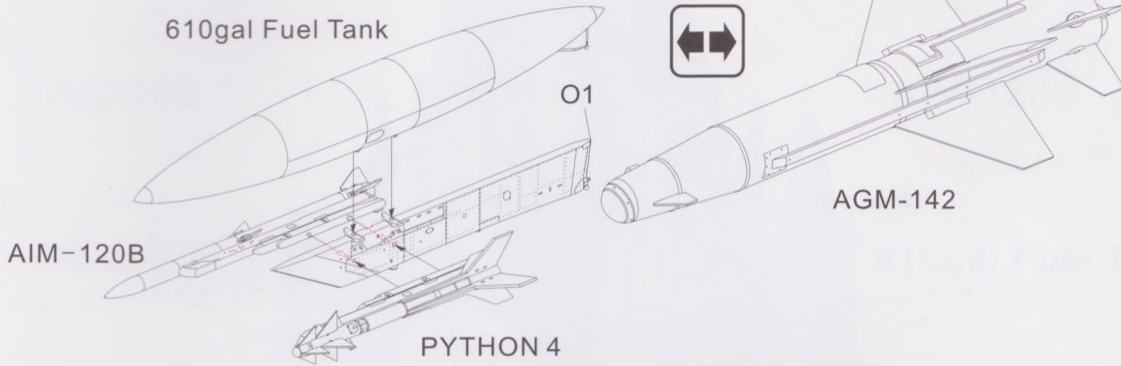

右 <R>

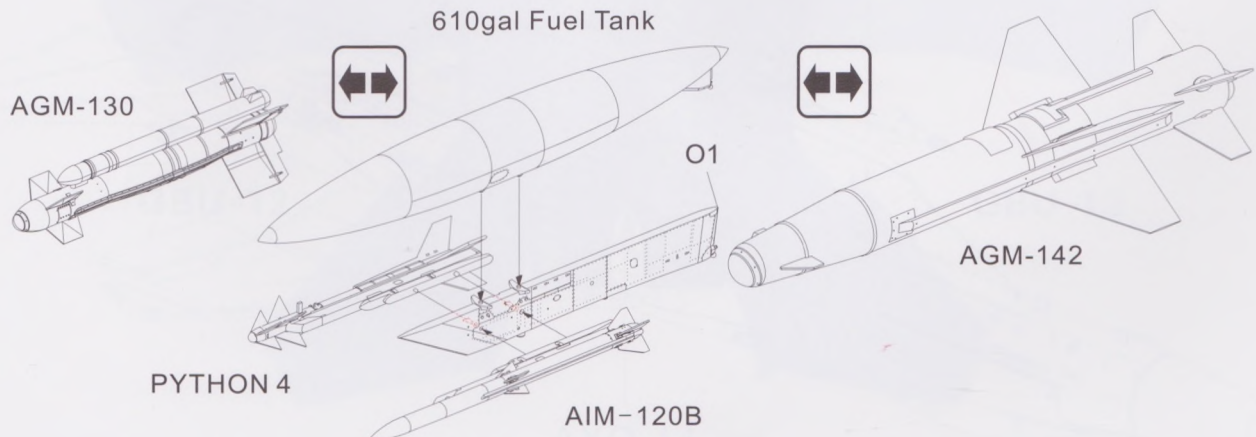

18

武器组装 I Weapons Assembly I 兵装の組み合わせ I

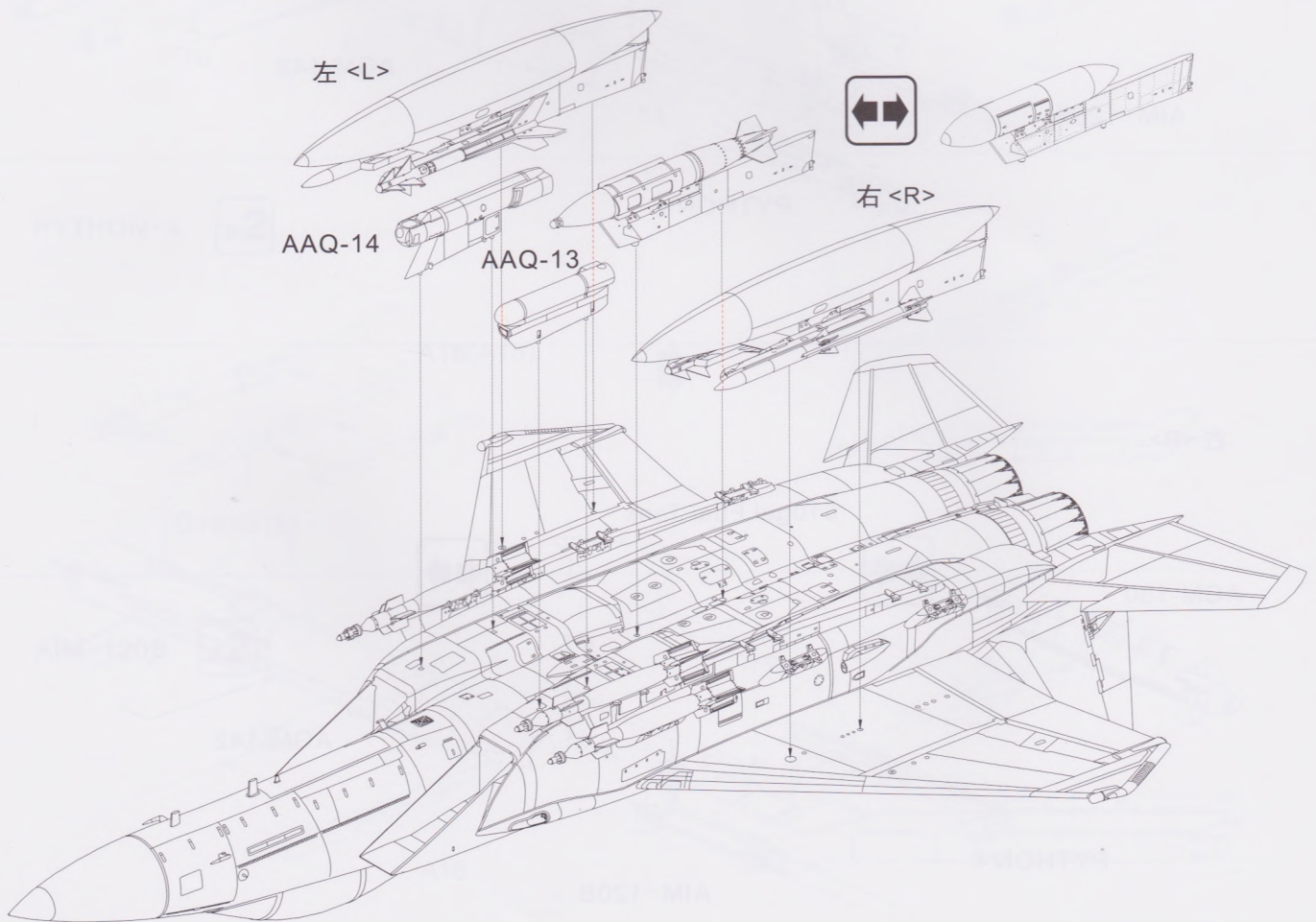
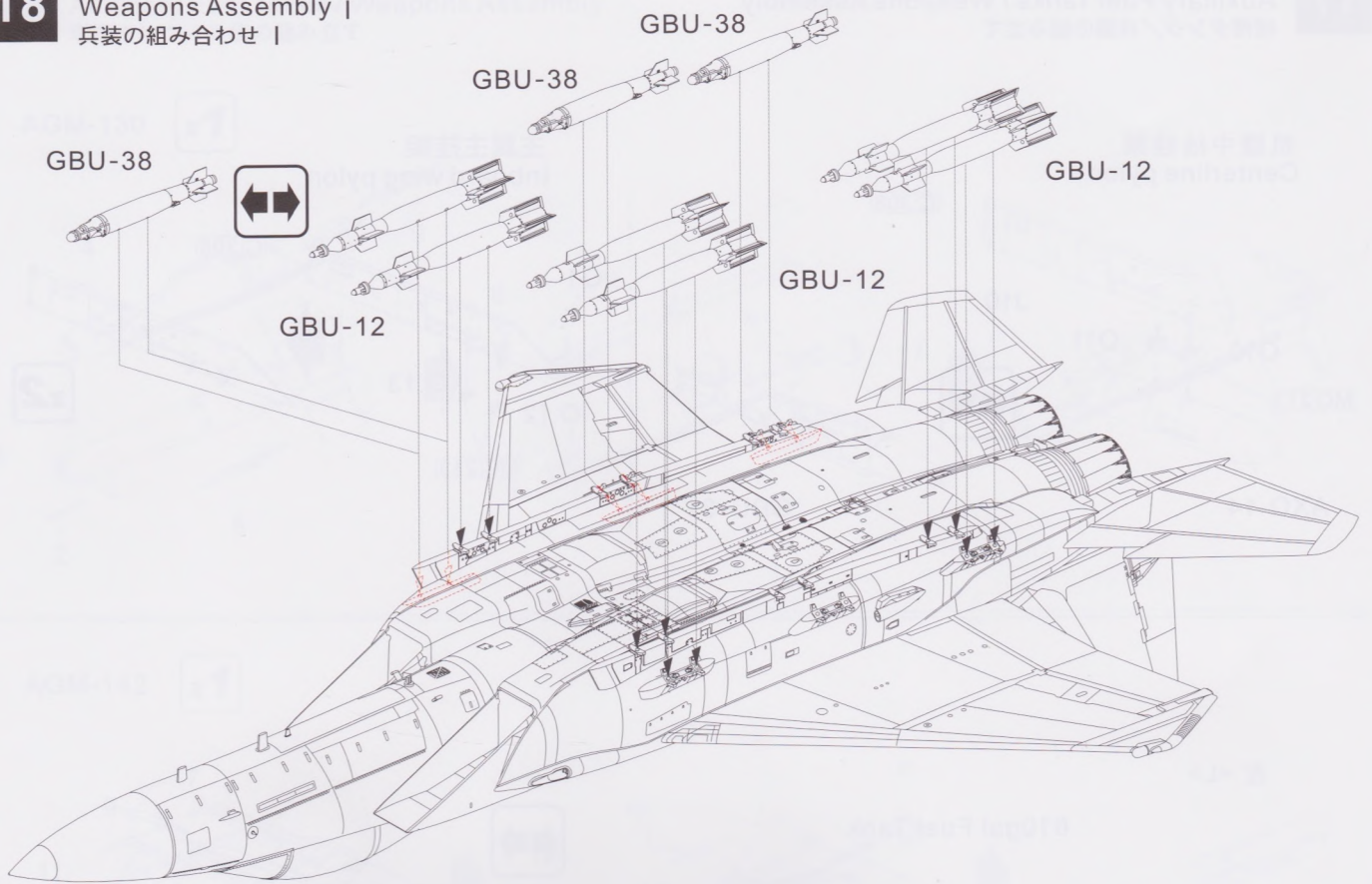

武器配置图

Armaments Installation

A

F-15I 以色列空军飞行测试评估中队, 201号机 特尔诺夫空军基地

F-15I Israeli Air Force Test & Evaluation Squadron(Manat in Hebrew),No.201 Tel-Nof AFB

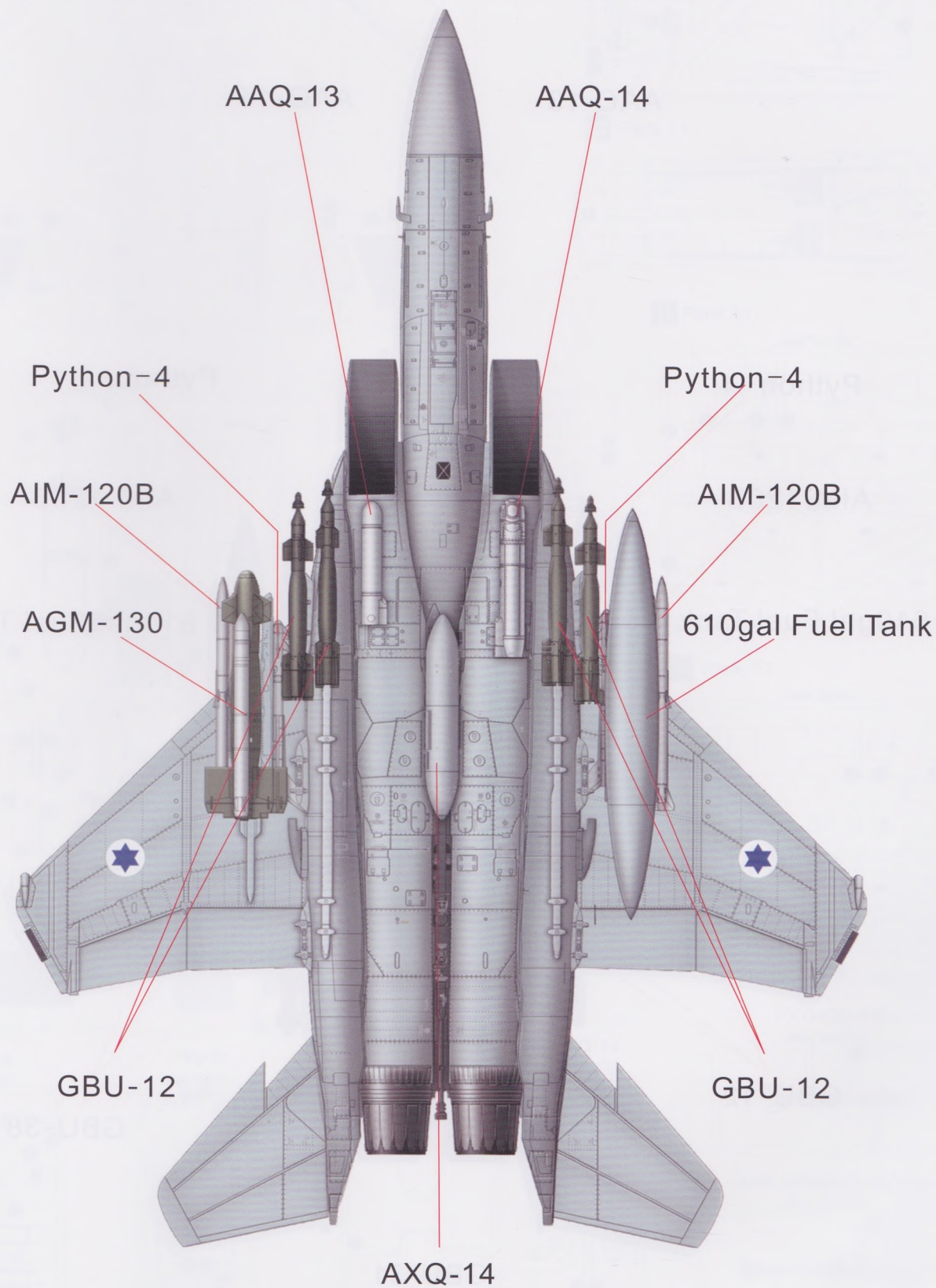

武器配置图
Armaments Installation

B F-15I Ra'am 以色列国防军空军第69“铁锤”中队, 241号机
F-15I Ra'am IAF 69 "Hammers" Squadron, No.241

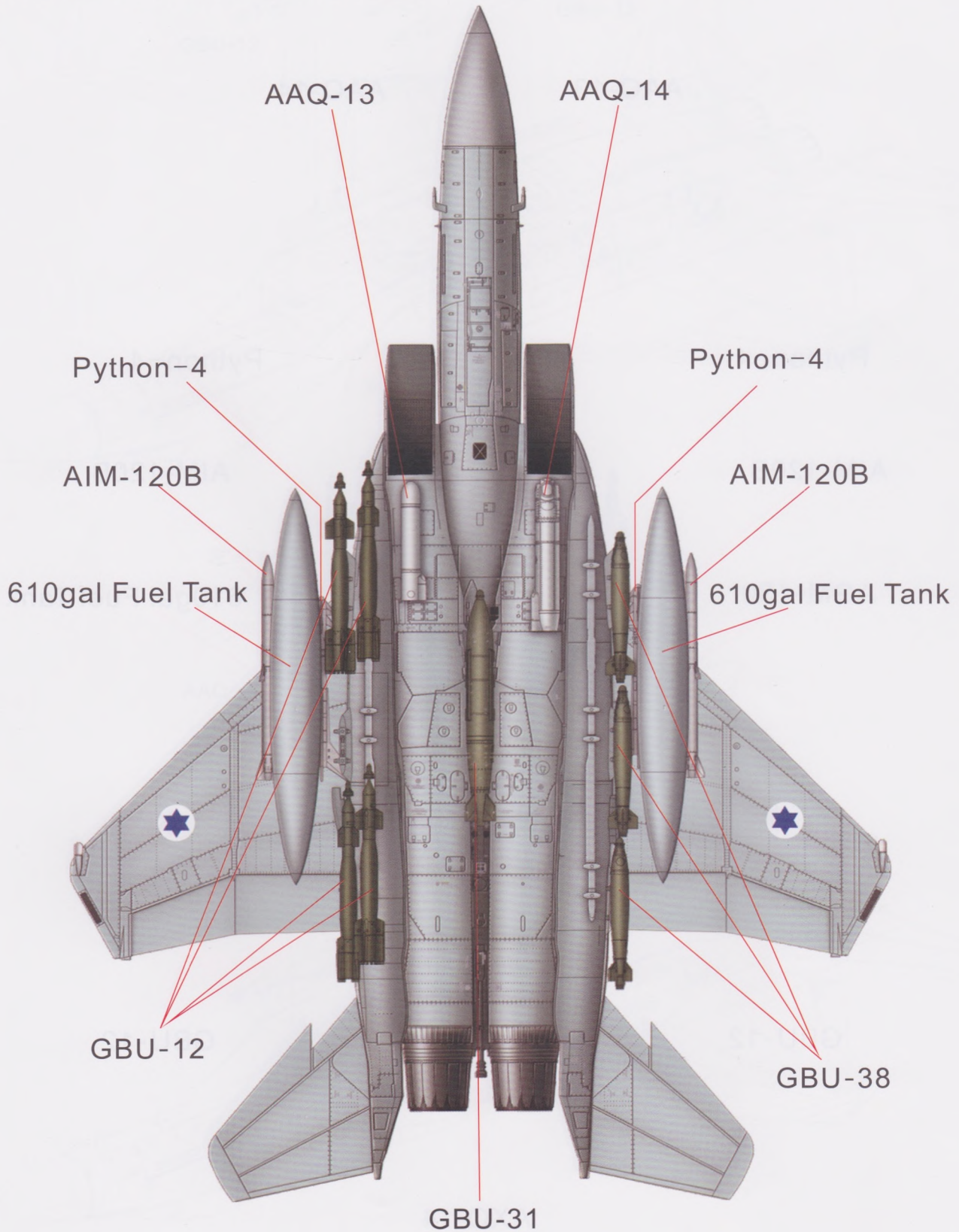

A Parts × 1

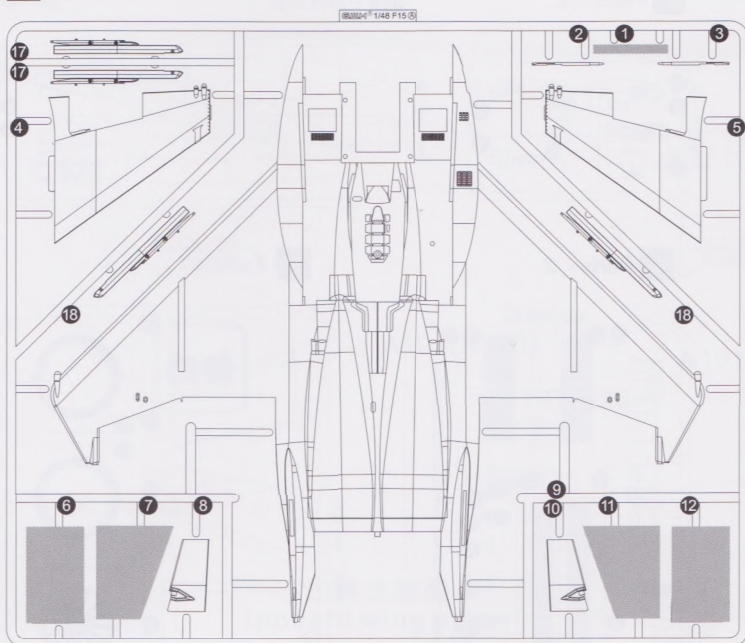

B Parts × 1

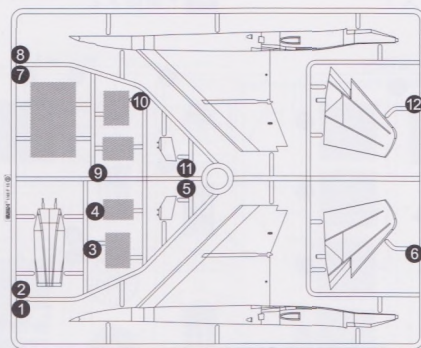

D Parts × 1

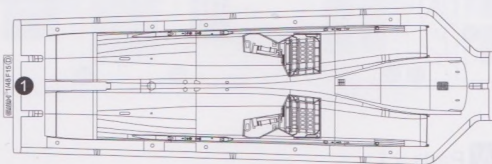

H Parts × 1

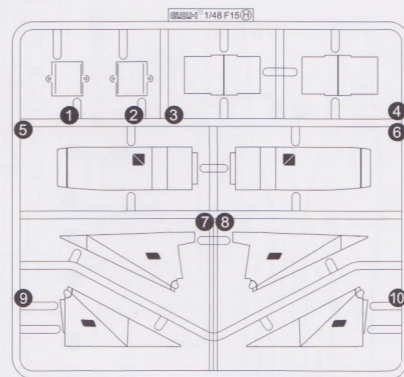

C Parts × 1

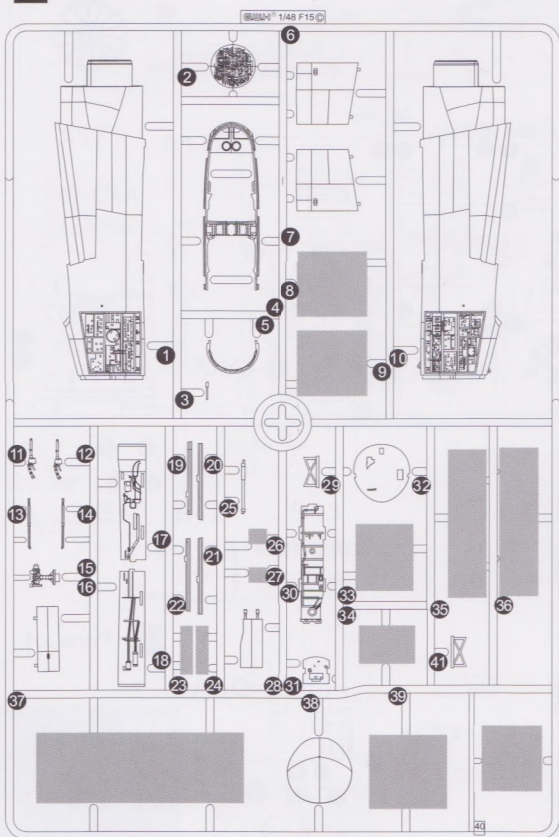

E Parts × 1

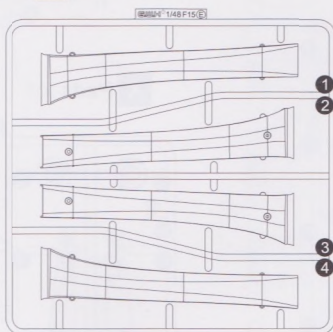

F Parts × 1

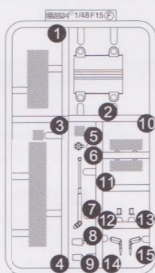

A Parts × 1

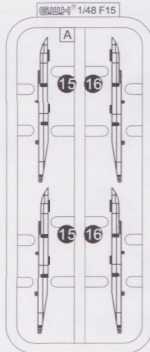

I Parts × 1

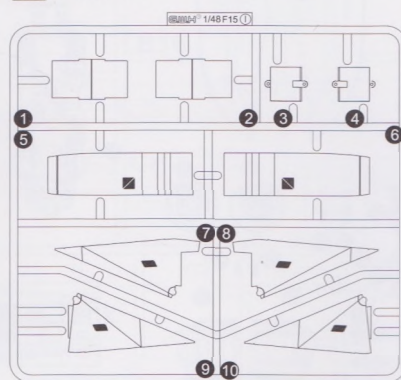

G Parts × 1

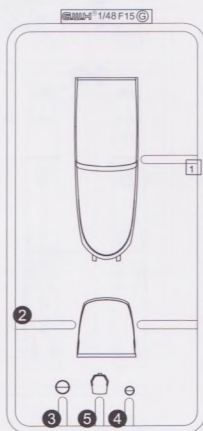

AXQ-14

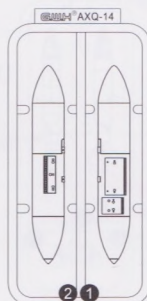

PYTHON-4x2

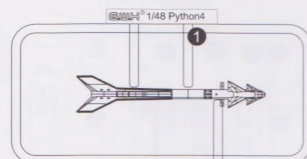

AIM-120B(AIM-120A)X2

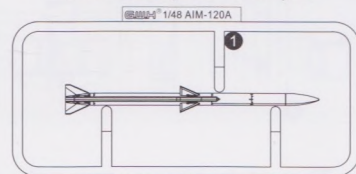

AAQ-14

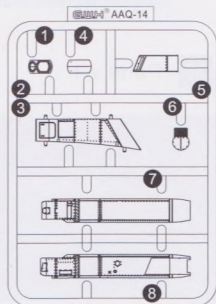

GBU-31

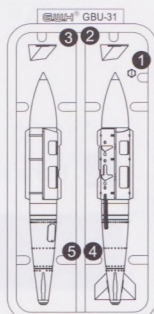

■ The parts in grey are not used.
灰色部分零件不使用。

J Parts × 1

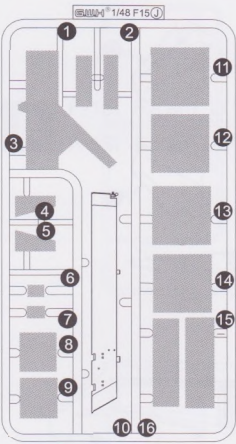

K Parts × 2

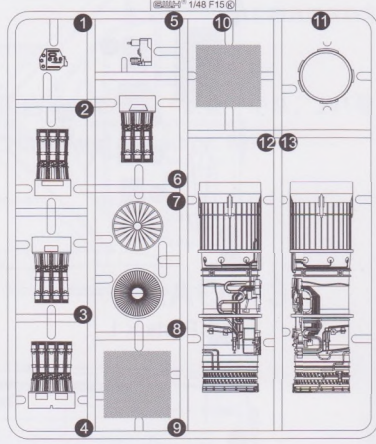

L Parts × 2

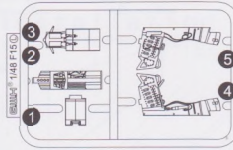

N Parts × 2

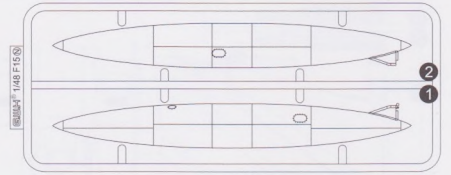

O Parts × 2

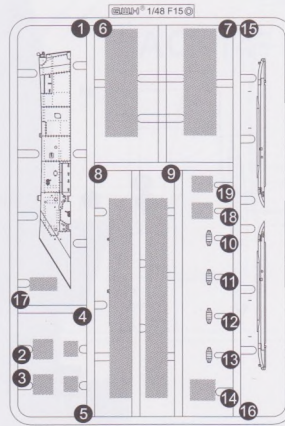

P Parts × 1

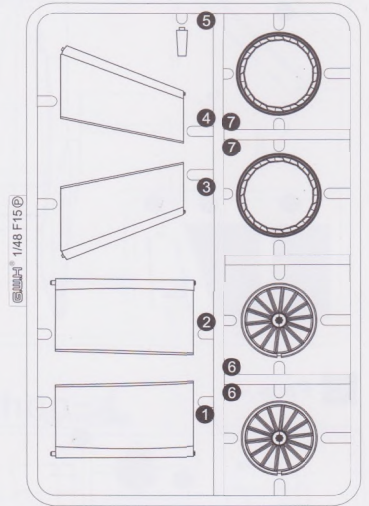

W Parts × 1

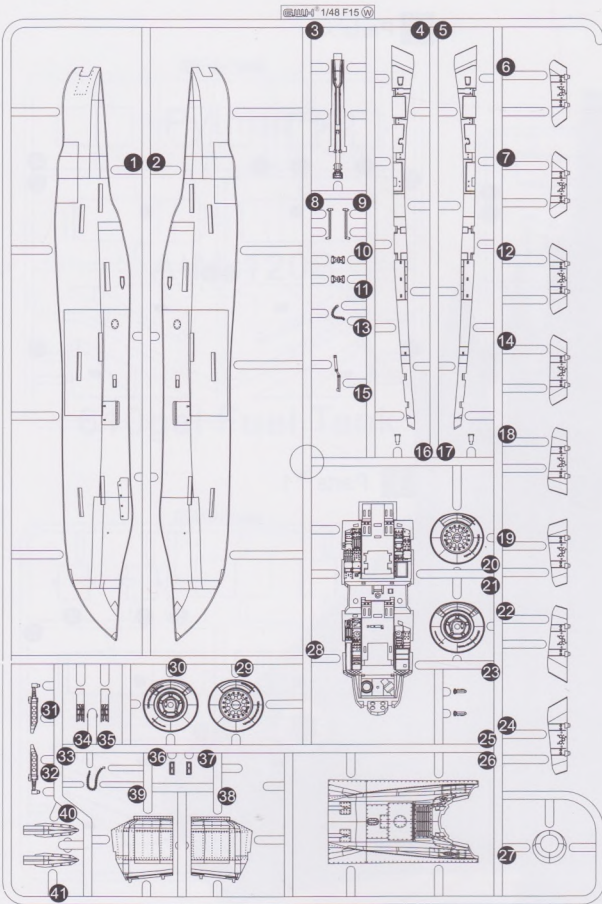

X Parts × 1

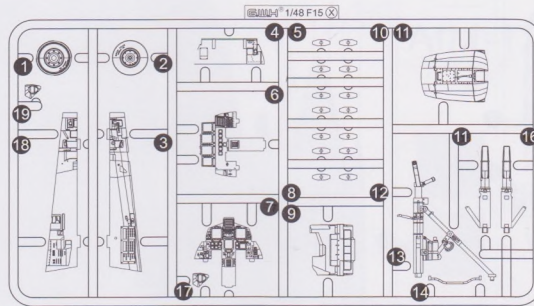

AAQ-13

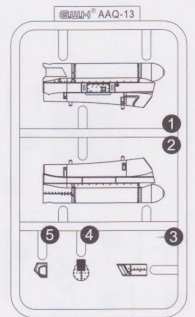

AGM-142

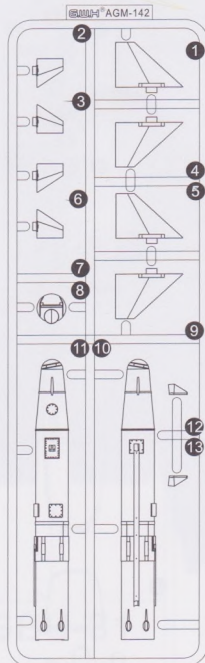

GBU-12x4

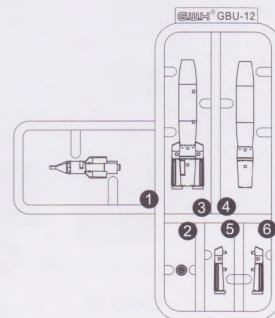

DA Parts × 1



AGM-130A

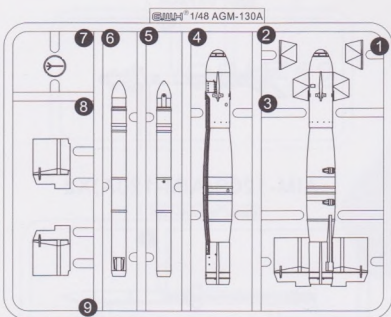

GBU-38x3

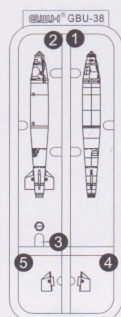

DB Parts × 1



PE Parts × 1

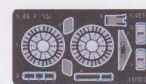

■ The parts in grey are not used.
灰色部分零件不使用。

Paint & Marking 通用水贴涂装指示

水贴编号 颜色编号
Decal No. Colour No

**保型油箱附属挂架
Outboard weapon row**

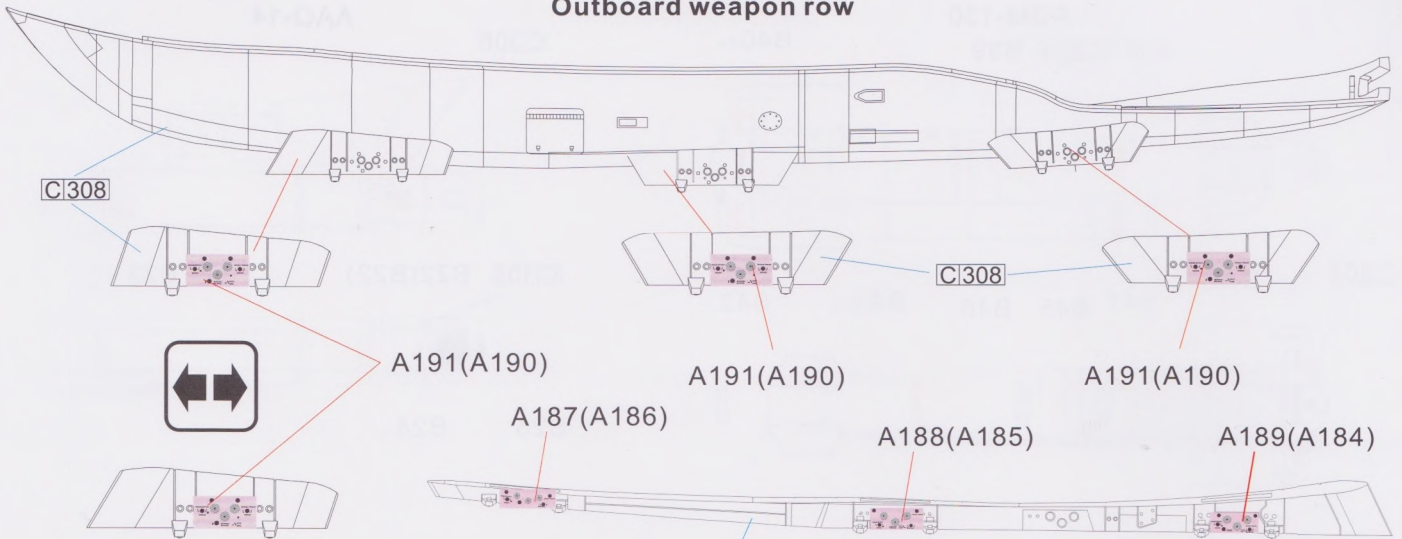

**主翼主挂架
Inboard wing pylon**

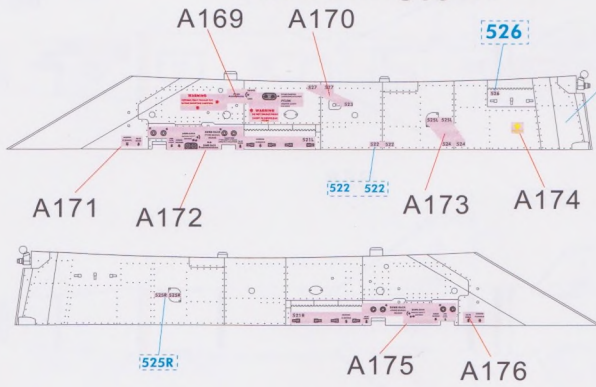

**机腹中线挂架
Centerline pylon**

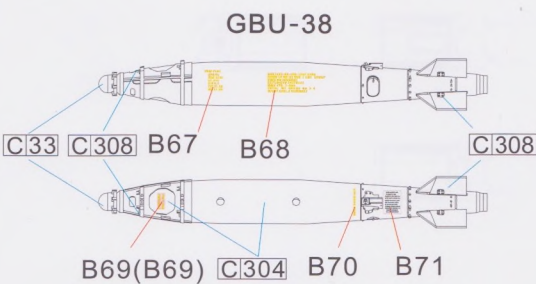
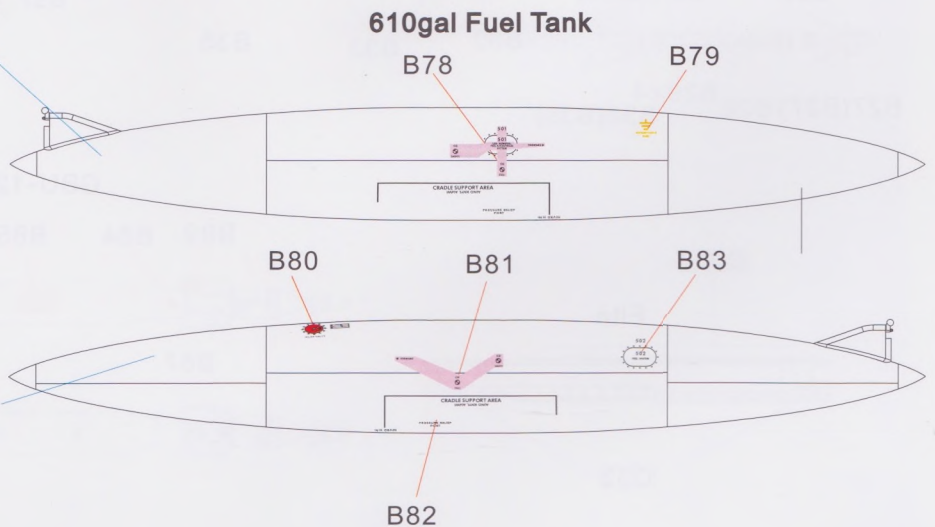
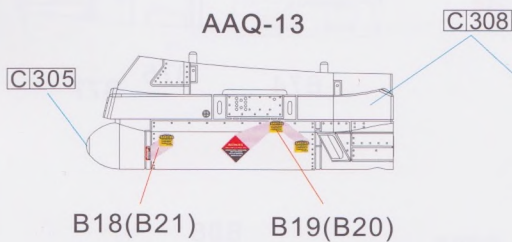
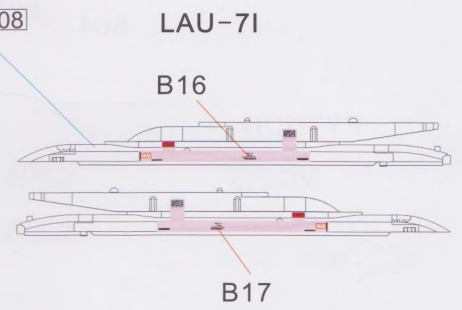
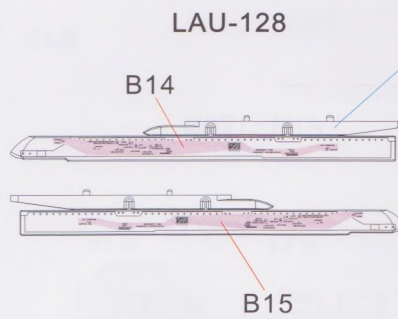
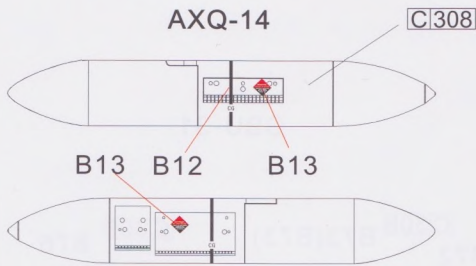
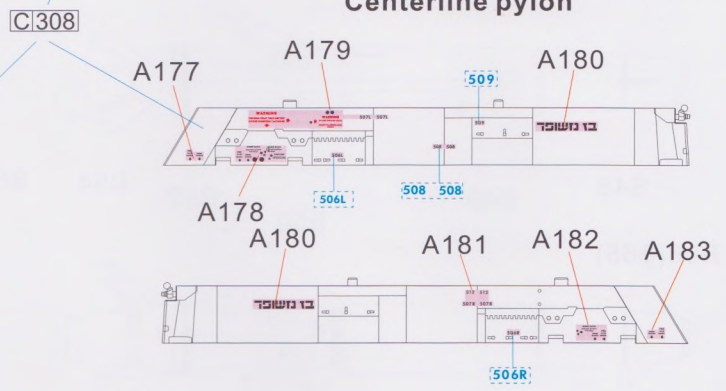

Paint & Marking 通用水贴涂装指示

水贴编号 颜色编号
Decal No. Colour No

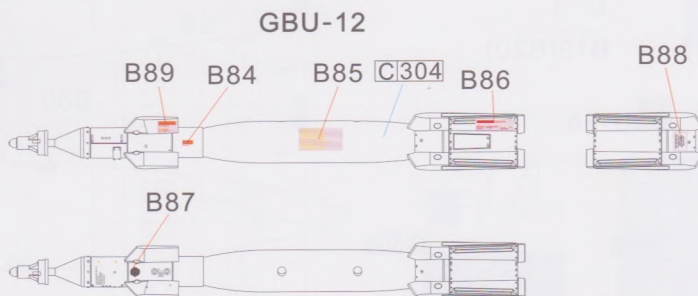
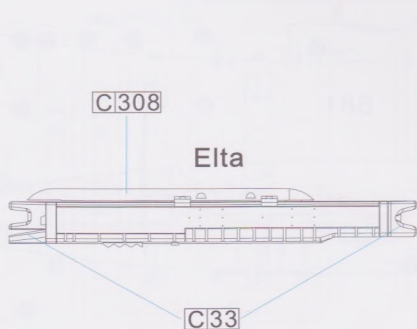
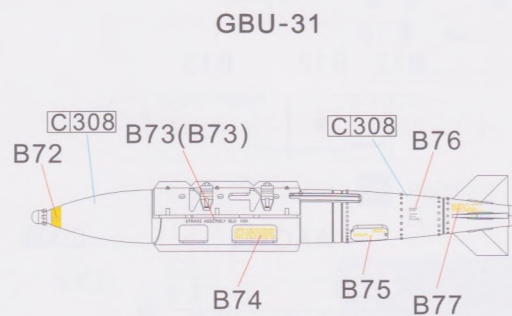
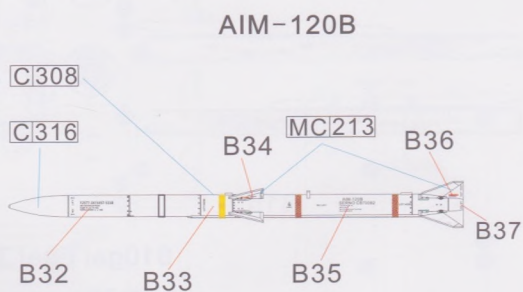
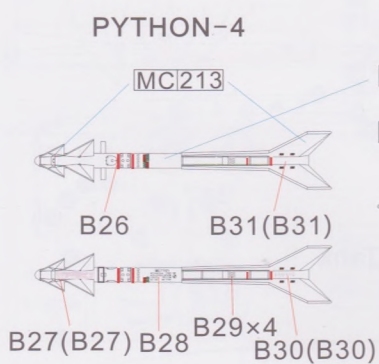
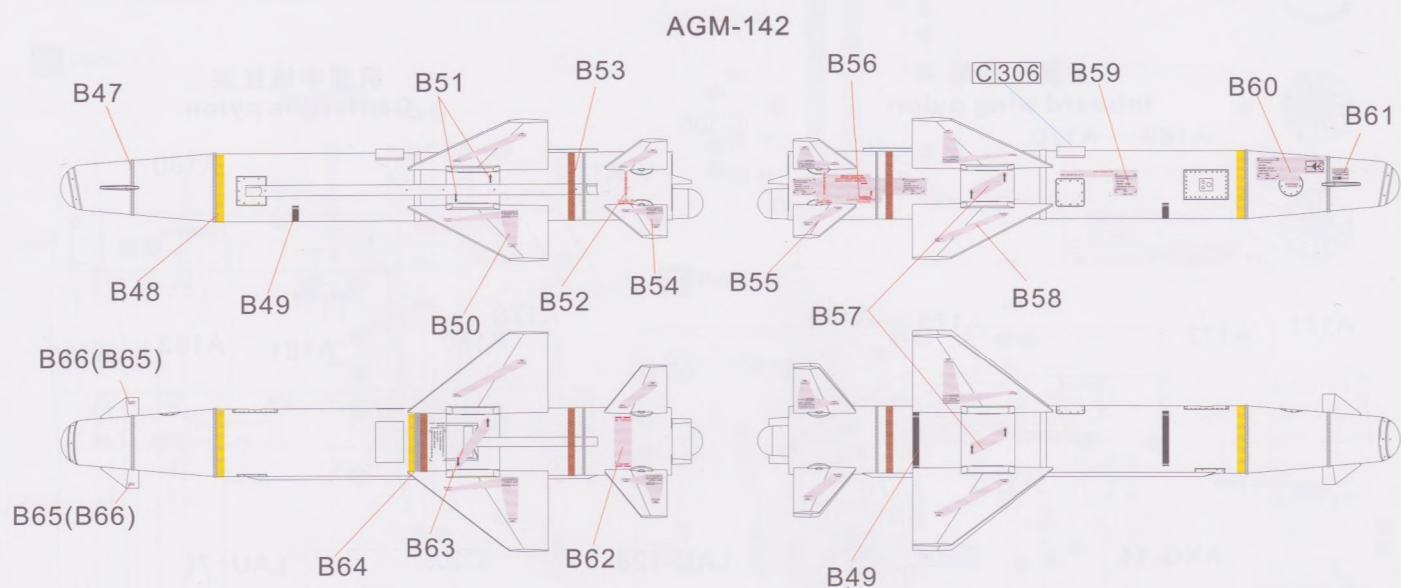
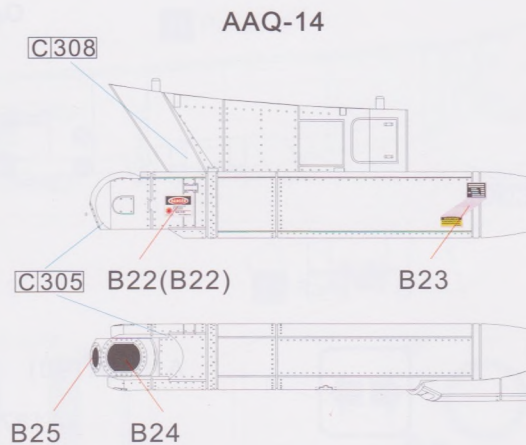
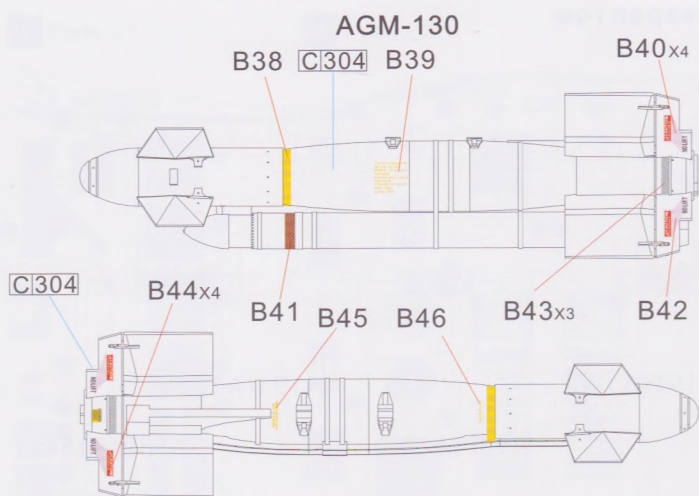

G.W.H[®]

F-15I IAF Ra'am

1/48
SCALE

L4816

以色列空军F-15I攻击鹰战斗机



上海狮瑞工艺模型有限公司
SHANGHAI LION ROAR ART MODEL CO.,LTD

地址:中国上海市零陵路631号25C室 邮编: 200030
Room 25C, No.631, Ling Ling Road, Shanghai, 200030, P.R.China
Tel:86-21-34230563 Fax:86-21-34230561 E-mail: marketing@lionroarmodel.com

www.lionroar.net www.lionroarmodel.cn

A F-15I 以色列空军飞行测试评估中队, 201号机 特尔诺夫空军基地
 F-15I Israeli Air Force Test & Evaluation Squadron(Manat in Hebrew), No.201 Tel-Nof AFB

Paint & Marking 涂装指示
 水贴编号 Decal No. 颜色编号 Colour No.

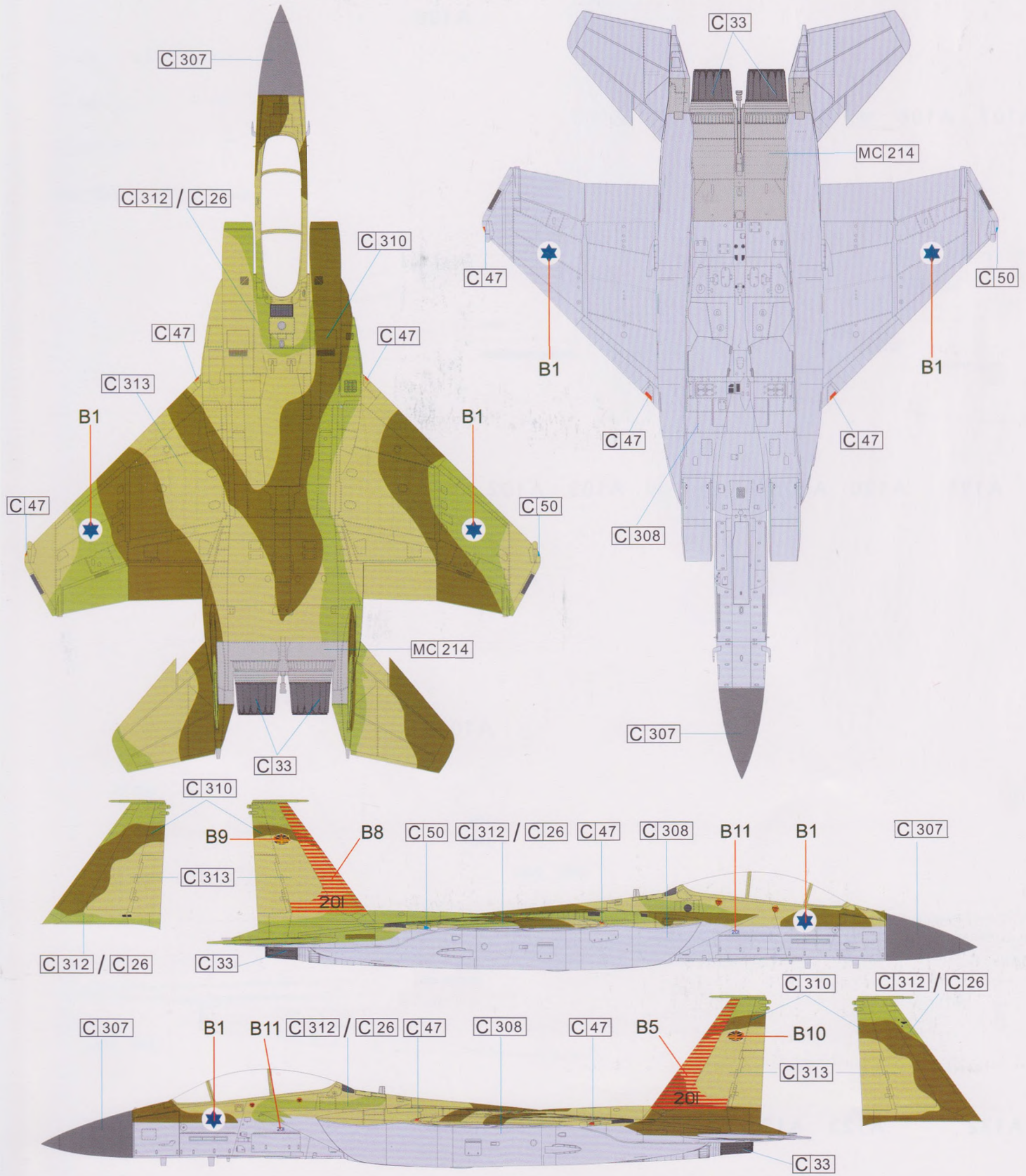

B F-15I Ra'am 以色列国防军空军第69“铁锤”中队, 241号机
 F-15I Ra'am IAF 69 "Hammers" Squadron, No.241

Paint & Marking 涂装指示
 水贴编号 Decal No. 颜色编号 Colour No.

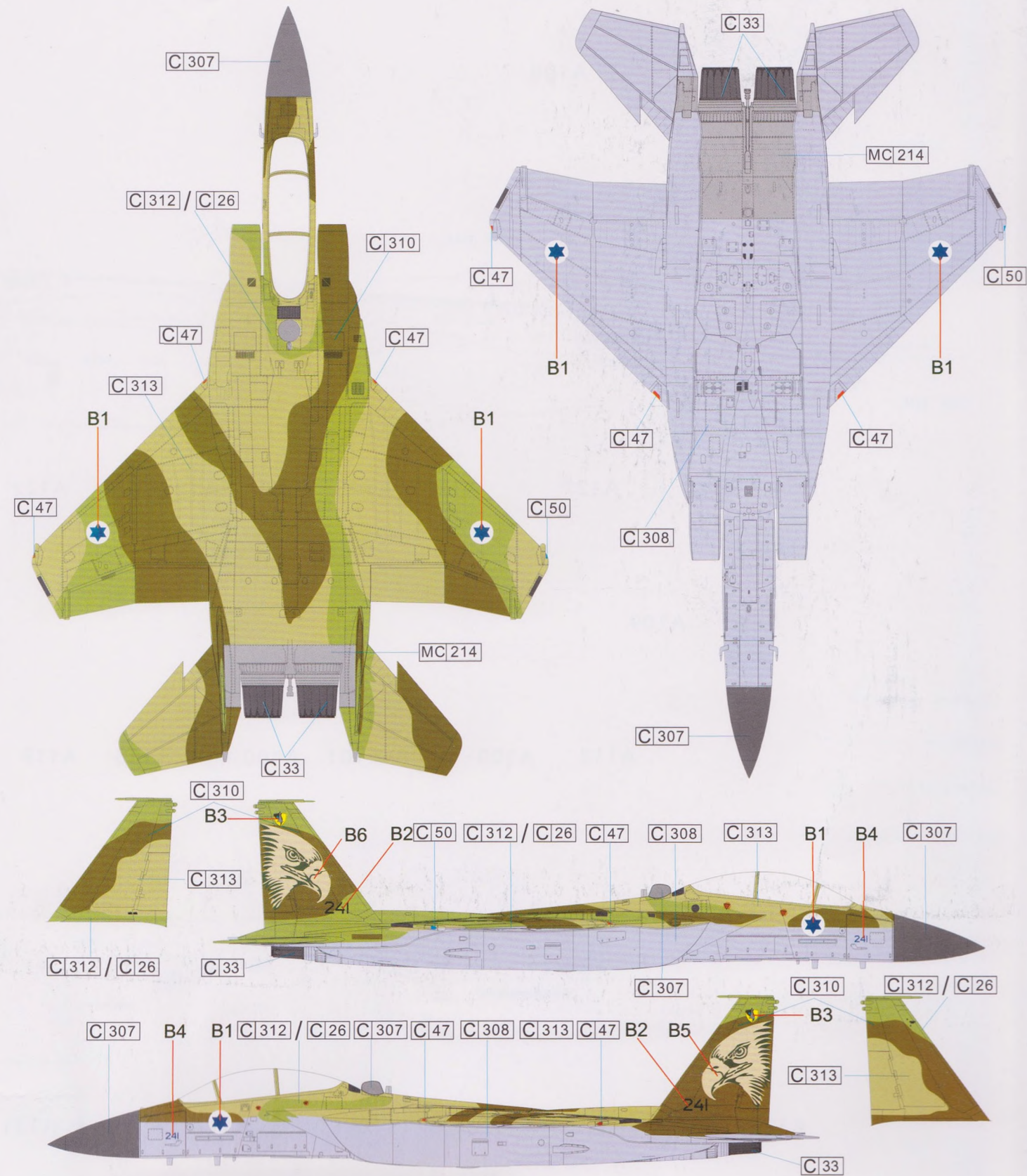

Paint & Marking 通用水贴涂装指示

Decal No. 水贴编号



Paint & Marking 通用水贴涂装指示

水贴编号
Decal No.

