

STEP 13



# Heinkel He 280 (engine Heinkel) scale 1/72

The Heinkel He 280 was the first jet powered fighter, although it never entered mass production. The aircraft was ready before the first of the new generation of Heinkel engines, and so its first test flight, on 22 September 1940, was an unpowered gliding test. The first powered flight followed on 2 April 1941, and saw the V1 take to the air powered by two HeS 8 engines. This was followed by a demonstration flight in front of Luftwaffe and Air Ministry officials on 5 April, which led to approval being given for Heinkel to develop a new general of jet engines. When powered by the same engines the smaller lighter He 280 was faster as the Me-262, had a faster rate of climb, and a higher maximum ceiling, but it suffered some problems with its tail, had a shorter range than the Me 262 and was under-armed compared to the Me 262. In 1943 work on developing the Heinkel design as a production fighter aircraft came to an end, although the aircraft continued to be used for development work and to test new engines. At least 100 test flights were made between August 1944 and early 1945. Some of the experiments were made in an attempt to solve some of the problems of high speed flight, and some to test a new 'vee' shaped tail that was being designed for the He 162 and Me 262. Total was built 9 prototypes.

RS MODELS

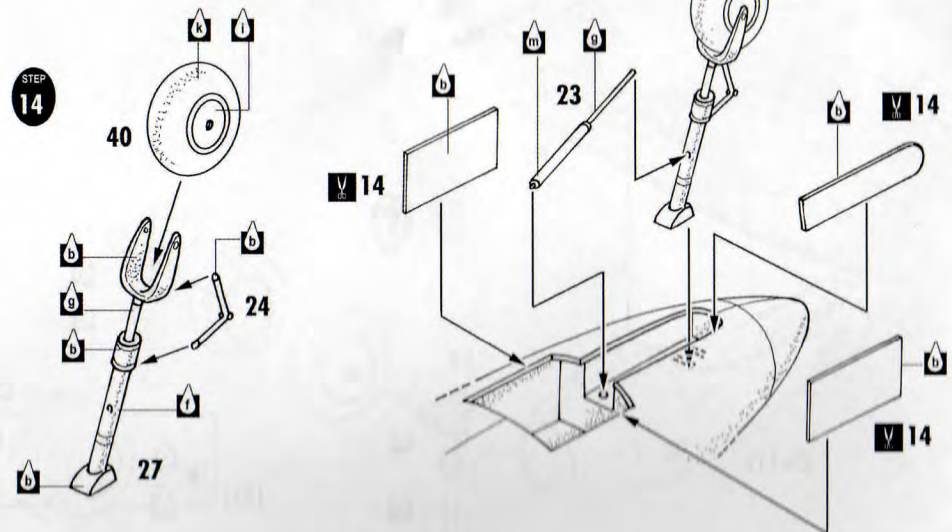

STEP 14

STEP 14

| CLEAR PARTS (CPI) |   |
|-------------------|---|
| 1                 | 2 |

| COLORS |                     |   |                        |
|--------|---------------------|---|------------------------|
| a      | Černá Black         | b | Červená Red            |
| b      | RLM02               | i | RLM66                  |
| c      | Stříbrná Silver     | j | Ocelová Iron metal     |
| d      | Přímo Linen         | k | Pneumatiky Tyres Black |
| e      | Kůže Leather        | l | Rezavá Rust            |
| f      | Hliníková Aluminium | m | Tmavá šedá Dark Grey   |
| g      | Chromová Chrome     | n | Kovová Gun metal       |

|     |             |     |                                       |     |                  |     |                |     |                 |     |                      |     |              |     |             |     |      |     |                                        |
|-----|-------------|-----|---------------------------------------|-----|------------------|-----|----------------|-----|-----------------|-----|----------------------|-----|--------------|-----|-------------|-----|------|-----|----------------------------------------|
| (C) | ohnout bend | (Y) | vlečtinové lepidlo cyanoacrylate glue | (V) | odstranit remove | (R) | upravit reduce | (O) | vrtat open hole | (S) | vyrobit scotch build | (D) | obtisk decal | (B) | barva color | (F) | film | (S) | symetrická montáž symmetrical assembly |
|-----|-------------|-----|---------------------------------------|-----|------------------|-----|----------------|-----|-----------------|-----|----------------------|-----|--------------|-----|-------------|-----|------|-----|----------------------------------------|

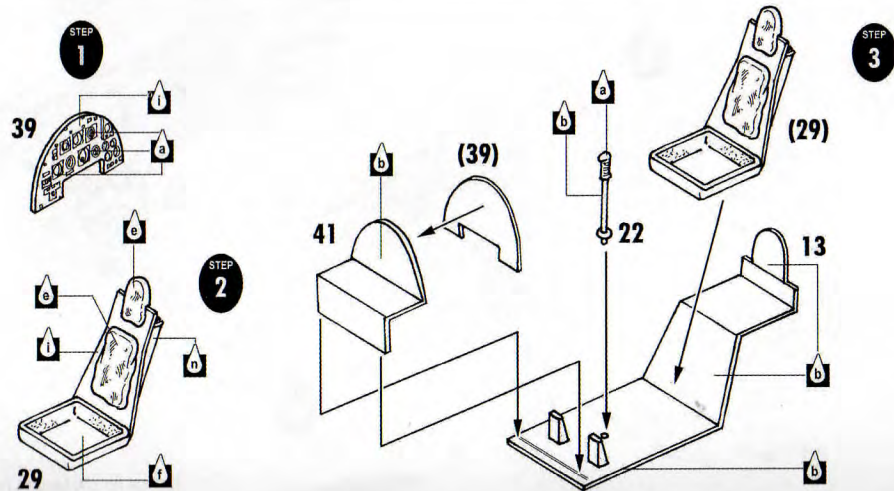

STEP 15

STEP 1

STEP 2

STEP 3

Heinkel He 280 (engine Heinkel)

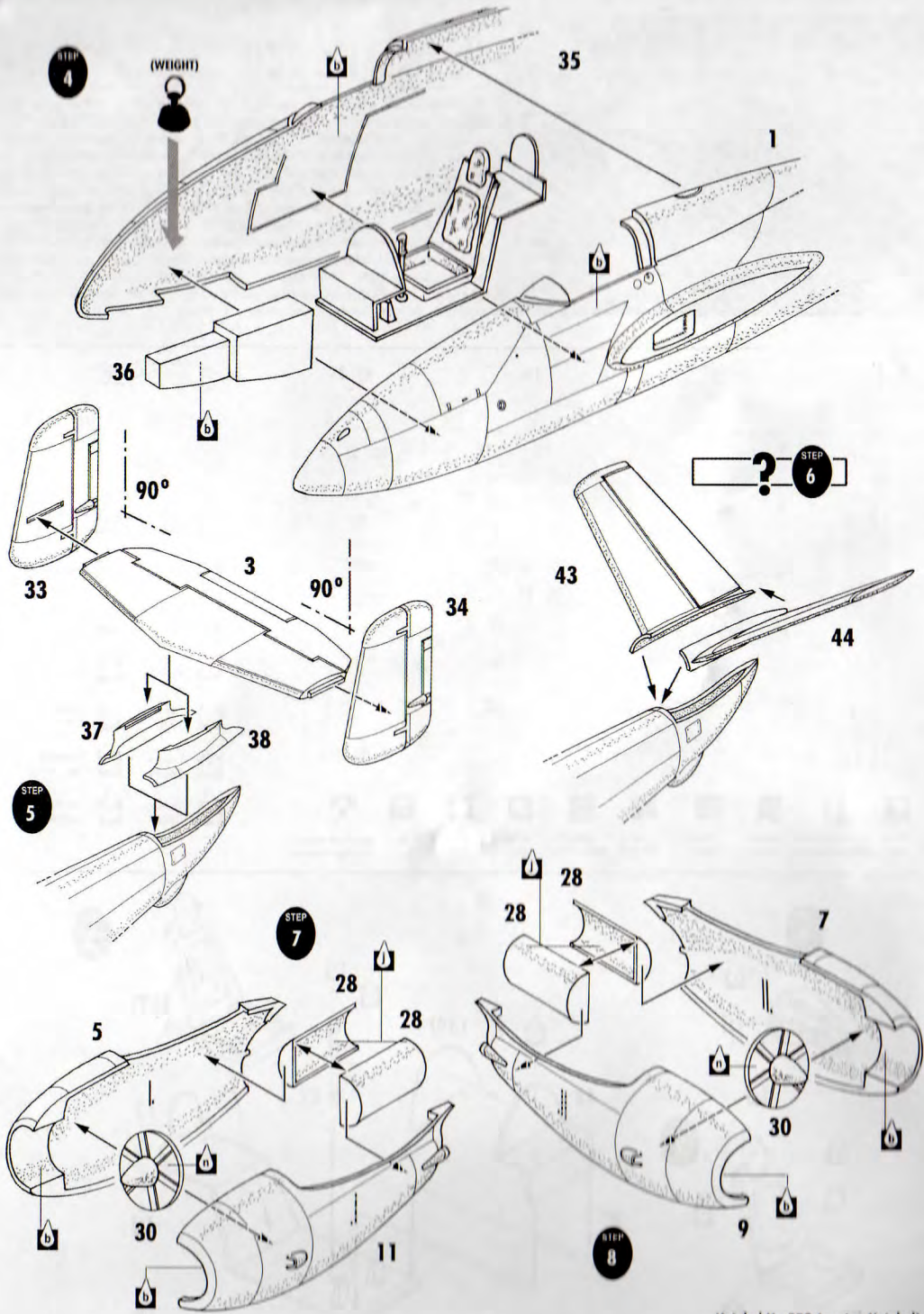

Heinkel He 280 (engine Heinkel)

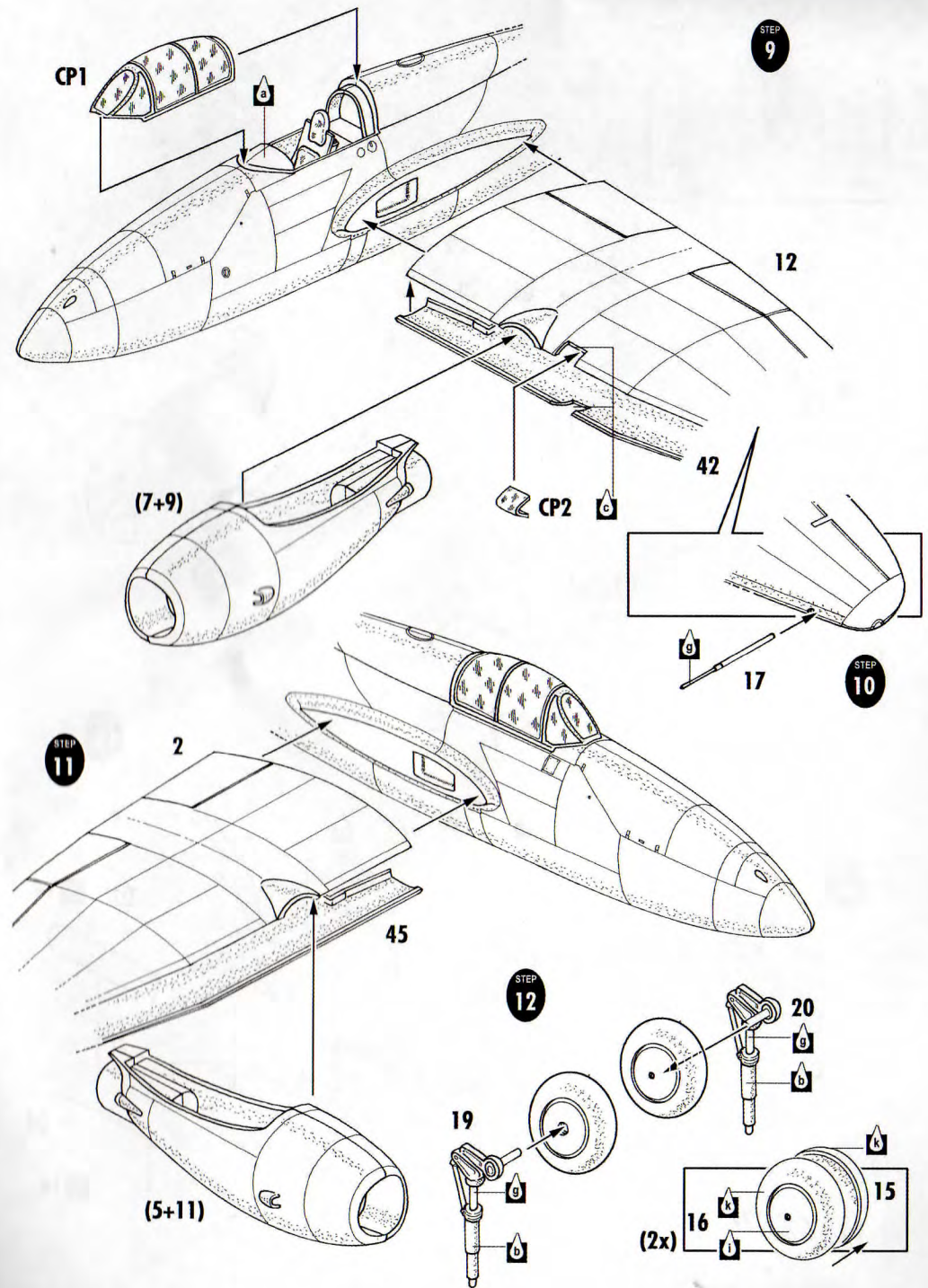

Heinkel He 280 (engine Heinkel)