

RESIN PARTS:

- | | | |
|---------------------------|-------------------------------|-------------------|
| 1. Tub | 10. Front Instrument Panel | 19. Throttle (x2) |
| 2. Seat (x2) | 11. Rear Instrument Panel | 20. Seat Raisers |
| 3. Wheel Well Bulkhead | 12. Rear Rudder Pedal Housing | |
| 4. Stick (x2) | 13. Rear Handle R | |
| 5. Rudder Pedals (x4) | 14. Rear Handle L | |
| 6. Mid Coaming | 15. Rear Side Wall R | |
| 7. Mid Coaming Detail | 16. Rear Side Wall L | |
| 8. Seat Head Sensors (x2) | 17. Front Side Wall R | |
| 9. Ejection Handle (x2) | 18. Front Side Wall L | |

AVIONIX
by Black Box

Item # AV48021
F-15E Strike Eagle
cockpit set for Revell/Monogram kit
1/48 scale

Step 1 **IMPORTANT NOTE:** Remove all detail from the inside of the fuselage halves (both sides) where the side walls will be installed.

Test fit tub several times before gluing left side walls to left fuselage



Gently tack right side walls to tub as shown

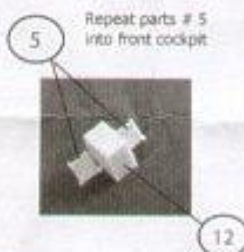

Repeat parts # 5 into front cockpit

Step 2



Step 3: REAR TUB

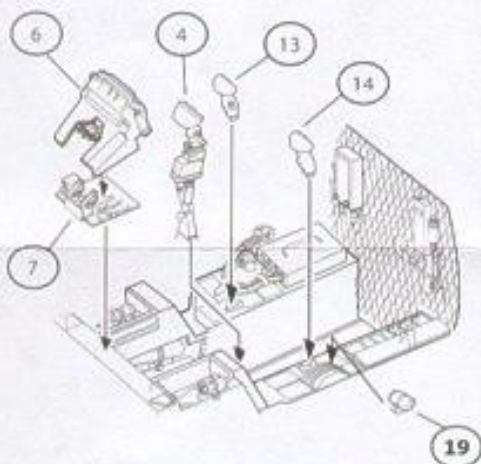

Repeat #4 and #19 into front tub

Step 4

Remove the two tabs from plastic part # 180 and glue together wheel well (parts # 22 - 180 - 46) and replace wheel well bulkhead with resin part #3 as shown in photo.

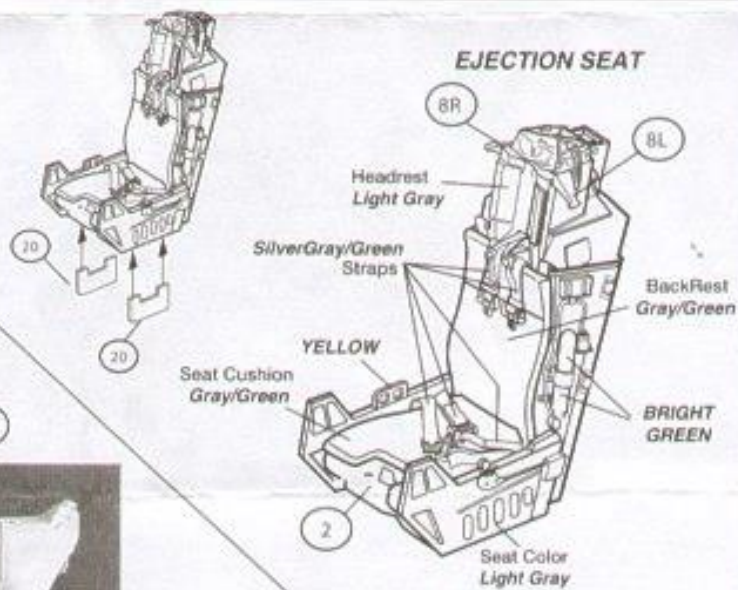
**EJECTION SEAT**

Step 5 Line up tub side walls and wheel bay as shown in photo. Again, test fit several times before gluing.

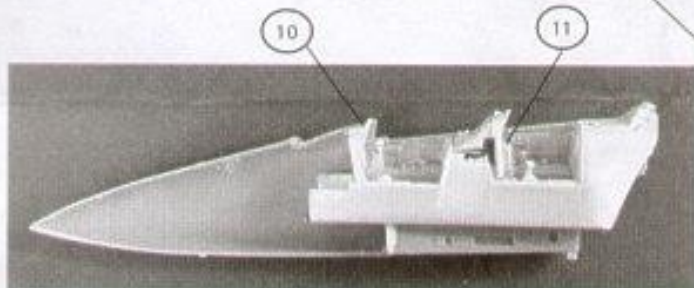

PAINTING INSTRUCTIONS
Paint cockpit according to kit instructions unless otherwise indicated

ACKNOWLEDGEMENTS

Special thanks to Lonnie Berry and the Machmaster once again for their support.

BEST REFERENCES:

F-15 E Strike Eagle, Lock On no. 22 Willy Peeters, Verlinden Publications, 1990.

Master pattern & instruction by Jef Verswyvel - Technical drawings by Willy Peeters

Copyright V.M.D. Studios, Inc. 2007