

CONSOLIDATED

PBY-4 FLYING BOAT CATALINA

ACADEMY

HOBBY MODEL KITS



1/72nd SCALE

- FULLY ENGRAVED PANEL LINES & RIVET DETAIL
- HIGHLY DETAILED COCKPIT INTERIOR & WAIST GUNNER'S COMPARTMENT
- OPTIONAL POSITION BEACHING GEAR & WING-TIP FLOATS
- REALISTIC P.V.C. TIRES INCLUDED

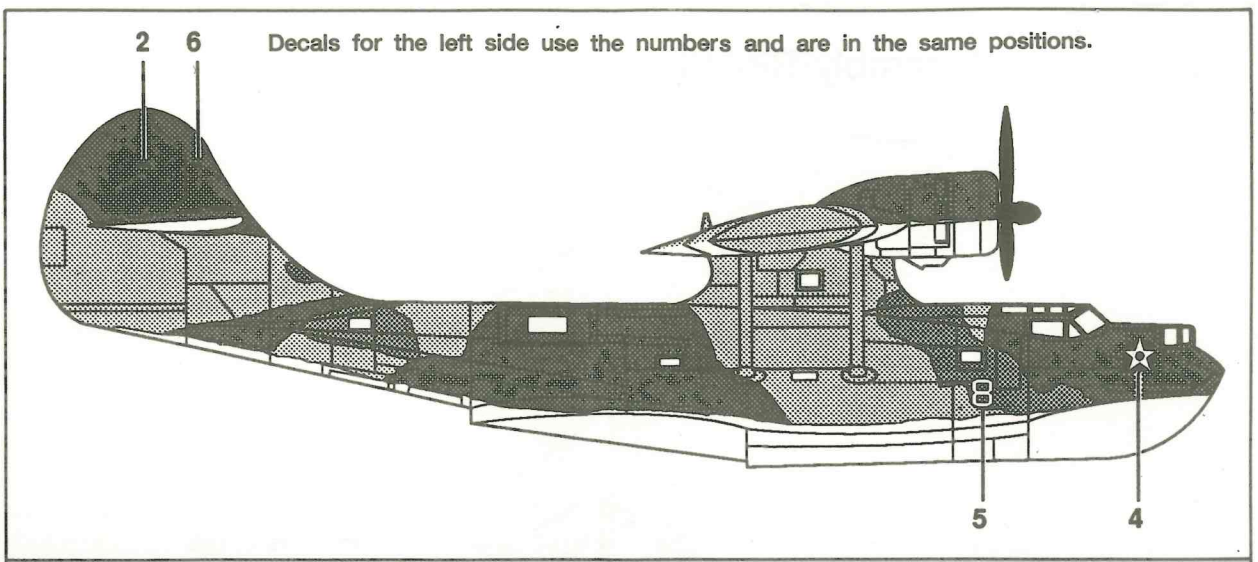
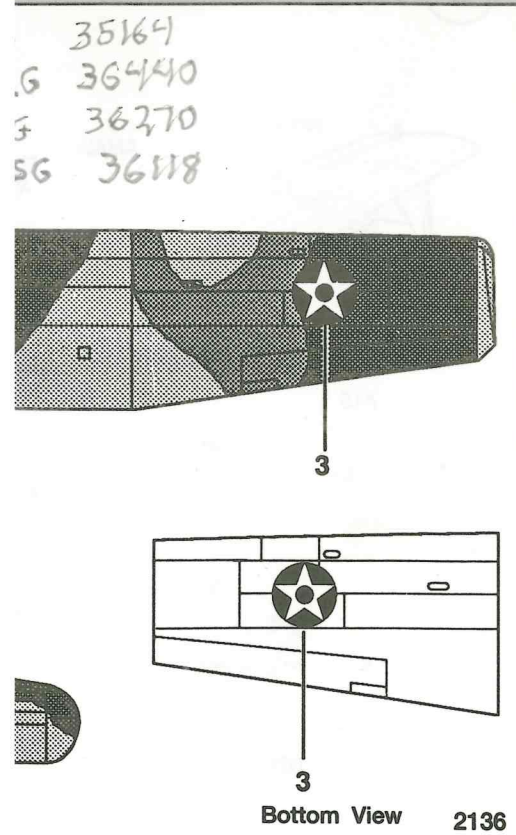
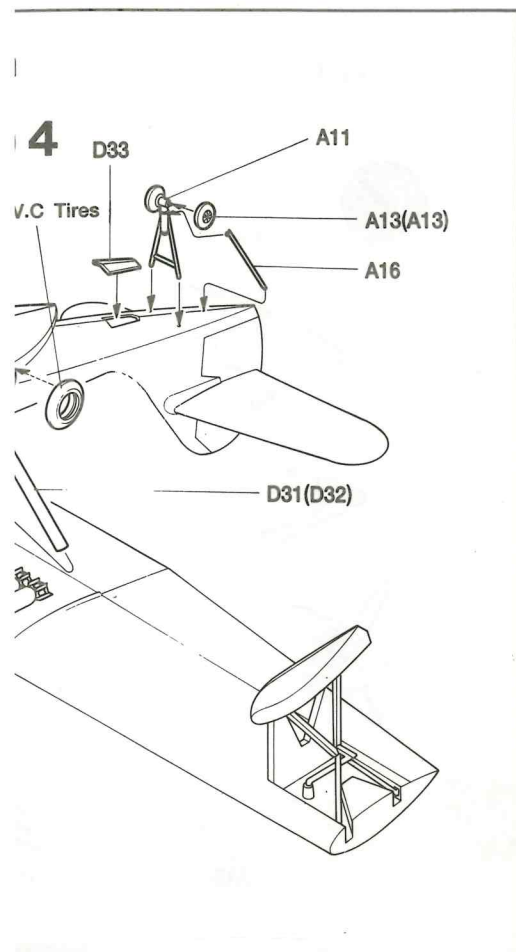

Parts Locating Diagram

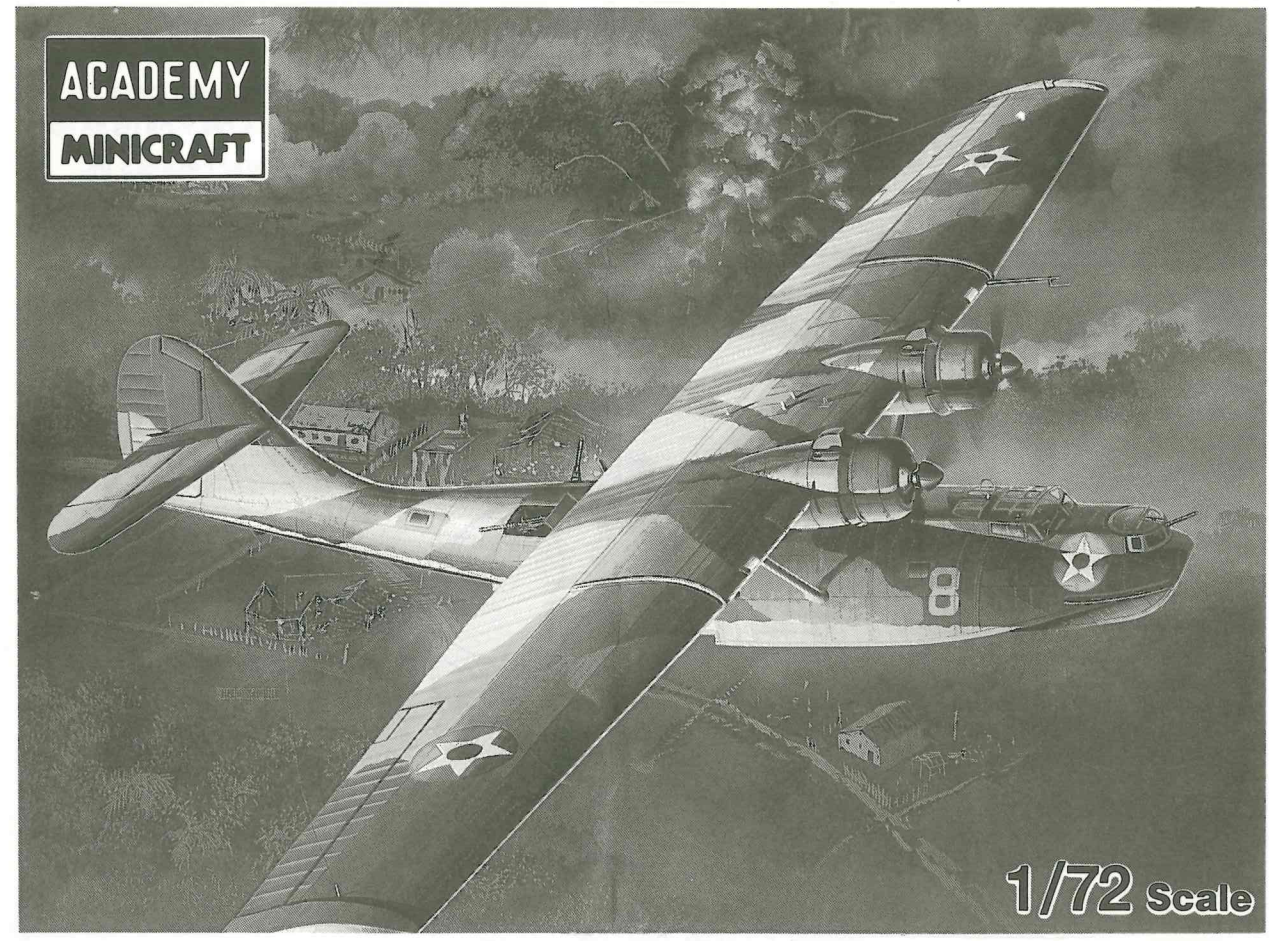
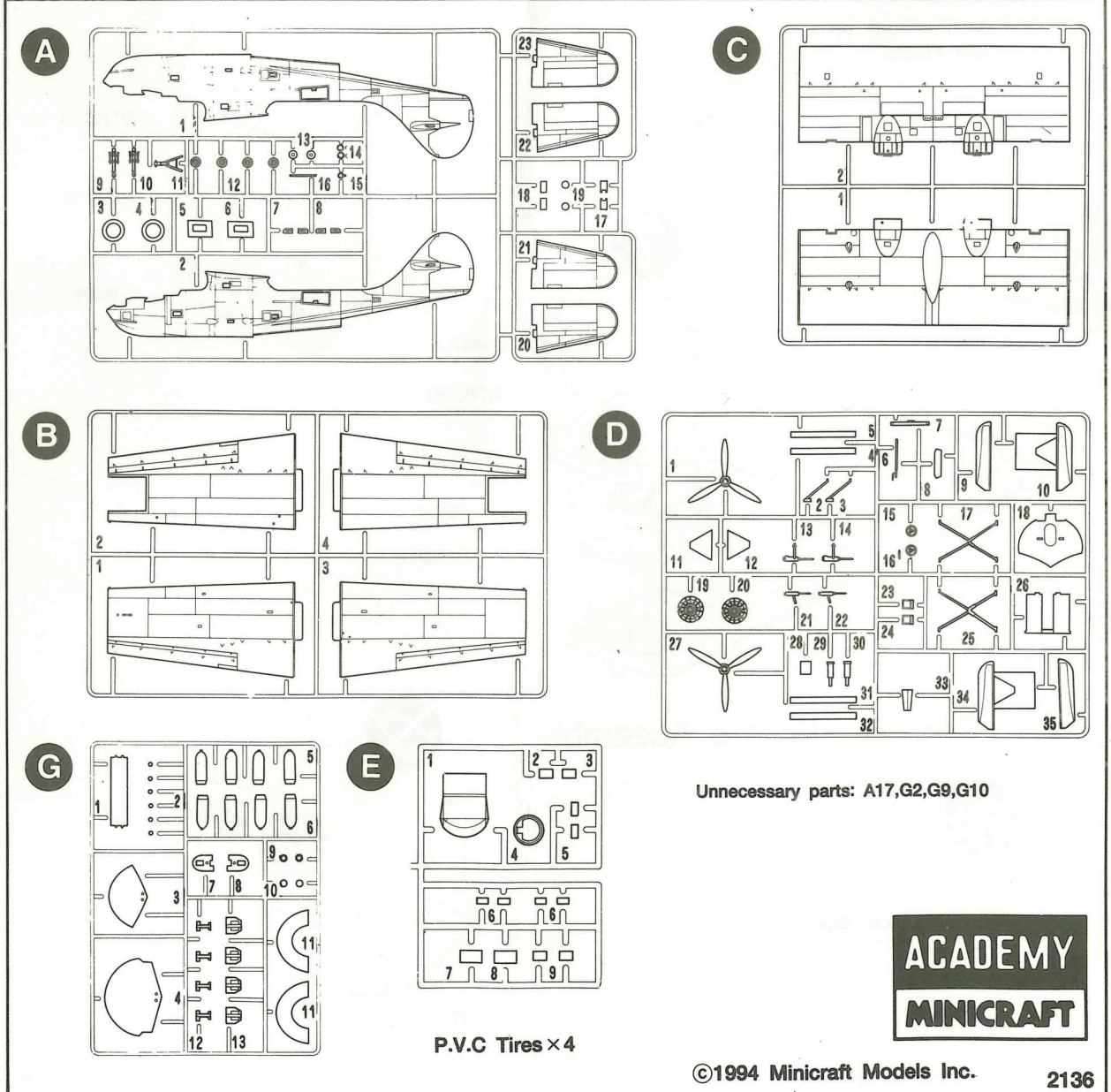

**CONSOLIDATED
PB4-CATALINA**

There were only 33 **PB4-Catalinas** manufactured, but their battle history in the Philippines as VP-101 and VP-102 remains legendary. They were called upon to seek and locate the enemy over the vast spaces of the Pacific. Their long range and extended flight time at cruising speeds enabled them to literally stand watch while looking for elements of the Japanese fleet.

In addition, the acute shortage of aircraft in the Philippines after the Japanese invasion caused the **Catalinas** to be pressed into service as bombers, strafers and mine-laying duties. If that were not enough, the remaining **Catalinas** were always in demand to transport high-ranking officers from one theater to another. It cannot be documented, but it more than likely that the subject of this kit was the airplane that took *General MacArthur* from the Philippines to Australia.

When the war broke out, the camouflage paint schemes were applied in the field with whatever paint could be found. As a result there are no specifications for the paint jobs, but many photographs clearly illustrate the general type of patterns and colors used.

It should be noted that the first group of **PB4-Catalinas** made the first Transpacific deployment in 1939 by way of Honolulu, Midway, Wake Island and Guam before arriving in Manila where they became VP-21.

With more powerful P&W R-1830 engines rated 1050 horsepower, the **PB4** still only had a top speed at 12,000 feet of 197 miles per hour. Old aviators who flew these planes often joked that they took off at 90 knots, cruised at 90 knots and landed at 90 knots.

7 Beaching Gear-Bombs Installation

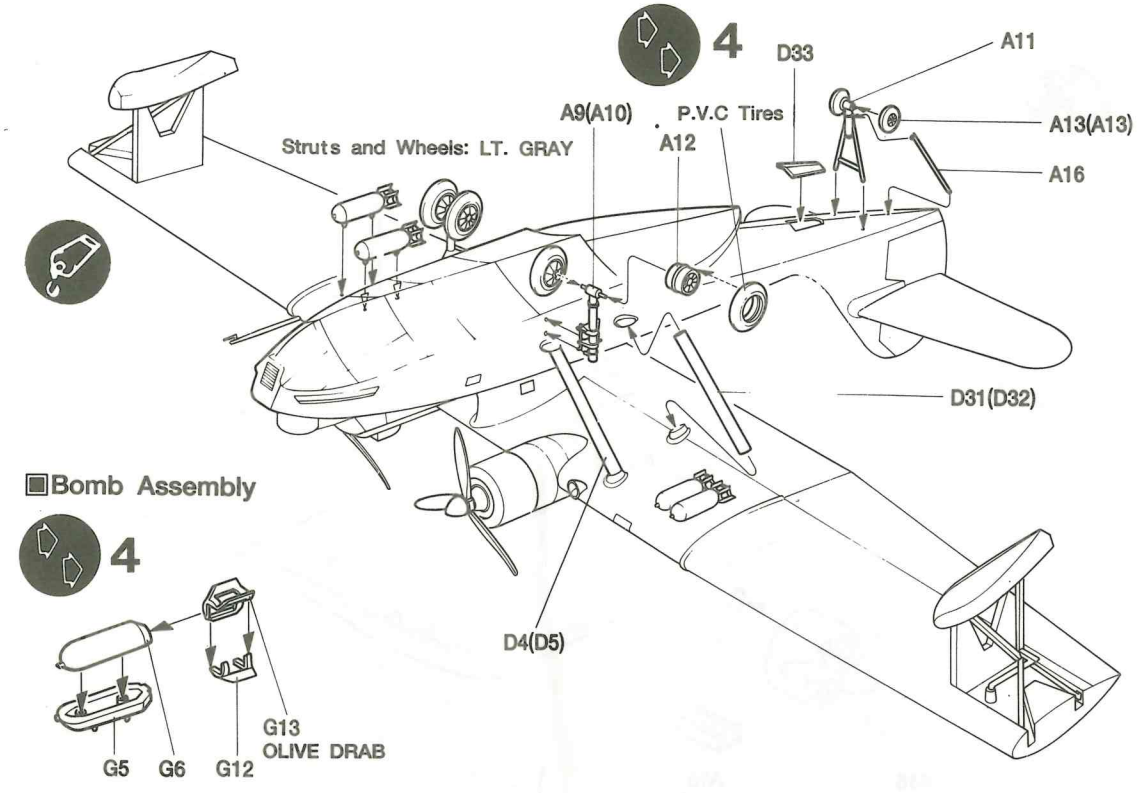

Painting and Decal Placement

- DARK BLUE GRAY F.S.35164
- BLUE GRAY F.S.35177
- LIGHT GULL GRAY F.S.36440
- LIGHT GRAY F.S.35630

IB 35164
 GLG 36440
 NG 36270
 GSG 36118

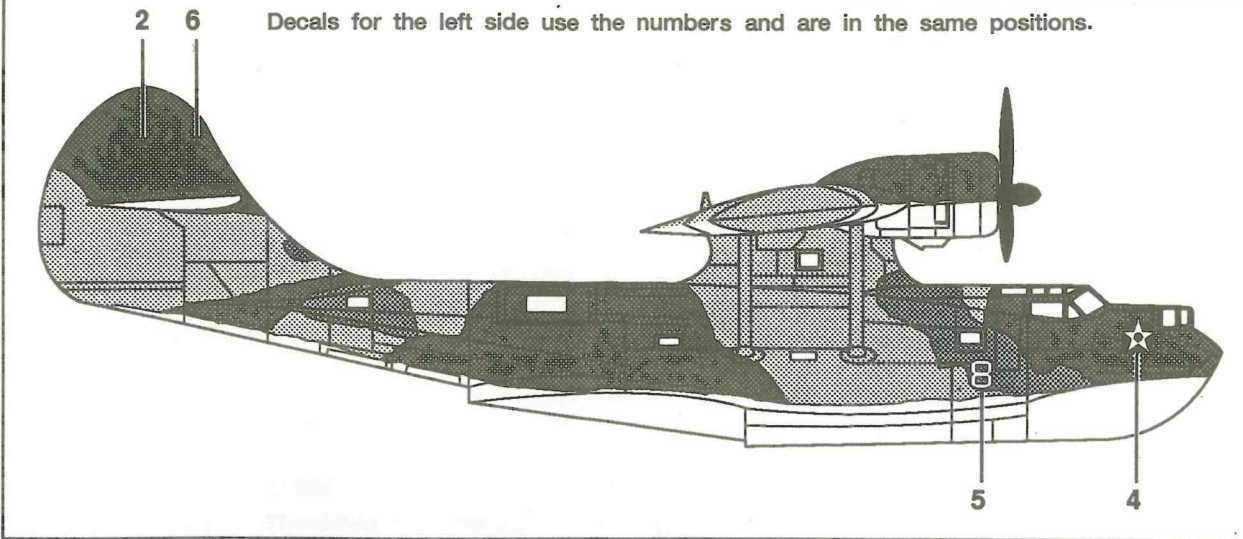
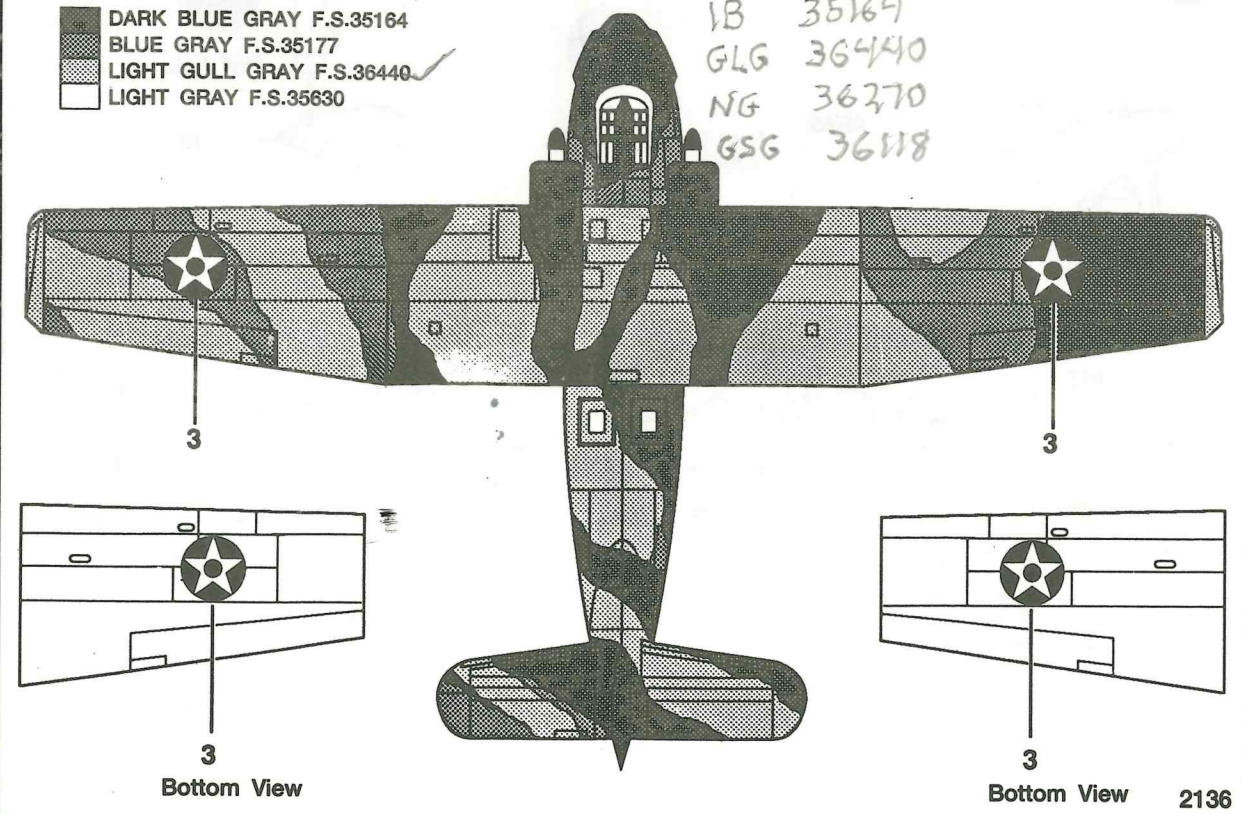

Parts Locating Diagram

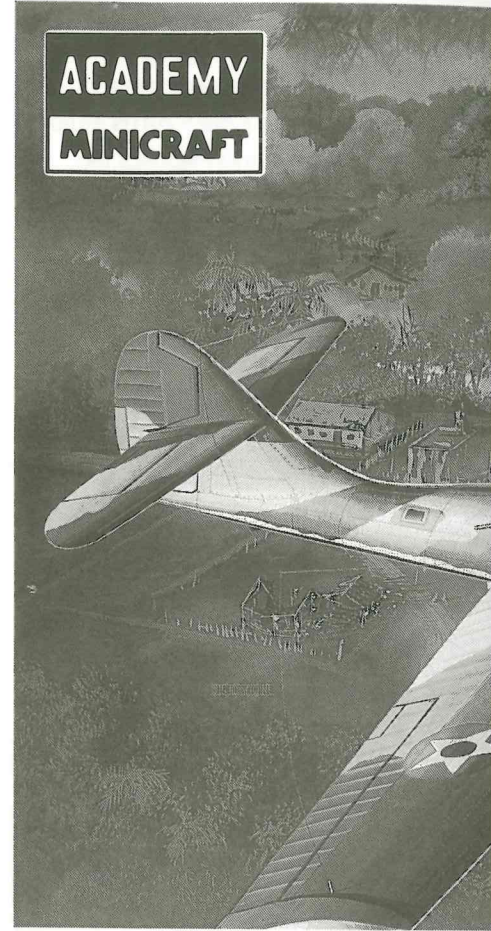
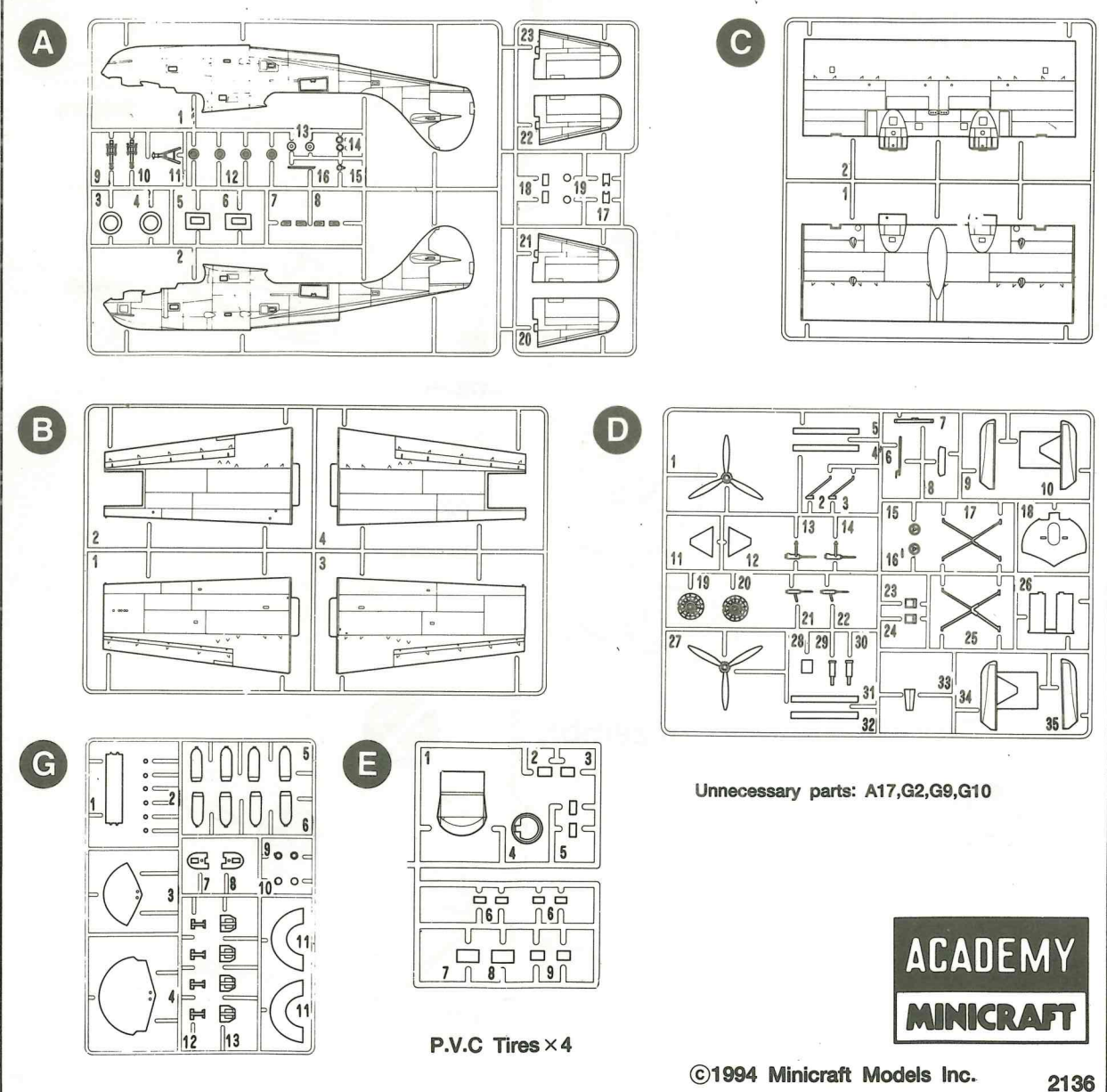

ACADEMY MINICRAFT

PBY-4

There were only 33 **PBY-4 Catalinas** VP-101 and VP-102 remains legend enemy over the vast spaces of the cruising speeds enabled them to Japanese fleet.

In addition, the acute shortage of caused the **Catalinas** to be pressed. If that were not enough, the remaining ranking officers from one theater to likely that the subject of this kit was Philippines to Australia.

When the war broke out, the can whatever paint could be found. As many photographs clearly illustrate

It should be noted that the first deployment in 1939 by way of Hong Manila where they became VP-21.

With more powerful P&W R-1830 engine top speed at 12,000 feet of 197 mph joked that they took off at 90 knots.

ENGLISH	FRENCH	GERMAN	SPANISH	ITALIAN
BLACK	NOIR	SCHWARZ	NEGRO	NERO
SILVER	ARGENT	SILBERN	PLATA	ARGENTO
GUNMETAL	METALLIC	METALLIK	METALICO	METALLICO
METALLIC	METALLIC	METALLIK	METALICO	METALLICO
GRAY	GRIS	GRAU	GRIS	GRIGIO
LT GRAY	GRIS CLAIR	HELL GRAU	GRIS CLARO	GRIGIO CHIARO
WHITE	BLANCO	WEISS	BLANC	BIANCO
YELLOW	JAUNE	GELB	AMARILLO	GIALLO
BLUE	BLEU	BLAU	AZUL	BLU
GREEN	VERT	GRUN	VERDE	VERDE

TO RECEIVE A COPY OF THE NEWEST FULL
 COLOR MINICRAFT/ACADEMY CATALOG,
 SEND US \$5.00 (U.S.A. ONLY) OR US \$6.00
 (FOREIGN) TO MINICRAFT MODELS, INC.
 P.O. BOX 3577, TORRANCE, CALIF 90510

1 Pilot-Gunner's Positions Assembly

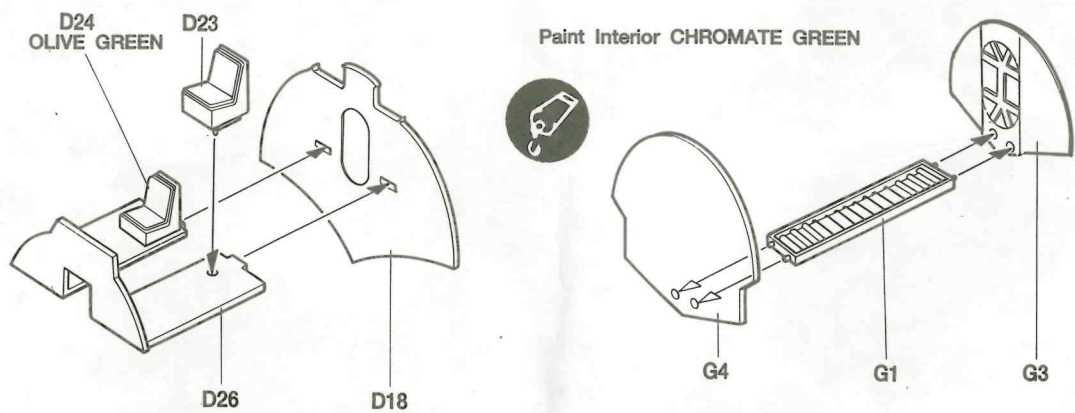

2 Interior Installation

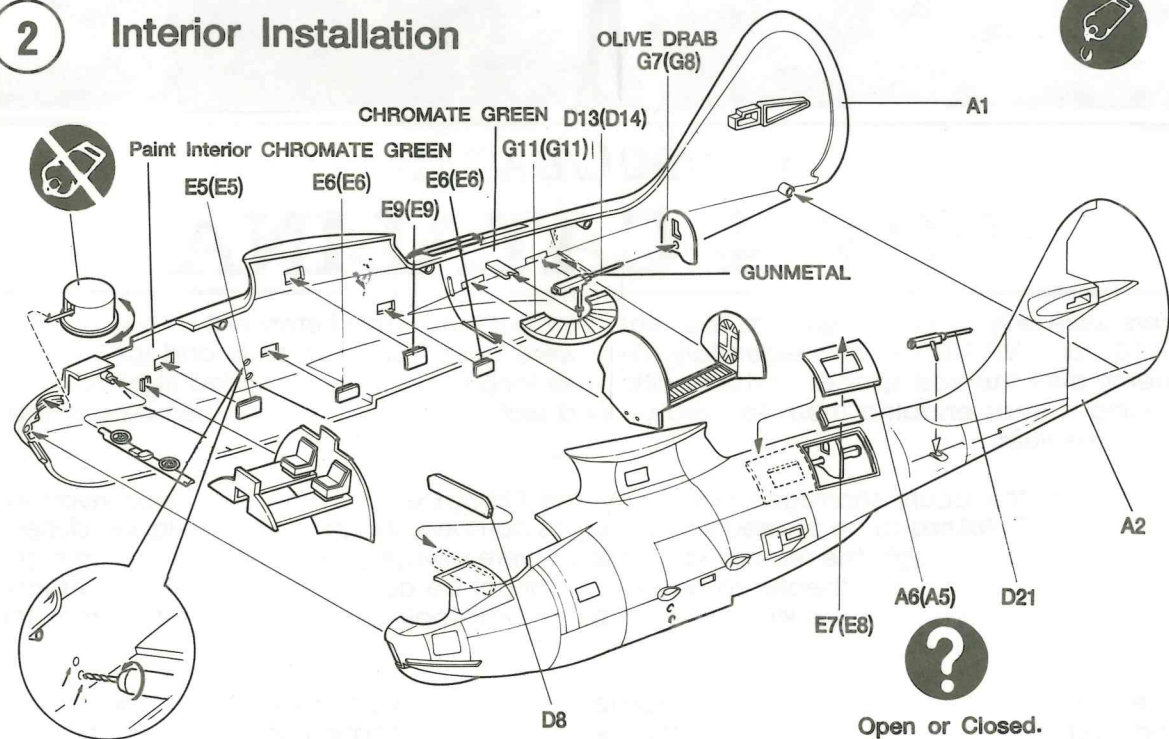

- Bow Turret
- Control Handle
- Instrument Panel

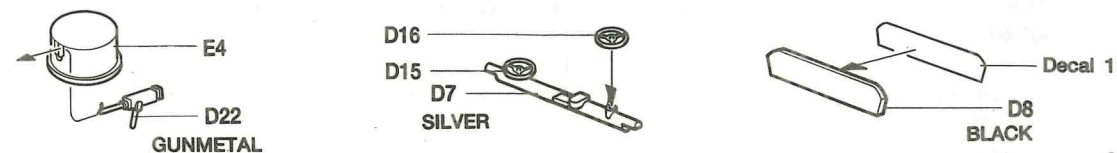

2136

3 Wing Assembly-Right(Left)

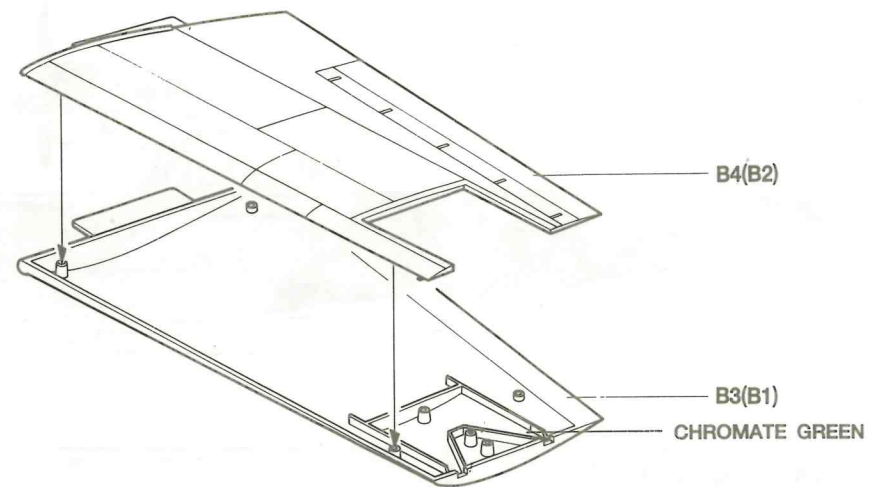

Optional Positions for
 Stabilizer Floats.

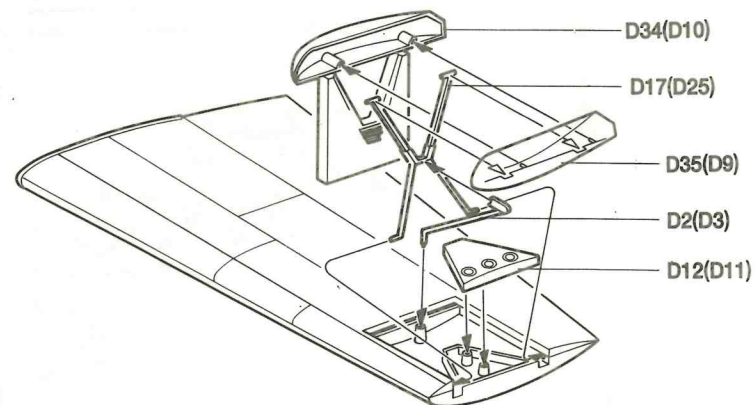
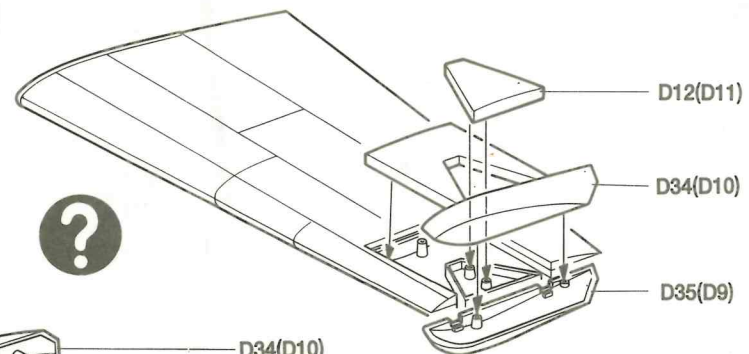

4 Propeller-Engine Assembly

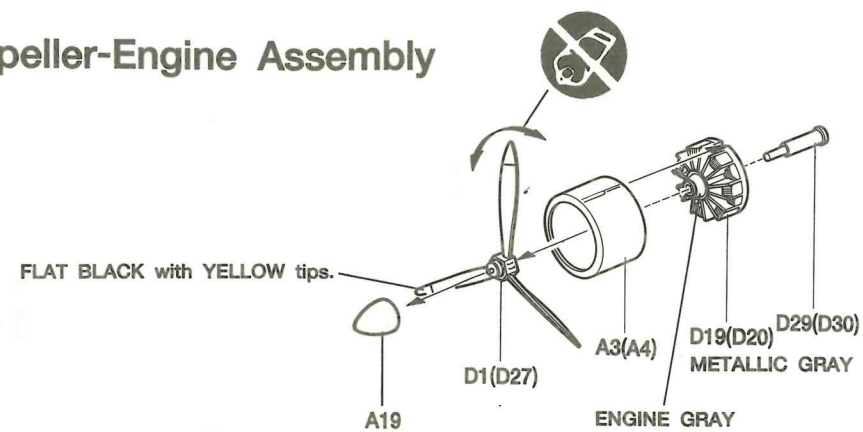

2136

5 Wing Assembly-Center

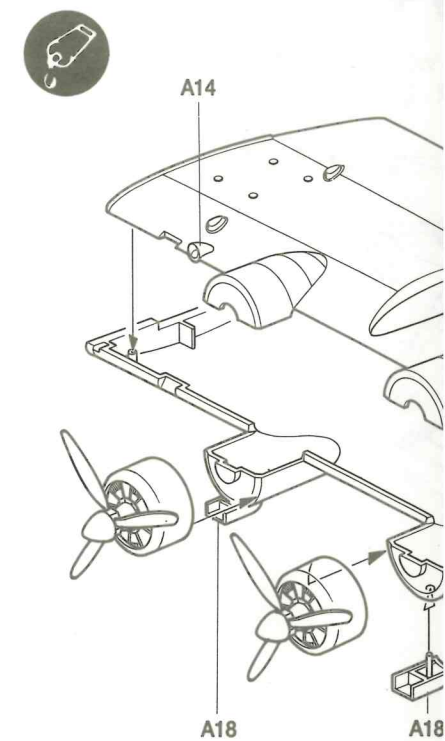

6 Wing Installation

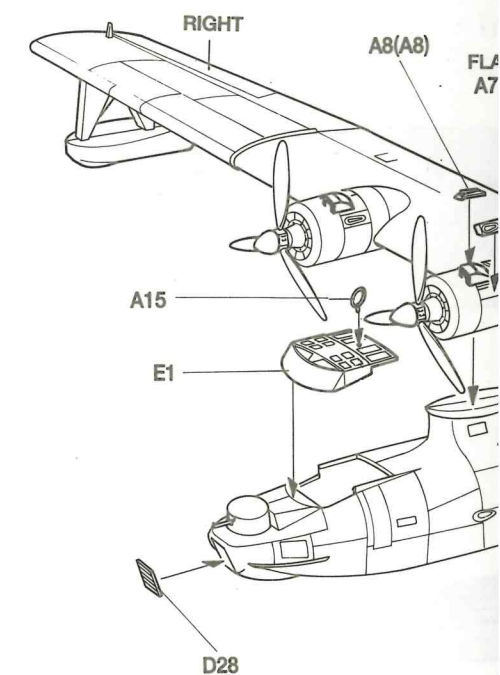

TO RECEIVE A COPY OF THE NEWEST FULL
 COLOR MINICRAFT/ACADEMY CATALOG,
 SEND US \$5.00 (U.S.A. ONLY) OR US \$6.00
 (FOREIGN) TO MINICRAFT MODELS, INC.
 P.O. BOX 3577, TORRANCE, CALIF 90510

ply

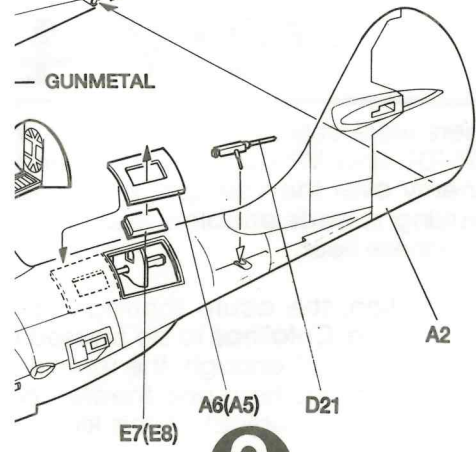
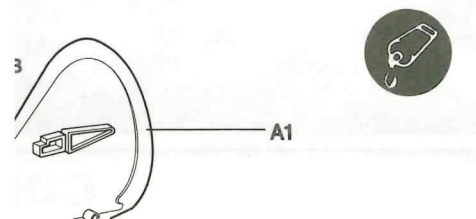
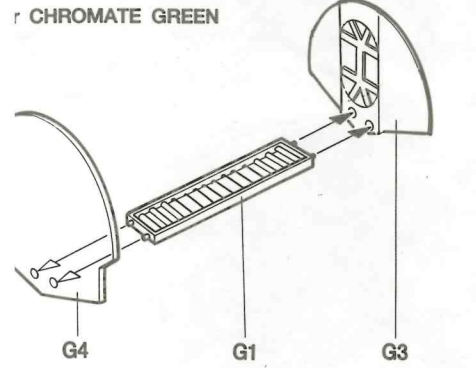

Open or Closed.

Instrument Panel

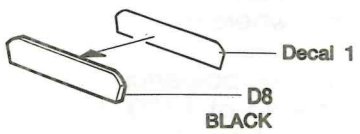

2136

3 Wing Assembly-Right(Left)

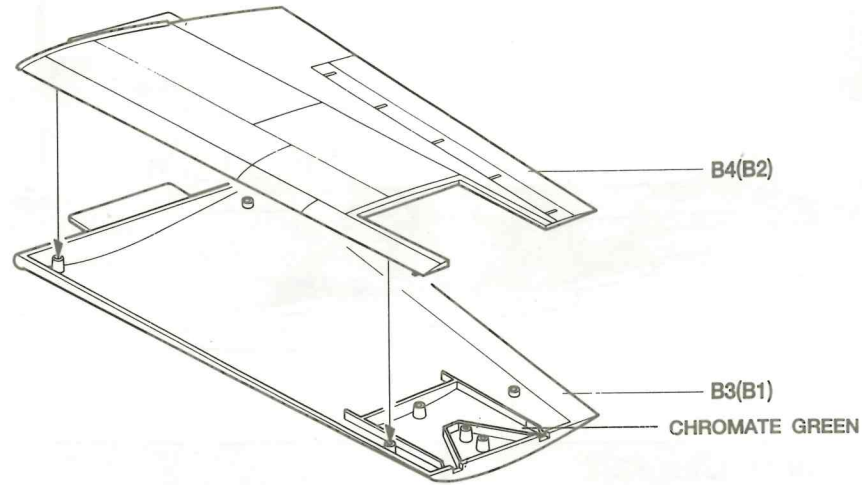

Optional Positions for Stabilizer Floats.

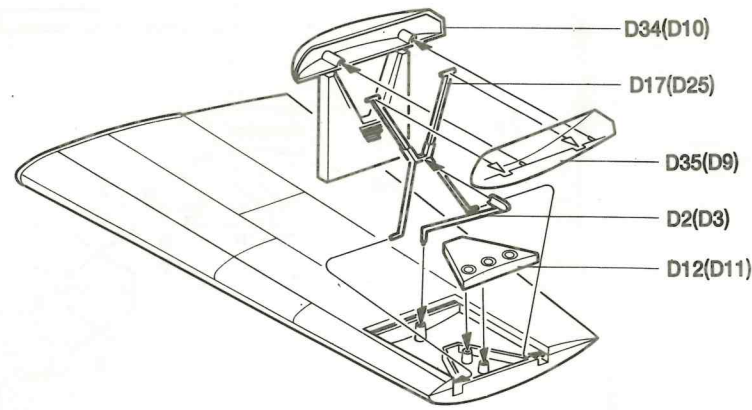
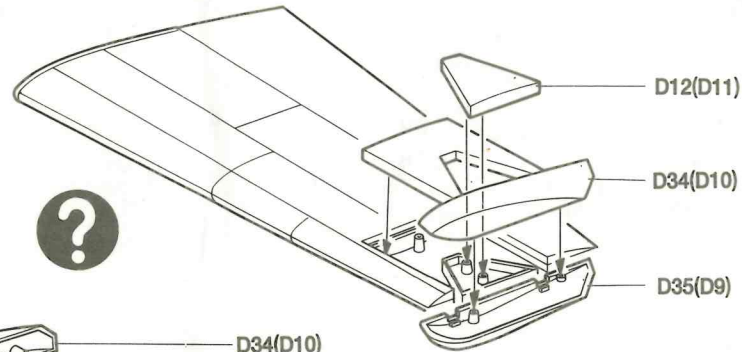

4 Propeller-Engine Assembly

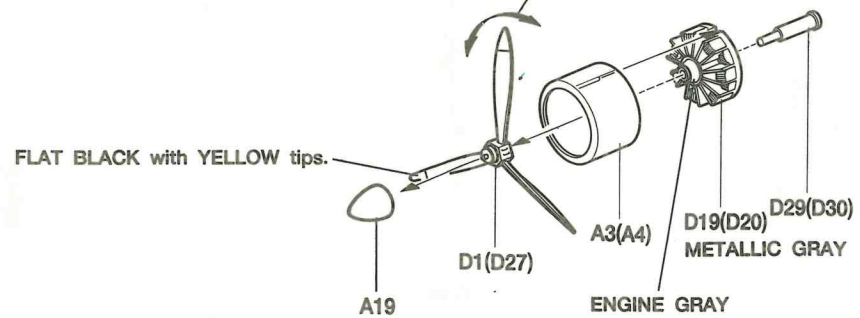

2136

5 Wing Assembly-Center

Open holes each points.

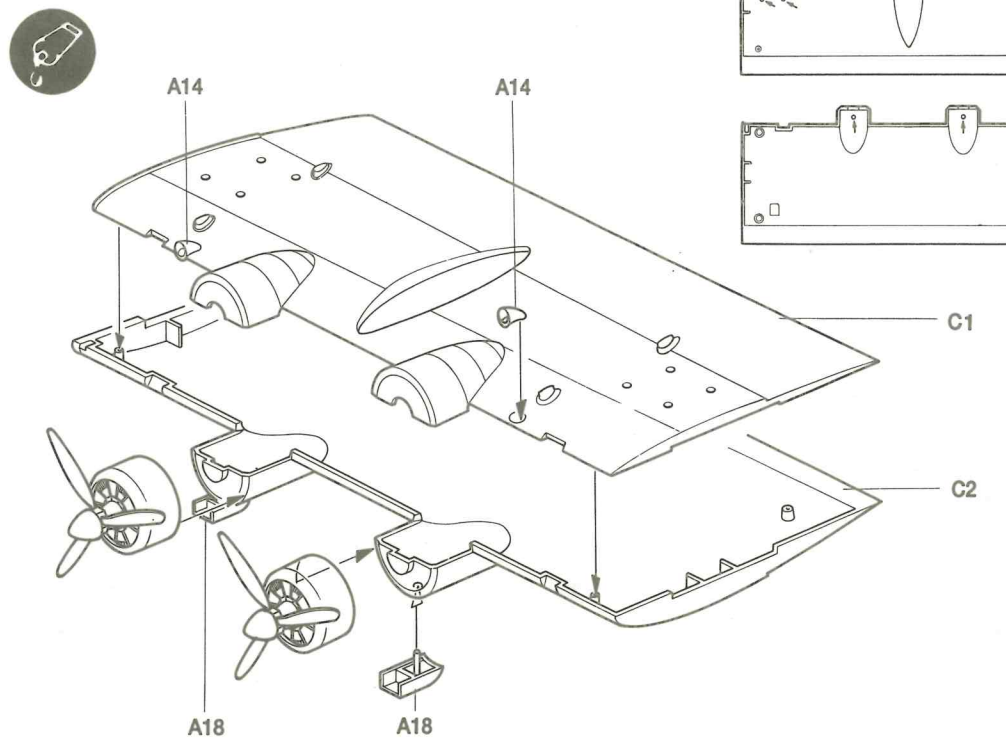
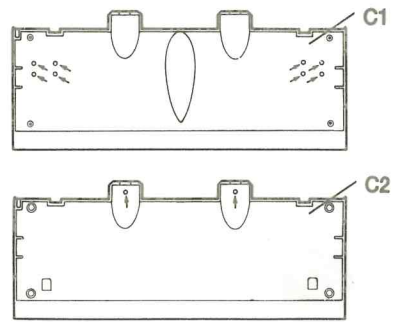

6 Wing Installation

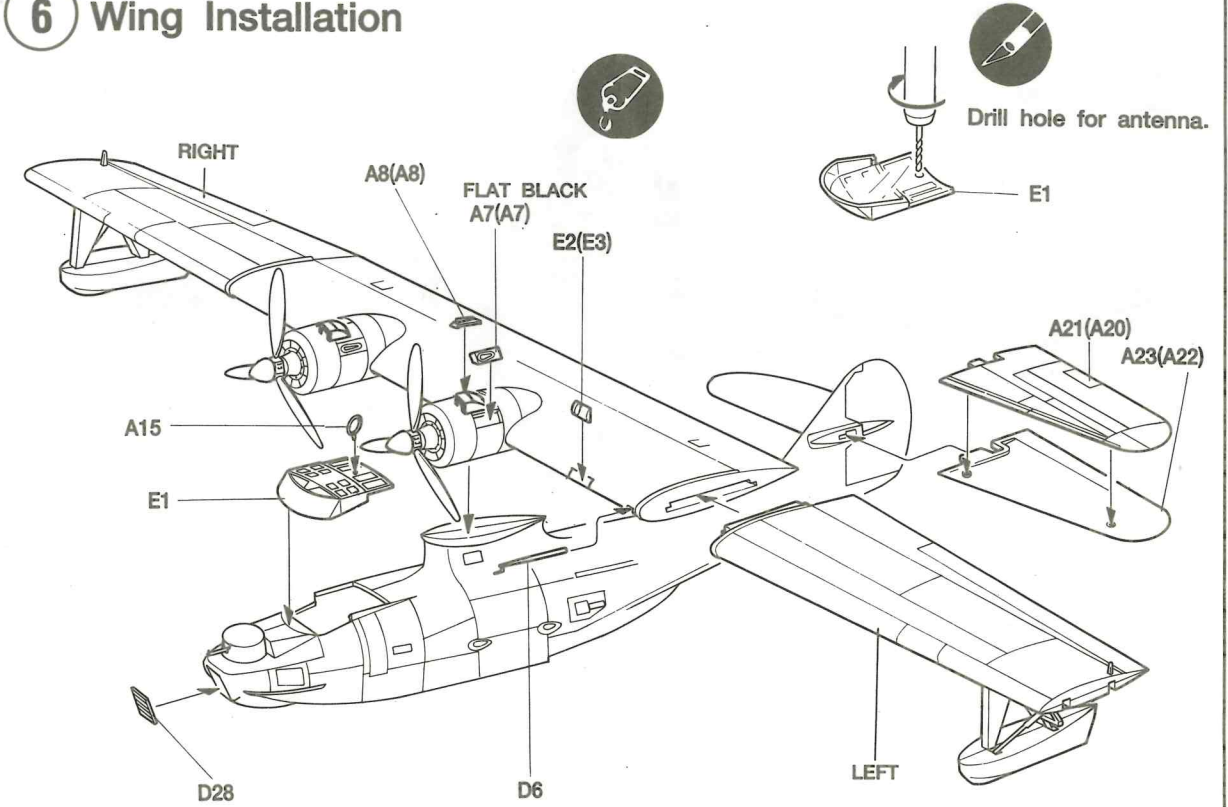

2136