



# German Dampflokomotive BR86

ドイツ蒸気機関車 BR-86

德国BR86蒸汽机车

## PLEASE READ BEFORE OPERATION!

- \* Tools recommended as below: (Not included)  
Adhesives; Paints; Side Cutters; Sharp Edged Pliers; Modeling Knife; Modeling File; Nippers; Drill; Scissors; Sand Paper; Soft Cloth; Cyanoacrylate Glue.
- \* Make sure to read this instruction listed below before assembling.
- \* The kit contains the small parts, they can be dangerous if swallowed by mistake, so keep them away from reach of children.
- \* Cut the all parts off carefully and remove the waste parts into the garbage can.
- \* More caution and care should be needed for cutting and handling the photo etched parts.
- \* Make attention that some parts should be attached the decal when assembled.
- \* During assembling, please tear up and throw away the plastic bags, or may cause the dangerous if wearing over head by children's mistake.
- \* When using the adhesives and paints, please do not use them in the closed room or near the fire, also must be very careful to protect your eyes, face and clothes.
- \* Adult supervised when assembled by children under 14 years old.

## 装配前请仔细阅读:

- \* 推荐使用的模型工具(请自备):  
专用模型胶水, 专用模型油漆, 水口剪刀, 长咀钳, 刀片, 锉刀, 镊子钳, 钻, 剪刀, 软布, 砂纸, 瞬间快干胶等。
- \* 用水口剪刀或刀片小心切下所有塑胶零件和蚀刻片零件, 不要遗失小零件。
- \* 切取蚀刻片时应特别注意防止利边划伤手指。
- \* 用模型锉刀小心锉平所有零件表面的注射浇口。
- \* 用适量的强力快干胶水粘合蚀刻片零件和金属轴, 切忌过量, 否则可能导致可动零件被粘住。
- \* 注意某些零件表面需在装配时同步贴上水贴纸。
- \* 制作时应远离幼儿并将包装袋及时收妥, 谨防小孩玩耍而引起意外。



cyanoacrylate glue  
强力胶



weight  
配重



make hole  
钻孔



cut / remove  
切除



option  
选择



no cement  
不涂胶水



decal  
贴纸



bend  
弯曲



repair  
填补

## The method to apply the decals

1. Cut off the decal from the decal paper and put it into the warm water 40°C for 10 seconds.
2. Take the decal from the water and put it on a piece of clean cloth.
3. Remove the decal slowly from the paper to the targeted location by a wet finger.
4. Use a piece of dry and soft cloth to press it gently on the decal until it getting dry and no bubble existing.

## 水贴纸的使用方法:

- 一. 把相关的印花从水贴纸上剪下, 放入40°C左右的温水中浸10秒。
- 二. 然后将印花放在干净的布上。
- 三. 拿上印花纸板, 手指蘸水将印花移到适当的位置。
- 四. 用软干布轻压印花直至水干, 气泡消失。

# 部品图 Parts

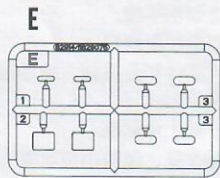
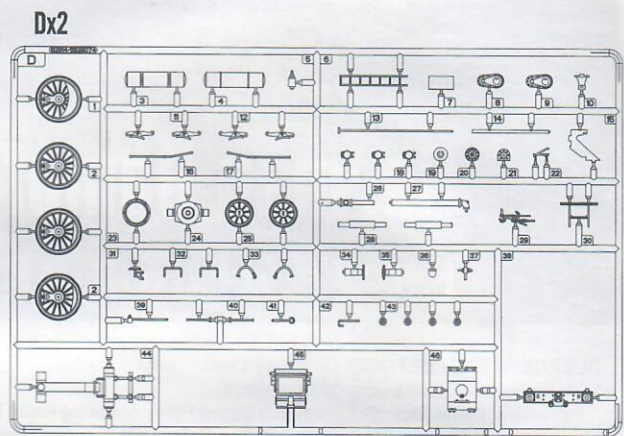
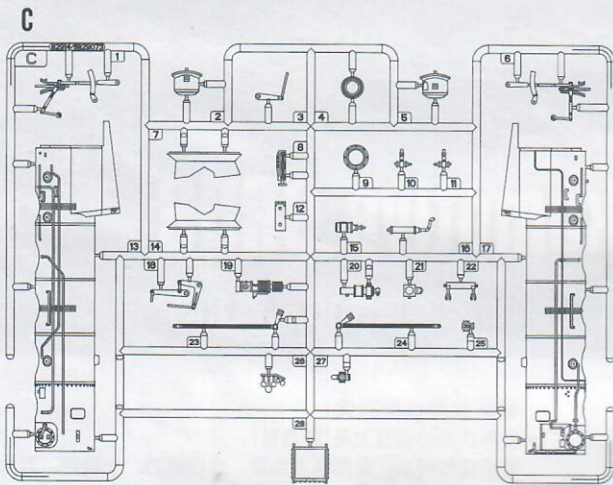
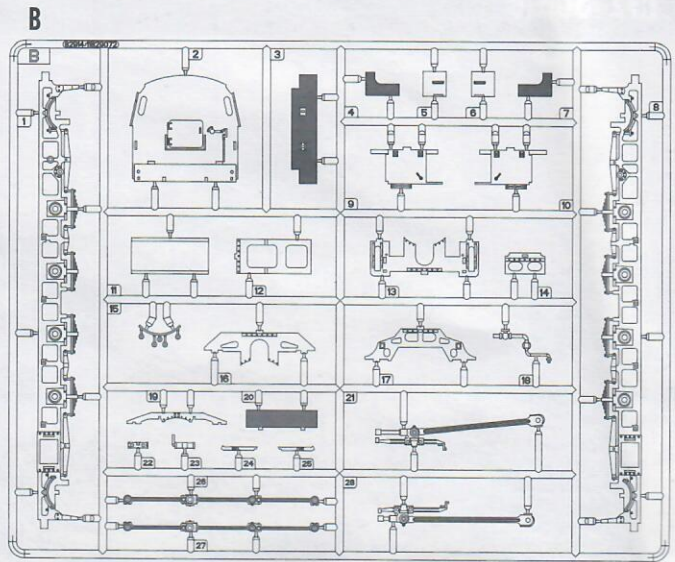
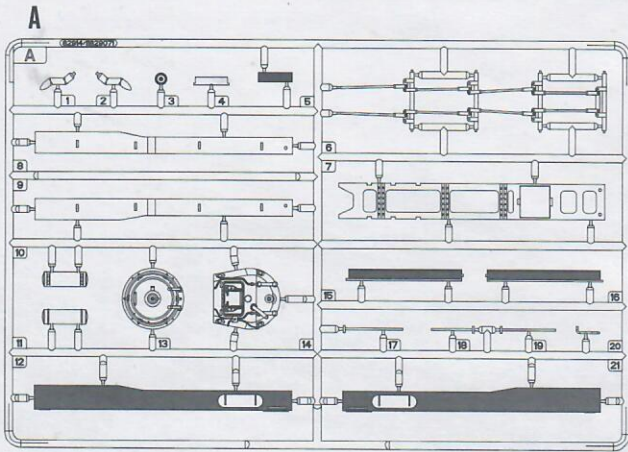

煤仓  
Coal bunker

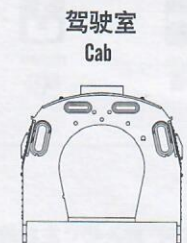
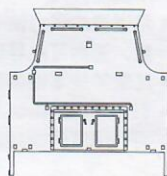

驾驶室  
Cab

水贴  
Decal



路基部分  
Road

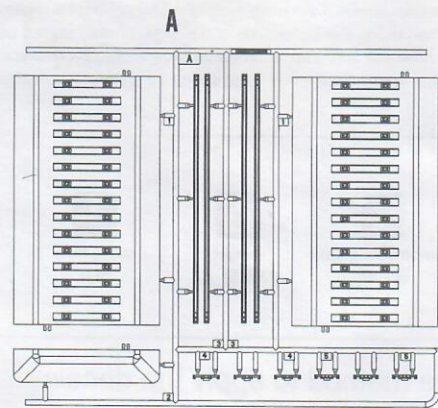

Rail-A2



**1**  
STEP

路基安装  
Attaching Road

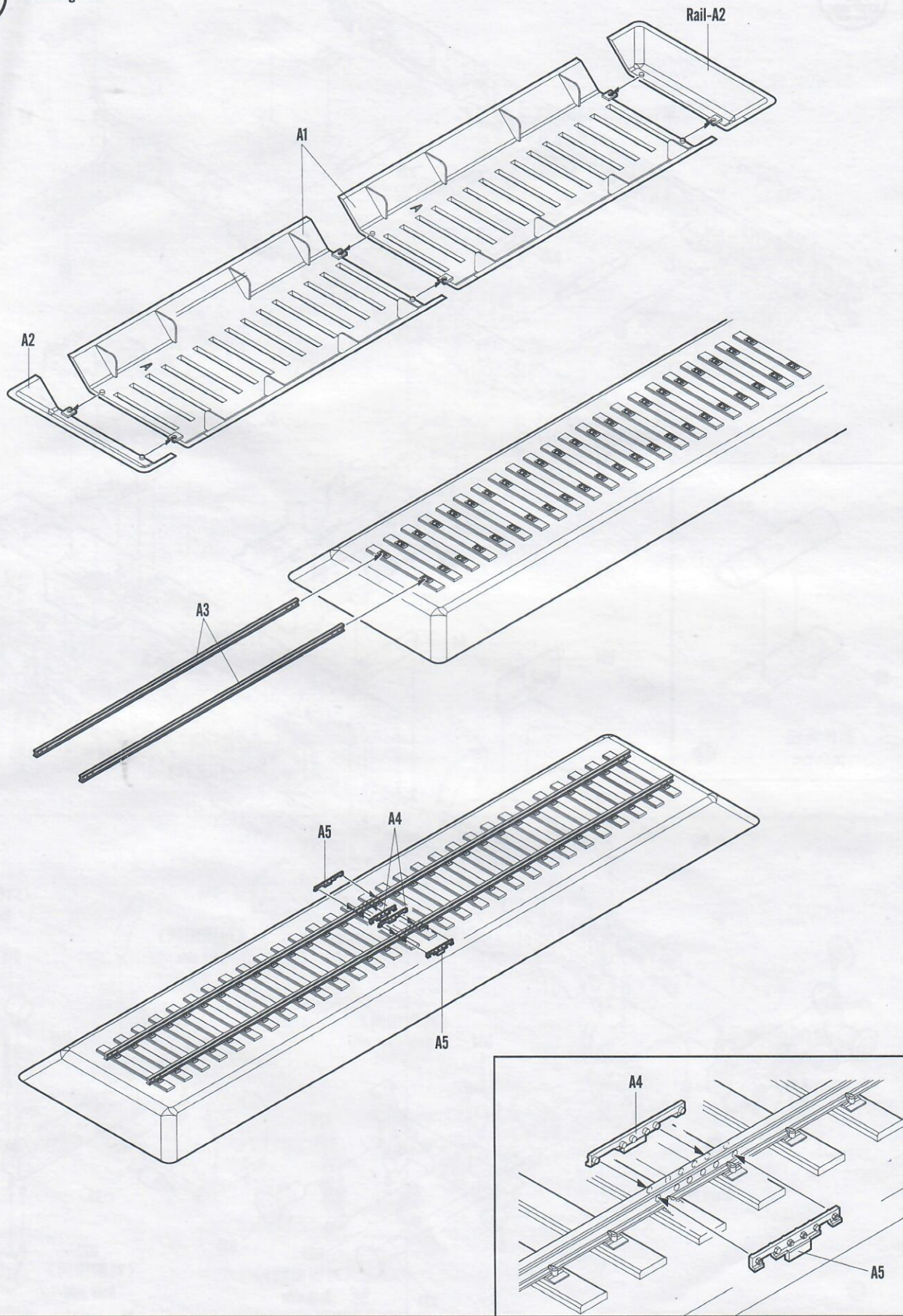

82914

3

**2**  
STEP

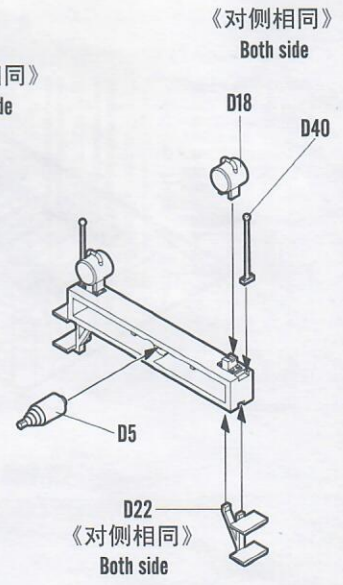
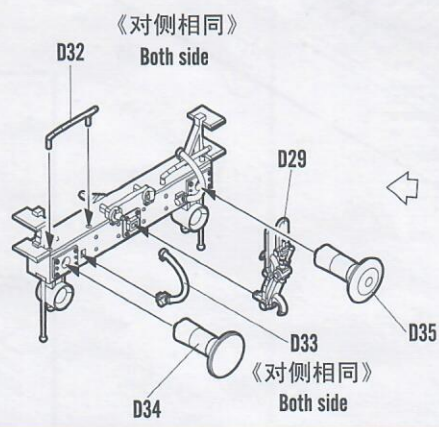
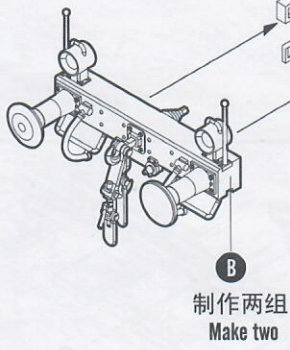
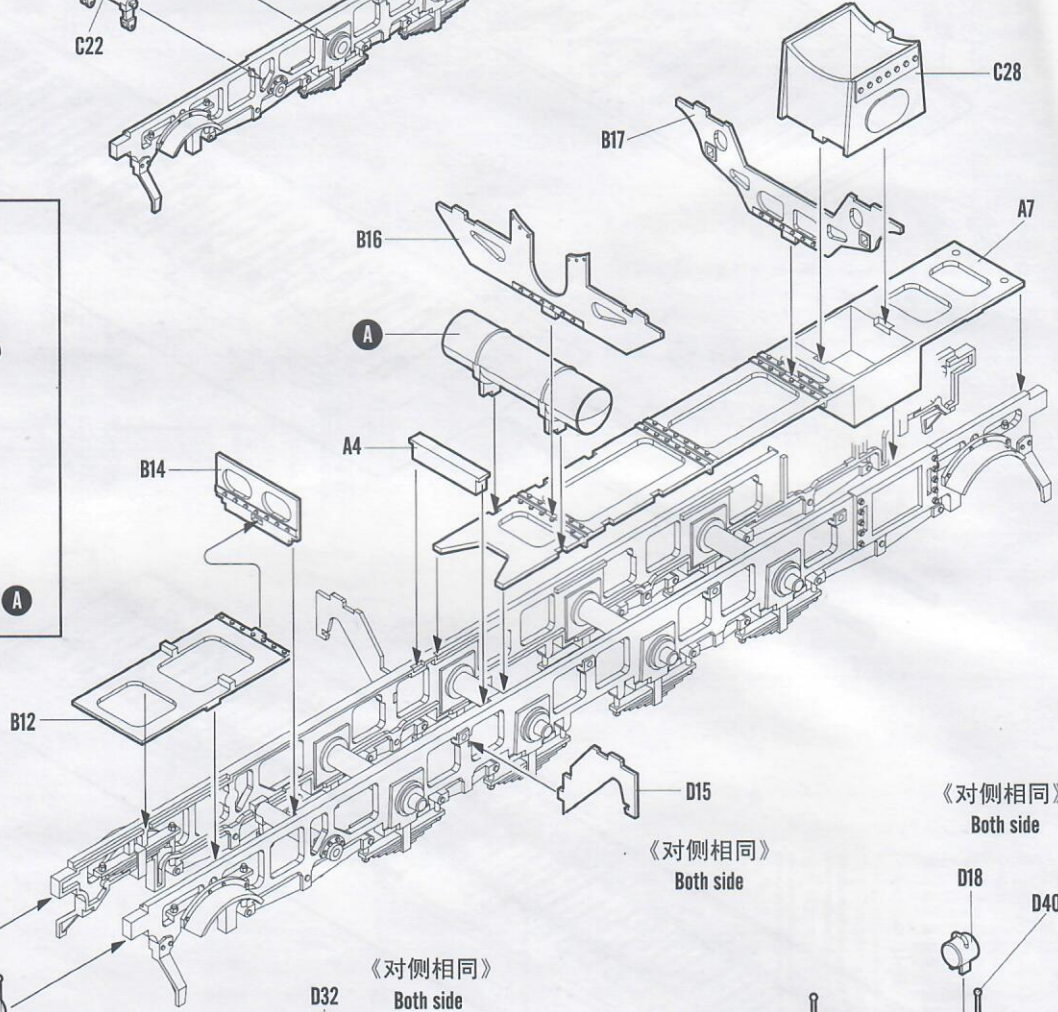
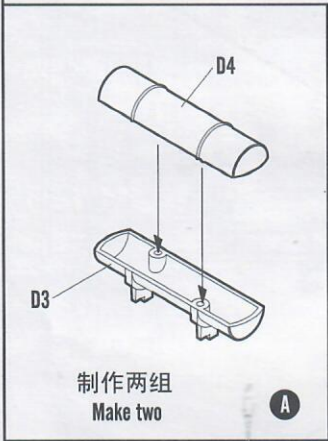
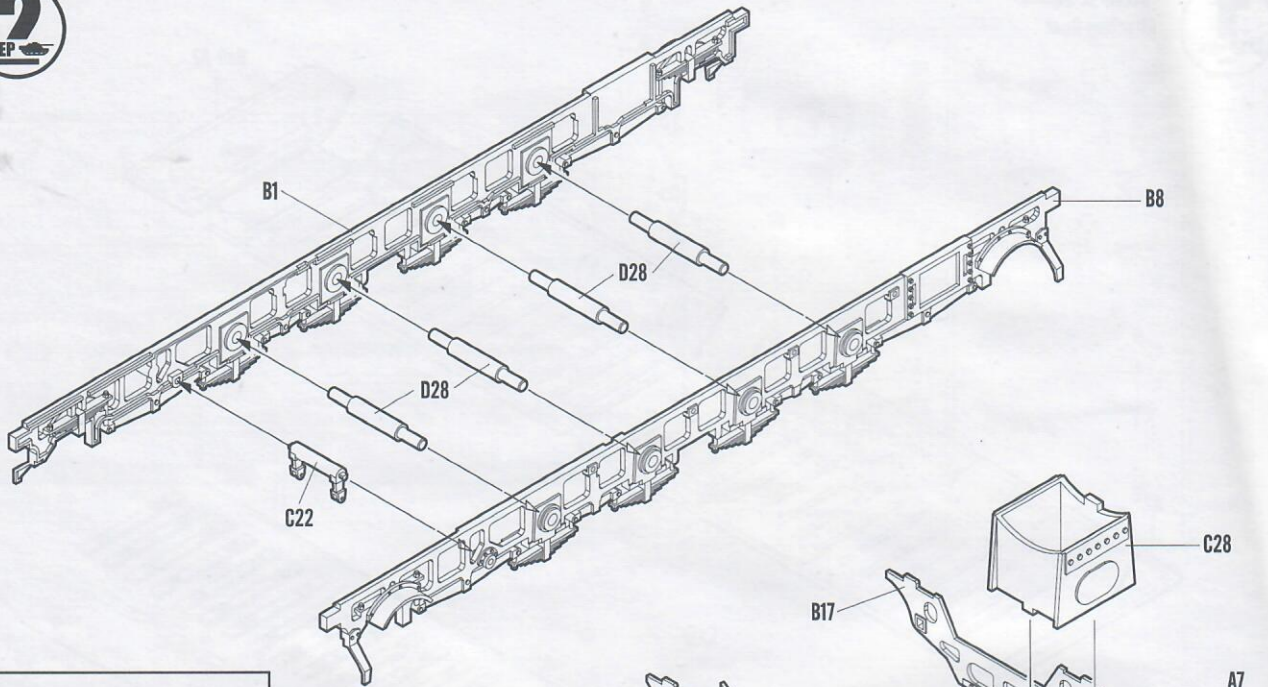

**3**  
STEP

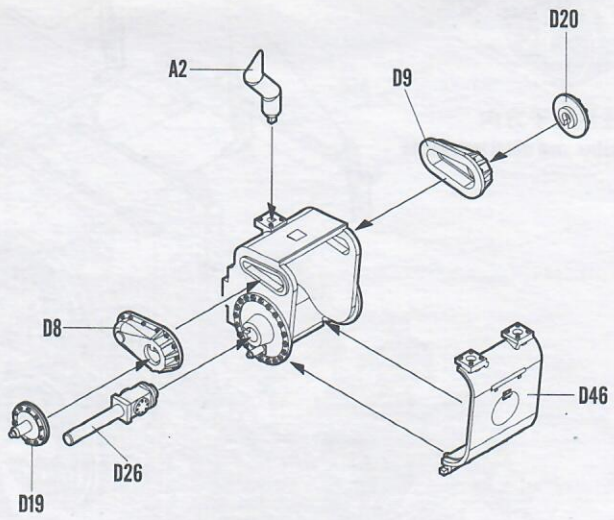
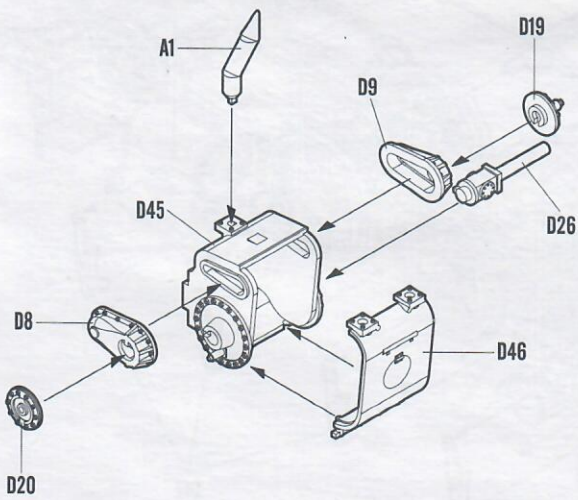
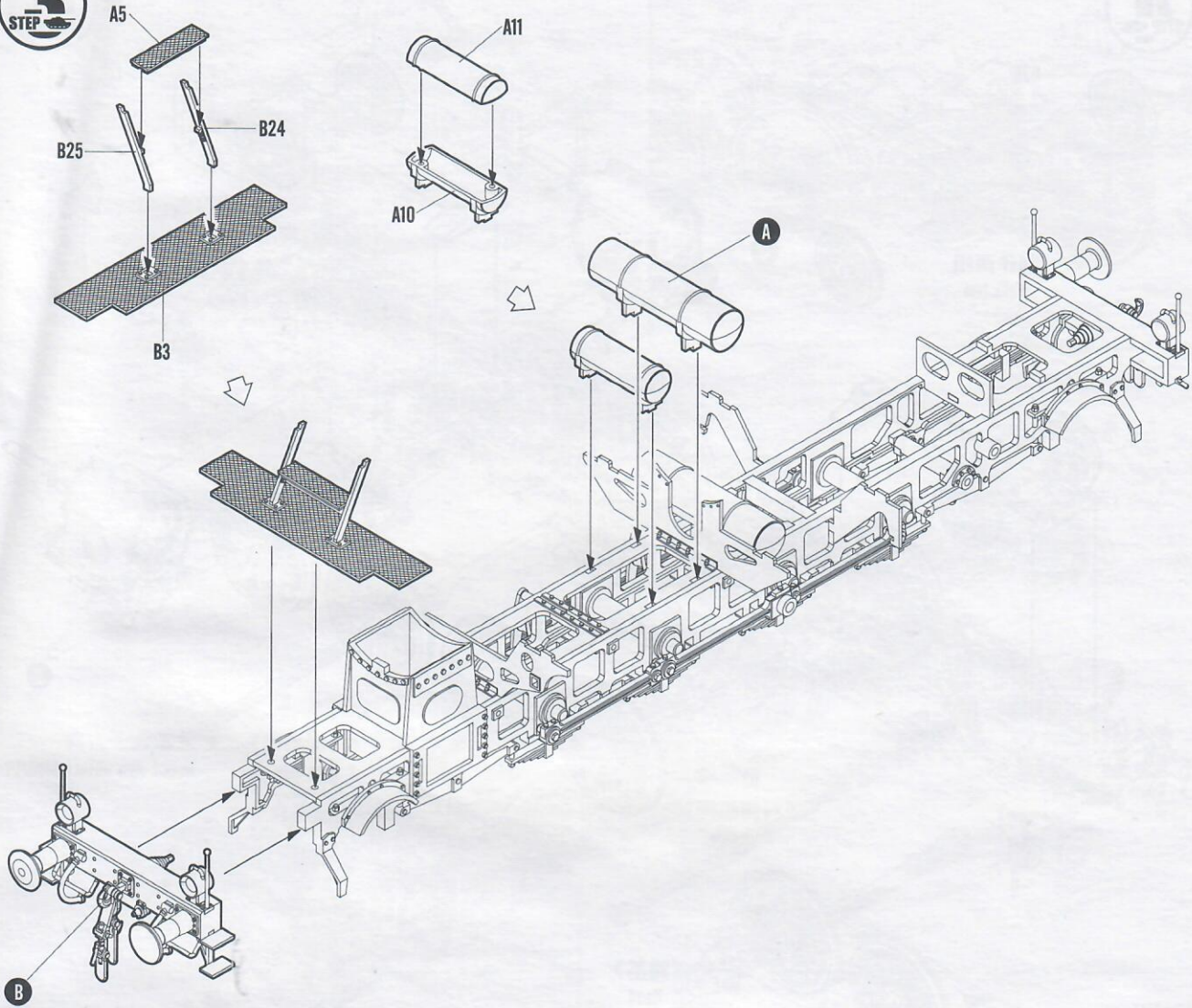

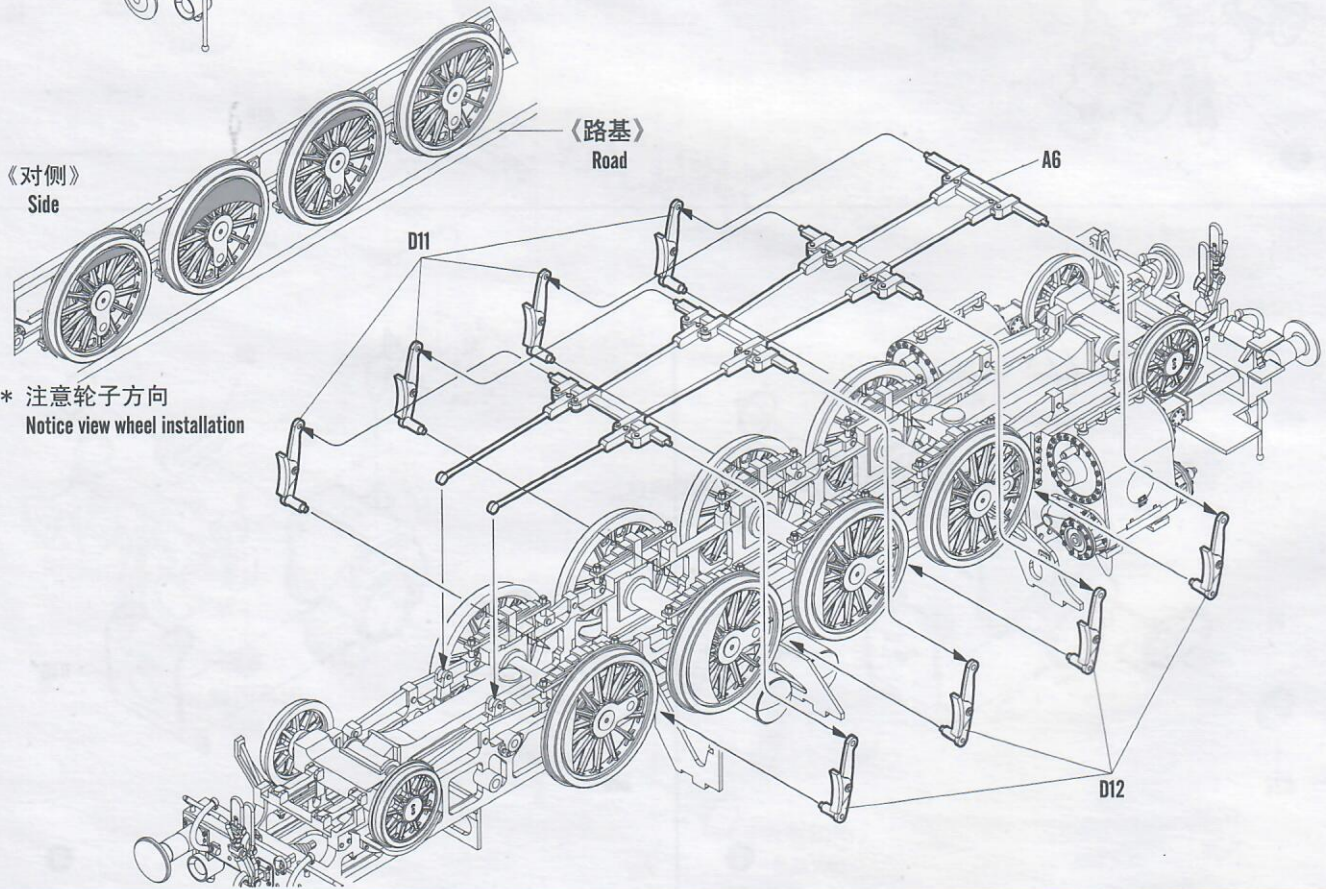
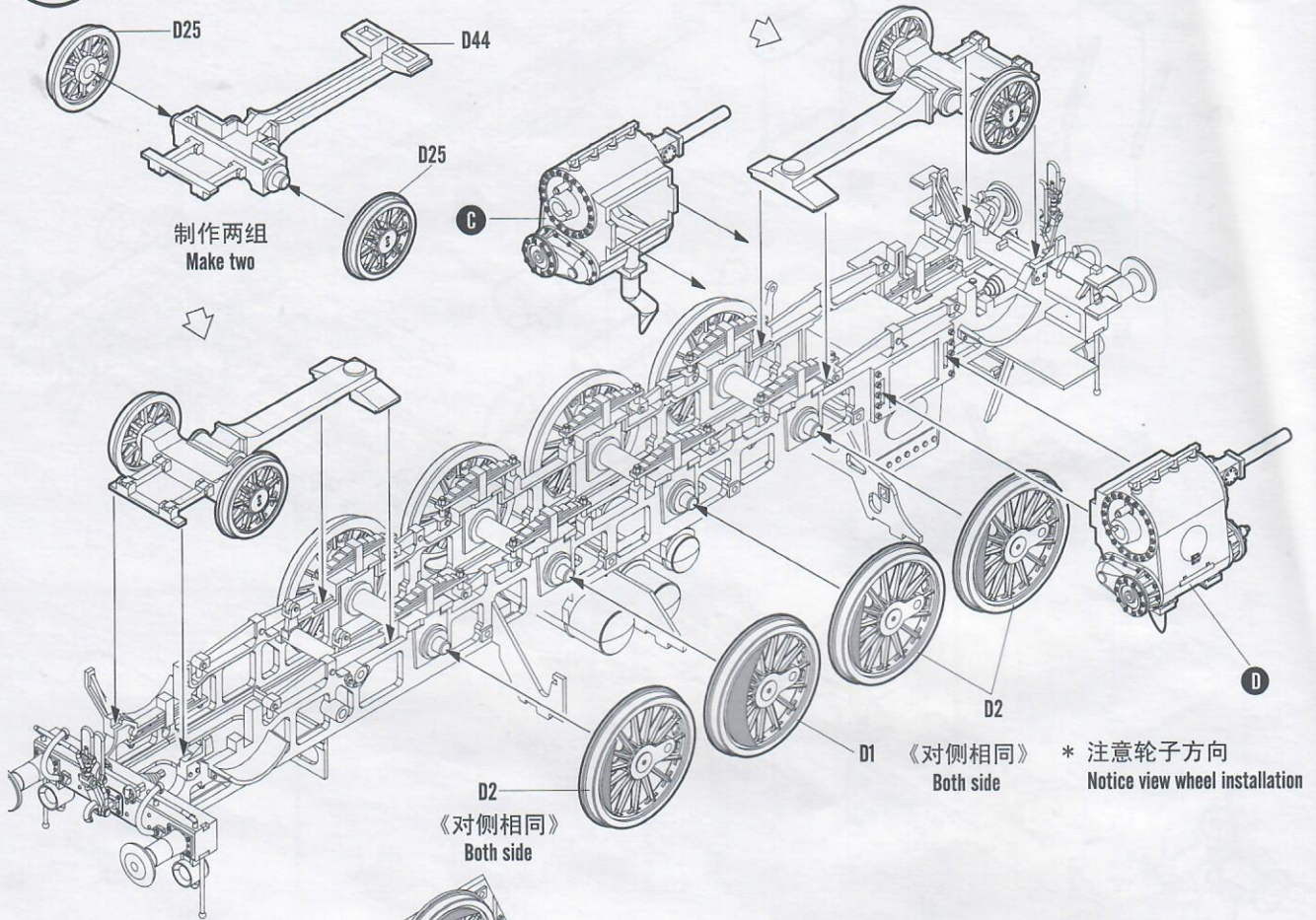

**5**  
STEP

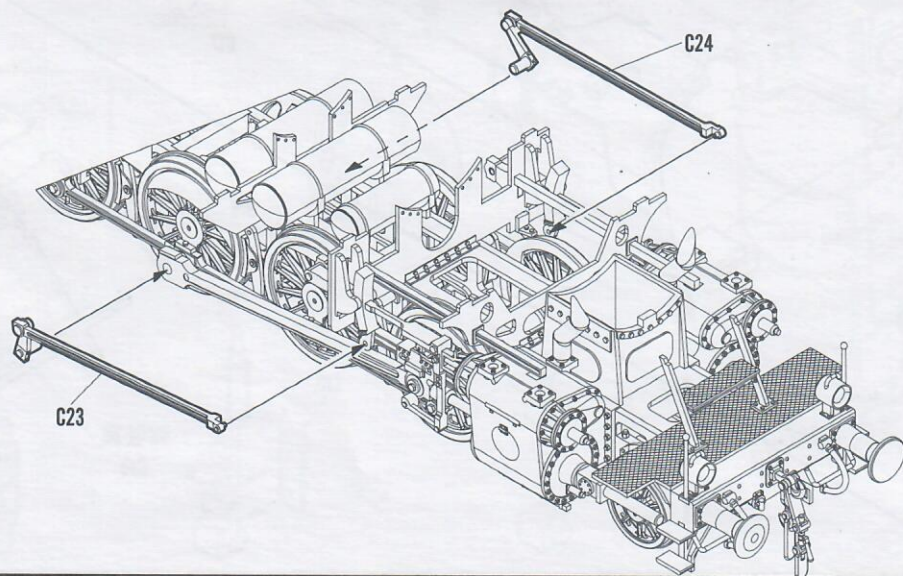
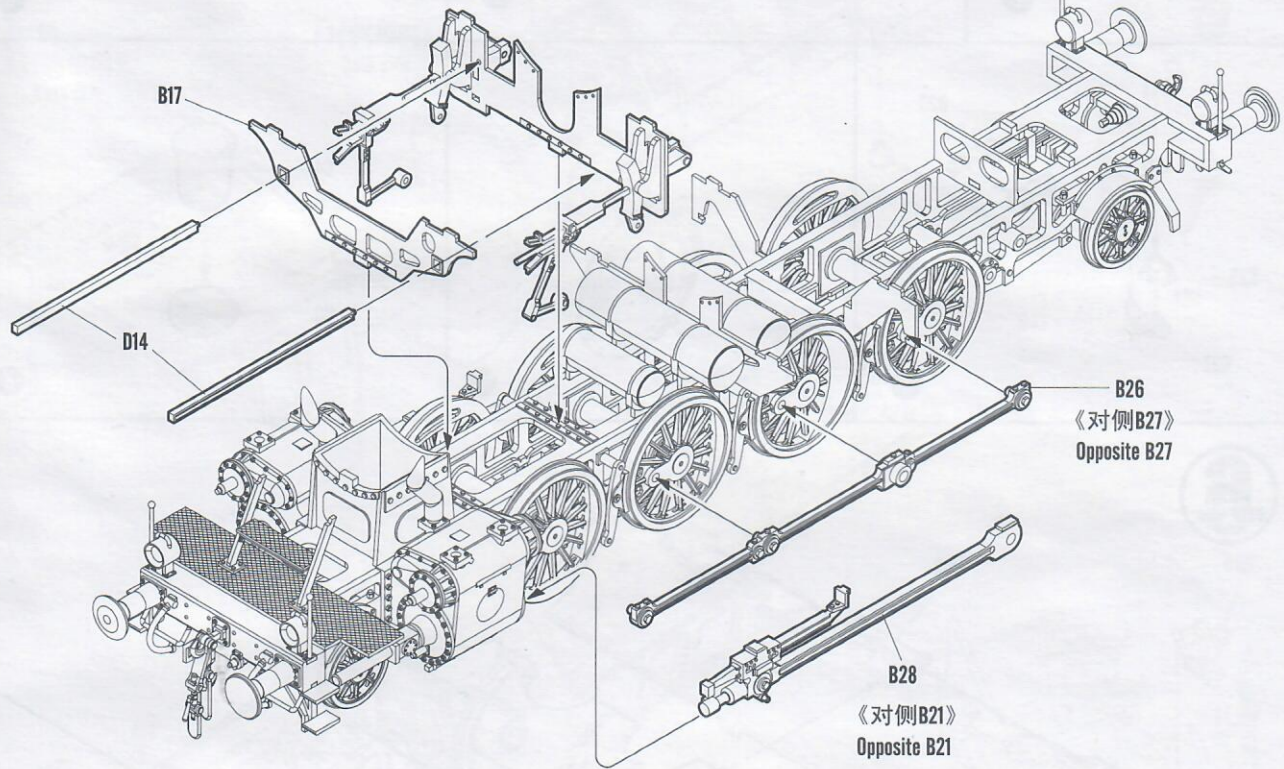
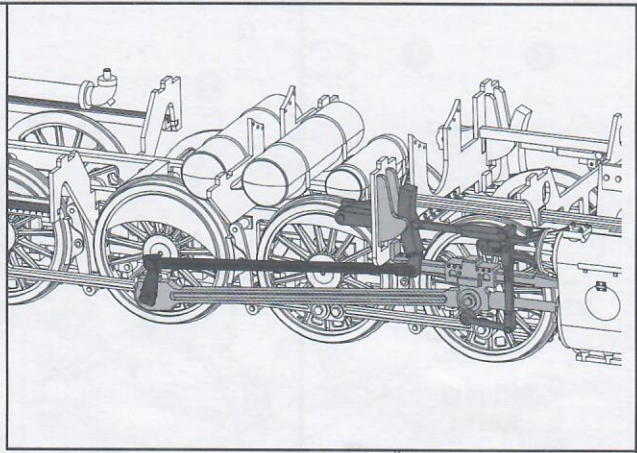
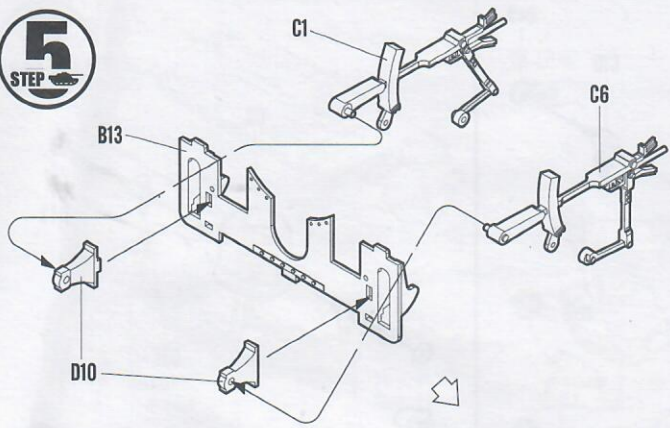

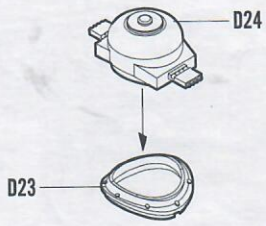

制作两组  
Make two

E

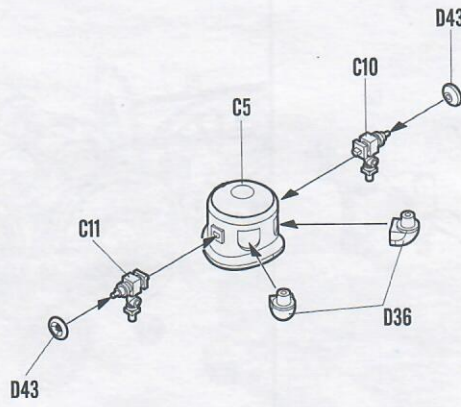

F

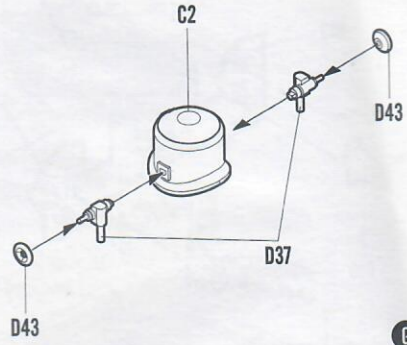

G

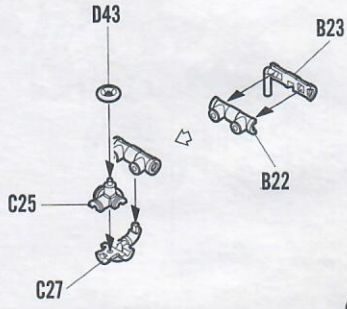

H

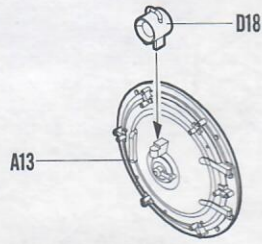

J

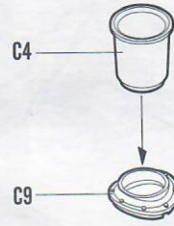

K

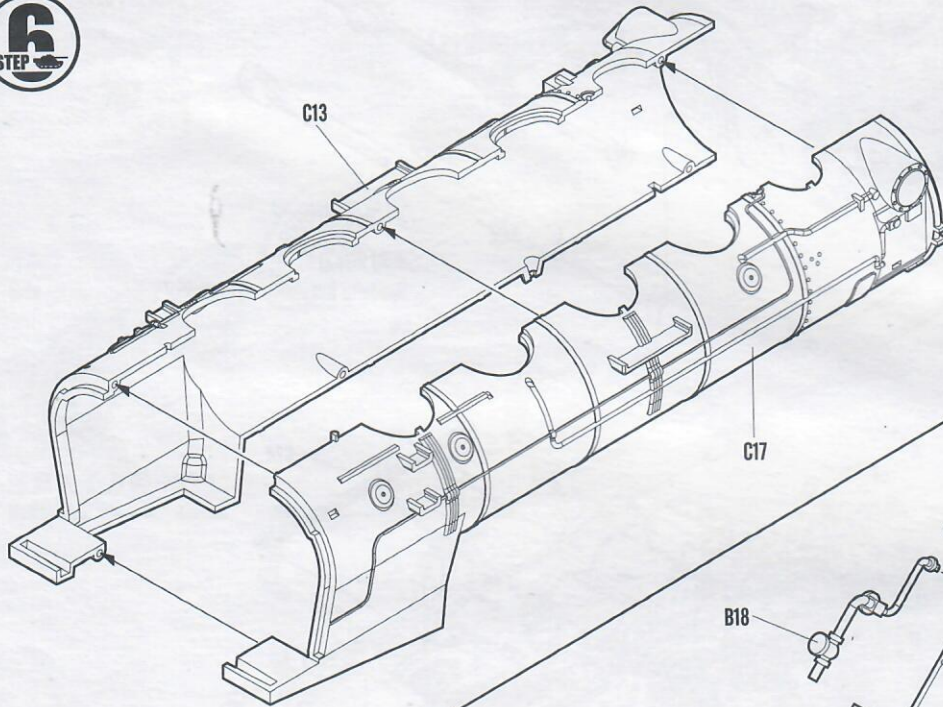

L

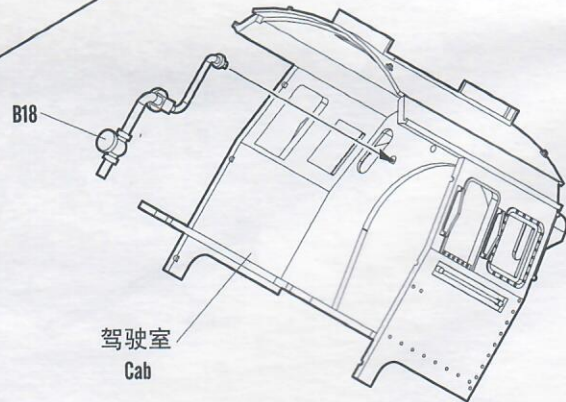

驾驶室  
Cab



**7**  
STEP

驾驶室  
Cab

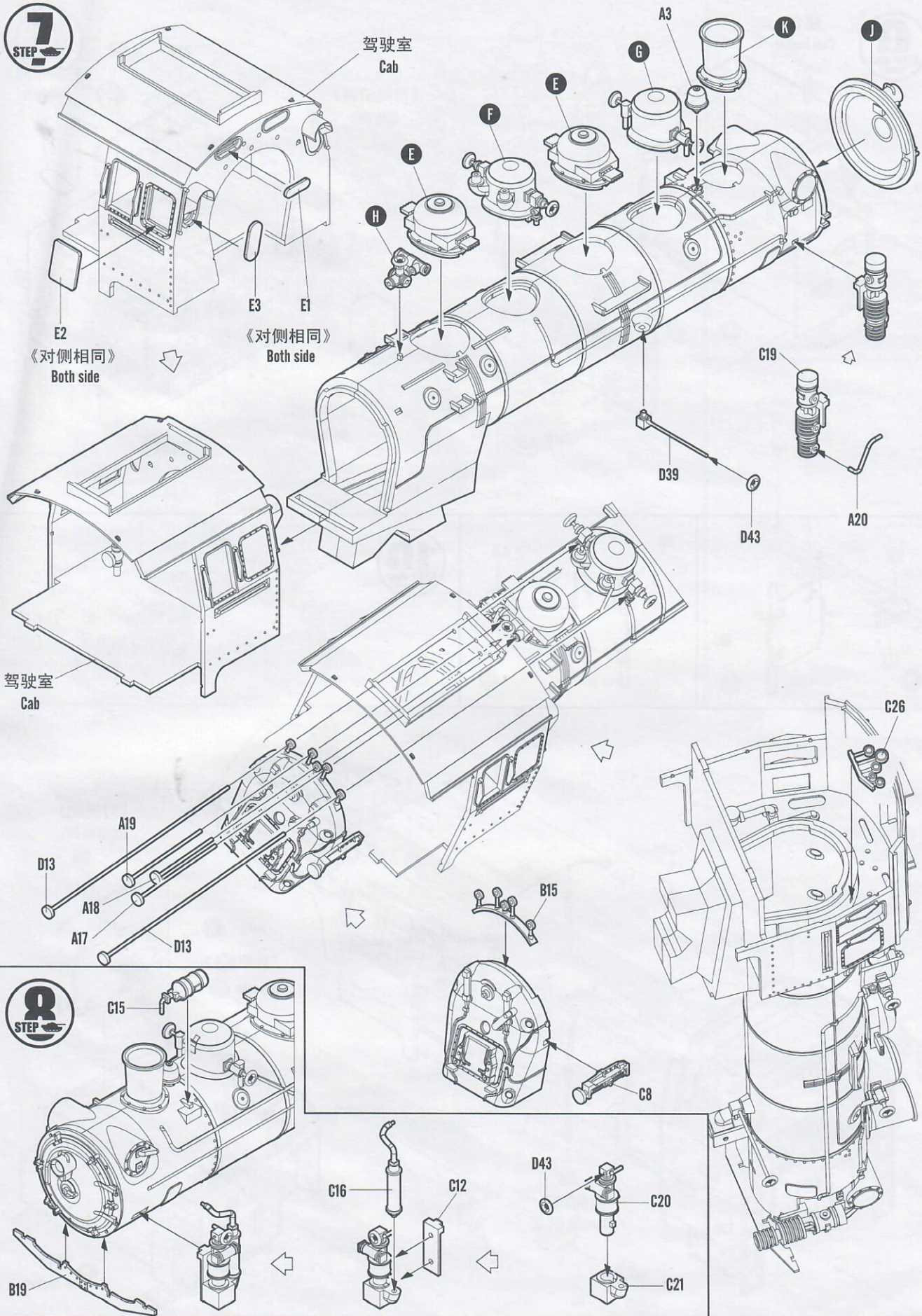

9  
STEP

煤仓  
Coal bunker

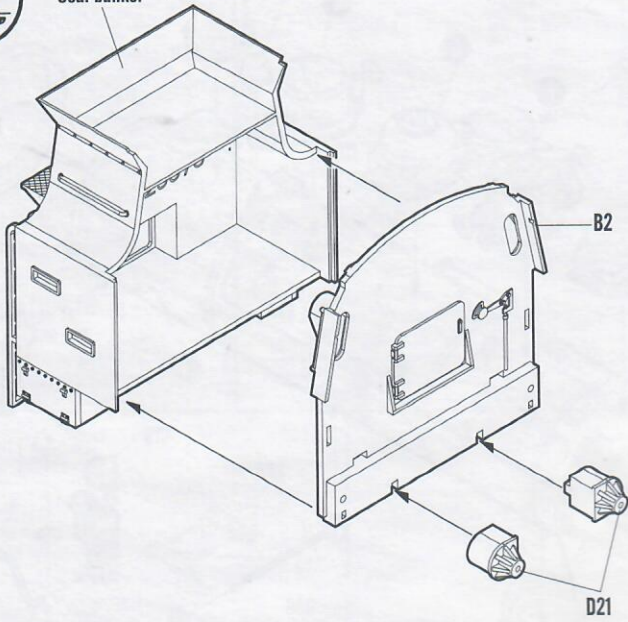

《对侧相同》  
Both side

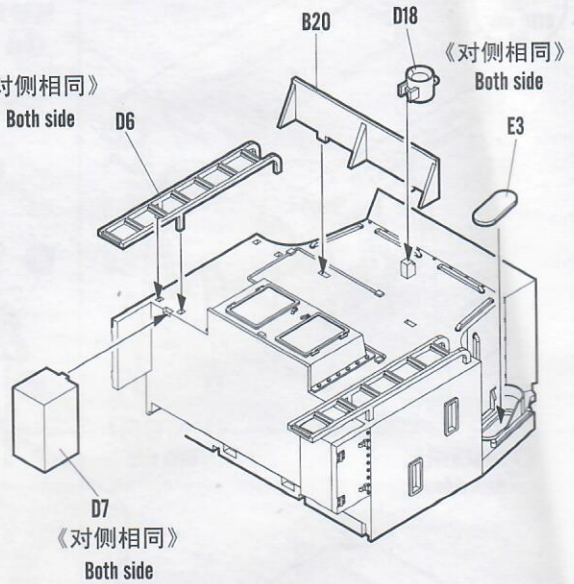

《对侧相同》  
Both side

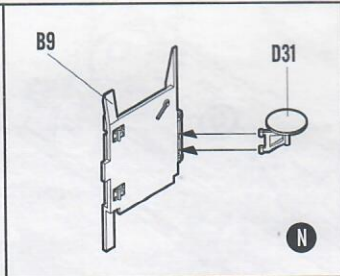
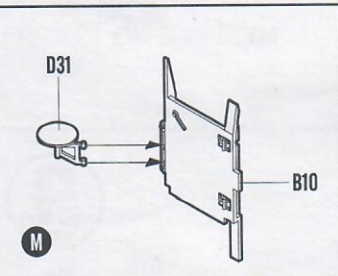

10  
STEP

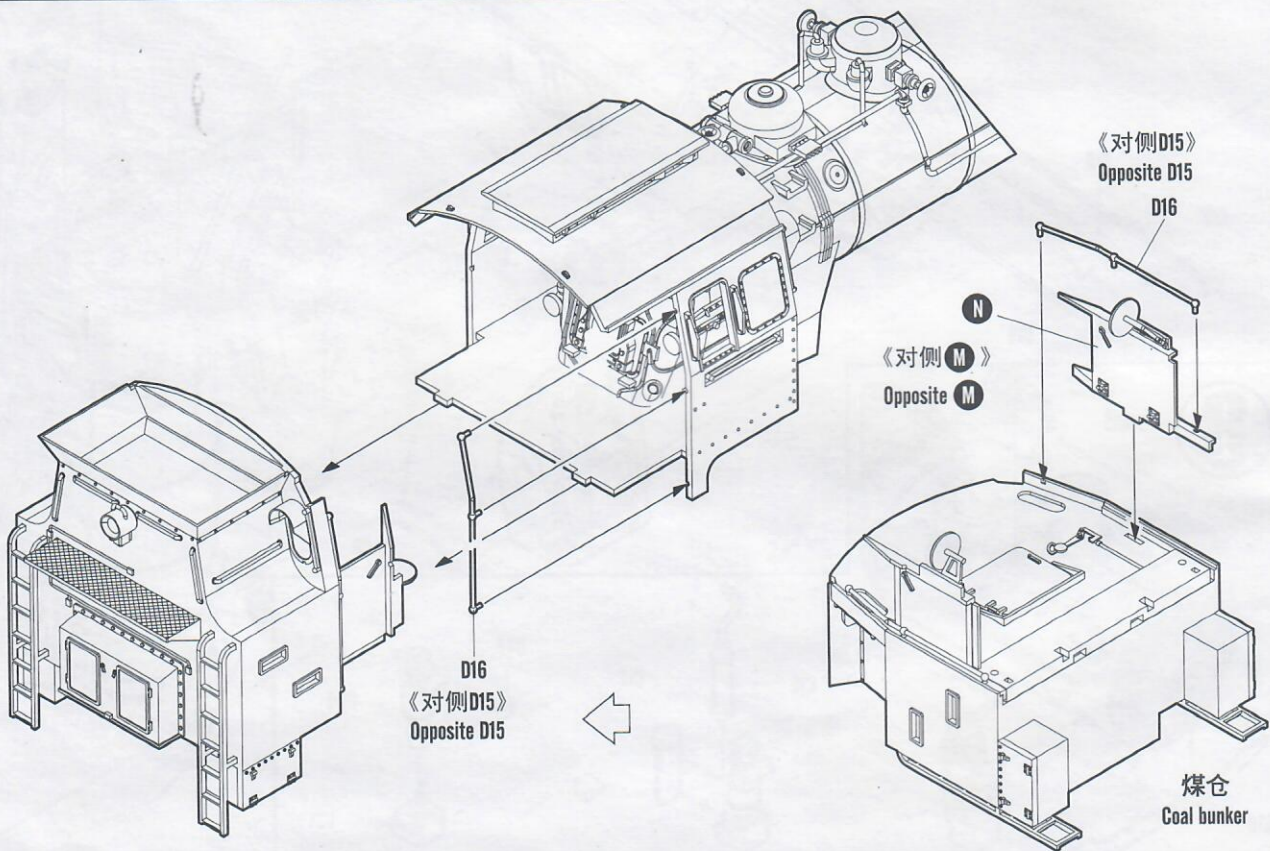

**11**  
STEP

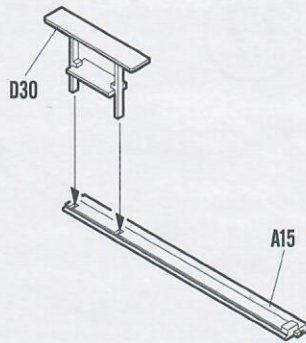
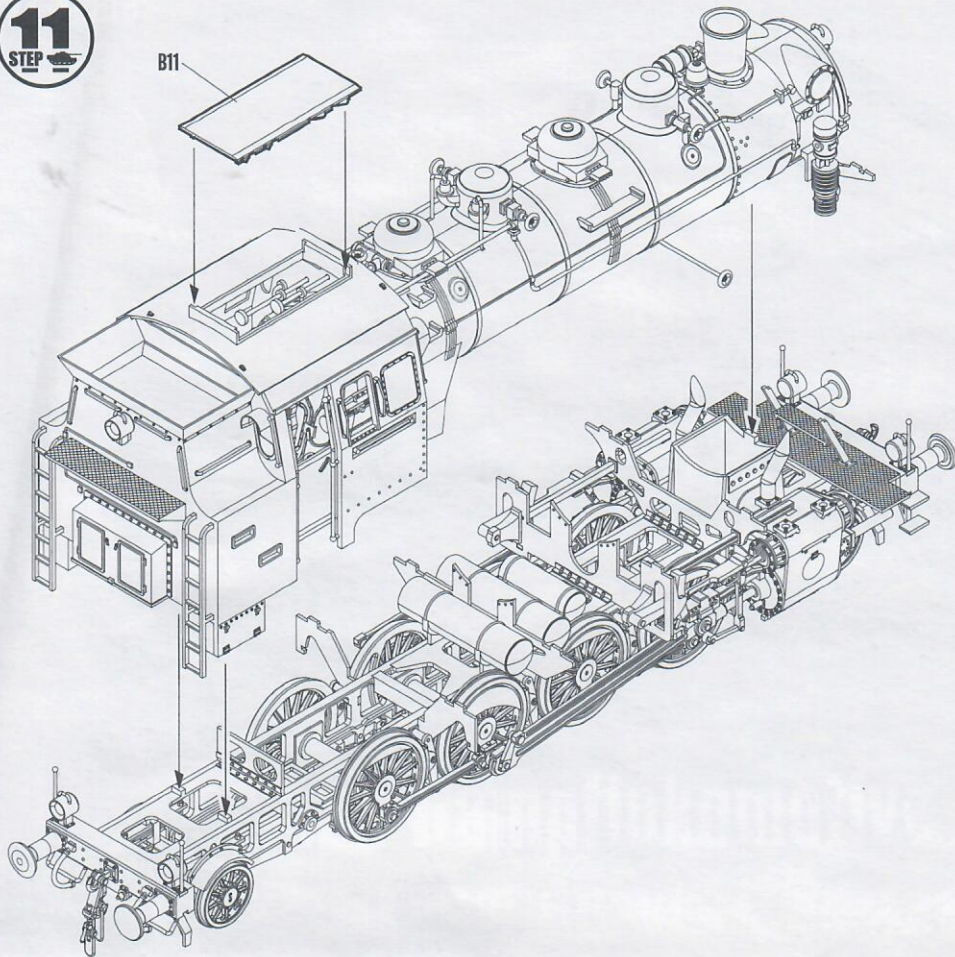

P

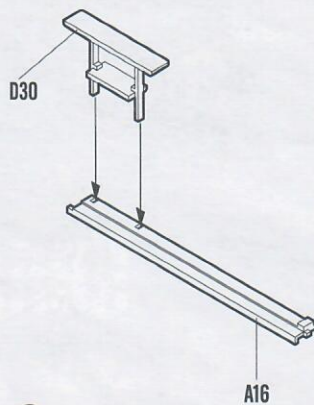

Q

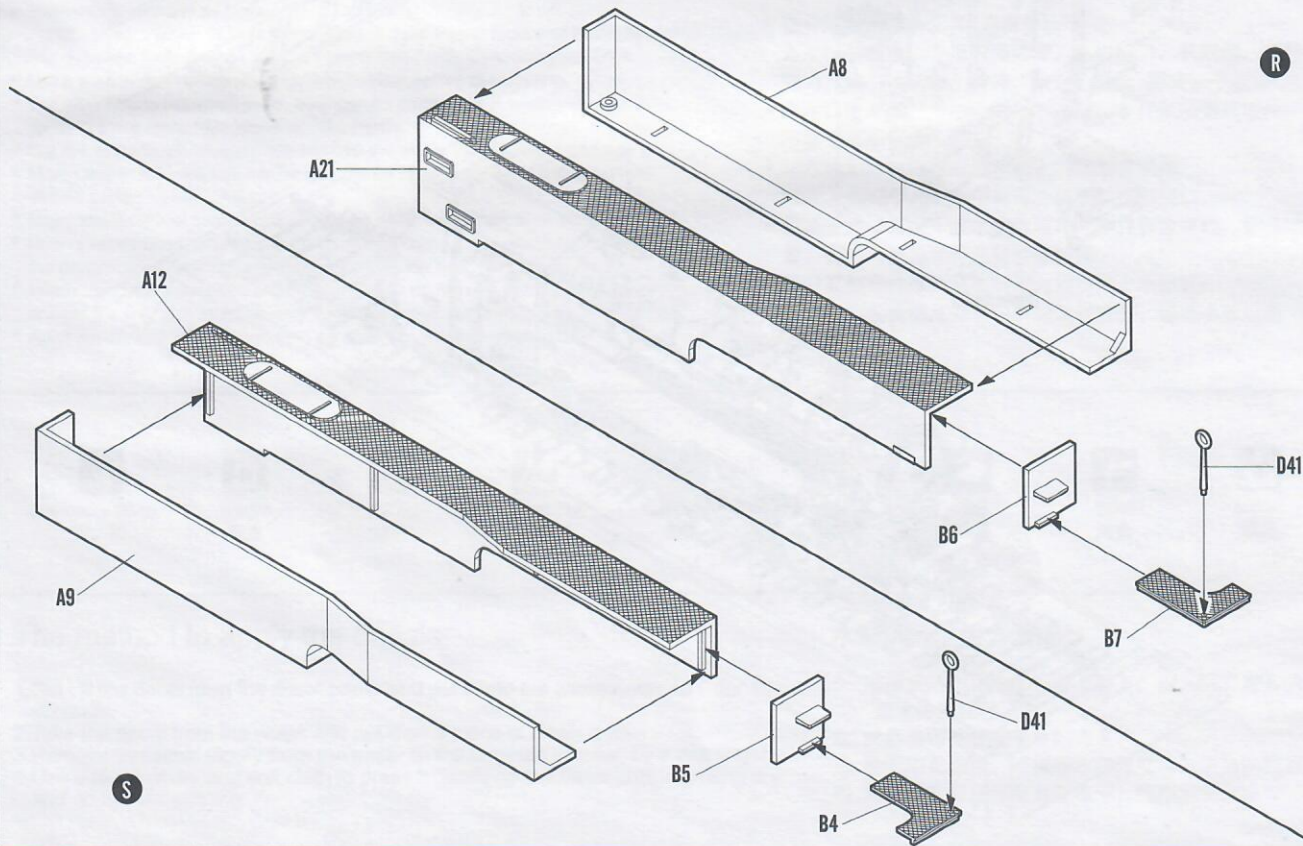

R

82914

11

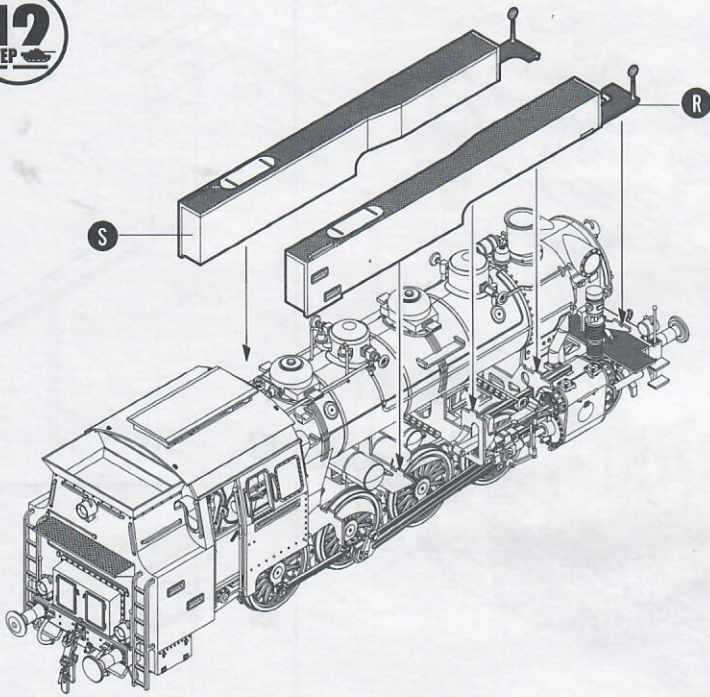

《对侧 Q》  
Opposite Q

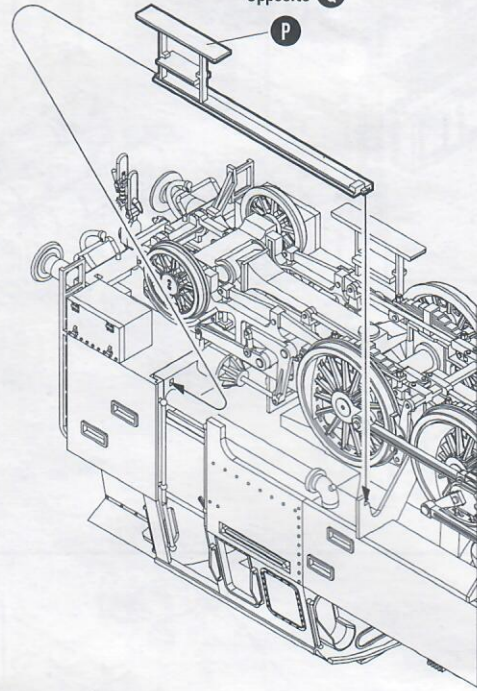

《对侧相同》  
Both side  
D27

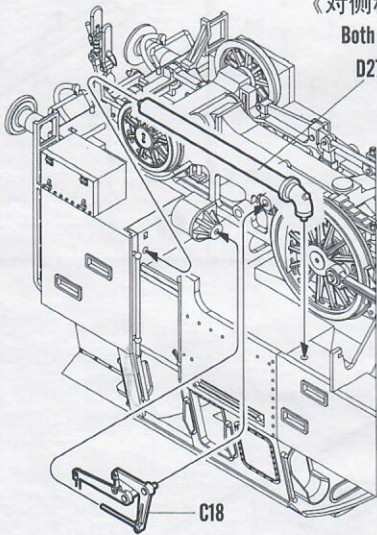

《对侧C3》  
Opposite C3

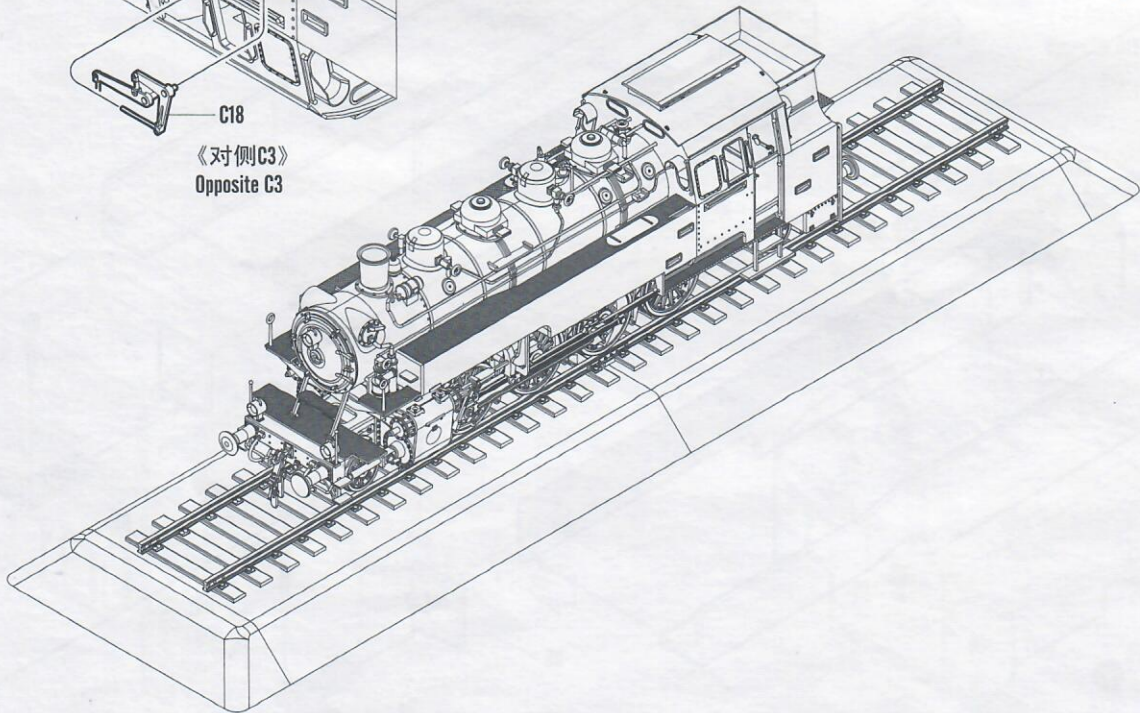

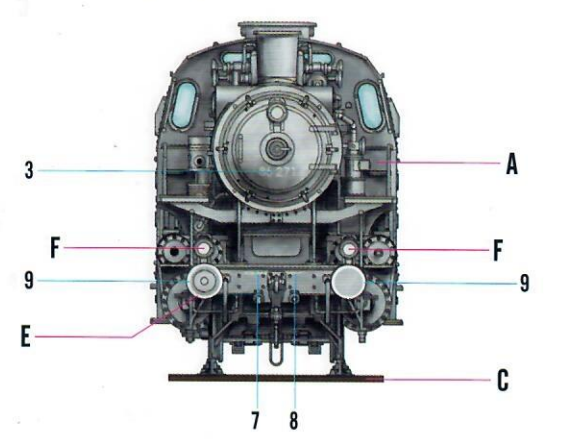
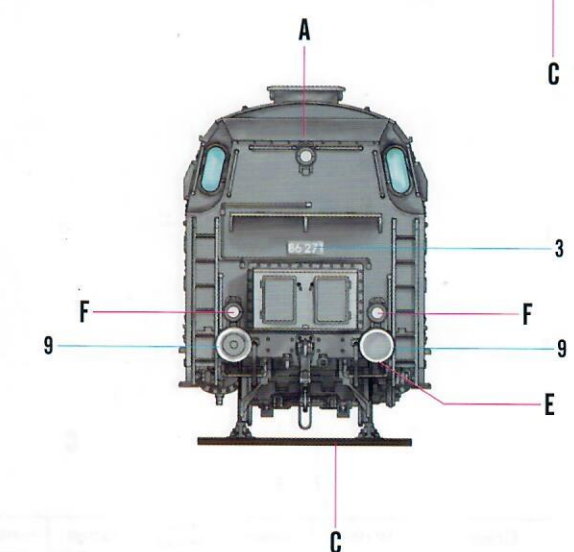
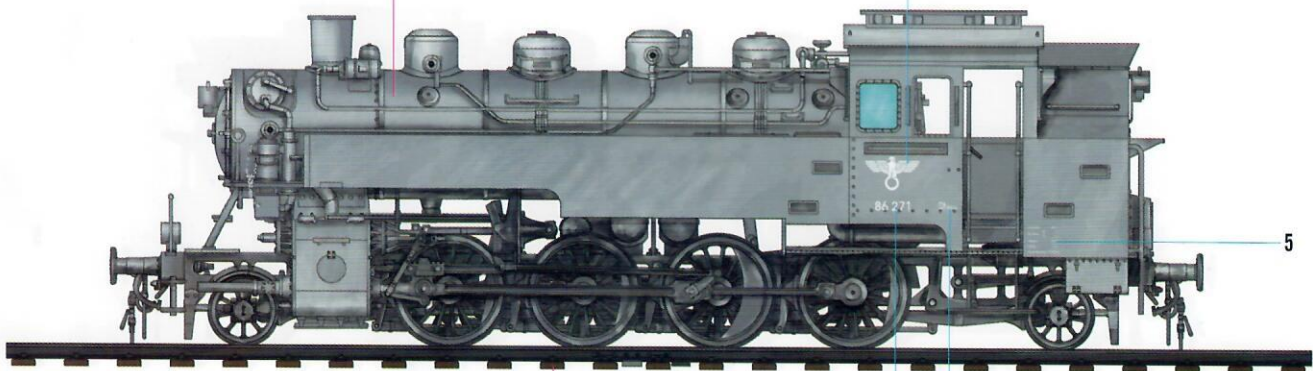
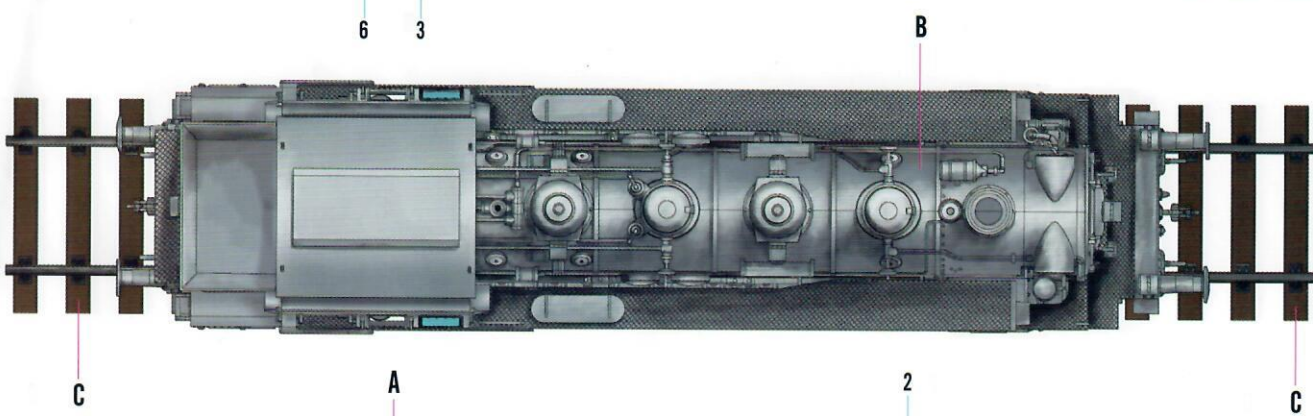

	Color	Mr.Hobby	Vallejo	Model Master	Tamiya	Humbrol
A	原野灰 Field Gray	H 32 40	830	--	XF22	111
B	黑色 Black	H 2 2	861	1747	X1	21
C	枕木色 Red Brown	H 47 41	984	--	XF64	160

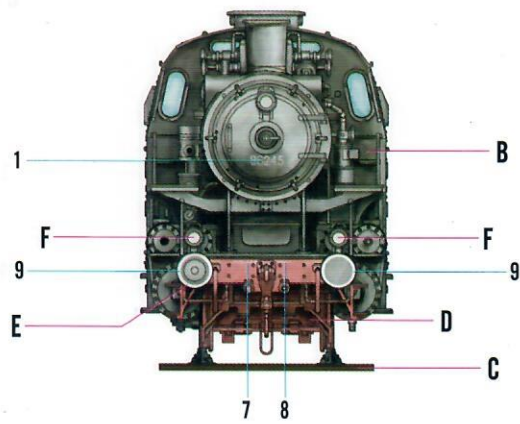
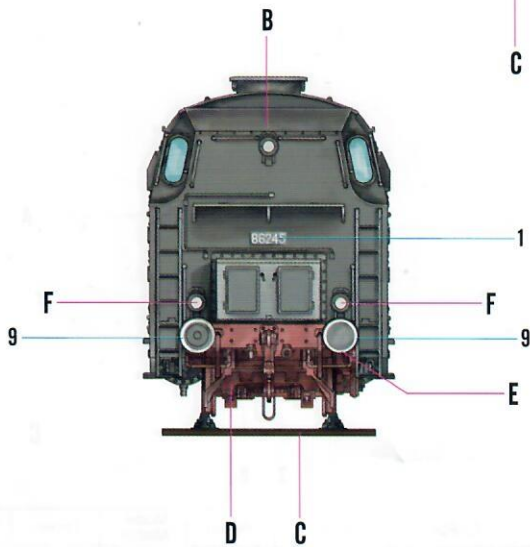
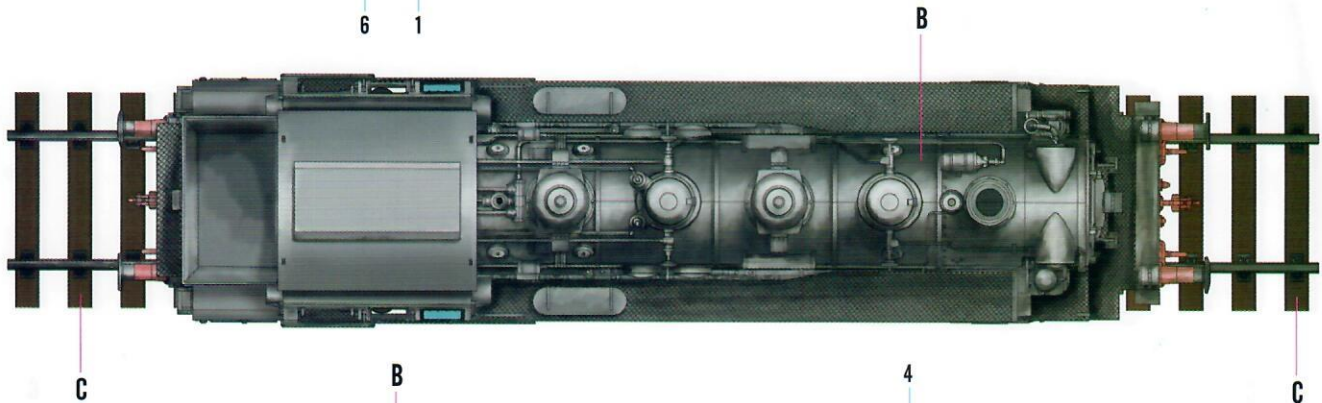

Color	Mr.Hobby	Vallejo	Model Master	Tamiya	Humbrol
<b>D</b> 红色 Red	H[3] 3	908	1503	X7	79
<b>E</b> 白色 White	H[1] 1	842	1745	X2	22
<b>F</b> 银色 Silver	H[8] 8	997	1546	X11	11

1:72  
Scale 82914

# German Dampflokomotive BR86

HOBBY BOSS



100% NEW TOOLING!

The legendary steam locomotive BR 86 was designed to a 1925 specification for a 15-ton axle loading for use on all branch lines, especially in hilly and mountainous countryside. These locomotives showed a remarkable uniformity in construction when compared to previous types, which had been manufactured to "regional" designs, leading to problems with maintenance and spare parts; the standardization of parts and components solved these problems. The first examples of the BR86 were produced by MGB Karlsruhe locomotive works in 1928 and last machine was manufactured in 1943 as interim war locomotive version. The BR 86 holds the record in Germany for the longest production run of any locomotive ever manufactured, with a total of 776 built. From 1939, these locomotives also saw service in Austria, Poland and the Soviet Union. After WW II, the Czechoslovak State Railway operated these locomotives, from a total of 65 locomotives seized as war prizes and reparation. They saw service until the 1960's, when most were phased out of regular service.

Kit consists of over 221 parts on 10 sprues including hull.  
Dimension of completed model: Length: 191.5mm Width: 44 mm



German Dampflokomotive BR86  
1:72 Scale HobbyBoss NO. 82914

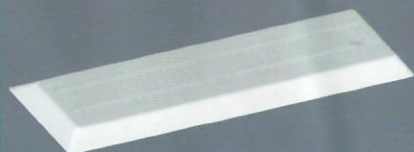

Decal with abundant markings and railroad track stand are included.

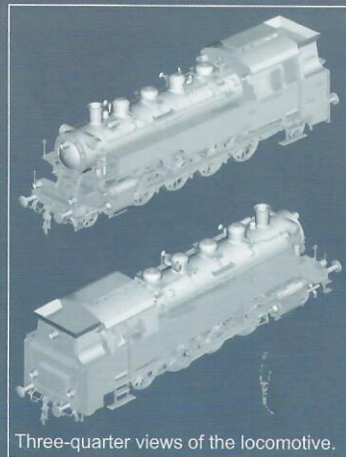

Three-quarter views of the locomotive.



Engineer's cab well detailed.

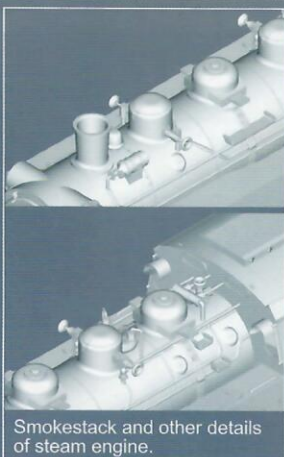

Smokestack and other details of steam engine.

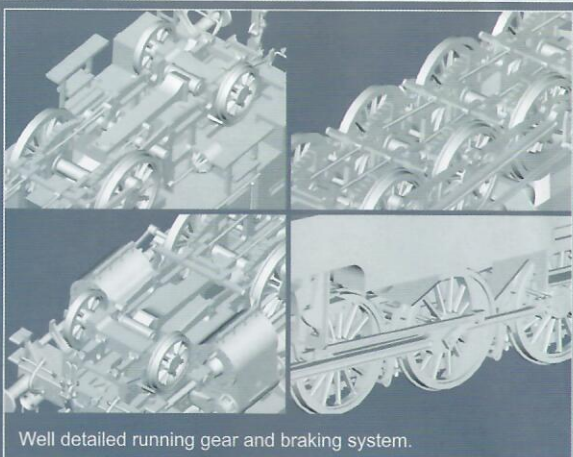

Well detailed running gear and braking system.

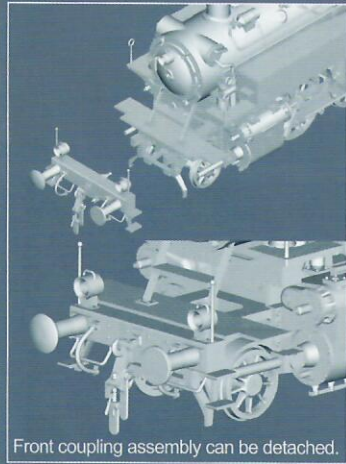

Front coupling assembly can be detached.

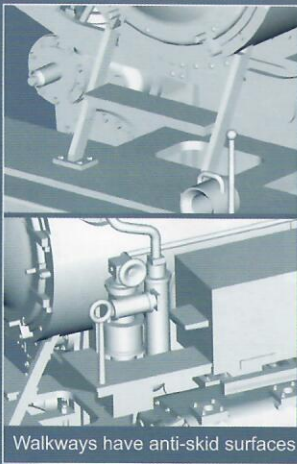

Walkways have anti-skid surfaces.

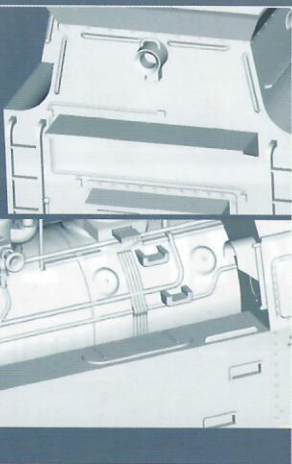

Smokebox and furnace doors well detailed.

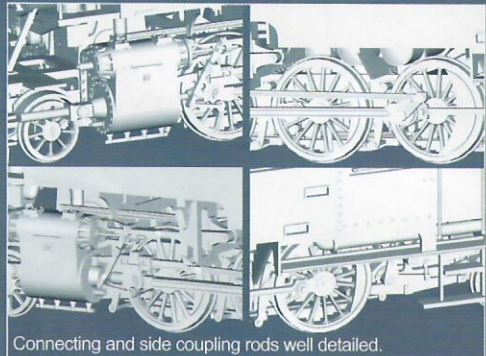
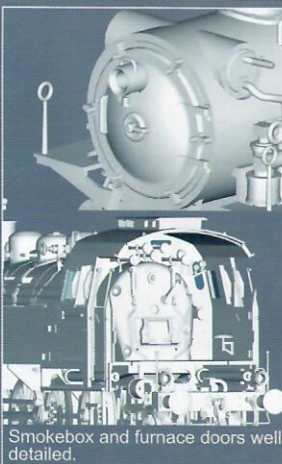

Connecting and side coupling rods well detailed.

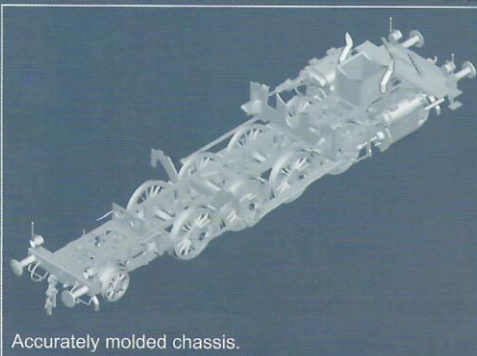

Accurately molded chassis.

