

"Snowbirds" Tutor

"雪鸟" 飞行表演队CT-114教练机

The CT-114 Tutor aircraft was designed for the RCAF requirement as a jet trainer, which began with the preliminary in house studies in 1955. By 1957, a full mock-up (CL-41) was constructed. It had side-by-side ejection seats and a single engine. After an evaluation by the RCAF, the CL-41 was ordered into production in September 1961 named "CT-114 Tutor" which was equipped with the GE J-85 CAN-40 jet engine. CT-114 Tutor was mostly used for the training of student pilots.

There were 13 CT-114 Tutor be selected as Snowbird flight performing team, with unique painting of red and white color, They often had road show in North America areas and became a popular performing team.

CT-114是应加拿大皇家空军要求而设计的一种教练机。于1955年开始秘密研究, 1957年完成第一架1: 1模型飞机(CL-41), 它装备有并列座椅及单引擎。经加拿大皇家空军评估后, 于1961年9月开始投产, 命名为CT-114, 装配了通用电气的J-85 CAN40喷气发动机, 主要用于训练飞行员。共有13架CT-114教练机被雪鸟飞行表演队选作花式表演, 并将飞机涂装成独特的红、白颜色。他们经常在北美地区作巡回表演, 是一支非常有名气的表演队。

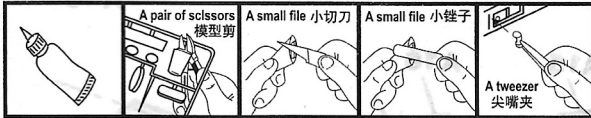

Attention-Useful Advice

1. Study the instructions carefully prior to assembly.
2. Check the fitness of each part before assembling.
3. Remove parts from frame with a sharp knife or a pair of scissors and trim away excess plastic. Be careful, do not break off any plastic parts.
4. Don't pull off the parts from frame.
5. Use plastic cement only and use cement sparingly to avoid damaging the model.
6. Paint small parts before detaching them from frame.
7. Remove paint where parts are to be cement.
8. Parts with shadows are not used for this model.

CAUTION

1. Before you start assembly, you should read all the instructions carefully.
2. Please have all the necessary tools ready before start assembling.
3. The removed plastic parts have sharp, pointed or jagged edges. Remove these with a file or sandpaper.
4. Do not use glue or paint near open flame. Keep the window open.
5. Plastic bags can be dangerous. To avoid danger of suffocation, keep this bag away from babies and children.
6. Keep out of the reach of children under 36 months old, as some parts are detachable. Children must not be allowed to suck any parts with this kits.
7. Please keep this instructions for future reference because it contains important information.

注意: 拼装技巧提示

1. 拼装之前请仔细阅读说明书。
2. 拼装之前请检查每部份零件是否吻合。
3. 请用小切刀或模型剪从注塑件中剪去多余的胶片, 请小心, 勿剪断塑胶零件。
4. 切勿从塑胶片中拉断零件。
5. 请使用模型专用胶水粘合, 小心使用胶水以免损坏模型。
6. 请先替小零件涂上颜色, 然后将小零件从塑胶片中取出。
7. 请刮去零件要沾合处的油漆。
8. 阴影部分的零件不是作为装配此模型之用。

小心:

1. 请在拼装之前, 仔细阅读所有说明书。
2. 请在拼装之前, 准备好所需工具。
3. 移去的塑胶零件会有尖锐的锯齿状的边缘, 请用小挫子或沙纸磨掉。
4. 切勿在火旁使用胶水或油漆, 应保持窗户通风。
5. 胶袋可以造成危险, 为避免窒息, 请勿让婴儿及小孩接触此胶袋。
6. 由于部分零件是可以分开的, 切勿让3岁以下小孩接触。禁止让此模型的零件让小孩含入口中。
7. 请保留此说明书作为将来参考之用, 因为此说明书包含重要资料。

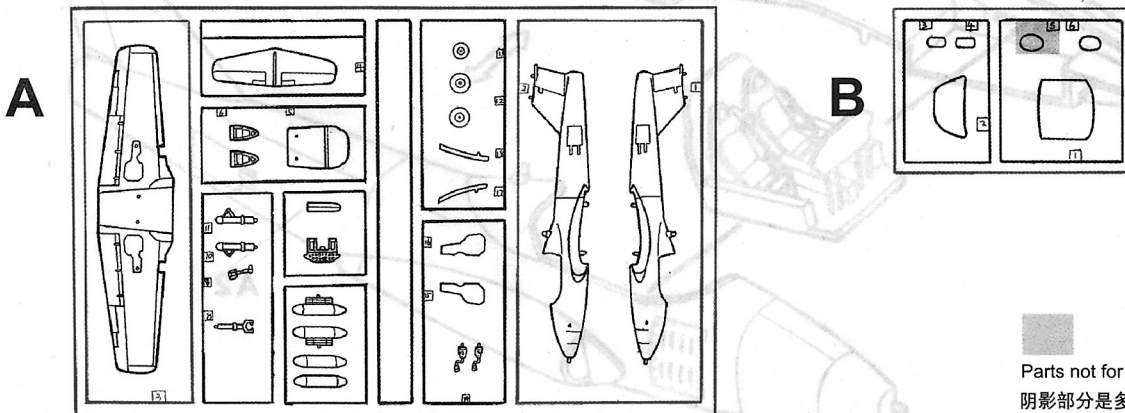

Parts not for use
阴影部分是多余的组件

4

APPLYING DECALS
 1 Cut the decal from the sheet.
 2 Dip the decal in tepid water for about 30 seconds. Do not use boiling water.
 3 Hold the decal by the edges and slide it onto the model.
 4 Move the decal into position by waiting about 10 seconds.
 5 Press the decal gently down with a soft cloth.
 6 Wipe away the water and smooth the decal.

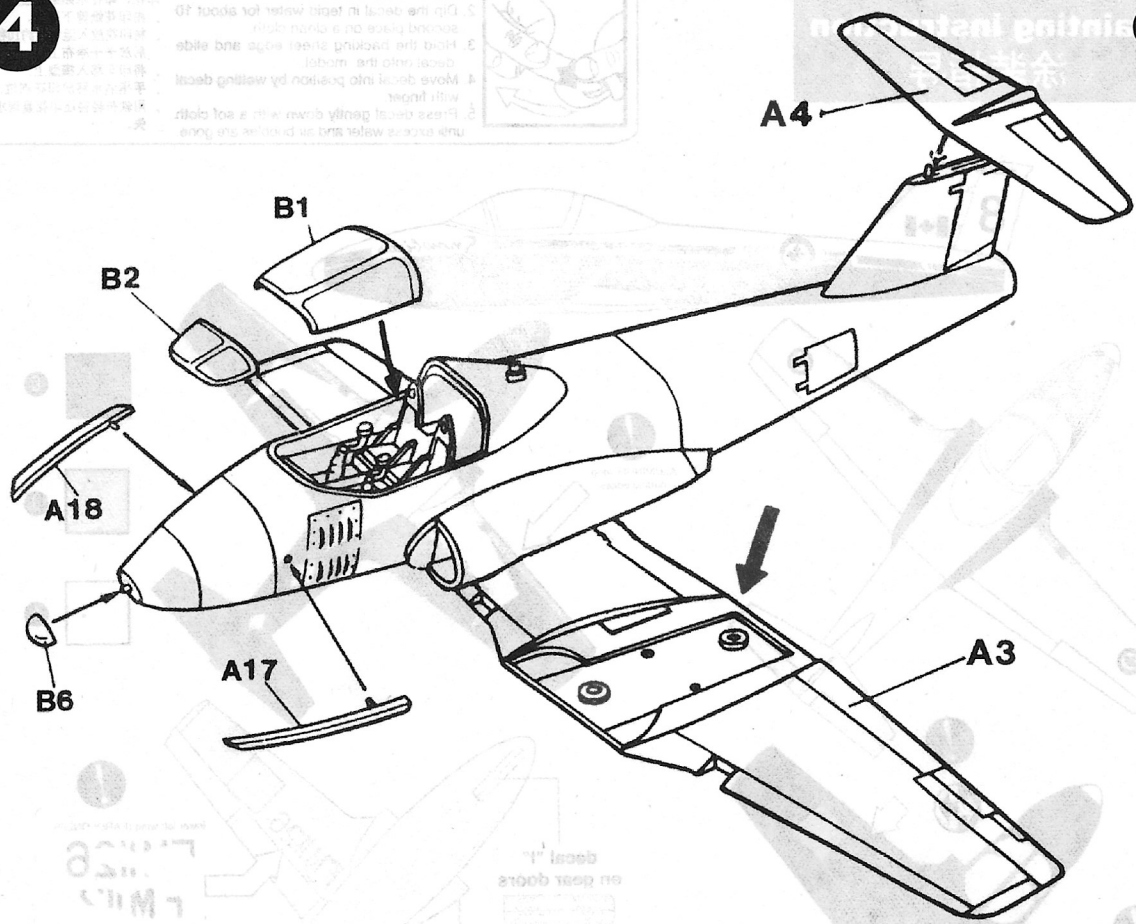

5

Colour Index Table (Refer to page 10)

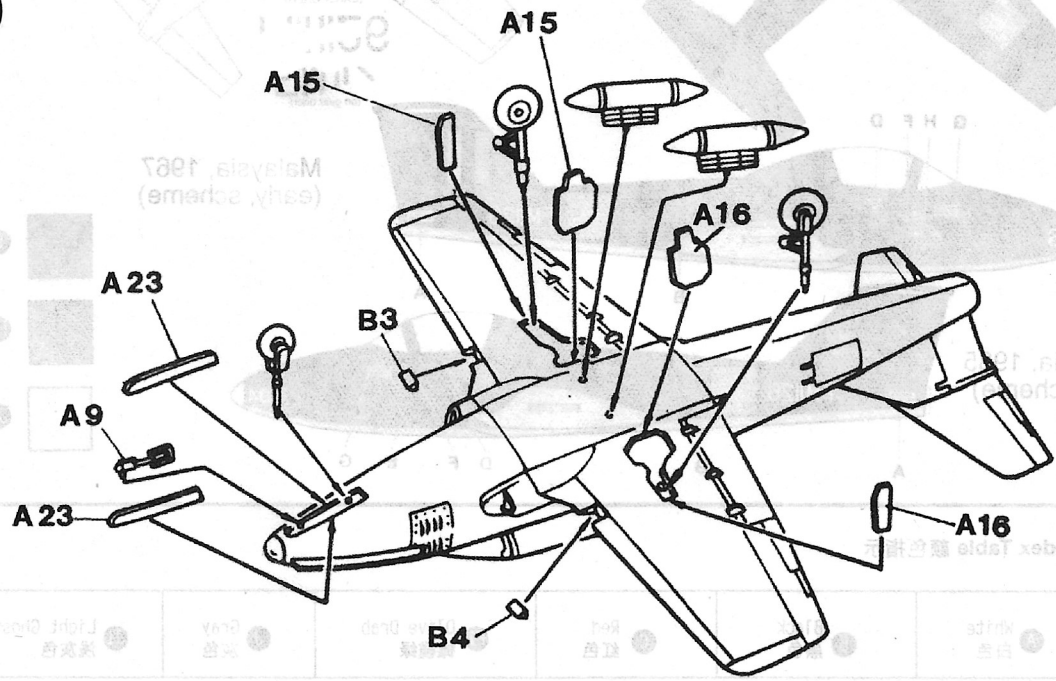

Light Blue Grey	Grey	Red	White
Light Blue	Black	Yellow	Black

Painting instruction

涂装指导

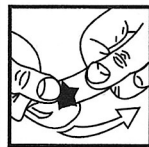

APPLYING DECALS

1. Cut off decal from sheet.
2. Dip the decal in tepid water for about 10 second place on a clean cloth.
3. Hold the backing sheet edge and slide decal onto the model.
4. Move decal into position by wetting decal with finger.
5. Press decal gently down with a soft cloth until excess water and air bubbles are gone.

- 印花 (印花水贴纸) 应用
- 由印花纸剪下印花。
 - 将印花放入温水中约10秒, 然后放于干净布上。
 - 将印花移入模型上。
 - 手指沾水移放印花到位。
 - 用软布轻轻压印花直到水泡消失。

ALUMINUM wing leading edges

decal "I" on gear doors

lower left wing (EARLY ONLY!)

lower right wing (EARLY ONLY!)

Malaysia, 1967 (early, scheme)

Malaysia, 1985 (Late scheme)

Color and decal callouts: A, B, C, F1, J, J1, G, H, F, D, E, 26, 04, 114037, CANADA, Snowbirds, ARMED FORCES, FORCES ARMÉES, TUOM M22-04.

Colour Index Table 颜色指示

A White 白色	B Black 黑色	C Red 红色	F1 Olive Drab 橄榄绿	J Gray 灰色	J1 Light Ghost Gray 浅灰色
----------------------	----------------------	--------------------	-----------------------------	---------------------	-----------------------------------