

RESIN CASTED PARTS

(Remove shaded areas by means of a cutting saw and some sandpaper).

RECOMMENDED REFERENCE MATERIAL

LOCK ON N° 2 F-16 FIGHTING FALCON/
Verlinden Publications.

Over 160 color photos of every F-16 detail including cockpit, seat, etc...

READ THE INSTRUCTIONS CAREFULLY BEFORE YOU START ASSEMBLING.

The rod and strip to be used as mentioned on this instruction sheet is not included. Ask your hobby shop for these useful items. If rod is not available to you, stretched sprue is an alternative material to be used.

CAUTION

The parts in this detail set can only be glued using cyanoacrylate glues. Work in well ventilated areas only and avoid inhaling the fumes for they can be harmful. Avoid contact with eyes and skin.

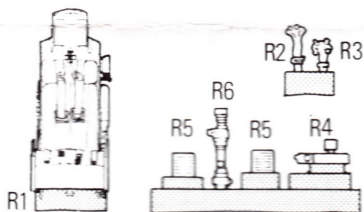
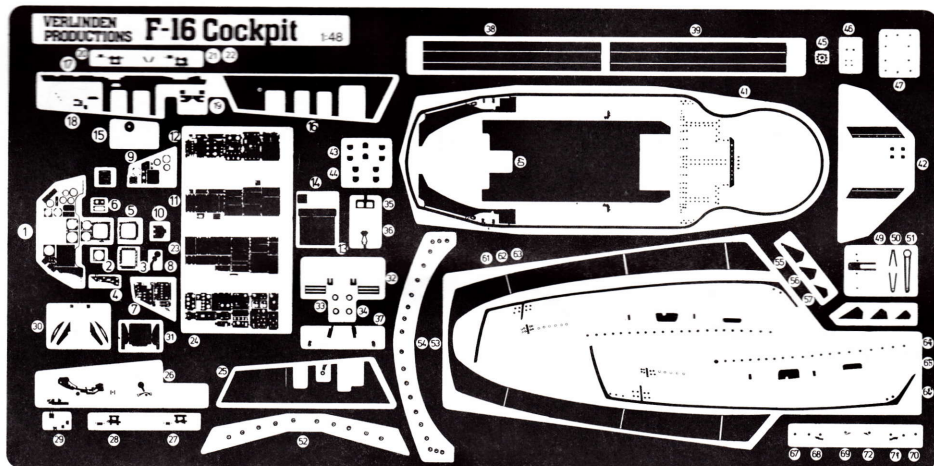
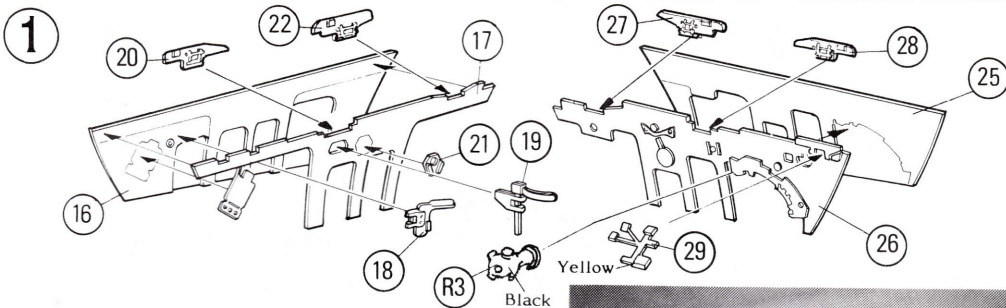

PHOTO-ETCHED PARTS





- 1/ Glue part 17 to part 16. Glue part 21 to part 17.
- 2/ Glue part 26 to part 25.

THE FOLLOWING STEPS SHOULD BE COMPLETED WHEN THE KIT IS COMPLETELY FINISHED. IF YOU GLUE THEM NOW, THEY WILL BREAK OFF WHEN CONSTRUCTING THE REST OF THE KIT.

- 3/ Glue parts 18 & 19 to 16 as shown in the picture on the front page of this instruction sheet.
- 4/ Glue parts R3 & 29 to 25 & 26 as shown in the picture at right.
- 5/ parts 20, 22, 27 & 28 should be glued when Step2 is completed.

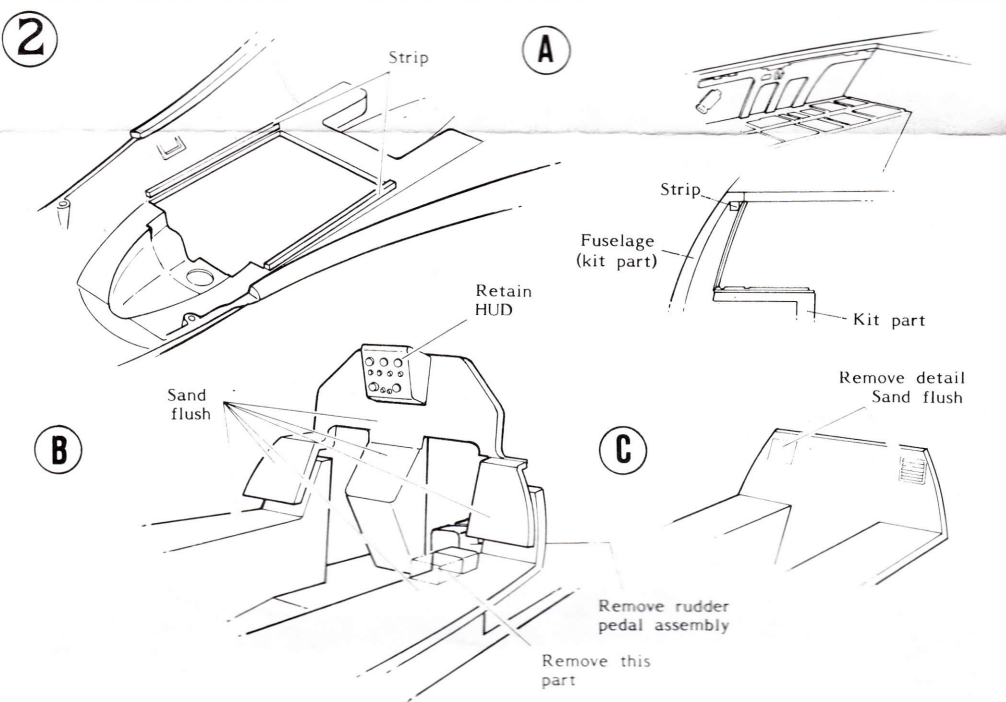
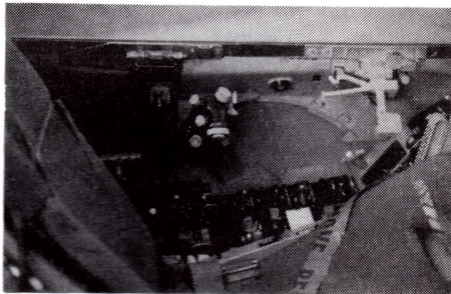

PREPARING THE COCKPIT ASSEMBLY

- 1/ Glue 2 strips alongside the canopy side railing as shown in drawing A . These strips will position photo-etched parts 16 & 25 to the side of the cockpit when Step 3 is executed.
- 2/ **IMPORTANT** : if you decide to retain the kit detail on the front and side panels, Step B should only

- partially be executed. If you want to add the photo-etched cockpit parts remove the detail from the front panel and the side consoles.
- 3/ Remove part of the stick assembly box (drawing C).
- 4/ Remove the rudder pedal assembly as shown in drawing C .

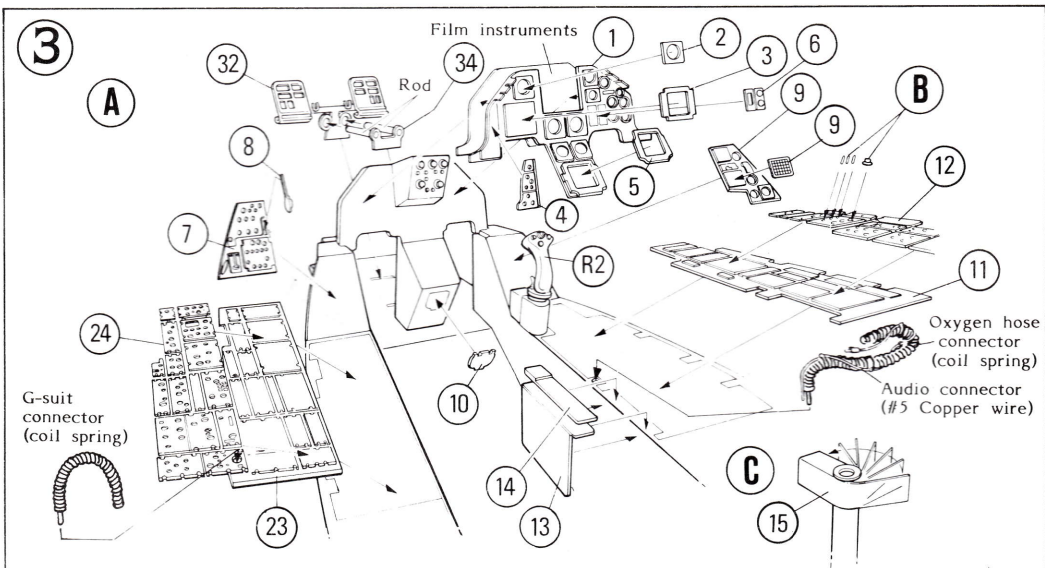

- 1/ Paint the front instrument panel white.
- 2/ Glue the film instruments to the panel.
- 3/ Glue part 1 in place.
Glue part 2, 3, 4, 5, & 6 to part 1.
- 4/ Glue part 7 in place. Insert part 8 as indicated.
- 5/ Glue part 9 in place.
- 6/ Glue parts 10 to the front console as shown.
- 7/ Glue the side console (11&12) in place.
- 8/ Glue the map storage box (13&14) to the side console as indicated.
- 9/ Shape part 15 as shown in drawing C. Glue on top of the side console. Glue the control stick (R2) into part 15.

- 10/ Glue the left side consoles (23 & 24) in place.
- 11/ Shape the lower part of the rudder pedals (part 32) over a large needle. Cut two pieces of rod (4mm) and insert these between parts 32 & 34.
- 12/ Glue this rudder pedal assembly in place.
- 13/ Cut two pieces of coil spring :
1. G-Suit hose connection : 6mm.
2. Oxygen connection : 10mm.
Cut a piece of #5 Copper Wire : 10mm.
- 14/ Insert #3 copper wire to hold the desired position and glue in place.
- 15/ Add control knobs & switches as shown in drawing B using Step 5 as a guide.

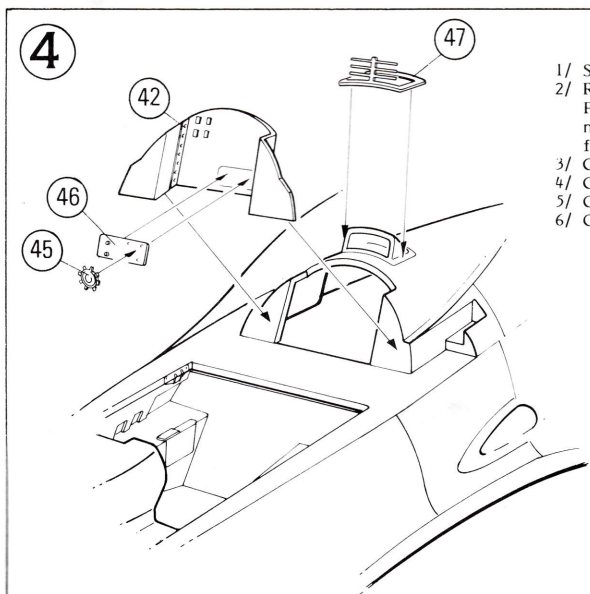

- 1/ Shape part 42 as shown.
- 2/ Remove part of the fairing aft of the cockpit. Part 42 should fit into the open space, so be careful not to remove too much material at once. Fit and fit again before cutting or filing.
- 3/ Glue part 42 in place.
- 4/ Glue part 45 to 46.
- 5/ Glue part 46 to 42 as indicated.
- 6/ Glue part 47 in place.

5

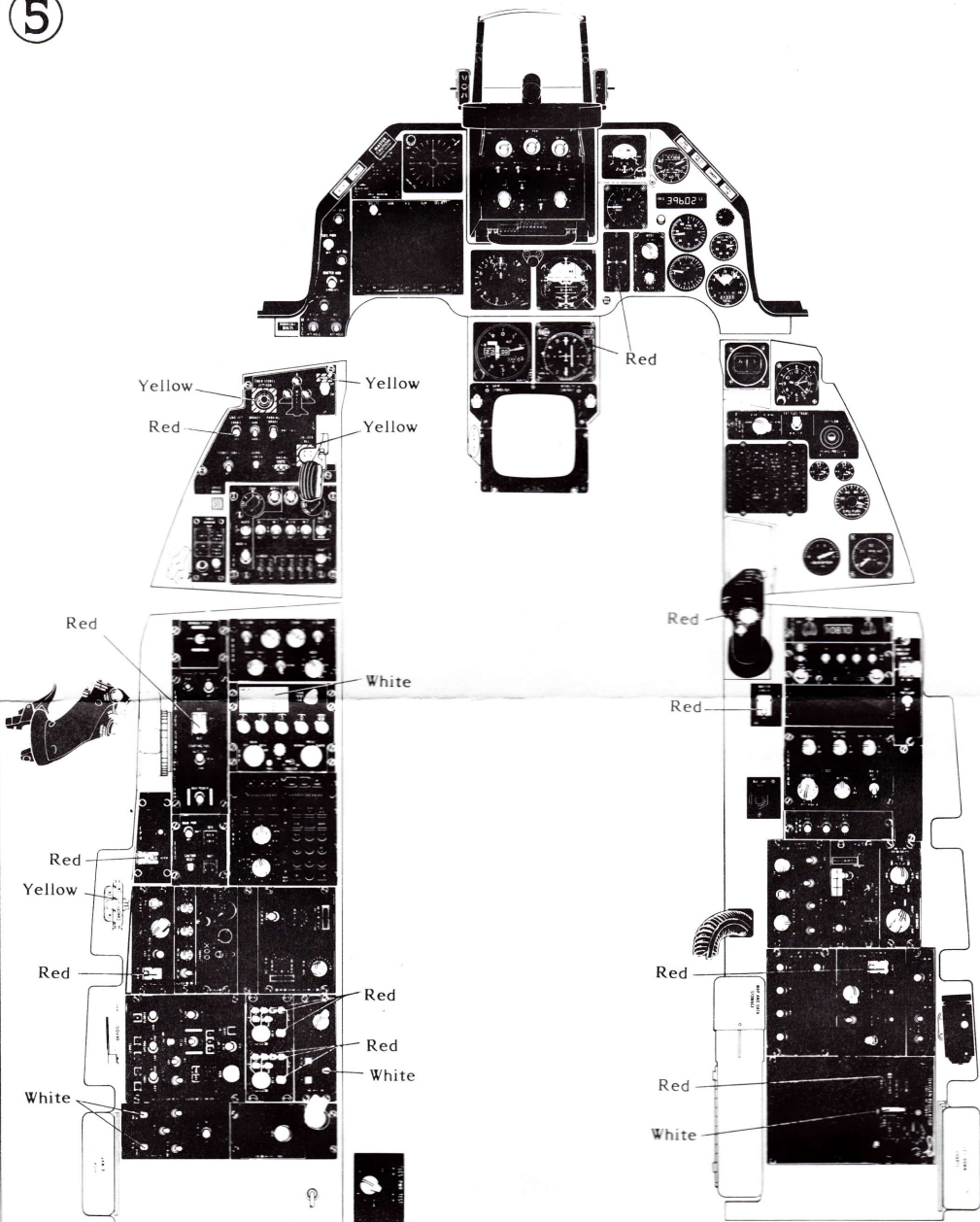

F-16 A Block 15
COCKPIT LAYOUT

This layout shows you the size and shape of the switches and the control knobs.

Cockpit interior is Light Ghost Grey overall. The panels, the upper part of the cockpit area, the instrument panel cover and the canopy framing inside are painted Very Dark Grey with a brownish appearance rather than Black.

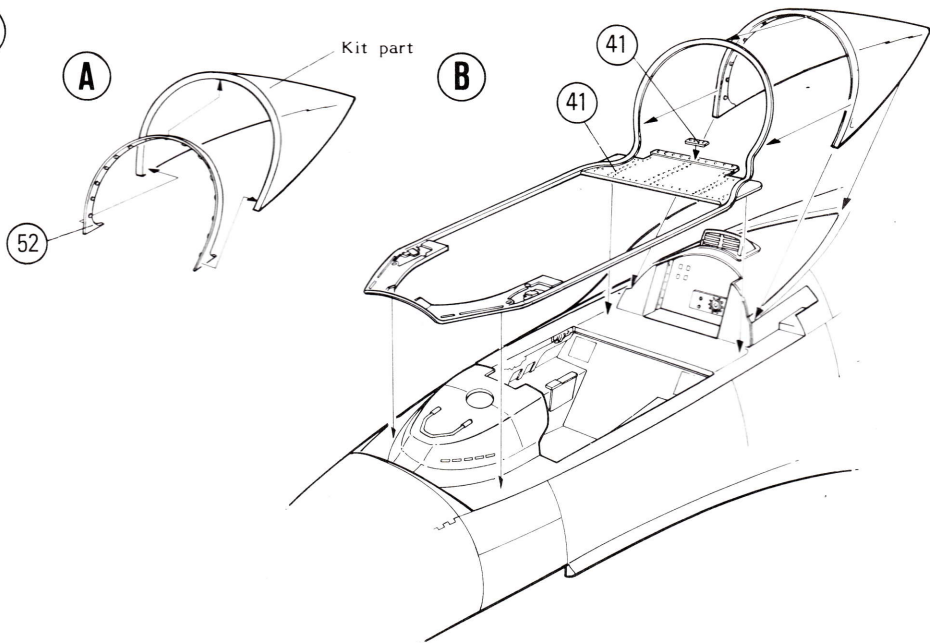
6

- 1/ Glue part 52 to the non-moving part of the canopy (see drawing A)
- 2/ Paint the frame Very Dark Grey inside before gluing it into place.
- 3/ Cut the aft strip of part 41 and glue in place as shown.

- 4/ Glue the aft part of the canopy in place as shown. Make sure it fits properly.
- 5/ Glue the canopy railing (part 41) in place. Note that the front part should be bended slightly upwards.

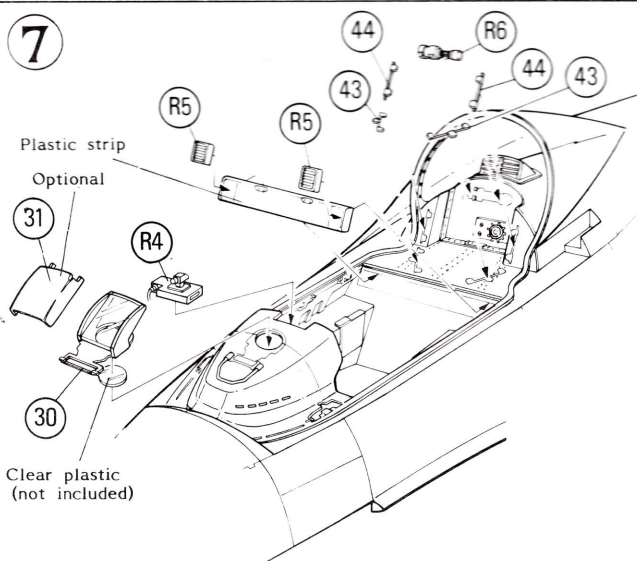
7

- 1/ Cut a piece of plastic strip (not included).
Length: 21mm
Height: 2,5mm
Width: 1mm
Break the edges with sandpaper.
- 2/ Glue parts R5 to this strip. Glue the strip in place as shown.
- 3/ Shape part 30, use part of the kit's HUD glass or cut one from clear plastic sheet (not included). The protective HUD cover (part 31) is optional and should be painted red.
- 4/ Glue part R4 in place.
- 5/ Glue part R6 into it's position on part 42.
- 6/ Glue parts 34 & 44 into place as indicated.

Clear plastic
(not included)

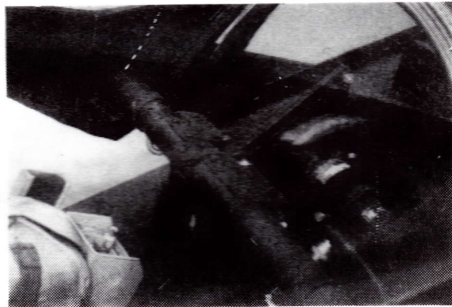
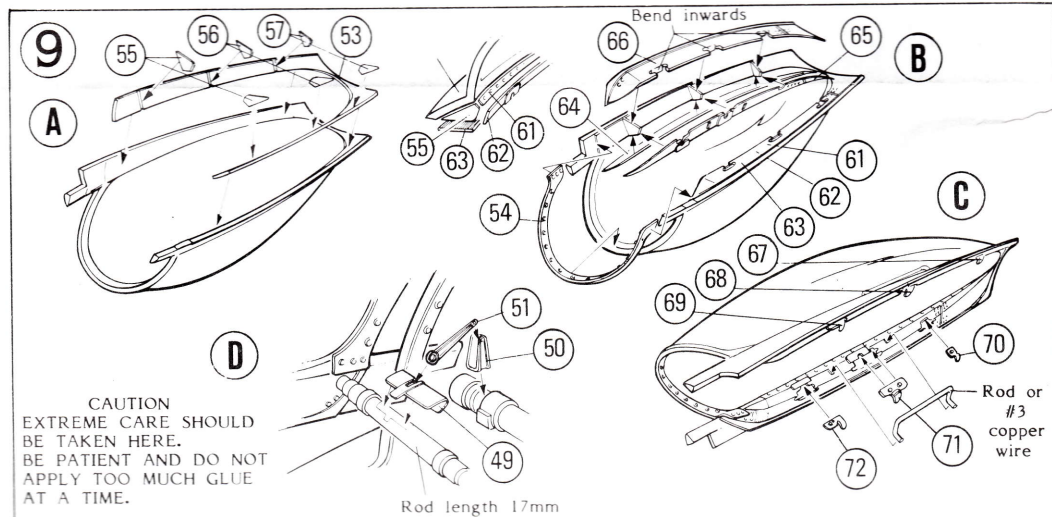
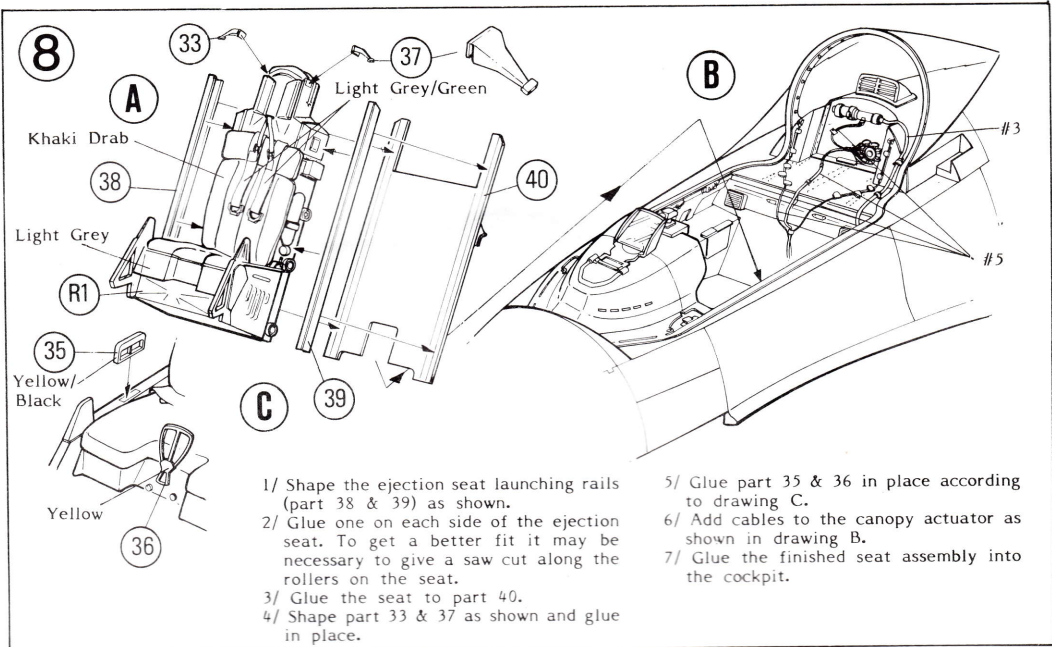

- 1/ Glue part 53 to the canopy.
- 2/ Glue parts 55, 56 & 57 to part 53 in the upright position.
- 3/ Glue parts 61 & 64 first. Start gluing from the front of the canopy and work towards the rear. Apply little glue at a time. Adjust and apply glue when the fit is correct.
- 4/ Glue parts 62 & 65 before finishing with 63 & 66. Be sure to bend the canopy lock housings inward first. The middle one may need a slit to go over part 56.
- 5/ Paint part 54 before gluing into place.
- 6/ Glue parts 67, 68, 69, 70, 71 & 72 in place.
- 7/ Make handholds from rod or #3 copper wire.
- 8/ Assemble the canopy raising mechanism as shown in drawing D.