

# LOCKHEED EC-121 WARNING STAR

in 1/144 SCALE

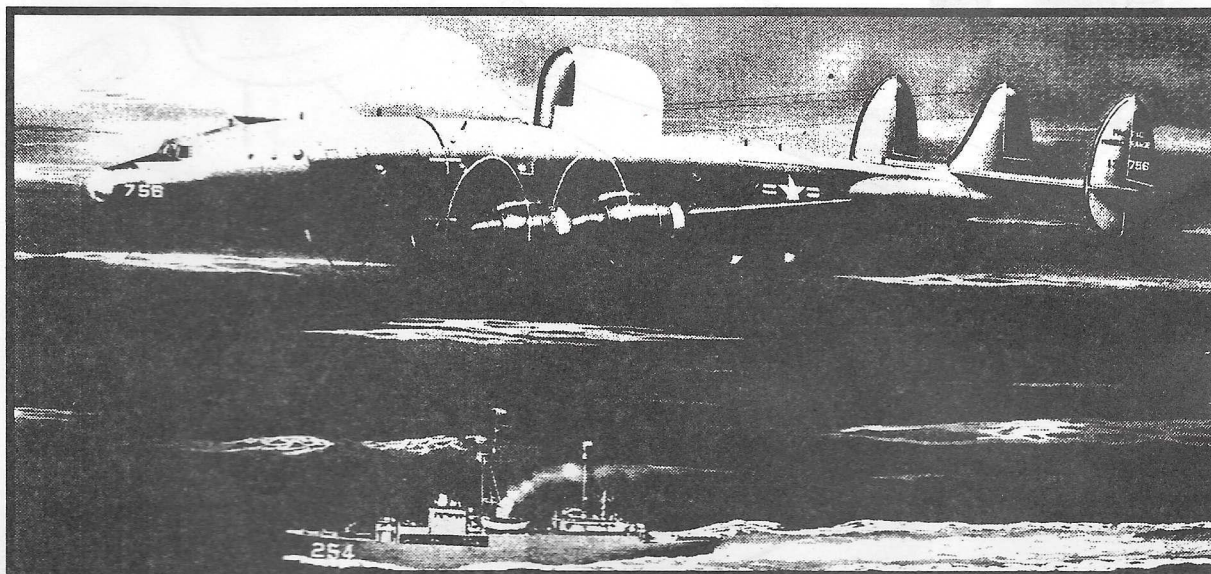

Lockheed's Constellation is one of the most distinctive airliners ever designed. Although designed originally as a luxury transport during the late '30's, it was drafted into the military as a cargo transport when the U.S. entered the war in 1941. The "Connie" was immensely successful in its original role following the Second World War, and several commercial variants were built, increasing the versatility of the graceful airliner.

As each of the new versions of the Constellation was developed, it also found a role in the military. In fact, more than half of all the new Super Constellations built were delivered to the military, and served for more than a quarter of a century before being retired. One of the most unique variants of these planes was the radar picket version, called "Warning Star". Originally designated WV-2, they were later re-classed as EC-121s. This version would be quickly identified by its enormous radar domes. These domes contained a complex array of sophisticated radar gear for locating and tracking ships and aircraft. Some aircraft also were outfitted for electronic countermeasure duties.

Warning Star #135756 carries markings from the Pacific Missile Range, at Point Mugu, California in 1961.

VW-13 flew Warning Stars from Newfoundland and Greenland in the early 1960's.

The EC-121 was powered by four 3,400 hp Wright R-3350 Turbo-Compound engines and had a maximum speed of 321 mph at 20,000 feet. Its range was 4,600 miles.



-  Cement  
Coller  
Kleben  
Pegar  
Incollare  
Colar  
Kleven
-  DO NOT Cement  
Ne pas Coller  
Nicht Kleben  
No Pegar  
Non Incollare  
Nao Colar  
Niet Kleven
-  Cut away  
Couper  
Scheiden  
Cortar  
Tagliare  
Cortar  
Snijden
-  Optional parts  
Choix  
Auswahlmöglichkeit  
Eleccion  
Scelta  
Opaco  
Keuze
-  **3**  
Repeat operation  
Répéter l'opération  
Vorgang wiederholen  
Repetir la operación  
Ripetere  
Repetir a operação  
Herhalen

# 1 FUSELAGE ASSEMBLY

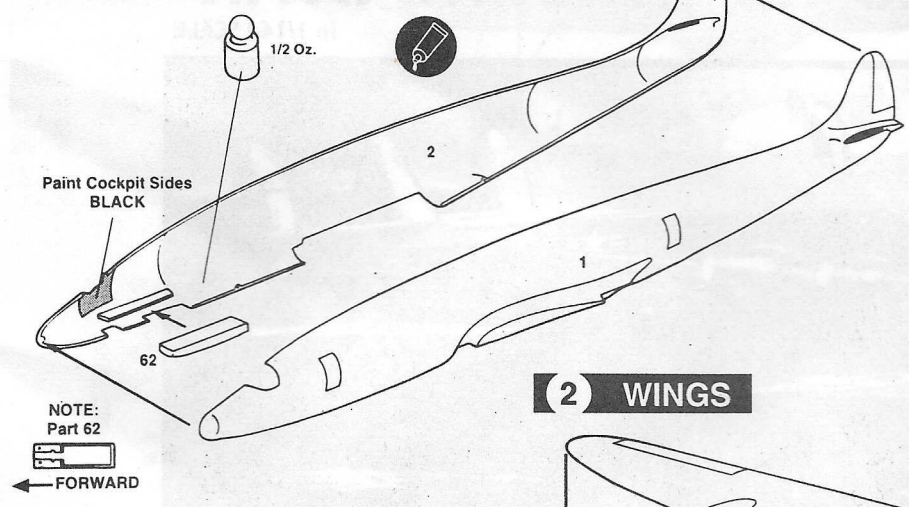

# 2 WINGS

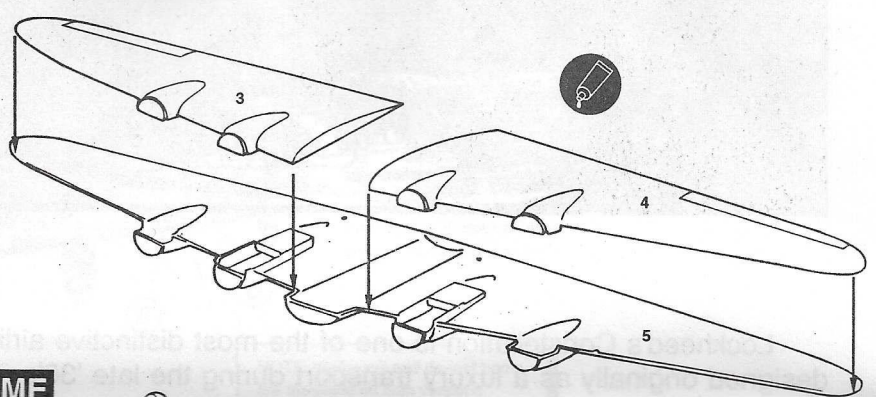

# 3 FUSELAGE / WINGS / RADOME

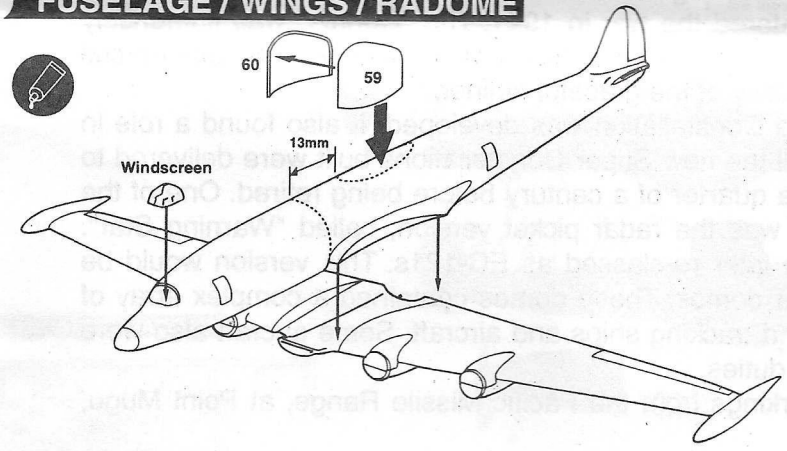

# 4 WING TIP TANKS / TAIL ASSEMBLY

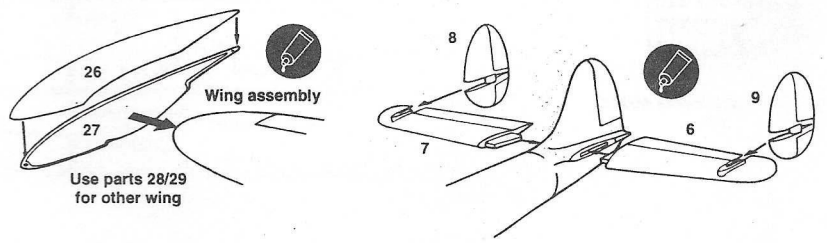



**5 UNDERFUSELAGE RADOME**

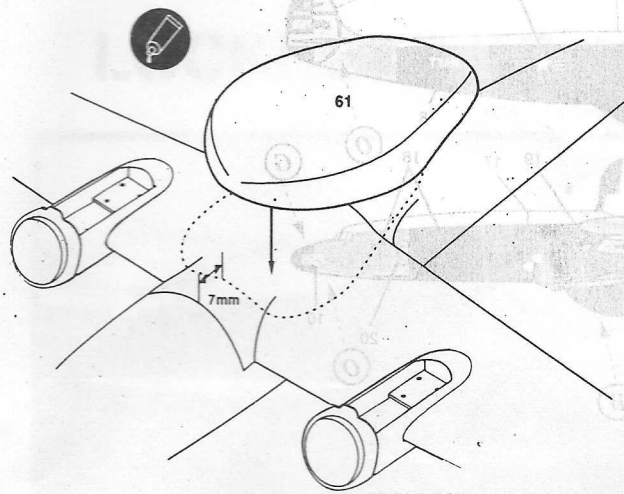

**6 NOSE GEAR**

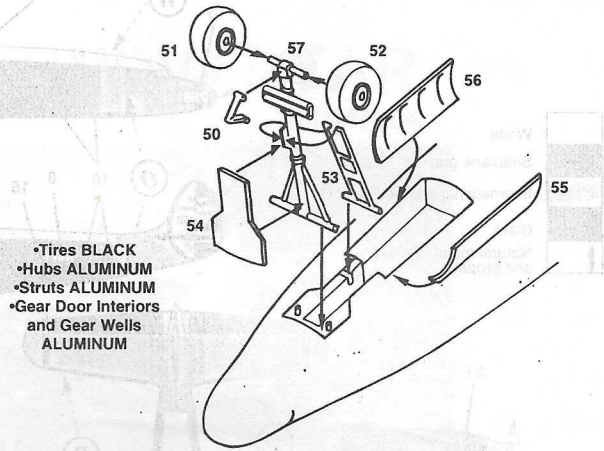

- Tires BLACK
- Hubs ALUMINUM
- Struts ALUMINUM
- Gear Door Interiors and Gear Wells ALUMINUM

**7 MAIN LANDING GEAR**

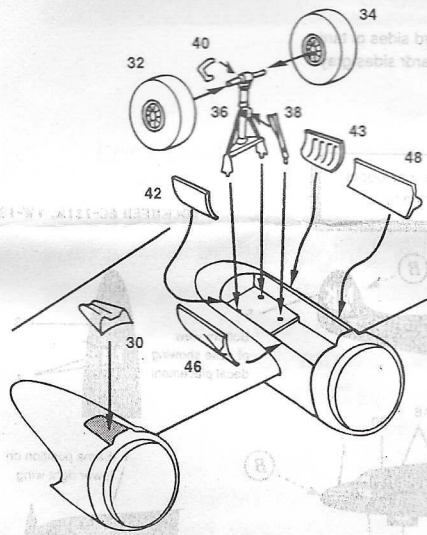

- Tires BLACK
- Hubs ALUMINUM
- Struts ALUMINUM
- Gear Door Interiors and Gear Wells ALUMINUM

Port (Left) Main Gear

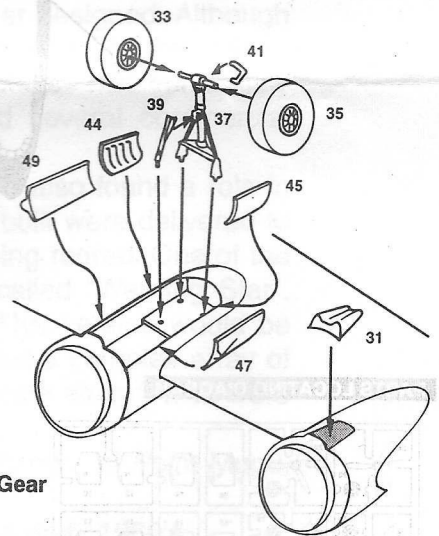

- Tires BLACK
- Hubs ALUMINUM
- Struts ALUMINUM
- Gear Door Interiors and Gear Wells ALUMINUM

Starboard (Right) Main Gear

**8 POWERPLANTS**

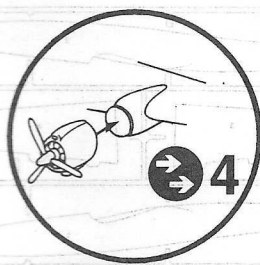
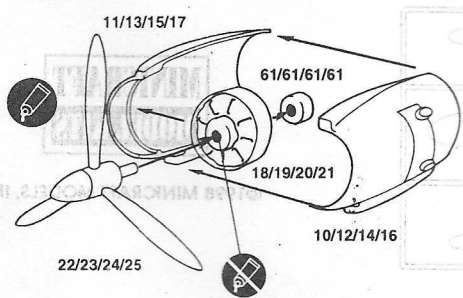

- Cylinders STEEL
- Gearbox GRAY
- Magnetos BLACK
- Cowling Interior ALUMINUM
- Propeller Hub ALUMINUM
- Propeller Blades FLAT BLACK



**LOCKHEED WV-2/EC-121 WARNING STAR**

**DECAL PLACEMENT AND PAINTING DIAGRAM**

- W** White
- G** Seaplane gray FS 36081
- O** International orange FS 12197
- B** Black
- Natural metal (Spinners and props)

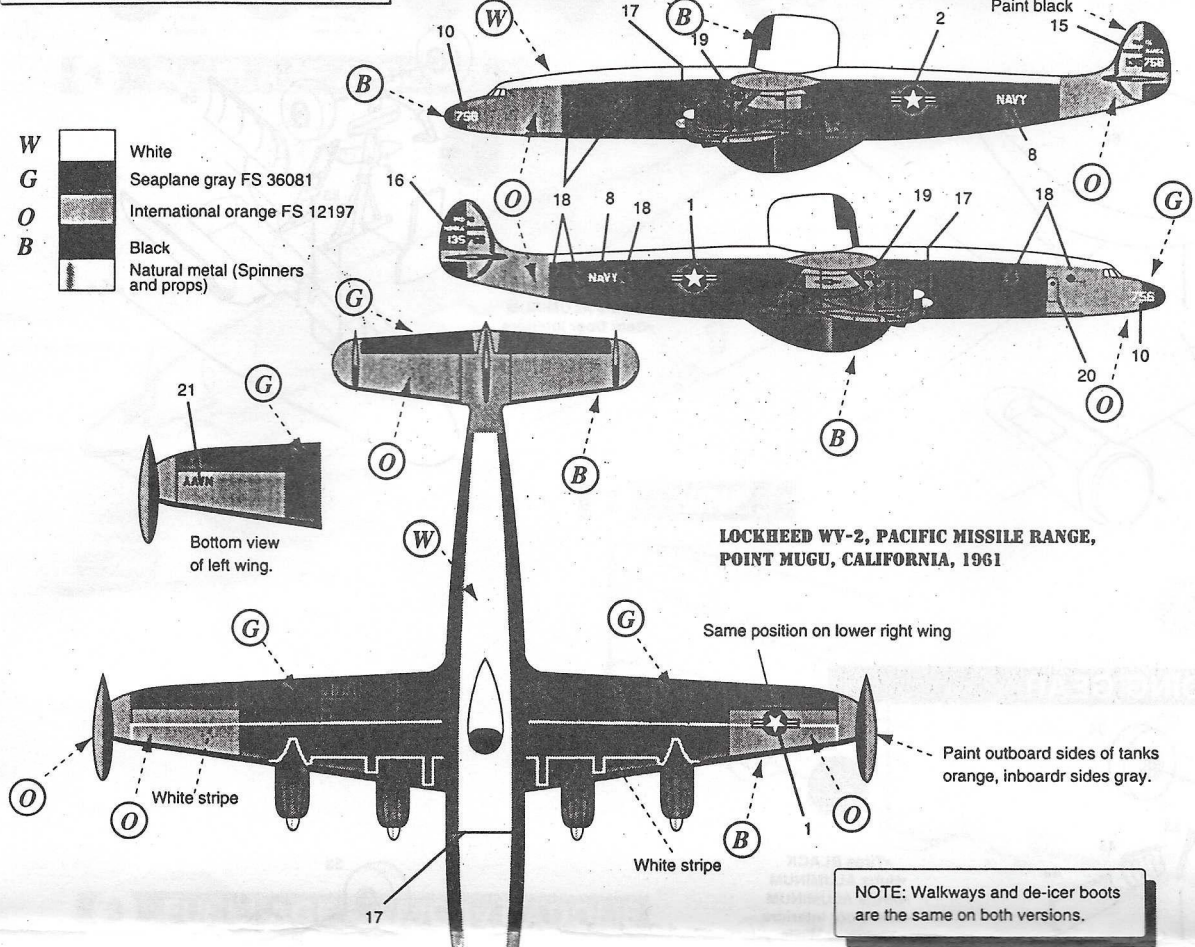

**LOCKHEED WV-2, PACIFIC MISSILE RANGE, POINT MUGU, CALIFORNIA, 1961**

LOCKHEED EC-121K, YV-13

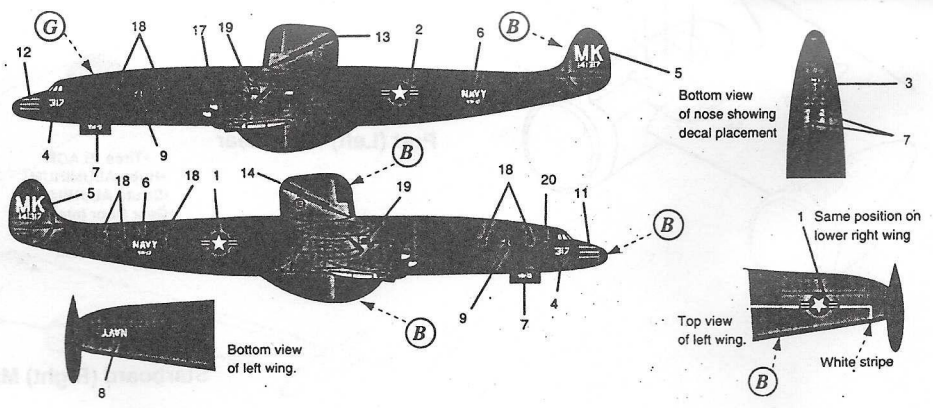

**PARTS LOCATING DIAGRAM**

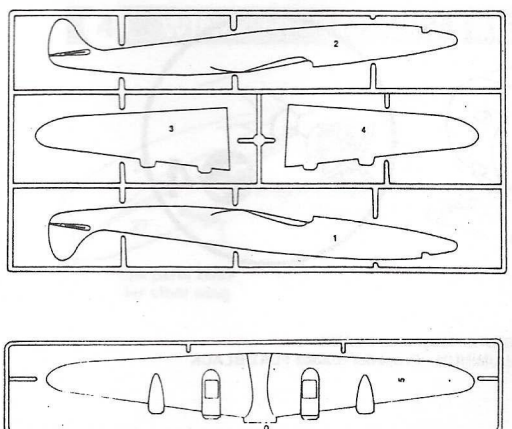
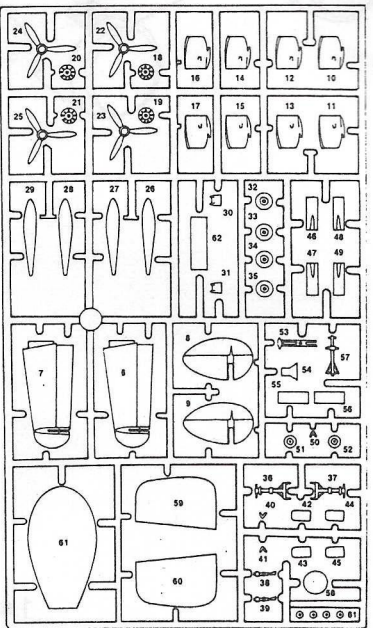

©1998 MINICRAFT MODELS, INC.