

WHITE ENSIGN MODELS

Short Sunderland Flying Boat

Photo Etched Parts for Detailing the Flight Deck Interior of the Airfix Kit in 1/72 scale

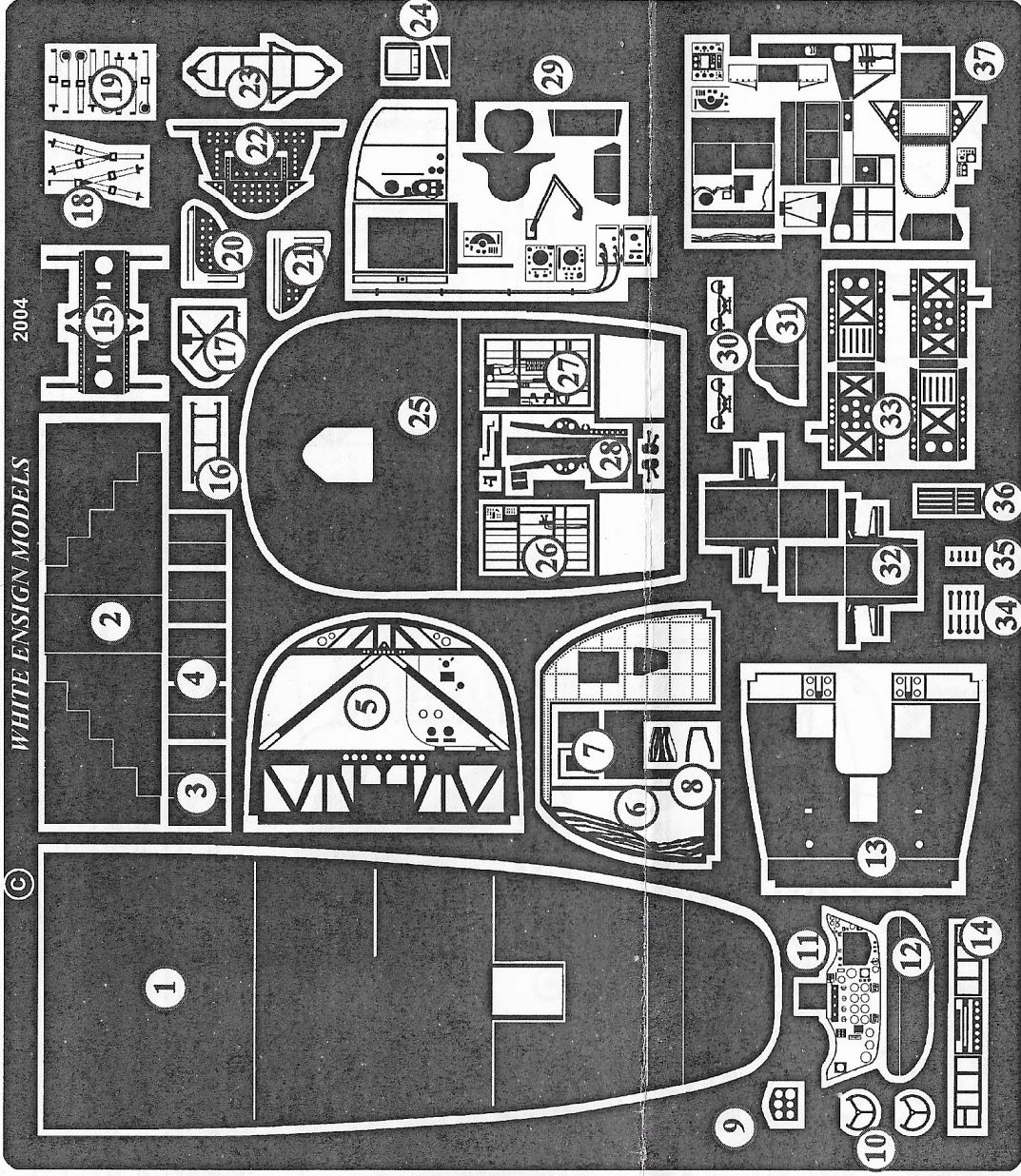

Photo Etched Parts General Instructions

1. Do not remove the etched parts from the fret until you are ready to use them.
2. Before assembly, soak the etched parts in a suitable solvent, such as white spirit, to de-grease the surfaces for painting.
3. Cyanoacrylate adhesive (Super glue) or contact adhesive such as Elmers white glue may be used. These can be applied with a pin or piece of stretched sprue.
4. When removing parts from the fret, place the fret on a hard surface, such as a smooth ceramic tile, in order to prevent parts bending whilst cutting through the holding tabs. It is suggested that a #11 type of modelling knife blade is used for this purpose.
5. When shaping or bending a part, a straight edged blade such as a chisel blade #17 or #18 will give a good sharp corner, or alternatively a small pair of smooth jawed pliers may be used.
6. If a part is bent incorrectly, lay it on a hard flat surface and roll it flat with a cylindrical object such as a modelling knife handle.

Parts List

- | | |
|-----------------------------|---------------------------------------|
| 1. Main Floor | 20. Mooring Foot Plate (Stbd) |
| 2. Stair Well | 21. Mooring Foot Plate (Port) |
| 3. Lower Steps | 22. Bomb Aimers Floor Plate |
| 4. Upper Steps | 23. Mooring Ladder |
| 5. Main Spar Bulkhead | 24. Bomb Aimers Window |
| 6. Central Bulkhead | 25. Rear Cabin Bulkhead |
| 7. Map Pocket | 26. Cockpit Stbd Side Frame |
| 8. Pistol Holster | 27. Cockpit Port Side Frame |
| 9. Flight Instruments | 28. Roof Console Assembly |
| 10. Control Wheels | 29. Navigators Position Parts |
| 11. Instrument Panel | 30. Rudder Pedals |
| 12. Sun Shield | 31. Throttle Quadrant Box |
| 13. Cockpit Floor Riser | 32. Pilots Seats |
| 14. Stair Well Extension | 33. Pilots Seat Support Frames |
| 15. Pilots Seat Attachments | 34. Throttle Control Levers |
| 16. Rear Cabin Ladder | 35. Pitch Control Levers |
| 17. Rear Cabin Hatch | 36. Throttle Quadrant Guides |
| 18. Shoulder Straps | 37. Wireless Operators Position Parts |
| 19. Lap Straps | |

PREPARATION WORK

Before fitting any of the photo etched parts in to the kit, some minor preparation work to the main fuselage halves is required. First, remove the cockpit floor retaining lugs from the ends of the cockpit floor support. Then extend the cockpit floor support, using 1mm (40 thou) square plastic strip, towards the rear of the cabin area, stopping just before the bomb door openings. Do this to both fuselage halves.

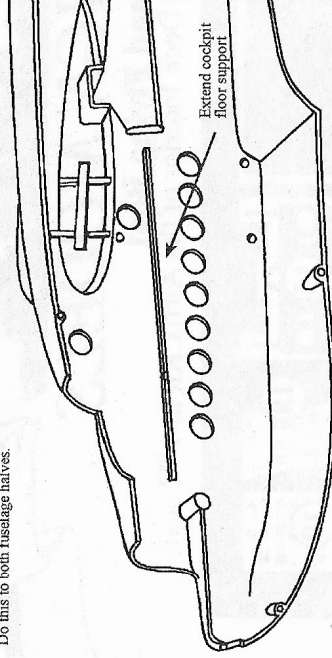

MAIN DECK & BULKHEAD LOCATIONS

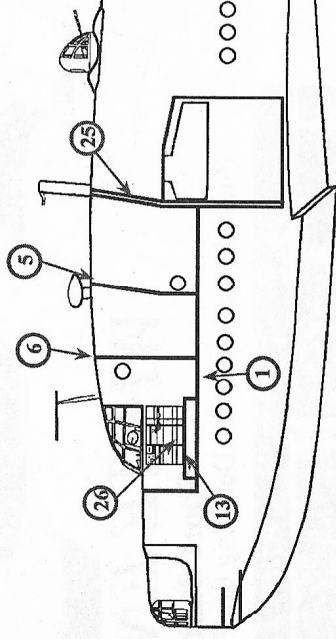

Using these diagrams, note the locations and shapes that the main component parts take in relation to the fuselage. It is advisable to fit the cockpit side panel 26 to the starboard fuselage half at this stage.

MAIN DECK & BULKHEAD LOCATIONS

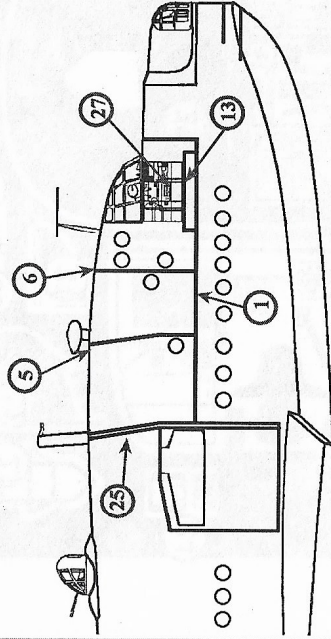

Fit the cockpit side panel 27 to the port side fuselage half after fitting the main floor sections, but before adding the pilots controls and instrument.

COCKPIT FLOOR RISER ASSEMBLY

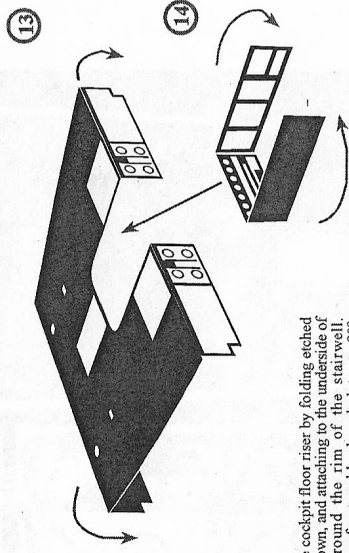

Assemble the cockpit floor riser by folding etched part 14 as shown, and attaching to the underside of the floor around the rim of the stairwell. Fold down the front and back end plates to 90°.

MAIN DECK AND BULKHEAD ASSEMBLY

Assemble the main bulkheads to the cockpit deck, using the etched lines as location slots. Fold up the forward bulkhead to 90°.

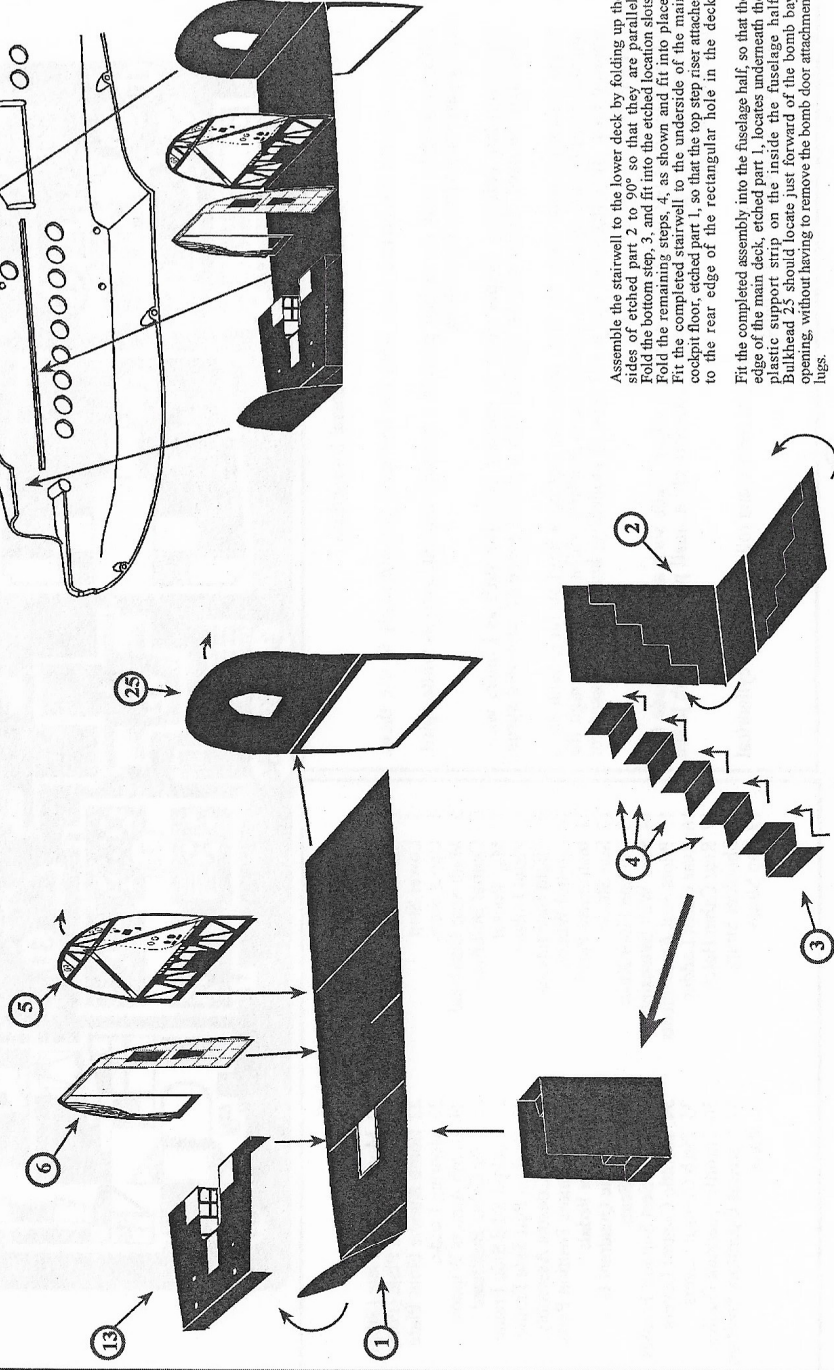

Assemble the stairwell to the lower deck by folding up the sides of etched part 2, to 90° so that they are parallel. Fold the bottom step, 3, and fit into the etched location slots. Fold the remaining steps, 4, as shown and fit into place. Fit the completed stairwell to the underside of the main cockpit floor, etched part 1, so that the top step riser attaches to the rear edge of the rectangular hole in the deck. Fit the completed assembly into the fuselage half, so that the edge of the main deck, etched part 1, locates underneath the plastic support strip on the inside of the fuselage half. Bulkhead 25 should locate just forward of the bomb bay opening, without having to remove the bomb door attachment lugs.

PILOTS INSTRUMENTS & CONTROLS ASSEMBLY

Assemble the instrument panel as shown below using a piece of .5mm (20thou) plasticard, painted black, as a backing. Shape etched part 12 to form the instrument panel combing and attach to the top of the completed panel using the etched line to locate.

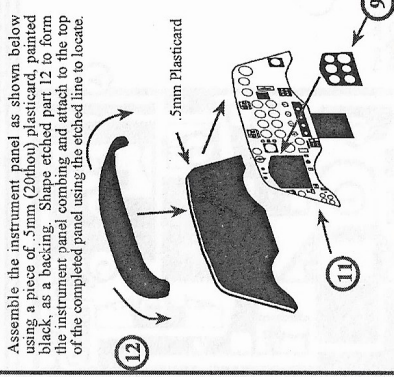

To assemble the control columns, remove the wheel part of kit parts 57 & 58 and replace with etched parts 10 as shown left.

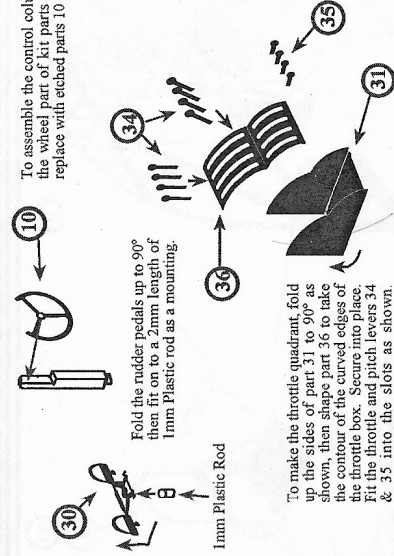

Assemble the completed control components to the deck of the cockpit floor riser as shown above.

ROOF CONSOLE ASSEMBLY

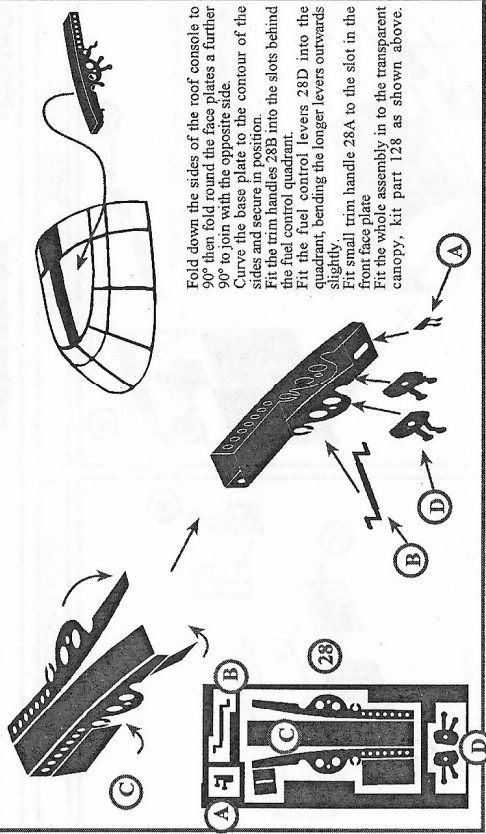

Fold down the sides of the roof console to 90° then fold round the face plate a further 90° to finish with the opposite side. Cut the base plate to the contour of the sides and trim handle. Fit the trim handle 28E into the slots behind the fuel control quadrant. Fit the fuel control levers 28D into the quadrant, bending the longer levers outwards slightly. Fit small trim handle 28A to the slot in the front face plate. Fit the whole assembly in to the transparent canopy, kit part 128 as shown above.

PILOTS SEATS ASSEMBLY

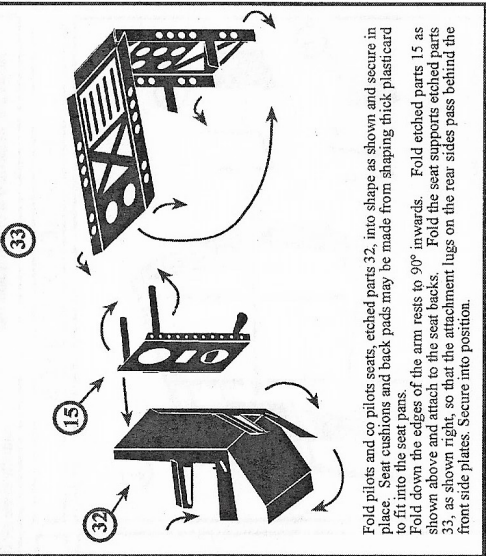

Fold pilots and co pilots seats, etched parts 32, into shape as shown, and secure in place. Seat cushions and back pads may be made from shaping thick plasticard into the seat pads. Fold down the edges of the arm rests to 90° inwards. Fold etched parts 15 as shown above and attach on to the seat backs. Fold the seat supports etched parts 33, as shown in right, so that the attachment lugs on the rear sides pass behind the front side plates. Secure into position.

PILOTS SEATS FITTINGS

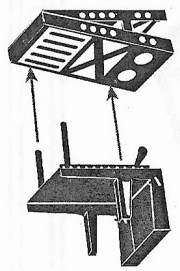

Fit the shoulder harnesses, 18, by folding and securing over the centre of the seat. Fit the ends of the lap straps, 19 into the slots provided in the seat pan.

Fit the completed seat assemblies to the etched recess on the cockpit floor riser, etched part 13, on either side of the stair well opening.

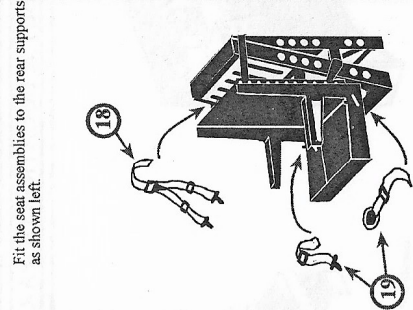

Fit the seat assemblies to the rear supports as shown left.

NAVIGATORS SEAT ASSEMBLY

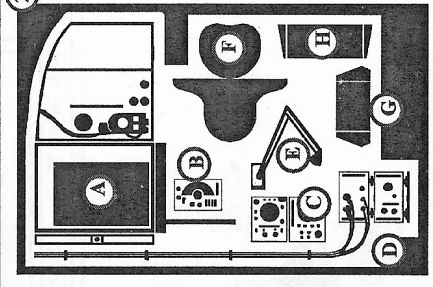

Assemble the navigators seat by folding the backrest up to 90° and shaping it around the seat. A seat cushion may be made by shaping to piece of thick (1.5mm) plasticard to fit.

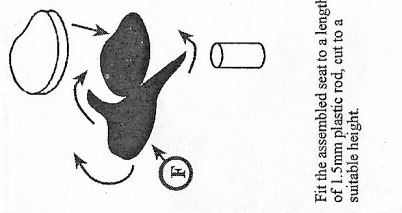

Fit the assembled seat to a length of 1.5mm plastic rod, cut to a suitable height.

NAVIGATORS INSTRUMENTS

Instrument boxes may be made by cutting blocks of 2 or 3 mm thick plasticard to the dimensions of the instrument faces to which they are attached.

Using this method make up the navigators instrument boxes from etched parts B and C as shown, then mount them on the shelves G and H.

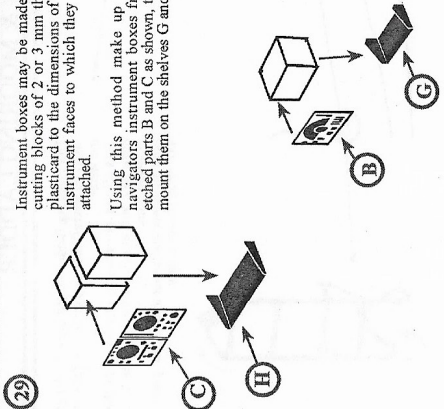

NAVIGATORS POSITION LOCATION OF PARTS

29 Fold the navigators table, etched part 29A, in to the shape shown below. Make up the sensor boxes using face panels D. These boxes fit under the table with the cable loom passing up to and securing behind the half bulkhead.

Fold the anglepoise lamp base to 90° and fit to the inside of the cabin wall.

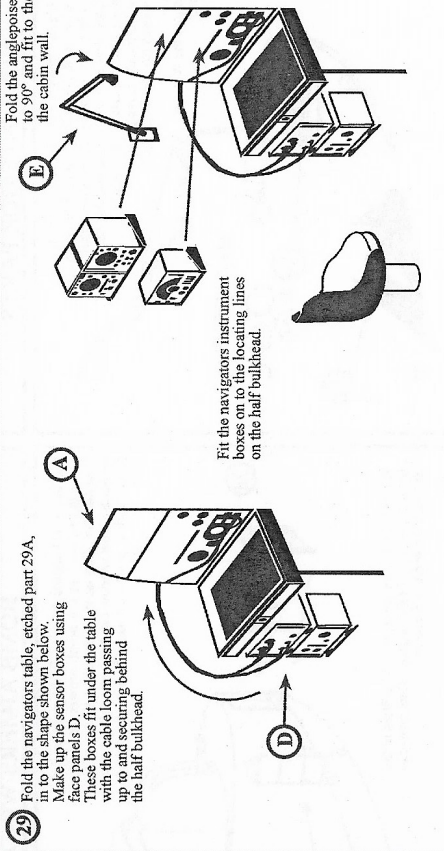

Fit the navigators instrument boxes on to the locating lines on the half bulkhead.

NAVIGATORS POSITION AND WIRELESS OPERATORS SEAT LOCATION

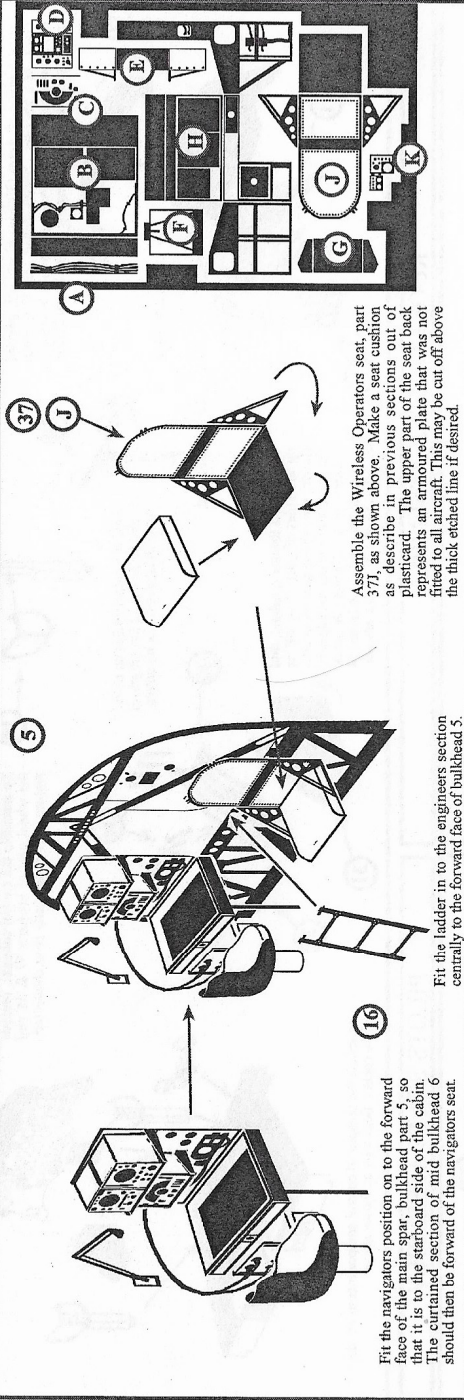

Fit the navigators position on to the forward face of the main spar, bulkhead part 5, so that it is to the starboard side of the cabin. The curtained section of mid bulkhead 6 should then be forward of the navigators seat.

Assemble the Wireless Operators seat, part 37I, as shown above. Make a seat cushion as describe in previous sections out of plasticard. The upper part of the seat back represents an armoured plate that was not fitted to all aircraft. This may be cut off above the thick etched line if desired.

Fit the ladder in to the engineers section centrally to the forward face of bulkhead 5.

BULKHEAD FITTINGS

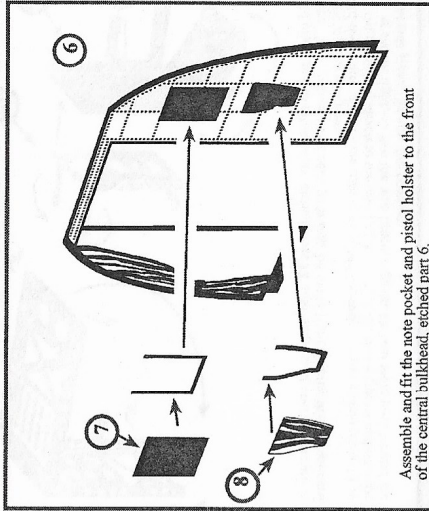

Assemble and fit the note pocket and pistol holster to the front of the central bulkhead, etched part 6.

WOS DESK ASSEMBLY

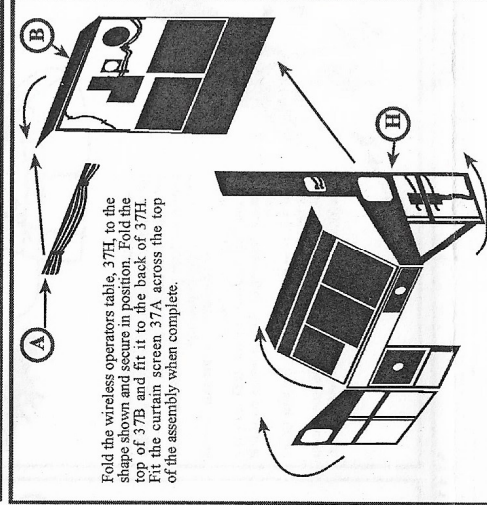

Fold the wireless operators table, 37H, to the shape shown and secure in position. Fold the top of 37B and fit it to the back of 37H. Fit the curtain screen 37A across the top of the assembly when complete.

WOS INSTRUMENTS

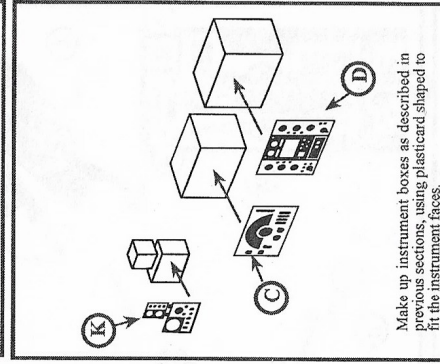

Make up instrument boxes as described in previous sections, using plasticard shaped to fit the instrument faces.

WIRELESS OPERATORS POSITION ASSEMBLY & LOCATION OF PARTS

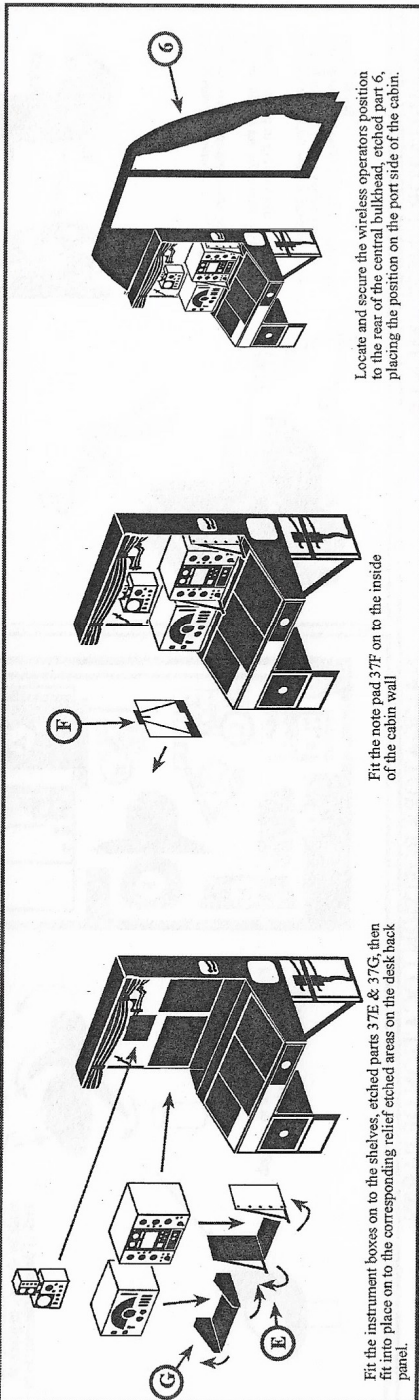

Fit the instrument boxes on to the shelves, etched parts 37E & 37G, then fit into place on to the corresponding relief etched areas on the desk back panel.

Locate and secure the wireless operators position to the rear of the central bulkhead, etched part 6, placing the position on the port side of the cabin.

NOSE INTERIOR PARTS

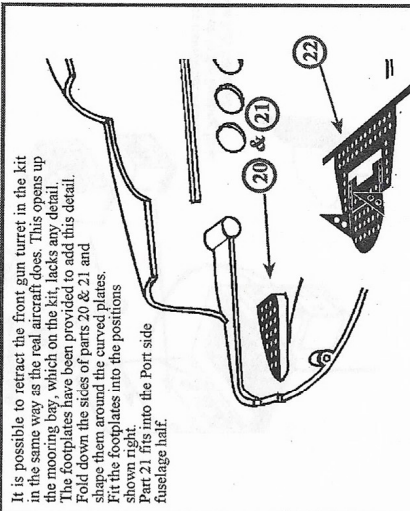

It is possible to retract the front gun turret in the kit in the same way as the real aircraft does. This opens up the mooring bay, which on the kit, lacks any detail. The floorplates have been provided to add this detail. Fold down the sides of parts 20 & 21 and shape them around the curved plates. Fit the footplates into the positions. Part 21 fits into the Port side fuselage half.

BOMB AIMERS WINDOW & MOORING LADDER

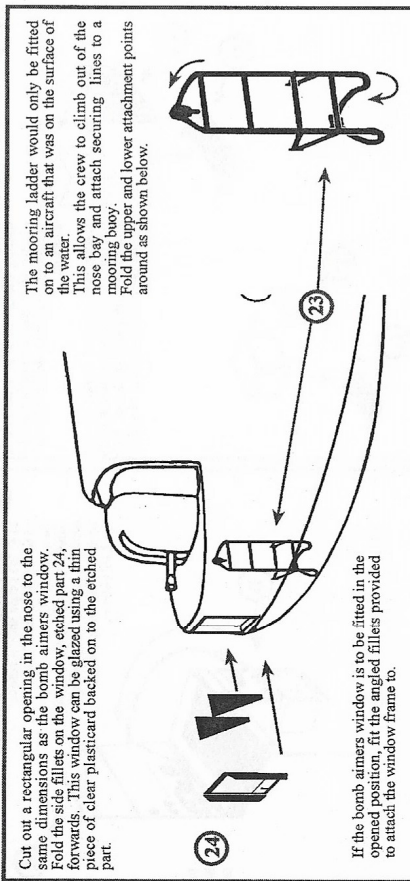

Cut out a rectangular opening in the nose to the same dimensions as the bomb aimers window. Fold the side fillers on the window, etched part 24, forwards. This window can be glazed using a thin piece of clear plasticard backed on to the etched part.

The mooring ladder would only be fitted on to an aircraft that was on the surface of the water. This allows the crew to climb out of the nose bay and attach securing lines to a mooring buoy. Fold the upper and lower attachment points around as shown below.

If the bomb aimers window is to be fitted in the opened position, fit the angled fillers provided to attach the window frame to.