

NÁVOD / INSTRUCTION SH48075 IMAM (Romeo) Ro-57bis

1/48

CZ - Historie

Počátkem roku 1939 vzlétl prototyp letounu Ro.57 zkonstruovaný firmou Industrie Meccaniche e Aeronautiche Meridionali (I.M.A.M.). Veřejnosti byl poprvé představen v květnu 1939 během mezinárodního kongresu pořádaného pro letecké žurnalisty. Dvumotorový záhytný stíhací letoun, poháněný motory Fiat A 74 R.C.38, byl smíšené konstrukce s kovovým potahem trupu a překližkovým potahem křídla. Letoun byl však hodnocen jako velmi zranitelný v roli záhytného stíhače, takže došlo k přehodnocení konstrukce a letoun byl upraven pro operační nasazení v roli stíhacího-bombardovacího letounu. Takto upravená konstrukce byla označena jako Ro.57bis. Původně bylo objednáno 200 sériových kusů, toto množství však bylo sníženo na 90 kusů, celkově však bylo později vyrobeno pouze 60 kusů. Letouny byly operačně nasazeny v rámci 97° Gruppo v únoru 1943.

Technické údaje: Rozpětí 12.50 m, Délka 8.80 m, Výška 2.90 m, Max. rychlost 500 km/h, Dolet 1200 km

Výzbroj: dva kulometry ráže 12.7 mm_ v přídi trupu, jedna puma o váze 500 kg pod trupem a dvě 250 kg pumy podkřídly.

EN - History

Early in 1939, the prototype Ro.57 designed by the Industrie Meccaniche e Aeronautiche Meridionali (I.M.A.M.) took to the air. It was first displayed in public in May at an international congress of aviation journalists. The twin-engined interceptor was powered by two Fiat A 74 R.C.38 engines and was of mixed construction, with a metal-skinned metal fuselage and plywood-covered wooden wings. After a re-appraisal of the Ro.57's role, it was considered that it would be too vulnerable against single-engined fighters and was re-designated as a fighter-bomber. The re-roled aircraft was known as the Ro.57bis. Although 200 aircraft were originally ordered, this was reduced to 90 and eventually only 60 were produced. It entered into service with the 97° Gruppo in February 1943.

Technical specifications: Wingspan 41ft 0in (12.50 m), Length 28ft 10in (8.80 m), Height 9ft 6in (2.90 m), Max. speed 311 mph (500 km/h), Range 746 miles (1200 km)

Armament: Two 12.7 mm machine guns in the nose and one 500 kg bomb under the fuselage and two 250 kg bombs under the wings.

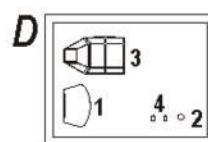
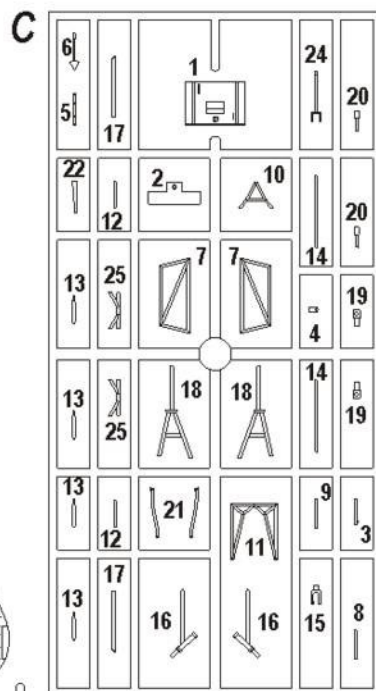
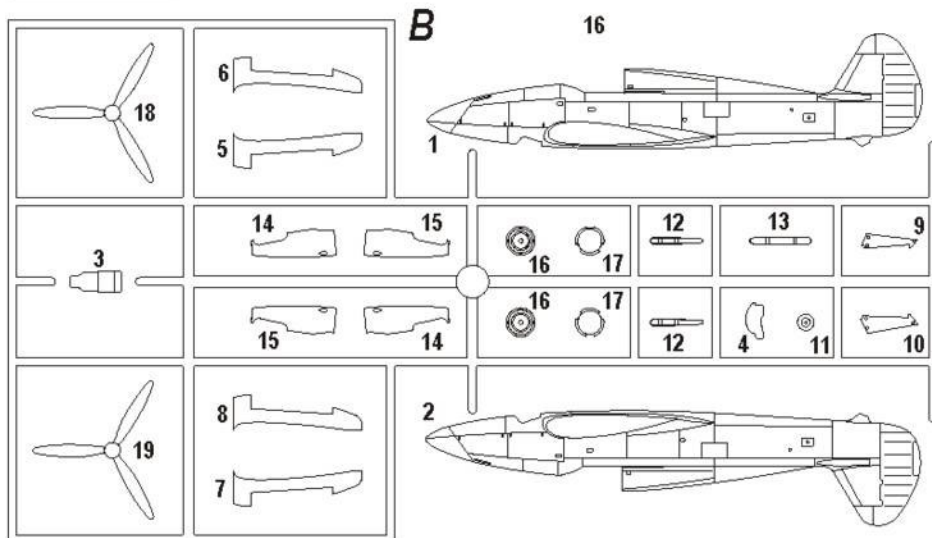
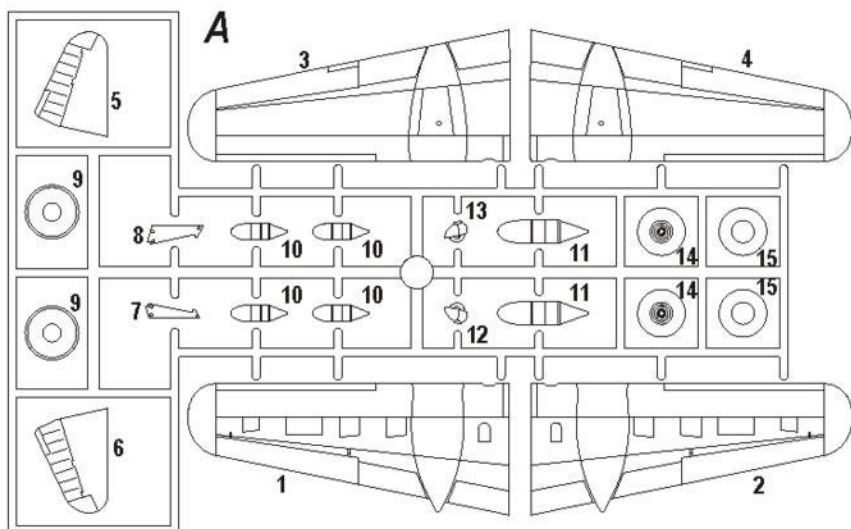

POLYURETHAN PARTS (E)

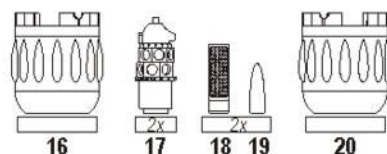
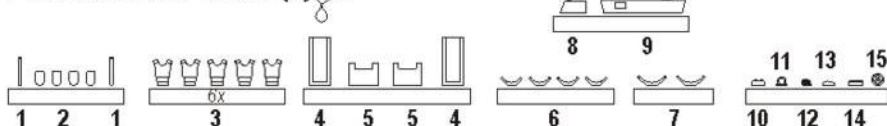

FILM PARTS (FP)

PHOTOETCHED PARTS (PP)

H2 / C2	Gloss Black / Lesklá černá	
H8 / C8	Silver / Stříbrná	
H21 / C69	Off White / Špinavá bílá	
H27 / C44	Tan / Plátno	
H28 / C78	Metal Black / Kovová černá	
H67 / C115	Grigio Azzuro Chiaro / Nebeská šedá	
H76 / C61	Burnt Iron / Opálený kov	
H77 / C137	Tire Black / Černá na pneumatiky	
H302 / C302	Verde Oliva Scuro 2 / Tmavá zelená	
H312 / C312	Primer / Základová barva	
H329 / C329	Yellow / Žlutá	
H338 / C338	Light Grey / Světlá šedá	



Možnost volby
Optional
Nach belieben
Option

Oddělit
Cut with knife
Mit Messer schneiden
Couper au couteau

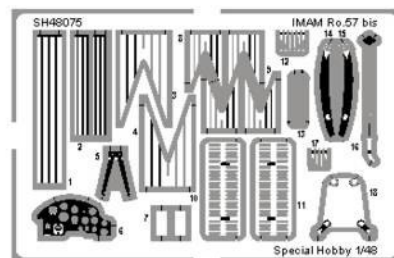

Ohnout
Bend
Biegen
Courber

Lepidlo na kov
Glue for metal
Metallkleber
Colle a metal

1

2

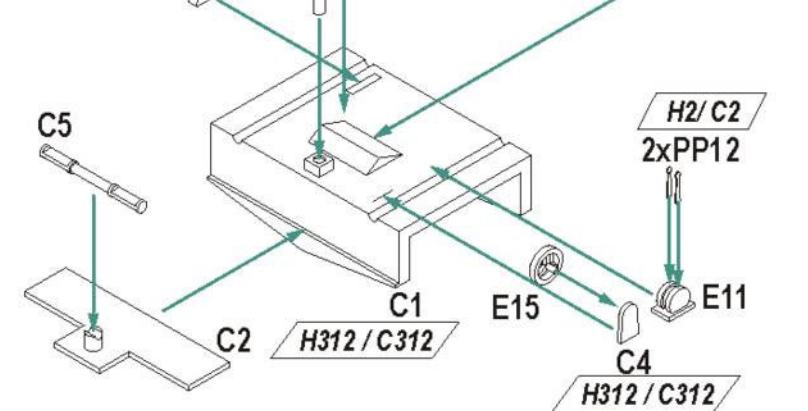
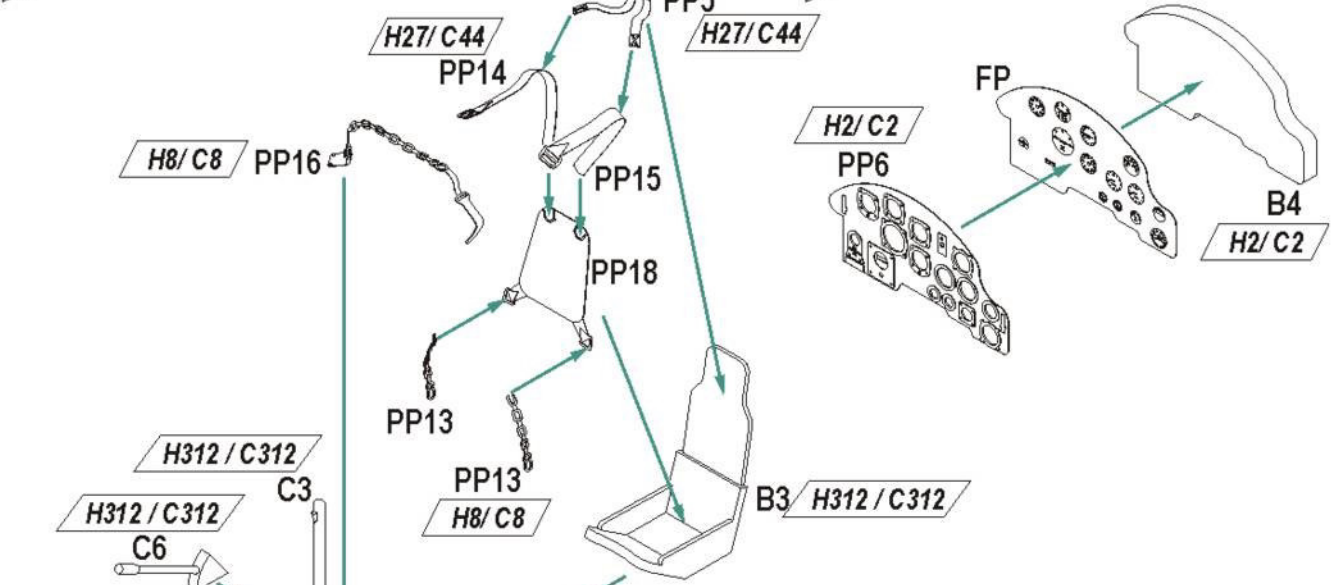

4 Make 2 sets

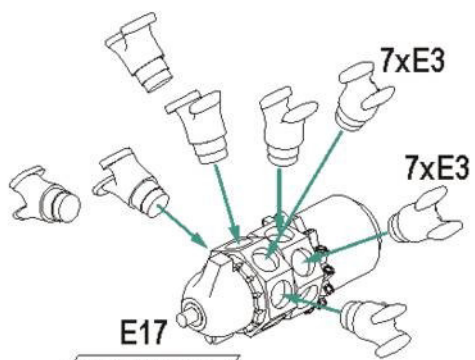

3

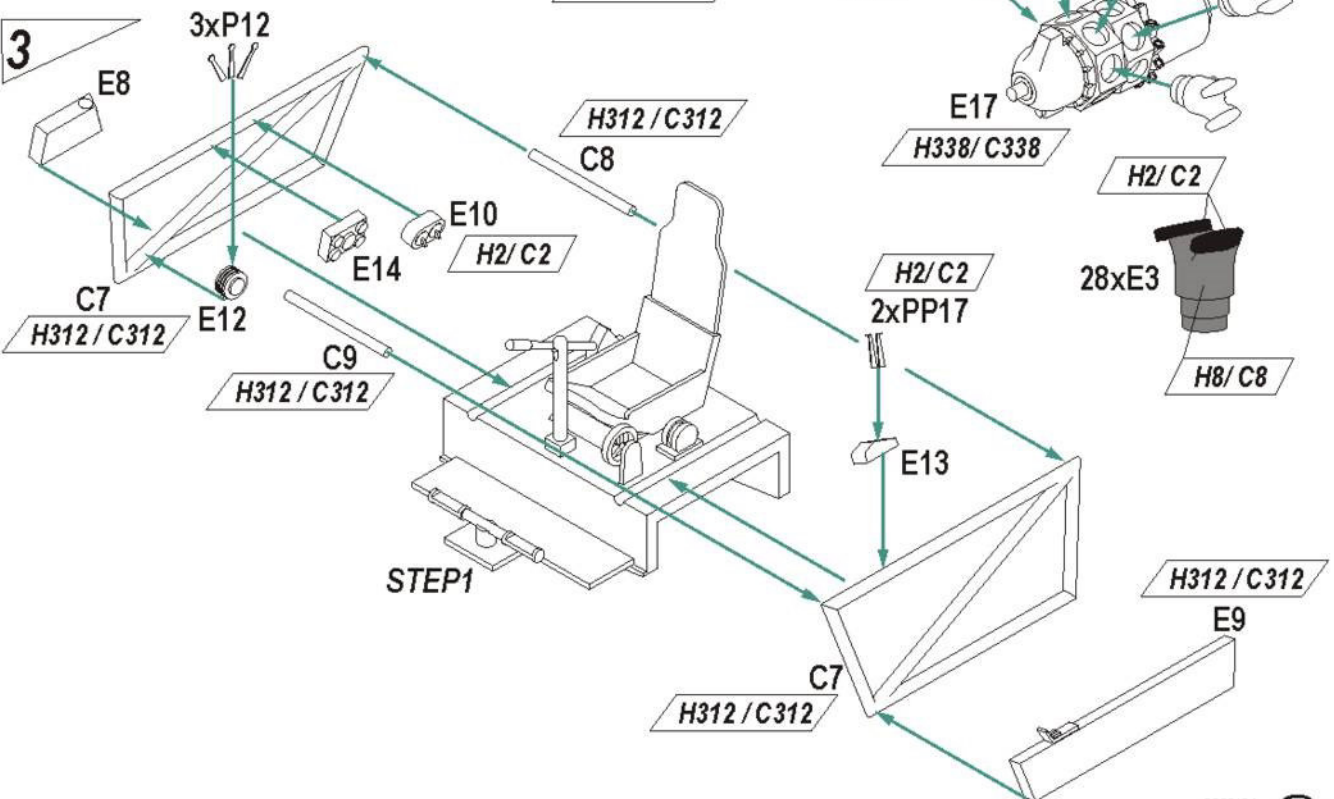

STEP1

2009/04

SH48075 IMAN Ro-57bis

3

5

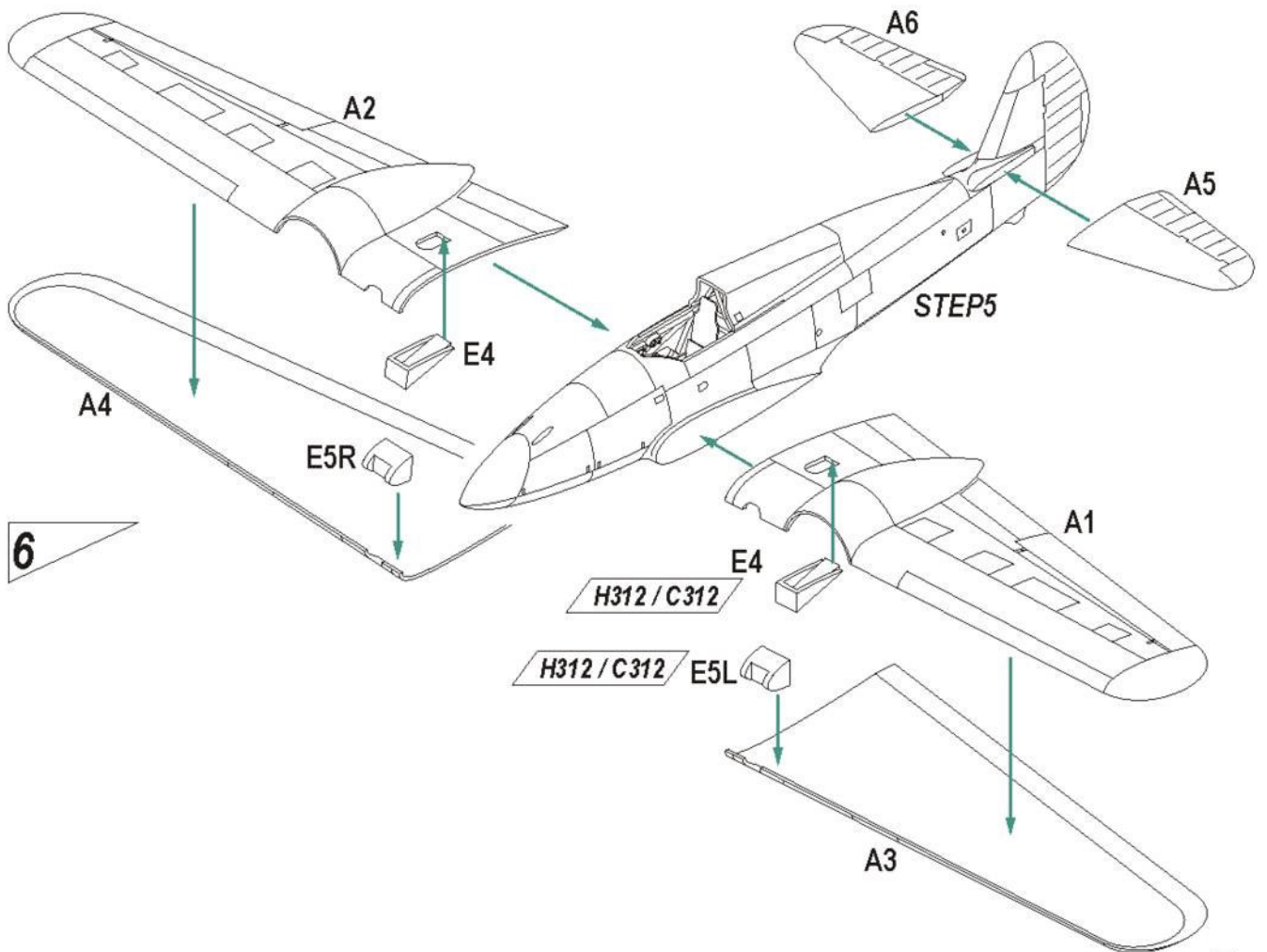
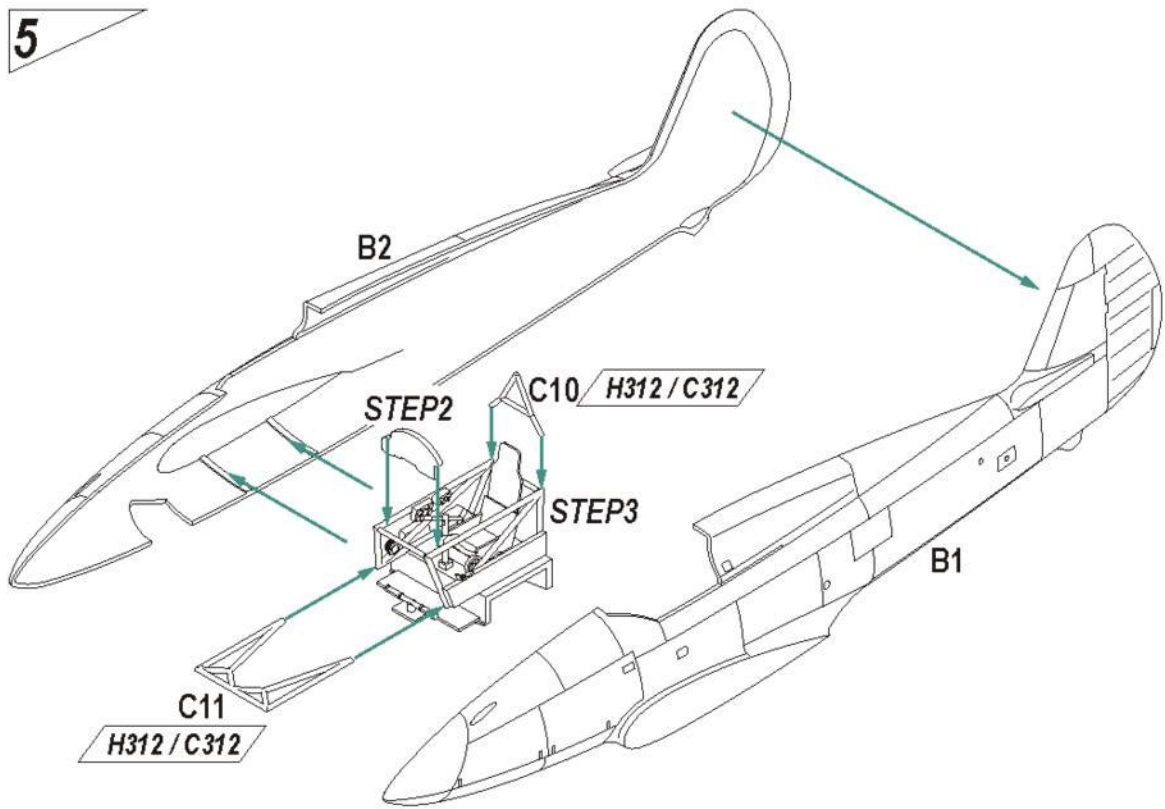

6

2009/04

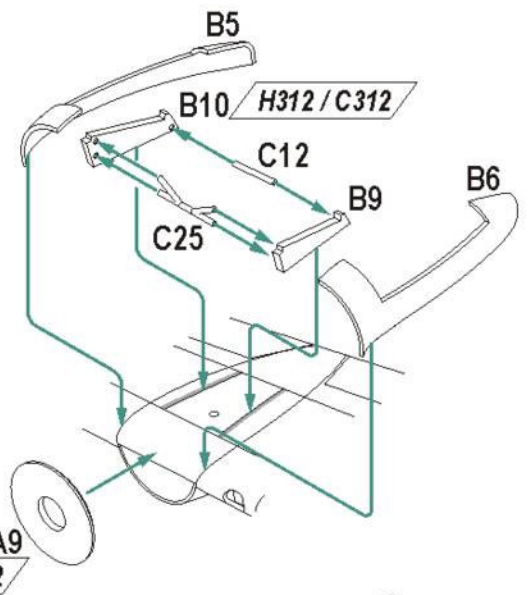
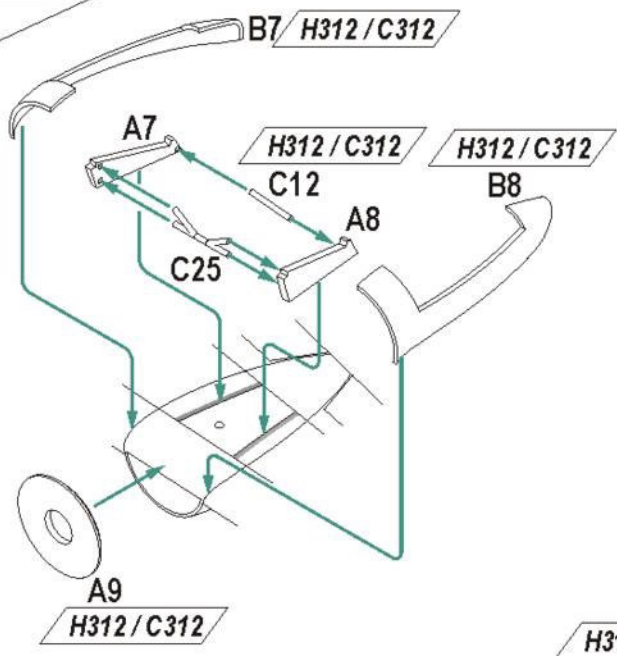
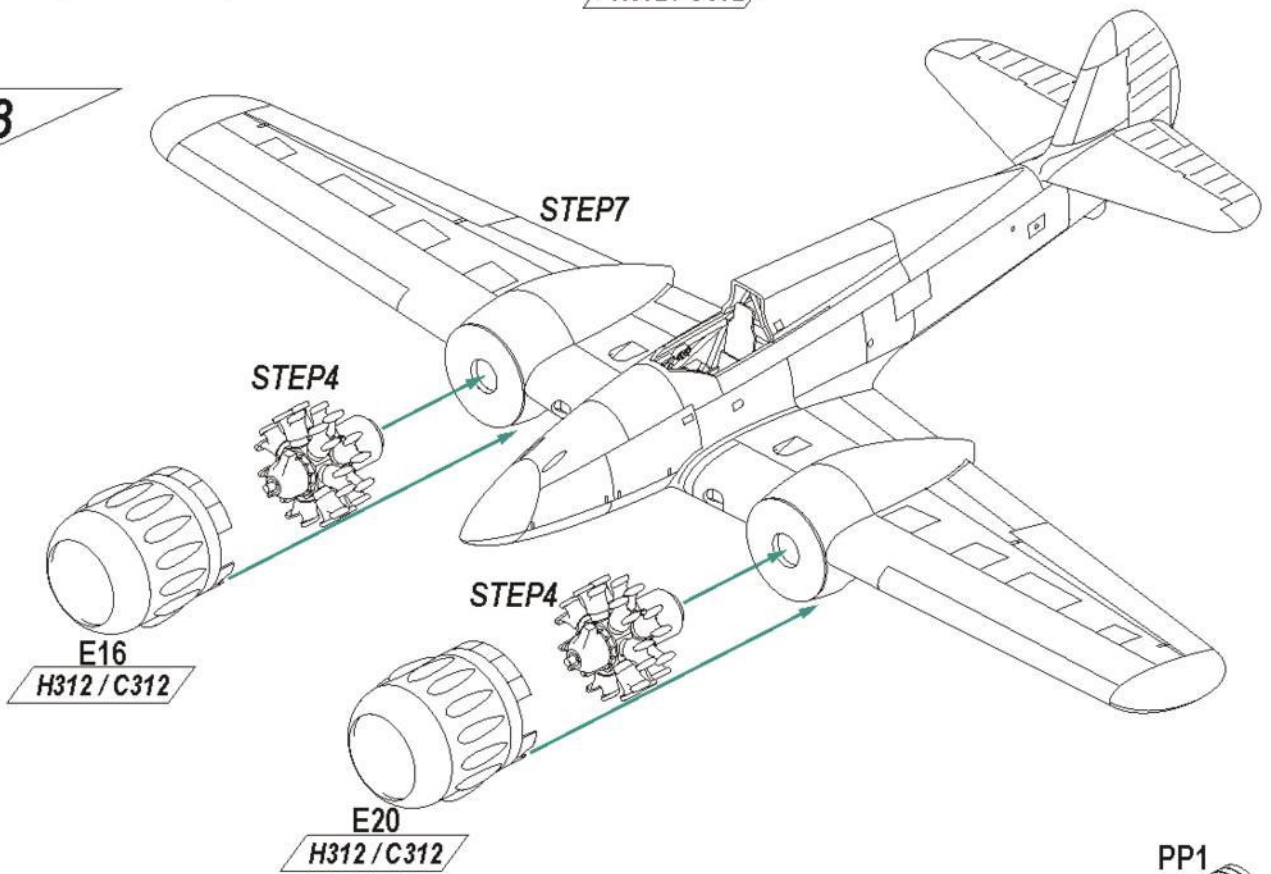
7**8****9**

Make 2 sets

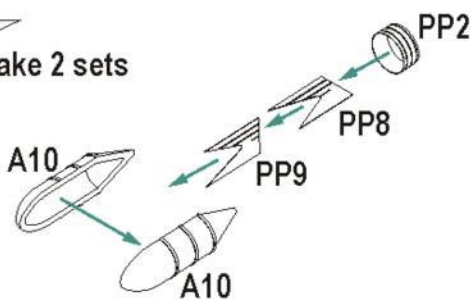
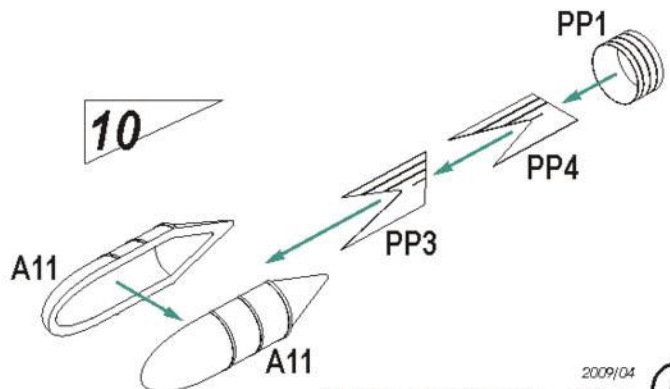
**10**

11

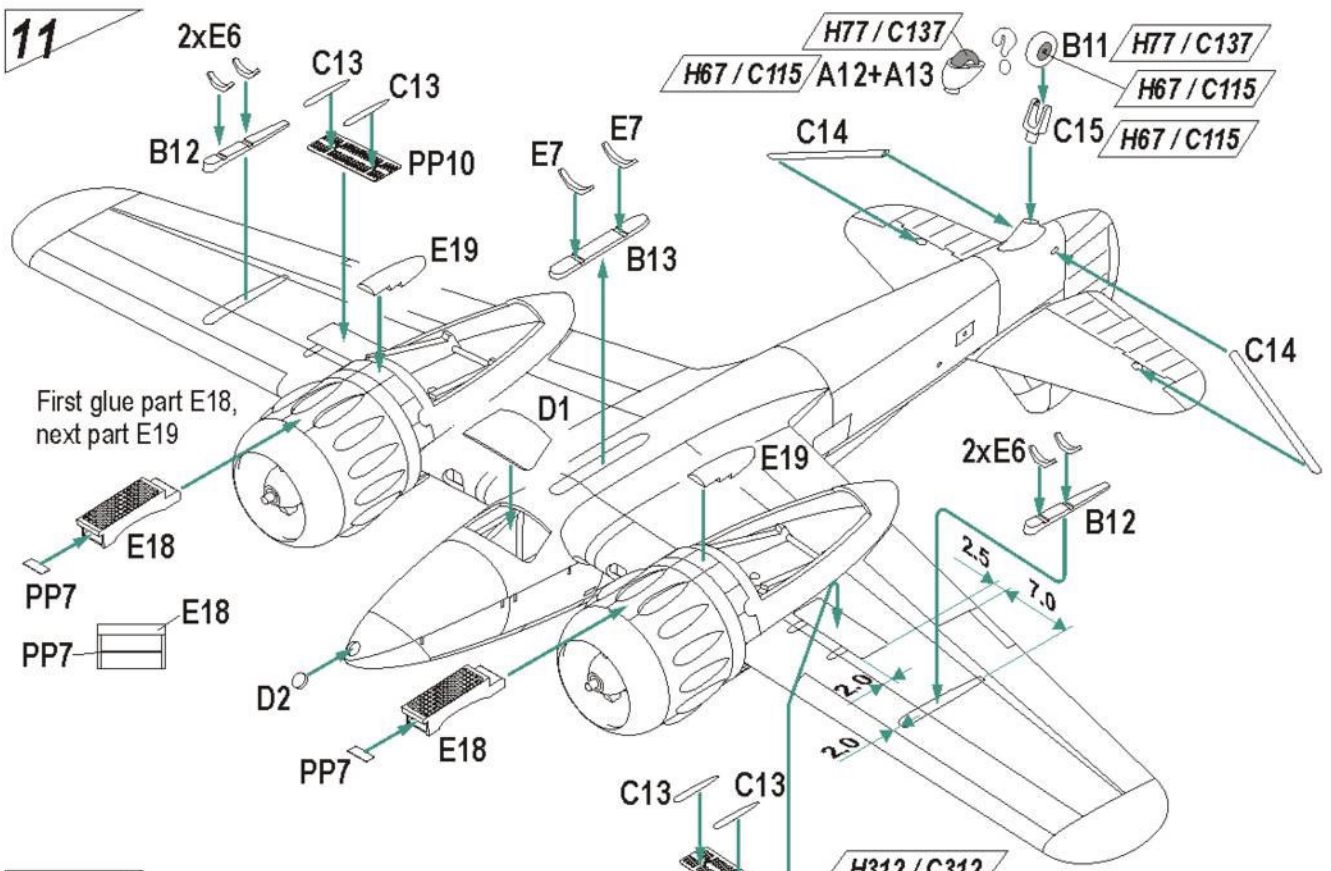

12

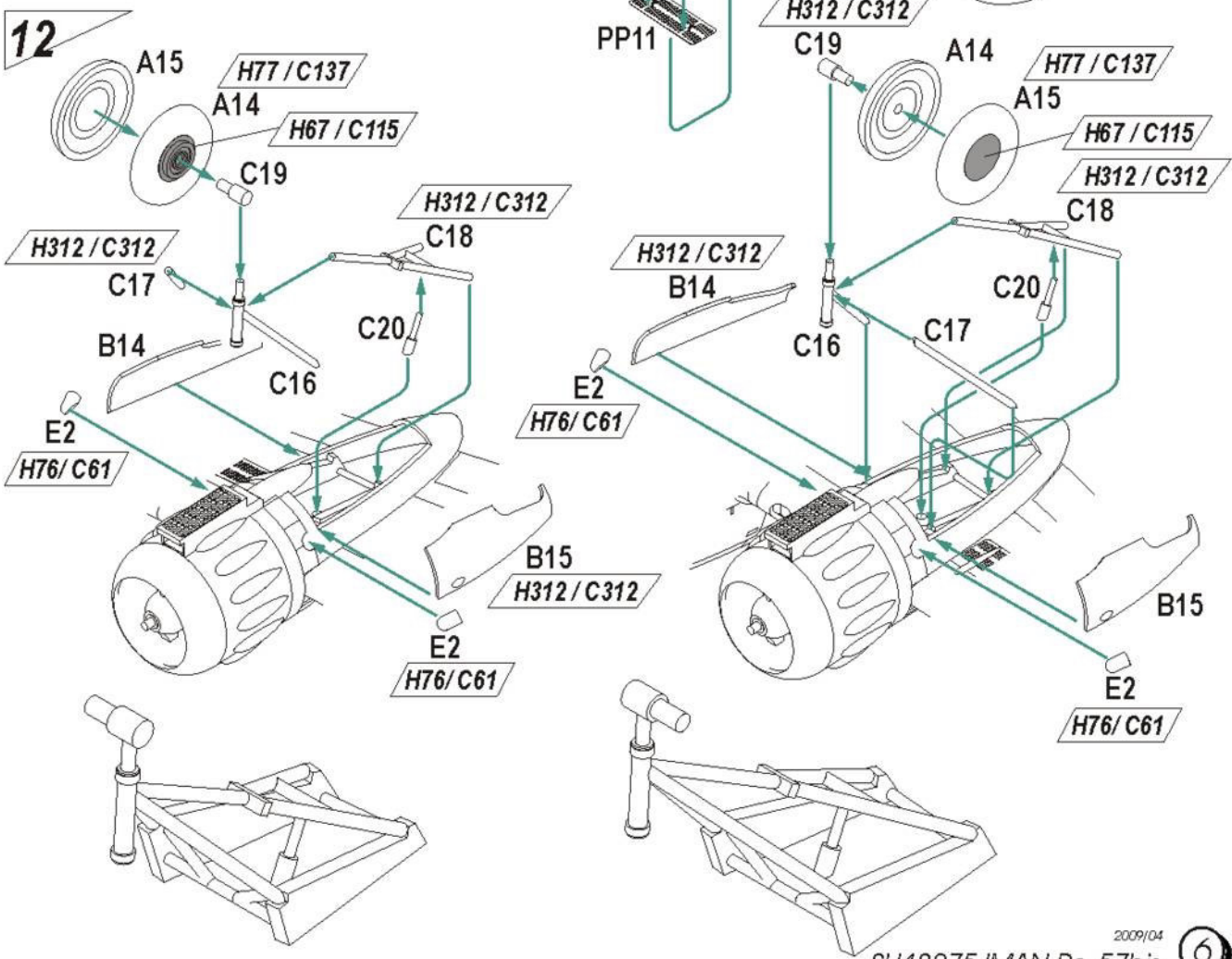

13

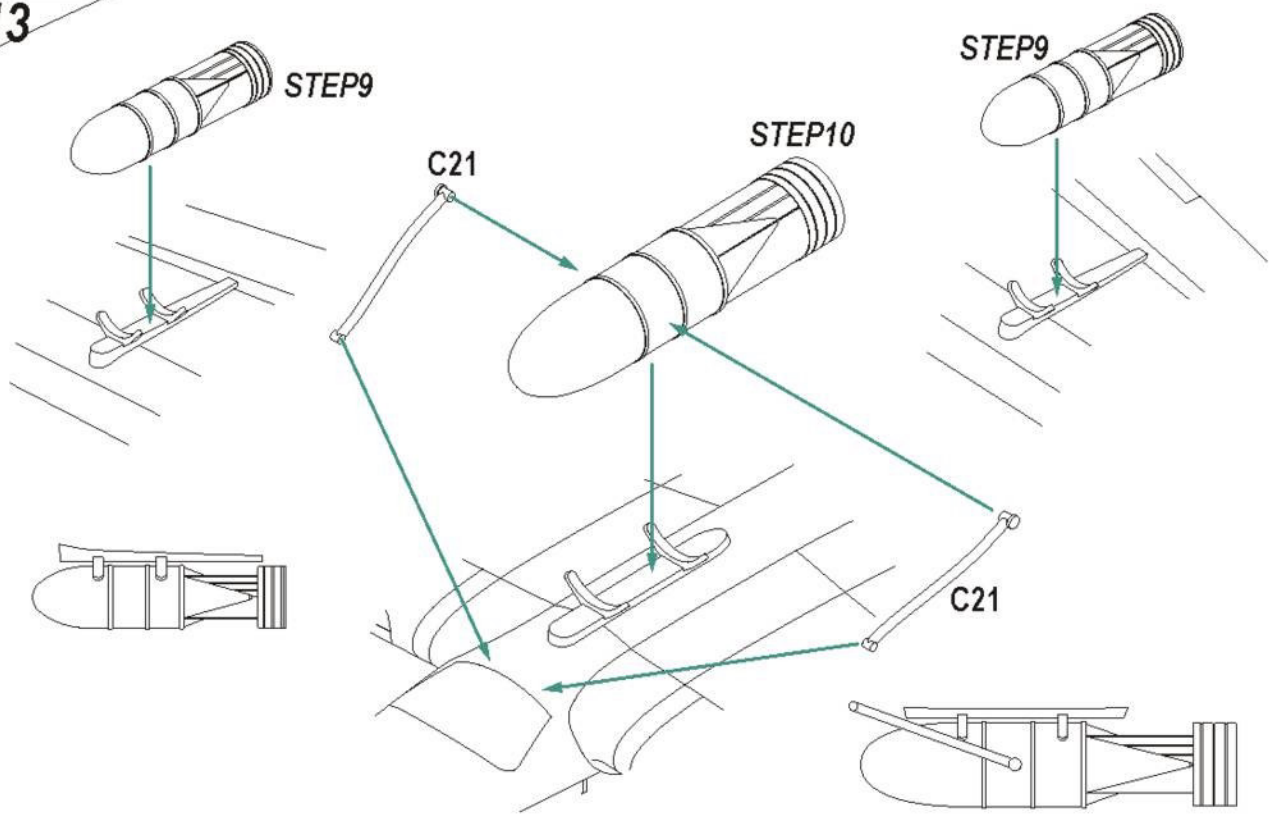

14

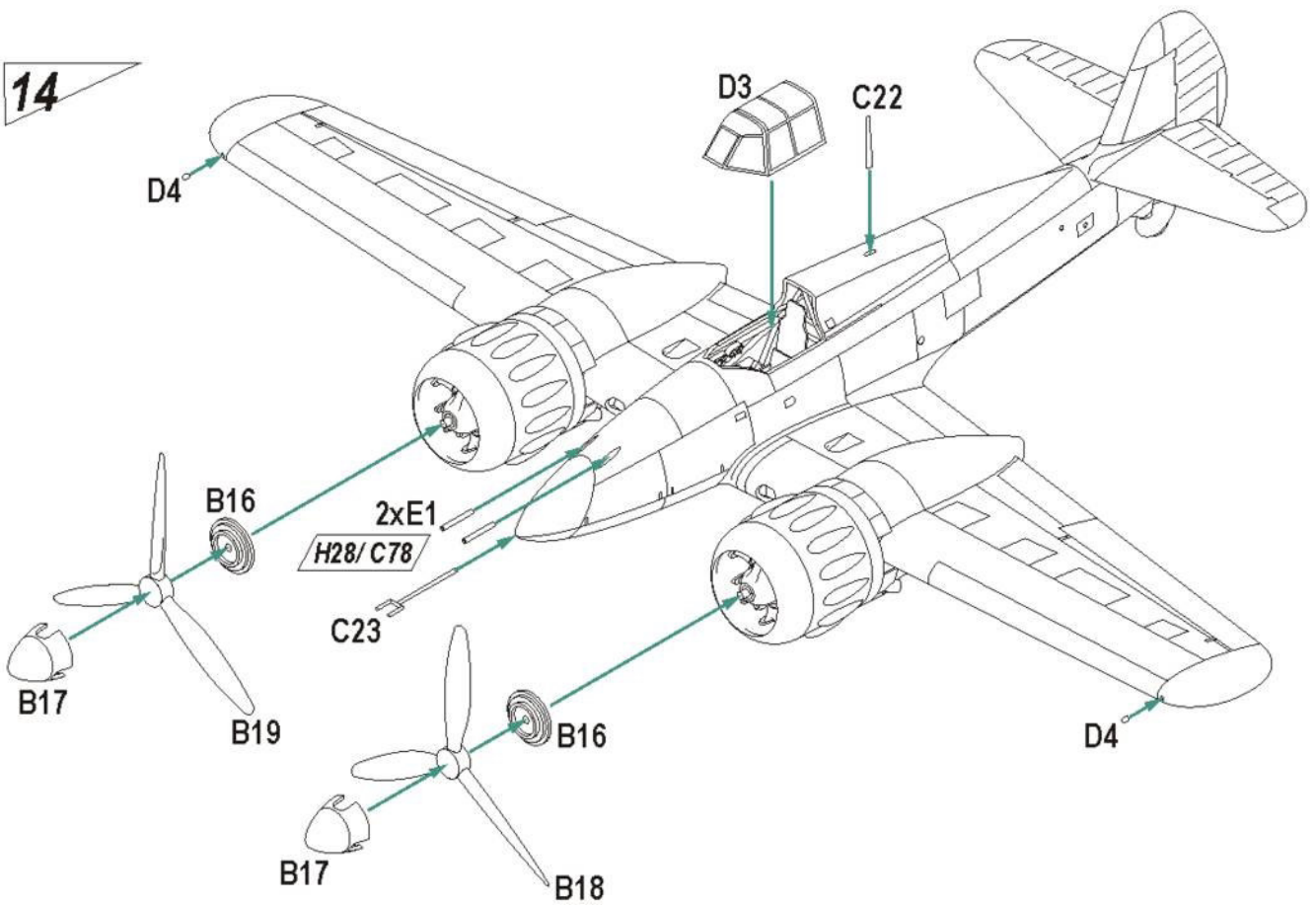

CAM. B

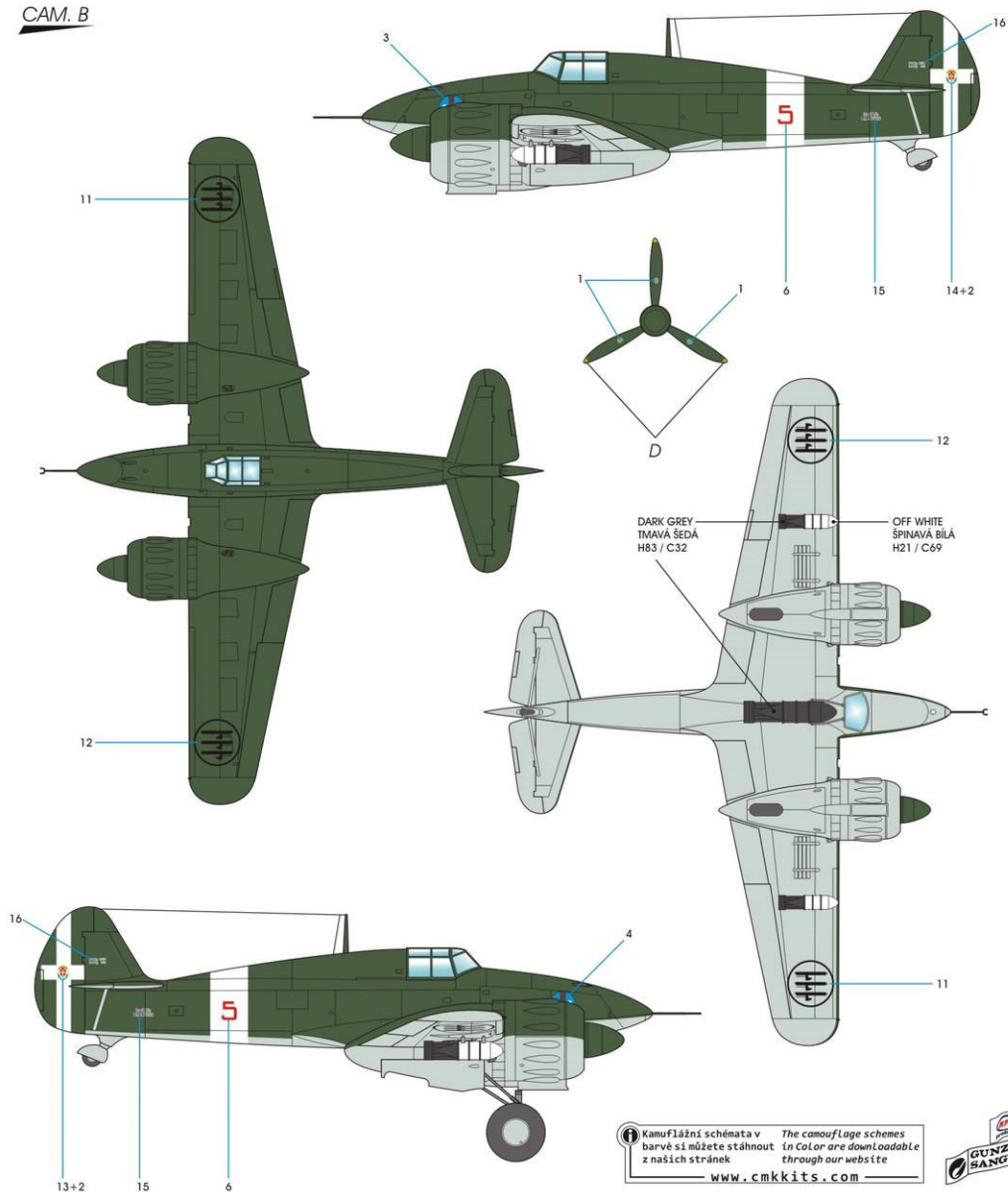

A Tmavá zelená
Verde Oliva Scuro 2
H302/ C302

B Nebeská šedá
Grigio Azzurro chiaro
H67/ C115

C Bílá
White
H11/ C62

D Žlutá
Yellow
H329/ C329
FS13538

CAM. C

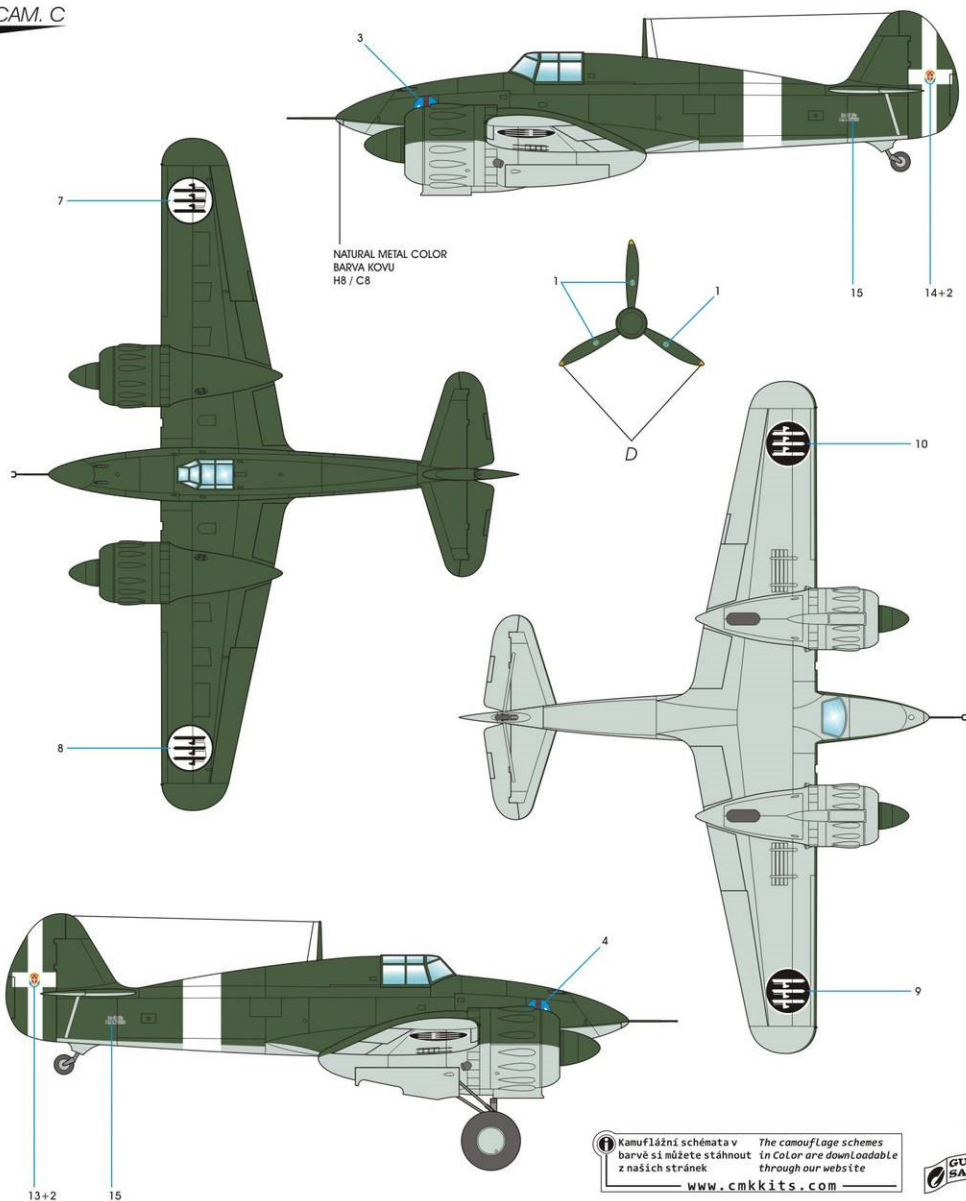

i Kamuflážní schémata v barvě si můžete stáhnout z našich stránek www.cmkkits.com
The camouflage schemes in Color are downloadable through our website



A  Tmavá zelená
Verde Oliva Scuro 2
H302/ C302

B  Nebeská šedá
Grigio Azzurro chiaro
H67/ C115

C  Bílá
White
H11/ C62

D  Žlutá
Yellow
H329/ C329
FS13538