

1930 MODEL "A"

Revell 

H-1324-380

© 1974 BY REVELL INC., VENICE, CALIF 90291

LITHO IN U.S.A.

The Ford Motor Company's beloved 1930 Model A Woody remains one of the most desired automobiles for the hot rodder and purist alike.

Ford sales literature of 1930 describes one particular Woody as a "deluxe delivery car that is a very smart unit...following passenger car lines that can provide seating for up to nine persons." Some versions of Ford's wood sidepanel automobiles were produced as early as 1915. These models were extremely popular with businessmen, who used it for delivering and transporting goods or several people from place to place. Many proud owners raved about the vehi-

cle's versatility. To be sure, the '30 Woody Wagon was everything that the sales literature claimed.

Through the years, many vehicles have become valued as collector's items and antiques. One of the highest valued and most popular is the Ford Woody, as it is called.

This Revell 1/25 scale hobby kit of the all-time favorite 1930 Woody is also a collector's item, for car hobby kit builders. It can be built purely in stock form, or, as options, the kit can be assembled with high performance 4-banger engine parts.

★ ★ ★ BEFORE YOU BEGIN ★ ★ ★

GET YOUR TOOLS READY:

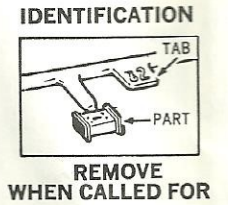
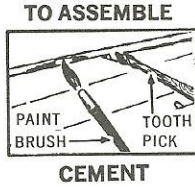
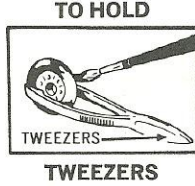
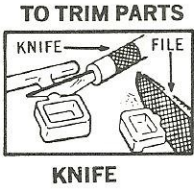

FIRST, FIT PARTS TOGETHER and TRIM EXCESS PLASTIC. Use a toothpick, pin or small paint brush to apply cement. APPLY CEMENT SPARINGLY. Too much cement will damage your model.

If you wish to stop at any point during the construction of your model do so at the end of an Assembly Step.

NOTE: In the illustrations some of the details on the parts have been OMITTED FOR CLARITY.

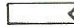
IF YOU WISH TO PAINT YOUR MODEL — See PAINTING FLAGS  for color suggestions.

- Use paints made for plastics only.
- Paint small parts before detaching from runner.
- Start with the lighter colors.
- Scrape off paint or chrome where parts are to be cemented to obtain a good bond.

PACTRA COLOR GUIDE

GLOSS BLACK = S-1 GLOSS BLACK

YELLOW = S-8 YELLOW

SILVER = S-11 OR X-11 SILVER

FLAT BROWN = XF-10 FLAT BROWN

FLAT BLACK = SF-1 FLAT BLACK

GRAY = S-9 GRAY

FLAT GREEN = XF-5 FLAT GREEN

TAN = X-17 TAN

1

FRONT AXLE

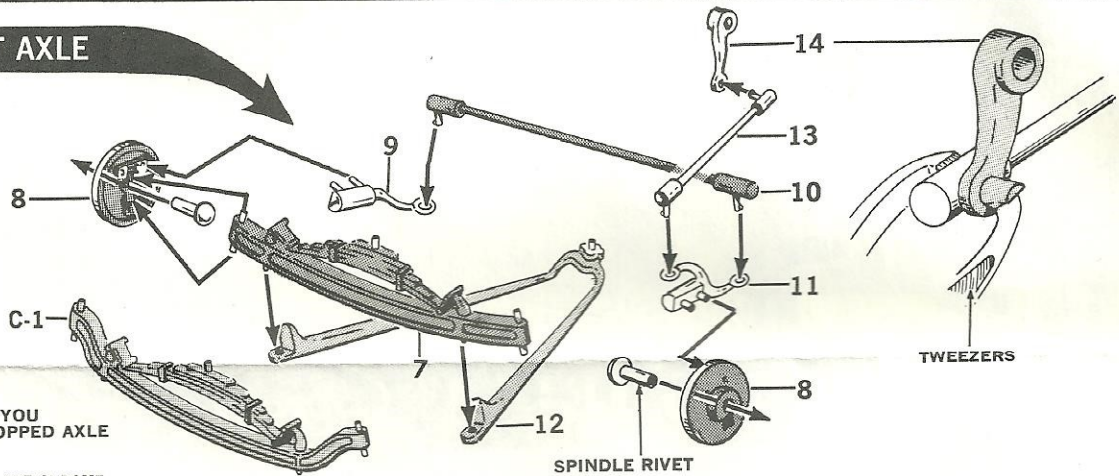

INVERT PART (10) IF YOU CHOOSE TO USE DROPPED AXLE

ALL THESE PARTS ARE CHROME

- C1 FRONT AXLE — CUSTOM DROPPED
- 7 FRONT AXLE
- 8 BRAKE PLATE — FRONT (2 Parts)
- 9 STEERING KNUCKLE — RIGHT
- 10 TIE ROD
- 11 STEERING KNUCKLE — LEFT
- 12 WISHBONE
- 13 DRAG LINK
- 14 PITMAN ARM

1. Insert one RIVET in each Part (8). Place lower pin on (7) or (C-1) in one Part (8) and cement (9) in position. **DO NOT LET CEMENT TOUCH UPPER PIN on AXLE or WHEEL will not turn.**
2. **ASSEMBLE, BUT DO NOT CEMENT (10) to (9) and (11).** Place remaining (8) on AXLE pin and cement (11) in place.
3. Cement (12) to (7) or (C-1).
4. Install end of (13) with SMALL BUMP on pin in remaining Hole in Part (11). Install pin on opposite end in (14). Use TWEEZERS to press parts together.

2

REAR AXLE

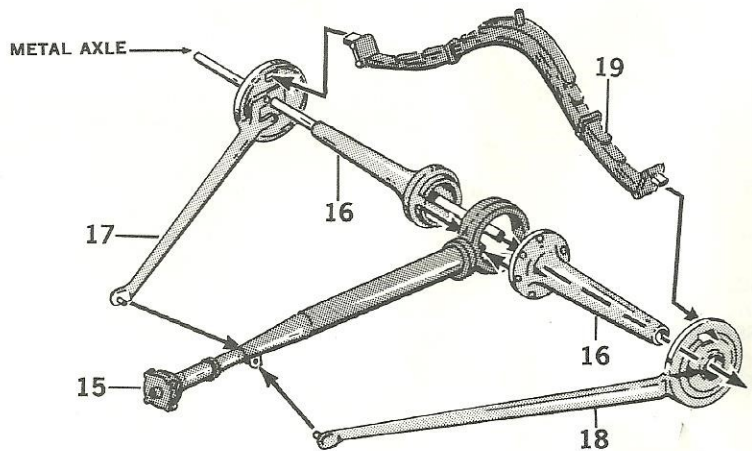

ALL THESE PARTS ARE CHROME

- 15 DRIVE SHAFT ASSY.
- 16 AXLE HOUSING — REAR (2 Parts)
- 17 BRAKE PLATE — RIGHT REAR
- 18 BRAKE PLATE — LEFT REAR
- 19 SPRING — REAR

1. Cement two Parts (16) to (15).
2. Cement (17) in position.
3. Locate (19) between (17) and (18) then cement (18) to (15) and (16).
4. Place METAL AXLE in position and set aside to dry.

3

WHEEL AND TIRES

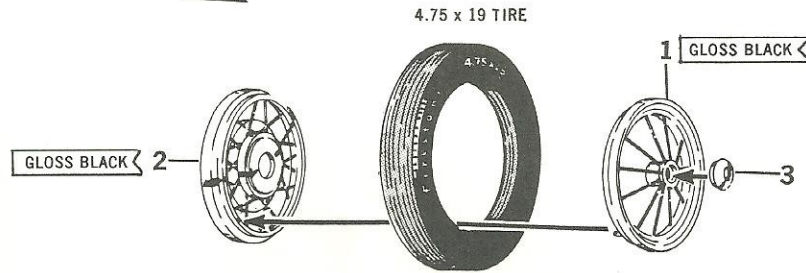

1F WHEEL OUTER HALF (2 Parts)
 1R WHEEL OUTER HALF (2 Parts)
 2 WHEEL INNER HALF (4 Parts)
 3 HUB CAP (4 Parts)-CHROME

1. Assemble two FRONT WHEELS using Parts (1-F), (2) and (3), place TIRES on WHEELS and then press WHEELS on FRONT AXLE.
2. Assemble two REAR WHEELS using Parts (1), (2) and (3), place TIRES on WHEELS and press WHEELS on REAR AXLE.

4

HOOD ASSEMBLY

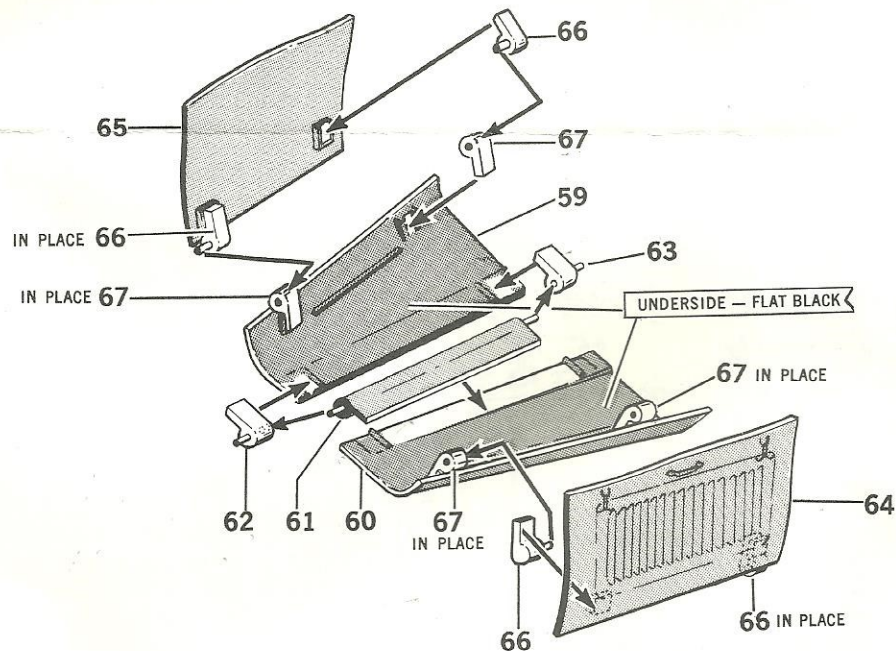

59 HOOD - LEFT CENTER SECTION
 60 HOOD - RIGHT CENTER SECTION
 61 HINGE - CENTER HOOD (CHROME)
 62 HINGE - CENTER HOOD END (CHROME)
 63 HINGE - CENTER HOOD END (CHROME)
 64 SIDE PANEL - HOOD RIGHT
 65 SIDE PANEL - HOOD LEFT
 66 HINGE - MALE SIDE PANEL (4 Parts)
 67 HINGE - FEMALE SIDE PANEL (4 Parts)

1. Cement two Parts (67) to both (59) and (60).
2. Cement (61) to (60) and (62) to (59).
3. Cement two Parts (66) to both (64) and (65). Allow cement to set before completing Assembly.
4. LOCATE, BUT DO NOT CEMENT (61) to both (62) and (63). Then carefully cement (63) to (59).
5. LOCATE, BUT DO NOT CEMENT SIDE PANELS (64) and (65) to HOOD TOP SECTION.

5

ENGINE ASSEMBLY

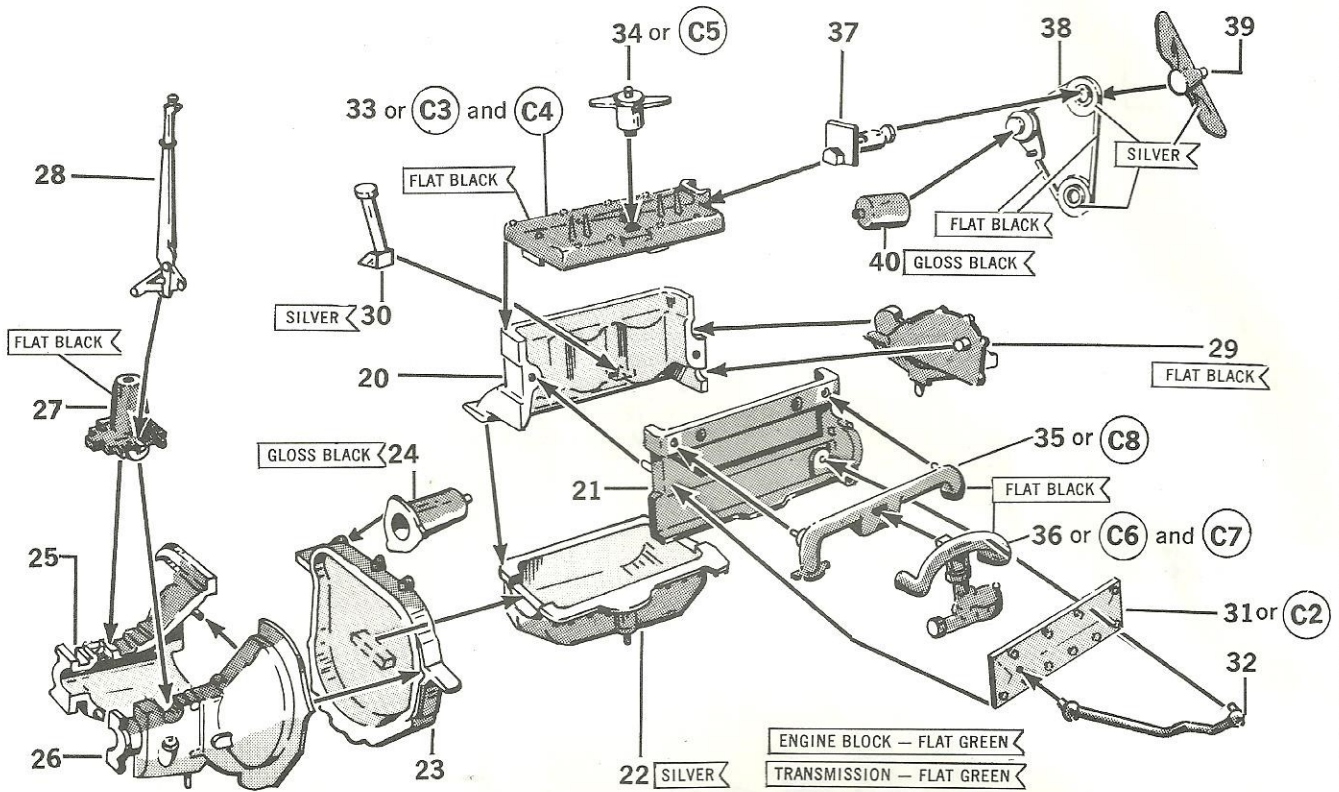

- 20 CYLINDER BLOCK — LEFT HALF
- 21 CYLINDER BLOCK — RIGHT HALF
- 22 OIL PAN
- 23 FLY WHEEL HOUSING
- 24 STARTING MOTOR
- 25 TRANSMISSION — LEFT HALF
- 26 TRANSMISSION — RIGHT HALF
- 27 TRANSMISSION COVER
- 28 BRAKE LEVER — EMERGENCY -CHROME
- 29 TIMING GEAR CASE
- 30 OIL FILLER PIPE
- 31 SIDE VALVE COVER
- 32 OIL RETURN PIPE -CHROME
- 33 CYLINDER HEAD
- 34 DISTRIBUTOR
- 35 EXHAUST MANIFOLD
- 36 INTAKE MANIFOLD AND CARBURETOR
- 37 WATER PUMP
- 38 FAN BELT AND PULLEY ASSY.
- 39 FAN
- 40 GENERATOR

CUSTOM SPEED EQUIPMENT

- C-2 SIDE VALVE COVER — ANSEN -CHROME
- C-3 CYLINDER HEAD — RILEY
- C-4 VALVE COVER — RILEY (2 Parts) -CHROME
- C-5 DISTRIBUTOR — MALLORY -CHROME
- C-6 INTAKE MANIFOLD — ANSEN -CHROME
- C-7 CARBURETOR — "97" (2 Parts) -CHROME
- C-8 EXHAUST HEADER -CHROME

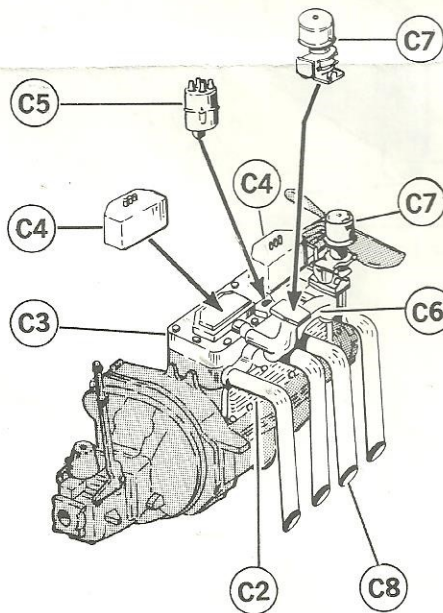

Your model may be assembled with the **STOCK ENGINE** or with various **CUSTOM EQUIPMENT**.

Please note in the drawing above that some parts are shown with two part numbers. The **CIRCLED NUMBERS** are **CUSTOM PARTS** that may be substituted for the **STOCK PARTS**. After assembling the **BASIC ENGINE** Parts (20) through (30) try some of the different possibilities before cementing the remaining parts in place.

1. Cement Parts (20), (21), (22), (29) and (30) together.
2. Cement Parts (23) through (28) together then cement assembly to ENGINE.
3. ASSEMBLE and cement Parts (38) through (40) set aside temporarily.
4. Complete Assembly of your ENGINE using the **STOCK** or **CUSTOM** Parts indicated.
5. Cement the Assembly of Parts (38 to 40) to the front of ENGINE.

6

CHASSIS ASSEMBLY

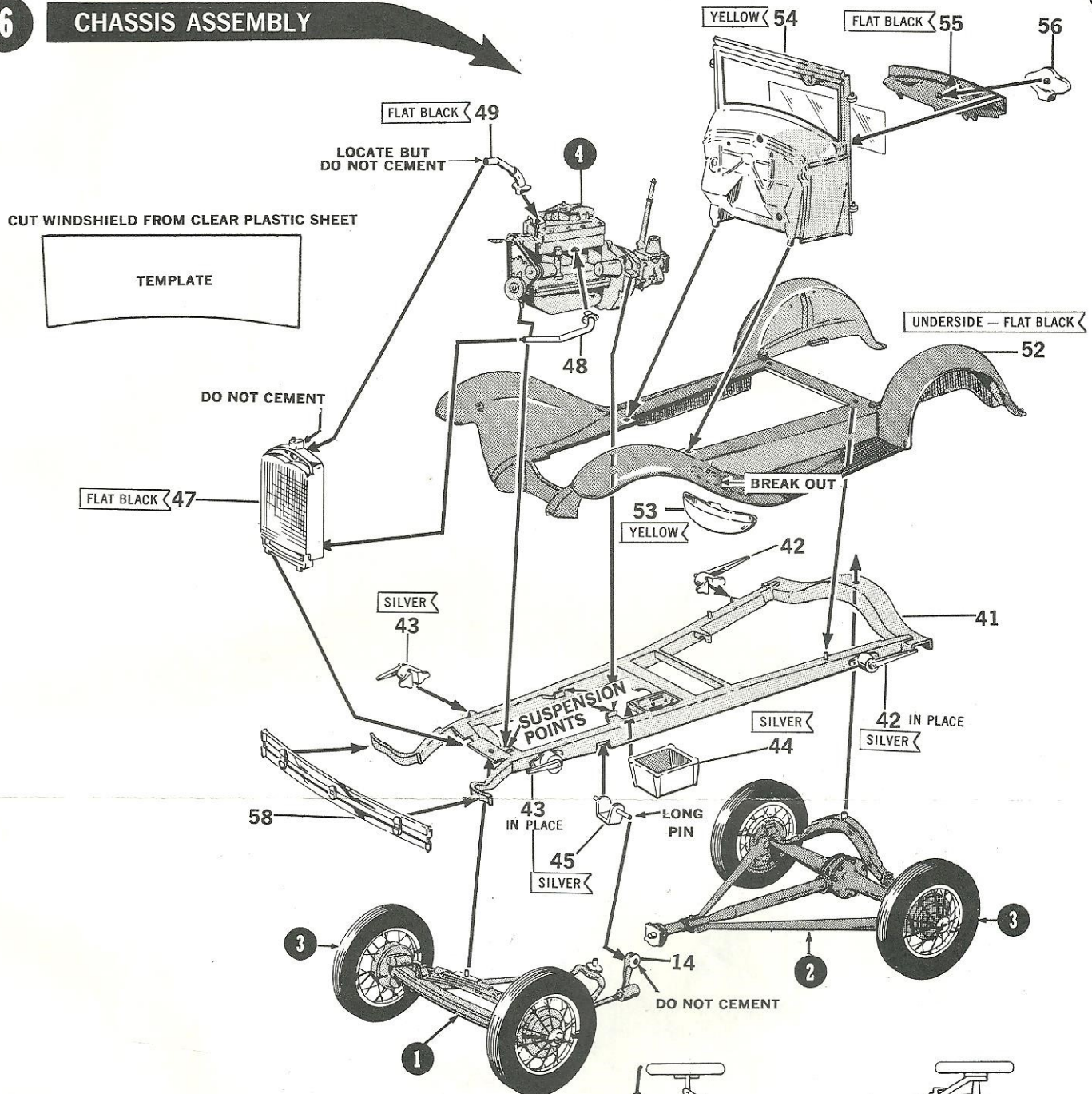

1. Break out the opening for the SPARE TIRE as indicated and cement Part (53) in position.
2. Cement two Parts (42), two Parts (43), and (44) and (45) to (41).
3. Cement ENGINE and (52) to (41).
4. Cement AXLE ASSEMBLIES to (41) and ENGINE.
5. Cement (47) and (48) in position. Cement (49) to ENGINE. LOCATE DO NOT CEMENT TOP END to (47).
6. Cement (50) to (51). Cement forward end of (50) to ENGINE EXHAUST MANIFOLD and (51) to FRAME LOCATOR.
7. Cut WINDSHIELD to Template size and carefully cement to (54).
8. Cement (56) to (55) to (54).
9. Cement (54) to (52) and (58) to (41).

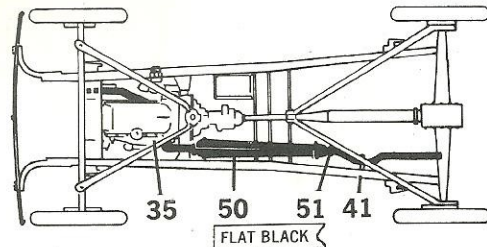

NOTE:
DO NOT ASSEMBLE OR INSTALL EXHAUST PIPE AND MUFFLER IF YOU ARE USING THE CUSTOM EXHAUST (C-8) ON YOUR ENGINE

41 FRAME ASSY.
42 SHOCK ABSORBER — REAR HOUDAILLE (2 Parts)
43 SHOCK ABSORBER — FRONT HOUDAILLE (2 Parts)
44 BATTERY CASE
45 PITMAN SHAFT
47 RADIATOR CORE
48 WATER COUPLING — LOWER
49 WATER COUPLING — UPPER
50 EXHAUST PIPE AND MUFFLER — FRONT HALF
51 MUFFLER AND TAIL PIPE — REAR HALF

52 FENDER ASSY.
53 WHEEL WELL
54 COWLING
55 DASH AND TANK
56 INSTRUMENT PANEL-CHROME
58 FRONT BUMPER-CHROME
WINDSHIELD — CLEAR SHEET

7

INSTALLATION HOOD AND LIGHTS

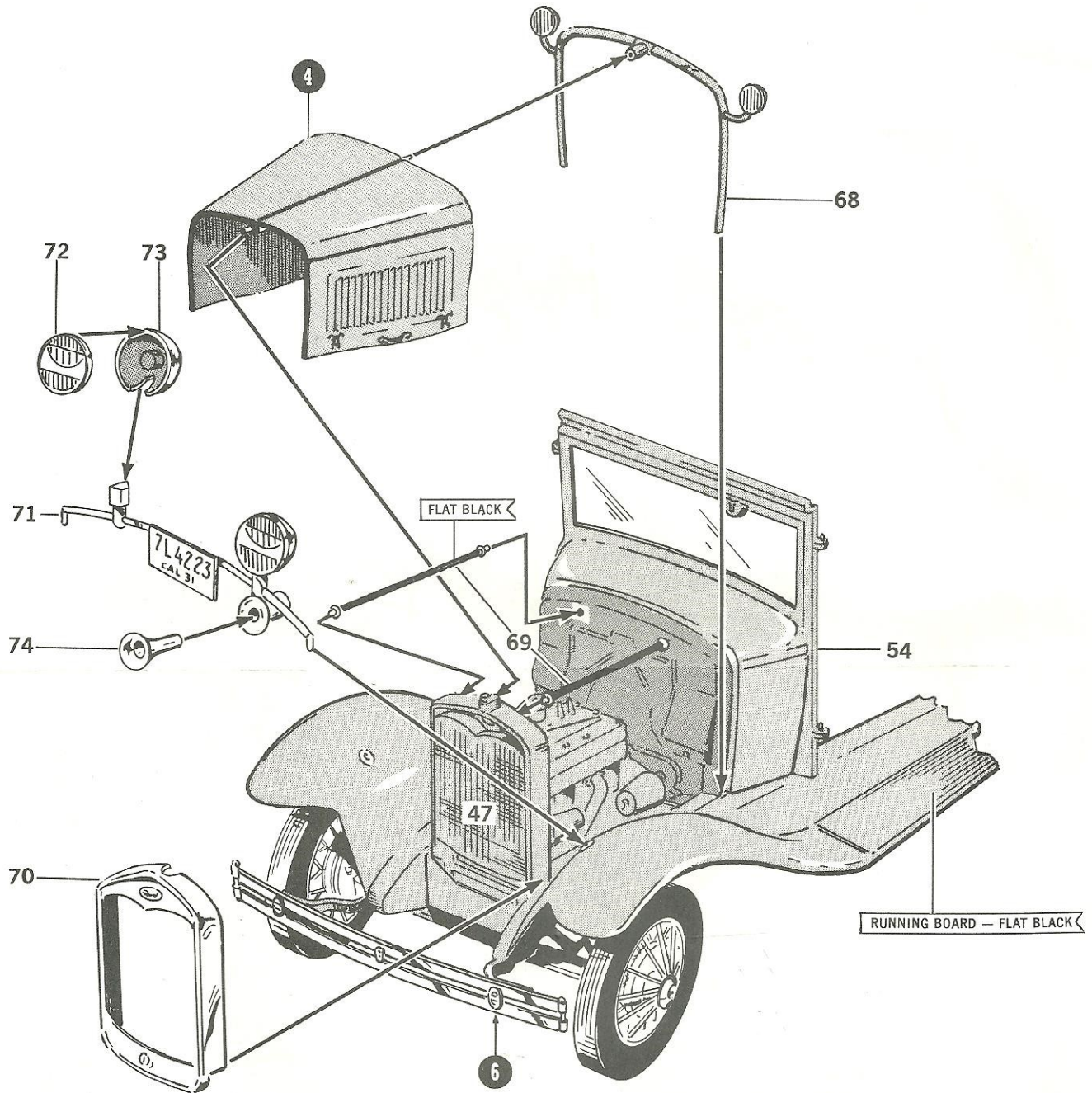

- 68 CHROME TRIM AND PARKING LAMPS (CHROME)
- 69 TIE ROD RADIATOR
- 70 SHELL RADIATOR (CHROME)
- 71 HEAD LAMP BRACKET ASSY. (CHROME)
- 72 LENS — HEAD LAMP (2 Parts)-CHROME
- 73 HEAD LAMP (CHROME) (2 Parts)-CHROME
- 74 HORN BELL (CHROME)

1. Cement (68) and two Parts (69) to Front of (54). Locate REAR PIN of HOOD to (68) and FRONT PIN to (47). Then carefully cement UPPER RADIATOR HOSE (49) and forward ends of both Parts (69) to (47).
2. Cement (70) to (47).
3. Cement two Parts (72) to two Parts (73). Cement both LIGHTS and (74) to (71). Cement (71) to FRONT FENDERS.

8

WOOD PANELS & TOP ASSEMBLY

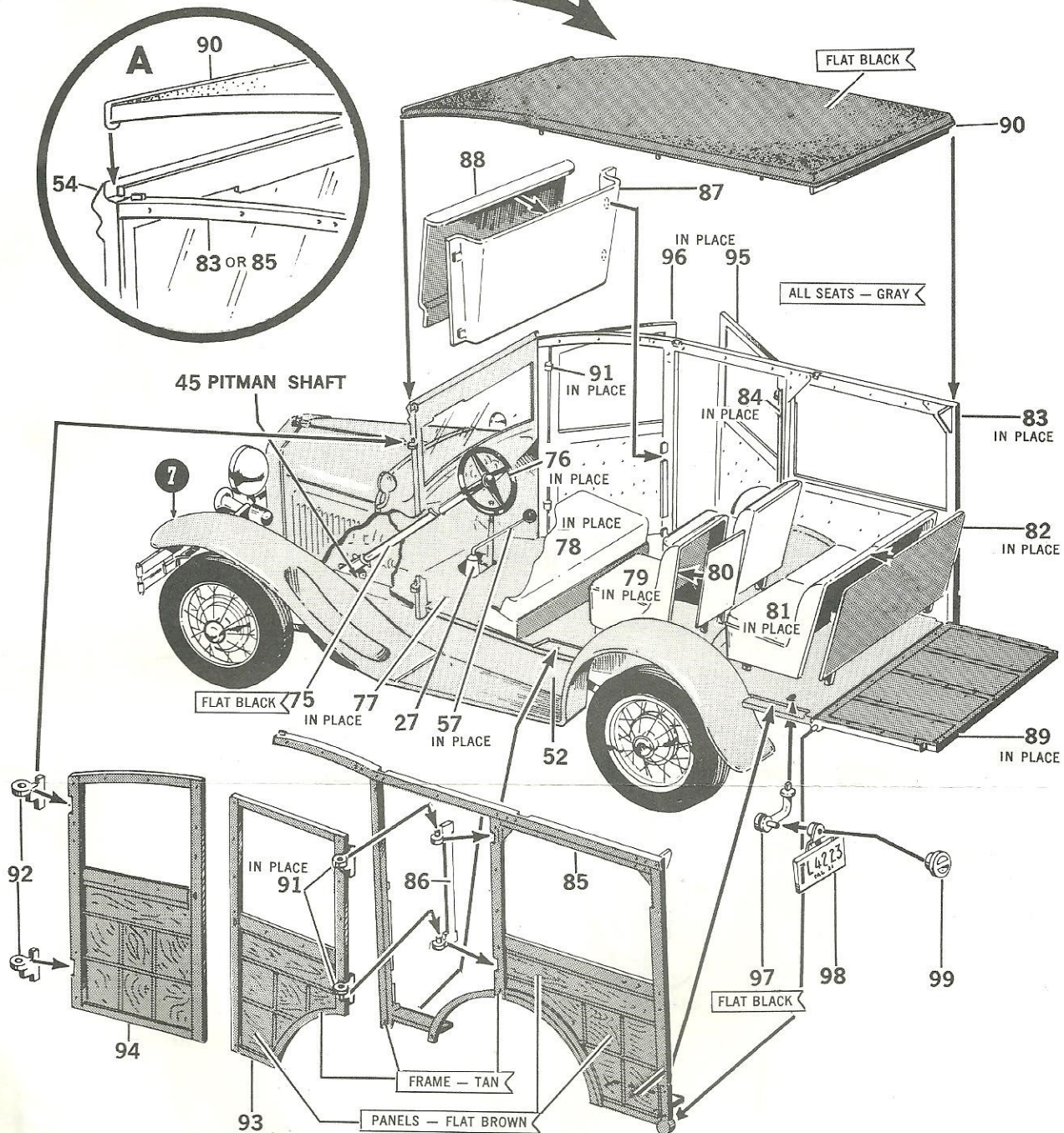

57 GEAR SHIFT LEVER (CHROME)
 75 STEERING COLUMN
 76 STEERING WHEEL
 77 FLOOR BOARD
 78 SEAT CUSHION - FRONT
 79 JUMP SEAT (2 Parts)
 80 BACK PANEL - JUMP SEAT (2 Parts)
 81 SEAT - REAR
 82 BACK PANEL - REAR SEAT
 83 BODY PANEL - RIGHT SIDE
 84 HINGE ASSY. - RIGHT REAR DOOR
 85 BODY PANEL - LEFT SIDE
 86 HINGE ASSY. - LEFT REAR DOOR
 87 PANEL - FRONT SEAT BACK
 88 CUSHION - FRONT SEAT BACK
 89 TAIL GATE
 90 TOP
 91 HINGE - LEFT REAR AND RIGHT FRONT DOOR (4 Parts)
 92 HINGE - RIGHT REAR AND LEFT FRONT DOOR (4 Parts)
 93 DOOR - LEFT REAR
 94 DOOR - LEFT FRONT
 95 DOOR - RIGHT REAR
 96 DOOR - RIGHT FRONT
 97 BRACKET - TAIL LAMP
 98 LICENSE PLATE - REAR (CHROME)
 99 TAIL LAMP (CHROME)

1. Locate (75) through hole in FIREWALL, cement to pin on FRAME and DASH BOARD LOCATOR. Cement (76) to (75).
2. Locate (77) over EMERGENCY BRAKE HANDLE and cement in place.
3. Cement (57) to (27).
4. Cement two Parts (79) to two Parts (80). Cement (81) to (82). Cement (78), two Parts (79) and (81) to (77).
5. Cement (86) to (85) and (84) to (83) and (87) to (88).
6. Assemble and cement (83) and (87) to FLOOR (77). **LOCATE, BUT DO NOT CEMENT (89) to (83) then position (85) to (89), (87) and (77) then cement in place.**
 NOTE: See detail DRAWING "A" for location of Parts (83) and (85) to (54).
7. Cement (90) in position.
8. Cement two Parts (91) to both (93) and (96).
9. Cement two Parts (92) to both (94) and (95). Locate DOORS to BODY ASSEMBLY.
10. Assemble and cement (97), (98) and (99). Cement (97) to (77).

9

FINAL ASSEMBLY

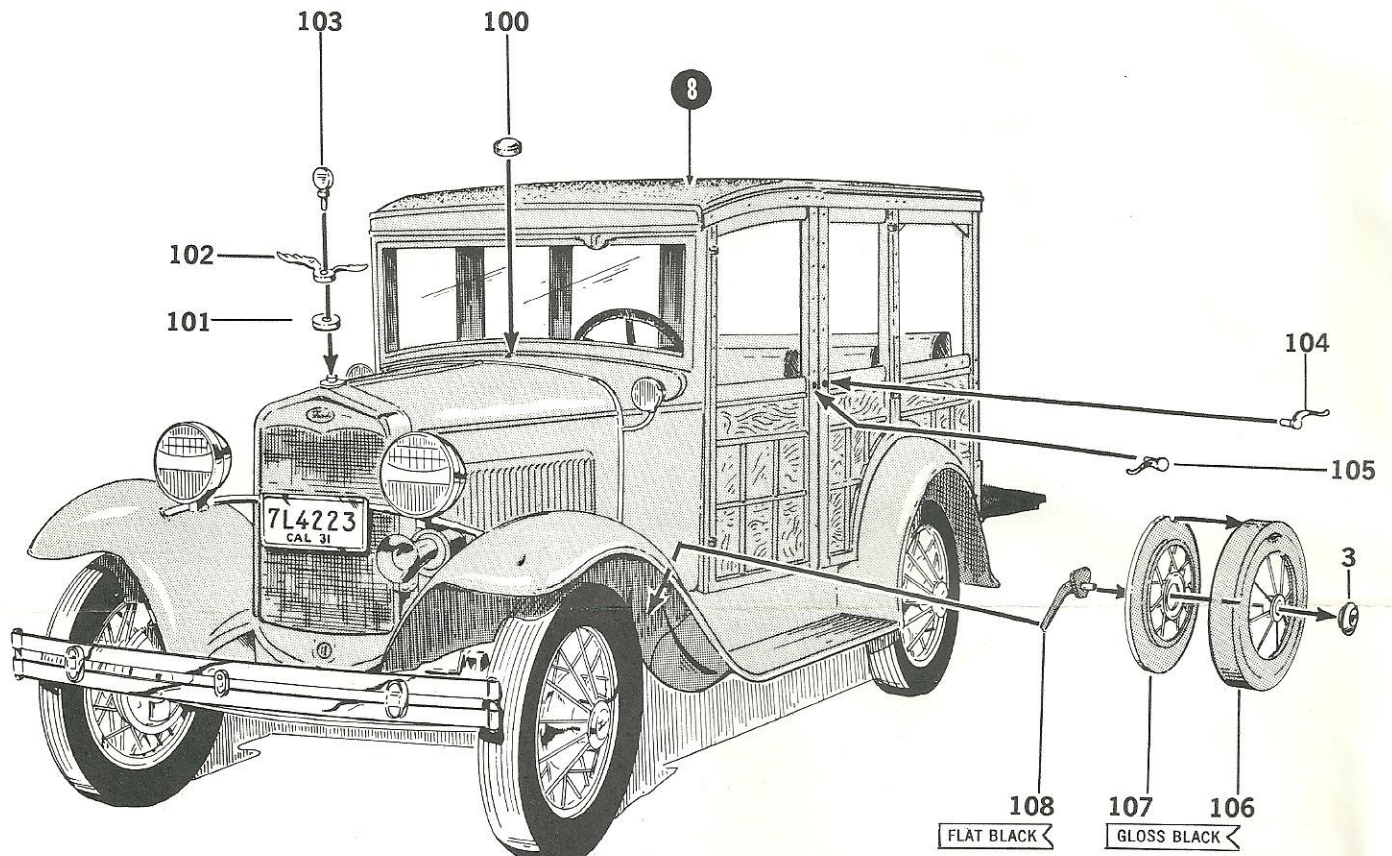

3 HUB CAP-CHROME
 100 CAP - GAS TANK (CHROME)
 101 CAP - RADIATOR (CHROME)
 102 WING ORNAMENT - RADIATOR CAP (CHROME)
 103 MOTOMETER HEAD (CHROME)
 104 DOOR HANDLE - LEFT REAR AND RIGHT FRONT (2 Parts) (CHROME)
 105 DOOR HANDLE - RIGHT REAR AND LEFT FRONT (2 Parts) (CHROME)
 106 SPARE WHEEL - OUTER HALF
 107 SPARE WHEEL - INNER HALF
 108 BRACKET - SPARE WHEEL MOUNT

1. Assemble (101), (102) and (103). Cement Assembly to RADIATOR.
2. Cement GAS CAP (100) to COWL.
3. Cement one Part (104) to both LEFT REAR and RIGHT FRONT DOORS.
4. Cement one Part (105) to both LEFT FRONT and RIGHT REAR DOORS.
5. Cement (3), (106), (107) and (108) together and to FENDER WELL.