



# Universal Carrier Wasp Mk.II C

1/35 SCALE

加拿大製“黃蜂”II C式噴火型運載車

NO.RV 35037



The Petroleum Warfare Department was established in Britain during 1940 to develop new weapons to defeat the expected German invasion. One of the projects was the vehicle-mounted flamethrower, that became known as the Ronson in British service and the Satan when used by the Americans. By 1942 the Ronson had been perfected and had achieved a very useful range of 80-100 meters. It was decided to mount the weapon in the Universal Carrier, the conversion being designated the Wasp. The first order was for 1,000 Wasps, the initial model being the MkI with the projector mounted on the engine cover. This was quickly replaced by the Mk.II which moved the projector to the front machine gun position. The Wasp Mk.II was first used in action during the Allied invasion of France in June 1944, with the vehicles being used to support infantry assaults. It was a great success as the Germans often gave up their positions rather than face the Wasp in action. It was also noted that the Wasp was far better at destroying bunkers than tank guns firing HE shells. The Wasp Mk.II was initially used by both British and Canadian units, but the Canadians modified their vehicles moving the fuel tanks to the rear hull of the Carrier. This allowed machine guns to be mounted in the side compartments increasing tactical flexibility. This version was designated the Wasp Mk.IIc and this became the main variant as the war ended. The Wasp Mk.II and Mk.IIc were also used in Italy and a few sent to the Far East. It is not noted how many Wasps were converted, perhaps as many as 3,000. They were withdrawn from service and stored after WWII a few later used in the Korean War 1950-53.

Special Thanks to Mr.Phil Greenwood, for providing precious informations.

1940年英國戰時燃料部為應對預期中德國軍隊對英國本土的進攻而設計的開發的新型兵器。計畫中的一個就是車載火焰發射器的Ronson（隆森），美軍稱之為satan（撒旦）。到1942年，其有效射程已達到優秀的80-100米。這個火焰噴射器決定使用通用運載車搭載，並被命名為“黃蜂”。最初訂購的1000輛初期型火焰噴射口放置在發動機艙蓋板上，很快在MkII型上又移動到了前部機槍的位置。黃蜂MkII最初在1944年盟軍在法國戰場作為步兵支援車輛使用。該車屢屢讓德國士兵放棄陣地，取得了比預期更好的效果。還有報告稱對於敵方的碉堡工事該車比使用HE高爆炸彈及AP穿甲彈反坦克炮更有效果。加拿大軍隊裝備的該車將火焰噴射器燃料筒放置在車輛後部，並在側面裝甲上加裝機槍支架安裝機槍，可以應對多種情況的戰鬥。這種型號命名為Mk.IIc，成為直到戰爭結束最主流的黃蜂型號。黃蜂Mk.II和Mk.IIc在義大利戰場也被使用，一些車輛也被用於與日軍作戰。將通用運載車直接改裝成黃蜂的記錄沒有留下，推測甚至可能有3000輛左右。二戰結束後，一些退役的該車在1950年-1953年的朝鮮戰爭中被使用。

1940年に英國戰時燃料部は予期されるドイツ軍の本土進攻に対して新型兵器の開発のため設立されました。計畫のひとつとしてが車載搭載火炎放射器の英國名ロンソン（Ronson）米軍側の名前がサターン（Satan）でした。1942年までロンソンは優秀で有効射程が80~100mまで達していました。この放射器はユニバーサルキャリアに搭載されることが決定され、搭載車両はWaspワズプ（大型の捕食類蜂）と命名されました。最初の発注1000台は初期型の射出口が車体上面のエンジン室カバー上にありました。すぐにMk.IIとして前部機銃位置に移されました。ワズプMk.IIは1944年の連合軍のフランス侵攻が最初の投入で歩兵支援車両として使用されました。本車両は効果的にドイツ兵の陣地をしばしば放棄させ艇ました。それは本来の使用より効果的でした。またワズプはブッカー（トーチカ）に対してもHE徹甲弾を用いた対戦車砲より効果的という報告もされていました。ワズプMk.IIは最初英軍とカナダ軍により使用されました。カナダ軍は火炎放射器の燃料を後部に移す改造がされ、側面の装甲に機銃を搭載、多岐なる戦闘に対応可能となりました。このタイプはMk.IIcと命名され、本車両の終戦までの主流となりました。ワズプMk.IIとMk.IIcはイタリア戦線でも使用され、数両は対日本戦にも投入されました。何両のユニバーサルキャリアが火炎放射器ワズプに変更されたかは記録が残っていませんがおよそ3000両ほどが改造されたと思われます。戦後、装備退役されましたが数両は1950~53年の朝鮮戦争で使用されました。

# ILLUSTRATION 图文说明

## CORRECT METHOD FOR APPLYING DECALS:

正确贴水上水贴纸的方法:

- |  |   |
|--|---|
| <ol style="list-style-type: none"> <li>1. Clean model surface with wet cloth.</li> <li>2. Cut out of decal sheet and dip them in cold water for 15 seconds.</li> <li>3. Place it on proper position on model.</li> <li>4. Slide off base paper leaving decals on model with wet finger tip.</li> <li>5. Move decals to exact position, push out excess water under decal with soft cotton cloth.</li> <li>6. When decals get dry then complete.</li> </ol> | <ol style="list-style-type: none"> <li>1. 将模型表面擦干净。</li> <li>2. 将贴纸剪下泡入清水中约15秒。</li> <li>3. 将泡湿之贴纸取出置于欲贴处旁。</li> <li>4. 用指尖轻推贴纸表面使其滑出底纸。</li> <li>5. 将贴纸调整至适当位置并轻擦拭水份。</li> <li>6. 待其自然干燥后即完成。</li> </ol> |
|--|---|

## READ BEFORE ASSEMBLING:

组装前必读:

- |  |  |
|--|--|
| <ul style="list-style-type: none"> <li>★ When you use glue or paint, do not use near open flame, and use in well ventilated room.</li> <li>★ Keep plastic model glue and tools away from children.</li> <li>★ Glue, paints and tools are not included in the kit.</li> <li>★ Remove all injection pins carefully using a modeling file.</li> </ul> | <p>胶水或油漆勿接近火源, 并打开窗户保持空气流通。</p> <p>胶水、油漆及工具勿让小孩接触。</p> <p>胶水、油漆及工具不包含在模型内。</p> <p>小心用专业锉刀锉平所有多余胶料。</p> |
|--|--|

## ICON INSTRUCTION 图标说明:

 Bend 弯曲	 Optional 选择采用	 Apply Decal 贴水上水贴纸	 Weight 配重	 Open Hole 钻孔	 x2 2 Sets needed 同样的制作二组
 Remove 切除	 Attention 请注意	 Do not cement 不用粘合	 File/Sand 锉平	 Fill Hole 把孔填平	 Instant Glue For Metal 瞬间接着剂金属用

限中国大陆 For use in mainland China orders only!

部品名称	单价 (RMB)
A版零件	20
B版零件	10
C版零件	10
D版零件	16
L版零件	20
N版零件	20
H版零件	8
J版零件	10
M2版零件	1
M3版零件	1
Sb版零件	15
T版零件	20
Z版零件	8
Pa 蚀刻片	10
Pb 蚀刻片	10
Decal 水帖	15



RV 35037  
零件补充申请表

本表价格仅作为您补件的参考  
如果原包装中零件遗失或者损坏,  
制作途中遗失或者损坏, 您可以  
登陆Riich.Models官方网店, 客  
服部将尽快为您处理。



# PARTS LIST 零件展示

**A**

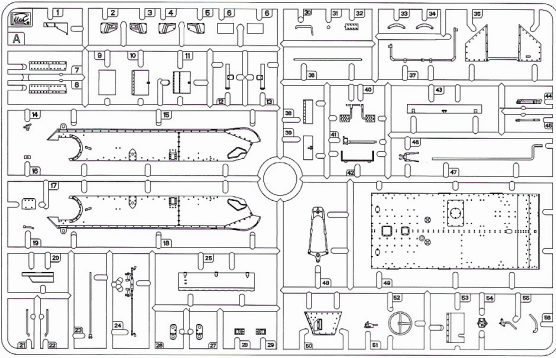

**B + C x2**

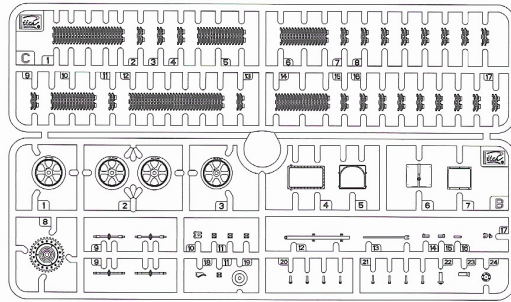

**L**

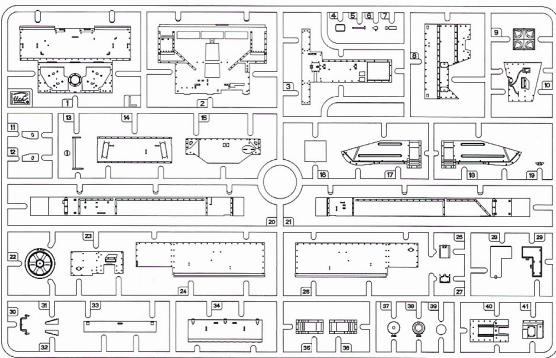

**N**

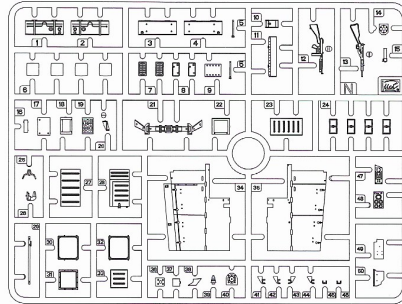

**D**

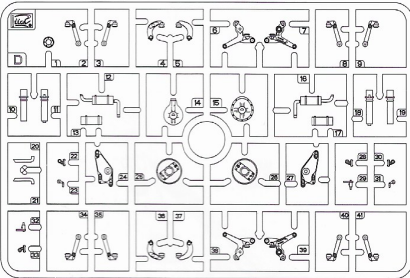

**T**

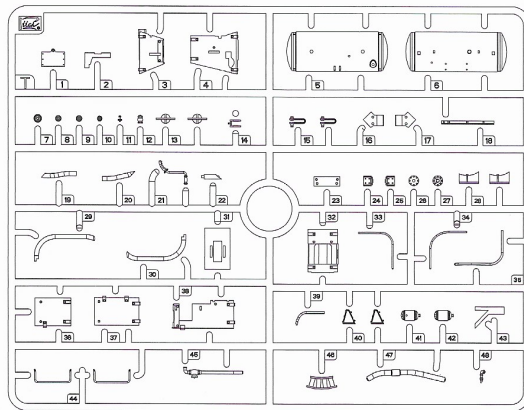

**H**



Decal



**J**

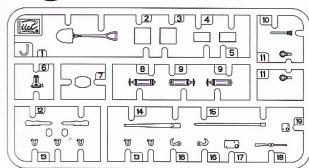

**Sb**

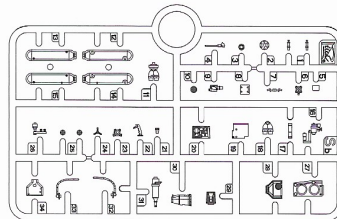

**M2** x16



Chain  
细链 (8cm)

**M3** x16



Thread  
细绳 (50cm)

**Pa**

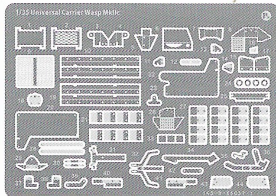

**Pb**

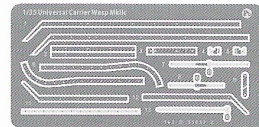
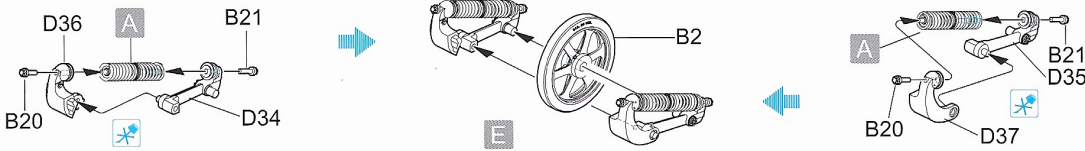
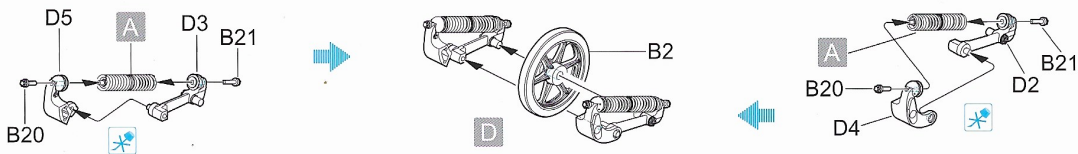
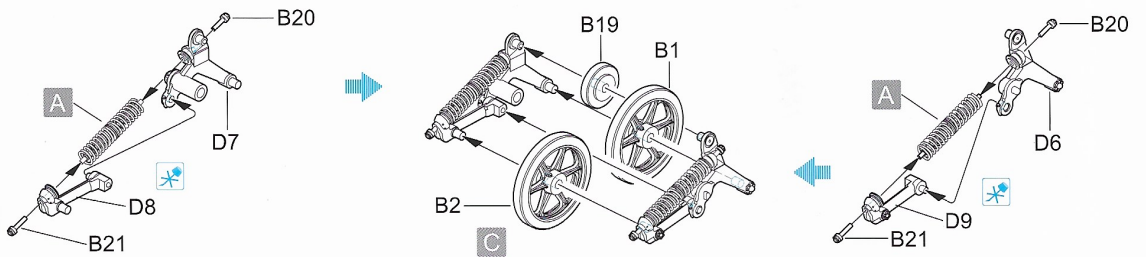
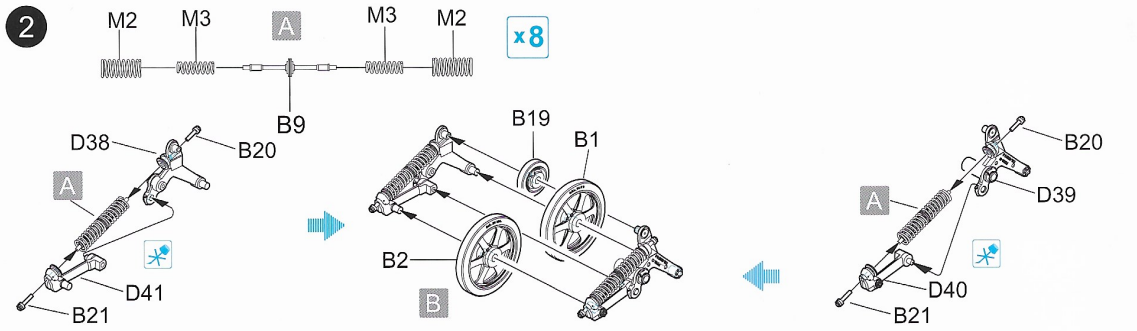
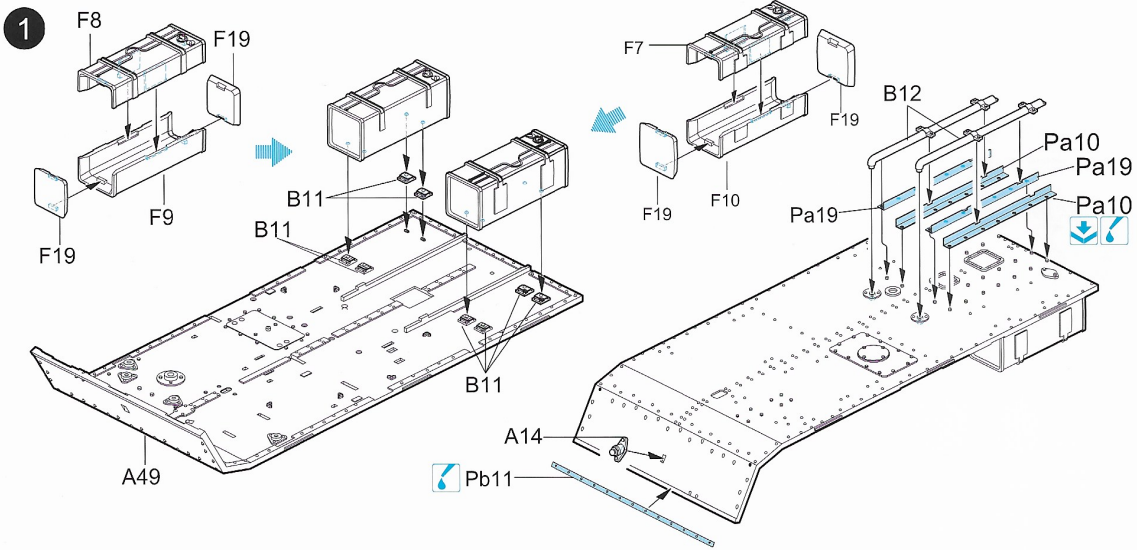
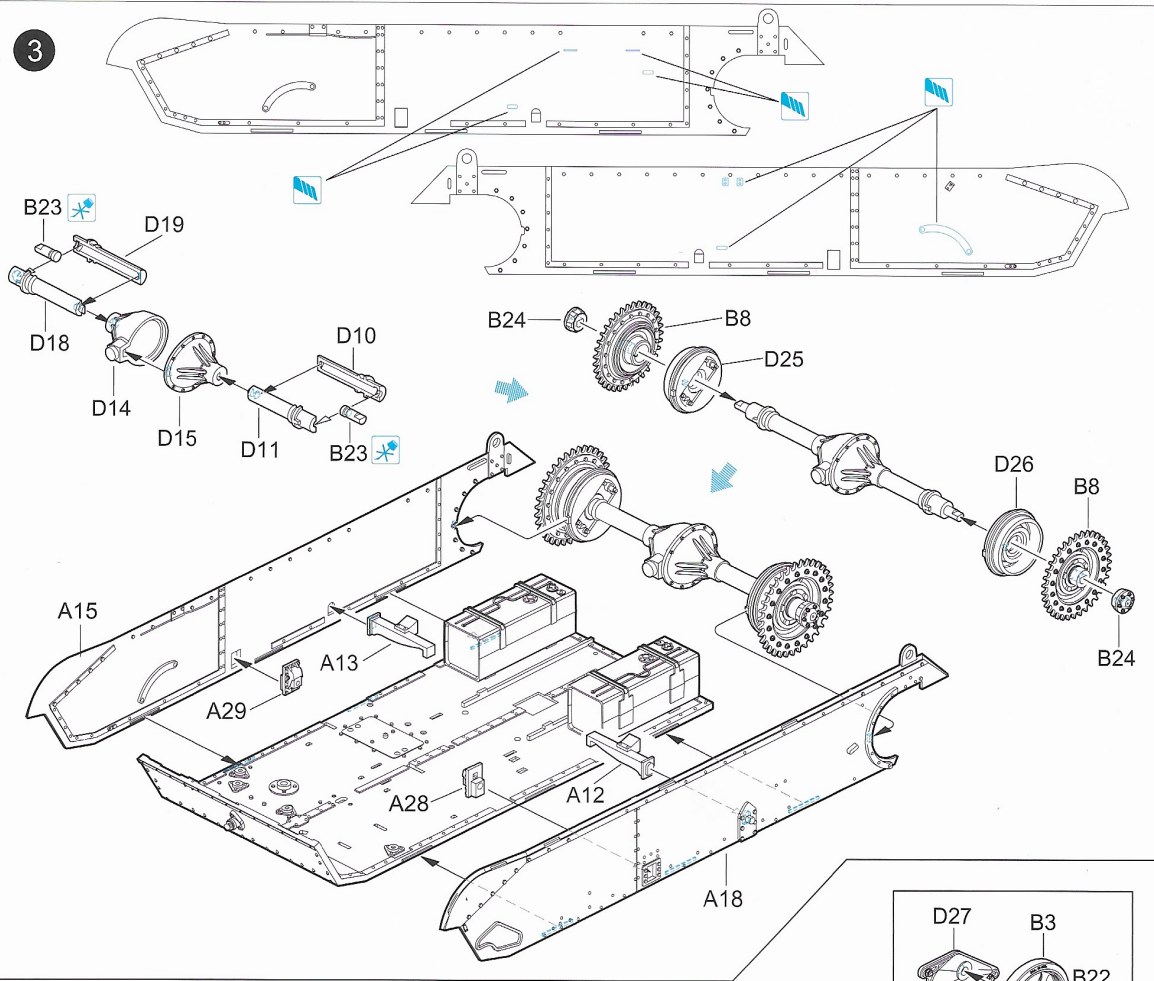

ILLUSTRATION 图文说明



3



4

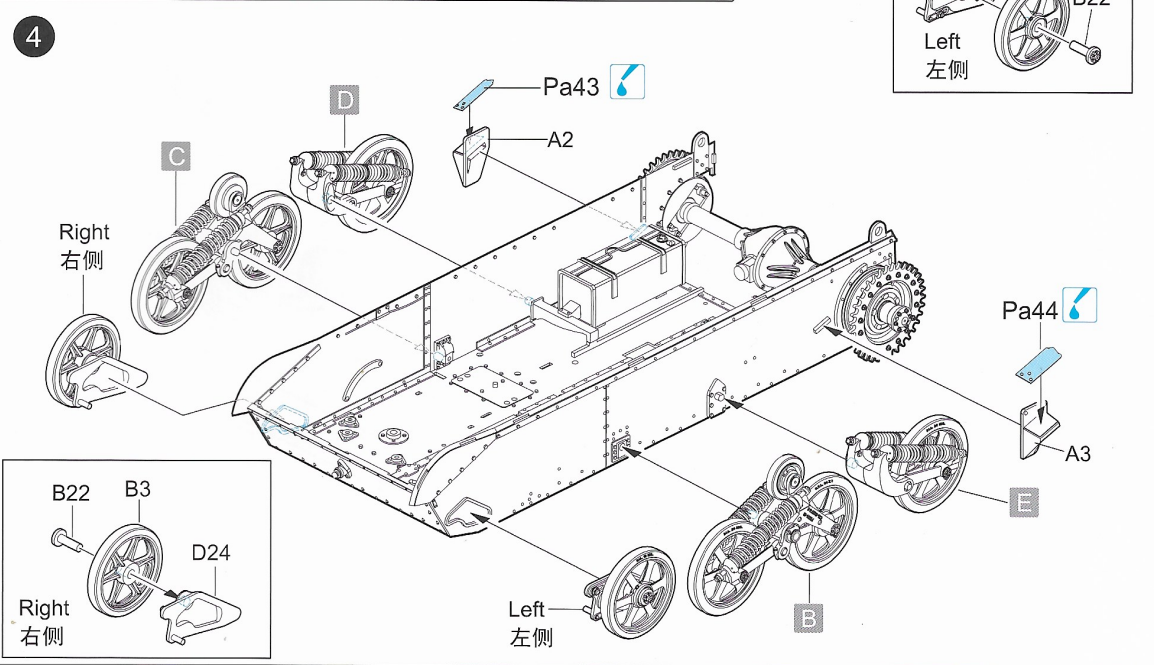

5

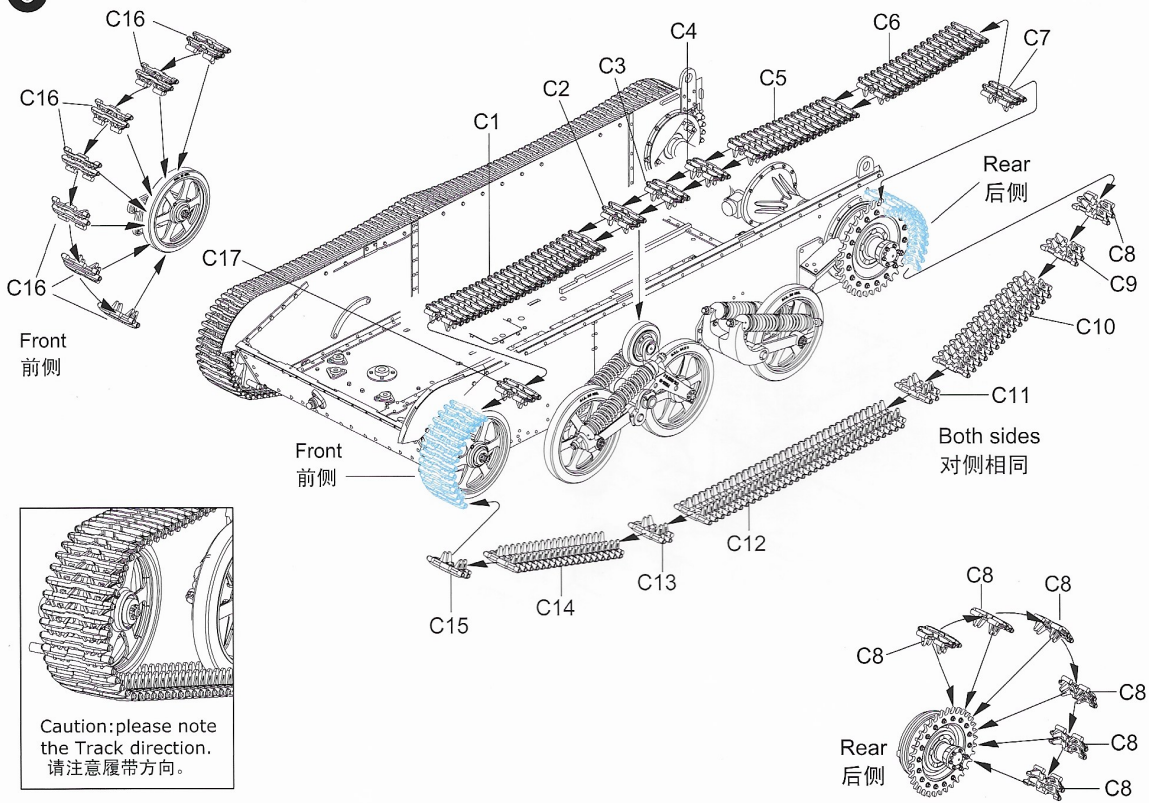

6

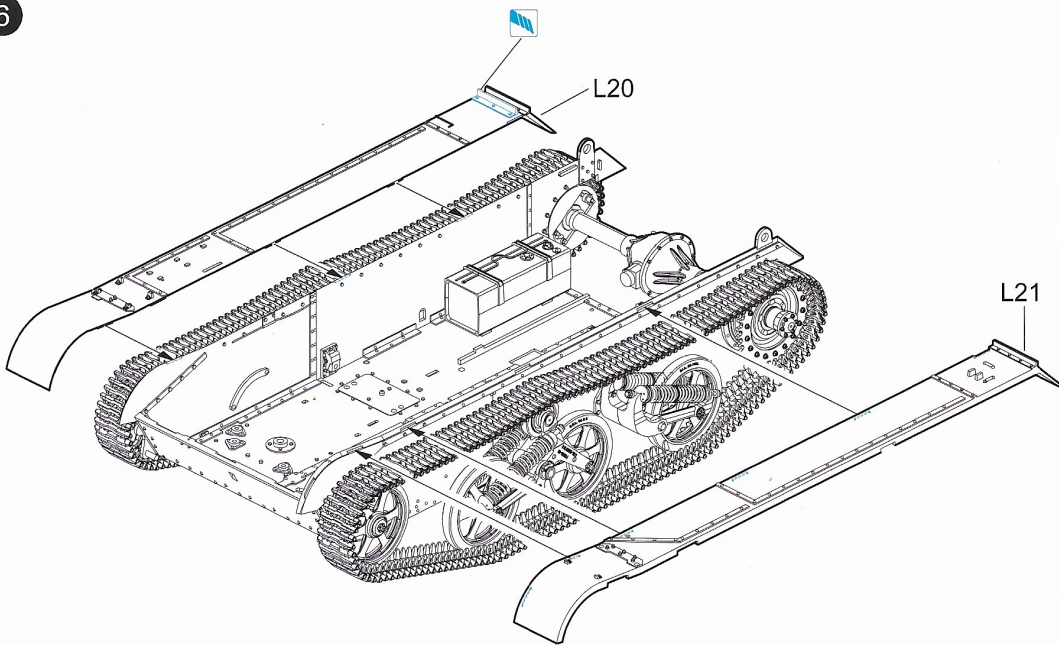

7

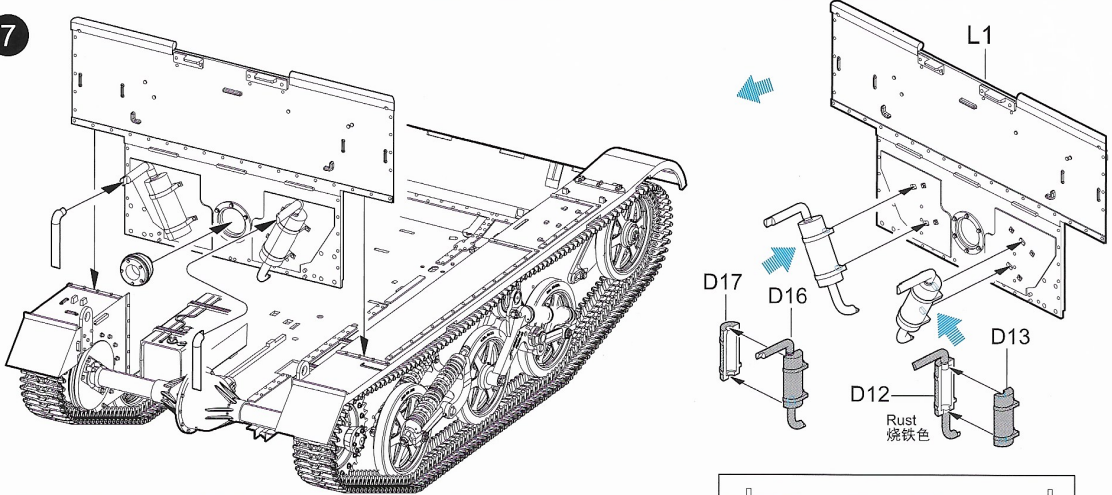

8

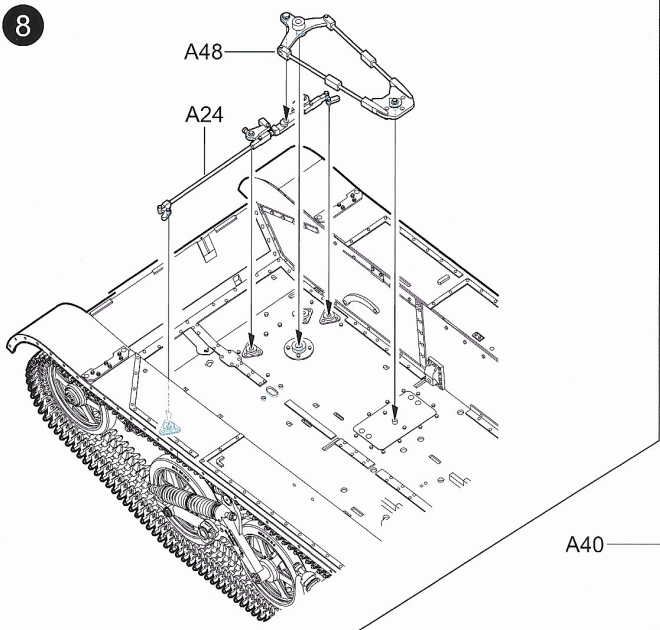

9

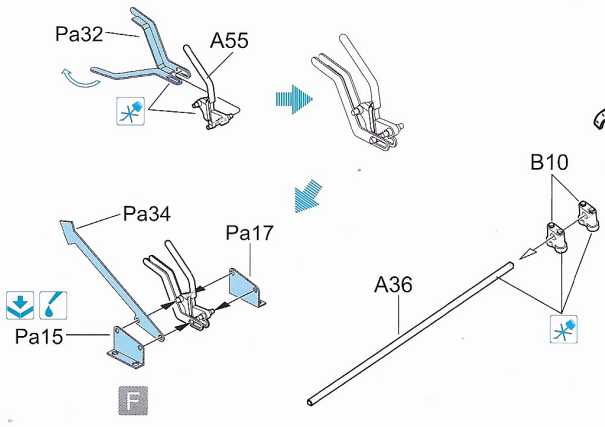
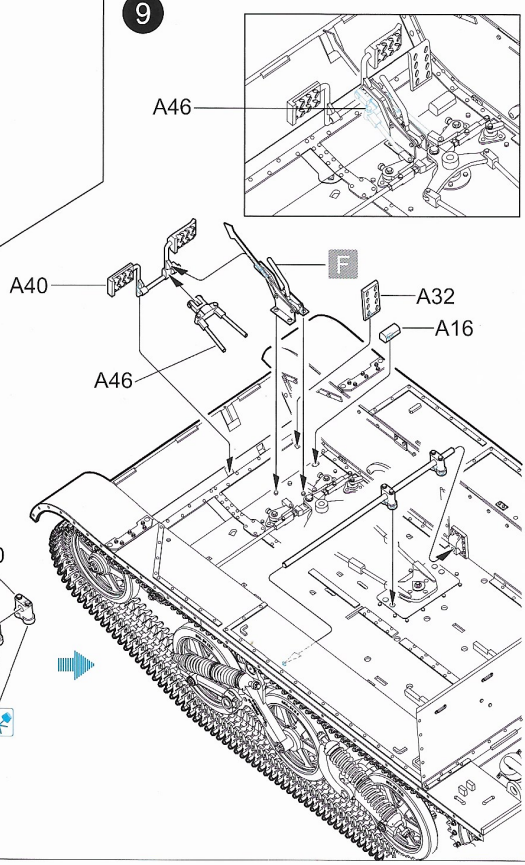

10

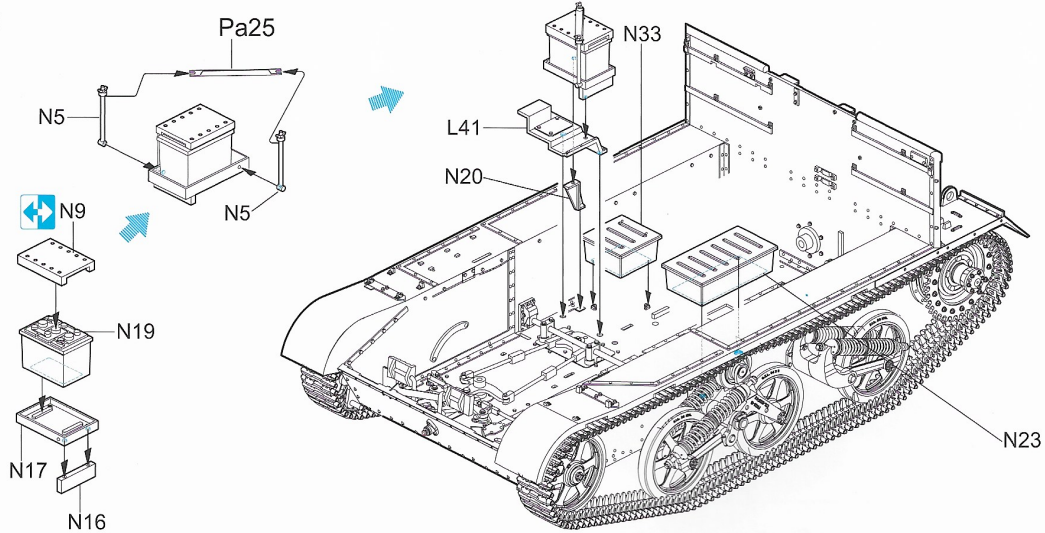

11

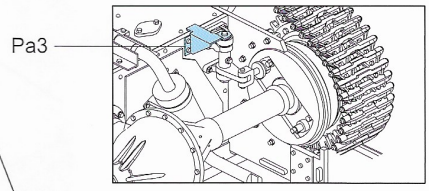
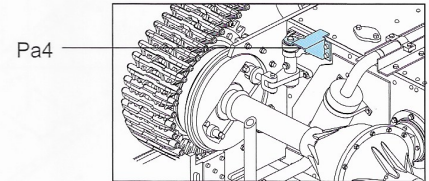
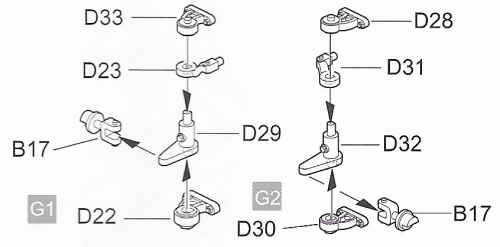
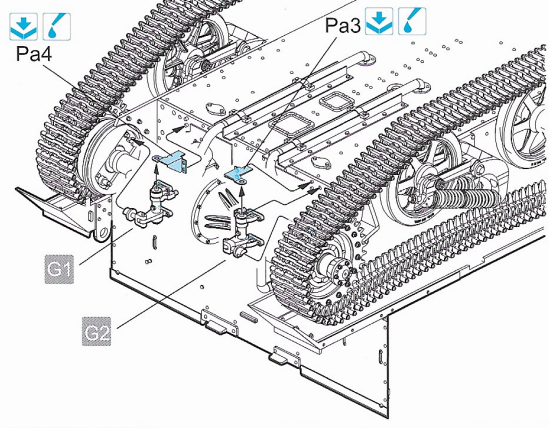

12

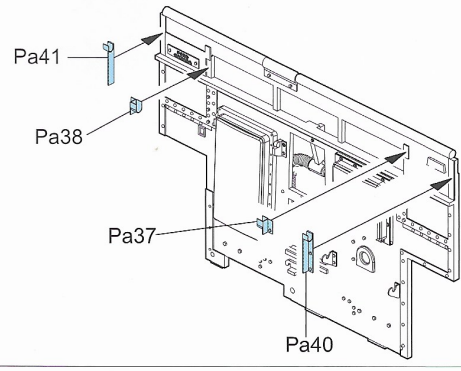
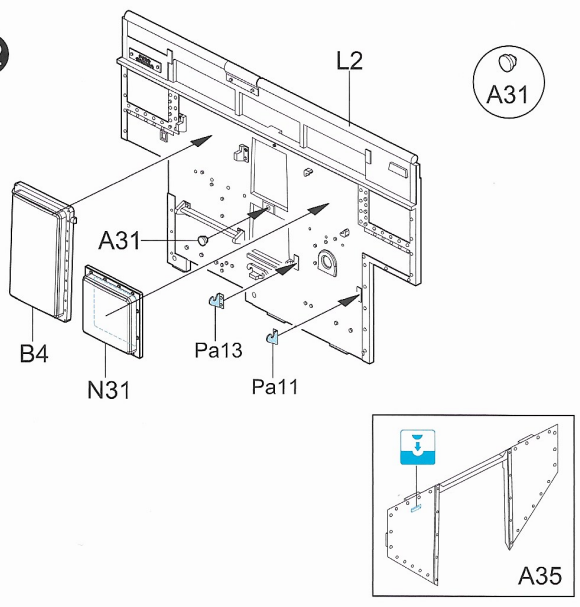



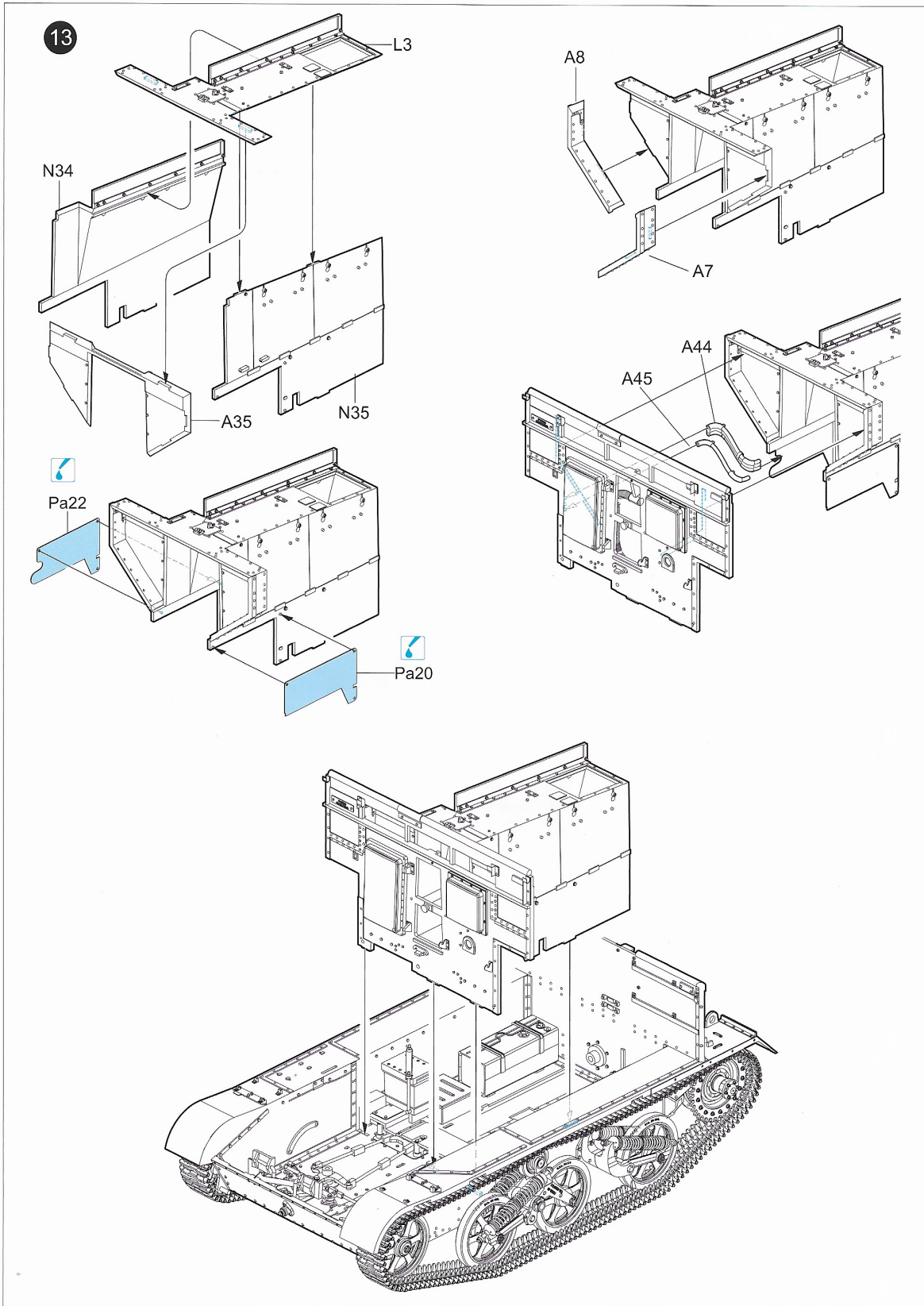

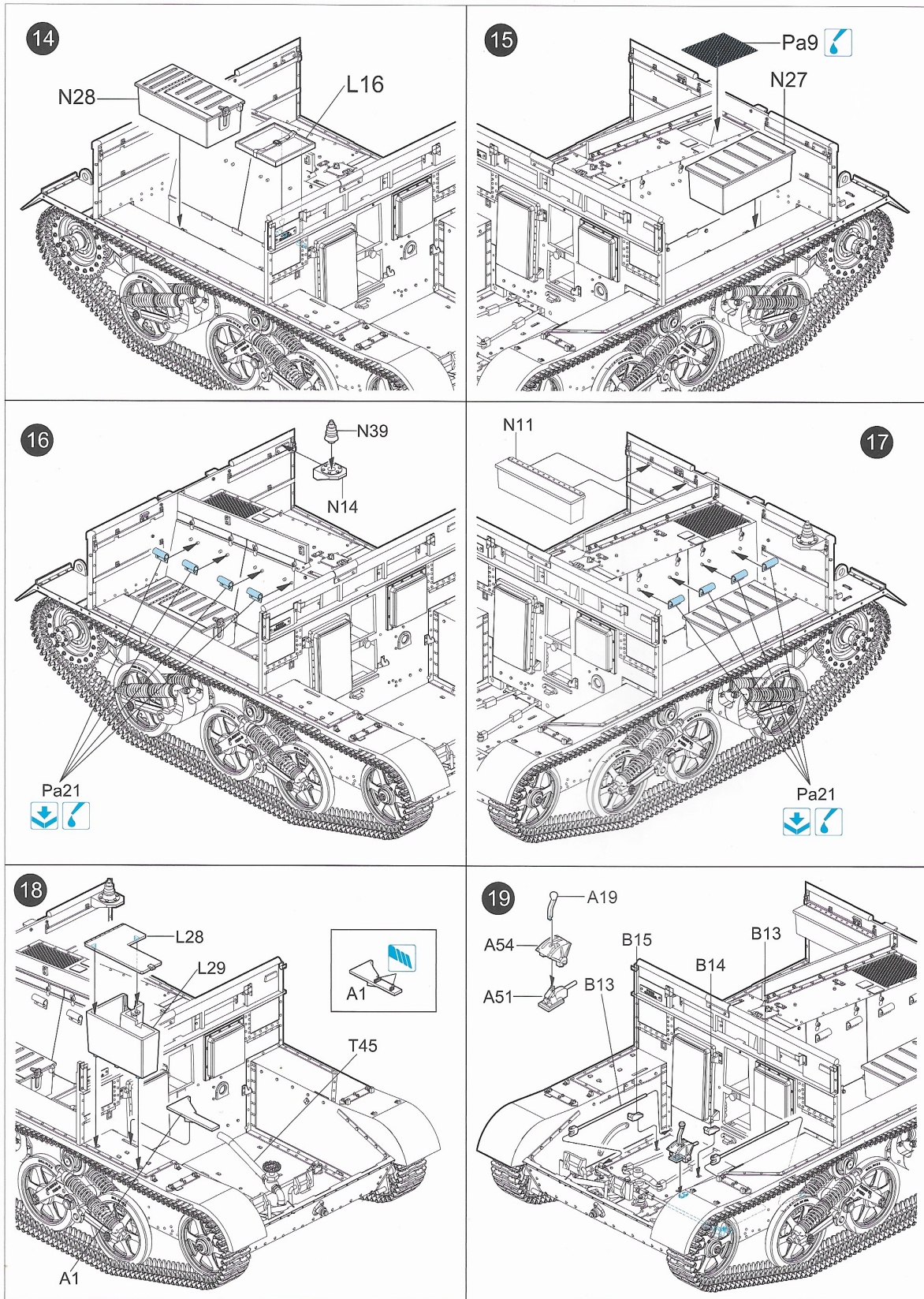

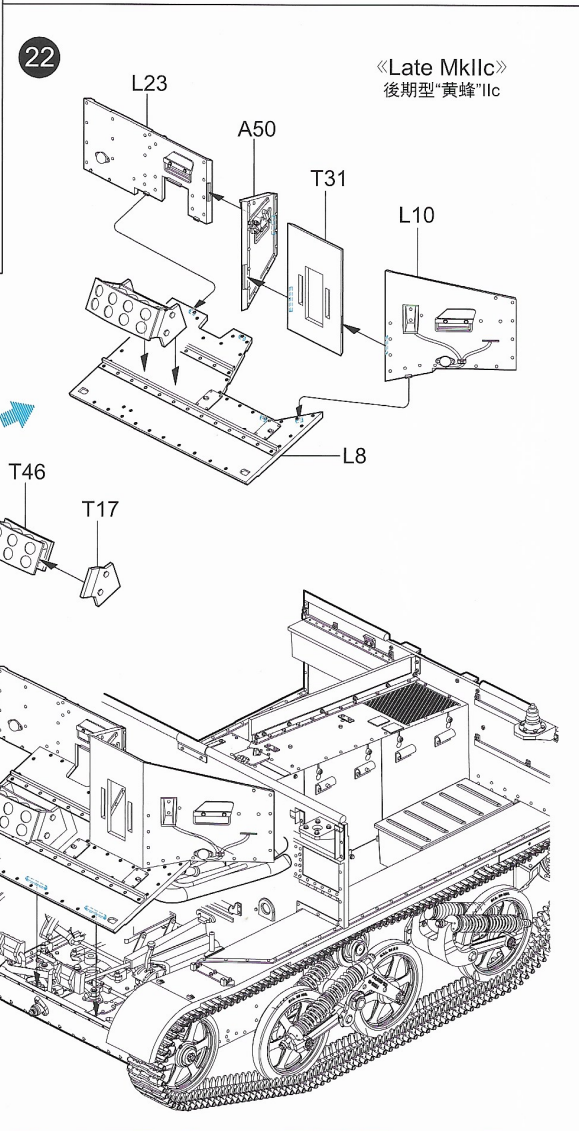
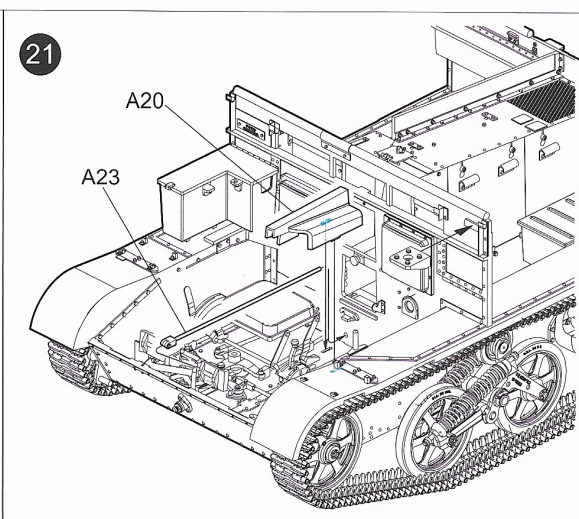
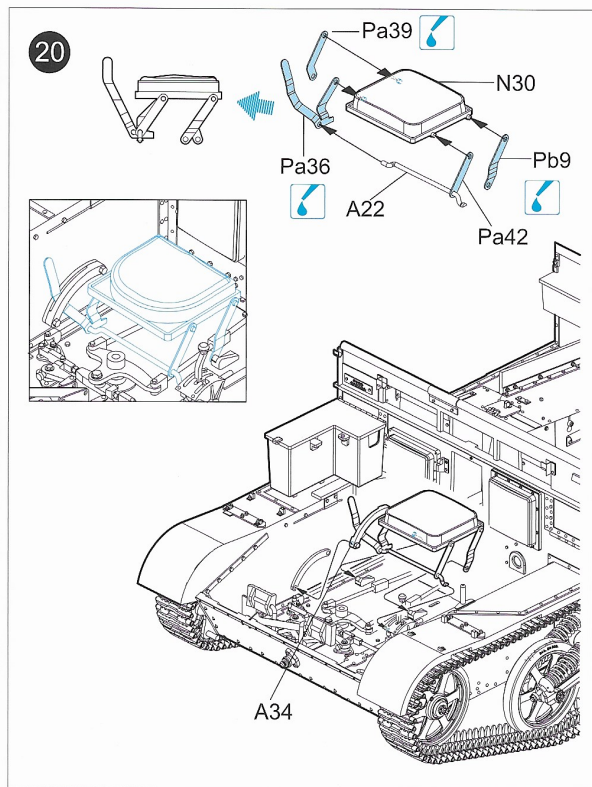

23

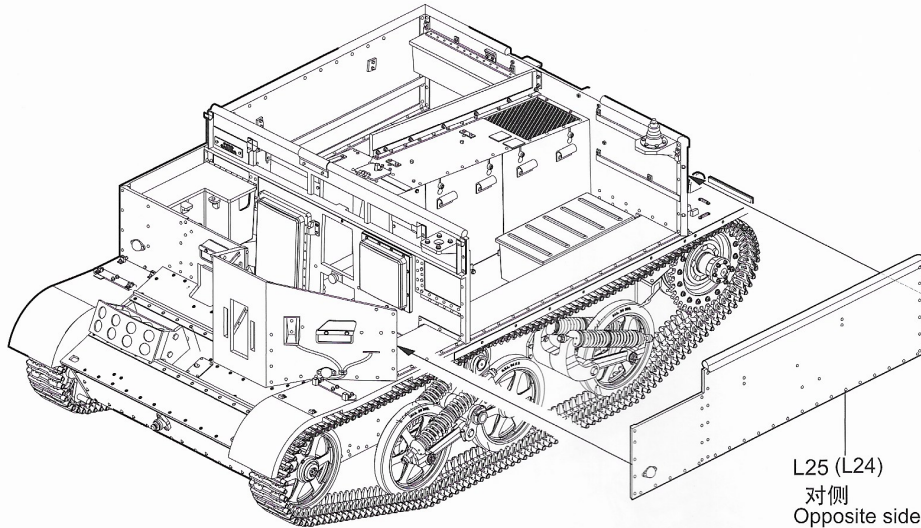

L25 (L24)  
对侧  
Opposite side

24

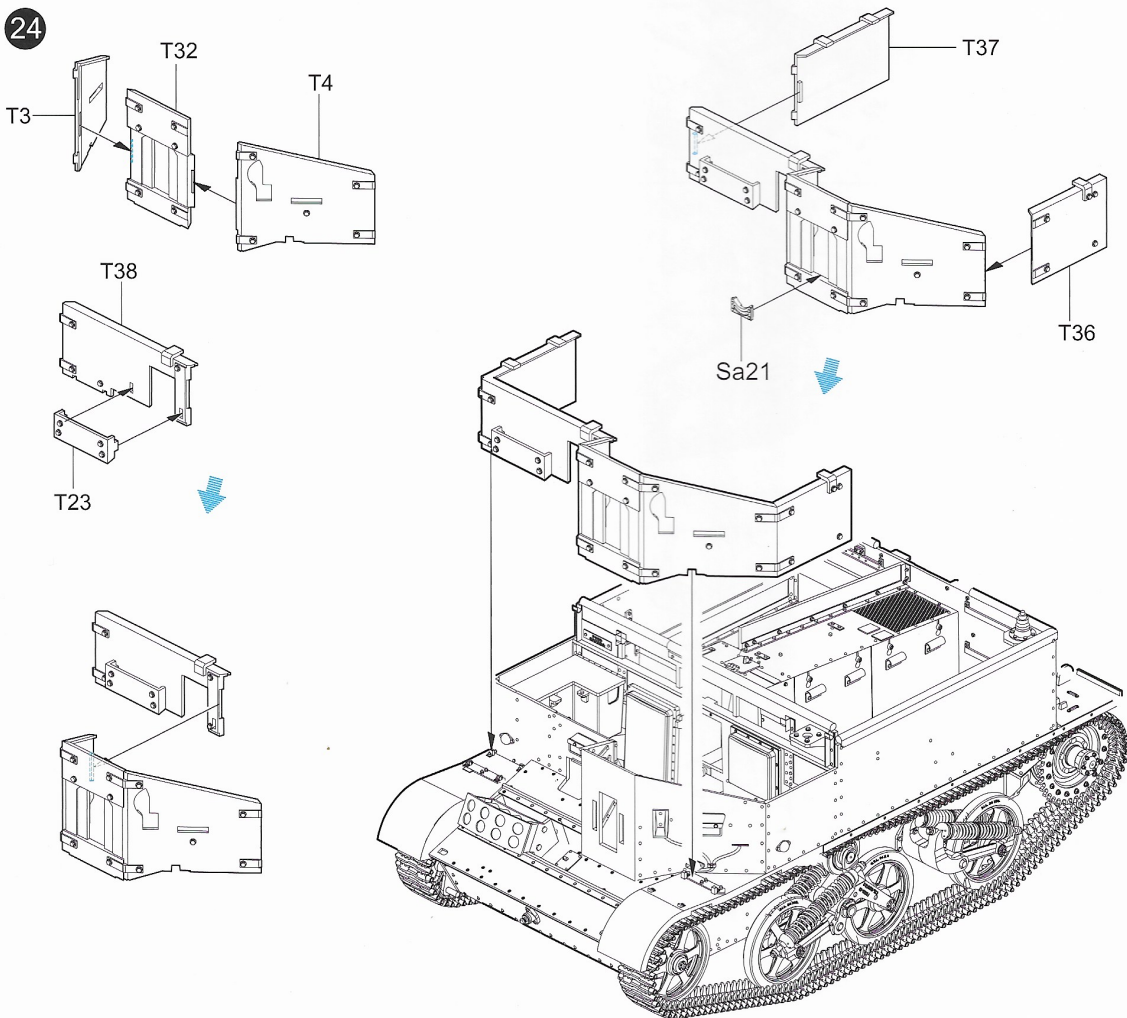

25

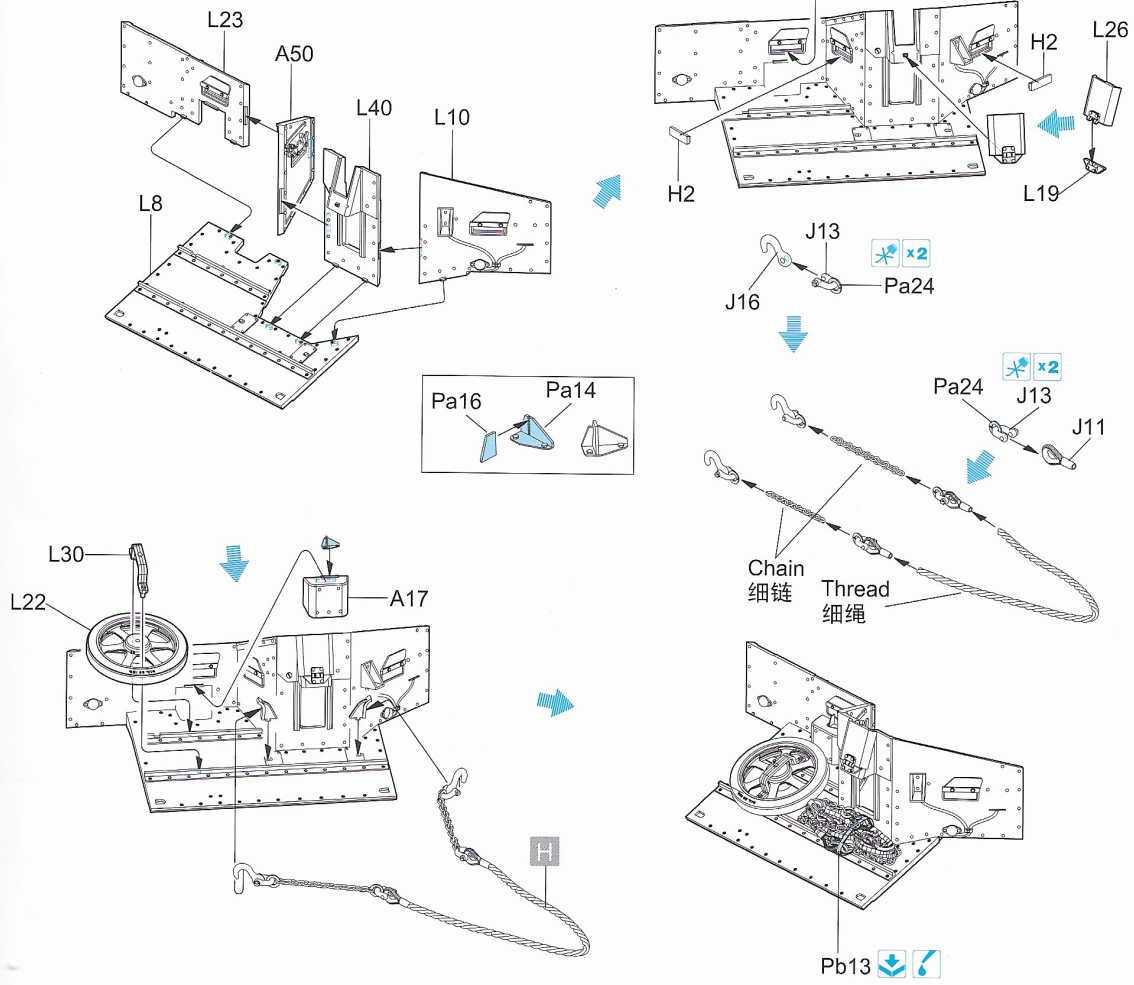

26

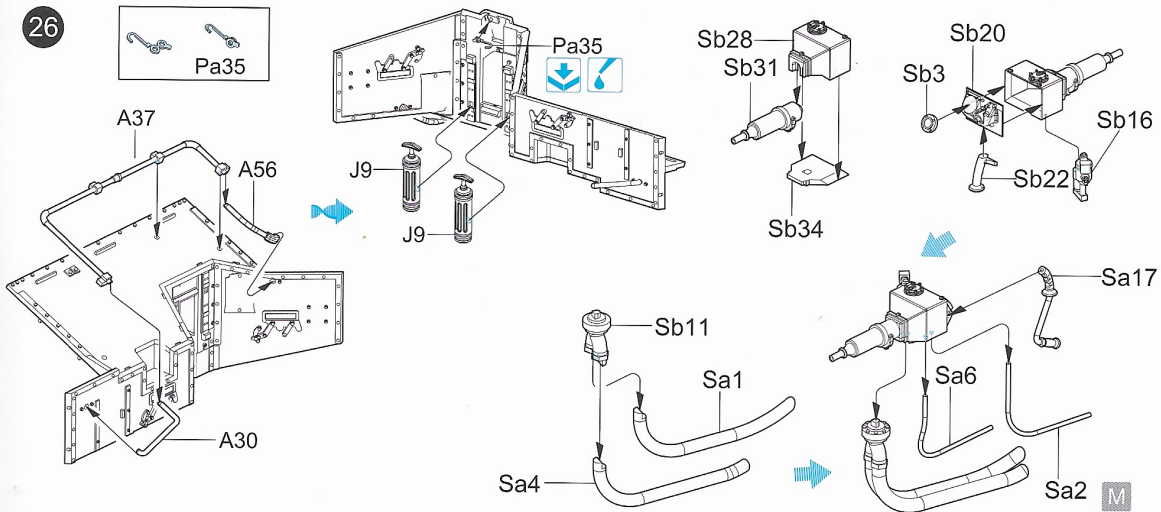

27

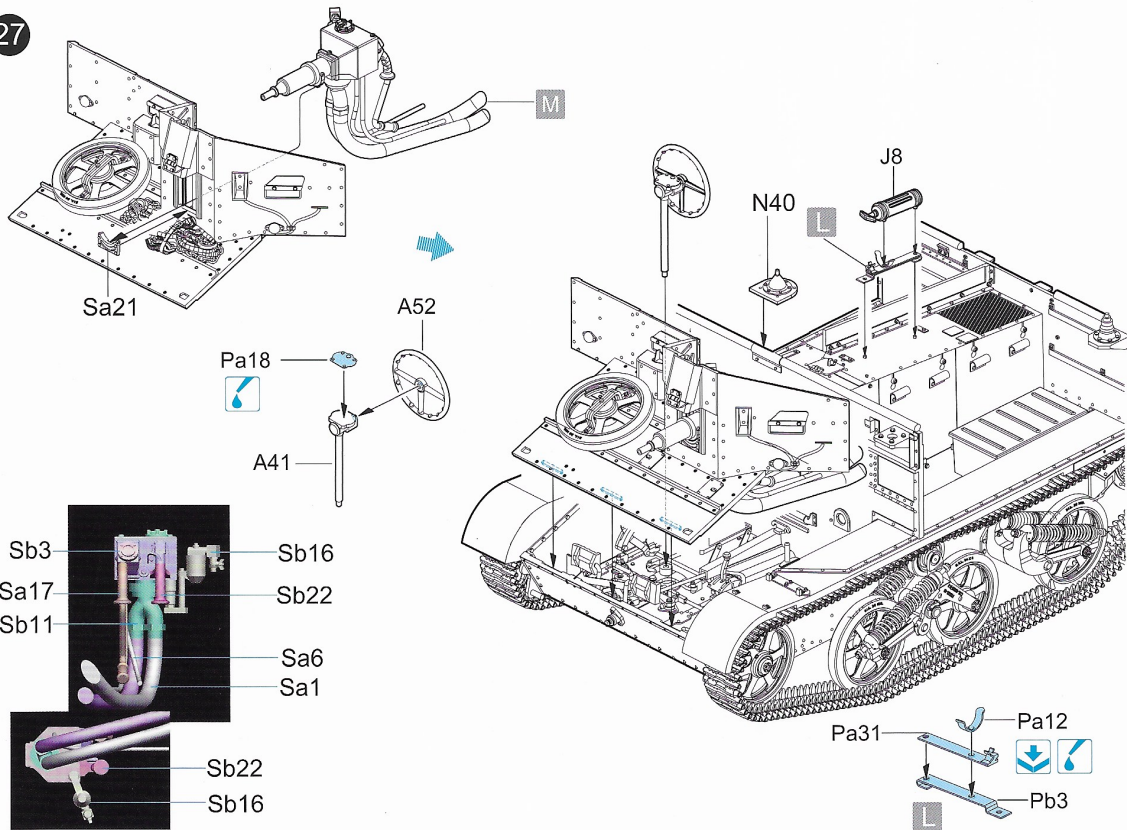

28

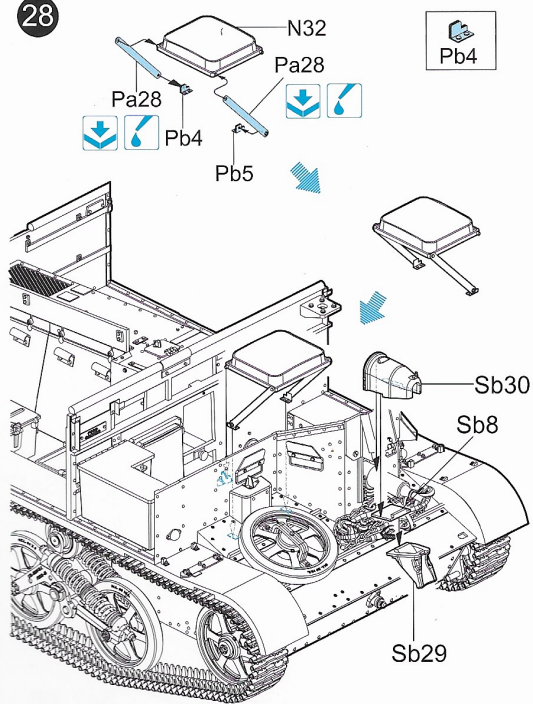

29

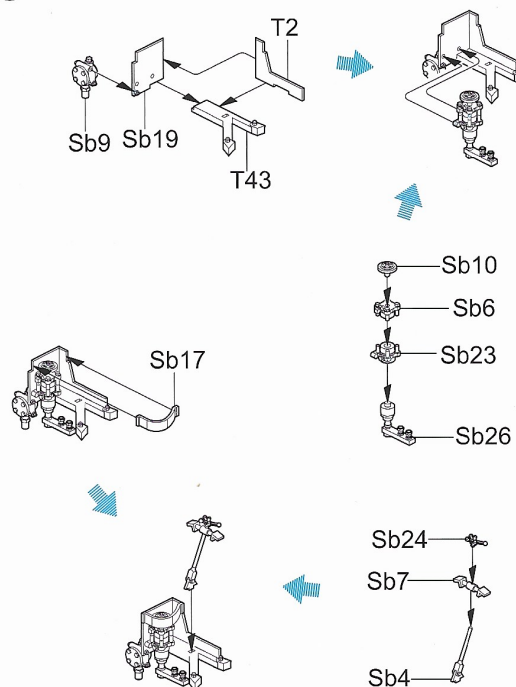

30

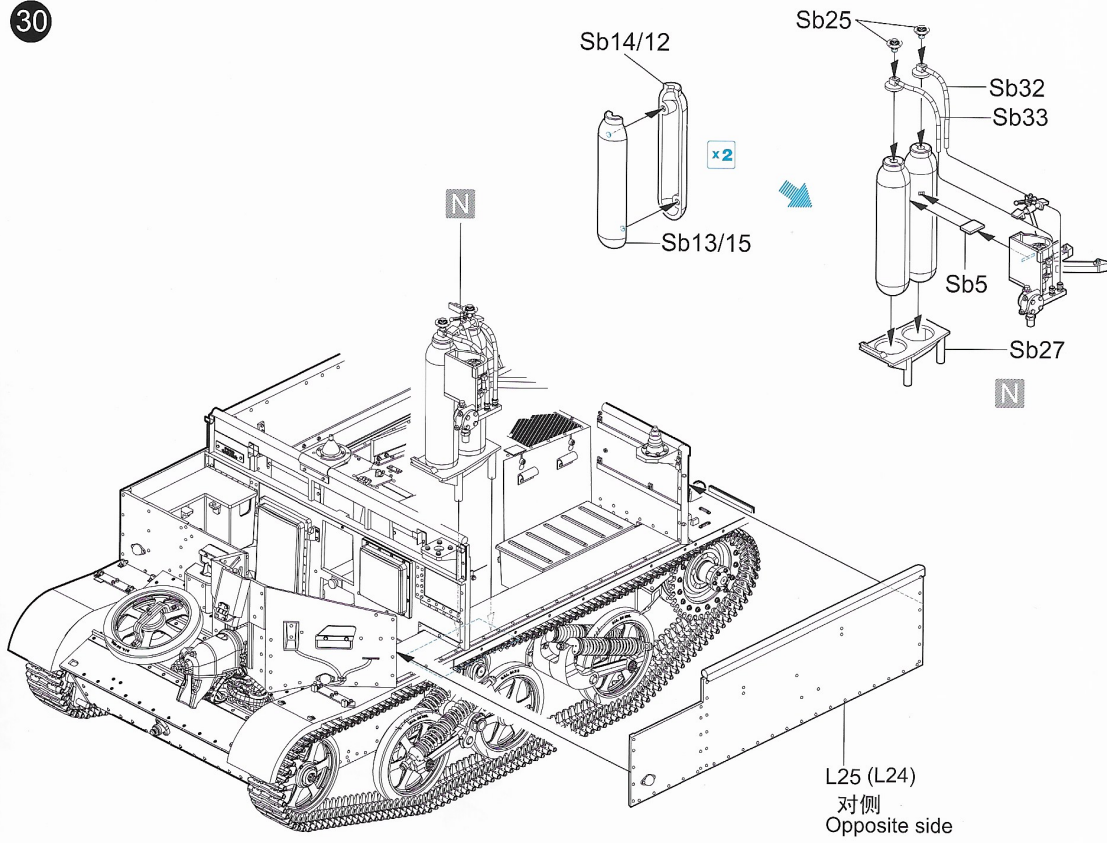

31

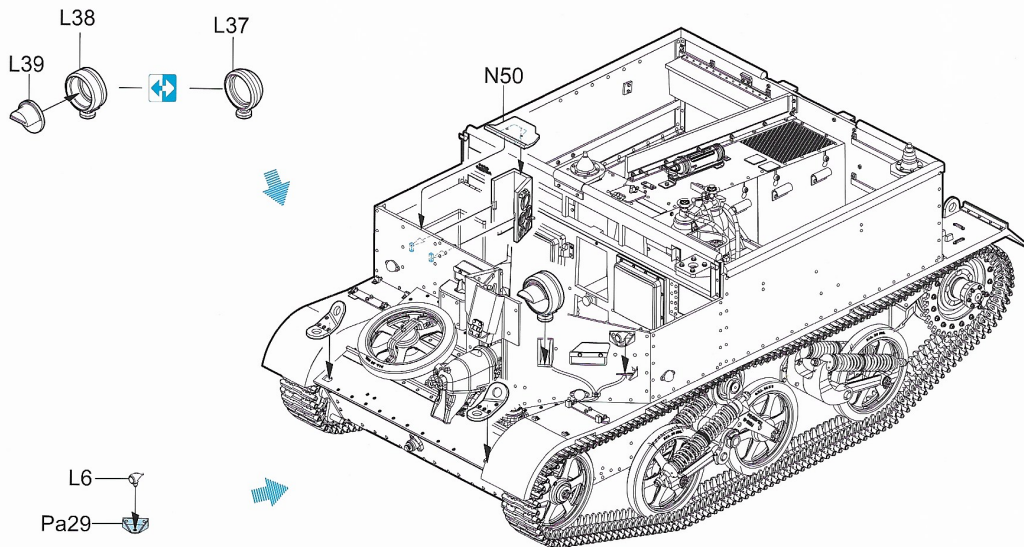

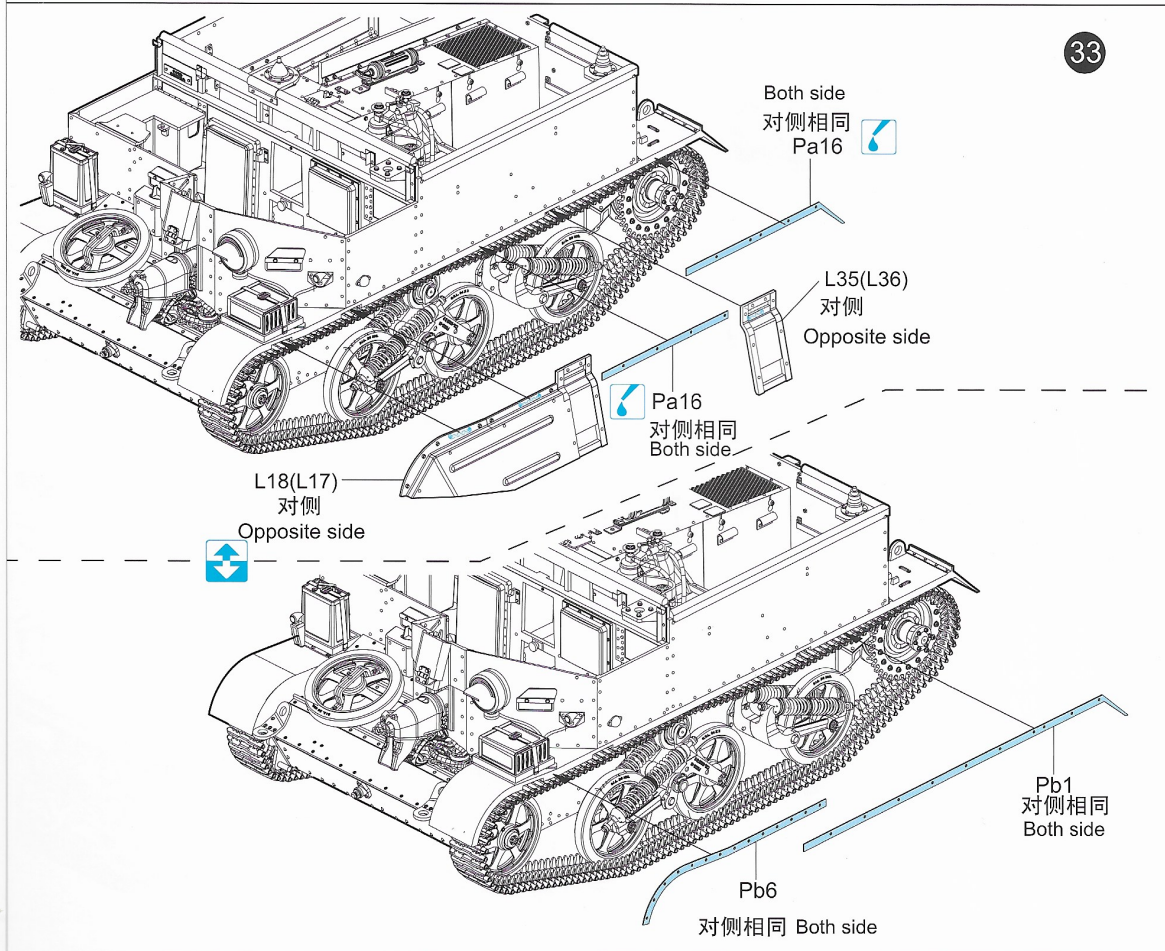
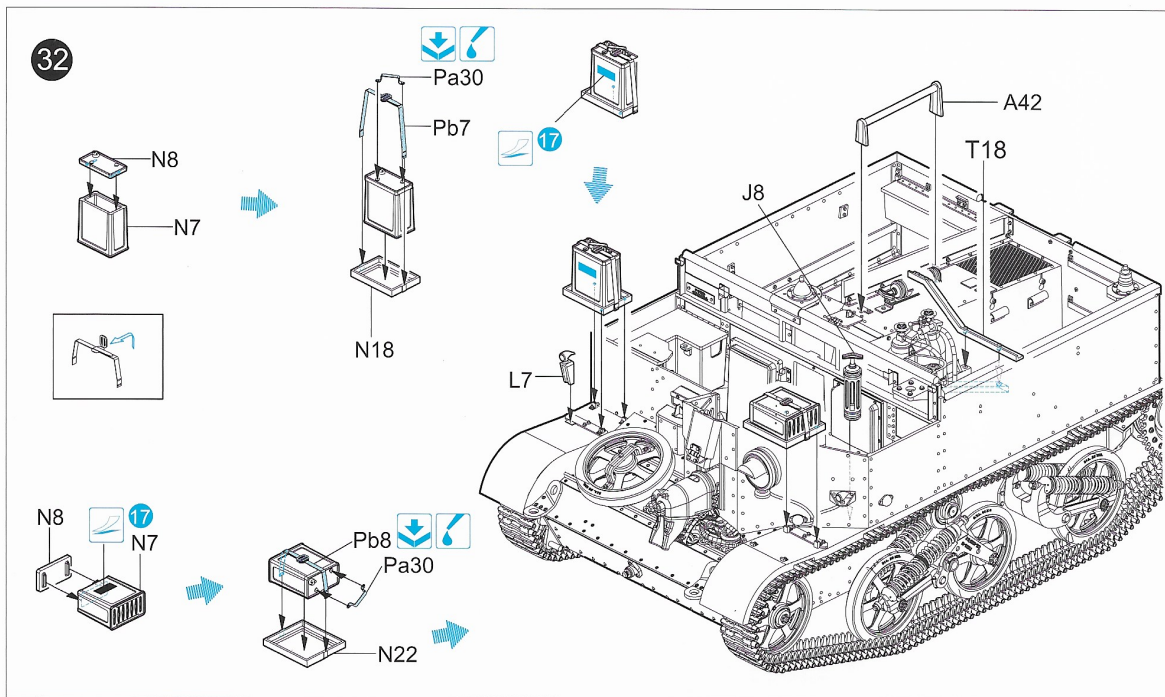



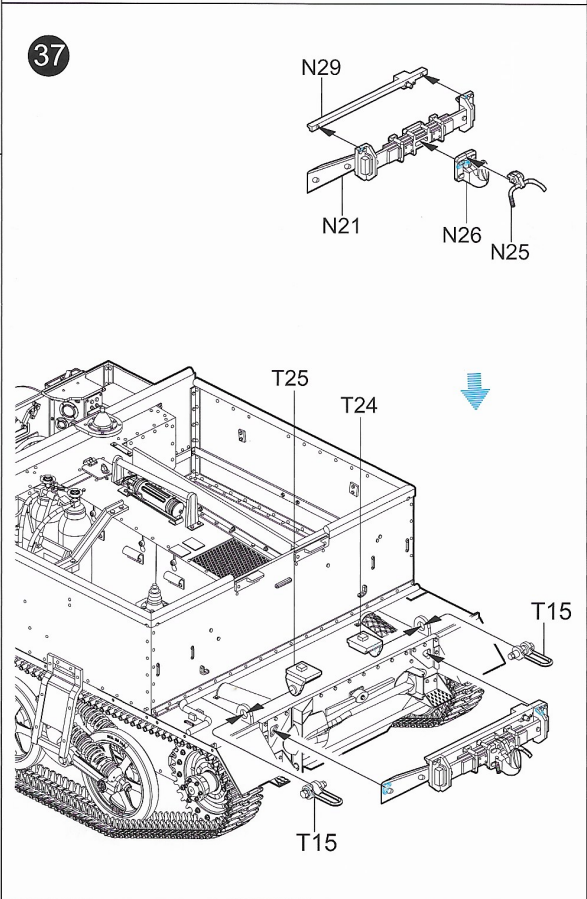
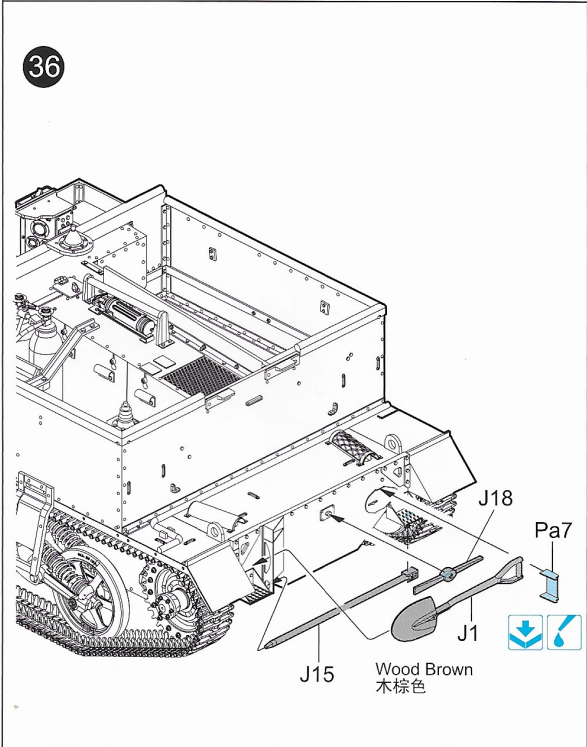
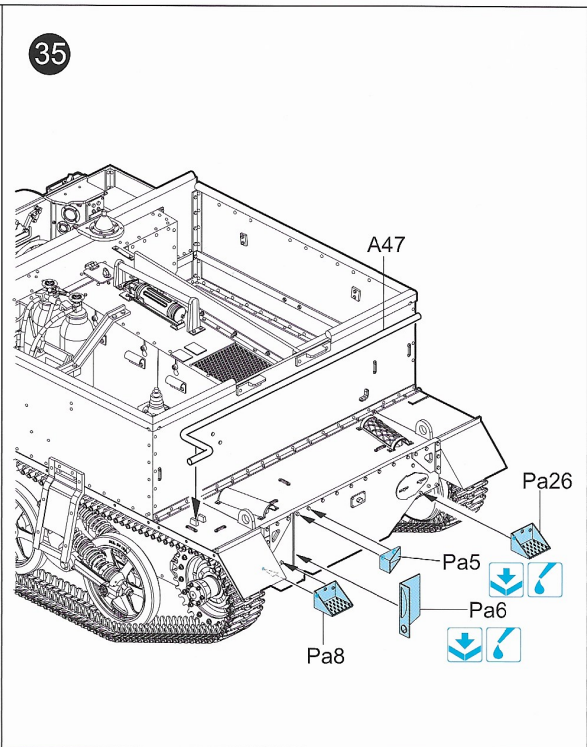
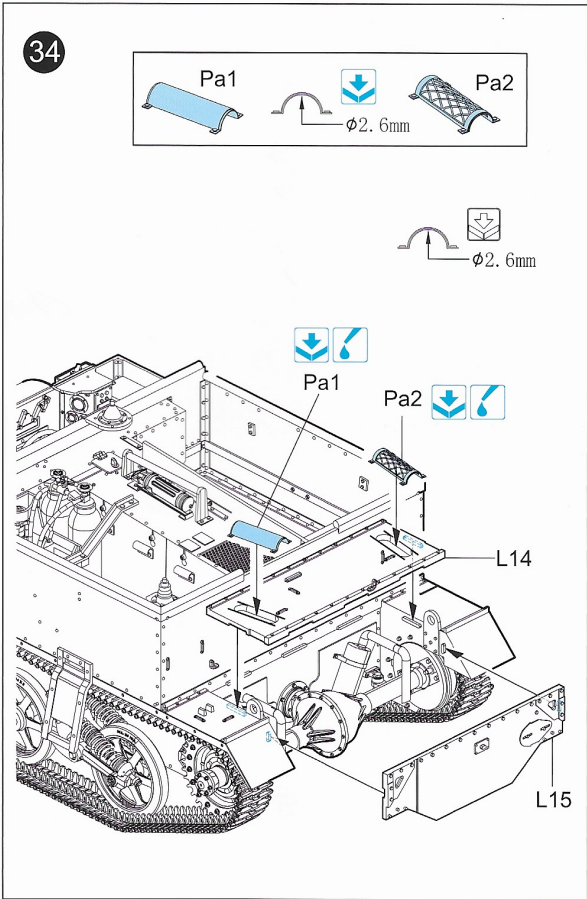

38

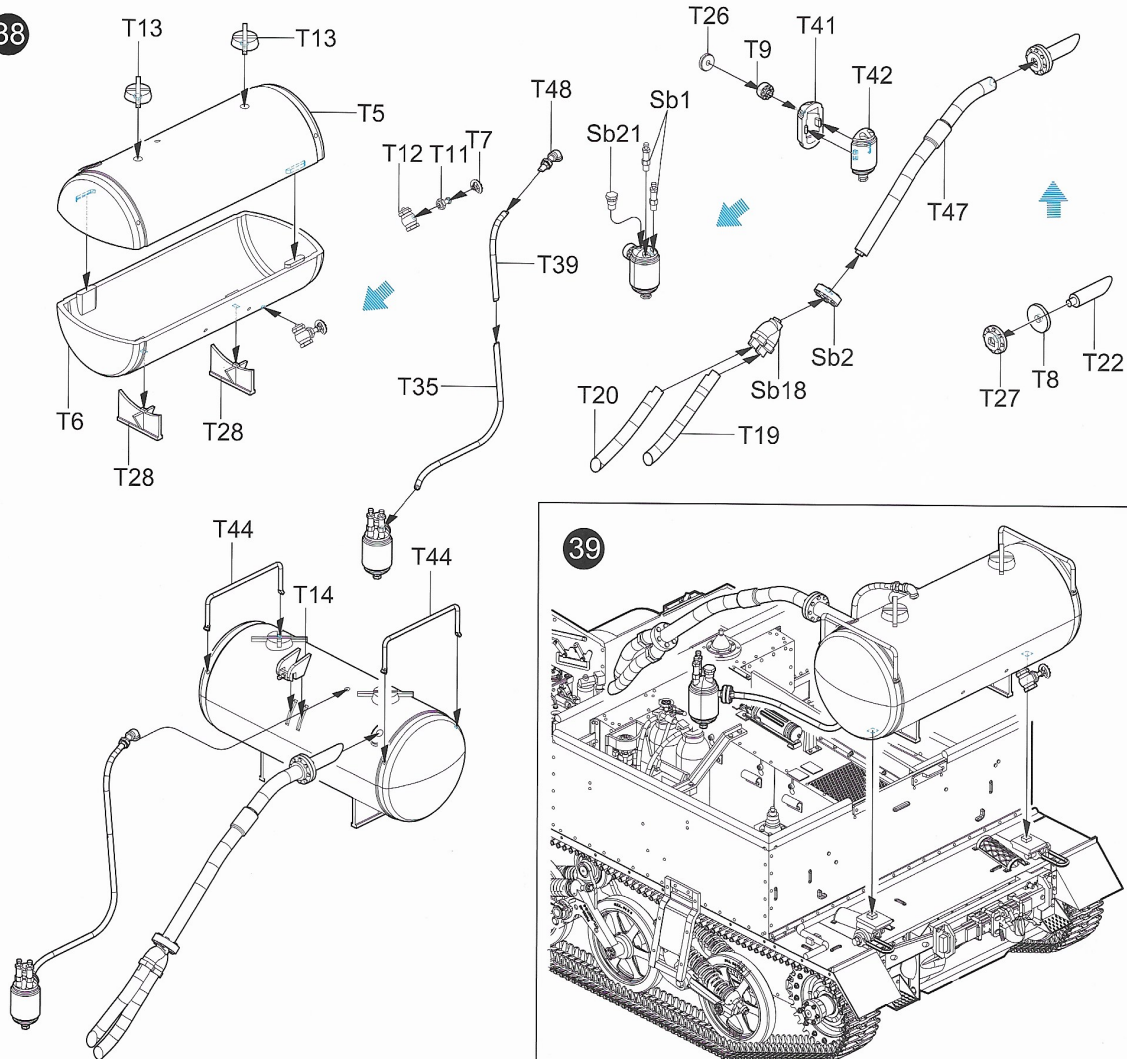

39

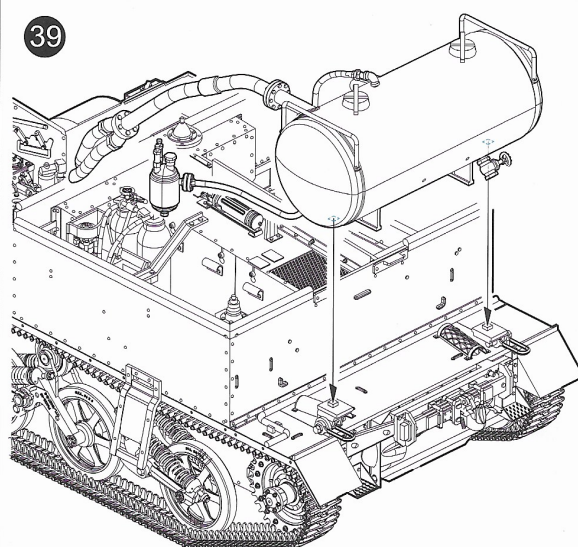

40

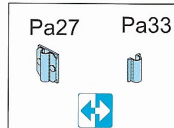
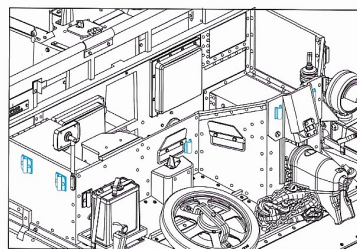
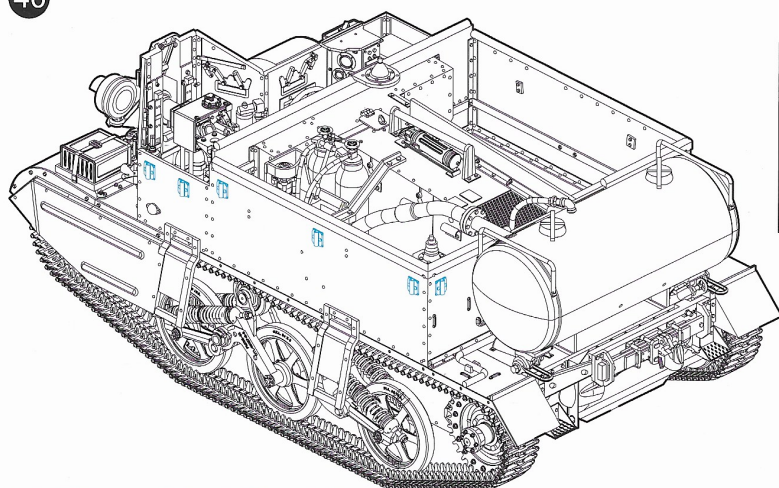

# MARKING & PAINTING 水贴与涂装指示

Option 1: CT267065 Universal Carrier Wasp IIC, Princess Patricia's Canadian Light Infantry, 1st Canadian Infantry Division, N.W. Europe.

加拿大第一步兵师，帕特里夏公主所属加拿大轻型步兵团，西北欧

Body color: Khaki Brown  
车颜色：卡其棕色

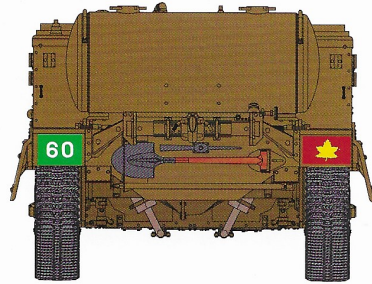
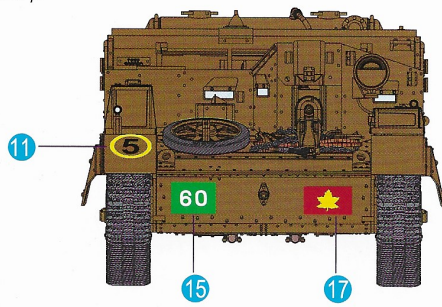
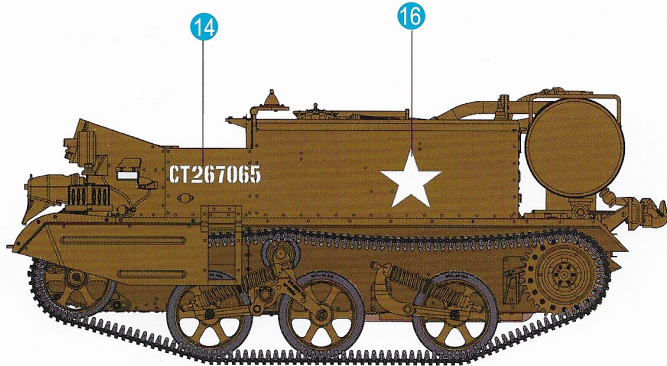

Option 2: T247649, Universal Carrier Wasp IIC, Polish 9th (Flanders) Rifle Brigade, 1st Armoured Division, Germany, 1945.

波蘭第一裝甲師，第9來復槍旅，德國，1945年

Body color: Khaki Drab G3  
車颜色：卡其綠色G3

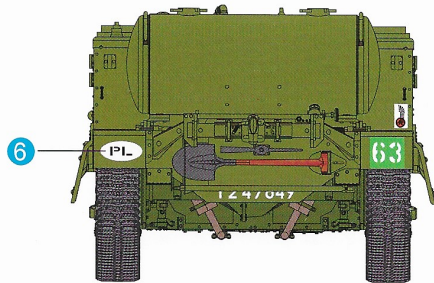
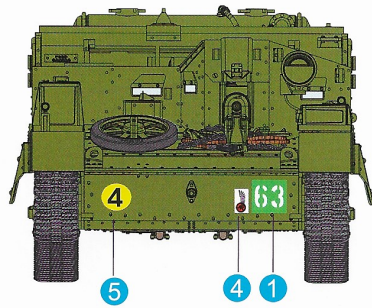
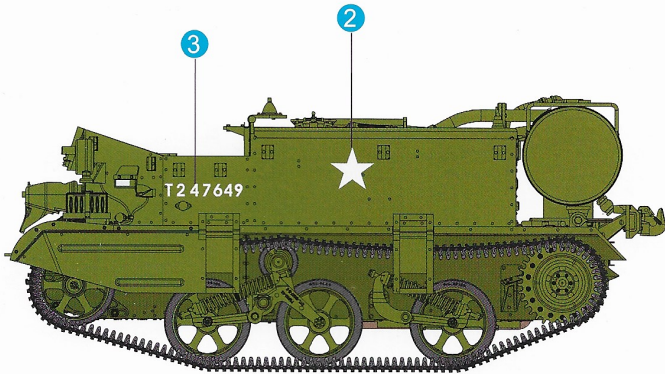

# MARKING & PAINTING 水贴与涂装指示

Option 3: Unknown census number, Wasp II C, 10th Battalion Highland Light Infantry, 15th (Scottish) Infantry Division, N.W. Europe.

英軍第15 (蘇格蘭) 步兵師, 高地輕步兵團第10營, 西北歐, 車號不明。

Body color: Khaki Drab G3  
車體色: 卡其綠色G3

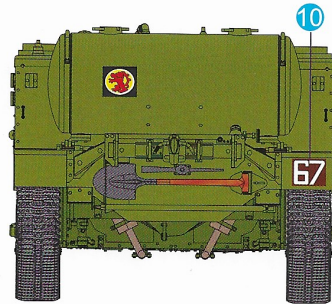
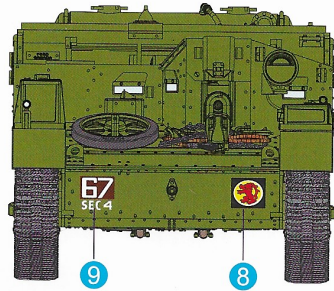
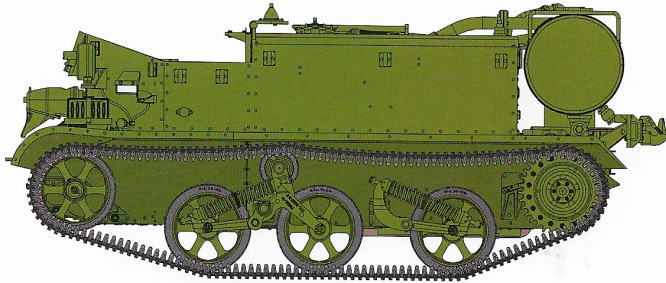

Option 4: Unknown census number, Late Wasp II C, The Royal Regiment of Canada, 2nd Canadian Infantry Division, Holland, 1944.

“黃蜂” II C後期型, 加拿大第2步兵師, 加拿大皇家方團, 荷蘭, 1944, 車號不明。

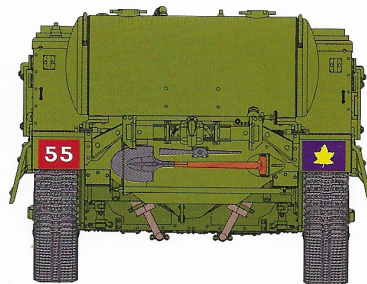
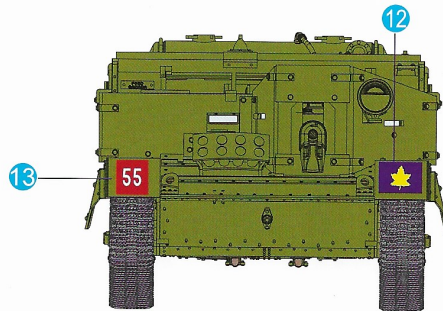
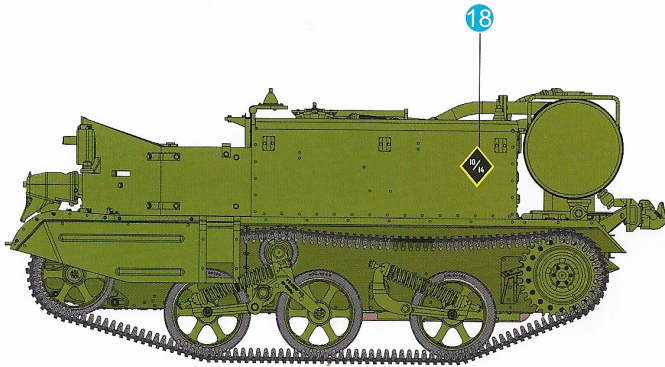

Colour	塗料號	Mr. Hobby	Vallejo	Colour	塗料號	Mr. Hobby	Vallejo
A	Khaki Drab G3	卡其綠色	H 80 54 988	E	Tyre Black	輪胎色	H 77 157 -
B	Khaki Brown	卡其棕色	H 404 879	F	Steel	黑灰色	H 118 28 864
C	Flesh	肌膚色	H 44 51 955	G	Leather	皮革色	H 810 310 818
D	Wood Brown	木棕色	H 37 43 843	H	Silver	銀色	H 8 8 997

\*Some paints may not be available in your country, Please check your local hobby shop for substitute.