

PV-1 Ventura



The United States Navy operated the PV-1 Ventura throughout WWII as both a long- range patrol bomber and as a gunship used to attack enemy ground targets and shipping.

The new Minicraft PV-1 kit offers 3 sets of markings representing aircraft operated by the U.S. Navy in the South Pacific, the Royal Air Force, and the Royal Australian Air Force.

Marking included in this kit are:

U.S. Navy PV-1, VB-142, Tarawa, July 1944

Royal Australian Air Force, No 13 Sqn, 1944

Royal New Zealand Air Force, No 1 (BR) Sqn, mid-1943

Minicraft Models, 1501 Commerce Drive, Elgin IL 60123 USA

www.minicraftmodels.com

PARTS LOCATING DIAGRAM

SPRUE A

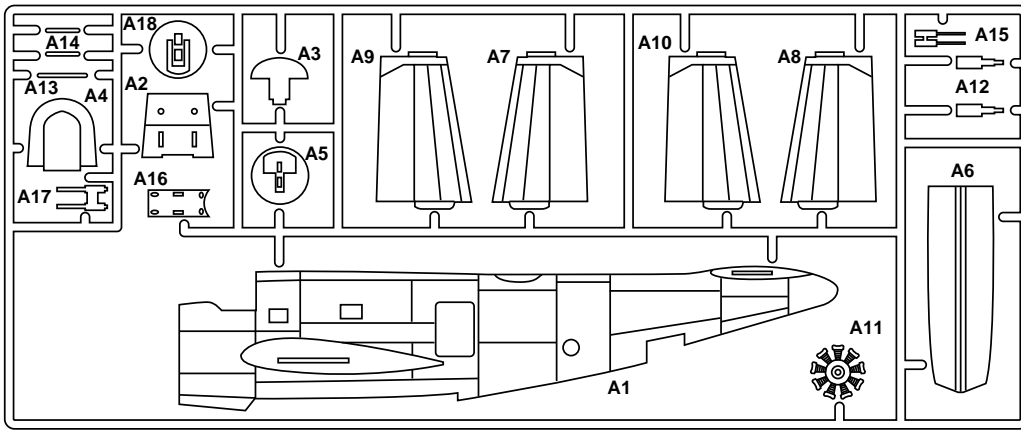

CLEAR SPRUE E

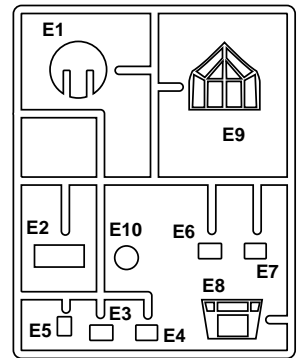

SPRUE B

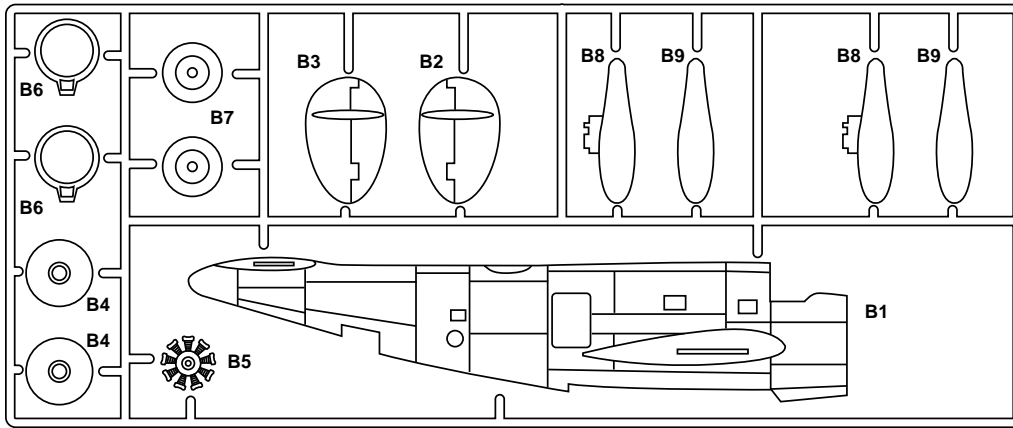

CLEAR SPRUE E

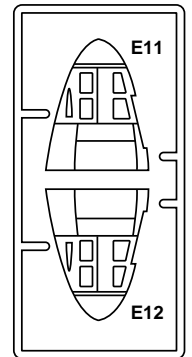

SPRUE C

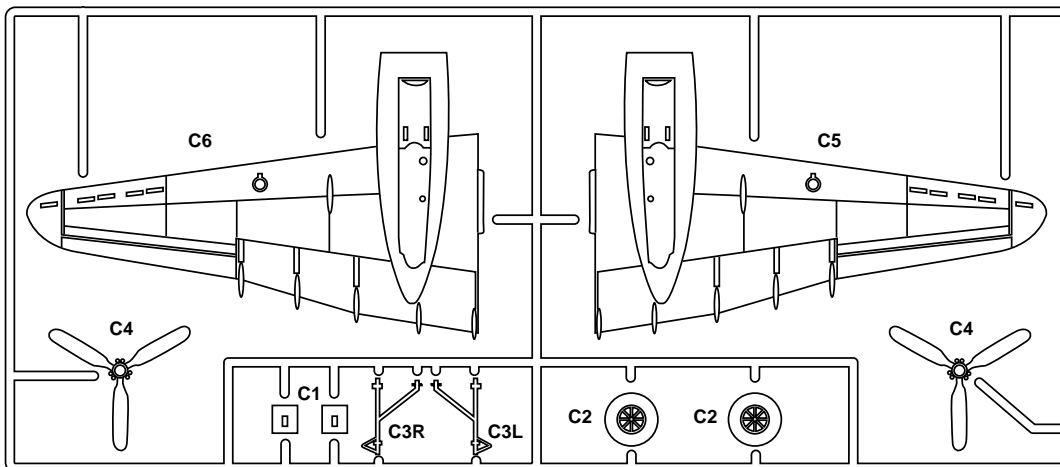

SPRUE D

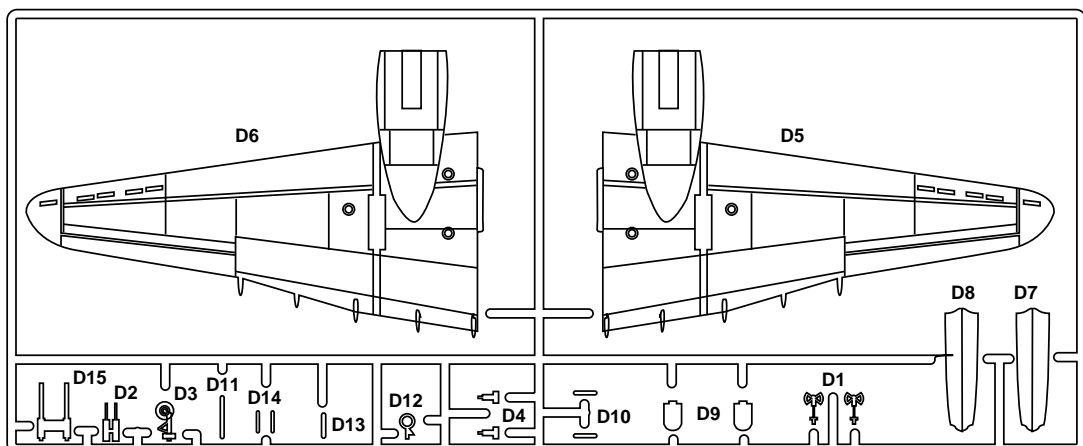



Cement Coller
Kleben
Pegar
Incollare
Colar
Kleven



DO NOT Cement
Ne pas Coller
Nicht Kleben
No Pegar
Non Incollare
Nao Colar
Niet Kleven



Cut away
Couper
Scheiden
Cortar
Tagliere
Cortar
Snijden



Optional parts
Choix
Auswahlmoglichkeit
Eleccion
Scelta
Opaco
Keuze



Repeat operation
R peeter l' op ration
Vorgang wiederholen
Repitir la operacion
Ripetere
Repitir a opera ao
Herhalen



Symmetrical assembly



Drill hole

1 INTERIOR / TURRET



All Parts

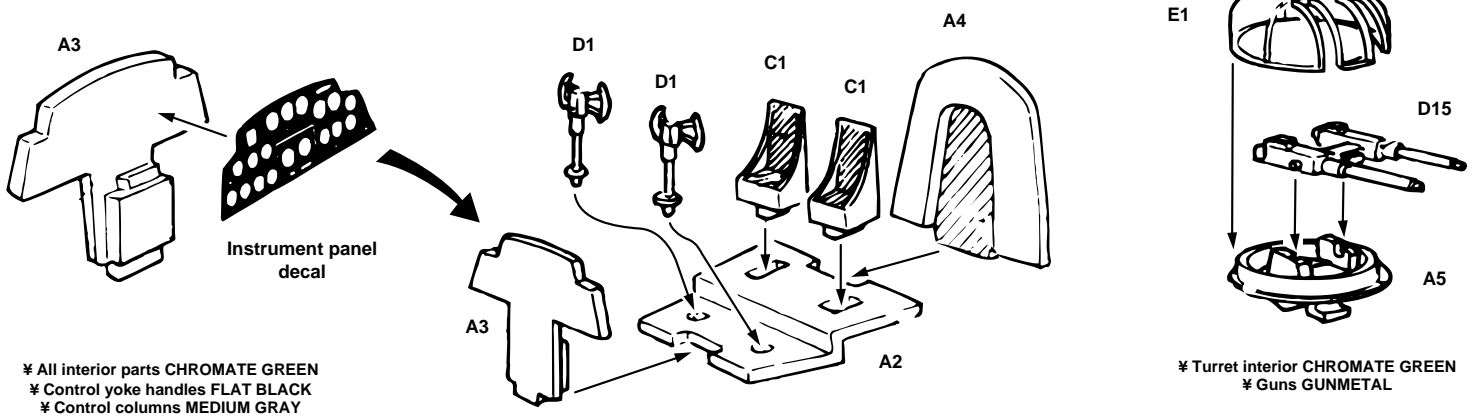

2 COCKPIT AND TURRET INSTALLATION

NOTE

Fill in engraved panels as shown in Gray before assembly

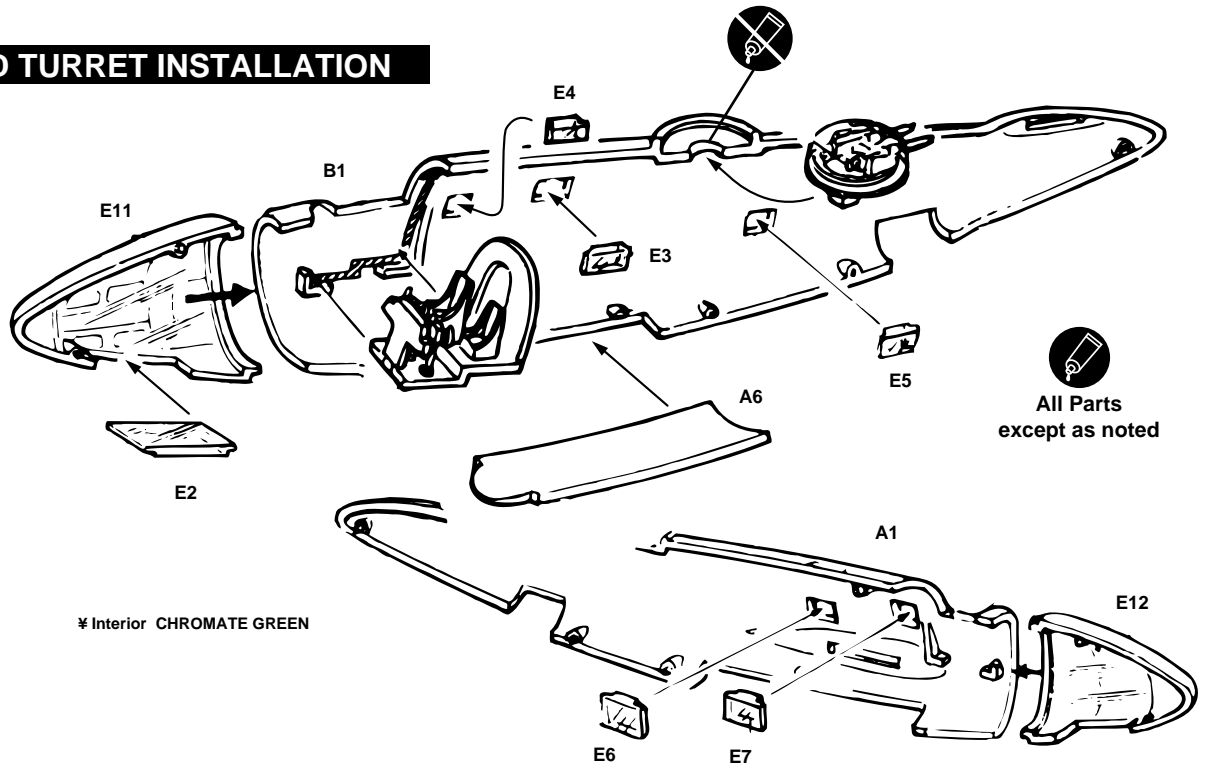

3 FUSELAGE ASSEMBLY

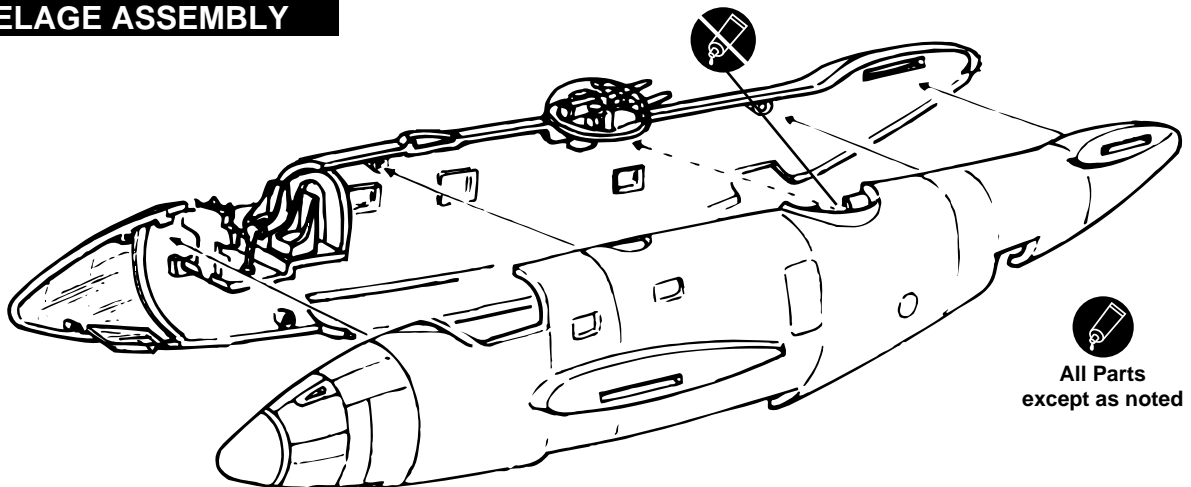

4 CANOPY INSTALLATION

 All Parts

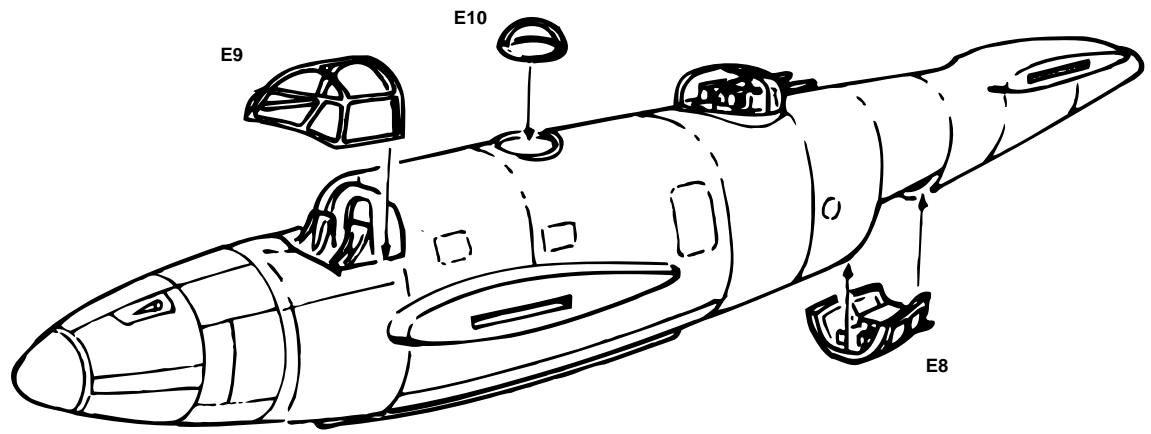

5 TAIL ASSEMBLY

 All Parts

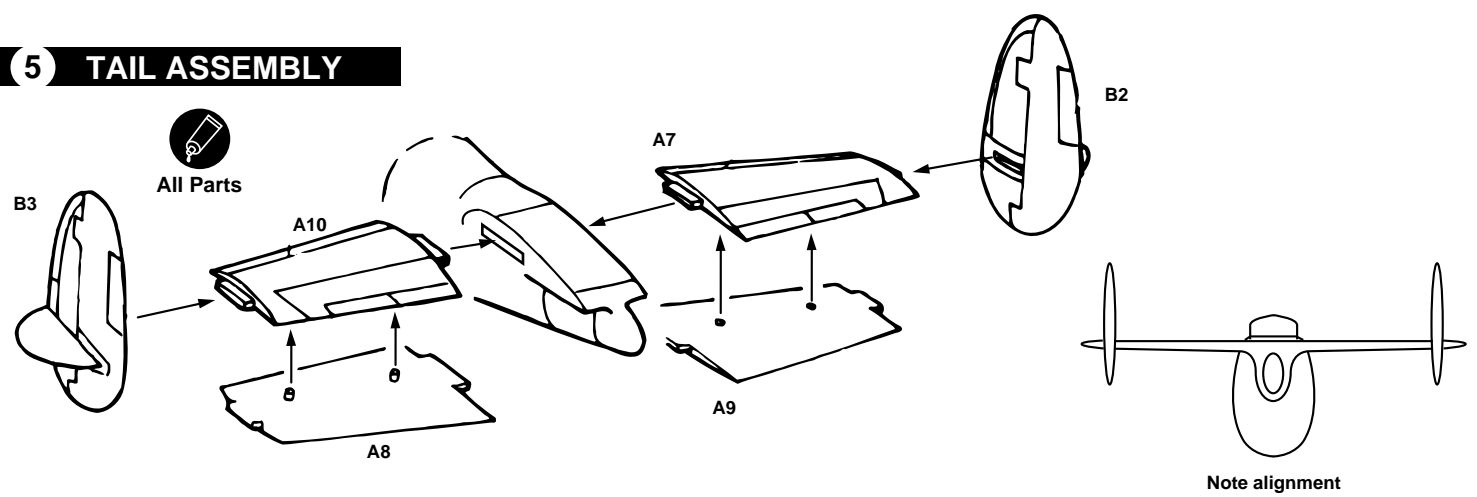

6 ENGINE ASSEMBLY

 All Parts except as noted

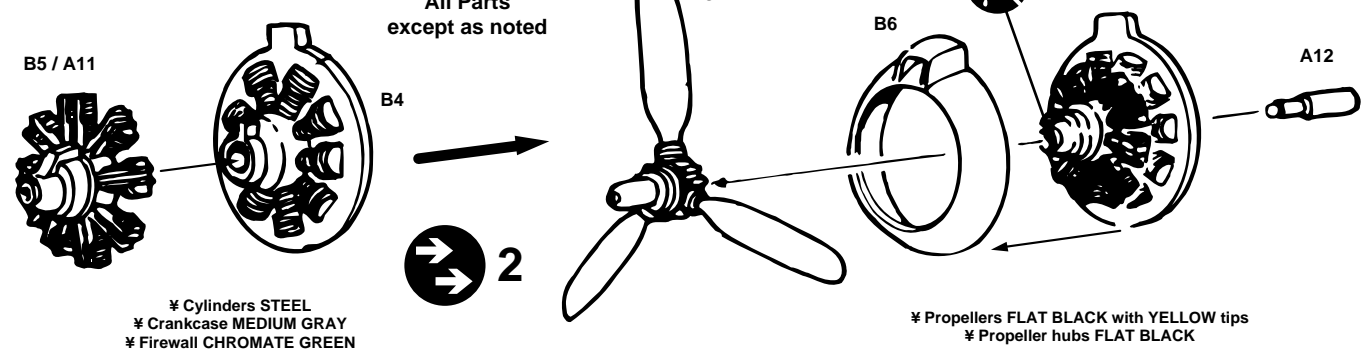

7 MAIN LANDING GEAR

 All Parts

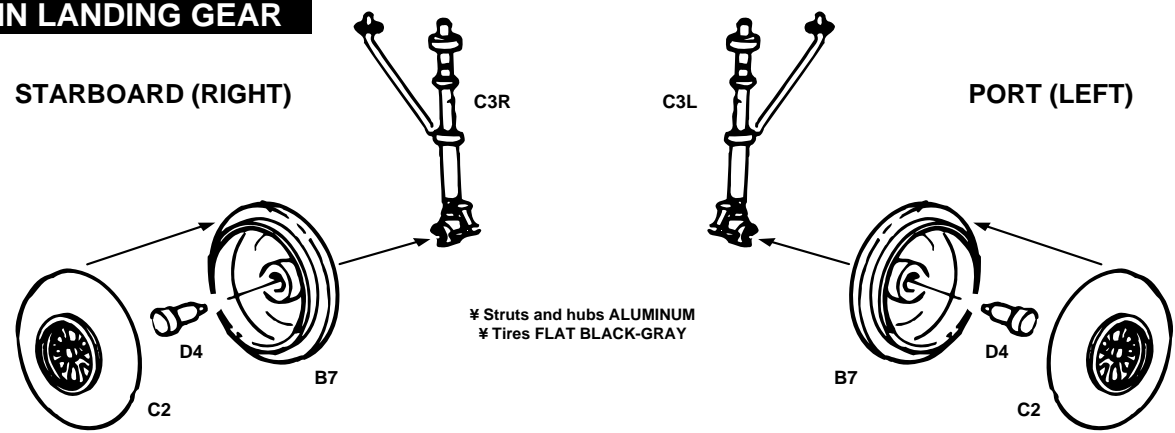

8 PORT (LEFT) WING ASSEMBLY



All Parts

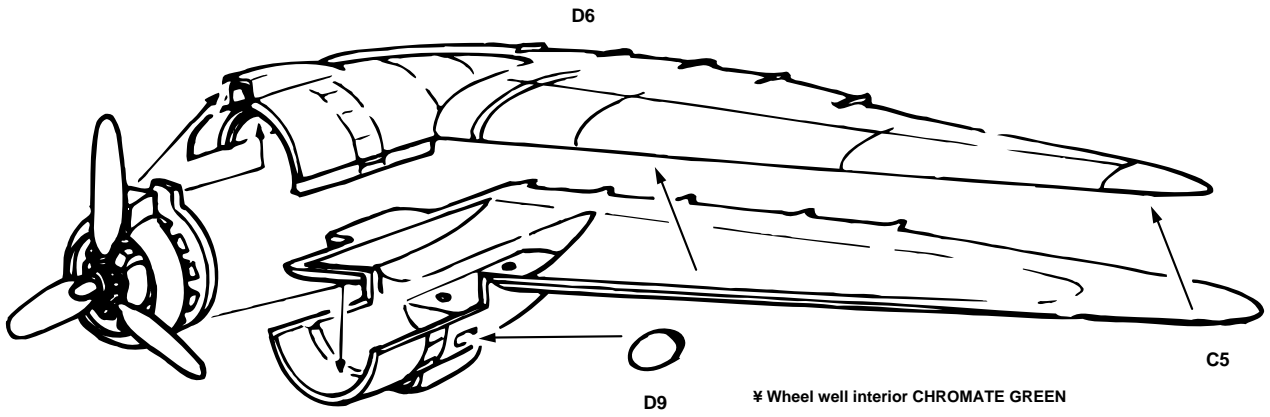

9 STARBOARD (RIGHT) WING ASSEMBLY



All Parts

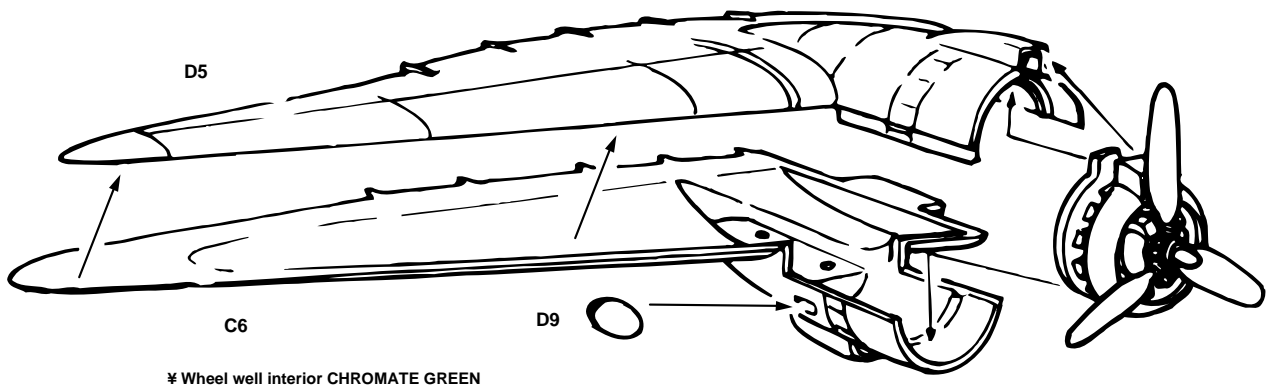

10 WING INSTALLATION

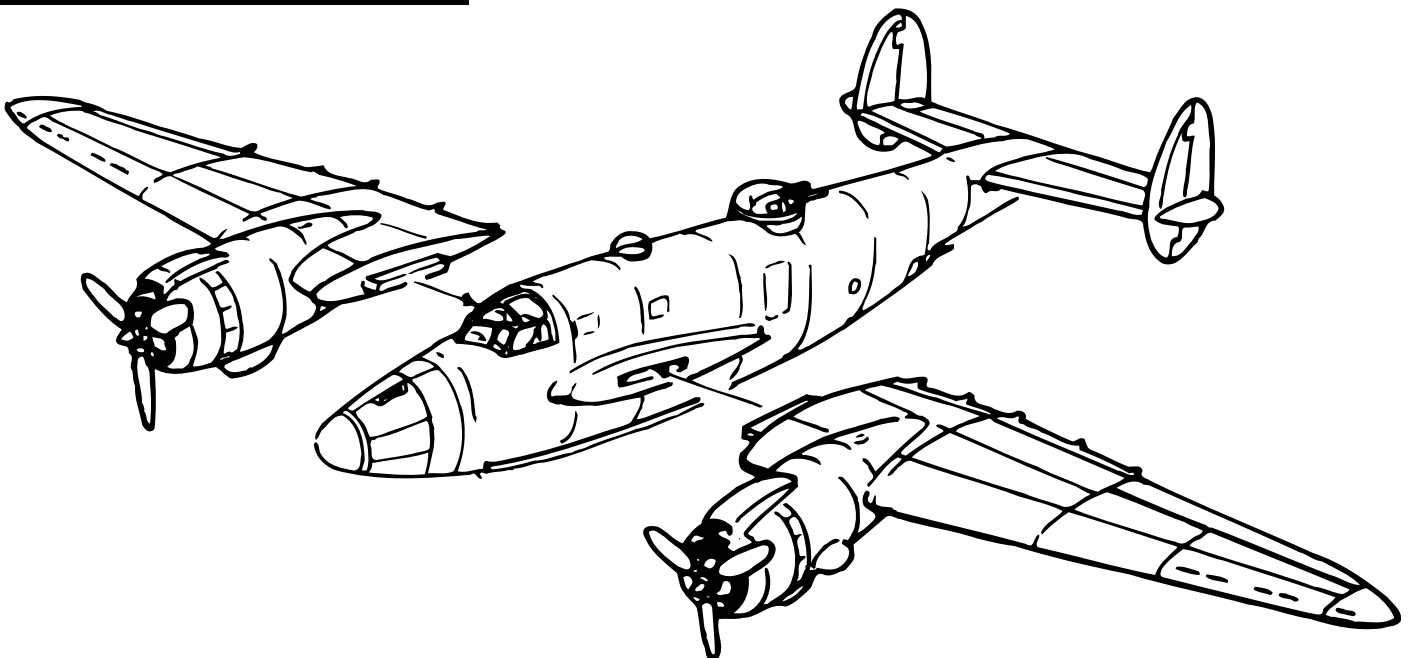

11 LANDING GEAR INSTALLATION

EXTENDED MAIN GEAR

Cut parts D7/D8 in half as shown

RETRACTED MAIN GEAR OPTION

‡ Gear door interiors CHROMATE GREEN
 ‡ Tailwheel strut ALUMINUM
 ‡ Tire FLAT BLACK-GRAY

All Parts

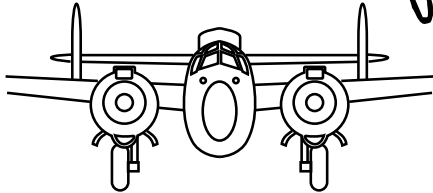
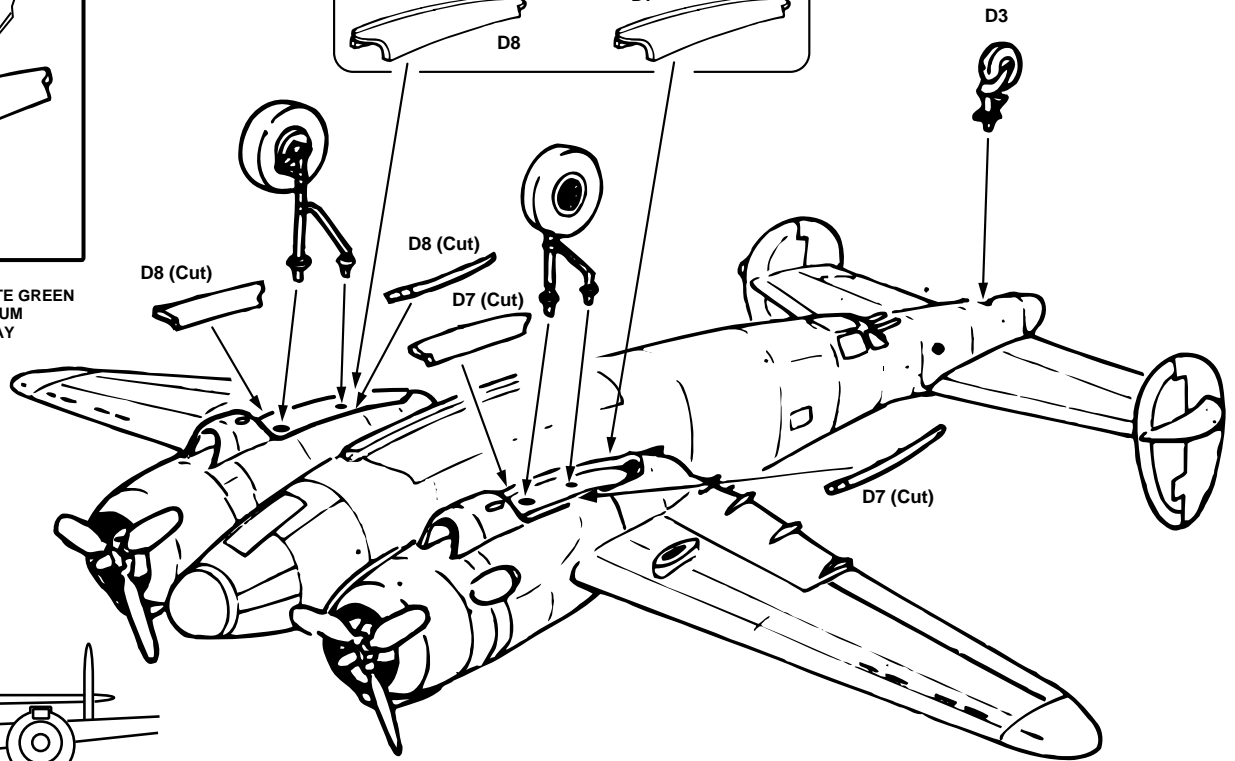

Note alignment

12 FINAL ASSEMBLY

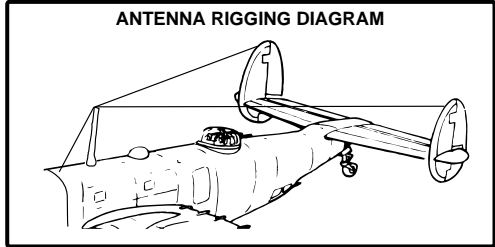

All Parts

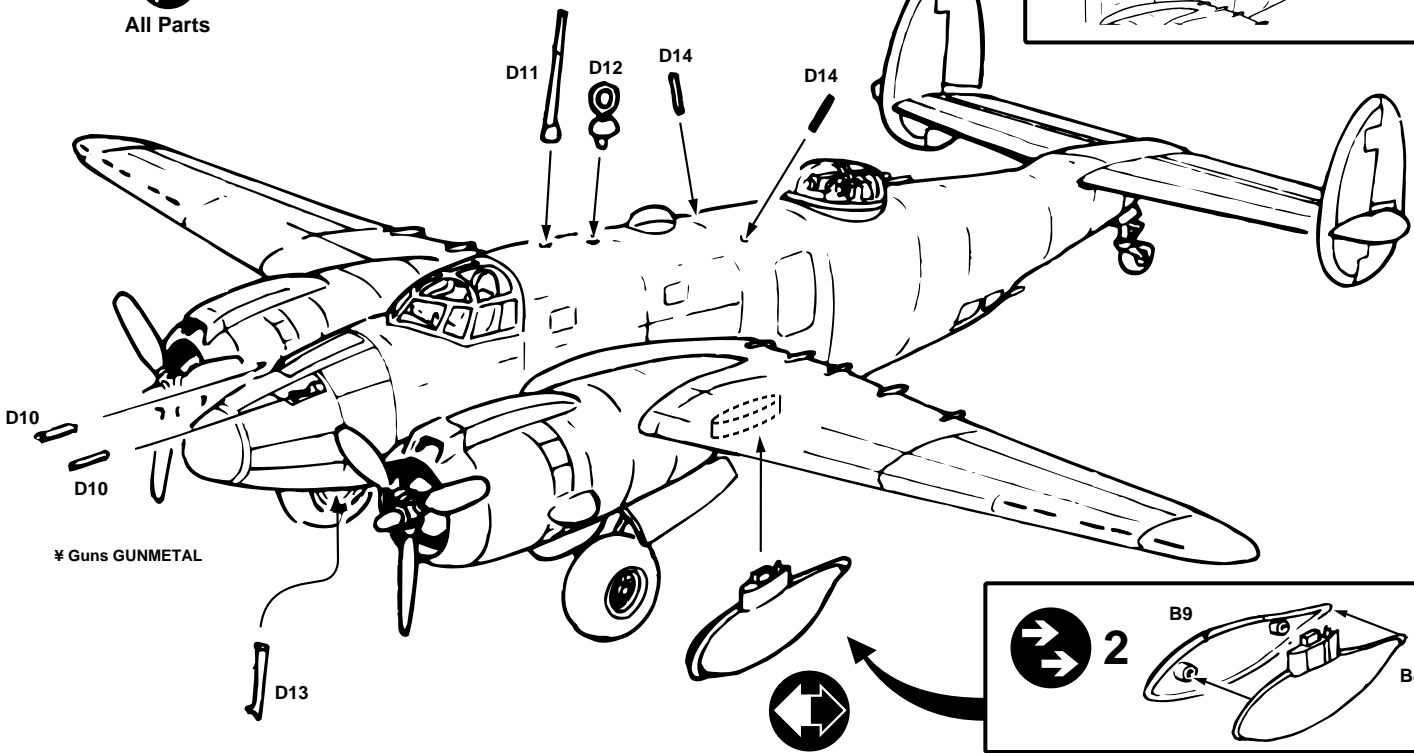

‡ Guns GUNMETAL

U.S. Navy PV-1, VB-142, Tarawa, July 1944

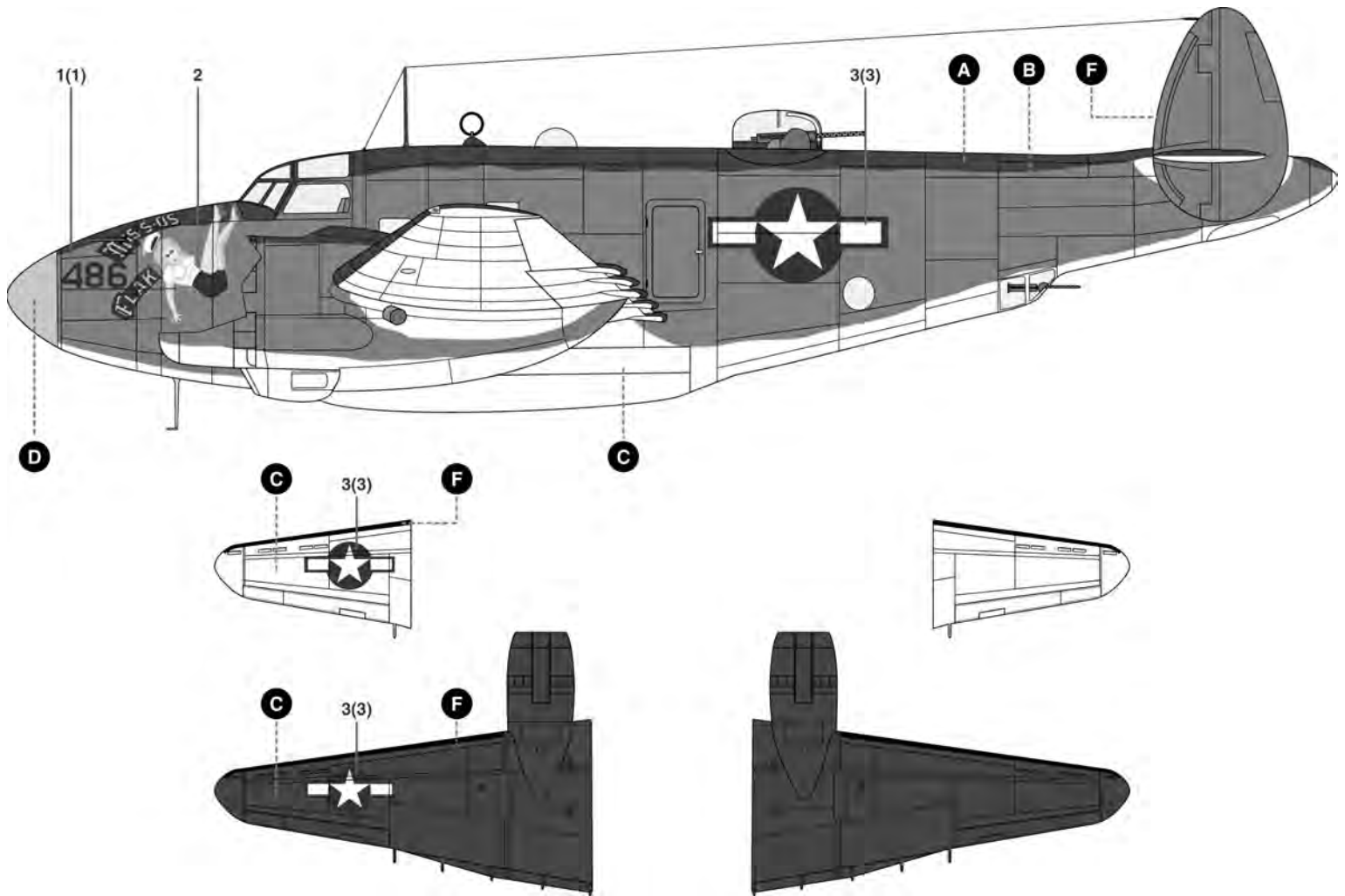

PAINTS

- A U.S. Navy Dark Sea Blue (ModelMaster 1718, Acryl 4686)
- B U.S. Navy Intermediate Blue (ModelMaster 1720, Acryl 4744)
- C U.S. Navy White (ModelMaster 1745, Acryl 4696)
- D U.S. Navy Blue Gray M-485 (ModelMaster 2055, Acryl 4847)
- E U.S. Navy Light Gray M-495 (ModelMaster ~1730, Acryl ~4763)
- F Black (ModelMaster 1749, Acryl 4768)

Royal Australian Air Force, No 13 Sqn, 1944

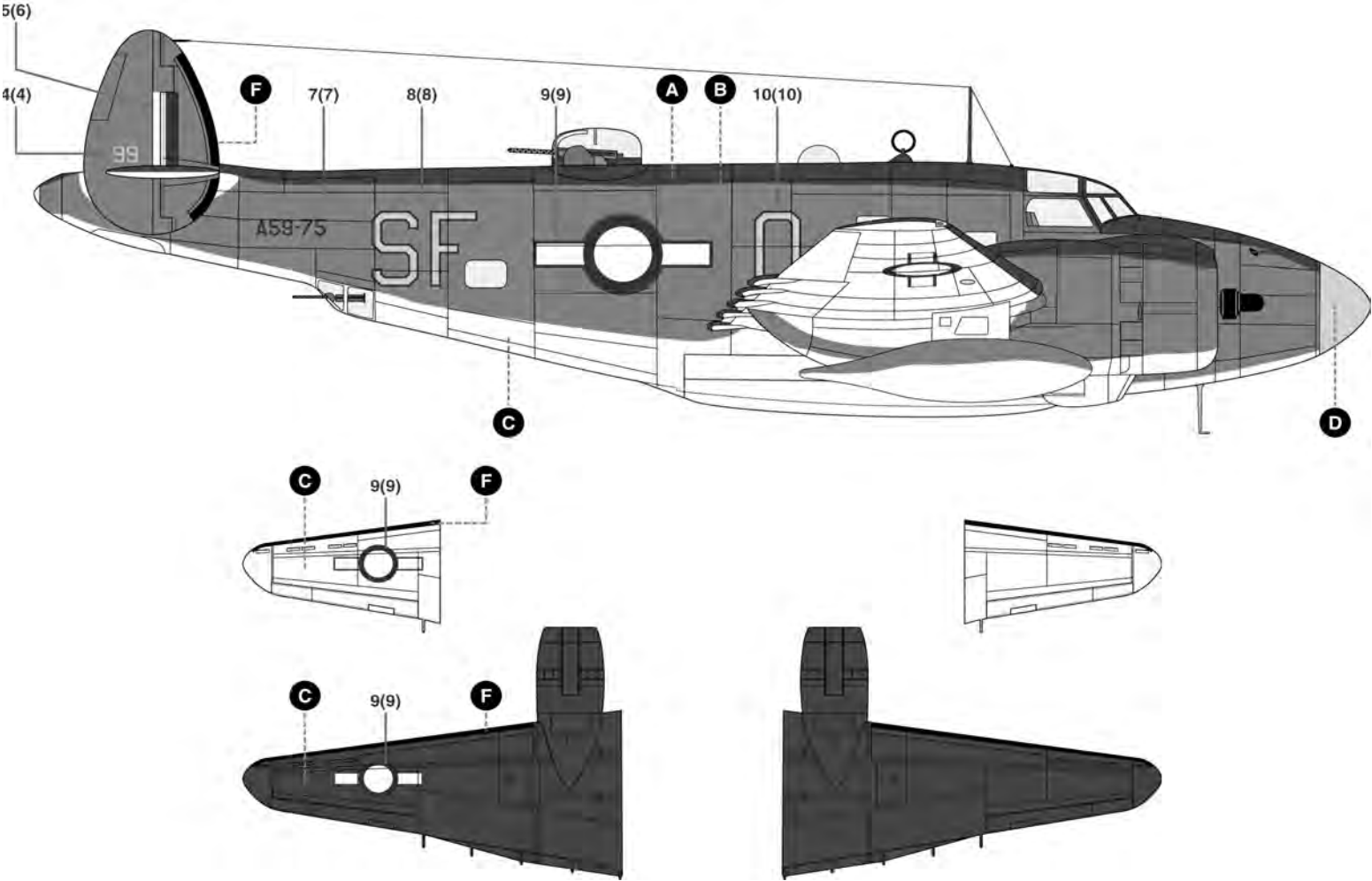

Royal New Zealand Air Force, No 1 (BR) Sqn, mid-1943

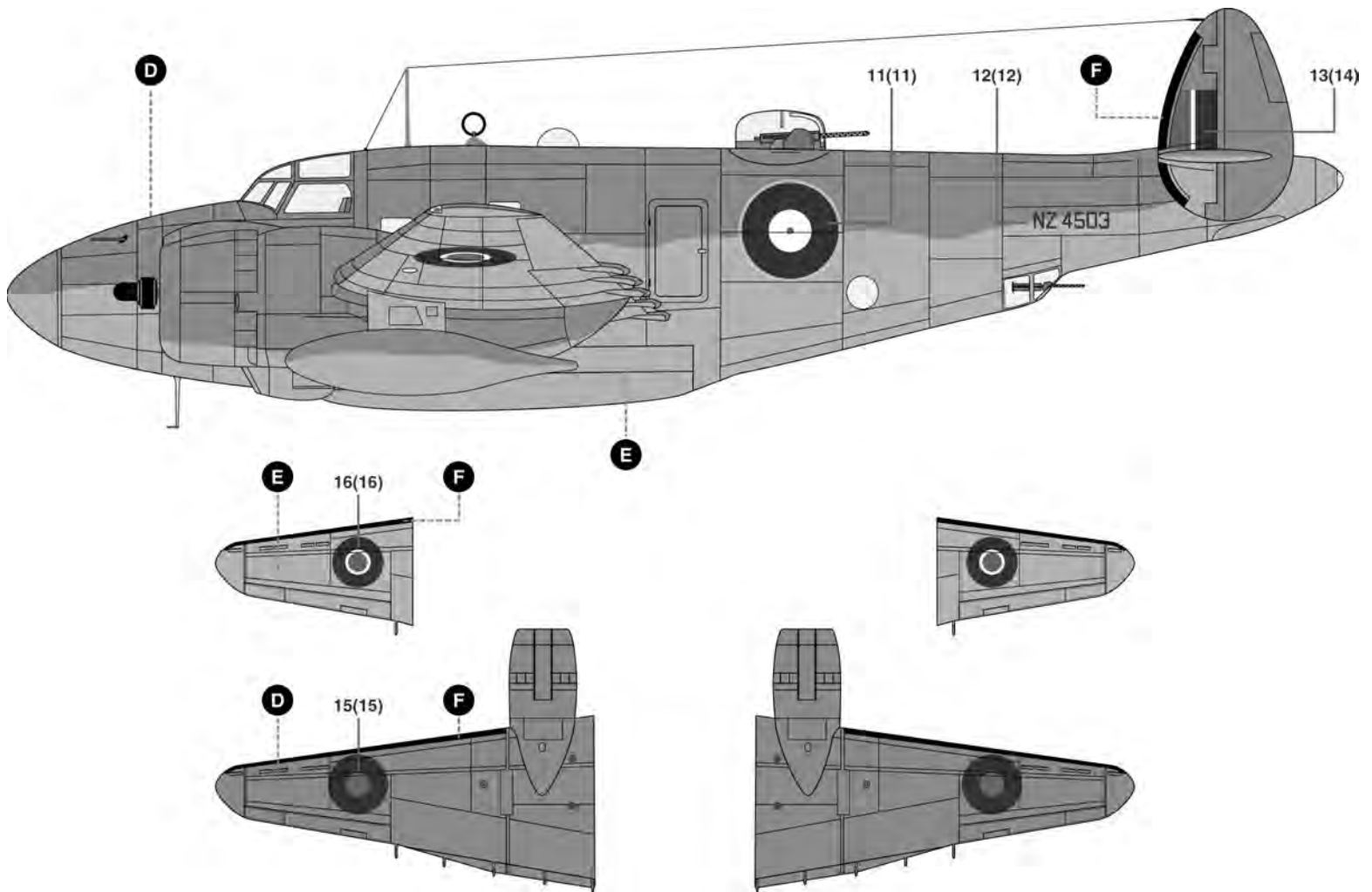

Your Minicraft model includes high-quality waterslide decals. These decals adhere best to a glossy surface; and it is recommended that you apply a clear gloss coat over your painted model.

Use a sharp scissors or knife to cut individual decals from the carrier sheet. Do not cut into the clear film surrounding the individual decals.

* It is recommended that you apply one decal at a time.

* Place the decal section in warm water, when first inserted in the water your decal will curl, after approximately ten seconds the decal will uncurl. Remove from water and lay on a paper towel. After approximately 10 - 20 seconds the decal will slide freely from the backing paper. Use a small brush to help slide the decal from the backing paper and into position on the model. Carefully blot excess water from the decal, using care not to move the decal or tear it.

* If you choose to use a setting solution, apply a thin coat over the decal following the manufacturer's instruction.

* Allow the decal to dry overnight. Wash any adhesive residue off the model with a small amount of clean water and dry thoroughly.

* Apply clear gloss, matte or flat coat to seal decals following the instructions from the manufacturer.



Legends in the making™

Visit our Website-
www.minicraftmodels.com

Minicraft Models
1501 Commerce Drive
Elgin, IL 60123

Phone: 847-429-9676