

BRITISH WW I SOPWITH CAMEL 1/72 scale

ACADEMY

HOBBY MODEL KITS

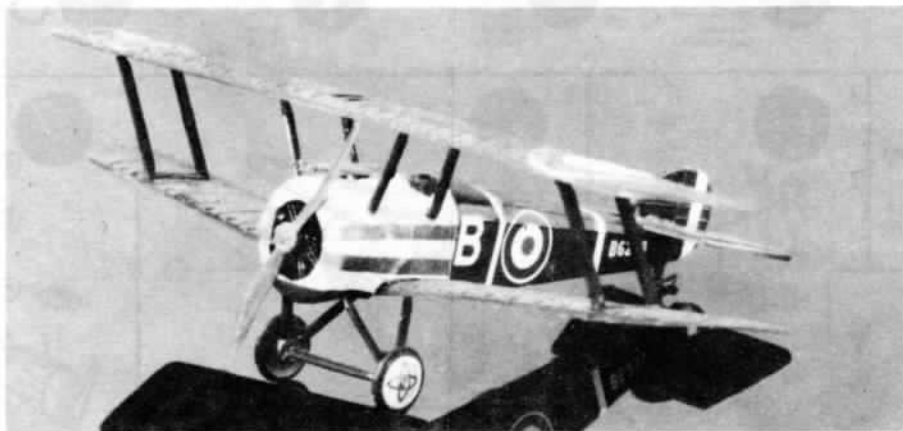

The Sopwith Camel is considered by many to be the best British fighter in World War I. It was fast and extremely nimble and one of them is credited with shooting-down more enemy planes than any other type during the war. It was also the first plane to destroy an enemy aircraft at night, when a Sopwith Camel successfully attacked a huge German Gotha bomber over London. One is also credited with the first Zeppelin kill.

The name "Camel" came from the hump in the fuselage which covered the twin 7.7 mm Vickers machine guns. This

armament was sufficient to cause considerable damage to any unfortunate enemy plane that happened to find itself in front of the nimble British fighter.

As successful as the Camel was, it was also very difficult to fly. It was unforgiving to the inexperienced pilot, and perhaps that was the the secret of its high rate of kills; only the best pilots could handle the Camel.

The Camel was operated by the British Royal Flying Corps and the Royal Navy. This model carries the markings of the No. 10 Squadron, B Flight, Royal Navy.



Cement Parts
Coller
Kleben
Pegar
Incollare
Colar
Kleven



DO NOT cement
Ne pas coller
Nicht kleben
No pegar
Non incollare
Nào colar
Niet kleven



Cut away
Couper
Scheiden
Cortar
Tagliare
Cortar
Snijden



Optional parts
Choix
Auswahlmöglichkeit
Elección
Scelta
Opcao
Keuze



3

Repeat operation
Répéter l'opération
Vorgang wiederholen
Repitir la operación
Ripetere
Repitir a operação
Herhalen

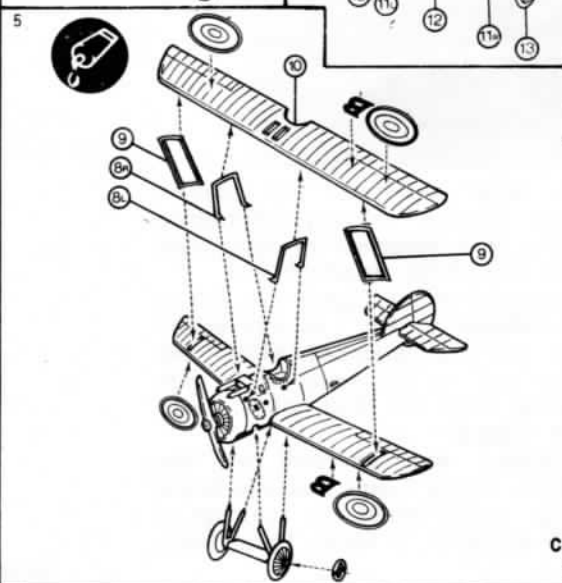
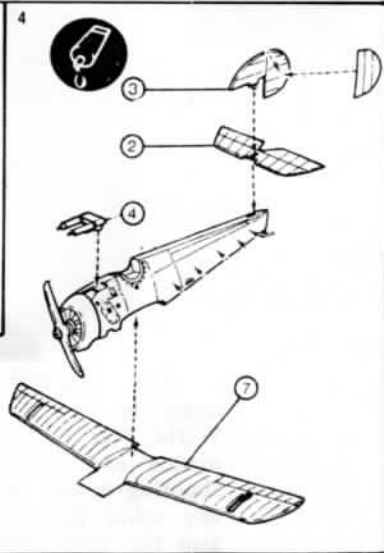
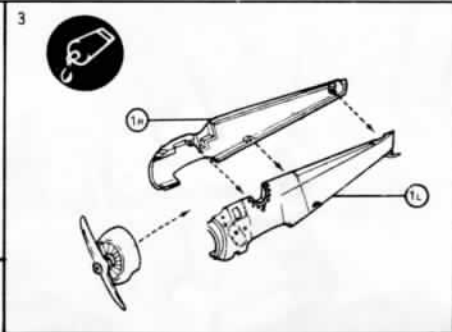
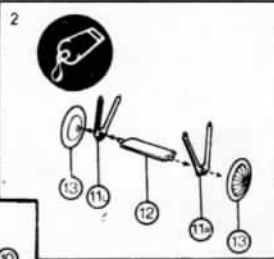
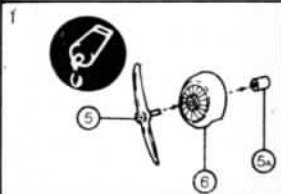

1624

Refer to box top photo for decal placement

ACADEMY

HOBBY MODEL KITS

Copyright 1986 Academy Plastic Model Co., Ltd.

273-64, Suyu-dong, Kangbuk-ku, Seoul, Korea FAX: 82-2-997-3003



보호자 분들은 반드시 읽어 주십시오.

- 조립하기 전에 취급 설명서를 필히 읽어 내용을 충분히 이해한 상태에서 조립하여 주십시오.
- 부품을 자를 때는 해당번호를 확인한 뒤 니퍼 등으로 깨끗이 잘라 주십시오. 칼을 이용하여 부품을 다듬고 자를 경우 손을 다치지 않도록 세심한 주의를 기울여 주십시오.
- 작은 부품 따위를 절대로 입에 넣지 마십시오. 잘못하여 삼킬 경우 질식 등의 위험이 있습니다.
- 자칫 먹을 우려가 있으므로 3세 미만의 어린이에게는 절대로 주지 마십시오.
- 잘라낸 부품은 깨끗이 닦아 조립하고 남은 쓰레기는 분리하여 잘 버려 주십시오.
- 기능상 부득이하게 튀어나온 부분이 있을 수 있습니다. 취급 시 충분한 주의를 기울여 주십시오.
- 제품 및 부품이 포장된 비닐봉지는 개봉 후 즉시 어린이의 손에 닿지 않는 곳에 잘 버려 주십시오. 머리에 뒤집어쓰거나 얼굴을 덮을 경우 질식의 위험이 있습니다.
- 색칠 및 접착을 위하여 모형용 도료 및 접착제 등을 사용할 때에는 창문을 열어 환기를 시키고 화기를 멀리하여 주십시오. 사용하고 남은 도료 및 접착제는 어린이의 손이 닿지 않는 곳에 잘 보관하여 주십시오.
- Before starting to assemble, read the instruction manual very carefully to understand the instructions completely.
- Before cutting parts off a sprue, check the part number again and use the appropriate tool, such as nippers, to cut it clearly. Take care not to injure yourself whilst using the modelling knife to cut or trim parts.
- Avoid danger of suffocation by never putting small parts in the mouth which can be accidentally swallowed.
- Keep away from children under 3 years old.
- The product may have some protruding parts for functional reasons. Take care when handling these.
- After cutting a part off a sprue, trim it cleanly to assemble and ensure proper disposal of all waste material.
- Plastic bags packed with the product and parts should be disposed of in an appropriate place immediately. keep out of reach of children to avoid any danger of suffocation by pulling plastic bags over face or head.
- Use modelling colours or cement in a well ventilated room and do not use near fire or flame. Keep out of reach of children at all times.

SOPWITH CAMEL CAT #1624

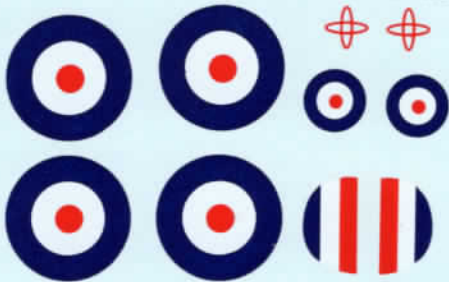

ACADEMY
HOBBY MODEL KITS



스라이드식 검사 시뮬레이션

1. 마크를 작아지게 가위로 잘라서 붙여진것만 물에 띄우도록만 남았다 하얀다를 30초 후에 뺀다.
2. 원하는 위치에 표면을 뒤로하고 일면서 떼어낸다.
3. 부드러운 수건이나 휴지등으로 눌러서 기포를 빼낸다.
4. 전사가 된 마크 표면에 손을 대지 않는다.

DIRECTIONS

1. CUT EACH DESIGN FROM DECAL SHEET AS NEEDED.
2. DIP IN WATER.
3. USE A SMALL BRUSH TO WET YOUR MODEL.
4. SLIDE DECAL FROM PAPER FACE UP INTO POSITION ON MODEL.
5. DO NOT TOUCH DECAL WITH FINGERS.
6. PRESS DOWN WITH SLOTTER.