

Lockheed SUPER-G CONSTELLATION

"LEGENDS OF AVIATION"

MINICRAFT
MODEL KITS



SUPER 144



Perhaps the most beautiful airliner ever flown, the Lockheed Super-G Connie was the airplane that opened Europe to the hordes of postwar American tourists that could not or would not spend the time and money to cross the Atlantic by ship. The L-1049 was the first airliner with sufficient speed and range to be termed inter-continental.



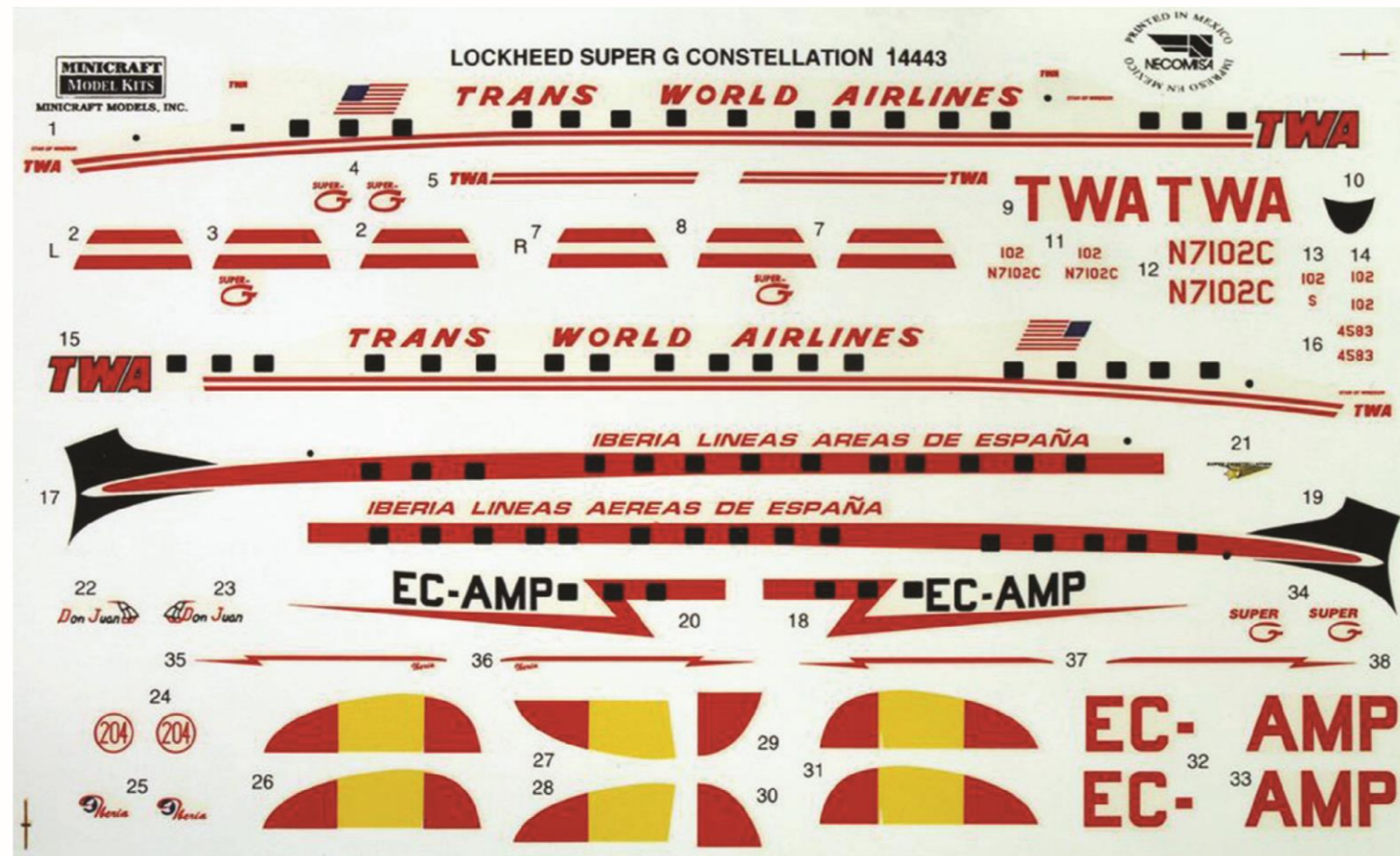

Les décalcomanies présentées respectent les proportions mais ne sont pas à l'échelle du modèle

MINICRAFT
MODEL KITS



LOCKHEED L-1049 SUPER-G CONSTELLATION

AIRCRAFT SPECIFICATIONS

Wingspan: 123.0 feet	Length: 113.6 feet
Height: 24.7 feet	Cabin Length: 83.2 feet
Cabin Width: 10.7 feet	Cabin Height: 10.7 feet
Empty Weight: 70,983 lbs.	Max. Takeoff Wt. 133,000
Max. Landing Wt. 110,000 lbs	Maximum Speed: 374 mph
Cruise Speed: 314 mph	Max Fuel Range: 4,760 m
Service Ceiling: 23,200 feet	

First flown in 1953, the Constellation had been in design or development since 1939 when Howard Hughes asked for a modern transport that could span the continent and be the airliner of the future. World War II interrupted TWA's plans; the 22 aircraft ordered went to the US Army Air force and were designated the C-69.

After 1945, production resumed on the commercial Constellation which gave Lockheed almost 18 months of lead time ahead of Douglas and Boeing who were developing the DC-6B and the Stratocruiser. The Constellation pioneered non-stop flights over the Atlantic and spelled the death knell for the ocean liner and a means of transport. With its speed and economy, passengers deserted the great ocean liners and flew their way to Europe.

Ahead of its time by a number of years, the Constellation will always be regarded as one of the most beautiful airplanes ever built.

14443

PARTS LOCATING DIAGRAM

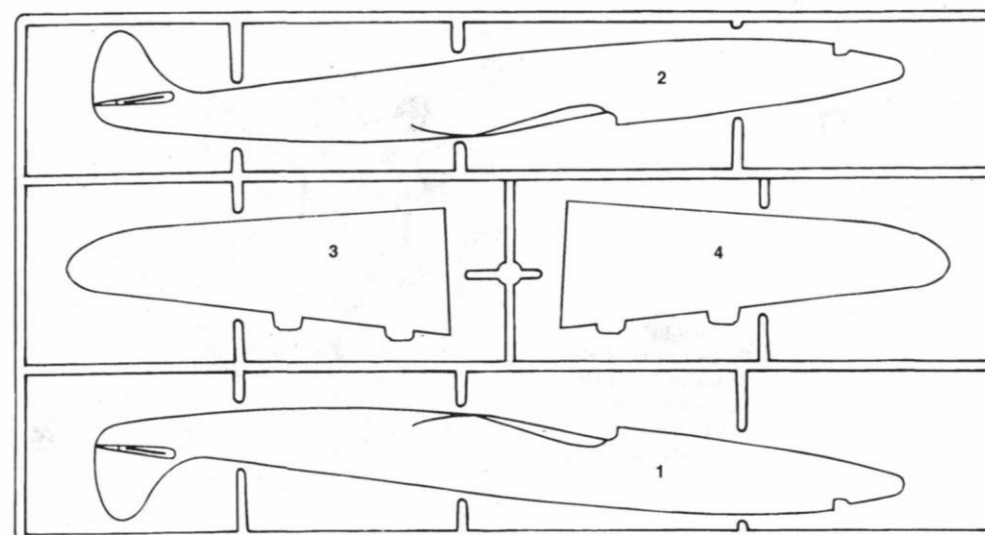
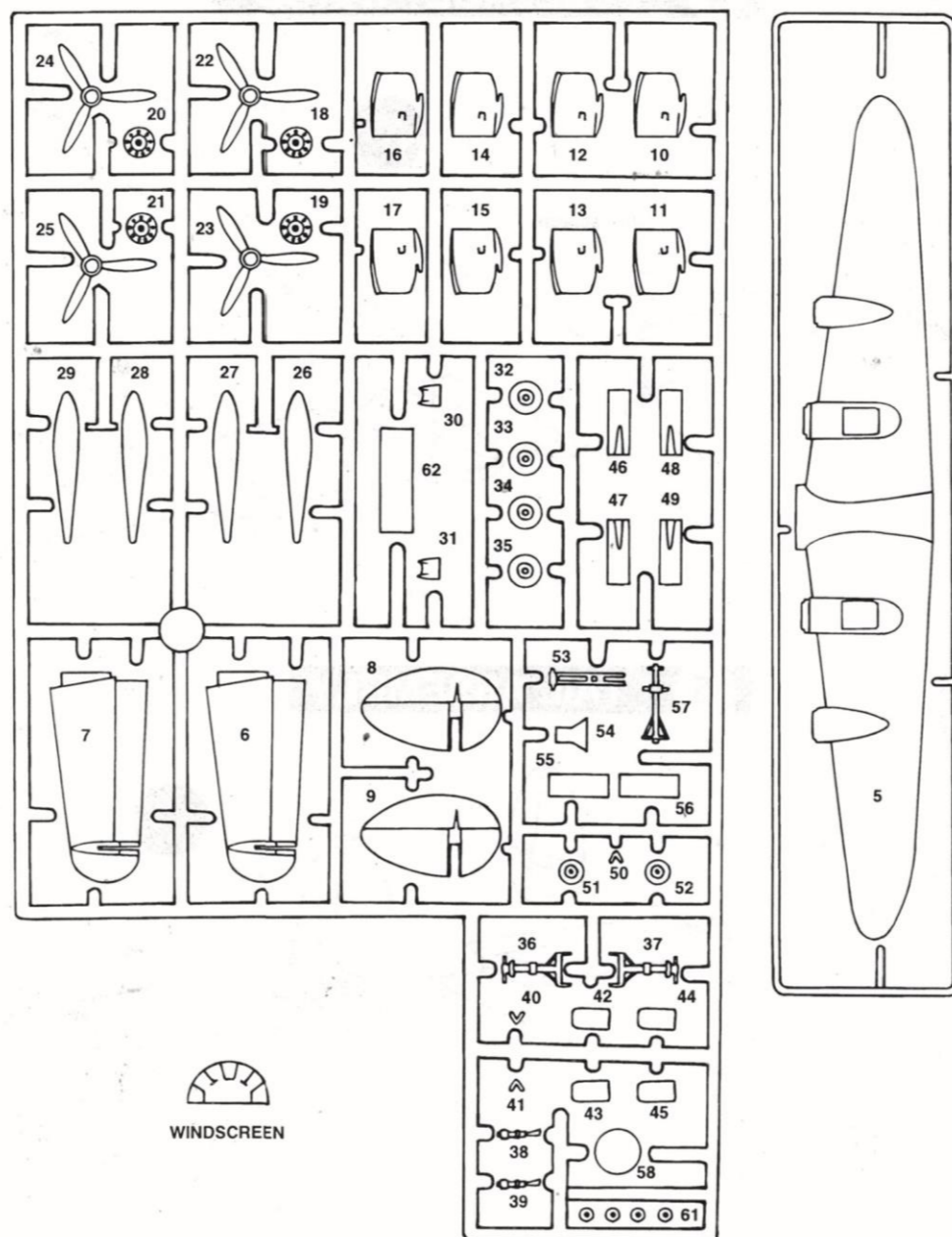

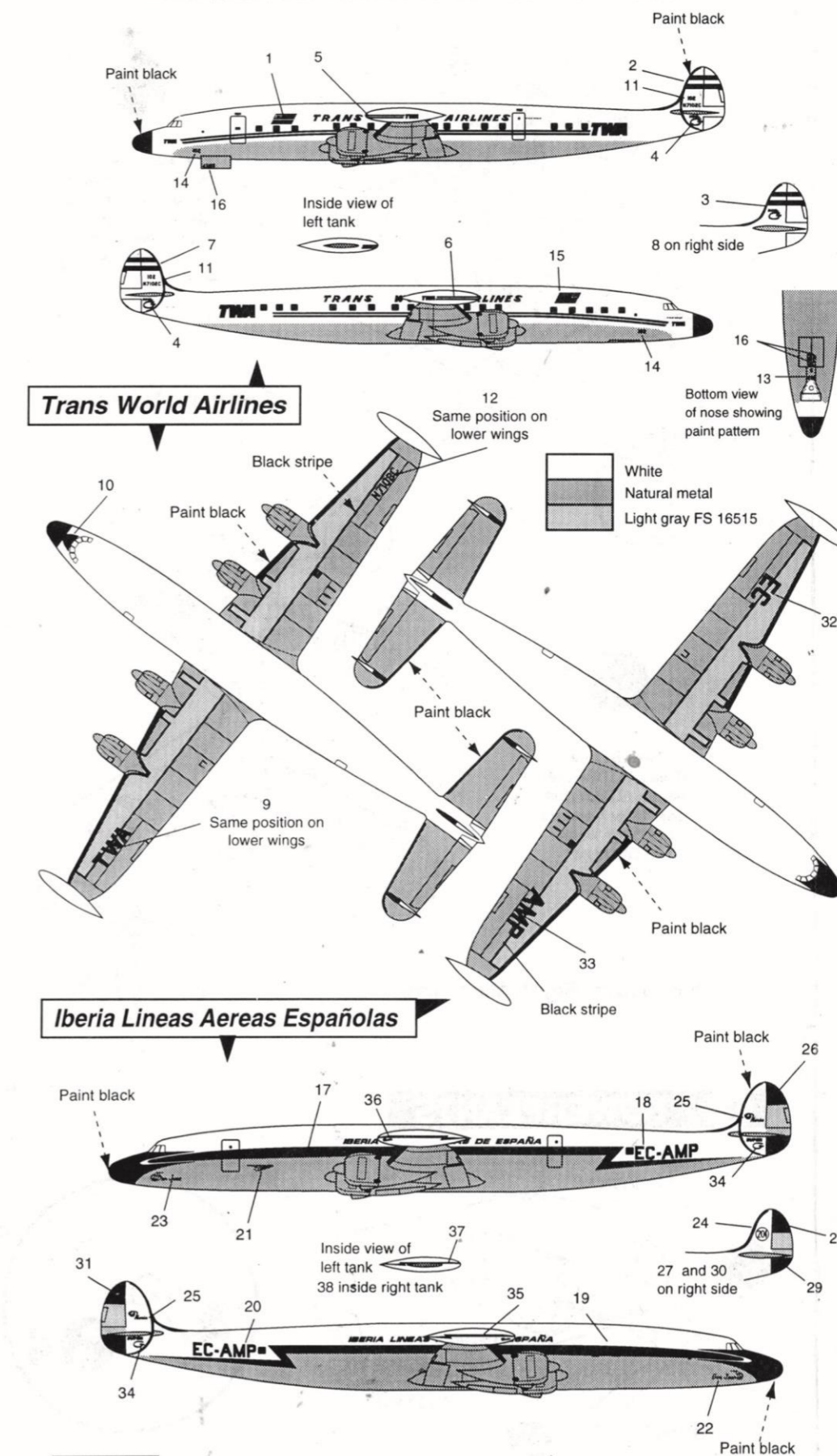

PAINTING & DECAL PLACEMENT



MINICRAFT
MODEL KITS

© MINICRAFT MODELS 1998
ALL RIGHTS RESERVED

-  Cement
Coller
Kleben
Pegar
Incollare
Colar
Kleven
-  DO NOT Cement
Ne pas Coller
Nicht Kleben
No Pegar
Non Incollare
Nao Colar
Niet Kleven
-  Cut away
Couper
Scheiden
Cortar
Tagliere
Cortar
Snijden
-  Optional parts
Choix
Auswahlmoglichkeit
Eleccion
Scelta
Opaco
Keuze
-  Repeat operation
Répéeter l'opération
Vorgang wiederholen
Repitir la operacion
Ripetere
Repitir a operaçao
Herhalen

1 FUSELAGE ASSEMBLY

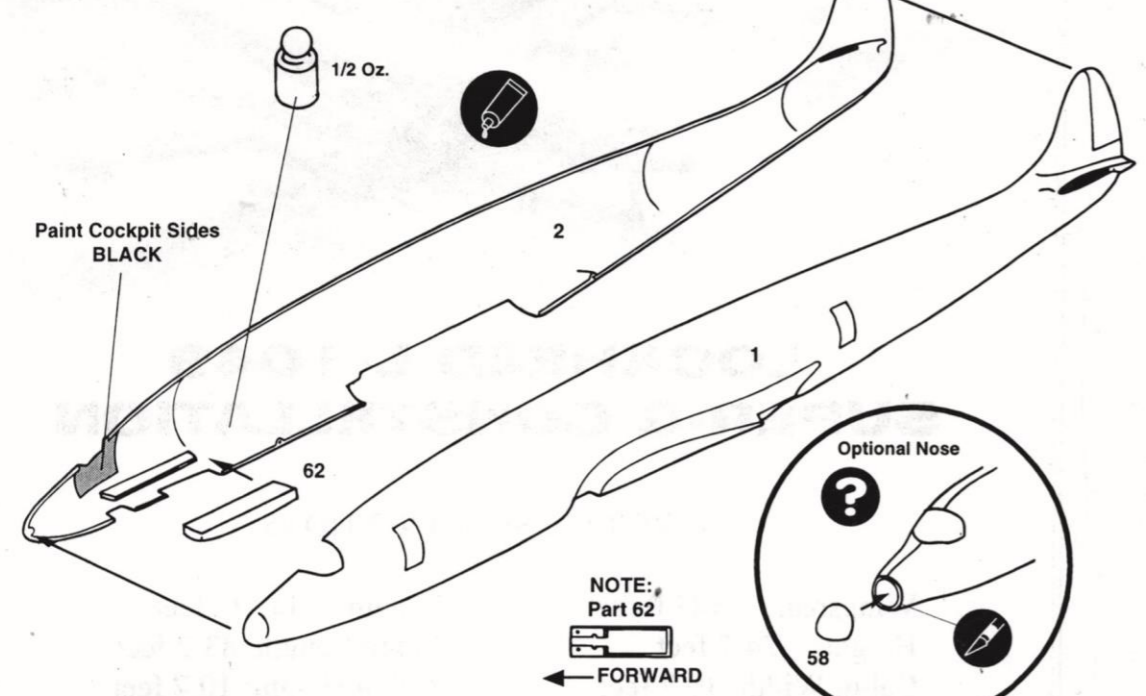

2 WINGS

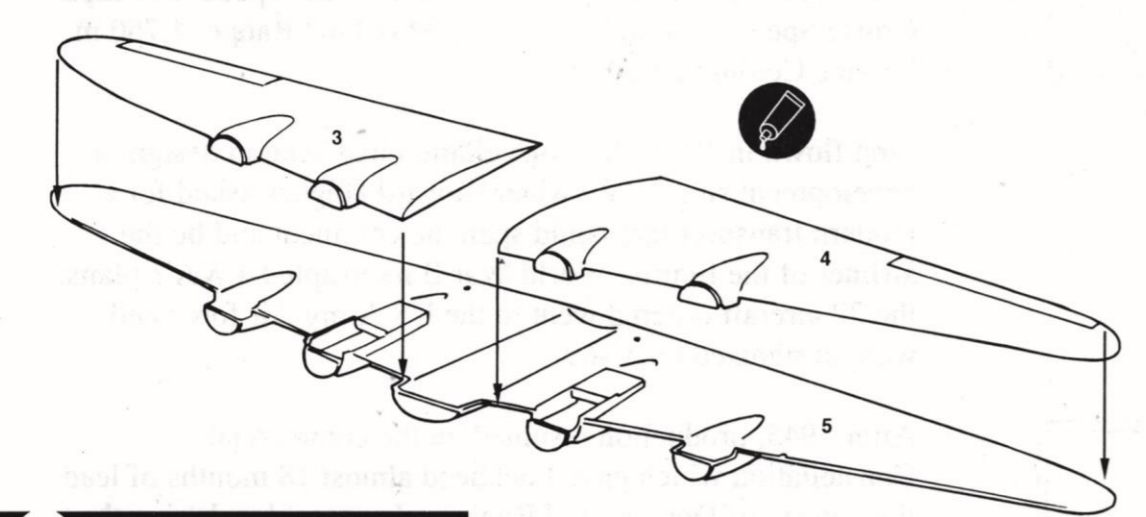

3 WING TIP TANKS

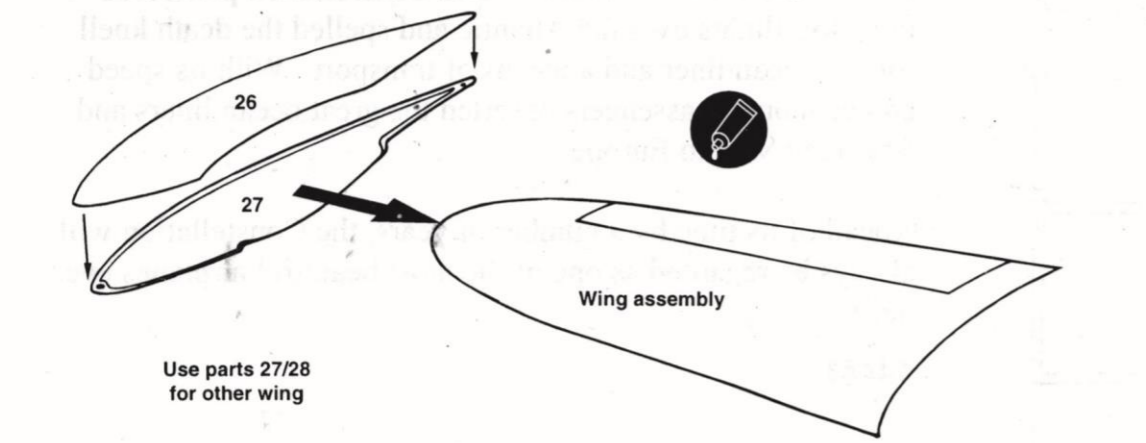

4 FUSELAGE / WINGS

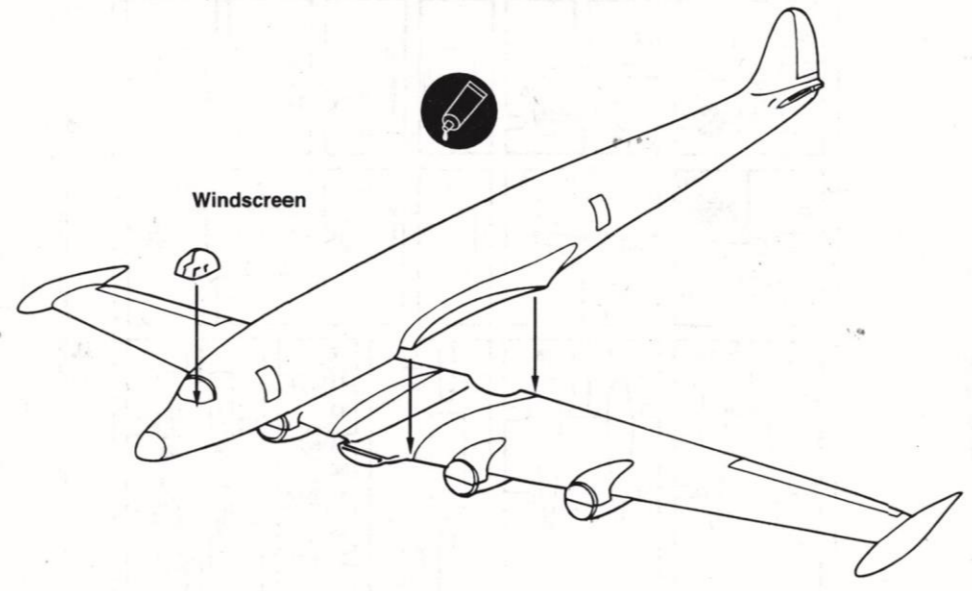

5 TAIL ASSEMBLY

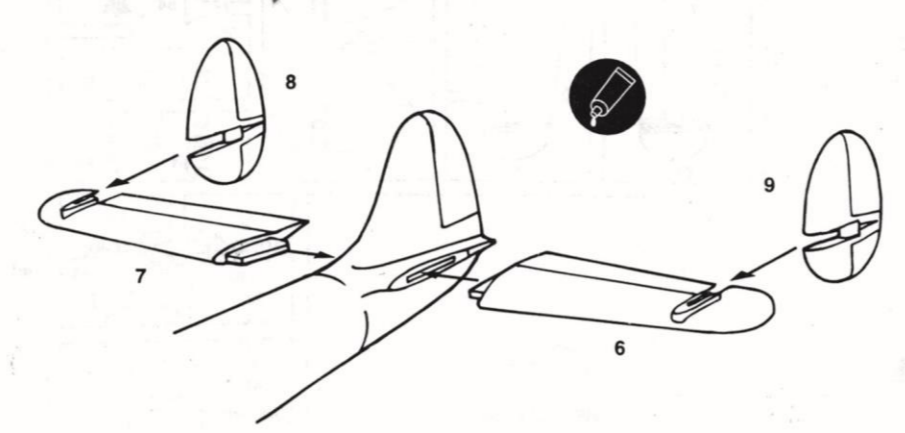

6 NOSE GEAR

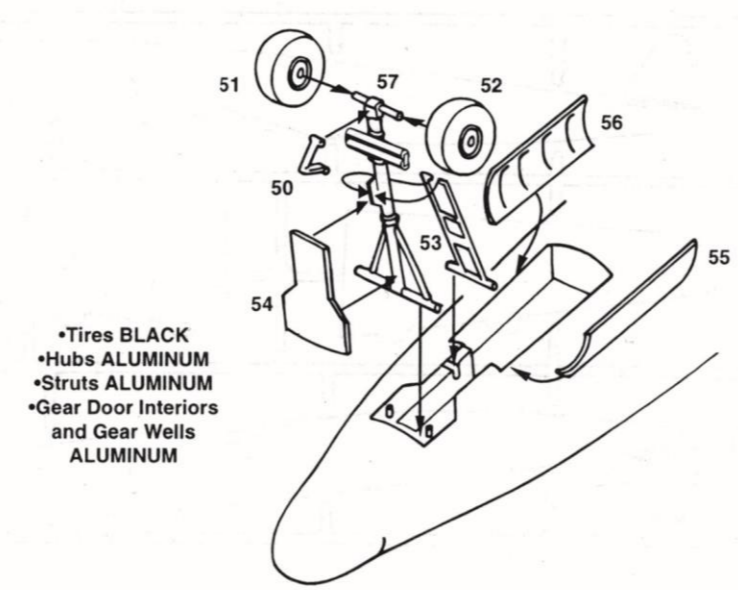

7 MAIN LANDING GEAR

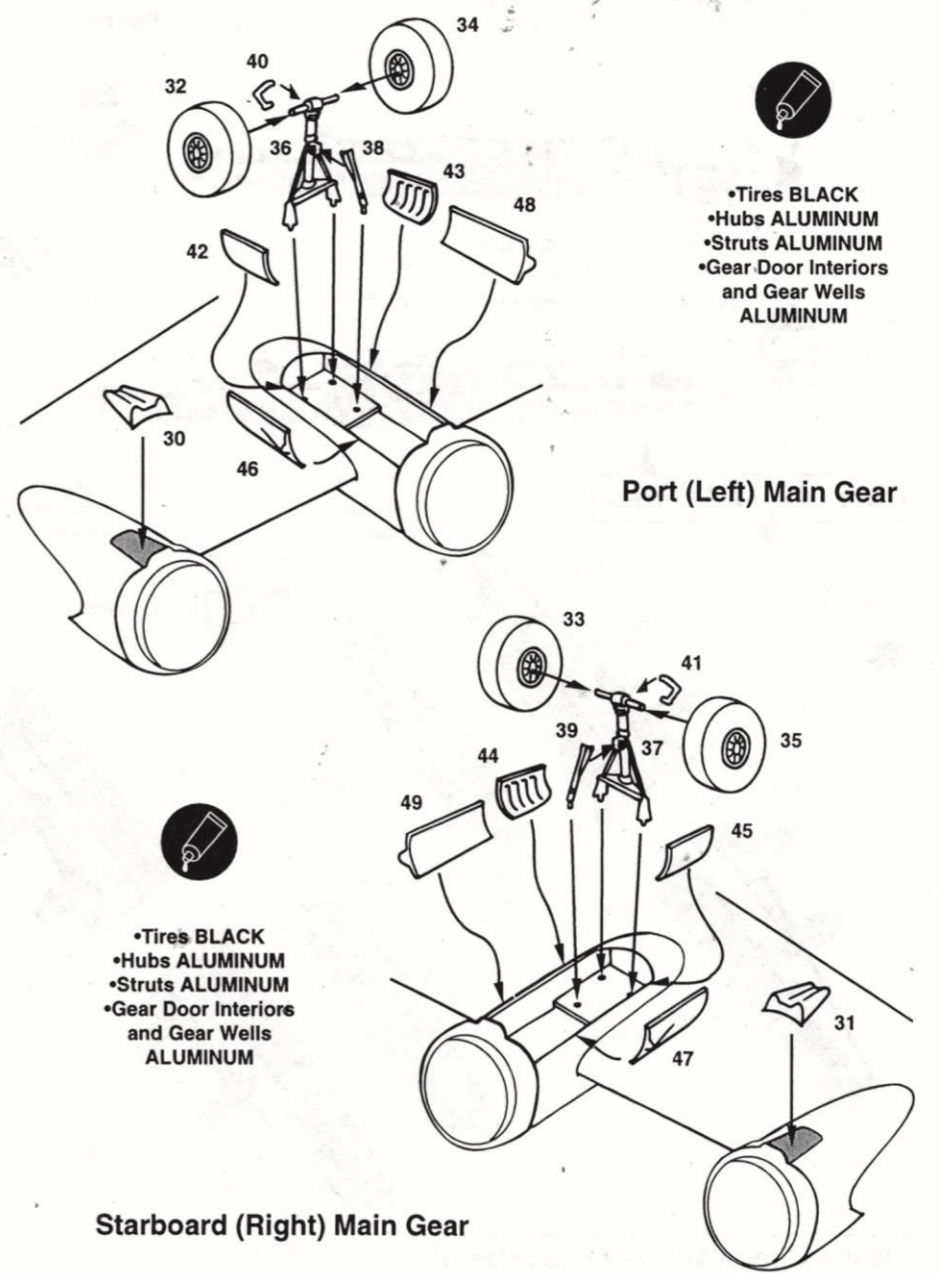

8 POWERPLANTS

