



1965 CHEVY STEPSIDE PICKUP

85724904200

KIT 7249

1/25 SCALE

1/25 ECHELLE

ESCALA 1/25

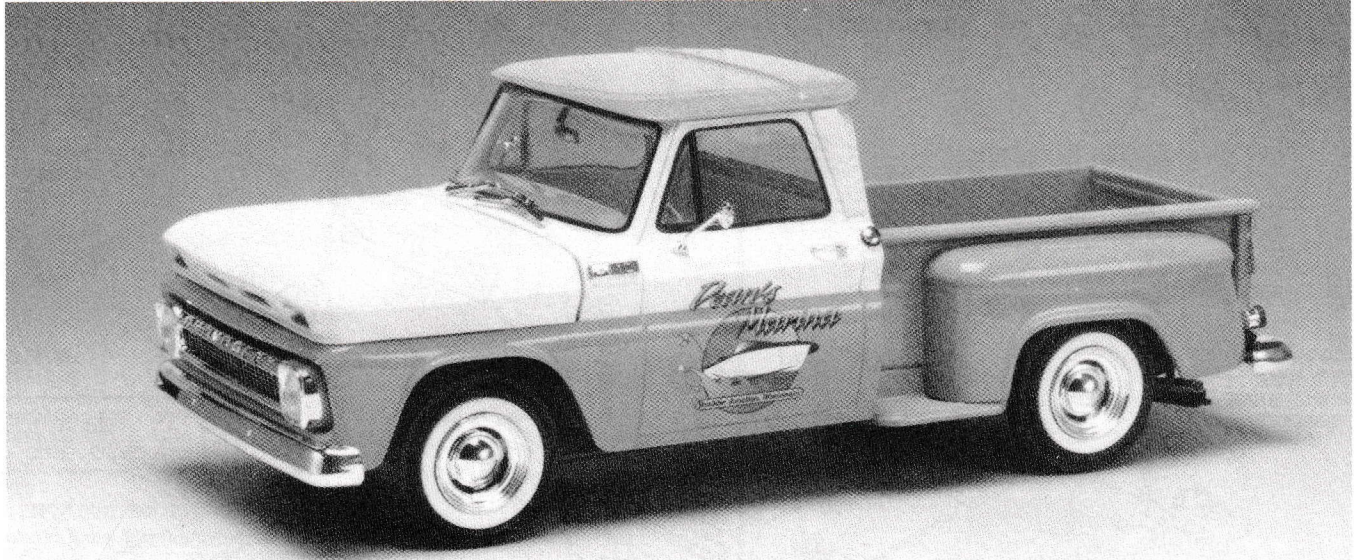

The sleepy little resort town of Boulder Junction, Wisconsin got more than they bargained for when the boys from Dean's Marina rolled into town last week. A few folks had been talking about the new marina that just opened up over on Trout Lake, but when the brand new '65 Chevy Stepside with a gorgeous new boat and trailer hitched up to it pulled into the filling station, the whole town turned out to see what all the commotion was about.

behold, but take a look at that boat sitting behind it, wow! It's got the most beautiful matching paint job you ever saw and just one glance at it and you know it's faster than any boat that's ever navigated these parts including old Milton's '47 Deluxe Chris-Craft. They say it's called a Hemi-Hydro and it's powered by a 392 cubic inch Hemi-Head engine.

That new Chevy Pickup truck with it's two-toned aqua and white paint job, full whitewall tires and a sturdy 283 V-8 engine under hood was certainly a sight to

Something tells me, once that boat takes to the water, things will never be the same on Trout Lake and this town probably won't be quite so sleepy anymore.

READ THIS BEFORE YOU BEGIN

- Study the assembly drawings.
- Each plastic part is identified by a number.
- In the assembly drawings, some parts will be marked by a star (*) to indicate plated plastic.
- Scrape plating from areas to be cemented.
- Check the fit of each piece before cementing into place.
- Do not use too much cement to join parts.
- Use only cement for polystyrene plastic.
- Models may be painted to match photos on box.
- Allow paint to dry thoroughly before handling parts.
- Scrape paint from areas to be cemented.
- For better paint and decal adhesion, wash the plastic parts in a mild detergent solution. Rinse and let air dry.

LISEZ CE QUI SUIT AVANT DE COMMENCER LE MONTAGE

- Etudier les schémas d'assemblage.
- Chaque pièce plastique porte un numéro d'identification.
- Sur les schémas d'assemblage les pièces dont le numéro comporte une astérisques (*) sont en plastique chromé.
- Grattez le chromage sur les surfaces à coller.
- Contrôler que chaque pièce soit bien conforme avant de la coller à sa place.
- N' utilisez pas trop de colle pour réunir les pièces.
- Utilisez uniquement une colle spéciale pour polystyrène.
- Le modèle peut être peint conformément aux photos sur la boîte.
- Laissez sécher la peinture complètement, avant de manipuler les pièces.
- Grattez la peinture sur les surfaces devant être collées.
- Pour assurer la meilleure adhésion possible de la peinture et des décalomanies, laver les pièces de plastique avec une légère solution savonneuse. Rincer et laisser sécher à l'air.

LEA ESTO ANTES DE EMPEZAR

- Estudie los dibujos de ensamblaje.
- Cada pieza de plástico se identifica por un número.
- En los dibujos de ensamblaje, algunos números de las piezas están marcados con una estrella (*) indicar plástico laminado.
- Raspe el laminado de las superficies que serán pegadas.
- Verifique que cada pieza encaje bien antes de posición.
- No use demasiado pegamento para unir las piezas.
- Use únicamente pegamento para plástico de poliestirena.
- El modelo puede pintarse de acuerdo con las fotografías de la caja.
- Permita que se seque la pintura completamente antes de tocar las piezas.
- Raspe la pintura de las superficies que serán pegadas.
- Para una mejor fijación de la pintura y de las calcomanías lávense las piezas plásticas en una solución de detergente suave. Enjuaguense y dejense secar al aire.



DECAL (DIP IN WATER)
DECALCOMANIA (MOJE CON AGUA)
DECALCOMANIE (À PLONGER DANS L'EAU)



OPTIONAL PARTS
PIEZAS OPCIONALES
PIECES EN OPTION



REMOVE AND THROW AWAY
QUITE Y TIRE
À RETIRER ET JETER



REPEAT SEVERAL TIMES
REPITA VARIAS VECES
A RÉPÈTER PLUSIEURS



DO NOT CEMENT
NO USE PEGAMENTO
NE PAS COLLER

TO COMPLETE THIS KIT AS SHOWN, WE RECOMMEND THE FOLLOWING PROMODELER PAINTS.

FLAT BLACK 88-0022	NEGRO APAGADO	NOIR TERNE
SATIN BLACK 88-0016	NEGRO MATE	NOIR MAT
GLOSS WHITE 88-0002	BLANCO BRILLANTE	BLANC LUSTRE
FLAT WHITE 88-0023	BLANCO	BLANC
ENGINE ORANGE 88-0018	NARANJADO	ORANGE
TURN SIGNAL AMBER 88-0017	AMBAR	AMBRE
STEEL 88-0015	METALICO	MATALLIC
ALUMINUM 88-0014	ALUMINIO	ALUMINIUM
RUBBER 88-0020	MARRON	BRUN
DESERT TAN 88-0025	CANELA	BRUN CLAIR
AQUA		

If you have any problems building this model, call our modeling tips hotline at: (800) 833-3570

REVELL-MONOGRAM, INC. Morton Grove, IL. Copyright©1996. All rights reserved. Made in U.S.A.

1 ENGINE ASSEMBLY

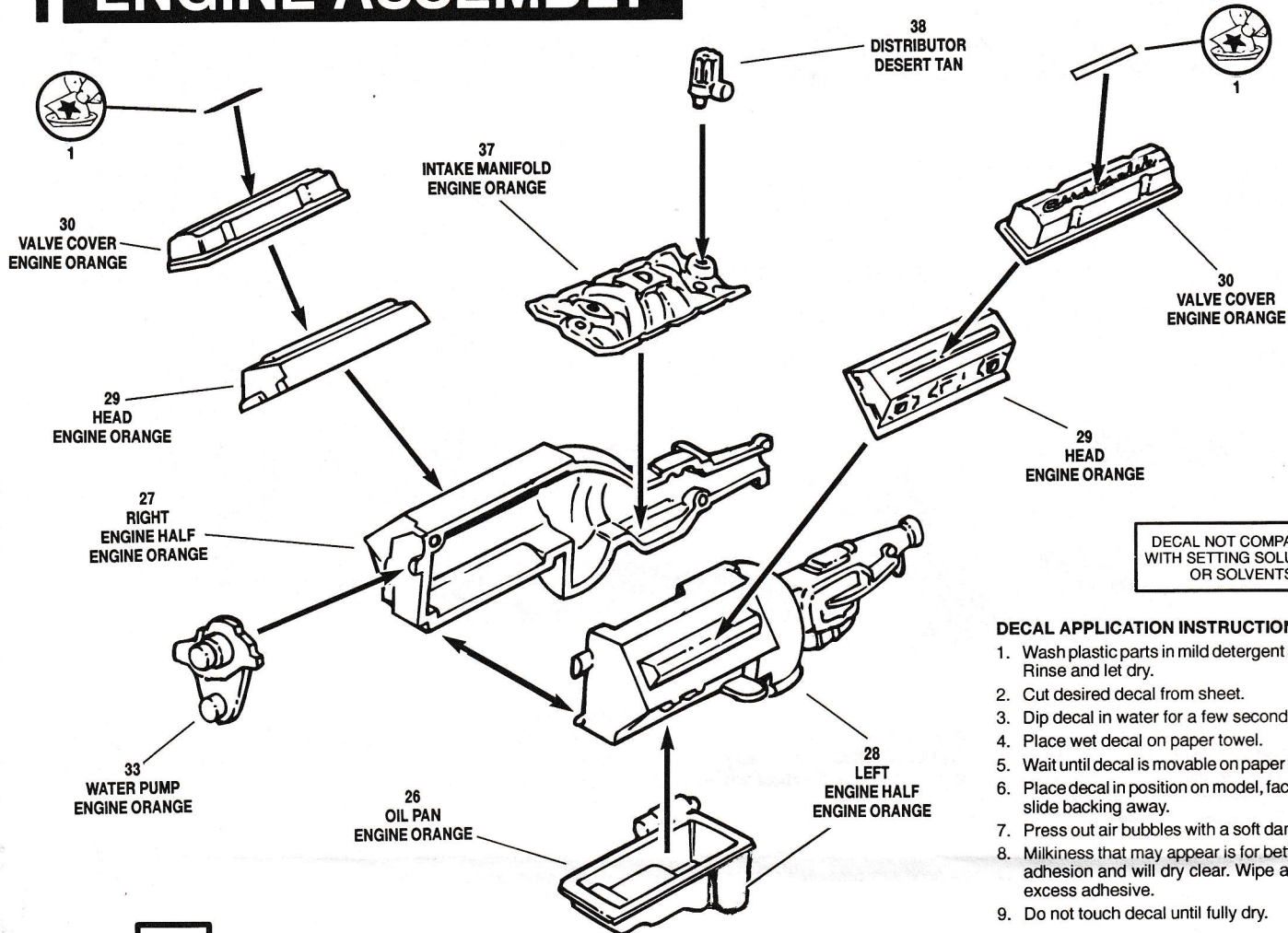

DECAL APPLICATION INSTRUCTIONS

1. Wash plastic parts in mild detergent solution. Rinse and let dry.
2. Cut desired decal from sheet.
3. Dip decal in water for a few seconds.
4. Place wet decal on paper towel.
5. Wait until decal is movable on paper backing.
6. Place decal in position on model, face up and slide backing away.
7. Press out air bubbles with a soft damp cloth.
8. Milkiness that may appear is for better decal adhesion and will dry clear. Wipe away any excess adhesive.
9. Do not touch decal until fully dry.

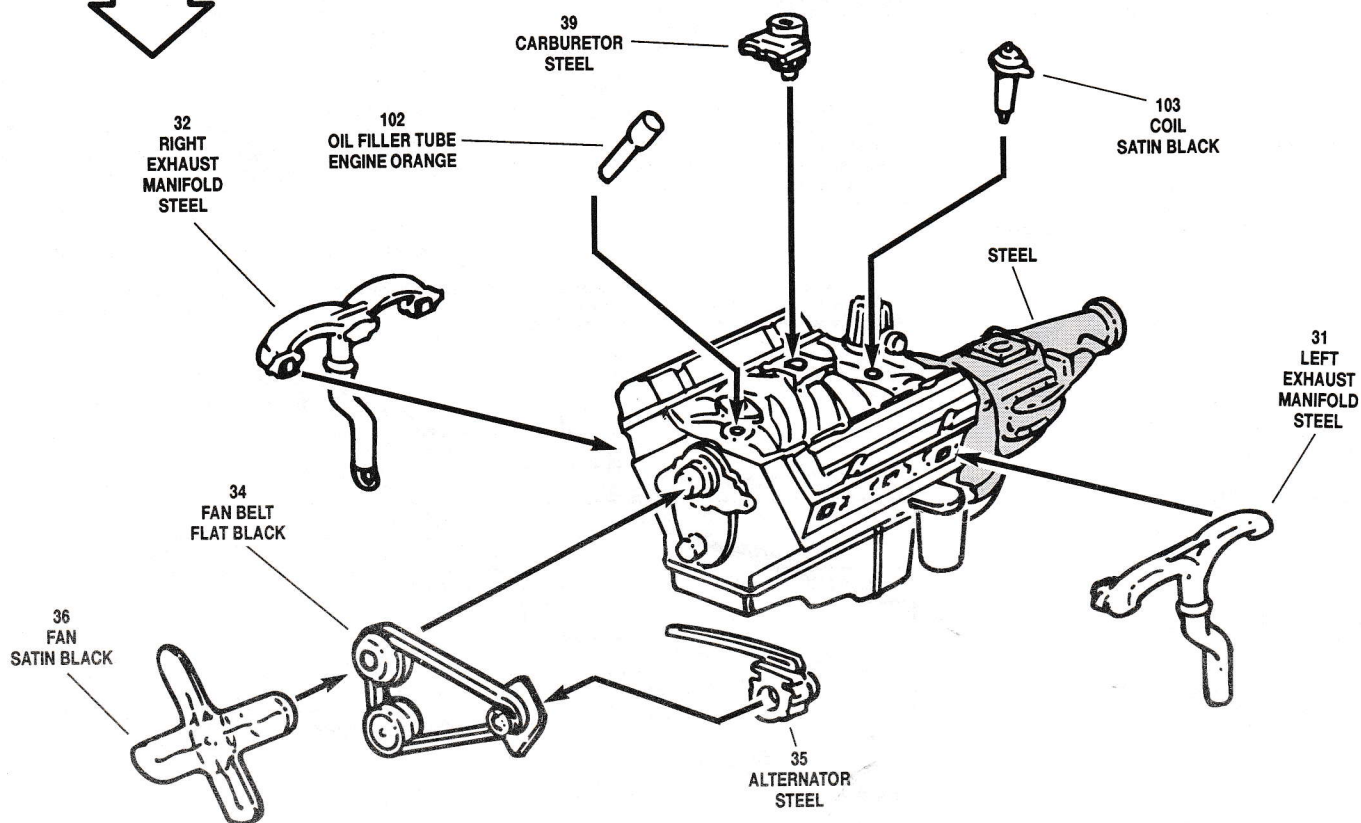

2 INTERIOR ASSEMBLY

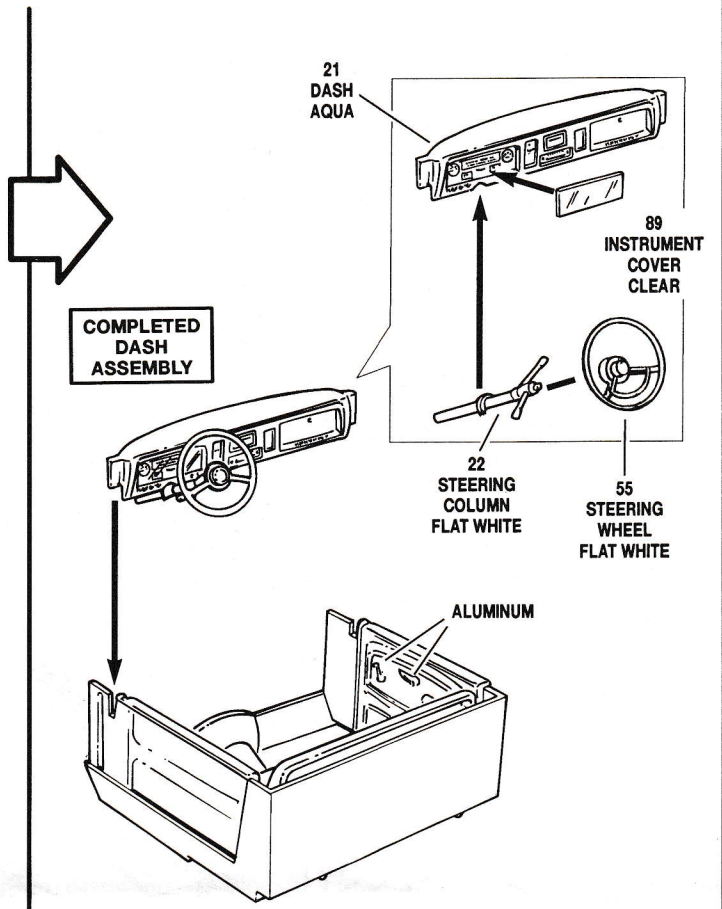
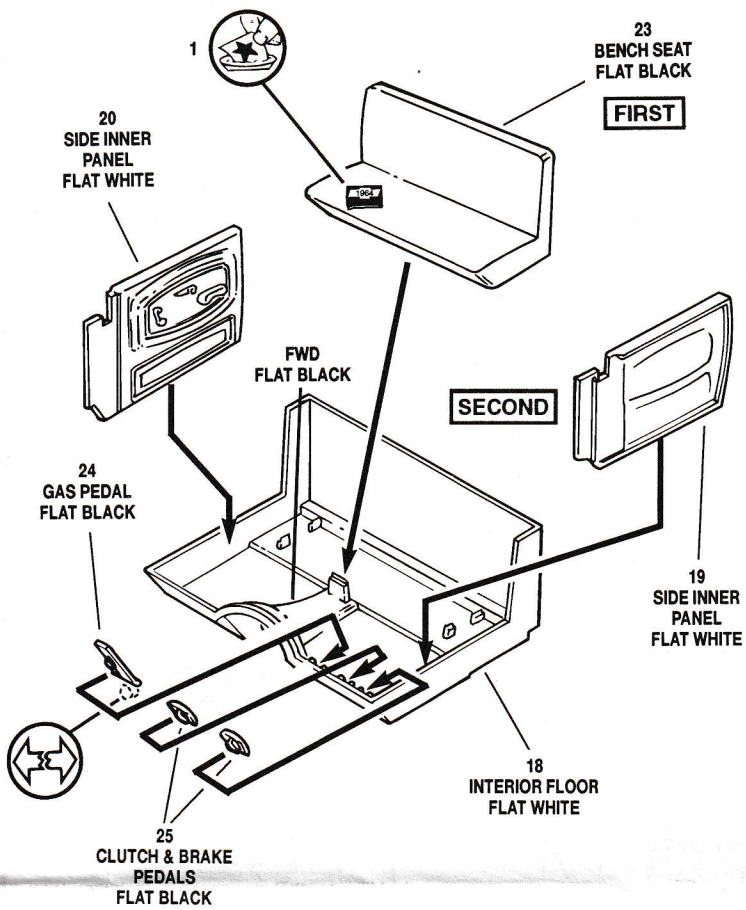

3 CAB ASSEMBLY

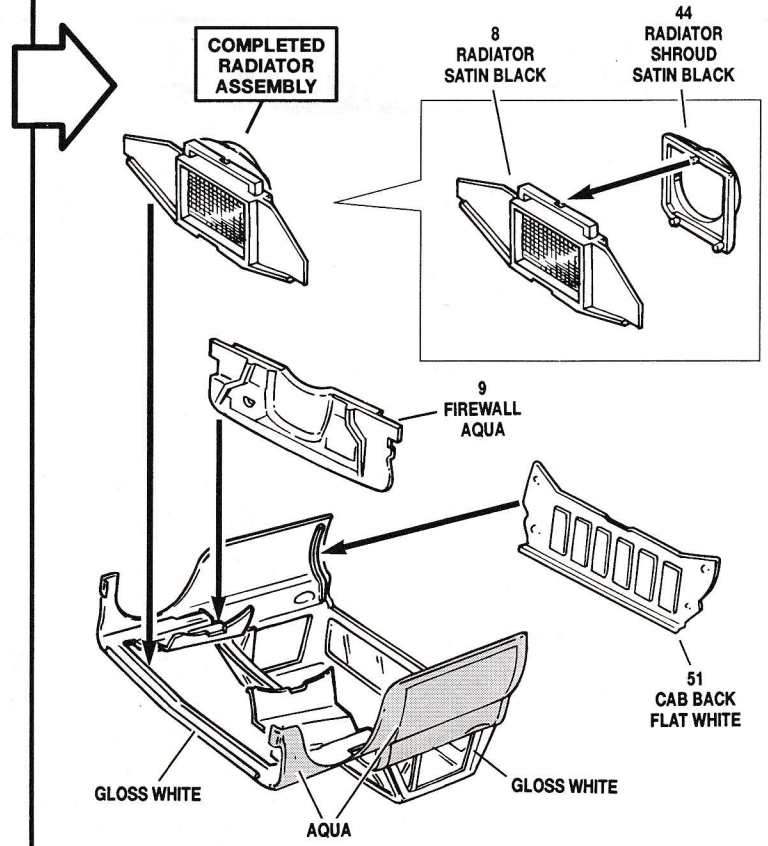
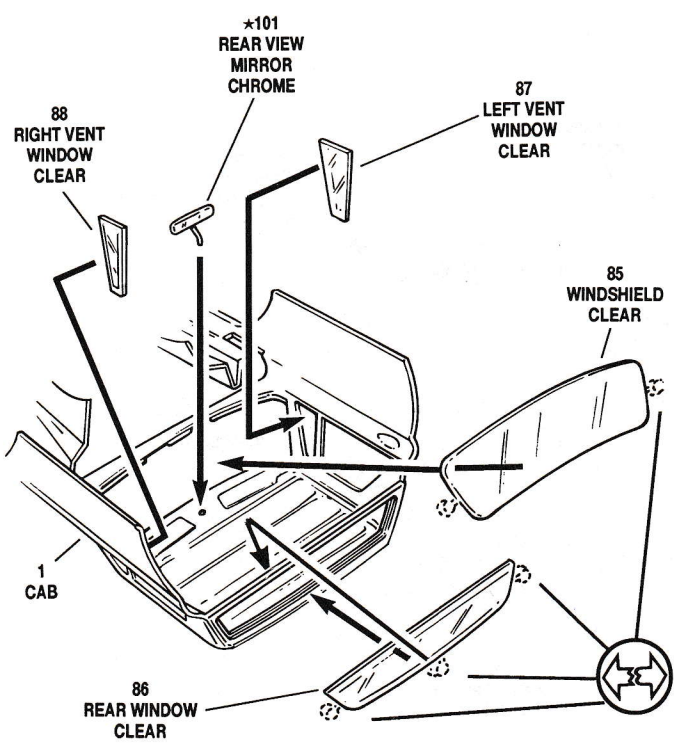

3 CAB ASSEMBLY CONTINUED

PAINT PICK-UP AND SKI BOAT BODY COLOR GLOSS WHITE AND AQUA OR MATCH PAINT TO MODELS SHOWN ON BOX.

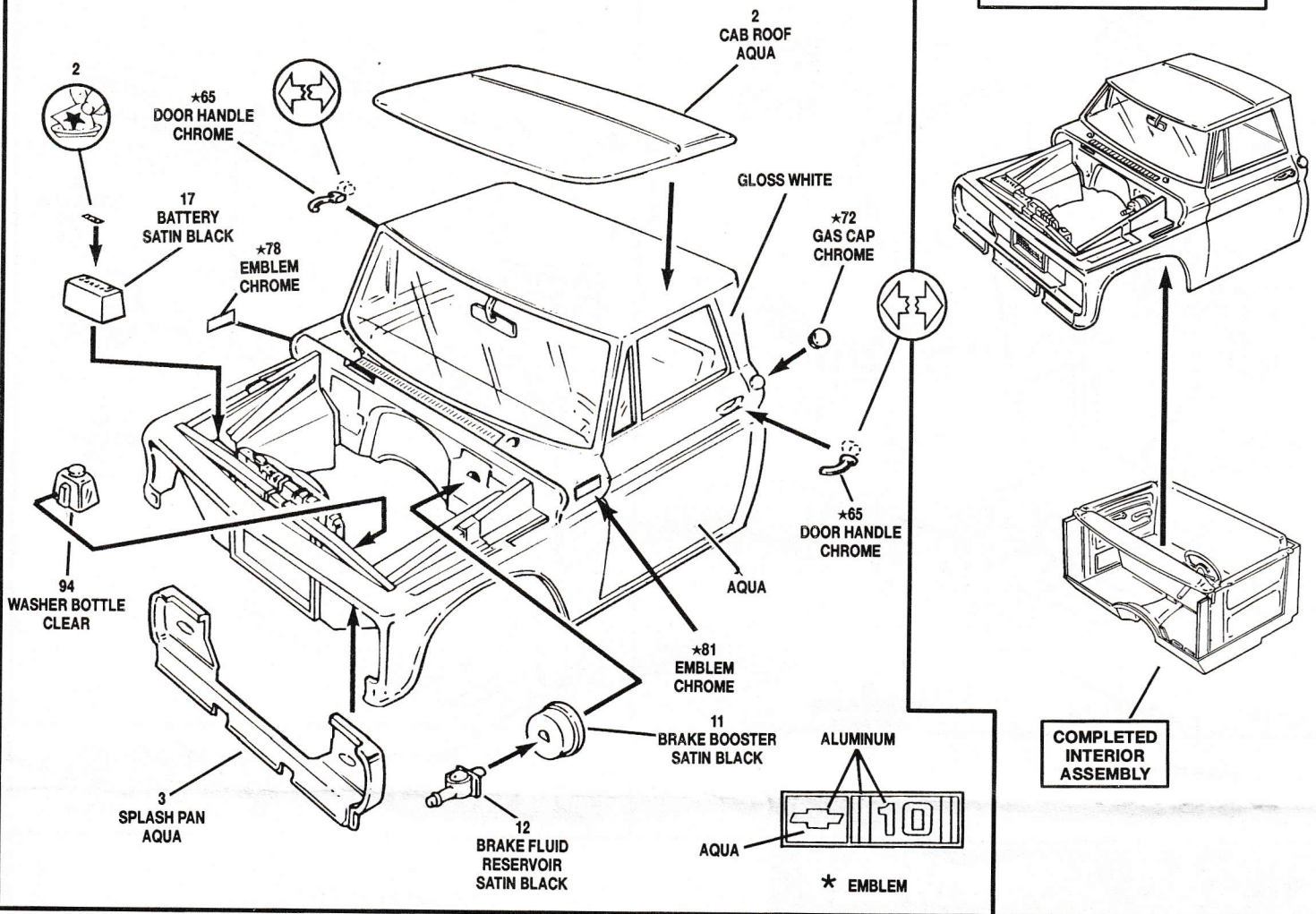

4 BED ASSEMBLY

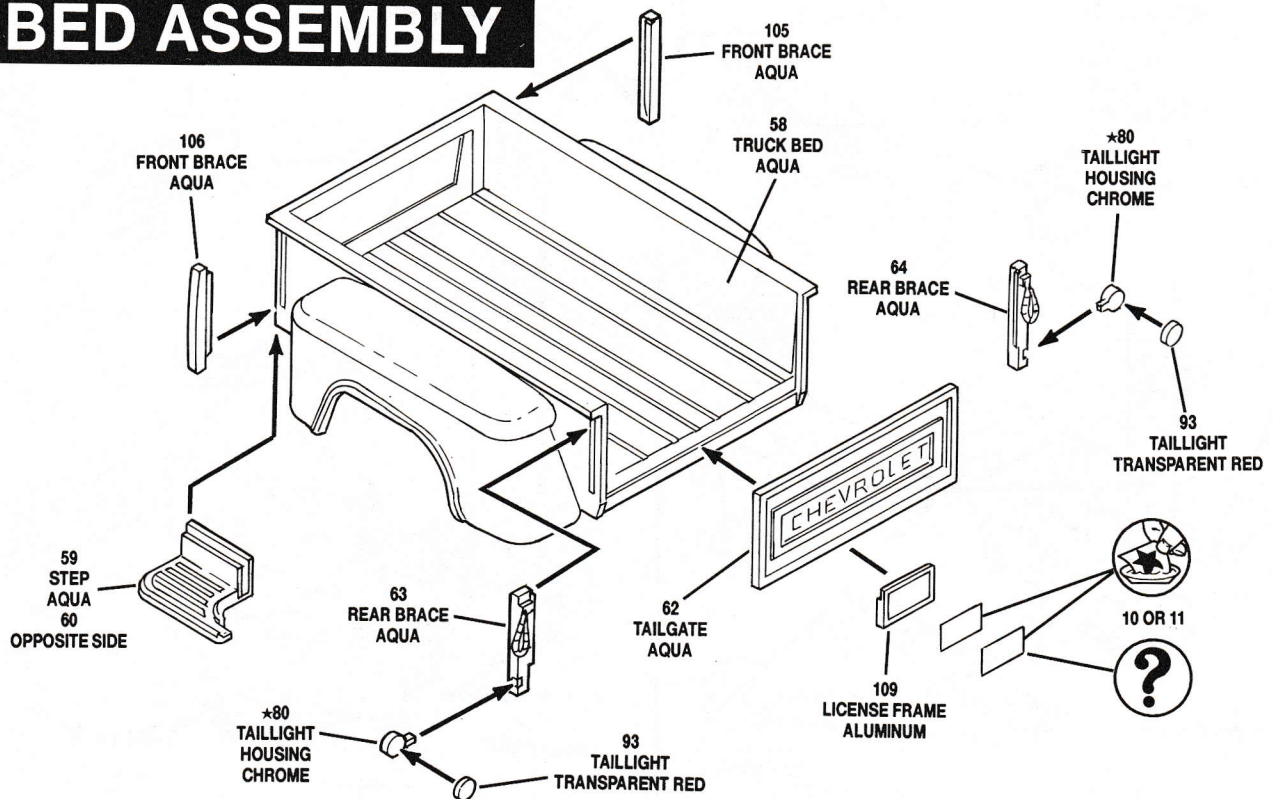

5 CHASSIS ASSEMBLY

COMPLETED
FRONT SUSPENSION
ASSEMBLY

42
FRONT SUSPENSION
SATIN BLACK

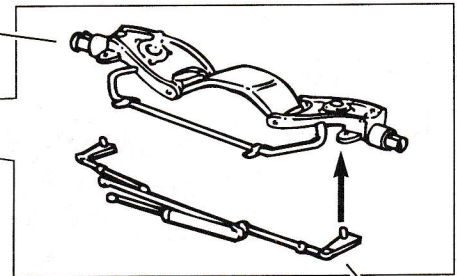

43
TIE ROD
SATIN BLACK

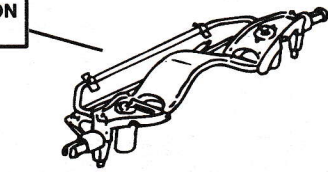

41
FRAME
SATIN BLACK

48
EXHAUST PIPE
STEEL

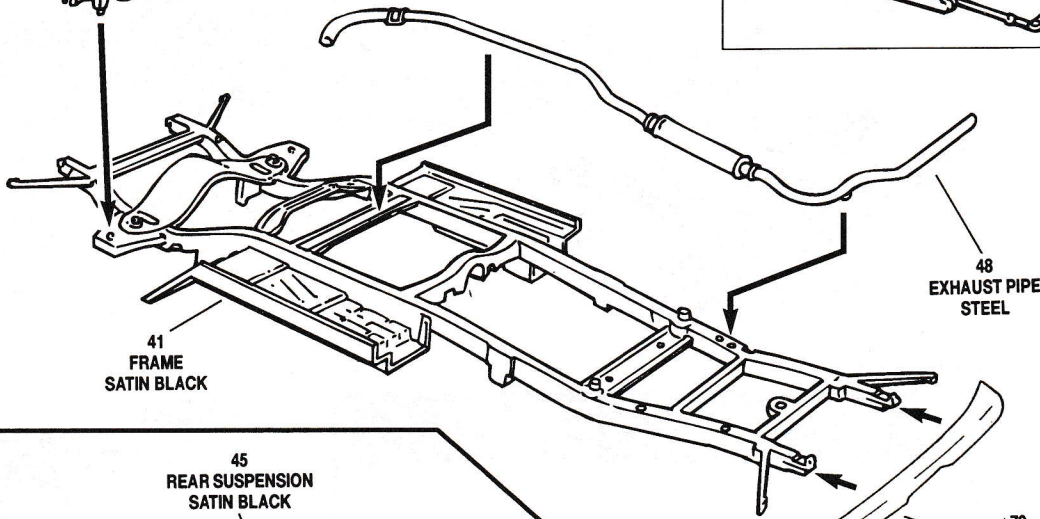

*79
BUMPER
CHROME

45
REAR SUSPENSION
SATIN BLACK

46
TORSION BAR
SATIN BLACK

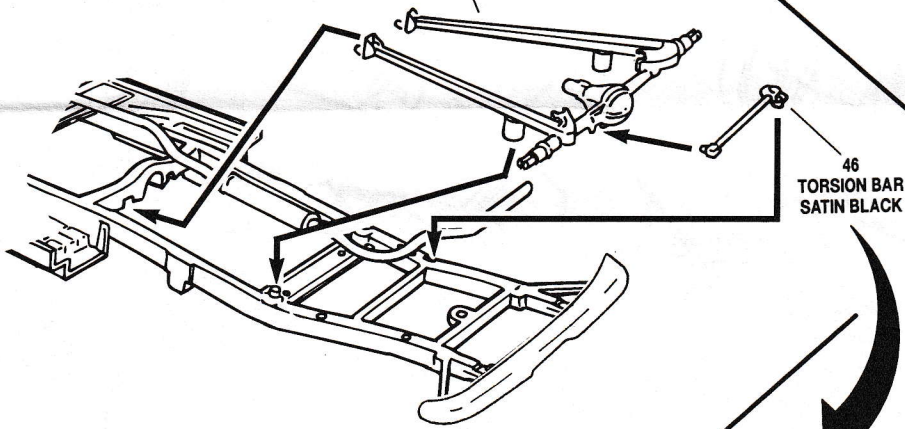

110
SPARE TIRE
BRACKET
STEEL

107
INNER WHEEL
STEEL

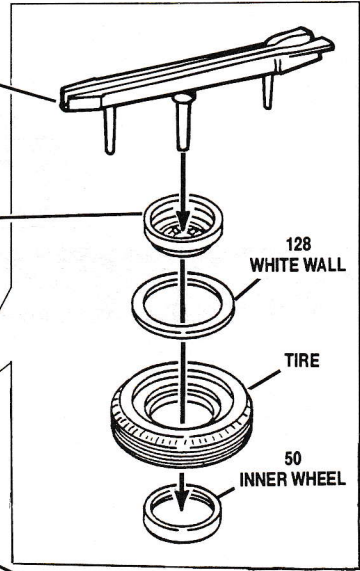

128
WHITE WALL

TIRE

50
INNER WHEEL

COMPLETED
SPARE TIRE
ASSEMBLY

99
FRONT SHOCK
SATIN BLACK

47
REAR SHOCK
SATIN BLACK

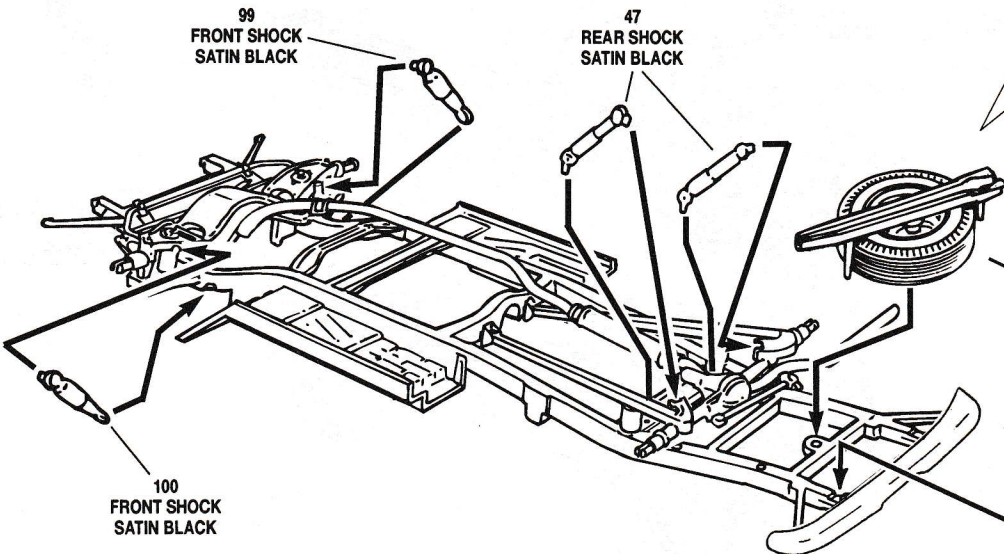

100
FRONT SHOCK
SATIN BLACK

62
TRAILER HITCH
STEEL

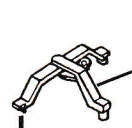

5 CHASSIS ASSEMBLY CONT.

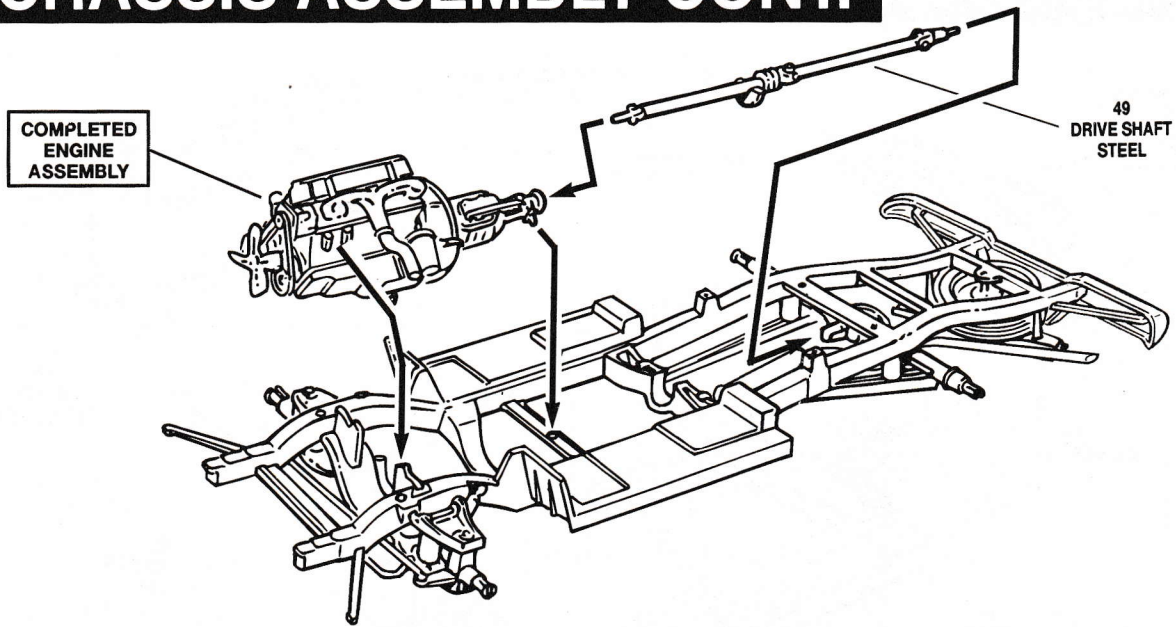

6 TIRE/WHEEL ASSEMBLY

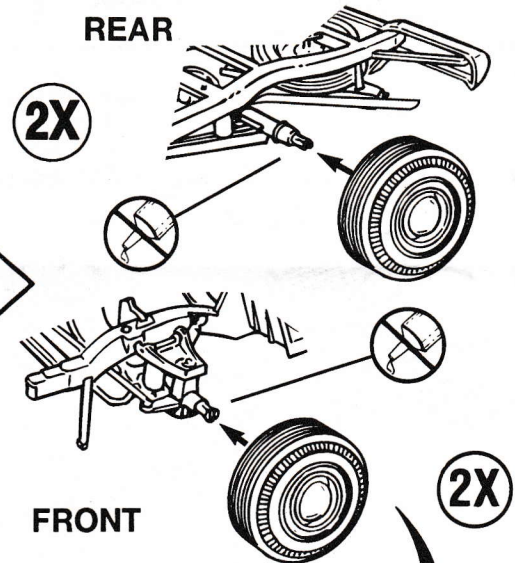
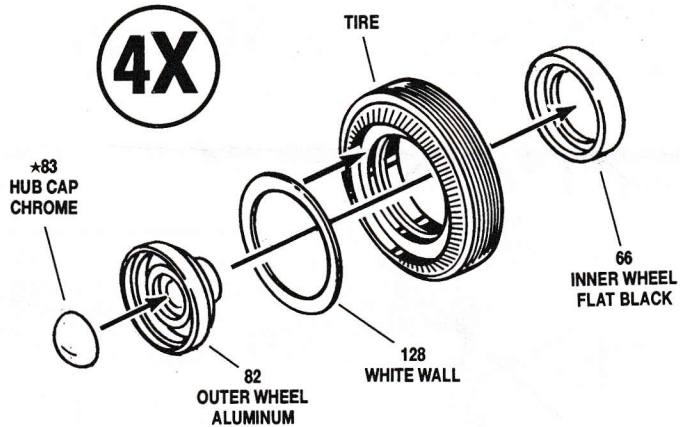

7 FINAL ASSEMBLY

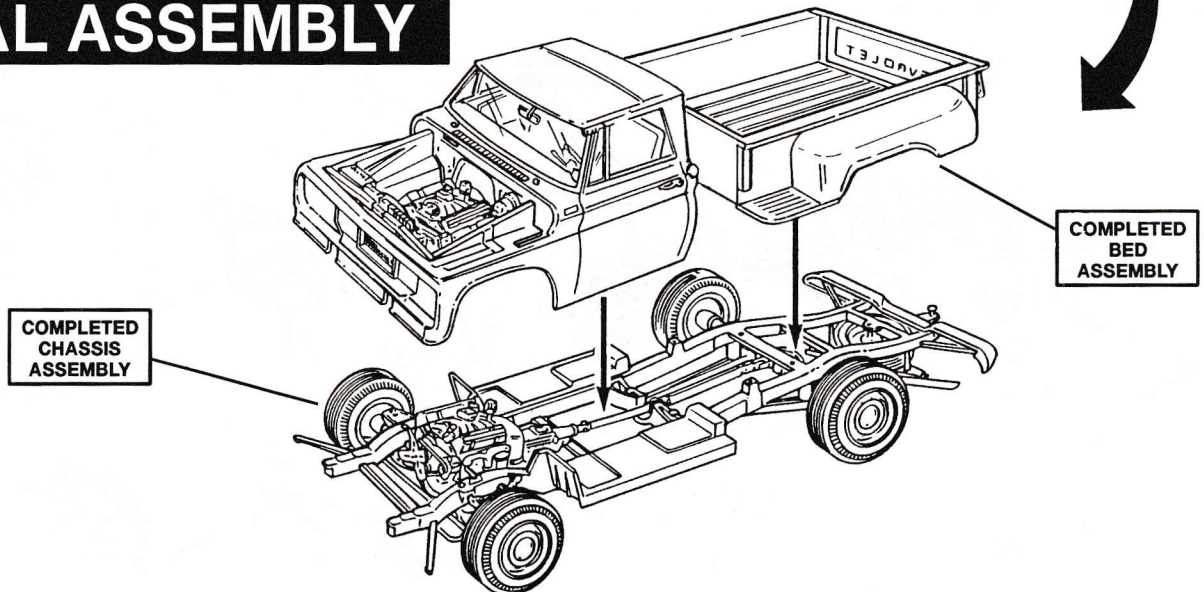

7 FINAL ASSEMBLY CONT.

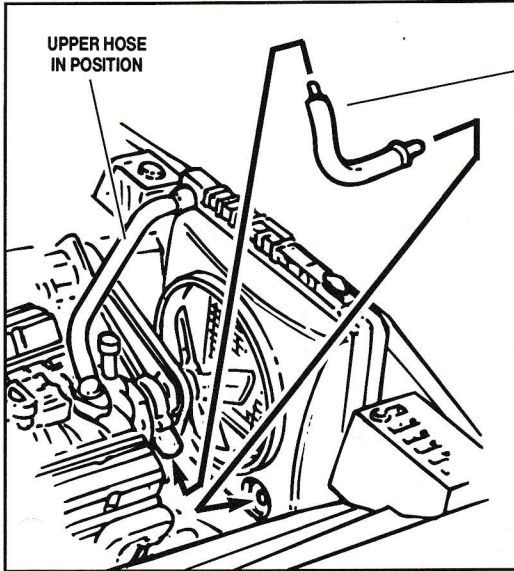

16
LOWER
RADIATOR HOSE
FLAT BLACK

40
AIR CLEANER
SATIN BLACK



*74
RIGHT
SIDE MIRROR
CHROME

*104
WINDSHIELD
WIPER
CHROME

*108
WINDSHIELD
WIPER
CHROME

2

10
HEATER
SATIN BLACK

3

84
HOOD LATCH
SATIN BLACK

*73
LEFT
SIDE MIRROR
CHROME

15
UPPER
RADIATOR HOSE
FLAT BLACK

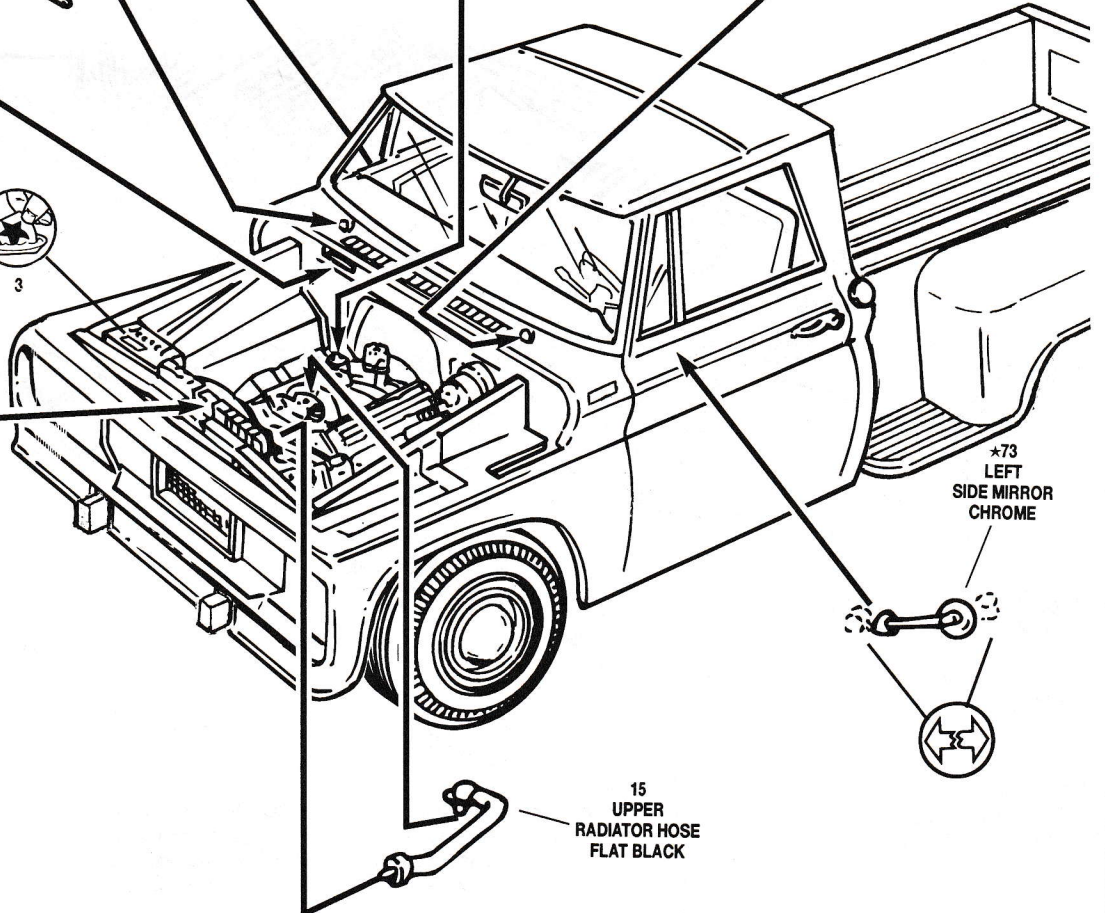

7 FINAL ASSEMBLY CONT.

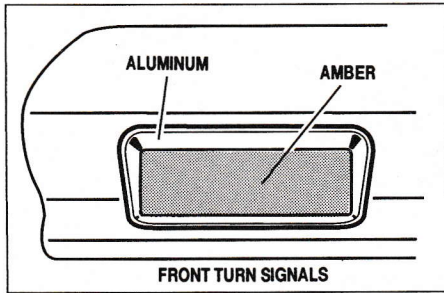

COMPLETED HOOD ASSEMBLY

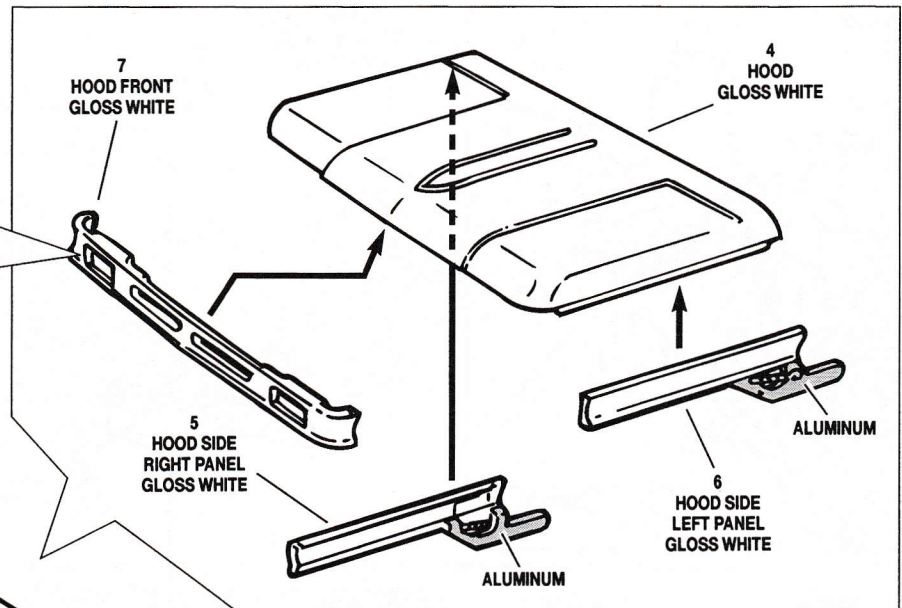
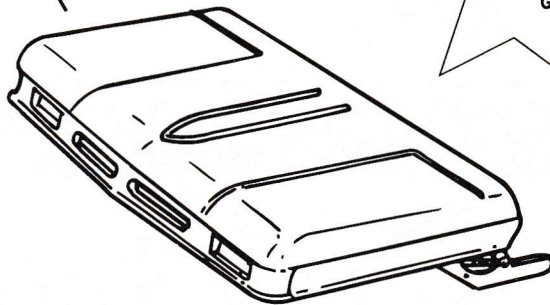

90 HEAD LIGHT LENS CLEAR

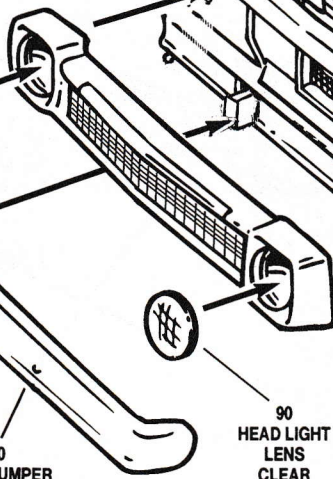

*70 FRONT BUMPER CHROME



6 REPEAT FOR OTHER SIDE USE DECAL 5

CUT LICENSE PLATE WITH PAPER BACKING AND GLUE TO BUMPER.

Every effort has been made to create and manufacture a model kit that is the finest available. If a part may be missing, please write to:

Be sure to include the kit number, part number, description, and your return address.

Revell-Monogram, Inc.
 Consumer Service Department
 8601 Waukegan Road
 Morton Grove, Illinois 60053

1/25 SCALE

1/25 ECHELLE

ESCALA 1/25



Water skiing has been, for quite some time, one of America's most popular sports. All summer long, lakes across the country are swarming with skiers skimming across the water, getting wet, and in general having fun.

Now, Hot Rodding is also one of America's favorite outdoor sports, and as you may have guessed, somewhere a couple of years ago an avid Hot Rodder caught the water skiing bug. He dismantled his street roadster, bought a ski boat, and combined the two!

The trend caught on and now the weekend ski boat is much more than it used to be. The lakes are now swarming with metallflake hulled, chrome engined, fire breathin' monsters capable of churning water at speeds up to 100 M.P.H.

Your Revell "Hemi Hydro" is an example of what is pulling skiers over the water at vacation spots across the country. Everything from its plush upholstery to its stompin' '392 Chrysler Hemi, make it a Hot Rodder's dream, on the water.

1 ENGINE ASSEMBLY

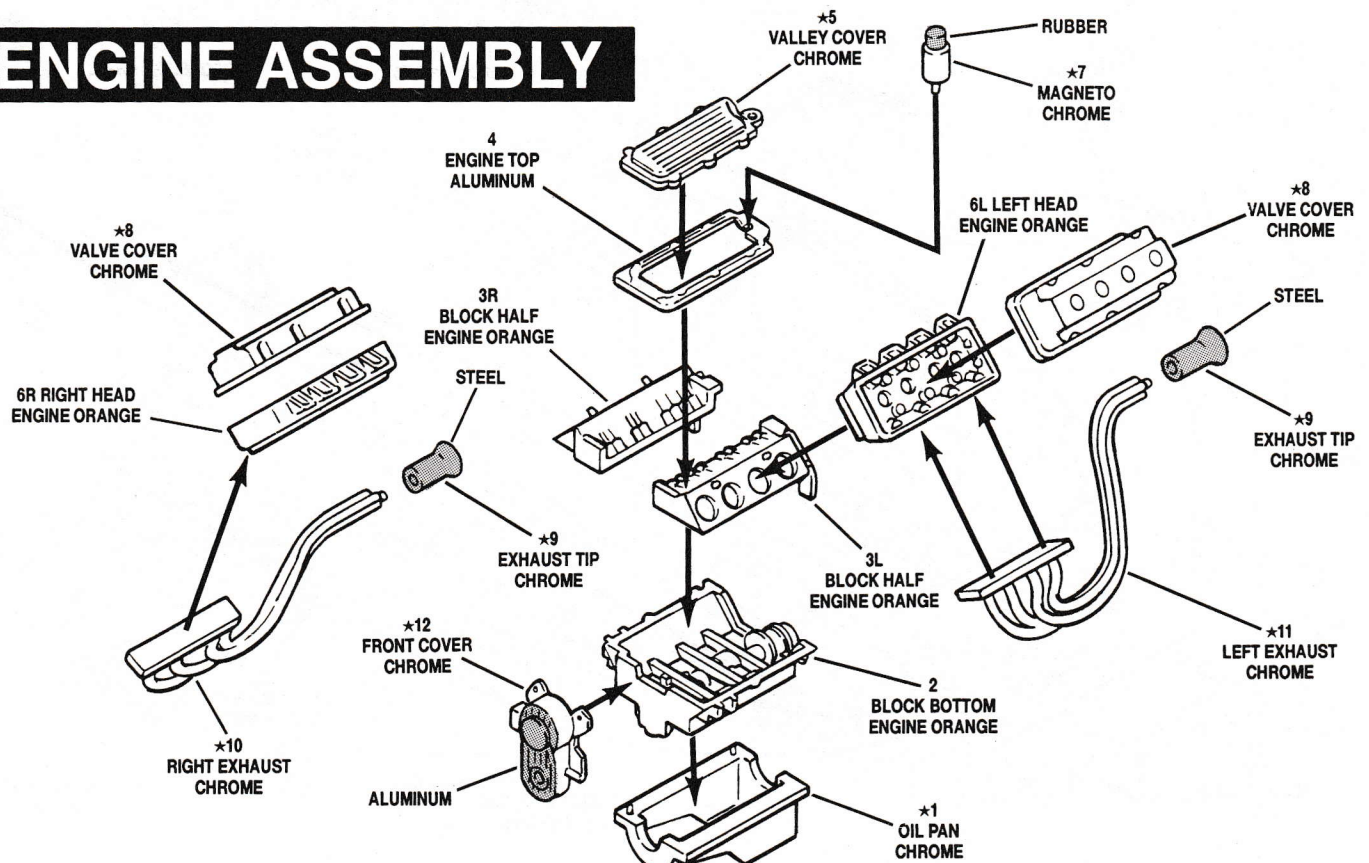

1 ENGINE ASSEMBLY CONT.

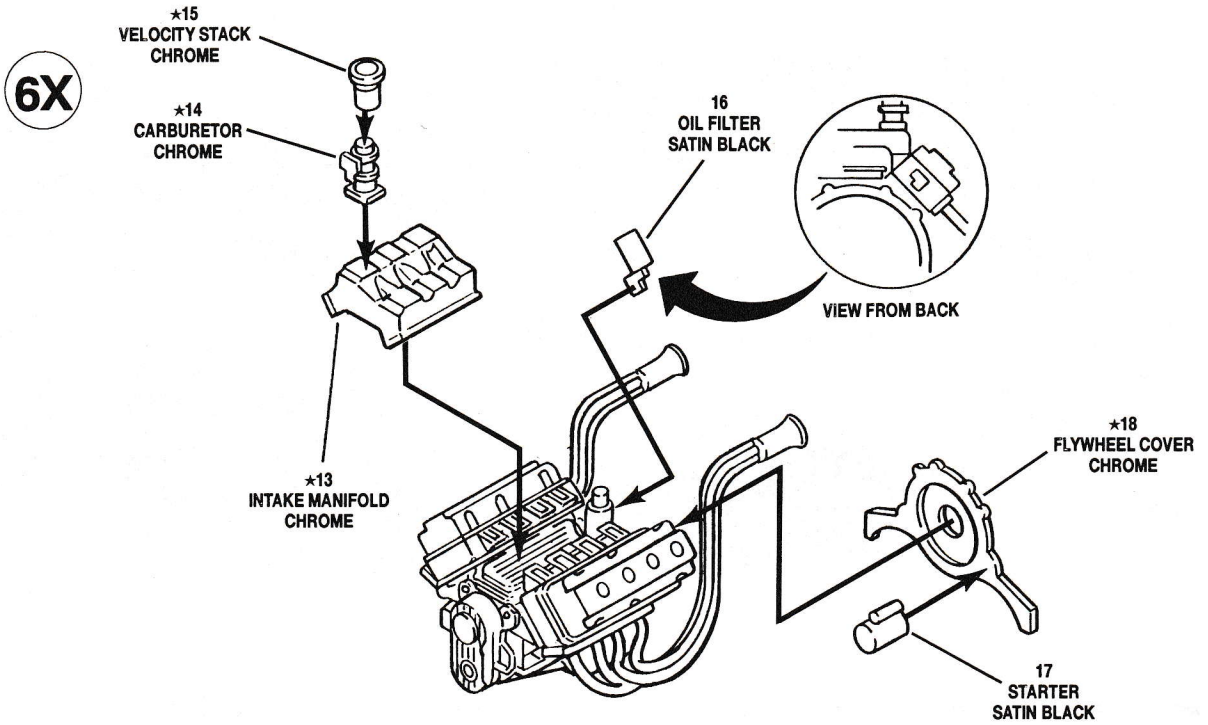

2 HULL ASSEMBLY

PAIN'T PICK-UP AND SKI BOAT BODY COLOR GLOSS WHITE AND AQUA OR MATCH PAINT TO MODELS SHOWN ON BOX.

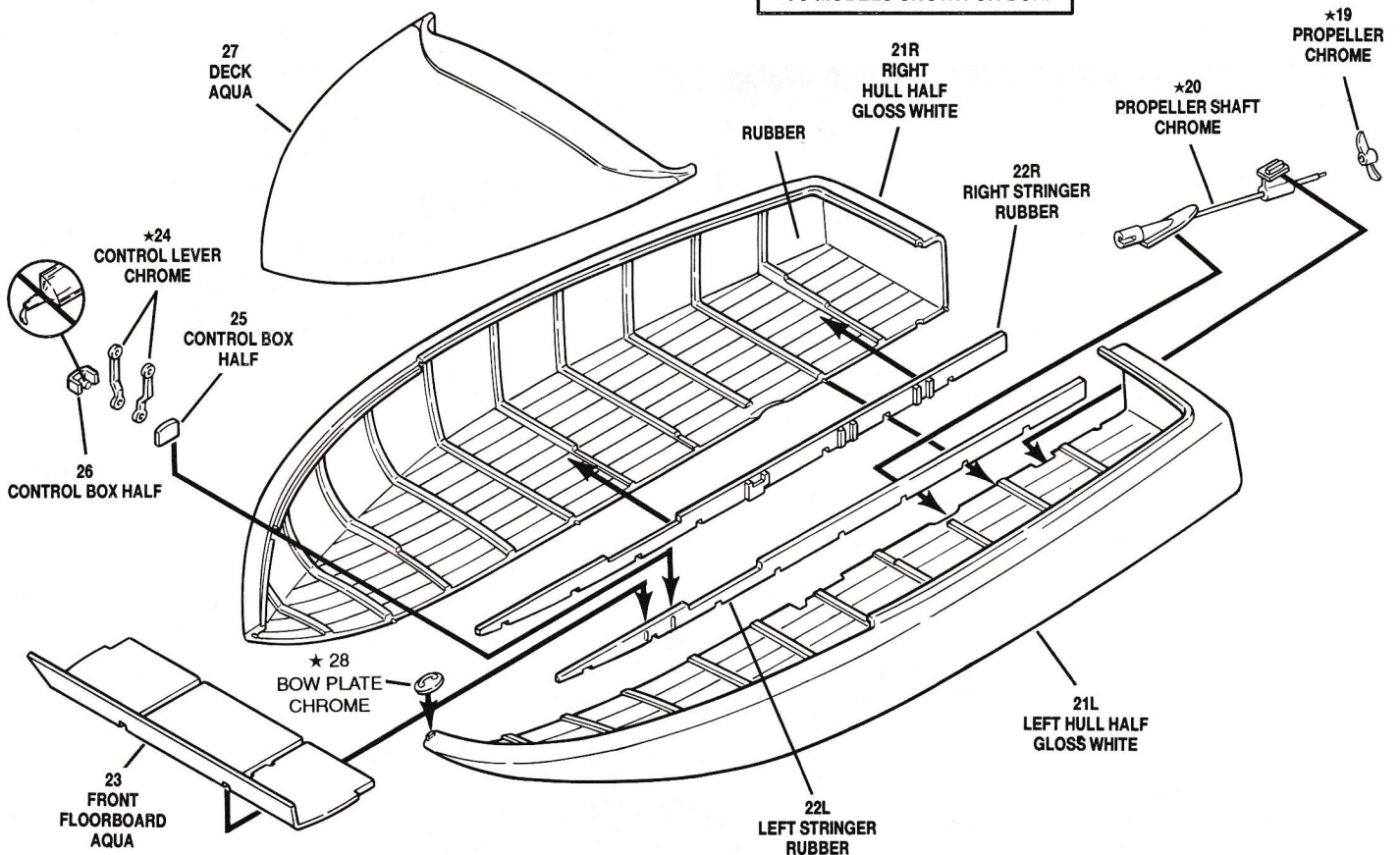

3 INTERIOR ASSEMBLY

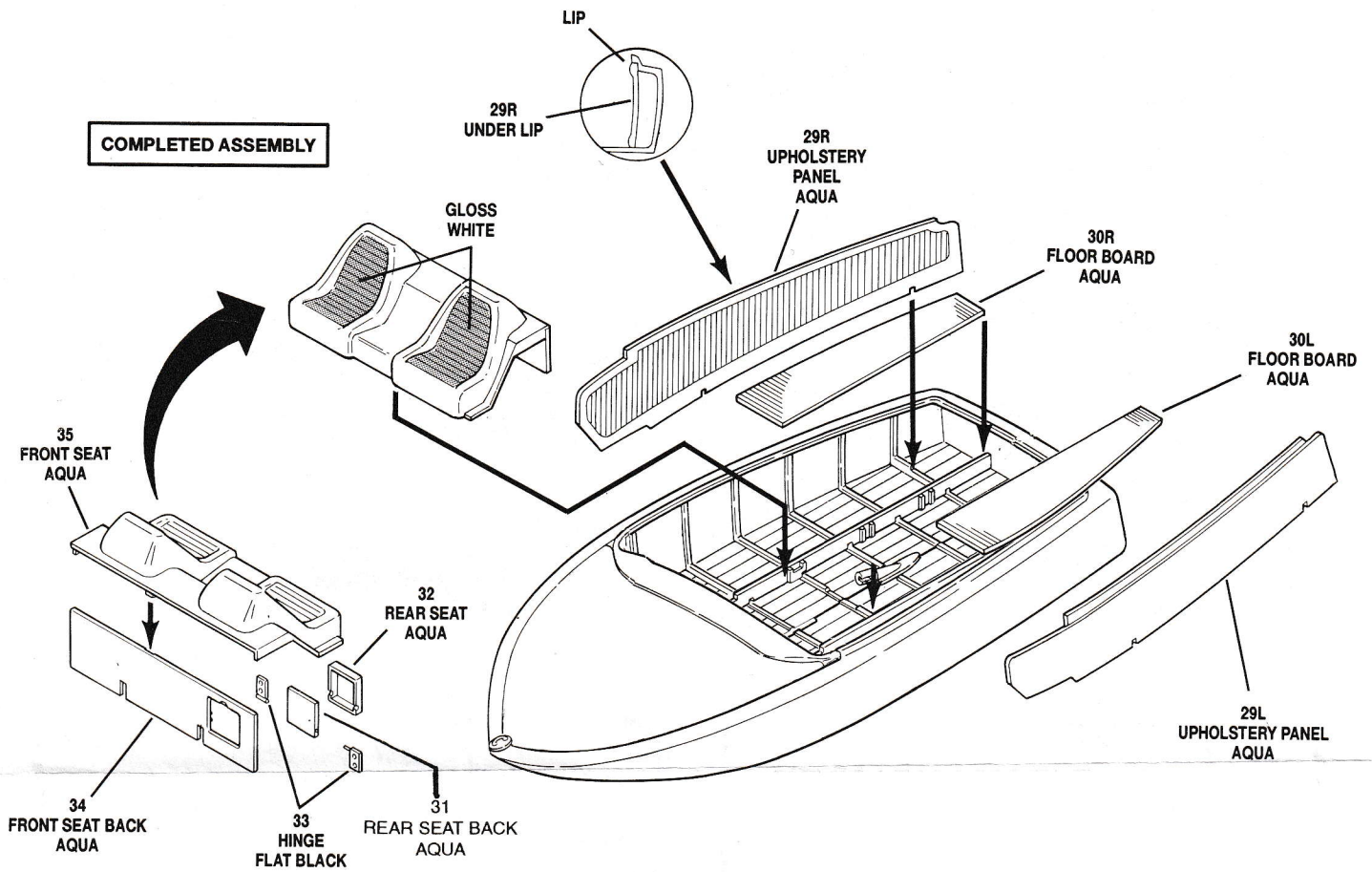

4 ENGINE/FITTINGS ASSEMBLY

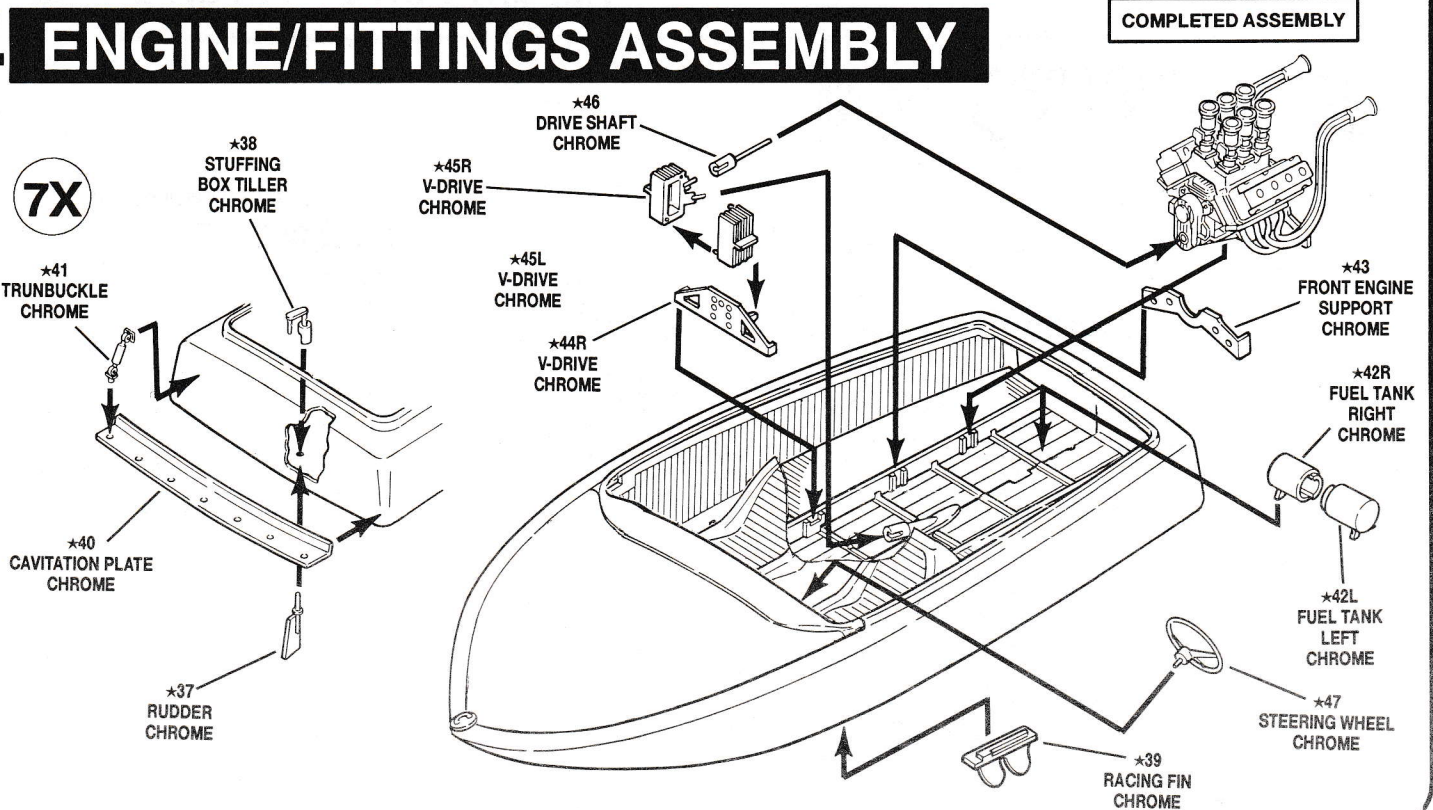

5 TRAILER ASSEMBLY

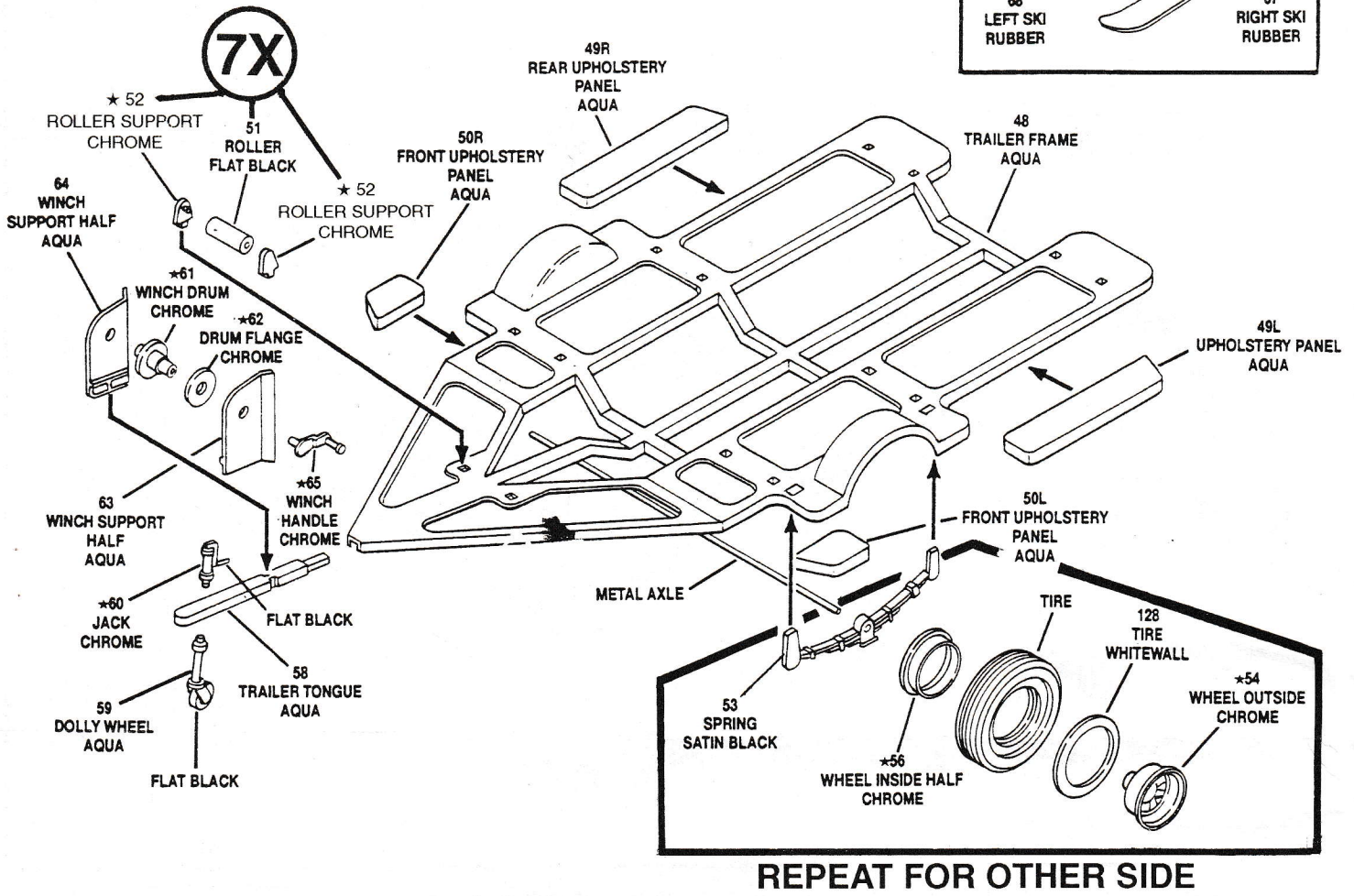

6 APPLY DECALS



DECAL NOT COMPATIBLE WITH SETTING SOLUTIONS OR SOLVENTS

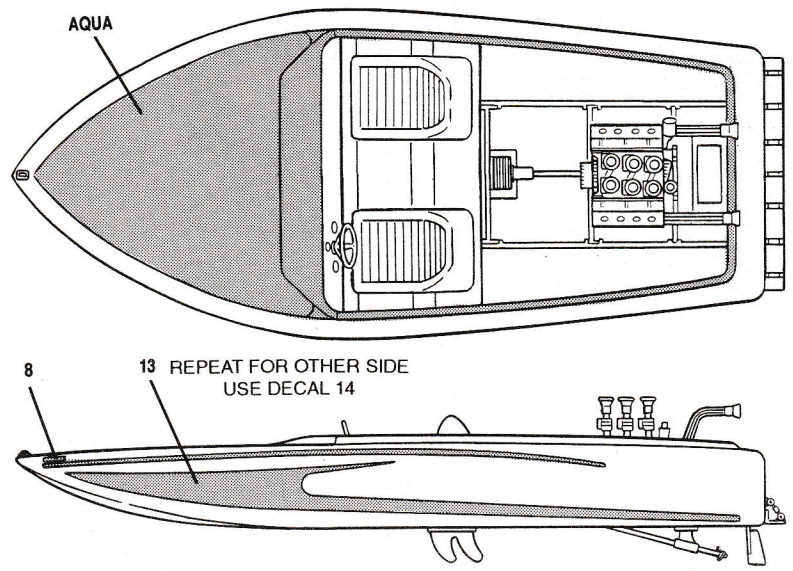

- DECAL APPLICATION INSTRUCTIONS**
1. Wash plastic parts in mild detergent solution. Rinse and let dry.
 2. Cut desired decal from sheet.
 3. Dip decal in water for a few seconds.
 4. Place wet decal on paper towel.
 5. Wait until decal is movable on paper backing.
 6. Place decal in position on model, face up and slide backing away.
 7. Press out air bubbles with a soft damp cloth.
 8. Milkiness that may appear is for better decal adhesion and will dry clear. Wipe away any excess adhesive.
 9. Do not touch decal until fully dry.