

Stavíte rádi vrtulníky? Postavte si DRACHE!  
Do you like to build helicopters? Why don't you build DRACHE!

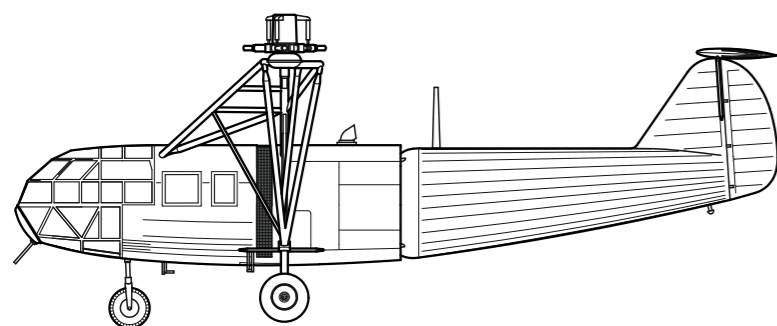

SH48020 Focke Achgelis Fa 223 Drache

1/48

SH48062

H-21 Shawnee

2007/10

10

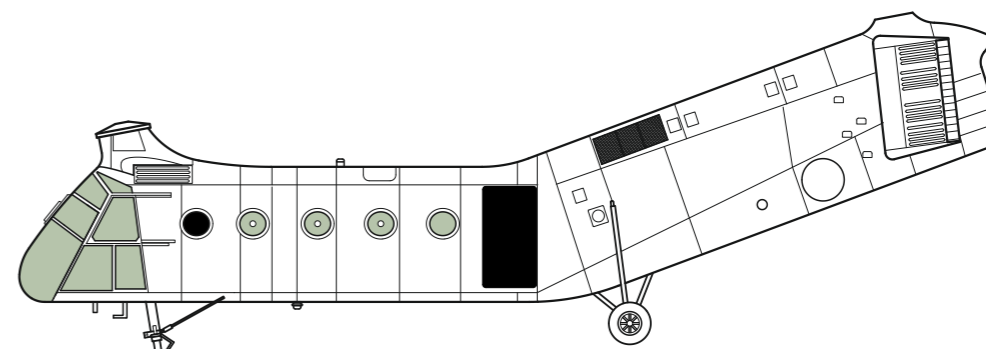

NÁVOD / INSTRUCTION

CZ - Historie

SH48062 H-21 Shawnee

1/48

Firma Piasecki vyvinula na základě stroje HRP-2 stavěného pro námořnictvo USA transportní dvourotorový vrtulník továrního označení PD-22. Původně byl určen pro USAF, které po testech prototypu s vojenským označením XH-21 objednalo postupně osmnáct a pak třicet dva kusů ve verzi H-21A Workhorse. Dále byla vyráběna ve více než stopadesátikusové serii verze H-21B se silnější verzí motoru R-1820. Pro US Army byla stavěna serie H-21C, a ta dostala bojové jméno Shawnee. Stroje US Army se zúčastnily bojů ve Vietnamu. Tam se při transportu vojáků nesporně osvědčily. Postupně je však nahradily vrtulníky Boeing Vertol CH-47. Ty vyráběla po odchodu F. Piaseckého do společnosti Vertol přetransformovaná společnost Piasecki. Vertol také pokračoval ve výrobě H-21C pod továrním označením Model 43. Starší verze dostaly zpětně označení Model 41 (H-21A) a Model 42 (H-21B). V roce 1962 se navíc změnilo vojenské označení typu na CH-21. Kromě služby v barvách jednotlivých složek vojsk USA se H-21 dostaly do služby v Kanadě, Německu a Francii. Zatím co kanadské H-21A byly používány jako záchrané, francouzské H-21 se dočkaly nasazení v Alžírě. Vertol také vyrobil civilní verze Model 44A, určený belgickou Sabenu a Model 44B. Ten používala francouzská vláda a švédské námořnictvo. To své stroje upravilo i pro protiponorkové lety.

Tech. data:

Délka: 16,00 m, výška: 4,80 m, průměr rotoru: 13,41 m, max. rychlost: 204 km/h, dolet: 644 km, dostup: 2360 m

EN - History

Based on HRP-2 machine produced for US Navy, Piasecki Helicopter developed new tandem rotor helicopter under company designation PD-22. It was originally intended for USAF. When the prototype with military designation XH-21 had successfully passed the trials USAF ordered 18 and subsequently 32 machines of version H-21A Workhorse. Production continued with H-21B version powered by improved R-1820 engine. More than 150 machines of H-21B were produced. H-21C version was named Shawnee and was produced for US Army. These machines were deployed to Vietnam combat zone where they proved to be efficient for troops' transports. Later, H-21s were replaced by Boeing Vertol CH-47. Piasecki Helicopter was acquired by Boeing in 1960 and renamed Boeing Vertol. Production of H-21C continued under company designation Model 43 at Vertol. The earlier versions were re-designated by return to Model 41 (H-21A) and Model 42 (H-21B). In 1962 the change of military designation led to change of H-21 to CH-21. Except of military service in USA, H-21s served in Canada, Germany and France. The Canadian ones were used as rescue helicopters, French H-21s were deployed to Algeria. Vertol also produced civil versions designated Model 44A for Belgian Sabena and Model 44B that were used by French Government and Swedish Navy that modified their machines for anti-submarine patrols.

Technical data:

Length: 16.00 m, Height: 4.80 m, Rotor diameter: 13.41 m, Max. Speed: 204 kmh, Range: 644 km, Service Ceiling: 2360 m

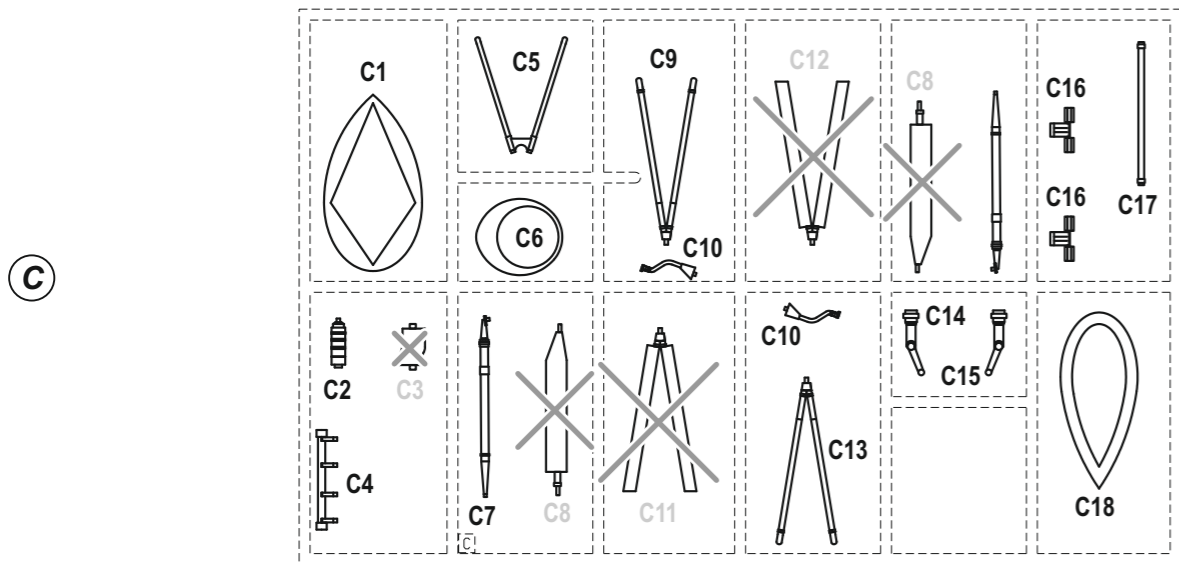
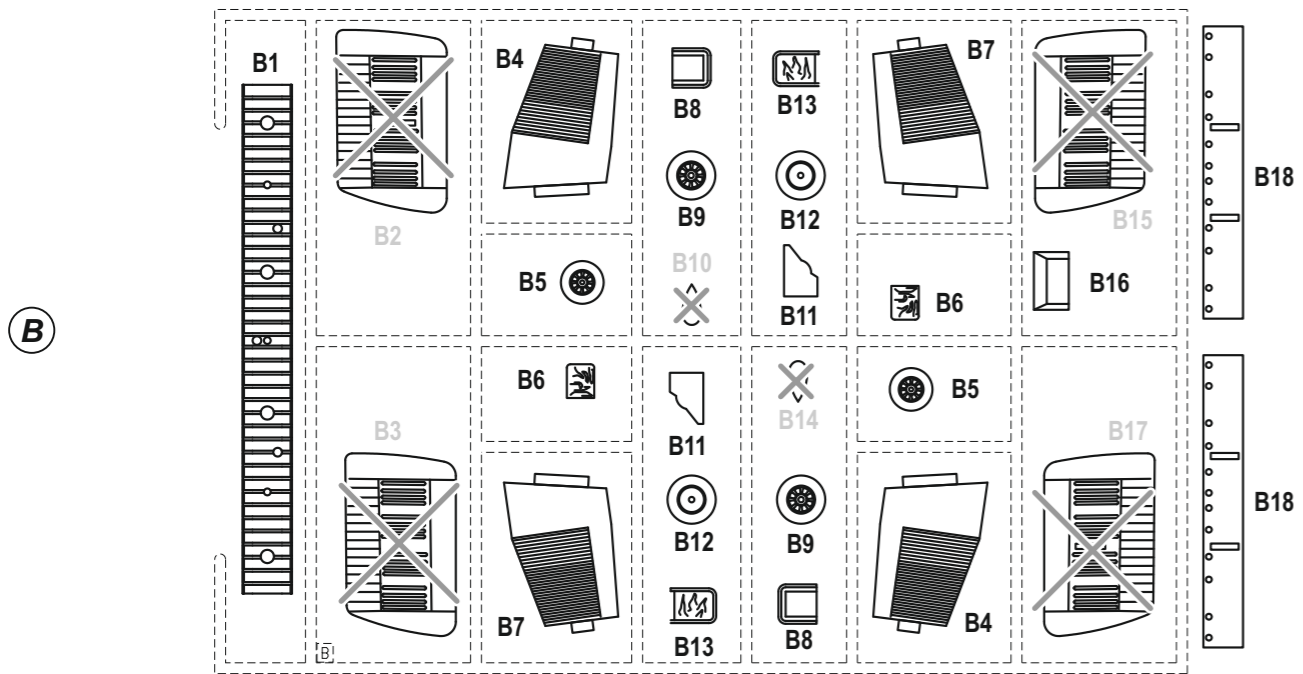
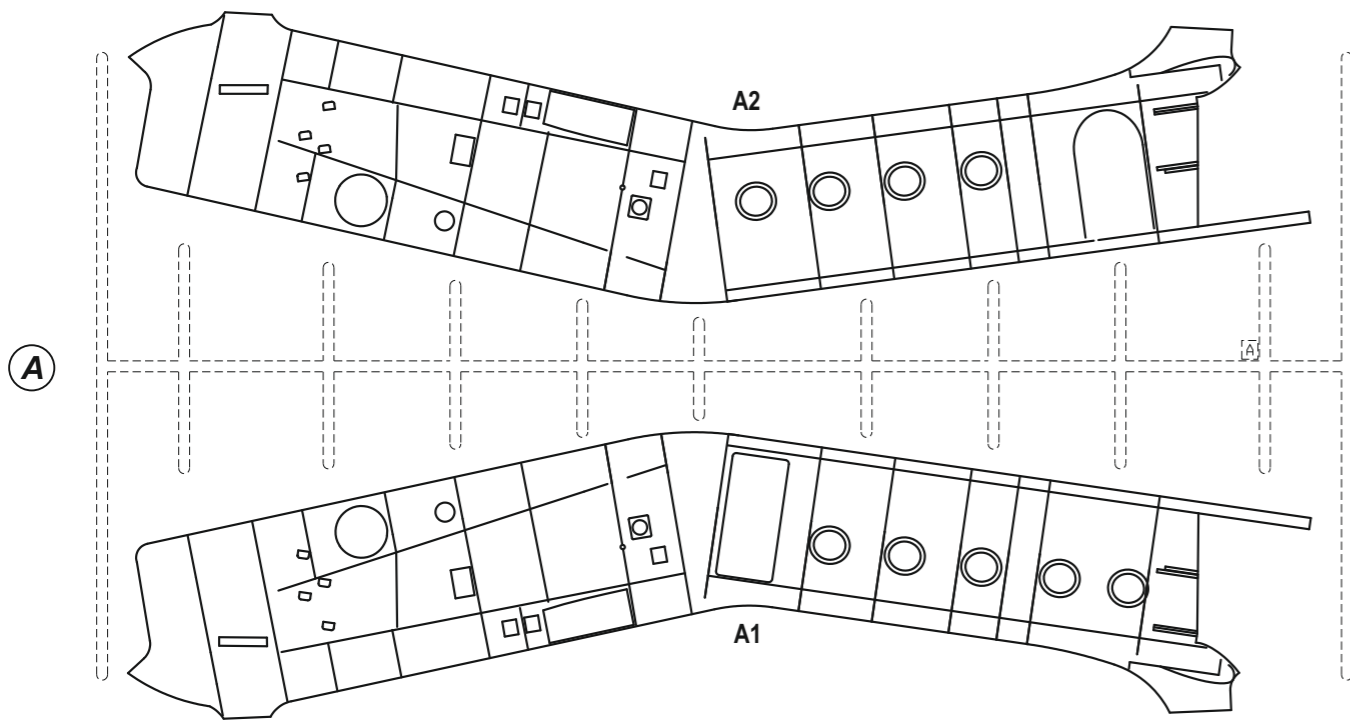

12

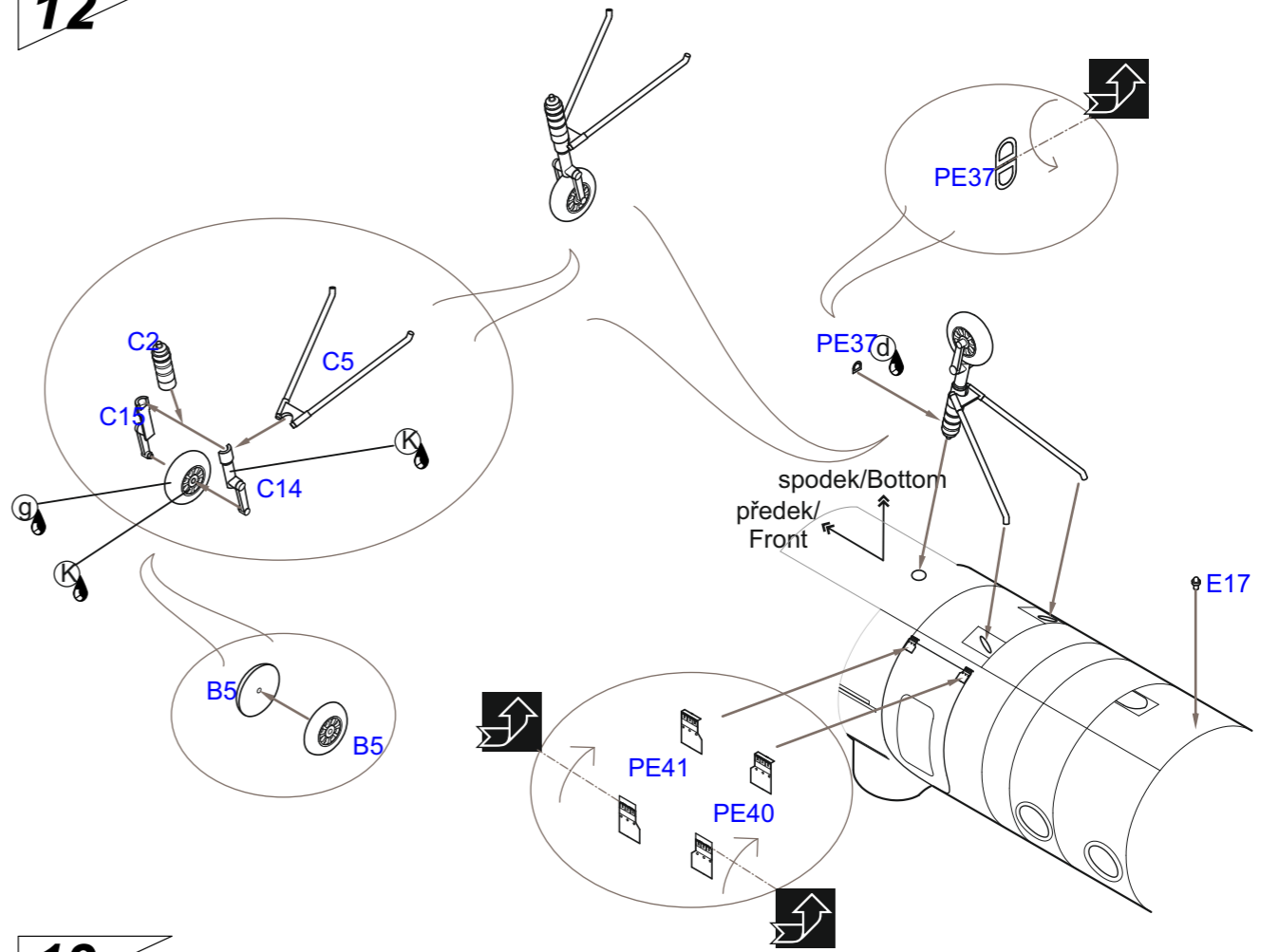

13

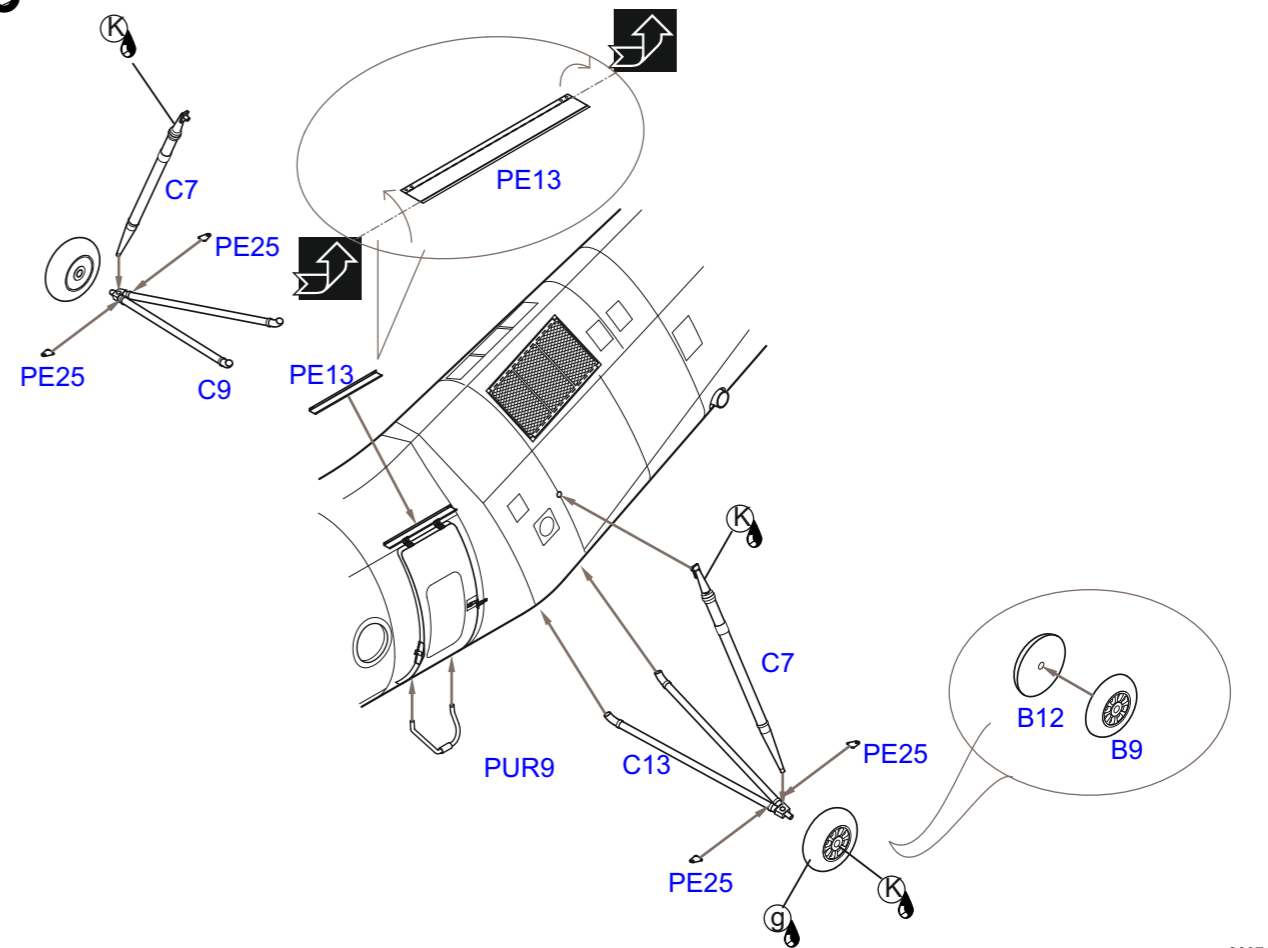

9

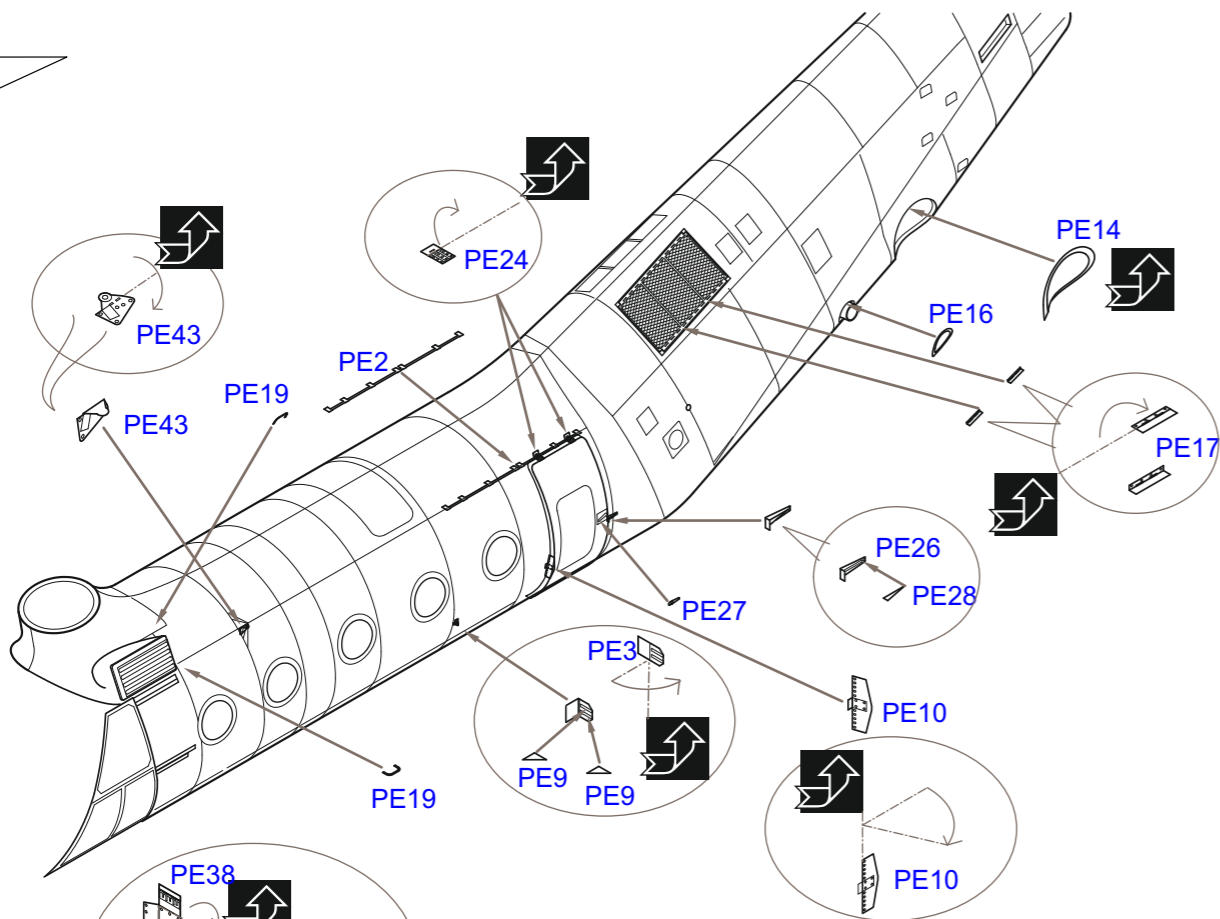

10

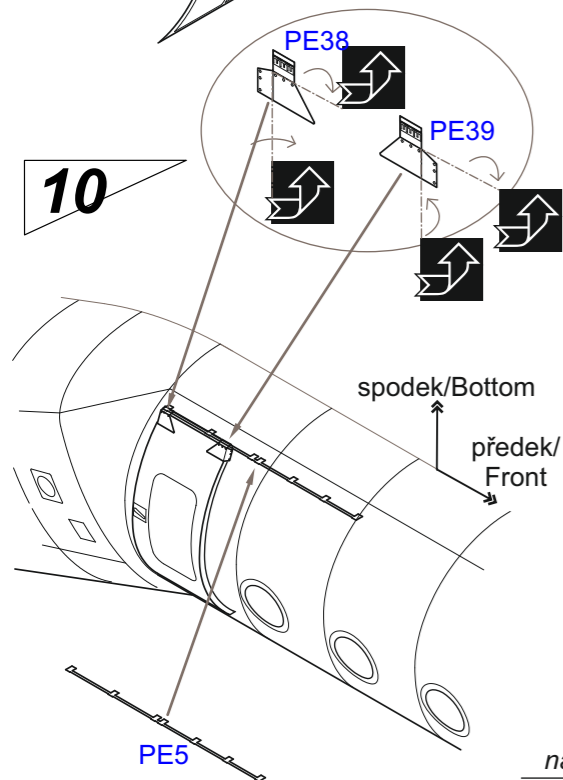

11

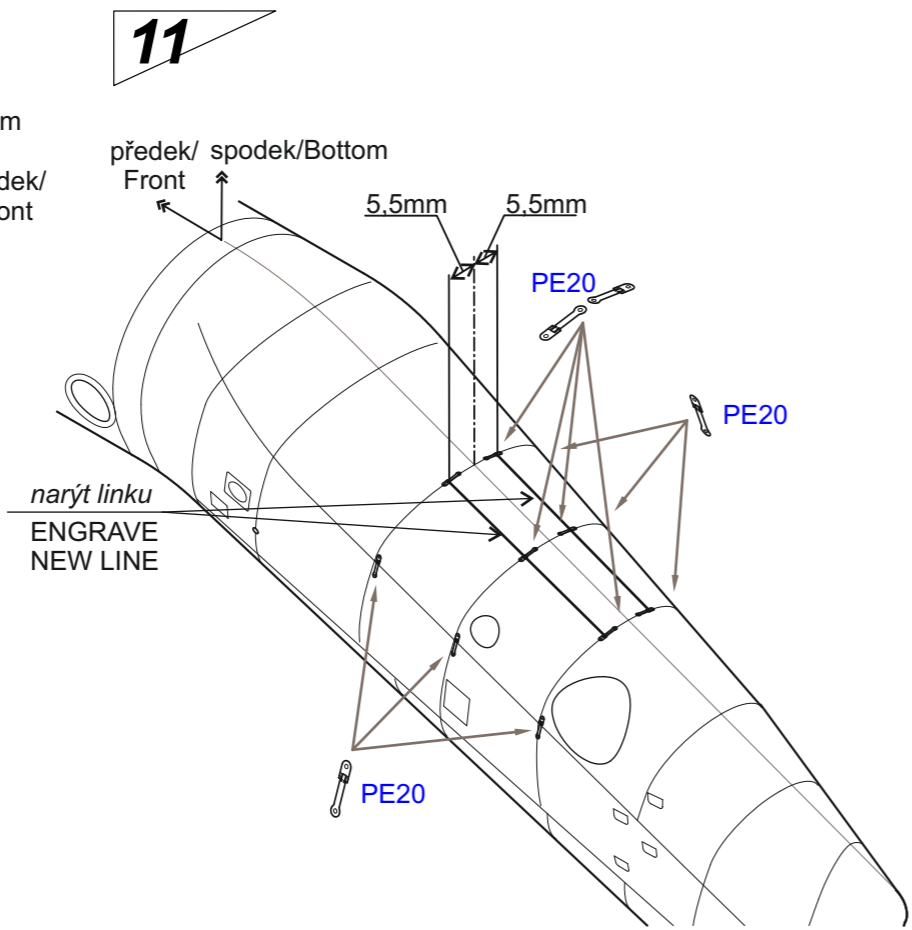

SH48062

H-21 Shawnee 8

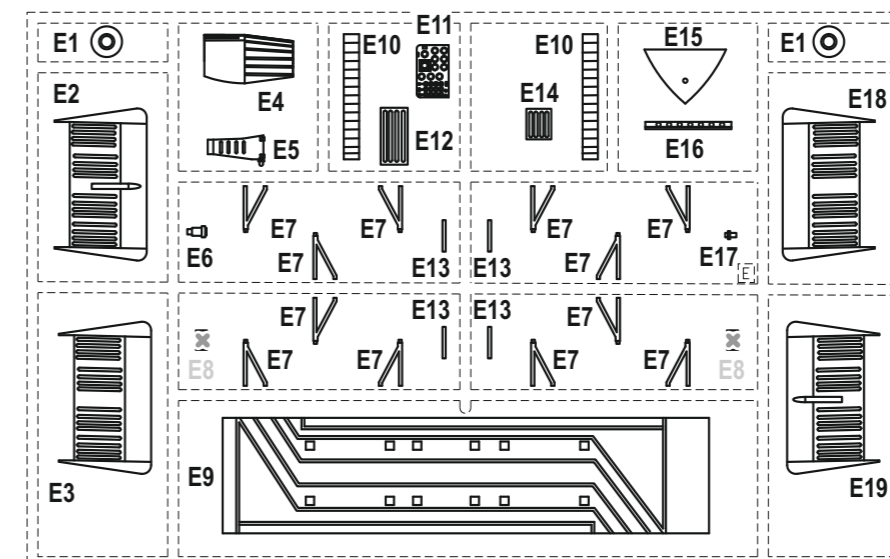
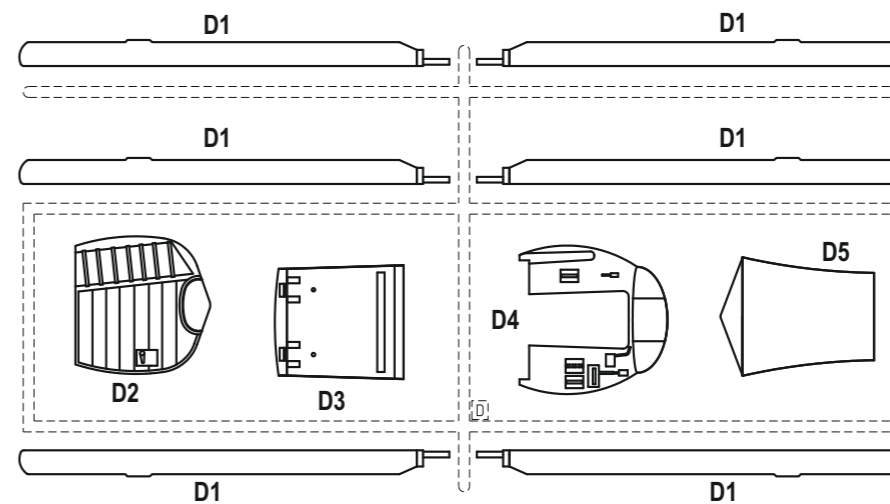

CLEAR PARTS (CP)

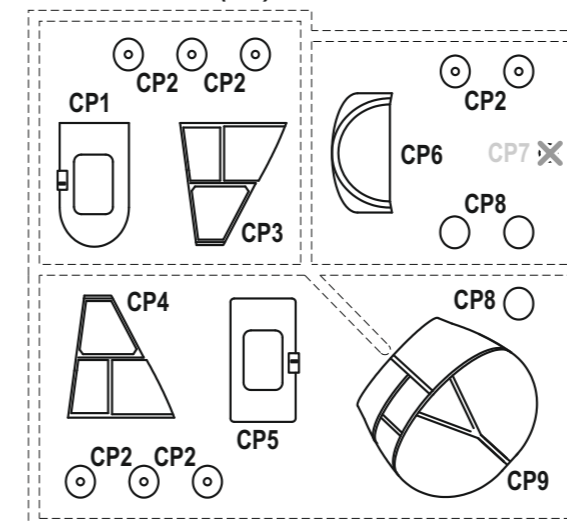

WHITE-METAL PART (WM)



PUR PARTS (PUR)

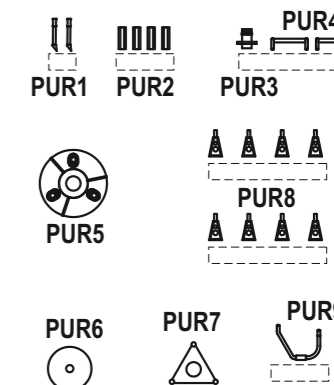
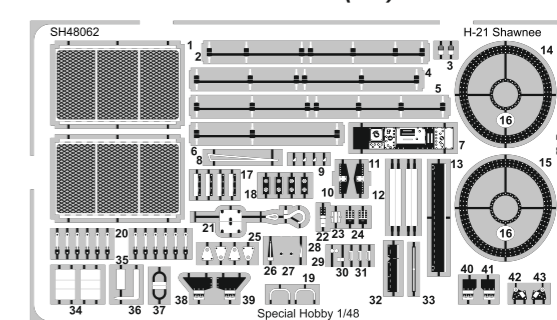

PHOTO-ETCHED PARTS (PE)



Barvy GUNZE/ GUNZE Col

- A Sv. šedá/ LIGHT GREY H1/C1
- b Červená/ RED H3/C3
- C Černá/ BLACK H12/C33
- d Žlutá/ YELLOW H4/C4
- e Bílá/ WHITE MC214
- f Zelená/ GREEN MC211
- g Černá pneu./ TIRE BLACK H42/C72
- h Opálený kov/ BURNT IRON MC218
- i Středně šedá/ GREY H77/C137
- J Interiér. zelená/ INTERIOR GREEN MC218
- K Hliník/ ALUMINIUM H8/C8



Možnost volby  
Optional  
Nach belieben  
Option



Rozdělit  
Cut with knife  
Mit Messer schneiden  
Couper au couteau



Lepidlo na kov  
Glue for metal  
Metallkleber  
Colle a metal



Ohnout  
Bend  
Biegen  
Courber



SH48062

H-21 Shawnee 3

1

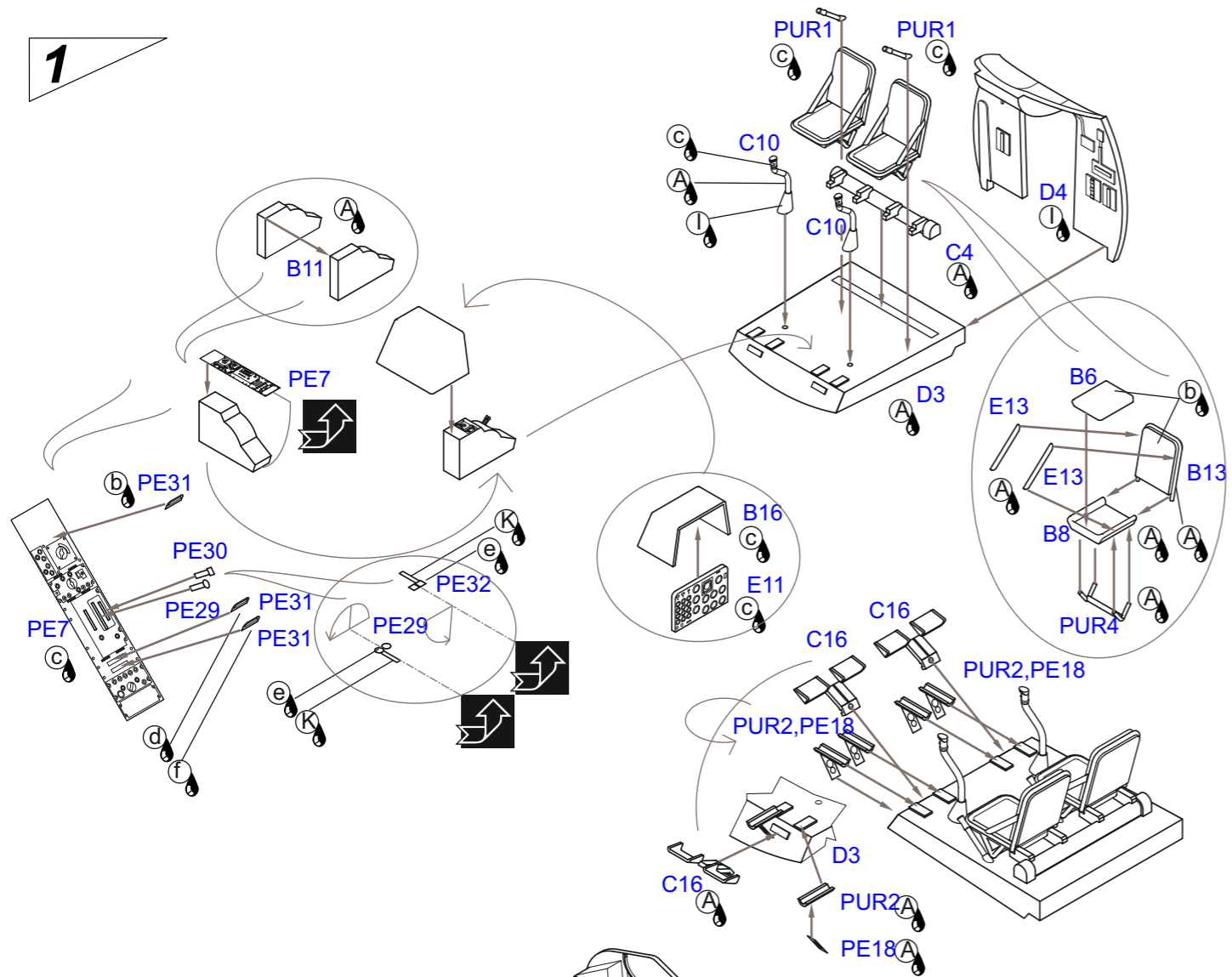

2

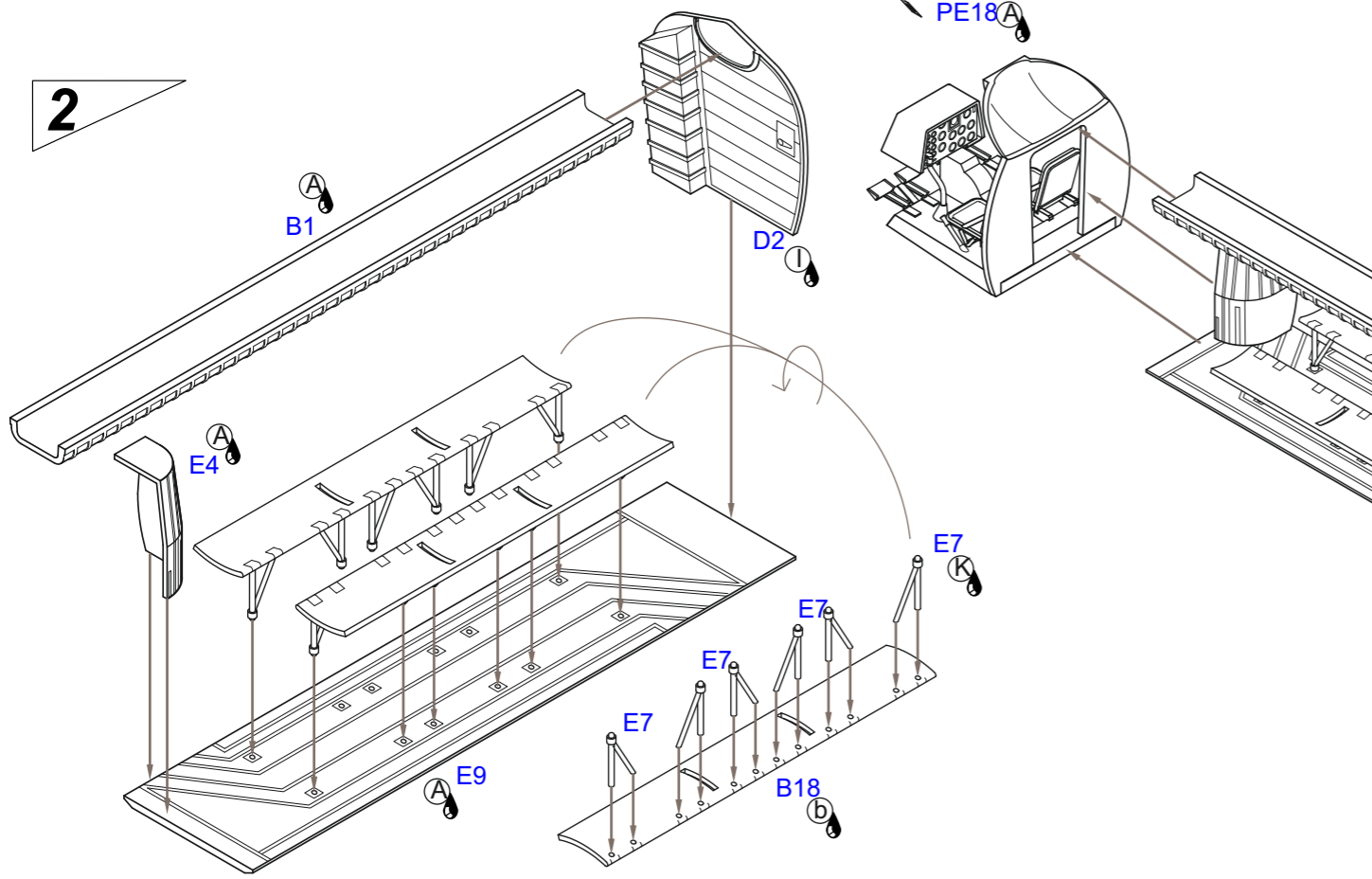

SH48062

2007/10 H-21 Shawnee 4

7

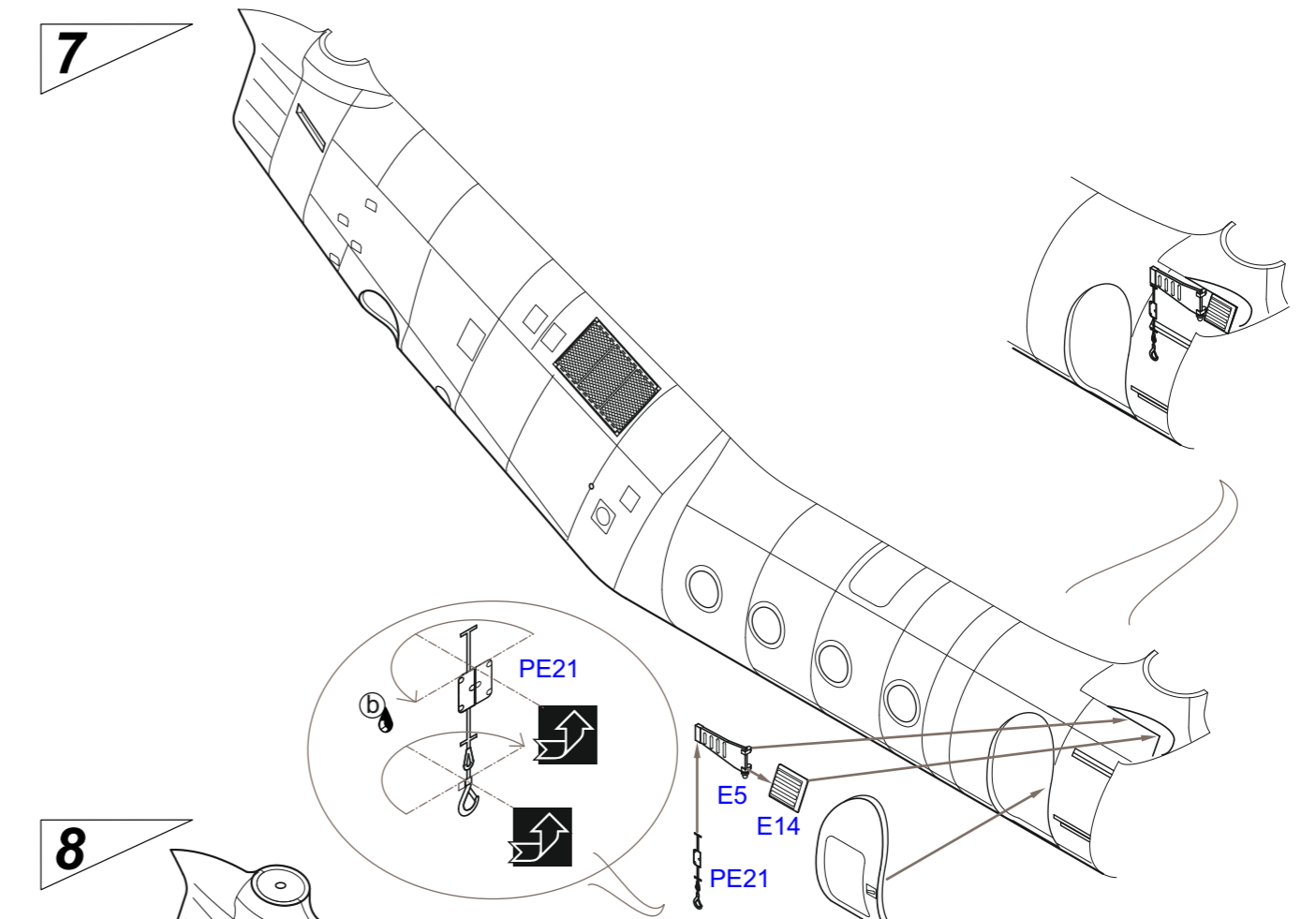

8

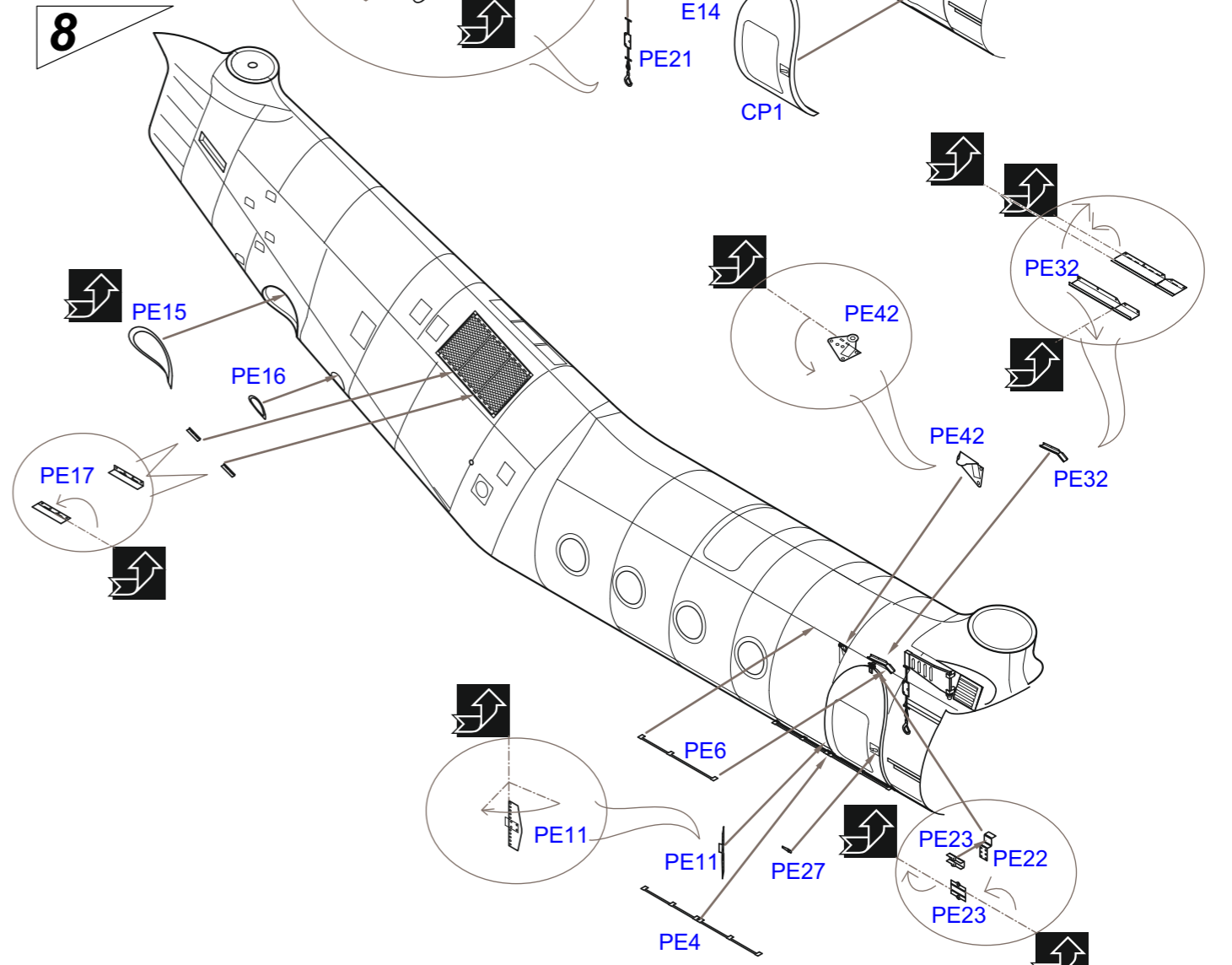

SH48062

2007/10 H-21 Shawnee 7

