

1/35 MILITARY MINIATURE VEHICLE UPGRADE SERIES PE35490

WWII German Sd.Kfz.232 8ROD early version

二战德军Sd.Kfz.232 8轮重型装甲车早期型改造件

[For AFV 35232]

推荐使用工具 RECOMMENDED TOOLS

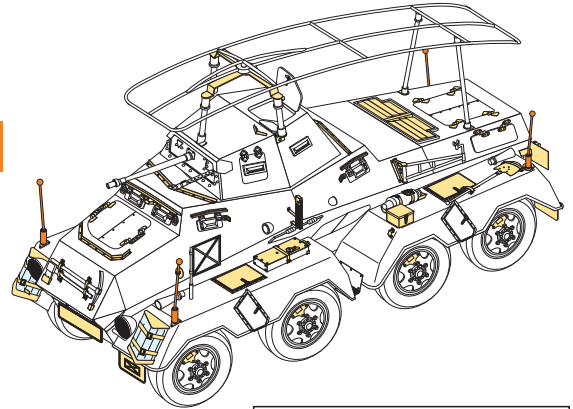
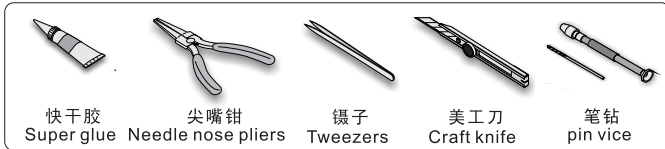

- 安装
install
- 折叠
bend
- A1**
改造件零件编号
PE/resin part number
- B12**
原零件编号
kit part number
- C22**
被替换的原零件编号
replaced kit part number
- 另一侧相同制作
repeat on opposite side
- 切除
remove
- 打磨
grind off
- 弧度卷曲
radial bending
- 制作若干组
multiple assembly
- 选择安装
alternative
- 钻孔
drill
- 用胶棒制作
make from plastic rod

用尖端在凹槽处冲压
use penpoint to press on the dent

蚀刻片零件内朝面向上
Put the part upside down
用笔尖在凹槽处刺
Use penpoint to press on the dent

Rear

Front

俯视图
Top view

a b c aa d e

1/35 MILITARY MINIATURE VEHICLE UPGRADE SERIES PE35490

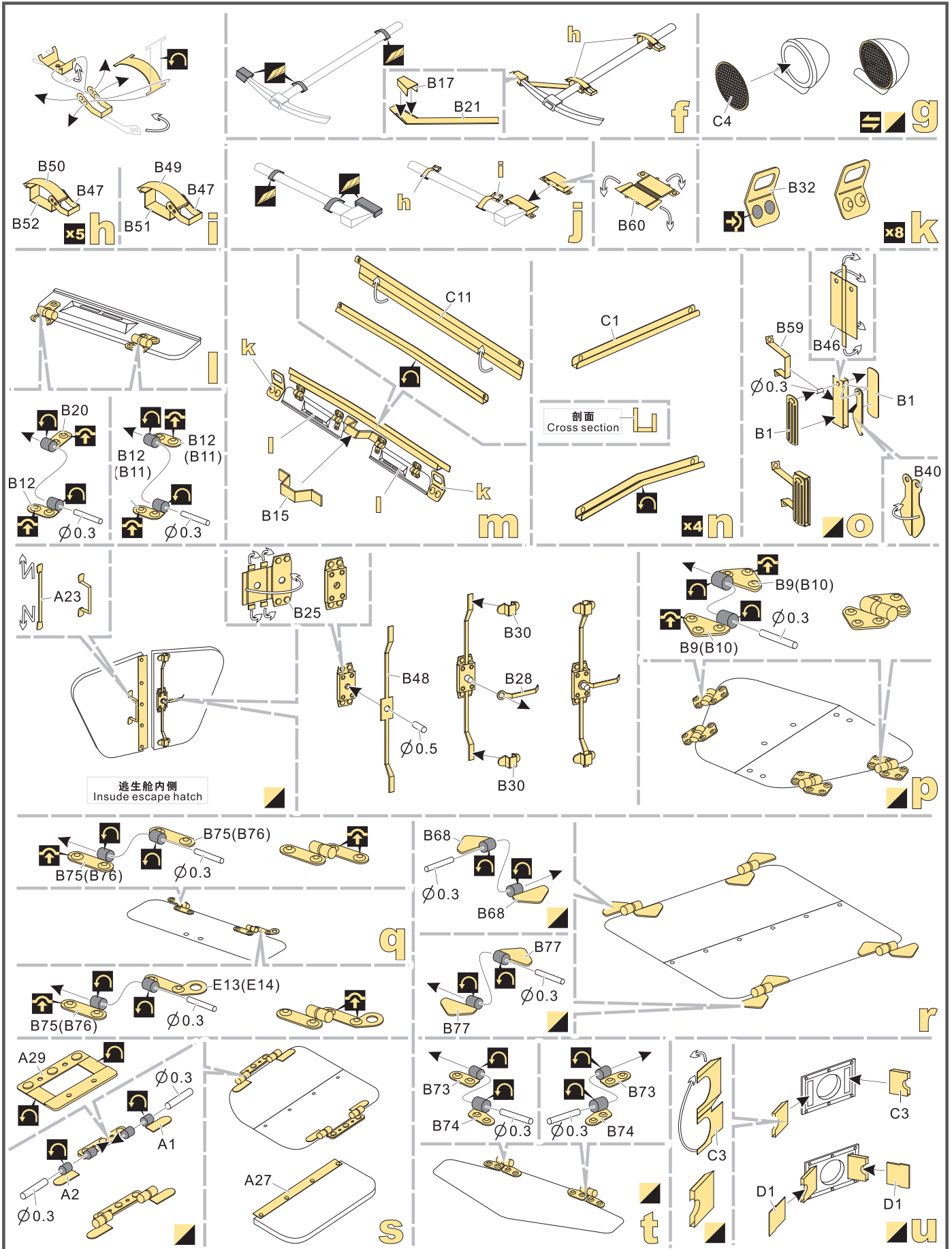

1/35 MILITARY MINIATURE VEHICLE UPGRADE SERIES PE35490

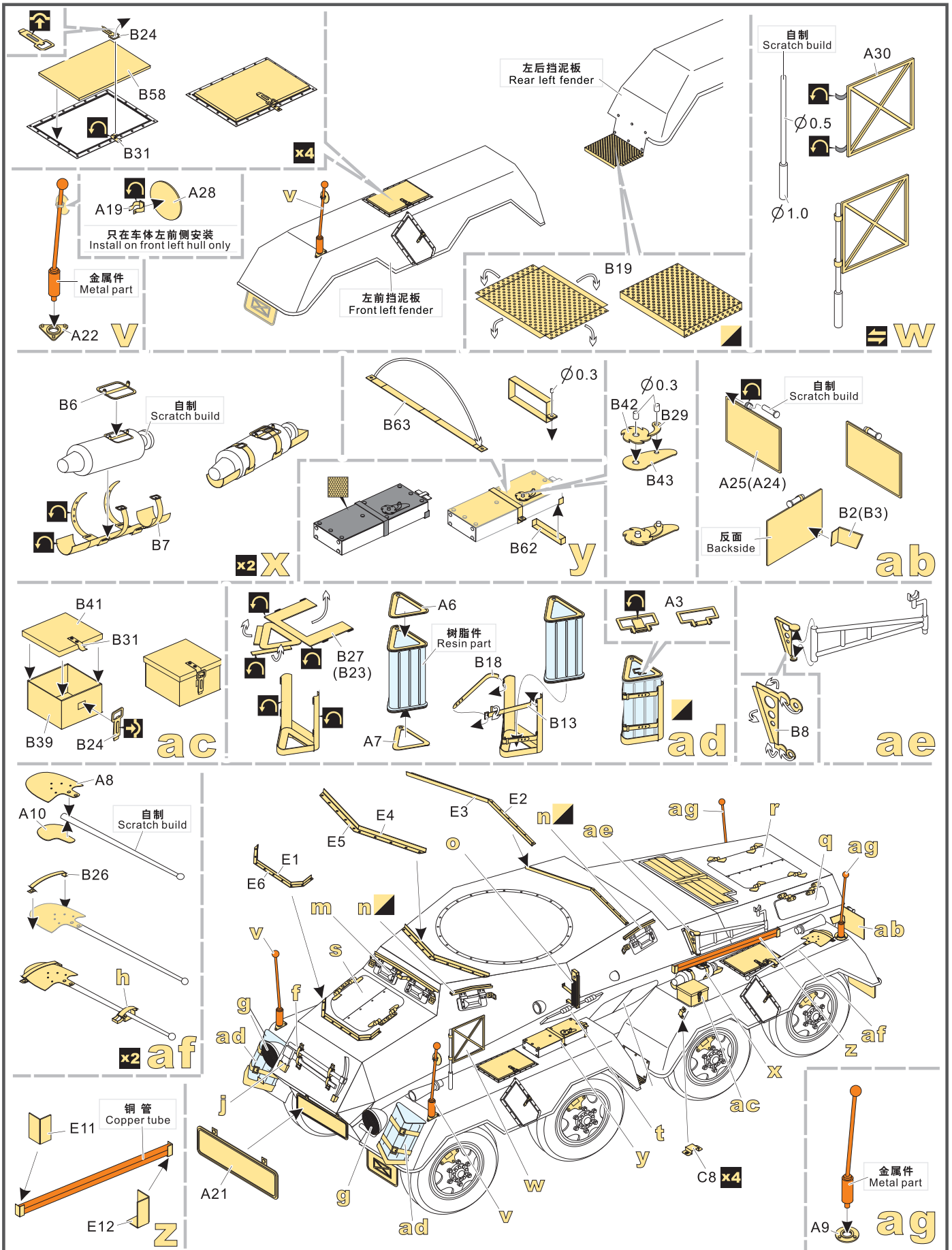

1/35 MILITARY MINIATURE VEHICLE UPGRADE SERIES PE35490

ah **ai** **aj** **al** **am** **an** **ak**

Parts shown in detail: C6(C7), B14, C12, B18, B44, B31, C24, A14, A15, A16, A17, B61, C9, B64(B65), B71(B72), A5, E15, Ø0.3, Ø0.5.

Assembly instructions: **am an** (parts B64, B71, A5, Ø0.3); **aj** (parts B31, C24, x2); **al** (part C9); **ak** (parts A14, A15, A16, A17, B61); **ah** (parts C6, C7); **ai** (parts B14, C12); **aj** (parts B31, C24).

Additional instructions: **am an** (parts B64, B71, A5, Ø0.3); **an** (part A5, Ø0.5).

Notes: 切下所需喷漆模板, 用胶带固定位置并遮盖要点 (Cut off required pattern, use tape for positioning and masking). 喷涂单色图案所需颜色, 或喷涂多色图案之底色 (Spray required color; For multi-colored ones, spray background color at this time).

Reference: Sd.Kfz.232

VOYAGERMODEL® 无微不至 极尽享受
The Best Upgrade Solution

Recommended item

PE 35065	WWII German Sd.kfz.232 6Rad
PE 35193	WWII German Sd.Kfz.232 8ROD early version(TAMIYA KIT)
PE 35489	WWII German Sd.Kfz.231 8ROD early version(AFV 35231)
PEA 295	WWII German Sd.Kfz.231 family 8ROD Road Wheels